

10 ft. 8 3/8 in.

10"
6"

Letter Height = 4.5 in.

4 ft. 9 in.



1 ft. 8 in.

6 ft. 6 in.



7 ft. 8 in.

9 ft. 4 in.

Scale = 18.72x

20"

 **Tyus Park**

1.1

 **City Park &
Golf Course**

5

 **City Park &
Golf Course**

11

**City Park &
Golf Course**



12

 **Welcome Ctr.**

Downtown

25

**Lakes at
Green Valley**



34

 **Lakes at
Green Valley**

35

12 ft. 5 3/8 in.

Letter Height = 4.5 in.

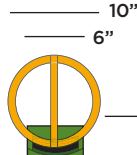

4 ft. 9 in.



3 ft. 5 in.

6 ft. 6 in.



7 ft. 8 in.

11 ft. 1 in.

Scale = 18.72x

41"

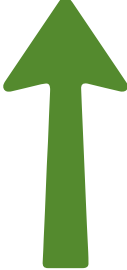
 **Welcome Ctr.**

Downtown

City Park & Golf Course

2.0

Courthouse 
Annex/City Hall

 **Welcome Ctr.**

Heritage Park

Welcome Ctr.

Downtown 

Memorial Stadium

22

Memorial Stadium 

 **Lakes at Green Valley**

21

 **Welcome Ctr.**

Downtown

City Park & Golf Course

26

 **Welcome Ctr.**

Downtown

City Park & Golf Course

28

Quarry's Edge

Welcome Ctr. 

Downtown

40

 **Quarry's Edge**

 **Welcome Ctr.**

Downtown

41

13 ft. 9 3/8 in.

Letter Height = 4.5 in.

10"
6"

4 ft. 9 in.



4 ft. 9 in.

6 ft. 6 in.



7 ft. 8 in.

12 ft. 11 3/8 in.

Scale = 18.72x

Welcome Ctr.

Downtown

City Park & Golf Course

Memorial Stadium

3

Welcome Ctr.

Downtown

Memorial Stadium

Griffin Auditorium

1.2

Downtown

Welcome Ctr.

Griffin Auditorium

City Park & Golf Course

33

Tyus Park →

← **Dundee Lake Park**

Welcome Ctr.

Downtown

Mem. Stadium

1

Memorial Stadium →

← **City Park & Golf Course**

Welcome Ctr.

Downtown

4

Welcome Ctr.

← **Downtown**

City Park & Golf Course

Memorial Stadium

24

Welcome Ctr. →

Courthouse Annex/City Hall

Heritage Park

↑ **City Park & Golf Course**

10

Welcome Ctr.

↑ **Downtown**

Memorial Stadium

City Park & Golf Course

13

← **Welcome Ctr.**

Downtown

Griffin Auditorium

↑ **Memorial Stadium**

16

City Park & Golf Course →

↑ **Welcome Ctr.**

Downtown

Memorial Stadium

14

Welcome Ctr.

Downtown ↗

Memorial Stadium

Griffin Auditorium

15

Welcome Ctr.

↑ **Downtown**

Memorial Stadium

City Park & Golf Course

18

14 ft. 8³/₈ in.

10"
6"

4 ft. 9 in.

Letter Height = 4.5 in.

City Park & Golf Course →

Welcome Ctr.

↑ **Courthouse Annex/City Hall**

Memorial Stadium

Griffin Auditorium

Griffin

5 ft. 8 in.

6 ft. 6 in.

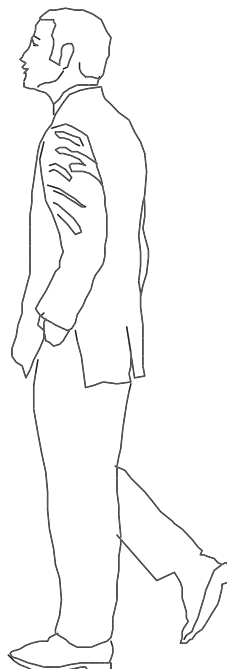

7 ft. 8 in.

13 ft. 10³/₈ in.

Scale = 18.72x

Lakes at Green Valley →

Griffin Auditorium

↑ **Welcome Ctr.**

Courthouse Annex/City Hall

Heritage Park

6

Welcome Ctr.

Downtown

↑ **Memorial Stadium**

City Park & Golf Course

Griffin Auditorium

8

← **UGA Griffin Quarry's Edge**

UGA Gardens →

↑ **Welcome Ctr.**

Downtown

Memorial Stadium

23

← **Volunteer Park**

↑ **Welcome Ctr.**

Downtown

Memorial Stadium

Griffin Auditorium

17

← **Memorial Stadium**

↑ **Welcome Ctr.**

Downtown

City Park & Golf Course

Griffin Auditorium

9

← **Dundee Lake Park**

Wyomia Tyus Park →

↑ **Welcome Ctr.**

Downtown

City Park & Golf Course

27

City Park & Golf Course →

↑ **Welcome Ctr.**

Courthouse Annex/City Hall

Memorial Stadium

Griffin Auditorium

19

← **Welcome Ctr.**

Courthouse Annex/City Hall

Heritage Park

↑ **Memorial Stadium**

G. Auditorium

Lakes at Green Valley

20

← **Courthouse Annex/City Hall**

↑ **City Park & Golf Course**

Memorial Stadium

Griffin Auditorium

30

City Park & Golf Course →

← **Memorial Stadium**

Griffin Auditorium

Lakes at Green Valley

31

Welcome Ctr.

Downtown







Memorial Stadium ↗

G. Auditorium





City Park & Golf Course

17.1

PAIN T SCHEDULE

| | |
|---|----------------------|
|  | P1 AKZO NOBEL 443-E4 |
|  | P2 AKZO NOBEL 443-G2 |
|  | P3 AKZO NOBEL 443-C4 |
|  | P4 AKZO NOBEL 424-D6 |
|  | P5 AKZO NOBEL 426-A1 |
|  | P6 AKZO NOBEL 426-B3 |

VINYL SCHEDULE

| | |
|---|-----------------------------|
|  | V1 3M 7725-196 APPLE GREEN |
|  | V2 3M REFLECTIVE WHITE 3290 |
|  | V3 3M 7725-77 PEACOCK BLUE |
|  | V4 3M 7725-25 SUNFLOWER |

1 PROJECT MATERIAL & PAINT SPECIFICATIONS

ABCDEFGHIJKLMNOPQRSTUVWXYZ
1234567890

2 PROJECT TYPEFACE I - GOTHAM BOLD

ABCDEFGHIJKLMNOPQRSTUVWXYZ
1234567890

3 PROJECT TYPEFACE II - GOTHAM BOOK

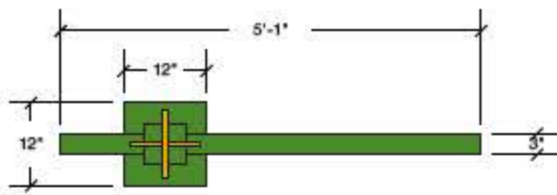

4 VEHICULAR DIRECTIONAL - PLAN VIEW
SCALE: 1/2" = 1'-0"

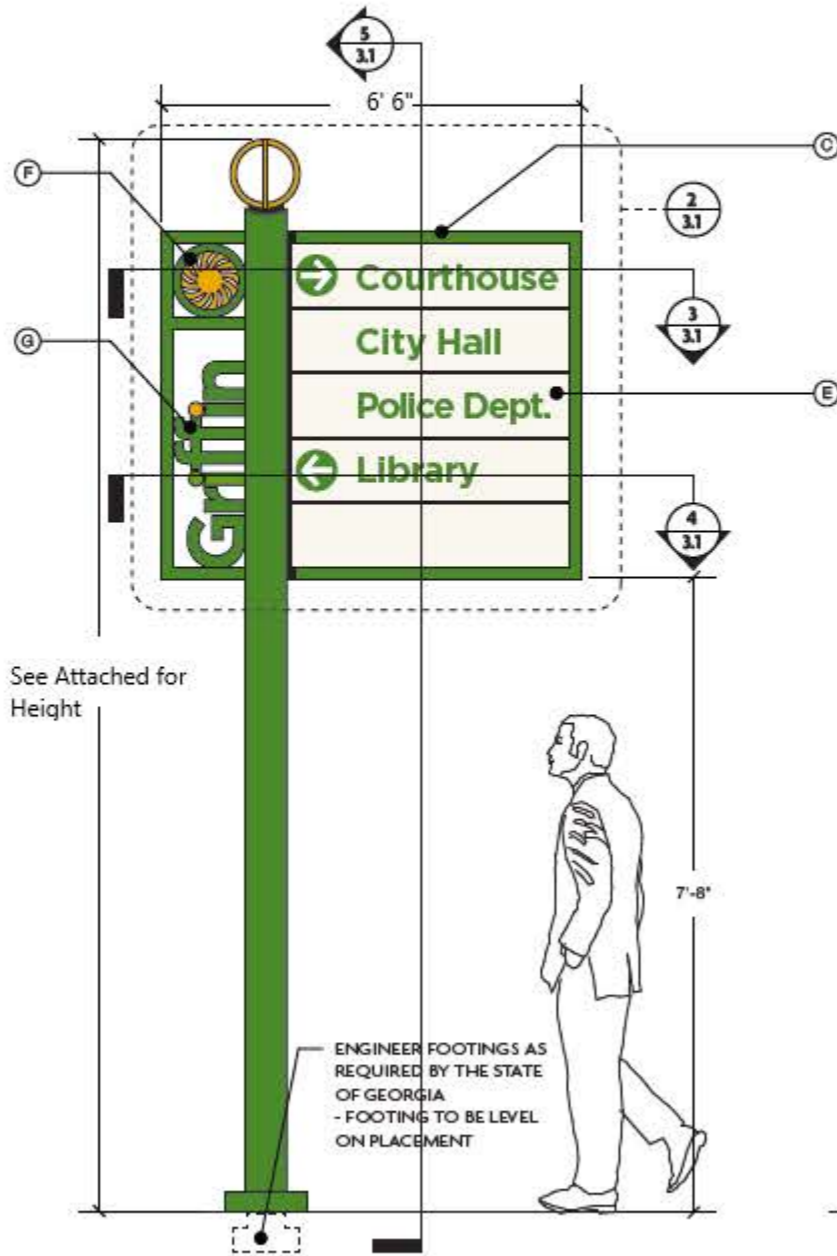

See Attached for Height

ENGINEER FOOTINGS AS REQUIRED BY THE STATE OF GEORGIA
- FOOTING TO BE LEVEL ON PLACEMENT

1 VEHICULAR DIRECTIONAL - FRONT ELEVATION
SCALE: 1/2" = 1'-0"

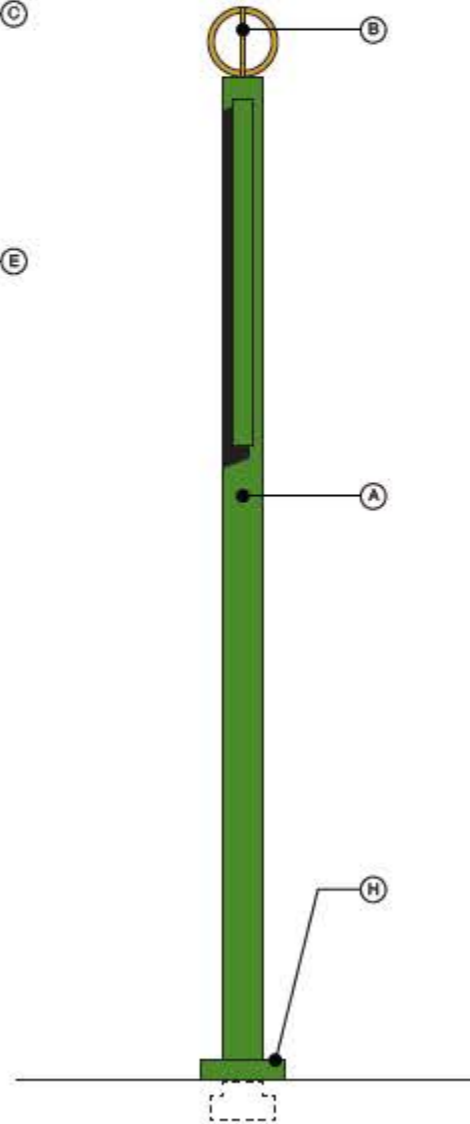

2 VEHICULAR DIRECTIONAL - SIDE ELEVATION
SCALE: 1/2" = 1'-0"

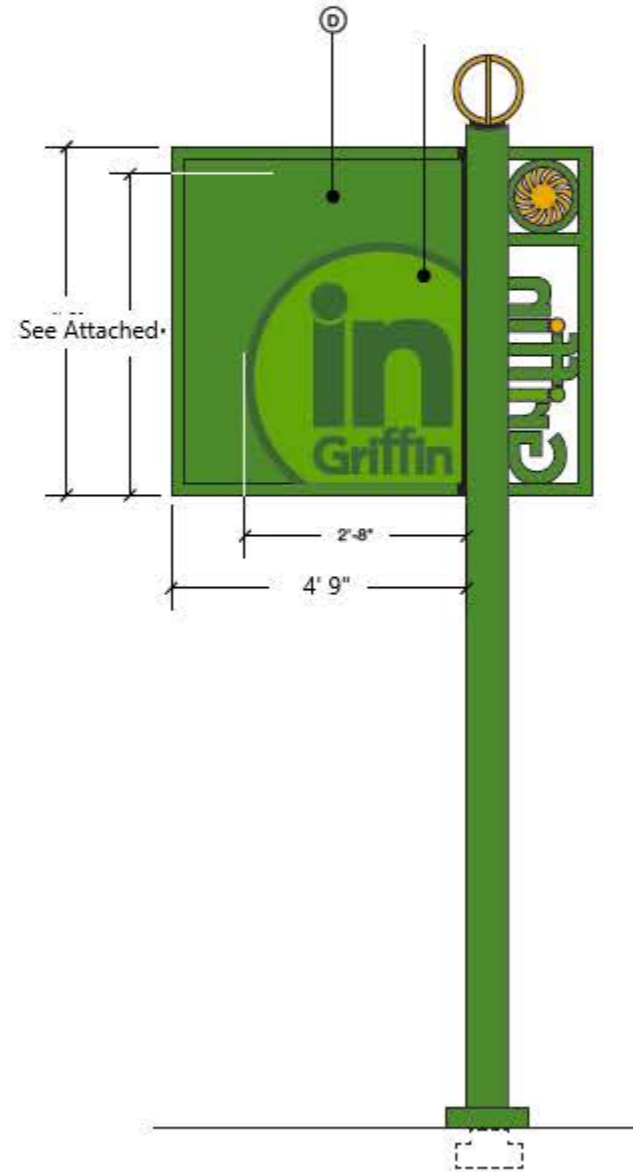

3 VEHICULAR DIRECTIONAL - BACK ELEVATION
SCALE: 1/2" = 1'-0"

MATERIALS & SPECIFICATIONS

- A - 6" SQUARE ALUMINUM TUBE POST WITH SCALLOPED TOP, PAINTED P1
- B - FABRICATED .75" THICK ALUMINUM FINIAL, PAINTED P4 WITH .5" THICK ALUMINUM SUPPORT, PAINTED P2
- C - FABRICATED ALUMINUM TUBE FRAME, PAINTED P1
- D - .125" THICK ALUMINUM PANEL, (FRONT SIDED) PAINTED P1 AND (BACK SIDE) PAINTED P1 WITH MASKED AND PAINTED LOGOGRAPHIC P3
- E - .125" THICK ALUMINUM PANEL PAINTED P5 WITH APPLIED VINYL COPY V1
- F - See attached graphics; vinyl sun and line graphic in V4 on painted P5.
- G - See attached graphics with logo V2 on painted P1.
- H - FABRICATED ALUMINUM ESCUTCHEON COVER, PAINTED P1

INSTALL:

- SIGN LOCATION TO BE SET BACK 10 FT. FROM ROW IN ACCORDANCE WITH GDOT REQUIREMENTS
- BACKFILL AS REQUIRED
- ALL STRUCTURAL COMPONENTS TO BE VERIFIED BY ENGINEER

NOTES:

- ALL LOCATIONS WILL REQUIRE ADDITIONAL REVIEW TO DETERMINE EXACT ORIENTATION AND PLACEMENT.



4 SECTION VIEW
SCALE: 3/4"=1'-0"

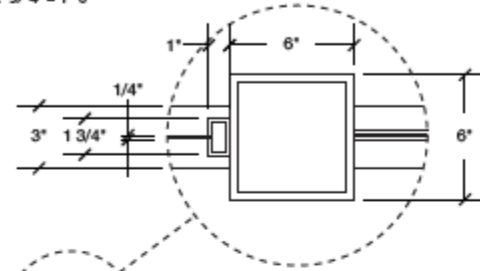

3 SECTION VIEW
SCALE: 3/4"=1'-0"

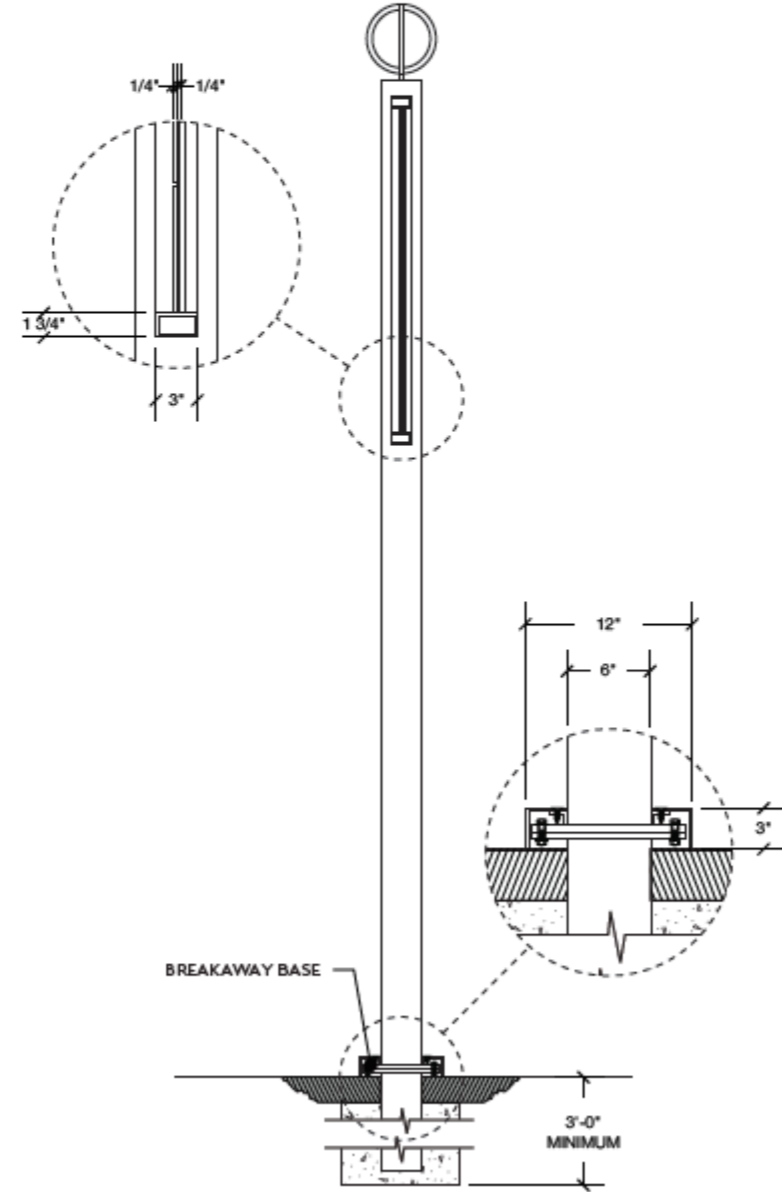

5 SECTION VIEW
SCALE: 3/4"=1'-0"