

AIDS TO NAVIGATION (AtoN)

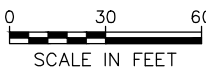

1

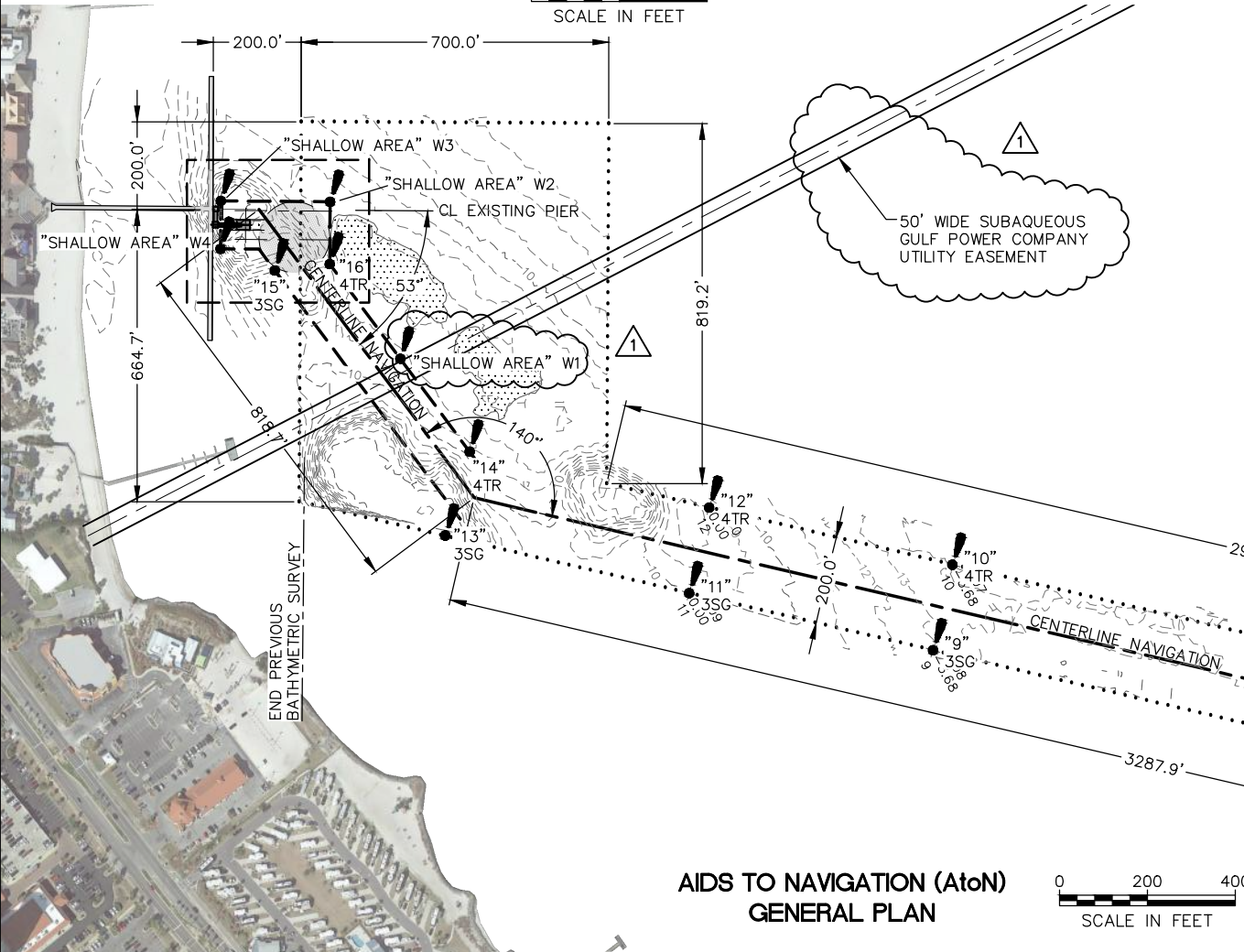

AIDS TO NAVIGATION (AtoN)
GENERAL PLAN

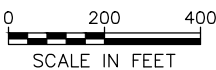

AIDS TO NAVIGATION TABLE										
MARK	LATITUDE	LONGITUDE	TYPE	DAYMARK	LANTERN NOMINAL RANGE	LANTERN	LANTERN FOCAL POINT	PILE DIA	TIP ELV.	CUTOFF ELV.
2	N30° 20' 57.97"	W87° 07' 55.06"	NAVIGATION	RED TRIANGLE	3NM	RED	+14.5'	12 IN	-46.0'	+14.0 FT
4	N30° 20' 48.51"	W87° 07' 54.81"	NAVIGATION	RED TRIANGLE	3NM	RED	+14.5'	12 IN	-46.0'	+14.0 FT
6	N30° 20' 37.53"	W87° 07' 54.52"	NAVIGATION	RED TRIANGLE	3NM	RED	+14.5'	12 IN	-46.0'	+14.0 FT
8	N30° 20' 29.53"	W87° 08' 02.31"	NAVIGATION	RED TRIANGLE	3NM	RED	+14.5'	12 IN	-46.0'	+14.0 FT
10	N30° 20' 21.24"	W87° 08' 10.38"	NAVIGATION	RED TRIANGLE	3NM	RED	+14.5'	12 IN	-46.0'	+14.0 FT
12	N30° 20' 16.93"	W87° 08' 14.58"	NAVIGATION	RED TRIANGLE	3NM	RED	+14.5'	12 IN	-46.0'	+14.0 FT
14	N30° 20' 12.70"	W87° 08' 18.70"	NAVIGATION	RED TRIANGLE	3NM	RED	+14.5'	12 IN	-46.0'	+14.0 FT
16	N30° 20' 11.81"	W87° 08' 24.69"	NAVIGATION	RED TRIANGLE	3NM	RED	+14.5'	12 IN	-46.0'	+14.0 FT
1	N30° 20' 58.02"	W87° 07' 52.78"	NAVIGATION	GREEN SQUARE	3NM	GREEN	+14.5'	12 IN	-46.0'	+14.0 FT
3	N30° 20' 48.55"	W87° 07' 52.53"	NAVIGATION	GREEN SQUARE	3NM	GREEN	+14.5'	12 IN	-46.0'	+14.0 FT
5	N30° 20' 36.83"	W87° 07' 52.22"	NAVIGATION	GREEN SQUARE	3NM	GREEN	+14.5'	12 IN	-46.0'	+14.0 FT
7	N30° 20' 28.25"	W87° 08' 00.57"	NAVIGATION	GREEN SQUARE	3NM	GREEN	+14.5'	12 IN	-46.0'	+14.0 FT
9	N30° 20' 19.97"	W87° 08' 08.64"	NAVIGATION	GREEN SQUARE	3NM	GREEN	+14.5'	12 IN	-46.0'	+14.0 FT
11	N30° 20' 15.66"	W87° 08' 12.83"	NAVIGATION	GREEN SQUARE	3NM	GREEN	+14.5'	12 IN	-46.0'	+14.0 FT
13	N30° 20' 11.34"	W87° 08' 17.03"	NAVIGATION	GREEN SQUARE	3NM	GREEN	+14.5'	12 IN	-46.0'	+14.0 FT
15	N30° 20' 10.64"	W87° 08' 25.19"	NAVIGATION	GREEN SQUARE	3NM	GREEN	+14.5'	12 IN	-46.0'	+14.0 FT
W1	N30° 20' 12.26"	W87° 08' 21.67"	DANGER MARK	WARNING ORANGE DIAMOND	3NM	WHITE	+14.5'	12 IN	-46.0'	+14.0 FT
W2	N30° 20' 12.45"	W87° 08' 26.12"	DANGER MARK	WARNING ORANGE DIAMOND	3NM	WHITE	+14.5'	12 IN	-46.0'	+14.0 FT
W3	N30° 20' 10.27"	W87° 08' 27.43"	DANGER MARK	WARNING ORANGE DIAMOND	3NM	WHITE	+14.5'	12 IN	-46.0'	+14.0 FT
W4	N30° 20' 09.77"	W87° 08' 26.33"	DANGER MARK	WARNING ORANGE DIAMOND	3NM	WHITE	+14.5'	12 IN	-46.0'	+14.0 FT

VERTICAL DATUM: NAVD88
BATHYMETRIC FIELD SURVEY PERFORMED ON DECEMBER 14,17,21, AND 22, 2016 BY BUTLER & ASSOCIATES OF PENSACOLA, INC.
BEARINGS AND COORDINATES SHOWN HAVE THE FOLLOWING METDATA:
A. PROJECTION ZONE: FLORIDA NORTH
B. PROJECTION TYPE: LAMBERT CONFORMAL CONIC.
C. DATUM: NORTH AMERICAN DATUM OF 1983 WITH DATUM TAG OF 2011 (NAD83 (2011))

M

M

MOTT
MACDONALD

MOTT MACDONALD
FLORIDA LLC
220 West Garden Street
Suite 700,
Pensacola, Florida 32502
Telephone: (850) 484-6011
Architects AA - C000035
Engineers EB - 0000155
Surveyors LB - 0006783

Client

DRAWINGS
PREPARED FOR
ESCAMBIA COUNTY,
FLORIDA

1	4/13/18	TM	REVISED NAV AID LOCATION		
Rev	Date	Drawn	Description	Chkd	App'd

Project Number
369128

B/O
1

Total
2

Designed	AR		Eng check	KP	
Drawn	SK		Coordination	KP	
Dwg check	KP		Approved		
Scale at ANSI D	Status	Rev	Security		
Drawing Number		X-XX			

Title
QUIETWATER BEACH
FERRY LANDING
PENSACOLA BEACH, FLORIDA

AIDS TO
NAVIGATION PLAN

This drawing is the property of Mott MacDonald Florida, LLC., and may not be reproduced without written permission. This document should not be relied on or used in circumstances other than those for which it was originally prepared and for which Mott MacDonald was commissioned. Mott MacDonald accepts no responsibility for this document to any party other than the person or entity by whom it was commissioned.