



CITY OF AZTEC  
 REQUEST FOR QUOTATION  
 RFQ # **2022-811**  
**THIS IS NOT AN ORDER**

DATE:	05/24/2022	<b>SUBMIT QUOTES TO:</b>  CITY OF AZTEC Attn: Joni Gay, Finance Dept 201 W. Chaco, Aztec, NM 87410  EMAIL: <a href="mailto:jgay@aztecnm.gov">jgay@aztecnm.gov</a>  PHONE: (505) 334-7656 FAX: (505) 334-7649  Quotes may be submitted via fax, email, or uploaded to VendorRegistry.com.	<b>QUESTIONS MAY BE DIRECTED TO:</b>  Denver DeWees 505-334-7667 <a href="mailto:ddewees@aztecnm.gov">ddewees@aztecnm.gov</a>
DUE DATE:	06/06/2022		
TIME:	10:00 am		
NIGP CODE(S):	959-43, 659-33		

NAME OF COMPANY SUBMITTING QUOTE:

NEW MEXICO RESIDENT PREFERENCE	PAYMENT TERMS	DELIVERY/SERVICE ADDRESS
# _____	NET 30 DAYS AFTER RECEIPT OF INVOICE	307 S. Ash Ave. Aztec NM 87410
NM Resident or Veteran Preference will be applied only to those certified vendors who enter # above <b>AND</b> attach current certificate.	DISCOUNT FOR EARLY PAYMENT: _____ % _____ DAYS	FOB DESTINATION – FREIGHT COSTS:
		Include all freight in quote. FOB Destination.

**NOTES TO BIDDERS:** Include freight/delivery charge if applicable.  
 Itemized quote required. May be submitted on this form or attached to this form.  
 This form must be submitted and signed on page 2.

**Brand Name or Equivalent:** Manufacture name listed for the purpose of describing the standard of quality, performance, and characteristics desired. Equivalents exhibiting the same standard of design, function, quality and performance will be considered. Include complete specifications if quoting a substitute.

ITEM #	DESCRIPTION	QTY	UNIT	PRICE PER UNIT	EXTENDED PRICE	DELIVERY TIME AFTER ORDER
1	Interference Gasket Joint, Champion 40A-SW-20-G, belowground (or equal), 4in IPS, AG; .070in Wall; Conduit, 20 ft. Lg.	3000	Ft			
2	Elbow, Champion 40A-SW-92-P, belowground (or equal), 4in SW .070in Wall; Conduit, 90° x 36"	16	Ea			
3	Joint, Expansion, Champion 40C-SW-37, aboveground (or equal), 4in IPS, AG; .070in Wall, Socket x Socket, w/ o-ring.	2	Ea			

ITEM #	DESCRIPTION	QTY	UNIT	PRICE PER UNIT	EXTENDED PRICE	DELIVERY TIME AFTER ORDER
4	Coupling, Stop w/ Gasket, Champion 40A-SW-40-G, belowground (or equal), 4in SW .070in Wall.	16	Ea			
5	Shipping costs shall be included in quote. CHECK ONE: <input type="checkbox"/> Freight <b>IS</b> included in pricing above. <input type="checkbox"/> Freight is <b>NOT</b> including in pricing above. List separately on this line:	1	EA			
Must meet standards and performance equal to Champion Fiberglass brand, including: Epoxy fiberglass, corrosion resistant, temp range -60° to +250°, UV stable, coefficient of thermal expansion rating of 1.0 (10-5 inch/inch/°F), ISO 9001 certified (Quality Management System Standard), ISO 14001 certified (Environmental Management System Standard), ISO 45001 certified (Occupational Health and Safety Management System Standard).						

Total:

--

DATE OF QUOTE	
SUBMITTED BY (Print Name)	
SIGNATURE (Bidder must sign to validate offer.)	
COMPANY NAME	
ADDRESS	
TELEPHONE	
EMAIL ADDRESS	
FED TAX ID NUMBER	
NM CRS ID NUMBER	

- RFQ shall be FOB Destination and must indicate normal lead time and/or best delivery date on the items listed. Shipping costs shall be included in quote. New Mexico laws prohibit acceptance of ownership of goods in transit.
- This RFQ and any required documents must be received by the Department indicated on the RFQ by the date and time indicated. RFQ's may be submitted via email, fax, USPS (or VendorRegistry.com if published there).
- All supplies and components quoted shall be new unless indicated otherwise. Any quotes submitted for used or

reconditioned supplies or components will be considered non-responsive. Quotes must be valid for a minimum of 30 days.

- The RFQ Number shall appear on all quotations and related correspondence.
- NM Resident & Veteran Vendor Preference: Preference will only be applied to those Bidders who have been issued a certification number from the State of NM Taxation & Revenue Department and return a copy of their certificate

with their quote. Veterans Preference and Resident Preference are separate and are not cumulative.

6. Use of Contract by Other Agencies: Pursuant to Section 13-1-129, NMSA 1978, Bidders /Contractors /Offerors are hereby notified that any central purchasing office allowed by law and as otherwise allowed by their respective governing rules and regulations, may contract for the goods and/or services included in this procurement document with the awarded Bidder /Contractor /Offeror. Contractual engagements accomplished under this provision shall be solely between the Bidder /Contractor /Offeror and the contracting entity with no obligation by the City of Aztec.
7. By law (Section 13-1-191, NMSA, 1978) the City is required to inform Vendors of the following: (1) it is a third-degree felony under NM law to commit the offense of bribery of a public officer or public employee (Section 30-24-1); (2) it is a third- degree felony to commit the offense of demanding or receiving a bribe by a public officer or public employee (Section 30-24-2); (3) it is a fourth-degree felony to commit the offense of soliciting or receiving illegal kickbacks (Section 30-41-1); (4) it is a fourth-degree felony to commit the offense of offering or paying illegal kickbacks (Section 30-41-2).
8. Conflict of Interest: Bidder warrants that it presently has no interest and will not acquire any interest, direct or indirect, which would conflict in any manner or degree with the performance of service under this contract. Bidder must notify the City's Chief Procurement Officer if any employee(s) of the requesting department or the Purchasing Office have a financial interest in the Bidder. If yes, the Bidder must specify the employee(s) name in their proposal.
9. Debarment, Suspension, and Ineligibility: By submitting a response (RFQ/Bid/Offer) to this solicitation, the business (Bidder /Offeror /Contractor) represents and warrants that it is not debarred, suspended, or placed in ineligibility under the provisions of Federal Executive Order 12549.
10. New vendors required to complete Vendor Packet <http://www.aztecnm.gov/purchasing/NewVendorPacket.pdf> prior to issuance of purchase order.

ITEM 1. 40A-SW-20-G

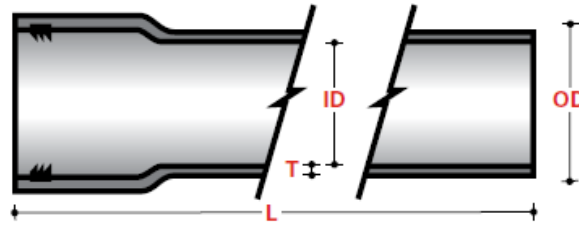

**INTERFERENCE GASKET JOINT\*\***



For further information, use your smart phone's QR code scanner to learn more about Interference Gasket Joints.

	TYPE SW (STANDARD WALL) INCHES (METRIC)											
	NOMINAL SIZE	IPS ITEM NO		UL/CSA LISTED	OUTSIDE DIAMETER		MIN. INSIDE DIAMETER	NOMINAL WALL THICKNESS* (T)	LENGTH (L)	WEIGHT		
		BELOW GROUND	ABOVE GROUND		AVERAGE	TOLERANCE				LBS/FT	KG/M	
<input type="checkbox"/>	2" (51)	20A-SW-20-G	20C-SW-20-G	Yes	2.375" (60)	+0.028" (0.7) -0.018" (0.4)	2.235" (57)	.070" (2)	20 ft (6.1 m)	0.38 (0.57)		
<input type="checkbox"/>	3" (76)	30A-SW-20-G	30C-SW-20-G	Yes	3.500" (89)	+0.028" (0.7) -0.018" (0.4)	3.360" (85)	.070" (2)	20 ft (6.1 m)	0.60 (0.90)		
<input type="checkbox"/>	4" (102)	<b>40A-SW-20-G</b>	40C-SW-20-G	Yes	4.460" (113)	+0.028" (0.7) -0.018" (0.4)	4.320" (110)	.070" (2)	20 ft (6.1 m)	0.72 (1.07)		
<input type="checkbox"/>	5" (127)	50A-SW-20-G	50C-SW-20-G	-	5.520" (140)	+0.028" (0.7) -0.018" (0.4)	5.380" (137)	.070" (2)	20 ft (6.1 m)	0.90 (1.34)		
<input type="checkbox"/>	6" (152)	60A-SW-20-G	60C-SW-20-G	-	6.575" (167)	+0.028" (0.7) -0.018" (0.4)	6.435" (163)	.070" (2)	20 ft (6.1 m)	1.00 (1.49)		
<input type="checkbox"/>	8" (203)	80A-SW-20-G	80C-SW-20-G	-	8.592" (218)	+0.028" (0.7) -0.018" (0.4)	8.400" (213)	.096" (2)	20 ft (6.1 m)	2.02 (3.01)		

ITEM 2. 40A-SW-92-P



**90° x 36"**

	NOMINAL		IPS ITEM NO		M	O-TANGENT (MIN)		R-RADIUS (MIN)		WEIGHT	
	SIZE	TYPE	BELOW GROUND	ABOVE GROUND						LBS	KG
<input type="checkbox"/>	3/4"	SW	07A-SW-92-P	07C-SW-92-P	1.05" (27)	6"	(152)	36"	(914)	0.96	(0.44)
<input type="checkbox"/>	1"	SW	10A-SW-92-P	10C-SW-92-P	1.32" (33)	6"	(152)	36"	(914)	1.08	(0.49)
<input type="checkbox"/>	1-1/4"	SW	12A-SW-92-P	12C-SW-92-P	1.66" (42)	6"	(152)	36"	(914)	1.30	(0.59)
<input type="checkbox"/>	1-1/2"	SW	15A-SW-92-P	15C-SW-92-P	1.90" (48)	6"	(152)	36"	(914)	1.87	(0.85)
<input type="checkbox"/>	2"	SW	20A-SW-92-P	20C-SW-92-P	2.37" (60)	6"	(152)	36"	(914)	2.15	(0.98)
<input type="checkbox"/>	2-1/2"	SW	25A-SW-92-P	25C-SW-92-P	2.88" (73)	6"	(152)	36"	(914)	2.61	(1.19)
<input type="checkbox"/>	3"	SW	30A-SW-92-P	30C-SW-92-P	3.50" (89)	6"	(152)	36"	(914)	3.40	(1.54)
<input type="checkbox"/>	4"	SW	40A-SW-92-P	40C-SW-92-P	4.46" (113)	6"	(152)	36"	(914)	4.08	(1.85)
<input type="checkbox"/>	4"	HW	40A-HW-92-P	40C-HW-92-P	4.51" (115)	6"	(152)	36"	(914)	5.50	(2.50)
<input type="checkbox"/>	5"	SW	50A-SW-92-P	50C-SW-92-P	5.52" (140)	6"	(152)	36"	(914)	5.14	(2.34)
<input type="checkbox"/>	5"	MW	50A-MW-92-P	50C-MW-92-P	5.57" (141)	6"	(152)	36"	(914)	6.85	(3.08)
<input type="checkbox"/>	5"	HW	50A-HW-92-P	50C-HW-92-P	5.60" (142)	6"	(152)	36"	(914)	7.54	(3.42)
<input type="checkbox"/>	6"	SW	60A-SW-92-P	60C-SW-92-P	6.58" (167)	6"	(152)	36"	(914)	5.71	(2.57)
<input type="checkbox"/>	6"	MW	60A-MW-92-P	60C-MW-92-P	6.63" (168)	6"	(152)	36"	(914)	8.11	(3.65)
<input type="checkbox"/>	6"	HW	60A-HW-92-P	60C-HW-92-P	6.66" (169)	6"	(152)	36"	(914)	9.31	(4.19)

ITEM 3. 40C-SW-37

## SINGLE EXPANSION JOINT SOCKET X SOCKET WITH O-RING

	NOMINAL		IPS ITEM NO	A	B	L - MIN	L - MAX	WEIGHT	
	SIZE	TYPE	ABOVE GROUND					LBS	KG
<input type="checkbox"/>	3/4"	SW	07C-SW-37	1.20" (30)	12" (305)	18" (457)	26" (660)	0.49	(0.22)
<input type="checkbox"/>	1"	SW	10C-SW-37	1.46" (37)	12" (305)	18" (457)	26" (660)	0.55	(0.25)
<input type="checkbox"/>	1-1/4"	SW	12C-SW-37	1.81" (46)	12" (305)	18" (457)	26" (660)	0.66	(0.30)
<input type="checkbox"/>	1-1/2"	SW	15C-SW-37	2.04" (52)	12" (305)	18" (457)	26" (660)	0.76	(0.35)
<input type="checkbox"/>	2"	SW	20C-SW-37	2.54" (65)	12" (305)	18" (457)	26" (660)	1.09	(0.50)
<input type="checkbox"/>	3"	SW	30C-SW-37	3.66" (93)	12" (305)	18" (457)	26" (660)	1.73	(0.79)
<input type="checkbox"/>	4"	SW	40C-SW-37	4.61" (117)	12" (305)	18" (457)	26" (660)	2.07	(0.94)
<input type="checkbox"/>	4"	HW	40C-HW-37	4.69" (119)	12" (305)	18" (457)	26" (660)	2.79	(1.27)
<input type="checkbox"/>	5"	SW	50C-SW-37	5.68" (144)	12" (305)	18" (457)	26" (660)	2.59	(1.18)
<input type="checkbox"/>	5"	MW	50C-MW-37	5.79" (147)	12" (305)	18" (457)	26" (660)	3.45	(1.57)
<input type="checkbox"/>	5"	HW	50C-HW-37	5.85" (149)	12" (305)	18" (457)	26" (660)	3.74	(1.70)
<input type="checkbox"/>	6"	SW	60C-SW-37	6.75" (171)	12" (305)	18" (457)	26" (660)	2.88	(1.31)
<input type="checkbox"/>	6"	MW	60C-MW-37	6.85" (174)	12" (305)	18" (457)	26" (660)	4.08	(1.85)
<input type="checkbox"/>	6"	HW	60C-HW-37	6.91" (176)	12" (305)	18" (457)	26" (660)	4.69	(2.13)

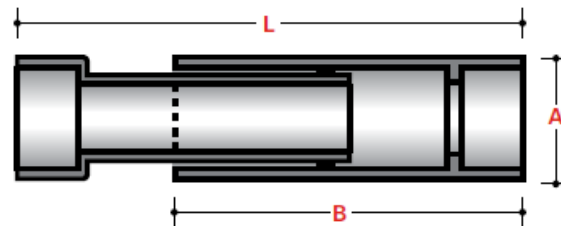

ITEM 4. 40A-SW-40-G

## STOP COUPLING WITH GASKET

	NOMINAL		IPS ITEM NO		D		L		WEIGHT	
	SIZE	TYPE	BELOW GROUND	ABOVE GROUND					LBS	KG
<input type="checkbox"/>	3/4"	SW	07A-SW-40-G	07C-SW-40-G	1.06"	(27)	8"	(203)	0.07	(0.03)
<input type="checkbox"/>	1"	SW	10A-SW-40-G	10C-SW-40-G	1.32"	(34)	8"	(203)	0.08	(0.04)
<input type="checkbox"/>	1-1/4"	SW	12A-SW-40-G	12C-SW-40-G	1.67"	(42)	8"	(203)	0.09	(0.04)
<input type="checkbox"/>	1-1/2"	SW	15A-SW-40-G	15C-SW-40-G	1.91"	(49)	8"	(203)	0.11	(0.05)
<input type="checkbox"/>	2"	SW	20A-SW-40-G	20C-SW-40-G	2.40"	(61)	8"	(203)	0.70	(0.32)
<input type="checkbox"/>	3"	SW	30A-SW-40-G	30C-SW-40-G	3.52"	(89)	8"	(203)	0.95	(0.43)
<input type="checkbox"/>	4"	SW	40A-SW-40-G	40C-SW-40-G	4.47"	(114)	9"	(228)	1.30	(0.59)
<input type="checkbox"/>	4"	HW	40A-HW-40-G	40C-HW-40-G	4.52"	(115)	9"	(228)	1.40	(0.64)
<input type="checkbox"/>	5"	SW	50A-SW-40-G	50C-SW-40-G	5.54"	(141)	10"	(254)	1.60	(0.73)
<input type="checkbox"/>	5"	MW	50A-MW-40-G	50C-MW-40-G	5.59"	(142)	10"	(254)	1.80	(0.82)
<input type="checkbox"/>	5"	HW	50A-HW-40-G	50C-HW-40-G	5.63"	(143)	10"	(254)	1.90	(0.86)
<input type="checkbox"/>	6"	SW	60A-SW-40-G	60C-SW-40-G	6.61"	(168)	10"	(254)	2.00	(0.91)
<input type="checkbox"/>	6"	MW	60A-MW-40-G	60C-MW-40-G	6.66"	(169)	10"	(254)	2.10	(0.95)
<input type="checkbox"/>	6"	HW	60A-HW-40-G	60C-HW-40-G	6.69"	(170)	10"	(254)	2.40	(1.09)

A stop coupling is sometimes referred to as a double bell coupling.

