

206' 8"

- INSTALL 6' FENCE WITH 3 STRAIND BARB WIRE

- DEMO EXISTING FENCE (SAME DIMENSIONS AS WHAT'S SHOWN) COUNTY WILL HAUL OFF.

- SEE ATTACHED MAT'L LIST. PLEASE ADVISE IF YOU SEE AN ISSUE.

114' 8"

98' 5"

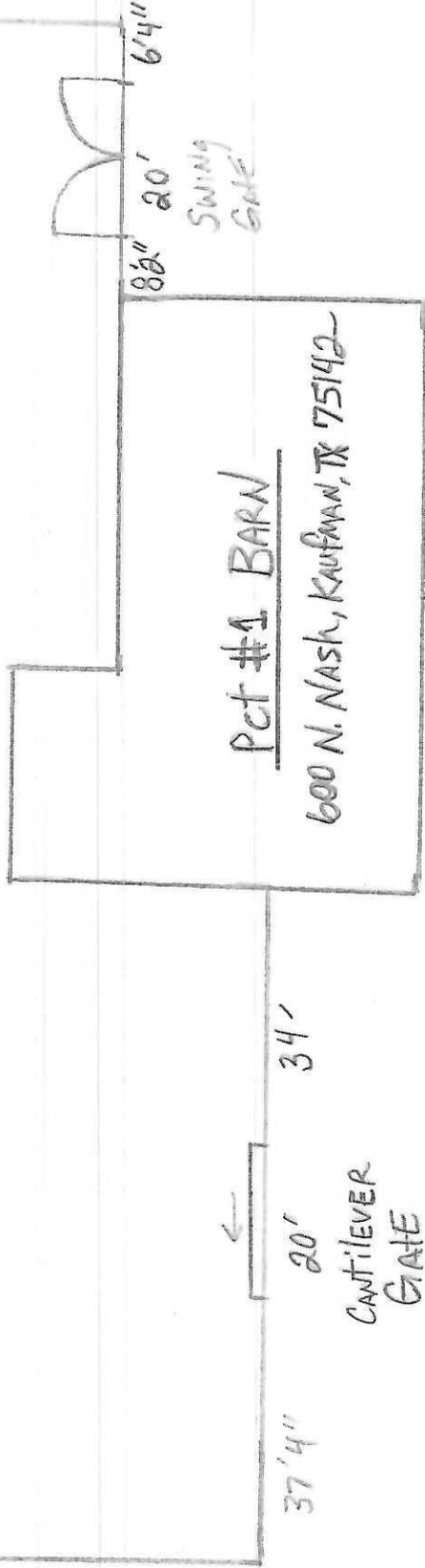

2" 9 GA 6'KT C/L GAW	500 LF
2 7/8 X 10'6" SCH40 POST	6 EA
4 X 10'6" SCH40 POST	3 EA
2 3/8 X 8' BF20 POST	48 EA
1 5/8 X 21' BF20 SE	504 LF
3/4 X 6' TENSION BAR	12 EA
1 5/8 PS OFFSET RAIL END	12 EA
2 7/8 BRACE BAND	40 EA
4 BRACE BAND	8 EA
2 7/8 TENSION BAND	50 EA
4 TENSION BAND	10 EA
5/16 X 1 1/4 CARRIAGE BOLT	200 EA
2 3/8 X 1 5/8 BARB ARM 45 DEGREE	48 EA
2 7/8 PS DOME CAP	6 EA
4 PS DOME CAP	3 EA
8 1/4 X 6GA ALUM TIES (100 CT BAG)	4 BG
6 1/2 X 9GA ALUM TIES (100 CT BAG)	4 BG
12GA. TENSION WIRE BY THE LB. LB 33' FEET PER LB	17 EA
12 1/2 GA STEEL HOG RINGS	5 LB
GATE	0
7'H X 19' TO 23'W CANTILEVER GATE 6-1 X 20' CANTILIVER GATE WITH BARB WIRE	1 EA
4 X 2 3/8 NYLON CANTILEVER ROLLER W/COVER	4 EA
4" X 1 7/8 CANTILEVER POST LATCH	1 EA
GATE 7'H X 19'6" TO 21'6" IND EA 1 5/8 BF20-F/W 11-9 GA FILL 20' WIDE X 6-1 HEIGHT BARB WIRE BOUBLE DRIVE GATE COX	1 EA
HINGES	0 SF
2 7/8 X 1 5/8 PS STEEL GATE HINGE	4 EA
CONCRETE MIX 80# BAG	120 BG
4 PT. BARB WIRE CLASS III 12 1/2 GA 1320' PER ROLL	2 RL