

Master Plant Schedule

Table with 6 columns: Key, Qty, Botanical Name, Common Name, Size, Notes. Lists various trees and shrubs such as Acer rubrum, Quercus alba, and Taxodium distichum.

Table with 6 columns: Key, Qty, Botanical Name, Common Name, Size, Notes. Lists lawn and mulch items like Festuca arundinacea and Arborist Wood Mulch.

Note: All trees to be installed by others

Abbreviations:

MT: Multi-trunk CT: Clear Trunk MIN: Minimum GAL: Gallon CL: Central Leader SF: Squar Feet DP-50: Deep Plug 50 Count PLS: Pure Live Seed

Table with 6 columns: Key, Qty, Botanical Name, Common Name, Size, Notes. Lists shrubs and groundcover plants like Amsonia hubrichtii, Aesculus parviflora, and Clethra alnifolia.

Table with 6 columns: Key, Qty, Botanical Name, Common Name, Size, Notes. Lists ornamental grasses such as Andropogon virginicus, Bouteloua gracilis, and Panicum virgatum.

Table with 6 columns: Key, Qty, Botanical Name, Common Name, Size, Notes. Lists wetland mix plants like Asclepias incarnata and Helenium autumnale.

Table with 6 columns: Key, Qty, Botanical Name, Common Name, Size, Notes. Lists short grass meadow mix plants like Baptisia x 'Purple Smoke' and Coreopsis x 'Baluptgonz'.

Table with 6 columns: Key, Qty, Botanical Name, Common Name, Size, Notes. Lists vines like Parthenocissus quinquefolia.

PROPERTY AND EXISTING R/W LINE REQUIRED R/W LINE CONSTRUCTION LIMITS PERMANENT EASEMENT FOR CONST. & MAINTENANCE OF SLOPES

PROGRESS SET NFC



REVISION DATES table with columns for date and description.

PLANTING PLAN ATLANTA BELTLINE SOUTHSIDE TRAIL (SEGMENT 2) PLANT SCHEDULE. Includes drawing number 29-100 and a circular seal for Georgia Registered Professional Landscape Architect Gabriel P. Poyden.

Planting Notes

1. Refer to the Department of Transportation State of Georgia Special Provision Atlanta Beltline, Inc., section 702, Vine, Shrub, and Tree planting, and section 893, Miscellaneous plant materials. Any conflicts that arise between the Special Provision document and the notes herein, the Special Provision shall govern.
2. Contractor shall verify all existing conditions in the field and report any discrepancies to the Landscape Architect or Owner's Representative prior to starting work.
3. No planting shall occur until soil samples have been received and all planting areas modified appropriately as per Special Provision section 893.
4. Plant selections reflect the nature of the planned environment and may need to be shifted due to as-built conditions. If built conditions do not match the plans stop work immediately and alert the Landscape Architect or Owner's Representative to confirm direction.
5. Stake location of all proposed trees and planting areas for approval by the Landscape Architect or Owner's Representative prior to the commencement of planting.
6. All new plant material shall conform to the guidelines established for nursery stock published by the American Association of Nurserymen, Inc. In addition, all new plant material for the project shall be of the highest specimen quality. Plant material delivered to the site that does not meet the requirements stated herein may be rejected by the Owner's Representative.
7. Do not assume trunk flare will be exposed at the nursery. Contractor to expose trunk flares to check for root girdling. Pull mulch away from the trunk flare of trees and from the base of all shrubs.
8. No plant material shall be planted before acceptance of rough grading. The finished grade shall not cover any part of the tree trunk flare. See tree planting detail.
9. All new plants shall be balled and burlapped or container grown unless otherwise noted on the plant list.
10. The Contractor shall locate and verify all existing utility lines prior to planting and report any conflicts to the Landscape Architect or Owner's Representative.
11. Apply mulch only in those areas identified on the plan to receive mulch and at the thickness specified on the plans. Mulch to be Arborist Wood Mulch.
12. Thoroughly water trees and shrubs during the first 24 hours after planting. Wet the soil to a depth of 18-24". When runoff starts, stop watering, let the water soak in and repeat until the proper depth is wet.
13. Any proposed substitutions of plant species shall be made with plants of equivalent overall form, height, branching habit, flower, leaf, color, fruit, and culture only as approved by the Landscape Architect or Owner's Representative.
14. All areas to be seeded shall receive soil preparation as specified prior to seeding, unless otherwise noted on plan.
15. Contractor's base bid to include all materials, labor, permits, equipment, tools, insurance, etc. to perform the work as described in the contract documents.
16. Contractor to complete work within schedule established by Owner.
17. Contractor to provide one year warranty for all material from date of substantial completion. Contractor to provide interim maintenance (watering, pruning, fertilizing, guying, mowing, trimming, adequate drainage of ponding areas, edging, weeding, mulching, and general landscape clean-up) until substantial completion notice is provided by the Owner's Representative. Application of insecticides/herbicides must be approved by Landscape Architect prior to use on site.
21. Shade trees to be planted a minimum of 5' from sidewalks, water line, sewer line or manholes. Evergreen and ornamental trees to be planted a minimum of 3' from sidewalks, water line, sewer line or manholes.

Instructions For Existing Soil Sampling:

1. Using a spade, dig a v-shape hole to a 6" depth; then cut a thin slice of soil from one side of the hole. Place the slice in a plastic bucket, do not use a metal bucket. Mix slices together and fill a plastic sample bag with three (3) cups of dirt. The sample bags can be ziploc bags that are labeled with the project name and sample number.
2. A well mixed composite from 10 to 20 random locations should be subsampled to make the three (3) cup sample.
3. Mark the plan to show soil sample locations.
4. Send samples to Waypoint Analytical Labs, Inc., 2790 Whitten Road, Memphis, Tennessee 38133, 800-264-4522, www.al-labs.com.
5. Results to be copied to the Owner.

Percolation Test Notes

1. Dig a hole 18- 24" deep & a minimum of 6" wide.
2. Fill hole with water to the top and let drain for several hours. Ideally let the hole pre-wet over night and test the following day.
3. Refill hole to within a couple inches of the top.
4. To aid in measurement, place a stick across the top of the hole and use a second stick to mark periodic drops in water level; mark side of hole; or mark soil on side of hole with nail or stick.
5. Measure drop in water level after 30 minutes and one hour. If possible measure drop in water level the next day.
6. Determine drop in water level per hour. If water level in hole drops more than one inch per hour, it is well drained and suitable for all plant species.

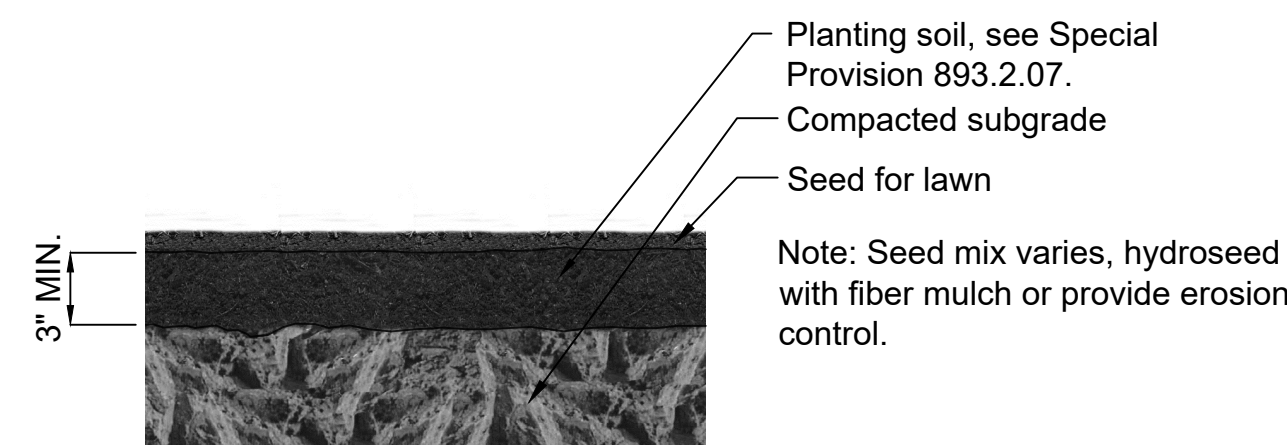

5 Seed Detail
Scale: NTS

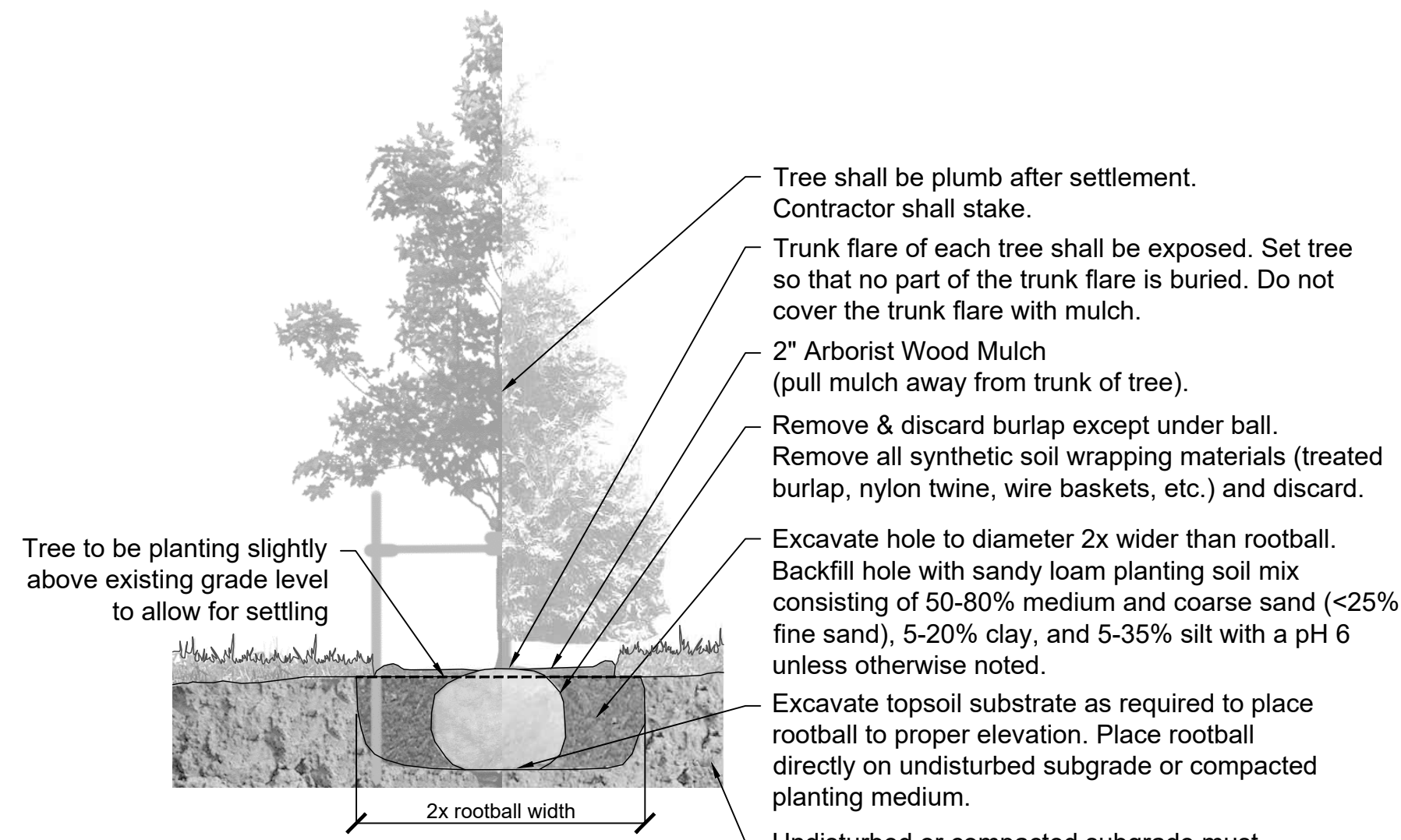

1 Tree Planting Detail
Scale: NTS

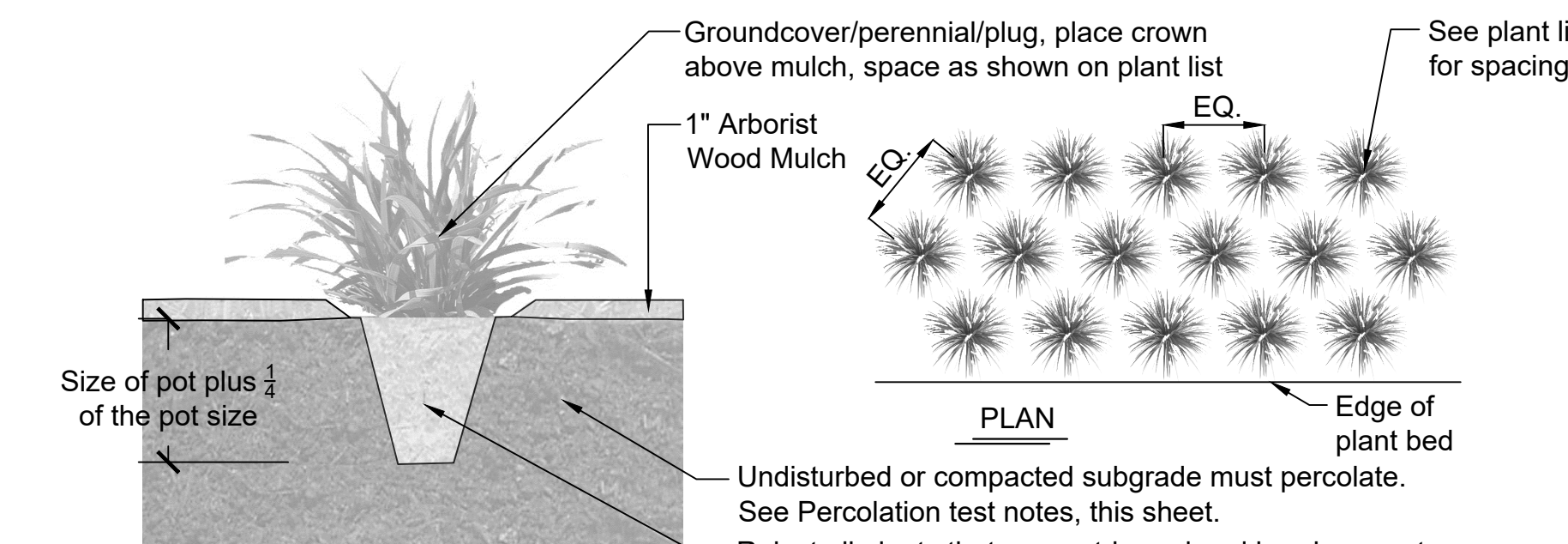

3 Groundcover/Perennial/Plug Planting Detail
Scale: NTS

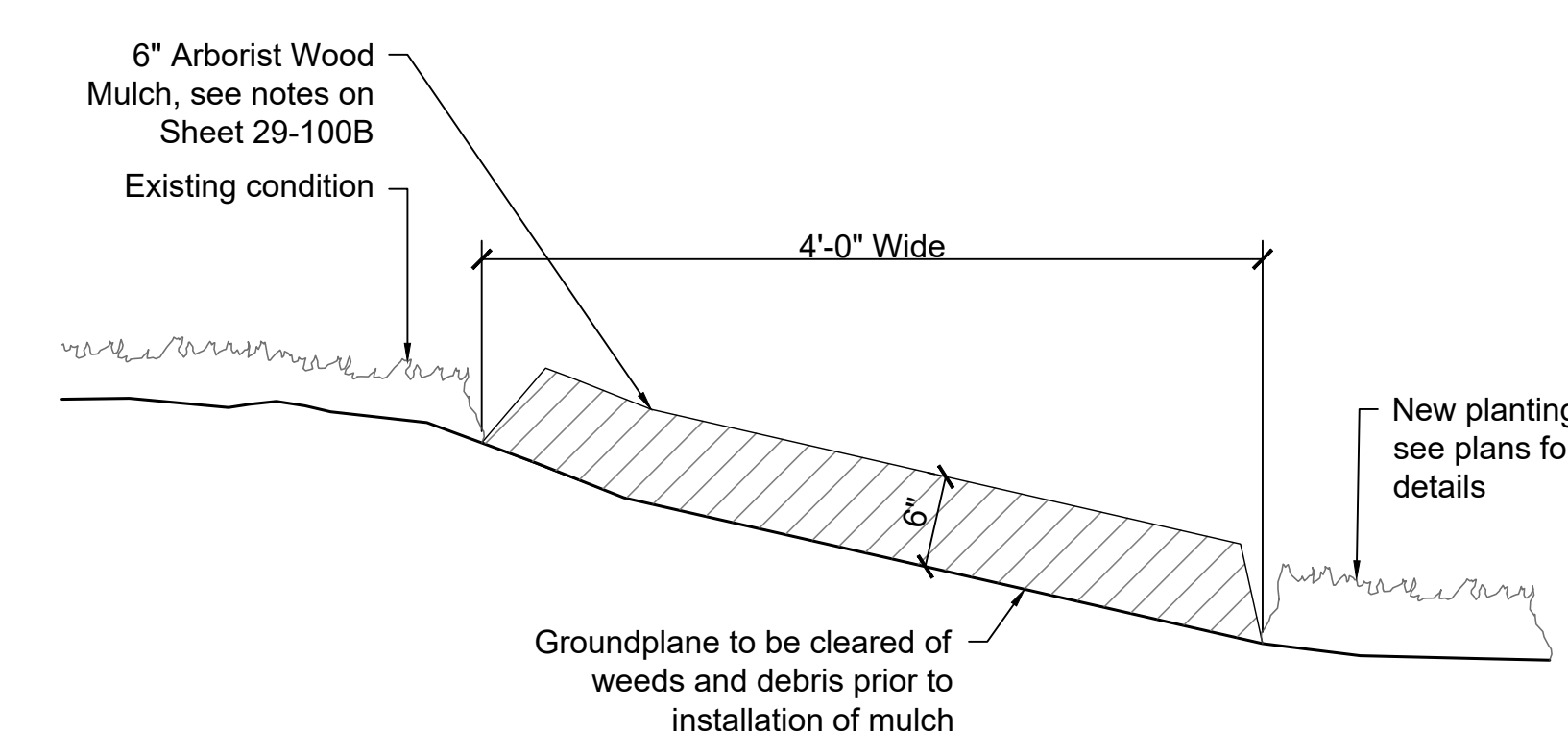

6 Maintenance Strip Detail
Scale: NTS

For Planting Soil, see GDOT Special Provision 893.2.07.

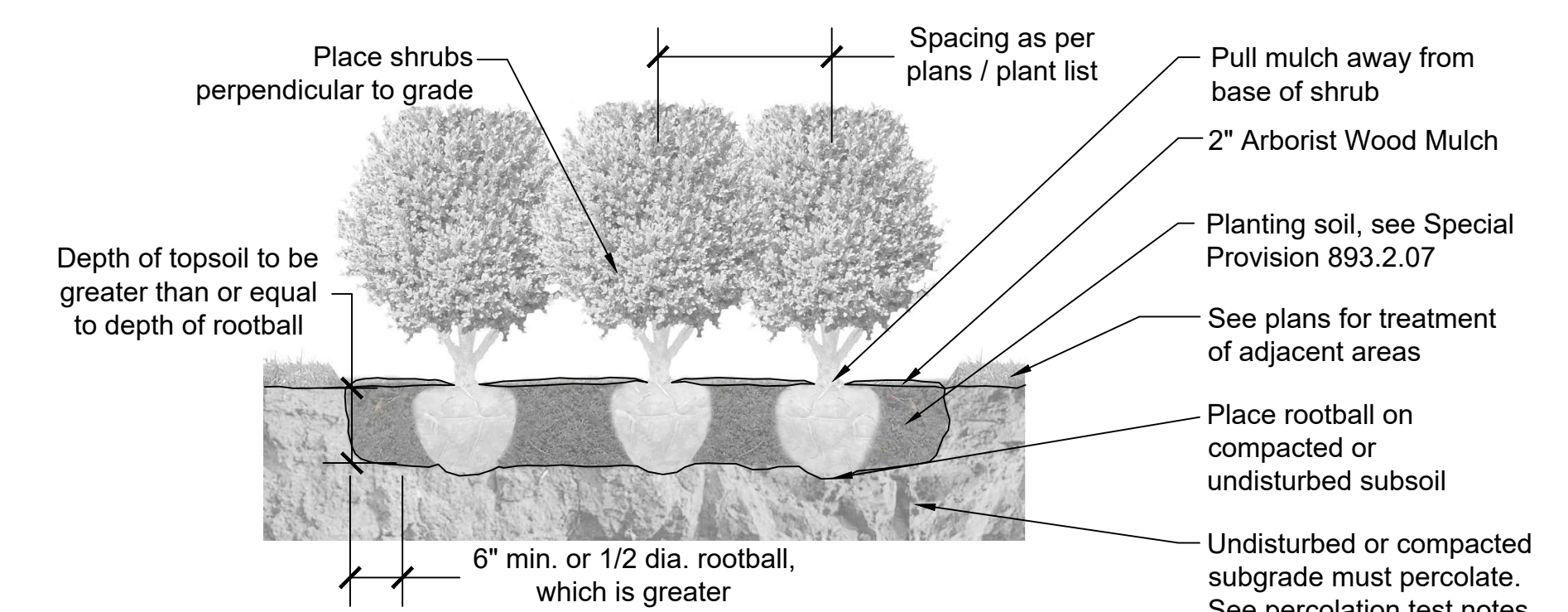

2 Shrub Planting Detail
Scale: NTS

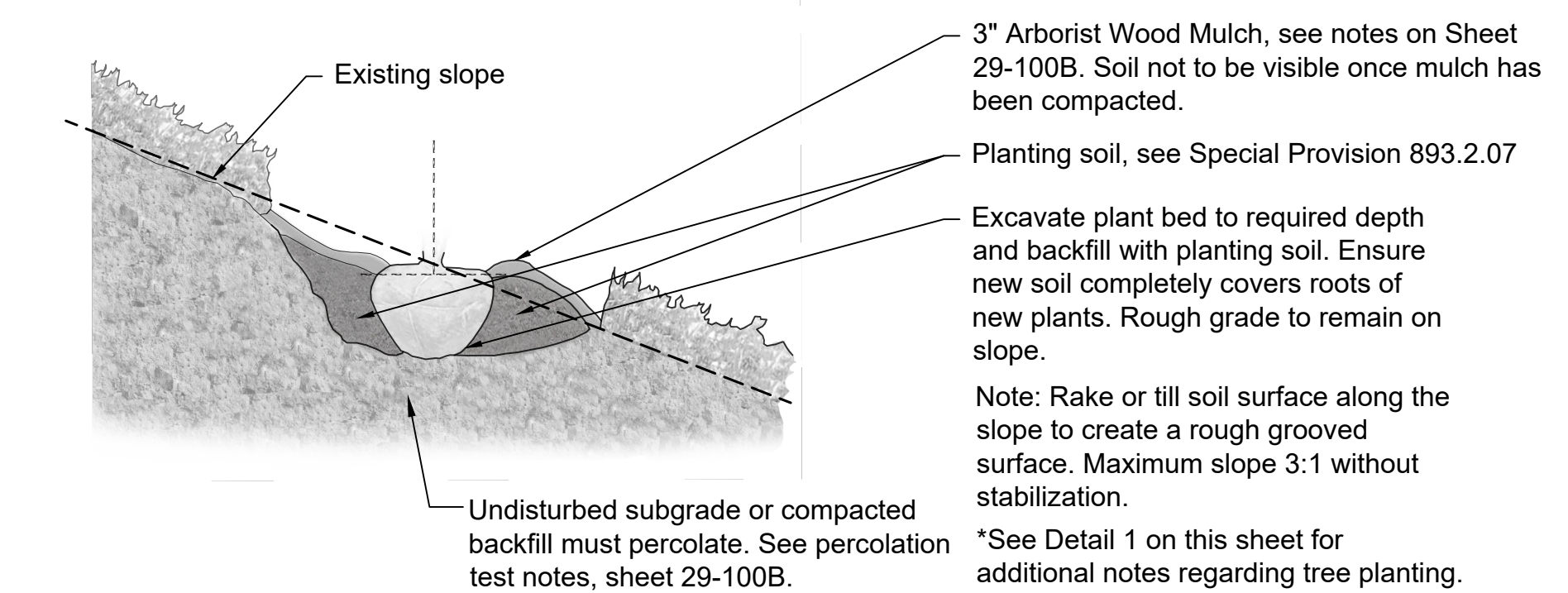

4 Slope Planting Detail
Scale: NTS

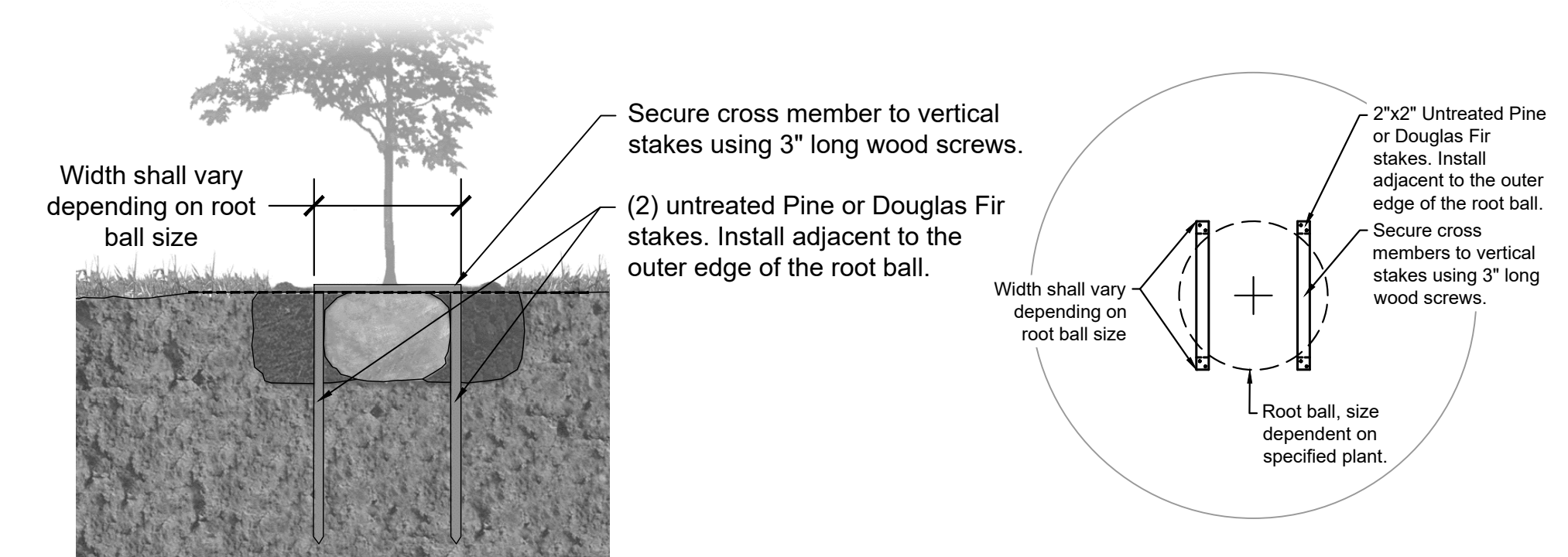

7 Tree Staking Detail
Scale: NTS

Tree Staking Detail: Plan View
Scale: 1/2"=1'-0"

PROPERTY AND EXISTING R/W LINE	---
REQUIRED R/W LINE	---
CONSTRUCTION LIMITS	---
PERMANENT EASEMENT FOR CONST. & MAINTENANCE OF SLOPES	
TEMPORARY EASEMENT FOR CONST. OF SLOPES	
TEMPORARY EASEMENT FOR CONST. OF DRIVES	

**PROGRESS SET
NFC**

Atlanta BeltLine
ATLANTA BELTLINE, INC.
100 PEACHTREE STREET, NW SUITE 2300
ATLANTA, GA 30303
TEL: (404) 477-3003
FAX: (404) 477-3606

Kimley»Horn
KIMLEY-HORN AND ASSOCIATES, INC.
THE BILTMORE, SUITE 601
817 WEST PEACHTREE STREET, NW
ATLANTA, GEORGIA 30308
TEL: (404) 419-8700

hedstrom
LANDSCAPE ARCHITECTURE
info@hedstromdesign.com
www.hedstromdesign.com
110 WEST MAGNOLIA AVE.
KNOXVILLE, TN 37917
OFFICE TEL: (865) 329.0012

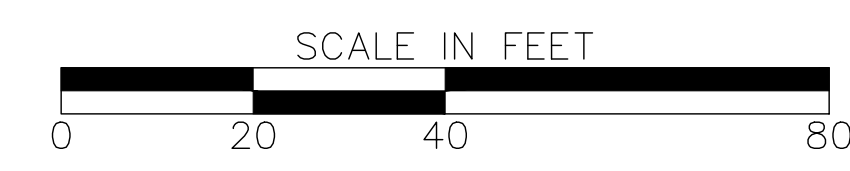

REVISION DATES	

PLANTING PLAN
ATLANTA BELTLINE SOUTHSIDE TRAIL (SEGMENT 2)
Planting Details and Notes

CHECKED:	DATE:	DRAWING No.
BACKCHECKED:	DATE:	29-100A
CORRECTED:	DATE:	
VERIFIED:	DATE:	

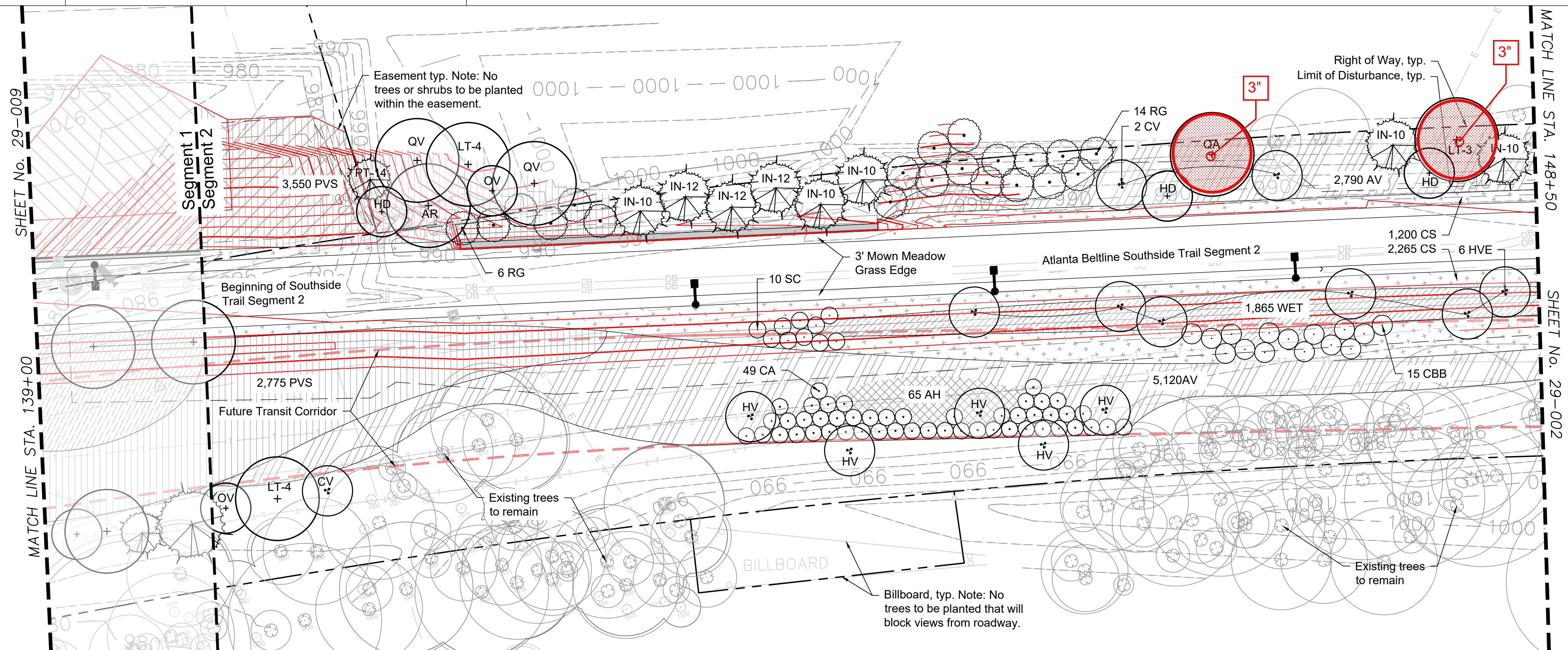

Plant Schedule: See Sheet 29-000 through 29-000A for master plant schedule, details and notes.

Key	Qty	Botanical Name	Common Name	Size	Notes
Trees					
AR	1	Acer rubrum 'October Glory'	October Glory Red Maple	3" cal.	6' CT, CL, full and well branched
CV	3	Chionanthus virginicus 'Prodigy'	Prodigy American Fringe Tree	12' hgt.	MT, 3 cane min., full and well branched
HD	3	Halesia diptera	Two-winged Silverbell	3" cal.	4' CT, CL, full and well branched
IN-10	5	Ilex x 'Nellie R Stevens'	Nellie Stevens Holly	10' hgt.	4' CT, CL, full and well branched
IN-12	3	Ilex x 'Nellie R Stevens'	Nellie Stevens Holly	12' hgt.	4' CT, CL, full and well branched
LT-3	1	Liriodendron tulipifera	Tulip Poplar	3" cal.	6' CT, CL, full and well branched
LT-4	2	Liriodendron tulipifera	Tulip Poplar	4" cal.	6' CT, CL, full and well branched
OV	2	Ostrya virginiana	Eastern Hop Hornbeam	2" cal.	5' CT, CL, full and well branched
PT-14	1	Pinus taeda	Loblolly Pine	14' hgt.	6' CT, CL, full and well branched
QA	1	Quercus alba	White Oak	3" cal.	6' CT, CL, full and well branched
QV	2	Quercus velutina	Black Oak	4" cal.	6' CT, CL, full and well branched
Shrubs & Groundcover					
AH	65	Amsonia hubrichtii	Arkansas Bluestar	1 gal.	3' o.c., full and dense, blue flowers
CA	49	Callicarpa americana	American Beautyberry	7 gal.	4' o.c., full and dense, purple berries
CBB	15	Cephalanthus occidentalis	Button Bush	7 gal.	6' o.c., full and dense, white flowers
CS	3465	Carex cherokeensis	Cherokee Sedge	DP-50	12" o.c., well developed roots
HV	5	Hamamelis virginiana 'Harvest Moon'	Harvest Moon Witch Hazel	8' hgt.	MT, 5 cane min., full and well branched
HVE	6	Hamamelis vernalis 'Autumn Embers'	Autumn Embers Ozark Witch Hazel	6' hgt.	MT, 5 cane min., full and well branched
RG	23	Rhus glabra	Smooth Sumac	7 gal.	8' o.c., full and dense
SC	10	Sambucus canadensis 'Adams'	Adam's Elderberry	7 gal.	5' o.c., full and dense, white flowers
Ornamental Grass					
AV	9345	Andropogon virginicus	Broomsedge	DP-50	12" o.c., well developed roots
PVS	6325	Panicum virgatum 'Shenandoah'	Shenandoah Switch Grass	DP-50	12" o.c., well developed roots
WET- Wetland Mix 1,865 sf					
80	Asclepias incarnata	Swamp Milkweed	Qts.	18" o.c., full and dense, pink flowers, well developed roots	
80	Helenium autumnale	Common Sneezeweed	Qts.	18" o.c., full and dense, yellow flowers, well developed roots	
80	Helenium 'Moerheim Beauty'	Morheim Beauty Sneezeweed	Qts.	18" o.c., full and dense, bronze flowers, well developed roots	
80	Iris psuedacorus	Yellow Flag Iris	Qts.	18" o.c., full and dense, yellow flowers, well developed roots	
80	Iris virginica	Southern Blue Flag Iris	Qts.	18" o.c., full and dense, blue flowers, well developed roots	
935	Juncus effusus	Common Rush	DP-50	12" o.c., well developed roots	

Abbreviations:

MT: Multi-trunk CAL: Caliper
 CL: Central Leader GAL: Gallon
 CT: Clear Trunk HGT: Height
 MIN: Minimum O.C.: On Center
 QTS: Quart DP-50: Deep Plug 50 Count

General Notes:

- New plant beds to encompass areas disturbed by construction. Prior to purchase of plant material contractor to verify that the plans match the as-built conditions. If conditions differ, stop work and communicate this to the Owner's Representative or the Landscape Architect.
- Temporary and Permanent Easements to be staked on site. No trees or shrubs shall be planted within the easement.
- Perennials can be substituted with up to (10) different cultivars of similar size to provide color mixture. Cultivars to be approved by Landscape Architect or Owner's Representative prior to purchase.

Hatch Legend:

(AV) Andropogon virginicus	(CS) Carex cherokeensis	Maintenance Strip between Beltline property and adjacent
(PVS) Panicum virgatum 'Shenandoah'	(WET) Wetland Mix	
(AH) Amsonia hubrichtii	Arborist Wood Mulch	

Key Plan

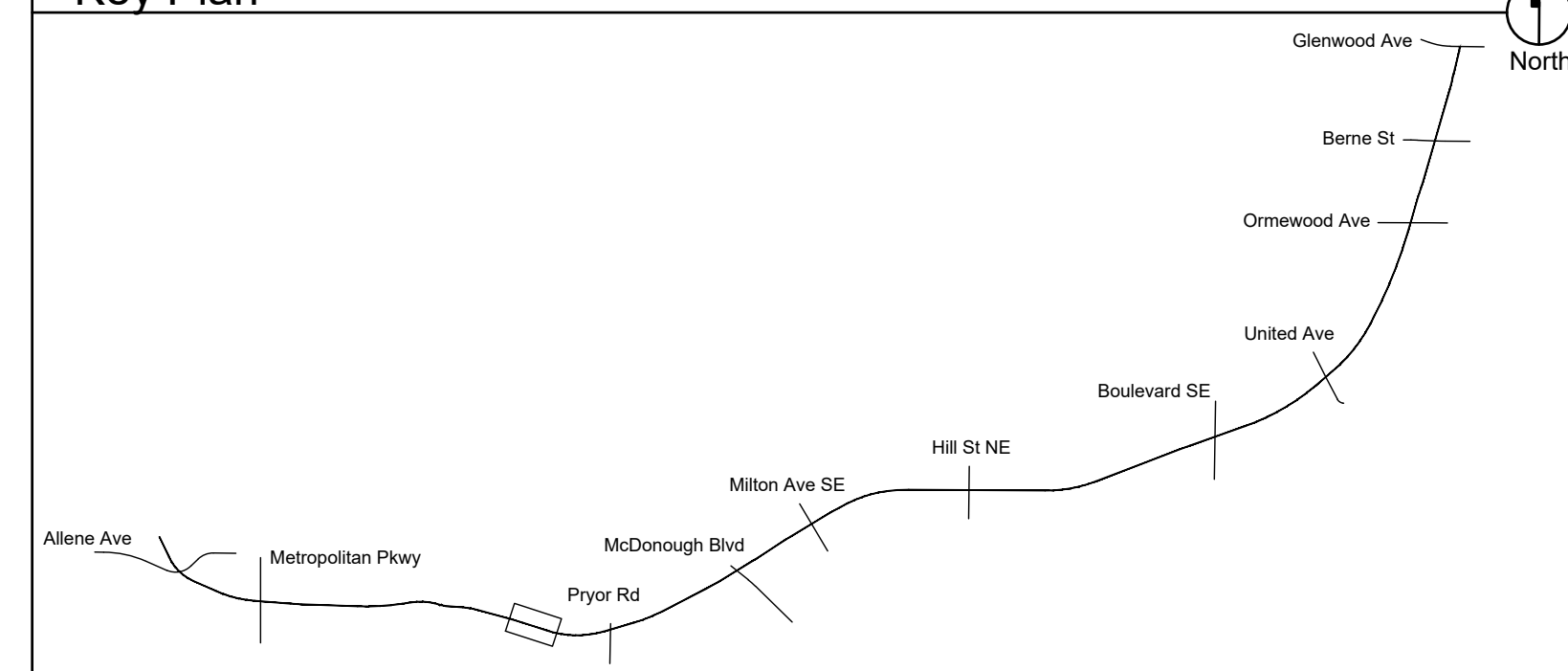

PROPERTY AND EXISTING R/W LINE	---
REQUIRED R/W LINE	---
CONSTRUCTION LIMITS	---
PERMANENT EASEMENT FOR CONST. & MAINTENANCE OF SLOPES	////
TEMPORARY EASEMENT FOR CONST. OF SLOPES	///
TEMPORARY EASEMENT FOR CONST. OF DRIVES	xxx

PROGRESS SET
NFC

Atlanta BeltLine
 ATLANTA BELTLINE, INC.
 100 PEACHTREE STREET, NW
 SUITE 2300
 ATLANTA, GA 30303
 TEL: (404) 477-3003
 FAX: (404) 477-3606

Kimley»Horn
 KIMLEY-HORN AND ASSOCIATES, INC.
 THE BILTMORE, SUITE 601
 817 WEST PEACHTREE STREET, NW
 ATLANTA, GEORGIA 30308
 TEL: (404) 419-8700

hedstrom
 LANDSCAPE ARCHITECTURE
 info@hedstromdesign.com
 www.hedstromdesign.com
 110 WEST MAGNOLIA AVE.
 KNOXVILLE, TN 37917
 OFFICE TEL: (865) 329.0012



REVISION DATES

PLANTING PLAN
ATLANTA BELTLINE SOUTHSIDE TRAIL (SEGMENT 2)

CHECKED:	DATE:	DRAWING No.
BACKCHECKED:	DATE:	29-101
CORRECTED:	DATE:	
VERIFIED:	DATE:	

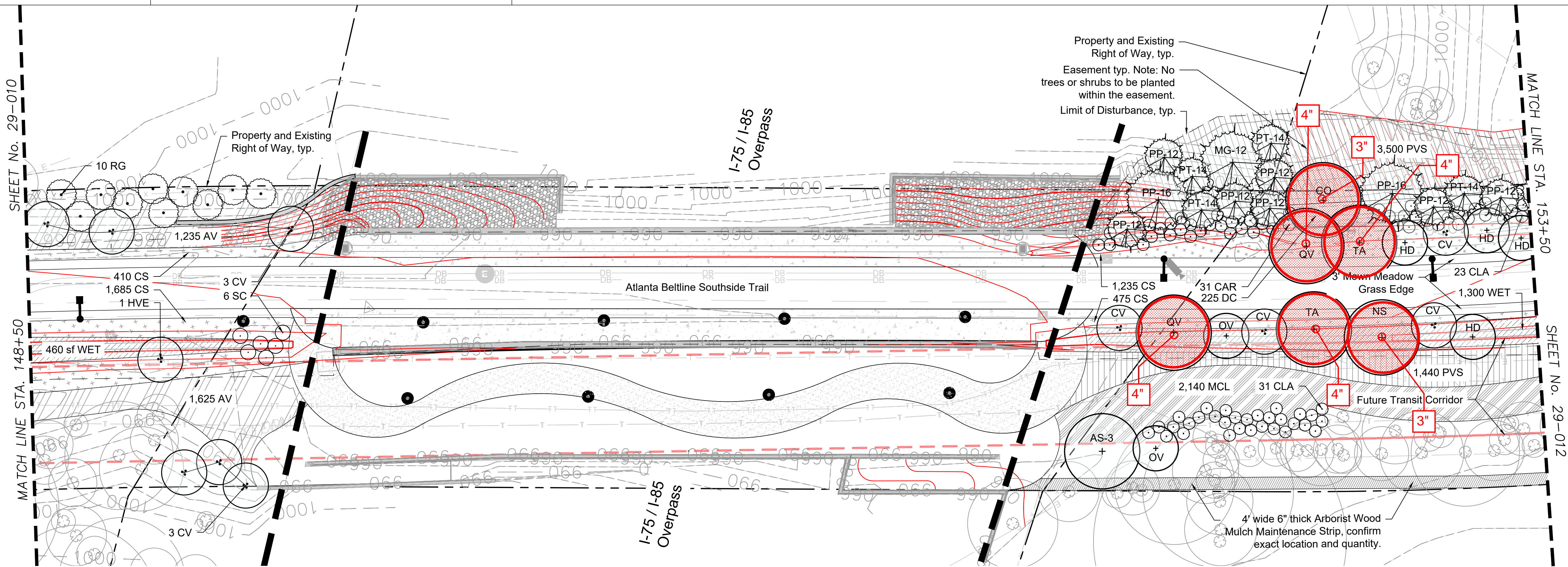

Plant Schedule: See Sheet 29-000 through 29-000A for master plant schedule, details and notes.

Key	Qty	Botanical Name	Common Name	Size	Notes
Trees					
AS-3	1	Acer saccharum 'Legacy'	Legacy Sugar Maple	3" cal. 6' CT, CL, full and well branched	
CO	1	Carya ovata	Shagbark Hickory	3" cal. 6' CT, CL, full and well branched	
CV	10	Chionanthus virginicus 'Prodigy'	Prodigy American Fringe Tree	12' hgt. MT, 3 cane min., full and well branched	
HD	4	Halesia diptera	Two-winged Silverbell	3" cal. 4' CT, CL, full and well branched	
MG-12	1	Magnolia grandiflora 'Claudia Wannamaker'	Claudia Wannamaker Magnolia	12' hgt. 4' CT, full, dense, and well branched	
NS	1	Nyssa sylvatica 'Wildfire'	Wildfire Blackgum	3" cal. 6' CT, CL, full and well branched	
OV	2	Ostrya virginiana	Eastern Hop Hornbeam	2" cal. 5' CT, CL, full and well branched	
PP-12	7	Pinus palustris	Longleaf Pine	12' hgt. 4' CT, CL, full and well branched	
PP-16	2	Pinus palustris	Longleaf Pine	16' hgt. 4' CT, CL, full and well branched	
PT-14	4	Pinus taeda	Loblolly Pine	14' hgt. 6' CT, CL, full and well branched	
QV	2	Quercus velutina	Black Oak	4" cal. 6' CT, CL, full and well branched	
TA	2	Tilia americana 'Continental Appeal'	Continental Appeal American Linden	4" cal. 6' CT, CL, full and well branched	
Shrubs & Groundcover					
CAR	48	Clethra alnifolia 'Ruby Spice'	Ruby Spice Summersweet	7 gal. 4' o.c., full and dense, pink flowers	
CLA	75	Clethra alnifolia 'Sixteen Candles'	Sixteen Candles Summersweet	7 gal. 4' o.c., full and dense, white flowers	
CS	3345	Carex cherokeensis	Cherokee Sedge	DP-50 12" o.c., well developed roots	
HVE	1	Hamamelis vernalis 'Autumn Embers'	Autumn Embers Ozark Witch Hazel	6' hgt. MT, 5 cane min., full and well branched	
RG	24	Rhus glabra	Smooth Sumac	7 gal. 8' o.c., full and dense	
SC	6	Sambucus canadensis 'Adams'	Adam's Elderberry	7 gal. 5' o.c., full and dense, white flowers	
Ornamental Grass					
AV	3035	Andropogon virginicus	Broomsedge	DP-50 12" o.c., well developed roots	
DC	350	Deschampsia cespitosa 'Goldtau'	Golden Dew Tufted Hair Grass	DP-50 12" o.c., well developed roots	
MCL	1575	Muhlenbergia capillaris 'Lenca'	Regal Mist Muhly Grass	DP-50 12" o.c., well developed roots	
PVS	6645	Panicum virgatum 'Shenandoah'	Shenandoah Switch Grass	DP-50 12" o.c., well developed roots	
WET- Wetland Mix 1,760 sf					
80	Asclepias incarnata	Swamp Milkweed	Qts.	18" o.c., full and dense, pink flowers, well developed roots	
80	Helenium autumnale	Common Sneezeweed	Qts.	18" o.c., full and dense, yellow flowers, well developed roots	
80	Helenium 'Moerheim Beauty'	Morheim Beauty Sneezeweed	Qts.	18" o.c., full and dense, bronze flowers, well developed roots	
80	Iris psueduacorus	Yellow Flag Iris	Qts.	18" o.c., full and dense, yellow flowers, well developed roots	
80	Iris virginica	Southern Blue Flag Iris	Qts.	18" o.c., full and dense, blue flowers, well developed roots	
860	Juncus effusus	Common Rush	DP-50	12" o.c., well developed roots	

Abbreviations:

MT: Multi-trunk CAL: Caliper
 CL: Central Leader GAL: Gallon
 CT: Clear Trunk HGT: Height
 MIN: Minimum O.C.: On Center
 QTS: Quart DP-50: Deep Plug 50 Count

General Notes:

- New plant beds to encompass areas disturbed by construction. Prior to purchase of plant material contractor to verify that the plans match the as-built conditions. If conditions differ, stop work and communicate this to the Owner's Representative or the Landscape Architect.
- Temporary and Permanent Easements to be staked on site. No trees or shrubs shall be planted within the easement.
- Perennials can be substituted with up to (10) different cultivars of similar size to provide color mixture. Cultivars to be approved by Landscape Architect or Owner's Representative prior to purchase.

Hatch Legend:

	(AV) Andropogon virginicus		(CS) Carex cherokeensis		Arborist Wood Mulch
	(PVS) Panicum virgatum 'Shenandoah'		(WET) Wetland Mix		Maintenance Strip between Beltline property and adjacent

Key Plan

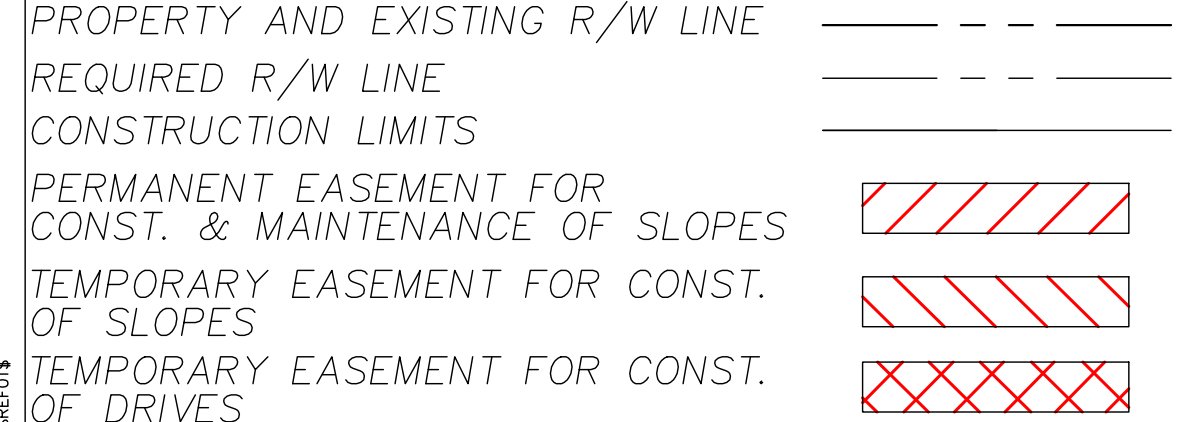
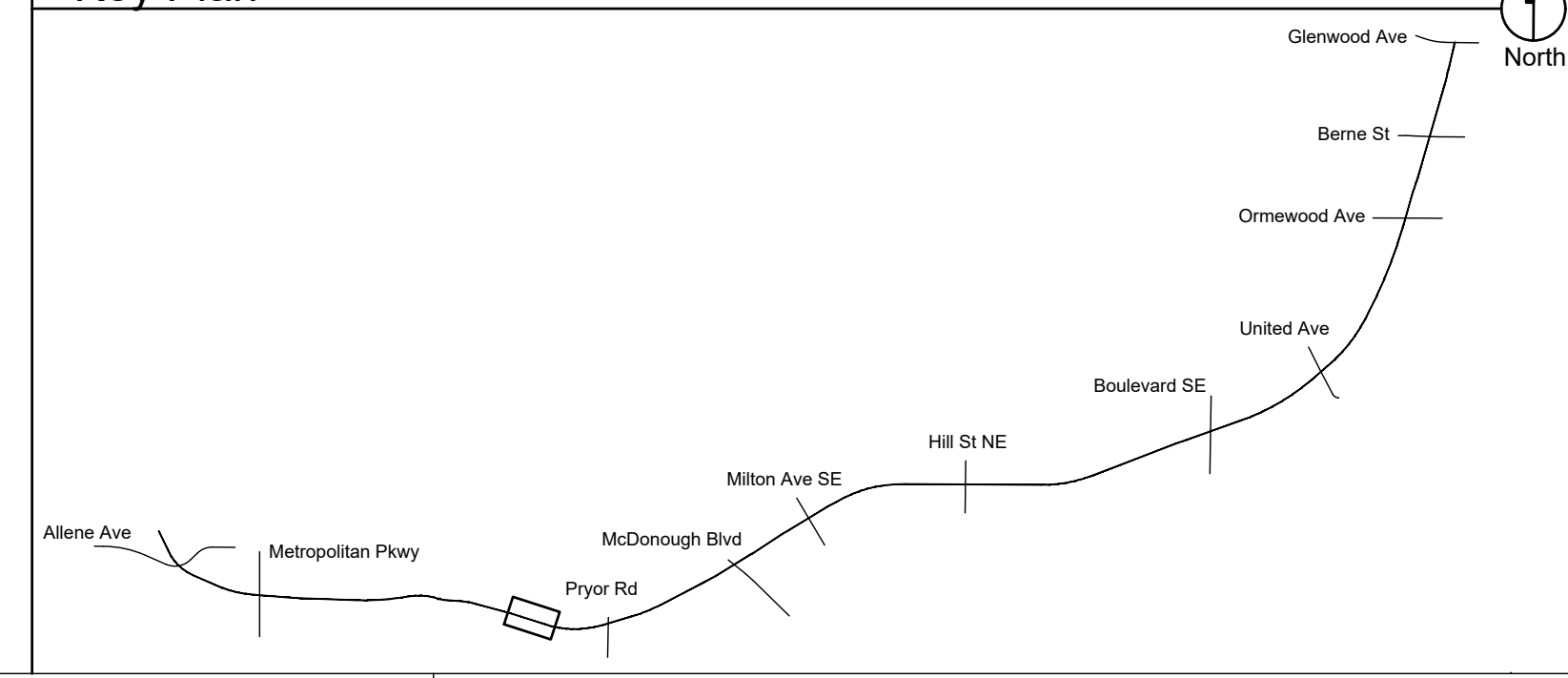

PROGRESS SET
NFC

Atlanta BeltLine
 ATLANTA BELTLINE, INC.
 100 PEACHTREE STREET, NW
 SUITE 2300
 ATLANTA, GA 30303
 TEL: (404) 477-3003
 FAX: (404) 477-3606

Kimley»Horn
 KIMLEY-HORN AND ASSOCIATES, INC.
 THE BILTMORE, SUITE 601
 817 WEST PEACHTREE STREET, NW
 ATLANTA, GEORGIA 30308
 TEL: (404) 419-8700

hedstrom
 LANDSCAPE ARCHITECTURE
 info@hedstromdesign.com
 www.hedstromdesign.com
 110 WEST MAGNOLIA AVE.
 KNOXVILLE, TN 37917
 OFFICE TEL: (865) 329.0012



REVISION DATES

No.	Date	Description

PLANTING PLAN

ATLANTA BELTLINE SOUTHSIDE TRAIL (SEGMENT 2)

CHECKED:	DATE:	DRAWING No.
BACKCHECKED:	DATE:	29-102
CORRECTED:	DATE:	
VERIFIED:	DATE:	

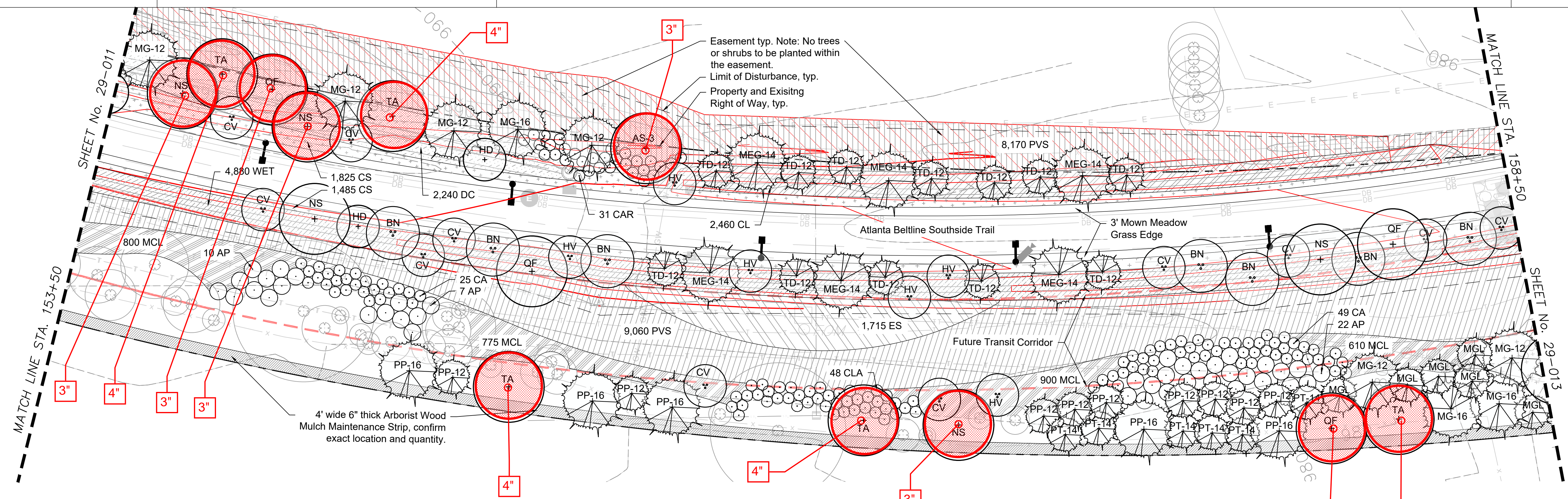

Easement typ. Note: No trees or shrubs to be planted within the easement.
 Limit of Disturbance, typ.
 Property and Existing Right of Way, typ.

Plant Schedule: See Sheet 29-000 through 29-000A for master plant schedule, details and notes.

Key	Qty	Botanical Name	Common Name	Size	Notes
Trees					
AS-3	1	Acer saccharum 'Legacy'	Legacy Sugar Maple	3" cal.	6' CT, CL, full and well branched
BN	7	Betula nigra 'City Slicker'	City Slicker River Birch	14' hgt.	MT, 3 cane min., full and well branched
CV	11	Chionanthus virginicus 'Prodigy'	Prodigy American Fringe Tree	12' hgt.	MT, 3 cane min. full and well branched
HD	2	Halesia diptera	Two Winged Silverbell	3" cal.	4' CT, CL, full and well branched
MEG-14	6	Metasequoia glyptostroboides 'Arrowhead'	Narrow Dawn Redwood	14' hgt.	4' CT, CL, full and well branched
MG-12	6	Magnolia grandiflora 'Claudia Wannamaker'	Claudia Wannamaker Magnolia	12' hgt.	4' CT, CL, full and well branched
MG-16	3	Magnolia grandiflora 'Claudia Wannamaker'	Claudia Wannamaker Magnolia	16' hgt.	4' CT, CL, full and well branched
MGL	6	Magnolia grandiflora 'Little Gem'	Little Gem Magnolia	12' hgt.	4' CT, CL, full and well branched
NS	5	Nyssa sylvatica 'Wildfire'	Wildfire Blackgum	3" cal.	6' CT, CL, full and well branched
PP-12	9	Pinus palustris	Longleaf Pine	12' hgt.	4' CT, CL, full and well branched
PP-16	5	Pinus palustris	Longleaf Pine	16' hgt.	4' CT, CL, full and well branched
PT-14	6	Pinus taeda	Loblolly Pine	14' hgt.	6' CT, CL, full and well branched
QF	4	Quercus falcata	Southern Red Oak	3" cal.	6' CT, CL, full and well branched
TA	5	Tilia americana 'Continental Appeal'	Continental Appeal American Linden	4" cal.	6' CT, CL, full and well branched
TD-12	12	Taxodium distichum 'Mickelson'	Shawnee Brave Bald Cypress	12' hgt.	4' CT, CL, full and well branched
Shrubs & Groundcover					
AP	53	Aesculus parviflora	Bottlebrush Buckeye	7 gal.	6' o.c., full and dense, white flowers
CA	100	Callicarpa americana	American Beautyberry	7 gal.	4' o.c., full and dense, purple berries
CAR	62	Clethra alnifolia 'Ruby Spice'	Ruby Spice Summersweet	7 gal.	4' o.c., full and dense, pink flowers
CLA	92	Clethra alnifolia 'Sixteen Candles'	Sixteen Candles Summersweet	7 gal.	4' o.c., full and dense, white flowers
CS	3245	Carex cherokeensis	Cherokee Sedge	DP-50	12" o.c., well developed roots
HV	5	Hamamelis virginiana 'Harvest Moon'	Harvest Moon Witch Hazel	8' hgt.	MT, 5 cane min., full and well branched
IVL	30	Itea virginica 'Little Henry'	Little Henry Sweetspire	3 gal.	3' o.c., full and dense, white flowers
Ornamental Grass					
DC	1200	Deschampsia cespitosa 'Goldtau'	Golden Dew Tufted Hair Grass	DP-50	12" o.c., well developed roots
ES	3520	Eragrostis spectabilis	Purple Love Grass	DP-50	12" o.c., well developed roots
MCL	3545	Muhlenbergia capillaris 'Lenca'	Regal Mist Muhly Grass	DP-50	12" o.c., well developed roots
PVS	17800	Panicum virgatum 'Shenandoah'	Shenandoah Switch Grass	DP-50	12" o.c., well developed roots
WET- Wetland Mix 4,655 sf					
	205	Asclepias incarnata	Swamp Milkweed	Qts.	18" o.c., full and dense, pink flowers, well developed roots
	205	Helenium autumnale	Common Sneezeweed	Qts.	18" o.c., full and dense, yellow flowers, well developed roots
	205	Helenium 'Moerheim Beauty'	Morheim Beauty Sneezeweed	Qts.	18" o.c., full and dense, bronze flowers, well developed roots
	205	Iris psueduacorus	Yellow Flag Iris	Qts.	18" o.c., full and dense, yellow flowers, well developed roots
	205	Iris virginica	Southern Blue Flag Iris	Qts.	18" o.c., full and dense, blue flowers, well developed roots
	2345	Juncus effusus	Common Rush	DP-50	12" o.c., well developed roots

Abbreviations:
 MT: Multi-trunk CAL: Caliper
 CL: Central Leader GAL: Gallon
 CT: Clear Trunk HGT: Height
 MIN: Minimum O.C.: On Center
 QTS: Quart DP-50: Deep Plug 50 Count

- General Notes:**
- New plant beds to encompass areas disturbed by construction. Prior to purchase of plant material contractor to verify that the plans match the as-built conditions. If conditions differ, stop work and communicate this to the Owner's Representative or the Landscape Architect.
 - Temporary and Permanent Easements to be staked on site. No trees or shrubs shall be planted within the easement.
 - Perennials can be substituted with up to (10) different cultivars of similar size to provide color mixture. Cultivars to be approved by Landscape Architect or Owner's Representative prior to purchase.

Hatch Legend:

(DC) Deschampsia cespitosa 'Goldtau'	(PVS) Panicum virgatum 'Shenandoah'	Arborist Wood Mulch
(ES) Eragrostis spectabilis	(CS) Carex cherokeensis	Maintenance Strip between Beltline property and adjacent
(MCL) Muhlenbergia capillaris 'Lenca'	(WET) Wetland Mix	

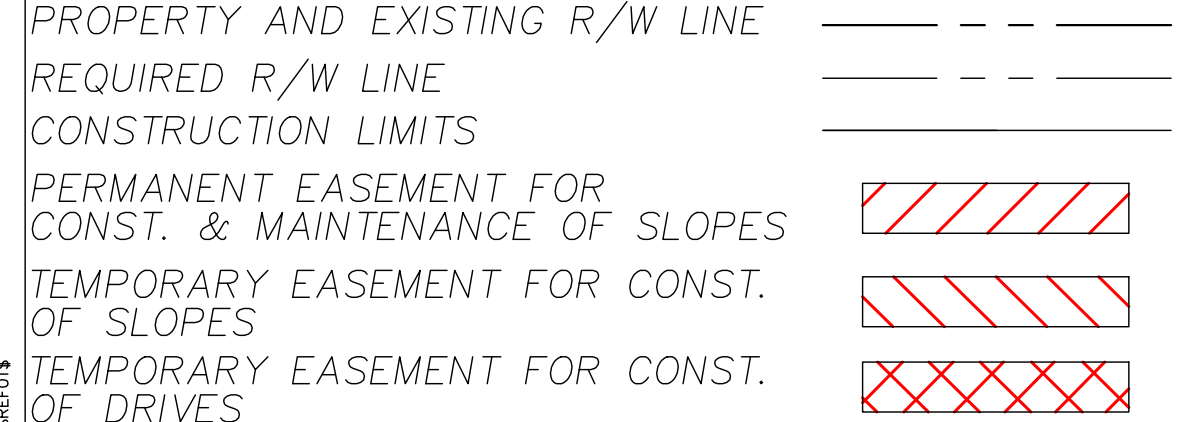
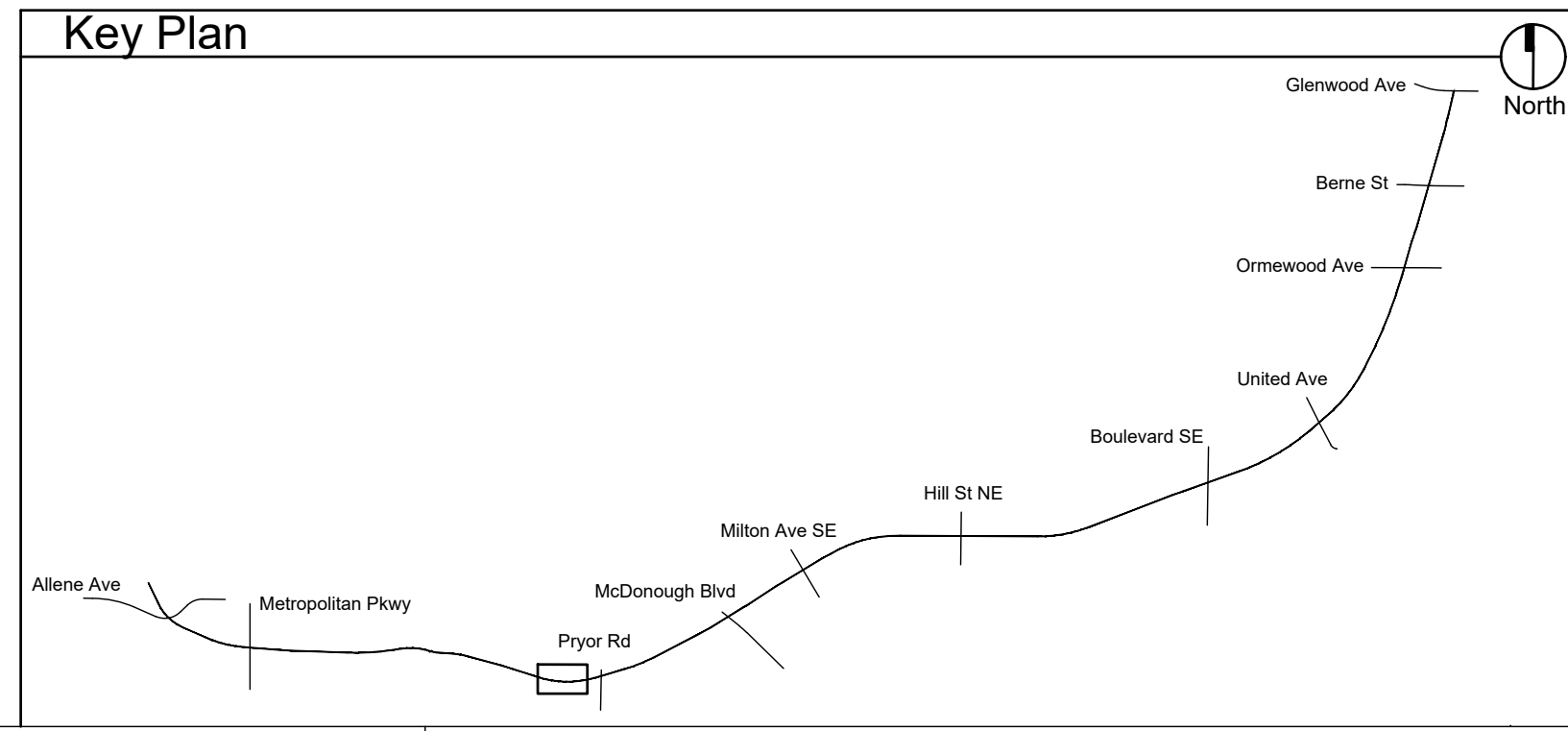

PROGRESS SET
NFC

Atlanta BeltLine
 ATLANTA BELTLINE, INC.
 100 PEACHTREE STREET, NW SUITE 2300
 ATLANTA, GA 30303
 TEL: (404) 477-3003
 FAX: (404) 477-3606

Kimley»Horn
 KIMLEY-HORN AND ASSOCIATES, INC.
 THE BILTMORE, SUITE 601
 817 WEST PEACHTREE STREET, NW
 ATLANTA, GEORGIA 30308
 TEL: (404) 419-8700

hedstrom
 LANDSCAPE ARCHITECTURE
 info@hedstromdesign.com
 www.hedstromdesign.com
 110 WEST MAGNOLIA AVE.
 KNOXVILLE, TN 37917
 OFFICE TEL: (865) 329.0012

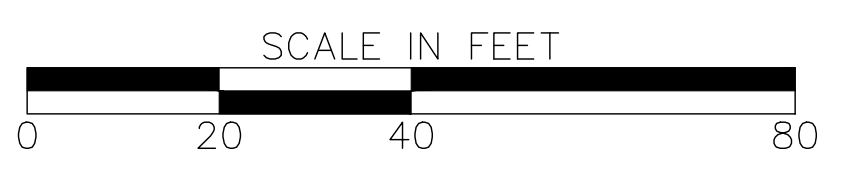

REVISION DATES		PLANTING PLAN	
NO.	DATE	ATLANTA BELTLINE SOUTHSIDE TRAIL (SEGMENT 2)	
		CHECKED:	DATE:
		BACKCHECKED:	DATE:
		CORRECTED:	DATE:
		VERIFIED:	DATE:
DRAWING No.			29-103

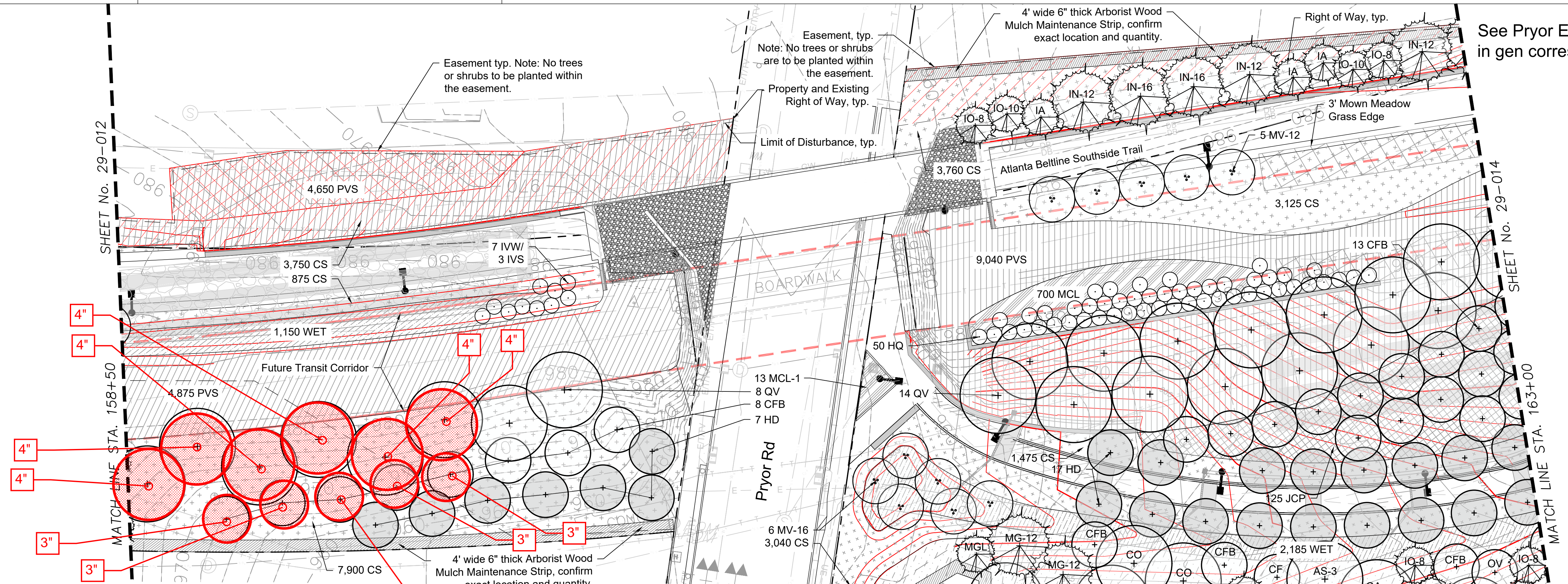

See Pryor Email from KH (12.04.2020 in gen correspondance)

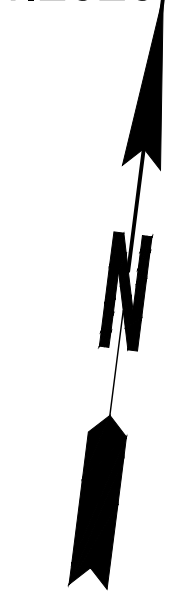

Plant Schedule: See Sheet 29-000 through 29-000A for master plant schedule, details and notes.

Key	Qty	Botanical Name	Common Name	Size	Notes
Trees					
AS-3	4	Acer saccharum 'Legacy'	Legacy Sugar Maple	3" cal.	6' CT, CL, full and well branched
CF	1	Cornus florida 'Appalachian Snow'	Appalachian Snow Dogwood	3" cal.	4' CT, CL, full and well branched
CFB	24	Cornus florida 'Comco No. 1'	Cherokee Brave Dogwood	3" cal.	4' CT, CL, full and well branched
CO	5	Carya ovata	Shagbark Hickory	3" cal.	6' CT, CL, full and well branched
HD	24	Halesia diptera	Two Winged Silverbell	3" cal.	4' CT, CL, full and well branched
IA	3	Ilex attenuata 'Fosteri'	Foster Holly	12" hgt.	4' CT, CL, full and well branched
IN-12	3	Ilex 'Nellie R Stevens'	Nellie Stevens Holly	12" hgt.	4' CT, CL, full and well branched
IN-16	3	Ilex 'Nellie R Stevens'	Nellie Stevens Holly	16" hgt.	4' CT, CL, full and well branched
IO-8	6	Ilex opaca 'Greenleaf'	Greenleaf American Holly	8' hgt.	CL, full and well branched
IO-10	4	Ilex opaca 'Greenleaf'	Greenleaf American Holly	10' hgt.	4' CT, CL, full and well branched
LT-3	3	Liriodendron tulipifera	Tulip Poplar	3" cal.	6' CT, CL, full and well branched
MG-12	3	Magnolia grandiflora 'Claudia Wannamaker'	Claudia Wannamaker Magnolia	12" hgt.	4; CT, CL, full and well branched
MGL	1	Magnolia grandiflora 'Little Gem'	Little Gem Magnolia	12" hgt.	4' CT, CL, full and well branched
MV-12	5	Magnolia virginiana 'Australis'	Sweetbay Magnolia	12" hgt.	MT, 3 cane min., full and well branched
MV-16	6	Magnolia virginiana 'Australis'	Sweetbay Magnolia	16" hgt.	MT, 3 cane min., full and well branched
OV	1	Ostrya virginiana	Eastern Hop Hornbeam	2" cal.	5' CT, CL, full and well branched
QA	3	Quercus alba	White Oak	3" cal.	6' CT, CL, full and well branched
QV	22	Quercus velutina	Black Oak	4" cal.	6' CT, CL, full and well branched
Shrubs & Groundcover					
CS	16355	Carex cherokeensis	Cherokee Sedge	DP-50	12" o.c., well developed roots
HQ	50	Hydrangea quercifolia 'Snow Queen'	Snow Queen Oakleaf Hydrangea	7 gal.	5' o.c., full and dense, white flowers
JCP	340	Juniperus chinensis 'Parsonii'	Parson Juniper	7 gal.	5' o.c., full and dense
Ornamental Grass					
MCL	700	Muhlenbergia capillaris 'Lenca'	Regal Mist Pink Muhly Grass	DP-50	12" o.c., well developed roots
MCL-1	13	Muhlenbergia capillaris 'Lenca'	Regal Mist Pink Muhly Grass	1 gal.	3' o.c., full and dense
PVS	18325	Panicum virgatum 'Shenandoah'	Shenandoah Switch Grass	DP-50	12" o.c., well developed roots
WET- Wetland Mix 3,740 sf					
	165	Asclepias incarnata	Swamp Milkweed	Qts.	18" o.c., full and dense, pink flowers, well developed roots
	165	Helenium autumnale	Common Sneezeweed	Qts.	18" o.c., full and dense, yellow flowers, well developed roots
	165	Helenium 'Moerheim Beauty'	Moerheim Beauty Sneezeweed	Qts.	18" o.c., full and dense, bronze flowers, well developed roots
	165	Iris pseudacorus	Yellow Flag Iris	Qts.	18" o.c., full and dense, yellow flowers, well developed roots
	165	Iris virginica	Southern Blue Flag Iris	Qts.	18" o.c., full and dense, blue flowers, well developed roots
	1870	Juncus effusus	Common Rush	DP-50	12" o.c., well developed roots

Abbreviations:
 MT: Multi-trunk CAL: Caliper
 CL: Central Leader GAL: Gallon
 CT: Clear Trunk HGT: Height
 MIN: Minimum O.C.: On Center
 QTS: Quart DP-50: Deep Plug 50 Count

- General Notes:**
- New plant beds to encompass areas disturbed by construction. Prior to purchase of plant material contractor to verify that the plans match the as-built conditions. If conditions differ, stop work and communicate this to the Owner's Representative or the Landscape Architect.
 - Temporary and Permanent Easements to be staked on site. No trees or shrubs shall be planted within the easement.
 - Perennials can be substituted with up to (10) different cultivars of similar size to provide color mixture. Cultivars to be approved by Landscape Architect or Owner's Representative prior to purchase.

Hatch Legend:

(MCL) Muhlenbergia capillaris 'Lenca'	(JCP) Juniperus chinensis 'Parsonii'	Arborist Wood Mulch
(PVS) Panicum virgatum 'Shenandoah'	(WET) Wetland Mix	Maintenance Strip between Beltline property and adjacent
(CS) Carex cherokeensis		

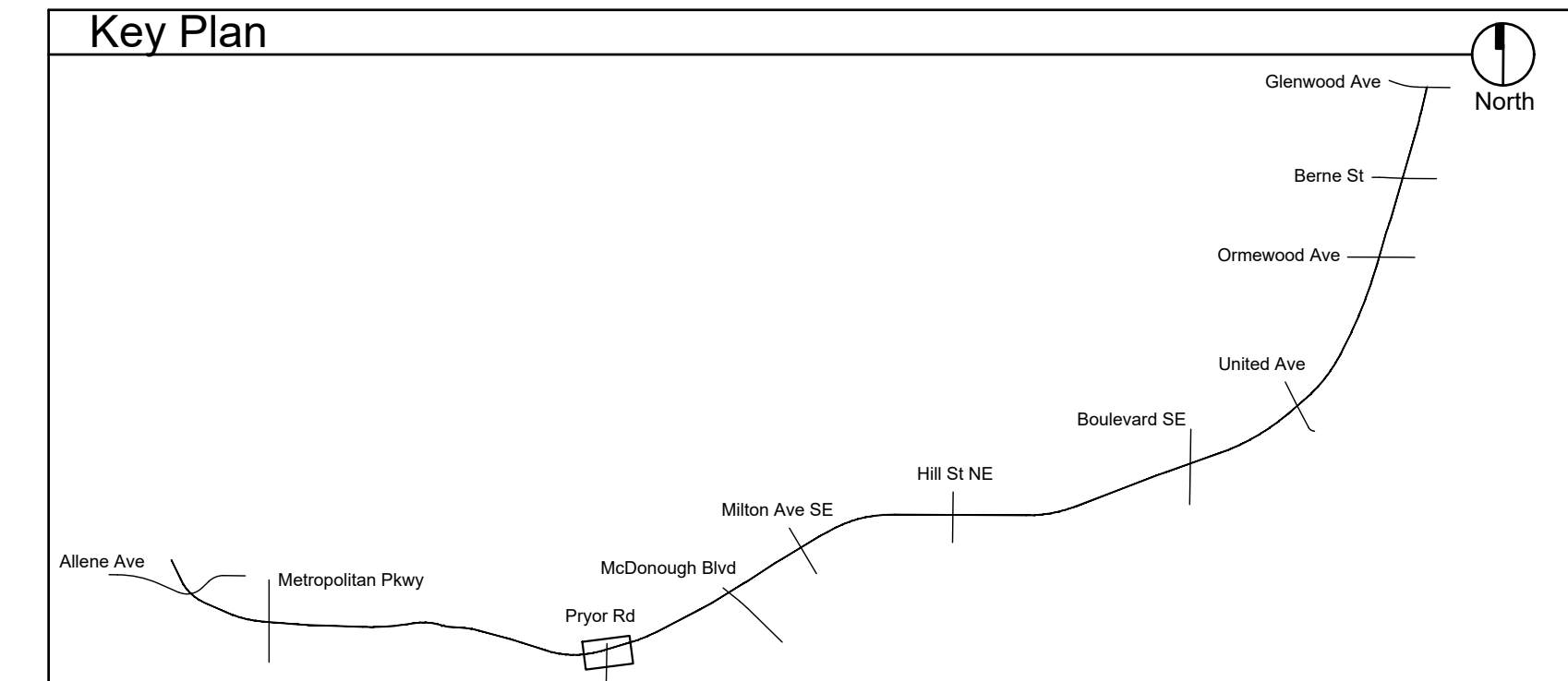

PROPERTY AND EXISTING R/W LINE
 REQUIRED R/W LINE
 CONSTRUCTION LIMITS
 PERMANENT EASEMENT FOR CONST. & MAINTENANCE OF SLOPES
 TEMPORARY EASEMENT FOR CONST. OF SLOPES
 TEMPORARY EASEMENT FOR CONST. OF DRIVES

**PROGRESS SET
 NFC**

Atlanta BeltLine
 ATLANTA BELTLINE, INC.
 100 PEACHTREE STREET, NW
 SUITE 2300
 ATLANTA, GA 30303
 TEL: (404) 477-3003
 FAX: (404) 477-3606

Kimley»Horn
 KIMLEY-HORN AND ASSOCIATES, INC.
 THE BILTMORE, SUITE 601
 817 WEST PEACHTREE STREET, NW
 ATLANTA, GEORGIA 30308
 TEL: (404) 419-8700

hedstrom
 LANDSCAPE ARCHITECTURE
 info@hedstromdesign.com
 www.hedstromdesign.com
 110 WEST MAGNOLIA AVE.
 KNOXVILLE, TN 37917
 OFFICE TEL: (865) 329.0012



REVISION DATES

PLANTING PLAN
 ATLANTA BELTLINE SOUTHSIDE TRAIL (SEGMENT 2)

CHECKED:	DATE:	DRAWING No.
BACKCHECKED:	DATE:	29-104
CORRECTED:	DATE:	
VERIFIED:	DATE:	

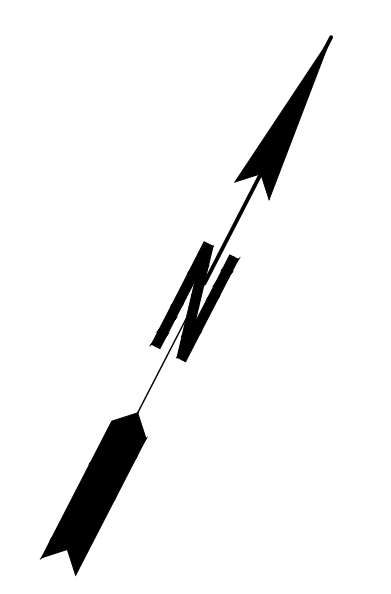
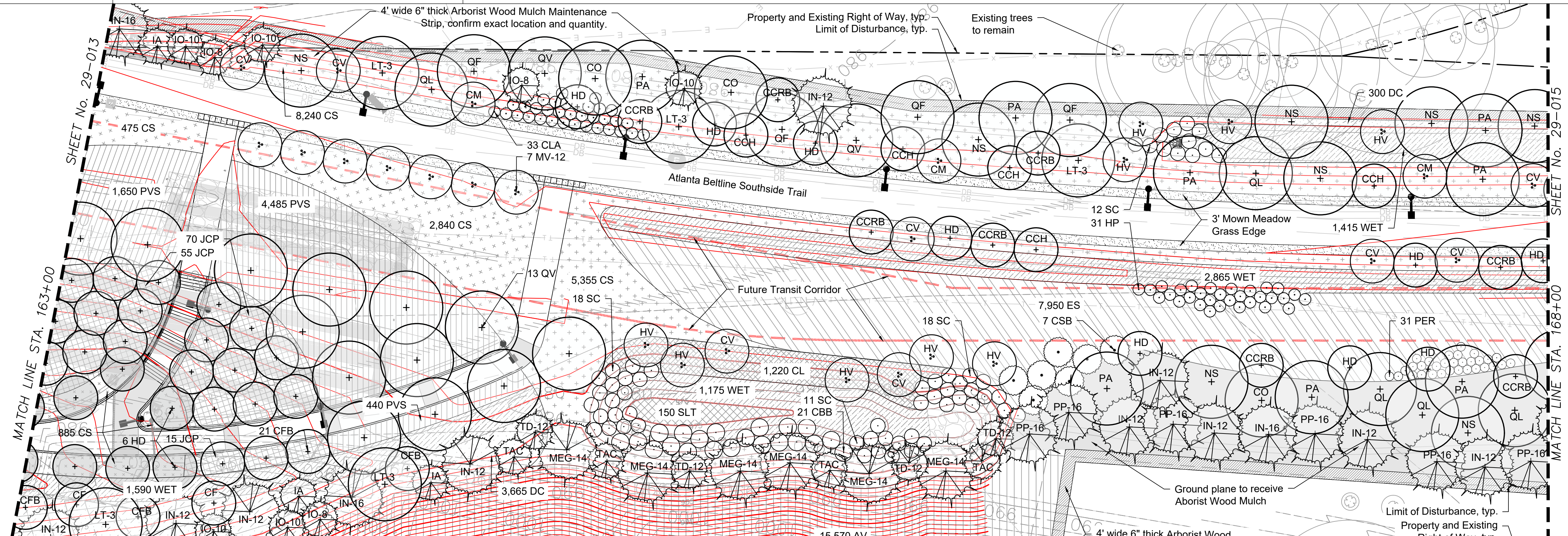

Plant Schedule: See Sheet 29-000 through 29-000A for master plant schedule, details and notes.

Key	Qty	Botanical Name	Common Name	Size	Notes
Trees					
CCRB	8	Cercis canadensis 'Appalachian Red'	Appalachian Red Redbud	3" cal.	4' CT, CL, full and well branched, pink flowers
CCH	5	Cercis canadensis 'Hearts of Gold'	Hearts of Gold Redbud	3" cal.	4' CT, CL, full and well branched, yellow leaves
CF	2	Cornus florida 'Appalachian Snow'	Appalachian Snow Dogwood	3" cal.	4' CT, CL, full and well branched
CFB	24	Cornus florida 'Comco No. 1'	Cherokee Brave Dogwood	3" cal.	4' CT, CL, full and well branched
CM	3	Cornus mas 'Golden Glory'	Golden Glory Comealian Cherry Dogwood	8' hgt.	MT, 3 cane min. full and well branched
CO	3	Carya ovata	Shagbark Hickory	3" cal.	6' CT, CL, full and well branched
CV	8	Chionanthus virginicus 'Prodigy'	Prodigy American Fringe Tree	12' hgt.	MT, 3 cane min., full and well branched
HD	15	Halesia diptera	Two-winged Silverbell	3" cal.	4' CT, CL, full and well branched, white flowers
IA	3	Ilex attenuata 'Fosteri'	Foster's Holly	12' hgt.	4' CT, CL, full and well branched
IN-12	10	Ilex 'Nellie R Stevens'	Nellie R Stevens Holly	12' hgt.	4' CT, CL, full and well branched
IN-16	3	Ilex 'Nellie R Stevens'	Nellie R Stevens Holly	16' hgt.	4' CT, CL, full and well branched
IO-8	3	Ilex opaca 'Greenleaf'	Greenleaf American Holly	8' hgt.	CL, full and well branched
IO-10	5	Ilex opaca 'Greenleaf'	Greenleaf American Holly	10' hgt.	4' CT, CL, full and well branched
LT-3	5	Liriodendron tulipifera	Tulip Poplar	3" cal.	6' CT, CL, full and well branched
MEG-14	7	Metasequoia glyptostroboides 'Arrowhead'	Arrowhead Dawn Redwood	14' hgt.	4' CT, CL, full and well branched
MV-12	6	Magnolia virginiana 'Australis'	Sweetbay Magnolia	12' hgt.	MT, 3 cane min., full and well branched
NS	8	Nyssa sylvatica 'Wildfire'	Wildfire Blackgum	3" cal.	6' CT, CL, full and well branched
PA	8	Platanus x acerifolia 'Morton's Circle'	Exclamation London Planetree	4" cal.	6' CT, CL, full and well branched
PP-16	6	Pinus palustris	Longleaf Pine	16' hgt.	4' CT, CL, full and well branched
QF	4	Quercus falcata	Southern Red Oak	3" cal.	6' CT, CL, full and well branched
QL	5	Quercus lyrata	Overcup Oak	3" cal.	6' CT, CL, full and well branched
QV	15	Quercus velutina	Black Oak	4" cal.	6' CT, CL, full and well branched
TAC	4	Taxodium ascendens 'Prairie Sentinel'	Prairie Sentinel Pond Cypress	12' hgt.	4' CT, CL, full and well branched
TD-12	4	Taxodium distichum 'Mickleson'	Shawnee Brave Bald Cypress	12' hgt.	4' CT, CL, full and well branched
Shrubs & Groundcover					
CBB	21	Cephalanthus occidentalis	Buttonbush	7 gal.	6" o.c., full and dense, white flowers
CLA	33	Clethra alnifolia 'Sixteen Candles'	Sixteen Candles Summersweet	7 gal.	4" o.c., full and dense, white flowers
CS	13720	Carex cherokeensis	Cherokee Sedge	DP-50	12" o.c., well developed roots
CSB	7	Cotinus coggygia 'Royal Purple'	Royal Purple Smokebush	7 gal.	10' o.c., full and dense, purple leaves
HP	35	Hypericum prolificum	Shrubby St. John's Wort	7 gal.	4' o.c., full and dense, yellow flowers
HV	5	Hamamelis virginiana 'Harvest Moon'	Harvest Moon Witch Hazel	8' hgt.	MT, 5 cane min., full and well branched
JCP	140	Juniperus chinensis 'Parsonii'	Parson's Juniper	3 gal.	3' o.c., full and dense
PER	31	Perovskia atriplicifolia	Russian Sage	3 gal.	3' o.c., full and dense, purple flowers
SC	48	Sambucus canadensis 'Adams'	Adam's Elderberry	7 gal.	5' o.c., full and dense, white flowers
SLT	150	Saururus cernuus	Lizard's Tail	Qts.	18" o.c., full and dense, well developed roots

Key	Qty	Botanical Name	Common Name	Size	Notes
Ornamental Grass					
AV	15570	Andropogon virginicus	Broomsedge	DP-50	12" o.c., well developed roots
CL	1220	Chasmanthium latifolium	River Oats	DP-50	12" o.c., well developed roots
DC	3665	Deschampsia cespitosa 'Goldtau'	Golden Dew Tufted Hair Grass	DP-50	12" o.c., well developed roots
ES	7950	Eragrostis spectabilis	Purple Love Grass	DP-50	12" o.c., well developed roots
PVS	6575	Panicum virgatum 'Shenandoah'	Shenandoah Switchgrass	DP-50	12" o.c., well developed roots
WET- Wetland Mix 7,790 sf					
345		Asclepias incarnata	Swamp Milkweed	Qts.	18" o.c., full and dense, pink flowers, well developed roots
345		Helenium autumnale	Common Sneezeweed	Qts.	18" o.c., full and dense, yellow flowers, well developed roots
345		Helenium 'Moerheim Beauty'	Moerheim Beauty Sneezeweed	Qts.	18" o.c., full and dense, bronze flowers, well developed roots
345		Iris pseudacorus	Yellow Flag Iris	Qts.	18" o.c., full and dense, yellow flowers, well developed roots
345		Iris virginica	Southern Blue Flag Iris	Qts.	18" o.c., full and dense, blue flowers, well developed roots
3895		Juncus effusus	Common Rush	DP-50	12" o.c., well developed roots

Hatch Legend:

	(CL) Chasmanthium latifolium		(JCP) Juniperus chinensis 'Parsonii'		Maintenance Strip between Beltline property and adjacent
	(ES) Eragrostis spectabilis		(SLT) Saururus cernuus		(WET) Wetland Mix
	(PVS) Panicum virgatum 'Shenandoah'		(CS) Carex cherokeensis		Arborist Wood Mulch

Abbreviations:
 MT: Multi-trunk CAL: Caliper
 CL: Central Leader GAL: Gallon
 CT: Clear Trunk HGT: Height
 MIN: Minimum O.C.: On Center
 QTS: Quart DP-50: Deep Plug 50 Count

- General Notes:**
- New plant beds to encompass areas disturbed by construction. Prior to purchase of plant material, contractor to verify that the plans match the as-built conditions. If conditions differ, stop work and communicate this to the Owner's Representative or the Landscape Architect.
 - Temporary and Permanent Easements to be staked on site. No trees or shrubs shall be planted within the easement.
 - Perennials can be substituted with up to (10) different cultivars of similar size to provide color mixture. Cultivars to be approved by Landscape Architect or Owner's Representative prior to purchase.

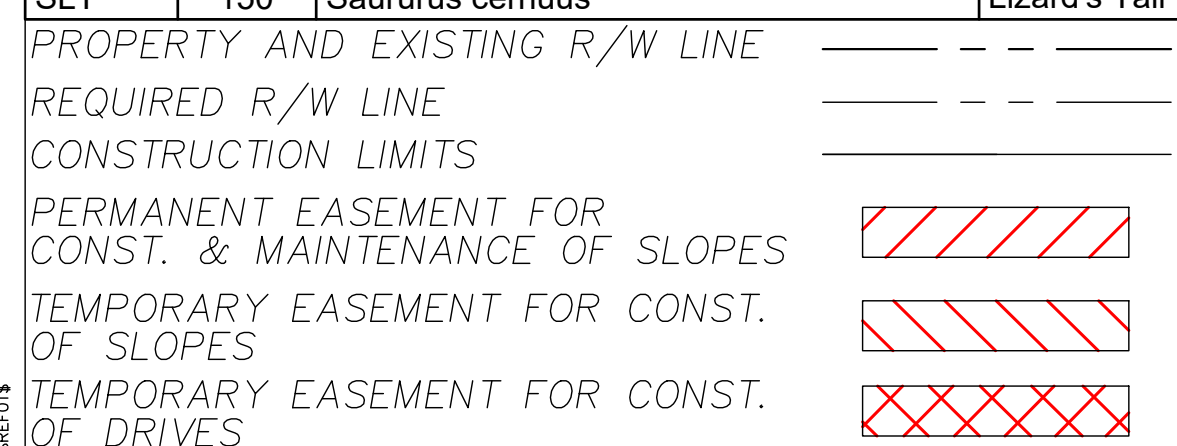
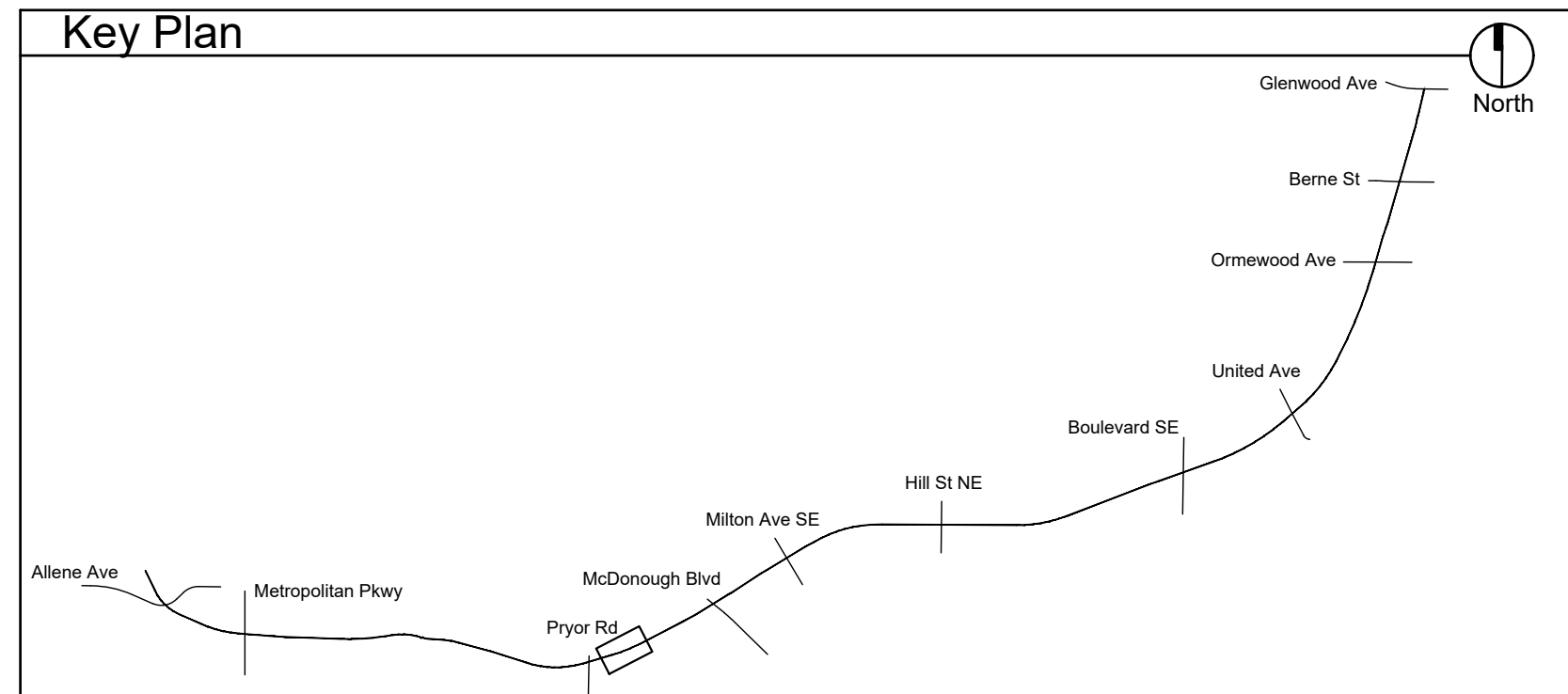

PROGRESS SET
NFC

Atlanta BeltLine
 ATLANTA BELTLINE, INC.
 100 PEACHTREE STREET, NW SUITE 2300
 ATLANTA, GA 30303
 TEL: (404) 477-3003
 FAX: (404) 477-3606

Kimley»Horn
 KIMLEY-HORN AND ASSOCIATES, INC.
 THE BILTMORE, SUITE 601
 817 WEST PEACHTREE STREET, NW
 ATLANTA, GEORGIA 30308
 TEL: (404) 419-8700

hedstrom
 LANDSCAPE ARCHITECTURE
 info@hedstromdesign.com
 www.hedstromdesign.com
 110 WEST MAGNOLIA AVE.
 KNOXVILLE, TN 37917
 OFFICE TEL: (865) 329-0012

SCALE IN FEET
 0 20 40 80

REVISION DATES		PLANTING PLAN	
		ATLANTA BELTLINE SOUTHSIDE TRAIL (SEGMENT 2)	
CHECKED:	DATE:	DRAWING No.	
BACKCHECKED:	DATE:	29-105	
CORRECTED:	DATE:		
VERIFIED:	DATE:		

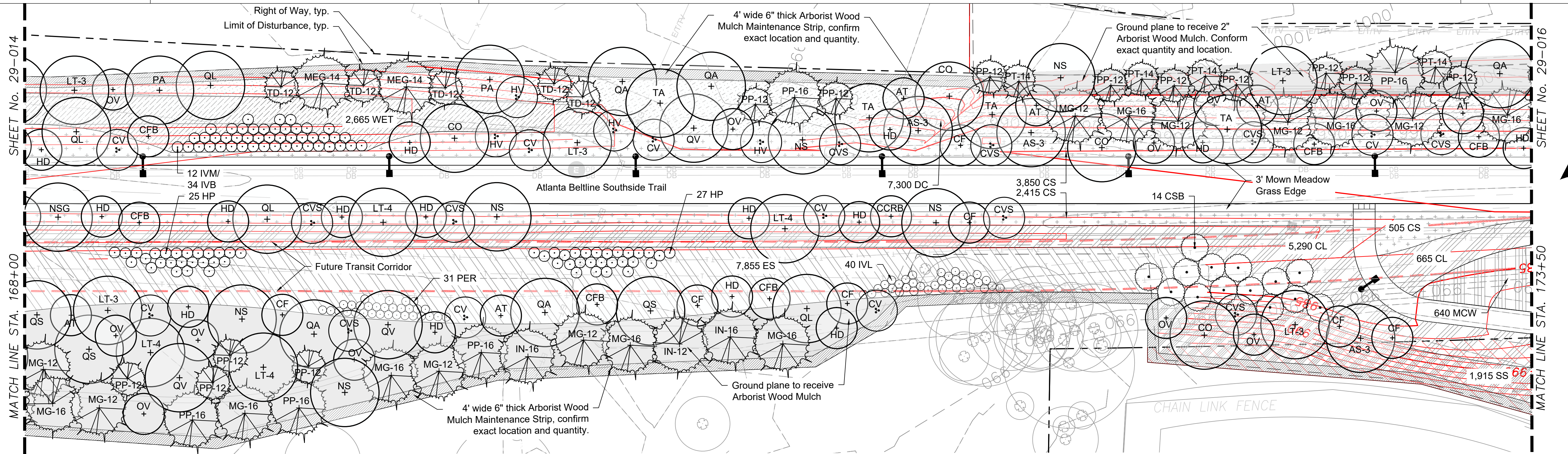

Plant Schedule: See Sheet 29-000 through 29-000A for master plant schedule, details and notes.

Key	Qty	Botanical Name	Common Name	Size	Notes
Trees					
AS-3	3	Acer saccharum 'Legacy'	Legacy Sugar Maple	3" cal.	6' CT, CL, full and well branched
AT	6	Asimina triloba	Paw Paw	3" cal.	6' CT, CL, full and well branched
CCRB	1	Cercis canadensis 'Appalachian Red'	Appalachian Red Redbud	3" cal.	4' CT, CL, full and well branched
CF	7	Cornus florida 'Appalachian Snow'	Appalachian Snow Dogwood	3" cal.	4' CT, CL, full and well branched
CFB	6	Cornus florida 'Comco No. 1'	Cherokee Brave Dogwood	3" cal.	4' CT, CL, full and well branched
CO	4	Carya ovata	Shagbark Hickory	3" cal.	6' CT, CL, full and well branched
CV	8	Chionanthus virginicus 'Prodigy'	Prodigy American Fringe Tree	12' hgt.	MT, 3 cane min., full and well branched
CVS	9	Chionanthus virginicus 'CV 1049'	Serenity American Fringe Tree	12' hgt.	MT, 3 cane min., full and well branched
HD	15	Halesia diptera	Two-winged Silverbell	3" cal.	4' CT, CL, full and well branched
IN-12	1	Ilex 'Nellie R Stevens'	Nellie R Stevens Holly	12' hgt.	4' CT, CL, full and well branched
IN-16	2	Ilex 'Nellie R Stevens'	Nellie R Stevens Holly	16' hgt.	4' CT, CL, full and well branched
LT-3	5	Liriodendron tulipifera	Tulip Poplar	3" cal.	6' CT, CL, full and well branched
LT-4	4	Liriodendron tulipifera	Tulip Poplar	4" cal.	6' CT, CL, full and well branched
MEG-14	2	Metasequoia glyptostroboides 'Arrowhead'	Arrowhead Dawn Redwood	14' hgt.	4' CT, CL, full and well branched
MG-12	8	Magnolia grandifolia 'Claudia Wannamaker'	Claudia Wannamaker Magnolia	12' hgt.	4' CT, full, dense, and well branched
MG-16	8	Magnolia grandifolia 'Claudia Wannamaker'	Claudia Wannamaker Magnolia	16' hgt.	4' CT, full, dense, and well branched
NS	6	Nyssa sylvatica 'Wildfire'	Wildfire Blackgum	3" cal.	6' CT, CL, full and well branched
NSG	1	Nyssa sylvatica 'NSUHH'	Green Gable Blackgum	3" cal.	6' CT, CL, full and well branched
OV	11	Ostrya virginiana	Eastern Hop Hornbeam	2" cal.	6' CT, CL, full and well branched
PA	2	Platanus x acerifolia 'Morton Circle'	Exclamation London Planetree	4" cal.	6' CT, CL, full and well branched
PP-12	13	Pinus palustris	Longleaf Pine	12' hgt.	4' CT, CL, full and well branched
PP-16	5	Pinus palustris	Longleaf Pine	16' hgt.	4' CT, CL, full and well branched
PT-14	4	Pinus taeda	Loblolly Pine	14' hgt.	4' CT, CL, full and well branched
QA	5	Quercus alba	White Oak	3" cal.	6' CT, CL, full and well branched
QL	4	Quercus lyrata	Overcup Oak	3" cal.	6' CT, CL, full and well branched
QS	3	Quercus shumardii	Shumard Oak	3" cal.	6' CT, CL, full and well branched
QV	3	Quercus velutina	Black Oak	4" cal.	6' CT, CL, full and well branched
TA	4	Tilia americana 'Continental Appeal'	Continental Appeal American Linden	4" cal.	6' CT, CL, full and well branched
TD-12	5	Taxodium distichum 'Mickelson'	Shawnee Brave Bald Cypress	12' hgt.	4' CT, CL, full and well branched
Shrubs & Groundcover					
CS	6265	Carex cherokeensis	Cherokee Sedge	DP-50	12" o.c., well developed roots
CSB	14	Cotinus coggygria 'Royal Purple'	Royal Purple Smokebush	7 gal.	10" o.c., full and dense, purple leaves
HP	52	Hypericum prolificum	Shrubby St. John's Wort	7 gal.	4" o.c., full and dense, yellow flowers
HV	4	Hamamelis virginiana 'Harvest Moon'	Harvest Moon Witch Hazel	8' hgt.	MT, 5 cane min., full and well branched
IVB	34	Ilex verticillata 'Berry Poppins'	Berry Poppins Winterberry Holly	7 gal.	4" o.c., full and dense, red berries
IVM	12	Ilex verticillata 'Mr Poppins'	Mr Poppins Winterberry Holly	7 gal.	4" o.c., full and dense, male pollinator
PER	71	Perovskia atriplicifolia	Russian Sage	3 gal.	3" o.c., full and dense, purple flowers

Ornamental Grass					
CL	5950	Chasmanthium latifolium	River Oats	DP-50	12" o.c., well developed roots
ES	7815	Eragrostis spectabilis	Purple Love Grass	DP-50	12" o.c., well developed roots
MCW	640	Muhlenbergia capillaris 'White Cloud'	White Cloud Muhly Grass	DP-50	12" o.c., well developed roots
WET- Wetland Mix 1,865 sf					
120	Asclepias incarnata	Swamp Milkweed	Qts.	18" o.c., full and dense, pink flowers, well developed roots	
120	Helenium autumnale	Common Sneezeweed	Qts.	18" o.c., full and dense, yellow flowers, well developed roots	
120	Penedium 'Moerheim Beauty'	Morheim Sneezeweed	Qts.	18" o.c., full and dense, bronze flowers, well developed roots	
120	Iris psueduacorus	Yellow Flag Iris	Qts.	18" o.c., full and dense, yellow flowers, well developed roots	
120	Iris virginica	Southern Blue Flag Iris	Qts.	18" o.c., full and dense, blue flowers, well developed roots	
1335	Juncus effusus	Common Rush	DP-50	12" o.c., well developed roots	

Hatch Legend:

	(CL) Chasmanthium latifolium		(CS) Carex cherokeensis		Maintenance Strip between Beltline property and adjacent
	(ES) Eragrostis spectabilis		(WET) Wetland Mix		Arborist Wood Mulch
	(MCW) Muhlenbergia capillaris 'White Cloud'				

Abbreviations:
 MT: Multi-trunk CAL: Caliper
 CL: Central Leader GAL: Gallon
 CT: Clear Trunk HGT: Height
 MIN: Minimum O.C.: On Center
 QTS: Quart DP-50: Deep Plug 50 Count

- General Notes:**
- New plant beds to encompass areas disturbed by construction. Prior to purchase of plant material contractor to verify that the plans match the as-built conditions. If conditions differ, stop work and communicate this to the Owner's Representative or the Landscape Architect.
 - Temporary and Permanent Easements to be staked on site. No trees or shrubs shall be planted within the easement.
 - Perennials can be substituted with up to (10) different cultivars of similar size to provide color mixture. Cultivars to be approved by Landscape Architect or Owner's Representative prior to purchase.

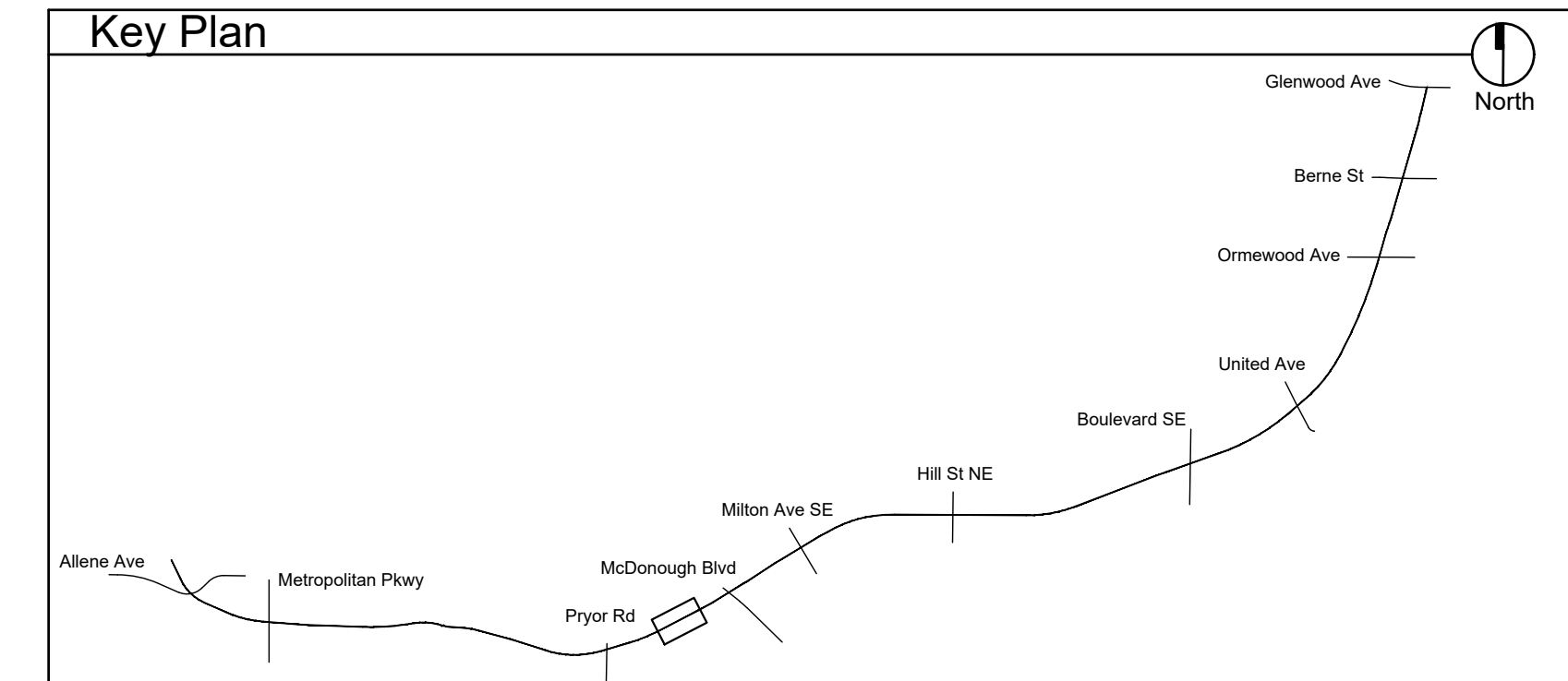

PROPERTY AND EXISTING R/W LINE ---

REQUIRED R/W LINE - - -

CONSTRUCTION LIMITS

PERMANENT EASEMENT FOR CONST. & MAINTENANCE OF SLOPES

TEMPORARY EASEMENT FOR CONST. OF SLOPES

TEMPORARY EASEMENT FOR CONST. OF DRIVES

PROGRESS SET
NFC

Atlanta BeltLine
 ATLANTA BELTLINE, INC.
 100 PEACHTREE STREET, NW
 SUITE 2300
 ATLANTA, GA 30303
 TEL: (404) 477-3003
 FAX: (404) 477-3606

Kimley»Horn
 KIMLEY-HORN AND ASSOCIATES, INC.
 THE BILTMORE, SUITE 601
 817 WEST PEACHTREE STREET, NW
 ATLANTA, GEORGIA 30308
 TEL: (404) 419-8700

hedstrom
 LANDSCAPE ARCHITECTURE
 info@hedstromdesign.com
 www.hedstromdesign.com
 110 WEST MAGNOLIA AVE.
 KNOXVILLE, TN 37917
 OFFICE TEL: (865) 329.0012

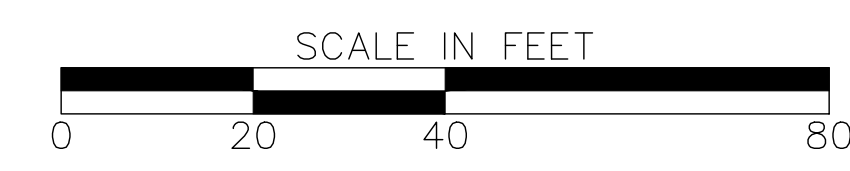

REVISION DATES		PLANTING PLAN		ATLANTA BELTLINE SOUTHSIDE TRAIL (SEGMENT 2)	
CHECKED:	DATE:	DRAWING No.		29-106	
BACKCHECKED:	DATE:				
CORRECTED:	DATE:				
VERIFIED:	DATE:				

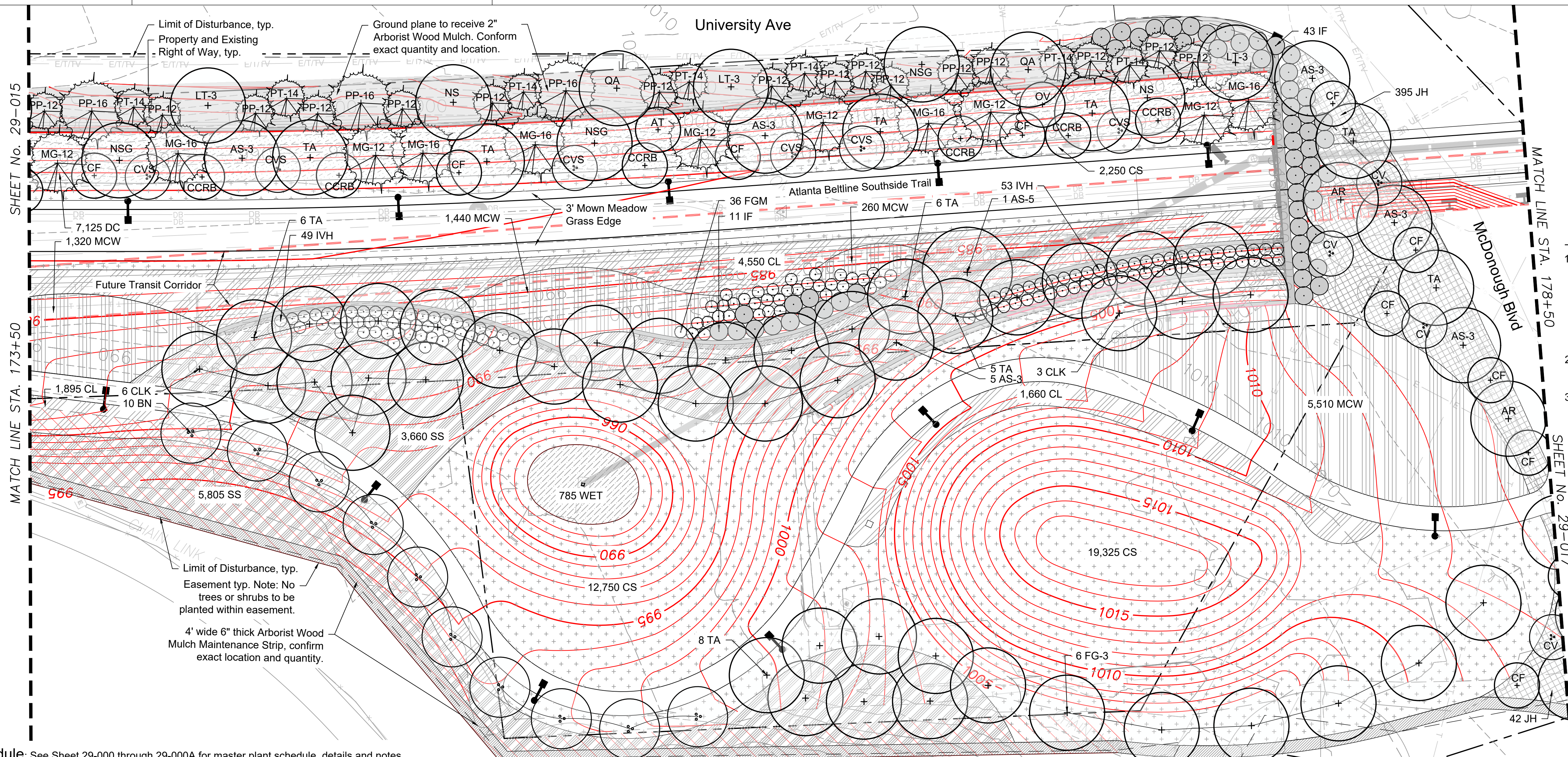

- General Notes:**
1. New plant beds to encompass areas disturbed by construction. Prior to purchase of plant material contractor to verify that the plans match the as-built conditions. If conditions differ, stop work and communicate this to the Owner's Representative or the Landscape Architect.
 2. Temporary and Permanent Easements to be staked on site. No trees or shrubs shall be planted within the easement.
 3. Perennials can be substituted with up to (10) different cultivars of similar size to provide color mixture. Cultivars to be approved by Landscape Architect or Owner's Representative prior to purchase.

- Hatch Legend:**
- (CL) Chasmanthium latifolium
 - (DC) Deschampsia cespitosa 'Goldtau'
 - (MCW) Muhlenbergia capillaris 'White Cloud'
 - (SS) Schizachyrium scoparium 'The Blues'
 - (CS) Carex cherokeensis
 - (JCP) Juniperus horizontalis 'Wiltonii'
 - (WET) Wetland Mix
 - Arborist Wood Mulch
 - Maintenance Strip between Beltline property and adjacent

Plant Schedule: See Sheet 29-000 through 29-000A for master plant schedule, details and notes.

Key	Qty	Botanical Name	Common Name	Size	Notes
Trees					
AR	2	Acer rubrum 'October Glory'	October Glory Red Maple	3" cal.	6' CT, CL, full and well branched
AS-3	10	Acer saccharum 'Legacy'	Legacy Sugar Maple	3" cal.	6' CT, CL, full and well branched
AS-5	1	Acer saccharum 'Legacy'	Legacy Sugar Maple	5" cal.	6' CT, CL, full and well branched
AT	1	Asimina triloba	Paw Paw	3" cal.	6' CT, CL, full and well branched
BN	10	Betula nigra 'City Slicker'	City Slicker River Birch	14' hgt.	MT, 3 cane min., full and well branched
CCRB	6	Cercis canadensis 'Appalachian Red'	Appalachian Red Red bud	3" cal.	4' CT, CL, full and well branched
CF	10	Cornus florida 'Appalachian Snow'	Appalachian Snow Dogwood	3" cal.	4' CT, CL, full and well branched
CLK	9	Cladastris kentukea 'Perkins Pink'	Perkins Pink Yellowwood	3" cal.	6' CT, CL, full and well branched
CV	4	Chionanthus virginiana 'Prodigy'	Prodigy American Fringe Tree	3" cal.	4' CT, CL, full and well branched
CVS	6	Chionanthus virginiana 'CV 1049'	Serenity American Fringe Tree	12' hgt.	MT, 3 cane min., full and well branched
FG-3	6	Fagus grandifolia	American Beech	3" cal.	6' CT, CL, full and well branched
LT-3	3	Liriodendron tulipifera	Tulip Poplar	3" cal.	6' CT, CL, full and well branched
MG-12	6	Magnolia grandifolia 'Claudia Wannamaker'	Claudia Wannamaker Magnolia	12' hgt.	4' CT, CL, full, dense, and well branched
MG-16	5	Magnolia grandifolia 'Claudia Wannamaker'	Claudia Wannamaker Magnolia	16' hgt.	4' CT, CL, full, dense, and well branched
NS	2	Nyssa sylvatica 'Wildfire'	Wildfire Blackgum	3" cal.	6' CT, CL, full and well branched
NSG	3	Nyssa sylvatica 'NSUHH'	Green Gable Blackgum	3" cal.	6' CT, CL, full and well branched
OV	1	Ostrya virginiana	Eastern Hop Hornbeam	2" cal.	5' CT, CL, full and well branched
PP-12	16	Pinus palustris	Longleaf Pine	12' hgt.	4' CT, CL, full and well branched
PP-16	3	Pinus palustris	Longleaf Pine	16' hgt.	4' CT, CL, full and well branched
PT-14	7	Pinus taeda	Loblolly Pine	14' hgt.	4' CT, CL, full and well branched
QA	2	Quercus alba	White Oak	3" cal.	6' CT, CL, full and well branched
TA	31	Tilia americana 'Continental Appeal'	Continental Appeal American Linden	4" cal.	6' CT, CL, full and well branched

Shrubs & Groundcover

CLA	Acer saccharum 'Legacy'	Sixteen Candles Summersweet	7 gal.	4' o.c., full and dense, white flowers
CS	Carex cherokeensis	Cherokee Sedge	DP-50	12" o.c., well developed roots
FGM	Fothergilla 'Mt. Airy'	Mt. Airy Fothergilla	7 gal.	4' o.c., full and dense, white flowers
IF	Illicium floridanum 'Halley's Comet'	Halley's Comet Florida Anise	7 gal.	6' o.c., full and dense, red flowers
IVH	Itea virginica 'Henry's Garnet'	Henry's Garnet Sweetspire	7 gal.	4' o.c., full and dense, white flowers
JH	Juniperus horizontalis 'Wiltonii'	Blue Rug Juniper	3 gal.	3' o.c., full and dense
RD	Rhaphiolepis x delacourii 'Corleyscouri'	Snowcap Indian Hawthorn	7 gal.	4' o.c., full and dense, white flowers

Ornamental Grass

CL	Chasmanthium latifolium	River Oats	DP-50	12" o.c., well developed roots
DC	Deschampsia cespitosa 'Goldtau'	Golden Dew Tufted Hair Grass	DP-50	12" o.c., well developed roots
MCW	Muhlenbergia capillaris 'White Cloud'	White Cloud Muhly Grass	DP-50	12" o.c., well developed roots
SS	Schizachyrium scoparium 'The Blues'	The Blues Little Bluestem	DP-50	12" o.c., well developed roots

WET - Wetland Mix 785 sf

35	Asclepias incarnata	Swamp Milkweed	Qts.	18" o.c., full and dense, pink flowers, well developed roots
35	Helenium autumnale	Common Sneezeweed	Qts.	18" o.c., full and dense, yellow flowers, well developed roots
35	Helenium 'Moerheim Beauty'	Moerheim Beauty Sneezeweed	Qts.	18" o.c., full and dense, bronze flowers, well developed roots
35	Iris pseudacorus	Yellow Flag Iris	Qts.	18" o.c., full and dense, yellow flowers, well developed roots
35	Iris virginica	Southern Blue Flag Iris	Qts.	18" o.c., full and dense, blue flowers, well developed roots
395	Juncus effusus	Common Rush	DP-50	12" o.c., well developed roots

- Abbreviations:**
- MT: Multi-trunk
 - CL: Central Leader
 - CT: Clear Trunk
 - MIN: Minimum
 - QTS: Quart
 - CAL: Caliper
 - GAL: Gallon
 - HGT: Height
 - O.C.: On Center
 - DP-50: Deep Plug 50 Count

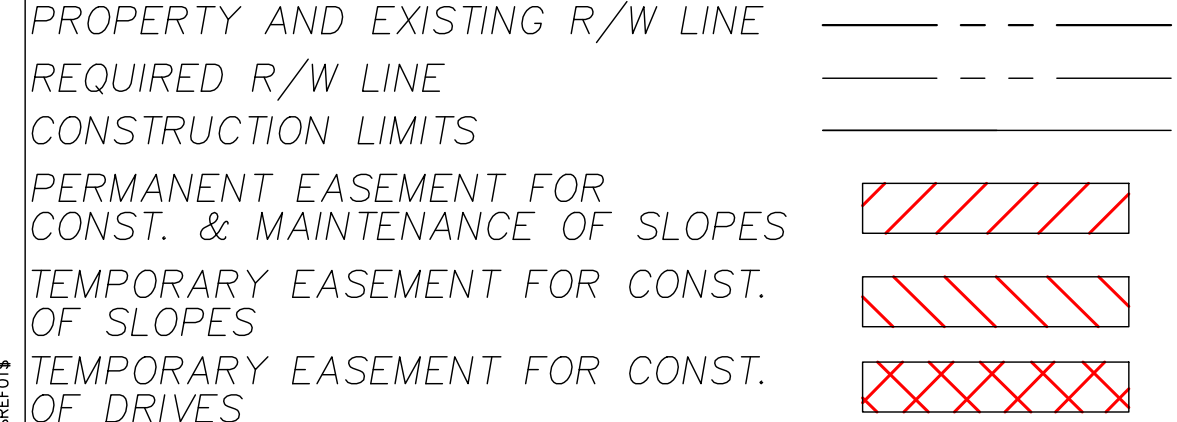
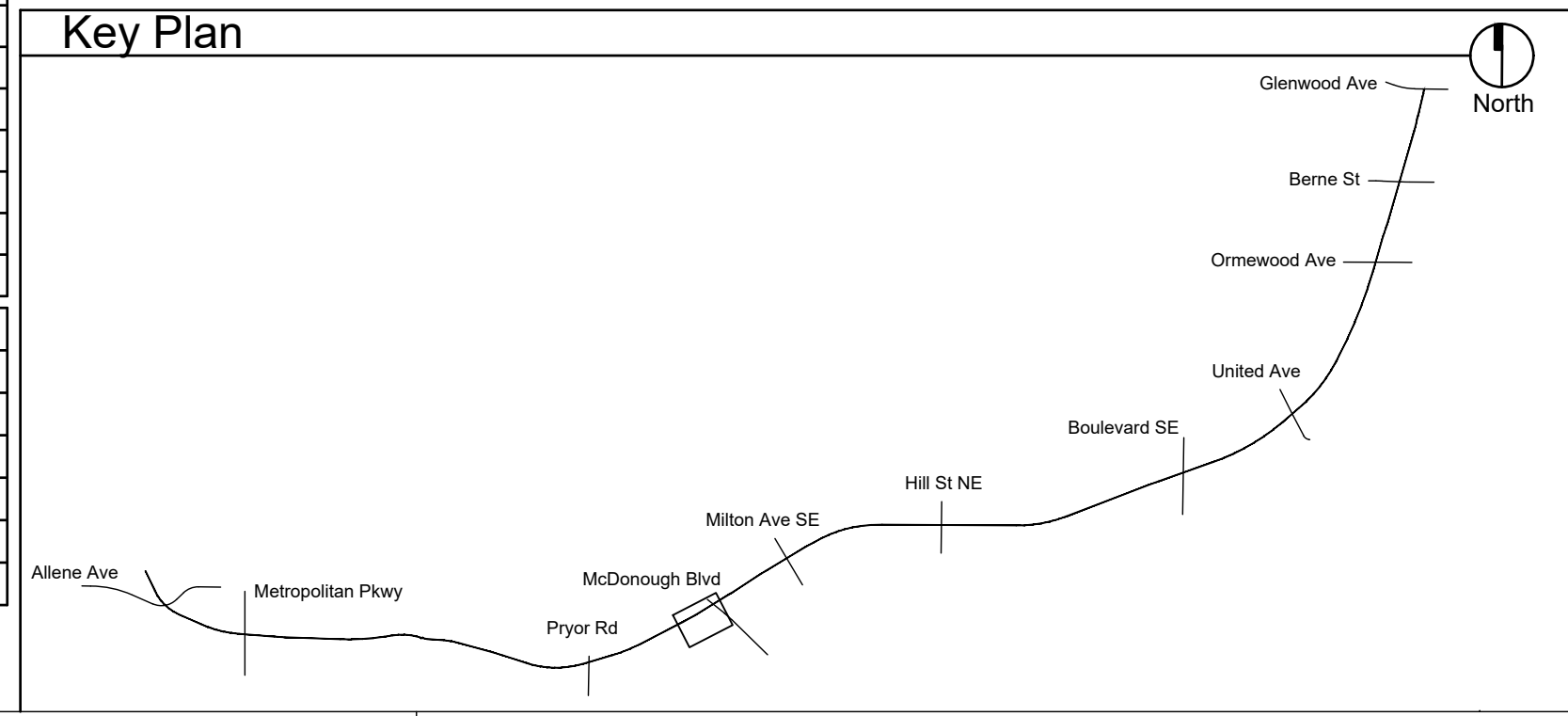

PROGRESS SET
NFC

Atlanta BeltLine
ATLANTA BELTLINE, INC.
100 PEACHTREE STREET, NW
SUITE 2300
ATLANTA, GA 30303
TEL: (404) 477-3003
FAX: (404) 477-3606

Kimley»Horn
KIMLEY-HORN AND ASSOCIATES, INC.
THE BILTMORE, SUITE 601
817 WEST PEACHTREE STREET, NW
ATLANTA, GEORGIA 30308
TEL: (404) 419-8700

hedstrom
LANDSCAPE ARCHITECTURE
info@hedstromdesign.com
www.hedstromdesign.com
110 WEST MAGNOLIA AVE.
KNOXVILLE, TN 37917
OFFICE TEL: (865) 329-0012



REVISION DATES

PLANTING PLAN
ATLANTA BELTLINE SOUTHSIDE TRAIL (SEGMENT 2)

CHECKED:	DATE:	DRAWING No.
BACKCHECKED:	DATE:	29-107
CORRECTED:	DATE:	
VERIFIED:	DATE:	

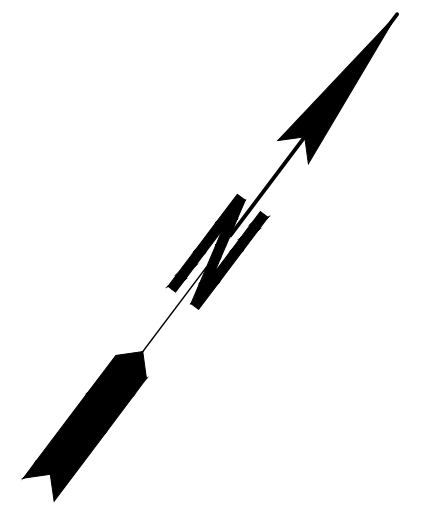
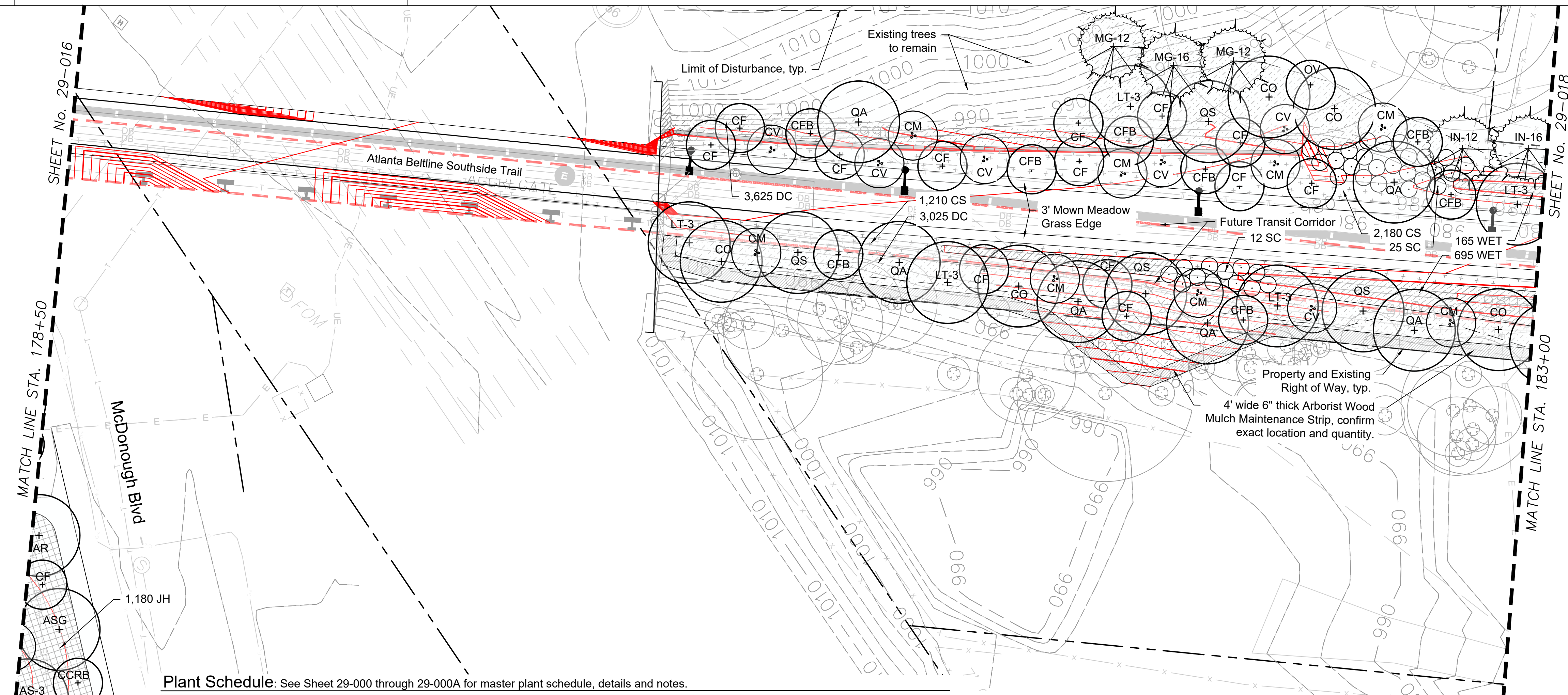

Plant Schedule: See Sheet 29-000 through 29-000A for master plant schedule, details and notes.

Key	Qty	Botanical Name	Common Name	Size	Notes
Trees					
AR	2	Acer rubrum 'October Glory'	October Glory Red Maple	3" cal.	6' CT, CL, full and well branched
AS-3	1	Acer saccharum 'Legacy'	Legacy Sugar Maple	3" cal.	6' CT, CL, full and well branched
ASG	1	Acer saccharum 'Green Mountain'	Green Mountain Sugar Maple	3" cal.	6' CT, CL, full and well branched
CCRB	1	Cercis canadensis 'Appalachian Red'	Appalachian Red Redbud	3" cal.	4' CT, CL, full and well branched
CF	14	Cornus florida 'Appalachian Snow'	Appalachian Snow Dogwood	3" cal.	4' CT, CL, full and well branched
CFB	8	Cornus florida 'Comco No. 1'	Cherokee Brave Dogwood	3" cal.	4' CT, CL, full and well branched
CM	8	Cornus mas 'Golden Glory'	Golden Glory Cornealian Cherry Dogwood	10' hgt.	MT, 3 cane min., full and well branched
CO	5	Carya ovata	Shagbark Hickory	3" cal.	6' CT, CL, full and well branched
CV	6	Chionanthus virginicus 'Prodigy'	Prodigy American Fringe Tree	12' hgt.	MT, 3 cane min., full and well branched
IN-12	1	Ilex 'Nellie R Stevens'	Nellie R Stevens Holly	12' hgt.	4' CT, CL, full and well branched
IN-16	1	Ilex 'Nellie R Stevens'	Nellie R Stevens Holly	16' hgt.	4' CT, CL, full and well branched
LT-3	5	Liriodendron tulipifera	Tulip Poplar	3" cal.	6' CT, CL, full and well branched
MG-12	2	Magnolia grandiflora 'Claudia Wannamaker'	Claudia Wannamaker Southern Magnolia	12' hgt.	4' CT, CL, full and dense
MG-16	1	Magnolia grandiflora 'Claudia Wannamaker'	Claudia Wannamaker Southern Magnolia	16' hgt.	4' CT, CL, full and dense
OV	1	Ostrya virginiana	Eastern Hop Hornbeam	2" cal.	5' CT, CL, full and well branched
QA	6	Quercus alba	White Oak	3" cal.	6' CT, CL, full and well branched
QS	4	Quercus shumardii 'Panache'	Panache Shumard Oak	4" cal.	6' CT, CL, full and well branched
Shrubs & Groundcover					
CS	3390	Carex cherokeensis	Cherokee Sedge	DP-50	12" o.c., well developed roots
JH		Juniperus horizontalis 'Wiltonii'	Blue Rug Juniper	3 gal.	3' o.c., full and dense
SC		Sambucus canadensis 'Adams'	Adam's Elderberry	7 gal.	5' o.c., full and dense
Ornamental Grass					
DC		Deschampsia cespitosa 'Goldtau'	Golden Dew Tufted Hair Grass	DP-50	12" o.c., well developed roots
WET- Wetland Mix 860 sf					
	40	Asclepias incarnata	Swamp Milkweed	Qts.	18" o.c., full and dense, pink flowers, well developed roots
	40	Helenium autumnale	Common Sneezeweed	Qts.	18" o.c., full and dense, yellow flowers, well developed roots
	40	Helenium 'Moerheim Beauty'	Morheim Beauty Sneezeweed	Qts.	18" o.c., full and dense, bronze flowers, well developed roots
	40	Iris psuedacorus	Yellow Flag Iris	Qts.	18" o.c., full and dense, yellow flowers, well developed roots
	40	Iris virginica	Southern Blue Flag Iris	Qts.	18" o.c., full and dense, blue flowers, well developed roots
	410	Juncus effusus	Common Rush	DP-50	12" o.c., well developed roots

Abbreviations:

MT: Multi-trunk CAL: Caliper
 CL: Central Leader GAL: Gallon
 CT: Clear Trunk HGT: Height
 MIN: Minimum O.C.: On Center
 QTS: Quart DP-50: Deep Plug 50 Count

General Notes:

- New plant beds to encompass areas disturbed by construction. Prior to purchase of plant material contractor to verify that the plans match the as-built conditions. If conditions differ, stop work and communicate this to the Owner's Representative or the Landscape Architect.
- Temporary and Permanent Easements to be staked on site. No trees or shrubs shall be planted within the easement.
- Perennials can be substituted with up to (10) different cultivars of similar size to provide color mixture. Cultivars to be approved by Landscape Architect or Owner's Representative prior to purchase.

Hatch Legend:

	(DC) Deschampsia cespitosa 'Goldtau'		(JH) Juniperus horizontalis 'Wiltonii'		Maintenance Strip between Beltline property and adjacent
	(CS) Carex cherokeensis		(WET) Wetland Mix		Arborist Wood Mulch

Key Plan

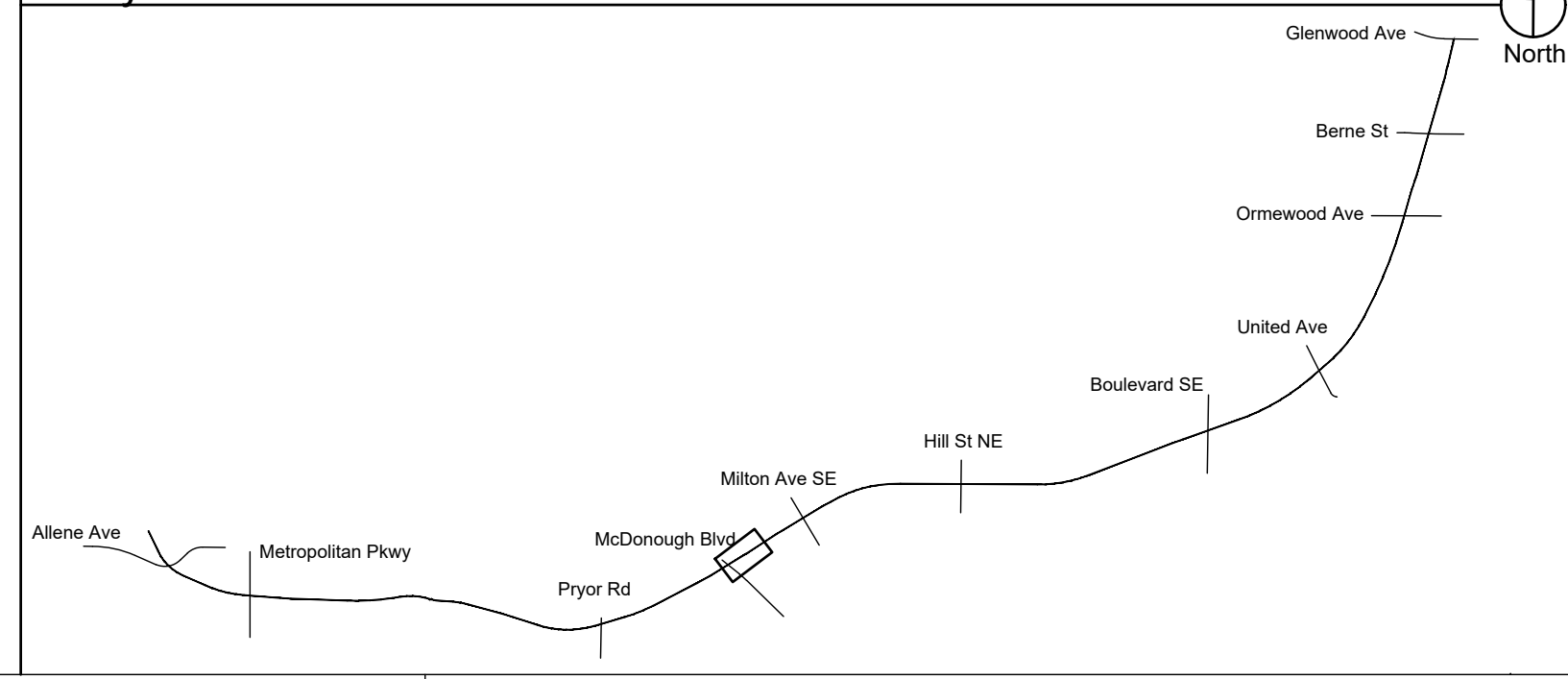

PROPERTY AND EXISTING R/W LINE
 REQUIRED R/W LINE
 CONSTRUCTION LIMITS
 PERMANENT EASEMENT FOR CONST. & MAINTENANCE OF SLOPES
 TEMPORARY EASEMENT FOR CONST. OF SLOPES
 TEMPORARY EASEMENT FOR CONST. OF DRIVES

PROGRESS SET
NFC

Atlanta BeltLine
 ATLANTA BELTLINE, INC.
 100 PEACHTREE STREET, NW
 SUITE 2300
 ATLANTA, GA 30303
 TEL: (404) 477-3003
 FAX: (404) 477-3606

Kimley-Horn
 KIMLEY-HORN AND ASSOCIATES, INC.
 THE BILTMORE, SUITE 601
 817 WEST PEACHTREE STREET, NW
 ATLANTA, GEORGIA 30308
 TEL: (404) 419-8700

hedstrom
 LANDSCAPE ARCHITECTURE
 info@hedstromdesign.com
 www.hedstromdesign.com
 110 WEST MAGNOLIA AVE.
 KNOXVILLE, TN 37917
 OFFICE TEL: (865) 329.0012



REVISION DATES

No.	Date	Description

PLANTING PLAN
 ATLANTA BELTLINE SOUTHSIDE TRAIL (SEGMENT 2)

CHECKED:	DATE:	DRAWING No.
BACKCHECKED:	DATE:	29-108
CORRECTED:	DATE:	
VERIFIED:	DATE:	

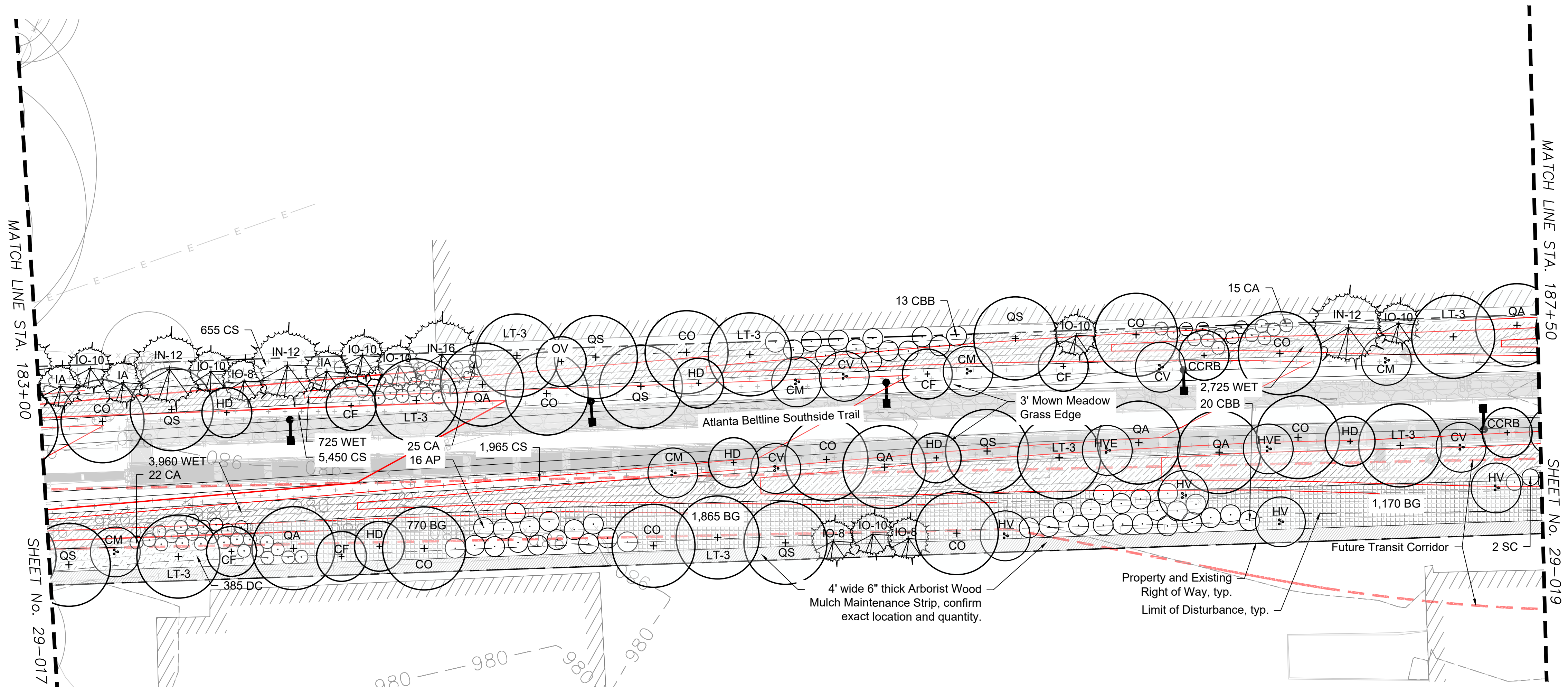

Plant Schedule: See Sheet 29-000 through 29-000A for master plant schedule, details and notes.

Key	Qty	Botanical Name	Common Name	Size	Notes
Trees					
CCRB	2	Cercis canadensis 'Appalachian Red'	Appalachian Red Redbud	3" cal.	4' CT, CL, full and well branched
CF	5	Cornus florida 'Appalachian Snow'	Appalachian Snow Dogwood	3" cal.	4' CT, CL, full and well branched
CM	5	Cornus mas 'Golden Glory'	Golden Glory Cornelian Cherry Dogwood	10' hgt.	MT, 3 cane min., full and well branched
CO	10	Carya ovata	Shagbark Hickory	3" cal.	6' CT, CL, full and well branched
CV	4	Chionanthus virginicus 'Prodigy'	Prodigy American Fringe Tree	12' hgt.	MT, 3 cane min., full and well branched
HD	6	Halesia diptera	Two-winged Silverbell	3" cal.	4' CT, CL, full and well branched
IA	3	Ilex attenuata 'Fosteri'	Foster's Holly	12' hgt.	4' CT, CL, full and well branched
IN-12	3	Ilex 'Nellie R Stevens'	Nellie R Stevens Holly	12' hgt.	4' CT, CL, full and well branched
IN-16	1	Ilex 'Nellie R Stevens'	Nellie R Stevens Holly	16' hgt.	4' CT, CL, full and well branched
IO-8	3	Ilex opaca 'Greenleaf'	Greenleaf American Holly	8' hgt.	CL, full and dense
IO-10	7	Ilex opaca 'Greenleaf'	Greenleaf American Holly	10' hgt.	4' CT, CL, full and well branched
LT-3	8	Liriodendron tulipifera	Tulip Poplar	3" cal.	6' CT, CL, full and well branched
OV	1	Ostrya virginiana	Eastern Hop Hornbeam	2" cal.	5' CT, CL, full and well branched
QA	6	Quercus alba	White Oak	3" cal.	6' CT, CL, full and well branched
QS	7	Quercus shumardii 'Panache'	Panache Shumard Oak	4" cal.	6' CT, CL, full and well branched
Shrubs and Groundcover					
AP		Aesculus parviflora	Bottlebrush Buckeye	7 gal.	6' o.c., full and dense, white flowers
CA		Callicarpa americana	American Beautyberry	7 gal.	4' o.c., full and dense, purple berries
CBB		Cephalanthus occidentalis	Buttonbush	7 gal.	6' o.c., full and dense, white flowers
CS		Carex cherokeensis	Cherokee Sedge	Plug	12" o.c., well developed roots
HV		Hamamelis virginiana 'Harvest Moon'	Harvest Moon Witch Hazel	8' hgt.	MT, 5 cane min., full and well branched
HVE		Hamamelis vernalis 'Autumn Embers'	Autumn Embers Ozark Witch Hazel	6' hgt.	MT, 5 cane min., full and well branched
SC		Sambucus canadensis 'Adams'	Adam's Elderberry	7 gal.	5' o.c., full and dense, white flowers
Ornamental Grass					
BG		Bouteloua gracilis 'Blonde Ambition'	Blonde Ambition Blue Grama Grass	DP-50	12" o.c., well developed roots

WET- Wetland Mix 6,575 sf					
290	Asclepias incarnata	Swamp Milkweed	Qts.	18" o.c., full and dense, pink flowers, well developed roots	
290	Helenium autumnale	Common Sneezeweed	Qts.	18" o.c., full and dense, yellow flowers, well developed roots	
290	Helenium 'Moerheim Beauty'	Moerheim Beauty Sneezeweed	Qts.	18" o.c., full and dense, bronze flowers, well developed roots	
290	Iris pseudacorus	Yellow Flag Iris	Qts.	18" o.c., full and dense, yellow flowers, well developed roots	
290	Iris virginica	Southern Blue Flag Iris	Qts.	18" o.c., full and dense, blue flowers, well developed roots	
3280	Juncus effusus	Common Rush	DP-50	12" o.c., well developed roots	

Hatch Legend:

	(BG) Bouteloua gracilis 'Blonde Ambition'		(WET) Wetland Mix		Maintenance Strip between Beltline property and adjacent
	(CS) Carex cherokeensis		Arborist Wood Mulch		

Abbreviations:

MT: Multi-trunk	CAL: Caliper
CL: Central Leader	GAL: Gallon
CT: Clear Trunk	HGT: Height
MIN: Minimum	O.C.: On Center
QTS: Quart	DP-50: Deep Plug 50 Count

General Notes:

- New plant beds to encompass areas disturbed by construction. Prior to purchase of plant material contractor to verify that the plans match the as-built conditions. If conditions differ, stop work and communicate this to the Owner's Representative or the Landscape Architect.
- Temporary and Permanent Easements to be staked on site. No trees or shrubs shall be planted within the easement.
- Perennials can be substituted with up to (10) different cultivars of similar size to provide color mixture. Cultivars to be approved by Landscape Architect or Owner's Representative prior to purchase.

Key Plan

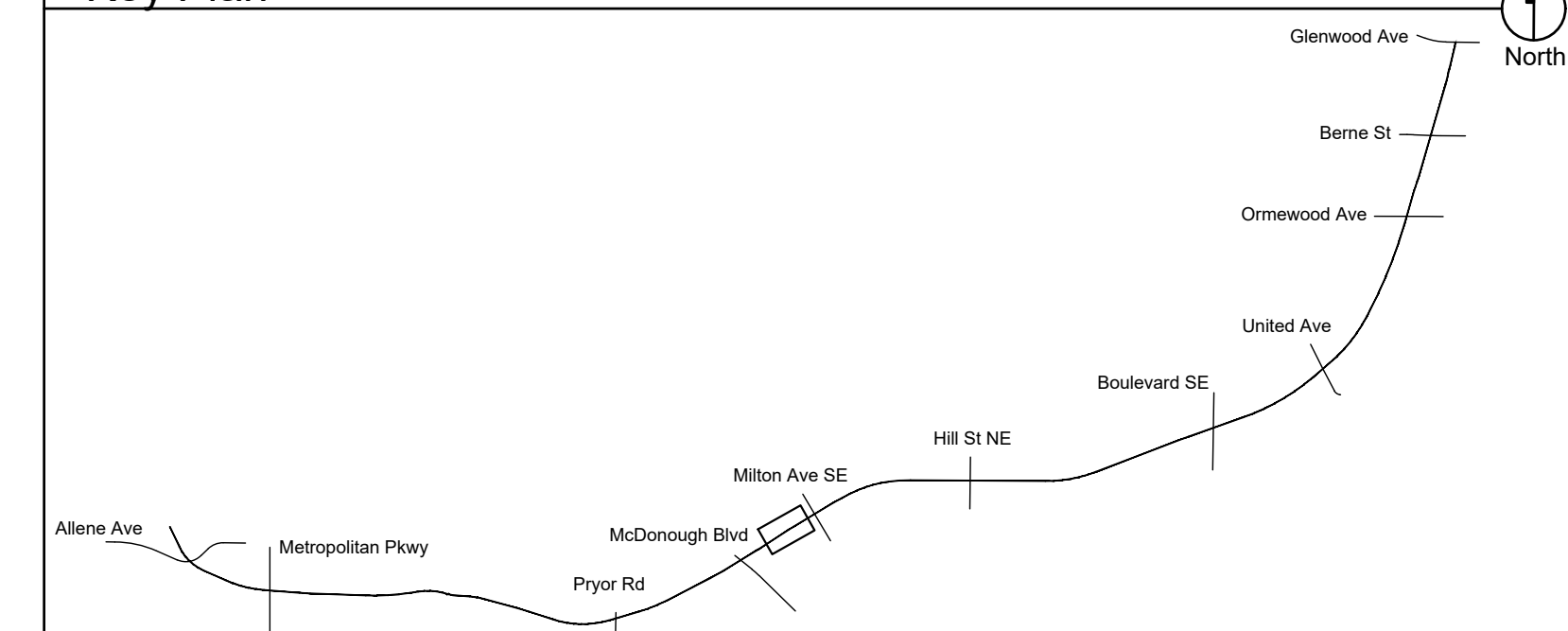

PROPERTY AND EXISTING R/W LINE	---
REQUIRED R/W LINE	---
CONSTRUCTION LIMITS	---
PERMANENT EASEMENT FOR CONST. & MAINTENANCE OF SLOPES	
TEMPORARY EASEMENT FOR CONST. OF SLOPES	
TEMPORARY EASEMENT FOR CONST. OF DRIVES	

PROGRESS SET
NFC

Atlanta BeltLine
ATLANTA BELTLINE, INC.
100 PEACHTREE STREET, NW
SUITE 2300
ATLANTA, GA 30303
TEL: (404) 477-3003
FAX: (404) 477-3606

Kimley»Horn
KIMLEY-HORN AND ASSOCIATES, INC.
THE BILTMORE, SUITE 601
817 WEST PEACHTREE STREET, NW
ATLANTA, GEORGIA 30308
TEL: (404) 419-8700

hedstrom
LANDSCAPE ARCHITECTURE
info@hedstromdesign.com
www.hedstromdesign.com
110 WEST MAGNOLIA AVE.
KNOXVILLE, TN 37917
OFFICE TEL: (865) 329.0012



REVISION DATES

No.	DATE	DESCRIPTION

PLANTING PLAN
ATLANTA BELTLINE SOUTHSIDE TRAIL (SEGMENT 2)

CHECKED:	DATE:	DRAWING No.
BACKCHECKED:	DATE:	29-109
CORRECTED:	DATE:	
VERIFIED:	DATE:	

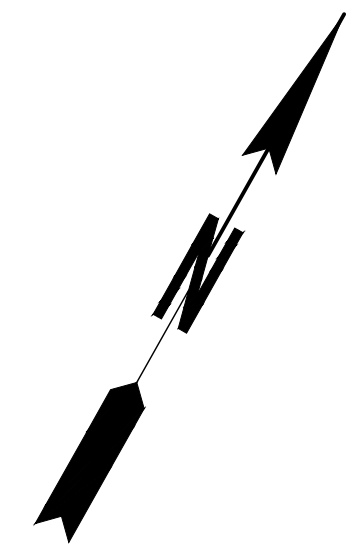
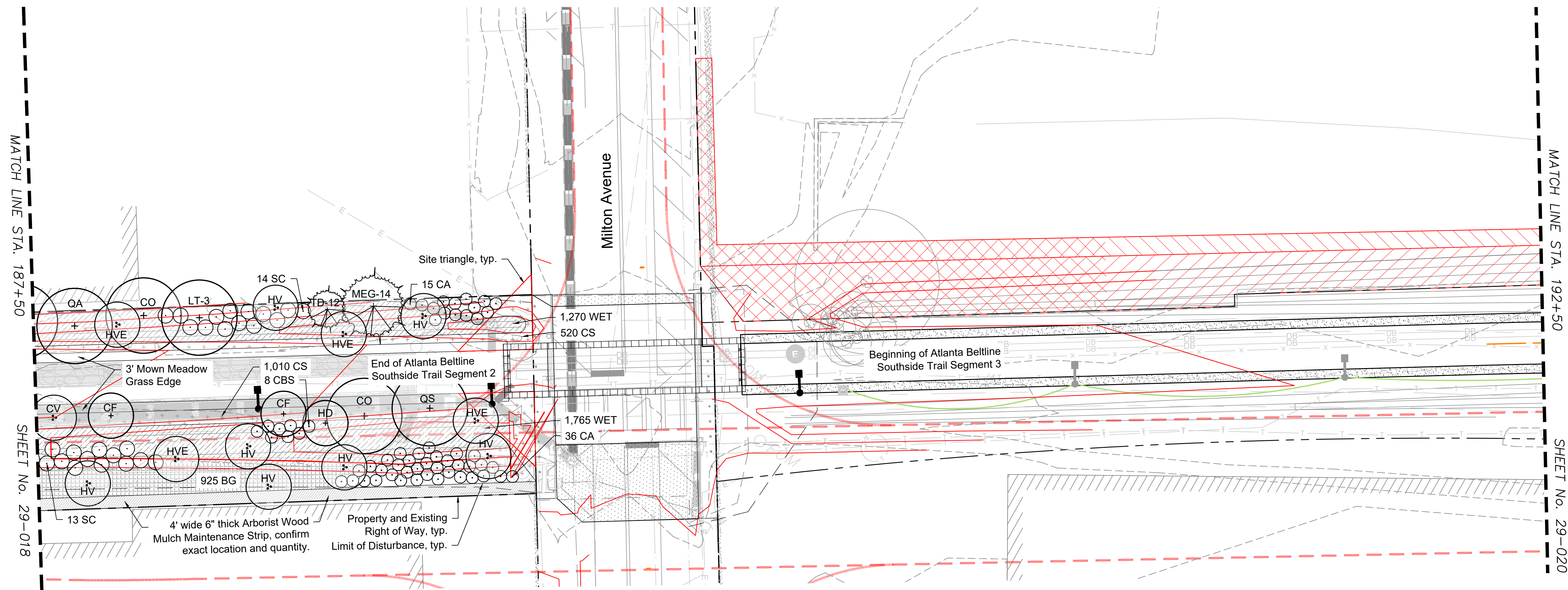

Plant Schedule: See Sheet 29-000 through 29-000A for master plant schedule, details and notes.

Key	Qty	Botanical Name	Common Name	Size	Notes
Trees					
CF	2	Cornus florida 'Appalachian Snow'	Appalachian Snow Dogwood	3" cal.	4' CT, CL, full and well branched
CO	2	Carya ovata	Shagbark Hickory	3" cal.	6' CT, CL, full and well branched
CV	1	Chinanthus virginicus 'Prodigy'	Prodigy American Fringe Tree	12' hgt.	MT, 3 cane min., full and well branched
HD	1	Halesia diptera	Two-winged Silverbell	3" cal.	4' CT, full and well branched
LT-3	1	Liriodendron tulipifera	Tulip Poplar	3" cal.	6' CT, CL, full and well branched
MEG-14	1	Metasequoia glyptostroboides 'Arrowhead'	Narrow Dawn Redwood	14' hgt.	4' CT, CL, full and well branched
TD-12	1	Taxodium distichum var. distichum	Bald Cypress	12' hgt.	6' CT, CL, full and well branched
QA	1	Quercus alba	White Oak	3" cal.	6' CT, CL, full and well branched
QS	1	Quercus shumardii 'Panache'	Panache Shumard Oak	4" cal.	6' CT, CL, full and well branched
Shrubs & Groundcover					
CA		Callicarpa americana	American Beautyberry	7 gal.	4' o.c., full and dense, purple berries
CBS		Cephalanthus occidentalis 'Sugar Shack'	Sugar Shack Dwarf Buttonbush	7 gal.	4' o.c., full and dense, white flowers
CS		Carex cherokeensis	Cherokee Sedge	DP-50	12" o.c., well developed roots
HV		Hamamelis virginiana 'Harvest Moon'	Harvest Moon Witch Hazel	8' hgt.	MT, 5 cane min., full and well branched
HVE		Hamamelis virginiana 'Autumn Embers'	Autumn Embers Witch Hazel	6' hgt.	MT, 5 cane min., full and well branched
SC		Sambucus canadensis 'Adams'	Adam's Elderberry	7 gal.	5' o.c., full and dense, white flowers
Ornamental Grass					
WET		Bouteloua gracilis 'Blonde Ambition'	Blonde Ambition Blue Grama Grass	DP-50	12" o.c., well developed roots
135		Asclepias incarnata	Swamp Milkweed	Qts.	18" o.c., full and dense, pink flowers, well developed roots
135		Helenium autumnale	Common Sneezeweed	Qts.	18" o.c., full and dense, yellow flowers, well developed roots
135		Helenium 'Moerheim Beauty'	Moerheim Beauty Sneezeweed	Qts.	18" o.c., full and dense, bronze flowers, well developed roots
135		Iris pseudacorus	Yellow Flag Iris	Qts.	18" o.c., full and dense, yellow flowers, well developed roots
135		Iris virginica	Southern Blue Flag Iris	Qts.	18" o.c., full and dense, blue flowers, well developed roots
1515		Juncus effusus	Common Rush	DP-50	12" o.c., well developed roots

Abbreviations:

MT: Multi-trunk CAL: Caliper
 CL: Central Leader GAL: Gallon
 CT: Clear Trunk HGT: Height
 MIN: Minimum O.C.: On Center
 QTS: Quart DP-50: Deep Plug 50 Count

General Notes:

- New plant beds to encompass areas disturbed by construction. Prior to purchase of plant material contractor to verify that the plans match the as-built conditions. If conditions differ, stop work and communicate this to the Owner's Representative or the Landscape Architect.
- Temporary and Permanent Easements to be staked on site. No trees or shrubs shall be planted within the easement.
- Perennials can be substituted with up to (10) different cultivars of similar size to provide color mixture. Cultivars to be approved by Landscape Architect or Owner's Representative prior to purchase.

Hatch Legend:

	(BG) Bouteloua gracilis 'Blonde Ambition'		(WET) Wetland Mix		Arborist Wood Mulch
	(CS) Carex cherokeensis		Maintenance Strip between Beltline property and adjacent		

Key Plan

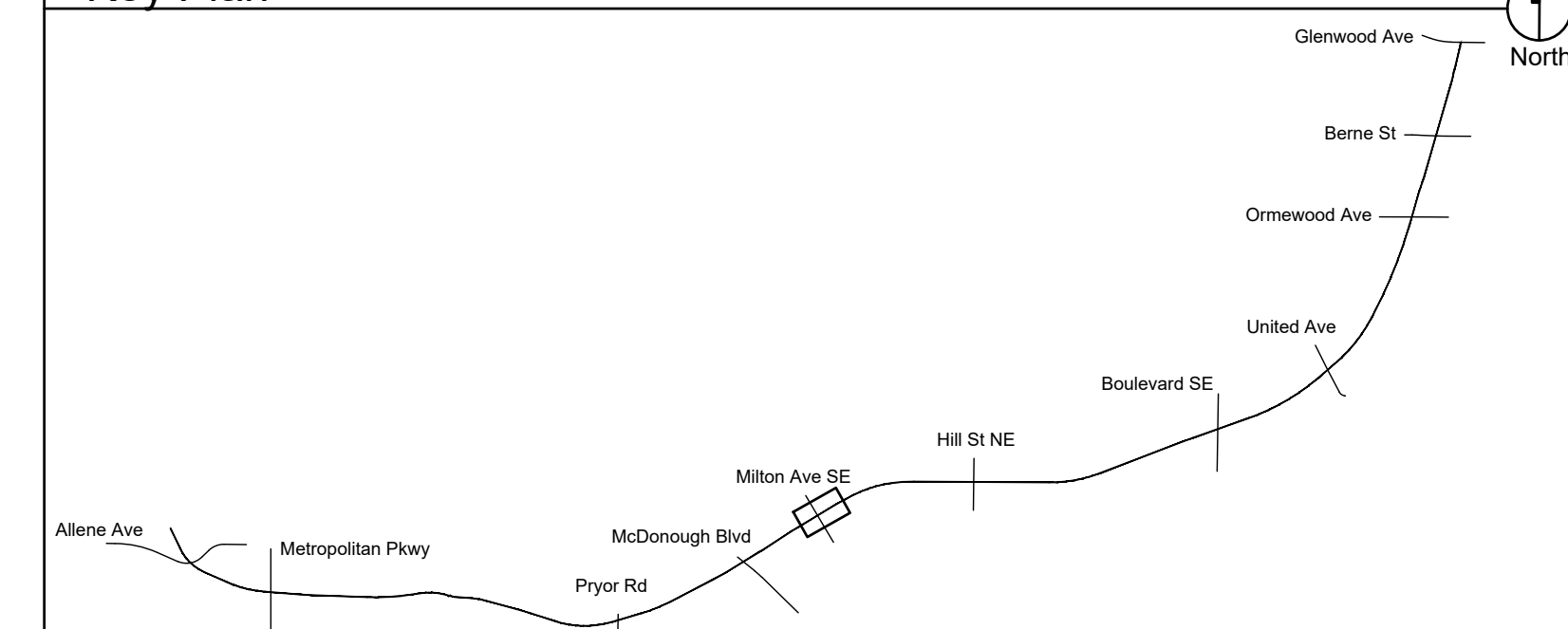

PROPERTY AND EXISTING R/W LINE
 REQUIRED R/W LINE
 CONSTRUCTION LIMITS
 PERMANENT EASEMENT FOR CONST. & MAINTENANCE OF SLOPES
 TEMPORARY EASEMENT FOR CONST. OF SLOPES
 TEMPORARY EASEMENT FOR CONST. OF DRIVES

**PROGRESS SET
 NFC**

Atlanta BeltLine, Inc.
 100 PEACHTREE STREET, NW
 SUITE 2300
 ATLANTA, GA 30303
 TEL: (404) 477-3003
 FAX: (404) 477-3606

Kimley-Horn and Associates, Inc.
 THE BILTMORE, SUITE 601
 817 WEST PEACHTREE STREET, NW
 ATLANTA, GEORGIA 30308
 TEL: (404) 419-8700

hedstrom
 LANDSCAPE ARCHITECTURE
 info@hedstromdesign.com
 www.hedstromdesign.com
 110 WEST MAGNOLIA AVE.
 KNOXVILLE, TN 37917
 OFFICE TEL: (865) 329-0012

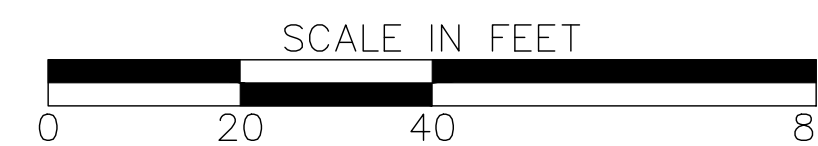

REVISION DATES

No.	Date	Description

PLANTING PLAN
 ATLANTA BELTLINE SOUTHSIDE TRAIL (SEGMENT 2)

CHECKED:	DATE:	DRAWING No.
BACKCHECKED:	DATE:	29-110
CORRECTED:	DATE:	
VERIFIED:	DATE:	