

REVISED	BY
2/7/22	GSF

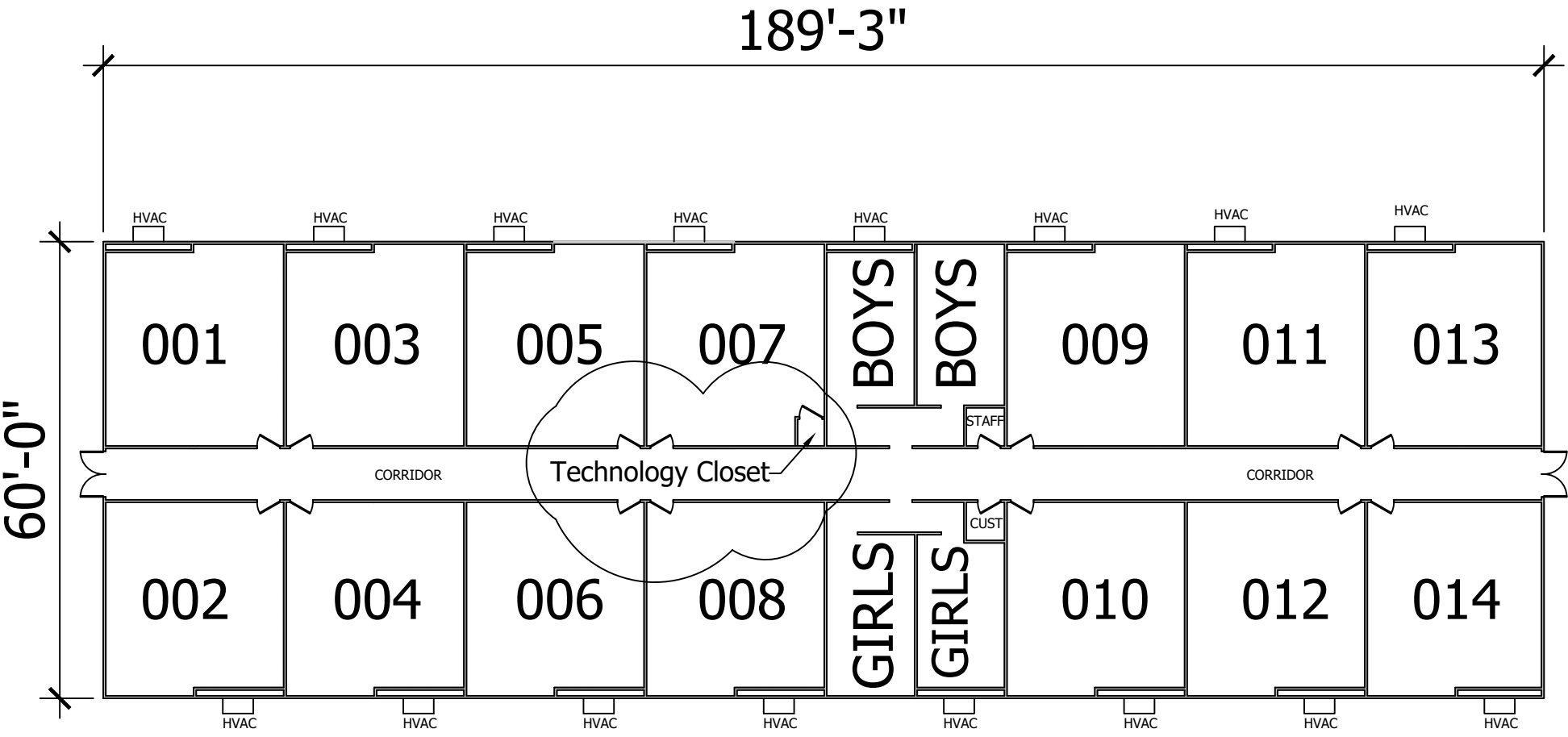

Example of a Multi-Plex

FAYETTE COUNTY SCHOOLS
 DIVISION OF MAINTENANCE
 461 Springhill Dr. Lexington, KY 40503



- Notes:
- Every classroom shall have
- 4'x8' marker board
 - 4'x8' tack board
 - Coat rack with shelves
 - Map rack above marker board
 - Pull down screen
 - Deck and ramp at each exterior entrance/exit

1 Multi-Plex Unit
 NTS

DRAWN	S. FITCH
CHECKED	
APPROVED	
DATE	9/1/16
PROJECT NUMBER	
SHEET	2
of 3	