

CITY OF BELLE MEADE, TENNESSEE

HARDING PLACE SIDEWALK PLAN, PHASE II

100% CONSTRUCTION DOCUMENTS / BID SET - JANUARY 15, 2021

HD# 20-2095

SHEET INDEX:

- L0.00 COVER SHEET
- L1.00 OVERALL SIDEWALK LAYOUT PLAN
- L1.01 SIDEWALK LAYOUT PLAN
- L1.02 SIDEWALK LAYOUT PLAN
- L1.03 SIDEWALK LAYOUT PLAN
- L1.04 SIDEWALK LAYOUT PLAN
- L1.05 DETAILS AND ENLARGEMENTS

COMMISSIONERS

JAMES V. HUNT, MAYOR
BOB WEIGEL, VICE MAYOR
CATHY ALTENBERN
BOYD BOGLE
GRAY O. THORNBURG

CITY MANAGER

BETH REARDON

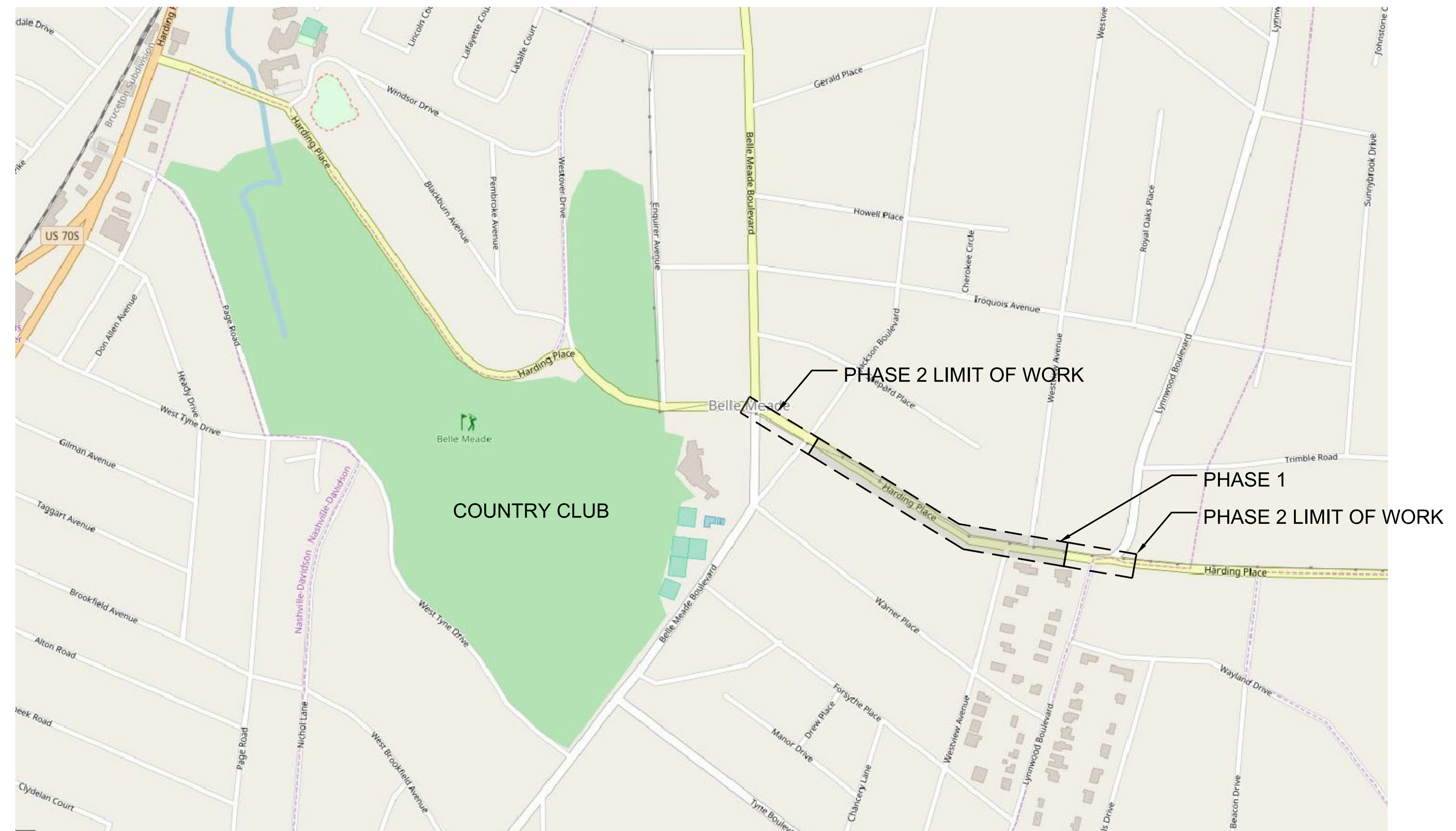

AREA MAP N.T.S.



NO. Date Issues/Revisions

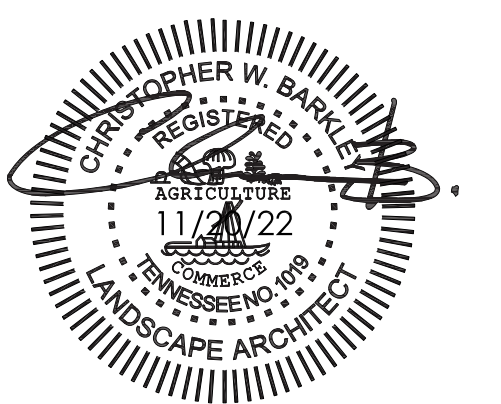

STAMP

NOT FOR
CONSTRUCTION-
FOR PRICING AND
FIELD REVIEW ONLY

PROJECT NAME
HARDING PLACE
SIDEWALK PLAN
PHASE II
BELLE MEADE,
TN

100% Construction Documents
Bid Set

PROJECT NO.: 202095
DRAWN BY: BH
CHECKED BY: CB

DRAWING TITLE

COVER SHEET

DATE: January 15, 2021
SCALE:

DRAWING NUMBER

L0.00

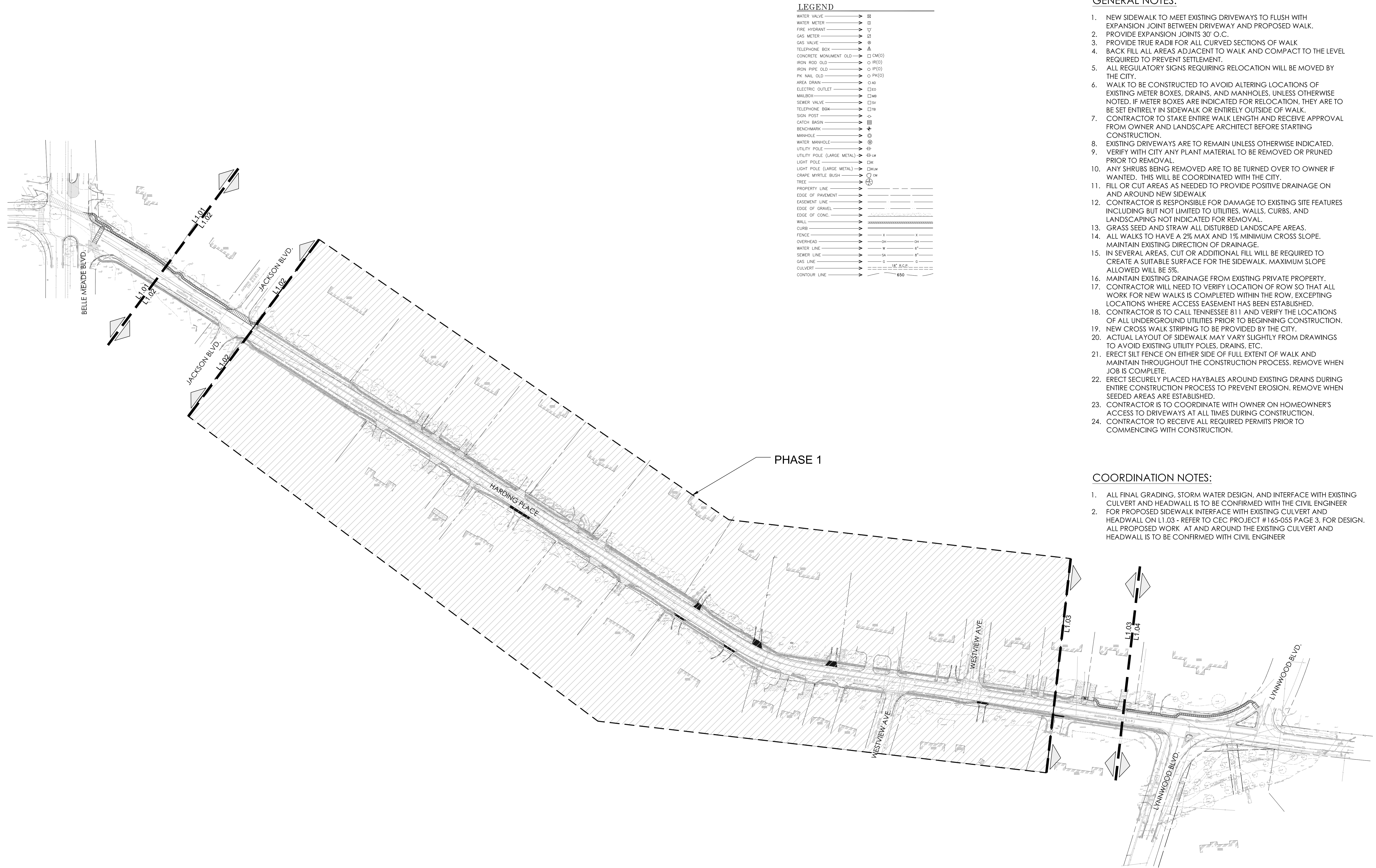

LEGEND

WATER VALVE	→	⊞
WATER METER	→	⊞
FIRE HYDRANT	→	⊞
GAS METER	→	⊞
GAS VALVE	→	⊞
TELEPHONE BOX	→	⊞
CONCRETE MONUMENT OLD	→	⊞
IRON ROD OLD	→	⊞
IRON PIPE OLD	→	⊞
PK NAIL OLD	→	⊞
AREA DRAIN	→	⊞
ELECTRIC OUTLET	→	⊞
MALIBOX	→	⊞
SEWER VALVE	→	⊞
TELEPHONE BOX	→	⊞
SIGN POST	→	⊞
CATCH BASIN	→	⊞
BENCHMARK	→	⊞
MANHOLE	→	⊞
WATER MANHOLE	→	⊞
UTILITY POLE	→	⊞
UTILITY POLE (LARGE METAL)	→	⊞
LIGHT POLE	→	⊞
LIGHT POLE (LARGE METAL)	→	⊞
GRAPE MYRTLE BUSH	→	⊞
TREE	→	⊞
PROPERTY LINE	→	⊞
EDGE OF PAVEMENT	→	⊞
EASEMENT LINE	→	⊞
EDGE OF GRAVEL	→	⊞
EDGE OF CONC.	→	⊞
WALL	→	⊞
CURB	→	⊞
FENCE	→	⊞
OVERHEAD	→	⊞
WATER LINE	→	⊞
SEWER LINE	→	⊞
GAS LINE	→	⊞
CULVERT	→	⊞
CONTOUR LINE	→	⊞

- GENERAL NOTES:**
1. NEW SIDEWALK TO MEET EXISTING DRIVEWAYS TO FLUSH WITH EXPANSION JOINT BETWEEN DRIVEWAY AND PROPOSED WALK.
 2. PROVIDE EXPANSION JOINTS 30' O.C.
 3. PROVIDE TRUE RADI FOR ALL CURVED SECTIONS OF WALK
 4. BACK FILL ALL AREAS ADJACENT TO WALK AND COMPACT TO THE LEVEL REQUIRED TO PREVENT SETTLEMENT.
 5. ALL REGULATORY SIGNS REQUIRING RELOCATION WILL BE MOVED BY THE CITY.
 6. WALK TO BE CONSTRUCTED TO AVOID ALTERING LOCATIONS OF EXISTING METER BOXES, DRAINS, AND MANHOLES. UNLESS OTHERWISE NOTED, IF METER BOXES ARE INDICATED FOR RELOCATION, THEY ARE TO BE SET ENTIRELY IN SIDEWALK OR ENTIRELY OUTSIDE OF WALK.
 7. CONTRACTOR TO STAKE ENTIRE WALK LENGTH AND RECEIVE APPROVAL FROM OWNER AND LANDSCAPE ARCHITECT BEFORE STARTING CONSTRUCTION.
 8. EXISTING DRIVEWAYS ARE TO REMAIN UNLESS OTHERWISE INDICATED.
 9. VERIFY WITH CITY ANY PLANT MATERIAL TO BE REMOVED OR PRUNED PRIOR TO REMOVAL.
 10. ANY SHRUBS BEING REMOVED ARE TO BE TURNED OVER TO OWNER IF WANTED, THIS WILL BE COORDINATED WITH THE CITY.
 11. FILL OR CUT AREAS AS NEEDED TO PROVIDE POSITIVE DRAINAGE ON AND AROUND NEW SIDEWALK
 12. CONTRACTOR IS RESPONSIBLE FOR DAMAGE TO EXISTING SITE FEATURES INCLUDING BUT NOT LIMITED TO UTILITIES, WALLS, CURBS, AND LANDSCAPING NOT INDICATED FOR REMOVAL.
 13. GRASS SEED AND STRAW ALL DISTURBED LANDSCAPE AREAS.
 14. ALL WALKS TO HAVE A 2% MAX AND 1% MINIMUM CROSS SLOPE. MAINTAIN EXISTING DIRECTION OF DRAINAGE.
 15. IN SEVERAL AREAS, CUT OR ADDITIONAL FILL WILL BE REQUIRED TO CREATE A SUITABLE SURFACE FOR THE SIDEWALK. MAXIMUM SLOPE ALLOWED WILL BE 5%.
 16. MAINTAIN EXISTING DRAINAGE FROM EXISTING PRIVATE PROPERTY. CONTRACTOR WILL NEED TO VERIFY LOCATION OF ROW SO THAT ALL WORK FOR NEW WALKS IS COMPLETED WITHIN THE ROW. EXCEPTING LOCATIONS WHERE ACCESS EASEMENT HAS BEEN ESTABLISHED.
 18. CONTRACTOR IS TO CALL TENNESSEE 811 AND VERIFY THE LOCATIONS OF ALL UNDERGROUND UTILITIES PRIOR TO BEGINNING CONSTRUCTION.
 19. NEW CROSS WALK STRIPING TO BE PROVIDED BY THE CITY.
 20. ACTUAL LAYOUT OF SIDEWALK MAY VARY SLIGHTLY FROM DRAWINGS TO AVOID EXISTING UTILITY POLES, DRAINS, ETC.
 21. ERECT SILT FENCE ON EITHER SIDE OF FULL EXTENT OF WALK AND MAINTAIN THROUGHOUT THE CONSTRUCTION PROCESS. REMOVE WHEN JOB IS COMPLETE.
 22. ERECT SECURELY PLACED HAYBALES AROUND EXISTING DRAINS DURING ENTIRE CONSTRUCTION PROCESS TO PREVENT EROSION. REMOVE WHEN SEEDED AREAS ARE ESTABLISHED.
 23. CONTRACTOR IS TO COORDINATE WITH OWNER ON HOMEOWNER'S ACCESS TO DRIVEWAYS AT ALL TIMES DURING CONSTRUCTION.
 24. CONTRACTOR TO RECEIVE ALL REQUIRED PERMITS PRIOR TO COMMENCING WITH CONSTRUCTION.

- COORDINATION NOTES:**
1. ALL FINAL GRADING, STORM WATER DESIGN, AND INTERFACE WITH EXISTING CULVERT AND HEADWALL IS TO BE CONFIRMED WITH THE CIVIL ENGINEER
 2. FOR PROPOSED SIDEWALK INTERFACE WITH EXISTING CULVERT AND HEADWALL ON L1.03 - REFER TO CEC PROJECT #165-055 PAGE 3, FOR DESIGN. ALL PROPOSED WORK AT AND AROUND THE EXISTING CULVERT AND HEADWALL IS TO BE CONFIRMED WITH CIVIL ENGINEER

NO.	Date	Issues/Revisions

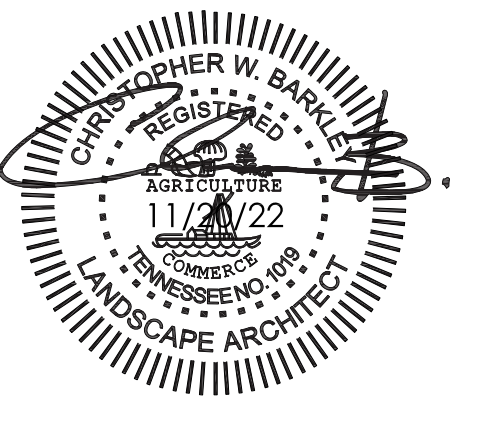

NOT FOR CONSTRUCTION- FOR PRICING AND FIELD REVIEW ONLY

PROJECT NAME
**HARDING PLACE
SIDEWALK PLAN
PHASE II**
BELLE MEADE,
TN

100% Construction Documents
Bid Set

PROJECT NO.: 202095
DRAWN BY: BH
CHECKED BY: CB

DRAWING TITLE
**OVERALL
SIDEWALK
LAYOUT PLAN**

DATE: January 15, 2021
SCALE:

DRAWING NUMBER

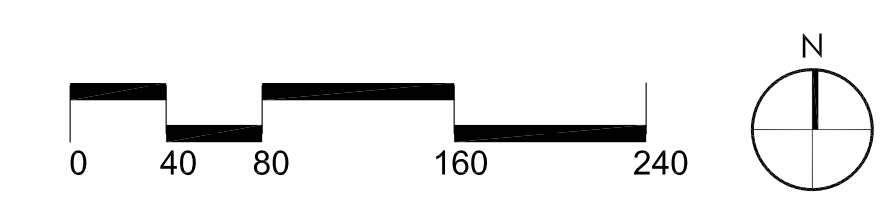

L1.00

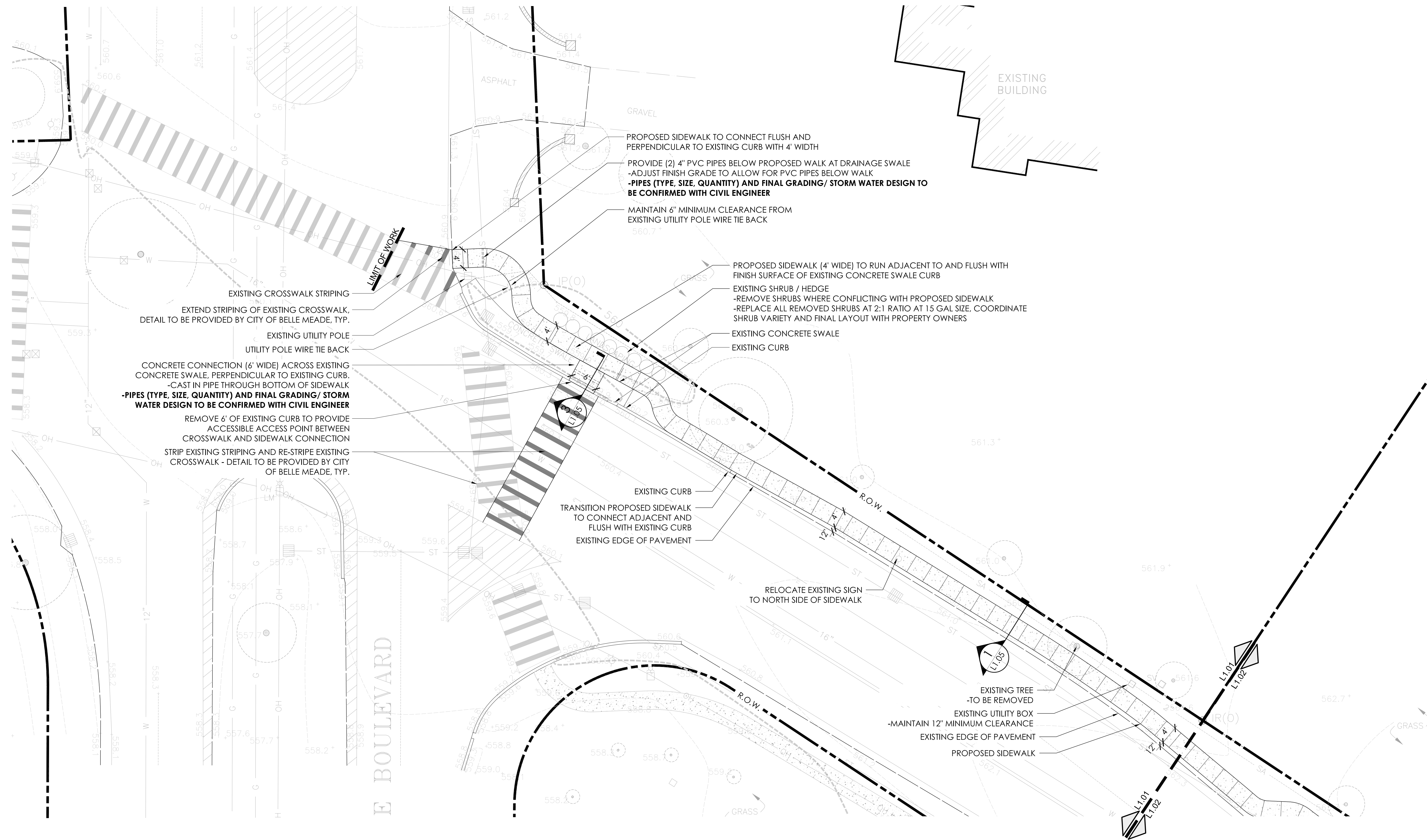

HARDSCAPE LEGEND

	PROPOSED SIDEWALK
	PROPOSED CROSSWALK TO BE PROVIDED BY CITY OF BELLE MEADE
	ALIGN PAVING EDGES

LEGEND

	WATER VALVE	WV
	WATER METER	WM
	FIRE HYDRANT	FH
	GAS METER	GM
	GAS VALVE	GV
	TELEPHONE BOX	TB
	CONCRETE MONUMENT OLD	CM(O)
	IRON ROD OLD	IR(O)
	IRON PIPE OLD	IP(O)
	PK NAIL OLD	PN(O)
	AREA DRAIN	AD
	ELECTRIC OUTLET	EO
	MANHOLE	MH
	SEWER VALVE	SV
	TELEPHONE BOX	TB
	SIGN POST	SP
	CATCH BASIN	CB
	BENCHMARK	BM
	MANHOLE	MH
	WATER MANHOLE	WMH
	UTILITY POLE	UP
	UTILITY POLE (LARGE METAL)	UP(LM)
	LIGHT POLE	LP
	LIGHT POLE (LARGE METAL)	LP(LM)
	CRAPE MYRTLE BUSH	CM
	PROPERTY LINE	PL
	EDGE OF PAVEMENT	EP
	EASEMENT LINE	EL
	EDGE OF GRAVEL	EG
	EDGE OF CONC.	EC
	WALL	W
	CURB	C
	FENCE	F
	OVERHEAD	OH
	WATER LINE	W
	SEWER LINE	SA
	GAS LINE	G
	CULVERT	HC, S.C.P.
	CONTOUR LINE	CL

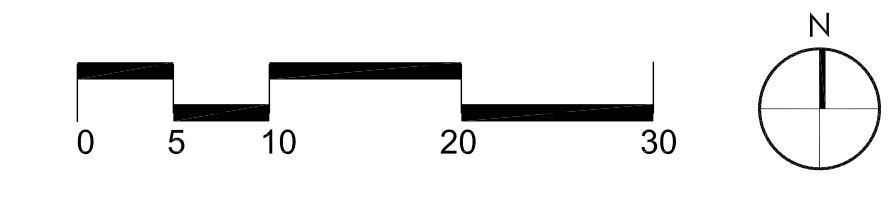

NO.	Date	Issues/Revisions
-----	------	------------------

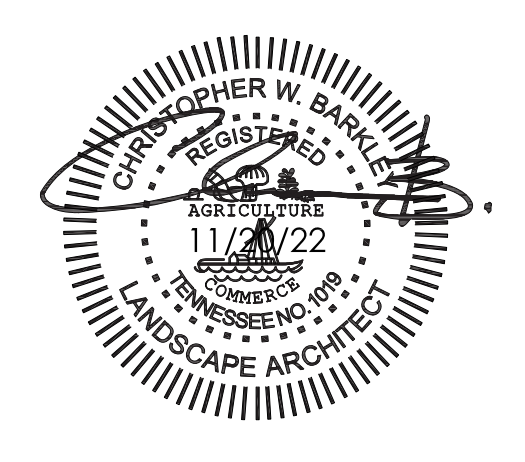

STAMP

NOT FOR CONSTRUCTION-
 FOR PRICING AND
 FIELD REVIEW ONLY

PROJECT NAME
**HARDING PLACE
 SIDEWALK PLAN
 PHASE II**
 BELLE MEADE,
 TN

100% Construction Documents Bid Set

PROJECT NO.: 202095
 DRAWN BY: BH
 CHECKED BY: CB

DRAWING TITLE

**SIDEWALK
 LAYOUT PLAN**

DATE: January 15, 2021
 SCALE:

DRAWING NUMBER

L1.01

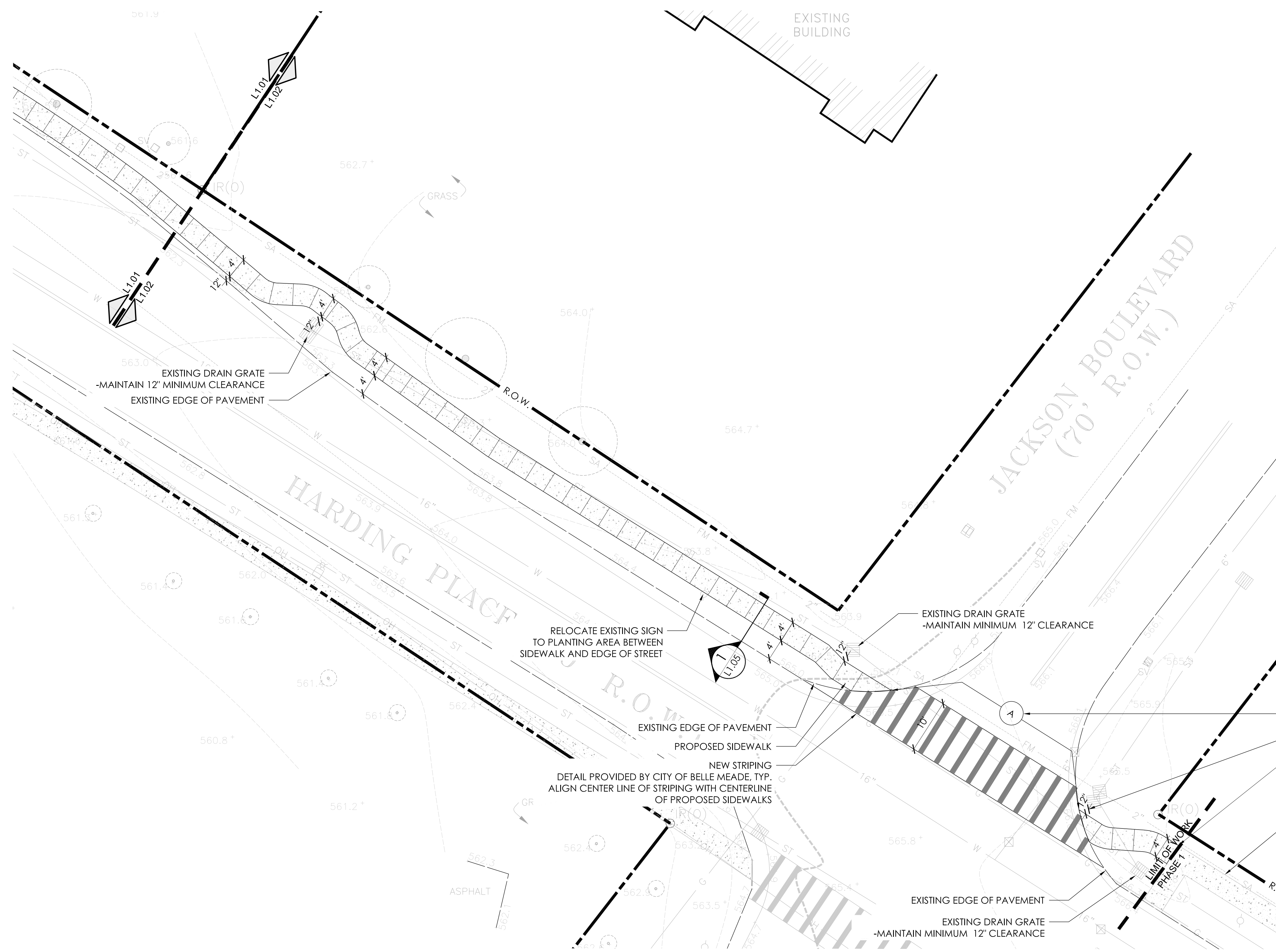

ALIGN SIDEWALKS CONNECTIONS ACROSS EXISTING INTERSECTION
- TYPICAL AT ALL INTERSECTION OR DRIVEWAY CROSSINGS

EXISTING DRAIN GRATE
- MAINTAIN MINIMUM 12" CLEARANCE

BEGIN PHASE 2 SIDEWALK
- ALIGN FINISH SURFACE FLUSH AND OUTSIDE EDGES OF SIDEWALK CONNECTION WITH PHASE I
- PROVIDE DOWELED CONSTRUCTION JOINT BETWEEN PROPOSED AND EXISTING SIDEWALKS

PHASE I SIDEWALK
- VERIFY LOCATION IN THE FIELD

HARDSCAPE LEGEND

	PROPOSED SIDEWALK
	PROPOSED CROSSWALK TO BE PROVIDED BY CITY OF BELLE MEADE
	ALIGN PAVING EDGES

LEGEND

WATER VALVE	→	□
WATER METER	→	□
FIRE HYDRANT	→	▽
GAS METER	→	□
GAS VALVE	→	⊙
TELEPHONE BOX	→	△
CONCRETE MONUMENT OLD	→	□ CM(O)
IRON ROD OLD	→	○ IR(O)
IRON PIPE OLD	→	○ IP(O)
PK NAIL OLD	→	○ PK(O)
AREA DRAIN	→	○ AD
ELECTRIC OUTLET	→	□ EO
MAILBOX	→	□ MB
SEWER VALVE	→	□ SV
TELEPHONE BOX	→	□ TB
SIGN POST	→	○
CATCH BASIN	→	□
BENCHMARK	→	+
MANHOLE	→	○
WATER MANHOLE	→	⊙
UTILITY POLE	→	⊕
UTILITY POLE (LARGE METAL)	→	⊕ LM
LIGHT POLE	→	⊕
LIGHT POLE (LARGE METAL)	→	⊕ LM
CRAPPE MYRTLE BUSH	→	○ CM
TREE	→	⊕
PROPERTY LINE	→	---
EDGE OF PAVEMENT	→	---
EASEMENT LINE	→	---
EDGE OF GRAVEL	→	---
EDGE OF CONC.	→	---
WALL	→	---
CURB	→	---
FENCE	→	---
OVERHEAD	→	---
WATER LINE	→	---
SEWER LINE	→	---
GAS LINE	→	---
CONTOUR LINE	→	---

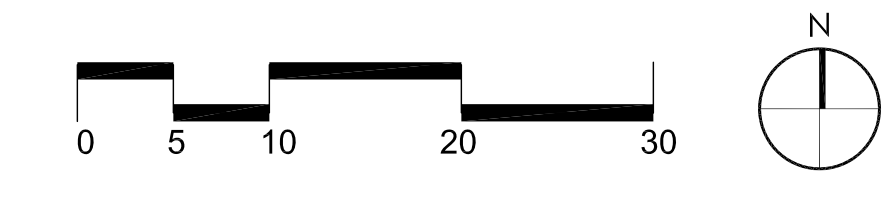

NO.	Date	Issues/Revisions
-----	------	------------------

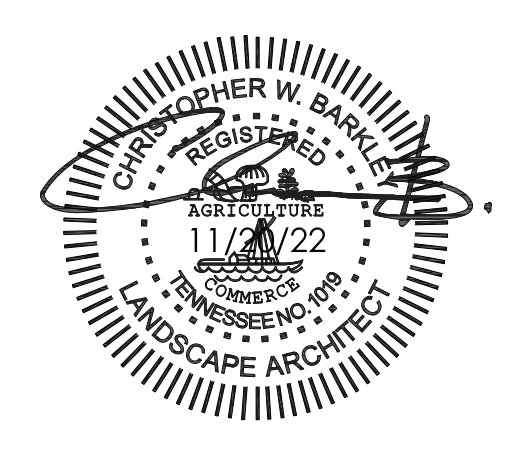

STAMP

NOT FOR CONSTRUCTION- FOR PRICING AND FIELD REVIEW ONLY

PROJECT NAME
HARDING PLACE SIDEWALK PLAN PHASE II
BELLE MEADE, TN

100% Construction Documents Bid Set

PROJECT NO.: 202095
DRAWN BY: BH
CHECKED BY: CB

DRAWING TITLE

SIDEWALK LAYOUT PLAN

DATE: January 15, 2021
SCALE:

DRAWING NUMBER

L1.02

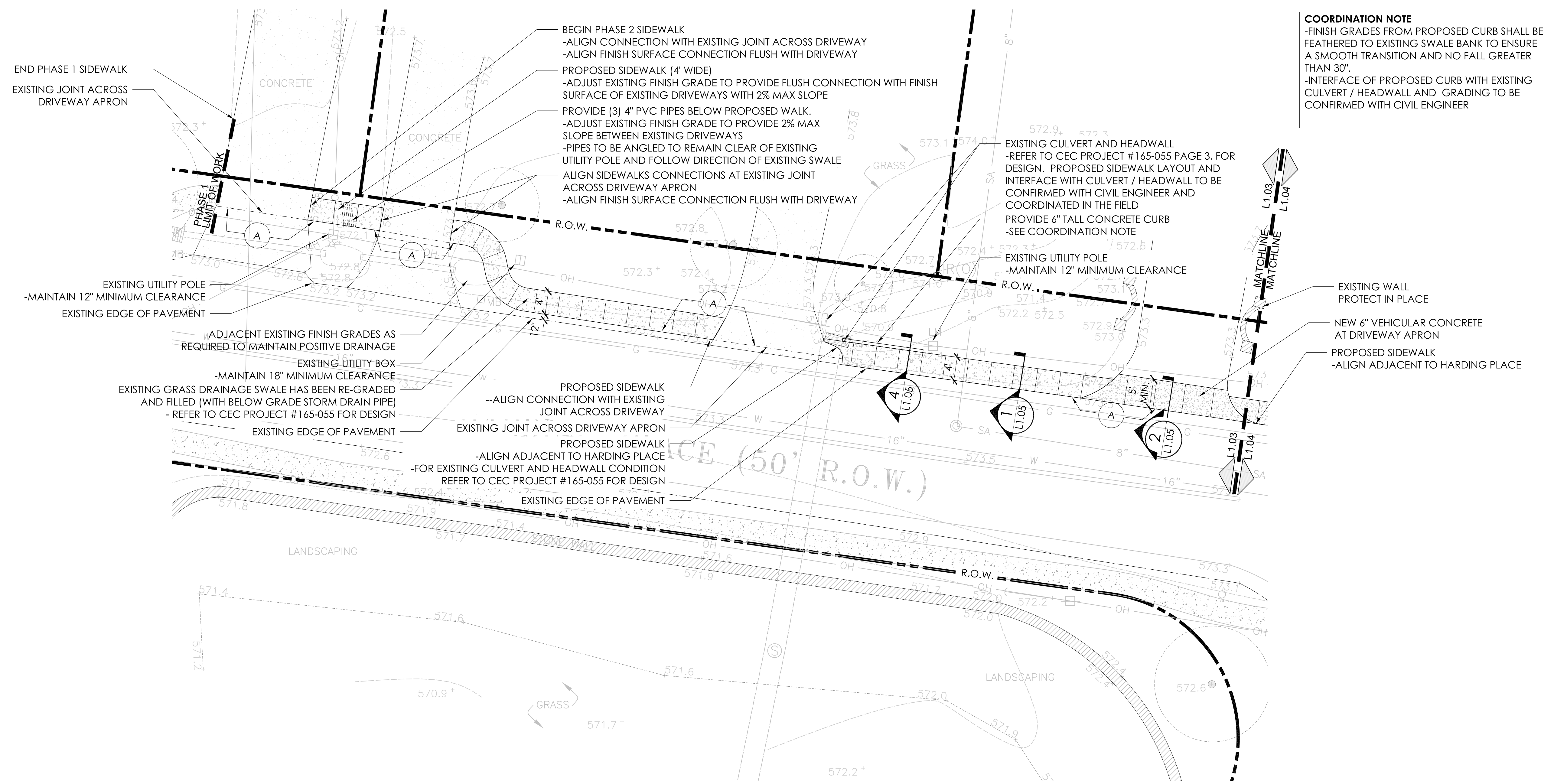

HARDSCAPE LEGEND

	PROPOSED SIDEWALK
	PROPOSED CROSSWALK TO BE PROVIDED BY CITY OF BELLE MEADE
	ALIGN PAVING EDGES

LEGEND

	WATER VALVE	WB
	WATER METER	WM
	FIRE HYDRANT	FD
	GAS METER	GM
	GAS VALVE	GV
	TELEPHONE BOX	TB
	CONCRETE MONUMENT OLD	CM(O)
	IRON ROD OLD	IR(O)
	IRON PIPE OLD	IP(O)
	PK NAIL OLD	PN(O)
	AREA DRAIN	AD
	ELECTRIC OUTLET	EO
	MANHOLE	MB
	SEWER VALVE	SV
	TELEPHONE BOX	TB
	SIGN POST	SP
	CATCH BASIN	CB
	BENCHMARK	BM
	MANHOLE	MB
	WATER MANHOLE	WM
	UTILITY POLE	UP
	UTILITY POLE (LARGE METAL)	UP-LM
	LIGHT POLE	LP
	LIGHT POLE (LARGE METAL)	LP-LM
	CRAPE MYRTLE BUSH	CM
	TREE	T
	PROPERTY LINE	PL
	EDGE OF PAVEMENT	EP
	EASEMENT LINE	EL
	EDGE OF GRAVEL	EG
	WALL	W
	CURB	C
	FENCE	F
	OVERHEAD	OH
	WATER LINE	WL
	SEWER LINE	SL
	GAS LINE	GL
	CULVERT	CU
	CONTOUR LINE	CL

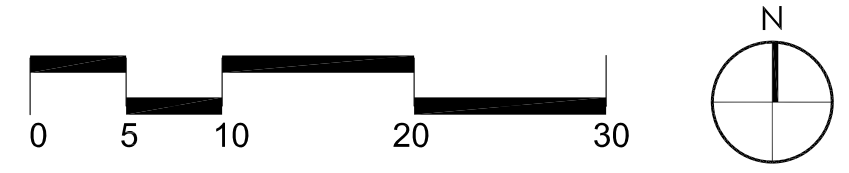

NO. Date Issues/Revisions

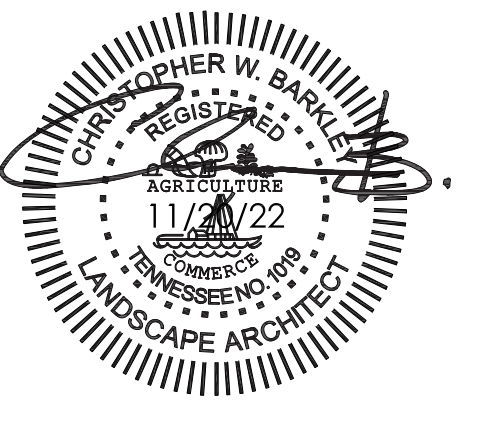

STAMP

NOT FOR CONSTRUCTION- FOR PRICING AND FIELD REVIEW ONLY

HARDING PLACE SIDEWALK PLAN PHASE II BELLE MEADE, TN

100% Construction Documents Bid Set

PROJECT NO.: 202095
 DRAWN BY: BH
 CHECKED BY: CB

SIDEWALK LAYOUT PLAN

DATE: January 15, 2021
 SCALE:

DRAWING NUMBER

L1.03

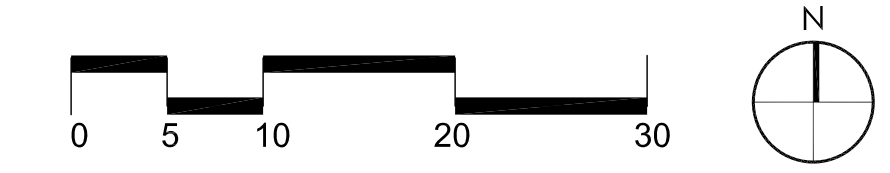
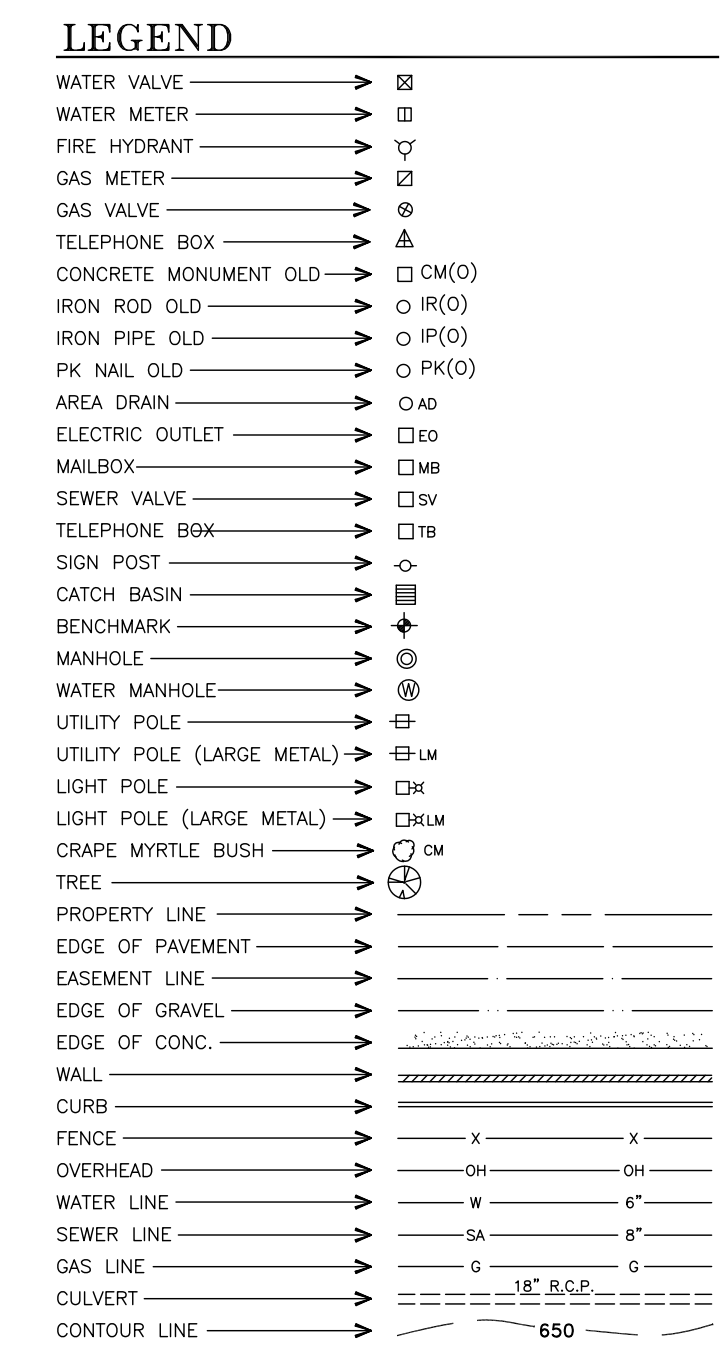
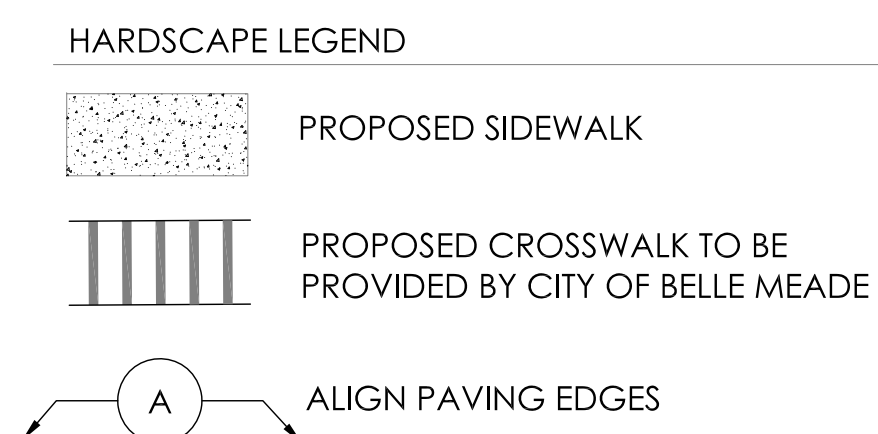
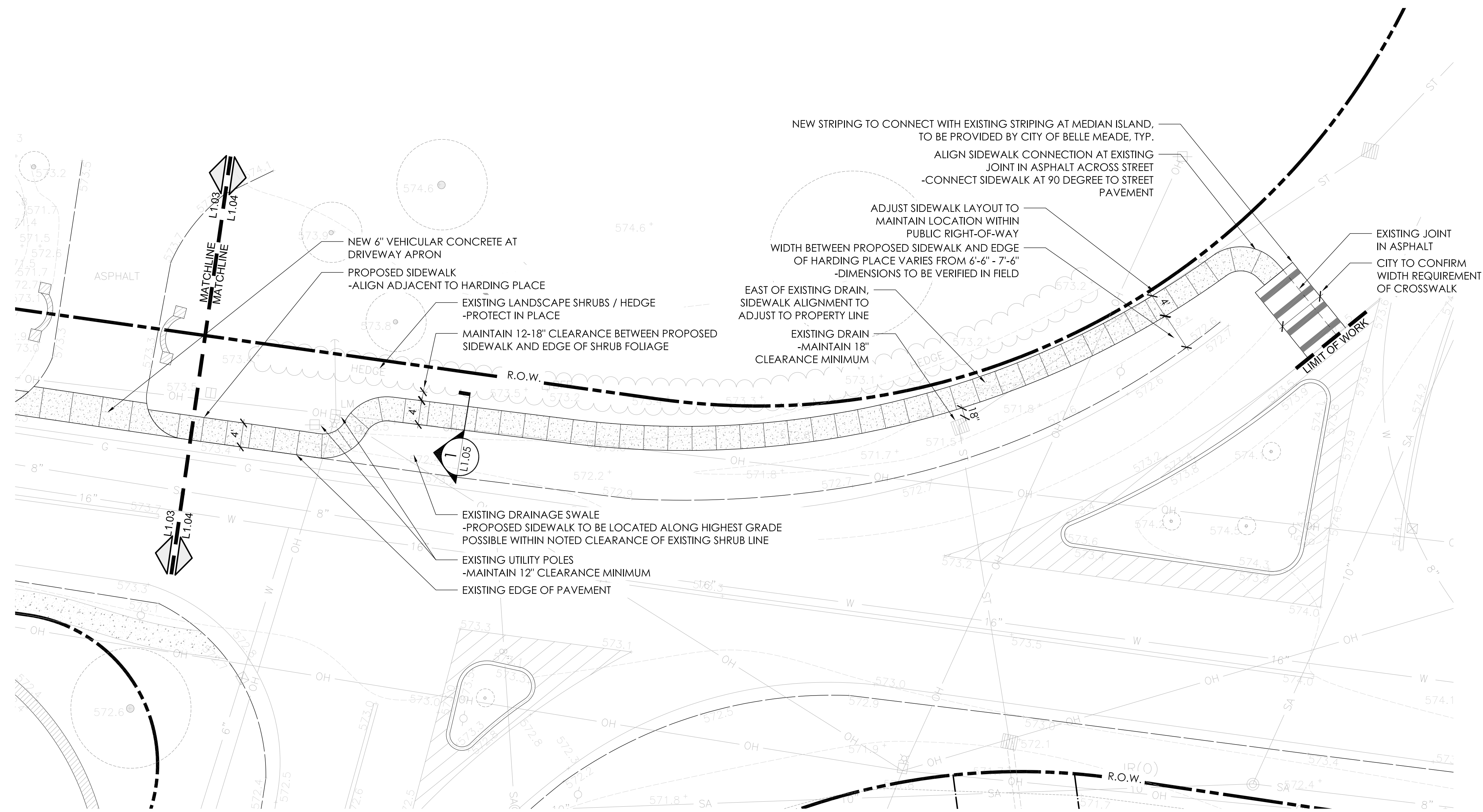

NO.	Date	Issues/Revisions

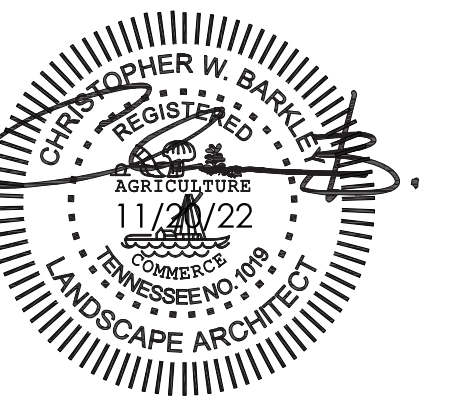

STAMP

NOT FOR CONSTRUCTION-
 FOR PRICING AND FIELD REVIEW ONLY

PROJECT NAME
HARDING PLACE SIDEWALK PLAN
PHASE II
 BELLE MEADE, TN

100% Construction Documents Bid Set

PROJECT NO.: 202095
 DRAWN BY: BH
 CHECKED BY: CB

DRAWING TITLE
SIDEWALK LAYOUT PLAN

DATE: January 15, 2021
 SCALE:

DRAWING NUMBER

L1.04

NOTE:

- CONTRACTOR TO PROVIDE 3'X3' MOCKUP (IN PLACE) FOR APPROVAL BY LANDSCAPE ARCHITECT PRIOR TO START OF CONSTRUCTION
- ANY PROPOSED SURFACE FOR VEHICULAR USE - REFER TO DETAIL 2, VEHICULAR CONCRETE

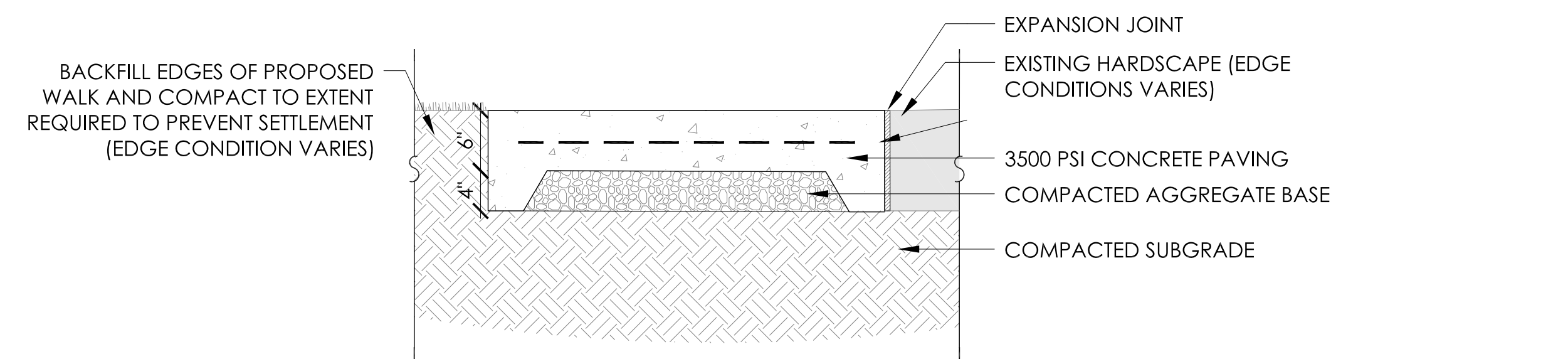

2 6" CONCRETE - VEHICULAR
1"=1'

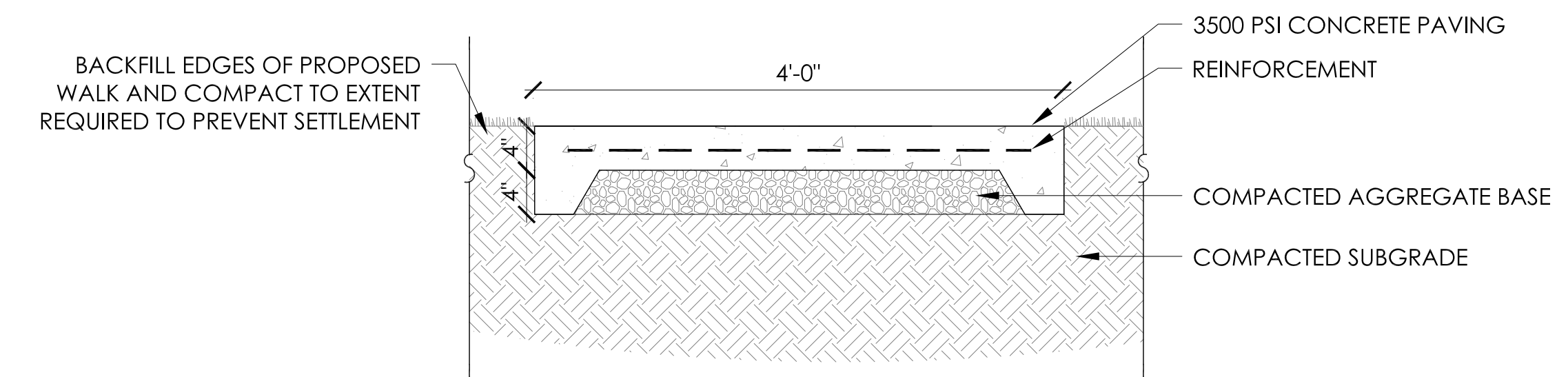

1 4" CONCRETE - PEDESTRIAN
1"=1'

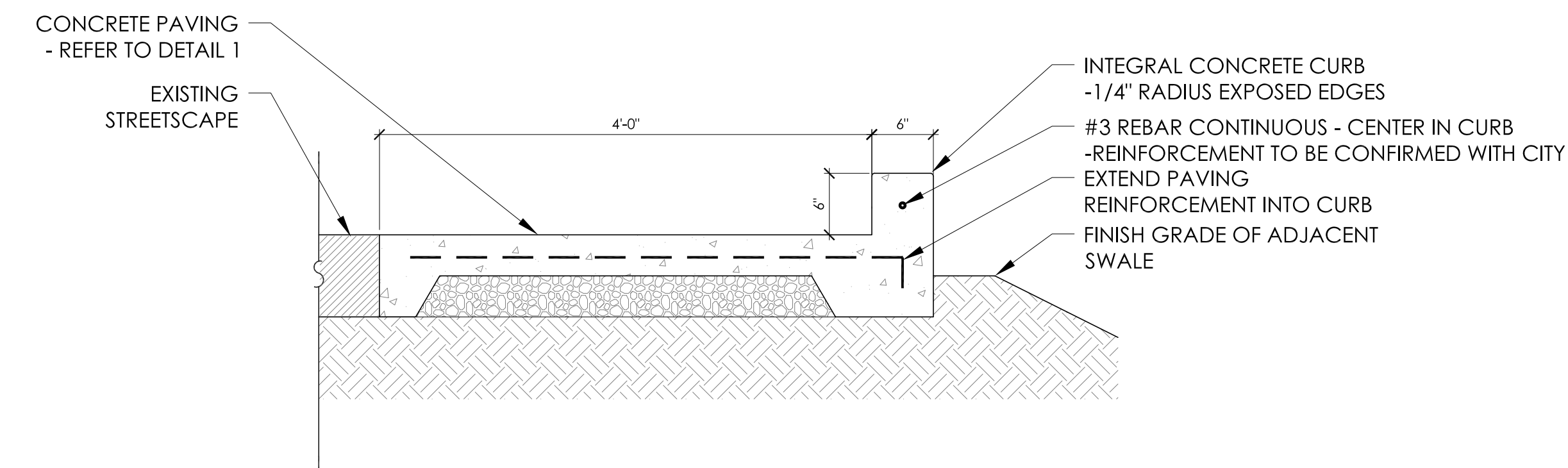

4 6" CONCRETE CURB
1"=1'

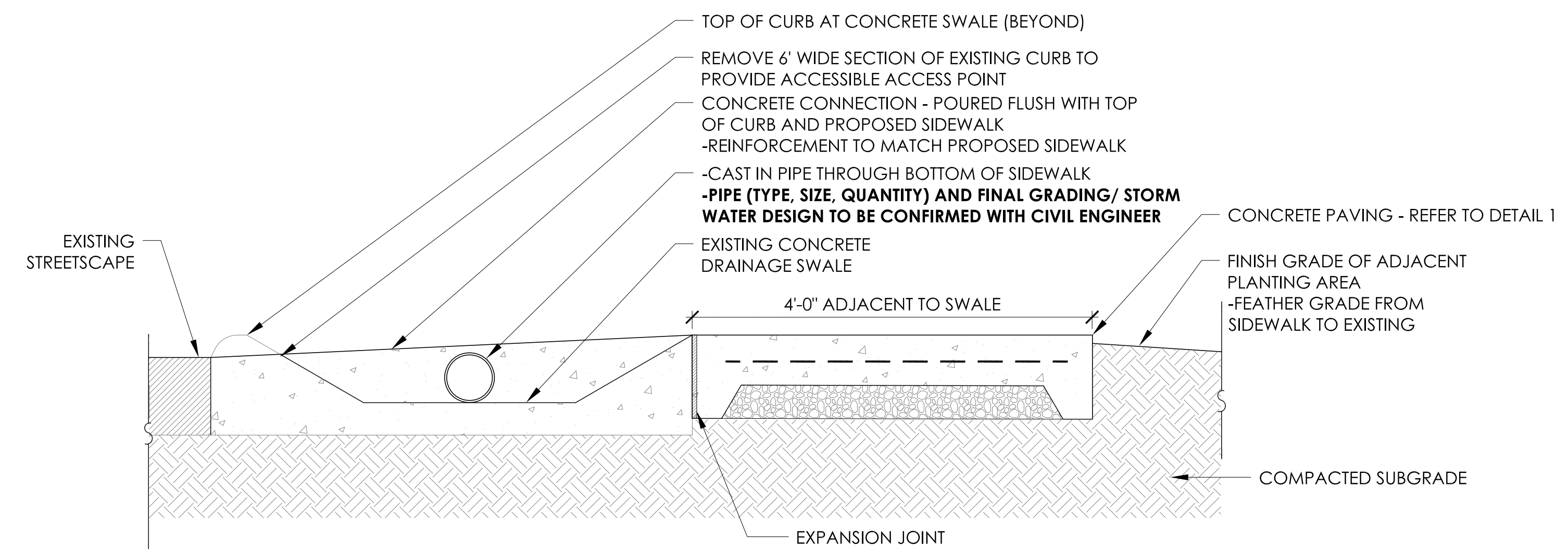

3 CONCRETE CONNECTION - AT EXISTING CONCRETE SWALE
1"=1'

NO.	Date	Issues/Revisions

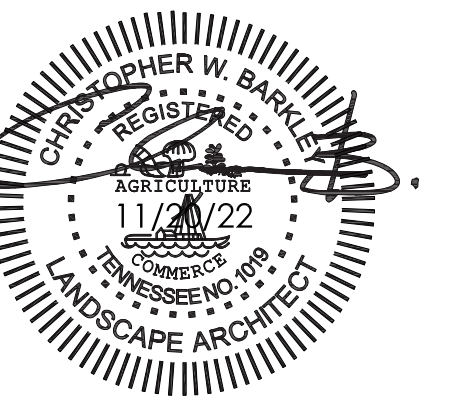

STAMP

NOT FOR CONSTRUCTION- FOR PRICING AND FIELD REVIEW ONLY

PROJECT NAME
HARDING PLACE SIDEWALK PLAN PHASE II
 BELLE MEADE, TN

100% Construction Documents Bid Set

PROJECT NO.: 202095
 DRAWN BY: BH
 CHECKED BY: CB

DRAWING TITLE

DETAILS AND ENLARGEMENTS

DATE: January 15, 2021
 SCALE:

DRAWING NUMBER

L1.05