

BINDING EDGE

BINDING EDGE

BINDING EDGE

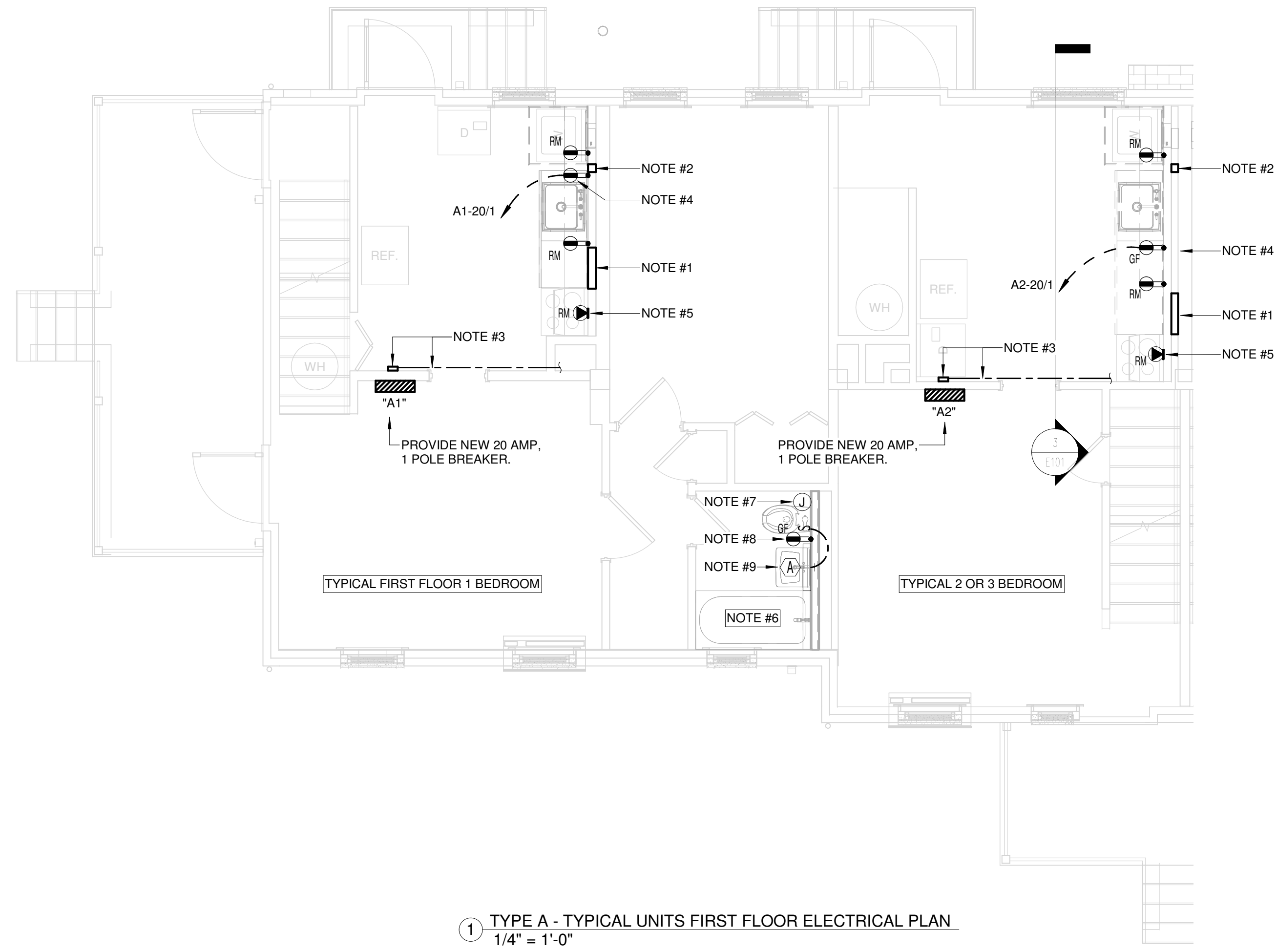

① TYPE A - TYPICAL UNITS FIRST FLOOR ELECTRICAL PLAN  
1/4" = 1'-0"

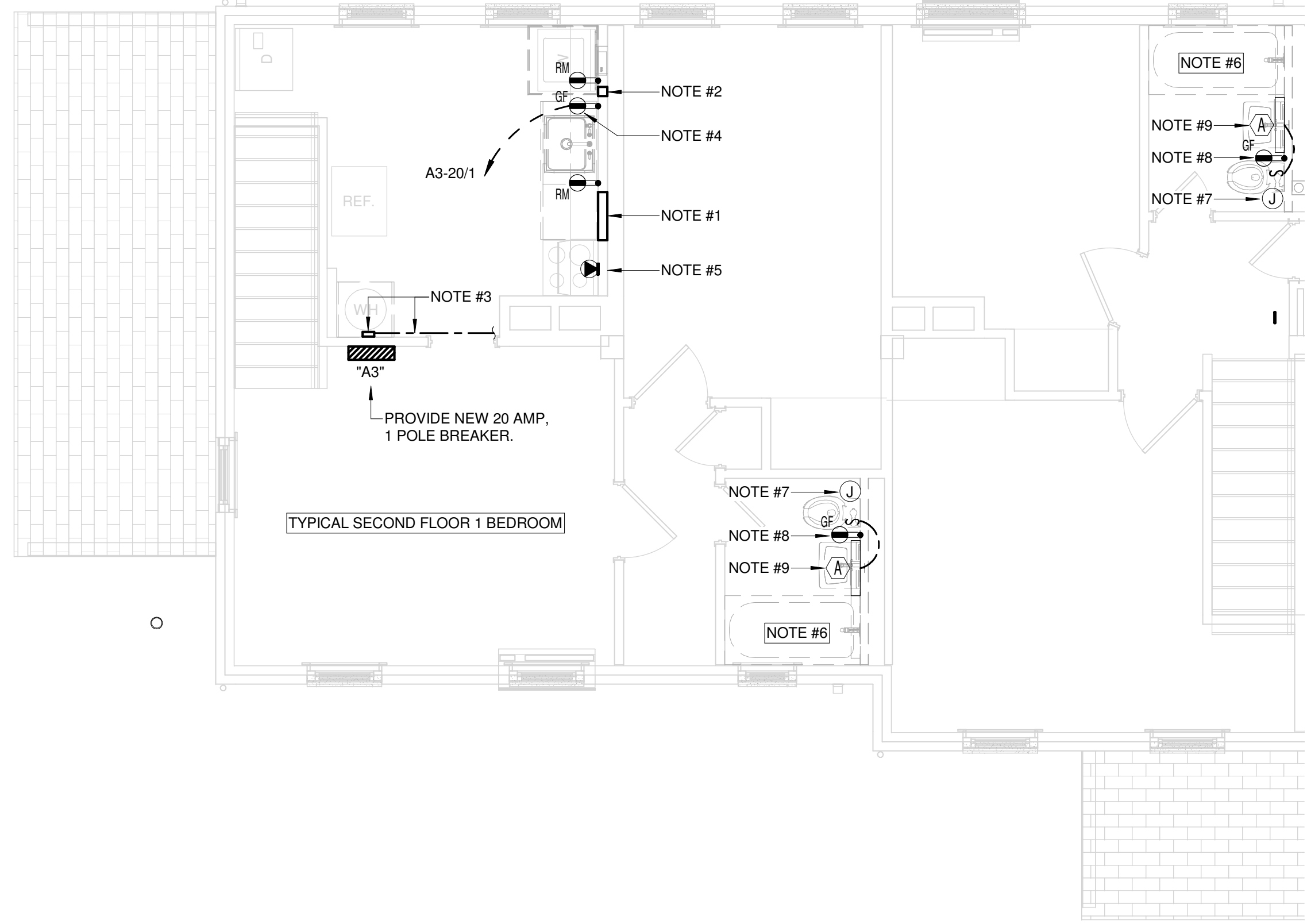

② TYPE A - TYPICAL UNITS SECOND FLOOR ELECTRICAL PLAN  
1/4" = 1'-0"

### LEGEND

SYMBOL	DESCRIPTION
[Symbol]	EXISTING PANELBOARD
--- --- --- A-1	HOME RUN TO PANEL WITH CIRCUIT SHOWN, CROSS MARKS INDICATE NUMBER OF CONDUCTORS WHERE MORE THAN TWO, NOT INCLUDING GROUND, MINIMUM #12 AWG.
--- --- ---	OVERHEAD WIRING
--- --- ---	UNDERGROUND WIRING
(A)	EXISTING TO BE REUSED, CLEAN AND RELAMP
S <sub>1</sub>	LIGHT SWITCH, TOGGLE, 20 AMP, 277V, MTD #F AFF, UNO. 'Y' CORRESPONDS TO FIXTURES CONTROLLED BY SWITCH
•	20A, 120V, 2 POLE, 3 WIRE, GROUNDING DUPLEX RECEPTACLE MTD, 42" AFF, UNO.
▼	EXISTING 208 VOLT, SINGLE-PHASE RECEPTACLE, NEMA 14-50R.
[RH]	RANGE HOOD

### ELECTRICAL ABBREVIATIONS

ABBREVIATIONS	DESCRIPTION
AFF	ABOVE FINISHED FLOOR - MEASURED FROM FLOOR TO CENTER OF DEVICE, EXCEPT AS OTHERWISE SPECIFICALLY NOTED.
AMP	AMPERE
ADA	AMERICANS WITH DISABILITIES ACT OF 1990
AFG	ABOVE FINISH GRADE
C	CONDUIT
CM	INDICATES DEVICE TO BE CEILING MOUNTED
F	FUSE
FPN	FUSE PER NAMEPLATE REQUIREMENTS
G	GROUND
GF	INDICATES RECEPTACLE OR CIRCUIT BREAKER, AS APPLICABLE, TO HAVE GROUND FAULT PROTECTION
MCM	Kcmil (THOUSAND CIRCULAR MILS)
NEC	NATIONAL ELECTRICAL CODE
N	NEUTRAL
PH	PHASE
RL	INDICATES FIXTURE TO BE EQUIPPED WITH QUARTZ RESTRIKE, PROVIDE TIME DELAY MODULE
R/LD	RELOCATED SHOWN AT FINAL LOCATION
RM	INDICATES DEVICE IS EXISTING TO REMAIN
RV	INDICATES DEVICE TO BE REMOVED
UND	UNLESS NOTED OTHERWISE
WP	INDICATES DEVICE TO HAVE WEATHERPROOF COVER

- #### GENERAL ELECTRICAL NOTES:
1. THE CONTRACTOR SHALL VISIT THE JOB SITE AND CAREFULLY EXAMINE THOSE PORTIONS OF THE SITE AFFECTED BY THIS WORK SO AS TO BECOME FAMILIAR WITH EXISTING CONDITIONS THAT WILL AFFECT EXECUTION OF THE WORK.
  2. THE CONTRACTOR IS RESPONSIBLE FOR OBTAINING ALL NECESSARY PERMITS AND PAYING ALL UTILITY CO. AND TO CONSTRUCTION FEES.
  3. ALL WORK SHALL BE IN ACCORDANCE WITH THE CURRENT APPLICABLE NATIONAL ELECTRICAL CODE, NFPA 70, LOCAL CODES ORDINANCES AND THE APPLICABLE ACCESSIBILITY CODE. SHOULD PLANS AND CODES CONFLICT, THE CODE TAKES PRECEDENCE, MAKE NO CHANGES, EVEN IN THE CASE OF CONFLICT, WITHOUT FIRST OBTAINING APPROVAL OF THE ARCHITECT/ENGINEER.
  4. 'PROVIDE' AS USED HERE AND ON THE DRAWINGS, IS AN ALL INCLUSIVE TERM REQUIRING CONTRACTOR TO FURNISH, INSTALL, WIRE AND CONNECT ALL SPECIFIED EQUIPMENT AS WELL AS COMPONENTS, ACCESSORIES, AND MOUNTING HARDWARE TO INSURE THAT SPECIFIED EQUIPMENT FUNCTIONS TO MEET SYSTEM REQUIREMENTS.
  5. IT SHALL BE THE RESPONSIBILITY OF THE CONTRACTOR TO PROTECT OTHER FACILITIES AND EQUIPMENT FROM DAMAGE. THE CONTRACTOR SHALL BEAR ALL EXPENSE FOR REPAIR OR REPLACEMENT OF FACILITIES, EQUIPMENT, OR OTHER PROPERTY DAMAGED BY OPERATIONS IN CONJUNCTION WITH THE COMPLETION OF THIS WORK. ELECTRICAL CONTRACTOR SHALL GIVE ADEQUATE NOTIFICATION TO TENNESSEE ONE CALL, (800) 951-1111, PRIOR TO COMMENCEMENT OF ANY EXCAVATION.
  6. PROVIDE SPECIFIED EQUIPMENT AS NOTED ON DRAWINGS, OR APPROVED EQUAL. ADDITIONAL EQUIPMENT AND MATERIAL MAY BE REQUIRED OTHER THAN THAT SHOWN ON DRAWINGS TO INSTALL THE SPECIFIED EQUIPMENT SUCH AS HANGERS, SUPPORTS, ETC. ELECTRICAL CONTRACTOR SHALL PROVIDE ALL MATERIAL, LABOR, AND EQUIPMENT REQUIRED.
  7. THE CONTRACTOR SHALL VERIFY THAT THE ACTUAL EQUIPMENT SUPPLIED HAS THE SAME ELECTRICAL SPECIFICATIONS AS THE EQUIPMENT USED AS THE BASIS OF DESIGN. IF THE EQUIPMENT IS DIFFERENT, THE CONTRACTOR SHALL MAKE ADJUSTMENTS TO THE PANELS AND CIRCUITS AND INCLUDE THEM IN SUBMITTALS.
  8. ALL MATERIALS SHALL BE LISTED AND LABELED BY UNDERWRITERS LABORATORY, INC.
  9. DESIGN IS BASED ON AN EXISTING 120/240 VOLT, SINGLE PHASE, THREE WIRE, SOLIDLY GROUND WYE SERVICE.
  10. ALL WIRES SHALL BE TERMINATED AND LABELED. ALL JUNCTION BOXES SHALL BE LABELED TO INDICATE THE CIRCUITS CONTAINED IN THE BOX.
  11. PANELBOARD LEGENDS SHALL BE TYPED. LABEL ALL PANELBOARDS WITH GEAR INDICATING LOCATION OF BREAKER SERVING PANEL IN ACCORDANCE WITH N.E.C.
  12. ALL FEEDERS 4" AND LARGER SHALL BE MESSER TESTED AFTER INSTALLATION.
  13. UNLESS OTHERWISE NOTED, ALL CONDUCTORS SHALL BE COPPER AND #12 AWG MINIMUM WITH THIRTYTHW 600 VOLT INSULATION.
  14. PROVIDE A DEDICATED NEUTRAL, COLOR CODED, FOR EACH UNGROUNDED CONDUCTOR. SHARING OF NEUTRALS IS PROHIBITED.
  15. DO NOT INSTALL MORE THAN THREE CIRCUITS OR CURRENT CARRYING CONDUCTORS IN A CONDUIT.
  16. THE MINIMUM CONDUIT SIZE SHALL BE 1" INTERIOR CONDUITS SHALL BE EMT, UNDERGROUND CONDUIT AND CONCRETE ENCASED CONDUIT SHALL BE SCHEDULE 40 PVC. EXTERIOR EXPOSED CONDUIT SHALL BE SCHEDULE 40 PVC, UNLESS NOTED OTHERWISE.
  17. MC CABLE SHALL ONLY BE USED FOR CONDUIT AND CIRCUIT WIRING.
  18. A GREEN COPPER GROUND WIRE SHALL BE INSTALLED IN ALL CONDUIT SYSTEMS AND SHALL BE BONDED TO ALL ENCLOSURES, BOXES, AND EQUIPMENT.
  19. BONDING JUMPERS SHALL BE USED TO BOND CONDUIT TO ENCLOSURES, BOXES, AND EQUIPMENT WHERE KNOCKOUTS ARE USED.
  20. ALL DIMENSIONS ARE MEASURED TO THE CENTER OF THE DEVICE.
  21. ELECTRICAL BOXES INSTALLED ON OPPOSITE SIDES OF A FIRE RATED WALL SHALL HAVE A TWO FOOT MINIMUM HORIZONTAL SEPARATION OR BE WRAPPED WITH UL LISTED PUTTY PADS.
  22. THE CONTRACTOR SHALL PROVIDE ADEQUATE TEMPORARY POWER AND LIGHT EQUIPMENT TO ONE (1) 150 WATT INCANDESCENT LAMP PER 200 SQ. FT.
  23. THE CONTRACTOR SHALL GUARANTEE ALL WORK TO BE FREE OF DEFECTS IN WORKMANSHIP AND MATERIALS FOR ONE YEAR AFTER SUBSTANTIAL COMPLETION.

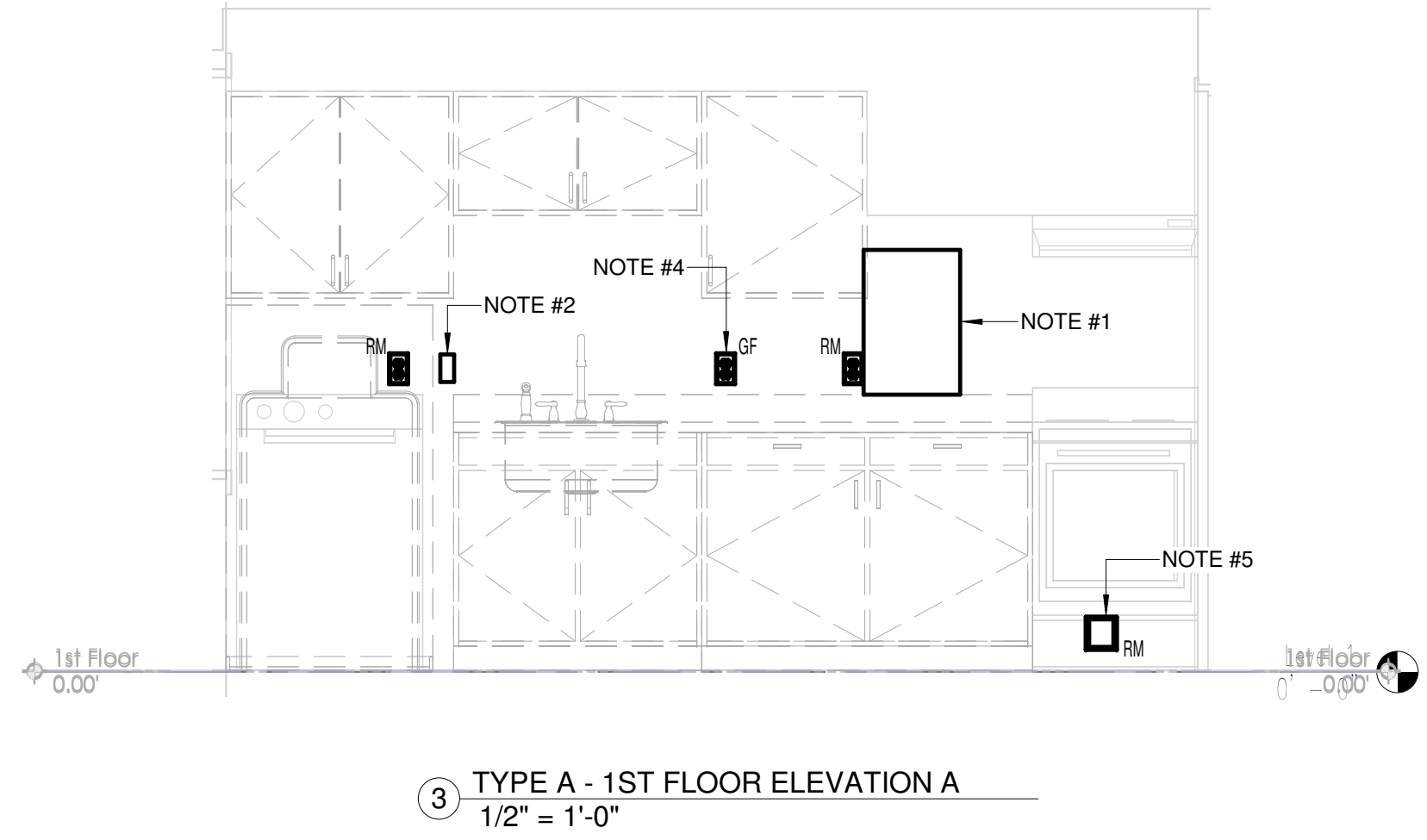

③ TYPE A - 1ST FLOOR ELEVATION A  
1/2" = 1'-0"

- #### REFERENCE NOTES:
1. EXISTING 14" x 21" PULL BOX TO REMAIN WITH ONE 1-1/2", ONE 1/2" AND FOUR 3/4" CONDUITS. PROVIDE TWO NEW 1" CONDUITS FROM PULL BOX TO PANEL. REMOVE EXISTING CONDUCTORS FROM PANEL TO PULL BOX UTILIZING EXISTING 1-1/2" FROM CONDUIT AND REINSTALL IN TWO NEW FLEX CONDUITS TO HAVE MAX SIX CURRENT CARRYING CONDUCTORS EACH.
  2. EXISTING SINGLE GANG BOX AND ASSOCIATED FLEX TO BE REMOVED.
  3. RECONNECT EXISTING SURFACE MOUNTED CONDUIT AND CONDUCTORS TO NEW RANGE HOOD.
  4. PROVIDE NEW GROUND FAULT RECEPTACLE WITH 12/2 WG MC TO PANEL VIA CRAWLSPACE OR ATTIC. CONNECT TO NEW 20/1 BREAKER.
  5. EXTEND NEW #3 WG MC VIA CRAWLSPACE TO EXISTING CIRCUIT SERVING RANGE. REMOVE WIRING TO PANEL VIA NOTE #1 PULL BOX.
  6. REMOVE EXISTING VANITY LIGHT AND ALL EXISTING SURFACE RACEWAY ON WALL. REINSTALL FIXTURE. SEE NOTE #9.
  7. PROVIDE NEW SURFACE JUNCTION BOX AT TOP OF WALL AND CONNECT TO EXISTING RACEWAY ON CEILING.
  8. RECEPTACLE TO BE FED FROM EXISTING CIRCUIT CURRENTLY SERVING GFI RECEPTACLE IN RESTROOM VIA JUNCTION BOX. SEE NOTE #7.
  9. EXISTING EXHAUST FAN, VANITY FIXTURE AND NEW SWITCH CONTROLLING BOTH TO BE FED FROM EXISTING CIRCUIT CURRENTLY SERVING LIGHTING IN RESTROOM, SEE NOTE #7.

TIME / DATE: 10/12/2018 3:54:08 PM

ALL ELECTRICAL WORK IS PART OF DEDUCT ALTERNATE 1

**FACILITY SYSTEMS CONSULTANTS, LLC**  
713 South Central Street, Suite 101  
Knoxville, Tennessee 37902  
Phone: (865) 246-0164  
Fax: (865) 246-1084

MCCARTY  
HOLSAPLE  
MCCARTY  
**MHM**  
ARCHITECTS & INTERIOR  
DESIGNERS

18036  
550 W. MAIN STREET, SUITE 300  
KNOXVILLE, TENNESSEE 37902  
CONTRACT: DOUG MCCARTY  
EMAIL: DmcCarthy@mhmhc.com  
TELEPHONE: (865) 544-2000  
FACSIMILE: (865) 544-0402  
INTERNET: mhmhc.com

Western Heights  
901 North Broadway, Knoxville, TN  
KNOXVILLE, TENNESSEE 00000-000

- #### ACTIVE DESIGN PHASE
- SCHEMATIC DESIGN
  - DESIGN DEVELOPMENT
  - RED-CHECK
  - CONSTRUCTION DOCUMENTS
  - CONSTRUCTION BIDDING PHASE
  - CONSTRUCTION ADMINISTRATION

SEAL:

1. The McCarty-Holsaple-McCarthy, Inc.  
Do NOT scale drawings, use given dimensions only.  
I, the undersigned, a duly qualified Professional Engineer, hereby certify that I am the author of these drawings and that they conform to the provisions of the Code of Ethics and the Conditions of the Act of 1903.  
TERRY T. BEADLA  
PROFESSIONAL ENGINEER  
STATE OF TENNESSEE  
NOV 1 2018

CONSULTANT INFORMATION

CODES OFFICIAL REVIEW

LET PLAN:

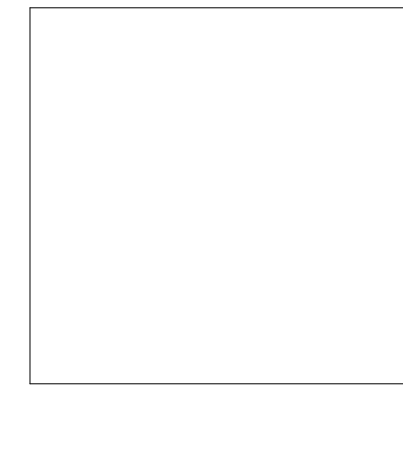

REVISION INFORMATION

No.	Date	Description

DRAWING INFORMATION

SCALE: As indicated  
SCALE GUIDE: OCT 5, 2018  
DWG ISSUED: M. BUTLER  
PRJ MGR: K. WHITE / G. TAYLOR  
PA / PC: S.A.H.  
DRAWN BY: L.T.H./P.C.H.

ELEC. LEGENDS, SCHEDULES AND BUILDING TYPE A TYPICAL UNIT PLAN  
DRAWING NO: **E101**