



Jackson County Board of Commissioners

67 Athens Street
Jefferson, Georgia 30549
Phone: (706) 367-6309
Fax: (706) 708-2505
Email: kmorris@jacksoncountygov.com

Date: May 1, 2024

To: Qualified Vendors

From: Kenneth Morris, Purchasing Manager

RE: Addendum 1 to Jackson County ITB 240008-1, Purchase of Three (3) Ambulance Vehicles, Jackson County Emergency Services (EMS)

1. Addendum 1 is hereby issued to attach Appendix A to Invitation to Bid 240008-1 which contains drawings, renderings, and layout for the county ambulance paint and graphics.
2. All other terms and conditions in ITB 240008-1 remain unchanged.
3. Any inquiries concerning Addendum 1 or the original invitation should be made to Kenneth Morris, Purchasing Manager, (706) 367-6309 or via email at kmorris@jacksoncountygov.com
4. Jackson County reserves the right to reject any and all proposals, to waive any technicalities or irregularities and to award the offer based upon the most responsive, responsible submission.
5. Bidders may acknowledge receipt of addenda, by either signing and attaching this copy, or by writing "Acknowledge Addenda #1" at bottom of Bid Schedule.

Jackson Co. EMS



APPROVED: _____ NOT APPROVED: _____

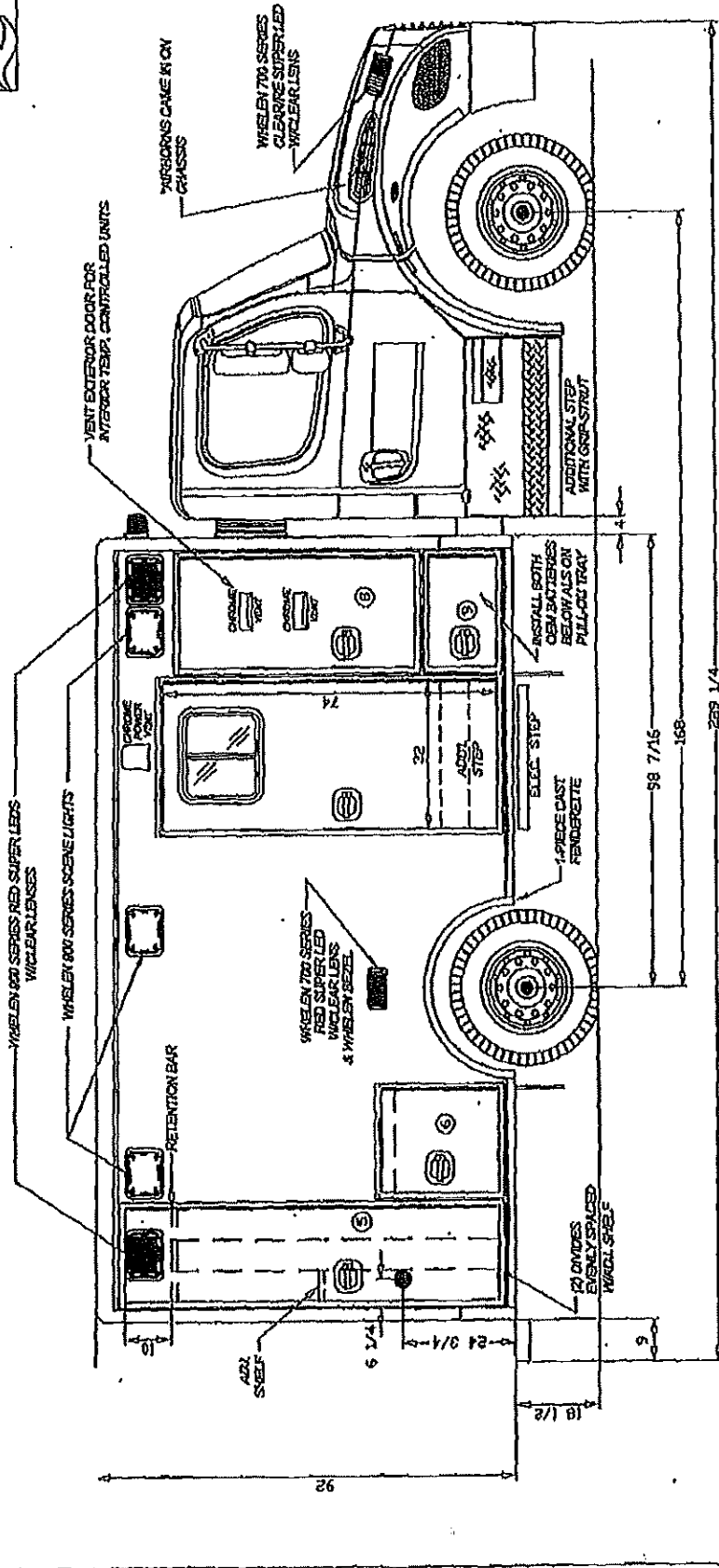

259 1/4

INSTALLMENTS #8 & #5



NOT APPROVED:

APPROVED:

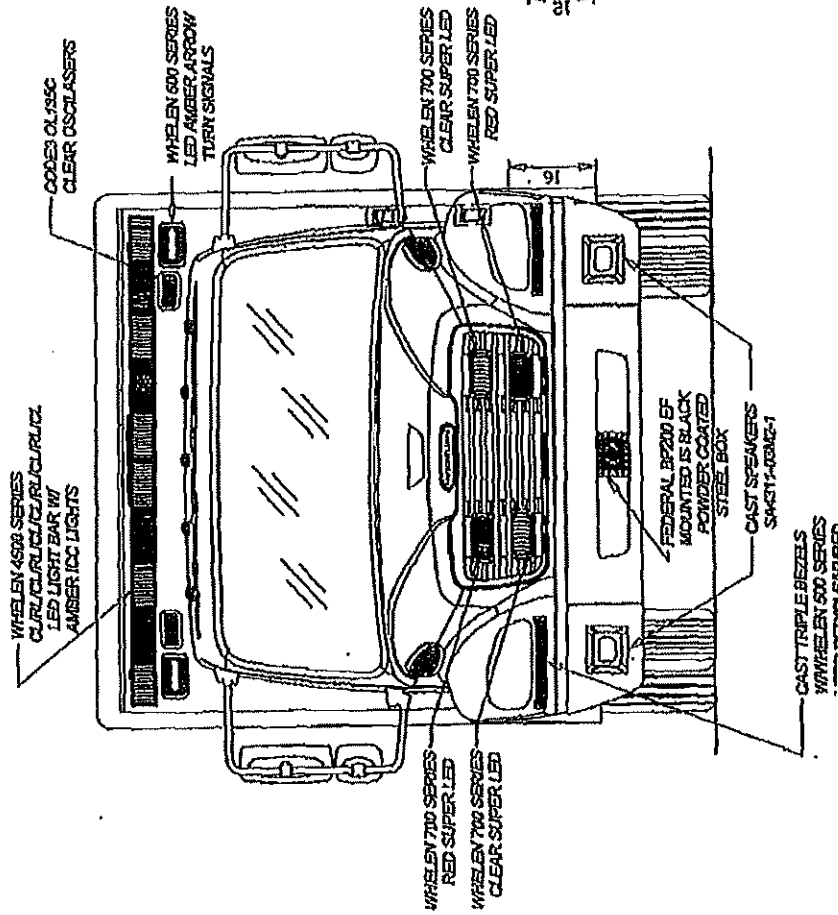
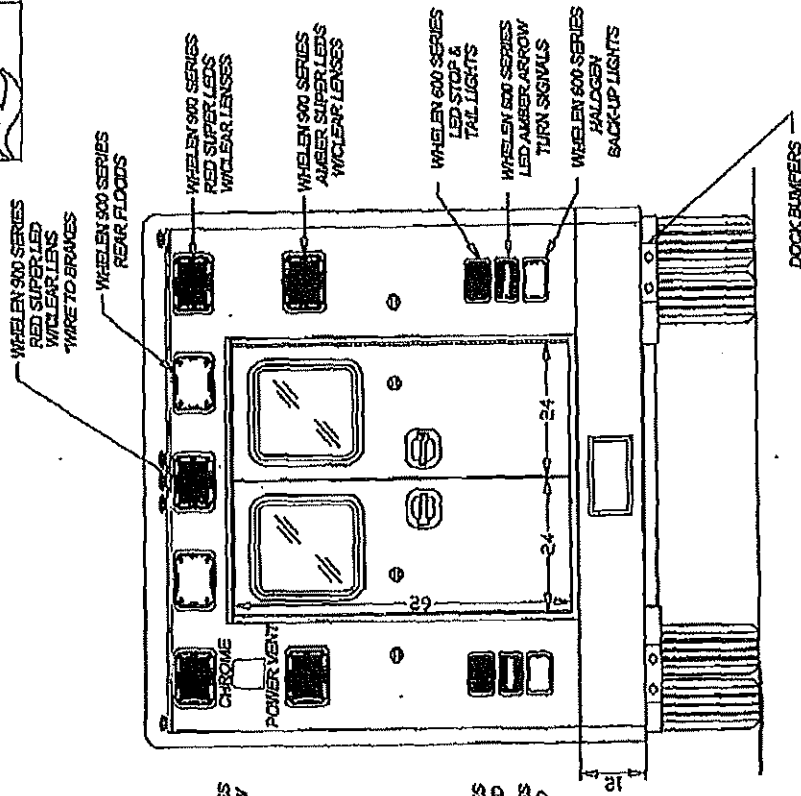



APPROVED: _____ NOT APPROVED: _____

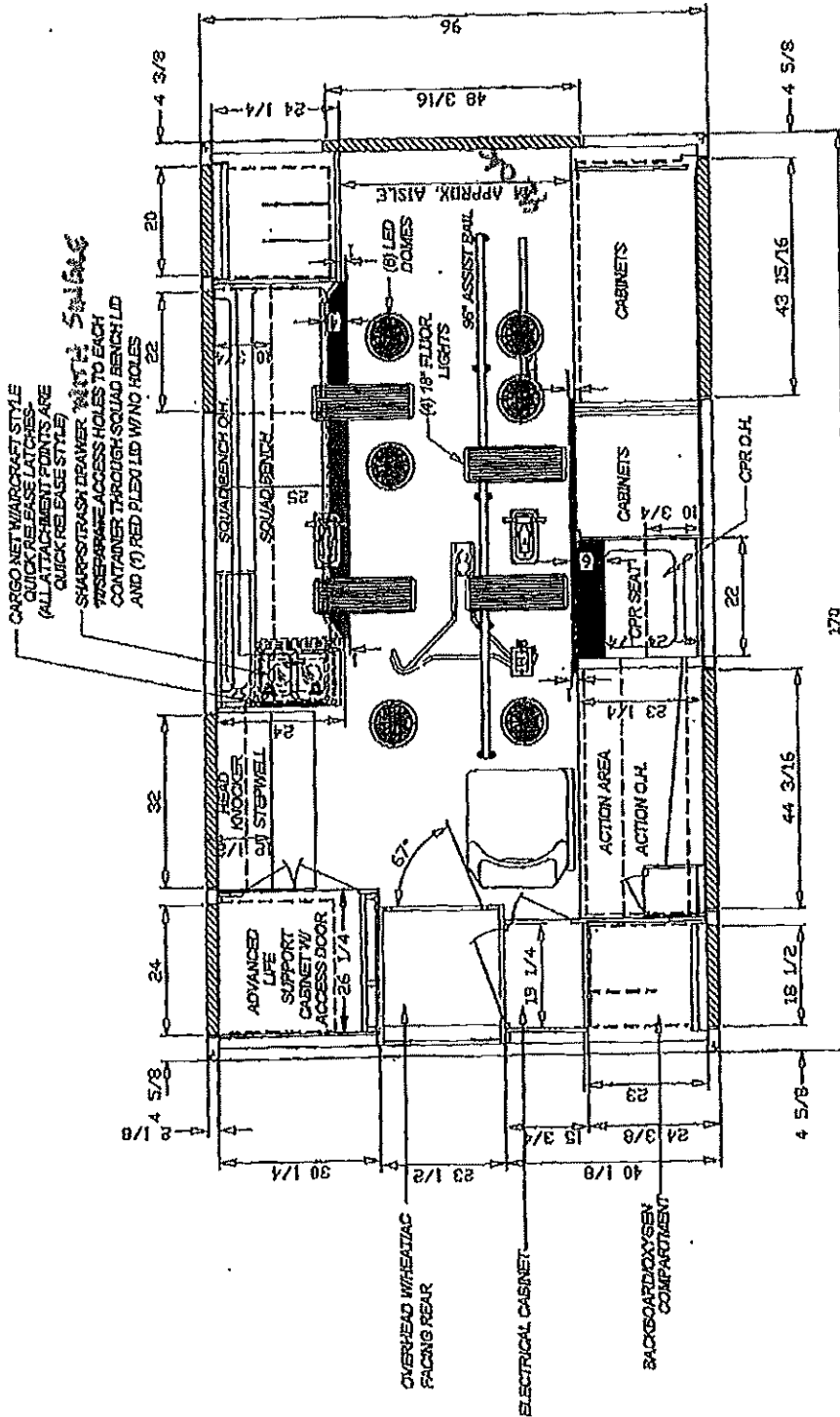

APPROVED: _____

NOT APPROVED: _____

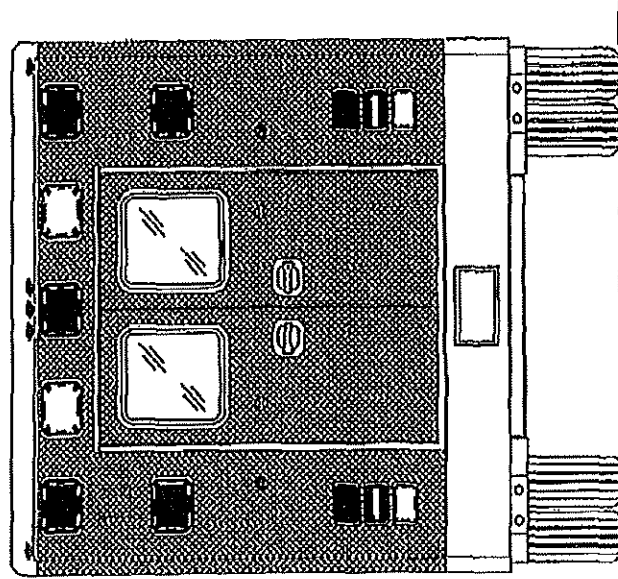
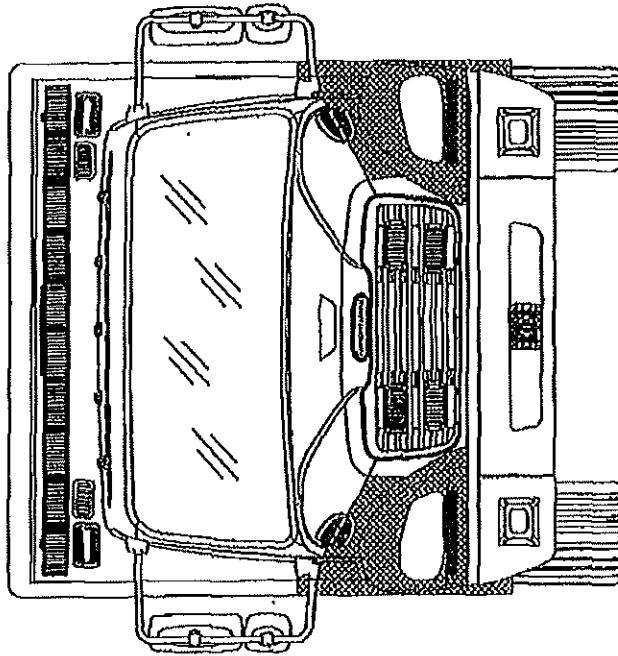



APPROVED: _____ NOT APPROVED: _____

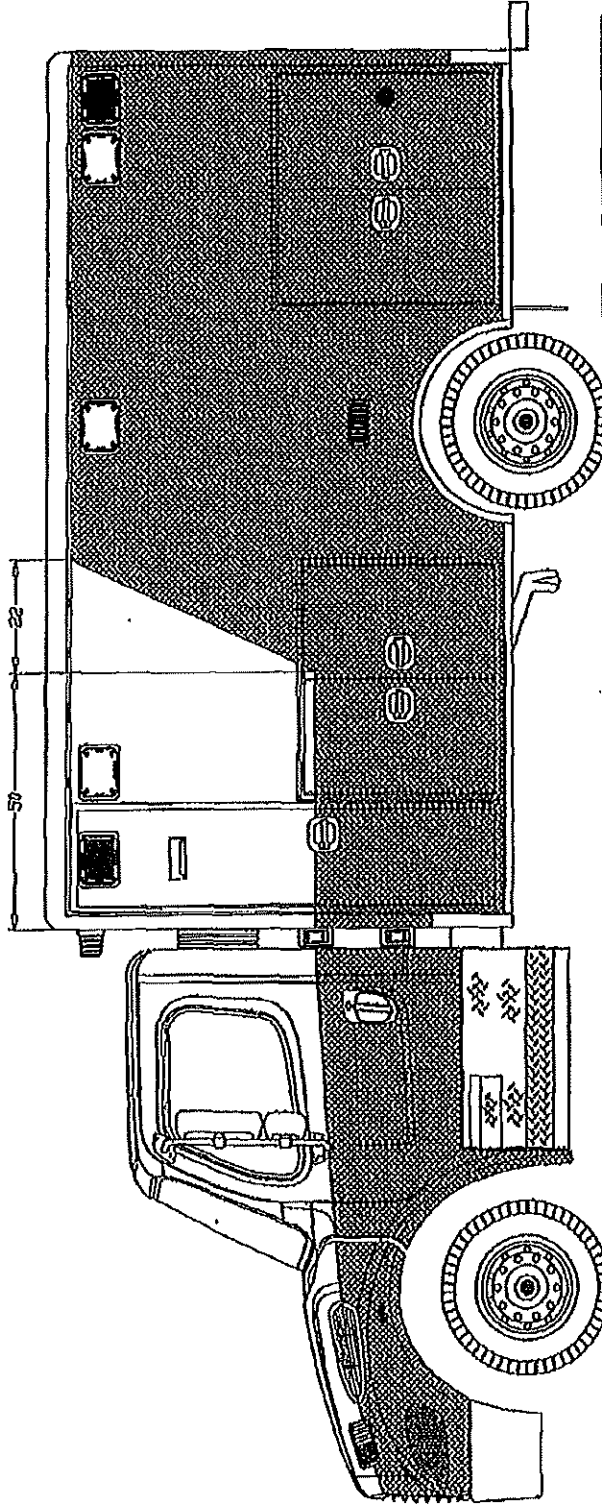

PAINT BOTTOM HALF OF CHASSIS AND MODULE RED PPG# FBCH911072
PAINT WHITE ON MODULE PPG# FBCH911002



APPROVED: _____ NOT APPROVED: _____

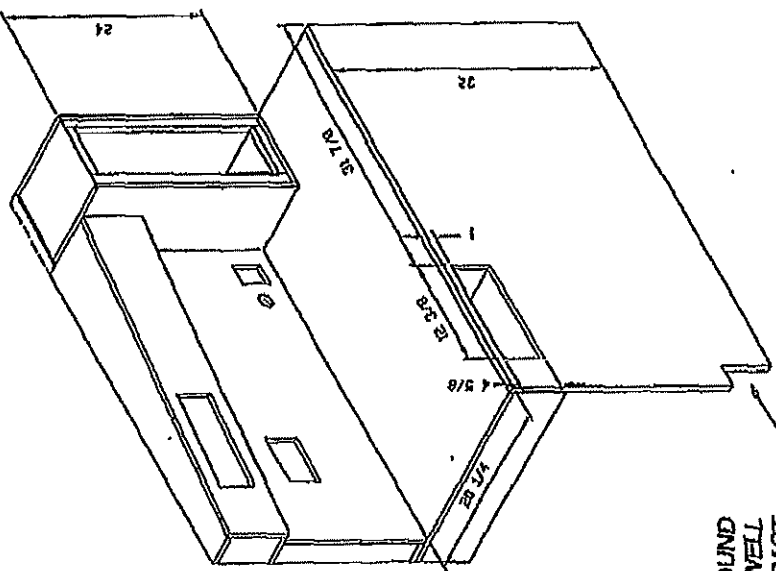

*NOTCH AROUND WHEEL WELL THAT WILL PROTRUDE PAST APPROX. AN INCH

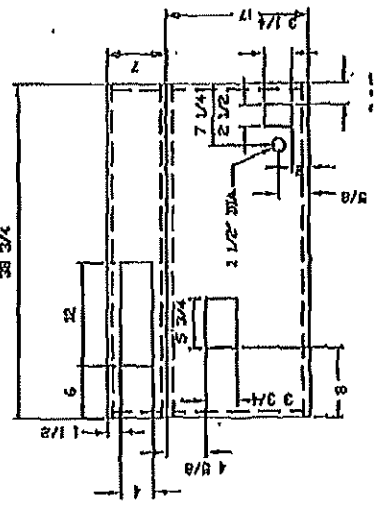
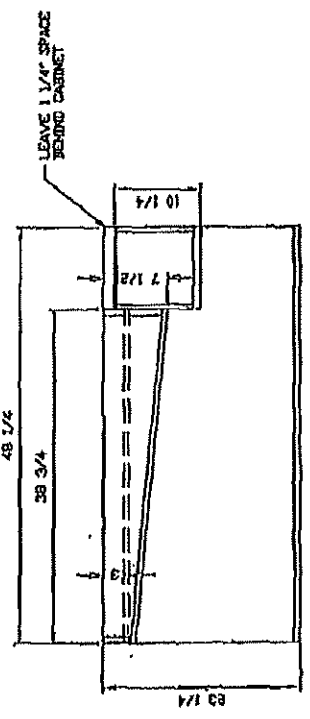



APPROVED: _____ NOT APPROVED: _____

DO NOT RADIUS VERTICAL EDGE OF ALS CABINET

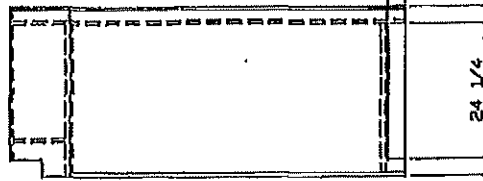
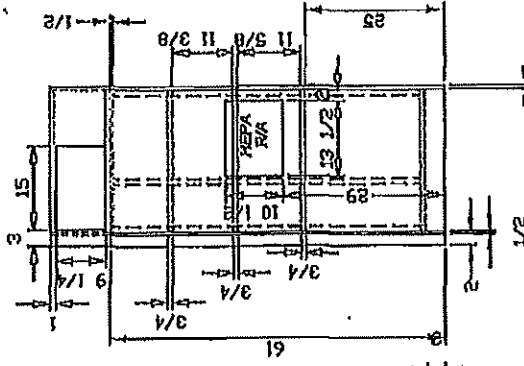
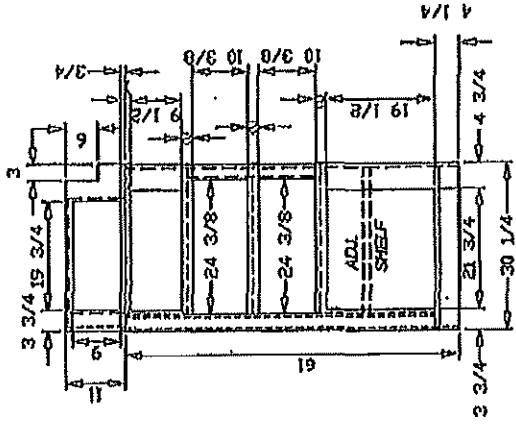
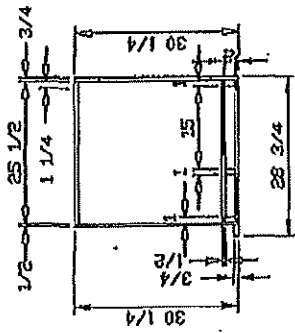
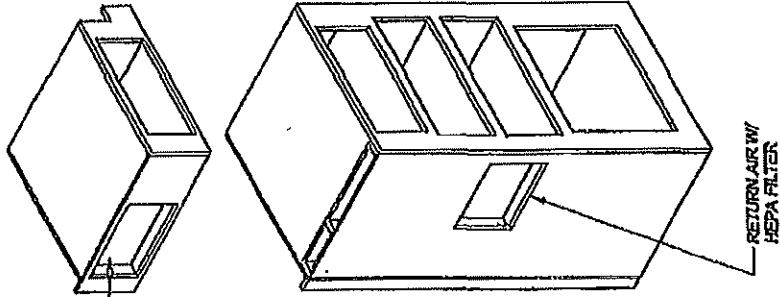

DATE: 10/15/2014

APPROVED: _____

NOT APPROVED: _____

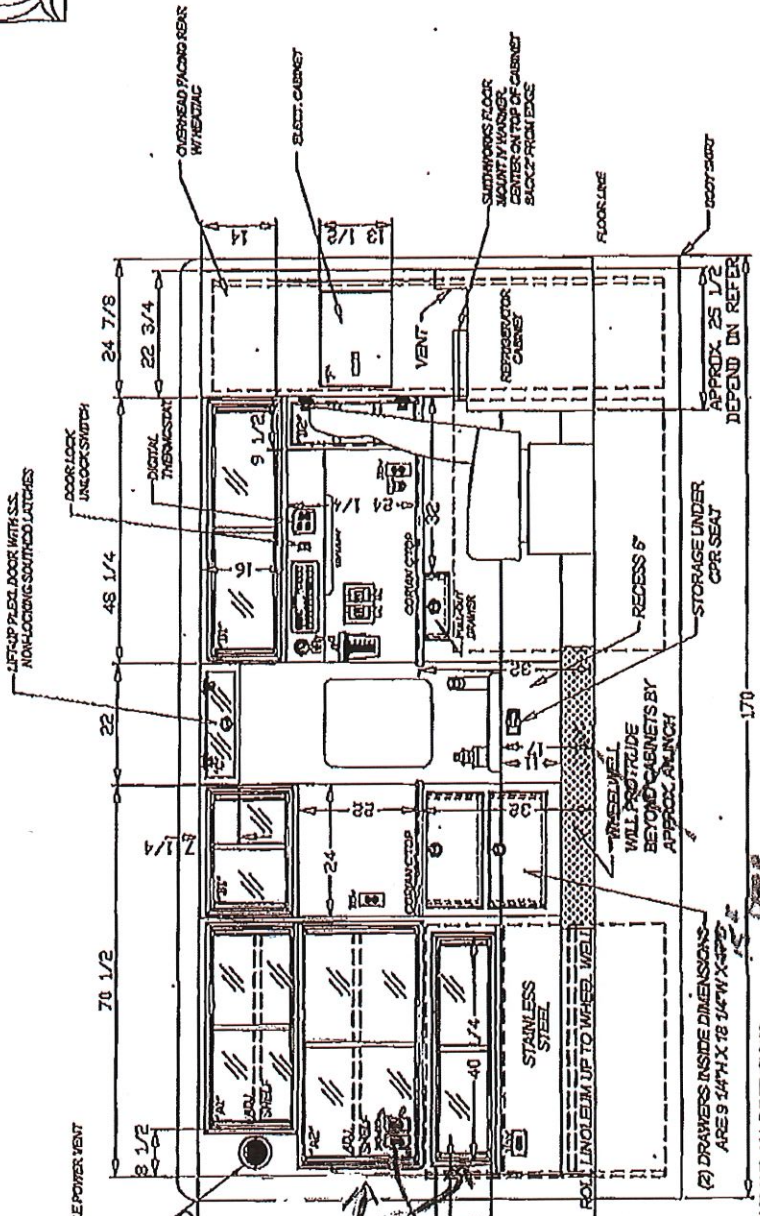

NOTE: DETAILS ARE CONCEPTUAL ONLY. LAYOUT AND ALL DIMENSIONS



APPROVED: _____

NOT APPROVED: _____

STORAGE FOR 60 GLOVE BOXES
INSIDE DIMENSIONS ARE
18" W X 5 1/4" H X 3' 11 1/2" D
USE 60 PLEED DOORS WITH CHROME
PULL HANDLES AND
ROLLER BALL CATCHES

CLOSEABLE POWER VENT
CONTROL PANELS
FOR TEMP. CABINETS

HEATING
OVERHEAD
FACING
REAR

ADVANCED
LIFE SUPPORT
CABINET

PASS-THRU

HEPA FILTER PANEL
WITH (2) STD. R/A
VENT COVERS

SMITHWORKS FLOOR
MOUNT WARMER
CENTER ON TOP OF CABINET,
2" BACK FROM EDGE

REFRIGERATOR
CABINET

STAINLESS
STEEL

STEPWELL

CARGO NET W/ AIRCRAFT STYLE
QUICK RELEASES AT ALL POINTS

STAINLESS
STEEL

ROLL LINOLEUM UP TO WHEELWELL
W/ L. PROTRUSION
BEYOND BENCH BY
APPROX. 1/4" INCH

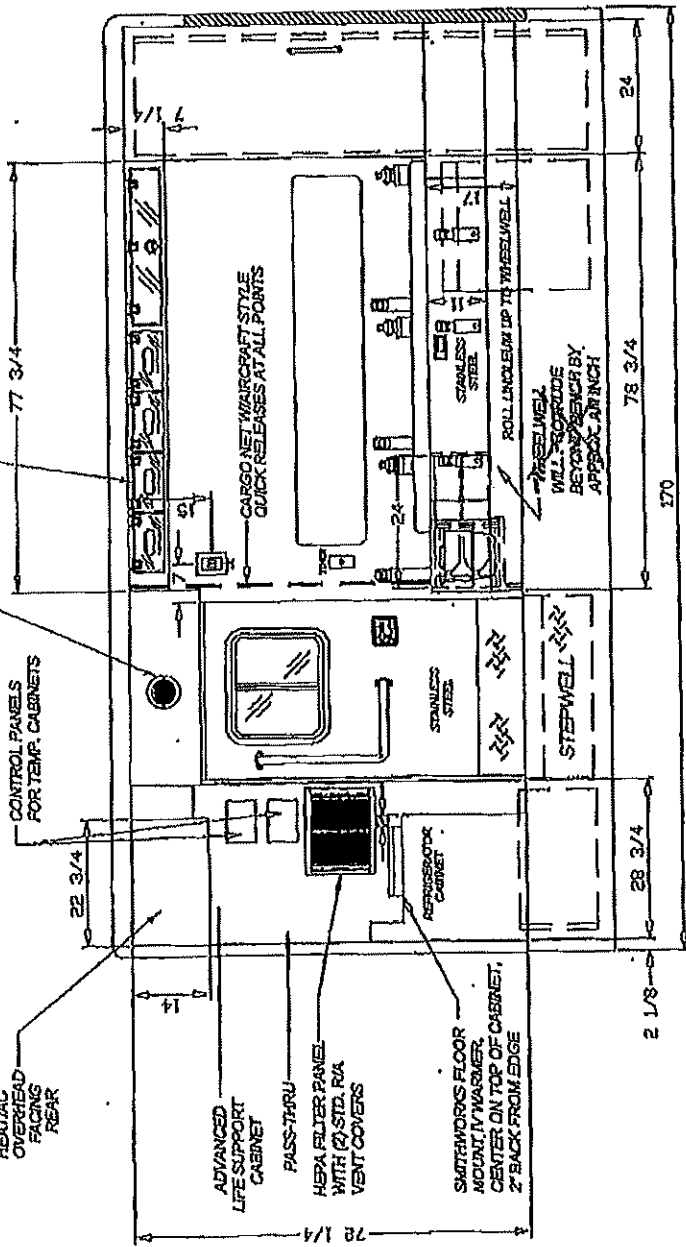

FLOOR

2 1/8



APPROVED: _____ NOT APPROVED: _____

