

Aztec Ditch Pump Replacement

City of Aztec, New Mexico

San Juan County

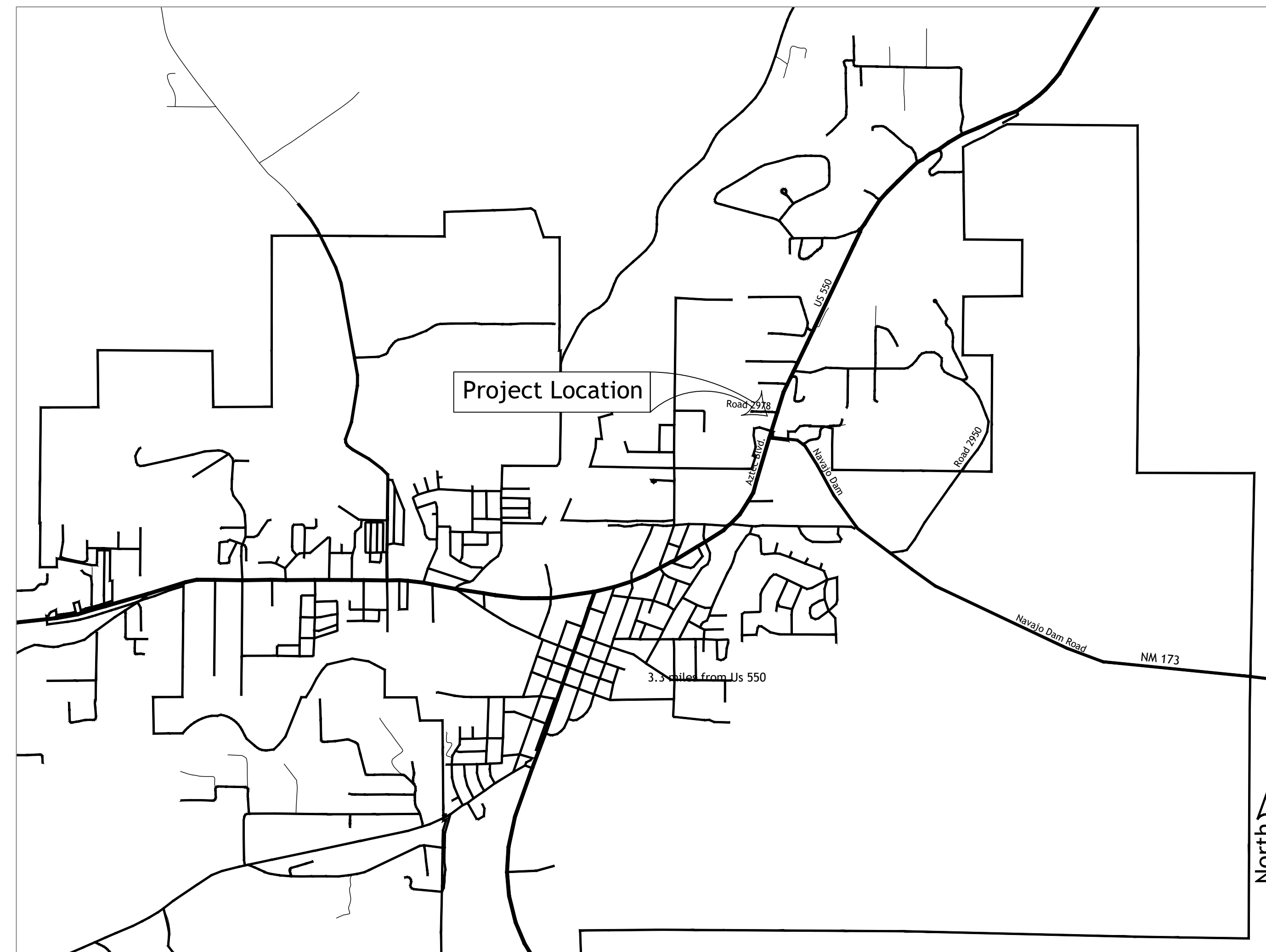
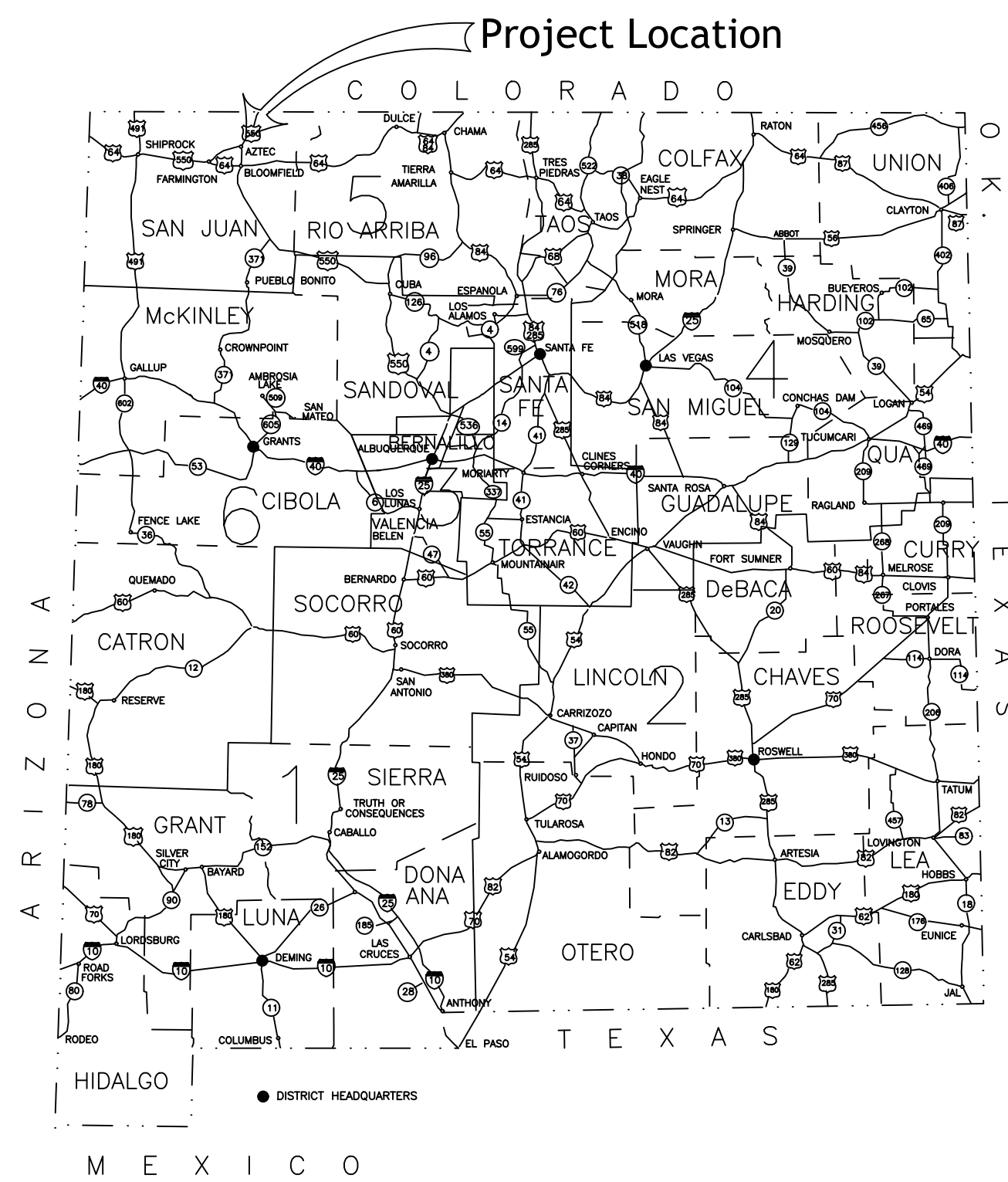

Vicinity Map
Scale: 1"= 2000'

Know what's below.
Call before you dig.
It's the Law!

New Mexico One Call, Inc.
NMOC
Professional Resources for Damage Prevention

UTILITY OWNERS

CITY OF AZTEC DEPARTMENT OF PUBLIC WORKS
(505) 334-7660

CITY OF AZTEC ELECTRIC DEVELOPMENT
(505) 334-7660

QWEST (TELEPHONE)
(505) 325-2311

COMCAST CABLE
VICTOR APPELEGATE 505-402-0055

PNM (GAS)
505-324-3783

Sheet List Table	
Sheet Number	Sheet Title
1-1	Cover Sheet
2-1	Site Location
3-1	Pump Station Plan
4-1	Photos
E001	Electrical Demolition Plan
E002	Connector Detail and BOM
E003	Demolition and Installation Plan
E004	Demolition and Installation Plan

Revision	Log
1	
2	
3	
4	
5	
6	

Owner:
City of Aztec

Project:
AZTEC DITCH PUMP REPLACEMENT

Sheet Description:
COVER SHEET

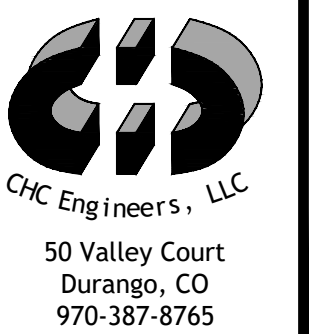
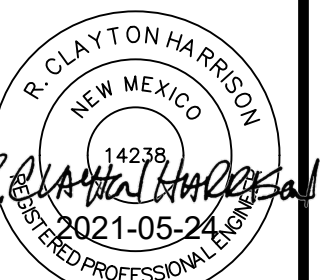

Project Date:
2021-05-24
Proj: 20012

Drawing created by CHC Engineers, LLC on 05/24/2021 at 1:25pm. Plot Date: 05/24/2021 at 1:25pm.



Revision Log

1.	
2.	
3.	
4.	
5.	
6.	

Owner:
City of Aztec

Project:
AZTEC DITCH PUMP REPLACEMENT

Sheet Description:
SITE LOCATION

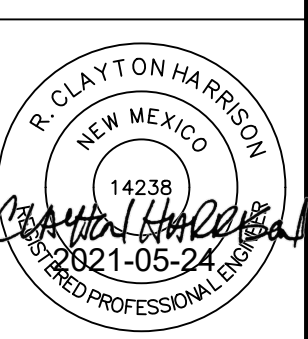

Project Date:
2021-05-24
Proj: 20012
2-1

Property owner: CHC Engineers, LLC, Aztec, NM, Pump House, Date: 05/24/2021 - 12:58pm

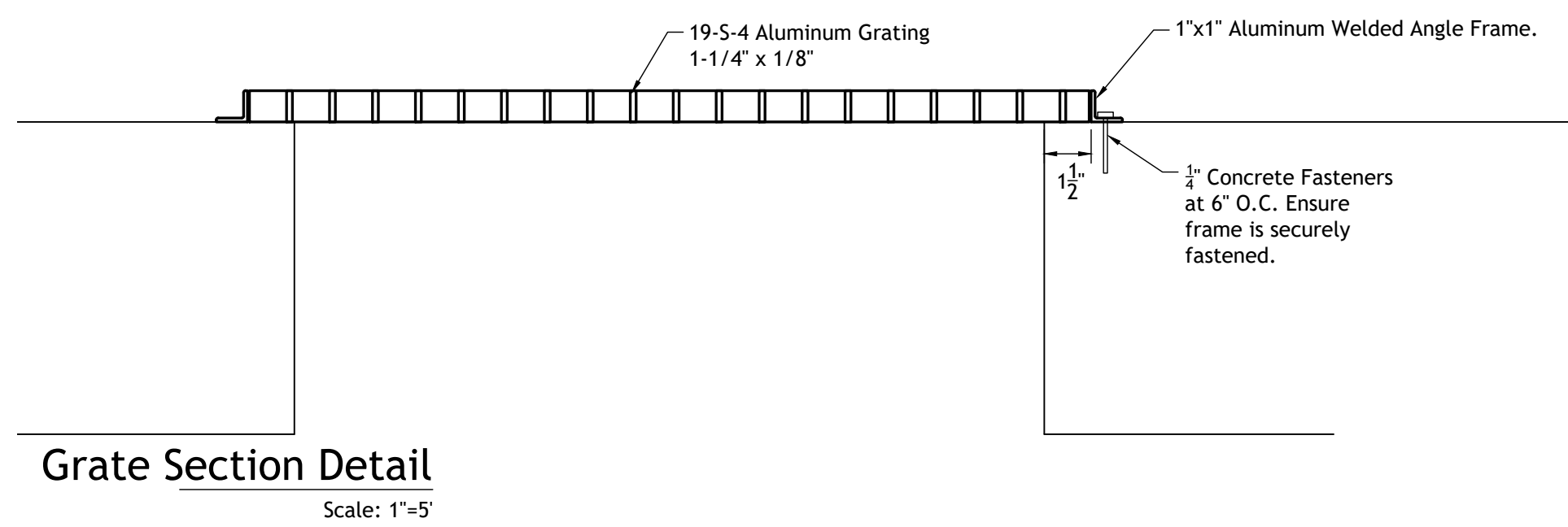

Grate Section Detail
Scale: 1"=5'

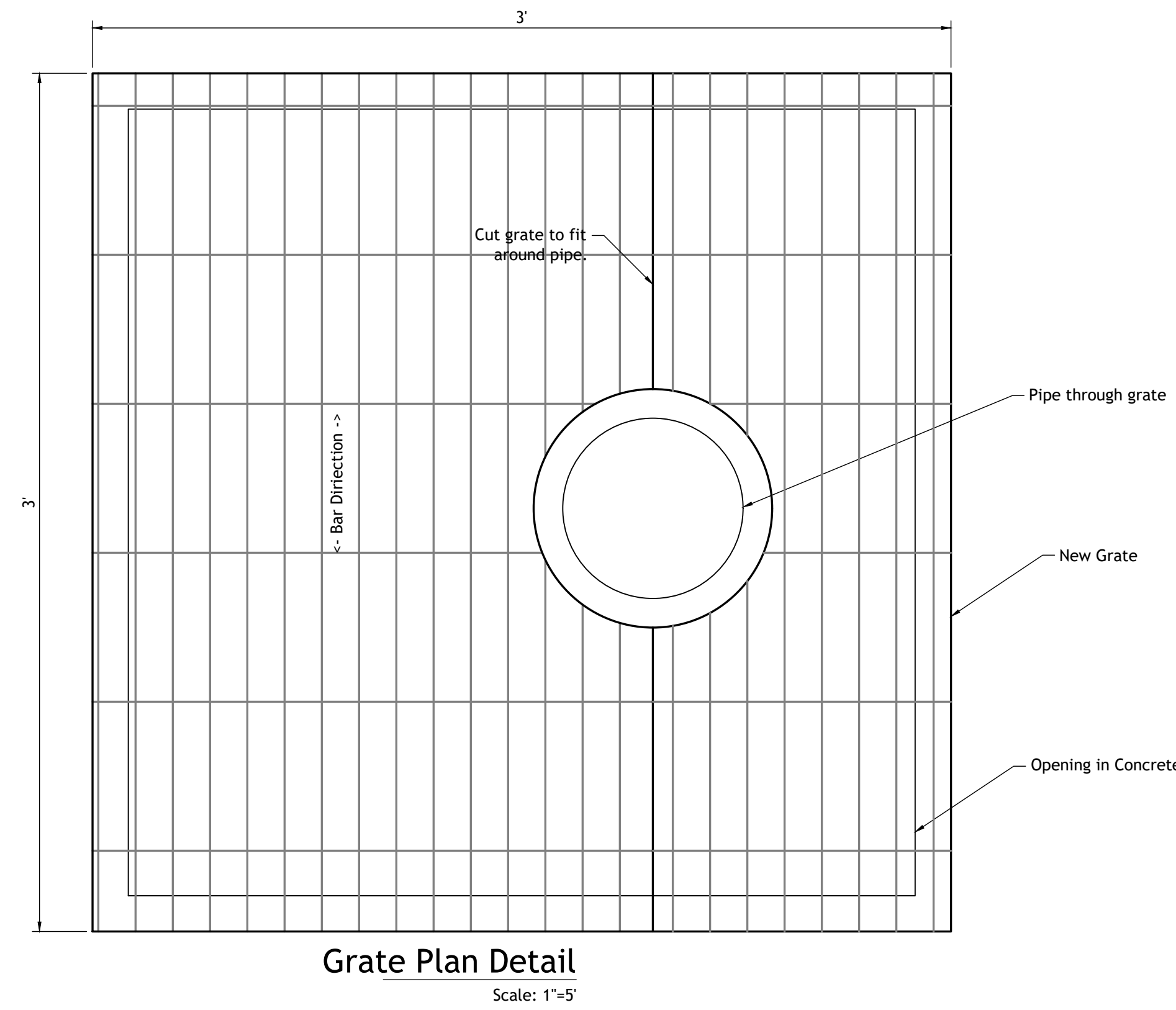

Grate Plan Detail
Scale: 1"=5'

- Note:
- All Fittings shall be AWWA C110 PC 250 with Flanged Ends.
 - All necessary fittings, bolts, gaskets, adjustments, etc. necessary for completion of the project not specifically called out are considered incidental to the project.
 - Spools called out as adjustable shall be FLXPE with Mega Flange to be field cut to length.
 - See electrical plans for connection details. All connectors, conduit, wiring, required shall be included in contract pricing.

Equipment:
Pump: Gorman-Rupp Model 56B1-E95-460

(all equipment shown is expected unless equal is approved)

Suggested Construction Sequence:

- Remove existing Pump and Air Valve.
- Sawcut new opening for pump.
- Seal 12" Inlet and Clean Sump.
- Install new Pump.
- Electrical demo and installation.
- Coordinate with City for soft start programming.
- Install grates.
- Remove plug on 12" line, open ditch headgate and fill sump.
- Test Pump

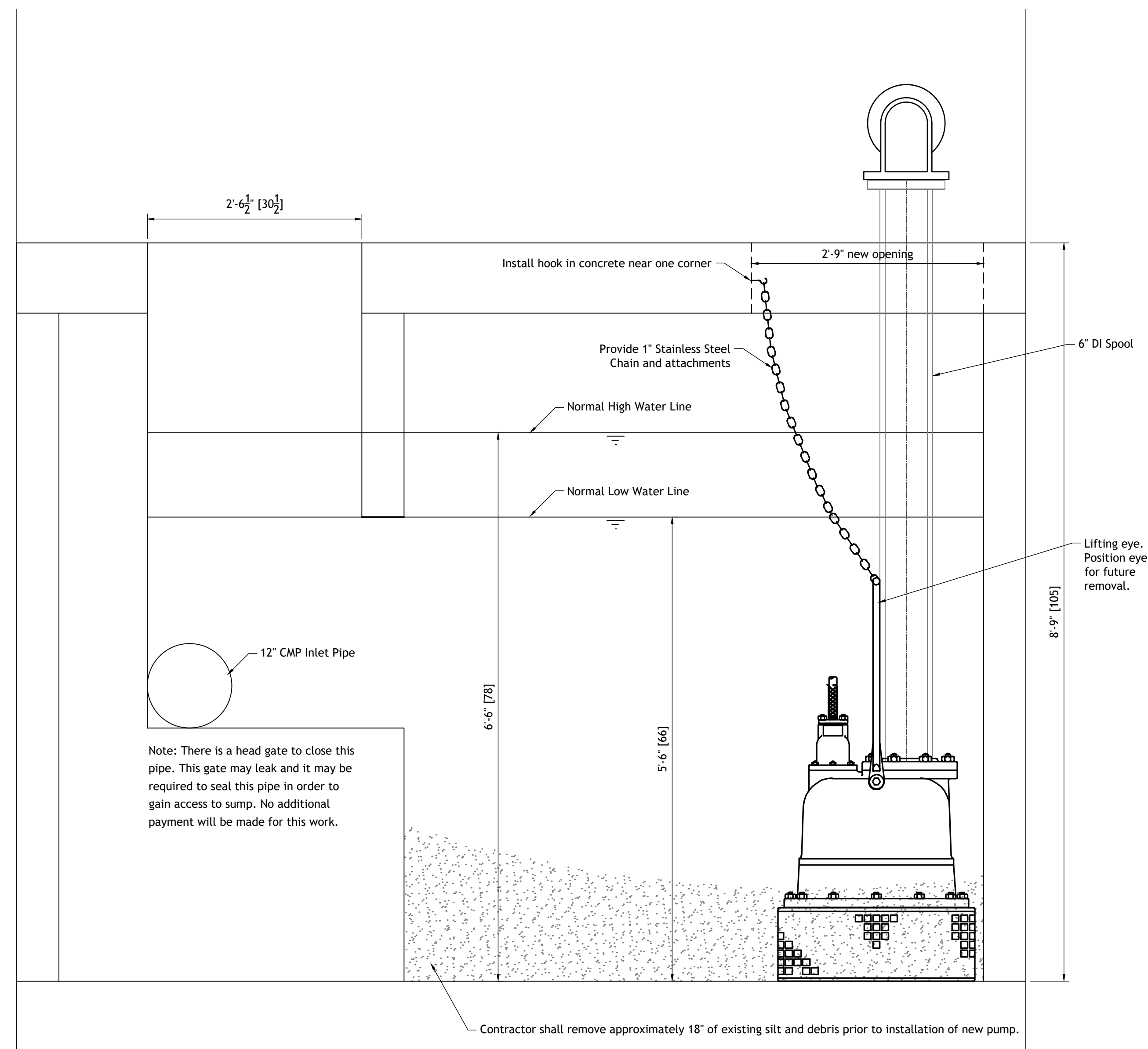

Pump House - Section
Scale: 1"=1'

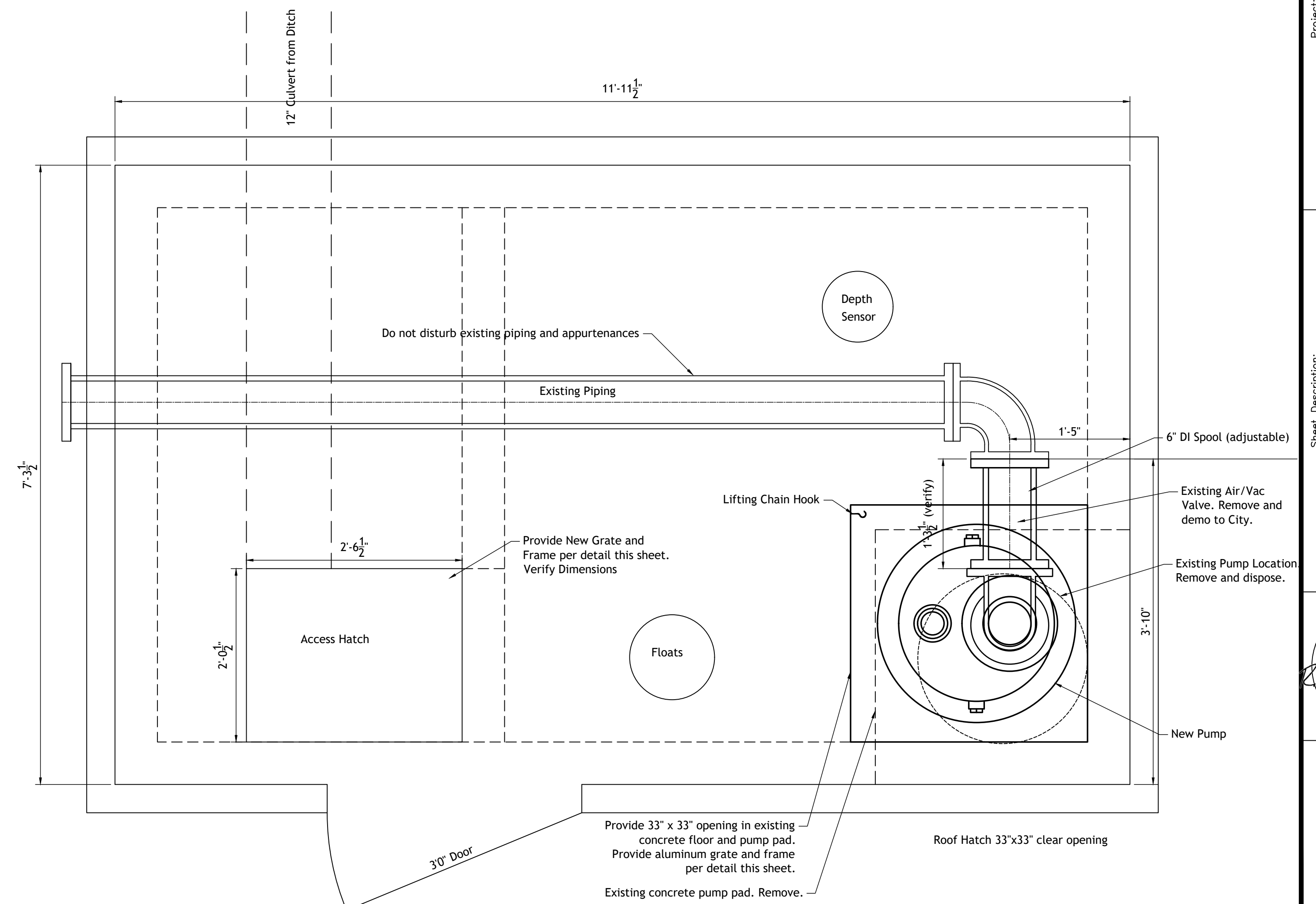

Pump House - Plan
Scale: 1"=1'

Revision	Log
1	
2	
3	
4	
5	
6	

Owner:
City of Aztec

Project:
AZTEC DITCH PUMP REPLACEMENT

Sheet Description:
PUMP STATION PLAN

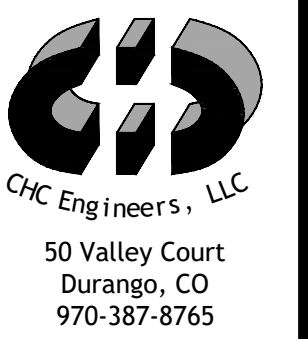
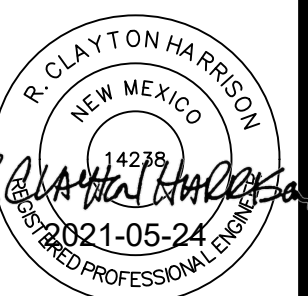

Project Date:
2021-05-24
Proj: 20012



Pump House - Showing Roof Hatch



Pump House - Showing Existing Pump



Pump House - Looking West



Access Hatch

Revision	Log
1	
2	
3	
4	
5	
6	

Owner:
City of Aztec

Project:
AZTEC DITCH PUMP REPLACEMENT

Sheet Description:
PHOTOS



Project Date:
2021-05-24
Proj: 20012

Aztec, NM - CHC Engineers, LLC - 50 Valley Court - Durango, CO 970-387-8765 - 05/24/2021 - 1:25pm



MOTOR REMOVAL AND INSTALL PLAN;

1. DISCONNECT 480V MOTOR LEADS AT MOTOR CONNECTION BOX AND WITHDRAW CONDUCTORS BACK TO THE STARTER OUTPUT TERMINALS AT STARTER CABINET. DISCARD #1 CONDUCTORS.
2. REMOVE EXISTING 12"X12" J-BOX AND HUB FROM CONDUIT.
3. INSTALL NEW MELTRIC OUTLET BOX AND RECEPTACLE AS SHOWN ON PAGE E002. SUPPORT BOX AND CONDUIT WITH STRUT AS NECESSARY.
4. INSTALL MALE END OF MELTRIC DEVICE ONTO NEW PUMP CONNECTION CORD USING THE INDICATED CORD GRIP DEVICE.

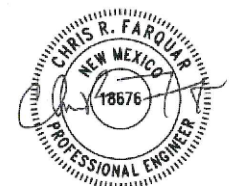

4/26/2021

DESIGNED BY:	CRF				
CHECKED BY:	CRF				
APPROVED BY:	---				
CLIENT APPROVAL:	---				
NO	DATE	ISSUED FOR CONSTRUCTION	BY	CK	APPR.
0	4/26/2021		CRF	CRF	



AZTEC DITCH PUMP REPLACEMENT
PUMP HOUSE
ELECTRIC DEMOLITION PLAN
SHEET 1 OF 4

JOB NO.	210000-01	SCALE	NTS
FILENAME	2100001-E001	REV. NO.	0
DWG. NO.	2100001-E001		

Apr 26, 2021 - 9:53am by cfarquar - Path = C:\Users\cfrquar\Documents\2 - CRF Project Files\CHC Engineers\Bibit Pump\CAD Files\2100001-E001.dwg
 ANSI D. 22 x 34 in.

BILL OF MATERIAL				
NO.	QTY.	DESCRIPTION	MANUFACTURER	PART NUMBER
1	1	METAL BOX W/ 60° ANGLE PLATE, 2" RMC OUTLET	MELTRIC	796C6N20
2	1	200A, 100HP, DS-200 SWITCH RATED RECEPTACLE	MELTRIC	37-24043
3	1	200A, 100HP, DS-200 SWITCH RATED INLET	MELTRIC	37-28043
4	1	METALLIC INLET HANDLE W/ 2" NPT OUTLET	MELTRIC	596P0N20
5	1	ALUMINUM CORD GRIP WITH	MELTRIC	CG2001AM**

** CORD GRIP DEVICE IS SIZED FOR A 1.75 INCH OD CABLE. VERIFY CABLE DIMENSIONS PRIOR TO ORDERING GRIP DEVICE.

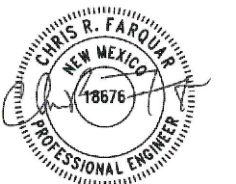
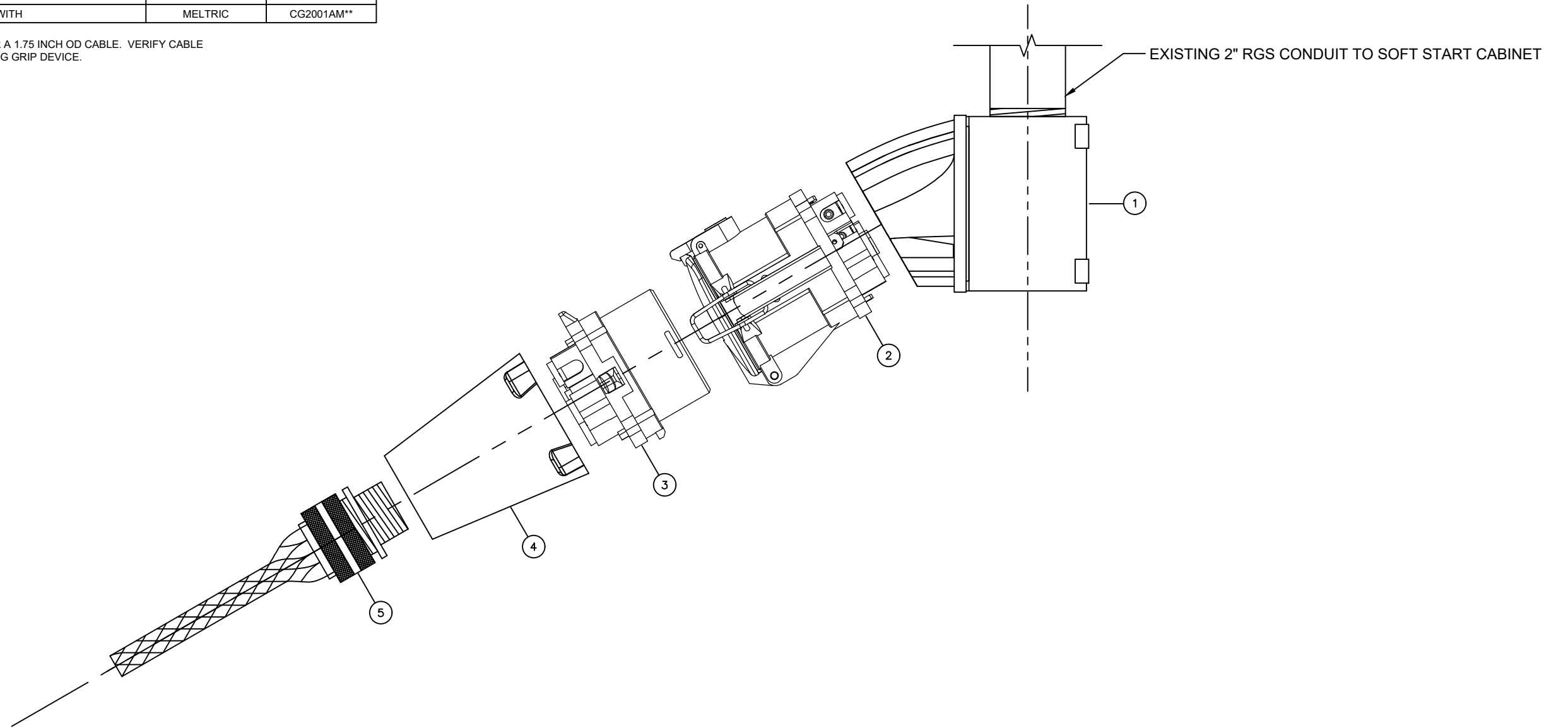

4/26/2021

DESIGNED BY:	CRF				
CHECKED BY:	CRF				
APPROVED BY:	---				
CLIENT APPROVAL:	---				
NO	DATE	ISSUED FOR CONSTRUCTION	BY	CK	APPR.
0	4/26/2021	ISSUED FOR CONSTRUCTION	CRF	CRF	



AZTEC DITCH PUMP REPLACEMENT
PUMP HOUSE MOTOR CONNECTOR
DETAIL & BOM
SHEET 2 OF 4

JOB NO.	210000-01	SCALE	NTS
FILENAME	2100001-E002	REV. NO.	0
DWG. NO.	2100001-E002		



FEEDER REPLACEMENT INSTALL PLAN;

1. DISCONNECT 480V MOTOR FEEDER AT THE STARTER CIRCUIT BREAKER LINE SIDE AND WITHDRAW CONDUCTORS BACK TO SERVICE PANEL FEEDER BREAKER LOAD TERMINALS. DISCARD CONDUCTORS.
2. REMOVE EXISTING LL67 AND LB67 CONDULETS AND REPLACE WITH EQUIVALENT FORM 8 DEVICES MODELS LL68 AND LB68 OR LARGER DEVICE. ALTERNATE MODELS SHOULD BE RATED FOR 4-1 CONDUCTOR COPPER #3/0 XHHW-2 MINIMUM. CUT AND THREAD 2" CONDUIT AS NECESSARY. RELOCATE ENTRIES INTO PANEL AS NECESSARY AND SEAL ALL UNUSED ENTRIES.
3. ONCE CONDUIT IS COMPLETE AND ALL PAGE E001 MODIFICATIONS ARE COMPLETE RE-PULL MOTOR LEADS BETWEEN THE SOFT STARTER OUTPUT TERMINALS TO THE NEWLY INSTALLED MELTRIC DEVICE. CONDUCTOR CONFIGURATION WILL INCLUDE 3-1 CONDUCTOR #3/0 XHHW-2 COPPER, AND 1-1 CONDUCTOR #6 GROUND.

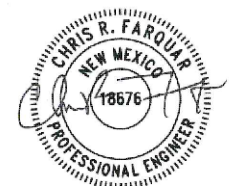

4/26/2021

DESIGNED BY:	CRF				
CHECKED BY:	CRF				
APPROVED BY:	---				
CLIENT APPROVAL:	---				
NO	DATE	ISSUED FOR CONSTRUCTION	BY	CK	APPR.
0	4/26/2021		CRF	CRF	



AZTEC DITCH PUMP REPLACEMENT
PUMP HOUSE ELECTRIC
DEMOLITION & INSTALLATION PLAN
SHEET 3 OF 4

JOB NO.	210000-01	SCALE	NTS
FILENAME	2100001-E003	REV. NO.	0
DWG. NO.	2100001-E003		



FEEDER REPLACEMENT INSTALL PLAN;

1. REMOVE EXISTING LR67 AND LB67 CONDULETS AND REPLACE WITH EQUIVALENT FORM 8 DEVICES MODELS LR68 AND LB68 OR LARGER DEVICE. ALTERNATE MODELS SHOULD BE RATED FOR 4-1 CONDUCTOR #3/0 XHHW-2 MINIMUM. CUT AND THREAD 2" CONDUIT AS NECESSARY. RELOCATE ENTRIES INTO PANEL AS NECESSARY AND SEAL ALL UNUSED ENTRIES.
2. ONCE CONDUIT MODIFICATIONS ARE COMPLETE RE-PULL FEEDER TO SOFT STARTER USING 3-#3/0 XHHW-2 COPPER CONDUCTORS AND 1-#6 COPPER GROUND.



4/26/2021

DESIGNED BY:	CRF				
CHECKED BY:	CRF				
APPROVED BY:	---				
CLIENT APPROVAL:	---				
NO	DATE	ISSUED FOR CONSTRUCTION	BY	CK	APPR.
0	4/26/2021		CRF	CRF	



AZTEC DITCH PUMP REPLACEMENT
PUMP HOUSE ELECTRIC
DEMOLITION & INSTALLATION PLAN
SHEET 4 OF 4

JOB NO.	210000-01	SCALE	NTS
FILENAME	2100001-E004	REV. NO.	0
DWG. NO.	2100001-E004		