

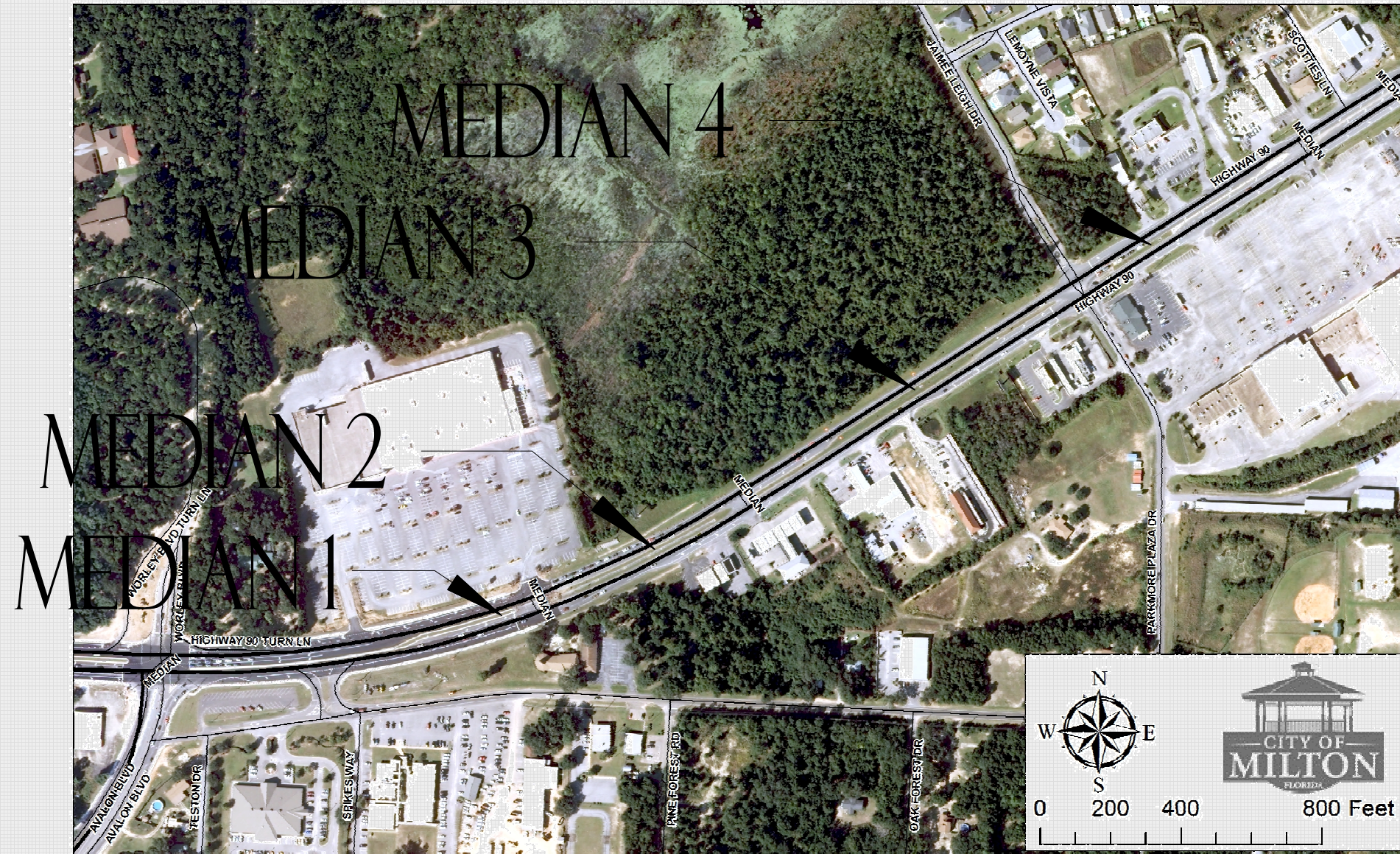



ROADSIDE BEAUTIFICATION ASSISTANCE PROGRAM
CITY OF MILTON, FL
S.R. 10/ U.S. 90 EAST OF AVALON
MEDIAN LANDSCAPE IMPROVEMENTS
FPID # 440107-3-58-01

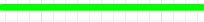

LEGEND

SYMBOL	DESCRIPTION
	GAS LINE
	SEWER LINE
	WATER LINE
	STREETS

LEGEND				
	COMMON NAME	BOTANICAL NAME	SIZE	QTY
FLOWER, GRASS				
	BREEZE GRASS	LOMANDRA LONGIFOLIA	1 GAL	73
	FAKAHATCHEE GRASS	PENNISETUM 'PRINCESS'	3 GAL	309
	GRASS, MULHY PINK	MUHLENBERGIA CAPILLARIS	3 GAL	429
FLOWER, PERENNIAL				
	FLAX LILY	DIANELLA TASMANICA 'VARIEGATA'	1 GAL	634
	GARLIC, SOCIETY TRICOLOR	TULBAGHIAVIOLACEA	1 GAL	204
SHRUB, DECIDUOUS				
	ROSE, MINIATURE, RED	ROSA HYBRID 'RED SUNBLAZE'	3 GAL	657
SHRUB, EVERGREEN BROADLEAF				
	CAMELLIA, SHISHI	CAMELLIA HIEMALIS SHISHI-GASHIRA	3 GAL	14
	BURGUNDY LOROPETALUM "PURPLE PIXIE"	LOROPETALUM CHINENSE 'PURPLE PIXIE'	3 GAL	51
	GULF GREEN HAWTHORN	RHAPHIOLEPIS UMBELLATA 'GULF GREEN'	3 GAL	113
	YEW, DWARF	TAXUS CUSPIDATA	3 GAL	172
TREE, DECIDUOUS				
	CRAPEMYRTLE, PINK-RED	LAGERSTROEMIA 'TUSKEGEE'	10' - 12'	6

* "CELEBRATION" BERMUDA APPROX 22,860 SQ. FT.

NOTES

ATTACHMENT #2

- SURFACE AND SUBSURFACE SURVEY INFORMATION TAKEN FROM FDOT DRAWINGS
- ALL MEDIAN AREAS THAT WILL BE PLANTED OR SODDED WILL BE TREATED WITH GLYPHOSPHATE HERBICIDE PRIOR TO BEGINNING WORK. HERBICIDE TREATMENTS WILL BE REPEATED TWO WEEKS AND FOUR WEEKS AFTER INITIAL TREATMENT. NO OTHER WORK WILL BEGIN UNTIL ACCEPTANCE OF HERBICIDE TREATMENT BY CITY OF MILTON
- ALL PLANTS WILL MEET OR EXCEED STANDARDS FOR FLORIDA NUMBER 1 GRADE. SELECT PLANTS FOR UNIFORMITY OF SIZE AND COLOR. PLANTS PICTURES WILL BE PROVIDED FOR APPROVAL.
- PLANT HOLES WILL BE DUG AS SHOWN BELOW AND ENRICHED WITH BIOPLEX 5-IN-1 COMPLETE PLANTING GRANULES AT MANUFACTURER'S RECOMMENDED RATES. ALL PLANTS ARE TO BE INSTALLED 1/2 INCHES ABOVE GRADE
- ALL PLANTING AREAS WILL BE MULCHED WITH 3 INCHES OF SETTLED PINE STRAW
- AFTER PLANTING, PRE-EMERGENT HERBICIDE WILL BE APPLIED TO ALL PLANTING AREAS
- LOCATE AND PREVENT DAMAGE TO UNDERGROUND UTILITIES AND ALL OTHER SITE IMPROVEMENTS. CONTRACTOR TO CALL SUNSHINE 811 AT LEAST 3 BUSINESS DAYS PRIOR TO ANY CONSTRUCTION.
- MANY AREAS OF PLANTING ARE LOCATED WITHIN STORMWATER DRAINAGEWAYS. GRADES IN THESE AREAS WILL NOT BE SIGNIFICANTLY CHANGED, SINCE THE REMOVAL OF 2 INCHES OF SOIL IN THESE AREAS WILL OFFSET THE IMPORTANCE OF PLANT ROOTBALLS AND DISTRIBUTION OF SOIL EXCAVATED FOR PLANTING. THE FLOW OF WATER IN THESE AREAS MAY BE SLIGHTLY IMPEDED, BUT NOT STOPPED, RESULTING IN MORE WATER PERCOLATING INTO THE SOIL RATHER THAN FLOWING INTO STORM SEWERS. SOME OF THE PINESTRAW MULCH COULD BE DISPLACED BY STORMWATER
- SOIL ANALYSIS WILL BE PROVIDED TO THE CITY OF MILTON PRIOR TO WORK BEGINNING.
- ALL EXISTING LIGHTING TO REMAIN.
- CONTRACTOR TO MAINTAIN SILT FENCE, OR ANY OTHER FORM OF EROSION CONTROL AT ALL TIMES.
- CONTRACTOR TO MAINTAIN TRAFFIC CONTROL THAT COMPLIES WITH DOT REQUIREMENTS FDOT DESIGN STANDARDS 600 SERIES.
- ALL PLANTINGS TO BE 24" FROM EDGE OF ROADWAY
- THE FOLLOWING UTILITY MEMBERS NEED TO BE CONTACTED DIRECTLY:

440107-3-58-01			
City of Milton JPA			
Santa Rosa County			
Utility Owners			
Company	Contact Person	Contact Number	Email Address
American Traffic Solutions	Jason Lang	(330) 807-3611	jason.lang@atsol.com
AT&T	Steve Hamer	(813) 888-8300	shamer@sdt-1.com
AT&T Florida	Steve Kennington	(850) 623-3811	sk1674@att.com
City of Milton	Joe Cook	(850) 983-5434	joe.cook@cl.milton.fl.us
Gulf Power Company	Chad Swails	(850) 429-2446	ceswails@southemco.com
Level 3 Communications	Michael Nunez	(720) 888-0916	michael.nunez@level3.com
Pace Water System	Rachel Lee	(850) 994-5129	rlee@pacewater.org
Southern Light	Andru Bramblett	(251) 662-1170	abramblett@sifiber.com
Verizon Business	Chuck Brunick	(407) 257-6135	chuck.brunick@verizon.com

PLANT MATERIAL SHALL NOT BE PRUNED PRIOR TO INSTALLATION - AFTER PLANT HAVE BEEN INSTALLED, EACH PLANT SHALL BE PRUNED FOR UNIFORMITY

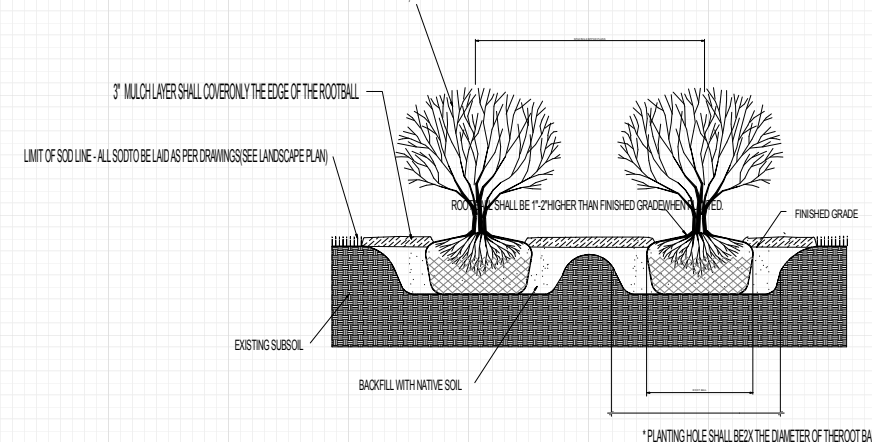

← KMART →

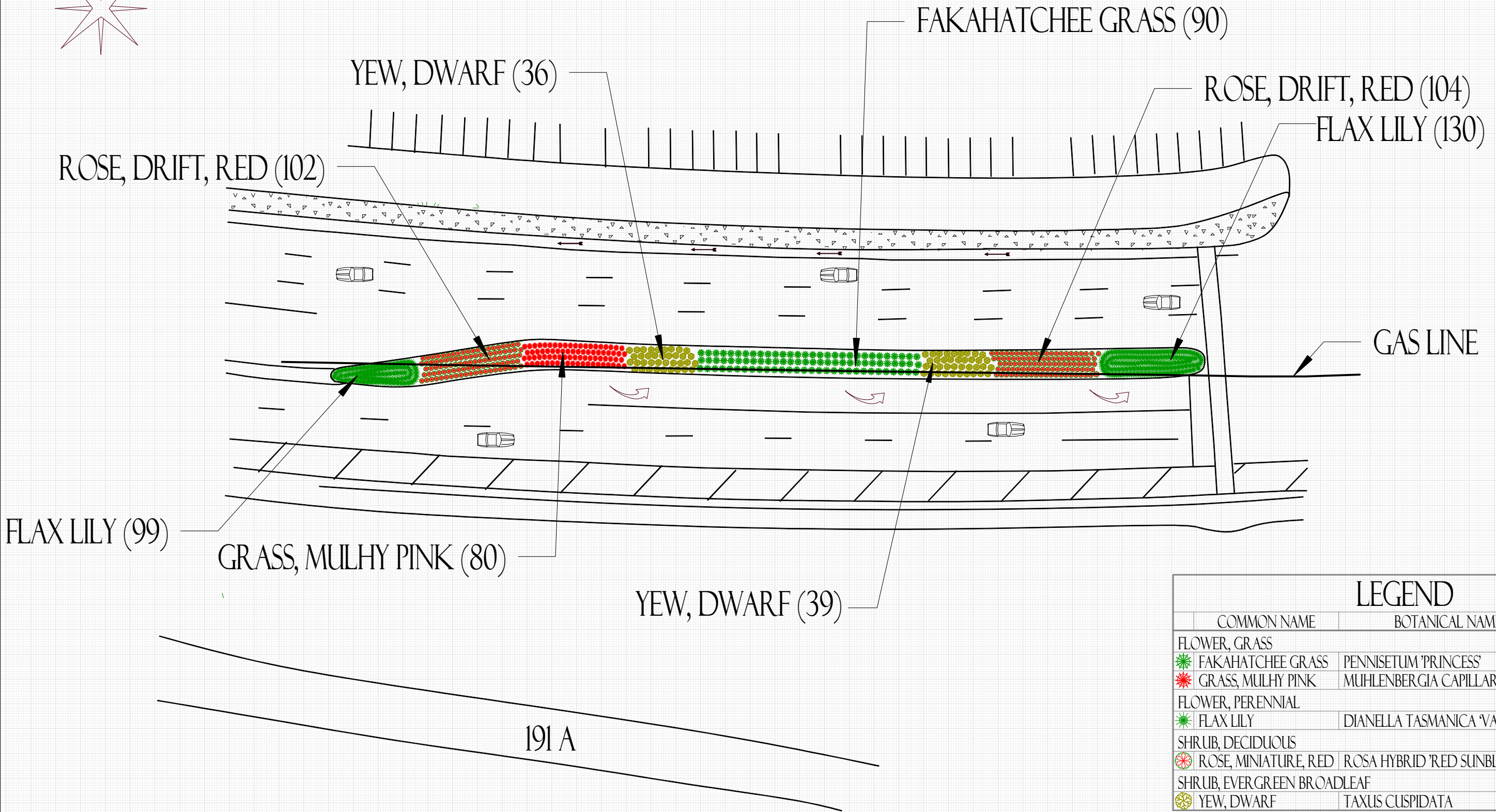
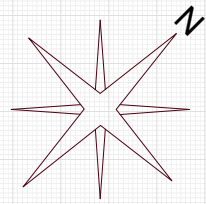

LEGEND				
COMMON NAME	BOTANICAL NAME	SIZE	QTY	
FLOWER, GRASS				
FAKAHATCHEE GRASS	PENNISETUM 'PRINCESS'	3 GAL	90	
GRASS, MULHY PINK	MUHLENBERGIA CAPILLARIS	3 GAL	80	
FLOWER, PERENNIAL				
FLAX LILY	DIANELLA TASMANICA 'VARIEGATA'	1 GAL	229	
SHRUB, DECIDUOUS				
ROSE, MINIATURE, RED	ROSA HYBRID 'RED SUNBLAZE'	3 GAL	206	
SHRUB, EVERGREEN BROADLEAF				
YEW, DWARF	TAXUS CUSPIDATA	3 GAL	75	

Revision #:
Date: 3/23/2017

Landscape Plan:
Hwy 90 West Median 1

Scale:
1" = 40'

Landscape Design by: Lee W
City of Milton, FL

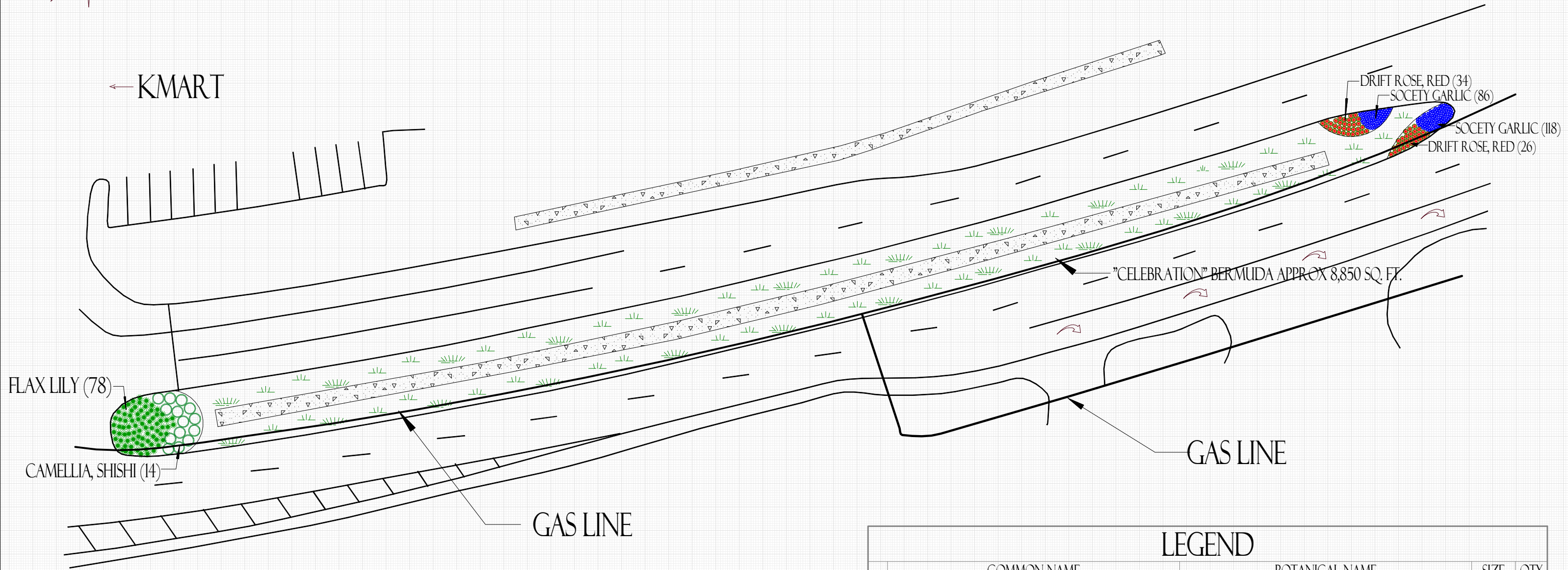
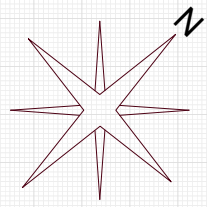

LEGEND				
	COMMON NAME	BOTANICAL NAME	SIZE	QTY
	FLOWER, PERENNIAL			
	FLAX LILY	DIANELLA TASMANICA 'VARIEGATA'	1 GAL.	78
	GARLIC, SOCIETY TRICOLOR	TULBAGHIAVIOLACEA	1 GAL.	204
	SHRUB, DECIDUOUS			
	ROSE, MINIATURE, RED	ROSA HYBRID 'RED SUNBLAZE'	3 GAL.	60
	SHRUB, EVERGREEN BROADLEAF			
	CAMELLIA, SHISHI	CAMELLIA HIEMALIS SHISHI-GASHIRA	3 GAL.	14

Revision #:
Date: 3/23/2017

Landscape Plan:
Hwy 90 West Median 2

Scale:
1" = 40'

Landscape Design by: Lee W
City of Milton, FL

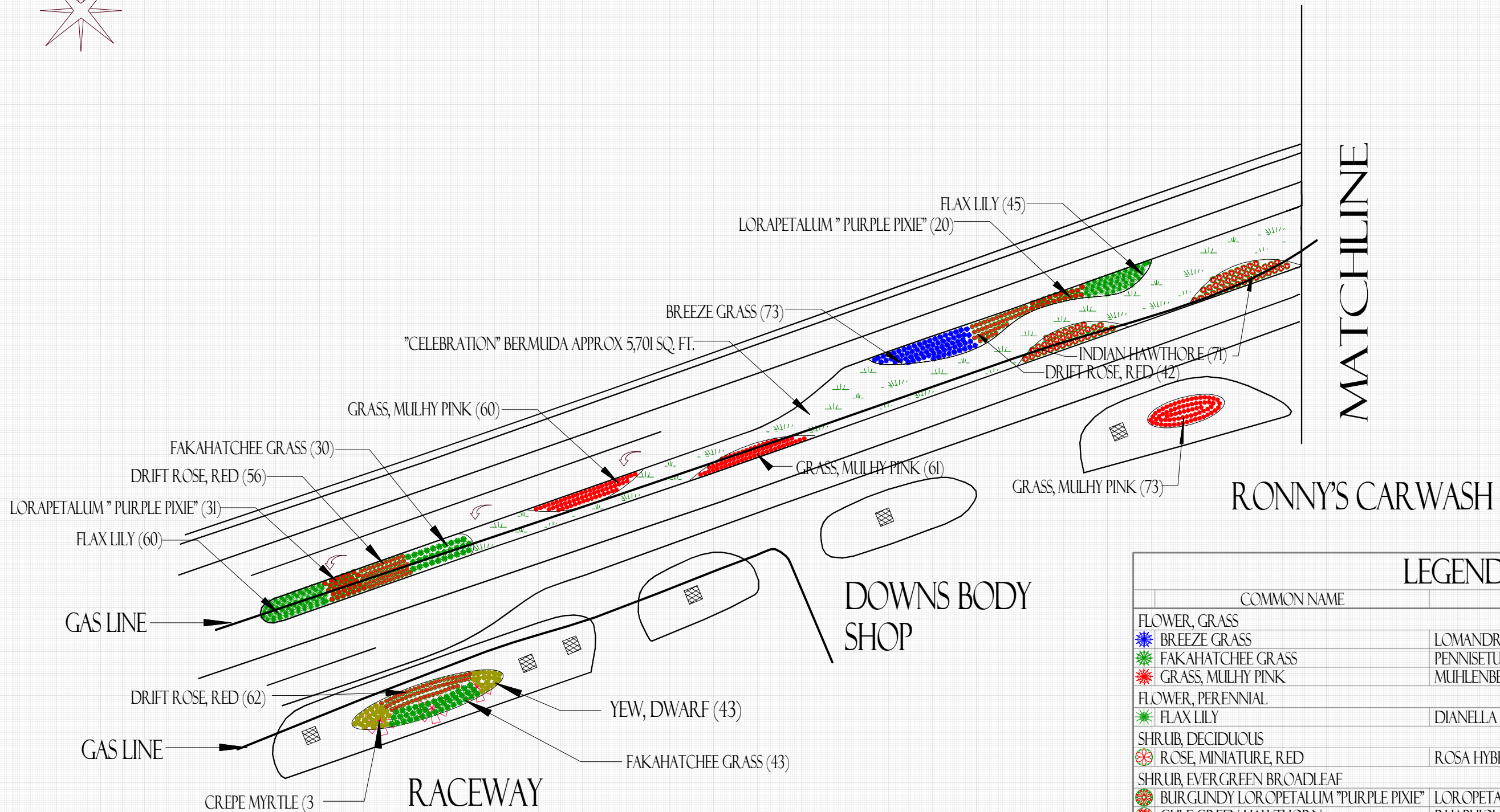
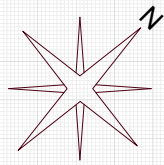

LEGEND				
COMMON NAME	BOTANICAL NAME	SIZE	QTY	
FLOWER, GRASS				
BREEZE GRASS	LOMANDRA LONGIFOLIA	1 GAL	73	
FAKAHATCHEE GRASS	PENNISETUM 'PRINCESS'	3 GAL	71	
GRASS, MULHY PINK	MUHLENBERGIA CAPILLARIS	3 GAL	194	
FLOWER, PERENNIAL				
FLAX LILY	DIANELLA TASMANICA 'VARIEGATA'	1 GAL	105	
SHRUB, DECIDUOUS				
ROSE, MINIATURE, RED	ROSA HYBRID 'RED SUNBLAZE'	3 GAL	158	
SHRUB, EVERGREEN BROADLEAF				
BURGUNDY LOROPETALUM "PURPLE PIXIE"	LOROPETALUM CHINENSE 'PURPLE PIXIE'	3 GAL	51	
GULF GREEN HAWTHORN	RHAPHIOLEPIS UMBELLATA 'GULF GREEN'	3 GAL	71	
YEW, DWARF	TAXUS CUSPIDATA	3 GAL	43	
TREE, DECIDUOUS				
CRAPEMYRTLE, PINK-RED	LAGERSTROEMIA 'TUSKEGEE'	10' - 12'	3	

Revision #:
Date: 3/23/2017

Landscape Plan:
Hwy 90 West Median 3A

Scale:
1" = 50'

Landscape Design by: Lee W
City of Milton, FL

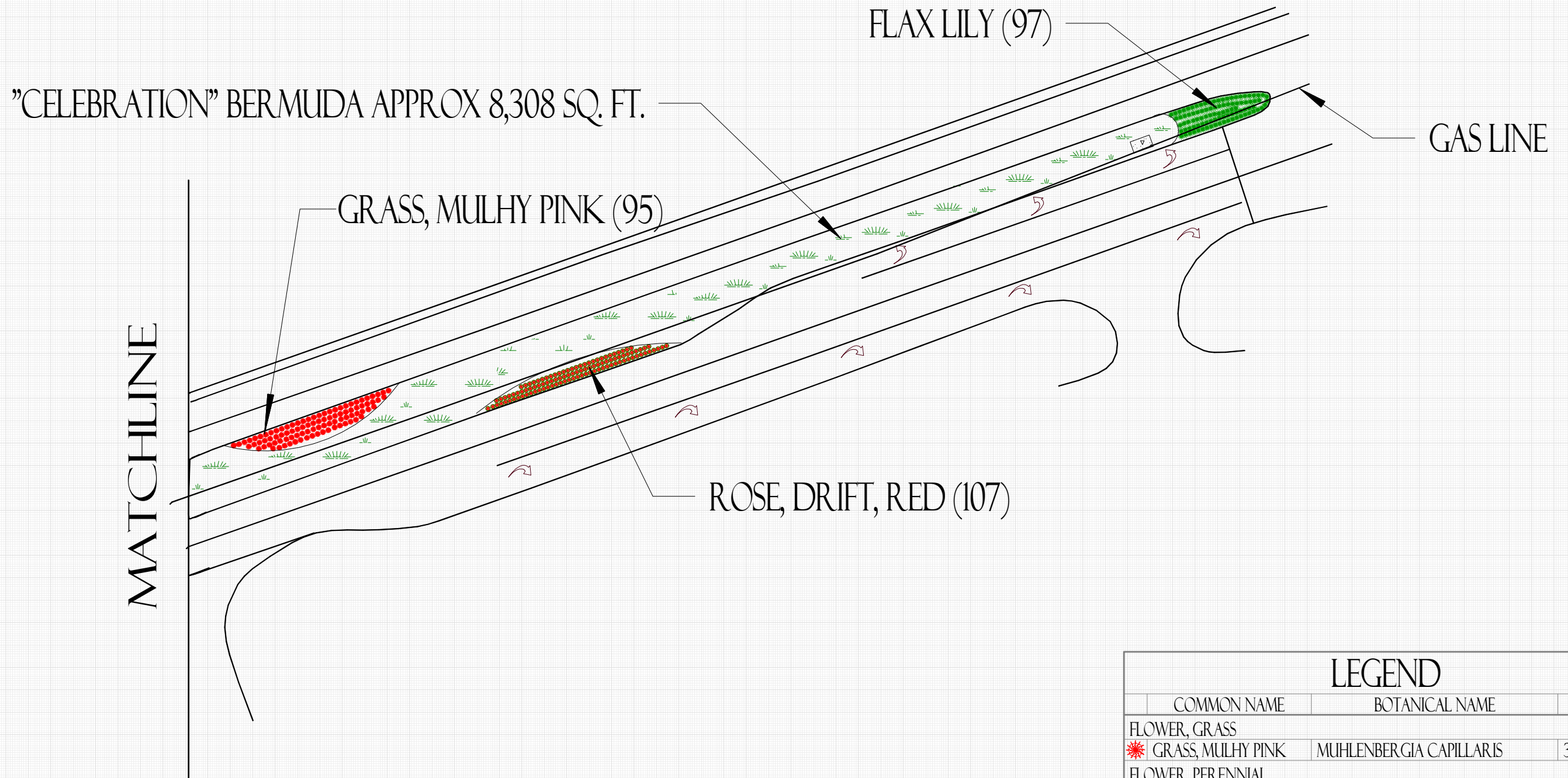
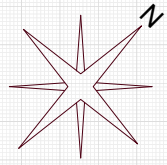

LEGEND			
COMMON NAME	BOTANICAL NAME	SIZE	QTY
FLOWER, GRASS			
GRASS, MULHY PINK	MUHLENBERGIA CAPILLARIS	3 GAL	95
FLOWER, PERENNIAL			
FLAX LILY	DIANELLA TASMANICA 'VARIEGATA'	1 GAL	97
SHRUB, DECIDUOUS			
ROSE, MINIATURE, RED	ROSA HYBRID 'RED SUNBLAZE'	3 GAL	107

Revision #:
Date: 3/23/2017

Landscape Plan:
Hwy 90 West Median 3B

Scale:
1" = 50'

Landscape Design by: Lee W
City of Milton, FL

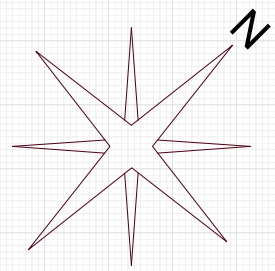

JAMIEE LEIGH DR

FLAX LILY (84)

YEW, DWARF (54)

ROSE, DRIFT, RED (100)

GRASS, MULHY PINK (60)

FAKAHATCHEE GRASS (72)

GAS LINE

FAKAHATCHEE GRASS (38)

FLAX LILY (41)

INDIAN HAWTHORN (21)

CREPE MYRTLE (3)

ROSE, DRIFT, RED (26)

FAKAHATCHEE GRASS (38)

INDIAN HAWTHORN (21)

OLLIES

LEGEND

COMMON NAME	BOTANICAL NAME	SIZE	QTY
FLOWER, GRASS			
FAKAHATCHEE GRASS	PENNISETUM 'PRINCESS'	3 GAL	148
GRASS, MULHY PINK	MUHLENBERGIA CAPILLARIS	3 GAL	60
FLOWER, PERENNIAL			
FLAX LILY	DIANELLA TASMANICA 'VARIEGATA'	1 GAL	125
SHRUB, DECIDUOUS			
ROSE, MINIATURE, RED	ROSA HYBRID 'RED SUNBLAZE'	3 GAL	126
SHRUB, EVERGREEN BROADLEAF			
GULF GREEN HAWTHORN	RHAPHIOLEPIS UMBELLATA 'GULF GREEN'	3 GAL	42
YEW, DWARF	TAXUS CUSPIDATA	3 GAL	54
TREE, DECIDUOUS			
CRAPEMYRTLE, PINK-RED	LAGERSTROEMIA 'TUSKEGEE'	10' - 12'	3

Revision #:
Date: 3/23/2017

Landscape Plan:
Hwy 90 West Median 4

Scale:
1" = 30'

Landscape Design by: Lee w
City of Milton, FL

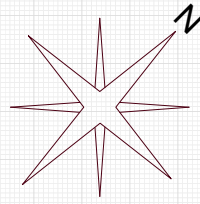

Irrigation Schedule

Symbol Manufacture/Model/Description

- 2.5 inch sch 40 mainline
- 12 Rainbird 1812 series
12" pop-up
- R Rainbird 5000 series
4" Rotor
- + 2 inch rainbird pga electric
remote valve
- C Rainbird ESP-LXD with Pedestal

New 4" Sch 40 PVC Sleeve by contractor
(all bores must meet FDOT requirements)
Bores require permitting by FDOT per Administrative
Code Chapter 14-46 and must comply with
Utility Accommodation Manual 2010

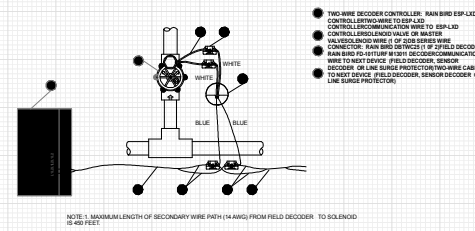

Electric Remote Control Valve With Decoder

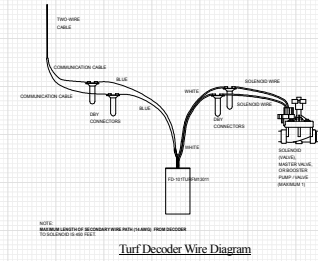

Turf Decoder Wire Diagram

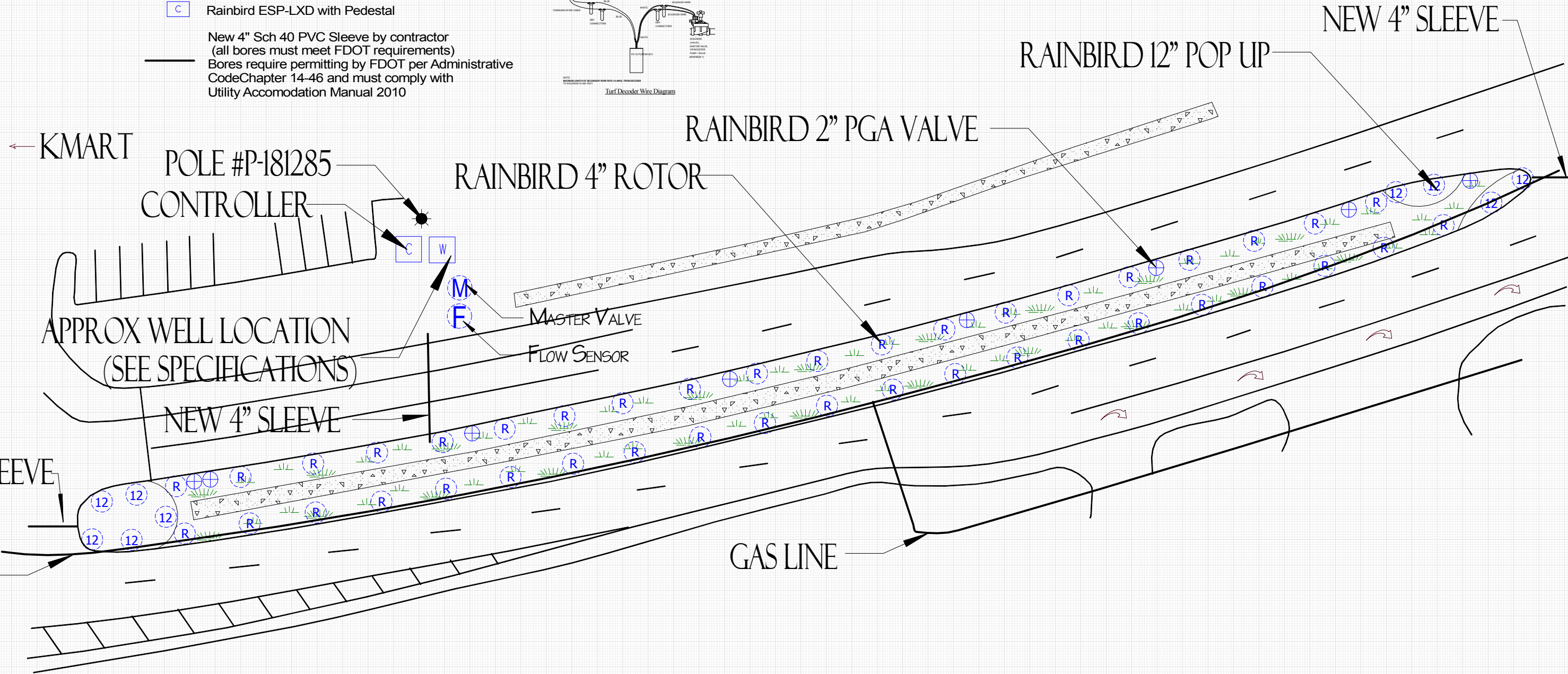

Revision #:
Date: 3/23/2017

Scale:
1" = 40'

Landscape Plan:
Hwy 90 West Median 2 Irrigation

Landscape Design by: Lee W
City of Milton, FL

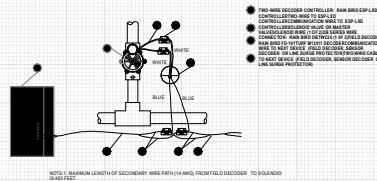
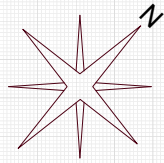

Electric Remote Control Valve With Decoder

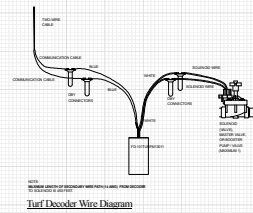

Irrigation Schedule

Symbol Manufacture/Model/Description

2.5 inch sch 40 mainline

⊕ Rainbird 1812 series 12" pop-up

⊕ Rainbird 1806 series 6" pop-up

⊕ 2 inch rainbird pga electric remote valve

New 4" Sch 40 PVC Sleeve by contractor
(all bores must meet FDOT requirements)
Bores require permitting by FDOT per Administrative Code Chapter 14-46 and must comply with Utility Accommodation Manual 2010

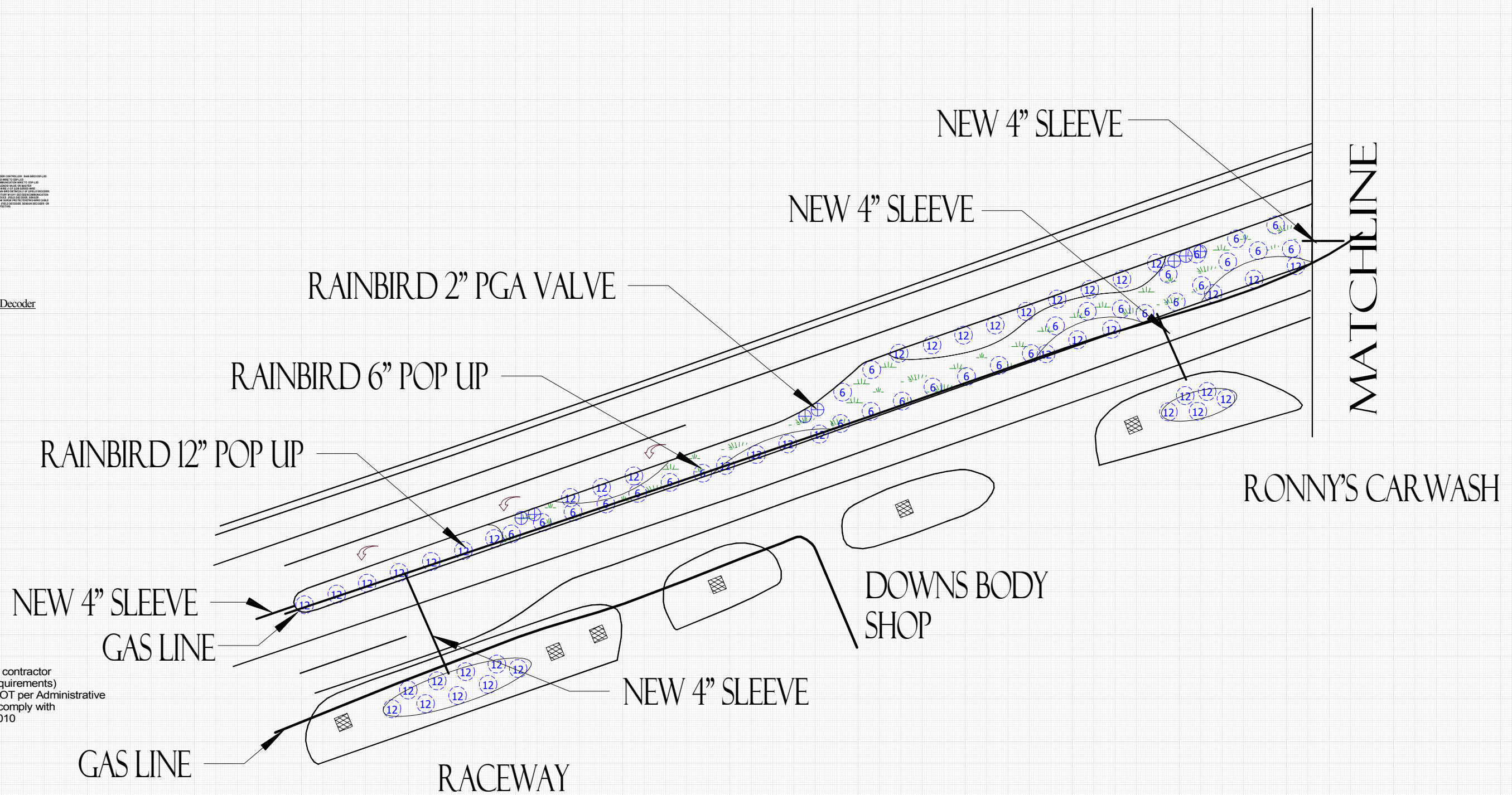

Revision #:
Date: 3/23/2017

Scale:
1" = 50'

Landscape Plan:
Hwy 90 West Median 3A Irrigation

Landscape Design by: Lee W
City of Milton, FL

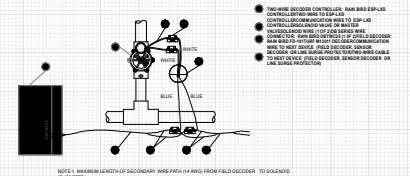
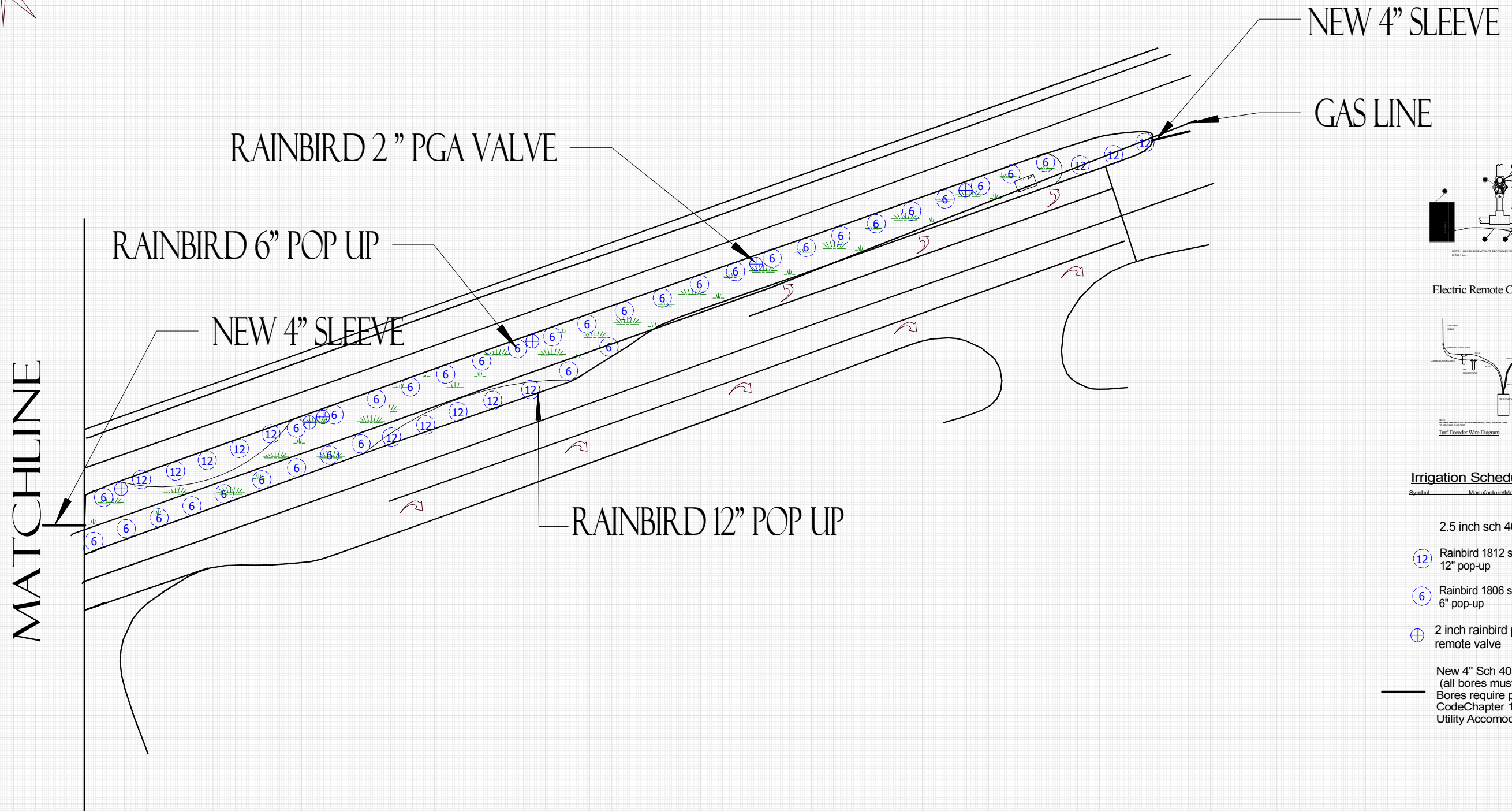
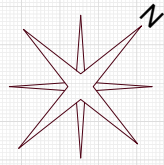

Electric Remote Control Valve With Decoder

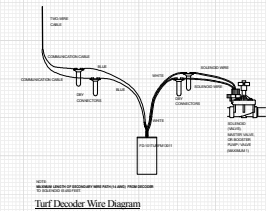

Irrigation Schedule

Symbol	Manufacture/Model/Description
—	2.5 inch sch 40 mainline
⊕	Rainbird 1812 series 12" pop-up
⊕	Rainbird 1806 series 6" pop-up
⊕	2 inch rainbird pga electric remote valve
—	New 4" Sch 40 PVC Sleeve by contractor (all bores must meet FDOT requirements) Bores require permitting by FDOT per Administrative Code Chapter 14-46 and must comply with Utility Accomodation Manual 2010

Revision #:
Date: 3/23/2017

Landscape Plan:
Hwy 90 West Median 3B Irrigation

Scale:
1" = 50'

Landscape Design by: Lee W
City of Milton, FL

IRRIGATION SCHEDULE

SYMBOL MANUFACTURE/MODEL/DESCRIPTION

	RAIN BIRD 5004-MPR TURF ROTOR, 4" POP-UP
	RAIN BIRD 1812 POP-UP 15 SERIES MPR SHRUB SPRAY
	RAIN BIRD 1806 POP-UP 15 SERIES MPR SHRUB SPRAY
	RAIN BIRD PGA ELECTRIC REMOTE CONTROL VALVE 2"
	2.5" PVC SCH 40 MAINLINE

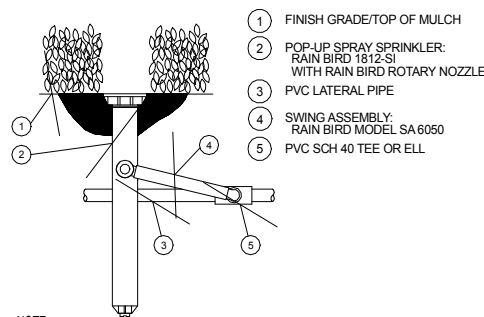

NOTE:
SIDE INLET CONNECTION SHOULD NOT BE USED IN FREEZING CLIMATES.

1812 Pop-up Spray Head w/ Side Inlet with Swing Pipe

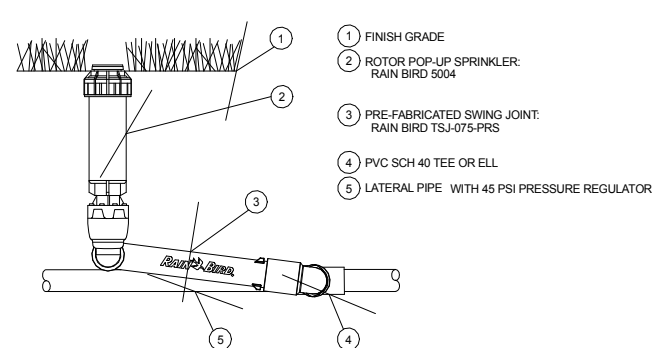

5004 Series Pop-up Rotors

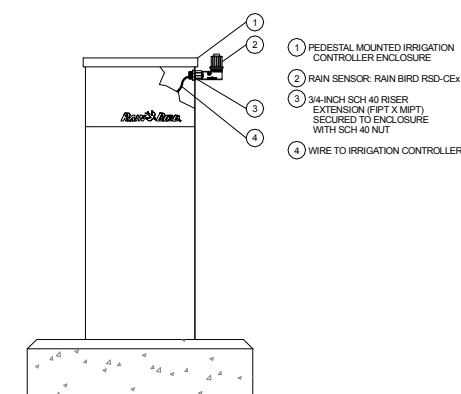

RSD-CEX RAIN SENSOR, PEDESTAL MOUNT

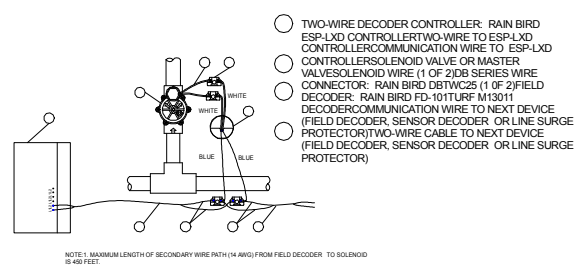

Electric Remote Control Valve With Decoder

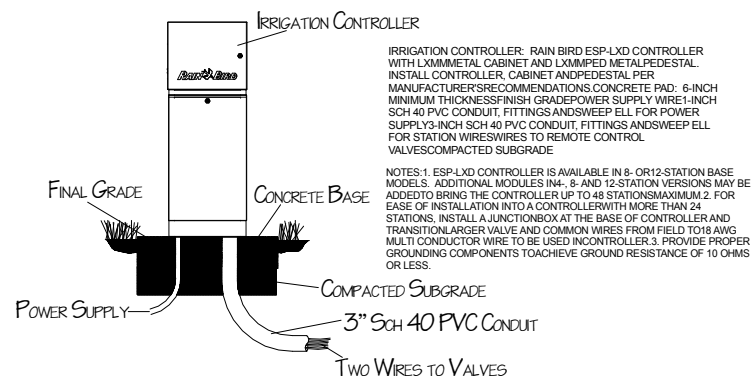

ESP50LXD Controller with Metal Enclosure & Pedestal

IRRIGATION NOTE:

IRRIGATION HEADS TO BE A MINIMUM OF 24" FROM EDGE OF ROADWAY

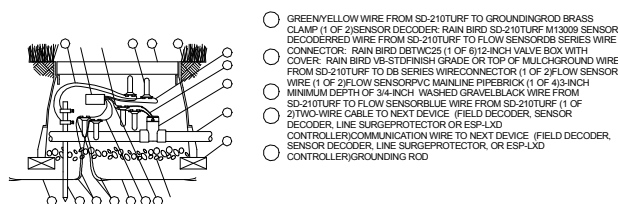

NOTES: 1. MAXIMUM LENGTH OF SECONDARY WIRE PATH (14 AWG) FROM DECODER TO RELAY IS 450 FEET. 2. PLACE 3 FEET OF EXTRA WIRE IN VALVE BOX FOR EASY SERVICING. 3. IN A SITE CONTROL DECODER SYSTEM A PULSE TRANSMITTER (PT322) SHOULD BE INSTALLED BETWEEN THE SENSOR DECODER AND THE FLOW SENSOR. THIS IS NOT NEEDED IN AN ESP-LXD CONTROLLER SYSTEM. 4. GROUNDING SHOULD BE TO 10 OHMS OR LESS.

Sensor Decoder and Flow Sensor

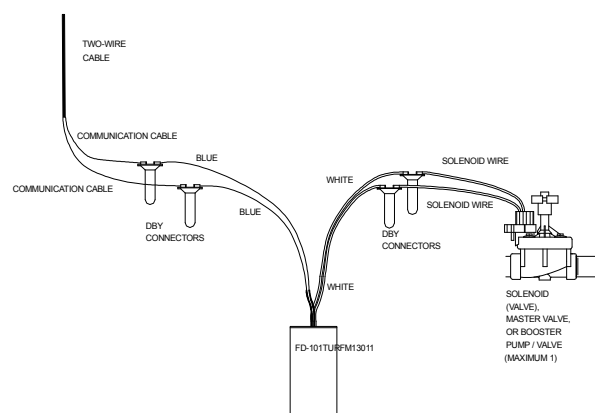

NOTE:
MAXIMUM LENGTH OF SECONDARY WIRE PATH (14 AWG) FROM DECODER TO SOLENOID IS 450 FEET.

Turf Decoder Wire Diagram

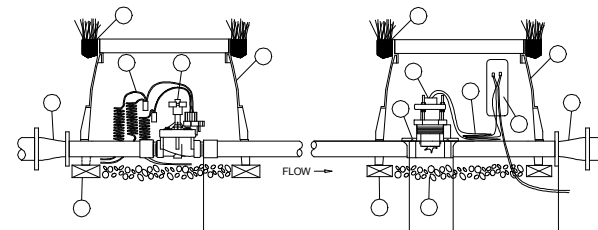

SITE CONTROL MASTER VALVE (NORMALLY OPEN) AND INSERTION STYLE FLOW SENSOR SATELLITE SYSTEM

○ NORMALLY OPEN MASTER VALVE(S) 3/6-INCH LENGTH OF COILED WIRE TO SATELLITE CONTROLLER SPARE STATION 3-INCH MINIMUM DEPTH OF 3/4-INCH WASHED GRAVEL BRICK (1 OF 4) VALVE BOX WITH COVER - 12-INCH SIZE FINISH GRADE RAIN BIRD FS SERIES 350 FLOW SENSOR(S) 3/6-INCH LENGTH OF COILED PE-CABLE TO FLOW SENSING EQUIPMENT AT CCU/SATELLITE CONTROLLER ASSEMBLY DOUBLE-STRAP SADDLE SEE SITE CONTROL DETAIL 612 FOR SPLICE. SEE FLOW SENSOR DETAIL FOR WIRING DIAGRAM. CONCENTRIC REDUCER

Revision #:

Date: 4/12/2017

Scale:

1/8" = 1'

Landscape Plan:

U.S 90 West Irrigaiton Detail

Landscape Design by: Lee W

City of Milton, FL

CITY OF MILTON
U. S. 90 PLANTED AREAS LANDSCAPE IMPROVEMENTS
S.R.10/US 90 FROM AVALON BLVD TO JAIMEE LEIGH DR

SPECIFICATION – TREES, SHRUBS, OTHER PLANTINGS and MISCELLANEOUS ITEMS

1. This work shall consist of furnishing and planting materials in the locations shown on the plans or as directed by the CITY.

1.1 Installer Qualifications: The CONTRACTOR shall have at least five (5) years experience in landscape installation. Further, the CONTRACTOR shall maintain an experienced full time supervisor on the PROJECT site when work is in progress. All pesticides and herbicides shall be licensed for commercial applications.

2. Materials:

2.1. All shrubs, groundcover and other plantings shall be purchased from Florida based Nurseryman Stock that comply with all required inspection, grading standards and plant regulations in accordance with the latest edition of the Florida Department of Agriculture’s “Grades and Standards for Nursery Plants” and American Standard for Nursery Stock, ANSI Z 60.1.

Unless otherwise specified, minimum grade for all plants is Florida No. 1 or better. All plants must be the specified size and grade at the time of delivery to the site and the minimum grade maintained throughout the project construction period and plant establishment period. All plants shall be free of insects and disease.

Use only plants that are true to type and species and ensure that the plants not specifically covered by the above grades and standards conform in type and species with the standards and designations in general acceptance by Florida nurseries. Prior to planting, furnish certification to the CITY that all plant materials have been purchased from Florida based Nurseryman Stock.

A minimum of two (2) plants of each species on each shipment must be shipped with tags stating botanical nomenclature and common name of the plant. Should discrepancies between botanical nomenclature and common name arise; the botanical name will take precedence.

2.2. Other: All mulch will be clean pine straw installed to the depth indicated on the drawings. Use of Cypress Mulch will not be allowed. There is to be no trace of the invasive Japanese Climbing Fern.

3. Planting Requirements:

3.1. Delivery: All materials must be available for inspection before delivery and installation and will be subject to approval or rejection.

- 3.2. Layout: CONTRACTOR shall mark all proposed planting beds and individual locations of shrubs as shown for the CITY'S review, prior to excavation or planting. The CITY may also request to review all proposed construction and maintenance practices before the start of the construction.
- 3.3. Soil Drainage: All planting holes and beds must drain sufficiently prior to installing any plants. Due to the location and contour of each median, the CONTRACTOR shall ensure that all drain inlets are free of debris and unobstructed. Some planting locations changes may be necessary as the result of the actual drain inlet locations.
- 3.4. Installation: All existing medians shall be stripped of plantings and grasses. The CONTRACTOR shall follow the herbicide treatment outline on the drawings or as may be approved by the CITY. All other planting and grass to be removed may become the property of the contractor. If not used, the CONTRACTOR will dispose all unused or surplus materials, spoil and debris generated on site.

In advance of planting, the City of Milton shall collect soil samples from at least four (4) different median locations and have tested for ph and other constituents that may be required for healthy growing conditions. Based on the results, the CONTRACTOR shall treat the soils to meet prime growing conditions. Any imported soils shall also be tested and treated (if needed prior to use. 16-4-8 slow-release granular fertilizer (25 pounds per 1,000 square to be installed 4-6 weeks after installation of turf.

The CONTRACTOR will ensure that all soil receiving new plantings shall be thoroughly watered prior to and after installation of the material

- 3.5 Irrigation: Irrigation will be installed per plans, any changes must be approved by the City of Milton. As-builts (3 copies) will be provided by the CONTRACTOR to the City of Milton at time of final acceptance. Irrigation will be installed to avoid over-spray on pavement.
- 3.6 Care: The CONTRACTOR will be responsible for care and maintenance of all plantings immediately after each planting and until final inspection and acceptance has been made by the CITY. Keep all plantings watered, fertilized, mulched, pruned, weeded and staked/guyed as necessary throughout the duration of the project and as may be required by the warranty to ensure they are healthy and undamaged. **The CITY to begin the maintenance upon final acceptance.** Any plantings that, in the judgment of the CITY, are not in a healthy growing condition at the time of final plant inspection shall be replaced by the contractor at no additional expense to the CITY.



- 3.7 Disposal of Surplus Materials: The CONTRACTOR shall (on a routine basis) remove from the PROJECT any surplus excavated material from plant holes, plantings not used and construction materials and dispose of at his own expense.
 - 3.8 Erosion Control: The CONTRACTOR will take all steps necessary to prevent erosion with the use of silt fences and other devices during the length of the PROJECT.
4. Warranty: All new plantings shall be warranted for a period of one (1) year from the date of final PROJECT acceptance. For the period during construction and up to the final PROJECT acceptance, the CONTRACTOR shall mow, weed, irrigate and maintain the entire PROJECT. Then, each month after, during the warranty period, the CONTRACTOR shall inspect the PROJECT along with CITY personnel for any defects. Any defects found shall be corrected as soon as possible or as agreed to by the CITY. For the warranty period, the CONTRACTOR will provide to the CITY a PERFORMANCE/WARRANTY BOND in the amount equal to the total contract. The cost of this Bond will be included in the amount of the bid for the PROJECT.
5. Work Zone Safety: Since all work will be within the FDOT right-of way, all Maintenance of Traffic (MOT) and other conditions of the FDOT Permit will be followed. A copy of the Permit will be available for review by the CONTRACTOR prior to bidding. In addition, many of the medians have BURIED TELEPHONE CABLES and a HIGH PRESSURE GAS MAIN located within them. EXTRA PRECAUTION will be required when digging around or above them. As with ALL land disturbance operations, the CONTRACTOR will be require to call SUNSHINE STATE ONE CALL (811) to provide locations of underground utilities. It may become necessary to make minor adjustments to the plant installation locations based on the actual locations of these utilities. Utility locations shown on the plans are for general reference only.
6. Sanitation: The CONTRACTOR shall, for the life of the PROJECT, furnish temporary sanitary facilities at a location near where the work is being completed.
7. Method of Measurement: The CONTRACT is based on a UNIT PRICE measurement; therefore, the final payment amount will be based on actual measured in-place quantities.
8. Submittals of all plant material and irrigation will be provided by the CONTRACTOR to the City of Milton, prior to any work beginning.
9. In addition to the specifications above, governing FDOT Standards and Specifications shall apply, including, but not limited to the following:
 - Standard Specification 165 – Prepared Soil Layer
 - Standard Specification 570 – Performance Turf

ATTACHMENT #2

- Standard Specification 580 – Maintenance Supplemental Specification
- Standard Specification 987 – Prepared Soil Layer Materials
- Design Standard Index 544 – Landscape Installation
- Design Standard Index 546 – Sight Distance at Intersections
- Design Standard Index 600 Series – Traffic Control
- Design Standard Index 700 – Roadside Offsets



LEGEND

-  Sewer Lines
-  Streets
-  Gas Lines



0 200 400 800 Feet



Roadside Beautification Assistance Program
SR 10/ US 90 from Avalon Blvd to Jamiee Leigh Dr
FDIP# 440107-3-58-01

1. Well installation (see attached location) to include the following:
 - 4" State Well Permit
 - Set back exemption and paperwork
 - Drilling per foot 4" well steel casing
 - 4" 188ft wall steel
 - 4" * 20' stainless steel well screen
 - Grouting of well for setback exemption
 - 7.5 hp 3 phase 230 volt motor
 - 85 gpm 7.5hp pump end
 - 7.5 1 PH in 3/ PH out 230 volt
 - PC 66 Flexcon tank
 - Misc fittings/pipe/pressure gauge and relief valve
 - 2" Sch 80 PVC drop pipe
 - 2" galvanized coupling
 - 10/4 flat double insulated wire
 - 2" galvanized T
 - Vac truck to remove drill mud from site

Specifications provided by Clydes Well Service

Contact Clydes Well Service for pricing: (850) 675-6230

5624 Pasture Ln. Jay, FL 32565