

TERREBONNE

Parish School District

**Request for Bids
For**

Kitchen Equipment

Bid# 121218

ADVERTISEMENT FOR BIDS

Notice is hereby given that the Terrebonne Parish School Board will receive sealed bids at its Purchasing Department, 340 St. Charles Street, Building #3, Houma, Louisiana, until the hour of **2:00PM, December 12, 2018 for Kitchen Equipment. Any bid received after the specified time and date of 2:00PM on December 12, 2018 will be returned unopened.** Bids will be publicly opened and acknowledged at 2:30PM CST in the Purchasing Department, 340 St. Charles Street, Building #3, Houma, LA 70360 and reviewed by an evaluation committee at a later date.

Bids/quotes received prior to the time of the scheduled opening will be securely kept unopened. Bidders are cautioned to allow ample time for the transmittal of bids by mail or otherwise. Bidders are urged to secure information relative to the probable time of arrival and distribution of mail at the place where the bids are opened. Failure of the U. S. Mail, of any express carrier, or delivery service to timely deliver the bid(s) shall not be considered due cause for the scheduled time of the bid opening to be extended.

Specifications and conditions for bidding may also be obtained from the Terrebonne Parish School Board Child Nutrition Program, 340 St. Charles Street, Building #3, Houma, LA 70360/P. O. Box 5097, Houma, LA 70361, or by phone (985) 876-7407.

Pursuant to R.S. 38:2212 (E), the Terrebonne Parish School Board has partnered with BidSync, LLC and Vendor Registry to distribute bid solicitations, collect responses, and/or allow contractors and vendors the ability to respond through a uniform and secure electronic interactive bidding system. Terrebonne Parish School Board accepts no responsibility for any technical failures via BidSync or Vendor Registry for bid/quote/proposal(s) at any time during the bid process. Electronic responses placed on the www.bidsync.com will be accepted as specified in each bid/quote/proposal. Bidders participating in the Bidsync option need to register with BidSync to obtain a user name and password or call Vendor Support at (801) 765-9245. There is a \$100.00 fee to register and receive e-mail or fax notification of bids and includes the ability to respond electronically to Terrebonne Parish School Board bid solicitations through the BidSync website. In addition, an electronic signature must be provided to complete the electronic bid. Where applicable, and in all construction projects, an electronic bid bond is also required and must be furnished. The referenced signature and bond are not included in the \$100.00 fee and are available from third party companies. Bidders participating with the Vendor Registry option, through the TPSB website, may register, inquire, and/or submit only a quote or proposal, at no additional cost to the bidder. Bids may not be submitted through Vendor Registry.

The Terrebonne Parish School Board reserves the right to use any state, government, or school contract that was properly let for public bidding as a bid for any item(s) where the prices are lower than or equal to the prices submitted by any or all vendors.

The Terrebonne Parish School Board accepts no responsibility for contacting any vendor, failure to contact a vendor, or a vendor not receiving information regarding this bid. This bid has been properly advertised and it is the sole responsibility of any or all Vendors to request and submit bids as advertised. To the extent permitted by applicable state and federal laws and regulations, the Terrebonne Parish School Board reserves the right to reject any or all bids for just cause.

Mr. Roger Dale DeHart, President
TERREBONNE PARISH SCHOOL BOARD

Publication Dates: November 20, 2018
November 28, 2018

TERREBONNE

Parish School District

Bid for Kitchen Equipment

PURPOSE

The Terrebonne Parish School Board (also referred to as the TPSB) is interested in receiving bids from qualified companies (hereinafter referred to as Contractors or qualified providers) to provide Kitchen Equipment to be delivered to school kitchens and warehouse sites based on the items listed on the enclosed forms.

The bid will be a one-time purchase.

CALENDAR OF EVENTS

Release of Invitation to Bid	- 11-20-18
Inquiry/Sample Deadline Date**	- 11-28-18
Bid Due Date	- 12-12-18 (02:00 pm)
Bid Opening Date	- 12-12-18 (02:30 pm)

(The School Board reserves the right to deviate from these dates.)

INQUIRIES

All inquiries must be submitted in writing by November 28, 2018 at 2:00 pm. Inquiries may be emailed to monicawalther@tpsd.org or mailed to 340 St. Charles Street, Building #3, Houma, LA 70361.

The Terrebonne Parish School District, Child Nutrition Program is funded 81% with federal funds for a total of approximately \$7,883,976.00 per year.

SCOPE

Notice is hereby given that the Terrebonne Parish School Board will receive bids for Kitchen Equipment.

Site visits are mandatory for each line item as indicated.

INSTRUCTIONS

The bid with original signatures must be submitted in any of the following methods: hand delivered to the Purchasing Department, Terrebonne Parish School Board, 340 St. Charles Street, Building #3, Houma, LA 70360, mailed to the Terrebonne Parish School Board, P.O. Box, 5097, Houma, LA 70361, or submitted electronically using www.bidsync.com. All hand delivered or mailed bids must be submitted in a sealed envelope plainly marked "**Kitchen Equipment Bid #121218**" as per specifications on Attachment A. Bids shall not be accepted by facsimile or e-mail.

All bids must be submitted on the bid forms provided; copies are permitted. Only bids typed or written in ink and properly signed by an authorized member of the firm or authorized representative will be accepted. Pencil figures, pencil signature, or photo-static copy of signature(s) on the bid forms submitted will disqualify the bid. To request electronic copies of the bid, call 985-876-7407 or email denastoufflet@tpsd.org.

Bid Form:

Indicate on Bid Form the item and price per unit specified. Prices are to be quoted on the brand specified. Bidders are encouraged to bid on all items listed. All items contained in Bid Form are to be quoted net price FOB to TPSB sites regardless of order quantity. Items listed on Bid Form that are left unmarked will be considered just cause to reject the line item bid.

Signature Page:

A signature page is required in the bid submittal. Signature herein guarantees products to be supplied will be against defective material or workmanship and to repair or replace any damage or marring occasioned within transit. In addition, bidder guarantees that the items offered are the manufacturer's standard design in construction and that no changes or substitutions have been made in the items listed in the contract. By signing the signature page, the bidder also agrees to the Terrebonne Parish School District Standard Terms and Conditions and understands the district reserves the right to cancel the contract within thirty (30) days for unsatisfactory performance. Failure of the bidder to complete the bid form and signature page as directed will be just cause to reject the bid as "non-responsive".

Required Federal Forms:

It is our preference that **EACH and EVERY FORM is signed and returned in the bid submittal.** The following forms: Certification Regarding Debarment, Suspension, Ineligibility and Voluntary Exclusion-Lower Tier Covered Transactions form, Certification Regarding Lobbying form, Disclosure of Lobbying Activities form, and Certificate of Independent Price Determination form, should be returned with the bid, but no later than 72 hours after the bid opening. Forms not signed and/or received bid, shall be signed, scanned, and e-mailed or faxed within 72 hours of bid opening. The original shall be sent by USPS or hand delivered within ten (10) days of the bid opening. Failure to comply shall result in your bid being rejected.

Owner Disclosure Certificate:

The Terrebonne Parish School Board, shall require each bidder or bidding entity to attest or submit an attestation that the sole proprietor, partner, incorporator, director, manager, officer, or other like individual who owns at least ten percent (10%) of the bidding entity, has not been convicted of, or has not entered a plea of guilty or nolo contendere (not contest) to any of the crimes or equivalent federal crimes listed in LA R. S. Ann. 38:2227. Signature herein signifies a truthful attestation by the bidding entity. Failure to complete the Owner Disclosure Certificate to its entirety will be just cause to reject the bid as "non-responsive".

Not Bidding on Child Nutrition Program (CNP) Bid

If your company does not wish to bid on the Child Nutrition Program Bid, but would like to remain on our list of vendors for future bids, the enclosed form must be returned. If you do not bid, and the enclosed form is not returned, your company will be removed from the bid list.

General Requirements Kitchen Equipment

1. All prices on this bid are held firm for the period of 60 days from bid opening. This bid will be awarded as a line item bid.
2. Prices shall be held firm for the entire bid period.
3. No sliding scale prices will be accepted. State law forbids cost-plus buying.
4. Errors and corrections to bid price or in preparation of bid must be initialed by the bidder in ink. Failure to do so shall make the item ineligible for award.
5. Terrebonne Parish School Board would prefer contractors who maintain a permanent service department. Bidders who maintain a service department should indicate the number and classification of personnel under his/her employment on the company letterhead and include this with the bid form.
6. The awarded vendor will receive a purchase order as an acknowledgment of award which will be placed in the mail delivered to the address provided in the Bid.
7. The awarded bidder will be the primary contact for all repairs while the awarded product is under warranty, and will immediately upon notification implement action

to have the warranty work done. Further, upon request the apparent successful bidder prior to award will provide contact information regarding warranty work and the manufacturer of each item under consideration. Failure to provide requested information may be just cause to reconsider bid award.

METHOD OF AWARD

This bid will be awarded by line item to the lowest responsible and qualified bidder in each section with consideration given to the quality of the articles that are supplied, conformity to bid specifications, and delivery terms. The TPSB will award this contract to the overall lowest responsive and responsible bidder based on the specified criteria described on Bid Form.

It is the intent to award the bid by line item. Items that have the same number will be awarded together. Example: Item 9a. & 9b will be awarded together.

NON-EXCLUSIVITY

The TPSB reserves the right to award by item, or groups of items; to award contracts to one or more bidders submitting identical bids as to price; to reject any submitting identical bids as to price; and, to reject any and all bids in whole, or in part for just cause.

This agreement is non-exclusive. The TPSB reserves the right to buy any of the bid items using a State Contract, or utilize cooperative purchasing, if more favorable prices become available.

CONTRACT PERIOD

The Terrebonne Parish School Board intends to award all sections of the Bid for a one time purchase. All items purchased shall have a delivery date of 90 days from the issuance of the purchase order.

CERTIFICATE OF INSURANCE

Upon notification, all successful bidders shall provide and maintain for the duration of the award a valid and acceptable Certificate of Insurance prior to any contract offering. Failure to provide the requested Certificate of Insurance within ten (10) days of the request may result in declaring a bid irregular, and therefore subject to rejection. Delays in meeting this requirement may result in loss of bid award and/or future bid awards. Please see the attached Insurance Requirements for Vendors, Service Contractors, or Professional Services for the acceptable minimum coverages.

TERREBONNE

Parish School District

STANDARD TERMS AND CONDITIONS

SCOPE

These Standard Terms and Conditions are pertinent to each Invitation for Bid (IFB), Request for Quote (RFQ), or Request for Proposal (RFP), and each contract, and apply in like force to contracts for the purchase of personal property and contractual services.

All Invitations for Bids, Requests for Quotes, or Requests for Proposals issued by the Terrebonne Parish School Board will bind the bidder to the terms and conditions set forth herein, except as specifically qualified in a special Bid, Quote, or Request for Proposal and contract terms and conditions issued in connection with an individual Bid, Quote, or Proposal.

DEFINITIONS

As used herein, as well as in all specifications, Bids, Quotes, or Request for Proposals, awards or contracts issued by the Terrebonne Parish School Board, the following definitions shall apply, unless otherwise indicated:

Agent - Purchasing Agent of the Terrebonne Parish School Board

Bid - The document comprised of an invitation, instructions, and specifications to submit a Bid, Quote, or Request for Proposal for commodities or services.

Bidder - Any individual, firm, or corporation submitting a Bid, Quote, or Proposal

Contract - The acceptance by the Terrebonne Parish School Board of an offer by a bidder to furnish commodities or services

Contractor - Any individual, firm, or corporation to whom a contract is awarded as the result of a Bid, Quote, or Proposal submitted and accepted

Electronic Bid - A Bid, Quote, or Proposal submitted through a uniform and secure electronic interactive bidding system

Bid or Proposal - The offer of a bidder to furnish commodities or services in response to a Bid, Quote, or Request for Proposal (RFP)

School Board - The Terrebonne Parish School Board/Public School System and Sub-Agency of the State Government of Louisiana

Any alleged oral agreement or arrangement made by a bidder or contractor with any employee of the Terrebonne Parish School Board prior to the official award of this Bid, Quote, or Proposal will be disregarded.

INQUIRIES

An initial inquiry period has been firmly set for all interested bidders to perform a detailed review of the bid documents and to submit any written questions relative thereto. Without exception, all questions SHALL be in writing and received by the close of business on the Inquiry Deadline Date set forth in the Calendar of Events. Further, the school district realizes that additional questions or requests for clarification may generate from the School District's addendum responses to the inquiries received during the initial inquiry period. The school district will make every attempt to clarify questions; however, all bid documents, including but not limited to the specifications, terms, conditions, plans, etc., will stand as written and/or amended by an addendum issued as a result of the deadline to receive inquiries period.

No negotiations, decisions, or actions shall be executed by any bidder as a result of any oral discussions with any TPSD employee or consultant. TPSD shall only consider written and timely communications from bidders.

Inquiries shall be submitted in writing by an authorized representative of the bidder, clearly cross-referenced to the relevant solicitation section. Only those inquiries received by the established deadline shall be considered by the School Board. Answers to questions that change or substantially clarify the solicitation shall be issued by addendum and provided to all perspective bidders. Inquiries concerning this solicitation may be mailed to Terrebonne Parish School District Purchasing Department, Terrebonne Parish School Board, P. O. Box 5097(70361)/340 St. Charles Street, Houma, Louisiana 70360, faxed to (985) 868-2738, or emailed to [E-mail: purchasing@tpsd.org](mailto:purchasing@tpsd.org) for questions regarding the bid. Inquiries regarding bid specifications will be directed to the supervisor of Child Nutrition via fax or mail.

SUBMISSION OF BIDS, QUOTES, AND PROPOSALS

Bids, Quotes, or Proposals must be submitted on, and in accordance with, all specifications and form(s) supplied in the Bid, Quote, or Request for Proposal package. Pursuant to RS 38:2212 (E), the Terrebonne Parish School Board has partnered with BidSync, LLC and Vendor Registry to distribute bid solicitations and/or collect responses. BidSync.com allows contractors and vendors the ability to respond with an electronic signature through a uniform and secure electronic interactive bidding system. Electronic responses placed on www.bidsync.com will be accepted as specified in each bid/quote/proposal. Terrebonne Parish School Board accepts no responsibility for any technical failures via BidSync for bid/quote/proposal(s) at any time during the bid process. Electronic responses placed on www.bidsync.com or the www.vendorregistry.com will be accepted as specified in each bid/quote/proposal. Bidders participating with the BidSync option need to register with BidSync to obtain a user name and password or call Vendor Support at (801) 765-9245. There is a \$100.00 fee to register and receive e-mail or fax notifications of bids and includes the ability to respond electronically, using the required electronic signature, to Terrebonne Parish School Board bid solicitations through the BidSync website. Where applicable, and in all construction projects, an electronic bid bond is also required and must be furnished.

The referenced signature and bond are not included in the \$100.00 fee and are available from third party companies. Vendors participating with the vendorregistry.com option through the TPSB website may register, inquire, and/or submit only a quote or proposal that does not require an electronic signature

Telegraphic or facsimile Bids, Quotes, or Request for Proposals will not be accepted unless specifically stated in the instructions to bidders. When acceptance is so stated in the instructions, the Bid, Quote, or Proposal is to be completed on the form(s) supplied or a copy thereof, completely executed and returned, and received by the Purchasing Agent, no later than the time and date specified for receipt of the Bid, Quote, or Request for Proposal. Forms must have original signatures except when telegraphic, facsimile, or electronic digital signatures are specifically stated as acceptable. Bids must be completed on the original bid form(s) or a copy thereof, signed in ink, and/or where applicable, have a digital signature. Do not send a fax copy of the bid form(s) as the original. The form(s) submitted must have the original signature(s) or an electronic digital signature.

The time and date the Bids, Quotes, or Proposals are to be opened is given in each Bid, Quote, or Proposal issued. All of the Bids, Quotes, or Proposals shall be submitted electronically, or in a sealed envelope, addressed to the Purchasing Department, Terrebonne Parish School Board, P. O. Box 5097, Houma, Louisiana 70361, with the envelope plainly marked, "KITCHEN EQUIPMENT BID #121218". Failure to properly mark Bid, Quote, or Proposal properly shall subject submittal to rejection and returned unopened. The name and complete address, including street, city, and state, of the bidder **shall appear** in the upper left hand corner of the envelope. If the Bid, Quote, or Proposal requires a licensed contractor, the Louisiana Contractor's License number shall appear on the front of the envelope. A copy of same may be included with the Bid, Quote, or Proposal. The referenced information should also be included on any outer envelope used for mailing.

Bidders are cautioned to verify their Bid, Quote, or Proposal before submission. Amendments to a received Bid, Quote, or Proposal submitted prior to the specified time for opening by the Purchasing Agent will not be considered. This applies to all Bids, Quotes, or Proposals sent by mail, delivered in person, submitted electronically, as well as telegraphic, and facsimile Bids,

Quotes, or Proposals. Bids, Quotes, or Proposals received prior to the time and date of the scheduled bid opening will be securely kept unopened. No Bid, Quote, or Proposal received after the scheduled time for opening will be considered. Bidders are cautioned to allow ample time for transmittal of Bids, Quotes, or Proposals by mail or otherwise. Bidders are urged to secure information relative to the probable time of arrival and distribution of mail at the place where bids are to be opened. Failure of the U.S. Mail or any carrier of delivery service to deliver the bids timely shall not be considered due cause for the scheduled time of the bid opening to be extended.

Bids, Quotes, or Proposals may be submitted for all or part of total quantities or for any or all agency requirements listed in the Bid, Quote, or Proposal, **unless otherwise specified** in the Bid, Quote, or Proposal.

If the bidder proposes to furnish any item of a foreign make or product, the word "foreign", together with the name of the originating country must be written opposite of such item on the Bid, Quote, or Proposal. All items not so designated will be considered to be of domestic origin.

Prices must be extended in decimals, not fractions; to be net, and shall have transportation and delivery charges fully prepaid by the contractor to the destination specified in the Bid, Quote, or Proposal, and subject to only cash discounts.

If there is a discrepancy between the unit price and extension, the unit price shall prevail.

All bidders declare that the Bid, Quote, or Proposal is not made in connection with any other bidder submitting a Bid, Quote, or Proposal for the same commodity or commodities, and is in all respects fair, and without collusion or fraud.

All Bids, Quotes, or Proposals will be opened, publicly acknowledged, read aloud, and are subject to public inspection. Bidders may be present or represented at all openings. Abstracts of Bids, Quotes, or Proposals received are not prepared for distribution by the Purchasing Department.

ALTERNATES AND SAMPLES

Alternates and descriptive literature must be submitted by the inquiry and sample deadline specified in the bid documents and will be answered and/or ruled acceptable within ninety-six (96) hours.

If samples are not required, but are later determined to be needed, they shall be delivered within seven (7) days following a written request. Samples must be furnished free of charge and may be accompanied by a descriptive memorandum indicating if the bidder desires a return, provided they have not been used or made useless by tests. Award samples may be held for comparison with deliveries. Samples may be returned upon request at the bidder's risk subject to their expense.

Unless qualified by the provision "No Substitute," the use of a specification, manufacturer, brand, make, or catalog designation in specifying an item does not restrict bidder to that manufacturer, brand, make, or catalog designation identification. This is used simply to indicate the character, quality, and/or performance equivalence for the commodity desired. The commodity on which Bid, Quote, or Proposal is submitted must be of such character, quality, and/or performance equivalence that it will serve the purpose for which it is to be used equally well as that specified. In submitting a Bid, Quote, or Proposal on a commodity other than as specified, the bidder shall furnish complete data and identification with respect to the alternative commodity proposed. Consideration will be given to Bids, Quotes, or Proposals submitted on alternative commodities to the extent that such action is deemed to serve best the interest of the Terrebonne Parish School Board. If the bidder does not indicate that the commodity proposed is an alternative commodity, it will be construed to mean that the bidder proposed to furnish the exact commodity described. The Terrebonne Parish School Board's agent shall be the sole judge as to whether an alternate offered item is equal to the item(s) specified.

The inspection of all commodities and the chemical and physical testing of samples submitted with Bids, Quotes, or Proposals to determine whether or not the samples comply with specifications shall be made in the manner prescribed by the Agent.

Any item which fails, in any way, to meet the terms of the specifications is subject to rejection or to be paid for at an adjusted price basis. The decision of the Agent shall be final.

DEVIATIONS FROM ITEM SPECIFICATION OR GENERAL TERMS AND CONDITIONS

Any and all limitations, expectations, qualifications, special conditions, or deviations from these General Terms and Conditions or any of the item specifications, including the offering of any alternate to the "approved brand and/or model" (where identified) must be clearly noted in detail by the offeror at the time of submission of the bid. The absence of such limitations, exceptions, qualifications, special conditions, or deviations being submitted in writing with the offeror's response will hold the offeror accountable to the Terrebonne Parish School Board to perform in strict accordance with all the General Terms and Conditions and all the item specifications as written, including any such limitations, exceptions, qualifications, special conditions, or deviations with the bid response may place the offeror at a competitive disadvantage or otherwise prevent the Terrebonne Parish School Board from considering the affected item(s).

Any deviation from any of the item specification, including the delivery of any product other than the specific brand of the product awarded, will be grounds for rejection of the product(s) when delivered, and will expose the vendor to the remedies identified in this Standard Terms and Conditions document under contracts and jeopardize future business from the Terrebonne Parish School Board.

TAXES

Terrebonne Parish School Board is not subject to State or Terrebonne Parish Sales Tax. All applicable taxes including ad valorem taxes shall be the responsibility of the bidder and are to be added in to the offer. This responsibility shall be inclusive of, but not limited to, all levies, impost, duties, charges or withholding whatsoever, all applicable sales, use, personal property, franchise (howsoever calculated), and other tax whatsoever (together with any penalties and fines thereon) whether assessed, levied, or imposed by any governmental or taxing authority (whether foreign, federal, state, or local) against or upon the bidder or otherwise, with respect to any item(s) or the purchase, acquisition, ownership, delivery, leasing, possession, use, operation, control, or other disposition thereof, of the rents, receipts, or earnings arising therefrom, with respect to any resultant lease or purchase of this Bid, Quote, or Proposal.

EXCLUSION/ REJECTION OF BIDS

The Terrebonne Parish School Board, after the opening of bids, shall require each bidder or bidding entity to attest or submit an attestation that the sole proprietor, partner, incorporator, director, manager, officer, or other like individual who owns at least ten percent (10%) of the bidding entity, has not been convicted of, or has not entered a plea of guilty or nolo contendere (not contest) to any of the crimes or equivalent federal crimes listed in LA R. S. Ann. 38:2227.

In awarding bids or contracts, the Terrebonne Parish School Board shall be authorized to reject the lowest bid from a business in which any individual with ownership interest of five percent (5%) or more has been convicted of, pled guilty or nolo contendere to any state felony crime or equivalent federal crime committed in the solicitation or execution of a contract or bid under the state laws governing public contracts; professional, personal, consulting, and social services procurement; or the Louisiana Procurement Code.

Any contract between the Terrebonne Parish School Board and a person or entity entered into as a result, of fraud, bribery, corruption, or other criminal acts, for which a final conviction has been obtained, shall be null and void.

Any person whose conviction causes the nullity of a contract shall be responsible for payment of all costs, attorney fees, and damages incurred in the rebidding of the contract.

AWARD

Bid, Quote, or Proposal Awards will be to the lowest responsible and responsive qualified bidder, with consideration given to the quality of the articles to be supplied, conformity with specifications, suitability to the requirement of the Terrebonne Parish School Board, and the delivery terms.

The Terrebonne Parish School Board reserves the right to award by item, part thereof, groups of items, or parts thereof, or all items of the Bid, Quote, or Proposal, and to award contracts to one or more bidders submitting identical Bids, Quotes, or Proposals as to price; to reject any and all Bids, Quotes, or Proposals in whole or in part for just cause; to waive technical defects, irregularities and omissions, such reservations shall comply with governing laws and shall be in the best interest of the Terrebonne Parish School Board.

This agreement is non-exclusive. The TPSB reserves the right to buy any of the bid items using a State Contract, or utilize cooperative purchasing, if more favorable prices become available.

The Terrebonne Parish School Board reserves the right to make awards within sixty (60) calendar days from the date Bids, Quote, or Proposals are opened, unless otherwise specified in the Bids, Quotes, or Proposals. During this period, Bids, Quotes, or Proposals shall not be withdrawn unless the bidder distinctly states in his/her Bid, Quote, or Proposal that acceptance thereof must be made within a shorter specified time. Should an award, in whole or in part, be delayed beyond the period of sixty (60) calendar days or an earlier date specified by the bidder in the bid/quote/proposal, such award shall be conditioned on an agreement by the successful bidder to extend the Bid, Quote, or Proposal award for one or more thirty (30) calendar day periods.

The bidder, if requested, must be prepared to present evidence of experience, ability, service facilities, and financial standing necessary to meet satisfactorily the requirements set forth or implied in the Bid, Quote, or Proposal.

The quantities listed in the Bid, Quote, or Proposal schedule may be increased or decreased by +/- 10% by the Purchasing Agent to meet new or amended requirements of the Terrebonne Parish School Board between the time the Bid, Quote, or Proposal is issued and the time the award is made, subject to the bidder's acceptance.

Pursuant to R.S. 38:2251; R.S. 38:2252, Preference is hereby given to materials, supplies and provisions, produced, manufactured, or grown in Louisiana, quality being equal to articles offered by competitors outside of the state. This provision shall not be applicable if restricted by Federal Law.

Cash discounts may be offered by bidder for prompt payment of bills, but such cash discounts will not be taken into consideration in determining the low bidder except in the case of tie Bids, Quotes, or Proposals and then, only provided such discount is based on payment of invoice not less than thirty (30) days after satisfactory delivery and/or receipt of invoice, whichever is later.

The Terrebonne Parish School Board reserves the right to reject the Bid, Quote, or Proposal of any bidder in default of any prior contract or guilty of misrepresentation, or of any company having as its sales agent or representative, or member of the firm, any individual in default or guilty of misrepresentation.

In accordance with LA R. S. 38:2212 et seq., changes to specifications and bid prices cannot be made after bids are received. TPSB must award bid items to ***the lowest responsible bidder or bidders meeting all specifications***. Awards for bids and all terms and conditions outlined in this packet will be legally binding. The prices bid shall remain firm until the contract has expired.

SUBSTITUTIONS

Substitutions will not be accepted after item(s) have been awarded as specified, unless such substitutions are deemed to be in the best interest of the Terrebonne Parish School Board, and unless prior agreements have been reached and reduced to writing regarding such substitutions. Substituting without the prior approval of the Terrebonne Parish School Board will constitute a breach of contract by the vendor. Said action will result in initiation of actions covered under contracts of the attached Standard Terms and Conditions.

CERTIFICATE OF INSURANCE

The apparent low bidder shall furnish the certificate of insurance and any other information or documentation no later than ten (10) days after notification by Terrebonne Parish School Board of such. If the apparent low bidder does not submit the proper information or documentation as

required within the ten-day period, such bidder shall be declared non-responsive, and Terrebonne Parish School Board may award the bid to the next lowest bidder, and afford the next lowest bidder ten (10) days from the date the apparent low bidder is declared non-responsive to submit the proper information and documentation as required by the bidding documents, and may continue such process until Terrebonne Parish School Board either determines the low bidder or rejects all bids. Please see the attached Insurance Requirements for Vendors, Service Contractors, or Professional Services for the acceptable minimum coverages.

CONTRACT

Each Bid, Quote, or Proposal will be received with the understanding that the **ACCEPTANCE** in writing by the school board agent of the offer to furnish any or all of the commodities or services described therein shall constitute a contract between the bidder and the Terrebonne Parish School Board, which shall bind the bidder to furnish and deliver the commodities or services at the prices given and in accordance with conditions of said accepted bid/proposal, specifications, standard bid/proposal contract terms and conditions, and the Terrebonne Parish School Board, on its part to order from such contractors, except for causes beyond reasonable control, subject to the availability of appropriate funds, and to pay for at the contract prices, all commodities or services ordered and delivered. The school board reserves the right to order up to ten (10) percent more or less, than the quantity listed in the bid/proposal or as amended in the award. The right of order percentage may exceed the reserved right of the ten percent upon agreement by the bidder.

The above referenced **ACCEPTANCE** is not an order to shop. By acceptance of a Terrebonne Parish School District purchase order or work order, the awarded vendor agrees to defend and hold harmless the Terrebonne Parish School Board from any or all claims made in connection with the completion of the goods and/or services listed on the purchase order. The vendor further agrees to waive any right of recovery for expenses incurred in defending and/or payment of any judgment imposed on the vendor.

Quantities are subject to order against contractors by school agencies not specifically mentioned, or to transfer between agencies subject to adjustment in the transportation cost, providing such transportation cost is based on separately determined delivery cost to individual agencies or as defined by law.

No alterations or variations of the terms of contract shall be valid or binding upon the Terrebonne Parish School Board unless made in writing and signed by their agent.

Contracts will remain in force for the full period specified and until all articles ordered before date of termination shall have been satisfactorily delivered and/or accepted (and thereafter until all terms and conditions have been met), unless:

- Terminated prior to expiration by satisfactory delivery against orders of entire quantities contracted for.
- Extended from written authorization of the agent and accepted by contractor to permit ordering of unordered balances or additional quantities at contracted price and in accordance with contract terms.

Contract quantities will be determined to have been ordered at expiration period according to contract terms. Contractor shall furnish the agent with a statement of all unordered balances at least ten (10) days prior to termination of contract.

It is mutually understood and agreed that the contractor shall not assign, transfer, convey, sublet, or otherwise dispose of his/her contract or his/her right, title, or interest therein, or his/her power to execute such contract to any other person, firm or corporation, without the prior written consent of the agent.

The placing in the mail to the address given by the bidder or delivery of a notice of award to a bidder will constitute notice of acceptance of contract; **validity shall be contingent upon insurance compliance, as per bid specifications**. When so requested by the Agent, the contractor shall execute a formal contract with the Terrebonne Parish School Board for the complete performance specified therein.

The contract may be canceled or annulled by the Agent if the Terrebonne Parish School Board, due to budget constraints, does not appropriate funding for the contract or upon nonperformance of contract terms. Any unfulfilled deliveries against such contract may be purchased from other sources at the contractor's expense.

Failure of a contractor to deliver within the time specified or within reasonable time as interpreted by the agent, or failure to make replacement of rejected commodities when so requested (immediately or as directed by the Agent) will constitute authority for the Agent to purchase rejected on undelivered commodities in the open market. The Agent reserves the right to authorize immediate purchase in the open market against rejections or excess overdue deliveries on any contract when necessary. On all such purchases, the contractor agrees promptly to reimburse the Terrebonne Parish School Board for excess costs associated by such purchases. However, should public necessity demand it, the Terrebonne Parish School Board reserves the right to use or consume commodities delivered which are substandard in quality, subject to an adjustment in price to be determined by the Purchasing Agent.

When commodities are rejected, they must be removed by the contractor from the premises of the school board within forty-eight (48) hours after notification, unless public health and safety require immediate destruction or other disposal of such rejected delivery. Rejected items left longer than forty-eight (48) hours will be considered abandoned, and the Terrebonne Parish School Board shall have the right to dispose of them as its own property.

Orders with contractors will be placed by agencies directly with the contractor. All orders shall be in writing and shall bear the contract number and/or purchase order number, and approval of the Terrebonne Parish School Board's Agent. Contractors making a delivery without a formal written order does so at his/her own risk.

The Agent reserves the right to remove from the mailing list for an intermediate period for future Bids, Quote, or Proposals the name of any bidder/contractor for failure to accept the contract and/or for unsatisfactory performance of the contract.

Contractor/Bidder hereby guarantees to:

- Perform the contract in accordance with the Bid, Quote, or Proposal specifications and vendor's Bid, Quote, or Proposal under which the contract was awarded.
- Save the Terrebonne Parish School Board, its agent, or employees harmless from liability of any claim, action, loss, damage, injury, liability, cost or expense of whatsoever kind or nature, including costs and expenses for the use of any copyrighted or not copyrighted composition, secret process, patented or unpatented invention, article or appliance furnished or used in the performance of the contract of which the contractor is not the patentee, assignee, or licensee, but not by way of limitation, attorney's fees, and court costs arising out of bodily injury to persons, including death or damage to tangible property, arising out of or incidental to the performance of this Bid, Quote, or Proposal (including goods and services provided thereto) by or on behalf of the successful bidder, whether or not due to or caused in part by the negligence or other culpability of the indemnitee excluding only the sole negligence or culpability of the indemnitee. The following shall be deemed the indemnitee: The Terrebonne Parish School Board, its board members, agents, and employees.
- Guarantee his/her products against defective material or workmanship, and to repair, or replace any damage or marring occasioned in transit.
- Guarantee that the items offered are the manufacturer's standard design in construction, and that no changes or substitutions have been made in the items listed in this contract.
- Furnish adequate protection from damage for all work and to repair damages of any kind, for which he/she or his/her employees are responsible, to the premises or equipment, to his/her own work or to the work of other contractors.
- Pay for all permits, licenses, and fees, and to give all notices and comply with all laws, ordinances, rules, and regulations of the city, town, and parish in which the installation is to be made, and of the State of Louisiana.

- At bidder's own expense, carry proper insurance to protect the Terrebonne Parish School Board from loss. All insurance policies shall be issued by companies that have insurance licenses and authority to do business in the State of Louisiana and held in good standing by the latest information available to Louisiana Insurance Regulators or other Louisiana agencies, if any, performing such services.
- Upon request, provide Terrebonne Parish School Board's insurance agent with a certificate(s) to verify insurance coverage as required (See Attached Insurance Requirements). **Such certificate must be presented before any contract acceptance by the Terrebonne Parish School Board shall be valid.** Neither approval nor failure to disapprove the insurance furnished by the successful bidder to the Terrebonne Parish School Board shall relieve the successful bidder of the responsibility to provide insurance as required in this Bid, Quote, or Proposal.
- The General Contractor shall be responsible, daily, for assuring that all of the Contractors' staff and employees, and any subcontractors' staff and employees, are legally documented to work in the United States of America and the State of Louisiana while working on Terrebonne Parish School Board projects and/or properties. The General Contractor shall be responsible for assuring that there is an English speaking Supervisor on site while working on Terrebonne Parish School Board projects and/or properties.

DELIVERY

Orders are to be placed by purchase order and the vendor shall not accept orders without first obtaining a purchase order approved and signed by the School Board's Purchasing Agent. Generally purchase orders are mailed, although may be faxed or emailed. Purchase orders for various quantities and amounts will be issued as needed, throughout the term of the Contract.

Contractor should maintain an adequate supply of items in order to meet specified delivery. All shipments shall be free inside delivery and F.O.B. destination (from contractor's to customer's location) to the address specified by the customer on the purchase order, and including to those sites where multiple locations exist at the same address (example- purchasing, child nutrition, maintenance, and warehouse, etc.). The contractor is required to make shipments to an individual office at the discretion of the customer. The contractor shall have delivery personnel on staff to deliver a minimum of 85% of all orders. Third party (UPS, DHL, etc.) deliveries shall be accepted, but paid by contractor as per the specific "ship to" requirements of the School Board and this bid.

Deliveries shall be made Monday through Friday, except on School Board holidays between the hours as follows:

High Schools	8:00 AM-2:00 PM
Jr. High Schools	8:00 AM-2:00 PM
Middle Schools	8:00 AM-2:30 PM
Elementary Schools	8:00 AM-2:30 PM
Warehouse	7:00 AM-2:00 PM

There are approximately forty-eight (48) "ship to" destinations or delivery sites throughout the Parish of Terrebonne comprising of the central offices, departments, and schools (hereafter may be referred to as "Agencies").

Extension of Delivery Date

If for any reason deliveries cannot be made on schedule, the Child Nutrition Program Office should be notified. The vendor shall then deliver at the earliest date possible. Any extension of time on delivery as specified must be requested from the school district at least five (5) days prior to delivery date. Such extension will apply only to the particular item or shipment affected.

The Contractor shall provide confirmations of order receipts and credit returns. The Contractor shall have a process in place to notify the School Board of any discrepancies related to the order, i.e. pricing, incorrect stock numbers, unit of measures, etc., within eight (8) business hours of receipt of order, in order to provide timely resolutions to the Agency. The Contractor shall also have a process in place where the School Board may opt to cancel an order in its entirety, or any portion thereof that is not already filled or delivered. This process is normally determined at the time of establishing the account. The Contractor shall include a packing slip,

which will be used for receiving delivered items. All items not included in the order shall be noted on this packing slip. The packing slip shall include, but not necessarily limited to, the following:

- The School Board's assigned purchase order number
- Ship-to Address, contact name and (where applicable) telephone number
- Bill to address
- Date of order
- Contract number
- Catalog stock number, item description, net unit cost, unit of measure
- Quantity ordered, quantity shipped, quantity on back-order
- Extended and total dollar amounts
- The School Board's account number
- The Contractor's assigned sales order number

The Contractor shall provide a packing slip, bill of lading, or "proof of delivery", which will be signed by the customer receiving the delivery. This document must list the School Board's assigned purchase order number, the number of packages received, the delivery address, the contact person, and (where applicable) the telephone number. This is the minimal information needed to ensure the proper matching of the document with the packing slip, the School Board's purchase order number, and the invoice number. This document will not solely serve as an "Acceptance of Order".

It shall be understood and agreed that any or all commodities or services furnished comply fully with all applicable federal and state laws and regulations.

Any equipment delivered must be standard new equipment and latest model, except as otherwise stated in the specifications. Where any, part, or normal appurtenances of equipment is not described, it shall be understood that all the equipment and appurtenances which are usually provided in the manufacturer's stock model shall be furnished.

Equipment, materials, and supplies delivered must be new and unused items, except as otherwise specifically state in Bid, Quote, or Proposal.

Delivery must be made as ordered and in accordance with Bid, Quote, or Proposal. If no delivery instructions appear on the order, it will be interpreted to mean prompt delivery and **if shipped by freight shall be FOB tailgate delivery, unless otherwise specified.** The decision of the Agent as to reasonable compliance with delivery terms shall be final. Burden of proof of delay in receipt of order shall rest with the contractor.

Any request for extension of time of delivery from that specified must be approved by the Agent, such extension applying only to the particular item or shipment.

Commodities shall be securely and properly packed for shipment according to accepted standard commercial practice, without extra charge for packing cases, bailing, sacks, or pallets. Shipping containers are to remain the property of the school board unless otherwise stated in the Bid, Quote, or Proposal.

The contractor shall notify the school site or facility within 48 hours of any item on an order that cannot be filled within the specified three (3) day delivery period. The balance of the order shall not be held due to the back-order item(s).

Only brands and product numbers stated in the catalog award are approved for delivery under this contract. Any substitutions shall receive prior written approval from the School Board's Purchasing Agent.

The contractor shall notify the School Board's Purchasing Agent of any eligible item that is discontinued by a manufacturer. This notification must be substantiated by written notice from the applicable manufacturer. A request for a replacement item of comparable value and quality shall be sent to the School Board's Purchasing Agent for review/approval within 14 days after notification.

The Contractor shall arrange for the return of all defective, outdated, and/or damaged products, and/or duplicate shipments received by the School Board within seven (7) days of notification. A credit, if applicable, is expected within a reasonable amount of time. The contractor shall not

charge to restock or charge a pickup fee for such returns. No more than five (5) returns are permissible per 100 orders delivered per month.

The Contractor shall arrange for the return of products ordered in error. The School Board may be responsible for shipping charges and a restocking fee not to exceed 15% of the actual sale price of the item, if applicable. Restocking charges will only be applicable for items the contractor does not normally carry in their inventory and must order from a special source. Returned products must not have been used, remain within the manufacturer's original packaging container, and include, in good condition, all manufacturer's packaging and instructions.

All returns described above may be executed within seven (7) days of receiving an order. A Return authorization shall be issued by the contractor within seven (7) days of notification by the School Board. The contractor shall promptly credit the invoice and issue a credit notification to the school board.

INVOICING AND PAYMENT

Invoices submitted by the contractor to the Terrebonne Parish School Board shall refer to the delivery ticket number, delivery date, purchase order, and/or release number, quantity, unit price, and delivery point. A separate invoice for each order delivered and accepted shall be submitted by the contractor to the Terrebonne Parish School Board Child Nutrition, ATTN: Ms. Harriet Lewis, Accounting Clerk II, at P.O. Box 5097, Houma, LA 70361 in duplicate.

The Contractor shall submit the invoice in accordance with the "bill to" instructions on the Terrebonne Parish School Board's order. The invoice shall include, but not limited to, the following:

- The School Board's assigned purchase order/ work order number
- Ship-to Address, contact name and (where applicable) telephone number
- Bill to address
- Date of order
- Contract number
- Quantity ordered, quantity shipped, quantity on back-order, service provided
- Extended and total dollar amounts
- The School Board's account number

All illegible or incorrect invoices will be returned for re-working without penalty to the Terrebonne Parish School Board.

Payment is net 30 from receipt of an approved and correct invoice. The School District pays by invoice only, not by statement. Invoices not referencing a valid purchase order/ or work order number and proof of delivery will be returned unpaid.

Where there is a question of non-performance, payment in whole or in part may be withheld. In the event a discount is involved, the withholding of payment as provided herein shall not deprive the Terrebonne Parish School Board from taking such discount.

All charges against a contractor shall be deducted from current obligations that are due or may become due. In the event that collection is not made in this manner, the contractors shall pay the Terrebonne Parish School Board, on demand, the amount of such charges. All remittances shall be made payable to the Terrebonne Parish School Board.

Payment for the unused portion of an inferior delivery may be made by the Terrebonne Parish School Board on an adjusted price basis, as determined by the agent.

STATEMENTS

Statements for all food shall be submitted to the Terrebonne Parish Child Nutrition Program, P.O. Box 5097, Houma LA 70361, ATTN: Ms. Harriet Lewis, Accounting Clerk II.

Monthly statements shall be submitted in duplicate on the vendor's regular form, to include the last school day of each calendar month.

Each firm that is awarded any item or group of items will receive orders on that item or group of items for the duration of the period specified on the forms. The quantities shown in this bid request represent the best estimate of the various food products required to support the Child Nutrition Program. The quantities to be purchased may vary depending upon internal changes, including but not limited to USDA Commodity availability and student participation. The Terrebonne Parish School Board does not assume or accept responsibility to purchase the total quantities listed. The Board reserves the right to purchase "more or less" for the specified deliveries.

SAVING CLAUSE

It is understood and agreed that the contractor shall not be held liable for any loss resulting if the fulfillment of the terms of the contract, shall be delayed or prevented by wars, acts of public enemies, strikes, fire, floods, acts of God, or any other acts not within the control of the contractor and which by exercise or reasonable diligence.

Should the performance of any contract be delayed or prevented as set forth in the previous paragraph, the contractor agrees to give immediate written notice and explanations of the cause and probable duration of any such delay.

It shall be a requirement of the Terrebonne Parish School Board that any contracted vendor currently employing a person convicted of a sex offense as defined in Louisiana R.S. 15:541 when the victim is under the age of thirteen years shall not permit same employee to enter any Terrebonne Parish School Board property for the purpose of fulfilling work order or delivery of active contract. Violation of this provision shall be cause for immediate termination and/or cancelation of any contract or agreement with contracted vendor.

DEVIATION/ALTERNATIVE BID/PROPOSAL CLAUSE

Any deviation from the specifications listed in the Bid, Quote, or Proposal must be noted in detail and submitted in writing as specified or on a separate document with the Bid, Quote, or Proposal. It must include specific reasons as to why the deviation(s) will render equivalent or better performance and reliability. The deviation(s) must meet or exceed the details of the respective specifications(s). The absence of this specification deviation information will hold the bidder strictly accountable to the specifications as written. Failure to submit documentation of specification deviation shall be grounds for rejection of the item(s) when offered for delivery. A Terrebonne Parish School Board evaluation committee will review all deviations or alternates and reserves the right to be the sole authority for acceptance or rejection of deviations and/or alternate Bid, Quote, or Proposal.

BIDS/PROPOSAL COMPLETION

Only paper Bids, Quotes, or Proposals written in ink or typed, and properly signed by a member of the firm or duly authorized representative will be accepted. Pencil figures, signatures, or photo copies of signatures on the Bid, Quote, or Proposal form submitted will disqualify the bidder. Do not submit a photo copy as an original Bid, Quote, or Proposal unless otherwise specified. Electronic digital signatures will be accepted only if specified.

ERASURES

The Bid, Quote, or Proposal submitted must not contain any erasures or corrections unless each correction is initialed by the person or persons signing the Bid, Quote, or Proposal in the margin immediately opposite the correction.

WARRANTIES

If specific warranties on equipment, vehicles, supplies, and materials specified are not required, they are to be standard manufactures and/or dealer's warranties. If full warranty is specified, it shall include parts, labor, and all other associated cost. Warranty shall be for all components of the related item, i.e. warranty on computer system shall include all components including, but not limited to, base processing unit, keyboard, mouse, monitor, speakers, drives, etc. With regard to a lease, to the extent permitted by law and contract, the successful bidder will assign

and pass through without representation to Terrebonne Parish School Board the benefits of warranties, if any, of the supplier of the items for the duration of any lease in effect and there exist with no event of default thereof.

BID/QUOTE/PROPOSAL RESPONSE

In the event you cannot submit a response on the requirements, please return the request for Bid, Quote, or Proposal form with an explanation as to why you are unable to submit an offer. Also, please state whether you would like to receive future Bid, Quote, or Proposal bid packets, and include the correct address that will receive the Bid, Quote, or Proposal bid packet.

VENUE AND JURISDICTION FOR LITIGATION

Bidders and the Terrebonne Parish School Board do consent to and accept the venue and jurisdiction of the 32nd Judicial District, Parish of Terrebonne, State of Louisiana in the event of any dispute or lawsuit arising as a result of this request for bids or proposals and any contract entered into or between bidder and Terrebonne Parish School Board, as a result thereof.

INELIGIBILITY NOTIFICATION

Bidders must advise the agent if he/she or his/her principles is presently debarred, suspended, proposed for debarment, declared ineligible, or voluntarily excluded from participation in any transactions resulting from the award of this Bid, Quote, or Proposal by any federal department or agency.

REQUIRED CONTRACT PROVISIONS FROM APPENDIX II OF 2 CFR PART 200

Equal Employment Opportunity. Except as otherwise provided under 41 CFR Part 60, all contracts that meet the definition of "federally assisted construction contract" in 41 CFR Part 60-1.3 must include the equal opportunity clause provided under 41 CFR 60-1.4(b), in accordance with Executive Order 11246, "Equal Employment Opportunity" (30 FR 12319, 12935, 3 CFR Part, 1964-1965 Comp., p. 339), as amended by Executive Order 11375, "Amending Executive Order 11246 Relating to Equal Employment Opportunity," and implementing regulations at 41 CFR part 60, "Office of Federal Contract Compliance Programs, Equal Employment Opportunity, Department of Labor" (Appendix II of 2 CFR Part 200E).

The vendor shall comply with the **Copeland "Anti-Kickback" Act** (40 U.S.C. 3145), as supplemented by Department of Labor regulations (29 CFR Part 3, "Contractors and Subcontractors on Public Building or Public Work Financed in Whole or in Part by Loans or Grants from the United States"). The Act provides that each contractor or subrecipient must be prohibited from inducing, by any means, any person employed in the construction, completion, or repair of public work, to give up any part of the compensation to which he or she is otherwise entitled. The non-Federal entity must report all suspected or reported violations to the Federal awarding agency (Appendix II of 2 CFR Part 200 (D)).

Contract Work Hours and Safety Standards Act (40 U.S.C. 3701-3708). Where applicable, all contracts awarded by the non-Federal entity in excess of \$100,000 that involve the employment of mechanics or laborers must include a provision for compliance with 40 U.S.C. 3702 and 3704, as supplemented by Department of Labor regulations (29 CFR Part 5). Under 40 U.S.C. 3702 of the Act, each contractor must be required to compute the wages of every mechanic and laborer on the basis of a standard work week of 40 hours. Work in excess of the standard work week is permissible provided that the worker is compensated at a rate of not less than one and a half times the basic rate of pay for all hours worked in excess of 40 hours in the work week. The requirements of 40 U.S.C. 3704 are applicable to construction work and provide that no laborer or mechanic must be required to work in surroundings or under working conditions which are unsanitary, hazardous or dangerous. These requirements do not apply to the purchases of supplies or materials or articles ordinarily available on the open market, or contracts for transportation or transmission of intelligence (Appendix II of 2 CFR Part 200(I)).

Contracts for more than the **simplified acquisition threshold** currently set at \$150,000, which is the inflation adjusted amount determined by the Civilian Agency Acquisition Council and the Defense Acquisition Regulations Council (Councils) as authorized by 41 U.S.C. 1908, must

address administrative, contractual, or legal remedies in instances where contractors violate or breach contract terms, and provide for such sanctions and penalties as appropriate (Appendix II of 2 CFR Part 200(A)).

All contracts in excess of \$10,000 must address termination for cause and for convenience by the non-Federal entity including the manner by which it will be effected and the basis for settlement (Appendix II of 2 CFR Part 200(B)).

Clean Air Act (42 U.S.C. 7401-7671q.) and the Federal Water Pollution Control Act (33 U.S.C. 1251-1387), as amended—Contracts and subgrants of amounts in excess of \$150,000 must contain a provision that requires the non-Federal award to agree to comply with all applicable standards, orders or regulations issued pursuant to the Clean Air Act (42 U.S.C. 7401-7671q) and the Federal Water Pollution Control Act as amended (33 U.S.C. 1251-1387). Violations must be reported to the Federal awarding agency and the Regional Office of the Environmental Protection Agency (EPA) (Appendix II of 2 CFR Part 200(G)).

Debarment and Suspension (Executive Orders 12549 and 12689)—A contract award (see 2 CFR 180.220) must not be made to parties listed on the governmentwide exclusions in the System for Award Management (SAM), in accordance with the OMB guidelines at 2 CFR 180 that implement Executive Orders 12549 (3 CFR part 1986 Comp., p. 189) and 12689 (3 CFR part 1989 Comp., p. 235), "Debarment and Suspension." SAM Exclusions contains the names of parties debarred, suspended, or otherwise excluded by agencies, as well as parties declared ineligible under statutory or regulatory authority other than Executive Order 12549 (Appendix II of 2 CFR Part 200(H)).

Byrd Anti-Lobbying Amendment (31 U.S.C. 1352)—Contractors that apply or bid for an award exceeding \$100,000 must file the required certification. Each tier certifies to the tier above that it will not and has not used Federal appropriated funds to pay any person or organization for influencing or attempting to influence an officer or employee of any agency, a member of Congress, officer or employee of Congress, or an employee of a member of Congress in connection with obtaining any Federal contract, grant or any other award covered by 31 U.S.C. 1352. Each tier must also disclose any lobbying with non-Federal funds that takes place in connection with obtaining any Federal award. Such disclosures are forwarded from tier to tier up to the non-Federal award (Appendix II of 2 CFR Part 200(I)).

Procurement of recovered materials- A non-Federal entity that is a state agency or agency of a political subdivision of a state and its contractors must comply with section 6002 of the Solid Waste Disposal Act, as amended by the Resource Conservation and Recovery Act. The requirements of Section 6002 include procuring only items designated in guidelines of the Environmental Protection Agency (EPA) at 40 CFR part 247 that contain the highest percentage of recovered materials practicable, consistent with maintaining a satisfactory level of competition, where the purchase price of the item **exceeds \$10,000** or the value of the quantity acquired by the preceding fiscal year exceeded \$10,000; procuring solid waste management services in a manner that maximizes energy and resource recovery; and establishing an affirmative procurement program for procurement of recovered materials identified in the EPA guidelines (2 CFR Part 200.322)

The vendor agrees to take all necessary affirmative steps to assure that minority businesses, women's business enterprises, and labor surplus area firms are used when possible (2 CFR Part 200.321)

Other Contract Provisions - The vendor shall comply with the following **civil rights laws**, as amended: Title VI of the Civil Rights Act of 1964; Title IX of the Education Amendments of 1972; Section 504 of the Rehabilitation Act of 1973; the Age Discrimination Act of 1975; Title 7 CFR Parts 15, 15a, and 15b; the Americans with Disabilities Act; and FNS Instruction 113-1, *Civil Rights Compliance and Enforcement in School Nutrition Programs*.

EQUAL LOW BIDS

Contracts shall be awarded in the following order of priority when two or more low bids are equal in all respects:

- a) Small business concerns that are also labor surplus area concerns.
- b) Other small business concerns. (As defined by the United States Small Business Administration).
- c) Other business concerns.

If two or more bidders still remain equally eligible after application of paragraph (a) above, award shall be made by a drawing by lot limited to those bidders. If time permits, the bidders involved shall be given an opportunity to attend the drawing. The drawing shall be witnessed by at least three persons, and the contract file shall contain the names and addresses of the witnesses and the person supervising the drawing.

RETURN OF DISCOUNTS, CREDITS, AND REBATES TO TERREBONNE PARISH SCHOOL BOARD

Allowable cost will be paid from the non-profit school food service account to the offeror/contractor net of all discounts, rebates and other applicable credits accruing to or received by the contractor or any assignee under this contract, to the extent those credits are allocable to the allowable portion of cost billed to the Terrebonne Parish School Board. The offeror agrees to fully disclose all discounts, rebates, allowances, and incentives received by the company from its suppliers. If the offeror/contractor receives a discount, rebate, allowance, or incentive from a supplier; the offeror/contractor must disclose and return to Terrebonne Parish School Board the full amount of the discount, rebate, or applicable credit that is received based on purchases made on behalf of Terrebonne Parish Child Nutrition Program. All discounts, rebates, allowances, and incentives must be returned to the Child Nutrition Program during a mutually agreed upon time frame that is beneficial to the School District.

"Cost Plus" bids will not be accepted.

PROTEST AWARDS

To initiate a protest of an award recommendation, a business must follow these steps:

- The protest must be received in writing within 5 business days of the recommendation of the Building, Food Service, and Transportation Committee.
- The written protest should include the bid number and should clearly identify the facts believed to constitute an error in the award recommendation and the desired remedy.
- The protesting bidder should focus on identifying the following in their letter of protest:
 - Any specific Louisiana/Federal statute that was violated (such as the application of a required preference)
 - Any specific purchasing policy of the Terrebonne Parish School District that was not applied (such as conflict of interest, fraud, or ethics violation)
 - Any specific solicitation instruction that was not followed (such as the evaluation and award instructions)
- Only the information provided within the protest period will be considered in arriving at a decision. The Purchasing Agent is not required to take into consideration any material filed by any party after the protest deadline.
- The Purchasing Agent or their designee will investigate and provide a written response to the protesting party. This decision is final.
- Until issuing a final decision on a timely protest, the Purchasing Agent will not finalize an award of a contract or purchase order pursuant to a disputed solicitation. However, if there is a threat to public health, safety, or welfare, or danger of immediate and substantial harm to state property from delay in making an award, the Purchasing Agent may proceed with an award and document the justification for such action.
- A revised award recommendation, based on a protest review, does not assure that there will be a new protest period.

The Freedom of Information Act (FOIA) process is not related to the protest process and is not a reason for a protest period extension.

REMEDIES FOR VIOLATION OF CONTRACT TERMS AND TERMINATION FOR CAUSE AND CONVENIENCE

Contract provisions required by 2 CFR Parts 3016.35(i), as applicable.

- i. Administrative, contractual, or legal remedies in instances where contractors violate or breach contract terms, and provide for such sanctions and penalties as may be appropriate. (Contracts more than the simplified acquisition threshold)

- ii. Termination for cause and for convenience by the grantee or subgrantee including the manner by which it will be effected and the basis for settlement. (All contracts in excess of \$10,000)
- iii. Notice of awarding agency requirements and regulations pertaining to reporting.
- iv. Notice of awarding agency requirements and regulations pertaining to patent rights with respect to any discovery or invention which arises or is developed in the course of or under such contract.
- v. Awarding agency requirements and regulations pertaining to copyrights and rights in data.
- vi. Access by the grantee, the subgrantee, the Federal grantor agency, the Comptroller General of the United States, or any of their duly authorized representatives to any books, documents, papers, and records of the contractor which are directly pertinent to that specific contract for the purpose of making audit, examination, excerpts, and transcriptions.

RECORD RETENTION

The successful bidder agrees to retain all books, records, and other documents relative to this agreement for three (3) years after the final payment for audit purposes and to make said records available upon request.

CIVIL RIGHTS STATEMENT: The vendor shall comply with the following civil right laws, as amended: Title VI of the Civil Rights Act of 1964; Title IX of the Education Amendments of 1972; Section 504 of the Rehabilitation Act of 1973; the Age Discrimination Act of 1975; Title 7 CFR Parts 15, 15a, and 15b; the Americans with Disabilities Act; and FNS Instruction 113-1, *Civil Rights Compliance and Enforcement in School Nutrition Programs*.

This institution is an equal opportunity provider.

TERREBONNE

Parish School District

-21-

November 20 2018

To: Bidders – Kitchen Equipment

From: Child Nutrition Program, Terrebonne Parish School District

If you are **not bidding** on the current bid, but would like to remain on our bid list, please complete and return this form. Failure to return this form could result in your name being removed from our bid list.

Company Name:

(Please Print or Type)

Address:

(Street/P.O. Box)

(City)

(State)

(Zip Code)

E-Mail Address:

Representative's
Signature:

Printed Name
of Representative's
Signature:

Bid Checklist
December 12, 2018

-22-

Items that should be returned with your bid:

_____ Original Bid Form; Signature Page - Signed (shall be returned with Bid)

_____ Certification Regarding Debarment

_____ Certification Regarding Lobbying

_____ Disclosure of Lobbying Activities

_____ Certificate of Independent Price Determination

N/A Buy America Provision

_____ Cuts and descriptive literature (where applicable)

_____ Vendor Insurance Certificate (Required if you are the successful vendor)

_____ Owner Disclosure Certificate

It is our preference that all of the above forms must be completed (where applicable), signed by the vendor and returned with your bid. If a form is not applicable, write N/A where not applicable, **sign the form and return it**. Failure to complete, return and/or sign any of the forms will be cause to reject your bid.

Deadline for bid is December 12, 2018 at 2:00 pm CST.

The Certification Regarding Debarment, Certification Regarding Lobbying, Disclosure of Lobbying Activities, Certificate of Independent Price Determination, and Cuts and Descriptive Literature should be returned with bid, but if not, no later than 72 hours after bid date.

**Terrebonne Parish School District
BID FORM**

Bid # 121218

Prices on this bid are for the **23-**
period of 60 days from bid
opening. Return by:
December 12, 2018 @ 2:00pm

Item	Description	Quantity	Unit Price	Extended Price
1	Walk in Freezer	1		
	See Specification sheet. Master-Bilt Nominal size 7'6" H x 8' 8 1/2" W x 9' 8 1/2" L or equivalent.			
	Site: South Terrebonne High School, 3879 Highway 24, Bourg LA 70343			
	Site Visit Date: Manager Signature:			
	Voltage: Amp: Phase:			
2	Walk in Freezer	1		
	See Specification sheet. Master-Bilt Nominal size 7'6" H x 7' 9" W x 9' 8" L or equivalent.			
	Site: Elysian Fields, 700 Hibernia Place, Houma LA 70363			
	Site Visit Date: Manager Signature:			
	Voltage: Amp: Phase:			
3	Installation, Removal, and Trade-in of items 1 and 2			
	Vendor shall be responsible for installation, removal, and trade-in of items South Terrebonne High School Old walk in Freezer and Elysian Fields old walk in Freezer. Installation will be coordinated with the school district and the successful vendor of item 1 & 2. Installation shall include set up of new walk-in freezer, all necessary refrigeration piping, charging, testing, and start-up of refrigeration system as specified in the spec sheet provided by manufacturer. Removal and disposal of all cartons and any job related degrees is the sole responsibility of the vendor. Hard drawn copper piping of refrigeration system and evaporation coil drain lines is required. A "P" trap for the evaporation coil and risers for the suction line is required. The box shall be properly sealed with 2 lines of Butyl sealant on the warm side of the box. All refrigeration lines are to be insulated with a minimum of 1 inch elastomeric thermal insulation. Drain lines are to be a minimum of 3/4 inches in diameter. Owner is to provide electrical disconnects within 6 feet of the condensing unit. Successful bidder shall be responsible for all electrical work and connections from the disconnect to the condensing unit, all control wiring, lights, etc. The project shall not interfere with school operation and if construction occurs during normal school operating days; a portable freezer will be supplied. A 2 year warranty on the insulation is required. A Louisiana Mechanical Contractor's License is required.			
a.	Portable Freezer, delivered to site, including electrical connection.			
b.	Louisiana Mechanical Contractor's License Number:			
c.	Site Visit for Item 1			
d.	Site Visit for Item 2			
4	Double Stack, Natural Gas, Convection Oven	2		
	Full-size double stack natural gas convection oven. Each compartment shall have porcelainize steel liner and accept five 18"x26" standard full-size baking pans. Stainless steel front, top, and sides. Doors shall be solid stainless steel on stainless steel frames, with single porcelain handle and simultaneous operation. Unit shall be gas heated with electronic spark ignition and shall cook by means of a dual-flow system combining direct & indirect heat. Air in baking chamber distributed by dual inlet blower wheel powered by a two-speed, 1/3 HP motor with thermal overload protection. Each chamber shall be fitted with four commercial lamps and five chrome-plated removable racks. Control panel to include a solid state manual thermostat (200-500 degrees F), a 60-minute timer. Fitted with 6" adjustable stainless steel legs. Include a 6 foot cord and plug. Gas manifold shall connect both ovens to have a single point gas connection. Price to include trade-in of old oven, delivery, set in place, install, unit burn off, and removal of all debris. To be Blodgett DFG-100 or equivalent.			
	Delivered, set in place, & installed at the following sites:			
	Oaklawn Jr. High, 2215 Acadian Drive, Houma LA 70363. Price includes trade-in of Blodgett Double Stack Oven Serial # 0889 R1743107/3016.			
	Site Visit Date: Manager Signature:			
	Upper Little Caillou School, 4824 Highway 56, Chauvin LA 70344.			
	Site Visit Date: Manager Signature:			

**Terrebonne Parish School District
BID FORM**

Bid # 121218

Prices on this bid are for the **24-**
period of 60 days from bid
opening. Return by:
December 12, 2018 @ 2:00pm

Item	Description	Quantity	Unit Price	Extended Price
5	Reach in Refrigerator 2 Door	1		
	Top mounted compressor. Stainless steel interior & exterior. Heavy gauge, polish stainless steel doors with stainless steel interior liner. Doors provided with cylinder lock. Door with hold open feature at 120 degrees. Humidity control wires around the door jam to prevent condensation. Refrigeration system to be high efficiency, air-cooled, self contained using R-134a refrigerant metered by an expansion valve. Unit to operate from 35 to 38 degrees. HACCP temperature monitoring system. Cam-lift hinges with concealed light switches. Exterior digital thermometer. OPTIONS: Heavy-duty 6 inch casters. Four (4) epoxy coated shelves on each section. Each shelf shall support 250 pounds. To include ten foot power cord with NEMA 5-15 P plug attached. 46.5 cu ft capacity. Dimensions: Width 52 1/8"/Height 84 1/4." To be Victory FS-2D-S1 or equal.			
	Delivered and set in place at the following site:			
	Pointe-Aux-Chenes, 1236 Highway 665, Montegut LA 70377. Price includes trade-in of 2 door McCall serial #M-706514AC.			
	Site Visit Date: Manager Signature:			
6	Reach in Refrigerator 2 Door	5		
	Top mounted compressor. Stainless steel interior & exterior. Heavy gauge, polish stainless steel doors with stainless steel interior liner. Doors provided with cylinder lock. Door with hold open feature at 120 degrees. Humidity control wires around the door jam to prevent condensation. Refrigeration system to be high efficiency, air-cooled, self contained using R-134a refrigerant metered by an expansion valve. Unit to operate from 35 to 38 degrees. HACCP temperature monitoring system. Cam-lift hinges with concealed light switches. Exterior digital thermometer. OPTIONS: Heavy-duty 6 inch casters. Four (4) epoxy coated shelves on the left section (each shelf shall support 250 pounds) and right section to include ten (10) pairs of type A/C tray slides which would accommodate 18" x 26" or (2) 14" x 18" pans. To include ten foot power cord with NEMA 5-15 P plug attached. 46.5 cu ft capacity. Dimensions: Width 52 1/8"/Height 84 1/4." To be Victory RS-2D-S1 or equal.			
	Delivered and set in place at the following sites:			
	H.L. Bourgeois High School, #1 Reservation Drive, Gray LA 70395. Price includes trade-in of McCall Serial #706513, 2 door reach in refrigerator.			
	Site Visit Date: Manager Signature:			
	Acadian Elementary, 1020 Saadi Street, Houma LA 70363. Price includes trade-in of 2 door reach in McCall Serial #M7209-13.			
	Site Visit Date: Manager Signature:			
	Evergreen Jr. High, 5000 West Main Street, Houma LA 70360. Price includes trade-in of 2 door reach in refrigerator Victory Model #VS-48-SN Serial #55874.			
	Site Visit Date: Manager Signature:			
	Montegut Middle School, 138 Dolphin Drive, Montegut LA 70377.			
	Site Visit Date: Manager Signature:			
	Mulberry Elementary School, 450 Cougar Drive, Houma LA 70360.			
	Site Visit Date: Manager Signature:			
7	Reach in Refrigerator 2 Door	1		
	stainless steel doors with stainless steel interior liner. Doors provided with cylinder lock. Door with hold open feature at 120 degrees. Humidity control wires around the door jam to prevent condensation. Refrigeration system to be high efficiency, air-cooled, self contained using R-134a refrigerant metered by an expansion valve. Unit to operate from 35 to 38 degrees. HACCP temperature monitoring system. Cam-lift hinges with concealed light switches. Exterior digital thermometer. OPTIONS: Heavy-duty 3 inch casters. Four (4) epoxy coated shelves on the left section (each shelf shall support 250 pounds) and right section to include ten (10) pairs of type A/C tray slides which would accommodate 18" x 26" or (2) 14" x 18" pans. To include ten foot power cord with NEMA 5-15 P plug attached. 46.5 cu ft capacity. Dimensions: Width 52 1/8"/Height 84 1/4." To be Victory RS-2D-S1 or equal.			
	Delivered and set in place at the following site:			
	Montegut Middle School, 138 Dolphin Drive, Montegut LA 70377.			
	Site Visit Date: Manager Signature:			

**Terrebonne Parish School District
BID FORM**

Bid # 121218

Prices on this bid are for the **25-**
period of 60 days from bid
opening. Return by:
December 12, 2018 @ 2:00pm

Item	Description	Quantity	Price	Price
8	Reach in Refrigerator Single Door	1		
	Top mounted compressor. Stainless steel interior & exterior. Heavy gauge, polish stainless steel doors with stainless steel interior liner. Door provided with cylinder lock. Door with hold open feature at 120 degrees. Humidity control wires around the door jam to prevent condensation. Refrigeration system to be high efficiency, air-cooled, self contained using R-134a refrigerant metered by an expansion valve. Unit to operate from 35 to 38 degrees. HACCP temperature monitoring system. Cam-lift hinges with concealed light switches. Exterior digital thermometer. OPTIONS: Heavy-duty 6 inch casters. Include ten (10) pairs of type A/C tray slides which would accommodate 18" x 26" or (2) 14" x 18" pans. To include ten foot power cord with NEMA 5-15 P plug attached. 21.5 cu ft capacity. Dimensions: Width 31 1/4"/Height 84 1/4." To be Victory RS-2D-S1 or equal.			
	Delivered and set in place at the following site:			
	Bourg Elementary School, 4413 Saint Andrew Street, Bourg LA 70343			
	Site Visit Date: _____ Manager Signature: _____			
9a	Mobile Hot Food Counter	2		
	To be 86 inches long x 32 inches wide x 36 inches high, Low Temp No. EF3-CPA series "Modified" or approved equal. 14 gauge stainless steel top, 661 watt energy efficient hot food wells, 240/60/1 phase, open 18 gauge stainless steel storage base, 5 inch locking swivel casters, UL-approved to be used wet or dry. Modifications with the following components/features/accessories as follows:			
	a) Eight (8) inch flat space before the hot wells (Left side of hot wells)			
	b) Three (3) 661-watt hot food wells located on the Left side of the equipment (facing student serving side) with copper drains, copper drain manifold, copper shut-off valve, and provisions for a plastic drain hose.			
	c) Flat top space for standard size sheet pan arranged length-wise to the right of the hot wells.			
	d) Hatco No GR-24 heat lamp with switch, pre-wired to counter base to be mounted over "Flat top space only" (over the space in item c)			
	e) 86 inches long x 18 inches high 16 gauge stainless steel single over shelf with single service buffet-style food guard with "fully adjustable" 1/4 inch thick tempered glass front panels.			
	f) 12 inches wide x "full length" solid-type stainless steel fold-down tray slide with tray runners ("V" ridges). Installed at 32 inches from the floor.			
	g) Line-up locks for adjacent counter			
	h) 5 inch diameter, ball bearing, swivel type casters to be non-marking and with brakes on all wheels.			
	i) Ten (10) foot long NEMA 14-30p Cord/plug assembly. 240 volts			
	j) Daisy chain receptacle to accept cord from item 9b			
	Delivered and set in place at to the following sites:			
	Pointe-Aux-Chenes, 1236 Highway 665, Montegut LA 70377			
	Price includes trade-in of current steam table. NOTE: TPSD will provide electrical within 6 feet of unit.			
	Montegut Elementary, 1137 Highway 55, Montegut LA 70377			
	Price includes trade-in of current steam table. NOTE: TPSD will provide electrical within 6 feet of unit.			
9b	Mobile Cold Food Counter	2		
	To be 74 inches long x 32 inches wide x 36 inch high, 14 gauge stainless steel top, Low Temp No. 50-CFT series "Modified" or approved equal. Eighteen (18) gauge stainless steel storage base, 5 inch locking swivel casters, UL-approved to be used wet or dry. Modifications with the following components/features/accessories as follows:			
	a) One (1) 38 inch long refrigerated solid frost top on the left side of the unit facing the student serving side			
	b) 48 inches long x 18 inches high single service buffet-style food guard with "fully adjustable" 1/4 inch thick tempered glass front panels at frost top. Covering the frost top area.			
	c) Flat top space for standard size sheet pan arranged length-wise to the right side unit facing the student serving side.			
	d) 12 inches wide x "full length" solid-type stainless steel fold-down tray slide with tray runners ("V" ridges) Installed at 32 inches from the floor.			
	e) 18-gauge stainless steel cabinet base			

Item	Description	Quantity	Unit Price	Extended Price
9b	Mobile Cold Food Counter (continued)			
	f) Line-up locks for adjacent counter			
	g) 5 inch diameter, ball bearing, swivel type casters to be non-marking and with brakes on all wheels.			
	i) 60 inch long NEMA 14-20 cord/Plug assembly			
	Delivered and set in place at the following site :			
	Pointe-Aux-Chenes, 1236 Highway 665, Montegut LA 70377			
	Site Visit Date: Manager Signature:			
	Montegut Elementary, 1137 Highway 55, Montegut LA 70377			
	Site Visit Date: Manager Signature:			
10	Reach in Freezer 2 Door	2		
	Top mounted compressor. Stainless steel interior & exterior. Heavy gauge, polish stainless steel doors with stainless steel interior liner. Doors provided with cylinder lock. Door with hold open feature at 120 degrees. Humidity control wires around the door jam to prevent condensation. Refrigeration system to be high efficiency, air-cooled, self contained using R-404a refrigerant metered by an expansion valve. Unit to operate from -5 to 0 degrees F. HACCP temperature monitoring system. Cam-lift hinges with concealed light switches. Exterior digital thermometer. OPTIONS: Heavy-duty 6 inch casters. A total of four (4) epoxy coated shelves on each section. Each shelf to support 250 pounds. To include ten foot power cord with NEMA 5-15 P plug attached. 46.5 cu ft capacity. Dimensions: Width 52 1/8", Height 84 1/4." To be Victory FS-2D-S1 or equal.			
	Delivered to the following sites:			
	Acadian Elementary, 1020 Saadi Street, Houma LA 70363. Price includes trade-in of 2 door reach in freezer Victory Serial #S-9718804.			
	Site Visit Date: Manager Signature:			
	Dularge Elementary, 621 Dularge Road, Houma LA 70363.			
	Site Visit Date: Manager Signature:			
11a	Mobile Hot Food Counter	1		
	To be 86 inches long x 32 inches wide x 36 inches high, Low Temp No. EF3-CPA series "Modified" or equal. 14 gauge stainless steel top, 661 watt energy efficient hot food wells, 240/60/1 phase, open 18 gauge stainless steel storage base, 5 inch locking swivel casters, UL-approved to be used wet or dry. Modifications with the following components/features/accessories as follows:			
	a) Eight (8) inch flat space before the hot wells (Left side of hot wells)			
	b) Three (3) 661-watt hot food wells located on the Left side of the equipment (facing student serving side) with copper drains, copper drain manifold, copper shut-off valve, and provisions for a plastic drain hose.			
	c) Flat top space for standard size sheet pan arranged length-wise to the right of the hot wells. (facing student side)			
	d) Hatco No GR-24 heat lamp with switch, pre-wired to counter base to be mounted over "Flat top space only" (over the space in item c)			
	e) 86 inches long x 18 inches high 16 gauge stainless steel single over shelf with single service buffet-style food guard with "fully adjustable" 1/4 inch thick tempered glass front panels.			
	f) 12 inches wide x "full length" solid-type stainless steel fold-down tray slide with tray runners ("V" ridges). Installed at 32 inches from the floor.			
	g) Line-up locks for adjacent counter			
	h) 5 inch diameter, ball bearing, swivel type casters to be non-marking and with brakes on all wheels.			
	i) Ten (10) foot long NEMA 14-30p Cord/plug assembly. 240 volts			
	j) Daisy chain receptacle to accept cord from item 11b			
	Delivered and set in place at the following site :			
	Bourg Elementary, 4413 Saint Andrew Street, Bourg LA 70343.			
	Site Visit Date: Manager Signature:			
	Price includes trade-in of current steam table. NOTE: TPSD will provide electrical within 6 feet of unit.			

Item	Description	Quantity	Unit Price	Extended Price
11b	Mobile Cold Food Counter	1		
	To be 74 inches long x 32 inches wide x 36 inches high, Low Temp No. 50-CFT series "Modified" or approved equal. 14 gauge stainless steel top, open 18 gauge stainless steel storage base, 5 inch locking swivel casters, UL-approved to be used wet or dry. Modifications with the following components/features/accessories:			
	a) One (1) 38 inch long refrigerated solid frost top. Installed to the left side of the unit (facing the student serving side)			
	b) 48 inches long x 18 inches high single service buffet-style food guard with "fully			
	c) Flat top space for standard size sheet pan arranged length-wise. Right side of the frost top.			
	d) 12 inches wide x "full length" solid-type stainless steel fold-down tray slide with tray runners ("V" ridges) Installed at 32 inches from the floor.			
	e) 18 inch wide end drop shelf. 18-gauge stainless steel finished like cabinet base. Installed on the right side of the unit student side facing.			
	f) 18-gauge stainless steel cabinet base			
	g) Line-up locks for adjacent counter			
	h) 5 inch diameter, ball bearing, swivel type casters to be non-marking and with brakes on all wheels.			
	i) 5 foot long NEMA 14-20 cord/Plug assembly			
	Delivered and set in place at the following site :			
	Bourg Elementary, 4413 Saint Andrew Street, Bourg LA 70343.			
	Site Visit Date: Manager Signature:			
12a	Mobile Hot Food Counter	2		
	To be 96 inches long x 32 inches wide x 36 inches high, Low Temp No. EF3-CPA series "Modified" or equal. 14 gauge stainless steel top, 661 watt energy efficient hot food wells, 240/60/1 phase, open 18 gauge stainless steel storage base, 5 inch locking swivel casters, UL-approved to be used wet or dry. Modifications with the following components/features/accessories as follows:			
	a) Eighteen (18) inch flat space before the hot wells (Left side of hot wells) student facing			
	b) Three (3) 661-watt hot food wells located on the left side of the equipment (facing student serving side) with copper drains, copper drain manifold, copper shut-off valve, and provisions for a plastic drain hose. To the right of item a.			
	c) Flat top space for standard size sheet pan arranged length-wise to the right of the hot wells. (facing student side)			
	d) Hatco No GR-24 heat lamp with switch, pre-wired to counter base to be mounted over "Flat top space only" (over the space in item c)			
	e) 96 inches long x 18 inches high 16 gauge stainless steel single over shelf with single service buffet-style food guard with "fully adjustable" 1/4 inch thick tempered glass front panels.			
	f) 12 inches wide x "full length" solid-type stainless steel fold-down tray slide with tray runners ("V" ridges). Installed at 32 inches from the floor.			
	g) Line-up locks for adjacent counter			
	h) 5 inch diameter, ball bearing, swivel type casters to be non-marking and with brakes on all wheels.			
	i) Ten (10) foot long NEMA 14-30p Cord/plug assembly. 240 volts			
	j) Daisy chain receptacle to accept cord from item 12b			
	k) provide holes for electrical cord and computer cable (cord hooks) on both side to mount into wall plug and cashier station.			
	Delivered and set in place at the following site :			
	Lisa Park Elementary, 6639 Lisa Park Avenue, Houma, LA 70364			
	Site Visit Date: Manager Signature:			
	Price includes trade-in of current steam table. NOTE: TPSD will provide electrical within 6 feet of unit.			
	Schriever Elementary, 2052 West Main, Schriever LA 70395			
	Site Visit Date: Manager Signature:			
	Price includes trade-in of current steam table. NOTE: TPSD will provide electrical within 6 feet of unit.			

Item	Description	Quantity	Unit Price	Extended Price
12b	Mobile Cold Food Counter	2		
	To be 74 inches long x 32 inches wide x 36 inches high, Low Temp No. 50-CFT series "Modified" or approved equal. 14 gauge stainless steel top, open 18 gauge stainless steel storage base, 5 inch locking swivel casters, UL-approved to be used wet or dry. Modifications with the following components/features/accessories:			
	a) One (1) 38 inch long refrigerated solid frost top. Installed to the left side of the unit (facing the student serving side)			
	b) 48 inches long x 18 inches high single service buffet-style food guard with "fully adjustable" 1/4 inch thick tempered glass front panels over the frost top.			
	c) Flat top space for standard size sheet pan arranged length-wise. Right side of the frost top.			
	d) 12 inches wide x "full length" solid-type stainless steel fold-down tray slide with tray runners ("V" ridges) Installed at 32 inches from the floor.			
	e) 18-gauge stainless steel cabinet base.			
	f) Line-up locks for adjacent counter			
	g) 5 inch diameter, ball bearing, swivel type casters to be non-marking and with brakes on all wheels.			
	h) 5 foot long NEMA 14-20 cord/Plug assembly			
	i) Provide holes for electrical cord and computer cable (cord hooks) on both sides to mount to wall and cashier station.			
	Delivered and set in place at the following site :			
	Lisa Park Elementary, 6639 Lisa Park Avenue, Houma, LA 70364			
	Site Visit Date: Manager Signature:			
	Schriever Elementary, 2052 West Main, Schriever LA 70395			
	Site Visit Date: Manager Signature:			
12c	Mobile Cashier Station	2		
	To be 28 inches long x 32 inches wide x 36 inches high, LowTemp No 28-CSD-S series "Modified" or approved equal. 14 gauge stainless steel top, 18 gauge enclosed base with hinged doors and slide-out shelf for CPU. Daisy chain to mobile unit 11b.			
	a) One grommet to accept Computer screen cords on the top of the station to be dropped to inside of the cabinet to CPU.			
	b) Hinged doors on closed cabinet base; slide out shelf to house a computer processing unit.			
	c) 12 inch wide x "full length" solid-type stainless steel fold-down tray slide with tray runner ("V" ridges).			
	d) Provide holes for electrical cord and computer cable (cord hooks) to mount to wall and cashier station.			
	Delivered and set in place at the following site :			
	Lisa Park Elementary, 6639 Lisa Park Avenue, Houma, LA 70364			
	Site Visit Date: Manager Signature:			
	Schriever Elementary, 2052 West Main, Schriever LA 70395			
	Site Visit Date: Manager Signature:			
13a	Mobile Hot Food Counter	3		
	To be 86 inches long x 32 inches wide x 36 inches high, Low Temp No. EF3-CPA series "Modified" or equal. 14 gauge stainless steel top, 661 watt energy efficient hot food wells, 240/60/1 phase, open 18 gauge stainless steel storage base, 5 inch locking swivel casters, UL-approved to be used wet or dry. Modifications with the following components/features/accessories as follows:			
	a) Eight (8) inch flat space before the hot wells (Left side of hot wells)			
	b) Three (3) 661-watt hot food wells located on the Left side of the equipment (facing student serving side) with copper drains, copper drain manifold, copper shut-off valve, and provisions for a plastic drain hose.			
	c) Flat top space for standard size sheet pan arranged length-wise to the right of the hot wells. (facing student side)			
	d) Hatco No GR-24 heat lamp with switch, pre-wired to counter base to be mounted over "Flat top space only" (over the space in item c)			
	e) 86 inches long x 18 inches high 16 gauge stainless steel single over shelf with single service buffet-style food guard with "fully adjustable" 1/4 inch thick tempered glass front panels.			

Item	Description	Quantity	Unit Price	Extended Price
13a	Mobile Hot Food Counter (continued)			
	f) 12 inches wide x "full length" solid-type stainless steel fold-down tray slide with tray runners ("V" ridges). Installed at 32 inches from the floor.			
	g) Line-up locks for adjacent counter			
	h) 5 inch diameter, ball bearing, swivel type casters to be non-marking and with brakes on all wheels.			
	i) Ten (10) foot long NEMA 14-30p Cord/plug assembly. 240 volts			
	j) Daisy chain receptacle to accept cord from item 13b			
	Delivered and set in place at the following site :			
	HL Bourgeois High School, #1 Reservation Drive, Gray LA 70359			
	Site Visit Date: Manager Signature:			
	Price includes trade-in of current steam table. NOTE: TPSD will provide electrical within 6 feet of unit.			
	Upper Little Cailou Elementary, 4824 Highway 56, Chauvin LA 70344.			
	Site Visit Date: Manager Signature:			
	Price includes trade-in of current steam table. NOTE: TPSD will provide electrical within 6 feet of unit.			
	Village East Elementary, 315 Lafayette Woods, Houma LA 70363			
	Site Visit Date: Manager Signature:			
	Price includes trade-in of current steam table. NOTE: TPSD will provide electrical within 6 feet of unit.			
13b	Mobile Cold Food Counter	3		
	To be 74 inches long x 32 inches wide x 36 inches high, Low Temp No. 50-CFT series "Modified" or approved equal. 14 gauge stainless steel top, open 18 gauge stainless steel storage base, 5 inch locking swivel casters, UL-approved to be used wet or dry. Modifications with the following components/features/accessories:			
	a) One (1) 38 inch long refrigerated solid frost top. Installed to the left side of the unit (facing the student serving side)			
	b) 48 inches long x 18 inches high single service buffet-style food guard with "fully adjustable" 1/4 inch thick tempered glass front panels over the frost top.			
	c) Flat top space for standard size sheet pan arranged length-wise. Right side of the frost top.			
	d) 12 inches wide x "full length" solid-type stainless steel fold-down tray slide with tray runners ("V" ridges) Installed at 32 inches from the floor.			
	e) 18-gauge stainless steel cabinet base			
	f) Line-up locks for adjacent counter			
	g) 5 inch diameter, ball bearing, swivel type casters to be non-marking and with brakes on all wheels.			
	h) 5 foot long NEMA 14-20 cord/Plug assembly			
	Delivered and set in place at the following site :			
	HL Bourgeois High School, #1 Reservation Drive, Gray LA 70359			
	Site Visit Date: Manager Signature:			
	Upper Little Cailou Elementary, 4824 Highway 56, Chauvin LA 70344.			
	Site Visit Date: Manager Signature:			
	Village East Elementary, 315 Lafayette Woods, Houma LA 70363			
	Site Visit Date: Manager Signature:			
13c	Mobile Hot Food Counter	3		
	To be 86 inches long x 32 inches wide x 36 inches high, Low Temp No. EF3-CPA series "Modified" or equal. 14 gauge stainless steel top, 661 watt energy efficient hot food wells, 240/60/1 phase, open 18 gauge stainless steel storage base, 5 inch locking swivel casters, UL-approved to be used wet or dry. Modifications with the following components/features/accessories as follows:			
	a) Eight (8) inch flat space before the hot wells (right side of hot wells)			
	b) Three (3) 661-watt hot food wells located on the right side of the equipment (facing student serving side) with copper drains, copper drain manifold, copper shut-off valve, and provisions for a plastic drain hose.			
	c) Flat top space for standard size sheet pan arranged length-wise to the left of the hot wells. (facing student side)			
	d) Hatco No GR-24 heat lamp with switch, pre-wired to counter base to be mounted over "Flat top space only" (over the space in item c)			
	e) 86 inches long x 18 inches high 16 gauge stainless steel single over shelf with single service buffet-style food guard with "fully adjustable" 1/4 inch thick tempered glass front panels.			

Item	Description	Quantity	Unit Price	Extended Price
13c	Mobile Hot Food Counter (continued)			
	f) 12 inches wide x "full length" solid-type stainless steel fold-down tray slide with tray runners ("V" ridges). Installed at 32 inches from the floor.			
	g) Line-up locks for adjacent counter			
	h) 5 inch diameter, ball bearing, swivel type casters to be non-marking and with brakes on all wheels.			
	i) Ten (10) foot long NEMA 14-30p Cord/plug assembly. 240 volts			
	j) Daisy chain receptacle to accept cord from item 13d			
	Delivered and set in place at the following site :			
	HL Bourgeois High School, #1 Reservation Drive, Gray LA 70359			
	Site Visit Date: Manager Signature:			
	Price includes trade-in of current steam table. NOTE: TPSD will provide electrical within 6 feet of unit.			
	Upper Little Cailou Elementary, 4824 Highway 56, Chauvin LA 70344.			
	Site Visit Date: Manager Signature:			
	Price includes trade-in of current steam table. NOTE: TPSD will provide electrical within 6 feet of unit.			
	Village East Elementary, 315 Lafayette Woods, Houma LA 70363			
	Site Visit Date: Manager Signature:			
	Price includes trade-in of current steam table. NOTE: TPSD will provide electrical within 6 feet of unit.			
13d	Mobile Cold Food Counter	2		
	To be 74 inches long x 32 inches wide x 36 inches high, Low Temp No. 50-CFT series "Modified" or approved equal. 14 gauge stainless steel top, open 18 gauge stainless steel storage base, 5 inch locking swivel casters, UL-approved to be used wet or dry. Modifications with the following components/features/accessories:			
	a) One (1) 38 inch long refrigerated solid frost top. Installed to the right side of the unit (facing the student serving side)			
	b) 48 inches long x 18 inches high single service buffet-style food guard with "fully adjustable" 1/4 inch thick tempered glass front panels over the frost top.			
	c) Flat top space for standard size sheet pan arranged length-wise. Left side of the frost top.			
	d) 12 inches wide x "full length" solid-type stainless steel fold-down tray slide with tray runners ("V" ridges) Installed at 32 inches from the floor.			
	e) 18-gauge stainless steel cabinet base			
	f) Line-up locks for adjacent counter			
	g) 5 inch diameter, ball bearing, swivel type casters to be non-marking and with brakes on all wheels.			
	h) 5 foot long NEMA 14-20 cord/Plug assembly			
	Delivered and set in place at the following site :			
	HL Bourgeois High School, #1 Reservation Drive, Gray LA 70359			
	Site Visit Date: Manager Signature:			
	Upper Little Cailou Elementary, 4824 Highway 56, Chauvin LA 70344.			
	Site Visit Date: Manager Signature:			
	Village East Elementary, 315 Lafayette Woods, Houma LA 70363			
	Site Visit Date: Manager Signature:			
14a	Mobile Hot Food Counter	1		
	To be 86 inches long x 32 inches wide x 36 inches high, Low Temp No. EF3-CPA series "Modified" or equal. 14 gauge stainless steel top, 661 watt energy efficient hot food wells, 240/60/1 phase, open 18 gauge stainless steel storage base, 5 inch locking swivel casters, UL-approved to be used wet or dry. Modifications with the following components/features/accessories as follows:			
	a) Eight (8) inch flat space before the hot wells (Left side of hot wells)			
	b) Three (3) 661-watt hot food wells located on the Left side of the equipment (facing student serving side) with copper drains, copper drain manifold, copper shut-off valve, and provisions for a plastic drain hose.			
	c) Flat top space for standard size sheet pan arranged length-wise to the right of the hot wells. (facing student side)			

Item	Description	Quantity	Unit Price	Extended Price
14a	Mobile Hot Food Counter (continued)			
	d) Hatco No GR-24 heat lamp with switch, pre-wired to counter base to be mounted over "Flat top space only" (over the space in item c)			
	e) 86 inches long x 18 inches high 16 gauge stainless steel single over shelf with single service buffet-style food guard with "fully adjustable" 1/4 inch thick tempered glass front panels.			
	f) 12 inches wide x "full length" solid-type stainless steel fold-down tray slide with tray runners ("V" ridges). Installed at 32 inches from the floor.			
	g) Line-up locks for adjacent counter			
	h) 5 inch diameter, ball bearing, swivel type casters to be non-marking and with brakes on all wheels.			
	i) Ten (10) foot long NEMA 14-30p Cord/plug assembly. 240 volts			
	j) Daisy chain receptacle to accept cord from item 14b			
	Delivered and set in place at the following site :			
	South Terrebonne High School, 3879 Highway 24, Bourg LA 70343.			
	Site Visit Date: Manager Signature:			
	Price includes trade-in of current steam table. NOTE: TPSD will provide electrical within 6 feet of unit.			
14b	Mobile Cold Food Counter	1		
	To be 74 inches long x 32 inches wide x 36 inches high, Low Temp No. 50-CFT series "Modified" or approved equal. 14 gauge stainless steel top, open 18 gauge stainless steel storage base, 5 inch locking swivel casters, UL-approved to be used wet or dry. Modifications with the following components/features/accessories:			
	a) One (1) 38 inch long refrigerated solid frost top. Installed to the left side of the unit (facing the student serving side)			
	b) 48 inches long x 18 inches high single service buffet-style food guard with "fully adjustable" 1/4 inch thick tempered glass front panels over the frost top.			
	c) Flat top space for standard size sheet pan arranged length-wise. Right side of the frost top.			
	d) Two tier display shelf without breath guards. Shelves to be 1/4 inch polished plate glass resting on a horizontal stainless steel framework welded to the uprights. Shelves to be over the flat space in item c.			
	e) 12 inches wide x "full length" solid-type stainless steel fold-down tray slide with tray runners ("V" ridges) Installed at 32 inches from the floor.			
	f) 18-gauge stainless steel cabinet base			
	g) Line-up locks for adjacent counter			
	h) 5 inch diameter, ball bearing, swivel type casters to be non-marking and with brakes on all wheels.			
	i) 5 foot long NEMA 14-20 cord/Plug assembly			
	Delivered and set in place at the following site :			
	South Terrebonne High School, 3879 Highway 24, Bourg LA 70343.			
	Site Visit Date: Manager Signature:			
14c	Mobile Hot Food Counter	1		
	To be 86 inches long x 32 inches wide x 36 inches high, Low Temp No. EF3-CPA series "Modified" or equal. 14 gauge stainless steel top, 661 watt energy efficient hot food wells, 240/60/1 phase, open 18 gauge stainless steel storage base, 5 inch locking swivel casters, UL-approved to be used wet or dry. Modifications with the following components/features/accessories as follows:			
	a) Eight (8) inch flat space before the hot wells (Right side of hot wells)			
	b) Three (3) 661-watt hot food wells located on the right side of the equipment (facing student serving side) with copper drains, copper drain manifold, copper shut-off valve, and provisions for a plastic drain hose.			
	c) Flat top space for standard size sheet pan arranged length-wise to the left of the hot wells. (facing student side)			
	d) Hatco No GR-24 heat lamp with switch, pre-wired to counter base to be mounted over "Flat top space only" (over the space in item c)			
	e) 86 inches long x 18 inches high 16 gauge stainless steel single over shelf with single service buffet-style food guard with "fully adjustable" 1/4 inch thick tempered glass front panels.			
	f) 12 inches wide x "full length" solid-type stainless steel fold-down tray slide with tray runners ("V" ridges). Installed at 32 inches from the floor.			
	g) Line-up locks for adjacent counter			
	h) 5 inch diameter, ball bearing, swivel type casters to be non-marking and with brakes on all wheels.			
	i) Ten (10) foot long NEMA 14-30p Cord/plug assembly. 240 volts			

Item	Description	Quantity	Unit Price	Extended Price
14c	Mobile Hot Food Counter (continued)			
	j) Daisy chain receptacle to accept cord from item 14d			
	Delivered and set in place at the following site :			
	South Terrebonne High School, 3879 Highway 24, Bourg LA 70343.			
	Site Visit Date: Manager Signature:			
	Price includes trade-in of current steam table. NOTE: TPSD will provide electrical within 6 feet of unit.			
14d	Mobile Cold Food Counter	1		
	To be 74 inches long x 32 inches wide x 36 inches high, Low Temp No. 50-CFT series "Modified" or approved equal. 14 gauge stainless steel top, open 18 gauge stainless steel storage base, 5 inch locking swivel casters, UL-approved to be used wet or dry. Modifications with the following components/features/accessories:			
	a) One (1) 38 inch long refrigerated solid frost top. Installed to the right side of the unit (facing the student serving side)			
	b) 48 inches long x 18 inches high single service buffet-style food guard with "fully adjustable" 1/4 inch thick tempered glass front panels over the frost top.			
	c) Flat top space for standard size sheet pan arranged length-wise. Left side of the frost top.			
	d) Two tier display shelf without breath guards. Shelves to be 1/4 inch polished plate glass resting on a horizontal stainless steel framework welded to the uprights. Shelves to be over the flat space in item c.			
	e) 12 inches wide x "full length" solid-type stainless steel fold-down tray slide with tray runners ("V" ridges) Installed at 32 inches from the floor.			
	f) 18-gauge stainless steel cabinet base			
	g) Line-up locks for adjacent counter			
	h) 5 inch diameter, ball bearing, swivel type casters to be non-marking and with brakes on all wheels.			
	i) 5 foot long NEMA 14-20 cord/Plug assembly			
	Delivered and set in place at the following site :			
	South Terrebonne High School, 3879 Highway 24, Bourg LA 70343.			
	Site Visit Date: Manager Signature:			
15a	Mobile Hot Food Counter	1		
	To be 96 inches long x 32 inches wide x 36 inches high, Low Temp No. EF3-CPA series "Modified" or equal. 14 gauge stainless steel top, 661 watt energy efficient hot food wells, 240/60/1 phase, open 18 gauge stainless steel storage base, 5 inch locking swivel casters, UL-approved to be used wet or dry. Modifications with the following components/features/accessories as follows:			
	a) Eighteen (18) inch flat space before the hot wells (Left side of hot wells)			
	b) Three (3) 661-watt hot food wells located on the Left side of the equipment (facing student serving side) with copper drains, copper drain manifold, copper shut-off valve, and provisions for a plastic drain hose.			
	c) Flat top space for standard size sheet pan arranged length-wise to the right of the hot wells. (facing student side)			
	d) Hatco No GR-24 heat lamp with switch, pre-wired to counter base to be mounted over "Flat top space only" (over the space in item c)			
	e) 78 inches long x 18 inches high 16 gauge stainless steel single over shelf with single service buffet-style food guard with "fully adjustable" 1/4 inch thick tempered glass front panels. To start at the hot well area and over item c.			
	f) 12 inches wide x "full length" solid-type stainless steel fold-down tray slide with tray runners ("V" ridges). Installed at 32 inches from the floor.			
	g) Line-up locks for adjacent counter			
	h) 5 inch diameter, ball bearing, swivel type casters to be non-marking and with brakes on all wheels.			
	i) Ten (10) foot long NEMA 14-30p Cord/plug assembly. 240 volts			
	j) Daisy chain receptacle to accept cord from item 15b			
	k) provide holes for electrical cord and computer cable (cord hooks) on both side to mount into wall plug and cashier station.			
	Delivered and set in place at the following site :			
	Terrebonne High School, 7318 Main Street, Houma LA 70360.			
	Site Visit Date: Manager Signature:			
	Price includes trade-in of current steam table. NOTE: TPSD will provide electrical within 6 feet of unit.			

Item	Description	Quantity	Unit Price	Extended Price
15b	Mobile Cold Food Counter	1		
	To be 74 inches long x 32 inches wide x 36 inches high, Low Temp No. 50-CFT series "Modified" or approved equal. 14 gauge stainless steel top, open 18 gauge stainless steel storage base, 5 inch locking swivel casters, UL-approved to be used wet or dry. Modifications with the following components/features/accessories:			
	a) One (1) 38 inch long refrigerated solid frost top. Installed to the left side of the unit (facing the student serving side)			
	b) 48 inches long x 18 inches high single service buffet-style food guard with "fully adjustable" 1/4 inch thick tempered glass front panels over the frost top.			
	c) Flat top space for standard size sheet pan arranged length-wise. Right side of the frost top.			
	d) Two tier display shelf without breath guards. Shelves to be 1/4 inch polished plate glass resting on a horizontal stainless steel framework welded to the uprights. Shelves to be over the flat space in item c.			
	e) 12 inches wide x "full length" solid-type stainless steel fold-down tray slide with tray runners ("V" ridges) Installed at 32 inches from the floor.			
	f) 18-gauge stainless steel cabinet base			
	g) Line-up locks for adjacent counter			
	h) 5 inch diameter, ball bearing, swivel type casters to be non-marking and with brakes on all wheels.			
	i) 5 foot long NEMA 14-20 cord/Plug assembly			
	j) provide holes for electrical cord and computer cable (cord hooks) on both side to mount into wall plug and cashier station.			
	Delivered and set in place at the following site :			
	Terrebonne High School, 7318 Main Street, Houma LA 70360.			
	Site Visit Date: Manager Signature:			
15c	Mobile Cashier Station	1		
	To be 28 inches long x 32 inches wide x 36 inches high, LowTemp No 28-CSD-S series "Modified" or approved equal. 14 gauge stainless steel top, 18 gauge enclosed base with hinged doors and slide-out shelf for CPU. Daisy chain to mobile unit 14b.			
	a) One grommet to accept Computer screen cords on the top of the station to be dropped to inside of the cabinet to CPU.			
	b) Hinged doors on closed cabinet base; slide out shelf to house a computer processing unit.			
	c) 12 inch wide x "full length" solid-type stainless steel fold-down tray slide with tray runner ("V" ridges).			
	d) Provide holes for electrical cord and computer cable (cord hooks) to mount to wall and cashier station.			
	Delivered and set in place at the following site :			
	Terrebonne High School, 7318 Main Street, Houma LA 70360.			
	Site Visit Date: Manager Signature:			
15d	Mobile Hot Food Counter	1		
	To be 96 inches long x 32 inches wide x 36 inches high, Low Temp No. EF3-CPA series "Modified" or equal. 14 gauge stainless steel top, 661 watt energy efficient hot food wells, 240/60/1 phase, open 18 gauge stainless steel storage base, 5 inch locking swivel casters, UL-approved to be used wet or dry. Modifications with the following components/features/accessories as follows:			
	a) Eighteen (18) inch flat space before the hot wells (Right side of hot wells)			
	b) Three (3) 661-watt hot food wells located on the right side of the equipment (facing student serving side) with copper drains, copper drain manifold, copper shut-off valve, and provisions for a plastic drain hose.			
	c) Flat top space for standard size sheet pan arranged length-wise to the left of the hot wells. (facing student side)			
	d) Hatco No GR-24 heat lamp with switch, pre-wired to counter base to be mounted over "Flat top space only" (over the space in item c)			
	e) 78 inches long x 18 inches high 16 gauge stainless steel single over shelf with single service buffet-style food guard with "fully adjustable" 1/4 inch thick tempered glass front panels. To start at the hot well area and over item c.			
	f) 12 inches wide x "full length" solid-type stainless steel fold-down tray slide with tray runners ("V" ridges). Installed at 32 inches from the floor.			
	g) Line-up locks for adjacent counter			
	h) 5 inch diameter, ball bearing, swivel type casters to be non-marking and with brakes on all wheels.			
	i) Ten (10) foot long NEMA 14-30p Cord/plug assembly. 240 volts			

Item	Description	Quantity	Price	Price
15d	Mobile Hot Food Counter (continued)			
	j) Daisy chain receptacle to accept cord from item 15e			
	k) provide holes for electrical cord and computer cable (cord hooks) on both side to mount into wall plug and cashier station.			
	Delivered and set in place at the following site :			
	Terrebonne High School, 7318 Main Street, Houma LA 70360.			
	Site Visit Date: Manager Signature:			
	Price includes trade-in of current steam table. NOTE: TPSD will provide electrical within 6 feet of unit.			
15e	Mobile Cold Food Counter	1		
	To be 74 inches long x 32 inches wide x 36 inches high, Low Temp No. 50-CFT series "Modified" or approved equal. 14 gauge stainless steel top, open 18 gauge stainless steel storage base, 5 inch locking swivel casters, UL-approved to be used wet or dry. Modifications with the following components/features/accessories:			
	a) One (1) 38 inch long refrigerated solid frost top. Installed to the right side of the unit (facing the student serving side)			
	b) 48 inches long x 18 inches high single service buffet-style food guard with "fully adjustable" 1/4 inch thick tempered glass front panels over the frost top.			
	c) Flat top space for standard size sheet pan arranged length-wise. Left side of the frost top.			
	d) Two tier display shelf without breath guards. Shelves to be 1/4 inch polished plate glass resting on a horizontal stainless steel framework welded to the uprights. Shelves to be over the flat space in item c.			
	e) 12 inches wide x "full length" solid-type stainless steel fold-down tray slide with tray runners ("V" ridges) Installed at 32 inches from the floor.			
	f) 18-gauge stainless steel cabinet base			
	g) Line-up locks for adjacent counter			
	h) 5 inch diameter, ball bearing, swivel type casters to be non-marking and with brakes on all wheels.			
	i) 5 foot long NEMA 14-20 cord/Plug assembly			
	j) provide holes for electrical cord and computer cable (cord hooks) on both side to mount into wall plug and cashier station.			
	Delivered and set in place at the following site :			
	Terrebonne High School, 7318 Main Street, Houma LA 70360.			
	Site Visit Date: Manager Signature:			
15f	Mobile Cashier Station	1		
	To be 28 inches long x 32 inches wide x 36 inches high, LowTemp No 28-CSD-S series "Modified" or approved equal. 14 gauge stainless steel top, 18 gauge enclosed base with hinged doors and slide-out shelf for CPU. Daisy chain to mobile unit 14e.			
	a) One grommet to accept Computer screen cords on the top of the station to be dropped to inside of the cabinet to CPU.			
	b) Hinged doors on closed cabinet base; slide out shelf to house a computer processing unit.			
	c) 12 inch wide x "full length" solid-type stainless steel fold-down tray slide with tray runner ("V" ridges).			
	d) Provide holes for electrical cord and computer cable (cord hooks) to mount to wall and cashier station.			
	Delivered and set in place at the following site :			
	Terrebonne High School, 7318 Main Street, Houma LA 70360.			
	Site Visit Date: Manager Signature:			

Item	Description	Quantity	Unit Price	Extended Price
16	Boilerless Steamer	1		
	NEED TO VERIFY--Top unit to fit on current bottom unit. SmartSteam100 Boilerless Steamer on Cabinet Base. Two compartment natural gas steamer on cabinet base, 5 pan capacity with basic controls, stainless steel exterior. Two stainless steel cooking compartments with coved interior corners. BASIC CONTROLS. Heavy duty doors and door latch mechanisms. Stainless steel water resistant cabinet base with stainless steel enclosed bottom. Including: Smart Steam 100 water treatment system (Model SSB-WT), additional replacement cartridge for the water treatment system, and two year extended warranty for K-12 educational system. 3/4" rear gas connection and gas pressure regulator. Requires 120/60/1 power supply, 2.0 amps maximum draw with 3 prong plug and 8 foot power cord . Price includes trade-in of current Groen top steamer at Evergreen Jr. High serial number # J15328-1-1t. To be Groen SmartSteam 100 Boilerless Steamer SSB-5GF or equivalent.			
	Delivered, set in place, and installed at the following site:			
	Evergreen Jr. High, 5000 West Main Street, Houma LA 70360			
	Site Visit Date: Manager Signature:			
17	Transport Warmer	4		
	Transport heated cabinet--Heavy-duty, 120 Volts, 60 Hz, single phase 15 amps with straight plug, (C5-STRPLG-15), 7 foot power cord, 3/4 Height (59 inches) solid doors insulated aluminum full length. Universal wire shelving (14 pairs) and universal slides. Including the following options: TRAVEL LATCH (C5-TRVL), FLUSH DOOR LATCH (C5-LATCHFLUSH-1). Color-Gray. To be Metro C5 3 Series Holding Unit Model #C537 HLFS UGYA or equivalent.			
18	Epoxy Wire Storage Shelving	2		
	Adjustable shelving system to contain 4 shelves and 4 post. Shelves to be 21 inches wide and 42 inches in length. Post to be 61 13/16 inches in length with casters attached. Shelves and post to be coated with epoxy that contains an antimicrobial product to protect the shelving in a wet environment. To be Metro Metroseal 4 shelves # A2136NK3 and 4 post #63UPK3 or equivalent.			
19	Epoxy Wire Storage Shelving	1		
	Adjustable shelving system to contain 4 shelves and 4 post. Shelves to be 18 inches wide and 48 inches in length. Post to be 61 13/16 inches in length with casters attached. Shelves and post to be coated with epoxy that contains an antimicrobial product to protect the shelving in a wet environment. To be Metro Metroseal 4 shelves # A1848NK3 and 4 post #63UPK3 or equivalent.			
20	Epoxy Wire Storage Shelving	1		
	Adjustable shelving system to contain 4 shelves and 4 post. Shelves to be 18 inches wide and 60 inches in length. Post to be 61 13/16 inches in length with casters attached. Shelves and post to be coated with epoxy that contains an antimicrobial product to protect the shelving in a wet environment. To be Metro Metroseal 4 shelves # A1860NK3 and 4 post #63UPK3 or equivalent.			
21	Food Holding Cabinet	12		
	Double compartment transport and storage cart with handles in the rear of the cart. Each compartment will hold twelve (12) sheet pans measuring 18" x 26" x 1 15/16". One-piece seamless, double-wall polyethylene construction for easy maintenance. Polyurethane foam insulation and air tight gaskets to help retain food quality and temperatures without the use of an external heat source. Vent cap on each compartment. Corrosion free stainless steel hinges and sturdy plastic, latches. Four 6 inch casters, 2 fixed, and 2 swivel, 1 brake for smooth transporting. To be Cambro #1826DTC in Dark Brown (131)			
22	Ice Pack	12		
	Reusable frozen ice pack. Dimensions 20.9 in. x 12.8 in. x 1.2 in. To be camchiller GN 1/1 Color Glacier Blue or equal.			
23	Stainless Steel Table	2		
	To be 24 inches in width x 30 inches in length. 16 gauge 300 series stainless steel table with 1 1/2 inch roll on front and rear, and sides turned down 90 degrees. Contains a stainless steel undershelf with marine edge. Legs are 1 5/8 inch O.D. stainless steel with 1 inch stainless steel adjustable bullet feet. Eagle Group T2430SEB or equal.			

**Terrebonne Parish School District
BID FORM**

Bid # 121218

Prices on this bid are for the **-36-**
period of 60 days from bid
opening. Return by:
December 12, 2018 @ 2:00pm

Item	Description	Quantity	Unit Price	Extended Price
24	8 Crate Stainless Steel Milk Box	3		
	MILK BOX, CHEST TYPE. Forced air with open front, designed to cover the milk with a cold-air blanket which keeps the milk between 33 and 38 degrees F during a 2 hour serving period. Single side access, with lid, door, adjustable hinges, and door latches made from 300 series stainless steel. Interior shall be 300 series stainless steel. Exterior shall be 300 series stainless steel. Interior to be stainless steel 300 series. Floors are heavily reinforced stainless steel (300 series). Heavy duty, epoxy coated steel wire floor racks are provided for added floor protection. Digital thermometer, cylinder lock, bottom drain, and seven (7) inch plate casters (2 with locks). Insulation foamed-in-place CFC polyurethane, 2 inches thick. Refrigerant to be in full compliance to all environmental concerns. Unit to be pre-wired with a eight (8) foot Service cord and NEMA 5015P plug set (115/60/1). To hold 8 crates of Milk. To be Beverage-Air Model #SMF34HC-1-S with above options or equivalent.			
25	Food Storage Box w/top	4		
	Polypropylene food storage boxes. Made of durable polypropylene that resist stains and ordors, can withstand temperatures from -40 degrees to 160 degrees; for use in refrigerators and freezers. 17 gallon size- 26 inches long by 18 inches wide by 12 inches deep. Color white. To by Poly Box Item 182612P with Poly Cover 1826CP or equal.			
26	Cooling Paddle, 64 oz	6		
	Cooling paddle, polycarbonate, NSF listed, 64 oz capacity; to be San Jamar or equal.			
27	Cooling Paddle, 128 oz	6		
	Cooling paddle, polycarbonate, NSF listed, 128 oz capacity; to be San Jamar or equal.			

1) I hereby declare price includes: a mandatory site visit prior to bid date to inspect all utilities, hook-ups, and access for delivery. Awarded Bidder is responsible for: delivery, uncrating, setting in place, equipment hook up, equipment testing/start up, and removal of all debris; for each item as specified.

2) I hereby ascertain that all door and entrance dimensions are adequate for equipment to be set in place.

3) I understand as the awarded bidder will schedule date of delivery with school board for all equipment within 90 days of award.

4) I understand as the awarded bidder will be the primary contact for all repairs while the product is under warranty. (Provide primary contact information for all warranty work.)

5) I UNDERSTAND THAT NO DROP SHIPMENTS WILL BE ALLOWED. ALL ITEMS SHALL BE SHIPPED F.O.B. TO DESTINATION.

Unless otherwise indicated, items will be shipped to 340 Saint Charles Street, Building #3, Houma, LA 70360.

Printed Name

Signature

Phone number

e-mail

Date

South Terrebonne High School-FREEZER**GENERAL**

Walk-in shall be constructed of prefab, precision-formed, modular panels designed for accurate, rapid field assembly. Walk-ins shall be equal to those manufactured by Master-Bilt.

CONSTRUCTION PLANS AND INSTRUCTIONS

Each walk-in shall have a complete set of installation instructions and assembly drawings. All panels shall have panel identification corresponding with assembly drawings to facilitate rapid and accurate field assembly.

Onsite job visit required by all bidders prior to bid. It is the responsibility of the bidder to verify location, job conditions, overall physical dimensions of walk-in, and verify voltage/phase of electrical provided.

Walk-in Freezer Overall Size: 8' 8 1/2 "W. x 9' 8 1/2 "L. x 7'-6"H. AS SHOWN ON DRAWING

1. PANEL CONSTRUCTION

Each panel shall consist of inner and outer metal pans, be precision-formed on steel dies and be equipped with cam-action locking devices.

The locking devices shall be operable from inside the walk-in and a 5/16" hex wrench will be supplied to activate locks. Panel shall be roll-formed to provide a flange that extends into the foam insulation for superior strength and adhesion. Panel widths, except corner panels, will be 11 1/2", 23", 34 1/2", 46" or 69".

To insure exact alignment and maximum strength, corner panels will be exact 90° angles with 1/4" interior radius and 1/2" exterior radius and will measure 12" in each horizontal exterior dimension.

Doors will be mounted in panels either 46" or 69" wide. Insulation will be rigid, pour-type polyurethane, foamed-in-place with minimum of 4" thickness. Locking devices will be no more than 46" apart.

Freezer to be with floor construction and have an interior floor ramp with a 30 degree angle.

Floor panels to be "HEAVY-DUTY REINFORCED SUPER-FLOOR" CAPABLE TO WITHSTAND 5000LB PSF..

All panels shall be connected one to another by placing the foamed tongue of one panel into the foamed groove of the adjoining panel, before actuating the cam-action locking device. The cam-action locking devices are actuated from inside the walk-in to permit erection against a wall or inside a room with close tolerances.

Press-fit plug buttons will be provided to seal wrench holes after panel assembly is complete.

Construction shall be as approved by the National Sanitation Foundation and shall bear the NSF® Seal of Approval affixed to the exterior of a door panel.

2. PANEL FINISH**2A. INTERIOR WALLS, and CEILING FINISH**

- 26 ga. pre-painted white smooth galvanized steel

2B. EXTERIOR WALLS AND ROOF FINISH

- 26 ga. pre-painted white smooth galvanized steel
 - 1/8" diamond aluminum treadplate to extend up 36 inches along front of box

2C. INTERIOR FLOOR FINISH

- 1/8" diamond aluminum treadplate foamed in place

3. INSULATION

Insulation shall be 4" thick rigid pour-type urethane. Insulation shall also be foamed-in-place using a CFC/HCFC-free 245fa blowing agent, with a tenacious bond to inner and outer metal pans. The "K" factor (thermal conductivity) shall be no more than .120 B.T.U. per hour, per square foot, per inch thickness, per degree Fahrenheit. The "U" factor (overall coefficient of heat transfer) shall not exceed .030 for 4" panels. Insulation shall be 97% closed cell to prevent moisture absorption. The "R" factor (insulation efficiency rating) shall be 33.33 for 4" panels.

4. RATINGS AND INDEPENDENT TESTING

Panels are to be independently tested:

- For structural strength
- Foam core tested by Factory Mutual (project #3022512) per ASTM E84-03 with the following results: Flame spread 25, smoke 400 @ 4" thickness
- ASTM E84-03, ASTM E711-87(1996), ASTM D1929-96(2001)e1, ASTM D482-00ae1, ASTM D1622-98

5. HEAVY DUTY HINGED WALK-IN DOORS

Opening size: 36" x 78" with 1/8" diamond aluminum kickplate protector door and frame, in and out; 36" high.

DOORS to be 22 ga Stainless Steel interior & exterior

Heavy-duty door contain the features found in the standard V-Series door listed below plus the following enhancements:

- A heavy-gauge, Z-shaped structural inner frame with a full length 1/4" thick steel hinge backing plate.
- Inner heater wires lining the door perimeter. One wire is provided in medium-temp applications. Two wires are supplied for low temp walk-ins (one wire shall be connected and operable while the other shall be for replacement of the first in case of a failure).

5A. Door shall be flush-mounted, infitting type with door panel construction the same as for other panels. Insulation shall be same thickness and type as used in other panels.

5B. Infitting doors will be hinged (to be determined).

5C. Infitting door frame construction shall consist of a vinyl frame with heavy-gauge steel backup.

5D. In addition, infitting door frame shall consist of 1/4" thick steel hinge backing plate welded to the hinge side of the heavy-gauge steel frame at hinge locations. Backing shall be precision-drilled and tapped to accept hinge butt-mounting screws.

5E. Infitting door shall be provided with adjustable hinge backup plates for each hinge. Backup plates shall be foamed-in-place behind the door leaf casing metal and shall consist of a minimum 1/4" thick steel plate contained within a minimum 14 gauge enclosure. Adjustable hinge backing plates shall be precision-drilled and tapped to accept hinge blade mounting screws and shall be designed to provide in-field adjustment of door hinges without removal of hinges or door from frame.

5F. On all walk-in freezers, infitting door jamb shall be provided with a thermostatically-controlled warmer cable around entire perimeter of opening. This warmer cable shall provide sufficient heat to prevent condensate or frost formation.

5G. Infitting door shall be fitted with thermoplastic, magnetic steel core gasket across top and along both sides of door. Bottom of door shall be fitted with adjustable, double vinyl wiper gasket. Gasket shall be water, oil, sunlight and fat resistant. When door is in closed position, the magnetic gasket shall form a positive airtight seal. Door gasket shall be easily replaceable.

5H. Infitting door shall be equipped with a deadbolt locking handle with chrome finish. Deadbolt lock can be independently locked by key and/or padlock. The entire locking mechanism will be located on the door frame with no moving parts through frame. Locking mechanism will have no exposed fasteners. Handle may be locked in the fully unlocked position with key and/or padlock to prevent unauthorized door locking.

All handles will be provided with inside safety release to prevent accidental or malicious entrapment in walk-in.

5I. Infitting door shall be equipped with 3 heavy-duty, spring-loaded hinges. Hinges shall have cam-lift nylon bearings mounted on heavy stainless steel pins. Door hinges shall have positive "hold-open" feature allowing door to remain open unaided, when opened to 180° position. Hinges shall have a polished chrome finish.

5J. Entry doors shall be provided with heavy-duty door closure in addition to spring-loaded hinges.

5K. Each infitting door panel shall be equipped with a vapor proof light fixture connected to a toggle switch and pilot light located on the panel exterior.

5L. All infitting doors and frames shall have UL listing.

5M. An audible, visual temperature alarm shall be provided complete with high/low setpoints from -40°F to 120°F, standard 25 ft. sensor line, continuous digital read out of monitored temperature, built-in battery and charger circuitry for power failure annunciation, piezo-type horn for audible notification, green LED-safe light, red LED-alarm light and temperature accuracy +/- 1°F. Master-Bilt model #MBWA-1

5N. A Vinyl hinged SPLIT 50/50 Door Curtain shall be provided at door opening. Door frame will have additional backing for support of vinyl door Curtain. Vinyl door shall be NSF approved and not less than 1/8 inch thick vinyl material. Curtain will be of heavy duty construction with minimum 1" overlap.

6. PRESSURE RELIEF PORT

PORT IS REQUIRED AND MUST BE SPECIFIED ON ANY WALK-IN OPERATING AT 0°F OR LOWER.

An oversized pressure relief port shall be provided to equalize atmospheric pressure inside and outside walk-in caused by temperature changes due to product loading, door opening and defrost cycles. Relief port shall be provided with 115/60/1 AC heater element to prevent freezing.

In all freezer applications up through 3 H.P., a single relief port must be included.

7. LED LIGHTING

Freezer compartment will be equipped with 2 each 48" LED light fixtures with bulbs included.

Fixtures shall be KASON LED Fixture 48" x 39W, .33A, 120-227VAC.

8. REFRIGERATION

FREEZER:

(1) MSLZ0151B 4HP LOW TEMPERATURE SCROLL COMPRESSOR

R-404A Refrigerant

Voltage to be 208-230 single phase. Must be verified prior to ordering by successful bidder

(1) EILZ0141B MATCHING EVAPORATOR COIL

8A. BUILT-UP REMOTE MS (SCROLL) SERIES CONDENSING UNITS

Remote refrigeration systems MH shall consist of a pre-packaged, heavy-duty remote condensing unit in conjunction with a generously-sized, condenser with low t.d. Condenser shall contain copper tubing and aluminum fins as well as heavy-duty, double-bearing fan motors. Condensing unit shall be assembled on a galvanized steel base with a generously-sized receiver (for ample pumpdown capacity of up to 100 foot maximum runs). Unit shall also have 1 1/2" high galvanized steel angle legs and a mechanically-fastened galvanized steel weather hood.

Factory pre-piping on units shall consist of pre-installed and tested liquid and suction line kits. These kits consist of a liquid line drier and sight glass, a shut-off valve and a heavy-duty compressor with suction service valve. Piping shall extend to the edge of the unit base and be pre-tested to that point, requiring only piping between condensing unit and evaporator, evacuation and charging.

On factory pre-wired units, wiring shall consist of all operating controls (including fan and compressor), a pre-wired, installed and preset fan-cycling switch, crankcase heater, pre-wired electrical control panel with pre-mounted and wired defrost timer (on low temp units only). Additionally, units will contain pre-set, non-adjustable high and low pressure controls in medium temp units. The low pressure control is adjustable in low temp units.

Condensing unit shall be supplied with a standard one year parts and compressor warranty. An optional four year extended compressor warranty will be available.

Unit shall be listed by Underwriters Laboratories.

There shall be a matching evaporator assembly properly sized for the specific room temperature and ready for rapid field installation.

Condensing unit model Ms shall consist of an internally spring-mounted, high starting torque, SCROLL compressor.

8B E-SERIES MATCHING EVAPORATORS

E-Series shall consist of a heavy-duty unit cooler reverse cycle defrost Freezer evaporator will be reverse cycle defrost through the use of the Master Controller System.

8C. MASTER CONTROLLER SYSTEM

To utilize the latest in energy savings technology a Master-Controller system will be used.

The refrigeration system of walk-in cooler and freezer will be equipped with a Master Controller electronic control system mounted to the evaporator coil. The Master Controller will be custom-designed for walk-in freezers to control an electric expansion valve in response to evaporator superheat and return air temperature. The Master Controller is part of the refrigeration system which also contains the multi-compressor system DRS series and one or more evaporator coils.

No power wiring is required between evaporator coils and condensing units (thermostat wire required when reverse cycle defrost option is specified).

Additionally, a refrigeration system containing a Master Controller will consist of the following factory-mounted parts:

- Electronic controller board with two-digit LED and two pushbuttons on panel interface for setup
- Three solid state temperature sensors
- Pressure transducer
- Electric expansion valve
- 24V transformer
- External relay to control liquid line solenoid valve or compressor contactor

The Master Controller board will contain three relay outputs: defrost heater (20A), evaporator fan (10A) and alarm (5A). It will be possible to configure this Master Controller system in a master/slave application for up to a total of 6 evaporators (including master).

Demand defrost will be the default method for the Master Controller system for freezers, off cycle will be the default defrost method for coolers.

The room temperature range will be -40°F to 80°F. Medium temperature application is pre-set at 35°F cut-out room temperature with air defrost. Low temperature application is pre-set at -10°F cut-out room temperature with demand defrost. The cut-in temperature differential is 5°F by default. These set points can be field set at the job site if different settings are desired.

8D. REVERSE CYCLE DEFROST

The refrigeration system of freezer will be equipped with an optional patented reverse cycle defrost system. This system consists of a reverse cycle valve mounted to the condensing unit and is an optional component on refrigeration systems utilizing Master Controller.

Warranties

Walk-in insulated panels are to be free from insulation failure for a period of 10 years under normal use and service.

All Hardware and Electrical components are to be free from defects in material and workmanship for a period of one year and three months from date of shipment.

Refrigeration compressor shall have an additional 4 year compressor replacement warranty.

Labor

A two year Service Warranty shall be provided by the successful bidder/installer.

Delivery shall be FOB to successful installer's warehouse.

Any alternates to be considered must be submitted as specified in the bid documents.
Any and all variances to these specifications are to be submitted in writing.
If alternates are acceptable an addendum will be issued with alternates to all bidders.

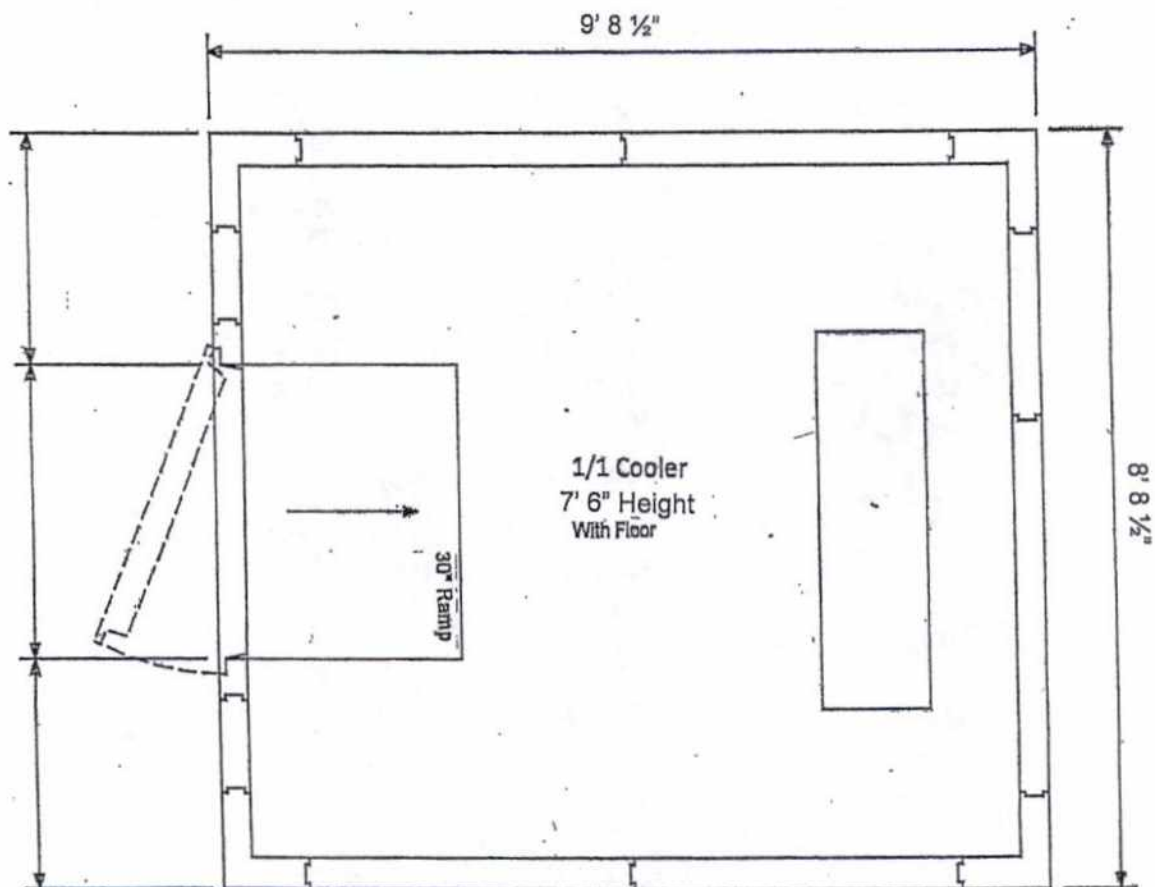

Elysian Fields Middle School-FREEZER**GENERAL**

Walk-in shall be constructed of prefab, precision-formed, modular panels designed for accurate, rapid field assembly. Walk-ins shall be equal to those manufactured by Master-Bilt.

CONSTRUCTION PLANS AND INSTRUCTIONS

Each walk-in shall have a complete set of installation instructions and assembly drawings. All panels shall have panel identification corresponding with assembly drawings to facilitate rapid and accurate field assembly.

Onsite job visit required by all bidders prior to bid. It is the responsibility of the bidder to verify location, job conditions, overall physical dimensions of walk-in, and verify voltage/phase of electrical provided.

Walk-in Freezer Overall Size: 7' 9" W. x 9' 8" L. x 7'-6"H. AS SHOWN ON DRAWING

1. PANEL CONSTRUCTION

Each panel shall consist of inner and outer metal pans, be precision-formed on steel dies and be equipped with cam-action locking devices.

The locking devices shall be operable from inside the walk-in and a $\frac{5}{16}$ " hex wrench will be supplied to activate locks. Panel shall be roll-formed to provide a flange that extends into the foam insulation for superior strength and adhesion. Panel widths, except corner panels, will be 11 $\frac{1}{2}$ ", 23", 34 $\frac{1}{2}$ ", 46" or 69".

To insure exact alignment and maximum strength, corner panels will be exact 90° angles with $\frac{1}{4}$ " interior radius and $\frac{1}{2}$ " exterior radius and will measure 12" in each horizontal exterior dimension.

Doors will be mounted in panels either 46" or 69" wide. Insulation will be rigid, pour-type polyurethane, foamed-in-place with minimum of 4" thickness. Locking devices will be no more than 46" apart.

Freezer to be with floor construction and have an interior floor ramp with a 30 degree angle.

Floor panels to be "HEAVY-DUTY REINFORCED SUPER-FLOOR" CAPABLE TO WITHSTAND 5000LB PSF..

All panels shall be connected one to another by placing the foamed tongue of one panel into the foamed groove of the adjoining panel, before actuating the cam-action locking device. The cam-action locking devices are actuated from inside the walk-in to permit erection against a wall or inside a room with close tolerances.

Press-fit plug buttons will be provided to seal wrench holes after panel assembly is complete.

Construction shall be as approved by the National Sanitation Foundation and shall bear the NSF® Seal of Approval affixed to the exterior of a door panel.

2. PANEL FINISH**2A. INTERIOR WALLS, and CEILING FINISH**

- 26 ga. pre-painted white smooth galvanized steel

2B. EXTERIOR WALLS AND ROOF FINISH

- 26 ga. pre-painted white smooth galvanized steel
 - 1/8" diamond aluminum treadplate to extend up 36 inches along front of box

2C. INTERIOR FLOOR FINISH

- 1/8" diamond aluminum treadplate foamed in place

3. INSULATION

Insulation shall be 4" thick rigid pour-type urethane. Insulation shall also be foamed-in-place using a CFC/HCFC-free 245fa blowing agent, with a tenacious bond to inner and outer metal pans. The "K" factor (thermal conductivity) shall be no more than .120 B.T.U. per hour, per square foot, per inch thickness, per degree Fahrenheit. The "U" factor (overall coefficient of heat transfer) shall not exceed .030 for 4" panels. Insulation shall be 97% closed cell to prevent moisture absorption. The "R" factor (insulation efficiency rating) shall be 33.33 for 4" panels.

4. RATINGS AND INDEPENDENT TESTING

Panels are to be independently tested:

- For structural strength
- Foam core tested by Factory Mutual (project #3022512) per ASTM E84-03 with the following results: Flame spread 25, smoke 400 @ 4" thickness
- ASTM E84-03, ASTM E711-87(1996), ASTM D1929-96(2001)e1, ASTM D482-00ae1, ASTM D1622-98

5. HEAVY DUTY HINGED WALK-IN DOORS

Opening size: 36" x 78" with 1/8" diamond aluminum kickplate protector door and frame, in and out; 36" high.

DOORS to be 22 ga Stainless Steel interior & exterior

Heavy-duty door contain the features found in the standard V-Series door listed below plus the following enhancements:

- A heavy-gauge, Z-shaped structural inner frame with a full length 1/4" thick steel hinge backing plate.
- Inner heater wires lining the door perimeter. One wire is provided in medium-temp applications. Two wires are supplied for low temp walk-ins (one wire shall be connected and operable while the other shall be for replacement of the first in case of a failure).

5A. Door shall be flush-mounted, infitting type with door panel construction the same as for other panels. Insulation shall be same thickness and type as used in other panels.

5B. Infitting doors will be hinged (to be determined).

5C. Infitting door frame construction shall consist of a vinyl frame with heavy-gauge steel backup.

5D. In addition, infitting door frame shall consist of 1/4" thick steel hinge backing plate welded to the hinge side of the heavy-gauge steel frame at hinge locations. Backing shall be precision-drilled and tapped to accept hinge butt-mounting screws.

5E. Infitting door shall be provided with adjustable hinge backup plates for each hinge. Backup plates shall be foamed-in-place behind the door leaf casing metal and shall consist of a minimum 1/4" thick steel plate contained within a minimum 14 gauge enclosure. Adjustable hinge backing plates shall be precision-drilled and tapped to accept hinge blade mounting screws and shall be designed to provide in-field adjustment of door hinges without removal of hinges or door from frame.

5F. On all walk-in freezers, infitting door jamb shall be provided with a thermostatically-controlled warmer cable around entire perimeter of opening. This warmer cable shall provide sufficient heat to prevent condensate or frost formation.

5G. Infitting door shall be fitted with thermoplastic, magnetic steel core gasket across top and along both sides of door. Bottom of door shall be fitted with adjustable, double vinyl wiper gasket. Gasket shall be water, oil, sunlight and fat resistant. When door is in closed position, the magnetic gasket shall form a positive airtight seal. Door gasket shall be easily replaceable.

5H. Infitting door shall be equipped with a deadbolt locking handle with chrome finish. Deadbolt lock can be independently locked by key and/or padlock. The entire locking mechanism will be located on the door frame with no moving parts through frame. Locking mechanism will have no exposed fasteners. Handle may be locked in the fully unlocked position with key and/or padlock to prevent unauthorized door locking.

All handles will be provided with inside safety release to prevent accidental or malicious entrapment in walk-in.

5I. Infitting door shall be equipped with 3 heavy-duty, spring-loaded hinges. Hinges shall have cam-lift nylon bearings mounted on heavy stainless steel pins. Door hinges shall have positive "hold-open" feature allowing door to remain open unaided, when opened to 180° position. Hinges shall have a polished chrome finish.

5J. Entry doors shall be provided with heavy-duty door closure in addition to spring-loaded hinges.

5K. Each infitting door panel shall be equipped with a vapor proof light fixture connected to a toggle switch and pilot light located on the panel exterior.

5L. All infitting doors and frames shall have UL listing.

5M. An audible, visual temperature alarm shall be provided complete with high/low setpoints from -40°F to 120°F, standard 25 ft. sensor line, continuous digital read out of monitored temperature, built-in battery and charger circuitry for power failure annunciation, piezo-type horn for audible notification, green LED-safe light, red LED-alarm light and temperature accuracy +/- 1°F. Master-Bilt model #MBWA-1

5N. A Vinyl hinged SPLiT 50/50 Door Curtain shall be provided at door opening. Door frame will have additional backing for support of vinyl door Curtain. Vinyl door shall be NSF approved and not less than 1/8 inch thick vinyl material. Curtain will be of heavy duty construction with minimum 1" overlap.

6. PRESSURE RELIEF PORT

PORT IS REQUIRED AND MUST BE SPECIFIED ON ANY WALK-IN OPERATING AT 0°F OR LOWER.

An oversized pressure relief port shall be provided to equalize atmospheric pressure inside and outside walk-in caused by temperature changes due to product loading, door opening and defrost cycles. Relief port shall be provided with 115/60/1 AC heater element to prevent freezing.

In all freezer applications up through 3 H.P., a single relief port must be included.

7. LED LIGHTING

Freezer compartment will be equipped with 2 each 48" LED light fixtures with bulbs included. Fixtures shall be KASON LED Fixture 48" x 39W, .33A, 120-227VAC.

8. REFRIGERATION

FREEZER:

(1) MSLZ0151B 4HP LOW TEMPERATURE SCROLL COMPRESSOR

R-404A Refrigerant

Voltage to be 208-230 three phase. Must be verified prior to ordering by successful bidder

(1) EILZ0141B MATCHING EVAPORATOR COIL

8A. BUILT-UP REMOTE MS (SCROLL) SERIES CONDENSING UNITS

Remote refrigeration systems MH shall consist of a pre-packaged, heavy-duty remote condensing unit in conjunction with a generously-sized, condenser with low t.d. Condenser shall contain copper tubing and aluminum fins as well as heavy-duty, double-bearing fan motors. Condensing unit shall be assembled on a galvanized steel base with a generously-sized receiver (for ample pumpdown capacity of up to 100 foot maximum runs). Unit shall also have 1 1/2" high galvanized steel angle legs and a mechanically-fastened galvanized steel weather hood.

Factory pre-piping on units shall consist of pre-installed and tested liquid and suction line kits. These kits consist of a liquid line drier and sight glass, a shut-off valve and a heavy-duty compressor with suction service valve. Piping shall extend to the edge of the unit base and be pre-tested to that point, requiring only piping between condensing unit and evaporator, evacuation and charging.

On factory pre-wired units, wiring shall consist of all operating controls (including fan and compressor), a pre-wired, installed and preset fan-cycling switch, crankcase heater, pre-wired electrical control panel with pre-mounted and wired defrost timer (on low temp units only). Additionally, units will contain pre-set, non-adjustable high and low pressure controls in medium temp units. The low pressure control is adjustable in low temp units.

Condensing unit shall be supplied with a standard one year parts and compressor warranty. An optional four year extended compressor warranty will be available.

Unit shall be listed by Underwriters Laboratories.

There shall be a matching evaporator assembly properly sized for the specific room temperature and ready for rapid field installation.

Condensing unit model Ms shall consist of an internally spring-mounted, high starting torque, SCROLL compressor.

8B E-SERIES MATCHING EVAPORATORS

E-Series shall consist of a heavy-duty unit cooler reverse cycle defrost Freezer evaporator will be reverse cycle defrost through the use of the Master Controller System.

8C. MASTER CONTROLLER SYSTEM

To utilize the latest in energy savings technology a Master-Controller system will be used.

The refrigeration system of walk-in cooler and freezer will be equipped with a Master Controller electronic control system mounted to the evaporator coil. The Master Controller will be custom-designed for walk-in freezers to control an electric expansion valve in response to evaporator superheat and return air temperature. The Master Controller is part of the refrigeration system which also contains the multi-compressor system DRS series and one or more evaporator coils.

No power wiring is required between evaporator coils and condensing units (thermostat wire required when reverse cycle defrost option is specified).

Additionally, a refrigeration system containing a Master Controller will consist of the following factory-mounted parts:

- Electronic controller board with two-digit LED and two pushbuttons on panel interface for setup
- Three solid state temperature sensors
- Pressure transducer
- Electric expansion valve
- 24V transformer
- External relay to control liquid line solenoid valve or compressor contactor

The Master Controller board will contain three relay outputs: defrost heater (20A), evaporator fan (10A) and alarm (5A). It will be possible to configure this Master Controller system in a master/slave application for up to a total of 6 evaporators (including master).

Demand defrost will be the default method for the Master Controller system for freezers, off cycle will be the default defrost method for coolers.

The room temperature range will be -40°F to 80°F. Medium temperature application is pre-set at 35°F cut-out room temperature with air defrost. Low temperature application is pre-set at -10°F cut-out room temperature with demand defrost. The cut-in temperature differential is 5°F by default. These set points can be field set at the job site if different settings are desired.

8D. REVERSE CYCLE DEFROST

The refrigeration system of freezer will be equipped with an optional patented reverse cycle defrost system. This system consists of a reverse cycle valve mounted to the condensing unit and is an optional component on refrigeration systems utilizing Master Controller.

Warranties

Walk-in insulated panels are to be free from insulation failure for a period of 10 years under normal use and service.

All Hardware and Electrical components are to be free from defects in material and workmanship for a period of one year and three months from date of shipment.

Refrigeration compressor shall have an additional 4 year compressor replacement warranty.

Labor

A two year Service Warranty shall be provided by the successful bidder/installer.

Delivery shall be FOB to successful installer's warehouse.

Any alternates to be considered must be submitted as specified in the bid documents.

Any and all variances to these specifications are to be submitted in writing.

If alternates are acceptable an addendum will be issued with alternates to all bidders.

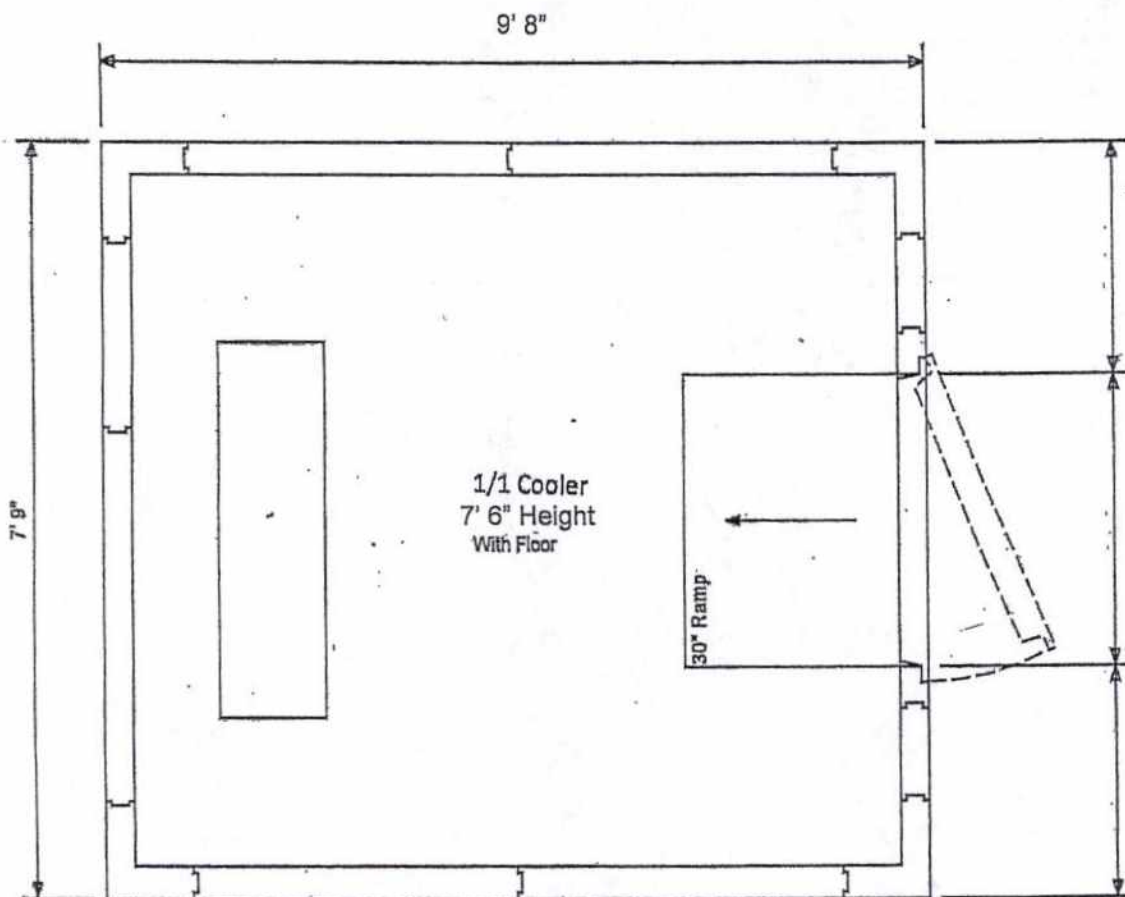

TERREBONNE

Parish School District

Signature Page

Kitchen Equipment Bid #121218

Vendor Name: _____

Phone #: _____

Fax #: _____

Address: _____

Email Address: _____

Bid Period: One time purchase

Bidder acknowledges receipt of Addenda by checking the space below as applicable:

____ 1 ____ 2 ____ 3 ____ 4 ____ Not Applicable

All prices on this bid are held firm for the period of 60 days from the bid opening.

Your bid must be signed and dated.

Authorized Representative

Signature

Date

Note: A completed signature page must be attached to the bid

Certification Regarding Debarment, Suspension, Ineligibility and Voluntary Exclusion - Lower Tier Covered Transactions

This certification is required by the regulations implementing Executive Order 12549, Debarment and Suspension, 7 CFR Part 3017, Section 3017, subpart c- Responsibilities of Participants. The regulations were published in the November 26, 2003, Federal Register (pages 66534-66566). Copies of the regulations may be obtained by contacting the Department of Agriculture.

(BEFORE COMPLETING CERTIFICATION, READ ATTACHED NSTRUCTIONS)

- (1) The prospective lower tier participant certifies, by submission of this proposal, that neither it nor its principals are presently debarred, suspended, proposed for debarment, declared ineligible, or voluntarily excluded from participation in this transaction by any Federal department or agency.

- (2) Where the prospective lower tier participant is unable to certify any of the statements in this certification, such prospective participant shall attach an explanation to this proposal.

Organization Name

PR/Award Number or Project Name

Name and Title of Authorized Representative

Signature

Date

INSTRUCTIONS TO BIDDERS FOR COMPLETING CERTIFICATION FORM

NOTE: Each responsive bidder must include this certification statement with its bid on each contract equaling or exceeding \$25,000 or any contract for audit services regardless of amount.

1. By signing and submitting this form, the prospective lower tier participant is providing the certification set out on the reverse side in accordance with these instructions.
2. The certification in this clause is a material representation of fact upon which reliance was placed when this transaction was entered into. If it is later determined that the prospective lower tier participant knowingly rendered an erroneous certification, in addition to other remedies available to the Federal Government, the department or agency with which this transaction originated may pursue available remedies, including suspension and/or debarment.
3. The prospective lower tier participant shall provide immediate written notice to the person to which this proposal is submitted if at any time the prospective lower tier participant learns that its certification was erroneous when submitted or has become erroneous by reason of changed circumstances.
4. The terms *covered transaction*, *debarred*, *suspended*, *ineligible*, *lower tier covered transaction*, *participant*, *person*, *primary covered transaction*, *principal*, *proposal*, and *voluntarily excluded*, as used in this clause, have the meanings set out in the Definitions and Coverage sections of the U. S. Department of Agriculture regulations 7 CFR 3017 implementing Executive Order 12 549. (Contact the person to whom this proposal is submitted for assistance in obtaining a copy of those regulations.)
5. The prospective lower tier participant agrees by submitting this form that, should the proposed covered transaction be entered into, it shall not knowingly enter into any lower tier covered transaction with a person who is debarred, suspended, declared ineligible, or voluntarily excluded from participation in this covered transaction, unless authorized by the department or agency with which this transaction originated.
6. The prospective lower tier participant further agrees by submitting this form that it will include this clause titled "Certification Regarding Debarment, Suspension, Ineligibility and Voluntary Exclusion Lower Tier Covered Transaction" without modification in all lower tier covered transactions and in all solicitations for lower tier covered transactions.
7. A participant in a covered transaction may rely upon a certification that a prospective participant in a lower tier covered transaction has not been debarred, suspended, ineligible, or voluntarily excluded from the covered transaction, unless the participant knows that the certification is erroneous. A participant may decide the method and frequency by which it determines the eligibility of its principals. Each participant may, but is not required to, check the Nonprocurement List.
8. Nothing contained in the foregoing shall be construed to require establishment of a system of records in order to render in good faith the certification required by this clause. The knowledge and information of a participant is not required to exceed that which is normally possessed by a prudent person in the ordinary course of business dealings.
9. Except for transactions authorized under Paragraph 5 of these instructions, if a participant in a covered transaction knowingly enters into a lower tier covered transaction with a person who is suspended, debarred, ineligible, or voluntarily excluded from participation in this transaction, in addition to other remedies available to the Federal Government, the department or agency with which this transaction originated may pursue available remedies, including suspension and/or debarment.

CERTIFICATION FOR CONTRACTS, GRANTS, LOANS, AND COOPERATIVE
AGREEMENTS EXCEEDING \$100,000 IN FEDERAL FUNDS

The undersigned certifies, to the best of his or her knowledge and belief, that:

- (1) No Federal appropriated funds have been paid or will be paid, by or on behalf of the undersigned, to any person for influencing or attempting to influence an officer or employee of any agency, a Member of Congress, an officer or employee of Congress, or an employee of a Member of Congress in connection with the awarding of any Federal contract, the making of any Federal grant, the making of any Federal loan, the entering into of any cooperative agreement, and the extension, continuation, renewal, amendment, or modification of any Federal contract, grant, loan, or cooperative agreement.
- (2) If any funds other than Federal appropriated funds have been paid or will be paid to any person for influencing or attempting to influence an officer or employee of any agency, a Member of Congress, an officer or employee of Congress, or an employee of a Member of Congress in connection with this Federal contract, grant, loan, or cooperative agreement, the undersigned shall complete and submit Standard Form - LLL, "Disclosure of Lobbying Activities," in accordance with its instructions.
- (3) The undersigned shall require that the language of this certification be included in the award documents for all subawards (exceeding \$100,000 in Federal funds) at all tiers (including subcontracts, subgrants, and contracts under grants, loans, and cooperative agreements) and that all subrecipients shall certify and disclose accordingly.

This certification is a material representation of fact upon which reliance was placed when this transaction was made or entered into. Submission of this certification is a prerequisite for making or entering into this transaction imposed by section 1352, title 31, U.S. Code. Any person who fails to file the required certification shall be subject to a civil penalty of not less than \$10,000 and not more than \$100,000 for each such failure.

NAME/ADDRESS of VENDOR

TITLE/TITLE of SUBMITTING OFFICIAL

SIGNATURE

DATE

Approved by OMB
0348-0046

Disclosure of Lobbying Activities

Complete this form to disclose lobbying activities pursuant to 31 U.S.C. 1352
(See attached for public burden disclosure)

1. Type of Federal Action: (enter letter of choice) <input type="checkbox"/> a. contract <input type="checkbox"/> b. grant <input type="checkbox"/> c. cooperative agreement <input type="checkbox"/> d. loan <input type="checkbox"/> e. loan guarantee <input type="checkbox"/> f. loan insurance		2. Status of Federal Action: (enter letter of choice) <input type="checkbox"/> a. bid/offer/application <input type="checkbox"/> b. initial award <input type="checkbox"/> c. post-award		3. Report Type: <input type="checkbox"/> a. initial filing <input type="checkbox"/> b. material change For material change only: Year _____ quarter _____ Date of last report _____	
4. Name and Address of Reporting Entity: ____ Prime _____ Subawardee Tier _____, if known: Congressional District, if known:			5. If Reporting Entity in No. 4 is Subawardee, Enter Name and Address of Prime: Congressional District, if known:		
6. Federal Department/Agency:			6. Federal Program Name/Description: CFDA Number, if applicable: _____		
8. Federal Action Number, if known:			9. Award Amount, if known: \$ _____		
10. a. Name and Address of Lobbying Registrant (if individual, last name, first name, MI):			b. Individuals Performing Services (including address if different from No. 10a) (last name, first name, MI):		
11. Amount of Payment (check all that apply): \$ _____ <input type="checkbox"/> actual <input type="checkbox"/> planned			13. Type of Payment (check all that apply): <input type="checkbox"/> a. retainer <input type="checkbox"/> b. one-time fee <input type="checkbox"/> c. commission <input type="checkbox"/> d. contingent fee <input type="checkbox"/> e. deferred <input type="checkbox"/> f. other, specify: _____		
12. Form of Payment (check all that apply): <input type="checkbox"/> a. cash <input type="checkbox"/> b. in-kind; specify: nature _____ value _____					
14. Brief Description of Services Performed or to be Performed and Date(s) of Service, including officer(s), employee(s), or Member(s) contacted, for Payment Indicated in Item 11: (Attach Continuation Sheet(s) SF-LLL-A, if necessary)					
15. Continuation Sheet(s) SF-LLL-A attached: _____ Yes _____ No					
16. Information requested through this form is authorized by Title 31 U.S.C. Section 1352. This Disclosure of Lobbying Activities is a material representation of fact upon which reliance was placed by the tier above when this transaction was made or entered into. This disclosure is required pursuant to 31 U.S.C. 1352. This information will be reported to the Congress semi-annually and will be available for public inspection. Any person who fails to file the required disclosure shall be subject to a civil penalty of not less than \$10,000 and not more than \$100,000 for each such failure.			Signature: _____		
			Print Name: _____		
Federal Use Only			Title: _____		
			Telephone No.: _____ Date: _____		
			Authorized for Local Reproduction Standard Form - LLL (Rev. 7-97)		

Office of Chief Financial Officer, USDA

Pt. 3018, App. B

**DISCLOSURE OF LOBBYING ACTIVITIES
CONTINUATION SHEET**

Approved by OMB
0348-0046

Reporting Entity: _____ Page _____ of _____

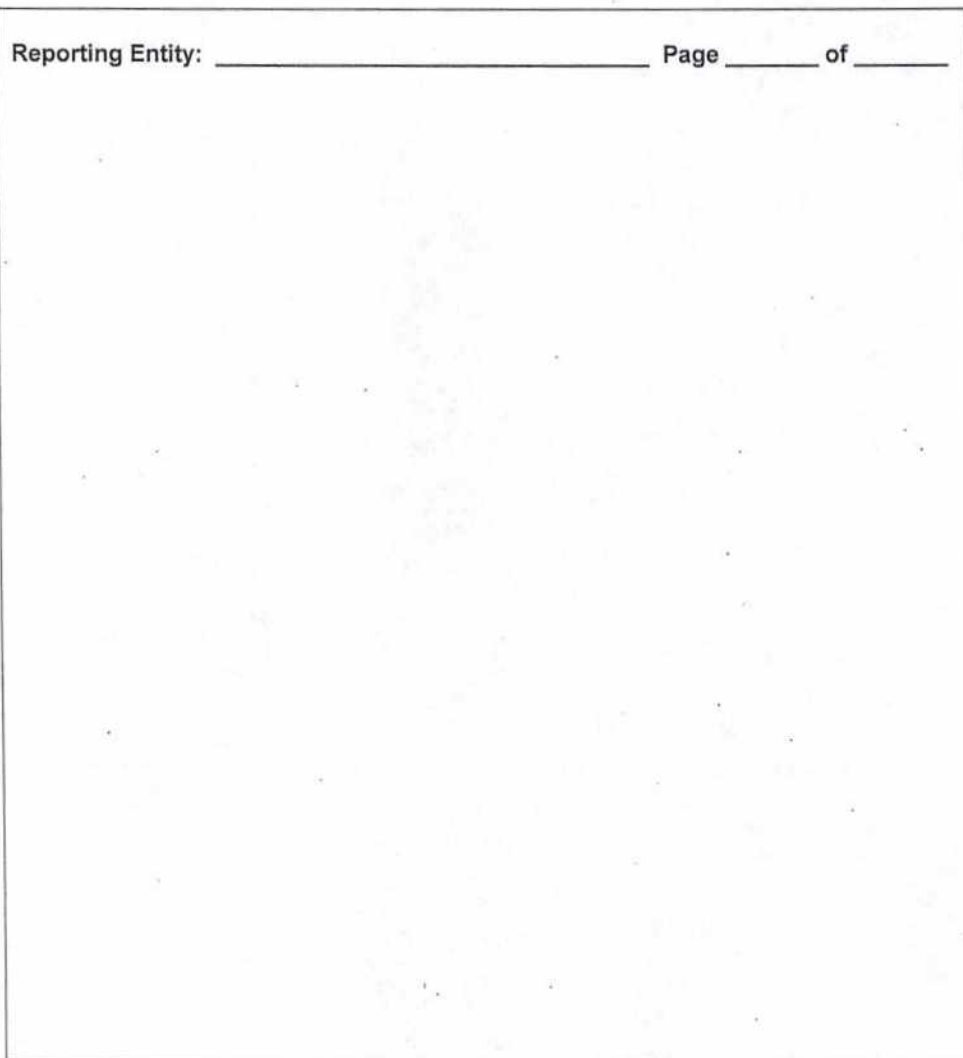

Authorized for Local Reproduction
Standard Form - LLL-A

INSTRUCTIONS FOR COMPLETION OF SF-LLL, DISCLOSURE OF LOBBYING ACTIVITIES

This disclosure form shall be completed by the reporting entity, whether subawardee or prime Federal recipient, at the initiation or receipt of a covered Federal action, or a material change to a previous filing, pursuant to title 31 U.S.C. section 1352. The filing of a form is required for each payment or agreement to make payment to any lobbying entity for influencing or attempting to influence an officer or employee of any agency, a Member of Congress, an officer or employee of Congress, or an employee of a Member of Congress in connection with a covered Federal action. Complete all items that apply for both the initial filing and material change report. Refer to the implementing guidance published by the Office of Management and Budget for additional information.

1. Identify the type of covered Federal action for which lobbying activity is and/or has been secured to influence the outcome of a covered Federal action.
2. Identify the status of the covered Federal action.
3. Identify the appropriate classification of this report. If this is a followup report caused by a material change to the information previously reported, enter the year and quarter in which the change occurred. Enter the date of the last previously submitted report by this reporting entity for this covered Federal action.
4. Enter the full name, address, city, State and zip code of the reporting entity. Include Congressional District, if known. Check the appropriate classification of the reporting entity that designates if it is, or expects to be, a prime or subaward recipient. Identify the tier of the subawardee, e.g., the first subawardee of the prime is the 1st tier. Subawards include but are not limited to subcontracts, subgrants and contract awards under grants.
5. If the organization filing the report in item 4 checks "Subawardee," then enter the full name, address, city, State and zip code of the prime Federal recipient. Include Congressional District, if known.
6. Enter the name of the federal agency making the award or loan commitment. Include at least one organizational level below agency name, if known. For example, Department of Transportation, United States Coast Guard.
7. Enter the Federal program name or description for the covered Federal action (item 1). If known, enter the full Catalog of Federal Domestic Assistance (CFDA) number for grants, cooperative agreements, loans, and loan commitments.
8. Enter the most appropriate Federal identifying number available for the Federal action identified in item 1 (e.g., Request for Proposal (RFP) number; Invitations for Bid (IFB) number; grant announcement number; contract, grant, or loan award number; application/proposal control number assigned by the Federal agency). Include prefixes, e.g., "RFP-DE-90-001."
9. For a covered Federal action where there has been an award or loan commitment by the Federal agency, enter the Federal amount of the award/loan commitment for the prime entity identified in item 4 or 5.
10. (a) Enter the full name, address, city, state and zip code of the lobbying entity engaged by the reporting entity identified in item 4 to influence the covered Federal action.
(b) Enter the full names of the individual(s) performing services, and include full address if different from 10(a). Enter Last Name, First Name, and Middle Initial (MI).
11. Enter the amount of compensation paid or reasonably expected to be paid by the reporting entity (item 4) to the lobbying entity (item 10). Indicate whether the payment has been made (actual) or will be made (planned). Check all boxes that apply. If this is a material change report, enter the cumulative amount of payment made or planned to be made.
12. Check the appropriate box(es). Check all boxes that apply. If payment is made through an in-kind contribution, specify the nature and value of the in-kind payment.
13. Check the appropriate box(es). Check all boxes that apply. If other, specify nature.
14. Provide a specific and detailed description of the services that the lobbyist has performed, or will be expected to perform, and the date(s) of any services rendered. Include all preparatory and related activity, not just time spent in actual contact with Federal officials. Identify the Federal official(s) or employee(s) contacted or the officer(s), employee(s), or Member(s) of Congress that were contacted.
15. Check whether or not a SF-LLL-A Continuation Sheet(s) is attached.
16. The certifying official shall sign and date the form, print his/her name, title, and telephone number.

Public reporting burden for this collection of information is estimated to average 30 minutes per response, including time for reviewing instructions, searching existing data sources, gathering and maintaining the data needed, and completing and reviewing the collection of information. Send comments regarding the burden estimate or any other aspect of this collection of information, including suggestions for reducing this burden, to the Office of Management and Budget, Paperwork Reduction Project (0348-0046), Washington, DC 20503

Certificate of Independent Price Determination

Both the school food authority and the Vendor (offeror) shall execute this Certificate of Independent Price Determination.

(Name of Vendor)

(Name of School Food Authority)

- (A) By submission of this offer, the offeror certifies and in the case of a joint offer, each party thereto certifies as to its own organization, that in connection with this procurement:
- (1) The prices in this offer have been arrived at independently, without consultation, communication or agreement, for the purpose of restricting competition, as to any matter relating to such prices with any other offeror or with any competitor;
 - (2) Unless otherwise required by law, the prices which have been quoted in this offer have not been knowingly disclosed by the offeror and will not knowingly be disclosed by the offeror prior to opening in the case of an advertised procurement, or prior to award in the case of a negotiated procurement, directly or indirectly to any other offeror or to any competitor; and
 - (3) No attempt has been made or will be made by the offeror to induce any person or firm to submit or not to submit, an offer for the purpose of restricting competition.
- (B) Each person signing this offer on behalf of the Vendor certifies that:
- (1) He or she is the person in the offeror's organization responsible within the organization for the decision as to the prices being offered herein and has not participated, and will not participate, in any action contrary to (A)(1) through (A)(3) above; or
 - (2) He or she is not the person in the offeror's organization responsible within the organization for the decision as to the prices being offered herein, but that he or she has been authorized in writing to act as agent for the persons responsible for such decision in certifying that such persons have not participated and will not participate, in any action contrary to (A)(1) through (A)(3) above, and as their agent does hereby so certify; and he or she has not participated, and will not participate, in any action contrary to (A)(1) through (A)(3) above.

To the best of my knowledge, this Vendor, its affiliates, subsidiaries, officers, directors and employees are not currently under investigation by any governmental agency and have not in the last three years been convicted or found liable for any act prohibited by State or Federal law in any jurisdiction, involving conspiracy or collusion with respect to bidding on any public contract, except as follows:

Signature of Vendor's
Authorized Representative

Title

Date

In accepting this offer, the SFA certifies that no representative of the SFA has taken any action which may have jeopardized the independence of the offer referred to above.

Monica Walther

Signature of School Food Authority's
Authorized Representative

Child Nutrition Supervisor

Title

11/20/18

Date

Note: Accepting a bidder's offer does not constitute award of the contract.

TERREBONNE

Parish School District

OWNER DISCLOSURE CERTIFICATE

COMPANY NAME: _____

ADDRESS: _____

TELEPHONE: _____

CELL PHONE: _____

FAX NUMBER: _____

EMAIL: _____

FED. TAX ID# _____

The Company Bidding is:

A. _____ Manufacturer _____ Dealer _____ Representative

B. _____ Corporation _____ Partnership _____ Sole Owner

If corporation, list any individuals or companies that own 10% or more stock:

1. _____ 2. _____
3. _____ 4. _____

If partnership, list principal partners:

1. _____ 2. _____
3. _____ 4. _____

Owner Signature: _____

Title: _____

Type or Print Signature and Title

The signature herein signifies a truthful attestation by the sole proprietor, partner, incorporator, director, manager, officer, or other like individual who owns 10% of the bidding entity, has not been convicted of, or has not entered a plea of guilty or nolo contendere to any crimes or equivalent federal crimes list in LA R.S. Ann. 38:2227.

Submittal of Bid:

Each section will be submitted in its own envelope. All submittals must be delivered to the Terrebonne Parish School Board Purchasing Department, 340 St. Charles Street, Building #3, Houma, Louisiana 70360 or Post Office Box 5097, Houma, Louisiana 70361 no later than the due date and time of 2:00 P.M. on December 12, 2018. Any bid received after the specified date and time will not be accepted and will be returned unopened.

Caution should be taken to assure your bid submittal is properly mailed or delivered and addressed as per bid specifications; **any bid submitted that is not properly addressed for submittal may be declared non-responsive and rejected.**

All outer envelopes including Fed Ex or UPS deliveries **MUST** state the Bid Name as indicated below, Kitchen Equipment Bid #121218.

In all bids requiring a state license, the contractor's license number **MUST** appear on the outside of the outer envelope and any inner envelopes, if applicable. **Pursuant to R.S. 37:2163 (A), if the bid does not display the contractor's license number on the bid envelope, the bid shall be automatically rejected.** If no contractor's license is required, "License Not Required" must appear on the outside of the envelope. Failure to comply will automatically disqualify the bid.

The bid shall be addressed following the example below:

Name or Firm	
Physical or Mailing Address	
City, State Zip	
	Purchasing Department Terrebonne Parish School Board 340 St. Charles Street, Building #3 Houma, LA 70360
Kitchen Equipment Bid #121218 License # _____ or License Not Required	

Attachment B

INSURANCE REQUIREMENTS FOR VENDORS, SERVICE CONTRACTORS, OR PROFESSIONAL SERVICES

The required insurance shall be approved by the Terrebonne Parish School Board before any site work may commence.

I. Workers Compensation

- A. Limit of Liability
 1. Coverage A - Statutory requirements
 2. Coverage B - \$ 500,000 Employer's liability
- B. Endorsements
 1. USL&H (if any)
 2. Waiver of Subrogation in favor of the Terrebonne Parish School Board
 3. 30 day notice of cancellation

II. Comprehensive General Liability

- A. Limits of Liability
 1. Premises / Operations
\$ 1,000,000 per occurrence (BI & PD)
 2. Products / Completed Operations
\$ 1,000,000 per Occurrence (BI & PD)
 3. General Policy Aggregate (if applicable)
\$ 2,000,000
 4. Personal Injury
\$ 1,000,000 per occurrence
- B. Endorsements
 1. Explosion, collapse and underground (if applicable)
 2. Contractual
 3. Independent contractors
 4. Medical payments
 5. Broad from CGL Endorsement
 6. Terrebonne Parish School Board named as "Additional Insured"
 7. Waiver of Subrogation in favor of the Terrebonne Parish School Board
 8. Pollution exclusion removed for "Sudden & Accidental"
(Fuel, oil, lube, and chemical vendors)
 9. 30 day Notice of Cancellation

III. Automobile Liability

- A. Limit of Liability
 1. Combined single limit - \$1,000,000 each accident
- B. Endorsements
 1. Hired automobile liability
 2. Non-ownership liability
 3. Terrebonne Parish School Board named as "Additional Insured"
 4. Waiver of Subrogation in favor of the Terrebonne Parish School Board
 5. 30 day notice of cancellation

IV. Other Requirements

- A. Suitable coverage may be required if special conditions or exposure exist.
(i.e., Marine coverage, Property exposures)
- B. Current insurance certificate shall be on file with the Terrebonne Parish School Board and accepted by the Risk Manager.
- C. All policies are required to be on occurrence form basis, except those generally written ONLY on claims-made forms. (i.e., Professional, Errors & Omissions, etc.).