

FRANJO ROAD (US1- SW 184 Street)- Master plan

Section 1

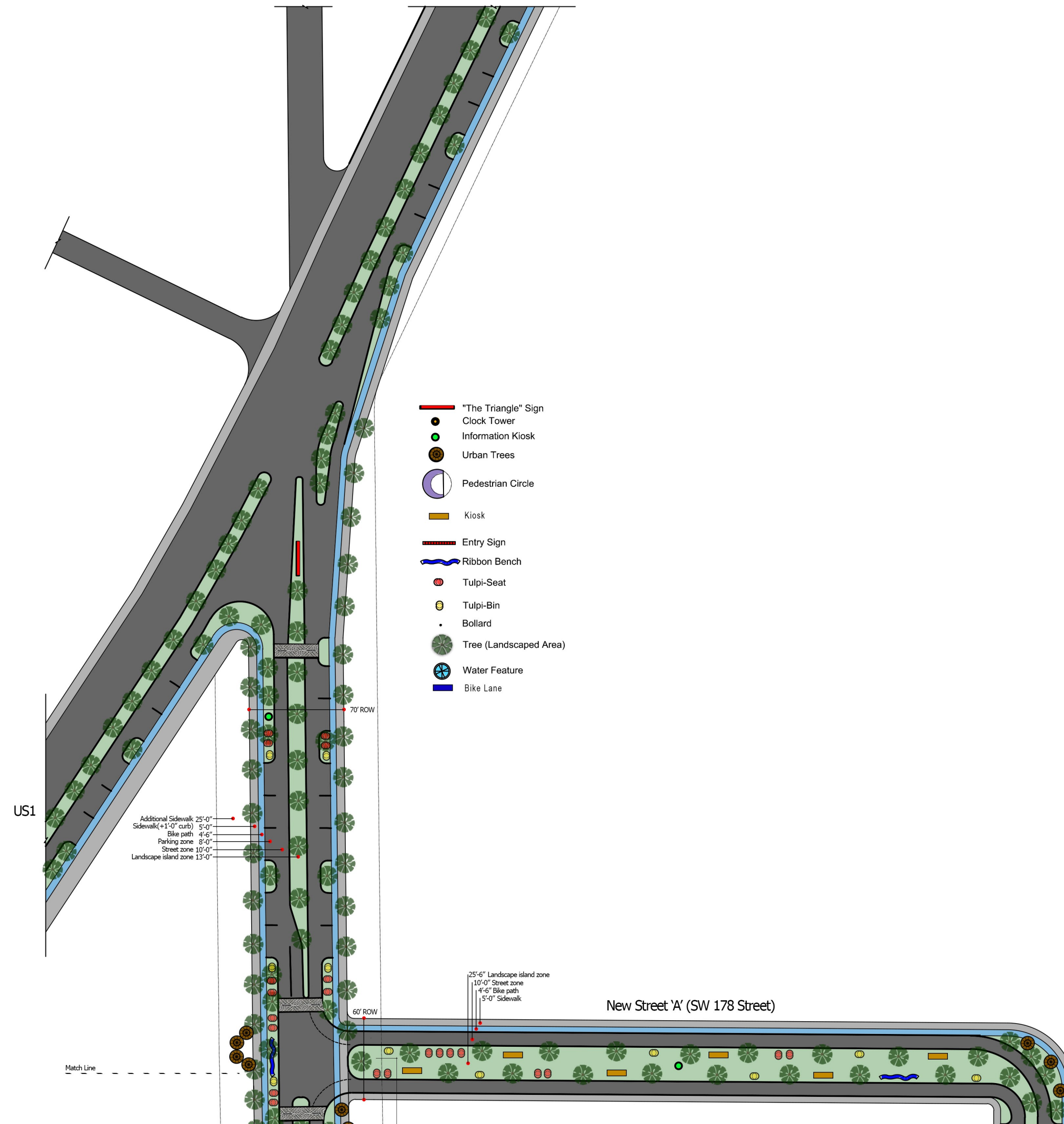

Section 2

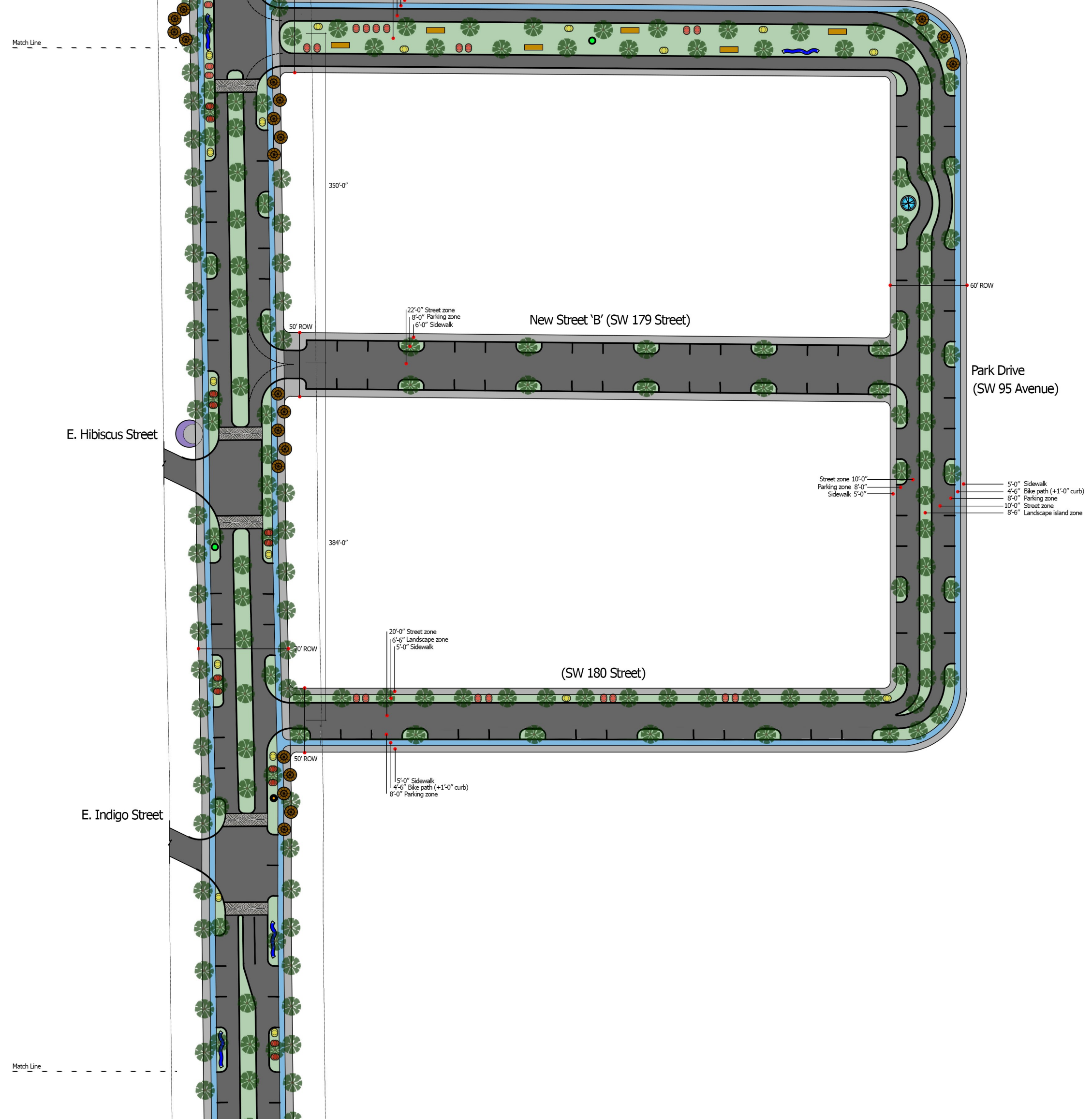

Section 3

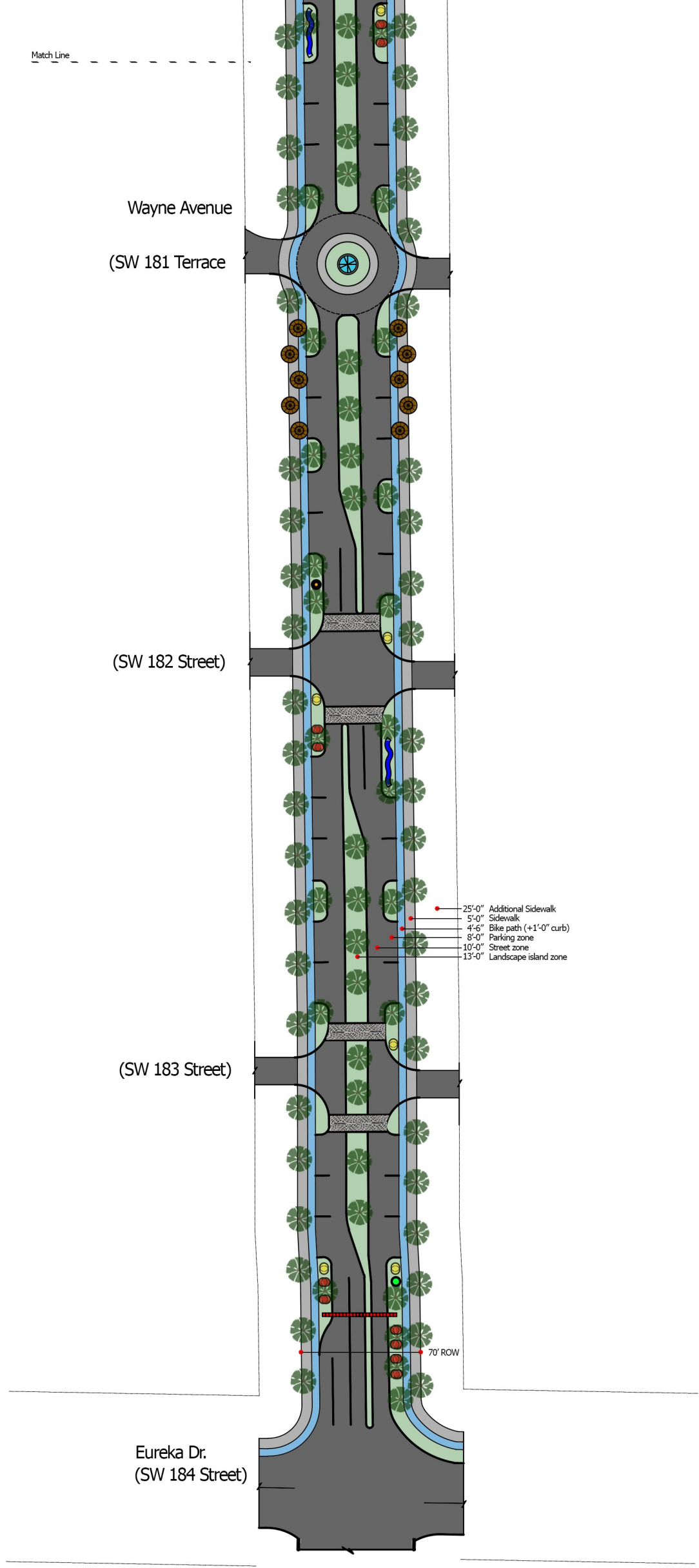

FRANJO ROAD - Section/Plan

(SW 97 Avenue-- from US1 to SW 184 Street)

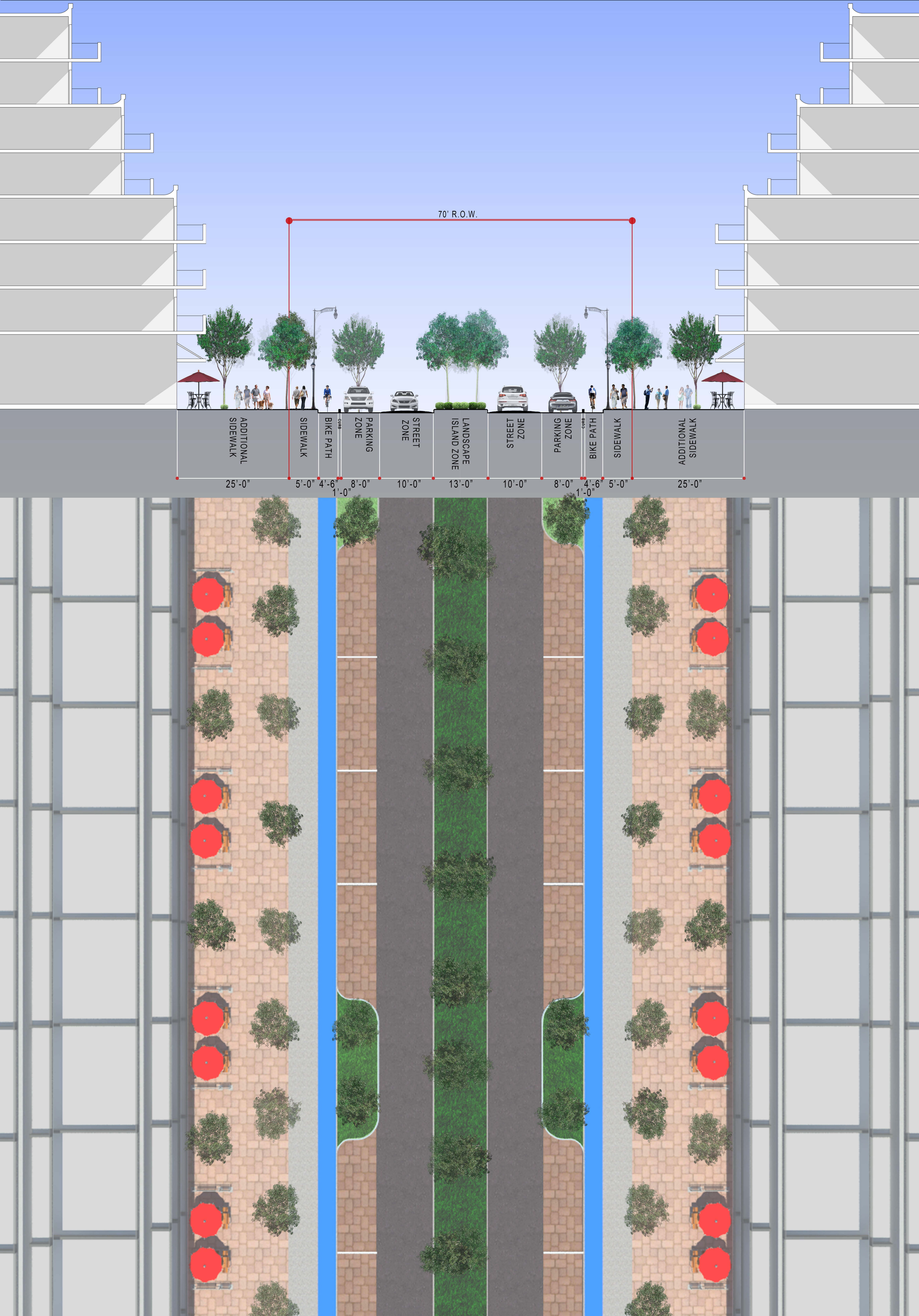

NEW STREET 'A' - Section/Plan

(SW 178 St.-- from Franjo Rd. to Park Dr.)

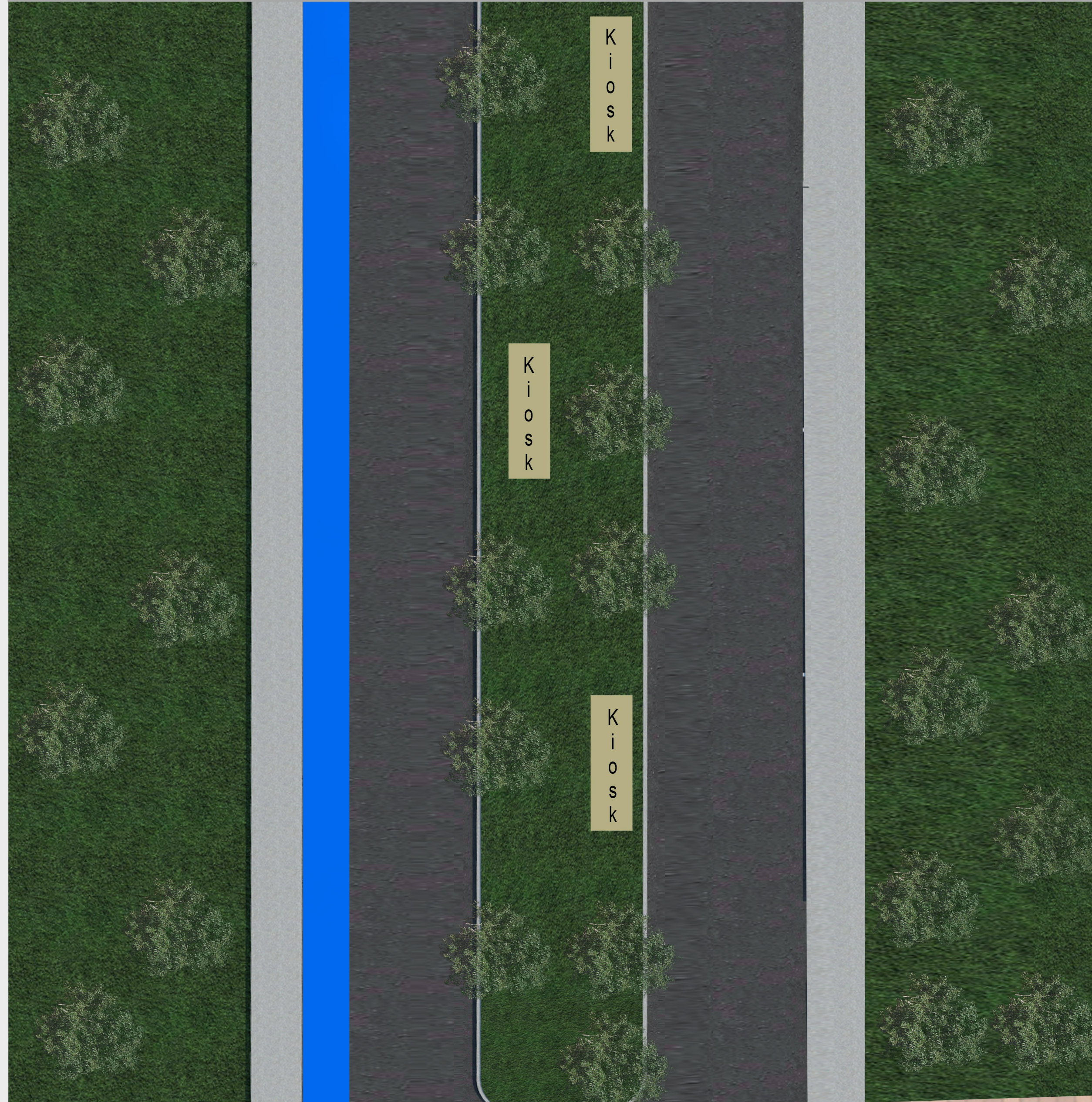
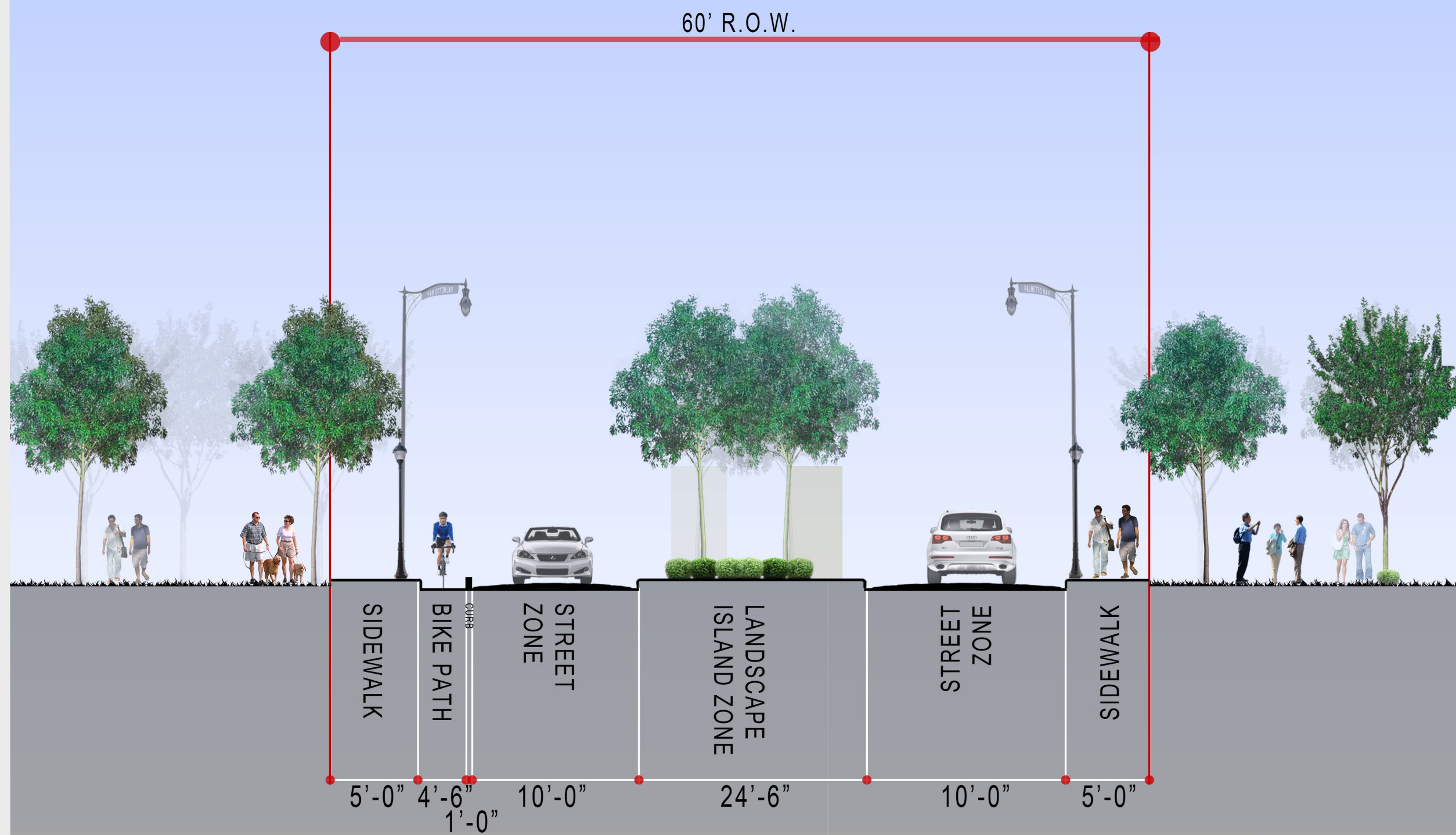

NEW STREET 'B' - Section/Plan

(SW 179 St.-- from Franjo Rd. to Park Dr.)

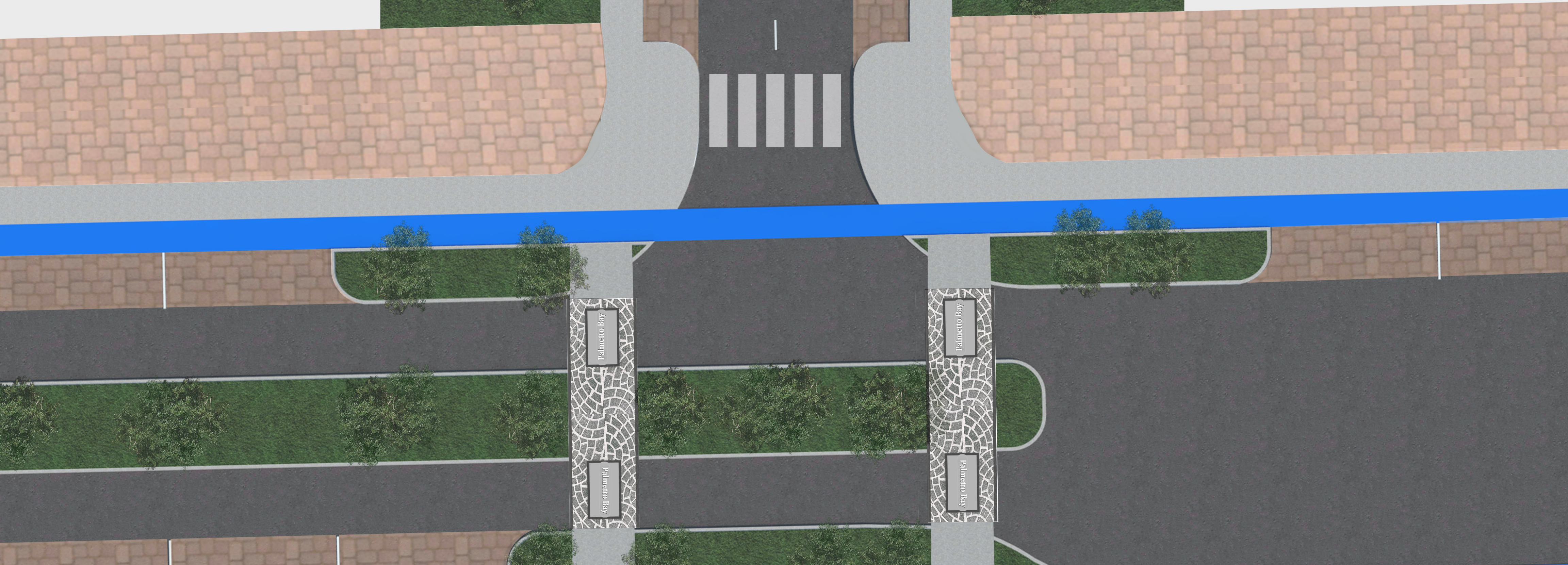
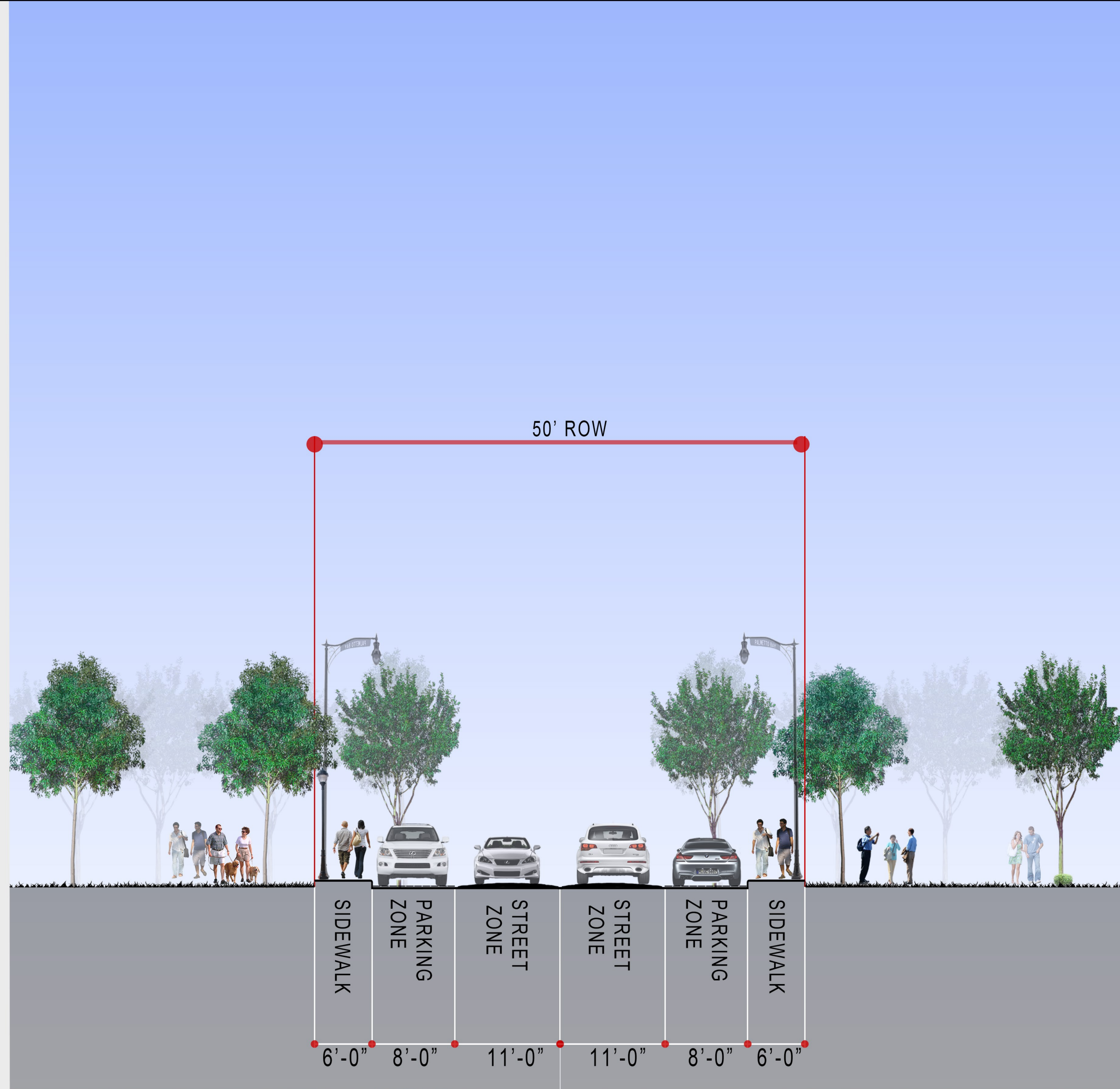

PARK DRIVE - Section/Plan

(SW 95 Ave.-- from SW 178 St. to SW 180 St.)

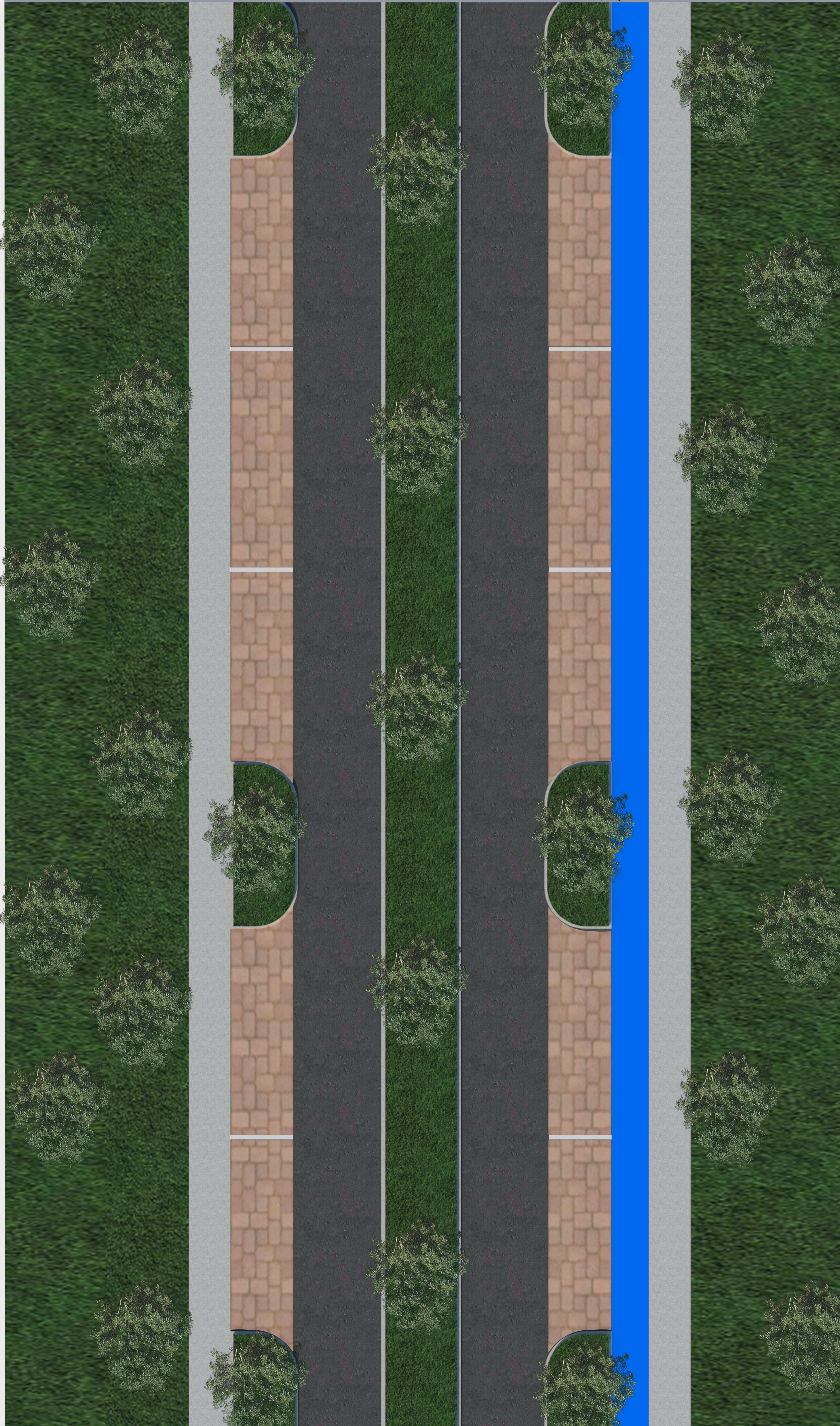
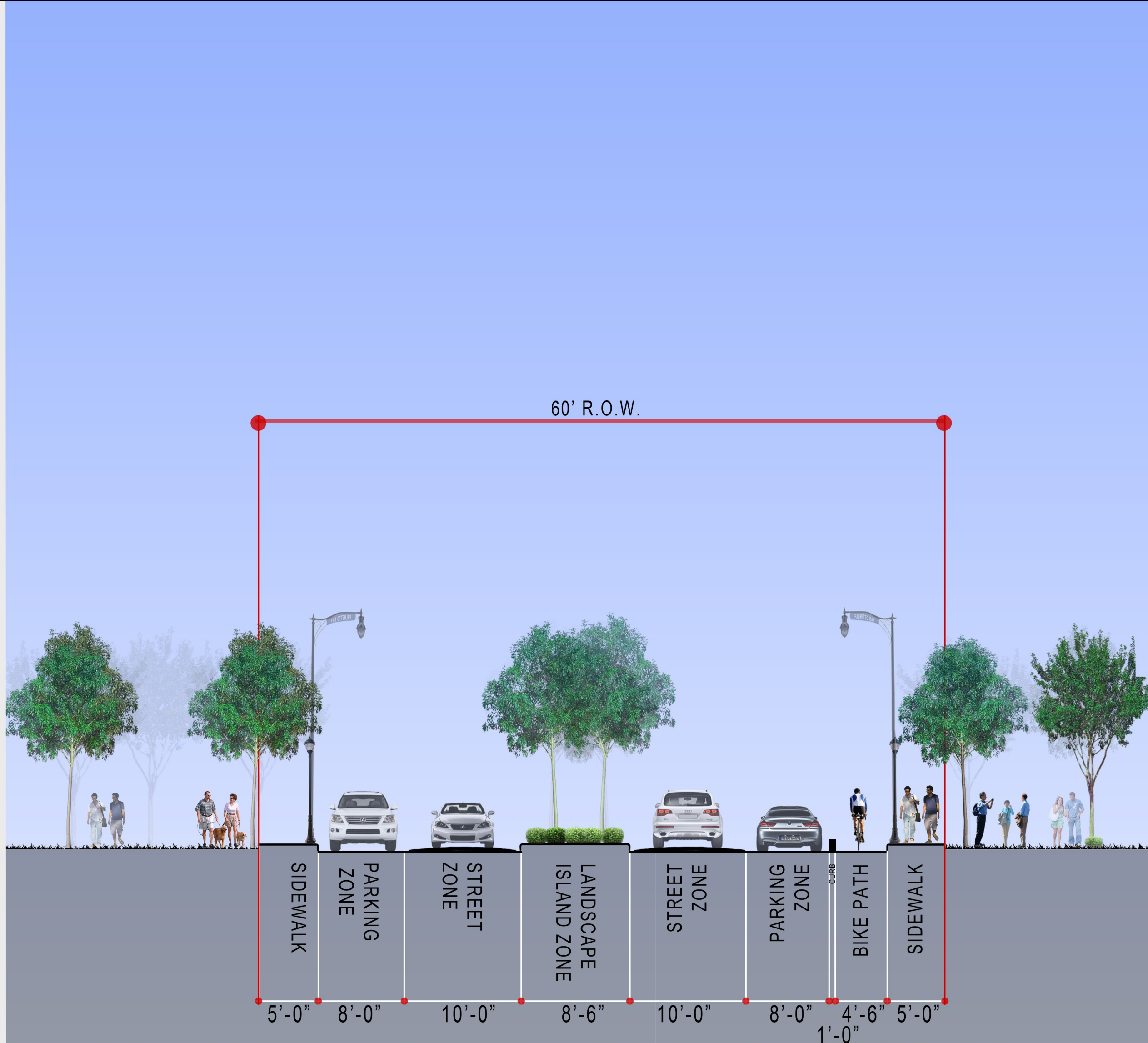

SW 180 St. - Section/Plan

(SW 180 St.-- from Franjo Rd. to Park Dr.)

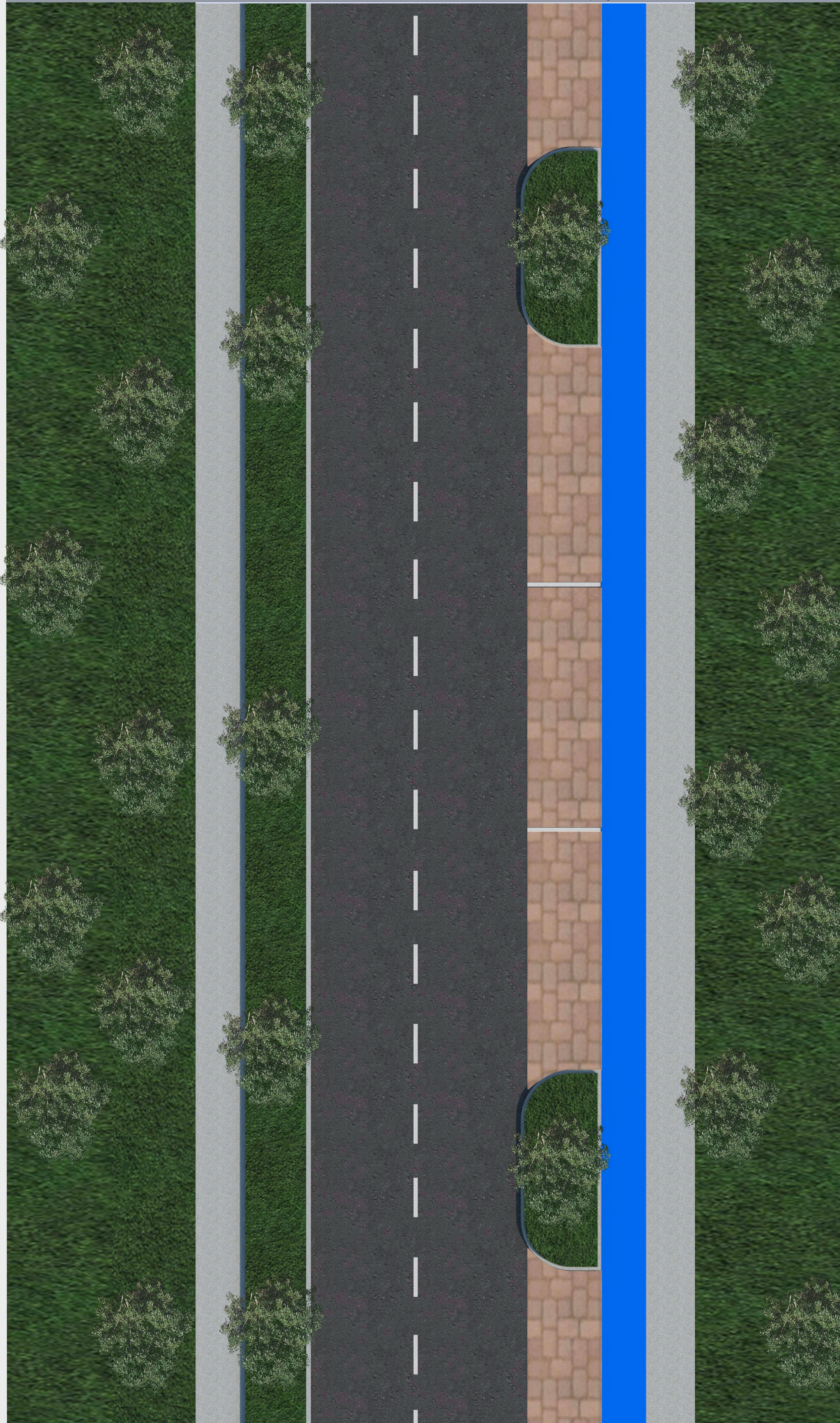
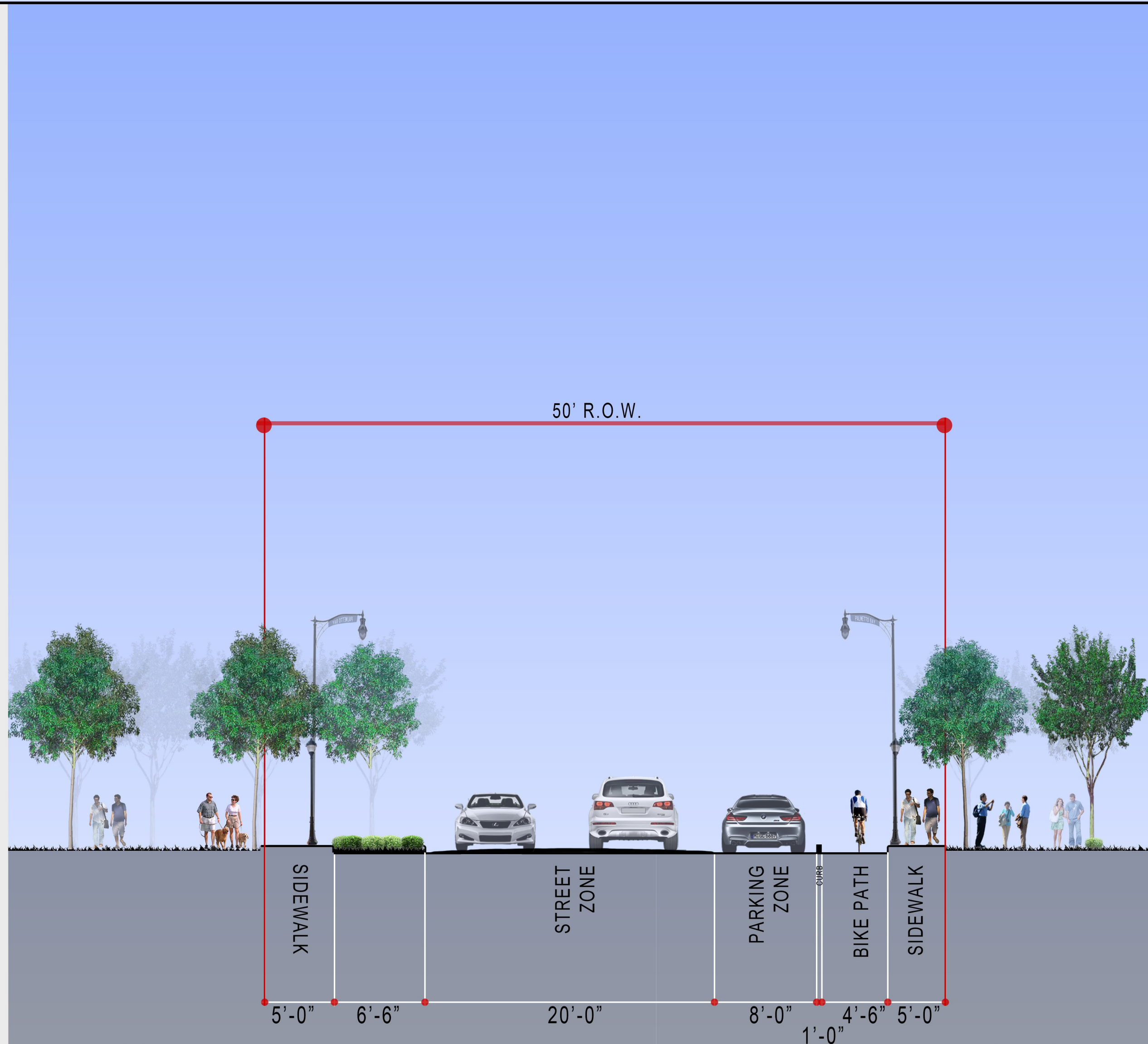

FRANJO ROAD - Roundabout Detail

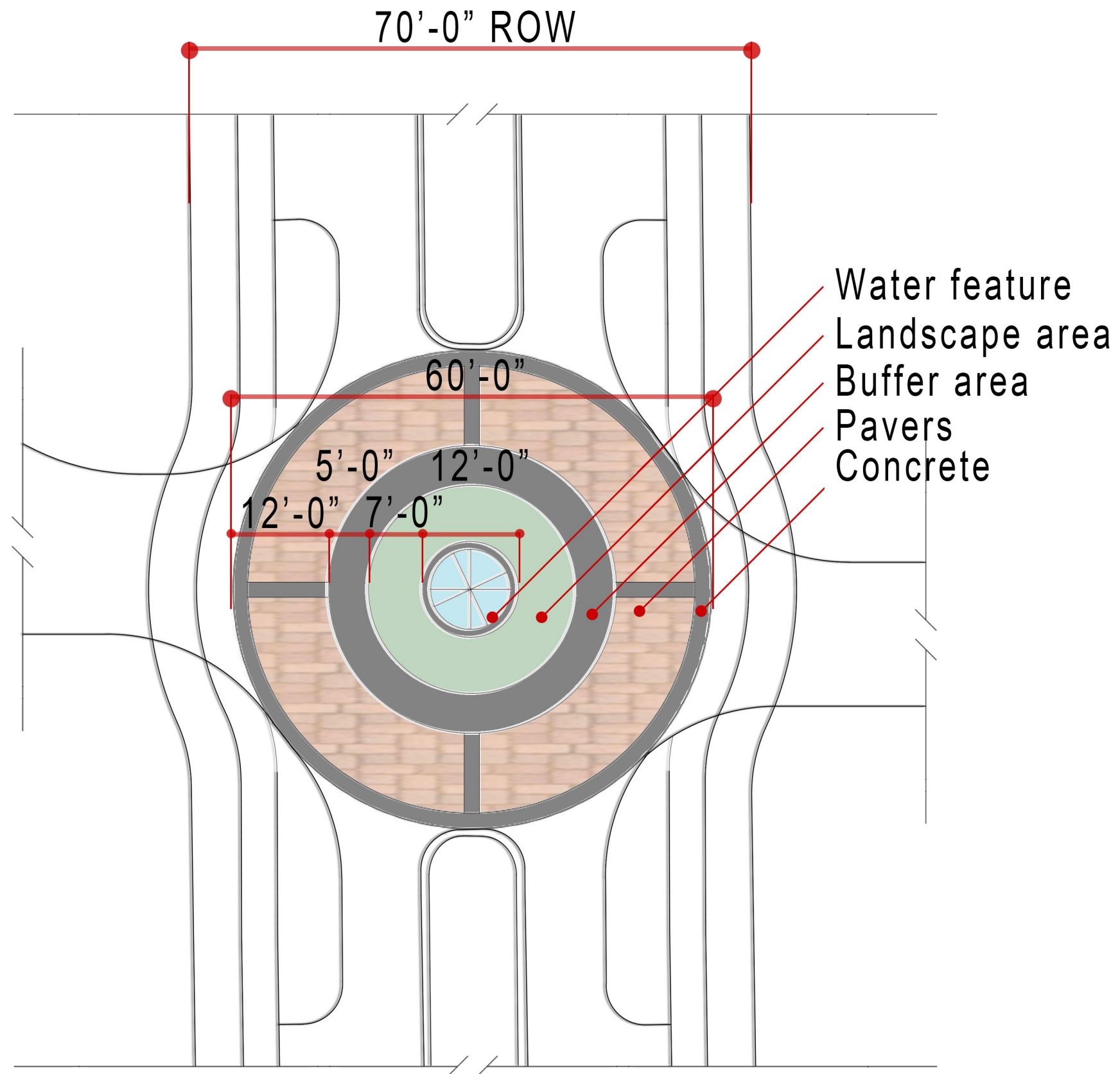

FRANJO ROAD - Crosswalk Detail

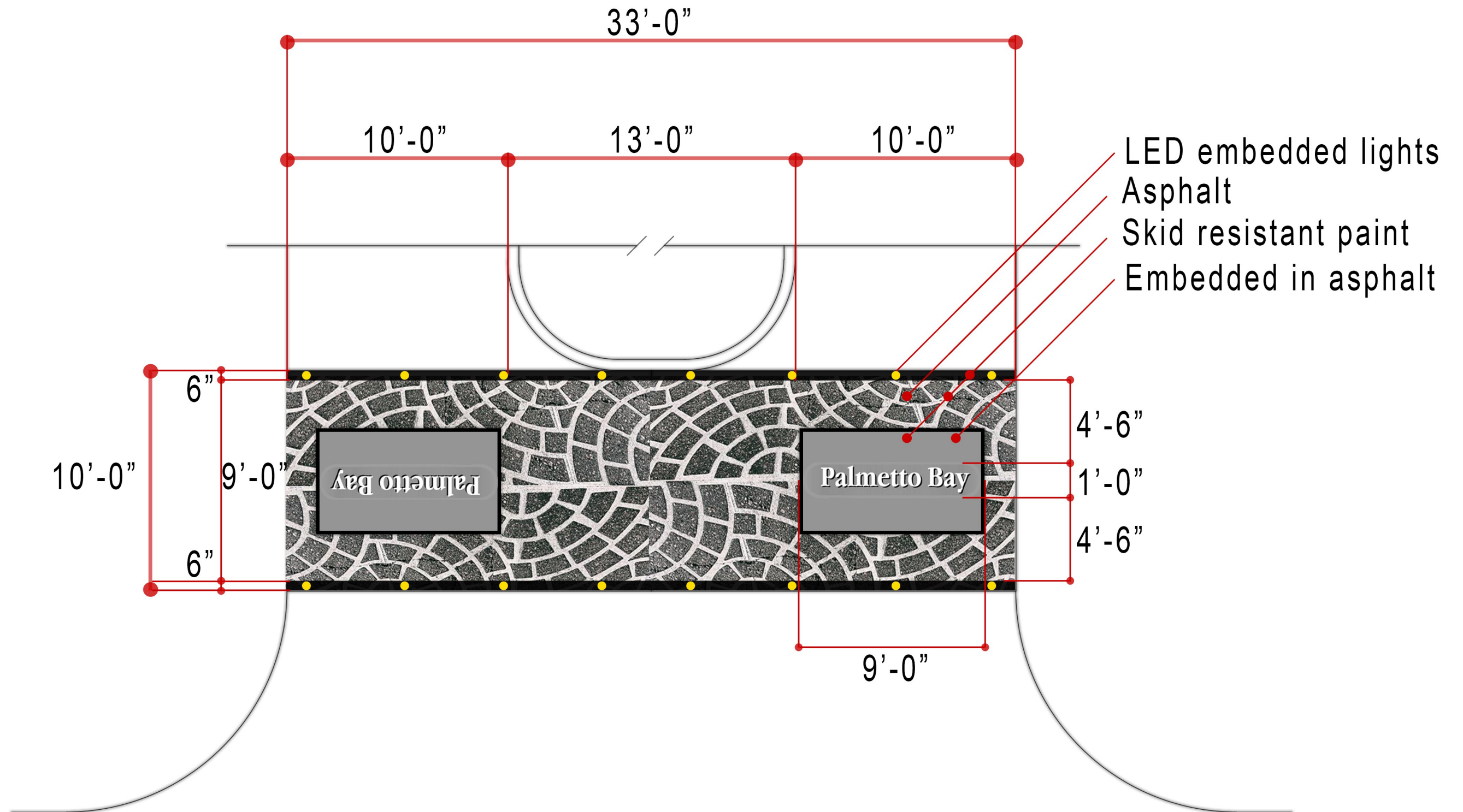

FRANJO ROAD - Streetscape



— “THE TRIANGLE” Entry sign



● Clock Tower



● Information Kiosk



● Urban Trees

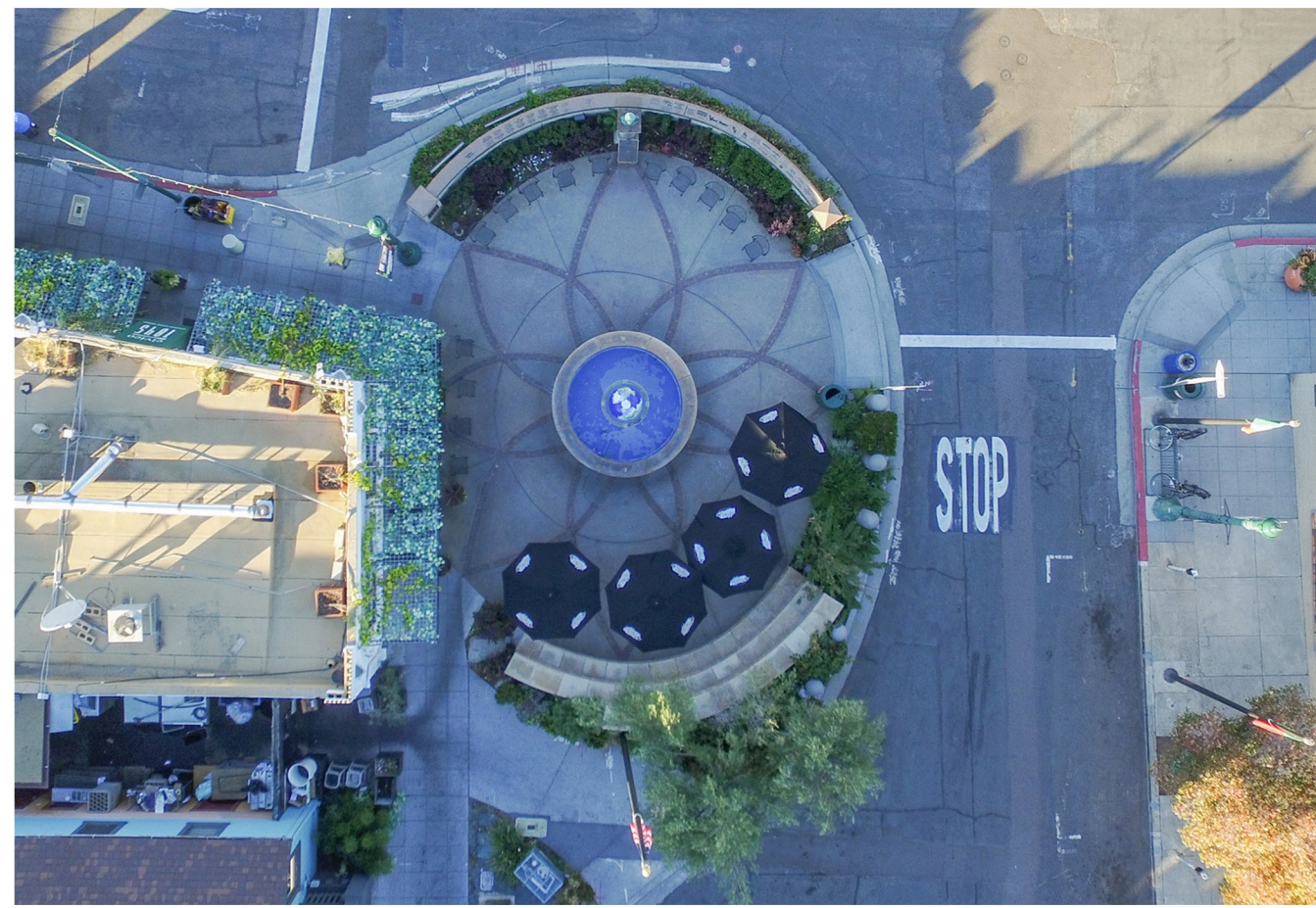

● Pedestrian Circle



● Ribbon Bench



● TuliBin



Tree Guards (all trees on sidewalk)



● TuliSeat



— “Franjo Road” Entry Sign

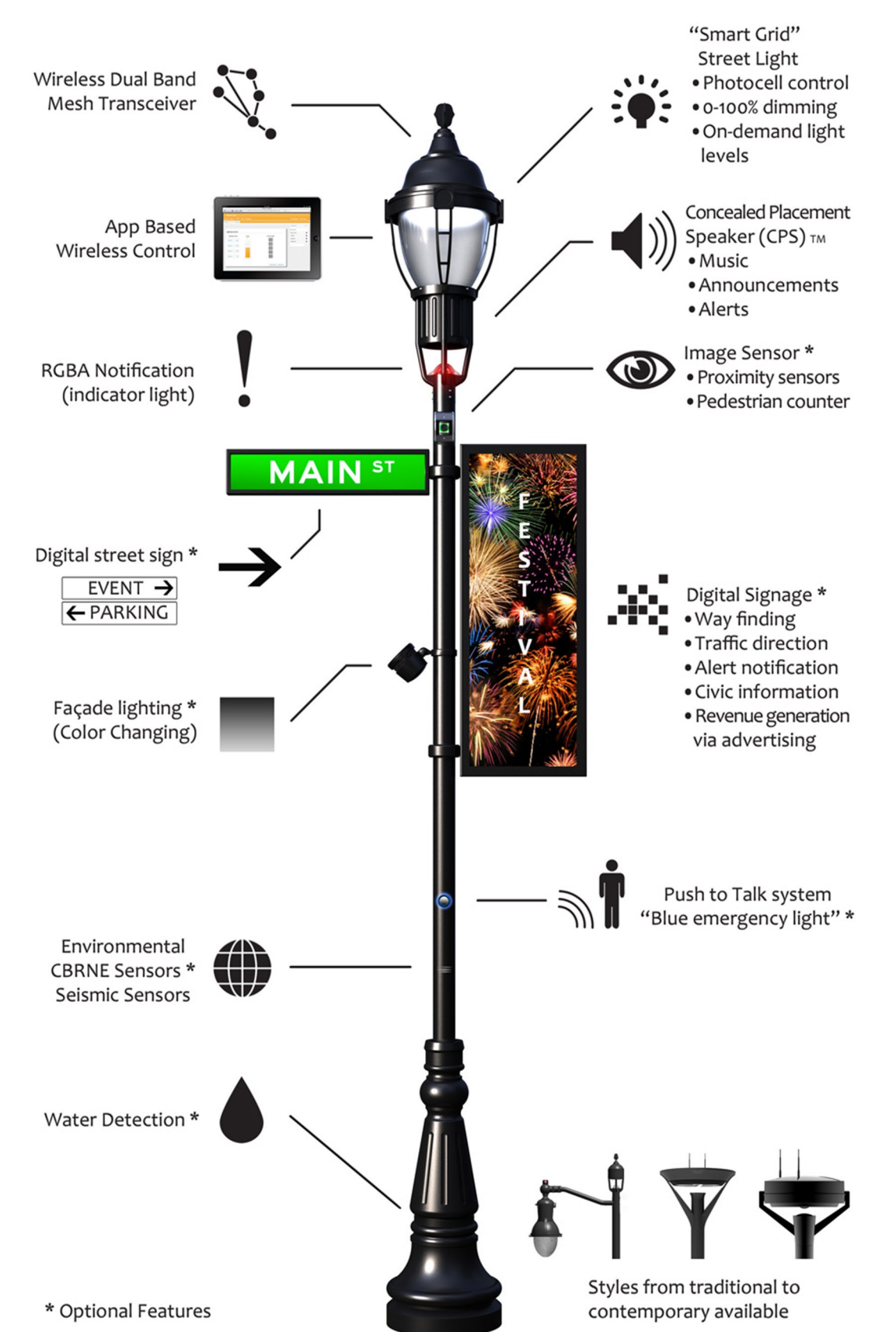

Intellistreets- Light Posts (every 30' both sides of street)