

October 5, 2020

BERKELEY CITY COLLEGE CAMPUS EXPANSION – 2118 MILVIA STREET

PROJECT DESCRIPTION

OVERVIEW

The Berkeley City College population has increased and the need for additional instructional space prompted a search for expansion capability that began nearly ten years ago as the College investigated several properties to lease or purchase. In 2014, the City of Berkeley planned to move its community development departments to an adjoining building, making the existing three-story building at the southeast corner of Milvia and Center Street available for purchase. Due to budgetary limitations at that time, the District planned to renovate the building. Because the building was not initially constructed as an educational facility, renovation would have required extensive structural upgrades to meet current codes for California community colleges. The Division of the State Architect review process was eventually completed, but the cost of structural upgrades would have been very high. With passage of Measure G the College and District agreed that a new building should be constructed that would offer more flexibility and improved performance.

In 2018 the College and District began an exercise to inventory their existing instructional space at 2050 Center Street, and the leased Annex space at 2000 Center Street. The objective was to determine how much additional space would be needed to accommodate existing programs, and to establish which programs should remain in the existing building and which should be housed in the new building at 2118 Milvia. Early on, the College expressed a wish to avoid describing the new building as an “annex”. Rather, they felt it was very important to locate a full complement of activities in the new building, including classrooms, instructional support, and faculty, and administrative functions. The specifics of each space type were developed over more than a year of regularly scheduled meetings with the building user Group (BUG) and the President’s Executive Team.

The respective locations of the two buildings was the strongest reason for the District to purchase the 2118 Milvia Street property. While not contiguous, the two buildings are very close. Placing spaces such as a Learning Resource Center, the bookstore, and home base for a broad array of learning cohorts in the new building is intended to create active connections between the two buildings for the entire student body.

The 2000 Center Street Annex will no longer be required when the new building is complete. The program for 2118 Milvia includes both new spaces to accommodate a growing population and relocated spaces. To assure that no existing functional areas were lost, a detailed spreadsheet was developed that tracks existing space in 2050 Center Street, as well as proposed new space at 2118 Milvia Street.

General Building Program

SPACE PROGRAMMING

The proposed program for the new building indicates the general number and size of spaces required to meet the objectives developed through the planning process. The District Design Draft Standards dated June

10, 2020, establish basic requirements for many typical space types. These Standards should be used as a benchmark in the design of the new building.

More detailed programming with faculty, staff and students has not taken place, so the specific requirements for each program remain to be developed. However, the list of rooms and spaces was carefully developed and has been crosschecked with the Space Inventory of 2050 Center Street and the 2000 Center Street Annex to establish that all required areas and functions will be included when the project is complete:

- The existing Library will remain at 2050 Center Street, but the 2118 Milvia Street building will include a Learning Resource Center with group study rooms to supplement the existing space and provide a balance of instructional support space for the two buildings.
- The two existing Art Studios will move to 2118 Milvia Street.
- The existing Anthropology classroom will move to 2118 Milvia Street.
- Classrooms provided in the new building will primarily be general assignment, used by the Humanities and Liberal Arts.
- A Communications Classroom and a shared computer lab are to be included.
- Flexibility in classroom assignment is very important. It has been noted that many of the general assignment classrooms at 2050 Center Street are quite small (600-700 SF). Larger classrooms are required to meet current District Standards and to allow larger class sizes.
- Two classes are identified to be configured for use as a single large lecture room, provided with an operable wall.
- Faculty offices should be provided in the new building for full time and adjunct faculty in the Humanities and Liberal Arts. Note that faculty offices at Berkeley City College are typically shared, and this model is to be followed in the new building.
- Faculty work and meeting areas, as well as mailboxes for faculty and staff based at 2118 Milvia Street, should be provided.
- Administrative offices, including the offices of the President, Vice Presidents, and their staff will move to 2118 Milvia Street.
- The Health Center, Veterans Center, and Multi-Cultural Center/Learning Communities will be located at 2118 Milvia Street to support student success.
- The bookstore, currently on the 5th floor of 2050 Center Street, will move to a more visible and accessible location at 2118 Milvia Street.
- A Student lounge can serve as space for informal study, small events, and as a gallery to showcase student work

Remaining at 2050 Center Street (for Information Only, not included in this project)

- STEM programs will remain at 2050 Center Street and additional laboratories will be provided there after general classrooms are relocated to the new building.
- Digital Media will remain at 2050 Center Street.
- Business Services, Admissions & Records, Counseling, and similar services will remain at 2050 Center Street.
- Counseling. Career Center, EOPS, DSPS and other Student Services remain at 2050 Center Street.
- The Library will remain and expand at 2050 Center Street.
- Student Activities (ASBCC) will remain at 2050 Center Street with access to the large atrium and auditorium.

GENERAL DESIGN GUIDELINES

Aligning with the Berkeley City College vision the new expanded campus should be:

- **UNIFIED**
- **WELCOMING**
- **ACTIVE**
- **FLEXIBLE**
- **HEALTHY**
- **SUSTAINABLE**

The existing atrium at 2050 Center Street is viewed as an important element of the campus, creating an open area that is active, engaging, and flexible. The smaller footprint of the Milvia Street property does not lend itself to a similar multi-story space. Instead, each floor should afford unprogrammed open space where informal interactions can take place.

Acoustic control between these active common areas and classrooms will be very important for concurrent activity. Similarly, the acoustic separation between classrooms and between offices is very important to maximize speech intelligibility in classrooms and to provide privacy for office conversations.

Natural light is a priority. Classrooms and other functional areas should be located at the three sides of the building where access to daylight is available. Classroom ceiling heights should be a minimum of __ feet to meet District Standards and maximize natural lighting.

Provide “borrowed light” to interior common areas. Consider glazing the interior stairwell walls to maximize daylighting and provide orientation. Provide generously proportioned stairwells to encourage use in lieu of elevators.

Provide two gurney sized elevators for efficient vertical circulation. Extend both elevators to the roof level. Note that emergency power will be required.

SUSTAINABILITY AND DAYLIGHTING

The District Standards set LEED goals for all new buildings. A sustainable and efficient building is a priority for both the College and the District. Lighting and equipment efficiency are expected to meet or exceed California code requirements. In addition, such features as exterior solar shading, rooftop photovoltaics, and high-performance exterior building assemblies are expected to provide both efficiency and long service life.

The building is positioned on the site to take maximum advantage of access to daylight. The north side closely adjoins an 8-story building that houses City of Berkeley offices. As a result, it is not feasible to provide fenestration on the west. Building services, shafts, and restrooms are concentrated on the west side of the building for this reason.

On the south and west sides, the site adjoins Center Street and Milvia Street, respectively. Generous glazing can be provided with provisions for solar shading; thus, the building is placed close to the property line on south and west.

On the north side, the building is held back to allow glazing. There may be a future opportunity to purchase the property immediately to the north. In that case, the building could be expanded. The suggested placement of stairs on the north side of the building is intended to permit the construction of an addition that could take advantage of the stairs to serve the added floor area.

SITE CONSIDERATIONS

No parking is proposed for 2118 Milvia Street. The site footprint is restricted. The space consumed by ramps, stairs and elevators would result in a very inefficient layout for parking spaces. The resulting cost per space would be very high. The College should take maximum advantage of nearby public transit (BART and buses) and the availability of public parking structures in the immediate vicinity rather than construct new parking.

Pedestrian activity in the area will be increased with the construction of the new building. The existing sidewalks are relatively narrow and the suggested building footprint at the ground floor addresses this limitation by setting the exterior wall back while the floors above cantilever to create shelter. Emergency exits, utility room doors, and loading door are set back from the back of the public sidewalk, permitting unrestricted opening of doors without alcoves that could encourage unauthorized use for encampments - an ongoing concern in Downtown Berkeley.

A loading bay and facilities storage, along with the main electrical room are located on Center Street, allowing the remainder of the ground floor to be as visually open as possible. The main loading dock, shipping and receiving will remain at 2050 Center Street, but a smaller shipping/receiving area will be needed to support the functioning of the new building.

The sidewalk setback can be enhanced with artwork on the solid portions of walls and on the pavement surface. Durable pavement and wall art including tile and metal inserts and tile mosaics would be elements that have been used extensively on nearby streets and could feature art by students.

The lighting of the building façade, as well as creative signage can further enhance the exterior and announce the College.

GROUND FLOOR FUNCTIONS

The Entrance Sequence

Street level views into the existing building are valued as a showcase for campus life, and the precedent created by 2050 Center Street should be followed at 2118 Milvia with such elements as a student gathering/gallery space and a welcoming but secure entrance. Placing an active classroom at street level is also important to the College as it places teaching and learning at the forefront.

Milvia Street slopes gently down from north to south, so it is possible to create a universally accessible entrance by taking advantage of these grades without creating a formal ramp.

While visual openness to the street and a welcoming public presence are both highly valued, Berkeley City College does operate as a safe place for its students, faculty, and staff. At the current location, there is a single point of entry to the building. Campus security personnel is stationed at the entrance and establishes a control point for the building. People entering the building next pass a welcome desk with student ambassadors, and an area where events, activities and opportunities are displayed. This entrance sequence has been successful – both secure and welcoming.

For the new 2118 Milvia, a similar configuration is desired. A visible and secure bicycle is desired near the entrance to encourage bike use. The security office should be located with direct access to the entrance vestibule and the building lobby with good line of sight to the street. The security office should be large enough to provide lost & found and secure storage and should have direct access to the exterior.

The Bookstore

The Bookstore should be located on the ground floor for convenience to both buildings. However, the College preferred not to have this retail activity located at the street. Positioning the bookstore for direct access to the shipping and receiving areas will allow deliveries to take place without encumbering the main lobby. The bookstore office should have direct access to the dedicated storage area and should also have an exit to the exterior in case of emergency.

College bookstore functions vary greatly over the course of each academic session, with book sales featured at the start of each class sequence. During the interim period, sale of convenience items and packaged foods require a more flexible layout. As a result, reconfigurable fixtures are generally used. Handwashing sinks are desired both in the storage/work area and convenient to a customer coffee service counter. The Berkeley City College Bookstore is managed by a vendor who will provide more detailed requirements.

The Student Lounge, Gallery

The proposed student lounge/gallery at the prominent corner of Milvia and Center Street is intended to be an attractive, active feature during all hours when the College is in operation. This should be a place to see and be seen; to display student work; to socialize and collaborate.

ROOFTOP GARDEN

The desire for usable outdoor space has been given high priority by the Berkeley City College community. Because space at grade is very limited, a roof garden is a very important feature for this project. Approximately half the roof area is anticipated to be available for use. Both unscheduled, casual use and organized events are foreseen. Both elevators and both stairs will need to extend to the roof level with full enclosure. In addition, the roof level should have a storage area for movable furniture; a small catering kitchen; and a janitorial closet with mop sink.

The rooftop mechanical equipment area should be screened and secured. Planting and surfacing materials should be durable and easy to maintain. Providing a full-height glazed wall at the perimeter is desirable to prevent inappropriate use and potential hazards to occupants. A taller enclosure will also provide wind shelter and extend the number of days that the area can be used.

Sustainability

RESTROOMS

Each floor requires restroom facilities to meet California Building and Plumbing Code requirements. These should be conveniently located, finished with durable and attractive materials, and located for safety and security. Restroom facilities must be fully accessible. On each floor, at least one restroom must be a gender neutral single-occupancy restroom. Provide restroom facilities at the roof level for convenient access from the rooftop garden.

BUILDING SERVICES

Each floor requires a custodial closet with mop sink, as well as storage for basic supplies such as paper goods and cleaning supplies.

Multi-occupancy restrooms are required at each floor, but gender neutral restrooms are also a requirement.

Building Services

The new building will operate somewhat independently from the existing building at 2050 Center Street. Facilities supplies and support spaces for facilities maintenance personnel will be needed at the new building. Office space and secure storage are also required for personnel based at the new building.

Electrical and mechanical space will be needed on each floor. An emergency generator will be required for the elevators and for emergency lighting. Depending on utility capacities, which are not fully known at this time, a fire pump may also be required and must be provided with emergency power. The likely location of the generator is on the roof.

The project must include provisions for façade maintenance and window washing.

SPACE GROUP	ASSIGNMENT	NAME	ROOM NAME	PROGRAM CODE	MINIMUM ASF	QUANTITY	MINIMUM ASF	DESCRIPTION	COMMENTS
01 GENERAL EDUCATION							16,010		
1A	ANTHROPOLOGY		LAB	1A.01	960	1	960	Anthropology Lab	Classroom for the Anthropology program with space for lab activities.
			STORAGE	1A.02			160	Anthropology Storage	Storage for the Anthropology Lab.
1B	ART		ART STUDIO	1B.01	1,200	2	2,400	Art Studio	Classroom for the Art program, adaptable to multiple studio layouts.
			STORAGE	1B.02			450	Project Storage	Storage for student projects, should be accessible to each Art Studio classroom. Can be one or two rooms.
1C	CLASSROOM		CLASSROOM	1C.01	960	9	8,640	General Education Classroom	General Education classrooms for multiple pedagogies.
			SMALL CLASSROOM	1C.02	900	2	1,800	General Education Classroom	General Education classrooms for multiple pedagogoies, separated by an operable wall.
1D	COMMUNICATIONS		COMMUNICATIONS CLASS	1D.01	960	1	960	Communications Classroom	Classroom for the Communications program.
			COMMUNICATIONS LAB	1D.02	320	1	320	Communications Lab	Lab space for special activities for the Communications program.
1E	STORAGE		STORAGE	1E.01			320	Classroom Storage	Distribute among classrooms and labs as needed.
02 FACULTY							2,110		
2A	FACULTY OFFICE		SHARED OFFICES	2A.01			1,500	Faculty Offices	Open offices for faculty, can be single or multiple rooms.
2B	SUPPORT		CONFERENCE ROOM	2B.01	240	1	240	Conference Room	Conference room for faculty
			FACULTY LOUNGE	2B.02	120	1	120	Faculty Lounge	Comfortable room for faculty to take breaks and hold informal meetings.
			FACULATY MAIL ROOM	2B.03	250	1	250	Satellite Mail / Copy Room	Central location for staff mail. Should include staff mail boxes and basic supplies for outgoing mail.
03 ADMINISTRATIVE OFFICE							3,090		
3A	ADMIN - LIBERAL ARTS	PRESIDENT'S OFFICE		3A.01	300	1	300	President Office	The office of the President, which will include an informal meeting area and secure storage.
			VICE-PRESIDENT'S OFFICE	3A.02	200	1	200	Vice President Office	The office of the Vice-President, which will include an informal meeting area and secure storage.
			ASSISTANT'S OFFICE	3A.03	110	2	220	Assistant	Offices for the Assistants to the President and the Vice-President.
			DEAN'S OFFICE	3A.04	150	1	150	Dean Office	The office of the Dean, which will include an informal meeting area and secure storage.

SPACE GROUP	ASSIGNMENT	NAME	ROOM NAME	PROGRAM CODE	MINIMUM ASF	QUANTITY	MINIMUM ASF	DESCRIPTION	COMMENTS
			ADMINISTRATORS OFFICE	3A.05	120	7	840	Administrator	Offices for Associate Dean, Scheduler, Curriculum & Assessment Specialist, Program Project Manager, Public Information, Researcher, Spare
			CONFERENCE ROOM	3A.06	500	1	500	President Conference	A conference room to be used by the President and staff.
			RECEPTION	3A.07	150	1	150	Reception	The reception area will be the front door of the suite, with a prominent staff service point and a waiting area.
			STORAGE	3A.08	60	1	60	Storage	Storage room for office supplies and files.
			ADMINISTRATIVE WORK R	3A.09	110	1	110	Workroom	Work area for the Administrative Suite.
			WORKSTATIONS	3A.10			560	Workstations	Workstations for administrative staff. A single room is preferred.
04 OUTDOOR MEETING AREA							3,290		
4A	MEETING	PATIO	4A.01	3,000	1	3,000	Roof Patio	An outdoor patio suitable for day-time or evening functions, classes or informal gatherings.	
		STAGING	4A.02	140	1	140	Staging	A staging room for preparing/cleaning up from functions held in the Patio.	
		STORAGE	4A.03	150	1	150	Storage	Storage for furniture, equipment and supplies associated with the Paio function area.	
05 STUDENT SERVICES & LEARNING COMMUNITIES							6,825		
5A	HEALTH CENTER	HEALTH CENTER RECEPTIO	5A.01	400	1	400	Waiting Rm / Meeting Rm	Main point of entry for the Health Center. Includes service point and waiting area.	
		EXAM ROOM	5A.02	150	1	150	Exam Room	Private examination room for patient consultation.	
		LACTATON	5A.03	100	1	100	Lactation	Private room for nursing mothers within the BCC Community.	
		HEALTH CENTER OFFICE	5A.04	120	1	120	Office	Staff office.	
		STORAGE	5A.05			150	Storage	Storage of filing and supplies for the Health Center. Single room preferred.	
5B	MENTAL WELLNESS	MENTAL WELLNESS WAITI	5B.01	150	1	150	Mental Wellness Waiting Room	Main point of entry for the Mental Wellness Center. Includes service point and waiting area.	
		CONFERENCE ROOM	5B.02	400	1	400	Conference Room	Conference room for Mental Wellness Center staff and student clients.	
		PRIVATE OFFICE	5B.03	100	2	200	Mental Wellness Counselor Office	Private offices for counselor / client consultations.	
		STAFF LOUNGE	5B.04	200	1	200	Staff Lounge	An informal space for individuals and small groups.	

SPACE GROUP	ASSIGNMENT	NAME	ROOM NAME	PROGRAM CODE	MINIMUM ASF	QUANTITY	MINIMUM ASF	DESCRIPTION	COMMENTS
5C	VETERANS		VETERANS' SUPPORT WAIT	5C.01	400	1	400	Veterans' Support Services waiting an	Open area for Veterans' Support Services, including a service desk and waiting area.
			OFFICE	5C.02	120	2	240	Staff Offices	Private office space for Veterans Coordinator, Vetereans Counselor
5D	MCRC		OFFICE	5D.01	100	6	600	Office	Offices for the Multicultural Resource Center [MCRC] staff.
			SHARED OFFICES	5D.02	500	1	500	Shared Open Area	Open offices for the Multicultural Resource Center [MCRC] staff.
5E	UCRC		RECEPTION	5E.01	375	1	375	Waiting Room	Main entry point for UCRC. Includes service/reception desk. Workstations for UCRC staff.
			OFFICE	5E.02	120	1	120	Office	Office space for the director of UCRC.
5F	BOOKSTORE		BOOKSTORE	5F.01	800	1	800	Retail Space	Retail space for the campus bookstore, including display for books and supplies, shelving, and point of sale. Provide multiple exit routes for security.
			OFFICE	5F.02	120	1	120	Office	Office for bookstore staff.
			STORAGE & WORK ROOM	5F.03			500	Storage & Work Room	Storage for both boxed and unboxed books and supplies. Work area for breaking down and preparing shipments.
5G	STUDENT LOUNGE / G/	GALLERY		5G.01	1,000	1	1,000	Lounge / Gallery	A multi-use space dedicated to student-initiated exhibitions.
5H	SHARED SERVICES		MEETING ROOM	5H.01	180	1	180	Meeting Room	Meeting room capable of providing privacy.
			QUIET ROOM	5H.02	120	1	120	Spirituality / Quiet Room	Private space for members of the BCC community.
06 LEARNING RESOURCE CENTER							3,560		
6A	LRC		OPEN AREA	6A.01	1,500	1	1,500	Learning Resource Center	Work area for students with nearby staff support. Includes a service desk in a prominent location.
			LRC GROUP STUDY	6A.02	180	2	360	LRC Group Study Rooms	Meeting room for students and staff.
			OFFICE	6A.03	110	2	220	LRC Office	Office space for the director of the LRC.
			OPEN OFFICES	6A.04	320	1	320	LRC Open Office	Shared office space for LRC staff.
6B	COMPUTER LAB		COMPUTER LAB	6B.01	960	1	960	Shared Computer Lab	Computer lab available to students, not for use as a classroom.

SPACE GROUP ASSIGNMENT NAME	ROOM NAME	PROGRAM CODE	MINIMUM ASF	QUANTITY	MINIMUM ASF	DESCRIPTION	COMMENTS
	COMPUTER LAB STORAGE	6B.02			200	Storage	Storage for Computer Lab supplies, including cables and accessories. Can one or more rooms.
11 BUILDING SERVICES					2,875		
11A ENTRANCE	ENTRANCE	11A.01	500	1	500	Entrance and Bike Parking	Main point of entry for the facility. Presents orientation and wayfinding through architectural elements and signage.
	WELCOME	2B.02	120	1	120	Welcome Desk	Part of the building entry, the Welcome Desk will be a staffed location providing assistance to visitors and building occupants.
	SECURITY OFFICE	2B.03	175	1	175	Security Office	Office for the building security staff.
	OFFICE	2B.04	150	1	150	Office	Office for building supervisor and welcome desk staff.
11B BUS/OPS	LOADING DOCK	11B.01	650	1	650	Loading Dock	Loading dock capable of receiving palettes of books, supplies and mail. Does not require a raised platform.
	OFFICE	2B.04	90	2	180	Loading Dock Office	Office for the shipping manager.
	STORAGE	2B.05	300	1	300	Loading Dock Storage	Area for receiving and breaking down incoming shipments.
	CUSTODIAL	11B.06	100	7	700	Custodial	Janitors' closet.
	IT OFFICE	11B.07	100	1	100	IT OFFICE	Storage room for IT related equipment and supplies.
	MECHANICAL	2B.08		7		Mechanical	Sized as required
	BUILDING ELECTRICAL	2B.09		1		Building Electrical Room	Sized as required
	ELECTRICAL / TELECOM	2B.10		7		Electrical & Telecom Room	Sized as required with subdivision for each discipline
12 TOTAL PROGRAM AREA					37,760		

1A.01

LAB

DESCRIPTION

Purpose of Space Anthropology Lab

Comments Classroom for the Anthropology program with space for lab activities.

Group / Assignment 01 GENERAL EDUCATION / A ANTHROPOLOGY

ARCHITECTURAL REQUIREMENTS

Area 1 at 960 SF = 960 SF

Occupants 40 Code Occupancy B

Room Access Students, Faculty, Staff Control Card Reader

Door / Entry Sidelite or Relite Closer Yes

Adjacencies Part of 1A Suite

FINISHES

Flooring Durable, environmentally safe, resilient flooring

Ceiling Suspended acoustic tile or gypsum board with acoustic treatment Acoustics NRC 0.70 / CAC 35

Walls Painted gypsum board Acoustics STC 50

Lighting and Views Daylight required, operable windows. Shading or low-E glazing as required. 30 Window Covering Window shades

CASEWORK, EQUIPMENT & FURNITURE

Owner Provided Chairs and desks, teacher workstation, adjustable shelving, lockable file cabinet, printer station

Contractor Provided 2 marker/chalk boards, 4' x 12' with tack strips and map hooks.

TECHNOLOGY

Power Outlets per code: 1) Min. 4 double duplex per wall and above counters, 2) Outlets as required for AV connectivity

Data / WIFI Wifi / Data Telephone Yes

AudioVisual See District "Smart Classroom" Standard

1A.02 STORAGE

DESCRIPTION

Purpose of Space Anthropology Storage

Comments Storage for the Anthropology Lab.

Group / Assignment 01 GENERAL EDUCATION / A ANTHROPOLOGY

ARCHITECTURAL REQUIREMENTS

Area 160 SF

Occupants 0 Code Occupancy B

Room Access Faculty, Staff Control Mechanical Lock

Door / Entry - Closer No

Adjacencies Part of 1A Suite

FINISHES

Flooring Resilient flooring or carpet tile

Ceiling Open to structure Acoustics 0

Walls Painted gypsum board Acoustics STC 40

Lighting and Views 5 -10 fc ambient light level. Window Covering -

CASEWORK, EQUIPMENT & FURNITURE

Owner Provided -

Contractor Provided -

TECHNOLOGY

Power -

Data / WIFI - Telephone -

AudioVisual -

1B.01

ART STUDIO

DESCRIPTION

Purpose of Space	Art Studio
Comments	Classroom for the Art program, adaptable to multiple studio layouts.
Group / Assignment	01 GENERAL EDUCATION / B ART

ARCHITECTURAL REQUIREMENTS

Area	2 at 1200 SF = 2400 SF		
Occupants	40	Code Occupancy	A-3
Room Access	Students, Faculty, Staff	Control	Card Reader
Door / Entry	Sidelite or Relite	Closer	Yes
Adjacencies	Part of 1B Suite		

FINISHES

Flooring	Durable, environmentally safe, resilient flooring		
Ceiling	Suspended acoustic tile or gypsum board with acoustic treatment	Acoustics	NRC 0.70 / CAC 35
Walls	Painted gypsum board	Acoustics	STC 50
Lighting and Views	Daylight required, operable windows. Shading or low-E glazing as required. 30	Window Covering	Window shades

CASEWORK, EQUIPMENT & FURNITURE

Owner Provided	Chairs and desks, teacher workstation, adjustable shelving, lockable file cabinet, printer station		
Contractor Provided	2 marker/chalk boards, 4' x 12' with tack strips and map hooks.		

TECHNOLOGY

Power	Outlets per code: 1) Min. 4 double duplex per wall and above counters, 2) Outlets as required for AV connectivity		
Data / WIFI	Wifi / Data	Telephone	Yes
AudioVisual	See District "Smart Classroom" Standard		

1B.02 STORAGE

DESCRIPTION

Purpose of Space	Project Storage
Comments	Storage for student projects, should be accessible to each Art Studio classroom. Can be one or two rooms.
Group / Assignment	01 GENERAL EDUCATION / B ART

ARCHITECTURAL REQUIREMENTS

Area	450 SF		
Occupants	0	Code Occupancy	B
Room Access	Students, Faculty, Staff	Control	Mechanical Lock
Door / Entry	-	Closer	No
Adjacencies	Part of 1B Suite		

FINISHES

Flooring	Resilient flooring or carpet tile		
Ceiling	Open to structure	Acoustics	0
Walls	Painted gypsum board	Acoustics	STC 40
Lighting and Views	5 -10 fc ambient light level.	Window Covering	-

CASEWORK, EQUIPMENT & FURNITURE

Owner Provided	-		
Contractor Provided	-		

TECHNOLOGY

Power	-		
Data / WIFI	-	Telephone	-
AudioVisual	-		

1C.01

CLASSROOM

DESCRIPTION

Purpose of Space	General Education Classroom
Comments	General Education classrooms for multiple pedagogies.
Group / Assignment	01 GENERAL EDUCATION / C CLASSROOM

ARCHITECTURAL REQUIREMENTS

Area	9 at 960 SF = 8640 SF		
Occupants	40 - 45	Code Occupancy	B
Room Access	Students, Faculty, Staff	Control	Card Reader
Door / Entry	Sidelite or Relite	Closer	Yes
Adjacencies	Other Classrooms, Storage as needed		

FINISHES

Flooring	Durable, environmentally safe, resilient flooring		
Ceiling	Suspended acoustic tile or gypsum board with acoustic treatment	Acoustics	NRC 0.70 / CAC 35
Walls	Painted gypsum board	Acoustics	STC 50
Lighting and Views	Daylight required, operable windows. Shading or low-E glazing as required. 30	Window Covering	Window shades

CASEWORK, EQUIPMENT & FURNITURE

Owner Provided	Chairs and desks, teacher workstation, adjustable shelving, lockable file cabinet, printer station		
Contractor Provided	2 marker/chalk boards, 4' x 12' with tack strips and map hooks.		

TECHNOLOGY

Power	Outlets per code: 1) Min. 4 double duplex per wall and above counters, 2) Outlets as required for AV connectivity		
Data / WIFI	Wifi / Data	Telephone	Yes
AudioVisual	See District "Smart Classroom" Standard		

1C.02 SMALL CLASSROOM

DESCRIPTION

Purpose of Space	General Education Classroom
Comments	General Education classrooms for multiple pedagogies, separated by an operable wall.
Group / Assignment	01 GENERAL EDUCATION / C CLASSROOM

ARCHITECTURAL REQUIREMENTS

Area	2 at 900 SF = 1800 SF		
Occupants	40 - 45	Code Occupancy	B
Room Access	Students, Faculty, Staff	Control	Card Reader
Door / Entry	Sidelite or Relite	Closer	Yes
Adjacencies	Other Classrooms, Storage as needed		

FINISHES

Flooring	Durable, environmentally safe, resilient flooring		
Ceiling	Suspended acoustic tile or gypsum board with acoustic treatment	Acoustics	NRC 0.70 / CAC 35
Walls	Painted gypsum board	Acoustics	STC 50
Lighting and Views	Daylight required, operable windows. Shading or low-E glazing as required. 30	Window Covering	Window shades

CASEWORK, EQUIPMENT & FURNITURE

Owner Provided	Chairs and desks, teacher workstation, adjustable shelving, lockable file cabinet, printer station		
Contractor Provided	2 marker/chalk boards, 4' x 12' with tack strips and map hooks.		

TECHNOLOGY

Power	Outlets per code: 1) Min. 4 double duplex per wall and above counters, 2) Outlets as required for AV connectivity		
Data / WIFI	Wifi / Data	Telephone	Yes
AudioVisual	See District "Smart Classroom" Standard		

1D.01

COMMUNICATIONS CLASSROOM

DESCRIPTION

Purpose of Space Communications Classroom

Comments Classroom for the Communications program.

Group / Assignment 01 GENERAL EDUCATION / D COMMUNICATIONS

ARCHITECTURAL REQUIREMENTS

Area 1 at 960 SF = 960 SF

Occupants 40 - 45 Code Occupancy B

Room Access Students, Faculty, Staff Control Card Reader

Door / Entry Sidelite or Relite Closer Yes

Adjacencies Part of 1C Suite

FINISHES

Flooring Durable, environmentally safe, resilient flooring

Ceiling Suspended acoustic tile or gypsum board with acoustic treatment Acoustics NRC 0.70 / CAC 35

Walls Painted gypsum board Acoustics STC 50

Lighting and Views Daylight required, operable windows. Shading or low-E glazing as required. 30 Window Covering Window shades

CASEWORK, EQUIPMENT & FURNITURE

Owner Provided Chairs and desks, teacher workstation, adjustable shelving, lockable file cabinet, printer station

Contractor Provided 2 marker/chalk boards, 4' x 12' with tack strips and map hooks.

TECHNOLOGY

Power Outlets per code: 1) Min. 4 double duplex per wall and above counters, 2) Outlets as required for AV connectivity

Data / WIFI Wifi / Data Telephone Yes

AudioVisual See District "Smart Classroom" Standard

1D.02

COMMUNICATIONS LAB

DESCRIPTION

Purpose of Space	Communications Lab
Comments	Lab space for special activities for the Communications program.
Group / Assignment	01 GENERAL EDUCATION / D COMMUNICATIONS

ARCHITECTURAL REQUIREMENTS

Area	1 at 320 SF = 320 SF		
Occupants	12	Code Occupancy	B
Room Access	Students, Faculty, Staff	Control	Card Reader
Door / Entry	Sidelite or Relite	Closer	Yes
Adjacencies	Part of 1C Suite		

FINISHES

Flooring	Durable, environmentally safe, resilient flooring		
Ceiling	Suspended acoustic tile or gypsum board with acoustic treatment	Acoustics	NRC 0.70 / CAC 35
Walls	Painted gypsum board	Acoustics	STC 50
Lighting and Views	Daylight required, operable windows. Shading or low-E glazing as required. 30	Window Covering	Window shades

CASEWORK, EQUIPMENT & FURNITURE

Owner Provided	Chairs and desks, teacher workstation, adjustable shelving, lockable file cabinet, printer station		
Contractor Provided	2 marker/chalk boards, 4' x 12' with tack strips and map hooks.		

TECHNOLOGY

Power	Outlets per code: 1) Min. 4 double duplex per wall and above counters, 2) Outlets as required for AV connectivity		
Data / WIFI	Wifi / Data	Telephone	Yes
AudioVisual	See District "Smart Classroom" Standard		

1E.01

STORAGE

DESCRIPTION

Purpose of Space Classroom Storage

Comments Distribute among classrooms and labs as needed.

Group / Assignment 01 GENERAL EDUCATION / E STORAGE

ARCHITECTURAL REQUIREMENTS

Area 320 SF

Occupants 0 Code Occupancy B

Room Access Faculty, Staff Control Mechanical Lock

Door / Entry - Closer No

Adjacencies Distribute among Classrooms as needed

FINISHES

Flooring Resilient flooring or carpet tile

Ceiling Open to structure Acoustics 0

Walls Painted gypsum board Acoustics STC 40

Lighting and Views 5 -10 fc ambient light level. Window Covering -

CASEWORK, EQUIPMENT & FURNITURE

Owner Provided -

Contractor Provided -

TECHNOLOGY

Power -

Data / WIFI - Telephone -

AudioVisual -

2A.01

SHARED OFFICES

DESCRIPTION

Purpose of Space Faculty Offices

Comments Open offices for faculty, can be single or multiple rooms.

Group / Assignment 02 FACULTY / A FACULTY OFFICE

ARCHITECTURAL REQUIREMENTS

Area 1500 SF

Occupants 30 Code Occupancy B

Room Access Faculty, Staff Control Mechanical Lock

Door / Entry Sidelite or Relite Closer No

Adjacencies Part of 02 Liberal Arts Office Suite

FINISHES

Flooring Carpet tile

Ceiling Suspended acoustic tile or gypsum board with acoustic treatment Acoustics NRC 0.70 / CAC 35

Walls Painted gypsum board Acoustics STC 45

Lighting and Views Daylight desirable. 30-50 fc ambient light level Window Covering Window shades

CASEWORK, EQUIPMENT & FURNITURE

Owner Provided Per workstation: Chair and desk, adjustable shelving, lockable file cabinet

Contractor Provided -

TECHNOLOGY

Power Outlets per code

Data / WIFI 1 4-port faceplate per work area Telephone -

AudioVisual 0

2B.01

CONFERENCE ROOM

DESCRIPTION

Purpose of Space Conference Room

Comments Conference room for faculty

Group / Assignment 02 FACULTY / B SUPPORT

ARCHITECTURAL REQUIREMENTS

Area 1 at 240 SF = 240 SF

Occupants 6 - 8 Code Occupancy B

Room Access Faculty, Staff Control Mechanical Lock

Door / Entry Relite Closer Yes

Adjacencies Can be part of 02 Liberal Arts Office Suite or remotely located

FINISHES

Flooring Carpet tile

Ceiling Suspended acoustic tile or gypsum board with acoustic treatment Acoustics NRC 0.70 / CAC 35

Walls Painted gypsum board Acoustics STC 45

Lighting and Views Daylight desirable. 30-50 fc ambient light level Window Covering Window shades

CASEWORK, EQUIPMENT & FURNITURE

Owner Provided Chairs, conference table.

Contractor Provided Casework credenza, lockable.

TECHNOLOGY

Power Outlets per code

Data / WIFI 1 4-port faceplate per wall. Telephone -

AudioVisual Wall-mounted display with media-capable workstation.

2B.02

FACULTY LOUNGE

DESCRIPTION

Purpose of Space Faculty Lounge

Comments Comfortable room for faculty to take breaks and hold informal meetings.

Group / Assignment 02 FACULTY / B SUPPORT

ARCHITECTURAL REQUIREMENTS

Area 1 at 120 SF = 120 SF

Occupants 3 - 6 Code Occupancy B

Room Access Faculty, Staff Control Mechanical Lock

Door / Entry Sidelite or Relite Closer Yes

Adjacencies Can be part of 02 Liberal Arts Office Suite or remotely located

FINISHES

Flooring Carpet tile

Ceiling Suspended acoustic tile or gypsum board with acoustic treatment Acoustics NRC 0.70 / CAC 35

Walls Painted gypsum board Acoustics STC 45

Lighting and Views Daylight desirable. 30-50 fc ambient light level Window Covering Window shades

CASEWORK, EQUIPMENT & FURNITURE

Owner Provided Chairs, tables, adjustable shelving

Contractor Provided Casework kitchenette.

TECHNOLOGY

Power Outlets per code

Data / WIFI 1 4-port faceplate Telephone -

AudioVisual 0

2B.03

FACULTY MAIL ROOM

DESCRIPTION

Purpose of Space	Satellite Mail / Copy Room
Comments	Central location for staff mail. Should include staff mail boxes and basic supplies for outgoing mail.
Group / Assignment	02 FACULTY / B SUPPORT

ARCHITECTURAL REQUIREMENTS

Area	1 at 250 SF = 250 SF		
Occupants	0	Code Occupancy	B
Room Access	Staff	Control	Mechanical Lock
Door / Entry	Relite	Closer	Yes
Adjacencies	02 Liberal Arts or 03 Administrative		

FINISHES

Flooring	Resilient flooring or carpet tile		
Ceiling	Suspended acoustic tile or gypsum board with acoustic treatment	Acoustics	NRC 0.70 / CAC 35
Walls	Painted gypsum board	Acoustics	STC 45
Lighting and Views	30-50 fc ambient light level	Window Covering	0

CASEWORK, EQUIPMENT & FURNITURE

Owner Provided	Table, chairs.		
Contractor Provided	Casework for mail cubbies, work counter, lockable storage.		

TECHNOLOGY

Power	Outlets per code		
Data / WIFI	1 4-port faceplate per wall.	Telephone	-
AudioVisual	Wall-mounted display with media-capable workstation.		

3A.01

PRESIDENT'S OFFICE

DESCRIPTION

Purpose of Space	President Office
Comments	The office of the President, which will include an informal meeting area and secure storage.
Group / Assignment	03 ADMINISTRATIVE OFFICE / A ADMIN - LIBERAL ARTS

ARCHITECTURAL REQUIREMENTS

Area	1 at 300 SF = 300 SF		
Occupants	1	Code Occupancy	B
Room Access	Faculty, Staff	Control	Mechanical Lock
Door / Entry	Relite	Closer	No
Adjacencies	Part of 3A Suite		

FINISHES

Flooring	Carpet tile		
Ceiling	Suspended acoustic tile or gypsum board with acoustic treatment	Acoustics	NRC 0.70 / CAC 35
Walls	Painted gypsum board	Acoustics	STC 45
Lighting and Views	Daylight desirable. 30-50 fc ambient light level	Window Covering	Window shades

CASEWORK, EQUIPMENT & FURNITURE

Owner Provided	Chair, desk, guest chairs, table, adjustable shelving, lockable file cabinet		
Contractor Provided	-		

TECHNOLOGY

Power	Outlets per code		
Data / WIFI	4 4-port faceplates	Telephone	-
AudioVisual	-		

3A.02

VICE-PRESIDENT'S OFFICE

DESCRIPTION

Purpose of Space	Vice President Office
Comments	The office of the Vice-President, which will include an informal meeting area and secure storage.
Group / Assignment	03 ADMINISTRATIVE OFFICE / A ADMIN - LIBERAL ARTS

ARCHITECTURAL REQUIREMENTS

Area	1 at 200 SF = 200 SF		
Occupants	1	Code Occupancy	B
Room Access	Faculty, Staff	Control	Mechanical Lock
Door / Entry	Relite	Closer	No
Adjacencies	Part of 3A Suite		

FINISHES

Flooring	Carpet tile		
Ceiling	Suspended acoustic tile or gypsum board with acoustic treatment	Acoustics	NRC 0.70 / CAC 35
Walls	Painted gypsum board	Acoustics	STC 45
Lighting and Views	Daylight desirable. 30-50 fc ambient light level	Window Covering	Window shades

CASEWORK, EQUIPMENT & FURNITURE

Owner Provided	Chair, desk, guest chairs, table, adjustable shelving, lockable file cabinet		
Contractor Provided	-		

TECHNOLOGY

Power	Outlets per code		
Data / WIFI	4 4-port faceplates	Telephone	-
AudioVisual	-		

3A.03 ASSISTANT'S OFFICE

DESCRIPTION

Purpose of Space Assistant

Comments Offices for the Assistants to the President and the Vice-President.

Group / Assignment 03 ADMINISTRATIVE OFFICE / A ADMIN - LIBERAL ARTS

ARCHITECTURAL REQUIREMENTS

Area 2 at 110 SF = 220 SF

Occupants 1 Code Occupancy B

Room Access Faculty, Staff Control Mechanical Lock

Door / Entry Relite Closer No

Adjacencies Part of 3A Suite

FINISHES

Flooring Carpet tile

Ceiling Suspended acoustic tile or gypsum board with acoustic treatment Acoustics NRC 0.70 / CAC 35

Walls Painted gypsum board Acoustics STC 45

Lighting and Views Daylight desirable. 30-50 fc ambient light level Window Covering Window shades

CASEWORK, EQUIPMENT & FURNITURE

Owner Provided Chair, desk, guest chair, adjustable shelving, lockable file cabinet

Contractor Provided -

TECHNOLOGY

Power Outlets per code

Data / WIFI 1 4-port faceplate Telephone -

AudioVisual -

3A.04 DEAN'S OFFICE

DESCRIPTION

Purpose of Space	Dean Office
Comments	The office of the Dean, which will include an informal meeting area and secure storage.
Group / Assignment	03 ADMINISTRATIVE OFFICE / A ADMIN - LIBERAL ARTS

ARCHITECTURAL REQUIREMENTS

Area	1 at 150 SF = 150 SF		
Occupants	1	Code Occupancy	B
Room Access	Faculty, Staff	Control	Mechanical Lock
Door / Entry	Relite	Closer	No
Adjacencies	Part of 3A Suite		

FINISHES

Flooring	Carpet tile		
Ceiling	Suspended acoustic tile or gypsum board with acoustic treatment	Acoustics	NRC 0.70 / CAC 35
Walls	Painted gypsum board	Acoustics	STC 45
Lighting and Views	Daylight desirable. 30-50 fc ambient light level	Window Covering	Window shades

CASEWORK, EQUIPMENT & FURNITURE

Owner Provided	Chair, desk, guest chairs, table, adjustable shelving, lockable file cabinet		
Contractor Provided	-		

TECHNOLOGY

Power	Outlets per code		
Data / WIFI	4 4-port faceplates	Telephone	-
AudioVisual	-		

3A.05

ADMINISTRATORS OFFICE

DESCRIPTION

Purpose of Space	Administrator
Comments	Offices for Associate Dean, Scheduler, Curriculum & Assessment Specialist, Program Project Manager, Public Information, Researcher, Spare
Group / Assignment	03 ADMINISTRATIVE OFFICE / A ADMIN - LIBERAL ARTS

ARCHITECTURAL REQUIREMENTS

Area	7 at 120 SF = 840 SF		
Occupants	1	Code Occupancy	B
Room Access	Faculty, Staff	Control	Mechanical Lock
Door / Entry	Relite	Closer	No
Adjacencies	Part of 3A Suite		

FINISHES

Flooring	Carpet tile		
Ceiling	Suspended acoustic tile or gypsum board with acoustic treatment	Acoustics	NRC 0.70 / CAC 35
Walls	Painted gypsum board	Acoustics	STC 45
Lighting and Views	Daylight desirable. 30-50 fc ambient light level	Window Covering	Window shades

CASEWORK, EQUIPMENT & FURNITURE

Owner Provided	Chair, desk, guest chair, adjustable shelving, lockable file cabinet		
Contractor Provided	-		

TECHNOLOGY

Power	Outlets per code		
Data / WIFI	1 4-port faceplate	Telephone	-
AudioVisual	-		

3A.06 CONFERENCE ROOM

DESCRIPTION

Purpose of Space President Conference

Comments A conference room to be used by the President and staff.

Group / Assignment 03 ADMINISTRATIVE OFFICE / A ADMIN - LIBERAL ARTS

ARCHITECTURAL REQUIREMENTS

Area 1 at 500 SF = 500 SF

Occupants 6 - 8 Code Occupancy B

Room Access Faculty, Staff Control Mechanical Lock

Door / Entry Sidelite or Relite Closer Yes

Adjacencies Part of 3A Suite

FINISHES

Flooring Carpet tile

Ceiling Suspended acoustic tile or gypsum board with acoustic treatment Acoustics NRC 0.70 / CAC 35

Walls Painted gypsum board Acoustics STC 45

Lighting and Views Daylight desirable. 30-50 fc ambient light level Window Covering Window shades

CASEWORK, EQUIPMENT & FURNITURE

Owner Provided Chairs, conference table.

Contractor Provided Casework credenza, lockable.

TECHNOLOGY

Power Outlets per code

Data / WIFI 1 4-port faceplate per wall. Telephone -

AudioVisual Wall-mounted display with media-capable workstation.

3A.07 RECEPTION

DESCRIPTION

Purpose of Space	Reception
Comments	The reception area will be the front door of the suite, with a prominent staff service point and a waiting area.
Group / Assignment	03 ADMINISTRATIVE OFFICE / A ADMIN - LIBERAL ARTS

ARCHITECTURAL REQUIREMENTS

Area	1 at 150 SF = 150 SF		
Occupants	1	Code Occupancy	B
Room Access	Students, Faculty, Staff	Control	Card Reader
Door / Entry	Sidelite or Relite	Closer	Yes
Adjacencies	Part of 3A Suite		

FINISHES

Flooring	Carpet tile		
Ceiling	Suspended acoustic tile or gypsum board with acoustic treatment	Acoustics	NRC 0.70 / CAC 35
Walls	Painted gypsum board	Acoustics	STC 45
Lighting and Views	Daylight desirable. 30-50 fc ambient light level	Window Covering	Window shades

CASEWORK, EQUIPMENT & FURNITURE

Owner Provided	Chair, desk, guest chair, adjustable shelving, lockable file cabinet
Contractor Provided	-

TECHNOLOGY

Power	Outlets per code		
Data / WIFI	1 4-port faceplate	Telephone	-
AudioVisual	-		

3A.08 STORAGE

DESCRIPTION

Purpose of Space Storage

Comments Storage room for office supplies and files.

Group / Assignment 03 ADMINISTRATIVE OFFICE / A ADMIN - LIBERAL ARTS

ARCHITECTURAL REQUIREMENTS

Area 1 at 60 SF = 60 SF

Occupants 0 Code Occupancy B

Room Access Faculty, Staff Control Mechanical Lock

Door / Entry - Closer No

Adjacencies Part of 3A Suite

FINISHES

Flooring Resilient flooring or carpet tile

Ceiling Open to structure Acoustics 0

Walls Painted gypsum board Acoustics STC 40

Lighting and Views 5 -10 fc ambient light level. Window Covering -

CASEWORK, EQUIPMENT & FURNITURE

Owner Provided -

Contractor Provided -

TECHNOLOGY

Power -

Data / WIFI - Telephone -

AudioVisual -

3A.09

ADMINISTRATIVE WORK ROOM

DESCRIPTION

Purpose of Space Workroom

Comments Work area for the Administrative Suite.

Group / Assignment 03 ADMINISTRATIVE OFFICE / A ADMIN - LIBERAL ARTS

ARCHITECTURAL REQUIREMENTS

Area 1 at 110 SF = 110 SF

Occupants 0 Code Occupancy B

Room Access Faculty, Staff Control Mechanical Lock

Door / Entry Relite Closer No

Adjacencies Part of 3A Suite

FINISHES

Flooring Carpet tile

Ceiling Suspended acoustic tile or gypsum board with acoustic treatment Acoustics NRC 0.70 / CAC 35

Walls Painted gypsum board Acoustics STC 40

Lighting and Views Daylight desirable. 30-50 fc ambient light level Window Covering Window shades

CASEWORK, EQUIPMENT & FURNITURE

Owner Provided Per workstation: Chair and desk, adjustable shelving, lockable file cabinet

Contractor Provided -

TECHNOLOGY

Power Outlets per code

Data / WIFI 1 4-port faceplate per work area Telephone -

AudioVisual 0

3A.10

WORKSTATIONS

DESCRIPTION

Purpose of Space Workstations

Comments Workstations for administrative staff. A single room is preferred.

Group / Assignment 03 ADMINISTRATIVE OFFICE / A ADMIN - LIBERAL ARTS

ARCHITECTURAL REQUIREMENTS

Area 560 SF

Occupants 7 Code Occupancy B

Room Access Faculty, Staff Control Mechanical Lock

Door / Entry Sidelite or Relite Closer No

Adjacencies Part of 3A Suite

FINISHES

Flooring Carpet tile

Ceiling Suspended acoustic tile or gypsum board with acoustic treatment Acoustics NRC 0.70 / CAC 35

Walls Painted gypsum board Acoustics STC 45

Lighting and Views Daylight desirable. 30-50 fc ambient light level Window Covering Window shades

CASEWORK, EQUIPMENT & FURNITURE

Owner Provided Per workstation: Chair and desk, adjustable shelving, lockable file cabinet

Contractor Provided -

TECHNOLOGY

Power Outlets per code

Data / WIFI 1 4-port faceplate per work area Telephone -

AudioVisual 0

4A.01 PATIO

DESCRIPTION

Purpose of Space Roof Patio

Comments An outdoor patio suitable for day-time or evening functions, classes or informal gatherings.

Group / Assignment 04 OUTDOOR MEETING AREA / A MEETING

ARCHITECTURAL REQUIREMENTS

Area 1 at 3000 SF = 3000 SF

Occupants 0 Code Occupancy A-3

Room Access Students, Faculty, Staff Control Access Control

Door / Entry Sidelite or Relite Closer Automatic

Adjacencies Roof Garden

FINISHES

Flooring Exterior drainable pavers

Ceiling - Acoustics -

Walls - Acoustics -

Lighting and Views - Window Covering -

CASEWORK, EQUIPMENT & FURNITURE

Owner Provided -

Contractor Provided -

TECHNOLOGY

Power All-weather outlets per code

Data / WIFI Wifi Telephone -

AudioVisual -

4A.02 STAGING

DESCRIPTION

Purpose of Space Staging

Comments A staging room for preparing/cleaning up from functions held in the Patio.

Group / Assignment 04 OUTDOOR MEETING AREA / A MEETING

ARCHITECTURAL REQUIREMENTS

Area 1 at 140 SF = 140 SF

Occupants 0 Code Occupancy B

Room Access Faculty, Staff Control Mechanical Lock

Door / Entry Sidelite or Relite Closer No

Adjacencies 4A.01 Roof Patio

FINISHES

Flooring Sealed Concrete

Ceiling Open to structure Acoustics 0

Walls Painted gypsum board Acoustics STC 40

Lighting and Views 5 -10 fc ambient light level. Window Covering -

CASEWORK, EQUIPMENT & FURNITURE

Owner Provided -

Contractor Provided -

TECHNOLOGY

Power Outlets per code

Data / WIFI 1 4-port faceplate Telephone -

AudioVisual -

4A.03 STORAGE

DESCRIPTION

Purpose of Space Storage

Comments Storage for furniture, equipment and supplies associated with the Paio function area.

Group / Assignment 04 OUTDOOR MEETING AREA / A MEETING

ARCHITECTURAL REQUIREMENTS

Area 1 at 150 SF = 150 SF

Occupants 0 Code Occupancy B

Room Access Faculty, Staff Control Mechanical Lock

Door / Entry - Closer No

Adjacencies 4A.01 Roof Patio

FINISHES

Flooring Sealed Concrete

Ceiling Open to structure Acoustics 0

Walls Painted gypsum board Acoustics STC 40

Lighting and Views 5 -10 fc ambient light level. Window Covering -

CASEWORK, EQUIPMENT & FURNITURE

Owner Provided -

Contractor Provided -

TECHNOLOGY

Power Outlets per code

Data / WIFI - Telephone -

AudioVisual -

5A.01

HEALTH CENTER RECEPTION

DESCRIPTION

Purpose of Space	Waiting Rm / Meeting Rm
Comments	Main point of entry for the Health Center. Includes service point and waiting area.
Group / Assignment	05 STUDENT SERVICES & LEARNING COMMUNITIES / A HEALTH CENTER

ARCHITECTURAL REQUIREMENTS

Area	1 at 400 SF = 400 SF		
Occupants	1	Code Occupancy	B
Room Access	Students, Faculty, Staff	Control	Card Reader
Door / Entry	Glazed Entry	Closer	Yes
Adjacencies	-		

FINISHES

Flooring	Durable, environmentally safe, resilient flooring		
Ceiling	Suspended acoustic tile or gypsum board with acoustic treatment	Acoustics	NRC 0.70 / CAC 35
Walls	Painted gypsum board	Acoustics	STC 45
Lighting and Views	Daylight desirable. 30-50 fc ambient light level	Window Covering	Window shades

CASEWORK, EQUIPMENT & FURNITURE

Owner Provided	Per workstation: Chair and desk, adjustable shelving, lockable file cabinet		
Contractor Provided	-		

TECHNOLOGY

Power	Outlets per code		
Data / WIFI	1 4-port faceplate per work area	Telephone	0
AudioVisual	0		

5A.02 EXAM ROOM

DESCRIPTION

Purpose of Space Exam Room

Comments Private examination room for patient consultation.

Group / Assignment 05 STUDENT SERVICES & LEARNING COMMUNITIES / A HEALTH CENTER

ARCHITECTURAL REQUIREMENTS

Area 1 at 150 SF = 150 SF

Occupants 2 Code Occupancy B

Room Access Students, Faculty, Staff Control Mechanical Lock

Door / Entry - Closer Yes

Adjacencies Part of 5A Health Center

FINISHES

Flooring Durable, environmentally safe, resilient flooring

Ceiling Suspended acoustic tile or gypsum board with acoustic treatment Acoustics NRC 0.70 / CAC 35

Walls Painted gypsum board Acoustics STC 50

Lighting and Views Privacy. 30-50 fc ambient light level Window Covering 0

CASEWORK, EQUIPMENT & FURNITURE

Owner Provided Exam room furnishings

Contractor Provided -

TECHNOLOGY

Power Outlets per code

Data / WIFI 1 4-port faceplate Telephone 0

AudioVisual 0

5A.03 LACTATON

DESCRIPTION

Purpose of Space Lactation

Comments Private room for nursing mothers within the BCC Community.

Group / Assignment 05 STUDENT SERVICES & LEARNING COMMUNITIES / A HEALTH CENTER

ARCHITECTURAL REQUIREMENTS

Area 1 at 100 SF = 100 SF

Occupants 1 Code Occupancy B

Room Access Students, Faculty, Staff Control Mechanical Lock

Door / Entry - Closer Yes

Adjacencies Part of 5A Health Center

FINISHES

Flooring Durable, environmentally safe, resilient flooring

Ceiling Suspended acoustic tile or gypsum board with acoustic treatment Acoustics NRC 0.70 / CAC 35

Walls Painted gypsum board Acoustics STC 50

Lighting and Views Privacy. 30-50 fc ambient light level Window Covering 0

CASEWORK, EQUIPMENT & FURNITURE

Owner Provided Exam room furnishings

Contractor Provided -

TECHNOLOGY

Power Outlets per code

Data / WIFI - Telephone 0

AudioVisual 0

5A.04 HEALTH CENTER OFFICE

DESCRIPTION

Purpose of Space	Office
Comments	Staff office.
Group / Assignment	05 STUDENT SERVICES & LEARNING COMMUNITIES / A HEALTH CENTER

ARCHITECTURAL REQUIREMENTS

Area	1 at 120 SF = 120 SF		
Occupants	1	Code Occupancy	B
Room Access	Faculty, Staff	Control	Mechanical Lock
Door / Entry	Relite	Closer	No
Adjacencies	Part of 5A Health Center		

FINISHES

Flooring	Carpet tile		
Ceiling	Suspended acoustic tile or gypsum board with acoustic treatment	Acoustics	NRC 0.70 / CAC 35
Walls	Painted gypsum board	Acoustics	STC 45
Lighting and Views	Daylight desirable. 30-50 fc ambient light level	Window Covering	Window shades

CASEWORK, EQUIPMENT & FURNITURE

Owner Provided	Chair, desk, guest chair, adjustable shelving, lockable file cabinet		
Contractor Provided	-		

TECHNOLOGY

Power	Outlets per code		
Data / WIFI	1 4-port faceplate	Telephone	-
AudioVisual	-		

5A.05 STORAGE

DESCRIPTION

Purpose of Space Storage

Comments Storage of filing and supplies for the Health Center. Single room preferred.

Group / Assignment 05 STUDENT SERVICES & LEARNING COMMUNITIES / A HEALTH CENTER

ARCHITECTURAL REQUIREMENTS

Area 150 SF

Occupants 0 Code Occupancy B

Room Access Faculty, Staff Control Mechanical Lock

Door / Entry - Closer No

Adjacencies Part of 5A Health Center

FINISHES

Flooring Resilient flooring or carpet tile

Ceiling Open to structure Acoustics 0

Walls Painted gypsum board Acoustics STC 40

Lighting and Views 5 -10 fc ambient light level. Window Covering -

CASEWORK, EQUIPMENT & FURNITURE

Owner Provided -

Contractor Provided -

TECHNOLOGY

Power -

Data / WIFI - Telephone -

AudioVisual -

5B.01

MENTAL WELLNESS WAITING ROOM

DESCRIPTION

Purpose of Space	Mental Wellness Waiting Room
Comments	Main point of entry for the Mental Wellness Center. Includes service point and waiting area.
Group / Assignment	05 STUDENT SERVICES & LEARNING COMMUNITIES / B MENTAL WELLNESS

ARCHITECTURAL REQUIREMENTS

Area	1 at 150 SF = 150 SF		
Occupants	3 - 5	Code Occupancy	B
Room Access	Students, Faculty, Staff	Control	Card Reader
Door / Entry	Glazed Entry	Closer	Yes
Adjacencies	-		

FINISHES

Flooring	Durable, environmentally safe, resilient flooring		
Ceiling	Suspended acoustic tile or gypsum board with acoustic treatment	Acoustics	NRC 0.70 / CAC 35
Walls	Painted gypsum board	Acoustics	STC 45
Lighting and Views	Daylight desirable. 30-50 fc ambient light level	Window Covering	Window shades

CASEWORK, EQUIPMENT & FURNITURE

Owner Provided	Per workstation: Chair and desk, adjustable shelving, lockable file cabinet		
Contractor Provided	-		

TECHNOLOGY

Power	Outlets per code		
Data / WIFI	1 4-port faceplate per work area	Telephone	0
AudioVisual	0		

5B.02

CONFERENCE ROOM

DESCRIPTION

Purpose of Space Conference Room

Comments Conference room for Mental Wellness Center staff and student clients.

Group / Assignment 05 STUDENT SERVICES & LEARNING COMMUNITIES / B MENTAL WELLNESS

ARCHITECTURAL REQUIREMENTS

Area 1 at 400 SF = 400 SF

Occupants 8 - 12 Code Occupancy B

Room Access Students, Faculty, Staff Control Mechanical Lock

Door / Entry Relite Closer Yes

Adjacencies Part of 5B Mental Wellness

FINISHES

Flooring Durable, environmentally safe, resilient flooring

Ceiling Suspended acoustic tile or gypsum board with acoustic treatment Acoustics NRC 0.70 / CAC 35

Walls Painted gypsum board Acoustics STC 45

Lighting and Views Daylight desirable. 30-50 fc ambient light level Window Covering Window shades

CASEWORK, EQUIPMENT & FURNITURE

Owner Provided Chairs, conference table.

Contractor Provided Casework credenza, lockable.

TECHNOLOGY

Power Outlets per code

Data / WIFI 1 4-port faceplate per wall. Telephone -

AudioVisual Wall-mounted display with media-capable workstation.

5B.03

PRIVATE OFFICE

DESCRIPTION

Purpose of Space Mental Wellness Counselor Office

Comments Private offices for counselor / client consultations.

Group / Assignment 05 STUDENT SERVICES & LEARNING COMMUNITIES / B MENTAL WELLNESS

ARCHITECTURAL REQUIREMENTS

Area 2 at 100 SF = 200 SF

Occupants 2 Code Occupancy B

Room Access Faculty, Staff Control Mechanical Lock

Door / Entry Relite Closer No

Adjacencies Part of 5B Mental Wellness

FINISHES

Flooring Resilient flooring or carpet tile

Ceiling Suspended acoustic tile or gypsum board with acoustic treatment Acoustics NRC 0.70 / CAC 35

Walls Painted gypsum board Acoustics STC 45

Lighting and Views Daylight desirable. 30-50 fc ambient light level Window Covering Window shades

CASEWORK, EQUIPMENT & FURNITURE

Owner Provided Chair, desk, guest chair, adjustable shelving, lockable file cabinet

Contractor Provided -

TECHNOLOGY

Power Outlets per code

Data / WIFI 1 4-port faceplate Telephone -

AudioVisual -

5B.04

STAFF LOUNGE

DESCRIPTION

Purpose of Space Staff Lounge

Comments An informal space for individuals and small groups.

Group / Assignment 05 STUDENT SERVICES & LEARNING COMMUNITIES / B MENTAL WELLNESS

ARCHITECTURAL REQUIREMENTS

Area 1 at 200 SF = 200 SF

Occupants 4 - 8 Code Occupancy B

Room Access Faculty, Staff Control Mechanical Lock

Door / Entry Sidelite or Relite Closer Yes

Adjacencies Part of 5B Mental Wellness

FINISHES

Flooring Resilient flooring or carpet tile

Ceiling Suspended acoustic tile or gypsum board with acoustic treatment Acoustics NRC 0.70 / CAC 35

Walls Painted gypsum board Acoustics STC 45

Lighting and Views Daylight desirable. 30-50 fc ambient light level Window Covering Window shades

CASEWORK, EQUIPMENT & FURNITURE

Owner Provided Chairs, tables, adjustable shelving

Contractor Provided Casework kitchenette.

TECHNOLOGY

Power Outlets per code

Data / WIFI 1 4-port faceplate Telephone -

AudioVisual 0

5C.01

VETERANS' SUPPORT WAITING AREA

DESCRIPTION

Purpose of Space	Veterans' Support Services waiting and service area
Comments	Open area for Veterans' Support Services, including a service desk and waiting area.
Group / Assignment	05 STUDENT SERVICES & LEARNING COMMUNITIES / C VETERANS

ARCHITECTURAL REQUIREMENTS

Area	1 at 400 SF = 400 SF		
Occupants	6 - 10	Code Occupancy	B
Room Access	Students, Faculty, Staff	Control	Card Reader
Door / Entry	Sidelite or Relite	Closer	Yes
Adjacencies	Other 05 Student Services		

FINISHES

Flooring	Carpet tile		
Ceiling	Suspended acoustic tile or gypsum board with acoustic treatment	Acoustics	NRC 0.70 / CAC 35
Walls	Painted gypsum board	Acoustics	STC 45
Lighting and Views	Daylight desirable. 30-50 fc ambient light level	Window Covering	Window shades

CASEWORK, EQUIPMENT & FURNITURE

Owner Provided	Per workstation: Chair and desk, adjustable shelving, lockable file cabinet		
Contractor Provided	-		

TECHNOLOGY

Power	Outlets per code		
Data / WIFI	1 4-port faceplate per work area	Telephone	-
AudioVisual	0		

5C.02

OFFICE

DESCRIPTION

Purpose of Space Staff Offices

Comments Private office space for Veterans Coordinator, Vetereans Counselor

Group / Assignment 05 STUDENT SERVICES & LEARNING COMMUNITIES / C VETERANS

ARCHITECTURAL REQUIREMENTS

Area 2 at 120 SF = 240 SF

Occupants 1 Code Occupancy B

Room Access Students, Faculty, Staff Control Mechanical Lock

Door / Entry Relite Closer No

Adjacencies Part of 5C Veterans Support Center

FINISHES

Flooring Carpet tile

Ceiling Suspended acoustic tile or gypsum board with acoustic treatment Acoustics NRC 0.70 / CAC 35

Walls Painted gypsum board Acoustics STC 45

Lighting and Views Daylight desirable. 30-50 fc ambient light level Window Covering Window shades

CASEWORK, EQUIPMENT & FURNITURE

Owner Provided Chair, desk, guest chair, adjustable shelving, lockable file cabinet

Contractor Provided -

TECHNOLOGY

Power Outlets per code

Data / WIFI 1 4-port faceplate Telephone -

AudioVisual -

5D.01

OFFICE

DESCRIPTION

Purpose of Space	Office
Comments	Offices for the Multicultural Resource Center [MCRC] staff.
Group / Assignment	05 STUDENT SERVICES & LEARNING COMMUNITIES / D MCRC

ARCHITECTURAL REQUIREMENTS

Area	6 at 100 SF = 600 SF		
Occupants	1	Code Occupancy	B
Room Access	Students, Faculty, Staff	Control	Mechanical Lock
Door / Entry	Relite	Closer	No
Adjacencies	Other 05 Student Services		

FINISHES

Flooring	Carpet tile		
Ceiling	Suspended acoustic tile or gypsum board with acoustic treatment	Acoustics	NRC 0.70 / CAC 35
Walls	Painted gypsum board	Acoustics	STC 45
Lighting and Views	Daylight desirable. 30-50 fc ambient light level	Window Covering	Window shades

CASEWORK, EQUIPMENT & FURNITURE

Owner Provided	Chair, desk, guest chair, adjustable shelving, lockable file cabinet		
Contractor Provided	-		

TECHNOLOGY

Power	Outlets per code		
Data / WIFI	1 4-port faceplate	Telephone	-
AudioVisual	-		

5D.02

SHARED OFFICES

DESCRIPTION

Purpose of Space Shared Open Area

Comments Open offices for the Multicultural Resource Center [MCRC] staff.

Group / Assignment 05 STUDENT SERVICES & LEARNING COMMUNITIES / D MCRC

ARCHITECTURAL REQUIREMENTS

Area 1 at 500 SF = 500 SF

Occupants 10 - 16 Code Occupancy B

Room Access Students, Faculty, Staff Control Card Reader

Door / Entry Sidelite or Relite Closer Yes

Adjacencies Part of 5D MCRC

FINISHES

Flooring Carpet tile

Ceiling Suspended acoustic tile or gypsum board with acoustic treatment Acoustics NRC 0.70 / CAC 35

Walls Painted gypsum board Acoustics STC 45

Lighting and Views Daylight desirable. 30-50 fc ambient light level Window Covering Window shades

CASEWORK, EQUIPMENT & FURNITURE

Owner Provided Per workstation: Chair and desk, adjustable shelving, lockable file cabinet

Contractor Provided -

TECHNOLOGY

Power Outlets per code

Data / WIFI 1 4-port faceplate per work area Telephone -

AudioVisual 0

5E.01

RECEPTION

DESCRIPTION

Purpose of Space	Waiting Room
Comments	Main entry point for UCRC. Includes service/reception desk. Workstations for UCRC staff.
Group / Assignment	05 STUDENT SERVICES & LEARNING COMMUNITIES / E UCRC

ARCHITECTURAL REQUIREMENTS

Area	1 at 375 SF = 375 SF		
Occupants	0	Code Occupancy	B
Room Access	Students, Faculty, Staff	Control	Card Reader
Door / Entry	Sidelite or Relite	Closer	Yes
Adjacencies	Other 05 Student Services		

FINISHES

Flooring	Carpet tile		
Ceiling	Suspended acoustic tile or gypsum board with acoustic treatment	Acoustics	NRC 0.70 / CAC 35
Walls	Painted gypsum board	Acoustics	STC 45
Lighting and Views	Daylight desirable. 30-50 fc ambient light level	Window Covering	Window shades

CASEWORK, EQUIPMENT & FURNITURE

Owner Provided	Per workstation: Chair and desk, adjustable shelving, lockable file cabinet		
Contractor Provided	-		

TECHNOLOGY

Power	Outlets per code		
Data / WIFI	1 4-port faceplate per work area	Telephone	-
AudioVisual	0		

5E.02

OFFICE

DESCRIPTION

Purpose of Space Office

Comments Office space for the director of UCRC.

Group / Assignment 05 STUDENT SERVICES & LEARNING COMMUNITIES / E UCRC

ARCHITECTURAL REQUIREMENTS

Area 1 at 120 SF = 120 SF

Occupants 1 Code Occupancy B

Room Access Students, Faculty, Staff Control Mechanical Lock

Door / Entry Relite Closer No

Adjacencies Part of 5E UCRC

FINISHES

Flooring Carpet tile

Ceiling Suspended acoustic tile or gypsum board with acoustic treatment Acoustics NRC 0.70 / CAC 35

Walls Painted gypsum board Acoustics STC 45

Lighting and Views Daylight desirable. 30-50 fc ambient light level Window Covering Window shades

CASEWORK, EQUIPMENT & FURNITURE

Owner Provided Chair, desk, guest chair, adjustable shelving, lockable file cabinet

Contractor Provided -

TECHNOLOGY

Power Outlets per code

Data / WIFI 1 4-port faceplate Telephone -

AudioVisual -

5F.01

BOOKSTORE

DESCRIPTION

Purpose of Space	Retail Space
Comments	Retail space for the campus bookstore, including display for books and supplies, shelving, and point of sale. Provide multiple exit routes for security.
Group / Assignment	05 STUDENT SERVICES & LEARNING COMMUNITIES / F BOOKSTORE

ARCHITECTURAL REQUIREMENTS

Area	1 at 800 SF = 800 SF		
Occupants	0	Code Occupancy	B
Room Access	Students, Faculty, Staff	Control	Card Reader
Door / Entry	Glazed Entry	Closer	Yes
Adjacencies	Ground Floor, near entry, highly visible		

FINISHES

Flooring	Resilient flooring or carpet tile		
Ceiling	Suspended acoustic tile or gypsum board with acoustic treatment	Acoustics	NRC 0.70 / CAC 35
Walls	Painted gypsum board	Acoustics	STC 40
Lighting and Views	Daylight desirable. 30-50 fc ambient light level	Window Covering	Window shades

CASEWORK, EQUIPMENT & FURNITURE

Owner Provided	Shelving for display of books, cashwrap for purchases. Grab & Go food display.		
Contractor Provided	Floor sinks.		

TECHNOLOGY

Power	Outlets per code		
Data / WIFI	1 4-port faceplate	Telephone	-
AudioVisual	-		

5F.02

OFFICE

DESCRIPTION

Purpose of Space	Office
Comments	Office for bookstore staff.
Group / Assignment	05 STUDENT SERVICES & LEARNING COMMUNITIES / F BOOKSTORE

ARCHITECTURAL REQUIREMENTS

Area	1 at 120 SF = 120 SF		
Occupants	1	Code Occupancy	B
Room Access	Faculty, Staff	Control	Mechanical Lock
Door / Entry	Relite	Closer	No
Adjacencies	Part of 5F Bookstore		

FINISHES

Flooring	Resilient flooring or carpet tile		
Ceiling	Suspended acoustic tile or gypsum board with acoustic treatment	Acoustics	NRC 0.70 / CAC 35
Walls	Painted gypsum board	Acoustics	STC 45
Lighting and Views	Daylight desirable. 30-50 fc ambient light level	Window Covering	Window shades

CASEWORK, EQUIPMENT & FURNITURE

Owner Provided	Chair, desk, guest chair, adjustable shelving, lockable file cabinet, safe.		
Contractor Provided	-		

TECHNOLOGY

Power	Outlets per code		
Data / WIFI	1 4-port faceplate	Telephone	-
AudioVisual	-		

5F.03

STORAGE & WORK ROOM

DESCRIPTION

Purpose of Space	Storage & Work Room
Comments	Storage for both boxed and unboxed books and supplies. Work area for breaking down and preparing shipments.
Group / Assignment	05 STUDENT SERVICES & LEARNING COMMUNITIES / F BOOKSTORE

ARCHITECTURAL REQUIREMENTS

Area	500 SF		
Occupants	0	Code Occupancy	B
Room Access	Faculty, Staff	Control	Mechanical Lock
Door / Entry	-	Closer	No
Adjacencies	5F Bookstore, access to Loading Area (11B.01)		

FINISHES

Flooring	Resilient flooring or carpet tile		
Ceiling	Open to structure	Acoustics	0
Walls	Painted gypsum board	Acoustics	STC 40
Lighting and Views	5 -10 fc ambient light level.	Window Covering	-

CASEWORK, EQUIPMENT & FURNITURE

Owner Provided	Postal & shipping equipment.
Contractor Provided	-

TECHNOLOGY

Power	-		
Data / WIFI	-	Telephone	-
AudioVisual	-		

DESCRIPTION

Purpose of Space	Lounge / Gallery
------------------	------------------

Comments	A multi-use space dedicated to student-initiated exhibitions.
----------	---

Group / Assignment	05 STUDENT SERVICES & LEARNING COMMUNITIES / G STUDENT LOUNGE / GALLERY
--------------------	---

ARCHITECTURAL REQUIREMENTS

Area	1 at 1000 SF = 1000 SF
------	------------------------

Occupants	0	Code Occupancy	A-3
-----------	---	----------------	-----

Room Access	Students, Faculty, Staff	Control	Card Reader
-------------	--------------------------	---------	-------------

Door / Entry	Glazed Entry	Closer	Yes
--------------	--------------	--------	-----

Adjacencies	Ground Floor, near entry
-------------	--------------------------

FINISHES

Flooring	Resilient flooring or carpet tile
----------	-----------------------------------

Ceiling	Gypsum board	Acoustics	NRC 0.70 / CAC 35
---------	--------------	-----------	-------------------

Walls	Painted gypsum board	Acoustics	STC 45
-------	----------------------	-----------	--------

Lighting and Views	Daylight desirable. 30-50 fc ambient light level	Window Covering	Window shades
--------------------	--	-----------------	---------------

CASEWORK, EQUIPMENT & FURNITURE

Owner Provided	Equipment for display of student work
----------------	---------------------------------------

Contractor Provided	-
---------------------	---

TECHNOLOGY

Power	Outlets per code
-------	------------------

Data / WIFI	-	Telephone	-
-------------	---	-----------	---

AudioVisual	-
-------------	---

5H.01

MEETING ROOM

DESCRIPTION

Purpose of Space Meeting Room

Comments Meeting room capable of providing privacy.

Group / Assignment 05 STUDENT SERVICES & LEARNING COMMUNITIES / H SHARED SERVICES

ARCHITECTURAL REQUIREMENTS

Area 1 at 180 SF = 180 SF

Occupants 6 - 8 Code Occupancy B

Room Access Students, Faculty, Staff Control Mechanical Lock

Door / Entry Sidelite or Relite Closer Yes

Adjacencies Other 05 Student Services

FINISHES

Flooring Carpet tile

Ceiling Suspended acoustic tile or gypsum board with acoustic treatment Acoustics NRC 0.70 / CAC 35

Walls Painted gypsum board Acoustics STC 45

Lighting and Views Daylight desirable. 30-50 fc ambient light level Window Covering Window shades

CASEWORK, EQUIPMENT & FURNITURE

Owner Provided Chairs, conference table.

Contractor Provided Casework credenza, lockable.

TECHNOLOGY

Power Outlets per code

Data / WIFI 1 4-port faceplate per wall. Telephone -

AudioVisual Wall-mounted display with media-capable workstation.

5H.02

QUIET ROOM

DESCRIPTION

Purpose of Space Spirituality / Quiet Room

Comments Private space for members of the BCC community.

Group / Assignment 05 STUDENT SERVICES & LEARNING COMMUNITIES / H SHARED SERVICES

ARCHITECTURAL REQUIREMENTS

Area 1 at 120 SF = 120 SF

Occupants 1 Code Occupancy B

Room Access Students, Faculty, Staff Control Mechanical Lock

Door / Entry Relite Closer No

Adjacencies Other 05 Student Services

FINISHES

Flooring Carpet tile

Ceiling Suspended acoustic tile or gypsum board with acoustic treatment Acoustics NRC 0.70 / CAC 35

Walls Painted gypsum board Acoustics STC 55

Lighting and Views 10-30 fc ambient light Window Covering 0

CASEWORK, EQUIPMENT & FURNITURE

Owner Provided Comfortable furniture

Contractor Provided -

TECHNOLOGY

Power Outlets per code

Data / WIFI 0 Telephone -

AudioVisual 0

6A.01 OPEN AREA

DESCRIPTION

Purpose of Space	Learning Resource Center
Comments	Work area for students with nearby staff support. Includes a service desk in a prominent location.
Group / Assignment	06 LEARNING RESOURCE CENTER / A LRC

ARCHITECTURAL REQUIREMENTS

Area	1 at 1500 SF = 1500 SF		
Occupants	30 - 50	Code Occupancy	B
Room Access	Students, Faculty, Staff	Control	Card Reader
Door / Entry	Sidelite or Relite	Closer	Yes
Adjacencies	6B Computer Lab		

FINISHES

Flooring	Carpet tile		
Ceiling	Suspended acoustic tile or gypsum board with acoustic treatment	Acoustics	NRC 0.70 / CAC 35
Walls	Painted gypsum board	Acoustics	STC 45
Lighting and Views	Daylight desirable. 30-50 fc ambient light level	Window Covering	Window shades

CASEWORK, EQUIPMENT & FURNITURE

Owner Provided	Per workstation: Chair and desk, adjustable shelving, lockable file cabinet		
Contractor Provided	-		

TECHNOLOGY

Power	Outlets per code		
Data / WIFI	0	Telephone	0
AudioVisual	0		

6A.02 LRC GROUP STUDY

DESCRIPTION

Purpose of Space LRC Group Study Rooms

Comments Meeting room for students and staff.

Group / Assignment 06 LEARNING RESOURCE CENTER / A LRC

ARCHITECTURAL REQUIREMENTS

Area 2 at 180 SF = 360 SF

Occupants 8 - 14 Code Occupancy B

Room Access Students, Faculty, Staff Control Mechanical Lock

Door / Entry Sidelite or Relite Closer No

Adjacencies Part of 6A LRC

FINISHES

Flooring Carpet tile

Ceiling Suspended acoustic tile or gypsum board with acoustic treatment Acoustics NRC 0.70 / CAC 35

Walls Painted gypsum board Acoustics STC 45

Lighting and Views Daylight desirable. 30-50 fc ambient light level Window Covering Window shades

CASEWORK, EQUIPMENT & FURNITURE

Owner Provided Chairs, conference table.

Contractor Provided Casework credenza, lockable.

TECHNOLOGY

Power Outlets per code

Data / WIFI 1 4-port faceplate per wall. Telephone -

AudioVisual Wall-mounted display with media-capable workstation.

6A.03 OFFICE

DESCRIPTION

Purpose of Space LRC Office

Comments Office space for the director of the LRC.

Group / Assignment 06 LEARNING RESOURCE CENTER / A LRC

ARCHITECTURAL REQUIREMENTS

Area 2 at 110 SF = 220 SF

Occupants 1 Code Occupancy B

Room Access Students, Faculty, Staff Control Mechanical Lock

Door / Entry Relite Closer No

Adjacencies Part of 6A LRC

FINISHES

Flooring Carpet tile

Ceiling Suspended acoustic tile or gypsum board with acoustic treatment Acoustics NRC 0.70 / CAC 35

Walls Painted gypsum board Acoustics STC 45

Lighting and Views Daylight desirable. 30-50 fc ambient light level Window Covering Window shades

CASEWORK, EQUIPMENT & FURNITURE

Owner Provided Chair, desk, guest chair, adjustable shelving, lockable file cabinet

Contractor Provided -

TECHNOLOGY

Power Outlets per code

Data / WIFI 1 4-port faceplate Telephone -

AudioVisual -

6A.04 OPEN OFFICES

DESCRIPTION

Purpose of Space LRC Open Office

Comments Shared office space for LRC staff.

Group / Assignment 06 LEARNING RESOURCE CENTER / A LRC

ARCHITECTURAL REQUIREMENTS

Area 1 at 320 SF = 320 SF

Occupants 4 - 8 Code Occupancy B

Room Access Students, Faculty, Staff Control Mechanical Lock

Door / Entry Sidelite or Relite Closer Yes

Adjacencies Part of 6A LRC

FINISHES

Flooring Carpet tile

Ceiling Suspended acoustic tile or gypsum board with acoustic treatment Acoustics NRC 0.70 / CAC 35

Walls Painted gypsum board Acoustics STC 45

Lighting and Views Daylight desirable. 30-50 fc ambient light level Window Covering Window shades

CASEWORK, EQUIPMENT & FURNITURE

Owner Provided Per workstation: Chair and desk, adjustable shelving, lockable file cabinet

Contractor Provided -

TECHNOLOGY

Power Outlets per code

Data / WIFI 1 4-port faceplate per work area Telephone -

AudioVisual 0

6B.01

COMPUTER LAB

DESCRIPTION

Purpose of Space Shared Computer Lab

Comments Computer lab available to students, not for use as a classroom.

Group / Assignment 06 LEARNING RESOURCE CENTER / B COMPUTER LAB

ARCHITECTURAL REQUIREMENTS

Area 1 at 960 SF = 960 SF

Occupants 40 Code Occupancy B

Room Access Students, Faculty, Staff Control Card Reader

Door / Entry Sidelite or Relite Closer Yes

Adjacencies 6A LRC

FINISHES

Flooring Durable, environmentally safe, resilient flooring

Ceiling Suspended acoustic tile or gypsum board with acoustic treatment Acoustics NRC 0.70 / CAC 35

Walls Painted gypsum board Acoustics STC 50

Lighting and Views Daylight required, operable windows. Shading or low-E glazing as required. 30 Window Covering Window shades

CASEWORK, EQUIPMENT & FURNITURE

Owner Provided Chairs and desks, teacher workstation, adjustable shelving, lockable file cabinet, printer station

Contractor Provided 2 marker/chalk boards, 4' x 12' with tack strips and map hooks.

TECHNOLOGY

Power Outlets per code: 1) Min. 4 double duplex per wall and above counters, 2) Outlets as required for AV connectivity

Data / WIFI 1 4-port faceplate per workstation Telephone Yes

AudioVisual See District "Smart Classroom" Standard

6B.02

COMPUTER LAB STORAGE

DESCRIPTION

Purpose of Space	Storage
Comments	Storage for Computer Lab supplies, including cables and accessories. Can one or more rooms.
Group / Assignment	06 LEARNING RESOURCE CENTER / B COMPUTER LAB

ARCHITECTURAL REQUIREMENTS

Area	200 SF		
Occupants	0	Code Occupancy	B
Room Access	Faculty, Staff	Control	Mechanical Lock
Door / Entry	-	Closer	No
Adjacencies	6A LRC		

FINISHES

Flooring	Resilient flooring or carpet tile		
Ceiling	Open to structure	Acoustics	0
Walls	Painted gypsum board	Acoustics	STC 40
Lighting and Views	5 -10 fc ambient light level.	Window Covering	-

CASEWORK, EQUIPMENT & FURNITURE

Owner Provided	-		
Contractor Provided	-		

TECHNOLOGY

Power	-		
Data / WIFI	-	Telephone	-
AudioVisual	-		

11A.01 ENTRANCE

DESCRIPTION

Purpose of Space	Entrance and Bike Parking
Comments	Main point of entry for the facility. Presents orientation and wayfinding through architectural elements and signage.
Group / Assignment	11 BUILDING SERVICES / A ENTRANCE

ARCHITECTURAL REQUIREMENTS

Area	1 at 500 SF = 500 SF		
Occupants	0	Code Occupancy	B
Room Access	Students, Faculty, Staff	Control	Central Access Control
Door / Entry	Glazed Entry	Closer	Automatic
Adjacencies	Ground Floor		

FINISHES

Flooring	Durable, environmentally safe, resilient flooring		
Ceiling	Gypsum Board	Acoustics	NRC 0.70 / CAC 35
Walls	Painted gypsum board	Acoustics	STC 40
Lighting and Views	Daylight desirable. 30-50 fc ambient light level	Window Covering	Window shades

CASEWORK, EQUIPMENT & FURNITURE

Owner Provided	Seating, information kiosk.		
Contractor Provided	-		

TECHNOLOGY

Power	Outlets per code		
Data / WIFI	4 4-port faceplates	Telephone	Yes
AudioVisual	-		

2B.02

WELCOME

DESCRIPTION

Purpose of Space	Welcome Desk
Comments	Part of the building entry, the Welcome Desk will be a staffed location providing assistance to visitors and building occupants.
Group / Assignment	11 BUILDING SERVICES / A ENTRANCE

ARCHITECTURAL REQUIREMENTS

Area	1 at 120 SF = 120 SF		
Occupants	1	Code Occupancy	B
Room Access	Students, Faculty, Staff	Control	Open
Door / Entry	Open	Closer	No
Adjacencies	11A.01 Entrance		

FINISHES

Flooring	Durable, environmentally safe, resilient flooring		
Ceiling	Gypsum Board	Acoustics	NRC 0.70 / CAC 35
Walls	Painted gypsum board	Acoustics	STC 40
Lighting and Views	Daylight desirable. 30-50 fc ambient light level	Window Covering	Window shades

CASEWORK, EQUIPMENT & FURNITURE

Owner Provided	-		
Contractor Provided	Main service desk with secondary position.		

TECHNOLOGY

Power	Outlets per code		
Data / WIFI	4 4-port faceplates	Telephone	Yes
AudioVisual	-		

2B.03

SECURITY OFFICE

DESCRIPTION

Purpose of Space Security Office

Comments Office for the building security staff.

Group / Assignment 11 BUILDING SERVICES / A ENTRANCE

ARCHITECTURAL REQUIREMENTS

Area 1 at 175 SF = 175 SF

Occupants 1 Code Occupancy B

Room Access Staff Control Mechanical Lock

Door / Entry Relite Closer No

Adjacencies 11A.01 Entrance

FINISHES

Flooring Durable, environmentally safe, resilient flooring

Ceiling Suspended acoustic tile or gypsum board with acoustic treatment Acoustics NRC 0.70 / CAC 35

Walls Painted gypsum board Acoustics STC 45

Lighting and Views Daylight desirable. 30-50 fc ambient light level Window Covering Window shades

CASEWORK, EQUIPMENT & FURNITURE

Owner Provided Chair, desk, guest chair, adjustable shelving, lockable file cabinet

Contractor Provided -

TECHNOLOGY

Power Outlets per code

Data / WIFI 1 4-port faceplate Telephone -

AudioVisual -

2B.04 OFFICE

DESCRIPTION

Purpose of Space	Office
Comments	Office for building supervisor and welcome desk staff.
Group / Assignment	11 BUILDING SERVICES / A ENTRANCE

ARCHITECTURAL REQUIREMENTS

Area	1 at 150 SF = 150 SF		
Occupants	1	Code Occupancy	B
Room Access	Staff	Control	Mechanical Lock
Door / Entry	Relite	Closer	No
Adjacencies	11A.01 Entrance		

FINISHES

Flooring	Durable, environmentally safe, resilient flooring		
Ceiling	Suspended acoustic tile or gypsum board with acoustic treatment	Acoustics	NRC 0.70 / CAC 35
Walls	Painted gypsum board	Acoustics	STC 45
Lighting and Views	Daylight desirable. 30-50 fc ambient light level	Window Covering	Window shades

CASEWORK, EQUIPMENT & FURNITURE

Owner Provided	Chair, desk, guest chair, adjustable shelving, lockable file cabinet		
Contractor Provided	-		

TECHNOLOGY

Power	Outlets per code		
Data / WIFI	1 4-port faceplate	Telephone	-
AudioVisual	-		

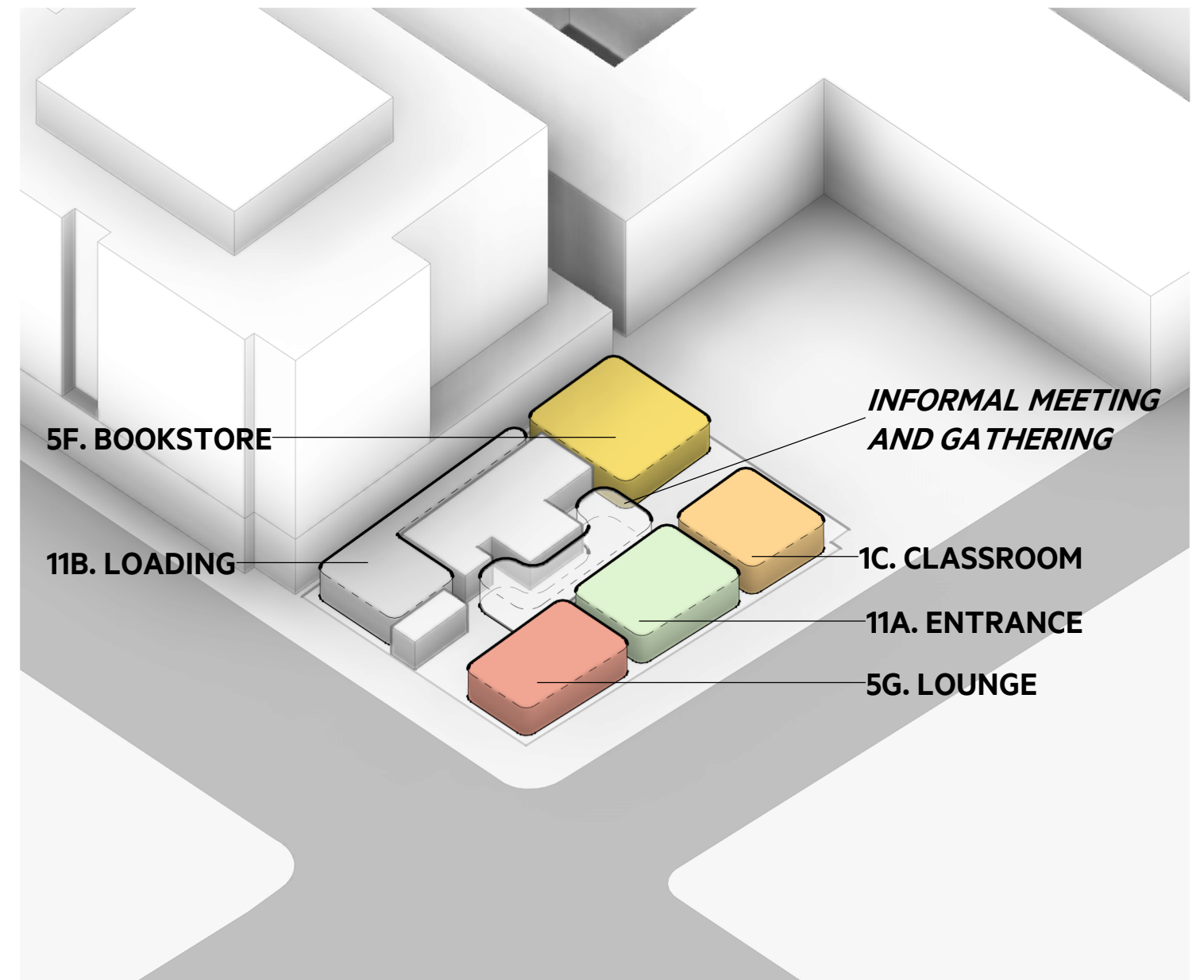
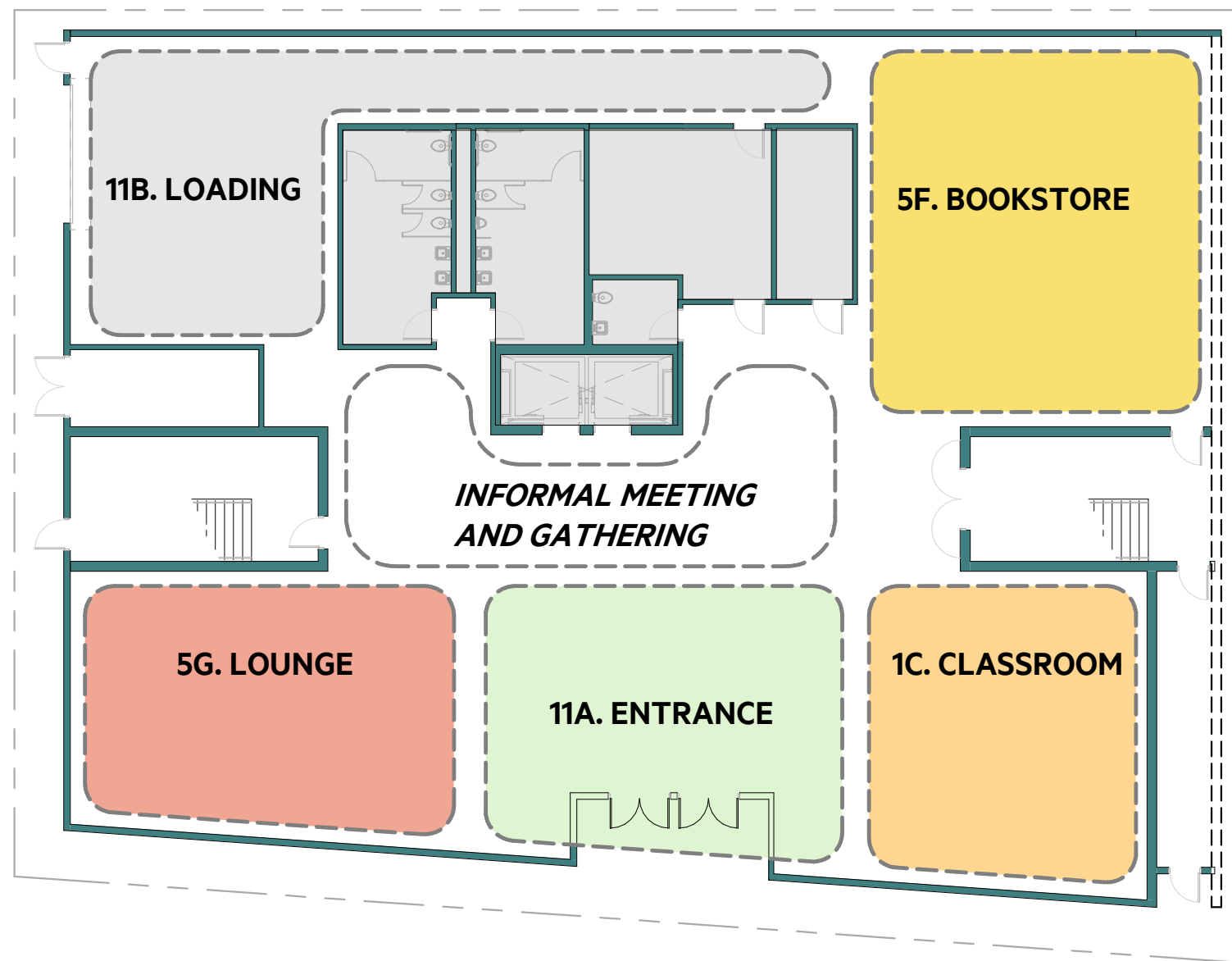

PLAN

3D VIEW

D01

LEVEL 01

10/09/2020

2118 MILVIA ST
BERKELEY CITY COLLEGE

NOLL & TAM
ARCHITECTS

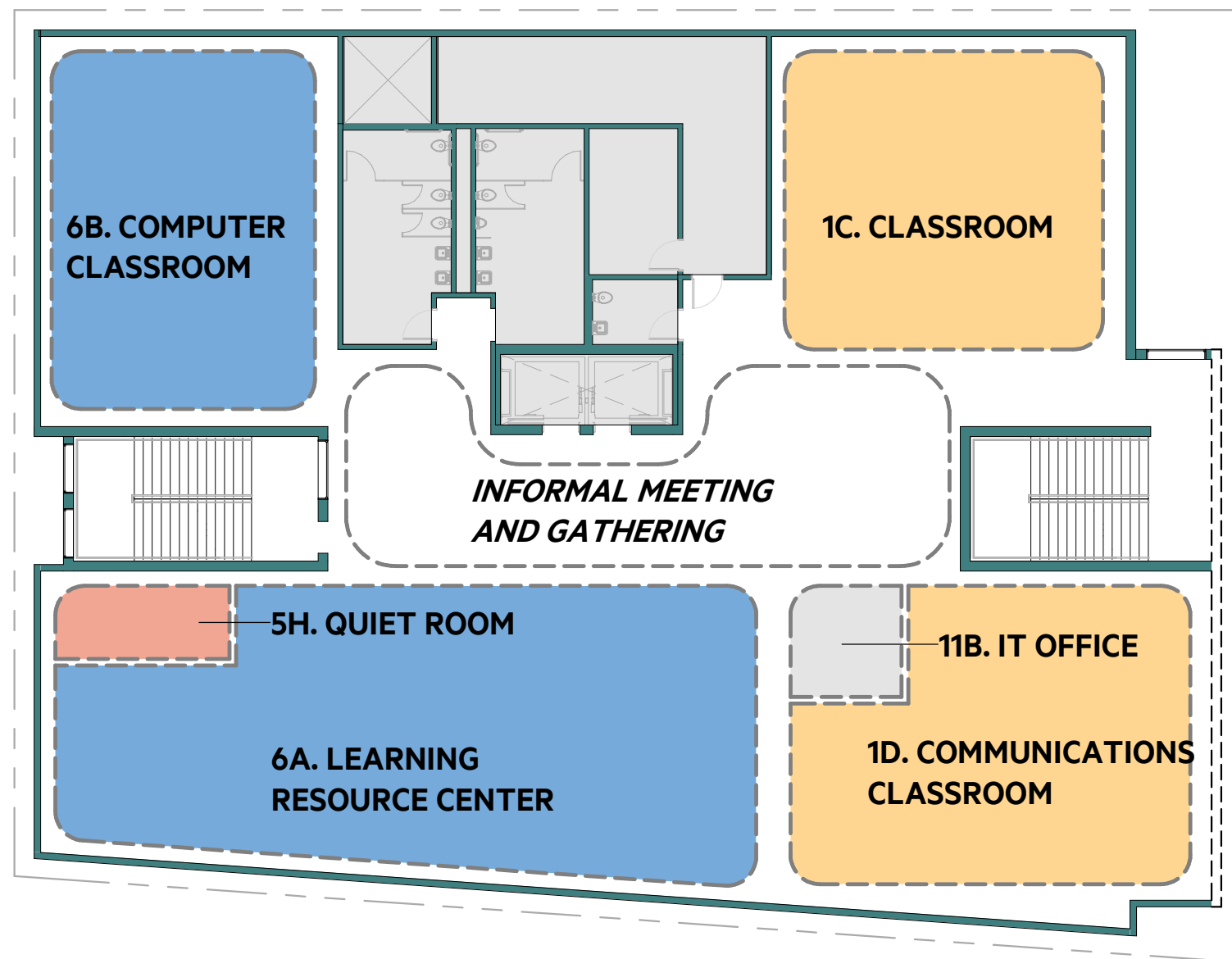

PLAN

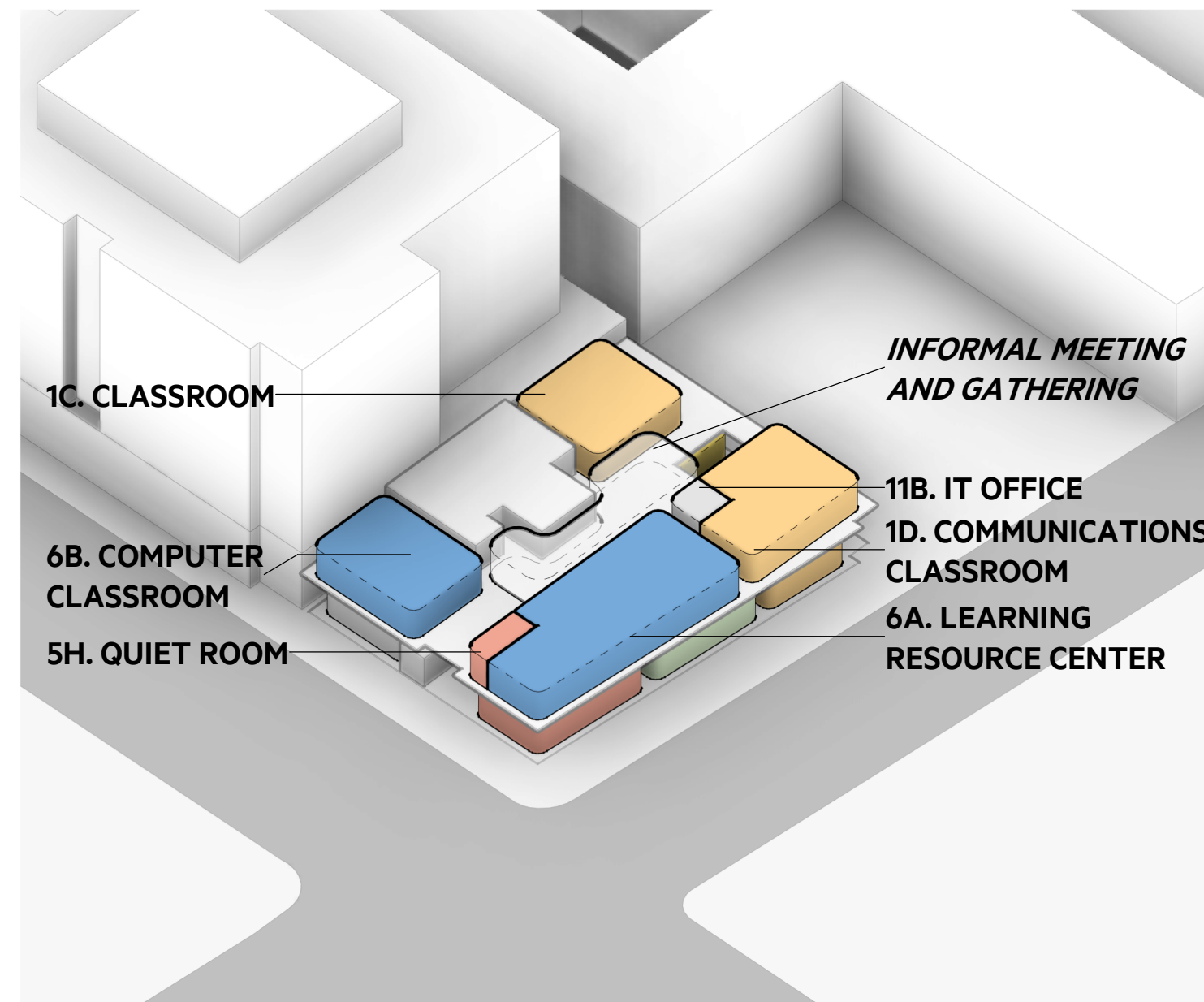

3D VIEW

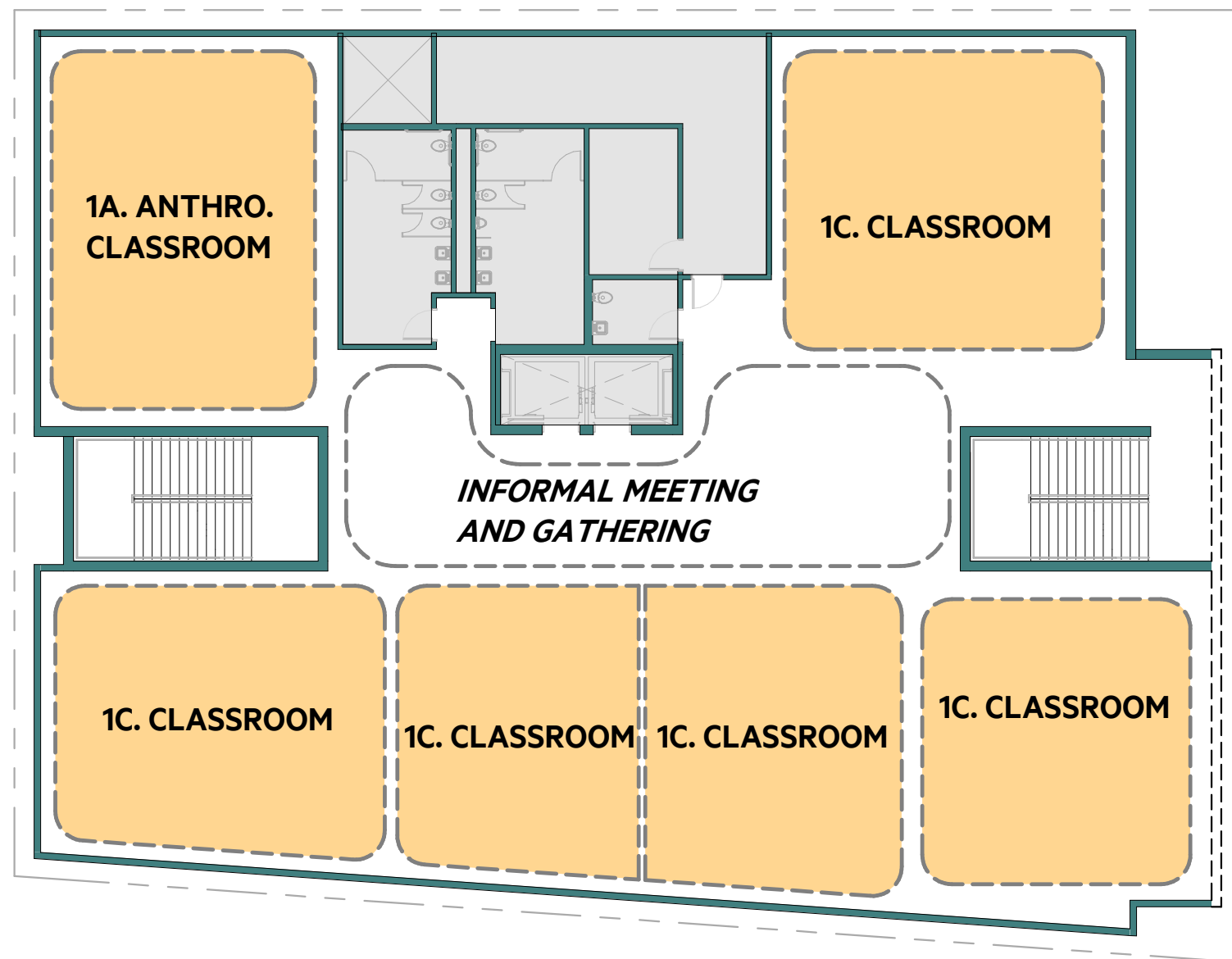

PLAN

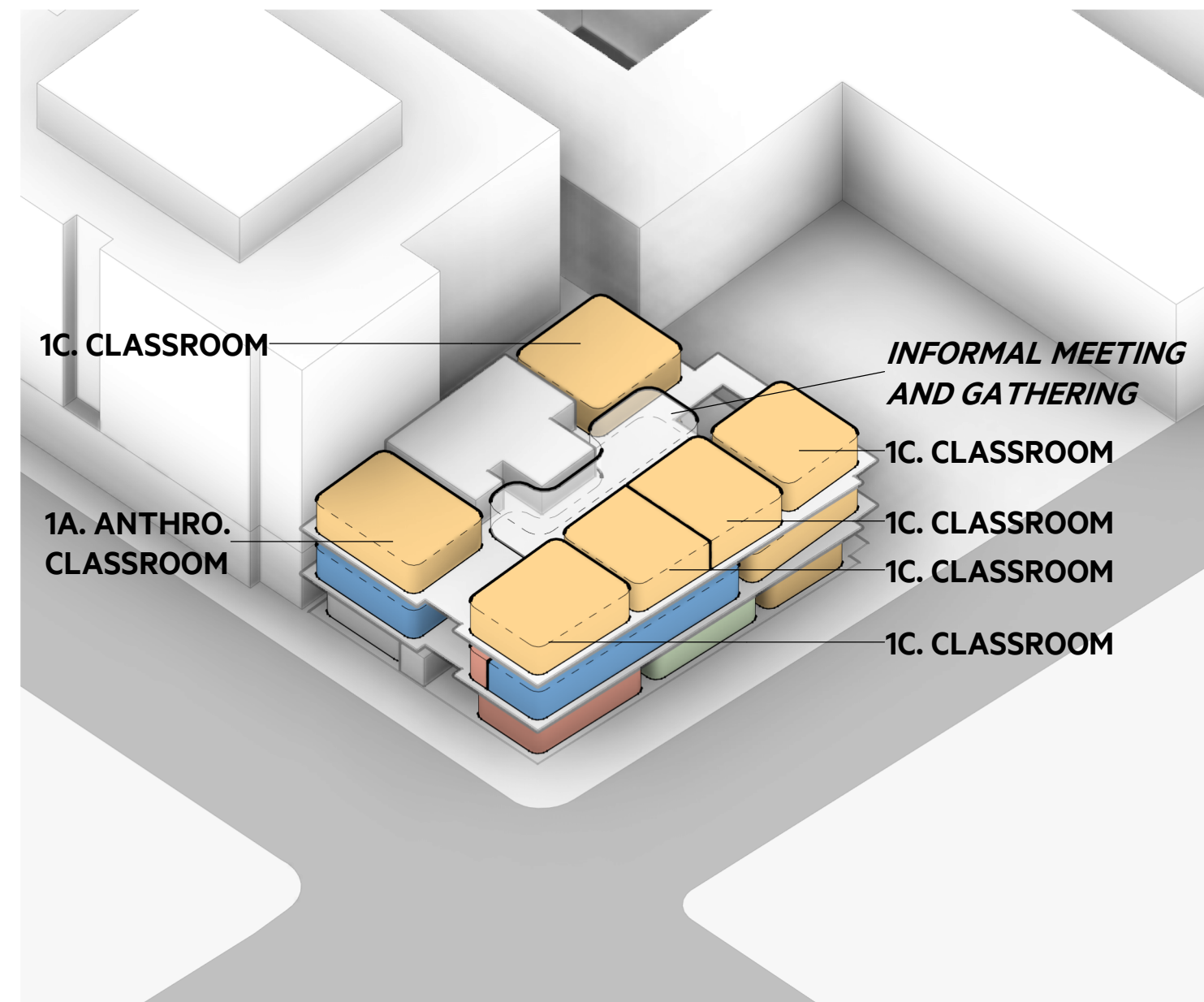

3D VIEW

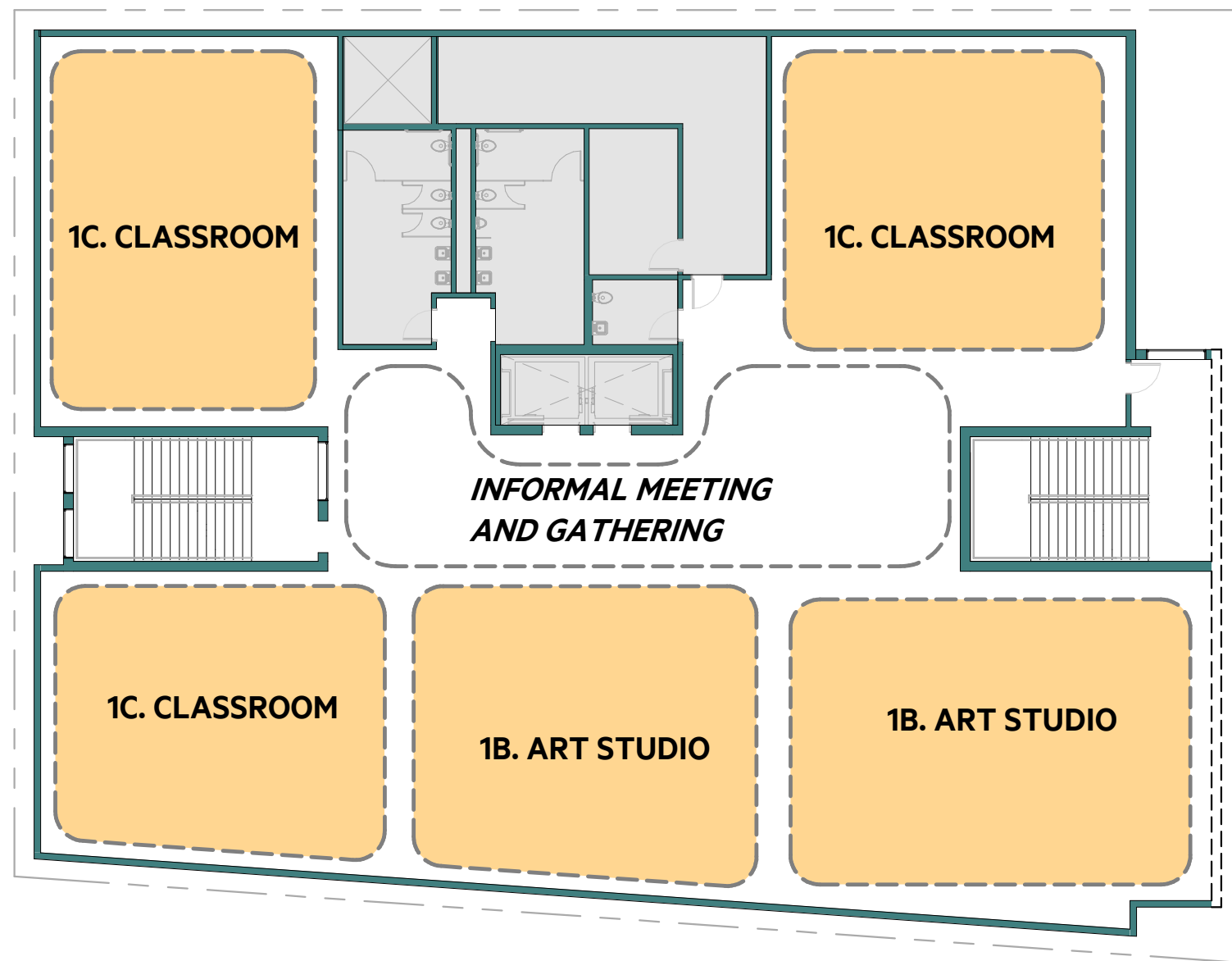

PLAN

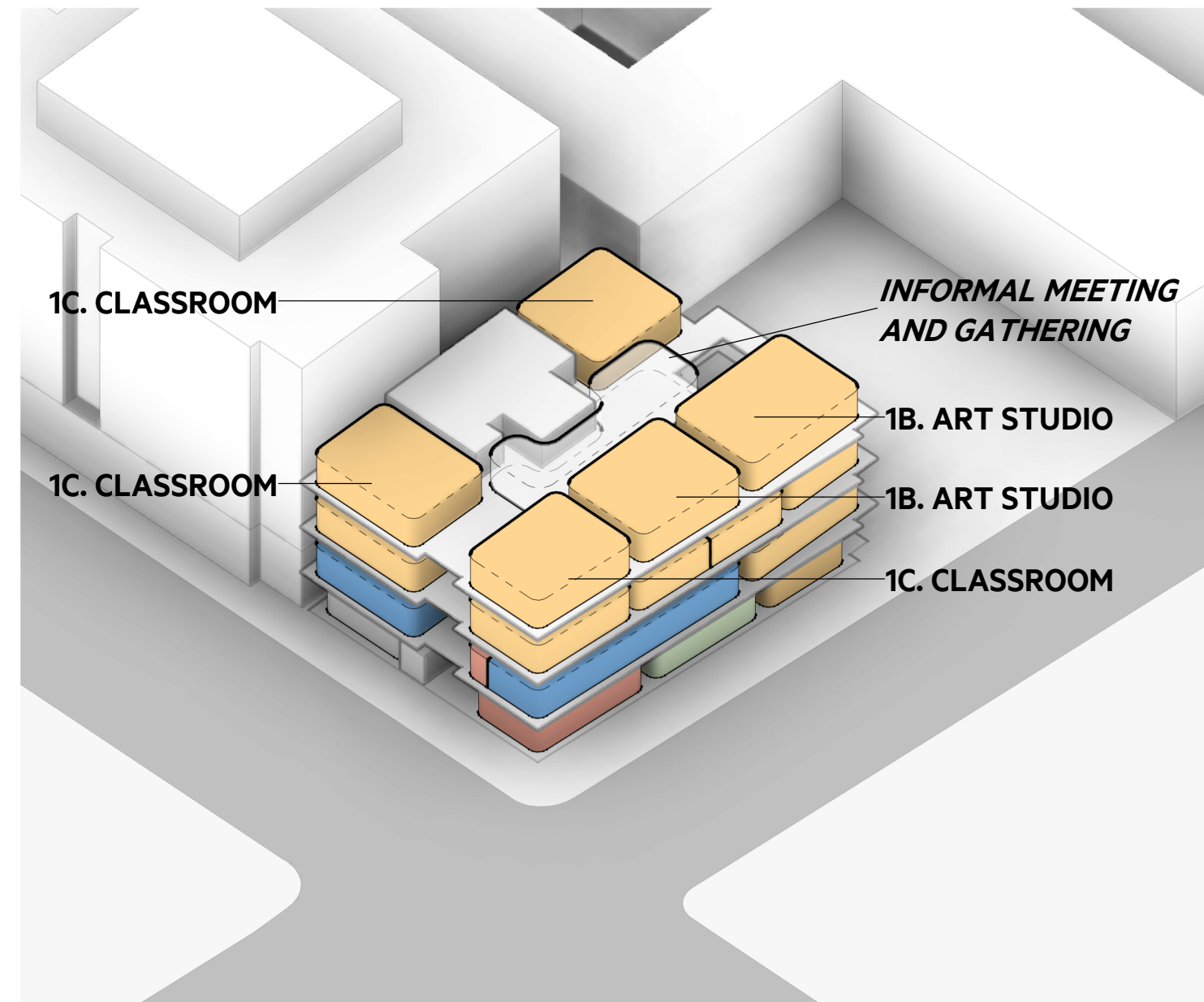

3D VIEW

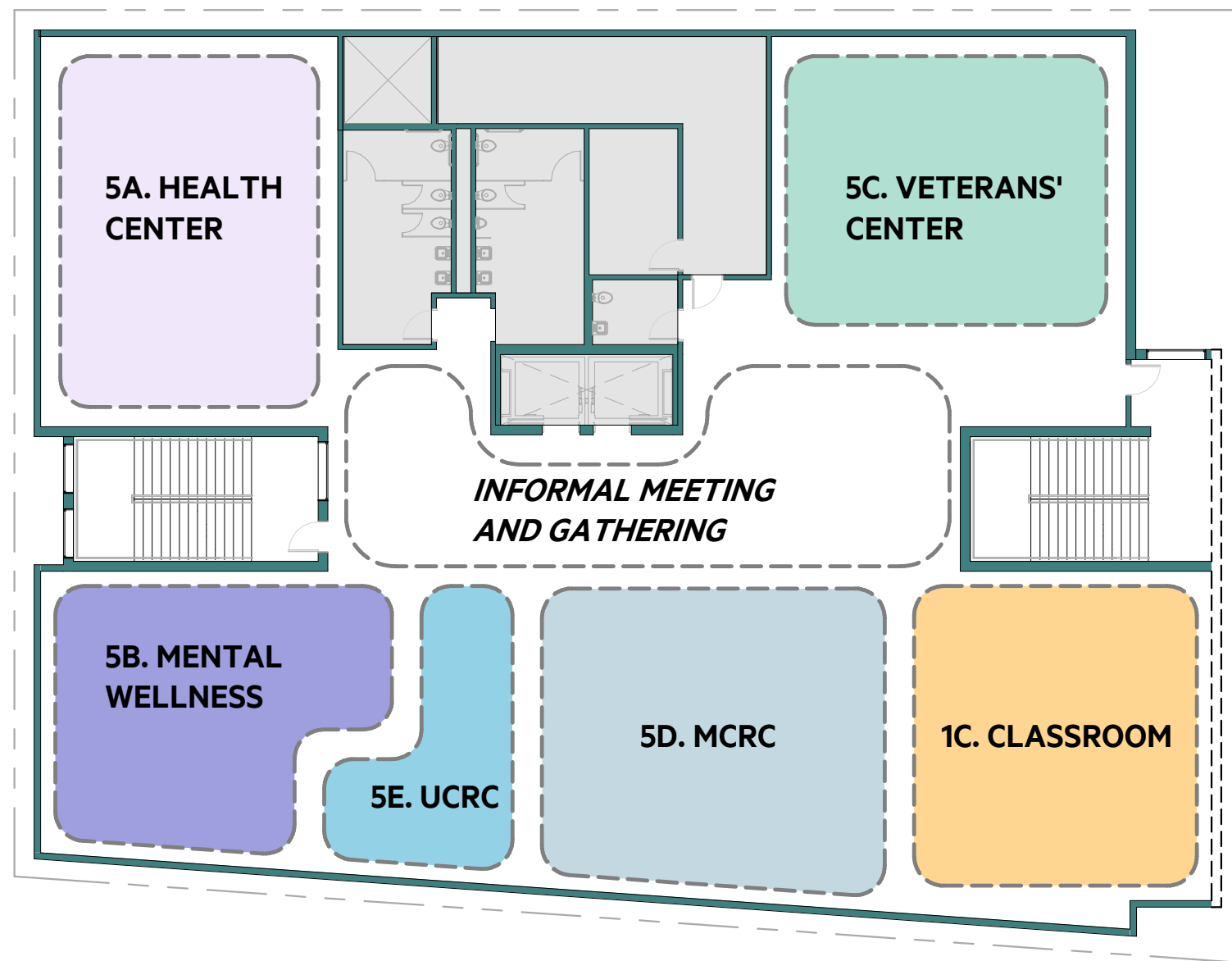

PLAN

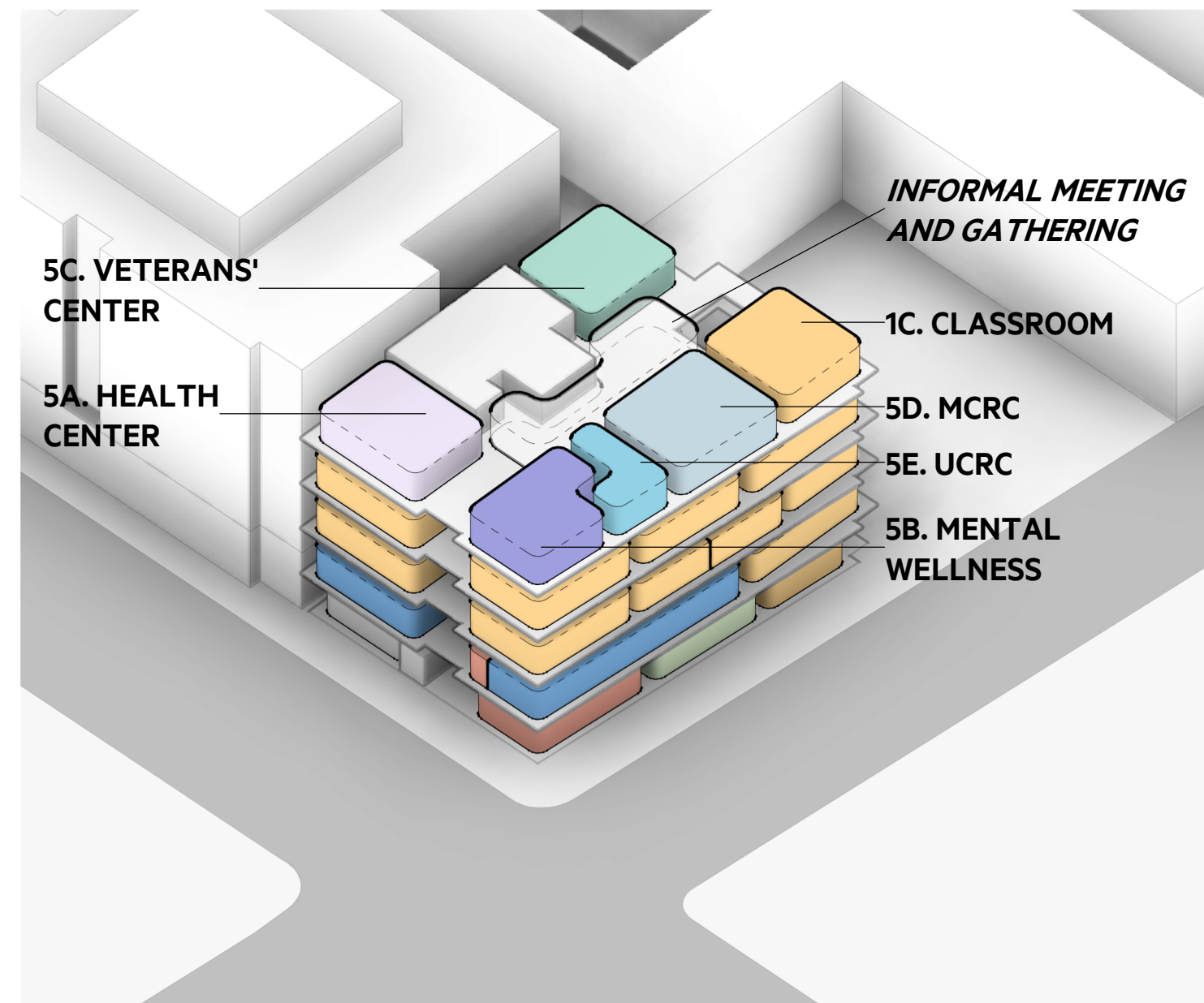

3D VIEW

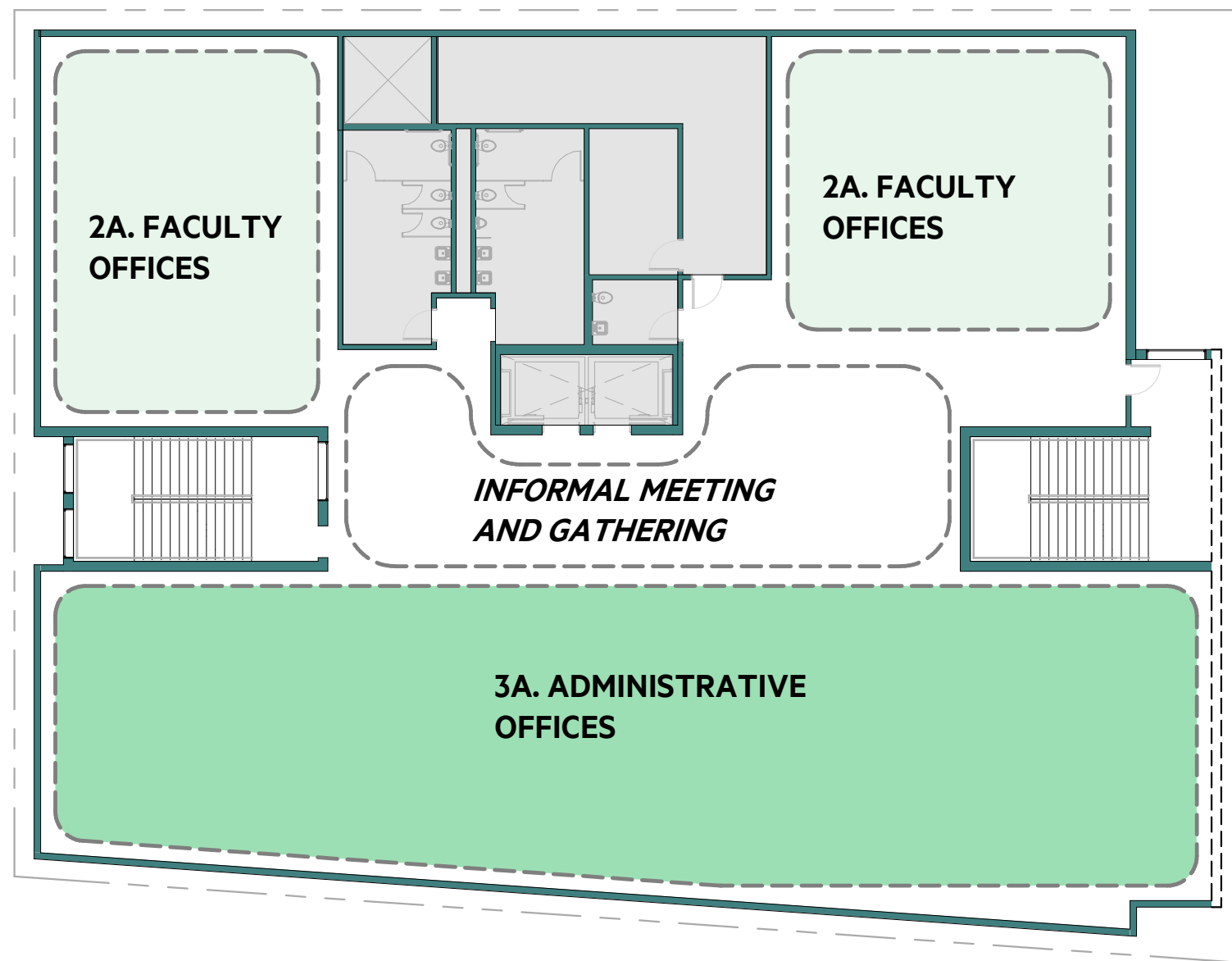

PLAN

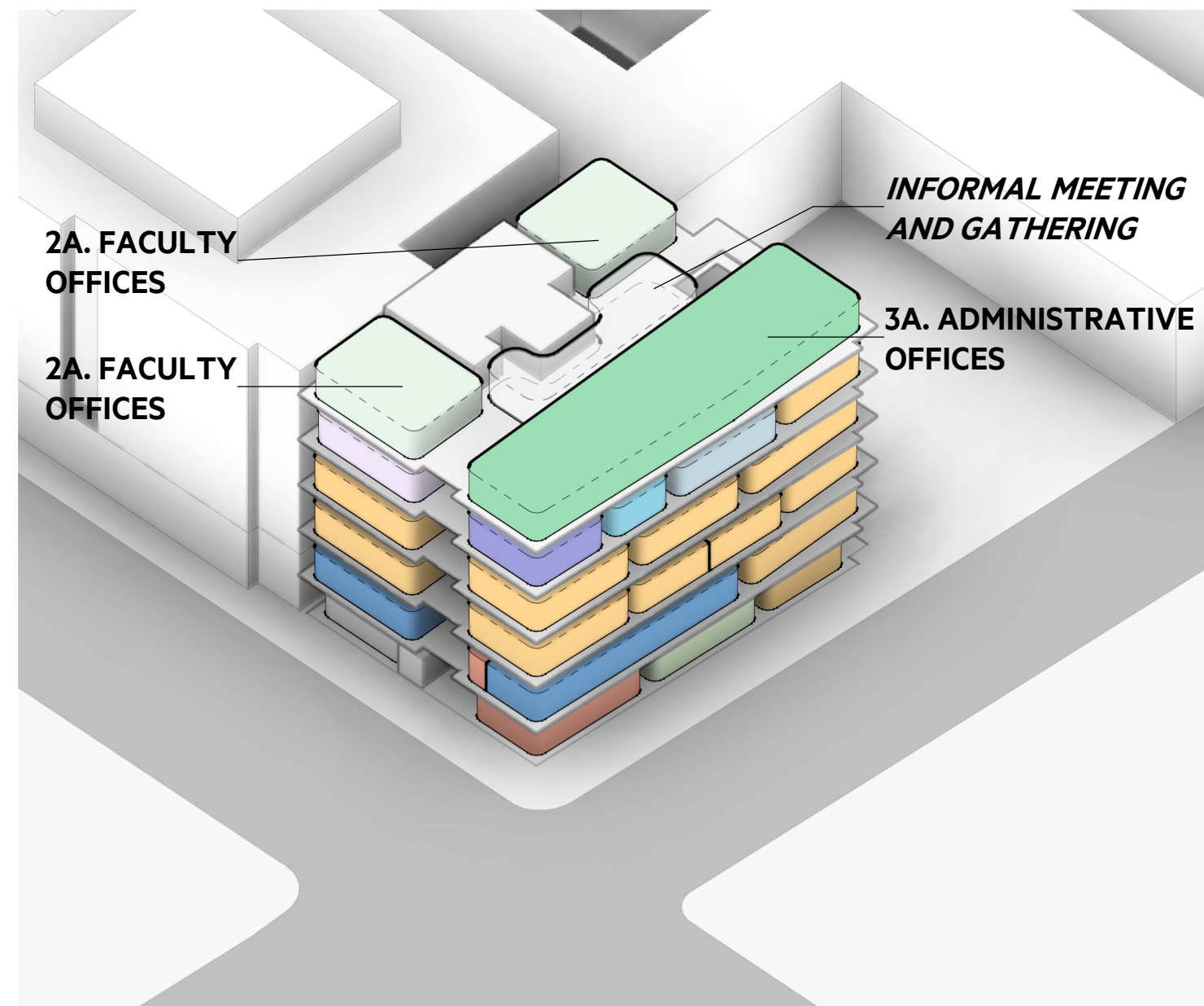

3D VIEW

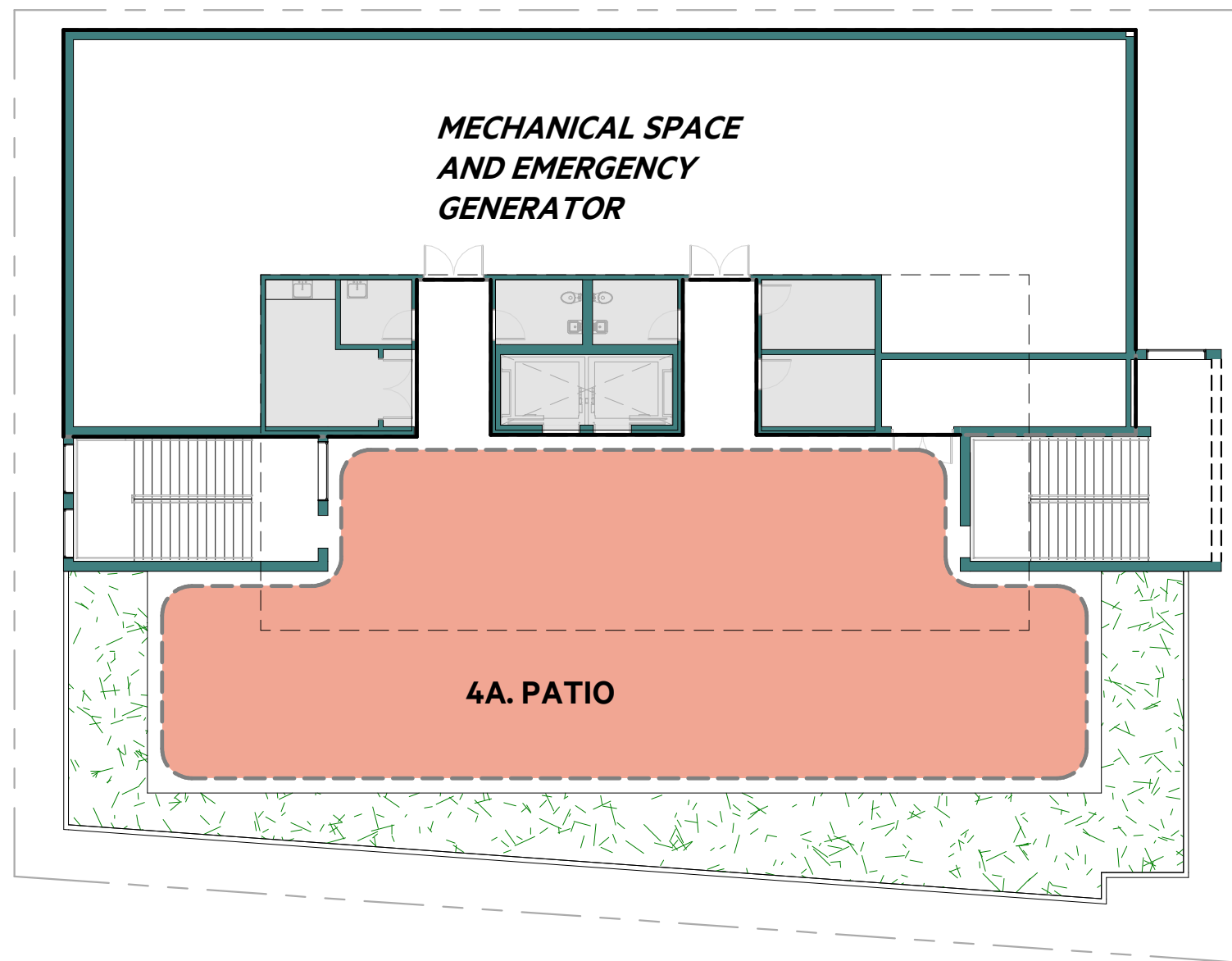

PLAN

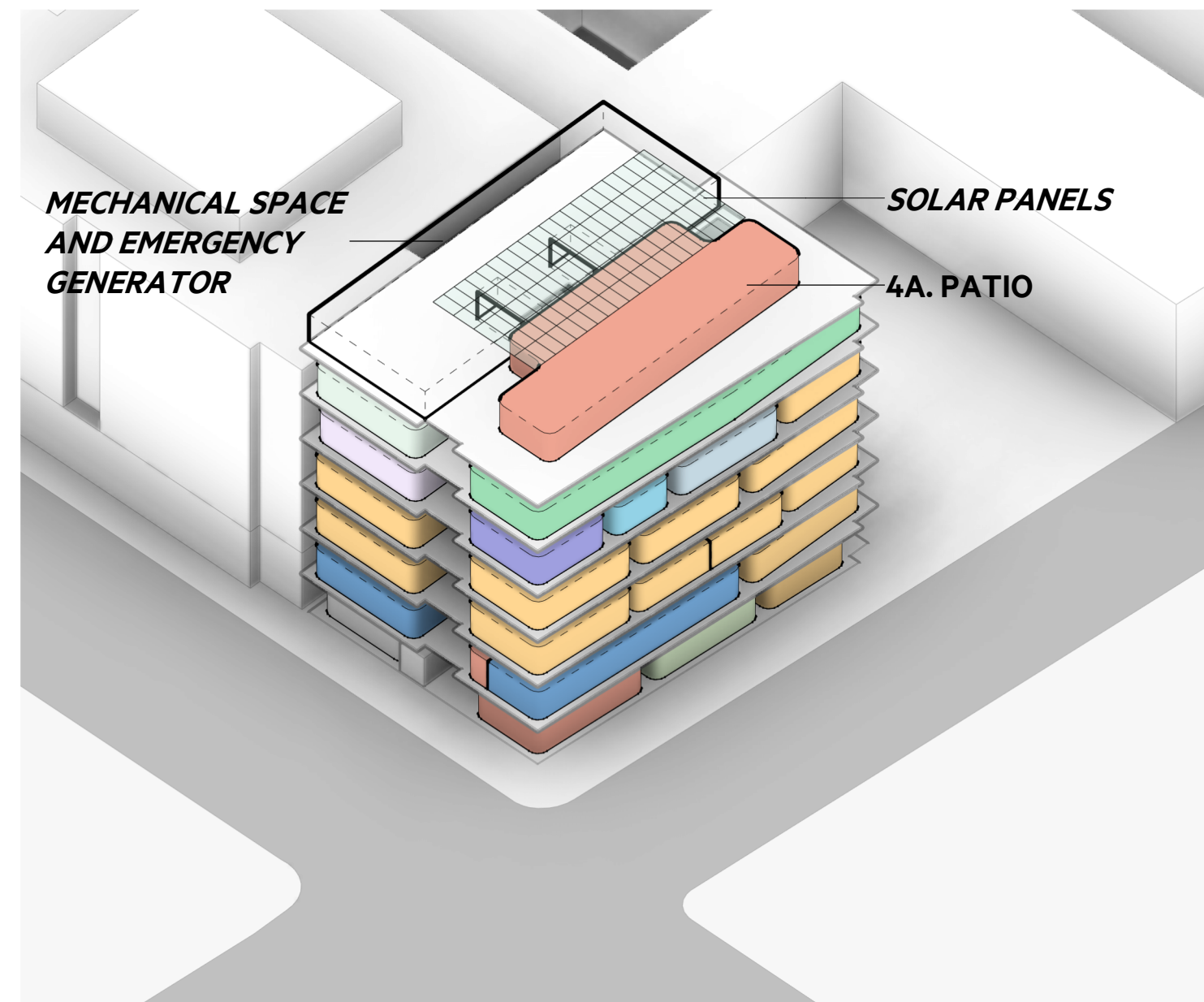

3D VIEW