

NOTES:
1) REFER TO WARD EDWARDS CIVIL ENGINEERING PLANS FOR STREET, PARKING, WALKWAYS, STORMWATER, GRADING AND UTILITY IMPROVEMENTS.
2) REFER TO PEARCE SCOTT ARCHITECTS FOR FUTURE PUBLIC RESTROOM AND ASSOCIATED ASSEMBLIES.

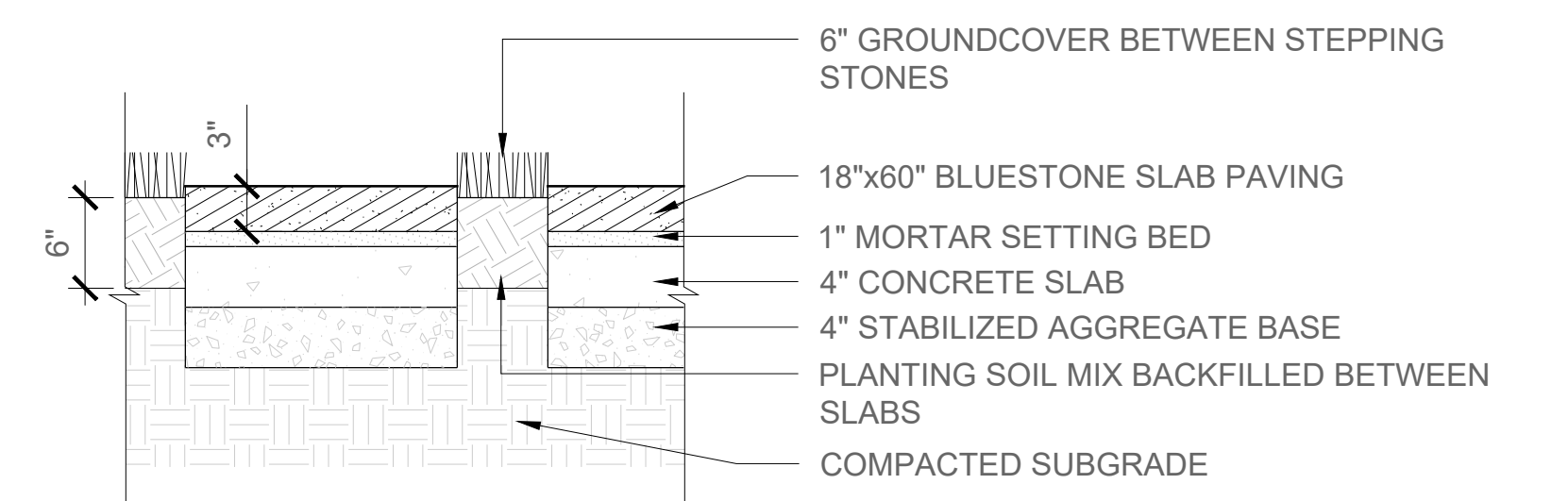

4 BLUESTONE THRESHOLD TYPICAL SECTION



NOTES:
1. SEE LAYOUT PLANS FOR JOINT TYPE LOCATIONS AND LAYOUT.
2. ISOLATION JOINT MAX 24' ON CENTER.
3. REFER TO CIVIL DRAWINGS.

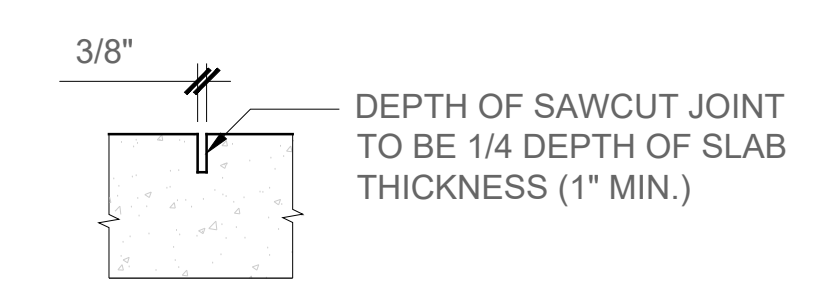

SAWCUT CONTROL JOINT

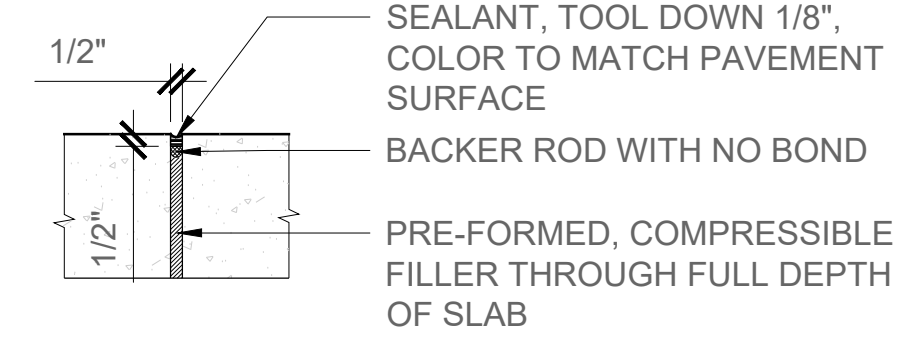

ISOLATION JOINT

3 ISOLATION AND CONTROL JOINTS TYPICAL SECTION



NOTES:
1. 2" WELDED WIRE MESH REINFORCEMENT TO BE INCLUDED IN PAVING WITHIN ROOT ZONES. REFER TO LAYOUT PLAN FOR LOCATIONS.
2. STABILIZED AGGREGATE BASE TO BE INCLUDED UNDER WALKS ADJACENT TO VEHICULAR PAVING. REFER TO LAYOUT PLAN FOR LOCATIONS.
3. REFER TO CIVIL DRAWINGS.

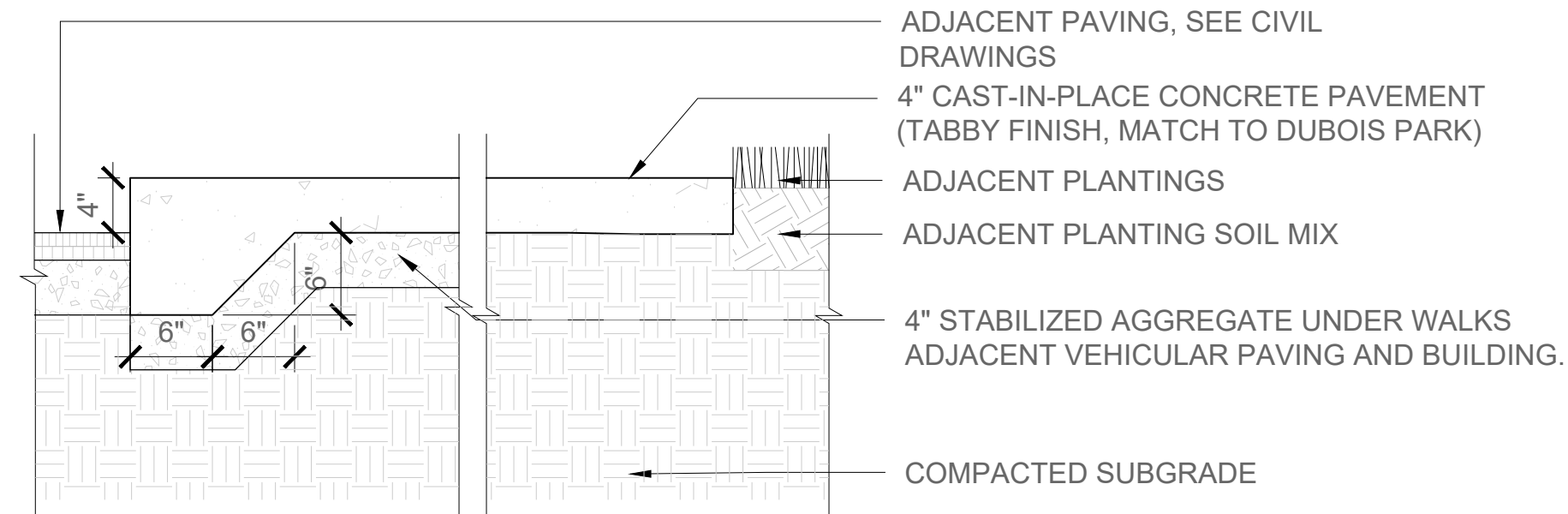

2 PCC-1: CONCRETE SIDEWALK TYPICAL SECTION

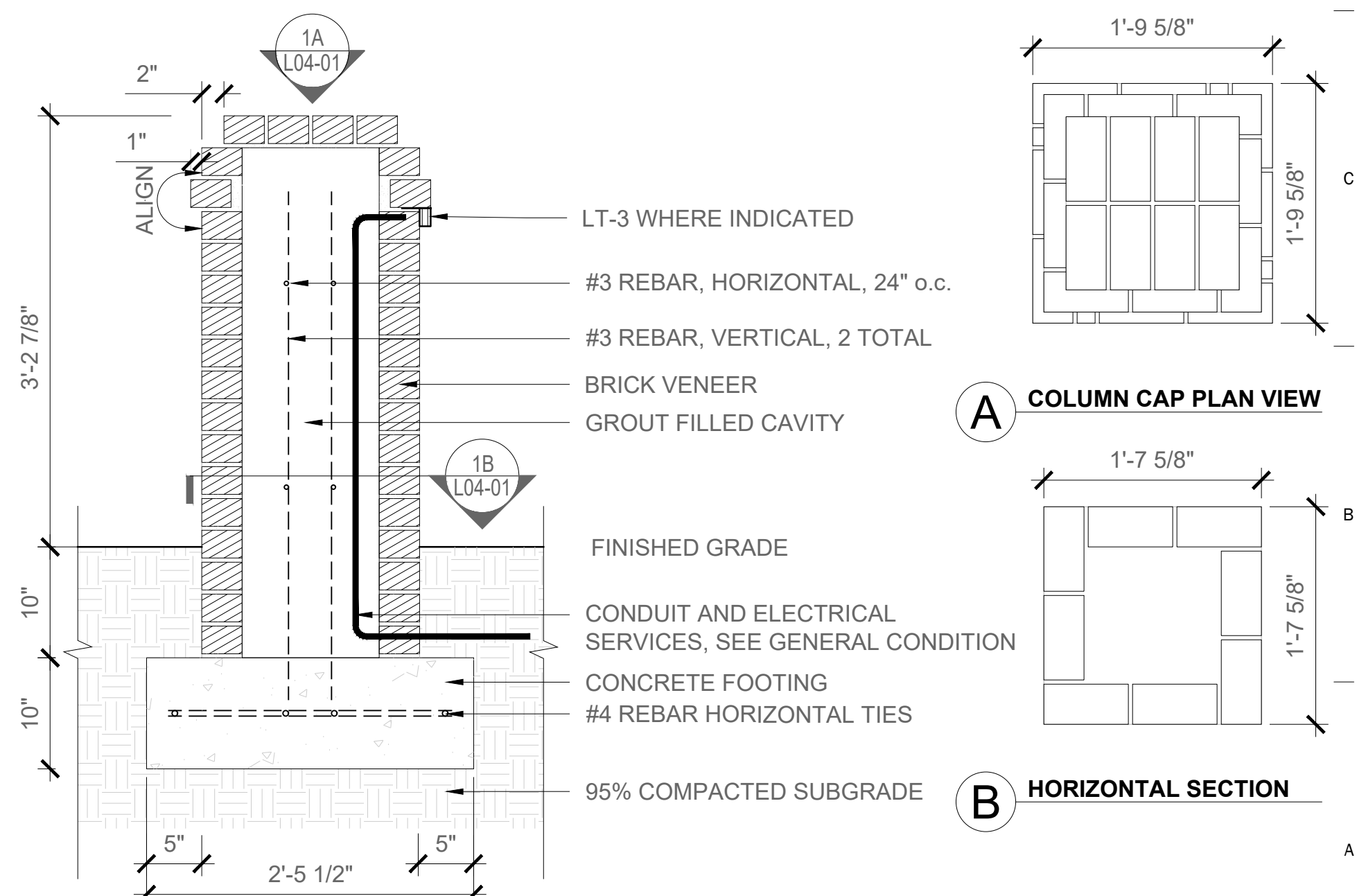

1 BRICK COLUMN TYPICAL SECTION



NOTES:
1. RAIL FENCE TO MATCH DUBOIS PARK.

6 RESTROOM ENLARGEMENT

5 RAIL FENCE

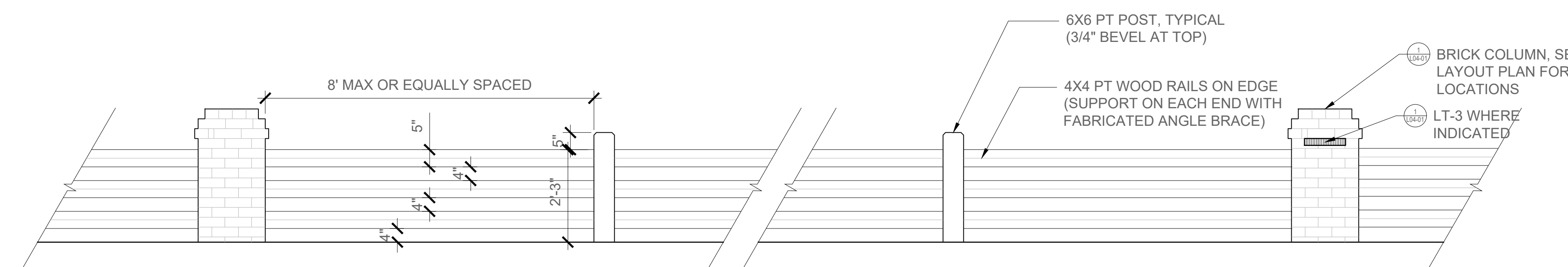

TYPICAL SECTION



PERMIT & BID SET
NOT FOR CONSTRUCTION

REV.	DATE	ISSUED
A	190111	REVISIONS
B	190116	REVISIONS
C	190308	REVISIONS

SEAL

ISSUE DATE
03.8.2019

PROJECT NUMBER
s17538

SHEET NAME
DETAILS - HARDSCAPE

SHEET NUMBER
L04-01

S:\Projects\2017\17538-02-Bluffton 68 Boundary Street Documentation\CAD\Curren\Sheets\17538-L04-Details.dwg, Mar. 12, 2019 - 2:34pm-bmansengill