



# Chris Jones - Escambia County Property Appraiser

Reference: 102S301000020003  

Account: [053033000](#)

Section Map: [46-1S-30-2](#)

Situs: 4417 FLORELLE WAY  
 Complex: MONTCLAIR UNIT #1 PB 4 P 63 UNIT #2 PB 4 P 100 ...  
 Owner: SIMS DEBRA DENISE  
 Mailing Address:  
 4417 FLORELLE AVE  
 PENSACOLA, FL 32505  
 Last Sale: 6/2000, \$100  
 Property Use: SINGLE FAMILY RESID  
 Approx. Acreage: 0.2081 ac  
 Bldg. Count: 1  
 Total Heated Area: 1,461 sf  
 Zoned: MDR  
 Taxing Auth: COUNTY MSTU  
 Schools:  
 Elem: MONTCLAIR  
 Int: BELLVIEW  
 High: PENSACOLA

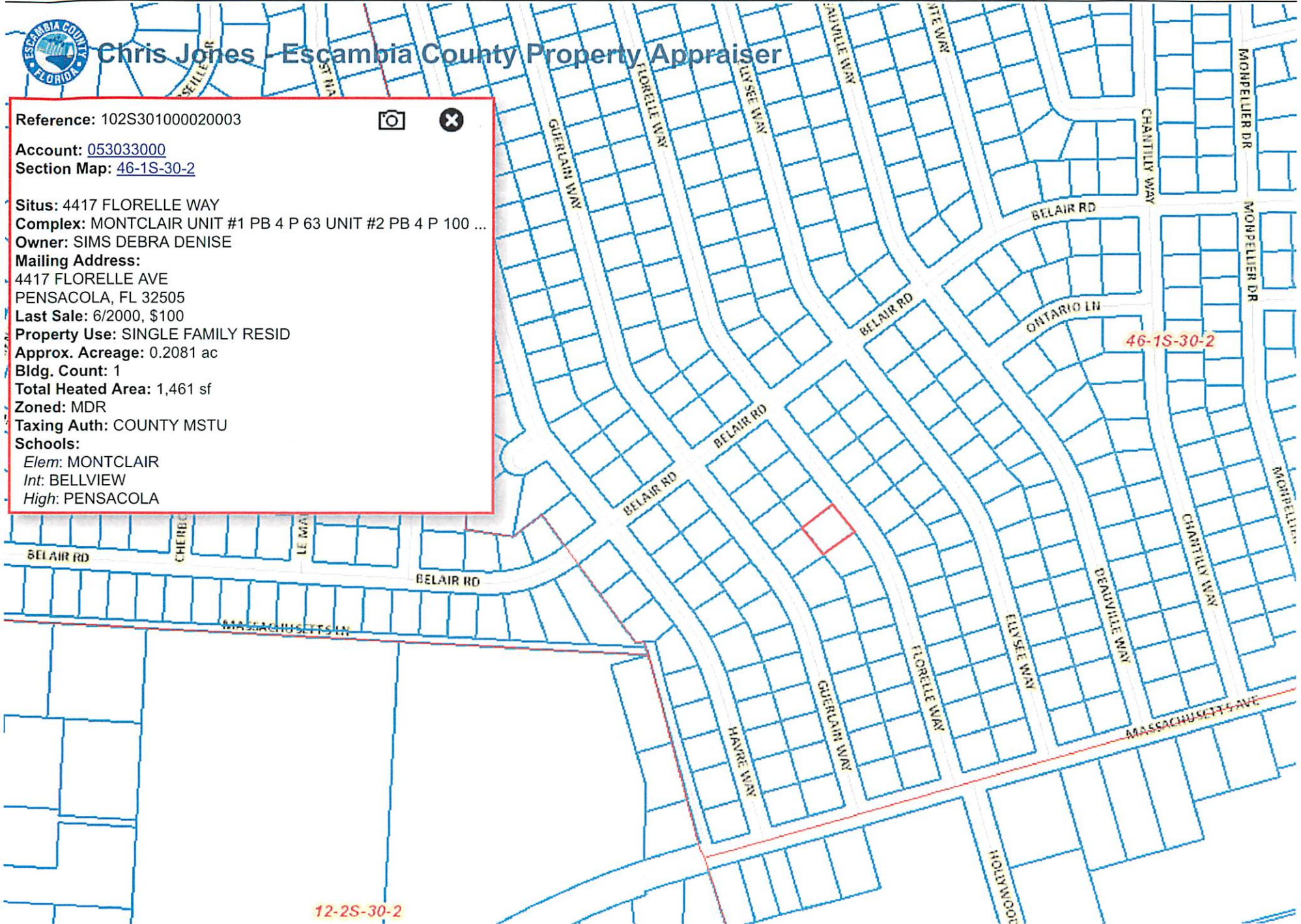

12-2S-30-2

100m  
400ft