

SHEET NO.	DESCRIPTION	SHEET SUBTOTALS
1	TITLE SHEET	1
2	SUMMARY OF ESTIMATED QUANTITIES	1
3	GENERAL CONSTRUCTION NOTE	1
4	REFERENCE ALIGNMENT DATA	1
5	EXISTING DEMOLITION, EROSION CONTROL PLANS	1
6A-B	PAVING SIDEWALK AND DRAINAGE PLAN	2
7	STRIPING LAYOUT PLAN	1
8	TRAFFIC SIGNAL PLAN	1
9	LANDSCAPE AND LIGHTING PLAN	1
10	DETAILS	1
TOTAL SHEETS		11

INTERSECTION IMPROVEMENTS & STREETSCAPE PLANS FOR

TOWN OF VARNVILLE
HAMPTON COUNTY, SOUTH CAROLINA
US 278 AT SC 63 & S-50

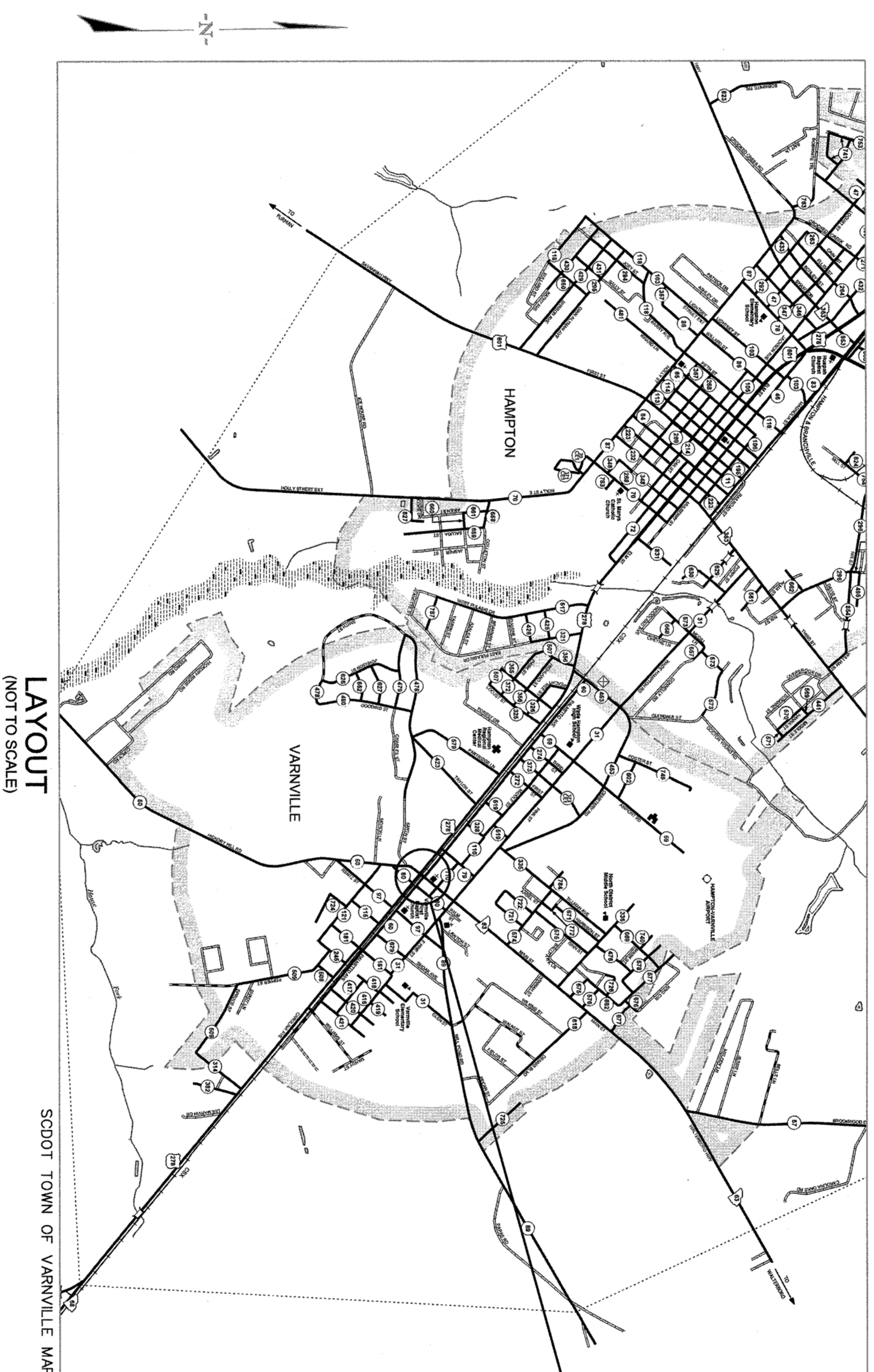
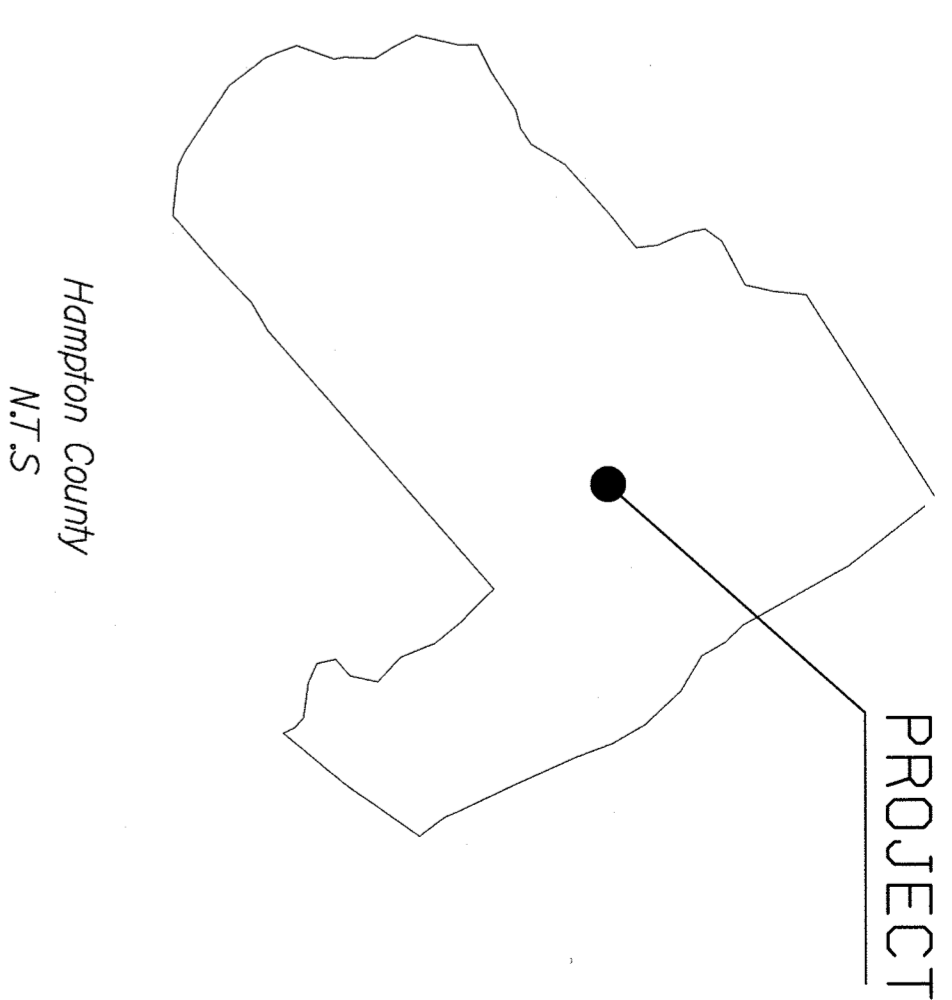

Approximate Location of Roadway is
Latitude 32° 57' 00.8" N
Longitude 81° 04' 49.2" W

Except as may otherwise be specified on the plans or in the special provisions, all materials and workmanship within the South Carolina Department of Transportation right-of-way shall conform to the SCDOT Standard Specifications for Highway Construction (Latest Edition) the Latest Traffic Signal Special Provisions and Specifications for Traffic Signal Installation, and SCDOT Standard Drawings for Road Construction in effect at the time of letting.

RAILROAD INVOLVEMENT?
(YES) NO

3 DAYS BEFORE DIGGING IN
SOUTH CAROLINA
CALL 811
SOUTH CAROLINA 811 (SC811)
WWW.SC811.COM
ALL UTILITIES MAY NOT BE A MEMBER OF SC811

PERMIT INFORMATION
SWPPP YES NO
SCDOT ENCROACHMENT PERMIT YES NO

For Right Of Way Acquisition:

Consultant Engineer of Record _____ Date _____

Preconstruction Engineer _____ Date _____

For Construction:

Engineer of Record _____ Date _____

ENGINEER	REV	DATE	DESCRIPTION
M Hines		8/11/2016	
J. Newcomb		8/11/2016	
M Hines		8/11/2016	



**VARNVILLE
STREETSCAPE**
DENNIS
CORPORATION
1800 Huger Street Columbia S.C. 29201
Ph: 803-252-0991 Fax: 803-733-6767

TITLE SHEET

JANUARY 2018 HAMPTON COUNTY SOUTH CAROLINA

Scale
NTS
Sheet
01

GENERAL NOTES:

- EXCEPT AS MAY OTHERWISE BE SPECIFIED ON THE PLANS OR IN THE SPECIAL PROVISIONS, ALL MATERIALS AND WORKMANSHIP WITHIN THE SOUTH CAROLINA DEPARTMENT OF TRANSPORTATION'S STANDARD SPECIFICATIONS (LATEST EDITION), THE LATEST TRAFFIC SIGNAL SPECIAL PROVISIONS AND SPECIFICATIONS FOR TRAFFIC SIGNAL INSTALLATION, AND SCODOT STANDARD DRAWING FOR ROAD CONSTRUCTION IN EFFECT AT THE TIME OF LETTING.
- COORDINATE WITH THE TOWN OF VARNVILLE FOR STORAGE OF MATERIALS AND SITE ACCESS ISSUES AS NECESSARY.
- CONTRACTOR SHALL PROTECT THE PUBLIC FROM HAZARDS ASSOCIATED WITH CONSTRUCTION.
- ACCESS TO ALL BUSINESSES AND GOVERNMENT BUILDINGS SHALL BE MAINTAINED AT ALL TIMES.
- CONTRACTOR SHALL PROVIDE THE NECESSARY BARRIERS AND SIGNS SO AS TO PROVIDE THE REQUIRED CLEARANCE FOR TRAFFIC TO PASS BY THE WORK AREA. BARRIERS AND SIGNS AT NO ADDITIONAL COST TO THE OWNER. PROPERTY LINES SHOWN HEREIN APPROXIMATED FROM GIS DATA.
- THE CONTRACTOR SHALL VERIFY THE ELEVATIONS OF PIPE FLOW LINES AND SIDE ROAD TIE-INS. THE CONTRACTOR SHALL NOTIFY THE ENGINEER OF ANY APPARENT DISCREPANCIES OR CONFLICTS IN THE CONSTRUCTION PLANS PRIOR TO COMMENCING CONSTRUCTION.
- CONTRACTOR SHALL COORDINATE UTILITY LOCATION WITH UTILITY PROVIDER DURING CONSTRUCTION.
- CONTRACTOR SHALL COORDINATE AND PERFORM ADJUSTMENT OF UTILITY BOXES AND MANHOLES TO MATCH FINISHED GRADE AT NO ADDITIONAL COSTS TO THE OWNER. RELOCATION AND/OR ADJUSTMENT OF OTHER UTILITIES ARE TO BE COMPLETED BY THE PROJECT OR CHANGES IN ALIGNMENT MUST BE SPECIFICALLY AUTHORIZED BY THE OWNER AND ENGINEER. THERE WILL BE NO SUBSTITUTIONS, ADDITIONS OR DELETIONS WITHOUT THE APPROVAL OF THE OWNER AND ENGINEER.
- PIPE LENGTHS THAT ARE SHOWN ON THE PLANS ARE HORIZONTAL DISTANCES. FIELD ADJUSTMENT OF THE ACTUAL PIPE LENGTHS MAY BE NECESSARY.
- THE CONTRACTOR SHALL STAGE HIS CLEARING AND GRUBBING WORK ALONG WITH HIS CONSTRUCTION WORK TO MINIMIZE THE AMOUNT OF EROSION AND SEDIMENTATION.
- THE CONTRACTOR IS RESPONSIBLE FOR ALL CONSTRUCTION SIGNING AND MAINTENANCE OF EXISTING PERMANENT SIGNS DURING CONSTRUCTION.
- ALL CURBS AND SIDEWALKS ON THESE ROADS BEING USED IN THE HAULING PROCESS.
- THE LOCATION OF THE UTILITIES IN THE PLANS IS BASED ON LIMITED INVESTIGATION TECHNIQUES AND INFORMATION PROVIDED BY OTHERS. THE LOCATIONS OF THE SHOWN UTILITIES SHOULD BE CONSIDERED APPROXIMATE. THE ELEVATIONS APPLY ONLY AT THE POINTS SHOWN. THERE MAY OR MAY NOT BE OTHER UTILITIES WITHIN THE LIMITS OF THE PROJECT. THE CONTRACTOR SHALL TAKE ALL APPROPRIATE STEPS TO SATISFY THEMSELVES AS TO THE NUMBER, TYPE, OWNER, AND LOCATION (BOTH HORIZONTAL AND VERTICAL) OF ALL ABOVE AND BELOW GRADE UTILITIES WITHIN THE LIMITS OF THE PROJECT.
- ALL CURVE RADIUSES SHOWN TO THE EDGE OF PAVEMENT UNLESS OTHERWISE DESCRIBED.
- ALL DRAINAGE STRUCTURES AND PIPE ARE TO BE IN ACCORDANCE WITH THE SC DEPARTMENT OF TRANSPORTATION'S STANDARD SPECIFICATIONS FOR HIGHWAY CONSTRUCTION, LATEST EDITION UNLESS OTHERWISE NOTED.
- COORDINATE REMOVAL AND REPLACEMENT OF ANY FENCE WITH THE OWNER OR DESIGNATED REPRESENTATIVE.
- CONTRACTOR TO PREPARE A TRAFFIC CONTROL PLAN AND WORKPLACE SAFETY PLAN WHICH ARE TO BE SUBMITTED TO THE ENGINEER FOR APPROVAL PRIOR TO BEGINNING CONSTRUCTION. THE WORKPLACE SAFETY PLANS TO BE IN ACCORDANCE WITH THE STANDARDS AND REQUIREMENTS AS MAY BE DIRECTED BY THE OWNER OR DESIGNATED REPRESENTATIVE. THE TRAFFIC CONTROL PLAN SHALL COMPLY WITH THE MANUAL FOR URBAN TRAFFIC CONTROL DEVICES, LATEST EDITION.
- FOR PROTECTION OF THE STREETS OF VARNVILLE, THE CONTRACTOR IS RESPONSIBLE FOR OBTAINING THE CONSTRUCTION PERMITS AND TO LOCATING THE LIMITS OF CLEARING AND GRUBBING AND ERECT BARRIERS IN ACCORDANCE WITH THE PLANS AND DETAILS OR AS DIRECTED BY THE ENGINEER. TO THE MAXIMUM EXTENT POSSIBLE, ERECT BARRIERS WITHIN THE LIMITS OF THE RIGHTS-OF-WAY AND/OR EASEMENTS. SECURE PERMISSION OF THE OWNER PRIOR TO PLACING BARRIERS ON PRIVATE PROPERTY.

SEMENT & EROSION CONTROL NOTES:

- IF NECESSARY, SLOPES WHICH EXCEED EIGHT (8) VERTICAL FEET SHOULD BE STABILIZED WITH SYNTHETIC OR VEGETATIVE MATS. IN ADDITION TO HYDROSEEDING, IT MAY BE NECESSARY TO INSTALL TEMPORARY SOPE BRANS DURING CONSTRUCTION. TEMPORARY BRANS MAY BE NEEDED UNTIL THE SLOPE IS BROUGHT TO GRADE.
- STABILIZATION MEASURES SHALL BE INITIATED AS SOON AS PRACTICABLE IN PORTIONS OF THE SITE WHERE CONSTRUCTION ACTIVITIES HAVE TEMPORARILY OR PERMANENTLY CEASED, BUT IN NO CASE MORE THAN FOURTEEN (14) DAYS AFTER WORK HAS CEASED. EXCEPT AS SPECIFICALLY EXCLUDED BY SNOW COVER OR FROZEN GROUND CONDITIONS, STABILIZATION MEASURES MUST BE INITIATED AS SOON AS PRACTICABLE.
- WHERE CONSTRUCTION ACTIVITY ON A PORTION OF THE SITE IS TEMPORARILY CEASED, AND EARTH-DISTURBING ACTIVITIES WILL BE RESUMED WITHIN 14 DAYS, TEMPORARY STABILIZATION MEASURES DO NOT HAVE TO BE INITIATED ON THAT PORTION OF THE SITE.
- ALL SEMENT AND EROSION CONTROL BARRIERS SHALL BE INSPECTED ONCE EVERY CALENDAR WEEK. IF 3 MONTHS HAVE PASSED SINCE THE BARRIERS WERE INSTALLED, THE CONTRACTOR OR MODIFICATION REQUIRED TO CORRECT THE BARRIERS WITHIN 48 HOURS OF IDENTIFICATION.
- PROVIDE ALL FENCE AND/OR OTHER CONTROL DEVICES AS MAY BE REQUIRED TO CONTROL SOIL EROSION IMMEDIATELY AFTER THE INSTALLATION OF UTILITIES, TRENCHES AND TRENCHES SHOULD BE FILLED TO REMOVE ANY SEDIMENT BEING PLACED BACK INTO ANY WATERS OF THE STATE.
- ALL EROSION CONTROL DEVICES SHALL BE PROPERLY MAINTAINED DURING ALL PHASES OF CONSTRUCTION UNTIL THE COMPLETION OF ALL CONSTRUCTION ACTIVITIES AND ALL DISTURBED AREAS HAVE BEEN STABILIZED. ADDITIONAL CONTROL DEVICES MAY BE REQUIRED DURING CONSTRUCTION IN ORDER TO CONTROL EROSION AND/OR OFF-SITE SEDIMENTATION. ALL TEMPORARY CONTROL DEVICES SHALL BE REMOVED ONCE CONSTRUCTION IS COMPLETE AND THE SITE IS STABILIZED. CONTRACTOR MUST TAKE NECESSARY ACTION TO MINIMIZE THE TRACKING OF MUD ONTO PAVED ROADWAYS) FROM CONSTRUCTION AREAS AND THE GENERATION OF DUST. THE CONTRACTOR SHALL DAILY REMOVE MUD/SOIL FROM PAVEMENT, AS MAY BE REQUIRED.
- RESIDENTIAL SUBDIVISIONS REQUIRE EROSION CONTROL FEATURES FOR INFRASTRUCTURE AS WELL AS FOR INDIVIDUAL LOT CONSTRUCTION. INDIVIDUAL PROPERTY OWNERS SHALL FOLLOW THESE STANDARDS FOR CONSTRUCTION OR FOR AN APPROVAL OF EROSION CONTROL MEASURES AND/OR DITCHES WILL BE PROVIDED AS NEEDED DURING CONSTRUCTION TO PROTECT WORK AREAS FROM UPSLOPE RUNOFF AND/OR TO DIVERT SEDIMENT-LADEN WATER TO APPROPRIATE TRAPS OR STABLE OUTLETS.
- ALL WATERS OF THE STATE (WOS), INCLUDING WETLANDS, ARE TO BE FLAGGED OR OTHERWISE CLEARLY MARKED IN THE FIELD. A DOUBLE ROW OF SILT FENCED IS TO BE INSTALLED IN ALL AREAS WHERE A 5-FOOT BUFFER CANNOT BE MAINTAINED BETWEEN THE DISTURBED AREA AND ALL WOS. A 10-FOOT BUFFER SHOULD BE MAINTAINED BETWEEN THE DISTURBED AREA AND ALL WOS. OILS, FIELDS, AND BUILDING PRODUCTS WITH SIGNIFICANT POTENTIAL FOR IMPACT (SUCH AS STOCKPILES OF FRESHLY TREATED LUMBER) AND CONSTRUCTION CHEMICALS THAT COULD BE EXPOSED TO STRAW WATER MUST BE PREVENTED FROM BECOMING A POLLUTANT SOURCE IN STORM WATER DISCHARGES.
- A COPY OF THE SWPPP INSPECTION RECORDS, AND RAINFALL DATA MUST BE RETAINED AT THE CONSTRUCTION SITE OR A NEARBY LOCATION EASILY ACCESSIBLE TO THE PUBLIC. THE BURNING OF WASTE MATERIALS AND/OR COMBUSTIBLES AT THE CONSTRUCTION SITE OR NEARBY LOCATION SHALL BE PROHIBITED.
- ALL POLLUTANTS THAT ARE NOT LISTED IN THE SC DEPARTMENT OF HEALTH AND ENVIRONMENTAL CONTROL'S POLLUTANT LIST SHALL BE TREATED AS IF THEY ARE. POLLUTANTS THAT ARE LISTED IN THE POLLUTANT LIST AND DISTURBING ACTIVITIES HAVE PERMANENTLY OR TEMPORARILY CEASED AND WILL NOT RESUME FOR A PERIOD OF 7 CALENDAR DAYS.
- MINIMIZE SOIL COMPACTION AND UNLESS INEVITABLE, PRESERVE TOPSOIL.
- MINIMIZE THE DISCHARGE OF POLLUTANTS FROM EQUIPMENT AND VEHICLE WASHING. WHEEL WASH WATER AND OTHER POLLUTANTS OF BETTER TREATMENT PRIOR TO DISCHARGE.
- MINIMIZE THE DISCHARGE OF POLLUTANTS FROM DEWATERING OF TRENCHES AND EXCAVATED AREAS. THESE DISCHARGES ARE TO BE ROUTED THROUGH APPROPRIATE BMP'S (SEDIMENT BASIN, FILTER BAG, ETC.).
- THE FOLLOWING DISCHARGES FROM SITES ARE PROHIBITED:
 - WASTEWATER FROM WASHOUT OF CONCRETE UNLESS MANAGED BY AN APPROPRIATE CONTROL MEASURES FROM WASTEWATER.
 - WASTEWATER FROM WASHOUT OF CLEANOUT OF STUCCO, PAINT, FORM RELEASE OILS, CURING COMPOUNDS AND OTHER CHEMICALS FROM MATERIALS.
 - FUELS, OILS OR OTHER POLLUTANTS USED IN VEHICLE AND EQUIPMENT OPERATION AND MAINTENANCE.
 - SOAPS OR SOLVENTS USED IN VEHICLE AND EQUIPMENT WASHING.
- AFTER CONSTRUCTION ACTIVITIES BEGIN, INSPECTIONS MUST BE CONDUCTED AT A MINIMUM OF AT LEAST ONCE EVERY CALENDAR WEEK AND MUST BE CONDUCTED UNTIL FINAL STABILIZATION IS REACHED ON ALL AREAS OF THE CONSTRUCTION SITE.
- CONSTRUCTION BMP'S NEED TO BE MODIFIED OR IF ADDITIONAL BMP'S ARE NECESSARY TO COMPLY WITH THE REQUIREMENTS OF THE NPDES GENERAL PERMIT FOR STORMWATER DISCHARGES FROM CONSTRUCTION ACTIVITIES AND/OR SC'S WATER QUALITY STANDARDS. IMPLEMENTATION MUST BE COMPLETED BEFORE THE NEXT STORM EVENT WHENEVER PRACTICABLE. IF IMPLEMENTATION BEFORE THE NEXT STORM EVENT IS IMPRACTICABLE, THE SITUATION MUST BE DOCUMENTED IN THE SWPPP AND ALTERNATIVE BMP'S MUST BE IMPLEMENTED AS SOON AS REASONABLY POSSIBLE.
- AFTER CONSTRUCTION COMPLETION, CONSTRUCTION ACTIVITIES FOR NON-LINEAR PROJECTS THAT DISTURB 10 ACRES OR MORE THIS CONFERENCE MUST BE HELD ON-SITE UNLESS THE SC DEPARTMENT OF HEALTH AND ENVIRONMENTAL CONTROL HAS APPROVED OTHERWISE.

DEMOLITION NOTES

- ALL DEMOLITION DEBRIS, INCLUDING CLEARING AND GRADING, TO BE DISPOSED OF OFF-SITE IN ACCORDANCE WITH HAMPTON COUNTY & SCODOT REGULATIONS. ALL MATERIALS TO BE REMOVED SHALL BE IDENTIFIED AND TRACKED TO THE BUILDINGS & ROAD CENTRLINES AND PERPENDICULAR TO APPLICABLE SIDE CUTS SHALL BE PARALLEL TO THE BUILDINGS & ROAD CENTRLINES AND PERPENDICULAR TO THE LONGITUDINAL DIRECTION OF ANY WALK, ROADWAY, OR BUILDING AT THE IN LOCATIONS.
- REPLACE ANY EXISTING CONCRETE SIDEWALKS, CURBING, OR ANY OTHER EXISTING ITEMS DAMAGED DURING THE DEMOLITION OR CONSTRUCTION PROCESS AT NO ADDITIONAL COST.
- COORDINATE DEMOLITION, RELOCATION, OR BURIAL WITH APPLICABLE UTILITY COMPANIES & SCODOT.
- INSTALL ORANGE CONSTRUCTION FENCE AROUND PERIMETER OF AREAS BEING DEMOLISHED AND AREAS UNDER CONSTRUCTION.
- EXCAVATED MATERIAL OBTAINED DURING CONSTRUCTION SHALL BECOME THE PROPERTY OF THE CONTRACTOR AND SHALL BE REMOVED FROM THE SITE.

ENGINEER	REV	DATE	DESCRIPTION
M. HINES			
DRAWN			
J NEWCOMB			
CHECKED			
M. HINES			

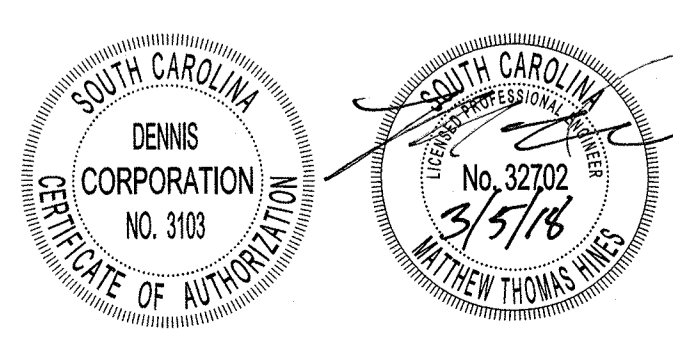

**VARNVILLE
STREETSCAPE**

DENNIS
CORPORATION

1800 Huger Street Columbia, S.C. 29201
Ph: 803-252-0991 Fax: 803-733-6787

**GENERAL
CONSTRUCTION NOTES**

JANUARY 2018 HAMPTON COUNTY SOUTH CAROLINA

Scale
NTS
Sheet
03

HORIZONTAL DATUM- NORTH AMERICAN DATUM - 1983 (NAD 83)
 VERTICAL DATUM- NORTH AMERICAN VERTICAL DATUM - 1988 (NAVD 88)

CONTROL POINT	NORTHING	EASTING	ELEVATION	DESCRIPTION
1	370409.7230	1974927.2061	104.2917	CP MAIL
2	370083.5812	1975333.0020	106.7860	CP MAIL
3	369886.0806	1975386.4678	103.5251	CP MAIL

GEOMETRIC DATA		STATION	NORTHING	EASTING
Horizontal Alignment :		10+00.00	370481.5285	1974830.4927
Element: Linear		23+13.68	369645.3581	1975843.6903
Tangent Direction:		POB		
Tangent Length:		POE		
		S 50°28'04" E		
		1313.678		

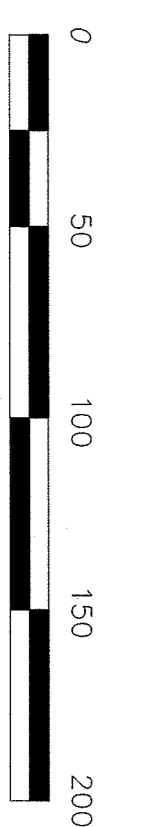
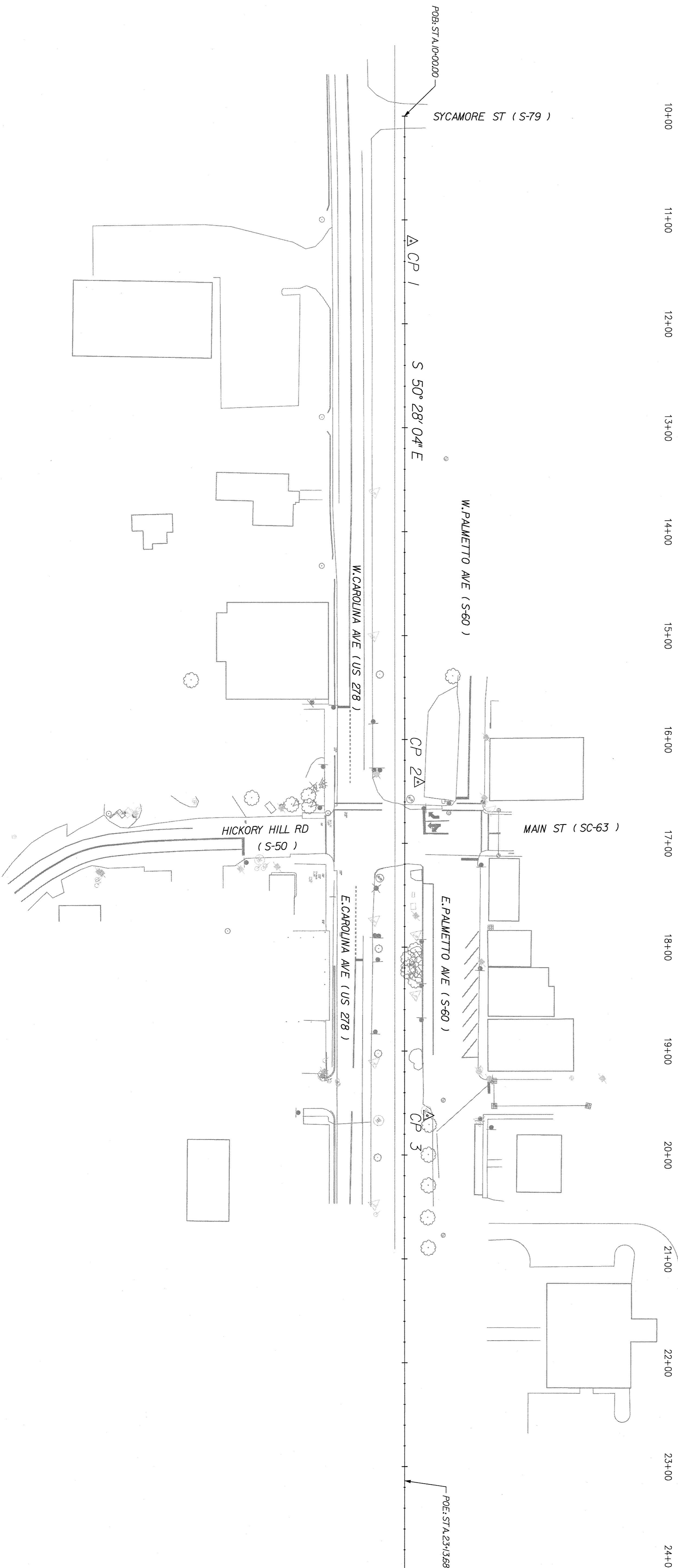

ENGINEER	REV	DATE	DESCRIPTION
M. Hines			
DRAWN			
J. Newcomb			
CHECKED			
M. Hines			

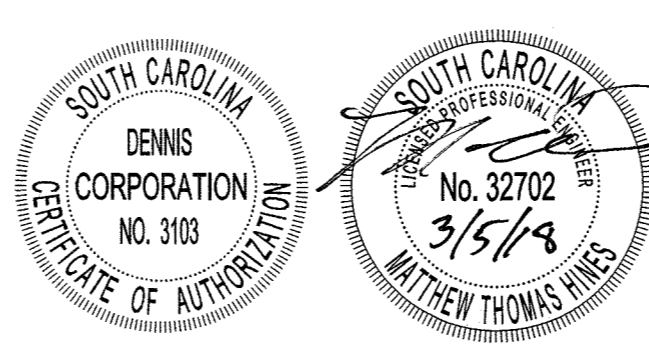

VARNVILLE STREETScape
DENNIS CORPORATION
 1800 Huger Street Columbia S.C. 29201
 Ph: 803-252-0991 Fax: 803-733-6767

REFERENCE ALIGNMENT DATA

JANUARY 2018 HAMPTON COUNTY SOUTH CAROLINA

Scale 1:50
 Sheet 04

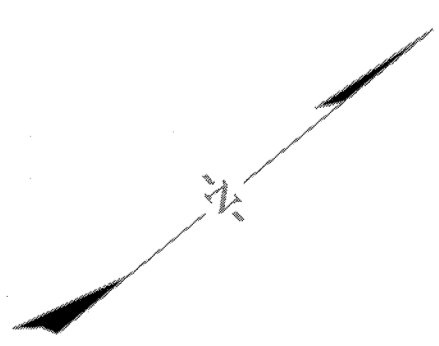
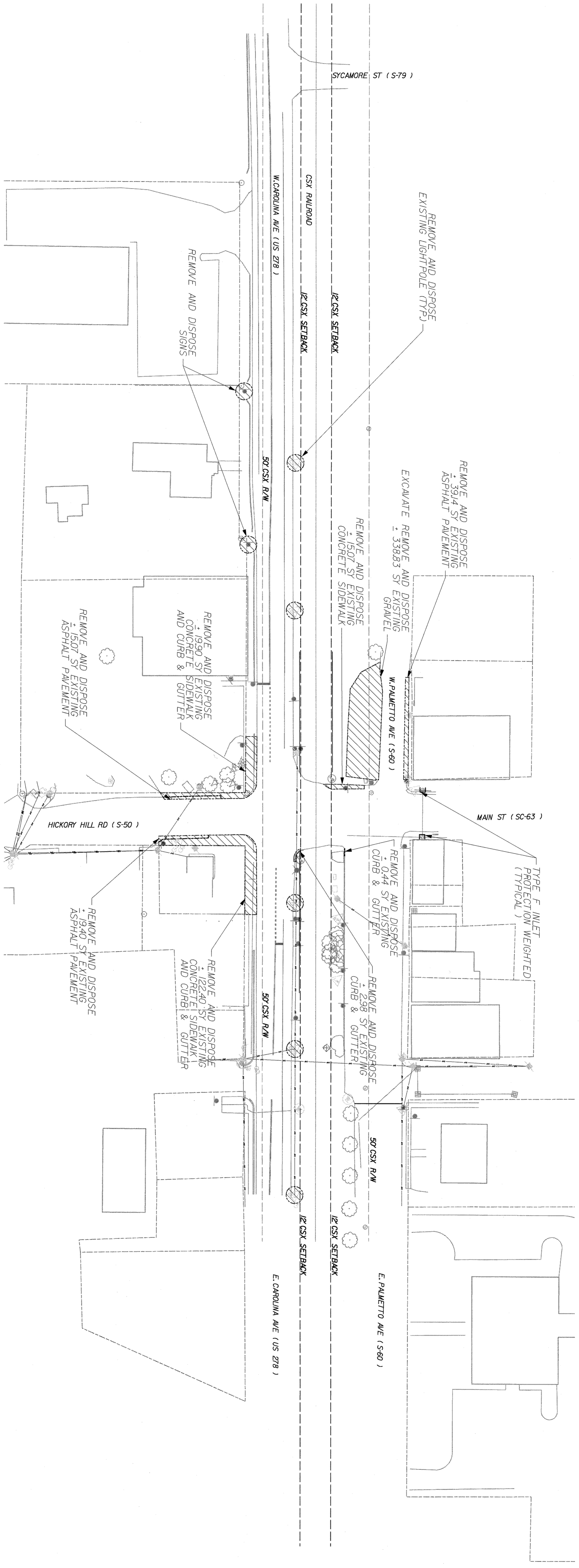

ENGINEER	REV	DATE	DESCRIPTION
M HINES			
J NEWCOMB			
M HINES			

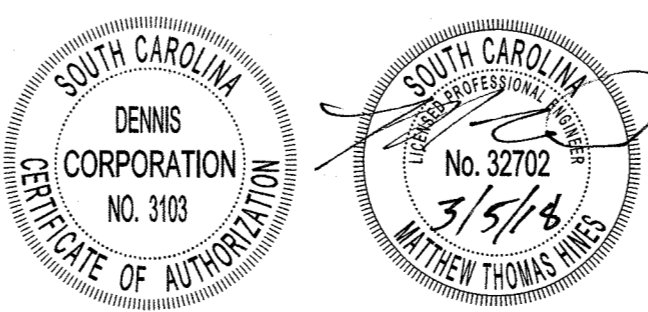

VARNVILLE STREETScape
DENNIS CORPORATION
 1800 Huger Street Columbia S.C. 29201
 Ph: 803-252-0991 Fax: 803-733-6787

EXISTING CONDITIONS, DEMOLITION AND EROSION CONTROL PLAN

JANUARY 2018 HAMPTON COUNTY SOUTH CAROLINA

Scale
1:50
 Sheet
05

NOTE: REFER TO SHEET 10 FOR PAVEMENT SECTION

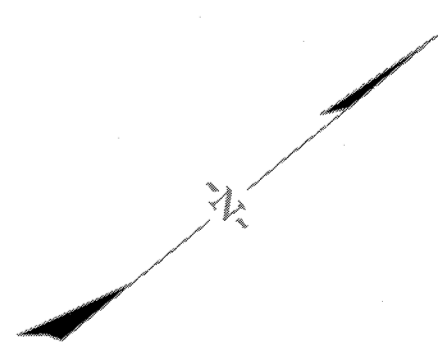
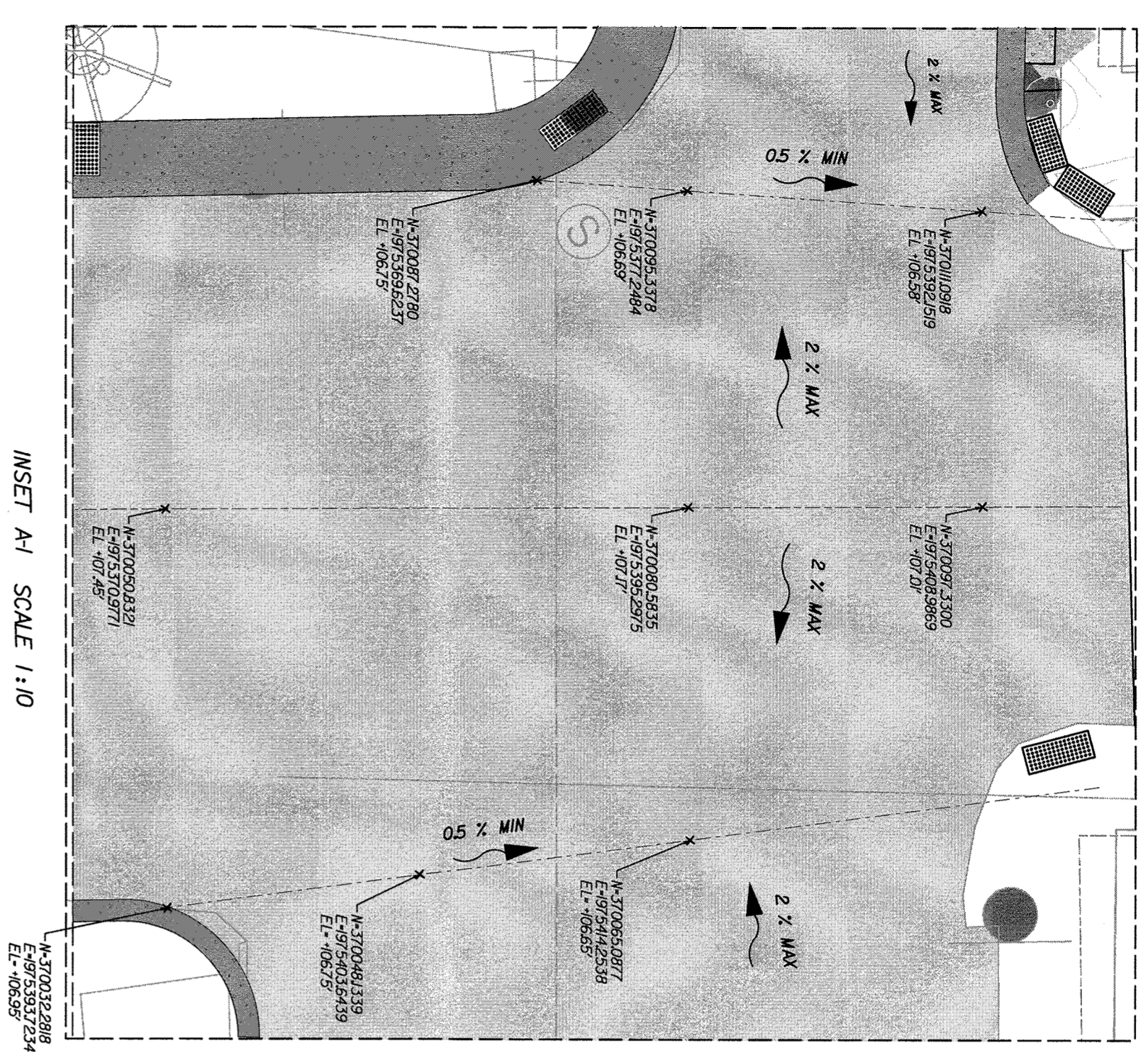
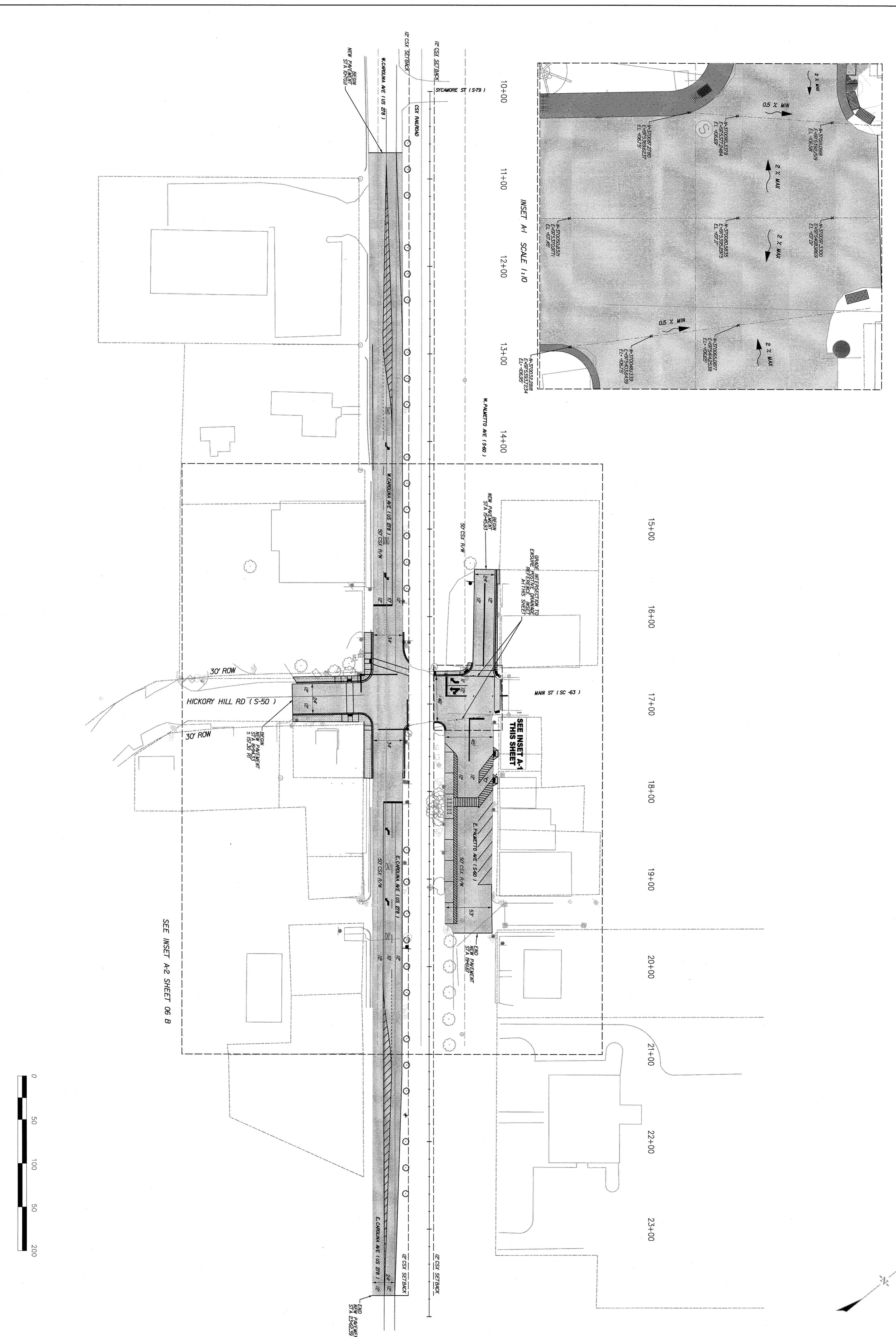

ENGINEER	REV	DATE	DESCRIPTION
M HINES			
J NEWCOMB			
M HINES			

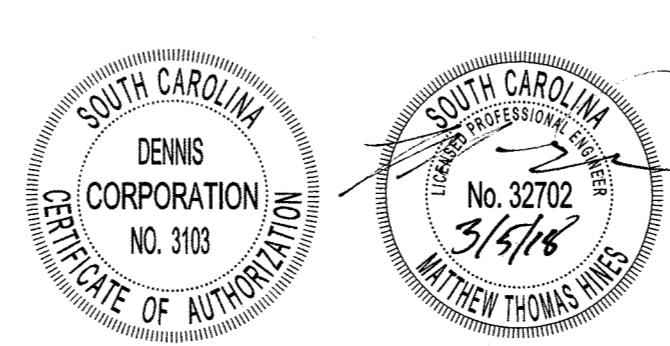

VARNVILLE STREETSCAPE
DENNIS CORPORATION
 1800 Huger Street Columbia S.C. 29201
 Ph: 803-252-0991 Fax: 803-733-6787

PAVING, SIDEWALK AND DRAINAGE PLAN (1 OF 2)

JANUARY 2018 HAMPTON COUNTY SOUTH CAROLINA

Scale AS SHOWN Sheet 06 A

NOTE: ALL CURB RADI SHOWN TO BACK OF CURB
REFER TO SHEET 06A FOR ASPHALT PAVING

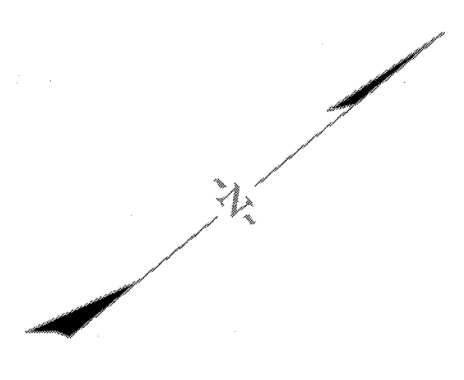
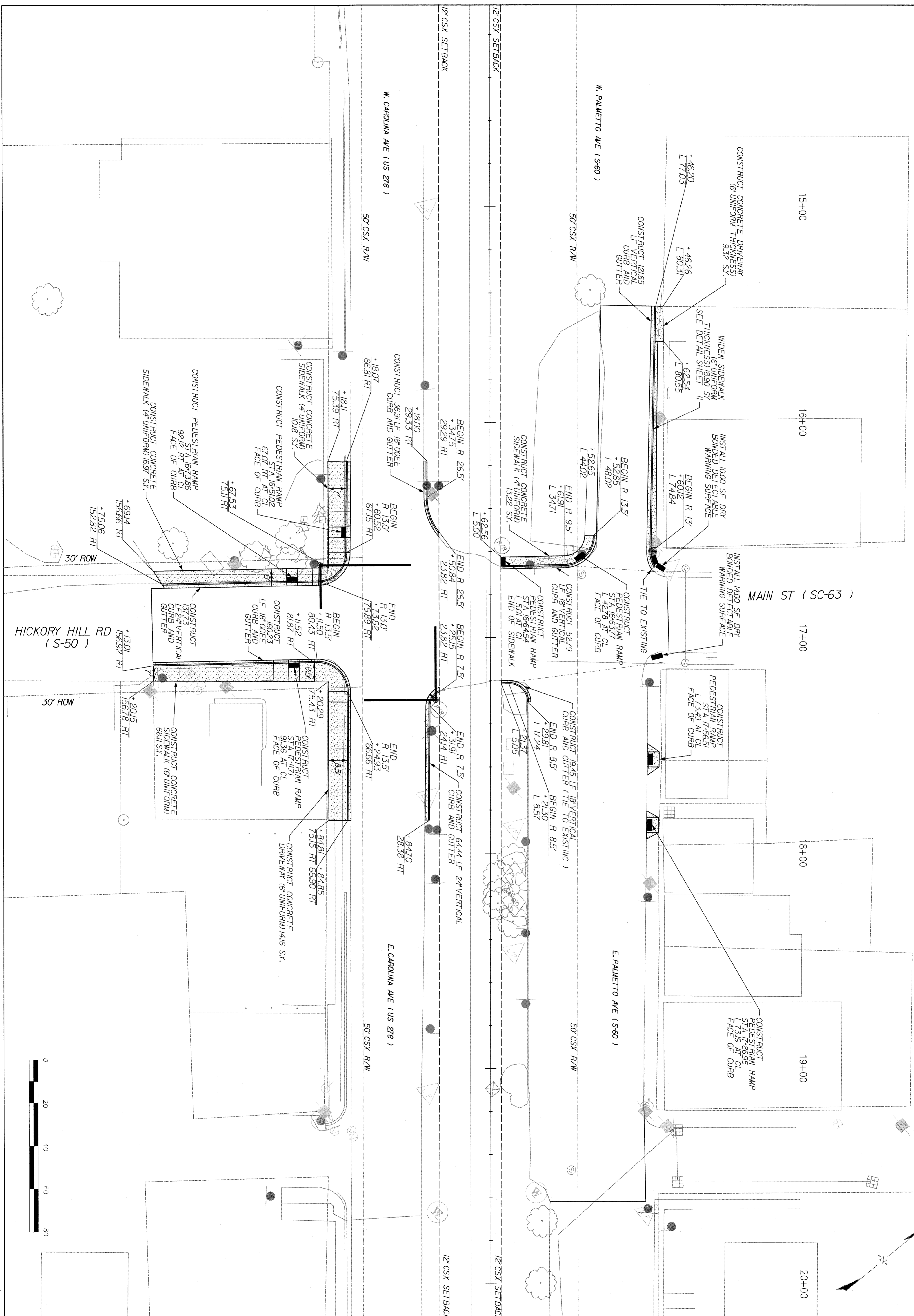

ENGINEER	REV	DATE	DESCRIPTION
M HINES			
DRAWN			
J NEWCOMB			
CHECKED			
M HINES			

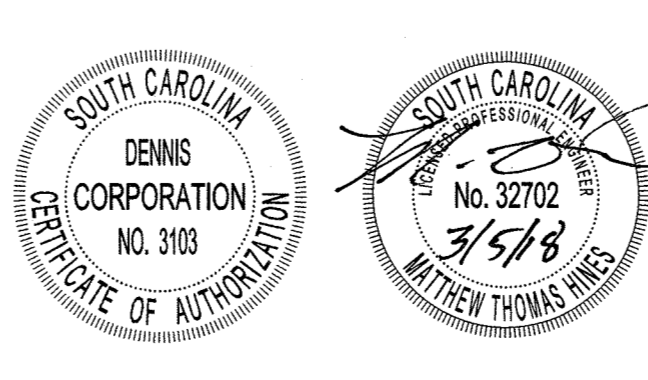

**VARNVILLE
STREETSCAPE**

DENNIS CORPORATION

1800 Huger Street Columbia S.C. 29201
Ph: 803-252-0991 Fax: 803-733-6787

**PAVING, SIDEWALK AND
DRAINAGE PLAN**

JANUARY 2018 HAMPTON COUNTY SOUTH CAROLINA

Scale
1:20
Sheet
06 B

NOTE: RETAIN EXISTING RAILROAD MARKINGS ON SB SC-63

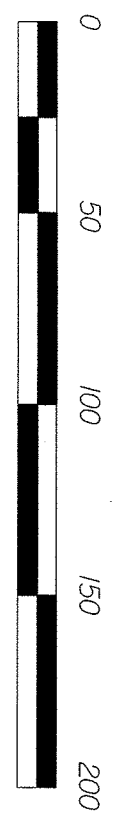
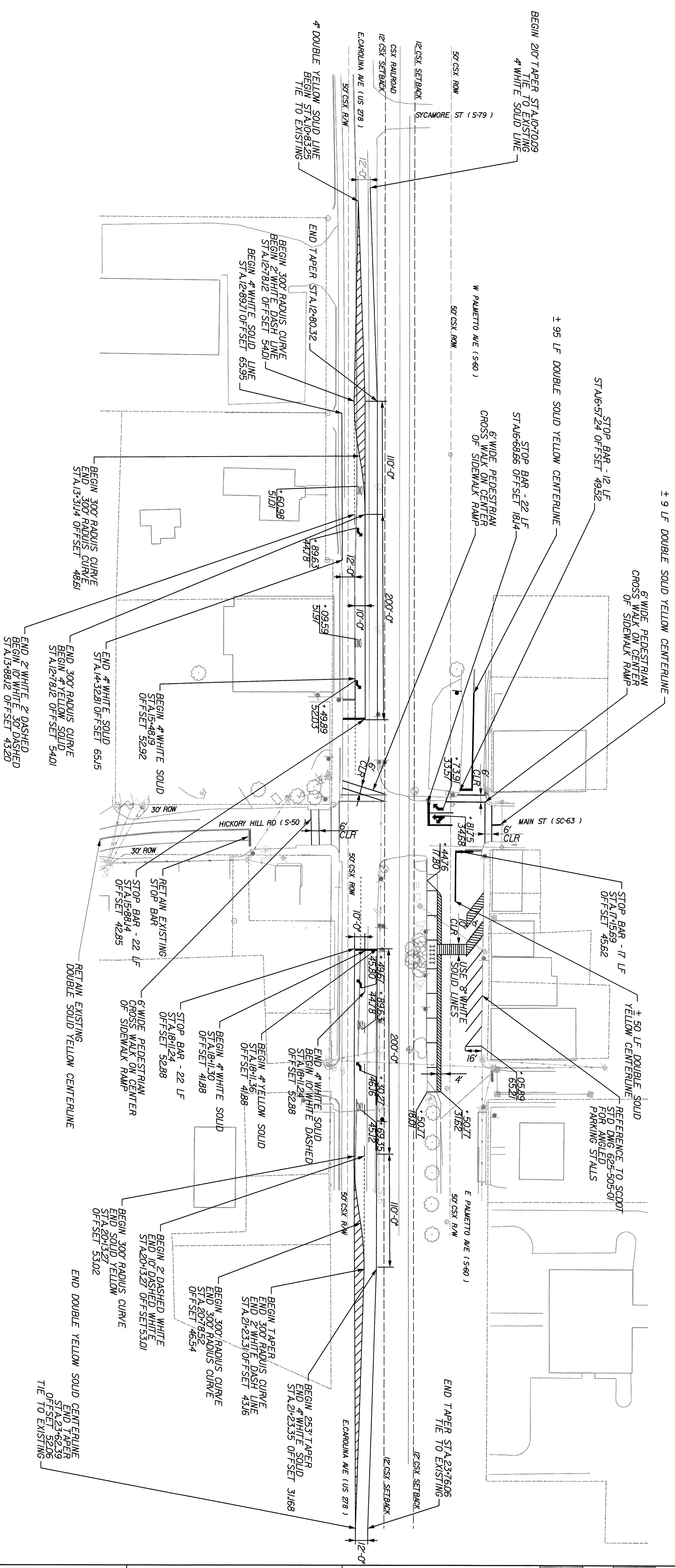

STRIPING LAYOUT PLAN

VARNVILLE
STREETSCAPE
DENNIS
CORPORATION
1800 Huger Street Columbia S.C. 29201
Ph: 803-252-0991 Fax: 803-733-6787

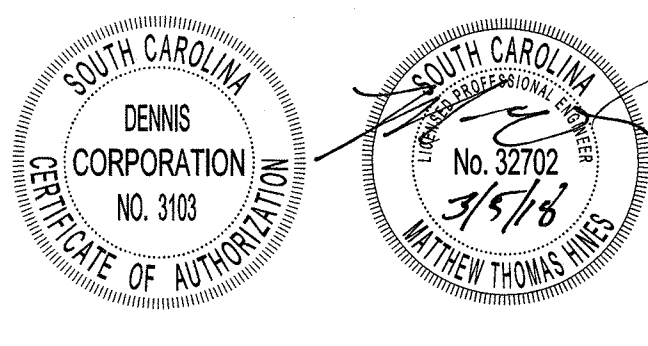

ENGINEER	REV	DATE	DESCRIPTION
M HINES			
DRAWN			
J NEWCOMB			
CHECKED			
M HINES			

SIGNAL EQUIPMENT

ONE (1) 8 PHASE FULLY ACTUATED STANDARD 2070 CONTROLLER WITH FLASHER, SIGNAL MONITOR UNIT, AND BASE-MOUNTED 332A CABINET.

MODEL 222 (2)-CHANNEL VEHICLE DETECTOR UNITS	EXT.	PROT.
PEDESTRIAN SIGNALS:	EXT.	PROT.
VEHICLE SIGNALS:	EXT.	PROT.
SIGNAL NUMBER	1 2 3 4 5 6 7 8 2P 4P	R R R R R R R R
LENS	Y Y Y Y Y Y Y Y	G G G G G G G G
PHASE	2 2 4 4 6 6 8 2P 2P	127 127 127 127 127 127 127 127
SIZE	2 2 2 2 2 2 2 2	2 2 2 2 2 2 2 2
QUANTITY	2 2 2 2 2 2 2 2	2 2 2 2 2 2 2 2

NOTE: 1 RR CROSSING PAVEMENT MARKINGS NOT NEEDED ON 3 OF 4 APPROACHES TO THIS URBAN/LOW SPEED CROSSING
 2 STOP LINES ARE SET BACK FOR LARGE TRUCK TURNS
 3 RETAIN EXISTING POST-MOUNTED SIGNS WITHIN PROJECT AREA EXCEPT WHERE NOTED

NOTE: 1 RR CROSSING PAVEMENT MARKINGS NOT NEEDED ON 3 OF 4 APPROACHES TO THIS URBAN/LOW SPEED CROSSING
 2 STOP LINES ARE SET BACK FOR LARGE TRUCK TURNS
 3 RETAIN EXISTING POST-MOUNTED SIGNS WITHIN PROJECT AREA EXCEPT WHERE NOTED

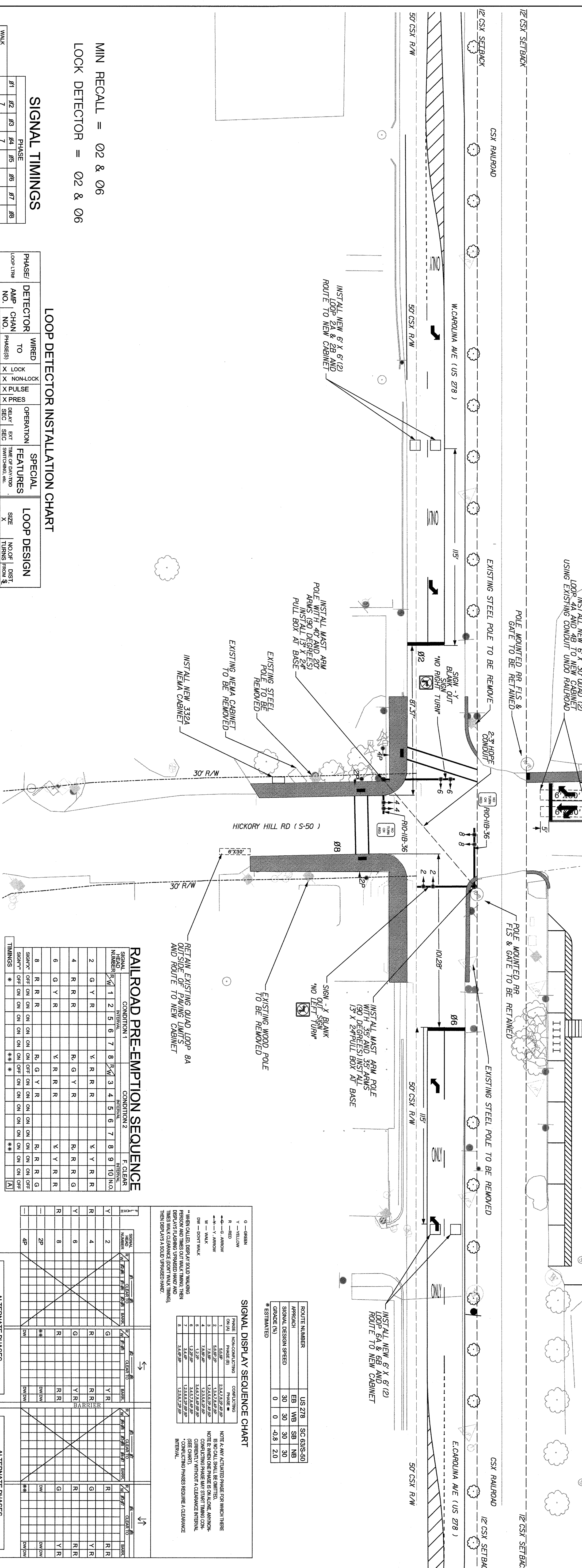

SIGNAL TIMINGS

WALK	7	8	9	10	11	12	13	14	15	16	17	18
MIN WALK	20	20	20	20	20	20	20	20	20	20	20	20
MAX WALK	4.2	4.2	4.2	4.2	4.2	4.2	4.2	4.2	4.2	4.2	4.2	4.2
VEH EXT	5.0	4.0	4.0	5.0	5.0	4.0	4.0	5.0	5.0	4.0	4.0	5.0
THEORETIC	16	9	9	16	16	9	9	16	16	9	9	16
MIN GAP	1.0	1.0	1.0	1.0	1.0	1.0	1.0	1.0	1.0	1.0	1.0	1.0
MAX LIMIT	33	15	15	33	33	15	15	33	33	15	15	33
WORKING	85	15	15	85	85	15	15	85	85	15	15	85
RELEASE	32	32	32	32	32	32	32	32	32	32	32	32
RED CLEAR	33	25	25	33	33	25	25	33	33	25	25	33

LOOP DETECTOR INSTALLATION CHART

PHASE	DETECTOR	WIRE	NON-LOCK	OPERATION	SPECIAL	LOOP DESIGN
2A	AMP NO. 2	X	X	EXT	SIZE X	NO. OF TURNS FROM 3
2B		X	X	EXT	SIZE X	NO. OF TURNS FROM 3
4A		X	X	EXT	SIZE X	NO. OF TURNS FROM 3
4B		X	X	EXT	SIZE X	NO. OF TURNS FROM 3
6A		X	X	EXT	SIZE X	NO. OF TURNS FROM 3
6B		X	X	EXT	SIZE X	NO. OF TURNS FROM 3
8A		X	X	EXT	SIZE X	NO. OF TURNS FROM 3

RAILROAD PRE-EMPTION SEQUENCE

COMPLETION 1	COMPLETION 2	INTERVAL
1 2 5 6 7 8 9 3 4 5 6 7 8 9 10	1 2 5 6 7 8 9 3 4 5 6 7 8 9 10	10 N.O.
2 6 7 8 9 3 4 5 6 7 8 9 10	2 6 7 8 9 3 4 5 6 7 8 9 10	10 N.O.
4 8 9 3 4 5 6 7 8 9 10	4 8 9 3 4 5 6 7 8 9 10	10 N.O.
6 9 3 4 5 6 7 8 9 10	6 9 3 4 5 6 7 8 9 10	10 N.O.
8 10 3 4 5 6 7 8 9 10	8 10 3 4 5 6 7 8 9 10	10 N.O.
9 10 3 4 5 6 7 8 9 10	9 10 3 4 5 6 7 8 9 10	10 N.O.
10 3 4 5 6 7 8 9 10	10 3 4 5 6 7 8 9 10	10 N.O.

SIGNAL DISPLAY SEQUENCE CHART

PHASE	NON-CONFLICTING	CONFLICTING
2A	2B, 4A, 4B, 6A, 6B, 8A, 8B	2P, 4P, 6P, 8P
2B	2A, 4A, 4B, 6A, 6B, 8A, 8B	2P, 4P, 6P, 8P
4A	2A, 2B, 6A, 6B, 8A, 8B	2P, 4P, 6P, 8P
4B	2A, 2B, 6A, 6B, 8A, 8B	2P, 4P, 6P, 8P
6A	2A, 2B, 4A, 4B, 8A, 8B	2P, 4P, 6P, 8P
6B	2A, 2B, 4A, 4B, 8A, 8B	2P, 4P, 6P, 8P
8A	2A, 2B, 4A, 4B, 6A, 6B	2P, 4P, 6P, 8P
8B	2A, 2B, 4A, 4B, 6A, 6B	2P, 4P, 6P, 8P

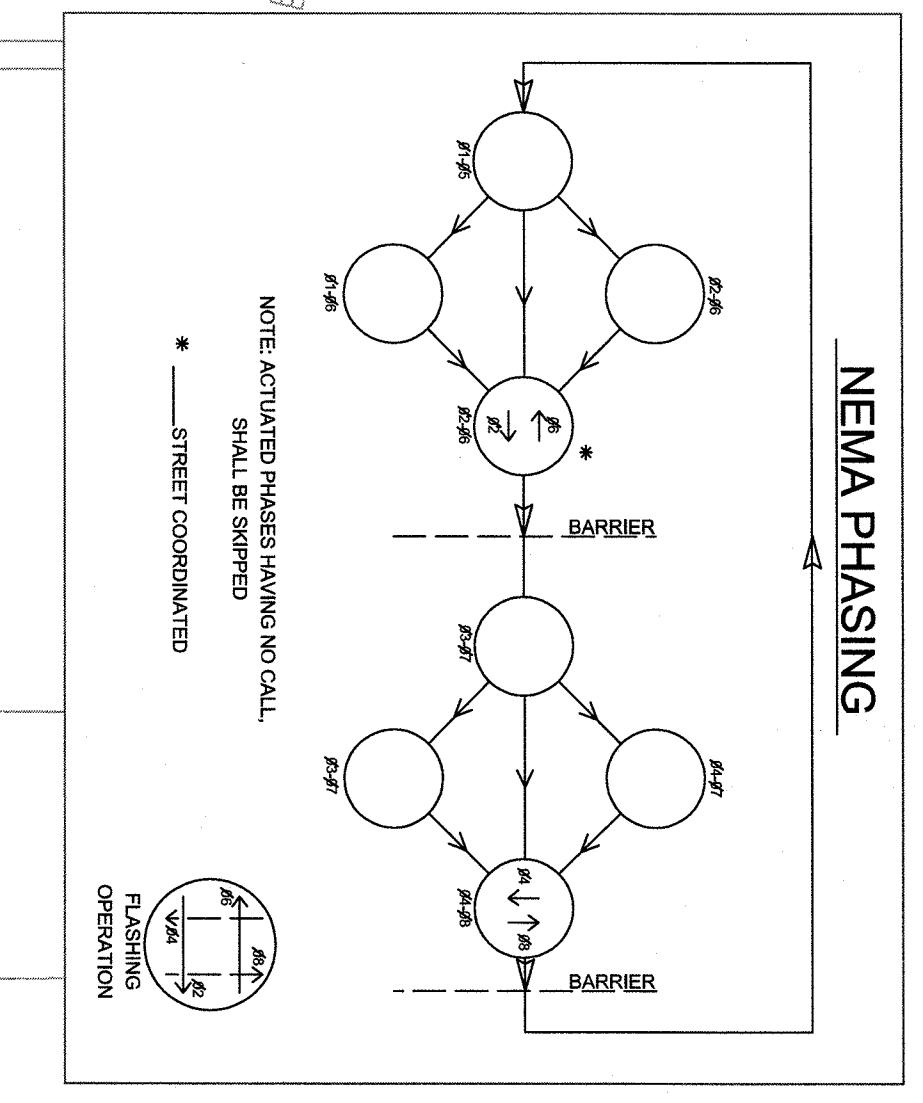

TRAFFIC SIGNAL PLAN

Scale 1:30
 Sheet 08

VARNVILLE STREETSCAPE DENNIS CORPORATION

1800 Huger Street Columbia S.C. 29201
 Ph: 803-252-0991 Fax: 803-733-6787

ENGINEER	REV	DATE	DESCRIPTION
M HINES			
DRAWN			
J NEWCOMB			
CHECKED			
M HINES			

SOUTH CAROLINA DENNIS CORPORATION
 No. 32702
 9/5/8
 MITCHELL THOMAS HINES

SOUTH CAROLINA CERTIFICATE OF AUTHORITY
 No. 3103

10+00 11+00 12+00 13+00 14+00 15+00 16+00 17+00 18+00 19+00 20+00 21+00 22+00 23+00

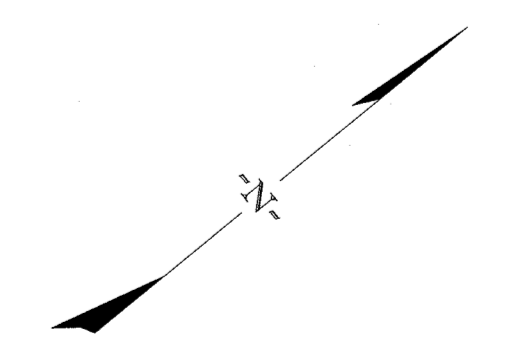
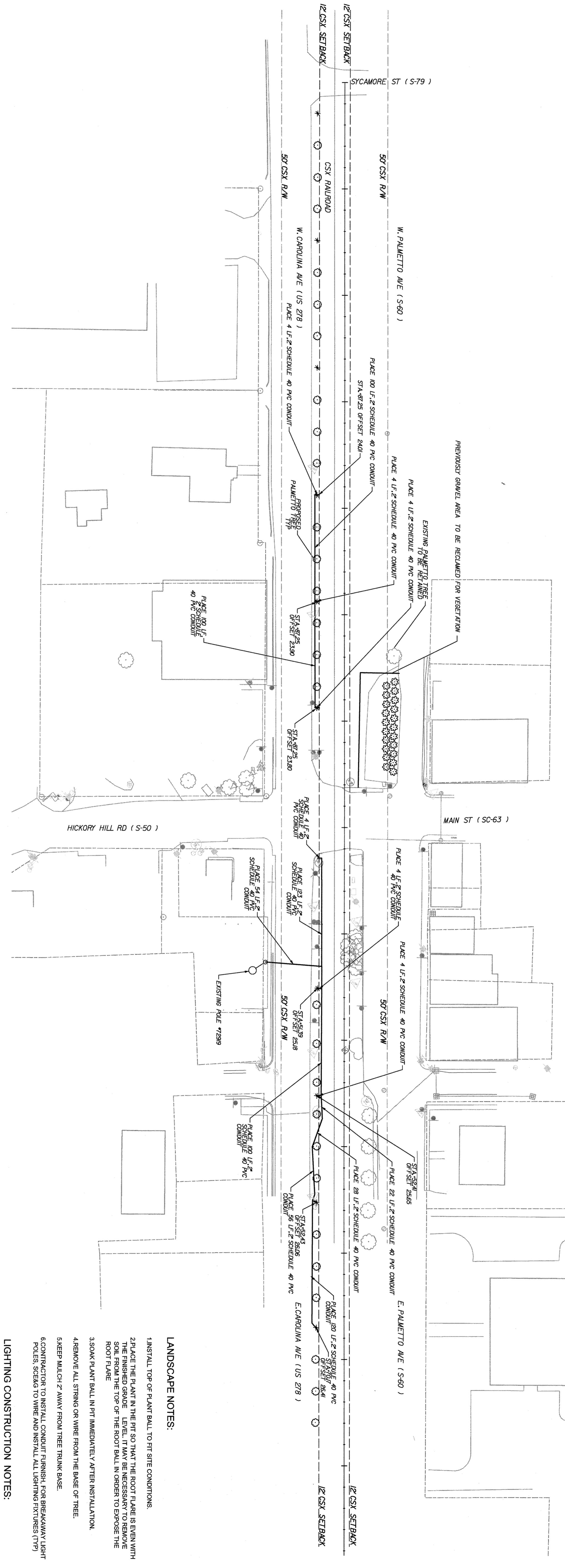

- LANDSCAPE NOTES:**
1. INSTALL TOP OF PLANT BALL TO FIT SITE CONDITIONS.
 2. PLACE THE PLANT IN THE PIT SO THAT THE ROOT FLARE IS EVEN WITH THE FINISHED GROUND. LABEL PLANT BALL ACCESS AND REMOVE STRIP OF FINISHED GROUND 5" WIDE AND 5' LONG TO EXPOSE THE ROOT FLARE.
 3. SOAK PLANT BALL IN PIT IMMEDIATELY AFTER INSTALLATION.
 4. REMOVE ALL STRING OR WIRE FROM THE BASE OF TREE.
 5. KEEP MULCH 2" AWAY FROM TREE TRUNK BASE.
 6. CONTRACTOR TO INSTALL CONDUIT FINISH, FOR BREAKAWAY LIGHT POLES, SECURE TO WIRE AND INSTALL ALL LIGHTING FIXTURES (TYP).
- LIGHTING CONSTRUCTION NOTES:**
1. ALL CONDUIT TO BE 2" SCHEDULE 40 PVC.
 2. PROVIDED AND INSTALLED BY DEVELOPER AT MINIMUM DEPTH OF 36" BELOW FINAL GRADE WITH PULL STRING INSTALLED AND ENDS TAPERED.
 3. ALL CONDUIT BENDS TO BE SCHEDULE 40 PVC LONG RADII TO INCLUDE 45° & 90° BENDS. SECURE TO PROVIDE AND INSTALL LIGHTS, POLES AND CONDUCTORS.
 4. SECURE TO PROVIDE HANGERS AT EACH LIGHT LOCATION. HANGERS TO BE INSTALLED AT 12" SPACING. HANGERS THAT HAVE TO BE LOCATED IN SIDEWALK OR PAVEMENT.

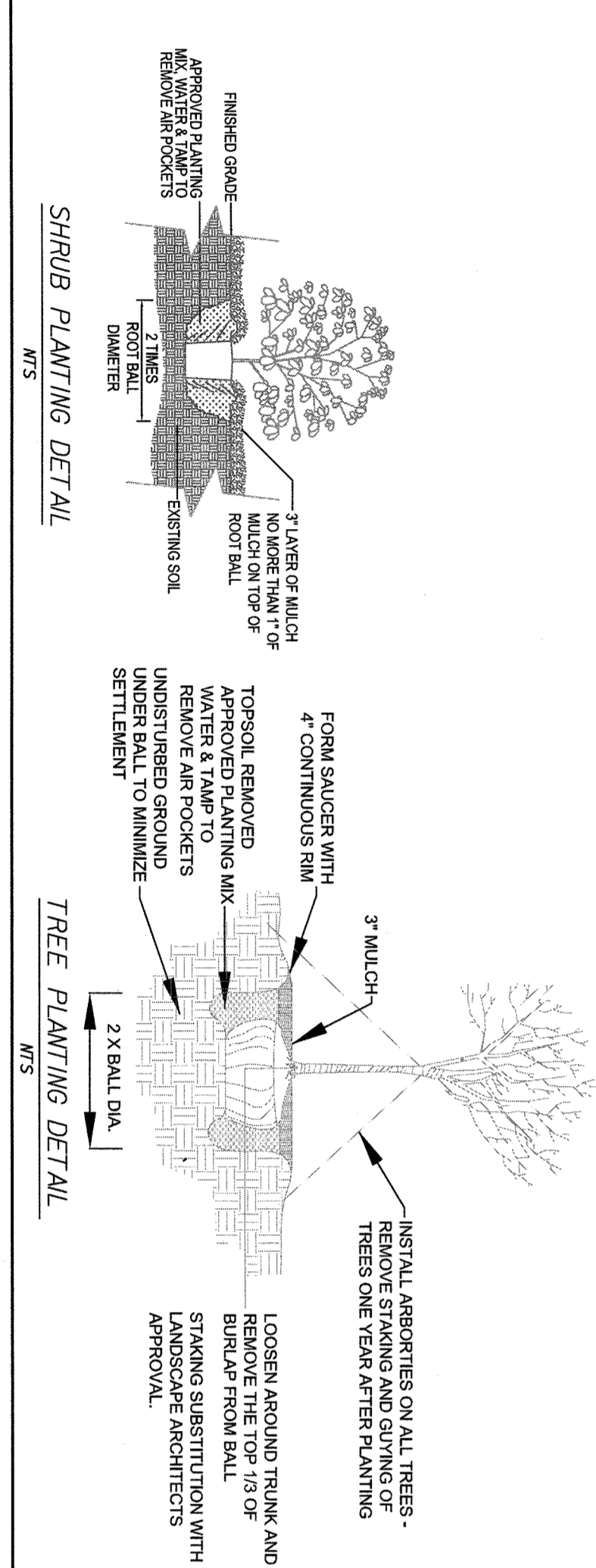

PLANT SCHEDULE

KEY	BOTANICAL NAME	COMMON NAME	QUANTITY	SIZE	SPACING
○	SABAL PALMETTO	PALMETTO TREE	27	7" DIA.	6' DIA.
○	BAYUS SAPHIRENIENS	AMERICAN BOXWOOD	300 SF	3" DIA.	4' DIA.
○	HARDWOOD MULCH	HARDWOOD MULCH		3/4"	1/4"

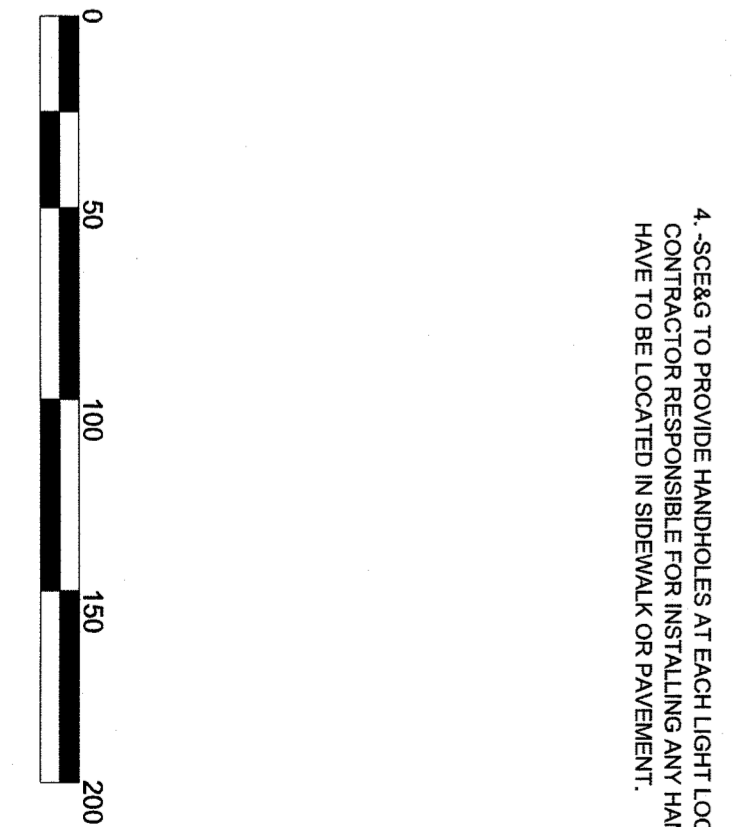

ENGINEER	REV	DATE	DESCRIPTION
M HINES			
J NEWCOMB			
M HINES			

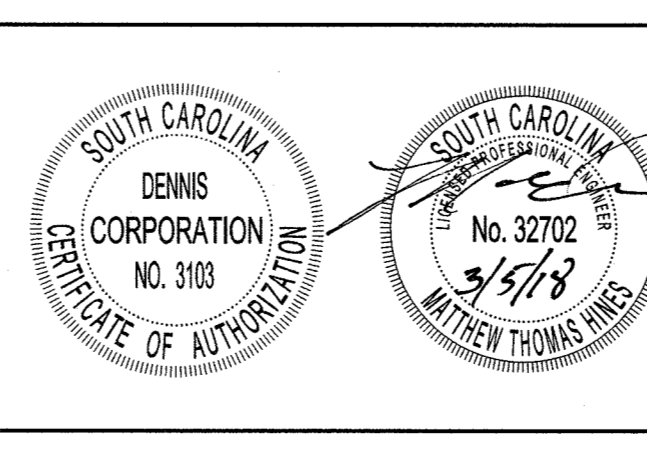

VARNVILLE STREETSCAPE

DENNIS CORPORATION

1800 Huger Street Columbia S.C. 29201
Ph: 803-252-0991 Fax: 803-733-6787

LANDSCAPE & LIGHTING PLAN

JANUARY 2018 HAMPTON COUNTY SOUTH CAROLINA

Scale 1" = 50'

Sheet 09

NOTE: CONTRACTOR SHALL REFER TO SODOT STANDARD DRAWINGS IN EFFECT AT TIME OF LETTING FOR GENERAL CONSTRUCTION DETAILS

TYPICAL SECTIONS

N.T.S

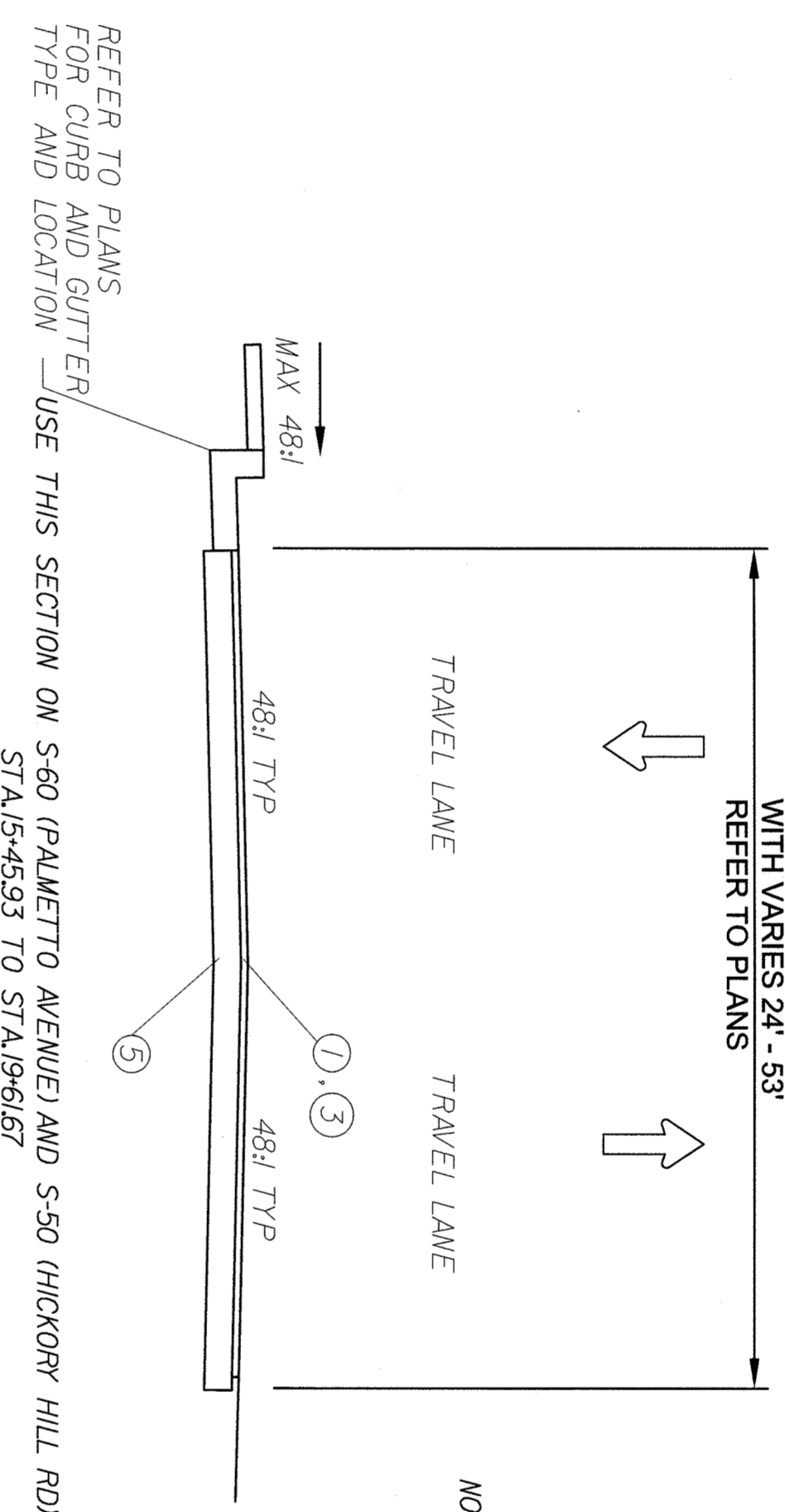

NOTE: MAINTAIN EXISTING SLOPES EXCEPT WHERE NOTED ON SHEET 6A

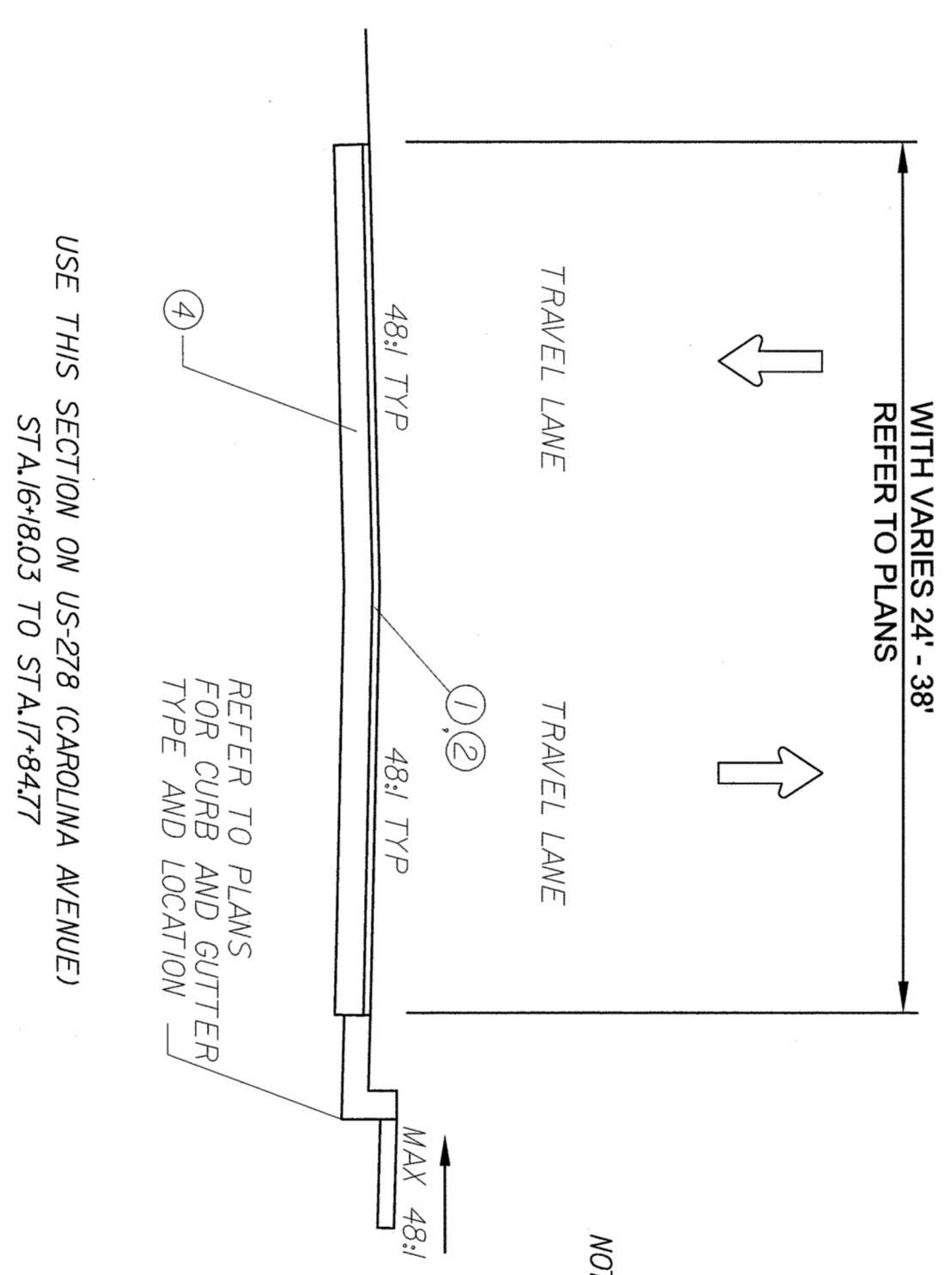

NOTE: MAINTAIN EXISTING SLOPES

- ① MILL EXISTING ASPHALT PAVEMENT 2" UNIFORM
 - ② HOT MIX ASPHALT SURFACE COURSE (TYPE B) 200LBS/SY
 - ③ HOT MIX ASPHALT SURFACE COURSE (TYPE C) 200 LBS/SY
 - ④ CEMENT MODIFIED RECYCLED BASE 12" UNIFORM **
 - ⑤ CEMENT MODIFIED RECYCLED BASE 8" UNIFORM **
- ** CONTRACTOR TO SUBMIT MIX DESIGN RECOMMENDATION FOR CEMENT CONTENT

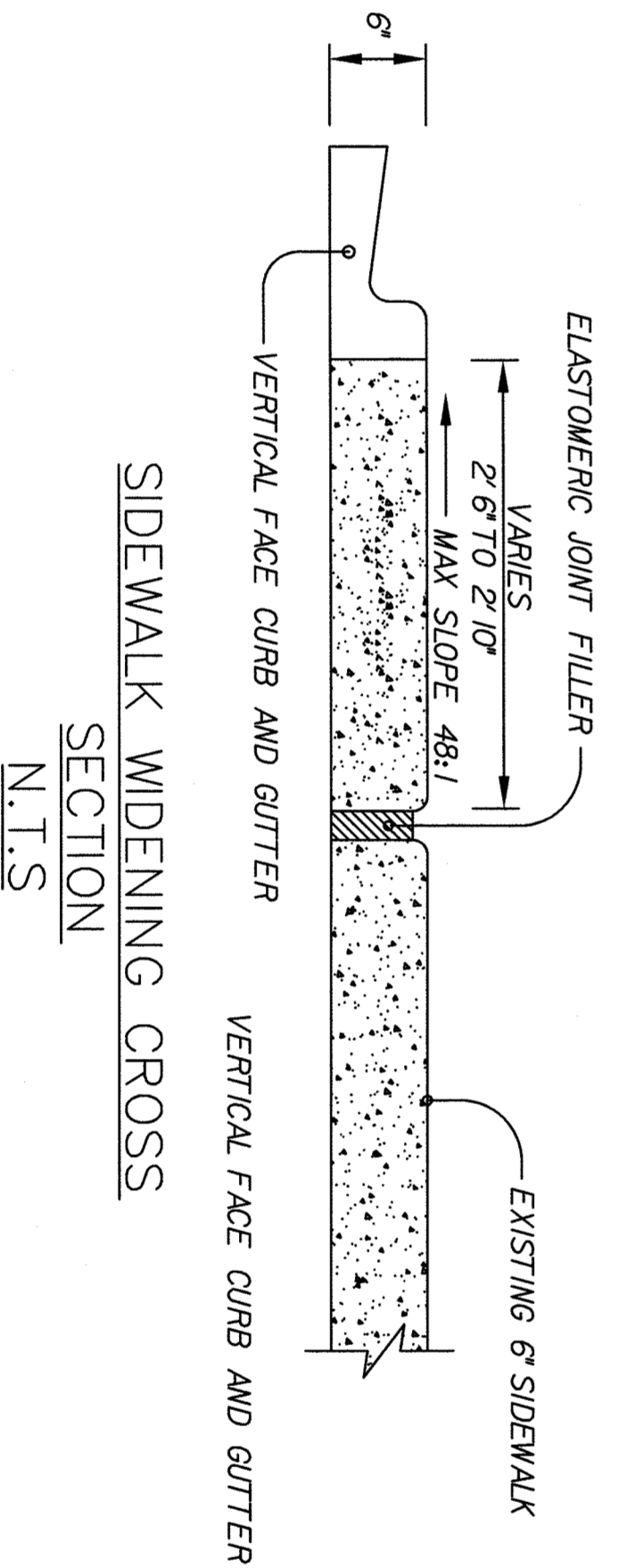

US 278 (E & W CAROLINA AVENUE)	DESIGN SPEED (MPH)	30
S-60 (EAST PALMETTO AVENUE)	DESIGN SPEED (MPH)	30
S-60 (WEST PALMETTO AVENUE)	DESIGN SPEED (MPH)	30
SC 63 (MAIN STREET)	DESIGN SPEED (MPH)	30
SC 63/ S-50 (HICKORY HILL ROAD)	DESIGN SPEED (MPH)	25

ENGINEER	REV	DATE	DESCRIPTION
M. Hines			
J. Newcomb			
M. Hines			

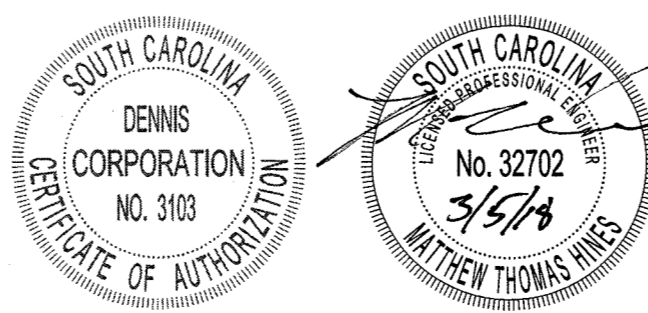

**VARNVILLE
STREETSCAPE**

DENNIS CORPORATION

1800 Huger Street Columbia S.C. 29201
Ph: 803-252-0991 Fax: 803-733-6787

TYPICAL SECTIONS

JANUARY 2018 HAMPTON COUNTY SOUTH CAROLINA