

**FORD F-450 CHASSIS**

**STANDARD OPTIONS:**

- SMOOTH COMPARTMENTS - VENTED w/ DRAIN HOLES
- EXTRUDED DOORS w/ DRIP RAILS
- D/P RUNNING BOARDS / KICK PANEL / STONE GUARDS / REAR BUMPER
- SMOOTH DOOR PANELS
- EBERHARD DOOR HANDLES
- SPLASH GUARDS
- ALUMINUM FENDERETTES
- C-CHANNEL w/ RED / WHITE REFLECTIVE

- CAST GRABBERS
- MUD FLAPS
- POLYFIBER INSULATION
- ICC LIGHTS
- COMPARTMENT LIGHTS
- WIRE ENGINE BLOCK HEATER
- SCORPION COMPARTMENTS / SHELVES GRAY
- PHOENIX WHEEL COVERS w/ VALVE EXTENDERS

**SPECIAL OPTIONS:**

- POWER DOOR LOCKS - ALL DOORS
- COLORED LENSES ON WARNING LIGHTS
- DOOR PANELS TO HAVE LOWER RED / GOLD CHEVRON

- WOOD CONSOLE w/ ARM RESTS
- SCORPION COAT GRAY
- LAPTOP SLOT IN FRONT
- RC TRONICS SWITCH PANEL w/ INTERCOM SWITCH w/ CODE LIGHTS
- SPOTLIGHT
- DIGITAL AMP / VOLT METER
- (2) WHELEN 295HFS2 w/ NCM SIRENS
- (1) 110V OUTLET
- MIRROR MOUNTED CAMERA MONITOR
- UPPER WARNING LIGHTS ON ONE SWITCH
- LOWER WARNING LIGHTS ON ONE SWITCH
- TWO POSITION STAINLESS GLOVE BOX BETWEEN SEATS ON BACK WALL

ION RED/CLEAR

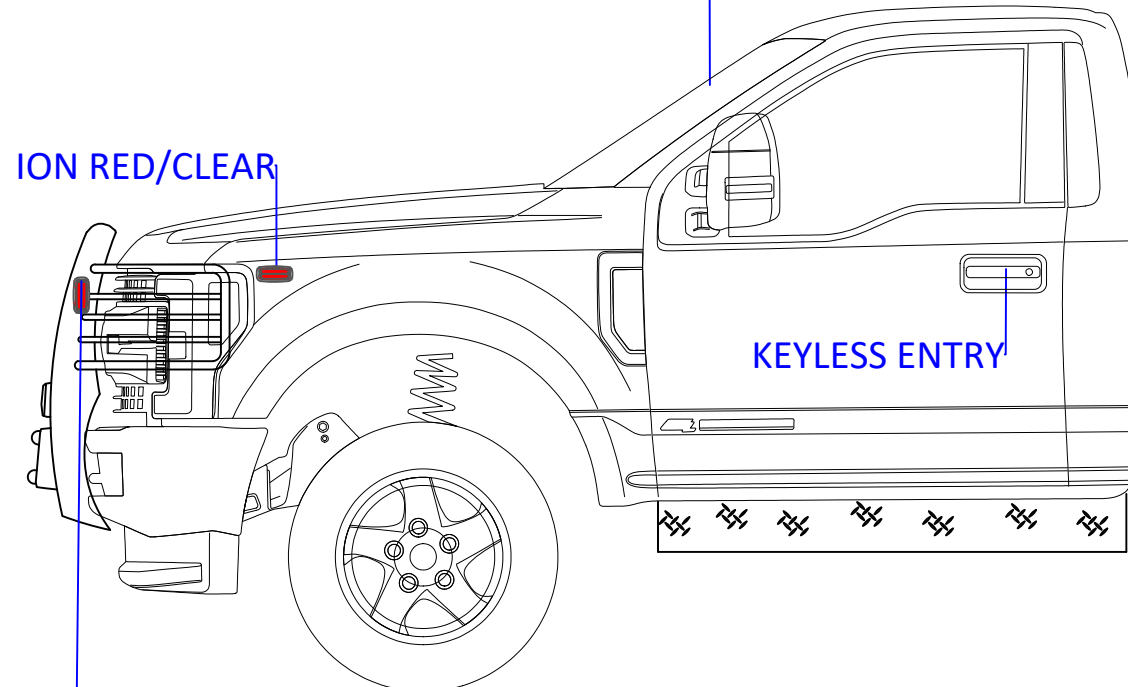

ION RED MOUNTED ON RANCH HAND

SPARE TIRE  
#10 FIRE EXTINGUISHER  
SHIP LOOSE

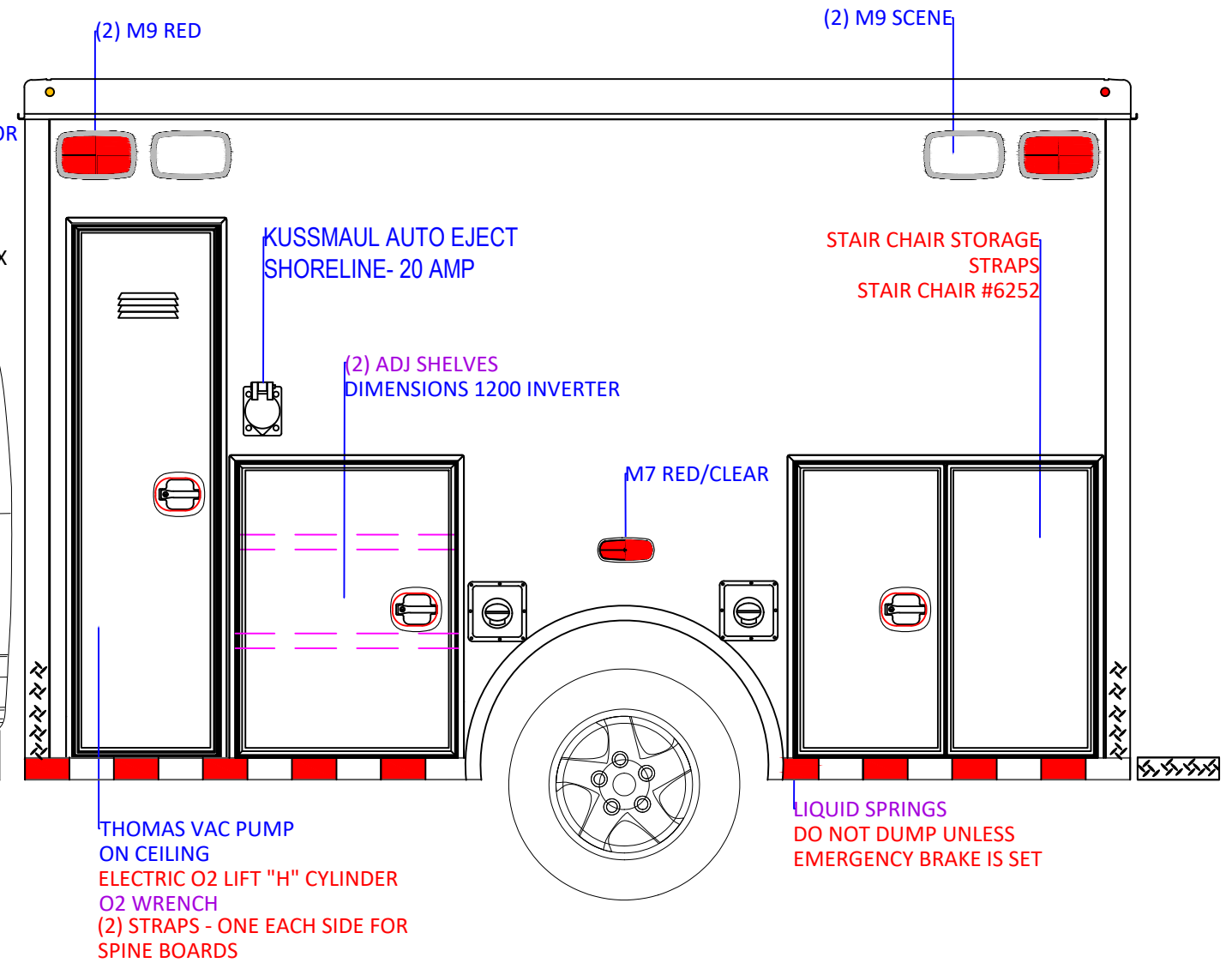

		BULLOCH	
		WORK ORDER	
	B	DRIVER EXT.	
WO#1	SCALE	DRAWN BY AK	DATE

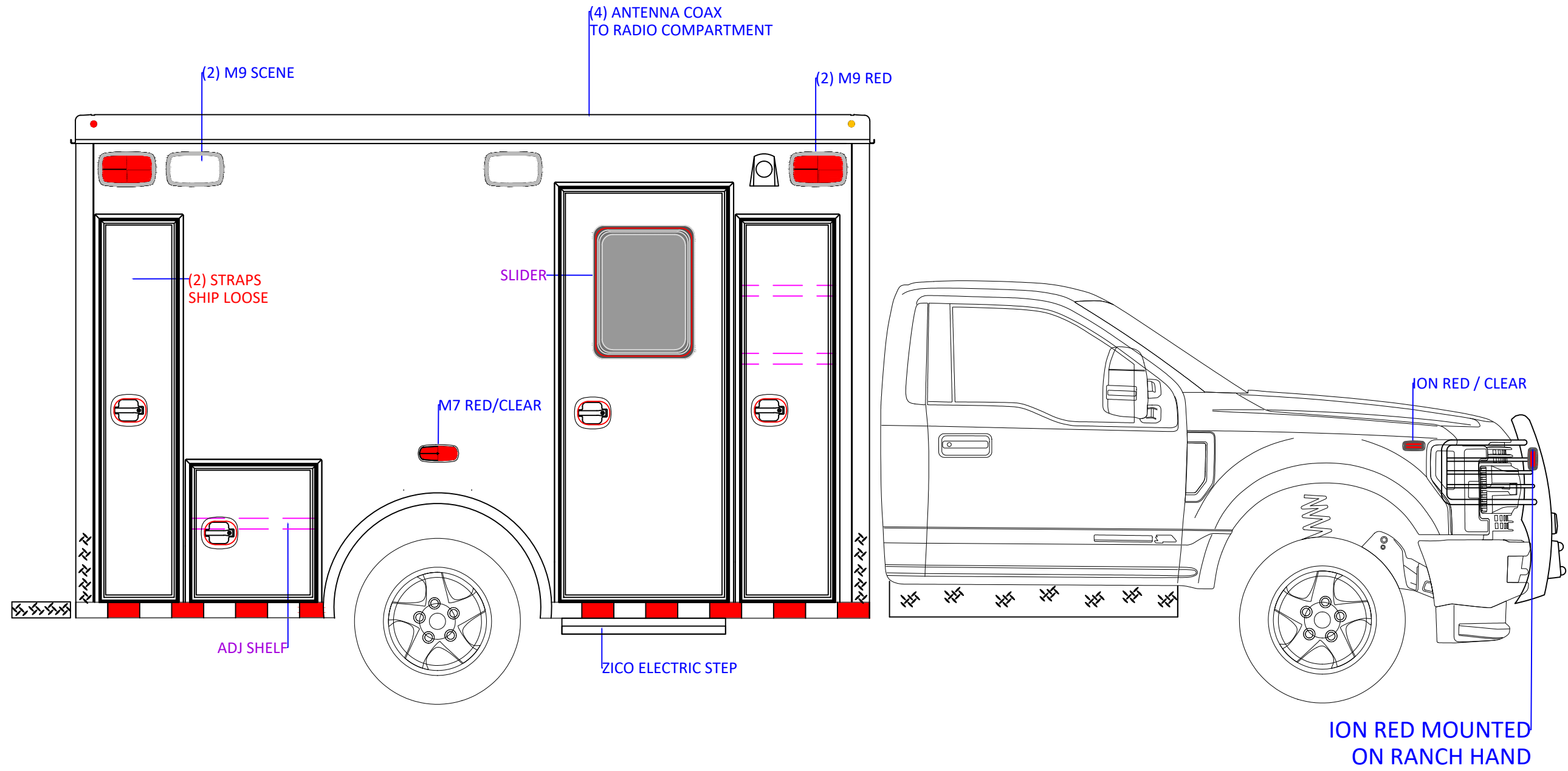

	BULLOCH		
	WORK ORDER		
	SIZE	PART	REVISION
	<b>B</b>		
WO#2	SCALE	DRAWN BY	DATE
		AK	

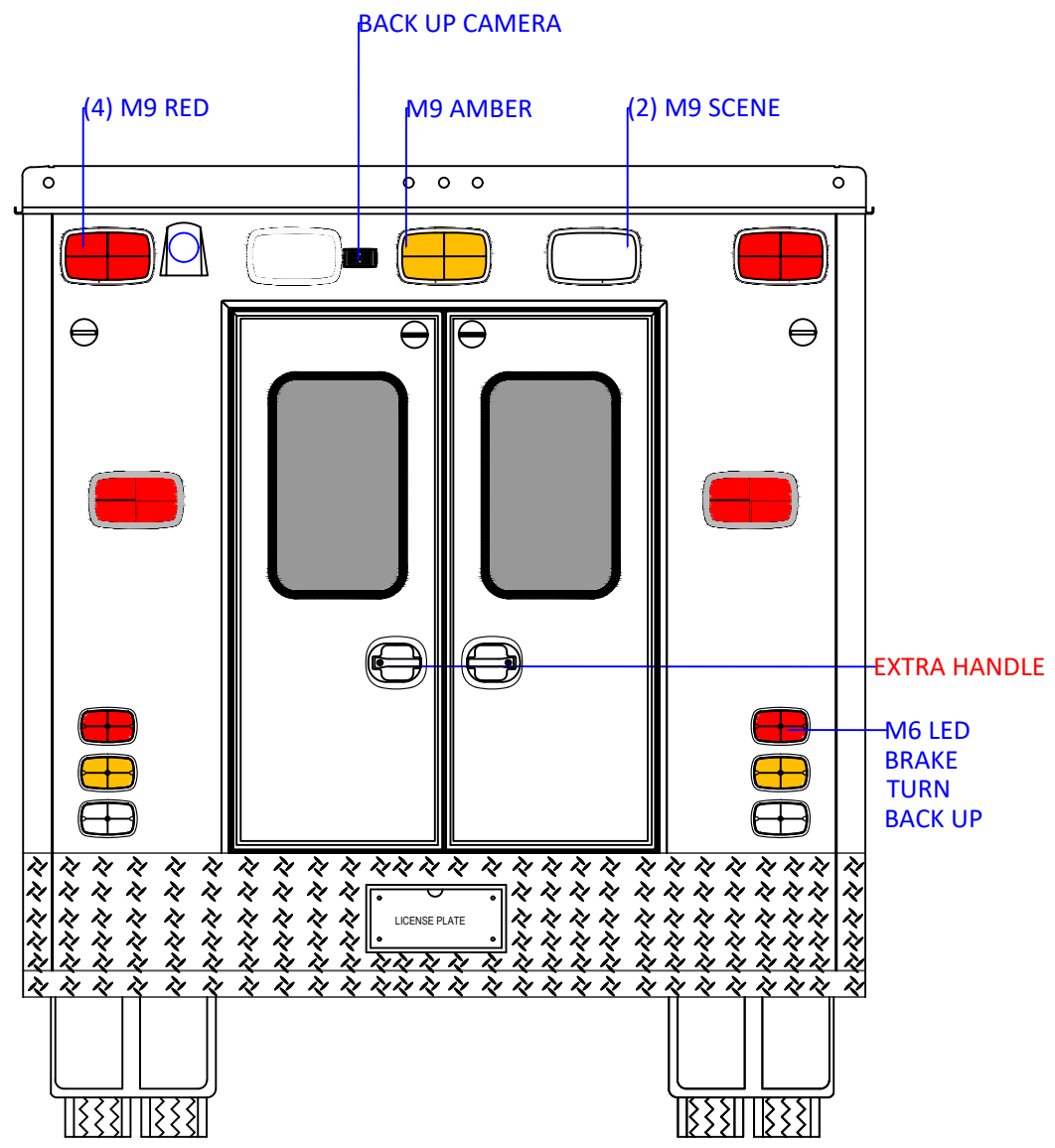
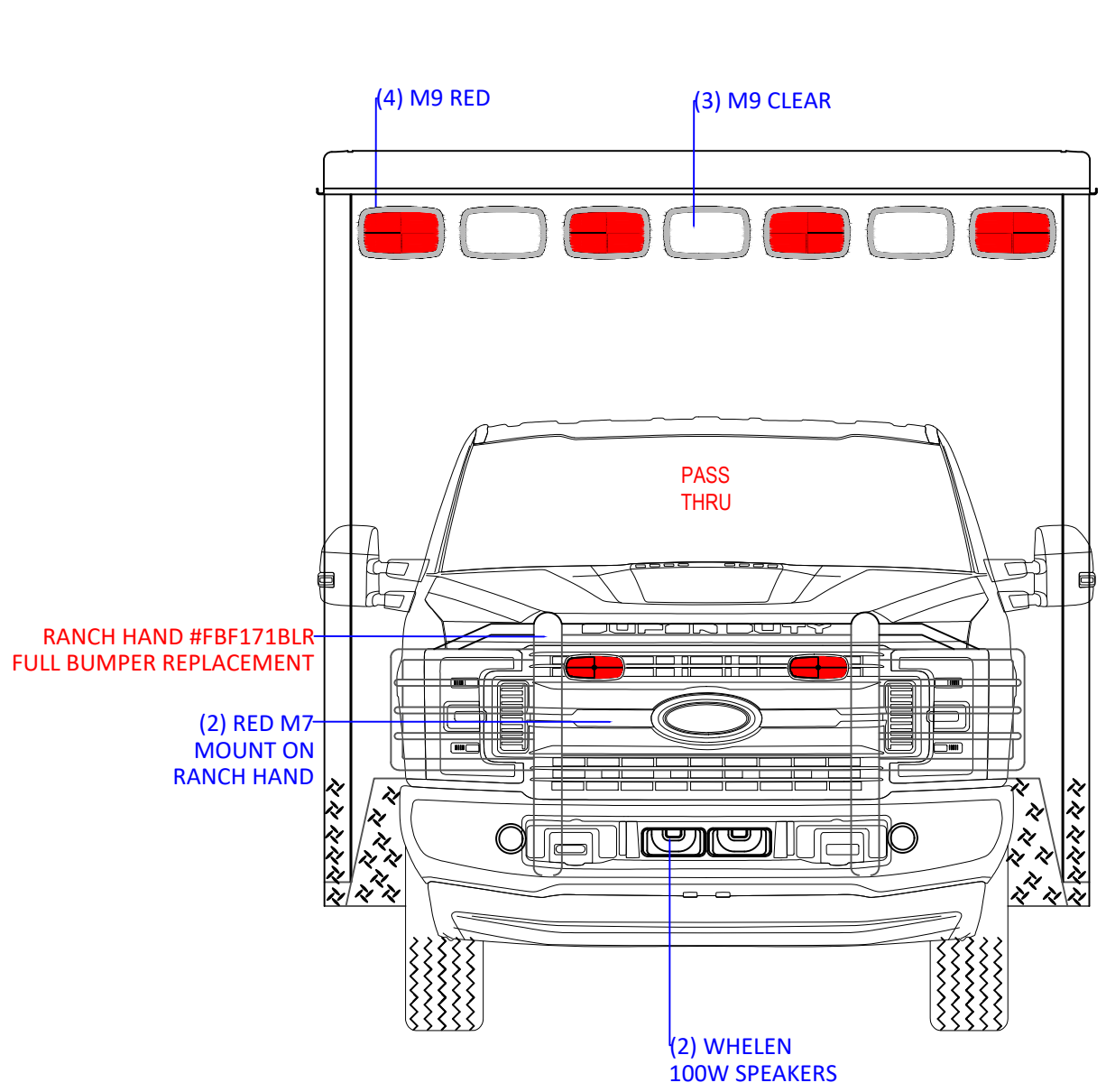

		BULLOCH	
		WORK ORDER	
	DATE	PART	REVISION
	<b>B</b>	FRONT/ REAR EXT.	
WO#3	SCALE	DRAWN BY	DATE
		AK	

CPR SEAT WITH FOLD-DOWN BACK  
NO 6PT HARNESS

IV POLE

ELECT O2  
SOLENOID

RICO SUCTION  
DO NOT MOUNT  
SHIP LOOSE

SWITCH PANEL

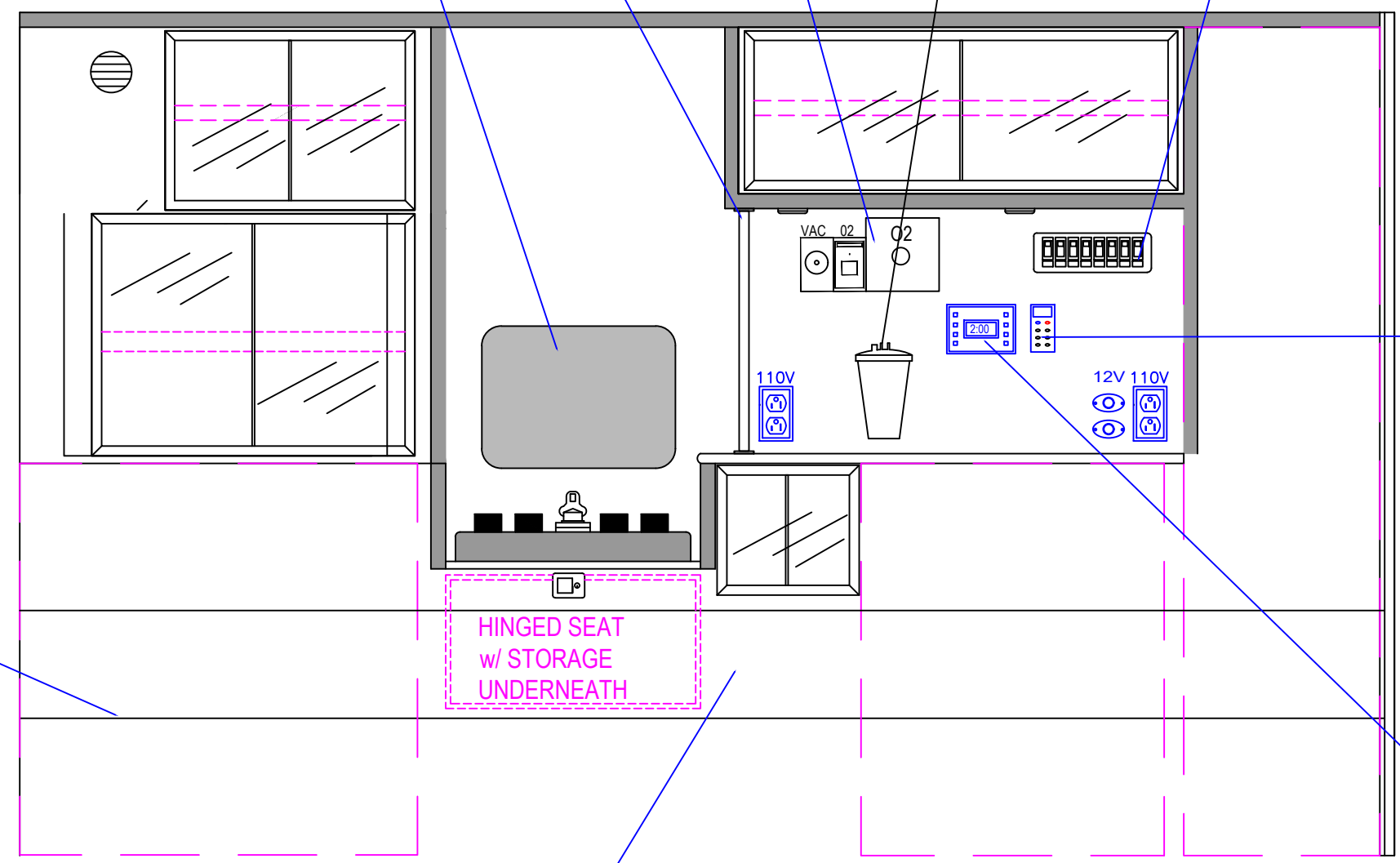

DIGITAL  
THERMOSTAT

POWER LOAD

HINGED SEAT  
w/ STORAGE  
UNDERNEATH

INTELLITEC

SS RISER

GLOSSY GRAY / WHITE FORMICA  
GUNMETAL UPHOLSTERY  
LONPLATE FLOORING  
WHITE COUNTERTOPS

		BULLOCH	
		WORK ORDER	
		SIZE <b>B</b>	PART DRIVER INT.
WO#4	SCALE	DRAWN BY AK	DATE

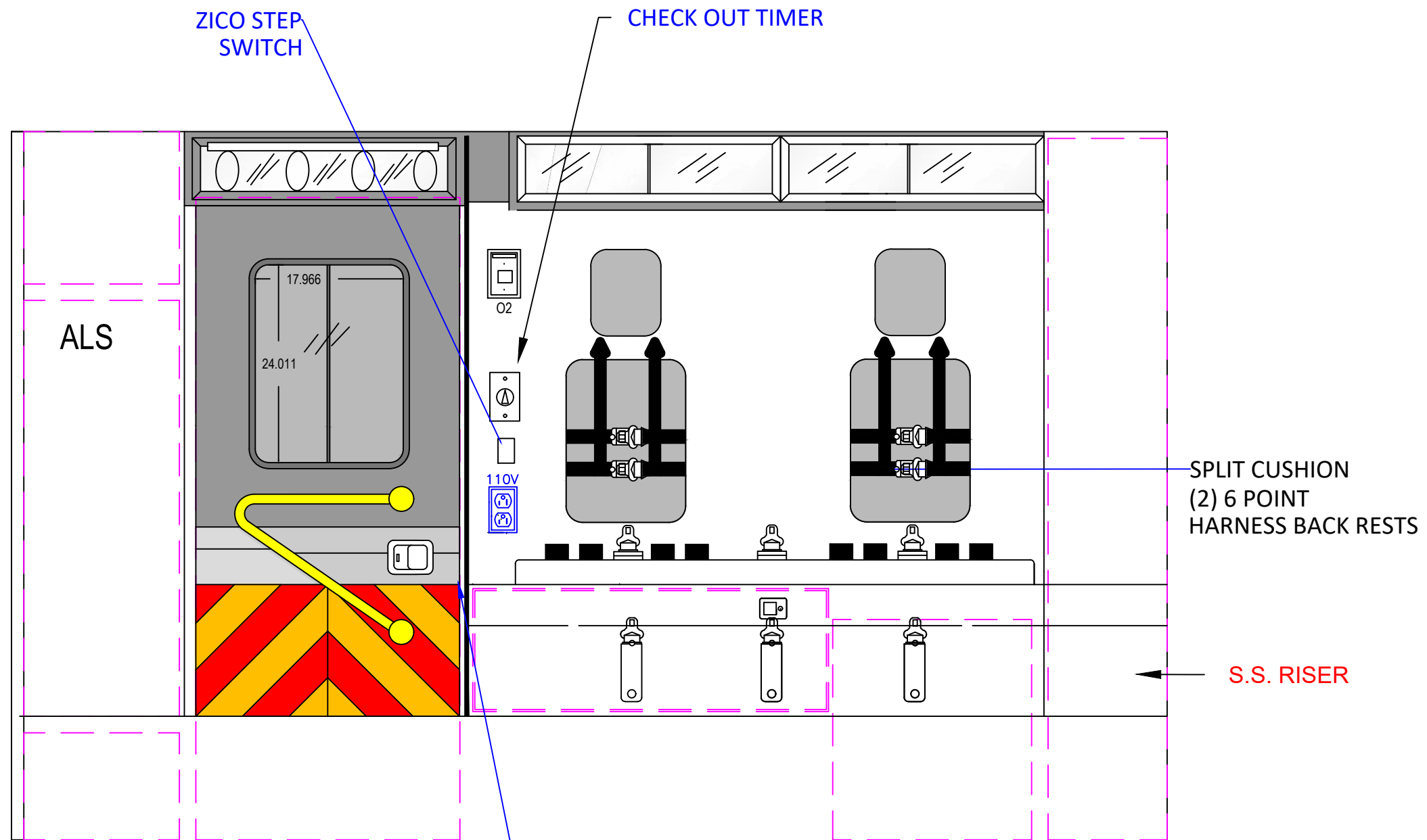

GLOSSY GRAY / GLOSSY WHITE FORMICA  
 GUNMETAL UPHOLSTERY  
 LONPLATE FLOORING  
 WHITE COUNTERTOPS

		BULLOCH	
		WORK ORDER	
	SIZE <b>B</b>	PART	REVISION
		PASSENGER INT.	
WO#5	SCALE	DRAWN BY AK	DATE

HOSELINE 12V  
 DUCTED / AUX CONDENSER  
 DIGITAL THERMOSTAT  
 HEAT VALVE HIGHER THAN STD  
 BLUE LED LIGHT

RADIO CABINET  
 FLIP UP

RC TRONICS.  
 ETHERNET (4) WIRES  
 TO CONSOLE.  
 PATTERN SWITCH FOR  
 WARNING LIGHTS.

PLEXI DOORS

MEDIKOOL  
 40SS w/ CompX  
 REGULATOR ELECT LOCK

WISE 3PT GUNMETAL  
 SWIVEL BASE

SHELF

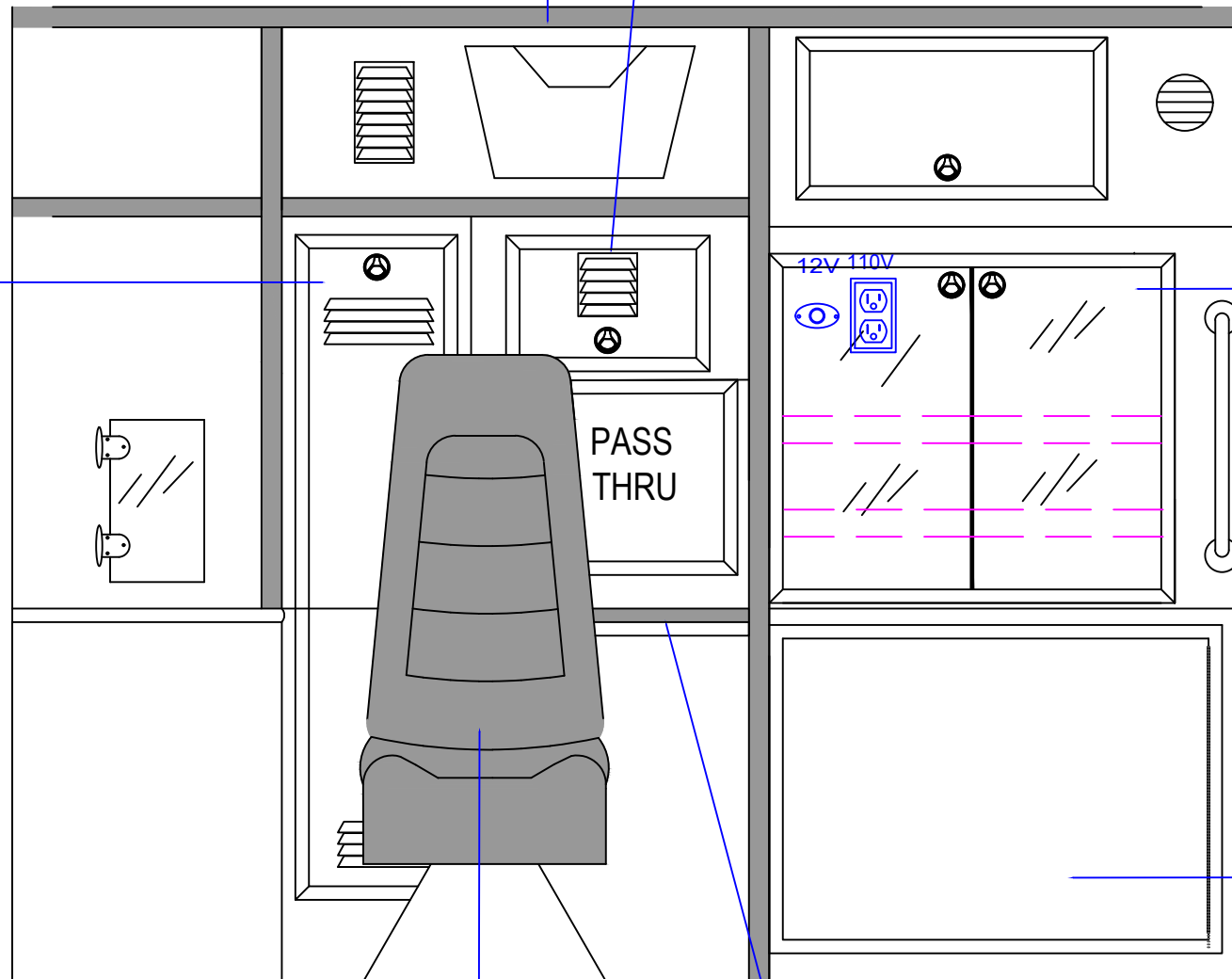

	BULLOCH		
	WORK ORDER		
	SCALE	DRAWN BY	DATE
WO#6	B	AK	

DRY ERASE  
MARKER BOARD  
30"x15"  
MOUNTED 12" DOWN FROM TOP  
AND 3" BACK FROM THE FACE

DUMP SWITCH  
ON DOOR

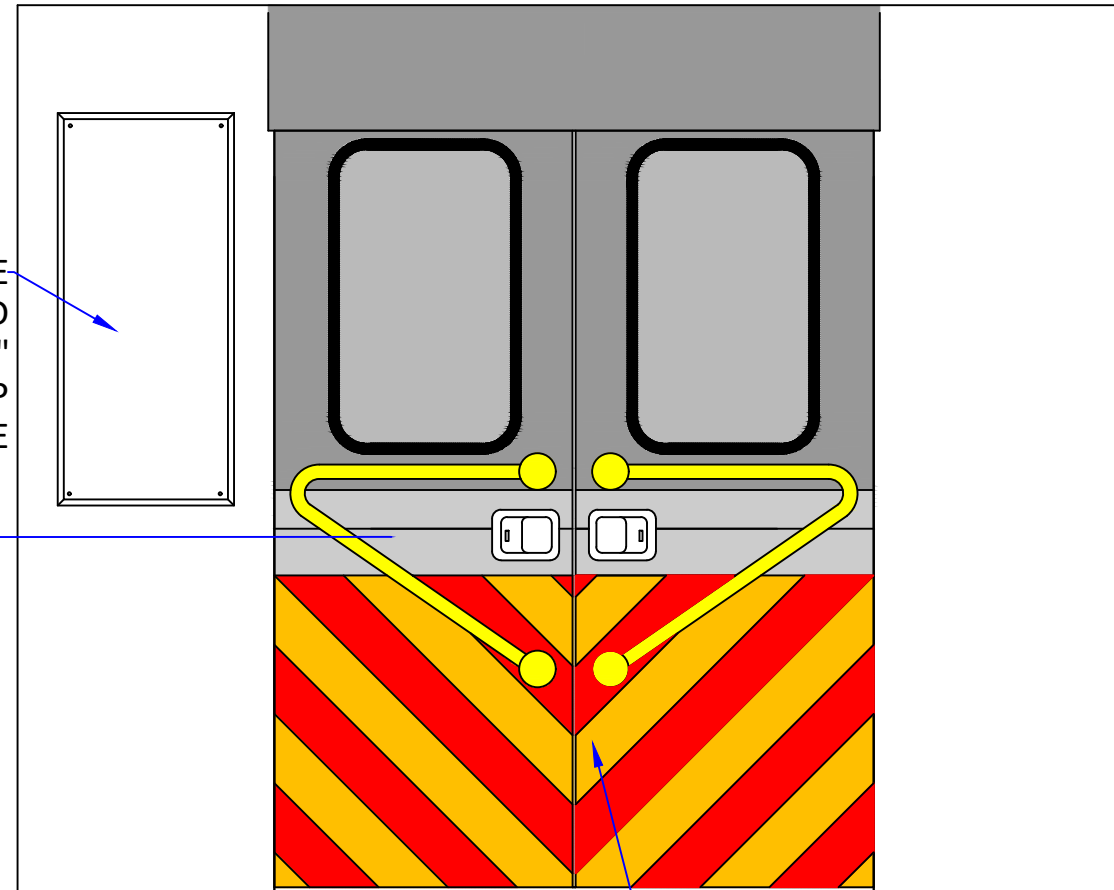

EMERGENCY RELEASE  
LATCHES

	BULLOCH		
	WORK ORDER		
	SIZE <b>B</b>	PART REAR INT.	REVISION
WO#7	SCALE	DRAWN BY AK	DATE

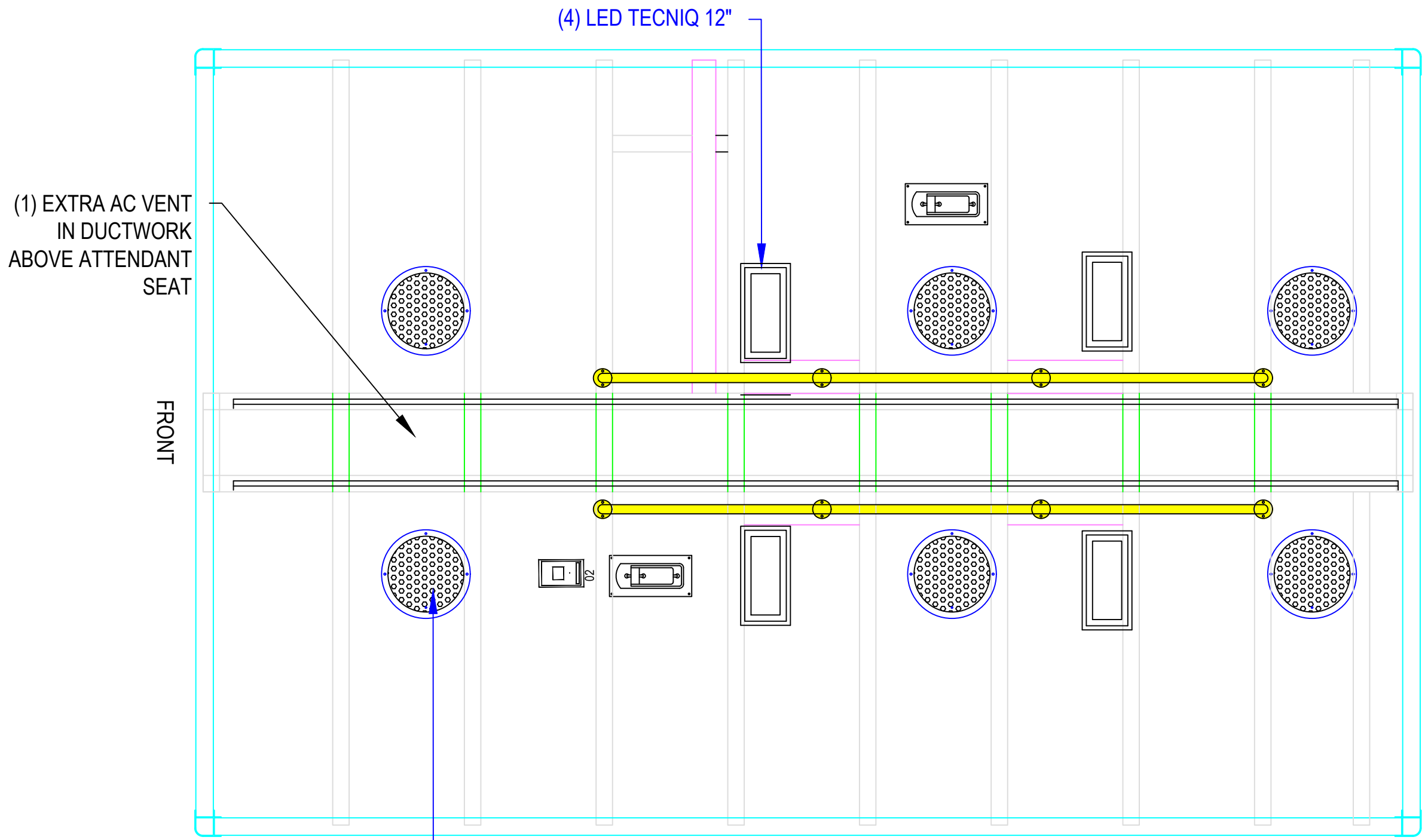

(1) EXTRA AC VENT  
IN DUCTWORK  
ABOVE ATTENDANT  
SEAT

FRONT

(4) LED TECNIQ 12"

(6) CODE 3 VIOSAFE  
DOME LIGHTS

EVERGREEN UV #ADU-136-PB LIGHT  
LAYOUT TO BE DETERMINED

		BULLOCH	
		WORK ORDER	
	SIZE	PART	REVISION
	<b>B</b>		
WO#8	SCALE	DRAWN BY	DATE
		AK	