

Drawing name: K:\AMT - WaterResources\013104000_Mitown Beltline Drainage-Home Depot\CAD\PlanSheets\CO-00 - CIVIL COVER SHEET.dwg CO-01 - GENERAL NOTES May 02, 2019 2:34pm by zac.randolph
This document, together with the concepts and designs presented herein, is intended only for the specific purpose and client for which it was prepared. Reuse of and improper reliance on this document without written authorization and adaptation by Kimley-Horn and Associates, Inc. shall be without liability to Kimley-Horn and Associates, Inc.

PROJECT INFORMATION:

- PROJECT:**
MIDTOWN BELTLINE DRAINAGE - HOME DEPOT
EASTSIDE BELTLINE TRAIL
- OWNER/DEVELOPER:**
ATLANTA BELTLINE INC.
100 PEACHTREE STREET NW
SUITE 2300
ATLANTA, GA 30303
CONTACT: KEVIN W. BURKE
- CIVIL ENGINEER:**
817 WEST PEACHTREE STREET, NW
THE BILTMORE, SUITE 601
ATLANTA, GA 30308
PHONE: (404) 419-8700
CONTACT: SEAN JOHNSTON, P.E.
- 24-HOUR CONTACT:**
TARIK ICGOREN
(404) 552-5248

PROJECT SITE INFORMATION:

- PROJECT LOCATION:**
EASTSIDE BELTLINE TRAIL
PROJECT ADDRESS 2
LAND LOT 80
14TH DISTRICT
FULTON COUNTY, GEORGIA
- PROJECT SITE AREA:**
DISTURBED AREA: ± 0.50 ACRES
TOTAL AREA: ± 0.50 ACRES

SURVEY INFORMATION:

FLOOD MAP INFORMATION:

SUBJECT PROPERTY DOES NOT LIE WITHIN FLOOD HAZARD AREA AS PER FIRM PANEL 13121C0263G, DATED 09/18/13.

ZONING INFORMATION:

L-1

CITY OF ATLANTA INFORMATION:

1. NOTIFICATIONS:

NOTIFY INSPECTOR 24 HOURS PRIOR TO CONSTRUCTION: CITY OF ATLANTA: (404) 546-1300

2. EROSION CONTROL VIOLATIONS:

THE CONTRACTOR MUST STOP ALL WORK AND RESTORE THESE AREAS IMMEDIATELY UPON NOTIFICATION BY THE CITY OF ATLANTA INSPECTOR AND/OR THE PROFESSIONAL ENGINEER.

CITY OF ATLANTA INFORMATION: (Continued)

3. MISCELLANEOUS:

- ALL REVISIONS TO THESE PLANS LOCATED IN THE ROW MUST BE SUBMITTED TO THE CITY OF ATLANTA DEPARTMENT OF PUBLIC WORKS PRIOR TO CONTINUING CONSTRUCTION. ALL REVISIONS TO THESE PLANS LOCATED OUT OF ROW MUST BE SUBMITTED TO CITY OF ATLANTA OFFICE OF BUILDINGS.
- ALL ROOFTOP APPURTENANCES, SATELLITE DISHES AND/OR OTHER COMMUNICATION DEVICES WILL BE SCREENED FROM ALL PUBLIC RIGHTS OF WAY.
- ALL TEMPORARY AND PERMANENT SIGNS TO BE PERMITTED SEPARATELY.
- IRRIGATION NOTES:
 - IRRIGATION SYSTEMS ARE NOT ALLOWED WITHIN THE PUBLIC RIGHT OF WAY
 - IRRIGATION COVER SPRAY ONTO PUBLIC ROADWAYS IS NOT ALLOWED
 - IRRIGATION SYSTEMS MUST BE SHUT OFF OR OPERATED MANUALLY DURING WINTER MONTHS TO PREVENT UNNECESSARY ICE ON ROADS.
- THE CITY ARBORIST MUST INSPECT THE SITE PRIOR TO LAND DISTURBANCE AND PRIOR TO THE ISSUANCE OF A CERTIFICATE OF OCCUPANCY.
- ALL GRADES IN TREE PROTECTION AREAS SHALL BE RETURNED TO THEIR ORIGINAL ELEVATION. NO UTILITY WORK SHALL OCCUR WITHIN THE TREE PROTECTION AREAS.
- OFF-STREET PARKING SHALL BE PROVIDED AND MAINTAINED THROUGHOUT CONSTRUCTION.
- CONTRACTOR SHALL FIELD VERIFY ALL UTILITIES PRIOR TO BEGINNING CONSTRUCTION.
- THE CONTRACTOR IS RESPONSIBLE FOR ALL AS-BUILT DRAWINGS OF ROADWAYS AND SANITARY SEWER FIELD APPROVAL BY THE INSPECTOR, AND ALL APPLICABLE BONDS REQUIRED PRIOR TO ACCEPTANCE OR ISSUANCE OF CERTIFICATE OF OCCUPANCY.

DEMOLITION INFORMATION:

6. NOTIFICATIONS:

THE CONTRACTOR SHALL NOTIFY THE OWNER AND CITY INSPECTOR(S) 24 HOURS PRIOR TO ANY DEMOLITION OR CONSTRUCTION.

7. DISPOSAL GUIDELINES:

- ONLY ITEMS SPECIFICALLY NOTED TO BE DEMOLISHED SHALL BE REMOVED FROM THE SITE.
- REMOVE EXISTING PAVED AREAS AS SHOWN INCLUDING DRIVEWAYS, SIDEWALKS, PARKING AREAS, SERVICE AREAS, EQUIPMENT PADS, AND ALL MISCELLANEOUS PAVING.
- ALL DEBRIS RESULTING FROM DEMOLITION SHALL BE REMOVED FROM THE SITE AND DISPOSED OF LEGALLY BY THE CONTRACTOR. BACKFILL ALL TRENCHES AND EXCAVATIONS RESULTING FROM DEMOLITION.
- ALL DEMOLISHED MATERIAL BECOMES THE PROPERTY OF THE CONTRACTOR UNLESS OTHERWISE NOTED.

3. TREE PROTECTION GUIDELINES:

PROTECT ALL EXISTING TREES AND ALL ITEMS TO BE TURNED OVER TO THE OWNER DURING DEMOLITION. TAKE ALL NECESSARY PRECAUTIONS AND PROTECTIVE MEASURES. ANY EXISTING ITEMS TO BE TURNED OVER TO THE OWNER WHICH ARE DAMAGED DURING DEMOLITION SHALL BE REPAIRED AT NO ADDITIONAL COST TO THE OWNER. TREES WHICH ARE DAMAGED WILL BE REPLACED OR REIMBURSED AT A RATE TO BE DETERMINED BY THE OWNER.

4. UTILITIES:

- PRIOR TO REMOVING OR ABANDONING ANY UTILITY THE CONTRACTOR SHALL VERIFY THAT NO UPSTREAM SERVICE WILL BE TERMINATED. THE CONTRACTOR SHALL INFORM THE ENGINEER IN WRITING OF ANY TERMINATION NOT SHOWN ON THE PLANS.
- ALL ABANDONED WATER LINES, STORM SEWER PIPE, SANITARY SEWER PIPES, GAS LINES, OR ANY OTHER ABANDONED UNDERGROUND UTILITY SHALL BE ABANDONED IN PLACE UNLESS NOTED OTHERWISE.

5. GRADING:

COMPACT AND ROUGH GRADE THE ENTIRE SITE IN ACCORDANCE WITH THE CONTRACT DOCUMENTS. ANY EXCAVATIONS IN THESE AREAS SHALL BE BACKFILLED, BUT DO NOT RAISE OR LOWER EXISTING GRADES.

SITE INFORMATION:

1. THE FOLLOWING ARE APPLICABLE TO ALL CIVIL DOCUMENTS:

- WHERE A DETAIL SECTION, TYPICAL SECTION, OR A NOTE IS SHOWN FOR ONE CONDITION, IT SHALL APPLY FOR ALL LIKE OR SIMILAR CONDITIONS, UNLESS OTHERWISE NOTED ON THE PLANS.
- EXISTING AND PROPOSED CONTOURS ARE AT ONE (1) FOOT INTERVALS.
- ALL DIMENSIONS ARE TO FACE OF CURB UNLESS OTHERWISE NOTED.
- ALL PIPE LENGTHS SPECIFIED IN THESE PLANS ARE THE HORIZONTAL DISTANCE AND ARE SHOWN FOR REFERENCE ONLY. IT IS THE RESPONSIBILITY OF THE CONTRACTOR TO DETERMINE ACTUAL LENGTHS BASED ON PROPOSED PIPE SLOPE.
- PIPE LENGTHS IN PLANS ARE MEASURED FROM CENTER OF STRUCTURE TO CENTER OF STRUCTURE UNLESS OTHERWISE NOTED.

CONTRACTOR RESPONSIBILITIES:

1. PRIOR TO CONSTRUCTION THE CONTRACTOR SHALL BE RESPONSIBLE FOR:

- THE CONTRACTOR SHALL VERIFY ALL PROPOSED AND EXISTING CONDITIONS INCLUDING UTILITIES (INVERTS, CONNECTIONS, MATERIALS, ETC.) AND DIMENSIONS WITHIN THE LIMITS OF WORK PRIOR TO THE START OF CONSTRUCTION.
- REFER TO ARCHITECTURAL DRAWINGS FOR DETAILED BUILDING INFORMATION.
- THE CONTRACTOR IS RESPONSIBLE FOR ALL NOTIFICATIONS AND LIAISONS WITH UTILITY COMPANIES DURING THE PROCESS OF LOCATING, RELOCATING, AND TYING INTO PUBLIC UTILITIES.
- PRIOR TO COMMENCING LAND DISTURBANCE ACTIVITY, THE LIMITS OF LAND DISTURBANCE SHALL BE CLEARLY AND ACCURATELY DEMARCATED WITH STAKES, RIBBONS, OR OTHER APPROPRIATE MEANS. THE LOCATION AND EXTENT OF ALL AUTHORIZED LAND DISTURBANCE SHALL OCCUR INSIDE THE APPROVED LIMITS INDICATED ON THE APPROVED PLANS.

2. DURING CONSTRUCTION THE CONTRACTOR SHALL BE RESPONSIBLE FOR:

- DEVIATIONS FROM THESE PLANS AND SPECIFICATIONS WITHOUT PRIOR WRITTEN CONSENT OF THE ENGINEER MAY CAUSE THE WORK TO BE UNACCEPTABLE.
- THE CONTRACTOR SHALL USE MATERIALS AND EMPLOY CONSTRUCTION METHODS IN ORDER TO COMPLY WITH THE DRAWINGS AND SPECIFICATIONS. WHERE A CONFLICT OCCURS, THE STRICTEST DESIGN SHALL GOVERN. THE ENGINEER'S REVIEW OF SHOP DRAWINGS, PRODUCT DATA, ETC., DOES NOT RELIEVE THE CONTRACTOR FROM COMPLYING WITH THE CONTRACT DOCUMENTS. THE CONTRACTOR SHALL INFORM THE ENGINEER IN WRITING OF ANY SPECIFIC DEVIATIONS AND OBTAIN ENGINEER'S WRITTEN APPROVAL OF THE SPECIFIC DEVIATION.
- IT IS SOLELY THE CONTRACTOR'S RESPONSIBILITY TO FOLLOW ALL APPLICABLE SAFETY CODES AND REGULATIONS DURING ALL PHASES OF CONSTRUCTION.
- ALL CONSTRUCTION MUST CONFORM TO THE STANDARDS, SPECIFICATIONS, AND CODES OF THE GOVERNING MUNICIPALITIES.
- CONSTRUCTION SHALL MEET ALL STANDARDS SET FORTH IN THE AMERICANS WITH DISABILITIES ACT.
- IF THE CONTRACTOR DAMAGES ANY EXISTING UTILITIES DURING CONSTRUCTION, HE SHALL, AT HIS OWN EXPENSE, REPLACE OR REPAIR THE UTILITIES TO ORIGINAL CONDITION AND QUALITY AS APPROVED BY THE OWNER AND REPRESENTATIVE OF THE APPROPRIATE UTILITY COMPANY.
- SUFFICIENT BARRICADES, LIGHTS, SIGNS, AND OTHER TRAFFIC CONTROL METHODS IN ACCORDANCE WITH GOVERNING ORDINANCES MAY BE NECESSARY FOR THE PROTECTION AND SAFETY OF THE PUBLIC. SAID CONTROL DEVICES SHALL BE PER THE MANUAL OF TRAFFIC CONTROL DEVICES, M.U.T.C.D., CURRENT EDITION, AND SHALL BE PROVIDED AND MAINTAINED THROUGHOUT CONSTRUCTION.
- TRAFFIC CONTROLS AND OTHER WARNING DEVICES SHALL BE INSTALLED PRIOR TO THE COMMENCEMENT OF ANY WORK ON CITY, COUNTY, OR GEORGIA DEPARTMENT OF TRANSPORTATION ROADS. THEY SHALL BE MAINTAINED THROUGHOUT CONSTRUCTION AND SHALL REMAIN IN PLACE UNTIL THE CONCLUSION OF ALL WORK.
- ALL WARNING DEVICES SHALL BE EITHER TYPE I BARRICADES OR DRUMS WITH WARNING LIGHTS ON EVERY OTHER DEVICE. THEY SHALL CONFORM TO THE MANUAL ON UNIFORM TRAFFIC CONTROL DEVICES (MUTCD), CURRENT EDITION, AND CITY OF ATLANTA STANDARDS FOR COLOR, SIZE, REFLECTIVITY, HEIGHT, AND PLACEMENT.
- FIRE DEPARTMENT ACCESS SHALL BE MAINTAINED AT ALL TIMES.
- CONTRACTOR SHALL SHORE AND BRACE ALL EARTH, FORMS, CONCRETE, STEEL, WOOD, AND MASONRY TO RESIST GRAVITY, EARTH, WIND, THERMAL, CONSTRUCTION, AND MISCELLANEOUS LOADS DURING CONSTRUCTION.
- ON-SITE BURIAL OF DEBRIS IS PROHIBITED.
- UNLESS OTHERWISE NOTED THE CONTRACTOR SHALL SUBMIT SHOP DRAWINGS OF ALL FABRICATED MATERIALS TO THE ENGINEER. DESIGN DOCUMENTS SHALL NOT BE REPRODUCED AS SHOP DRAWINGS.
- IN CASE OF UNFORESEEN CONSTRUCTION COMPLICATIONS OR DISCREPANCIES, THE CONTRACTOR IS TO IMMEDIATELY NOTIFY THE ENGINEER IN WRITING.
- ALL REQUIRED TESTING REPORTS SHALL BE AVAILABLE AT THE JOB SITE.
- AS-BUILT DRAWINGS OF ROADWAYS, STORM DRAINS, SANITARY SEWER AND WATER LINES, FIELD APPROVAL BY THE ENGINEER, AND ALL APPLICABLE BONDS ARE REQUIRED PRIOR TO FINAL ACCEPTANCE BY THE OWNER.
- UNLESS OTHERWISE NOTED ON THE DRAWINGS OR SPECIFICATIONS, ALL FILL AREAS MUST BE COMPACTED TO MINIMUM 95% STANDARD PROCTOR.
- CONTRACTOR SHALL MAINTAIN CONTINUOUS UTILITY SERVICE TO ALL EXISTING BUILDINGS THROUGHOUT CONSTRUCTION UNLESS APPROVAL FOR SERVICE INTERRUPTION IS OBTAINED FROM THE OWNERS IN ADVANCE.
- CUT AND FILL SLOPES SHALL NOT EXCEED 2:1 H:V.
- ACCESS TO VIEWPOINT TO REMAIN OPEN DURING CONSTRUCTION INCLUDING VEHICULAR, LOADING, EMERGENCY ACCESS AND EGRESS. CONTRACTOR TO COORDINATE IMPACTS WITH OWNER.

STORM DRAINAGE INFORMATION:

1. PIPES:

- UNLESS OTHERWISE NOTED ON THE DRAWING RCP SHALL BE CLASS III WITH "O" RING JOINTS.
- THE PIPE MANUFACTURER SHALL SUPPLY A CLASSIFICATION OF THE PIPE SPECIFICATIONS FOR EACH PIPE PRIOR TO INSTALLATION.
- PIPE INSTALLATION SHALL CONFORM TO THE DEPARTMENT OF TRANSPORTATION, STATE OF GEORGIA STANDARD SPECIFICATIONS FOR CONSTRUCTION OF ROADS AND BRIDGES, CURRENT EDITION.
- ALL ROOF DRAIN MANIFOLDS SHALL HAVE A MINIMUM SLOPE OF 1.00%.

2. STRUCTURES:

- ALL STRUCTURES SHALL BE MADE OF PRECAST CONCRETE. ALL INVERTS SHALL BE NEATLY FORMED UP TO THE SPRING LINE WITH MORTAR OR BRICK TO INSURE PROPER FLOW.
- CONTRACTOR SHALL BE RESPONSIBLE FOR VERIFYING ALL INVERTS AND PIPE SLOPES PRIOR TO INSTALLATION TO ENSURE PROPER COVER AND LENGTHS OF PIPE.

EROSION AND SEDIMENT CONTROL INFORMATION:

1. COMPREHENSIVE:

- THE ESCAPE OF SEDIMENT FROM THE SITE SHALL BE PREVENTED BY THE INSTALLATION OF EROSION AND SEDIMENT CONTROL MEASURES AND PRACTICES PRIOR TO OR CONCURRENT WITH LAND-DISTURBING ACTIVITIES.
 - PROVISIONS TO PREVENT EROSION OF SOIL FROM THE SITE SHALL BE AT A MINIMUM IN CONFORMANCE WITH THE REQUIREMENTS OF THE MANUAL FOR EROSION AND SEDIMENT CONTROL IN GEORGIA, LATEST EDITION, AND THE CITY OF ATLANTA CODES GOVERNING EROSION AND SEDIMENTATION CONTROL. IF FULL IMPLEMENTATION OF THE APPROVED PLAN DOES NOT PROVIDE FOR EFFECTIVE EROSION CONTROL, ADDITIONAL EROSION AND SEDIMENT CONTROL MEASURES SHALL BE IMPLEMENTED TO CONTROL OR TREAT THE SEDIMENT SOURCE.
 - FAILURE TO INSTALL, OPERATE, OR MAINTAIN ALL EROSION CONTROL MEASURES WILL RESULT IN ALL CONSTRUCTION BEING STOPPED ON THE JOB SITE UNTIL SUCH MEASURES ARE CORRECTED BACK TO THE STANDARDS SPECIFIED IN THE MANUAL FOR EROSION AND SEDIMENT CONTROL IN GEORGIA, CURRENT EDITION, AND CITY OF ATLANTA STANDARDS.
 - EROSION CONTROL MEASURES WILL BE MAINTAINED AT ALL TIMES. IF FULL IMPLEMENTATION OF THE APPROVED PLAN DOES NOT PROVIDE FOR EFFECTIVE EROSION CONTROL, ADDITIONAL EROSION AND SEDIMENT CONTROL MEASURES SHALL BE IMPLEMENTED TO CONTROL OR TREAT THE SEDIMENT SOURCE.
 - EROSION CONTROL DEVICES SHALL BE INSTALLED PRIOR TO LAND DISTURBANCE. THE LOCATION OF SOME OF THE EROSION CONTROL DEVICES MAY HAVE TO BE ALTERED FROM THAT SHOWN ON THE APPROVED PLANS IF DRAINAGE PATTERNS DURING CONSTRUCTION ARE DIFFERENT FROM THE FINAL PROPOSED DRAINAGE PATTERNS. IT IS THE CONTRACTOR'S RESPONSIBILITY TO ACCOMPLISH EROSION CONTROL FOR ALL DRAINAGE PATTERNS CREATED AT VARIOUS STAGES DURING CONSTRUCTION. ANY DIFFICULTY IN CONTROLLING EROSION DURING ANY PHASE OF CONSTRUCTION SHALL BE REPORTED TO THE ENGINEER IMMEDIATELY.
 - THE CONSTRUCTION OF THE SITE WILL COMMENCE WITH THE INSTALLATION OF EROSION CONTROL MEASURES SUFFICIENT TO CONTROL SEDIMENT DEPOSITS AND EROSION. ALL SEDIMENT CONTROL WILL BE MAINTAINED UNTIL ALL UPSTREAM GROUND WITHIN THE CONSTRUCTION AREA HAS BEEN COMPLETELY STABILIZED WITH PERMANENT VEGETATION AND ALL ROADS/DRIVEWAYS HAVE BEEN PAVED.
 - CONSTRUCTION EXITS SHALL BE CONSTRUCTED AT EACH POINT OF ENTRY OR EXIT FROM THE SITE AND SHALL BE MAINTAINED IN A CONDITION WHICH WILL PREVENT TRACKING OR FLOW OF MUD ONTO PUBLIC RIGHTS-OF-WAY. THIS MAY REQUIRE PERIODIC TOP DRESSING WITH STONE AS CONDITIONS DEMAND. REPAIR, AND/OR CLEANOUT OF ANY STRUCTURES USED TO TRAP SEDIMENT. ALL MATERIALS SPILLED, DROPPED, WASHED, OR TRACKED FROM VEHICLES OFF SITE ONTO PUBLIC RIGHTS-OF-WAY MUST BE REMOVED IMMEDIATELY.
 - IMMEDIATELY AFTER THE ESTABLISHMENT OF CONSTRUCTION EXITS, ALL PERIMETER EROSION CONTROL DEVICES AND STORMWATER MANAGEMENT DEVICES SHALL BE INSTALLED PRIOR TO ANY OTHER CONSTRUCTION.
 - ALL SILT BARRIERS MUST BE PLACED AS ACCESS IS OBTAINED DURING CLEARING. NO GRADING SHALL BE DONE UNTIL SILT BARRIER INSTALLATION.
 - EROSION CONTROL DEVICES ARE TO BE INSTALLED AND FULLY OPERATIONAL PRIOR TO ANY DEMOLITION.
 - SILT FENCE MUST MEET THE REQUIREMENTS OF SECTION 171 - TEMPORARY SILT FENCE OF THE DEPARTMENT OF TRANSPORTATION, STATE OF GEORGIA, STANDARD SPECIFICATIONS, CURRENT EDITION, THE MANUAL FOR EROSION AND SEDIMENT CONTROL IN GEORGIA, LATEST EDITION, AND CITY OF ATLANTA STANDARDS.
 - ADDITIONAL EROSION CONTROL MEASURES WILL BE EMPLOYED WHERE DETERMINED NECESSARY BY ACTUAL SITE CONDITIONS.
- #### 2. DURING CONSTRUCTION:
- ON-SITE DUST CONTROL DURING CONSTRUCTION SHALL BE IN ACCORDANCE WITH ALL LOCAL CODES AND REGULATIONS.
 - THE CONTRACTOR SHALL REMOVE ACCUMULATED SILT WHEN THE SILT IS WITHIN 12" OF THE TOP OF THE SILT FENCE UTILIZED FOR EROSION CONTROL.
 - ALL OPEN SWALES MUST BE GRASSED AND RIP-RAP MUST BE PLACED AS REQUIRED TO CONTROL EROSION. STONE FOR RIP-RAP SHALL CONSIST OF ROUGH UN-HEWN QUARRY GRANITE AS NEARLY IN RECTANGULAR SECTION AS PRACTICAL. THE MINIMUM SIZE STONE SHALL WEIGH BETWEEN 75 AND 150 POUNDS AND SHALL BE HAND PLACED AS A LOOSE STONE EMBANKMENT.
 - ANY DISTURBED AREA LEFT EXPOSED FOR A PERIOD GREATER THAN 14 DAYS SHALL BE STABILIZED WITH MULCH OR TEMPORARY SEEDING.
 - AT ANY TIME DURING CONSTRUCTION IF IT BECOMES NECESSARY TO PUMP STORM WATER OR GROUNDWATER FROM AN EXCAVATION, THE PUMPED WATER MUST MEET THE TURBIDITY REQUIREMENTS OUTLINED IN THE SITE SPECIFIC COMPREHENSIVE MONITORING PROGRAM. WATER THAT DOES NOT MEET THESE REQUIREMENTS MUST BE FILTERED OR DISCHARGED INTO A TEMPORARY SEDIMENT BASIN UNTIL IT MEETS THE TURBIDITY REQUIREMENTS. ONCE THE TURBIDITY REQUIREMENTS HAVE BEEN MET THE WATER MAY BE DISCHARGED INTO THE STORM SEWER SYSTEM. AS A MINIMUM TURBIDITY TESTS SHOULD BE PERFORMED AS FOLLOWS:
 - DURING DRY CONDITIONS: ONE TEST EVERY TWO WEEKS
 - DURING WET CONDITIONS: ONE TEST PER WEEK AND AFTER EACH QUALIFYING RAINFALL EVENT.
 - DURING SIGNIFICANT GRADING ACTIVITIES: ONE TEST PER WEEK UNTIL THE SITE IS STABLE.
- THESE SAME REQUIREMENTS APPLY TO ALL AUTHORIZED NON-STORM WATER DISCHARGES UNDER THE STATE OF GEORGIA DEPARTMENT OF NATURAL RESOURCES (DNR) ENVIRONMENTAL PROTECTION DIVISION (EPD) GENERAL PERMIT NO. GAR 100000, AUTHORIZATION TO DISCHARGE UNDER THE NATIONAL POLLUTANT DISCHARGE ELIMINATION SYSTEM (NPDES) FOR STORM WATER DISCHARGES ASSOCIATED WITH CONSTRUCTION ACTIVITY.
- NO GRADED SLOPE SHALL EXCEED 2H:1V.

GRADING & DRAINAGE NOTES:

- SITE AREA: 0.50 ACRES
DISTURBED AREA: 0.50 ACRES
- CRITICAL SPOT GRADES ARE TO PAVEMENT GRADE UNLESS OTHERWISE NOTED.
- CONTRACTOR SHALL CONSTRUCT ALL SIDEWALKS AND CROSSWALKS WITH A 2.0% MAXIMUM CROSS SLOPE AND A 5.0% MAXIMUM RUNNING SLOPE. UNLESS NOTED AS A RAMP, GRADES WITHIN ADA HANDICAP PARKING AREAS NOT TO EXCEED A 2% MAXIMUM SLOPE IN ANY DIRECTION.
- ALL ROOF DRAIN PIPING SHALL BE PVC UNLESS OTHERWISE NOTED.
- ALL ROOF DRAIN CLEANOUTS IN PAVED AREAS SHALL HAVE A BRASS CAP SET FLUSH WITH THE PROPOSED GRADE.
- ALL PIPE LENGTHS SPECIFIED IN THESE PLANS ARE THE HORIZONTAL DISTANCE AND ARE SHOWN FOR REFERENCE ONLY. IT IS THE RESPONSIBILITY OF THE CONTRACTOR TO DETERMINE ACTUAL LENGTHS BASED ON PROPOSED PIPE SLOPE. PIPE LENGTHS IN PLANS ARE MEASURED FROM CENTER OF STRUCTURE TO CENTER OF STRUCTURE UNLESS OTHERWISE NOTED.
- THIS PROJECT DOES NOT LIE WITHIN A 100 YEAR FLOOD HAZARD ZONE AS DEFINED BY THE F.E.M.A. "FLOOD HAZARD BOUNDARY MAP" COMMUNITY PANEL NUMBER 13121C0263G, DATED 09/18/13.
- UTILITIES MAY EXIST WHICH ARE NOT SHOWN ON THE PLANS. THE CONTRACTOR SHALL BE RESPONSIBLE FOR CONTACTING ALL UTILITY COMPANIES HAVING UTILITIES WITHIN OR ADJACENT TO THE WORK AREA. THE CONTRACTOR SHALL HAVE THE UTILITIES FIELD LOCATED AND COORDINATE WITH THE UTILITY COMPANIES TO HAVE CONFLICTS RELOCATED WHEN NECESSARY OR ADAPTED FOR THE-INS.
- CONTRACTOR TO FIELD VERIFY EXISTING INVERT FOR SANITARY SEWER AND STORM DRAINAGE SERVICE CONNECTIONS PRIOR TO CONSTRUCTION. CONTRACTOR SHALL NOTIFY ENGINEER OF DISCREPANCY PRIOR TO PROCEEDING.
- NO GRADED SLOPE SHALL EXCEED 2H:1V
- ALL WALLS GREATER THAN 30" IN HEIGHT SHALL BE DESIGNED AND PERMITTED BY AN ENGINEER LICENSED IN THE STATE OF GEORGIA.
- ALL WALLS GREATER THAN 30" IN HEIGHT SHALL HAVE FALL PROTECTION THROUGH FENCING OR HANDRAIL AT A MINIMUM OF 42" TALL. REFERENCE LANDSCAPE PLANS FOR DETAILS.
- THE INFILTRATION FOR THE STORMWATER SYSTEM IS BASED ON IN-SITU TESTING BY GEOTECHNICAL ENGINEER. THE SYSTEM IS BASED ON OBTAINING INFILTRATION RATES SIMILAR TO THE TESTED VALUES PRE-CONSTRUCTION. AS SUCH, THE AREAS WHERE STORMWATER IS DIRECTED TO INFILTRATE ARE TO REMAIN RESIDUAL. SOILS AND COMPACTION IS TO BE LIMITED TO ENSURE THE SOIL CHARACTERISTICS CONTINUE TO FUNCTION AS TESTED PRE-CONSTRUCTION. IF THESE AREAS ARE DISTURBED, COMPACTED, OR FILLED, THE ENGINEER IS TO BE NOTIFIED AS ADDITIONAL TESTING AND COORDINATION WOULD BE REQUIRED TO ENSURE THE PREVIOUSLY RECORDED INFILTRATION RATES CAN BE ACHIEVED.

NO.	REVISIONS	DATE

Kimley»Horn
© 2019 KIMLEY-HORN AND ASSOCIATES, INC.
817 W. PEACHTREE STREET, NW
THE BILTMORE, SUITE 601
ATLANTA, GEORGIA 30308
PHONE: (404) 419-8700
WWW.KIMLEY-HORN.COM

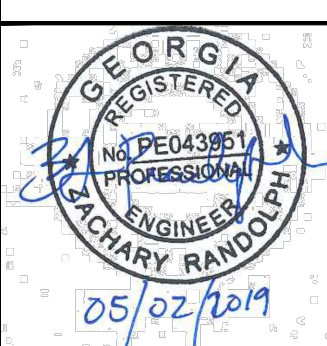

SCALE:	N.T.S.
DRAWN BY:	JRN
DESIGNED BY:	ZLR
CHECKED BY:	KRT

CLIENT: ATLANTA BELTLINE
PROJECT: EASTSIDE TRAIL DRAINAGE
TITLE: GENERAL NOTES
86 PRYOR STREET, SW, SUITE 200
ATLANTA, GA 30303
PHONE: (404) 880-4100

PROJECT:	EASTSIDE TRAIL DRAINAGE
TITLE:	GENERAL NOTES
DATE	05/01/19
PROJECT NO.	013104000
SHEET NUMBER	C0-01

Drawing name: K:\AMT - WaterResources\013104000 - Midtown Beltline Drainage-Home Depot\CAD\PlanSheets\C1-00 - EXISTING CONDITIONS PLAN.dwg May 02, 2019 2:34pm By: zack.randolph
 This document, together with the concepts and designs presented herein, as an instrument of service, is intended only for the specific purpose and client for which it was prepared. Reuse of and improper reliance on this document without written authorization and adaptation by Kimley-Horn and Associates, Inc. shall be without liability to Kimley-Horn and Associates, Inc.

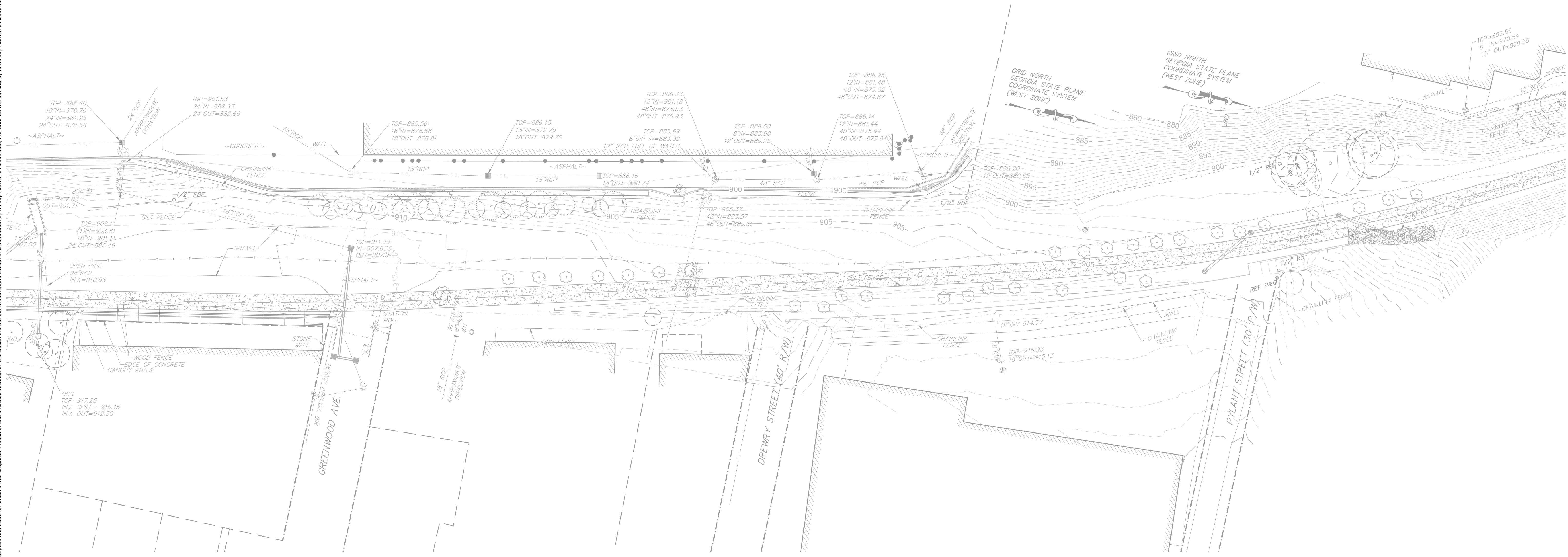

EXISTING CONDITIONS NOTES:

- EXISTING CONDITIONS SHOWN HEREON ARE FROM A SURVEY FILE PROVIDED BY ACKERMAN LAND SURVEYING INC. DATED 01/21/2016.
- UTILITIES MAY EXIST WHICH ARE NOT SHOWN ON THE PLANS. THE CONTRACTOR SHALL BE RESPONSIBLE FOR CONTACTING ALL UTILITY COMPANIES HAVING UTILITIES WITHIN OR ADJACENT TO THE WORK AREA. THE CONTRACTOR SHALL HAVE THE UTILITIES FIELD LOCATED AND COORDINATE WITH THE UTILITY COMPANIES TO HAVE CONFLICTS RELOCATED WHEN NECESSARY OR ADAPTED FOR TIE-INS.
- WHERE EXISTING RUNOFF LEAVES THE SITE IN A SHEET FLOW CONDITION, RUNOFF SHALL LEAVE THE SITE IN A SHEET FLOW CONDITION AFTER DEVELOPMENT.

No.	REVISIONS	DATE	BY
7			
6			
5			
4			
3			
2			
1			

Kimley-Horn
 © 2019 KIMLEY-HORN AND ASSOCIATES, INC.
 817 W. PEACHTREE STREET, NW
 THE BILTMORE, SUITE 601
 ATLANTA, GEORGIA 30308
 PHONE: (404) 419-3700
 WWW.KIMLEY-HORN.COM

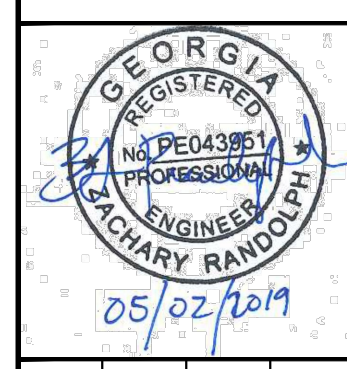

SCALE: 1" = 40'
 DRAWN BY: JRN
 DESIGNED BY: ZLR
 CHECKED BY: KRT

CLIENT: ATLANTA BELTLINE
 86 PRYOR STREET, SW, SUITE 200
 ATLANTA, GA 30303
 PHONE: (404) 880-4100

PROJECT: EASTSIDE TRAIL DRAINAGE
 TITLE: EXISTING CONDITIONS PLAN

DATE: 05/01/19
 PROJECT NO.: 013104000
 SHEET NUMBER: C1-00

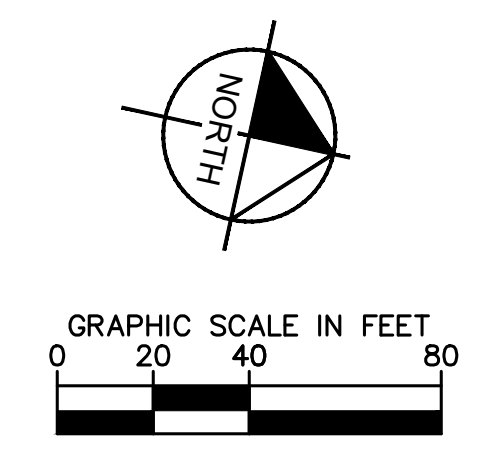

Drawing name: K:\MINT - WaterResources\013104000 - Midtown Beltline Drainage-Home Depot\CAD\PlanSheets\C2-00 - SITE PLAN.dwg C2-00 SITE PLAN May 02, 2019 2:34pm by zac.randolph
 This document, together with the concepts and designs presented herein, is intended only for the specific purpose and client for which it was prepared. Reuse and improper reliance on this document without written authorization and adaptation by Kimley-Horn and Associates, Inc. shall be without liability to Kimley-Horn and Associates, Inc.

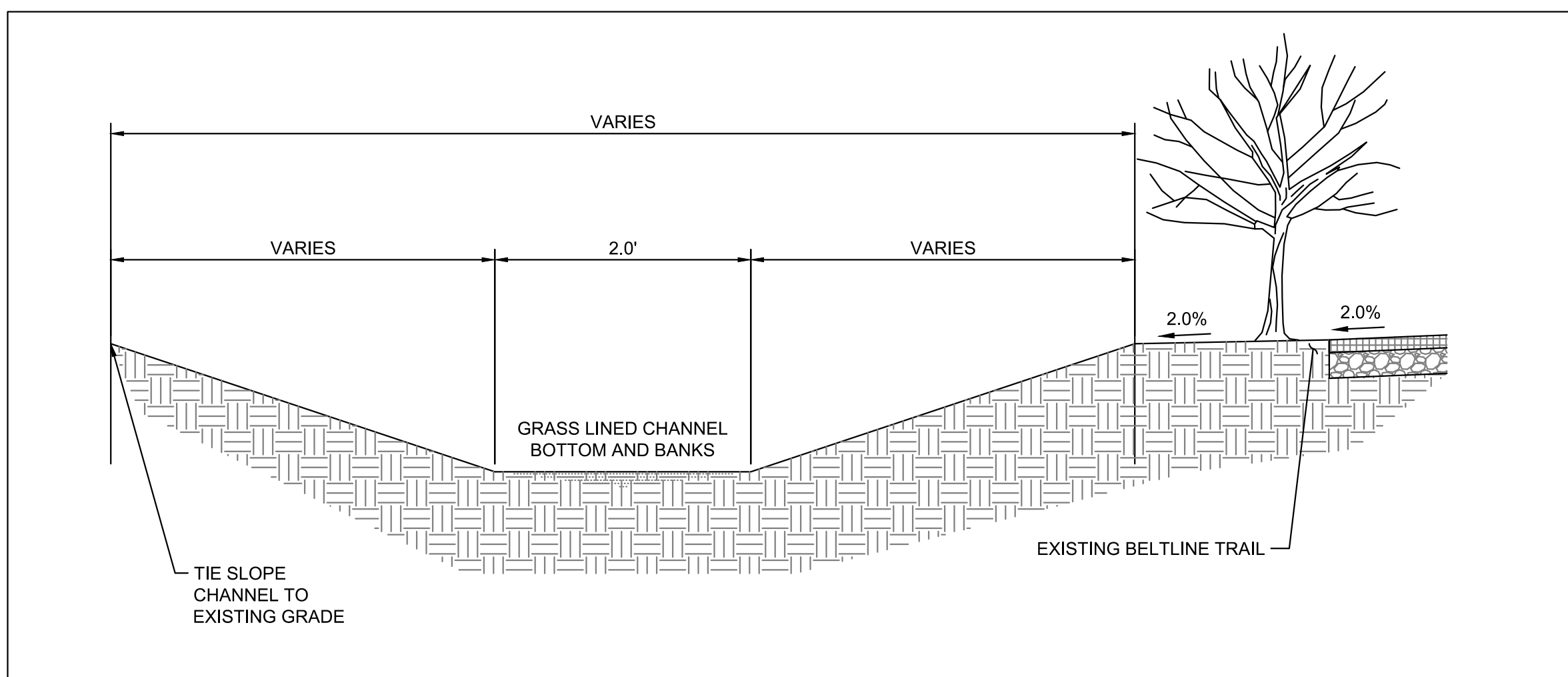
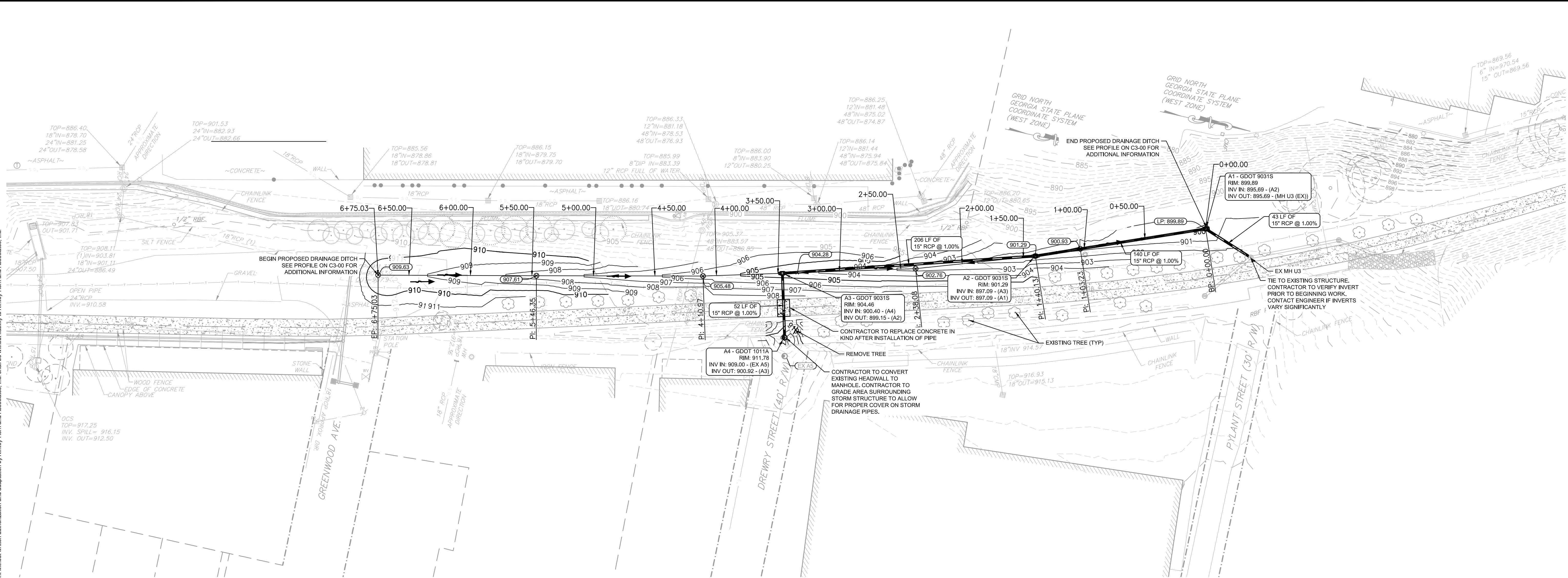

DETAIL 1
DRAINAGE DITCH - TYPICAL DETAIL
 SCALE = N.T.S.

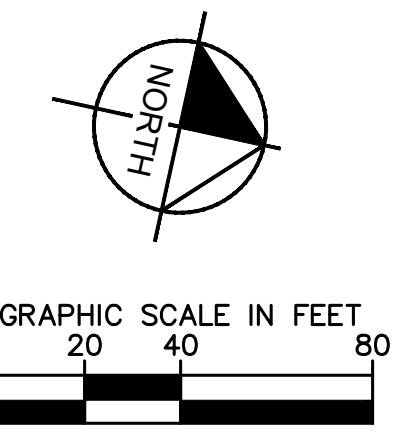

GEORGIA811
 Utilities Protection Center, Inc.
 Know what's below.
 Call before you dig.

PROJECT:	EASTSIDE TRAIL DRAINAGE	DATE	05/01/19
	TITLE:		PROJECT NO.
CLIENT:	ATLANTA BELTLINE	SHEET NUMBER	C2-00
	86 PRYOR STREET, SW, SUITE 200 ATLANTA, GA 30303 PHONE: (404) 880-4100		REVISIONS
SCALE:	1" = 40'	No.	7
DRAWN BY:	JRN		6
DESIGNED BY:	ZLR		5
CHECKED BY:	KRT	4	
		3	
		2	
		1	
		No.	
		DATE	

Kimley-Horn
 © 2019 KIMLEY-HORN AND ASSOCIATES, INC.
 817 W. PEACHTREE STREET, NW
 THE BELTLINE, SUITE 601
 ATLANTA, GEORGIA 30308
 PHONE: (404) 419-9700
 WWW.KIMLEY-HORN.COM

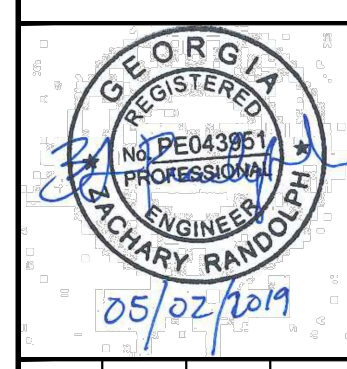

Drawing name: K:\A\T...WaterResources\013104000_Midtown Beltline Drainage-Home Depot\CAD\PlanSheets\C3-00 - STORM PROFILES May 02, 2019 2:35pm by: zac.randolph
 This document, together with the concepts and designs presented herein, is intended only for the specific purpose and client for which it was prepared. Reuse and improper reliance on this document without written authorization and adaptation by Kimley-Horn and Associates, Inc. shall be without liability to Kimley-Horn and Associates, Inc.

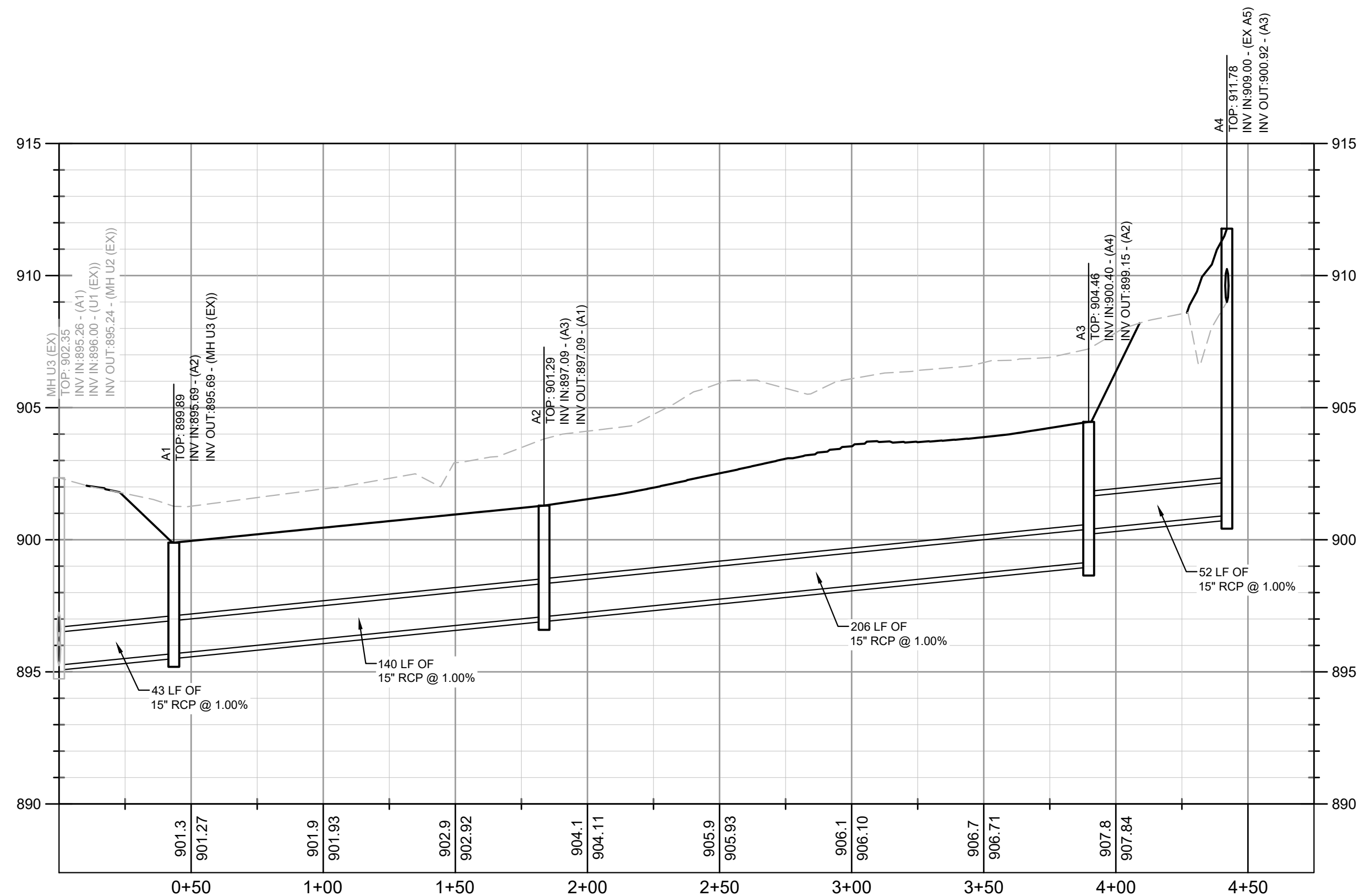

PROFILE VIEW
 EX MH U3 TO A4
 1" = 40' HORZ.
 1" = 4' VERT.

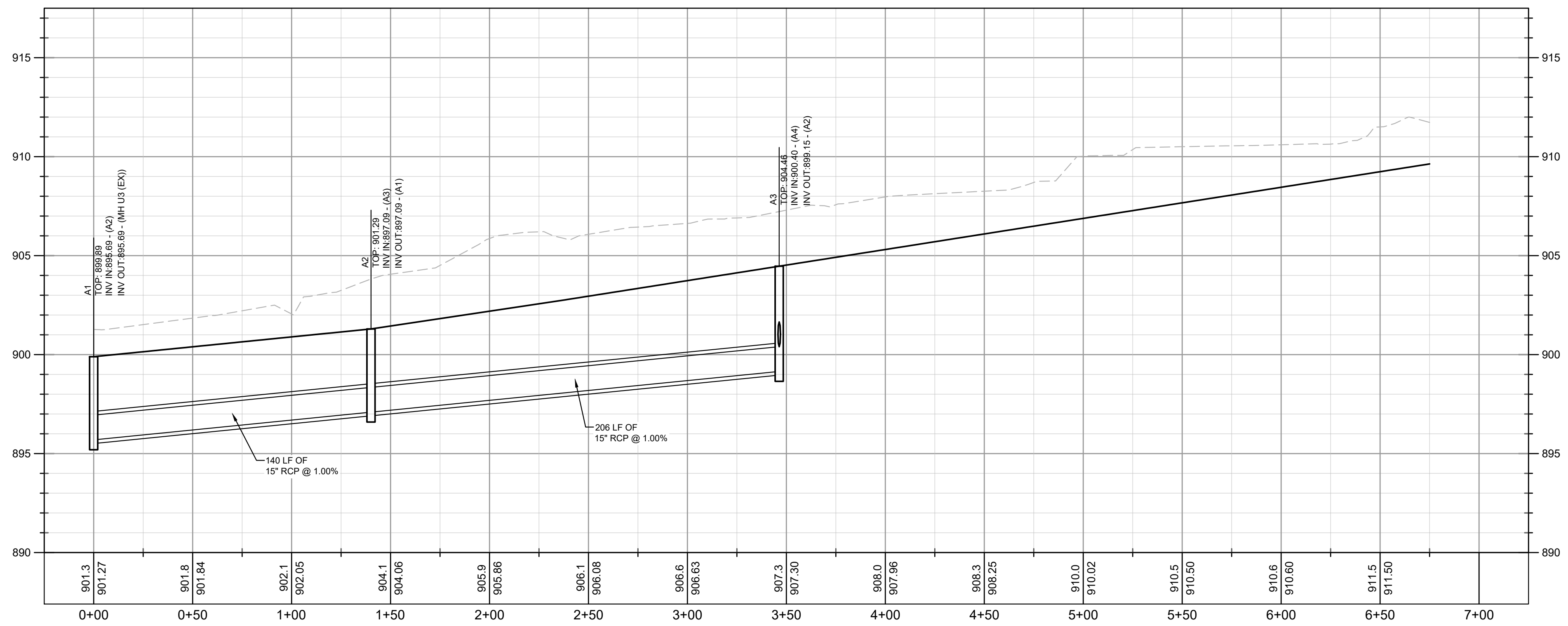

PROFILE VIEW
 CENTERLINE OF SWALE
 1" = 40' HORZ.
 1" = 4' VERT.

STORM DRAINAGE PROFILE NOTES:

1. ALL PIPE LENGTHS SPECIFIED IN THESE PLANS ARE THE HORIZONTAL DISTANCE AND ARE SHOWN FOR REFERENCE ONLY. IT IS THE RESPONSIBILITY OF THE CONTRACTOR TO DETERMINE ACTUAL LENGTHS BASED ON PROPOSED PIPE SLOPE. PIPE LENGTHS IN PLANS ARE MEASURED FROM CENTER OF STRUCTURE TO CENTER OF STRUCTURE UNLESS OTHERWISE NOTED.
2. CONTRACTOR TO FIELD VERIFY EXISTING INVERT FOR STORM DRAINAGE SERVICE CONNECTIONS PRIOR TO CONSTRUCTION. CONTRACTOR SHALL NOTIFY ENGINEER OF DISCREPANCY PRIOR TO PROCEEDING.
3. ALL STORM PIPE SHALL HAVE BEDDING PER BEDDING DETAILS IN CONSTRUCTION DETAIL SHEETS.
4. ALL STORM PIPING TO BE RCP UNLESS OTHERWISE NOTED. SEE CHART FOR PIPE CLASS.
5. RIM ELEVATIONS GIVEN ARE APPROXIMATE. CONTRACTOR SHALL REFERENCE GRADING PLAN FOR STRUCTURE THROAT / RIM ELEVATIONS.
6. IF ANY CONFLICTS, DISCREPANCIES, OR ANY OTHER UNSATISFACTORY CONDITIONS ARE DISCOVERED, EITHER ON THE CONSTRUCTION DOCUMENTS OR FIELD CONDITIONS, THE CONTRACTOR MUST NOTIFY THE ENGINEER IMMEDIATELY AND SHALL NOT COMMENCE FURTHER OPERATION UNTIL THE CONFLICTS, DISCREPANCIES, OR OTHER UNSATISFACTORY CONDITIONS ARE RESOLVED.
7. ALL STORM JOINTS TO BE WATER TIGHT.

PROFILE LINE LEGEND:

- PROPOSED GRADE LINE
- - - EXISTING GRADE LINE

RCP PIPE CLASSIFICATION CHART:

1-15' CLASS III
 15'-20' CLASS IV
 20'-30' CLASS V

ALL CONCRETE PIPE SHALL BE A MINIMUM CLASS III WITH 12" MINIMUM COVER. REFERENCE GDOT DETAIL 1030D FOR ADDITIONAL GUIDANCE.

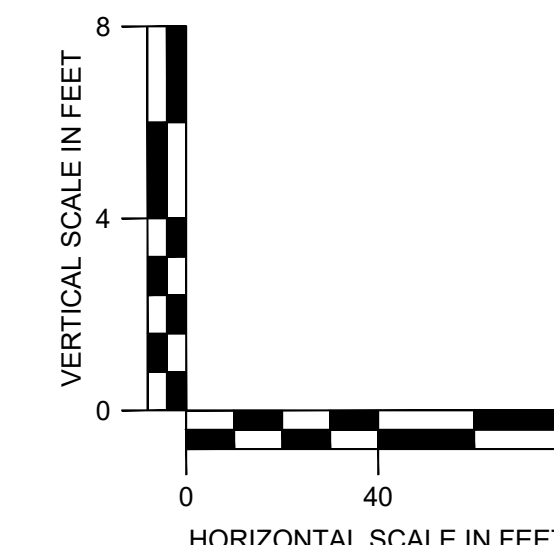

PROJECT:	EASTSIDE TRAIL DRAINAGE	CLIENT:	ATLANTA BELTLINE
TITLE:	STORM PROFILES	SCALE:	1" = 40'
DATE:	05/01/19	DRAWN BY:	JRN
PROJECT NO.:	013104000	DESIGNED BY:	ZLR
SHEET NUMBER:	C3-00	CHECKED BY:	KRT
		REVISONS	DATE
		No.	
		7	
		6	
		5	
		4	
		3	
		2	
		1	

Drawing name: K:\M\T - WaterResources\013104000 - Erosion Control\Plan Sheets\C4-11 - Erosion Control Details May 02, 2019 2:35pm by: zac.randolph
This document, together with the concepts and designs presented herein, is intended only for the specific purpose and client for which it was prepared. Reuse of and improper reliance on this document without written authorization and adaptation by Kimley-Horn and Associates, Inc. shall be without liability to Kimley-Horn and Associates, Inc.

MATERIAL	DEPTH
DRY STRAW OR HAY	2" TO 4"
WOOD WASTE (SAWDUST, BARK, CHIPS)	2" TO 3"
CUTBACK ASPHALT (SLOW CURING)	1200 GAL. / ACRE (1/4 GAL. / SQ.YD.)
BLACK POLYETHYLENE FILM	COMPLETELY COVER AREA; HOLD IN PLACE WITH SOIL ON OUTER EDGE

Ds1 MULCHING

FERTILIZER REQUIREMENTS FOR PERMANENT VEGETATION				
TYPES OF SPECIES	PLANTING YEAR	FERTILIZER (N-P-K)	RATE (LBS./ACRE)	N TOP DRESSING RATE (LBS./ACRE)
COOL SEASON GRASSES	FIRST	6-12-12	1500	50-100
	SECOND	6-12-12	1000	-
	MAINTENANCE	10-10-10	400	30
COOL SEASON GRASSES & LEGUMES	FIRST	6-12-12	1500	0-50
	SECOND	6-12-12	1000	-
	MAINTENANCE	10-10-10	400	-
GROUND COVERS	FIRST	10-10-10	1300	-
	SECOND	10-10-10	1300	-
	MAINTENANCE	10-10-10	1100	-
PINE SEEDLINGS	FIRST	20-10-5	ONE 21-GRAM PELLETT PER SEEDLING PLACED IN THE CLOSING HOLE	-
	MAINTENANCE	0-10-10	700	-
SHRUB LESPEDEZA	FIRST	0-10-10	700	-
	MAINTENANCE	0-10-10	400	-
TEMPORARY GROUND COVER CROPS SEEDED ALONE	FIRST	10-10-10	500	30
	MAINTENANCE	10-10-10	1500	50-100
WARM SEASON GRASSES	FIRST	6-12-12	800	50-100
	SECOND	6-12-12	800	-
	MAINTENANCE	10-10-10	400	30
WARM SEASON GRASSES & LEGUMES	FIRST	6-12-12	1500	30
	SECOND	6-12-12	1000	-
	MAINTENANCE	0-10-10	400	-

Ds3 PERMANENT SEEDING

APPLY AGRICULTURAL LIME AS PRESCRIBED BY SOIL TESTS OR AT A RATE OF 1-2 TONS PER ACRE

PLANTS, PLANTING RATES, AND PLANTING DATES FOR TEMPORARY COVER OR COMPANION CROPS					
SPECIES	RATES PER 1,000 SQ. FT.	RATES PER ACRE	PLANTING DATES BY REGION		
			M-L	P	C
BARLEY	3.3 LBS.	3 BU.	9/1-10/31	9/15-11/15	10/1-12/31
COATS	2.9 LBS.	4 BU.	9/15-11/15	9/15-11/15	9/15-11/15
TRITICALE	3.3 LBS.	3 BU.	-	-	10/15-12/15
RYEGRASS, ANNUAL	0.9 LBS.	40 LBS.	8/15-11/15	9/1-12/15	9/15-12/31
RYE LESPEDEZA, ANNUAL	0.6 LBS.	0.5 BU.	8/15-10/31	9/15-11/30	10/1-12/31
WEEDING LOVEGRASS	0.9 LBS.	40 LBS.	3/1-3/31	3/1-3/31	2/1-2/28
SUDANGRASS	1.4 LBS.	4 LBS.	4/1-5/31	4/1-5/31	3/1-5/31
MILLET, BROWN TOP	1.4 LBS.	60 LBS.	4/1-8/31	4/1-8/31	3/1-7/31
MILLET, PEARL	0.9 LBS.	40 LBS.	4/15-6/15	4/15-6/30	4/15-6/30
WHEAT	1.1 LBS.	50 LBS.	5/15-7/15	5/1-7/31	4/15-8/15
	4.1 LBS.	3 BU.	9/15-11/30	10/1-12/15	10/15-12/31

1. TEMPORARY COVER CROPS ARE VERY COMPETITIVE AND WILL CROWN OUT PERENNIALS IF PLANTED TOO HEAVILY.
2. REDUCE SEEDING RATES BY 50% WHEN DRILLED.
3. UNUSUAL SITE CONDITIONS MAY REQUIRE HEAVIER SEEDING RATES.
4. SEEDING RATES MAY NEED TO BE ALTERED TO FIT TEMPERATURE VARIATIONS AND LOCAL CONDITIONS.

M-L REPRESENTS THE MOUNTAIN, BLUE RIDGE, AND RIDGES & VALLEYS MLRAS.
P REPRESENTS THE SOUTHERN PIEDMONT REGION MLRA.
C REPRESENTS THE SOUTHERN COASTAL PLAIN, SAND HILLS, BLACK LANDS, AND ATLANTIC COAST FLATWOODS MLRAS.

FERTILIZER REQUIREMENTS FOR TEMPORARY VEGETATION				
TYPES OF SPECIES	PLANTING YEAR	FERTILIZER (N-P-K)	RATE (LBS./ACRE)	N TOP DRESSING RATE (LBS./ACRE)
COOL SEASON GRASSES	FIRST	6-12-12	1500	50-100
	SECOND	6-12-12	1000	-
	MAINTENANCE	10-10-10	400	30
COOL SEASON GRASSES & LEGUMES	FIRST	6-12-12	1500	0-50
	SECOND	6-12-12	1000	-
	MAINTENANCE	10-10-10	400	-
TEMPORARY COVER CROPS	FIRST	10-10-10	500	30
SEEDED ALONE	FIRST	6-12-12	1500	50-100
WARM SEASON GRASSES	SECOND	6-12-12	800	50-100
	MAINTENANCE	10-10-10	400	30

Ds2 TEMPORARY SEEDING

PLANTS, PLANTING RATES, AND PLANTING DATES FOR PERMANENT COVER						
TYPES OF SPECIES	RATES PER ACRE	RATES PER 1,000 SF	PLANTING DATES BY REGION			REMARKS
			M-L	P	C	
BAHIA, PENSACOLA ALONE OR WITH TEMPORARY COVER WITH PERENNIALS	60 LBS. 30 LBS.	1.4 LBS. 0.7 LBS.	-	4/1-5/31	3/1-5/31	LOW GROWING AND SOD FORMING. ALLOW TO ESTABLISH. WILL SPREAD INTO BERMUDA LAWNS.
BAHIA, WILMINGTON ALONE OR WITH TEMPORARY COVER WITH PERENNIALS	60 LBS. 30 LBS.	1.4 LBS. 0.7 LBS.	3/15-5/31	3/1-5/31	-	LOW GROWING AND SOD FORMING. ALLOW TO ESTABLISH. WILL SPREAD INTO BERMUDA LAWNS.
BERMUDA, COMMON (HULLED SEED) ALONE OR WITH TEMPORARY COVER WITH PERENNIALS	10 LBS. 6 LBS.	0.2 LBS. 0.1 LBS.	-	4/1-5/31	3/15-5/31	QUICK COVER, LOW GROWING AND SOD FORMING. NEEDS FULL SUN
BERMUDA, COMMON (UNHULLED SEED) ALONE OR WITH TEMPORARY COVER WITH PERENNIALS	10 LBS. 6 LBS.	0.2 LBS. 0.1 LBS.	-	10/1-2/28	11/1-1/31	PLANT WITH WINTER ANNUALS PLANT WITH TALL FESCUE
BERMUDA SPRIGS TEMPORARY COVER	40 CF SOD PLUGS 3' X 3'	0.9 CF	4/15-6/15	4/1-6/15	4/1-5/31	1 CF = 650 SPRIGS 1 BU. = 1.25 CF OR 800 SPRIGS.
CENTPEDE	BLOCK SOD ONLY	-	-	11/1-5/31	11/1-5/31	DROUGHT TOLERANT; FULL SUN OR PARTIAL SHADE; EFFECTIVE ADJACENT TO CONCRETE AND IN CONCENTRATED FLOW AREAS; IRRIGATION NEEDED UNTIL FULLY ESTABLISHED; DO NOT PLANT NEAR PASTURES
CROWN VETCH WITH WINTER ANNUALS OR COOL WINTER GRASSES	15 LBS.	0.3 LBS.	9/1-10/15	9/1-10/10	-	MIX WITH 30 LBS. TALL FESCUE OF 15 LBS. RYE; INOCULATE SEED; ONLY NORTH OF ATLANTA, DENSE GROWTH; DROUGHT TOLERANT AND FIRE RESISTANT
FESCUE, TALL ALONE WITH OTHER PERENNIALS	50 LBS. 30 LBS.	1.1 LBS. 0.7 LBS.	3/1-4/1 - OR - 8/15-10/15	9/1-10/15 - OR - 2/15-4/15	-	NOT FOR DROUGHTY SOILS. MIX WITH PERENNIAL LESPEDEZAS OR CROWN VETCH. APPLY TOPDRESSING IN SPRING FOLLOWING FALL PLANTINGS. NOT FOR HEAVY USE AREAS OR ATHLETIC FIELDS. 227,800 SEED PER POUND.
LESPEDEZA, SERICEA SCARIFIED UNSCARIFIED SEED-BEARING HAY	60 LBS. 75 LBS. 3 TONS	1.4 LBS. 1.7 LBS. 138 LBS.	4/1-5/31 9/1-2/28 10/1-2/28	3/15-5/31 9/1-2/28 10/1-1/31	3/1-5/15 9/1-2/28 9/15-1/15	WIDELY ADAPTED AND LOW MAINTENANCE. TAKES 2-3 YEARS TO ESTABLISH. EXCELLEN ON ROADBANKS, INOCULATE SEED WITH EL INOCULANT. MIX WITH WEEPING LOVEGRASS, COMMON BERMUDA, HAHIA, OR TALL FESCUE. MIX WITH TALL FESCUE OR WINTER ANNUALS CUT WHEN SEED IS MATURE, BUT BEFORE IT SHATTERS. ADD TALL FESCUE OR WINTER ANNUALS.
LESPEDEZA, AMBRO VIRGETA OR APPALOW SCARIFIED UNSCARIFIED	60 LBS. 75 LBS.	1.4 LBS. 1.7 LBS.	4/1-5/31 9/1-2/28	3/15-5/31 9/1-2/28	3/15-5/15 9/1-2/28	SPREADING GROWTH WITH HEIGHT OF 18"-24". GOOD IN URBAN AREAS, MIX WITH WEEPING LOVEGRASS, COMMON BERMUDA, BAHIA, TALL FESCUE, OR WINTER ANNUALS. DO NOT MIX WITH SERICEA LESPEDEZA. SLOW TO DEVELOP SOLID STANDS. INOCULATE SEED WITH EL INOCULANT.
LESPEDEZA, SHRUB (LESPEDEZA BICOLOR OR LESPEDEZA THUMBERGII) PLANTS	3' X 3' SPACING	-	10/1-3/31	11/1-3/15	11/15-2/28	PLANT IN SMALL CLUMPS FOR WILDLIFE FOOD AND COVER.
LOVEGRASS, WEEPING ALONE WITH OTHER PERENNIALS	4 LBS. 2 LBS.	0.1 LBS. 0.05 LBS.	4/1-5/31	3/15-5/31	3/1-5/31	QUICK COVER, DROUGHT TOLERANT. GROWS WELL WITH SERICEA LESPEDEZA ON ROADBANKS.
MAIDENCANE SPRIGS	2' X 3' SPACING	-	2/1-3/31	2/1-3/31	2/1-3/31	FOR VERY WET SITES SUCH AS RIVERBANKS AND SHORELINES. DIG SPRIGS LOCALLY. MAY CLOG CHANNELS.
PANICGRASS, ATLANTIC COASTAL	20 LBS.	0.5 LBS.	-	3/1-4/30	3/1-4/30	GROWS WELL ON COASTAL SAND DUNES, BORROW AREAS, AND GRAVEL PITS. PROVIDES WINTER COVER FOR WILDLIFE. MIX WITH SERICEA LESPEDEZA EXCEPT ON SAND DUNES
REED CANARY GRASS ALONE WITH OTHER PERENNIALS	50 LBS. 30 LBS.	1.1 LBS. 0.7 LBS.	6/15-10/15	9/1-10/15	-	GROWS SIMILAR TO TALL FESCUE
SUNFLOWER, AZTEC/ MAXIMILLIAN	10 LBS.	0.2 LBS.	4/15-5/31	4/15-5/31	4/1-5/31	MIX WITH WEEPING LOVEGRASS, LEGUMES, OR OTHER LOW GROWING GRASSES.

Ds3 PERMANENT GRASSING

○ DISTURBED AREA STABILIZATION

Sd2-SS INLET SEDIMENT TRAP: SILT SAVER DROP INLET PROTECTION

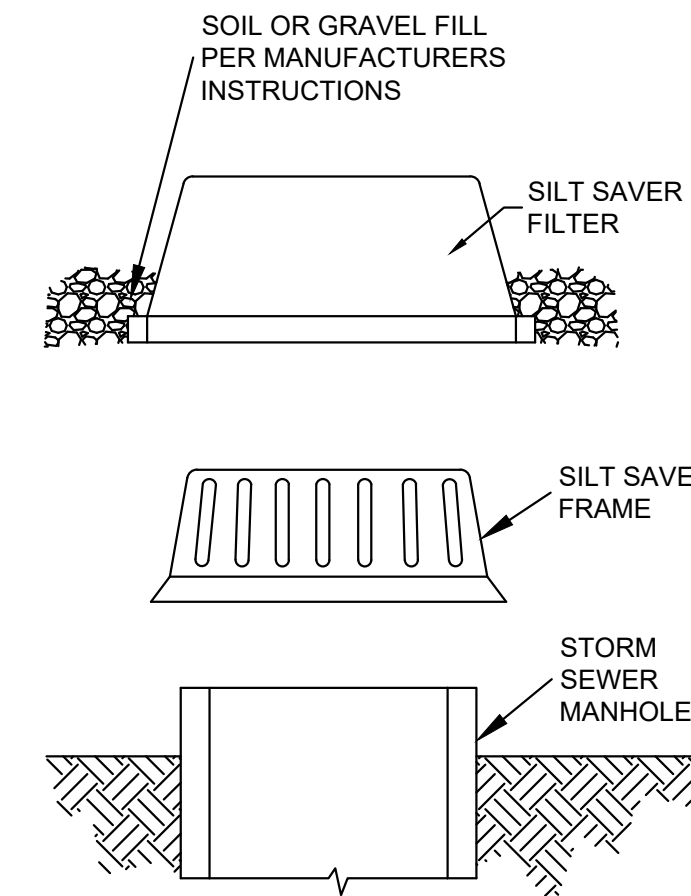

- EXCAVATE APPROXIMATELY 4" TO 6" BELOW THE TOP OF THE INLET STRUCTURE.
- PLACE THE FRAME ONTO THE INLET STRUCTURE, ENSURING PROPER SEATING OF FRAME TO STRUCTURE.
- SLIDE THE FILTER OVER THE FRAME.
- FILL THE FILTER POCKETS WITH SOIL, #57 GRAVEL OR EQUIVALENT. THE FILTERPOCKETS SHOULD BE COMPLETELY FILLED TO ENSURE A GOOD SEAL BETWEEN THE GROUND AND INLET STRUCTURE.
- BACKFILL AROUND THE FRAME AND FILTER ASSEMBLY IS NOT REQUIRED TO COMPLETE INSTALLATION; HOWEVER, BACKFILLING MAY BE NECESSARY TO COMPLETE EXCAVATION REQUIREMENTS FOR THE SITE.
- THE TRAP SHALL BE INSPECTED DAILY AND AFTER EACH RAIN AND REPAIRS MADE AS NEEDED. SEDIMENT SHALL BE REMOVED WHEN THE SEDIMENT HAS ACCUMULATED TO ONE-HALF THE HEIGHT OF THE TRAP.

○ INLET SEDIMENT TRAP - SILT SAVER (Sd2-SS)

7	6	5	4	3	2	1	No.	REVISIONS	DATE
<p>Kimley-Horn © 2019 KIMLEY-HORN AND ASSOCIATES, INC. 817 W. PEACHTREE STREET, NW THE BILTMORE, SUITE 601 ATLANTA, GEORGIA 30308 PHONE: (404) 419-9700 WWW.KIMLEY-HORN.COM</p>									
<p>SCALE: N.T.S. DRAWN BY: JRN DESIGNED BY: ZLR CHECKED BY: KRT</p>									
<p>CUSTOMER: ATLANTA BELTLINE PROJECT: EASTSIDE TRAIL DRAINAGE TITLE: EROSION CONTROL DETAILS</p>									
<p>86 PRYOR STREET, SW, SUITE 200 ATLANTA, GA 30303 PHONE: (404) 880-4100</p>									
<p>DATE: 05/01/19 PROJECT NO.: 013104000 SHEET NUMBER: C4-11</p>									

