

GENERAL NOTES:

1. THESE NOTES SHALL APPLY EXCEPT WHERE OTHERWISE INDICATED BY DRAWINGS OR SPECIFICATIONS.
2. CONTRACT DOCUMENTS INCLUDE THE STRUCTURAL DRAWINGS AND SPECIFICATIONS BUT DO NOT INCLUDE SHOP DRAWINGS, VENDOR DRAWINGS OR OTHER SUBMITTALS BY THE CONTRACTOR.
3. REFERENCE TO DESIGN STANDARDS AND BUILDING CODES SHALL MEAN THE LATEST EDITION OF THE REFERENCE UNLESS SPECIFICALLY STATED OTHERWISE.
4. THE GENERAL CONTRACTOR SHALL VERIFY ALL DIMENSIONS AND SITE CONDITIONS AND NOTIFY ENGINEER OF ANY DISCREPANCIES PRIOR TO PROCEEDING WITH WORK. FOR DIMENSIONS NOT SHOWN ON STRUCTURAL DRAWINGS, SEE ARCHITECTURAL DRAWINGS.
5. ALL MATERIALS & WORKMANSHIP ARE SUBJECT TO THE REVIEW OF THE ENGINEER OF RECORD.
6. THE CONTRACTOR HAS SOLE RESPONSIBILITY FOR THE MEANS, METHODS, TECHNIQUES, SEQUENCES, AND PROCEDURES OF CONSTRUCTION.
7. THE GENERAL CONTRACTOR HAS SOLE RESPONSIBILITY TO COMPLY WITH REQUIRED OSHA REGULATIONS.
8. THE STRUCTURE DESCRIBED BY THESE DRAWINGS IS SELF-SUPPORTING ONLY IN ITS COMPLETED FORM. THE CONTRACTOR SHALL BE RESPONSIBLE FOR THE DESIGN AND INSTALLATION OF TEMPORARY BRACING AND SHORING OF ALL WORK.
9. THE GENERAL CONTRACTOR SHALL COORDINATE WITH THE BUILDING OFFICIAL REGARDING SUBMITTAL OF INSPECTION REPORTS TO THE BUILDING DEPARTMENT.
10. CONSTRUCTION ADMINISTRATION AND SITE VISITS DURING CONSTRUCTION ARE NOT CURRENTLY INCLUDED IN O'CONNOR ENGINEERING'S SCOPE OF WORK FOR THIS PROJECT.

BUILDING DESIGN CRITERIA:

1. THESE STRUCTURAL DRAWINGS HAVE BEEN PREPARED IN ACCORDANCE WITH THE 2018 INTERNATIONAL BUILDING CODE (IBC) W/ GEORGIA STATE AMENDMENTS.
2. LIVE LOAD: = 250# AT 48" ABOVE GRADE
3. DEAD LOADS:
 - 3.A. CHARGER LOAD (D) = 750#
4. SNOW LOADS:
 - GROUND SNOW LOAD (P_g) = 5.0 PSF
5. WIND LOADS:
 - 5.A. ULTIMATE WIND SPEED (V, 3 SECOND GUST) = 115 MPH
 - 5.B. RISK CATEGORY = I
 - 5.C. WIND IMPORTANCE FACTOR (I_w) = 1.00
 - 5.D. UPWIND EXPOSURE CATEGORY = B
6. SEISMIC DESIGN CRITERIA:
 - 6.A. SEISMIC DESIGN CATEGORY : C
 - 6.B. SITE CLASS: D

FOUNDATION NOTES:

1. DESIGN SOIL BEARING PRESSURE = 1500 PSF. STRUCTURAL ENGINEER SHALL BE NOTIFIED IF THE ACTUAL SOIL BEARING PRESSURE APPEARS LOWER THAN THE DESIGN SOIL PRESSURE.
2. ALL FOOTINGS SHALL BEAR ON ORIGINAL UNDISTURBED SOIL OR STRUCTURAL FILL.
3. PRIOR TO POURING CONCRETE, ALL DEBRIS, WATER, AND LOOSE EARTH SHALL BE REMOVED FROM THE FOUNDATION BED.

CONCRETE NOTES:

1. PREPARE DESIGN MIXTURES FOR EACH TYPE AND STRENGTH OF CONCRETE, PROPORTIONED ON THE BASIS OF LABORATORY TRIAL MIXTURE OR FIELD TEST DATA, OR BOTH, ACCORDING TO ACI 301.
2. MINIMUM CONCRETE COMPRESSIVE STRENGTH @ 28 DAYS:
3000 PSI NORMAL WEIGHT CONCRETE (AS INDICATED ON DRAWINGS) WITH MAXIMUM WATER-CEMENTITIOUS MATERIALS RATIO OF 0.50 FOR 3000 PSI MIX. PROVIDE A MAXIMUM SLUMP OF 2" TO 4" BEFORE ADDING HIGH RANGE, WATER REDUCING ADMIXTURE OR PLASTICIZING ADMIXTURE.
3. STRUCTURAL MEMBERS OF REINFORCED CONCRETE SHALL BE CONSTRUCTED IN ACCORDANCE WITH ACI 318-11.
4. CONTRACTOR SHALL TO CONFORM TO ACI HOT OR COLD WEATHER PLACEMENT PROCEDURES IF APPLICABLE DUE TO TEMPERATURES AT TIME OF POUR.

REINFORCING STEEL NOTES:

1. SHALL BE FABRICATED AND PLACED ACCORDING TO THE LATEST STANDARDS OF THE AMERICAN CONCRETE INSTITUTE (ACI) AND THE CONCRETE REINFORCING STEEL INSTITUTE (CRSI).
2. MATERIALS:
 - 2.A. REINFORCING BARS SHALL COMPLY WITH ASTM A615 GRADE 60.
3. CLEAR MINIMUM COVER OF CONCRETE OVER REINFORCING BARS SHALL BE AS INDICATED ON THE DRAWINGS BUT SHALL NOT BE LESS THAN THE FOLLOWING:
 - 3.A. CONCRETE PLACED AGAINST EXPOSED EARTH (NOT FORMED) 3"
4. PROVIDE ADEQUATE BOLSTERS, HIGH CHAIRS, SUPPORT BARS, ETC. TO MAINTAIN SPECIFIED CLEARANCES FOR THE ENTIRE LENGTH OF ALL REINFORCING BARS AND WELDED WIRE FABRIC.
5. TIE ALL REINFORCING & EMBEDMENTS SECURELY IN PLACE PRIOR TO PLACING CONCRETE. PROVIDE SUFFICIENT SUPPORTS TO MAINTAIN THE POSITION OF REINFORCEMENT WITHIN SPECIFIED TOLERANCES DURING ALL CONSTRUCTION ACTIVITIES. "STICKING" DOWELS INTO WET CONCRETE IS NOT PERMITTED.

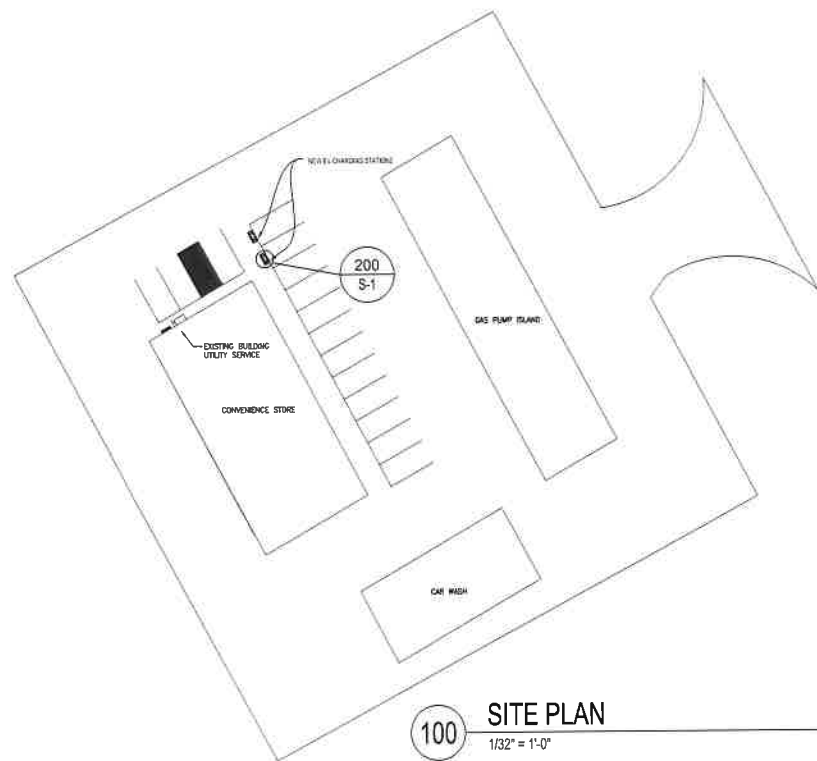

100 SITE PLAN
1/32" = 1'-0"

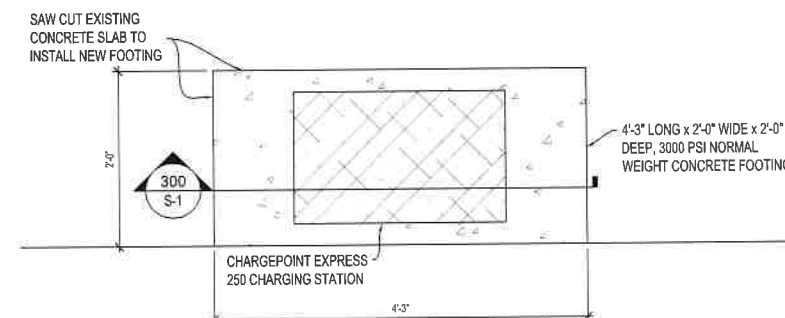

200 FOOTING PLAN
1" = 1'-0"

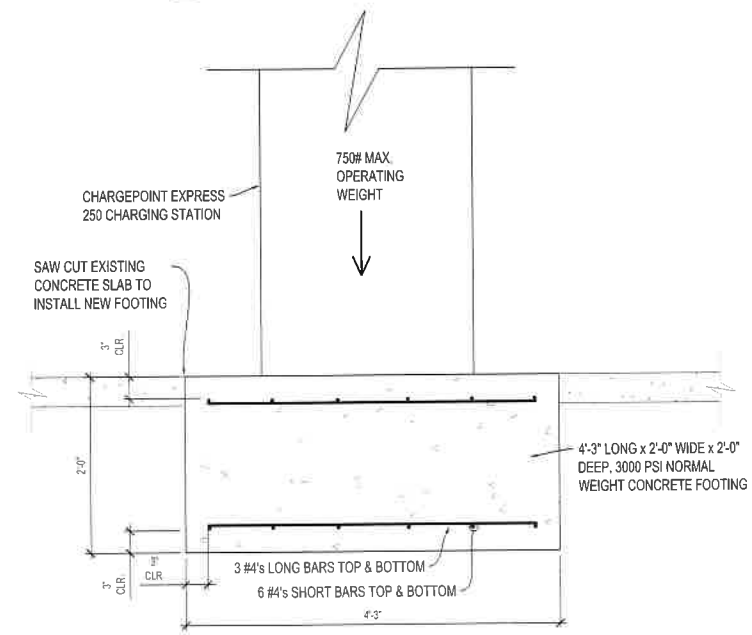

300 FOOTING SECTION
1" = 1'-0"

O'CONNOR ENGINEERING L.L.C.
ATHENS, GA / LAKE O'CONNOR
P.O. Box 116 / Greenham, GA 30642
P: (770) 313-0302
E-mail: admin@oconnor-engineering.com



ENMARK STATIONS, INC.
EV STATIONS
221 BOBBY JONES EXPY
MARTINEZ, GEORGIA 30007
FOR:
STANTON ELECTRIC, INC.
ATLANTA, GEORGIA

MARK	DATE	BY	DESCRIPTION
	12/8/20		ISSUE FOR CONSTRUCTION

DESIGNED: _____
DRAWN: _____
CHECKED: _____
APPROVED: _____
DATE: 12-8-2020
ORIGINAL DRAWING SIZE: 36"x24"
© COPYRIGHT 2020. UNAUTHORIZED USE OF ANY KIND, INCLUDING USE ON OTHER PROJECTS, IS PROHIBITED. ANY ALTERATIONS OR REPRODUCTIONS MUST BE AUTHORIZED IN WRITING BY O'CONNOR ENGINEERING, L.L.C.

FOUNDATION PLAN & NOTES