

GENERAL MECHANICAL AND ELECTRICAL DEMOLITION NOTES:

- DEMOLITION NOTES FOR THIS PROJECT ARE INTENDED TO GENERALLY IDENTIFY THE REMOVAL OF EXISTING ITEMS AT LOCATIONS WHERE REQUIRED BUT SHALL IN NO WAY RELIEVE THE CONTRACTOR OF THE FULL RESPONSIBILITY FOR FIELD EXAMINING AND VERIFYING THE FULL EXTENT OF EXISTING CONDITIONS PRIOR TO BEING THIS PROJECT.
- THE CONTRACTOR SHALL BE RESPONSIBLE FOR THE PROPER DISPOSAL OF ALL DEMOLISHED MATERIALS. ALL REMOVED MATERIALS SHALL BE DISPOSED OF, UNLESS NOTED AS "RETURNED TO OWNER," OR "SALVAGED". INFORMATION AND DRAWINGS INCLUDED IN THESE CONTRACT DOCUMENTS PERTAINING TO THE WORK HAVE BEEN OBTAINED FROM DRAWINGS PROVIDED BY OTHERS, GENERAL FIELD MEASUREMENTS, AND OBSERVATIONS. THE INFORMATION IS INCLUDED HEREIN WITH THE INTENT TO PROVIDE THE CONTRACTOR WITH A BASIC UNDERSTANDING OF EXISTING CONDITIONS. ACTUAL CONDITIONS AND DIMENSIONS MAY VARY FROM THOSE INDICATED AND REQUIRE FIELD VERIFICATION. NOT ALL EXISTING CONSTRUCTION IS SHOWN. THE CONTRACTOR MAY REVIEW THE PROJECT SITE BY ARRANGEMENT WITH THE OWNER'S AGENT.
- SHOULD THE CONTRACTOR ENCOUNTER ANY MATERIALS DURING SELECTIVE DEMOLITION AND NEW WORK WHICH ARE SUSPECTED BY THE CONTRACTOR TO BE OF AN UNKNOWN OR QUESTIONABLE COMPOSITION, WITH RESPECT TO CONTAINING CONTAMINANTS WHICH MAY BE HAZARDOUS TO HUMAN HEALTH, THE CONTRACTOR SHALL IMMEDIATELY NOTIFY THE OWNER IN WRITING OF SUCH FINDINGS.
- ANY ITEMS INDICATED AS "SALVAGED" SHALL BE REMOVED BY OWNER.
- THE OWNER SHALL NOT BE RESPONSIBLE FOR VANDALISM AND CONDITION OF THE BUILDING AND SALVAGEABLE MATERIAL FROM THE TIME THE BIDS ARE SUBMITTED UNTIL THE AWARD OF THE CONTRACT. THE CONTRACTOR SHALL BE RESPONSIBLE FOR ALL DEMOLITION AND REMOVAL OF ITEMS TO ALLOW FOR NEW CONSTRUCTION SHOWN OR NOT SHOWN ON DEMOLITION PLANS AS MAY BE REQUIRED FOR NEW WORK, WHETHER INDICATED ON THIS DRAWING OR NOT.
- THE ELECTRICAL CONTRACTOR SHALL BE RESPONSIBLE FOR THE PROPER DISPOSAL OF ALL MERCURY LAMPS, BALLASTS, ETC. SEE ELECTRICAL SPECIFICATIONS FOR MORE INFORMATION.
- COORDINATE PHASING OF ALL DEMOLITION WORK WITH ARCHITECTURAL SPECIFICATIONS, GENERAL CONTRACTOR, AND ALL UTILITY COMPANIES PRIOR TO PERFORMING ANY WORK. DEMOLITION OF EXISTING HIGH SCHOOL ACADEMIC BUILDING SHALL NOT OCCUR UNTIL NEW ACADEMIC BUILDING IS COMPLETE.
- REMOVE ALL EXISTING INTERIOR AND EXTERIOR ELECTRICAL EQUIPMENT, EQUIPMENT PADS AND FENCING ASSOCIATION WITH EXISTING BUILDING ELECTRICAL SYSTEM.

HAZARDOUS MATERIALS NOTES:

- IF ANY CONSTRUCTION PERSONNEL ENCOUNTER ANY MATERIAL WHICH THEY SUSPECT MIGHT BE HAZARDOUS OR TOXIC, THEY SHALL STOP WORK IMMEDIATELY AND ADVISE THE OWNER. THE CONTRACTOR SHALL TAKE IMMEDIATE AND APPROPRIATE ACTION TO PROTECT BUILDING USERS AND WORKERS IN ACCORDANCE WITH ALL FEDERAL, STATE, AND LOCAL LAWS, CODES AND REGULATIONS. THE ARCHITECT AND ENGINEER SHALL HAVE NO RESPONSIBILITY FOR DISCOVERY, PRESENCE, HANDLING, REMOVAL OR DISPOSAL, AND OR EXPOSURE OF PERSONS TO ANY HAZARDOUS MATERIALS IN ANY FORM AT THE PROJECT SITE.
- THE CONTRACTOR IS HEREBY ADVISED THAT NEITHER SHERMAN-CARTER-BARNHART PSC NOR KTA, INC. IS A DESIGN PROFESSIONAL IN THE DETERMINATION OF THE PRESENCE OF HAZARDOUS MATERIALS, OR IN MAKING RECOMMENDATIONS REGARDING THE TESTING, REMOVAL, ENCAPSULATION OR OTHER CORRECTIVE MEASURES PERTAINING TO HAZARDOUS MATERIALS.
- BY EXECUTION OF THE CONTRACT FOR CONSTRUCTION, THE CONTRACTOR HEREBY AGREES TO BRING NO CLAIM FOR NEGLIGENCE, BREACH OF CONTRACT, INDEMNITY OR OTHERWISE AGAINST THE ARCHITECT, HIS PRINCIPALS, EMPLOYEES, AGENTS, OR CONSULTANTS, IF SUCH A CLAIM IN ANY WAY WOULD INVOLVE THE INVESTIGATION OF OR REMEDIAL WORK RELATED TO HAZARDOUS MATERIALS ENCOUNTERED DURING THE PROJECT.
- BY EXECUTION OF THE CONTRACT FOR CONSTRUCTION, THE CONTRACTOR AGREES TO DEFEND, INDEMNIFY AND HOLD THE ARCHITECT, HIS PRINCIPALS, EMPLOYEES, AGENTS AND CONSULTANTS HARMLESS FROM ANY SUCH HAZARDOUS MATERIALS RELATED CLAIMS THAT MAY BE BROUGHT BY THE CONTRACTORS, SUBCONTRACTORS, SUPPLIERS OR ANY THIRD PARTIES WHO MAY BE ACTING UNDER THE DIRECTION OF THE CONTRACTOR PURSUANT TO THIS PROJECT.
- IF THE WORK WHICH IS TO BE PERFORMED UNDER THE CONTRACT INTERFACES IN ANY WAY WITH EXISTING COMPONENTS WHICH CONTAIN HAZARDOUS MATERIALS, IT IS THE CONTRACTOR'S RESPONSIBILITY TO CONTACT THE OWNER'S ENVIRONMENTAL CONSULTANT REGARDING THE PROPER MEANS AND METHODS TO BE UTILIZED IN DEALING WITH HAZARDOUS MATERIALS.

MECHANICAL SHEET NOTES:

- CAP EXISTING GAS MAIN WHEN DEMOLITION BEGINS.
- ABANDON THIS SECTION OF GAS MAIN WHEN INFORMED TO BY GENERAL CONTRACTOR.
- PLUG SANITARY SEWER BRANCH TO EXISTING SCHOOL WHEN BUILDING IS READY FOR DEMOLITION.
- EXISTING FIRE HYDRANT TO REMAIN.
- TERMINATE ALL GAS, WATER AND SEWER CONNECTION AT EXTERIOR OF BUILDING PRIOR TO STARTING DEMOLITION OF BUILDING.
- TERMINATE ANY MECHANICAL HEATING/COOLING PIPING SERVING BUILDING AT EXTERIOR OF BUILDING.
- ABANDONED LP GAS LINE.
- EXISTING WATER LINE TO BE ABANDON IN PLACE.
- REMOVE EXISTING REGULATOR STATION PREPAR EXISTING PIPING FOR CONNECTION TO NEW GAS REGULATOR/METER SHOWN ON NEW WORK SITE PLAN SHEET SMI.1.
- REMOVE EXISTING WATER METER AND METER BOX.
- EXISTING WATER PIPING TO BE UTILIZED AT THIS POINT FOR CONNECTION OF NEW WATER PIPING. SEE SHEET SMI.1.
- ABANDON EXISTING SANITARY SEWER. PLUG EXISTING BRANCH IN EXISTING MANHOLE (TO REMAIN).
- EXISTING 6" SANITARY SEWER TO REMAIN.
- EXISTING WATER PIPING TO REMAIN.
- REMOVE ALL EXISTING INTERIOR AND EXTERIOR MECHANICAL EQUIPMENT, EQUIPMENT PADS AND FENCING ASSOCIATION WITH EXISTING BUILDING MECHANICAL SYSTEM.
- REMOVE ALL EXISTING IRRIGATION SPRINKLER HEADS. REMOVE ALL EXISTING IRRIGATION PIPING AND EQUIPMENT REQUIRED TO ALLOW FOR INSTALLATION OF NEW IRRIGATION SYSTEM. REMOVE ALL INGROUND VALVES AND VALVE VAULTS SERVING EXISTING IRRIGATION SYSTEM.
- REMOVE EXISTING IN-GROUND VAULTS CONTAINING POST INDICATOR VALVE AND FIRE DEPARTMENT CONNECTION. RECONFIGURE WATER PIPING AS REQUIRED TO CONTINUE FIRE WATER AND DOMESTIC WATER SERVICE.

ELECTRICAL SHEET NOTES:

- PROVIDE ELECTRICAL DEMOLITION IN EXISTING BUILDING, INCLUDING CANOPIES, ETC. TO ALLOW BUILDING TO BE DEMOLISHED. DISCONNECT ALL UTILITY SERVICES, AS REQUIRED.
- DISCONNECT ELECTRICAL SERVICE FROM EXISTING BUILDING.
- DISCONNECT, REMOVE, AND PROPERLY DISPOSE OF EXISTING FIELD LIGHTING POLE. REMOVE CONDUCTORS FROM UNDERGROUND FEEDER AND ABANDON CONDUIT.
- EXISTING UNDERGROUND ELECTRIC SERVICE, PADMOUNT TRANSFORMER, AND ALL OTHER WORK ASSOCIATED WITH FOOTBALL FIELD SHALL REMAIN.
- DISCONNECT, REMOVE, AND DEMOLISH EXISTING LIGHTING POLE. REMOVE ALL CONDUCTORS. ABANDON UNDERGROUND CONDUITS.
- REMOVE AND PROPERLY DISPOSE OF EXISTING UTILITY POLES, TRANSFORMERS, AND OVERHEAD ELECTRIC LINES AFTER ALLEL AND INSIGHT HAVE REMOVED THEIR SERVICES.
- EXISTING BASEBALL FIELD CONCRETE LIGHTING POLES AND ASSOCIATED UNDERGROUND ELECTRIC SERVICES ARE TO REMAIN. SEE NEW WORK PLAN.
- EXISTING ELECTRIC SERVICE POLE, TRANSFORMERS, AND OVERHEAD SERVICE FOR BASEBALL FIELD LIGHTING SHALL BE DISCONNECTED, REMOVED, AND DISPOSED OF. TWO EXISTING SERVICE DISCONNECTS AND UNDERGROUND FEEDERS SHALL BE SAVED AND REUSED. SEE SHEET SE1.1 FOR NEW ELECTRIC SERVICE AT THIS LOCATION.
- EXISTING OVERHEAD ELECTRIC LINE AND UTILITY POLE ARE TO REMAIN.
- KU COMPANY'S EXISTING PRIMARY METER IS AT THIS LOCATION. METER WILL BE REMOVED BY KU COMPANY.
- DISCONNECT, REMOVE, AND PROPERLY DISPOSE OF ELECTRICAL CONNECTIONS AND SERVICE FOR EXISTING CHILLER. REMOVE ALL CONDUCTORS AND ABOVE GROUND DEVICES. CAP AND ABANDON BELOW SLAB CONDUIT.
- EXISTING SERVICES FOR BASEBALL FIELDHOUSE SHALL BE REPLACED WITH NEW SERVICES. SEE SHEET SE1.1.
- DISCONNECT ALL EXISTING SERVICES FROM TRAILERS TO ALLOW FOR REMOVAL BY OTHERS.
- DISCONNECT, REMOVE, AND DISPOSE OF EXISTING SIGN LIGHTS. REMOVE ALL CONDUCTORS AND CAP/ABANDON CONDUIT.
- COORDINATE DISCONNECT AND REMOVAL OF OVERHEAD ELECTRIC AND UTILITY POLES WITH KU COMPANY. INCLUDE ALL COSTS IN BID.
- EXISTING BASEBALL FIELD LIGHTING ON CONCRETE/METAL POLES SHALL REMAIN. A NEW SERVICE WILL BE INSTALLED TO POWER THESE DEVICES. SEE SHEET SE1.1.
- EXISTING SCOREBOARD, DISCONNECT, AND RECEPTACLE SHALL REMAIN. DISCONNECT EXISTING CIRCUIT, REMOVE CONDUCTORS TO THEIR SOURCE, AND CAP/ABANDON CONDUIT. NOTE THAT SCOREBOARD, DISCONNECT, AND RECEPTACLE WILL BE BACKED WITH A NEW CIRCUIT. SEE NEW WORK PLAN. EXISTING CONTROL CABLING AND CONTROL RECEPTACLE IN PRESSBOX SHALL BE REMOVED FOR RE-USE OR NEW EQUIVALENTS SHALL BE PROVIDED.
- DISCONNECT, REMOVE, AND PROPERLY DISPOSE OF EXISTING LIGHT FIXTURES ON EXTERIOR OF GYMNASIUM.
- TWO EXISTING GYM SCOREBOARDS AND CONTROL RECEPTACLES ARE TO BE SAVED AND REUSED. NEW CONTROL CABLING SHALL BE PROVIDED TO MATCH EXISTING CABLING.

KTA CONSULTING ENGINEERS
 1708 JARVIS FOX WAY - LEWINGTON, KENTUCKY 40511
 PHONE: (859) 253-2459 FAX: (859) 259-1864
 © 2004, KTA, INC.

BRYAN STATION HIGH SCHOOL
 FAYETTE COUNTY PUBLIC SCHOOLS
 LEXINGTON, KENTUCKY

SITE UTILITIES
 DEMOLITION PLAN

Sherman Carter Barnhart PSC
 ARCHITECTURE • LANDSCAPE ARCHITECTURE • CIVIL ENGINEERING
 2405 HARRISBURG ROAD • LEXINGTON, KY 40504 • PH: 859-224-1351 • FAX: 859-224-8446

JOB NO. 02122
DATE
DRAWN
CHECKED
COPYRIGHT © 2004 SHERMAN / CARTER / BARNHART, PSC
REVISIONS
SHEET
SUD1.1

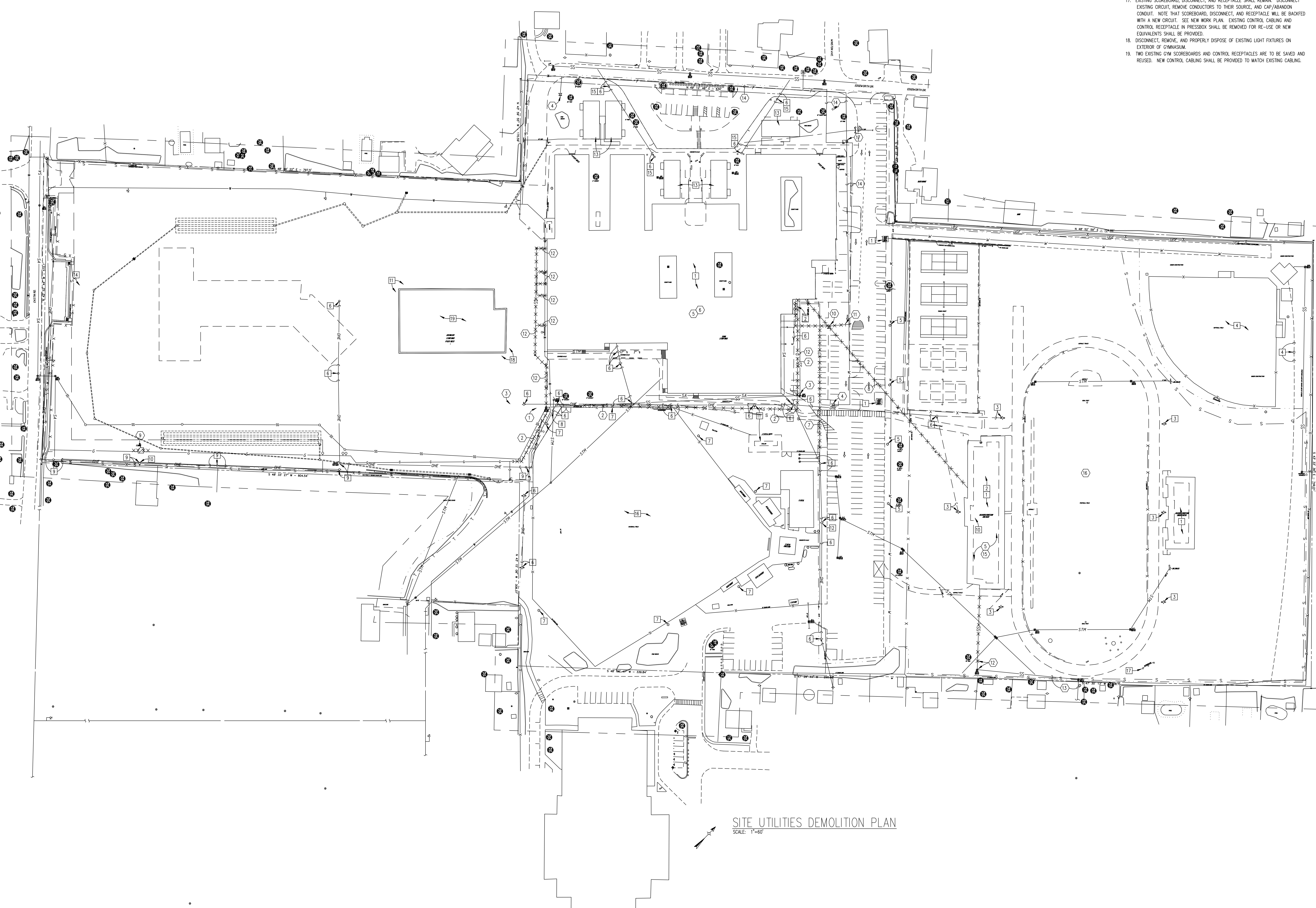

SITE UTILITIES DEMOLITION PLAN
 SCALE: 1"=60'

BC# 03-415

KTA PROJECT #03050