

FORD F-450 CHASSIS

STANDARD OPTIONS:

- SMOOTH COMPARTMENTS - VENTED w/ DRAIN HOLES
- EXTRUDED DOORS w/ DRIP RAILS
- D/P RUNNING BOARDS / KICK PANEL / STONE GUARDS / REAR BUMPER
- SMOOTH DOOR PANELS
- EBERHARD DOOR HANDLES
- SPLASH GUARDS
- ALUMINUM FENDERETTES
- C-CHANNEL w/ RED / WHITE REFLECTIVE

- CAST GRABBERS
- MUD FLAPS
- POLYFIBER INSULATION
- ICC LIGHTS
- COMPARTMENT LIGHTS
- WIRE ENGINE BLOCK HEATER
- SCORPION COMPARTMENTS / SHELVES GRAY
- PHOENIX WHEEL COVERS w/ VALVE EXTENDERS

SPECIAL OPTIONS:

- POWER DOOR LOCKS - ALL DOORS
- COLORED LENSES ON WARNING LIGHTS
- DOOR PANELS TO HAVE LOWER RED / GOLD CHEVRON

- WOOD CONSOLE w/ ARM RESTS
- SCORPION COAT GRAY
- LAPTOP SLOT IN FRONT
- RC TRONICS SWITCH PANEL w/ INTERCOM SWITCH w/ CODE LIGHTS
- SPOTLIGHT
- DIGITAL AMP / VOLT METER
- (2) WHELEN 295HFS2 w/ NCM SIRENS
- (1) 110V OUTLET
- MIRROR MOUNTED CAMERA MONITOR
- UPPER WARNING LIGHTS ON ONE SWITCH
- LOWER WARNING LIGHTS ON ONE SWITCH
- TWO POSITION STAINLESS GLOVE BOX BETWEEN SEATS ON BACK WALL

ION RED/CLEAR

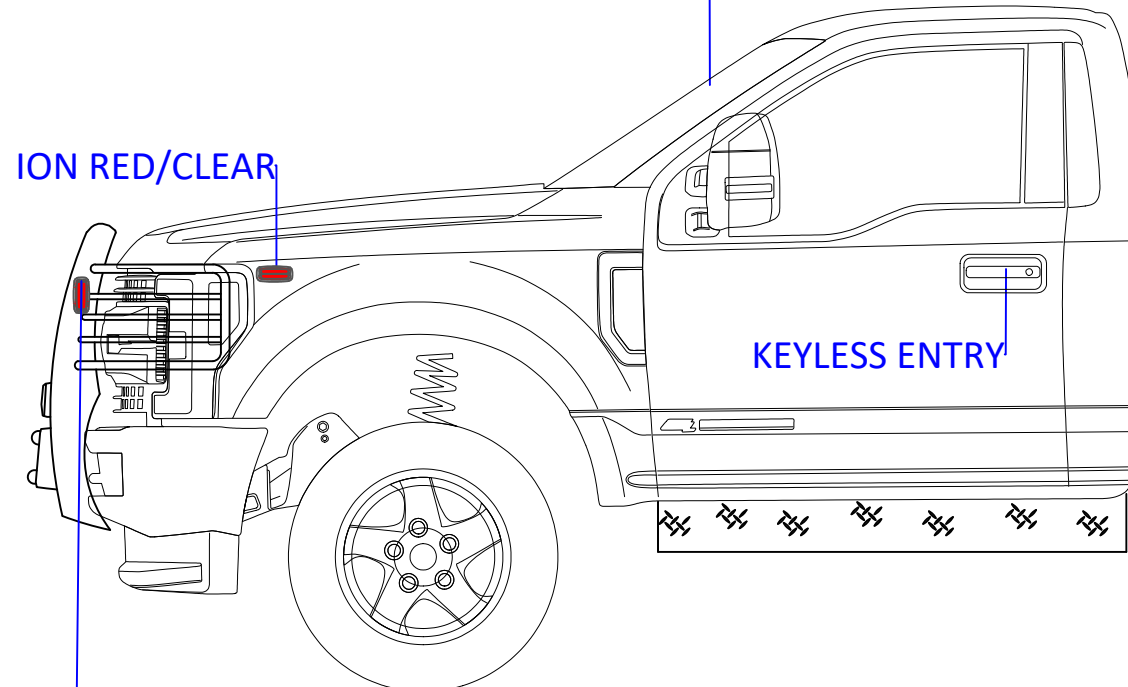

KEYLESS ENTRY

ION RED MOUNTED ON RANCH HAND

SPARE TIRE
#10 FIRE EXTINGUISHER
SHIP LOOSE

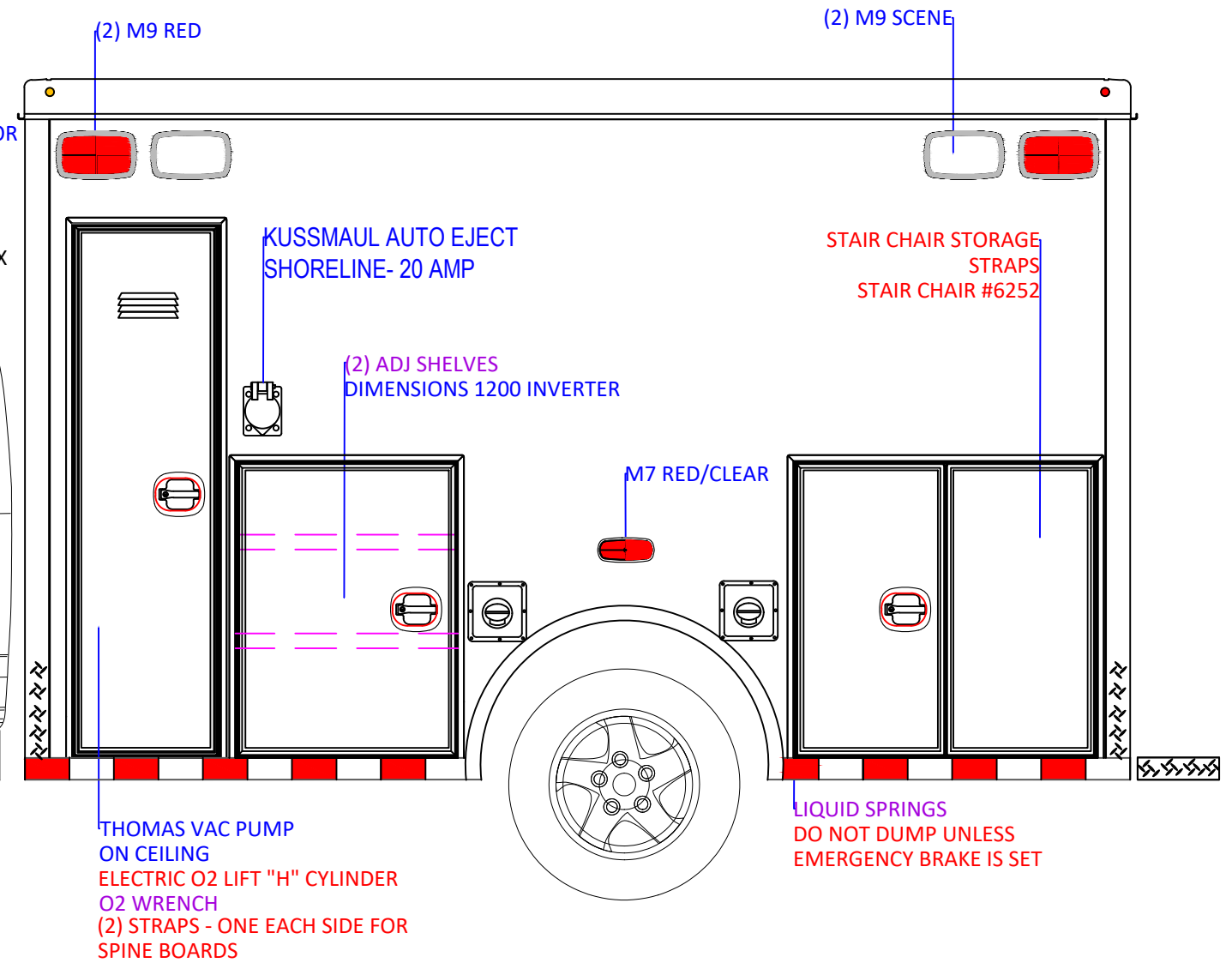

		BULLOCH	
		WORK ORDER	
	B	DRIVER EXT.	
WO#1	SCALE	DRAWN BY AK	DATE

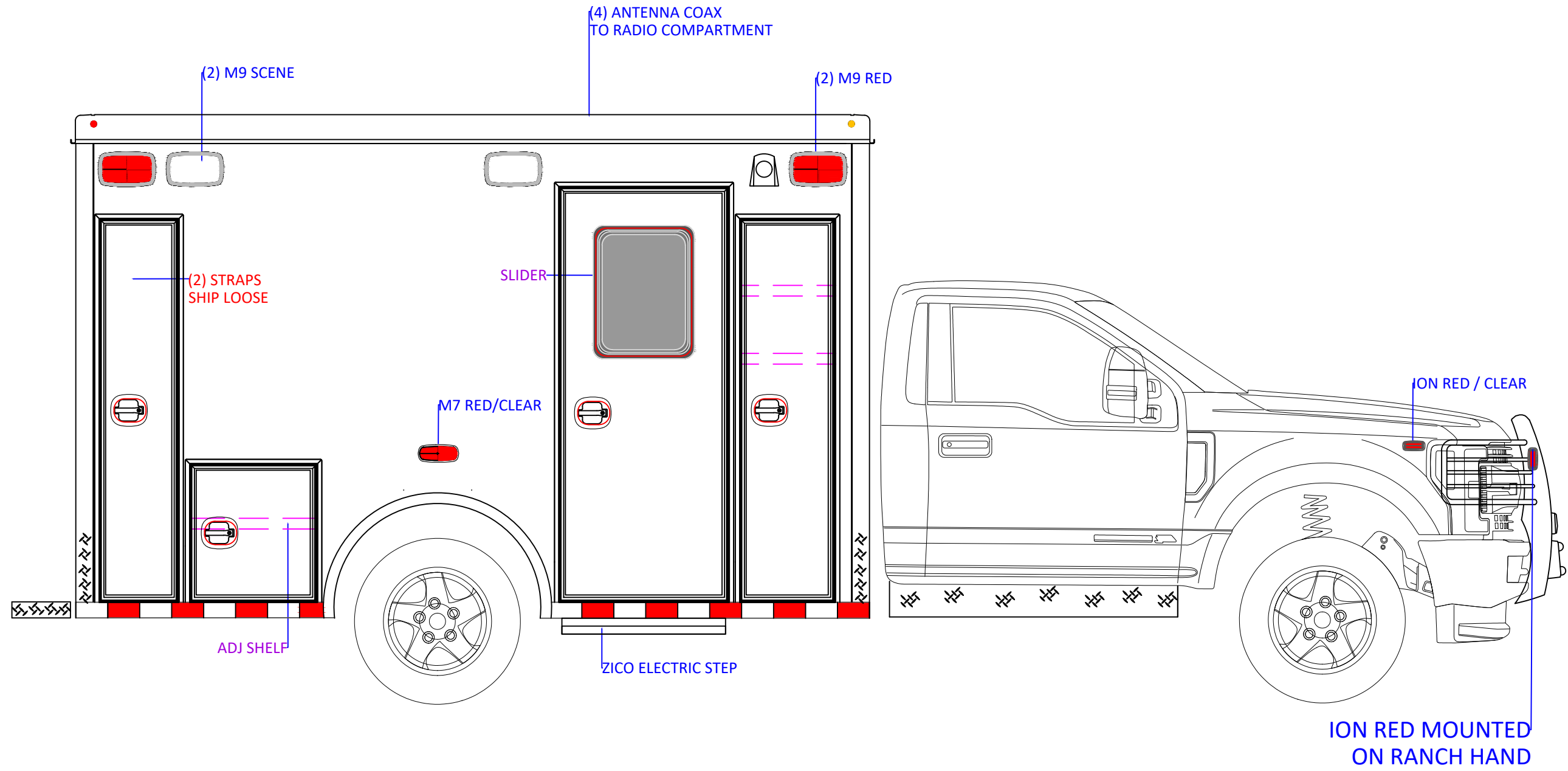

		BULLOCH	
		WORK ORDER	
	SIZE	PART	REVISION
	B		
WO#2	SCALE	DRAWN BY	DATE
		AK	

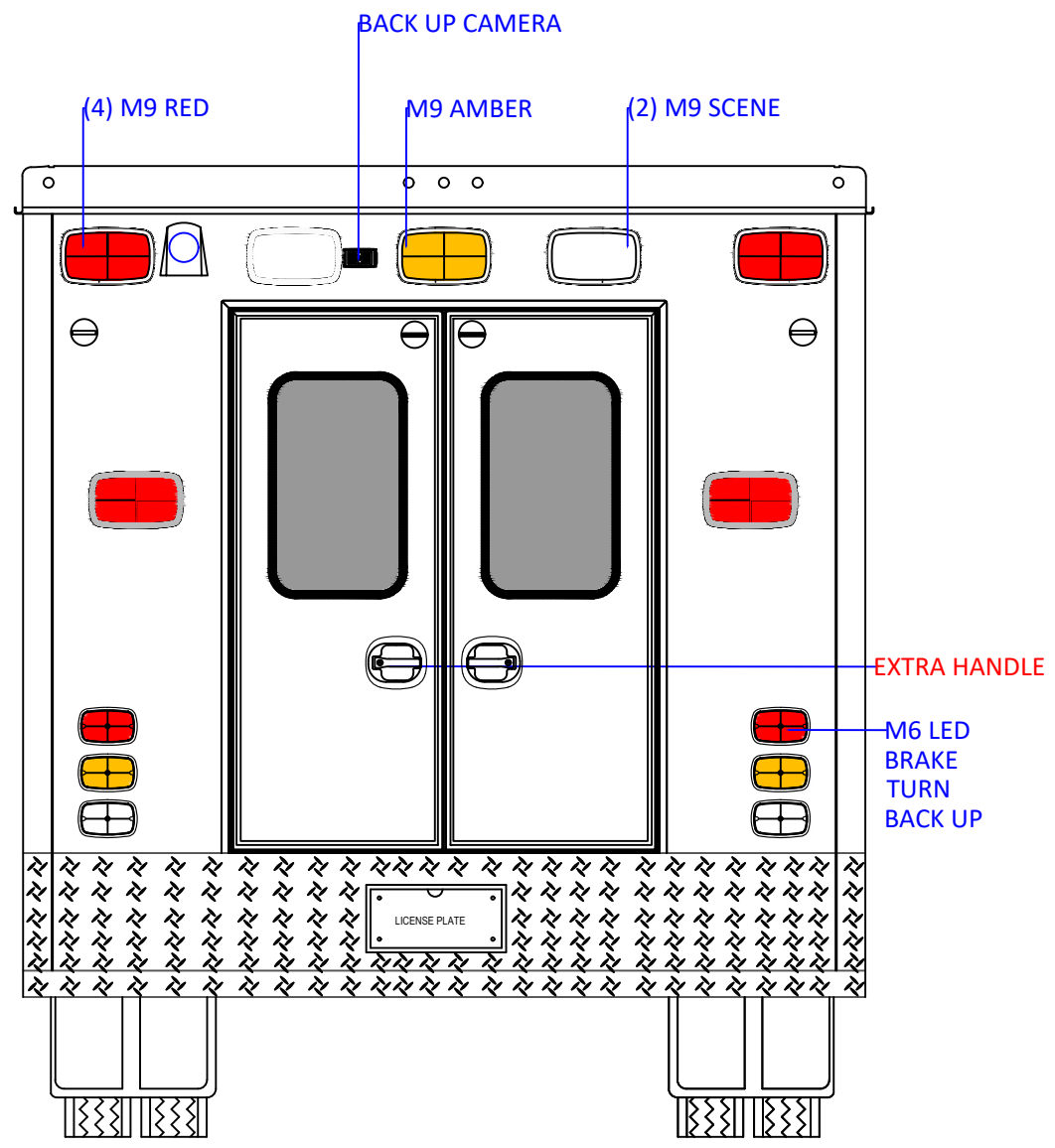
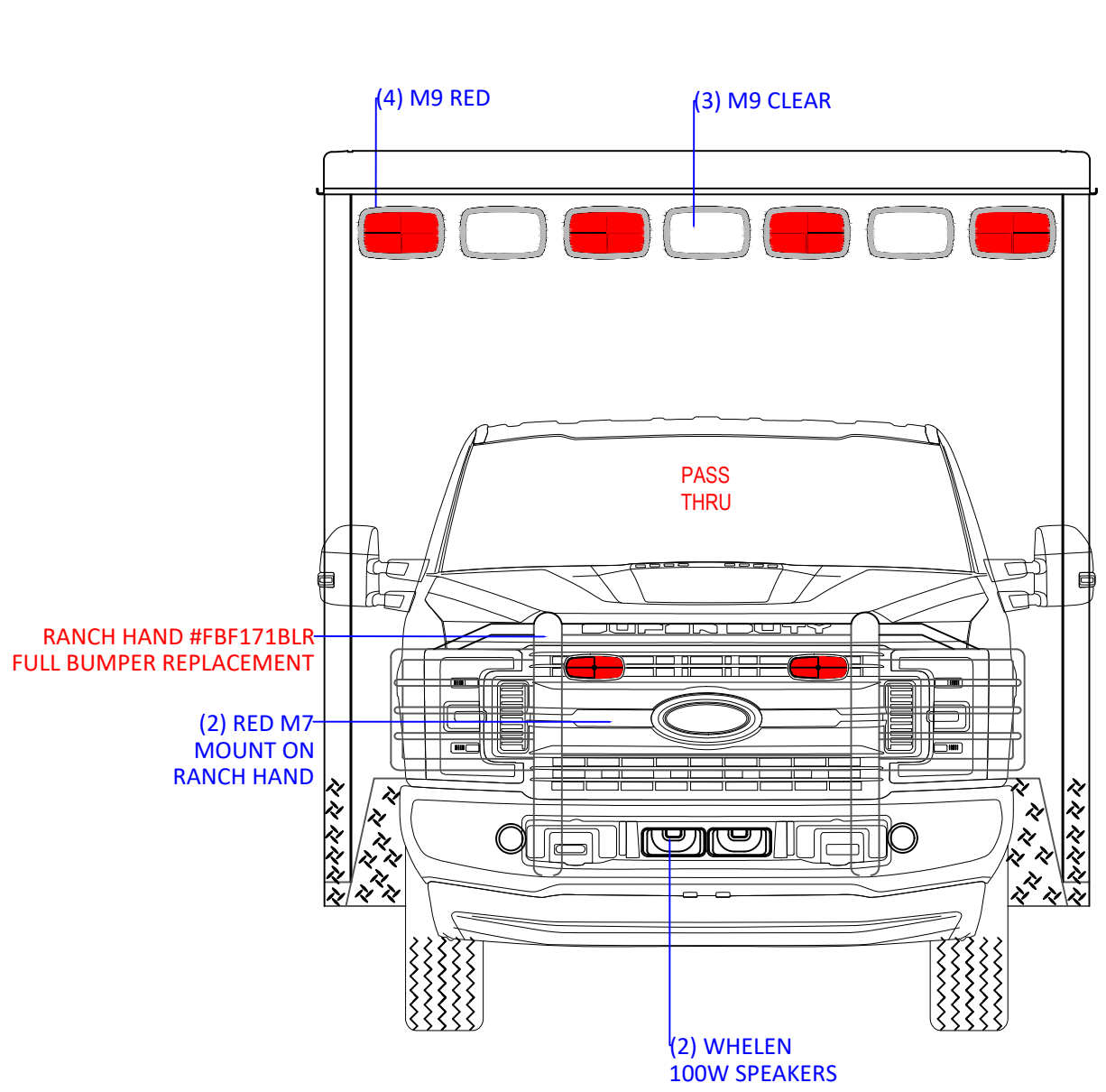

		BULLOCH	
		WORK ORDER	
	DATE B	PART FRONT/ REAR EXT.	REVISION
WO#3	SCALE	DRAWN BY AK	DATE

CPR SEAT WITH FOLD-DOWN BACK
NO 6PT HARNESS

IV POLE

ELECT O2
SOLENOID

RICO SUCTION
DO NOT MOUNT
SHIP LOOSE

SWITCH PANEL

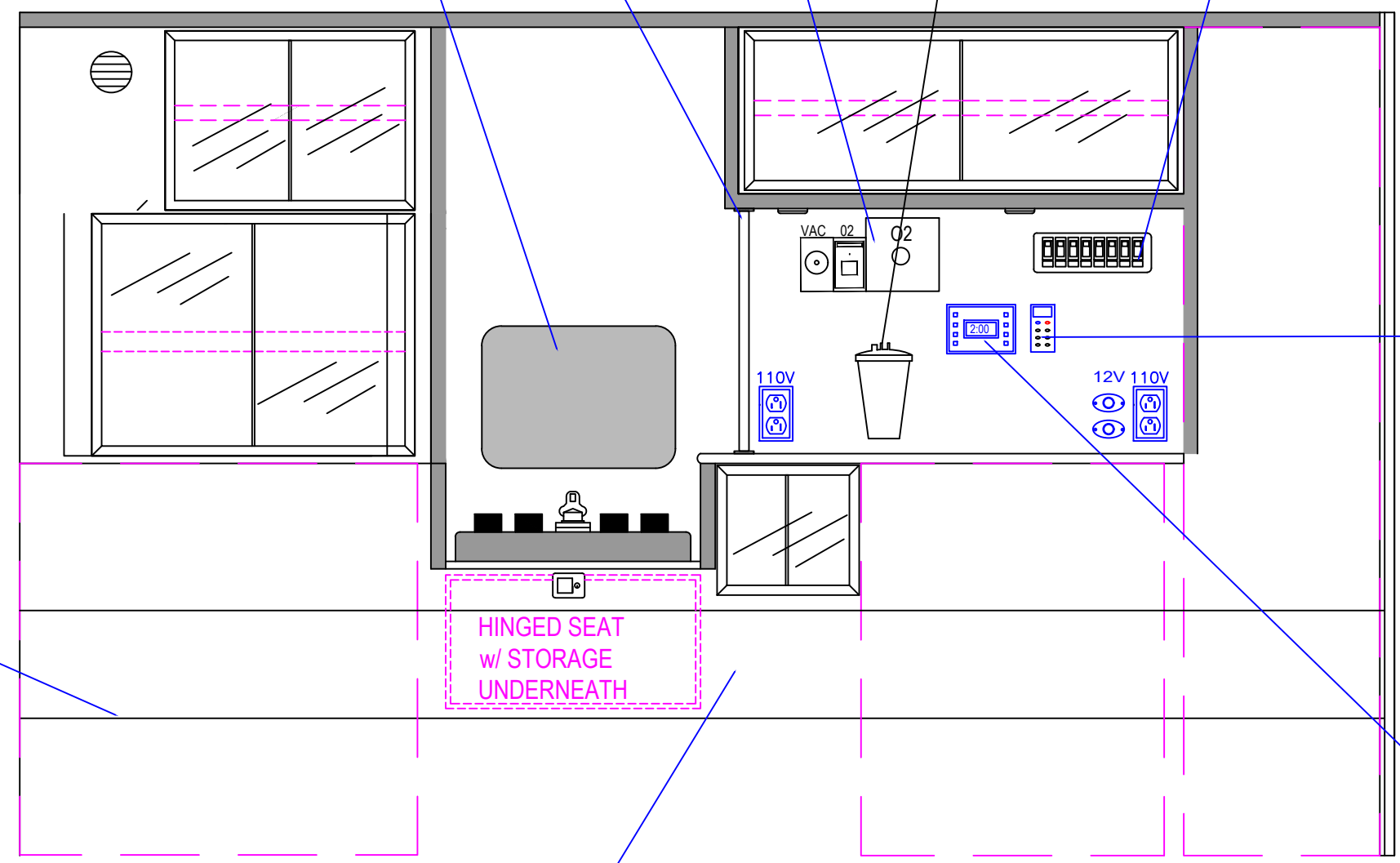

DIGITAL
THERMOSTAT

POWER LOAD

HINGED SEAT
w/ STORAGE
UNDERNEATH

INTELLITEC

SS RISER

GLOSSY GRAY / WHITE FORMICA
GUNMETAL UPHOLSTERY
LONPLATE FLOORING
WHITE COUNTERTOPS

		BULLOCH	
		WORK ORDER	
	SIZE B	PART	REVISION
		DRIVER INT.	
WO#4	SCALE	DRAWN BY AK	DATE

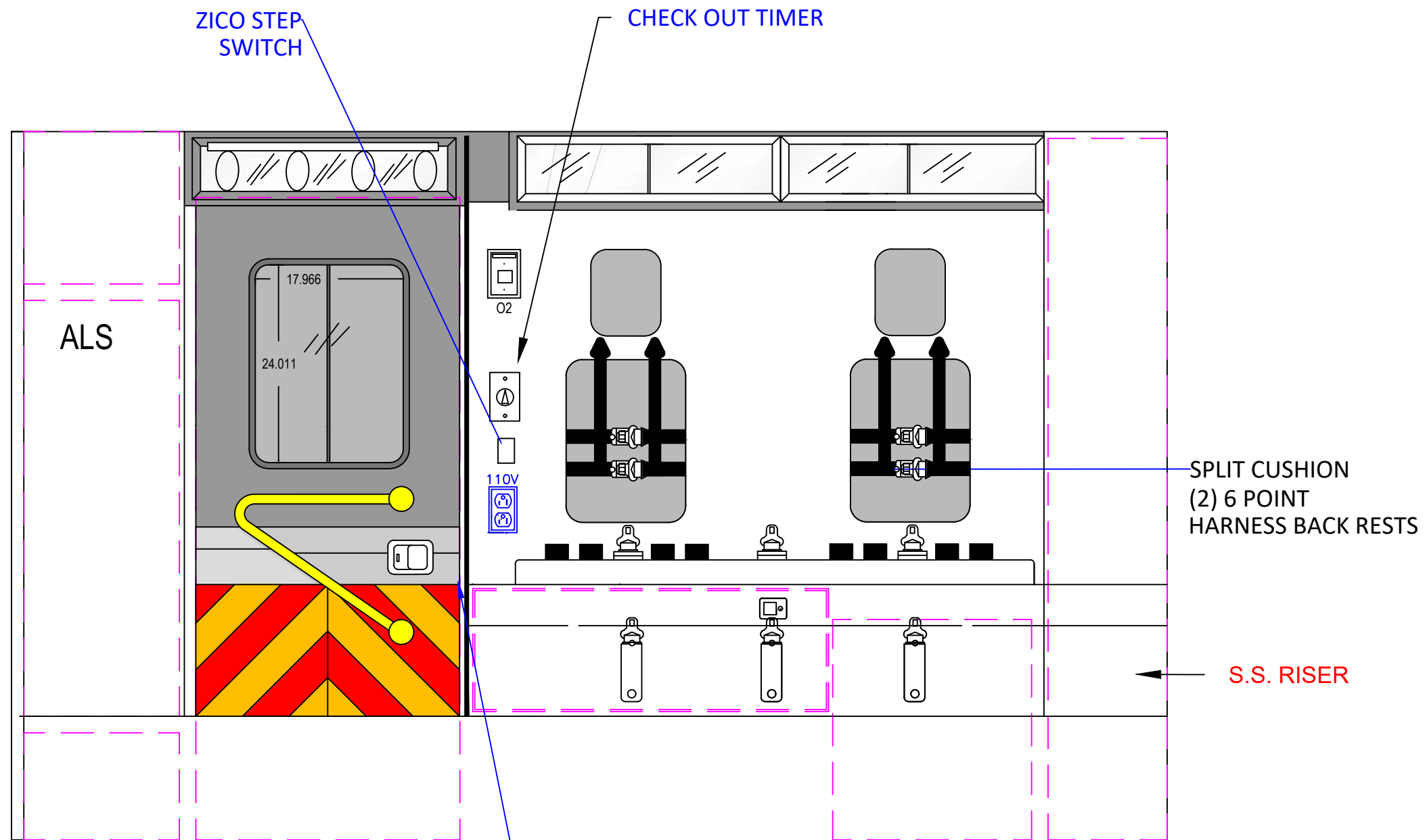

GLOSSY GRAY / GLOSSY WHITE FORMICA
 GUNMETAL UPHOLSTERY
 LONPLATE FLOORING
 WHITE COUNTERTOPS

		BULLOCH	
		WORK ORDER	
	SIZE B	PART	REVISION
		PASSENGER INT.	
WO#5	SCALE	DRAWN BY AK	DATE

HOSELINE 12V
 DUCTED / AUX CONDENSER
 DIGITAL THERMOSTAT
 HEAT VALVE HIGHER THAN STD
 BLUE LED LIGHT

RADIO CABINET
 FLIP UP

RC TRONICS.
 ETHERNET (4) WIRES
 TO CONSOLE.
 PATTERN SWITCH FOR
 WARNING LIGHTS.

PLEXI DOORS

MEDIKOOL
 40SS w/ CompX
 REGULATOR ELECT LOCK

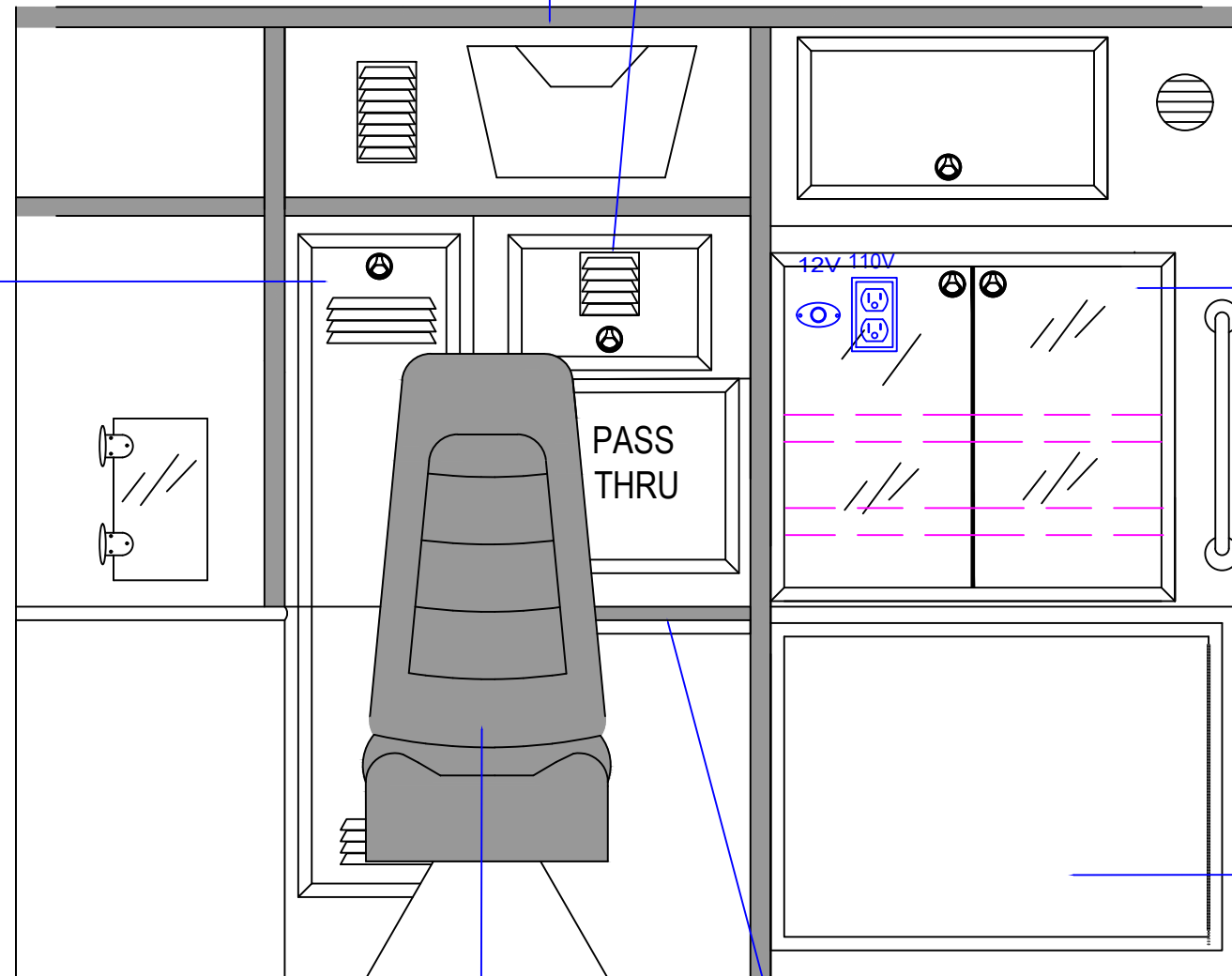

SHELF

WISE 3PT GUNMETAL
 SWIVEL BASE

		BULLOCH	
		WORK ORDER	
	SIZE B	PART	FRONT INT.
WO#6	SCALE	DRAWN BY AK	DATE

DRY ERASE
MARKER BOARD
30"x15"
MOUNTED 12" DOWN FROM TOP
AND 3" BACK FROM THE FACE

DUMP SWITCH
ON DOOR

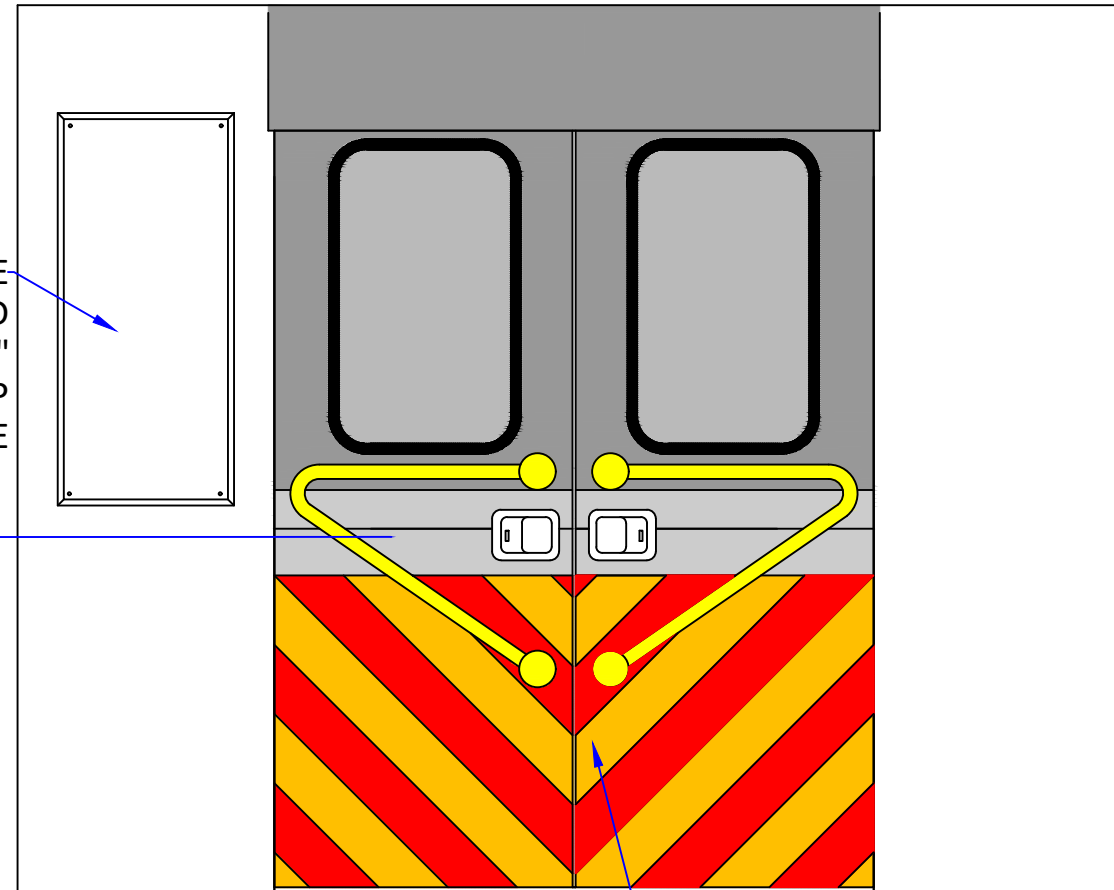

EMERGENCY RELEASE
LATCHES

	BULLOCH		
	WORK ORDER		
	SIZE B	PART REAR INT.	REVISION
WO#7	SCALE	DRAWN BY AK	DATE

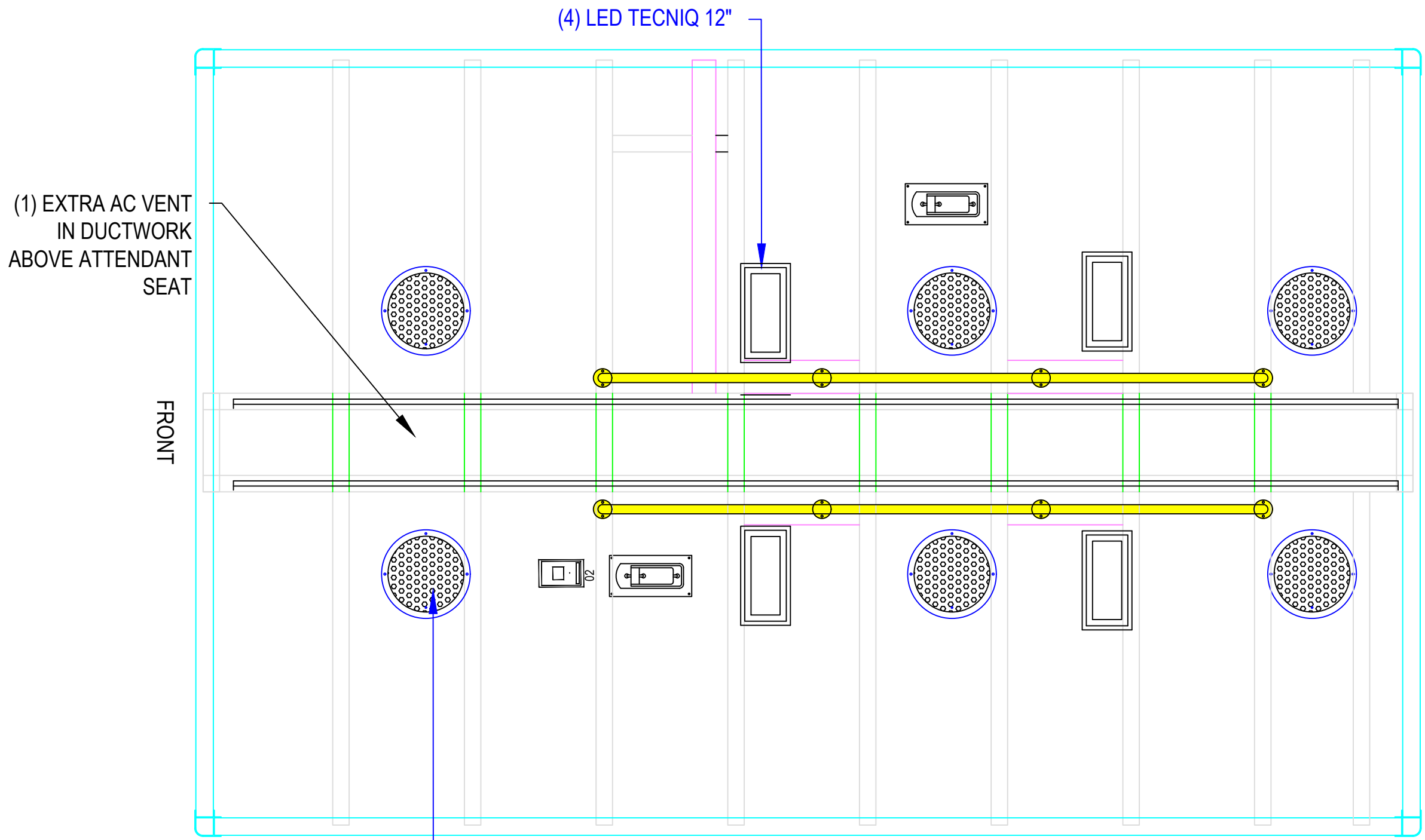

(1) EXTRA AC VENT
IN DUCTWORK
ABOVE ATTENDANT
SEAT

FRONT

(4) LED TECNIQ 12"

(6) CODE 3 VIOSAFE
DOME LIGHTS

EVERGREEN UV #ADU-136-PB LIGHT
LAYOUT TO BE DETERMINED

		BULLOCH	
		WORK ORDER	
	SIZE	PART	REVISION
	B		
WO#8	SCALE	DRAWN BY	DATE
		AK	