

City of Columbia City Hall Renovation to Development Services & City Recorder Counters Contract Documents



owner City of Columbia
700 N. Garden St.
Columbia, TN 38401

architect the architect WORKSHOP
700 Melpark Drive
Nashville, TN 37204
phone: 615.750.3137

architect project number 1724

contract documents table of contents

cover
a01 - plan
a02 - details
a03 - details
a04 - existing conditions
a05 - specifications
a05a - specifications
a05b - specifications
a05c - specifications
a05d - specifications

draft owner-contractor agreement

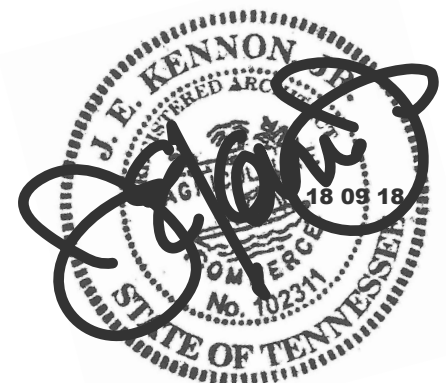

INVITATION TO BID

The City of Columbia, Tennessee is soliciting bids for Renovations to the City Recorder and Development Services public counters located in the main floor lobby of the City Hall Building, in Columbia, Tennessee from qualified general contractors for the following scope of work.

Sealed bids will be received until **2 pm, 16 October 2018**
at the Architect's office, 700 Melpark Drive, Nashville, TN 37204

Bidding Documents will be available electronically after
9 am, 18 Sept 2018 at the Architect Workshop – email
bidding@TheArchitectWorkshop.net to request documents.

Scope of work consists of modifications to the two counters to install ballistic rated windows at the counters and related upgrades and changes to the counters. The City intends to award work in November for work to begin after the first of the year. Anticipated total duration is 12 weeks (8 weeks for material delivery, 4 weeks onsite)

Potential bidders are invited to attend a contact Danny King, Assistant City Finance Director, City of Columbia danny@columbiatn.com to visit the project location prior to bids.

The City of Columbia is an equal opportunity employer and provider.

END OF SECTION

18 Sep 18

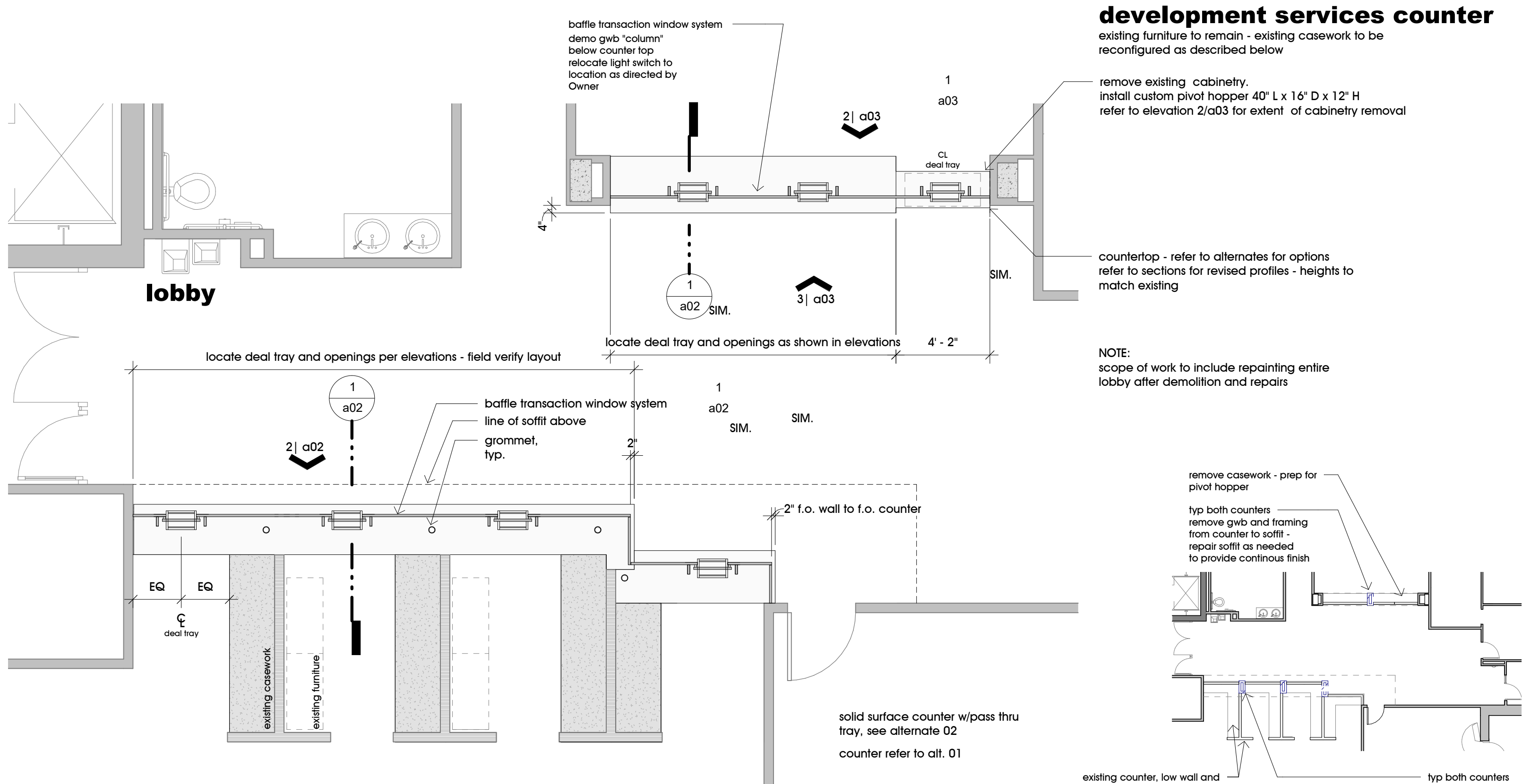

development services counter

existing furniture to remain - existing casework to be reconfigured as described below

remove existing cabinetry.
install custom pivot hopper 40" L x 16" D x 12" H
refer to elevation 2/a03 for extent of cabinetry removal

countertop - refer to alternates for options
refer to sections for revised profiles - heights to match existing

NOTE:
scope of work to include repainting entire lobby after demolition and repairs

city recorder counter

existing casework & furniture to remain

1 City Recorder & Development Services Counters

1/4" = 1'-0"

2 demolition

1/16" = 1'-0"

a01

Columbia City Hall - Renovations

700 N. Garden St.
Columbia, TN 38401

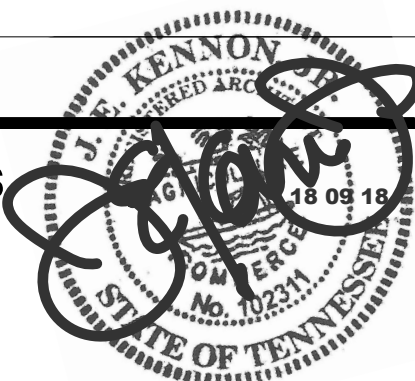

plan | the architect
WORKSHOP

18 Sep 18

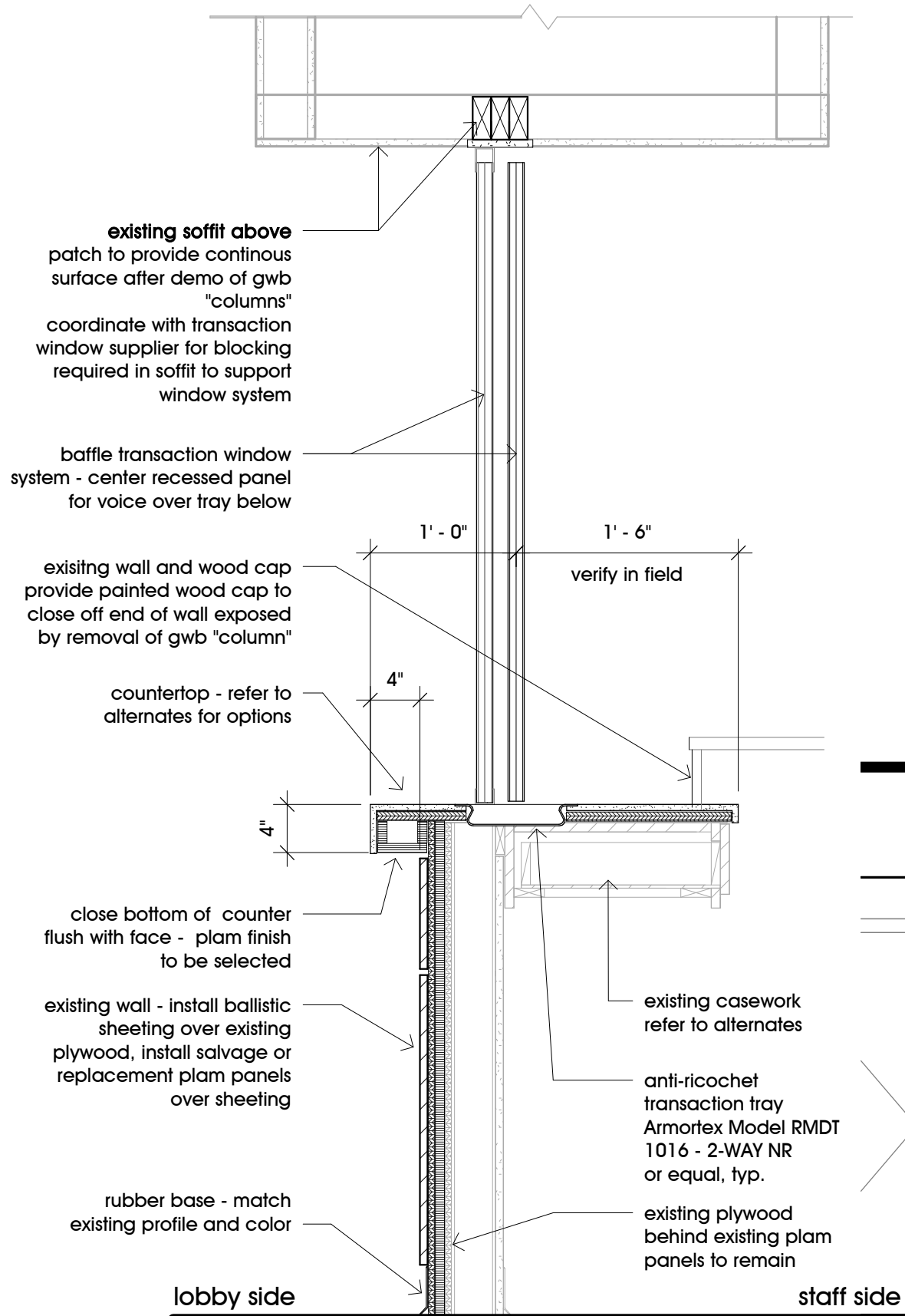
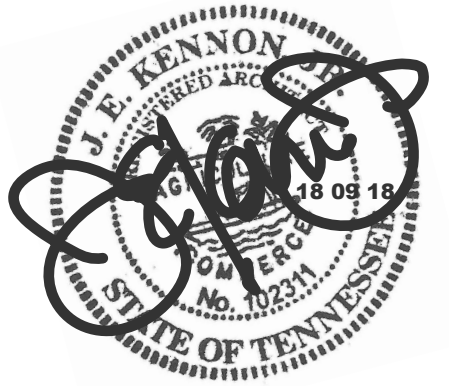

1 section detail - counter typical
1" = 1'-0"

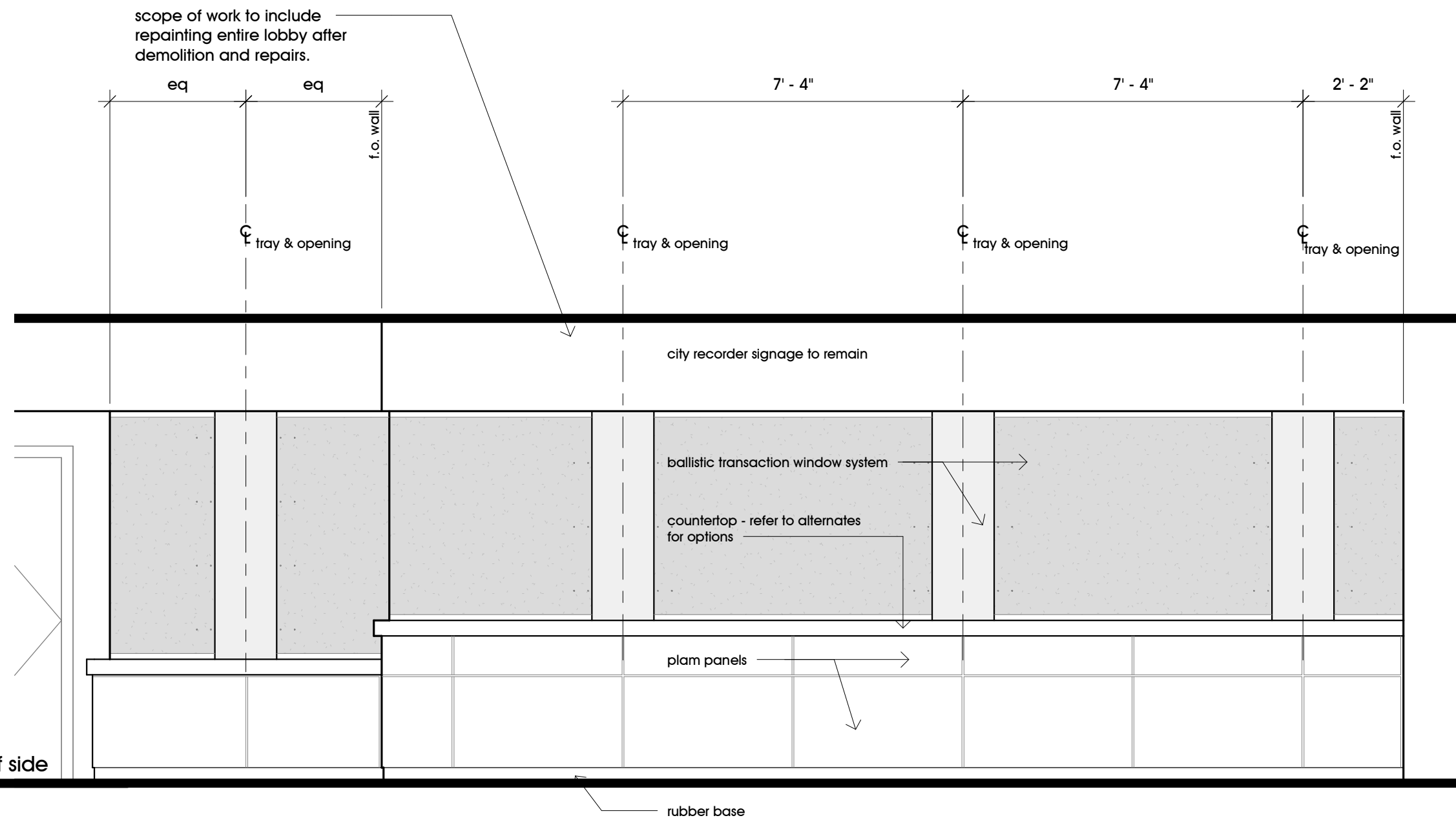

2 city recorder counter - lobby side
3/8" = 1'-0"

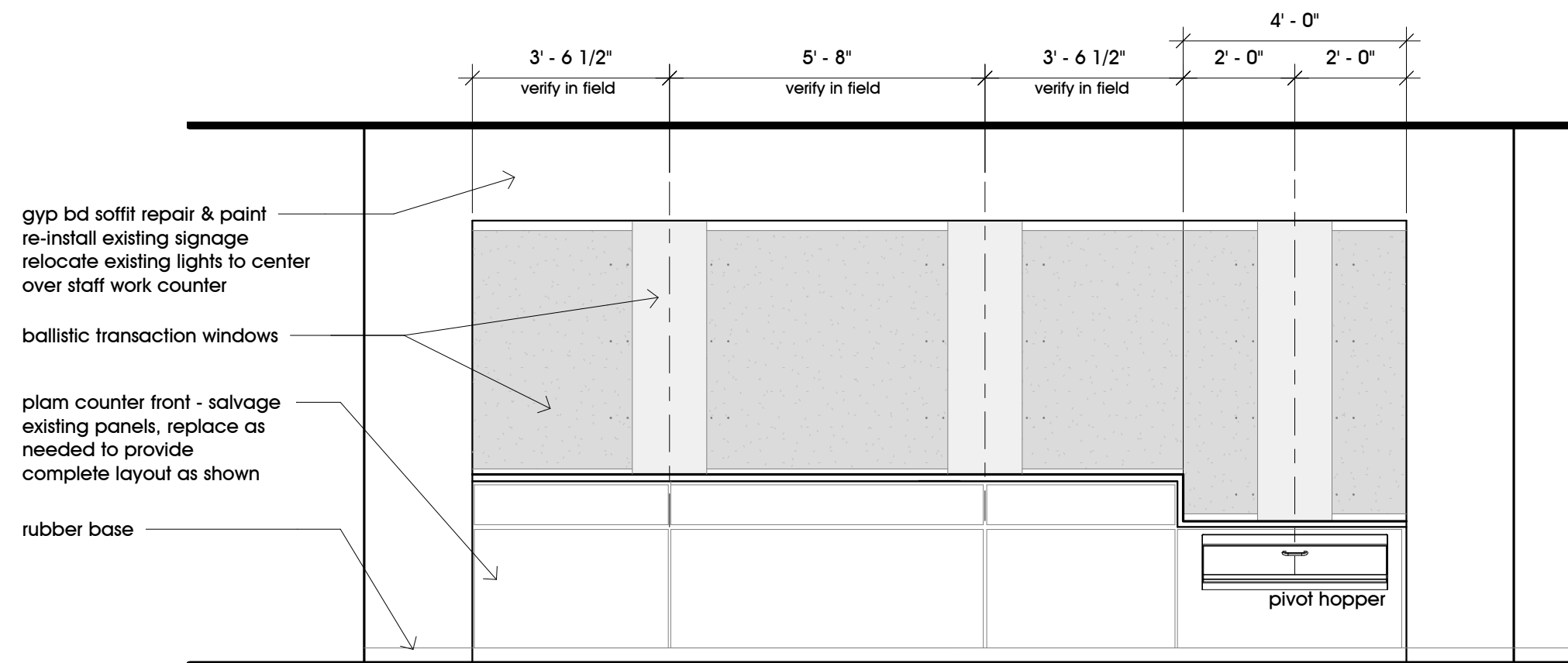
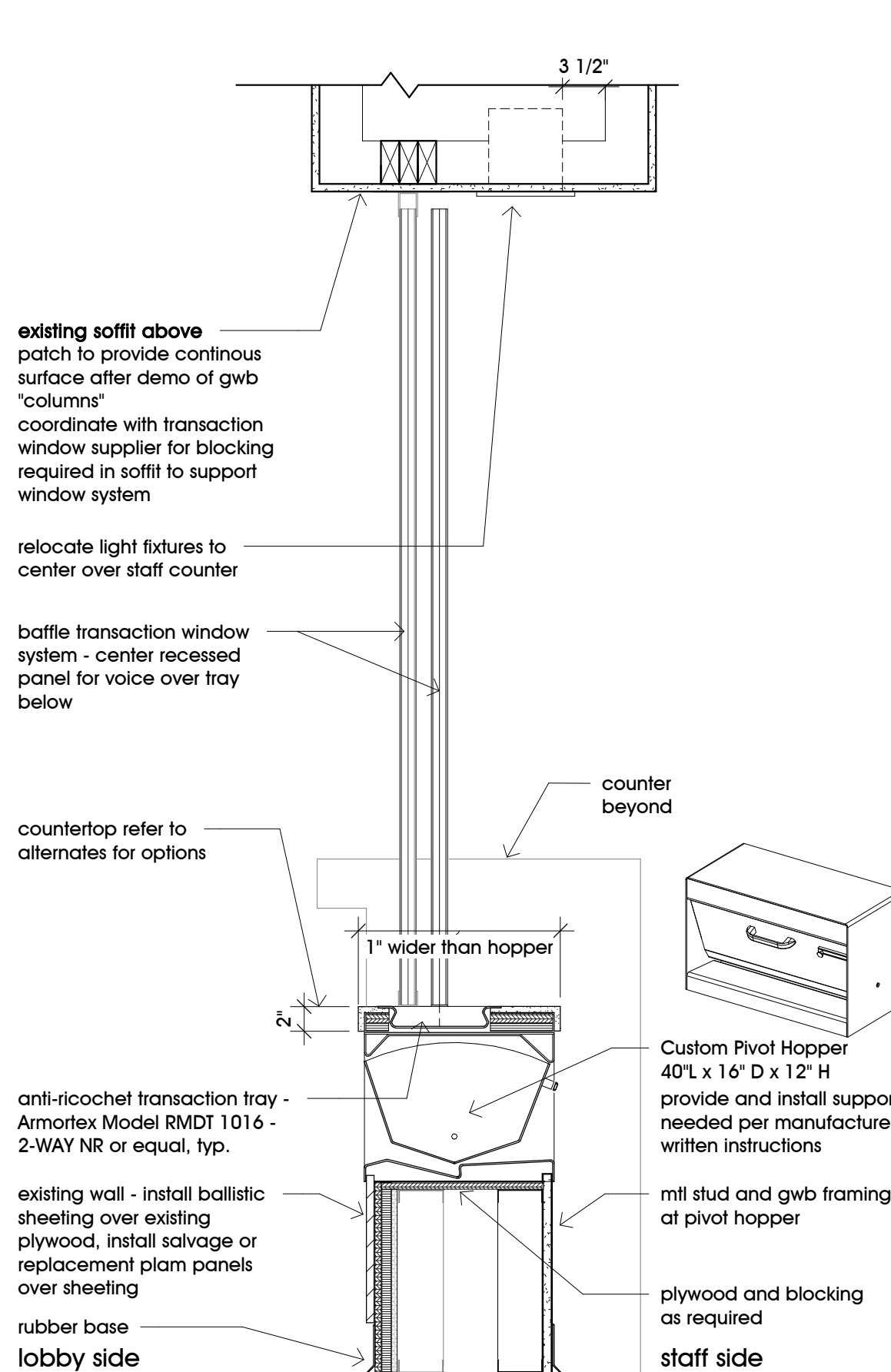

3 development counter - lobby side

3/8" = 1'-0"

- baffle transaction windows refer to specifications
- counter top - refer to alternates for options
- existing casework - salvage and reconfigure as shown
- refer to section - construct filler panel of matching casework to flush out space for pivot hopper

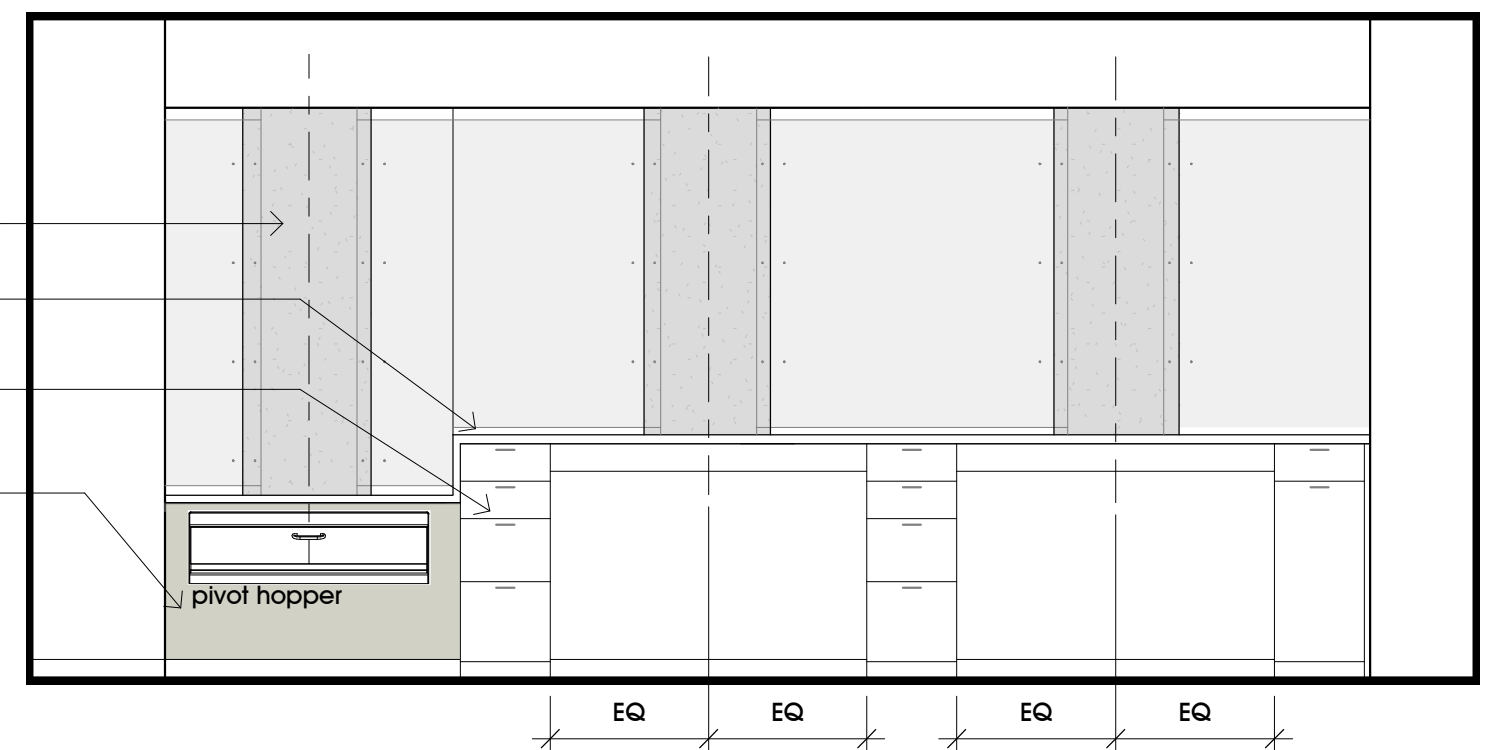

2 development services counter - staff side

3/8" = 1'-0"

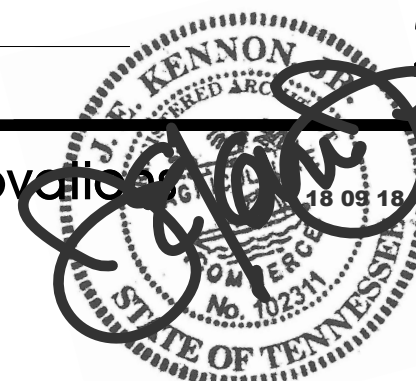

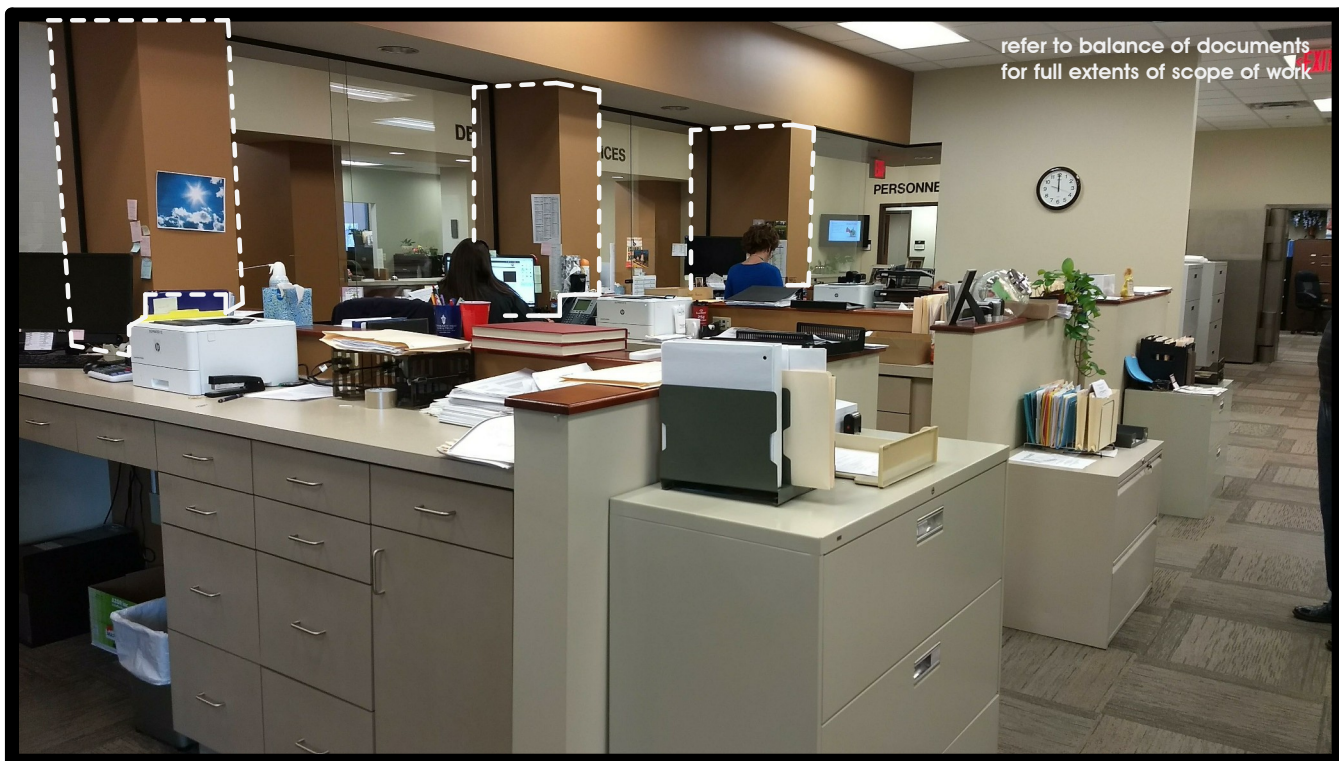

city recorder - staff side



city recorder - staff side



development services - staff side



lobby

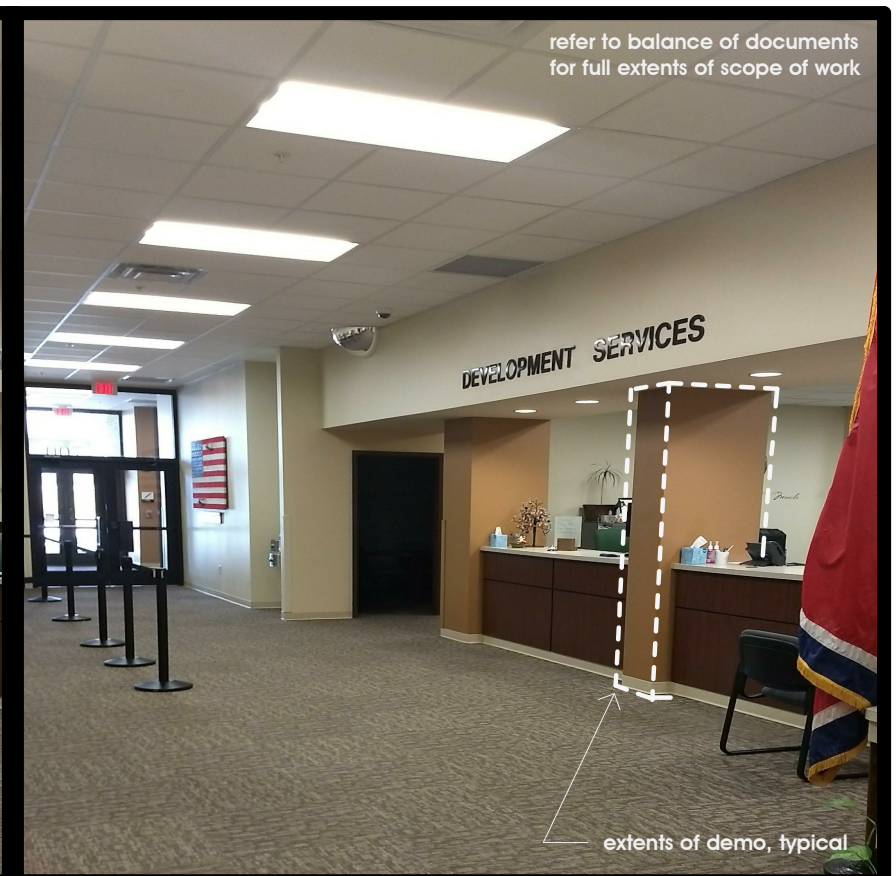

general notes

Contractor is responsible for the means & methods of construction, including scheduling, sequencing & coordination of trades. Contractor is responsible for scheduling & arranging for elevators, hoisting facilities, parking, & handling of materials.

Contractor is responsible for compliance with codes, ordinances, & regulations applicable to the project location. Contractor shall obtain all necessary permits & approvals & shall maintain copies of these documents at the job site throughout the project. If Contractor at any time ascertains that any requirement of these documents is at variance with applicable laws, ordinances, regulations or building code requirements, he shall immediately notify Architect for clarification.

These drawings have been developed from existing drawings, provided by others, which may not reflect actual field conditions. Contractor shall verify field conditions and notify the Architect immediately of any discrepancies prior to commencing with work.

Contractor shall furnish, & pay for, all drawings necessary for use on the project by Contractor's employees & subcontractors.

Contractor is responsible for the verification of all field measurements, field construction installation criteria, coordination of all trades & owner supplied items. Contractor shall verify all dimensions & job conditions & shall report to Architect any discrepancies or omissions which would interfere with satisfactory completion of the work.

Contractor shall not scale drawings. If additional information is required to clarify these documents, the Contractor shall contact the Architect immediately.

Contractor shall become acquainted with all available information concerning the job site conditions, nature of the work, general local conditions, codes & ordinances, disposal, handling & storage of materials, availability of labor, as well as all other matters which may in any way affect the work or cost thereof. Failure to do so will not relieve the responsibility of properly estimating the difficulty or cost of successfully performing the work.

Contractor shall provide all materials necessary to construct the total project, whether or not details are provided. If additional information is required, contact Architect immediately. All work shall conform to the drawings & specifications. Both the drawings & specifications contain information vital to the performance of the work & should never be considered separately. These documents are to be considered only as a total package. If discrepancies appear in the Contract Documents, the Contractor shall notify the Architect before proceeding with the work. If such a conflict occurs in or between drawings & specifications, the Contractor shall provide the more restrictive condition or material.

provide the owner with a maintenance manual of manufacturer's recommended routine and special maintenance instructions for each item.

all finish materials are to be supplied from (1) dye lot or color batch per item, including, but not limited to paint and wall covering.

the minimum flame spread classification of all interior finishes shall be class C interior finish (FLAME SPREAD 76-200, SMOKE DEVELOPED 0-450) per SBC 2000, article 803

changes in the work

Architect/Owner's representative, without invalidating the agreement, may order changes by altering, adding to or deleting from the work. Such changes shall be made only when issued in writing by the Architect/Owner's Representative.

building maintenance & protection

Contractor shall maintain the site, interior & exterior, in a safe, clean, & orderly manner at all times. Contractor shall make provisions for disposal of all construction debris in a manner consistent with all building, local, state, & federal regulations. The site shall be kept clean of demolition debris, & new construction material shall be stored in an orderly manner.

The consumption of food & drink, or smoking shall not be permitted on the premises except in areas designated by the Building Representative.

Contractor shall maintain sanitary facilities on the site, & refrain from utilizing the existing facilities, unless otherwise specified.

Contractor shall protect all existing construction that is not scheduled for demolition. The Contractor is responsible for any damage to existing elements which occurs during the execution of the work. Contractor shall take whatever precautions are necessary to protect existing utility lines, ductwork, fixtures, etc. which remain as part of the final systems. Contractor shall clean, repair, relamp, etc. these items as required for proper function of the final systems.

Contractor shall maintain the building envelope in a watertight condition at all times.

Contractor shall protect all existing structures, utilities, signs & installation of any kind against damage or interruption of service. Contractor will notify the Building Representative of any impending interruption of service.

Contractor shall protect & preserve all materials, supplies & equipment, including property which may be owner-furnished, or owned, & all work previously installed.

Contractor is responsible for notifying the Architect/Owner's Representative of any damage done by others or of any existing damage found prior to startup of the work. All costs for repair or replacement of this damage are the responsibility of the Contractor.

safety

Contractor shall exercise caution at all times for the protection of persons (including employees) & property. Observe the provisions of applicable laws, building & construction codes & O.S.H.A. In no case shall the Owner, Architect or Owner's Representative be responsible for construction means, methods, techniques, sequences or procedures, or for safety precautions & programs in connection with the work. Nor shall the Owner, Architect or Owner's Representative be responsible for the Contractor's failure to employ proper safety procedures.

existing conditions notes

Existing base cabinetry units to remain shall be protected from damage, including during temporary removal as required for installation of armortex wall covering.

existing wood paneling in lobby area to remain, protect from damage during construction

renovation notes

If fire rated building assemblies are damaged or modified during demolition or new construction, these assemblies shall be returned to their original rated condition. Contractor shall verify that existing walls indicated as fire-rated are constructed in accordance with local building code requirements. Upgrade existing construction to comply with codes if necessary.

If materials containing or suspected of containing asbestos or other hazardous materials are encountered during demolition or construction, contact Owner's Representative immediately.

If previously unknown structural elements are encountered during demolition, work shall be terminated immediately & Architect/Owner's Representative shall be notified. Contractor shall be responsible for shoring, bracing, & stability of the work during demolition & new construction.

Contractor shall identify the location of all utilities related to this project prior to commencing work. If any unknown existing services are located notify Architect/Owner's Representative immediately. If any building services are to be disrupted for any reason, notice shall be given to the building management minimum of 48 hours prior to interruption of service.

Contractor shall remove all elements indicated to be demolished. Walls & ceilings indicated for demolition shall be removed completely, including electrical, communications, plumbing, mechanical & other components of construction. Terminate all services in a safe condition above line of ceiling or below line of floor. Remove all fixtures & related plumbing attachments in areas where demolition occurs. Cap & seal all drains which are not to be reused.

Contractor shall repair all walls disturbed by demolition or remodeling. Patching should not be visible & final finish should match existing adjacent wall surfaces. Extend finish to nearest transition point.

Contractor shall clean, & touchup finish on existing doors to remain. Existing fixtures (lights, toilets, blinds, etc.) to remain shall be cleaned & repaired as necessary to be operational. Level of repair shall be coordinated in advance with Architect/Owner's Representative.

schedule

Owner intends to award contract and allow material submittals and procurement to proceed prior to Contractor being on site.

Contractor will be allowed 8 weeks - final schedule to be determined upon award - for shop drawings and material procurement. Work shall not proceed onsite until Contractor submits confirmation that all materials are onsite or under their control at a local warehouse.

Contractor will be allowed 4 weeks for onsite construction including final cleaning and closeout.

Sequence of renovation to be developed with general contractor and city representatives, after award of contract., it is anticapted that extended work hours, or weekend work hours maybe required to complete the work with minimal disruption to Owner. Contractor shall make assumptions in bid for work hours to complete within the allotted 4 weeks. Lidquadated Damages of \$500 day shall be in effect once work begins on site.

City will work with Contractor in order to allow the Development Services and City Records office to rotate during the week a "closing or reduced services" days in order to accommodate the project construction sequences. City intends to keep both desks open during renovation with planned 1-2 day closures during weeks. Final schedule and sequence of closings to be developed with general contractor and city representatives. City proposed to close the City Recorder Desk on Mondays and Development Desk on Fridays to facilitate construction. Saturday and Sunday work is also allowed.

final cleanup

Prior to final inspections & the Architect/Owner's Representative acceptance of the work, clean all areas of the project site within the area of work. These clean up operations include but are not limited to:

- cleaning glass areas, interior & exterior.
- cleaning exposed unpainted metals.
- removing trash & debris from the site & providing legal disposal.
- cleaning all exposed surfaces including lenses of all lighting fixtures.
- removing construction dust, paint over spray, & hand prints.
- cleaning all toilet partitions, fixtures & accessories.
- removing all surplus materials, tools, & other unused materials.
- vacuuming all carpeted floors.
- cleaning & preparing resilient flooring per manufacturer's recommendations
- all cleaning operations shall be performed in strict accordance with the manufacturer's written recommendations using products approved by the manufacturer for the materials being cleaned.

final close-out

When work is considered complete, the Contractor shall submit written certification that:

- work has been completed in compliance with the contract documents or describe in detail the work remaining & completion time frame.
- equipment & systems have been tested in the presence of the Architect/Owner's Representative & are operational.
- final cleanup has been performed
- required test reports have been submitted, (if applicable).
- all keys have been delivered to owner.
- all operating tools, replacement items, & "attic stock" materials specified have been delivered to owner, (if applicable).
- all required certificates & guarantees have been delivered to owner including, but not limited to signed-off permits, final inspections, & certificate of occupancy by local authorities having jurisdiction, evidence of payment, & release of liens & certificate of insurance for products & completed operations, (if applicable).

The Architect/Owner's Representative will review the work to verify the status of completion with reasonable promptness after receipt of such certification. If the work is considered incomplete or defective, the Contractor will be notified in writing listing the areas of concern. Contractor shall take immediate steps to remedy the stated deficiencies & send a second written certification that the work is complete. When the Architect/Owner's Representative finds that the work is acceptable with respect to the contract documents, he shall request the Contractor to make close-out submittals

alternates

base bid shall include scope as shown on these documents provide pricing for alternates as identified below Contractor to identify cost and schedule impacts related to alternates

alternate 01 - base bid rework and salvage existing casework at replacement countertops alternate to be replacement of existing casework with new to match existing, in lieu of salvage

alternate 02 - new countertops base bid to be plastic laminate alternate to be solid surface

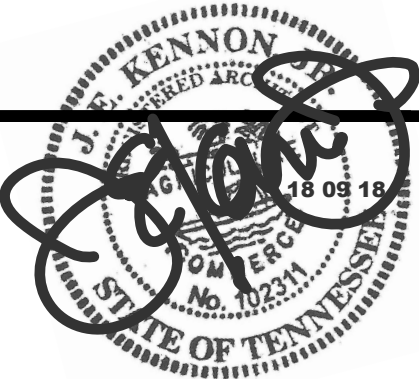

specifications

general carpentry

QUALITY ASSURANCE: Lumber standards: Comply with PS 20 & with applicable rules of the respective agencies for species & products specified. Plywood product standards: Comply with PS 1 (ANSI A199.1) or, for products not manufactured under PS 1 provisions, with applicable APA Performance standard for type of panel indicated.

LUMBER: Dimensions: Conform to standards established by the American Lumber standards Committee. Moisture content: Unseasoned or 19% maximum at the time of permanent closing in of the structure. Surfacing: S4S. Light framing (less than 6" wide): "Stud" grade for stud framing or "standard" grade for other light framing, any species.

MISCELLANEOUS LUMBER: Provide wood for support or attachment of other work including, but not limited to, cant strips, bucks, nailers, plates, blocking, bracing, furring, grounds, stripping & similar members. Provide lumber of sizes indicated, worked into shapes shown. Shall be #2, GM, SYP, KDAT.

WOOD TREATMENT - FIRE-RETARDANT: Where lumber or plywood is specified or otherwise indicated to be fire-retardant, provide materials which comply with AWWPA standards for pressure impregnation with fire-retardant chemicals

FASTENERS & ANCHORAGE: Provide size, type, material & finish as indicated & as recommended by applicable standards, complying with Federal Specifications for nails, staples, screws, bolts, nuts, washers & anchoring devices. Provide metal hangers & framing anchors of the size & type recommended by the manufacturer for each use including recommending nails. Where rough carpentry work is exposed to weather, in ground contact, or in area of high humidity, provide fasteners & anchorage with a hot-dip zinc coating (ASTM A 153).

WOOD GROUNDS, NAILERS, BLOCKING & SLEEPERS: Provide for screeding or attachment of other work. Form to shapes as shown & cut as required for true line & level of work to be attached. Coordinate location with other work involved. Attach to wall framing to support applied loading. In stud walls, provide blocking for support of h&rails, wall cabinets, toilet vanities, etc.

paint

MANUFACTURERS: Porter Paint Company (specified),

SUBMITTALS: Submit product literature and color/finish samples of all selections.

PREPARATION OF SURFACES: Examine surfaces to be painted prior to commencement of work. Remove loose dirt and foreign matter then prime to show defects. Paint after defects have been remedied. Commencement of work shall be construed as acceptance of the surfaces and, therefore, the Contractor shall be fully responsible for satisfactory work as required herein. Apply masonry filler to concrete block as required to provide even, consistent surface. Prime, stain, or seal wood required to be job painted immediately upon delivery to job. Fill nail holes and cracks after primer has dried and sand between coats. Clean unprimed steel surfaces by washing with solvent. Apply treatment of phosphoric acid solution, ensuring weld joints, bolts and nuts are similarly cleaned.

Completely mask, remove, and protect all hardware, accessories, lighting fixtures, and similar items in contact with painted surfaces. Spot prime all exposed nails and other metals that are to be painted with emulsion paints, using a primer recommended by the manufacturer of the coating system.

APPLICATION: Paint exposed surfaces whether designated in any "schedule", unless surface is noted to be natural finish. All materials shall be applied under adequate illumination, evenly spread, and smoothly flowed on with the proper type and size of brushes, roller covers, bucket grids, and spray equipment to avoid run, sags, holidays, brush marks, air bubbles, and excessive roller stipple. Coverage and hide shall be complete.

When color, stain, mark of any kind, dirt or undercoats show through the final schedule coat of paint to the surface, it shall be covered by additional coats until the paint film is of uniform finish, color, appearance and coverage at no additional cost.

Finished areas shall be free from sags, runs, crawls, brush marks, and other defects. Touch-up painting as required to provide smooth, even finish prior to final acceptance of work and remove paint where spilled, splashed or spattered.

Provide Low VOC paints - sheen and color to match existing finishes and colors

PAINT SCHEDULE - INTERIOR:
Metal Surfaces - Enamel (Semi-Gloss): 1 coat Porter 296 Rust Inhibitive Primer - 1.8 mil DFT, 2 coats Porter 439 Glyptex - 1.5 mil DFT.

Gypsum wallboard ceilings - Latex (Flat): 1 coat Porter 426 Drywall Sealer - 1.3 mil DFT, 2 coats Porter 945 Vinyl Suede - 1.2 mil DFT. each coat.

Gypsum wallboard - Latex (Eggshell): 1 coat Porter 767 Latex Primer Sealer, 2 coats Porter 36168 Latex Eggshell.

Wood - Enamel (Semi-Gloss): 1 coat Porter 135 Enamel Undercoat - 1.4 mil DFT, 1 coat mixture of 1/2 Porter 135 and 1/2 Porter #439 - 1.9 mil DFT, 1 coat Porter aside 439 Glyptex Eggshell - 1.9 mil DFT.

Wood - Stain (Low sheen): 1 coat Porter 832 Stain (degree of color as determined by the Architect), 1 coat Porter 671 Sanding Sealer, 1 coat Porter 831 Rubbed Effect Varnish.

gypsum wallboard

Quality Assurance: United States Gypsum Company Gypsum Construction handbook & Gypsum Association (GA) Publications. Provide fire-rated assemblies materials & construction identical to those of assemblies tested for fire resistance per ASTM E119 by an independent testing & inspecting agency acceptable to authorities having jurisdiction.

Product: fire rated, 5/8", USG "X" board. Conform to "specification for Gypsum Drywall", ASTM C36 for type "X: gypsum board.

Installation: Provide suitable back-up anchorage as required for the attachment fo shelves and cabinets. Treat joints, screw head depressions, or defects incurred during the installation with joint treatment.

Finish: Apply joint treatment at gypsum board joints (both directions); flanges of corner bead, edge trim, & control joints; penetrations; fastener heads, surface defects, & elsewhere as required to prepare gypsum board surfaces for levels of gypsum board finish match existing. Pre-fill open joints, rounded or beveled edges, & damaged areas using setting-type joint compound.

Apply joint tape over gypsum board joints & trim accessories with concealed face flanges as recommended by trim accessory manufacturer & as required to prevent cracks from developing in joint compound at flange edges.

Repair areas within existing walls and ceilings with even square cuts and infill to provide smooth transition at infill, sand and patch to conceal removed section. Refer to paint for additional criteria at patches.

METAL STUDS: Non-load bearing, screw-type, channel studs, roll-formed with 25 gauge electro-galvanized steel in sizes as indicated on the Drawings. Flanges shall be at least 1-1/4" wide. Webs shall be punched to receive bridging, conduit, piping, etc. Meet or exceed ASTM C645, "Light-Gauge Studs, Runners, & Rigid Furring Channels". Unless otherwise directed, install on 16" centers.

METAL TRIM: Trim: USG #200 series. All metal that shall be concealed when wall is finished out & size to accommodate drywall thickness. Corner beard: "Dura-A-Bead" all metal heavy gauge hot-dipped galvanized steel reinforcement for protecting external corners.

JOINT TREATMENT: Products to comply with ASTM C-475, "Joint Treatment Materials for Gypsum Wallboard Construction". Joint reinforcing tape: Perf-A-Tape Reinforcing Tape. Joint compounds: Durabond Joint Compound-Taping & USG Crater, Free Ready-to-Use Joint Compound Topping.

ENVIRONMENTAL CONDITIONS: During & after application of these materials, temperatures within the building shall be maintained within the range of 55 degrees F to 70 degrees F. Adequate ventilation shall be provided to carry off excess moisture.

METAL FRAMING INSTALLATION: Install metal studs & accessory items in strict accordance with the approved submittal of manufacturer's recommendations, anchoring all members in position for long life under hard use. Align all partition & wall assemblies to a tolerance of one in 200 horizontally & one in 500 vertically. Attach steel runners at floor & ceiling to structural elements with suitable fasteners located 2" from each end & spaced 24" o.c. To suspended ceilings, use toggle bolts or hollow wall anchors spaced 16" o.c. Place studs in direct contact with all door frame jams, abutting partitions, partition corners & existing construction elements. Where studs are installed directly against exterior walls & a possibility of water penetration through walls exists, install asphalt felt strips between studs & wall surfaces. Anchor all studs for shelf-walls & those adjacent to door & window frames, partition intersections, corners & freestanding furring to ceiling & floor runner flanges with metal lock fastener tool or screws.

sealants

SUBMITTAL - Submit product literature & color samples for selection.

SEALANT -as recommended by product manufacturer for sealant of joints in product

PRIMERS: As recommended by the sealant manufacturer for use in conjunction with the sealant for application onto the various types of materials to which the sealant applied, & complying with the requirements above. When the manufacturer's instructions make reference to use of primers &/or the construction condition requires special surface preparation, these instructions shall be complied with. Where required by manufacturer's instructions in lieu of primers, shall be of the type & kind recommended by the sealant manufacturer.

BACK-UP MATERIALS: Verify the compatibility of filler material with caulking before installation. Use filler about 1/3 to wider than width of joint so sufficient pressure is exerted by filler to provide substantial resistance to displacement.

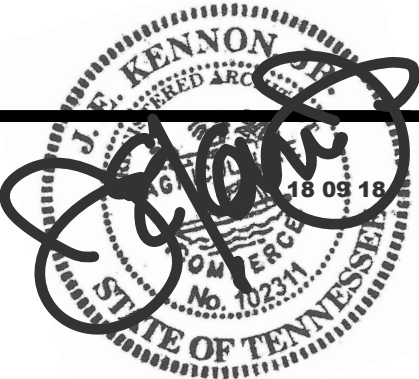

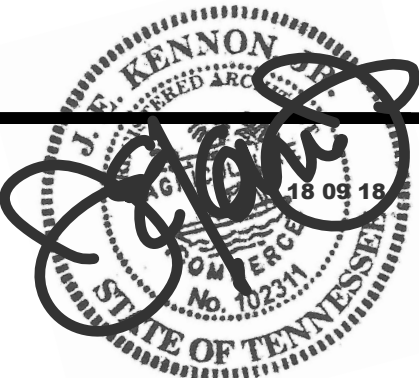

Plastic Laminate Casework and Countertops

PART 1 - GENERAL

- 1.01 SUMMARY**

A. Section Includes:

1. Plastic Laminate Casework and Countertops

2. Hardware typically furnished by the casework manufacturer.

3. Structural supports incorporated into wood casework.

B. Excluding:

1. Metal support brackets and fittings that are part of the building structure.

2. Plumbing, electrical fixtures, and telephone equipment.

C. Related Sections:

1. Countertops.

2. Rough Carpentry: Wood blocking or grounds inside finished walls or above finished ceilings.
- 1.02 REFERENCES**

A. *Architectural Woodwork Standards* (AWS), latest edition. Jointly published by Woodwork Institute, Architectural Woodwork Institute, and the Architectural Woodwork Manufacturers' Association of Canada.
- 1.03 SUBMITTALS**

A. Shop Drawings:

1. Submit shop drawings in conformance with the requirements of *Architectural*
- 1.04 QUALITY ASSURANCE**

A. Work shall be in accordance with the Grade or Grades specified of the *Architectural Woodwork Standards*.

B. Qualification:

1. Firm (woodwork manufacturer) with no less than 5 years of production experience similar to a specific project, whose qualifications indicate the ability to comply with the requirements of this Section.
- 1.05 DELIVERY STORAGE AND HANDLING**

A. Deliver materials only when the project is ready for installation and the general contractor has provided a clean storage area.
- PART 2 - PRODUCTS**

2.01 COMPONENTS

A. Lumber: In accordance with the *Architectural Woodwork Standards* Grade specified for the product being fabricated. Moisture Content: 6% to 12% for boards up to 2 inch (50.8 mm) nominal thickness, and shall not exceed 19% for thicker pieces.

B. Core: MDF meeting the requirements of *Architectural Woodwork Standards*.

1. Made with no added Urea Formaldehyde.

2. Water resistant core, where required: Particle board meeting the requirements of ANSI A208.1 Grade M3 MR-50 or MDF meeting the requirements of ANSI A 208.2 Grade 155 MR-50.

C. Veneer core plywood: A non-telegraphing hardwood manufactured with exterior glue.

D. Plastic Laminate: Meeting the requirements of the *Architectural Woodwork Standards* for its use.

E. Cabinet Liner: NEMA LD-3 Grade CLS.

F. Edgeband: **PVC or ABS matching the color and pattern of the exposed laminate**

G. Adhesives: Type II, water resistant.

H. Hardware:

1. Finish: match existing hardware

2. Pulls: \$10 each allowance – match existing pulls.

3. Drawer Guides: Full extension

a. Meeting the requirements of the AWS for the type and size of drawer.

b. File Drawers: Full extension. Minimum 100 pound capacity except 150 pound capacity for lateral files.

4. Hinges: Five knuckle Grade 1 hinges

5. Shelf Supports: Bored hole system with metal supports

Plastic Laminate Casework, con'td

- 2.02 FABRICATION**

A. Grade: AWS Custom Grade.

B. Exposed Exterior Surfaces: High Pressure Decorative Laminate. Color and pattern as selected by the architect.

C. Exposed interior surfaces: melamine overlay color and pattern compatible with exposed surfaces

D. Semi-exposed surfaces: Low-pressure melamine overlay

E. Cabinet construction type: Frameless.

F. Door Interface Style: Flush overlay

G. Edgeband: PVC, matching the color and pattern of the exposed laminate

1. [Edgeband at doors, drawer fronts, and false fronts: 3mm PVC

H. Drawers:

1. Sides: MDF with melamine surfacing.

2. Bottoms: MDF with melamine faces. Bottoms shall be fully housed into drawer sides, backs, and sub-fronts, and securely glued.

3. Joinery: Nailed and glued lock joints

- PART 3 - EXECUTION**

3.01 EXAMINATION

A. Verify the adequacy and proper location of any required backing or support framing.

B. Verify that mechanical, electrical, plumbing, and other building components affecting work in this Section are in place and ready.

3.02 INSTALLATION

A. Install all work in conformance with the *Architectural Woodwork Standards*, latest edition.

1. Installation shall conform to the *AWS* Grade of the items being installed.

B. All work shall be secured in place, square, plumb, and level.

C. All work abutting other building components shall be properly scribed.

D. Mechanical fasteners used at exposed and semi-exposed surfaces, excluding installation attachment screws and those securing cabinets end to end, shall be countersunk.

E. Equipment cutouts shown on plans shall be cut by the installer.

3.03 ADJUSTING & TOUCH UP

A. Before completion of the installation, the installer shall adjust all moving and operating parts to function smoothly and correctly.

B. All nicks, chips, and scratches in the finish shall be filled and retouched. Damaged items that cannot be repaired shall be replaced.

3.04 CLEANUP

A. Upon completion of installation, the installer shall clean all installed items of pencil and ink marks and broom clean the area of operation, depositing debris in containers provided by the general contractor.

END OF SECTION

Plastic Laminate Countertops

- PART 1 - GENERAL**

1.01 SUMMARY

A. Laminated Plastic Countertops.

B. Related Work: Rough Carpentry: Wood blocking or grounds for anchorage
- 1.02 REFERENCES**

A. *Architectural Woodwork Standards*, latest edition.

B. NEMA LD-3, High Pressure Decorative Laminate, latest edition.

C. ANSI 208.1, Particle Board, latest edition.

D. ANSI 208.2, MDF, latest edition.
- 1.03 SUBMITTALS**

A. Shop Drawings: Submit shop drawings in conformance with the requirements of *Architectural Woodwork Standards*.

B. Samples: Submit four samples of each product to be provided. Samples 4"x4" min.
- 1.04 QUALITY ASSURANCE**

A. Work shall be in accordance with the Custom Grade of the *Architectural Woodwork Standards*.

B. Qualification: Firm (countertop manufacturer) with no less than 5 years of production experience similar to a specific project, whose qualifications indicate the ability to comply with the requirements of this Section. Single Source Responsibility: A single manufacturer shall provide and install the work of described in this Section.
- 1.05 DELIVERY STORAGE AND HANDLING**

A. Deliver materials only when the project is ready for installation and the general contractor has provided a clean storage area.

1. Maintain indoor temperature and humidity within the range recommended by the *Architectural Woodwork Standards* for the location of the project.

B. Coordinate fabrication, delivery, and installation with the general contractor and other applicable trades.
- PART 2 - PRODUCTS**
- 2.01 LAMINATED PLASTIC COUNTERTOPS**

A. Grade: AWS Premium Grade.

B. Laminate: Flat Tops: NEMA LD-3 Grade HGS. 0.048 inch thick. Color s selected by the architect from manufacture's range of colors type excluding premium

C. Core material: MDF

D. Backing Sheet: Meeting the requirements of the AWS.

E. Back splash Detail: Square butt joint - 2 inches high. Splash construction: Deck Mount

F. Front edge: Three-millimeter PVC matching the color and pattern of the laminate

G. Cutouts: Seal edges of cutouts with a color toned sealer before items are installed.
- PART 3 - EXECUTION**
- 3.01 EXAMINATION**

A. Verify the adequacy and proper location of any required backing or support framing.

B. Verify that building components affecting work in this Section are in place and ready.
- 3.02 INSTALLATION**

A. Install all work in conformance with *Architectural Woodwork Standards*, latest edition.

B. All work shall be secured in place, square, plumb, and level.

C. All work abutting other building components shall be properly scribed.

D. Equipment cutouts shown on plans shall be cut by the installer, provide grommets as directed by architect and owner for equipment wiring
- 3.03 ADJUSTING & TOUCH UP & CLEAN UP**

A. All nicks, chips, and scratches in the finish shall be filled and retouched. Damaged items that cannot be repaired shall be replaced.

B. Upon completion of installation, the installer shall clean all installed items of pencil and ink marks and broom clean the area of operation, depositing debris in containers provided by the general contractor.
- END OF SECTION

SOLID SURFACE COUNTERTOPS

PART 1 - GENERAL

SECTION INCLUDES:

1. Solid Surfacing Fabrications for countertops as indicated, including trim and material needed for a complete installation.

A. REFERENCE STANDARDS: In addition to requirements, comply with applicable provisions of following for design, materials, fabrication, and installation of component parts:

1. ISSFA-2, "Classification And Standards Publication of Solid Surfacing Material".
2. ASTM G21 "Fungal Resistance," Method [A] [B], no growth.
3. ASTM G22 "Bacterial Resistance," no growth.
4. Stain Resistance, ANSI Z124-6-5.2 1997.

1. DESIGN REQUIREMENTS

- A. DESIGN LOAD: Deflection limited to 1/360.
- B. Design items with sufficient strength for handling stresses.

C. ACCESSIBLE DESIGN: Comply with the U.S. Architectural & Transportation Barriers Compliance Board's "Americans with Disabilities Act (ADA), Accessibility Guidelines for Buildings and Facilities (ADAAG)."

1. SUBMITTALS

A. PRODUCT DATA: Manufacturer's technical literature indicating physical properties and performance criteria for solid surfacing materials and related components.

B. SHOP DRAWINGS: Indicate design parameters, adjacent construction, materials, dimensions, thickness, fabrication details, tolerances, jointing methods, method of support, anchorages, integration with plumbing fixtures and connections, and colors.

C. SAMPLES: Submit two, 2 inch by 2 inch (51mm x 51mm) samples representative of colors, patterns, textures, finishes and edge treatments. Approved samples will be retained as a standard for the work.

D. INFORMATIONAL SUBMITTALS: Submit following packaged separately from other submittals:

1. Manufacturer's written installation instructions.
2. Maintenance Data: Manufacturer's recommended cleaning and maintenance procedures. Include in project closeout documents.

1. QUALITY ASSURANCE

A. FABRICATOR/INSTALLER QUALIFICATIONS: Company specializing in fabricating and installing solid surfacing fabrications similar in complexity to those required in this project, including specific requirements indicated.

B. SOURCE LIMITATIONS: Obtain solid surfacing fabrications through one source.

C. FIRE-TEST-RESPONSE CHARACTERISTICS: Provide solid surfacing fabrications with the following surface-burning characteristics as determined by testing identical products per ASTM E 84 by UL 723 or another testing and inspecting agency acceptable to authorities having jurisdiction:

1. Flame-Spread Index: 25 or less.
2. Smoke-Developed Index: 450 or less.

1. DELIVERY, STORAGE AND HANDLING

A. Deliver, store, handle, and protect materials in accordance with manufacturer's written instructions.

1. Provide protective coverings of suitable material. Take special precautions at corners.

1. PROJECT CONDITIONS

A. ENVIRONMENTAL LIMITATIONS: Do not deliver or install solid surfacing fabrications until building is enclosed, wet work is complete, and HVAC system is operating and maintaining temperature and relative humidity at design levels during the remainder of the construction period.

B. FIELD MEASUREMENTS: Verify that field measurements are as indicated on Shop Drawings.

s.

SOLID SURFACE COUNTERTOPS, Cont'd

1. SEQUENCING

A. Sequence work to permit installation of adjacent affected construction.

B. Coordinate sizes and locations of cut-outs, and other related work specified in other sections to ensure that interior architectural woodwork can be supported and installed as indicated.

1. WARRANTY

A. WARRANTY: Provide manufacturer's 10 year limited warranty covering replacement of the material except for non-covered conditions as follows:

1. Minor stains, scratches, water spots, and burns that may be corrected by techniques covered in the manufacturer's Use and Care Guide.
2. Failure of solid surfacing joint material.
3. Failure due to structural failure of base cabinets or other solid surfacing substrate construction.
4. Use for purposes other than indoor finish material. See manufacturer's warranty for complete details.

PART 2 - PRODUCTS

2.1 PRODUCTS AND MANUFACTURERS

A. ACCEPTABLE PRODUCT AND MANUFACTURER: Formica Solid Surfacing, Formica Corp., Cincinnati, OH. Or approved equal.

2.2 MATERIALS AND COMPONENTS

A. SOLID SURFACING MATERIALS: Homogeneous solid sheets of filled plastic resin complying with ISSFA-2.

1. Colors and Patterns: As selected by Architect from manufacturer's full range.

C. ACCESSORIES:

1. Adhesives: For seams and drop edges, Formica Solid Surfacing Seaming Cartridges, 9 ounce (260ml); color to blend with sheet material

2. VOC Limits for Installation Adhesives and Glues: Use installation adhesives that comply with the limits for VOC content when calculated according to 40 CFR 59, Subpart D.

2.3 FABRICATION

A. Assemble work at shop following manufacturer's printed fabrication instructions and deliver to job ready for installation. Manufacture in largest practical pieces for handling and shipping without seams.

1. Grade: AWI, Custom.

2. Fabricate work square and to required lines.

3. Recess and conceal fasteners, connections, and reinforcing.

4. Design construction and installation details to allow for expansion and contraction of materials. Properly frames material with tight, hairline joints held rigidly in place.

5. Fabricate countertops with back splash and side splash pieces.

6. Fabricate items to profiles shown with connections and supports as indicated or as required for complete installation in accordance with manufacturer's written instructions and approved submittals.

7. Provide cut-outs for fixtures and trim, and related items. Confirm layout with manufacturer's cut-out templates before beginning work. Round corners of cut-outs and sand edges smooth.

8. Do not exceed manufacturer's recommended unsupported overhang distances.

9. Finish exposed surfaces smooth and polish to low sheen.

10. Ease corners and edges.

SOLID SURFACE COUNTERTOPS, Cont'd

B. Countertops:1/2 inch (13mm) thick, Solid Surfacing, adhesively joined with no exposed seams, edge details as indicated.

1. Provide expansion joints in countertops as required by manufacturer's standards.

2. Provide cut-outs for accessories in accordance with approved submittals with templates furnished by general contractor from manufacturer.

3. Reinforce seams, cut-outs and edges in accordance with approved submittals and manufacturer's written installation instructions.

PART 3 - EXECUTION

3.1 EXAMINATION AND PREPARATION

A. Examine surfaces for conditions that would adversely affect execution.

B. PREPARATION: Take field measurements.

3.2 INSTALLATION

A. GENERAL: Install in accordance with manufacturer's written installation instructions and approved Submittals. Provide templates and rough-in measurements.

1. Set items plumb, level, rigid and solidly adhered to substrate.
2. Prefit items: Adjust supports to make fit. Align joints over support framing.
3. Apply dabs of silicone on supports; place items on supports and attach.

B. SPLASHES: Install splashes at back and sides of countertops using silicone. Apply silicone to back surface only. Place thin bead of seam adhesive along edge where splash seats.

3.3 CLEANING AND PROTECTION

A. CLEANING:

1. Clean and polish fabrications in accordance with manufacturer's instructions.
2. Promptly remove excessive mastic and seam adhesive.
3. Clean tops and splashes in accordance with manufacturer's recommendations.

B. PROTECTION:

1. Do not permit construction near unprotected surfaces.

C. Refer to manufacturer's warranty and exclusions.

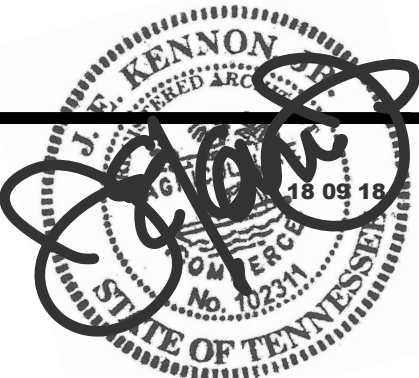

BALLISTIC RESISTANT BAFFLE DESIGN TRANSACTION BARRIERS

PART 1 - GENERAL

1.1 REFERENCE
The publication below forms a part of this specification.
UNDERWRITERS LABORATORY UL 752
11th Edition dated Sept. 5, 2005
Standard for Bullet Resistant Equipment

The provider of this window must be ISO 9001:2008 Certified by an accredited registrar and provide proof of such. Provide manufacturer's instructions for installation and cleaning.

1.2 DESIGN
Though the design, manufacturing technique and material application, this assembly shall provide single or multiple transaction positions utilizing the "natural voice" baffle configuration. This design shall employ offset vertical standing vision panels and 5" baffles to complete the "natural voice" design as well as to protect against angled ballistic penetrations. Components must be manufactured in strict accordance with the specifications, design and details. All vision panels and baffles shall be cut to size with all exposed edges polished. Necessary holes shall be pre drilled and tapped where required. Stainless Steel assembly screws and acrylic spacers shall be provided. Clear anodized angles and channels shall be provided in field lengths. Anchor screws shall be provided by the installer. No field alterations to the construction of the units fabricated under the acceptable standards shall be allowed unless approved by the manufacturer and the architect. Standard manufacturing tolerances shall be +/- 1/16".

1.3 SUBMITTALS
Submit for approval prior to fabrication:
Catalog cuts, shop drawings, specifications, frame profiles, size, type and spacing of frame anchors, reinforcement size and locations, details of joints and connections, welding details and printed data in sufficient detail to indicate compliance with the contract documents.

1.4 WARRANTY

All materials and workmanship shall be warranted against defects for a period of five (5) years from date of receipt at job site.

PART 2 - PRODUCTS

2.1 MANUFACTURER

Armortex® 5926 Corridor Pkwy, Schertz, Texas.
www.armortex.com
Phone: 210-661-8306, 800-880-8306,
Fax: 210-661-8308

alternate
Total Security Solutions
170 National Park Drive, Fowlerville, MI 48836 tel: 888.339.4190
https://www.tssbulletproof.com/product/baffle-interior-transaction-windows

2.2 FRAMING

Extruded aluminum angle
1 ¼" x 1 ¼" x 1/8" at Jambs,
2" x 1" x 1/8" angle at Head,
1 ¼" x 1 9/16" U-Shaped channel at sill.
Acrylic 1" spacer and stainless steel security screws at baffles.

2.3 FINISH

Anodized Finish Class I Clear

2.4 GLAZING PANELS-BAFFLES

The glazing must be UL Listed Ballistic Level 3 Multi-ply Polycarbonate or Acrylic Polycarbonate Composite with all exposed edges polished clear.

2.5 DEAL TRAYS

16 ga. Stainless Steel Non-Ricochet Two-Way Deal Tray with #3 satin brush finish.

BALLISTIC RESISTANT BAFFLE DESIGN TRANSACTION BARRIERS (cont.)

PART 3 - EXECUTION

3.1 INSTALLATION
Set frames and glaze in accordance with manufacturer's instructions. Proper anchoring device shall be determined by the material to be anchored. Repair damaged units as directed (if approved by the manufacturer and the architect) prior to completion and the acceptance of the project. Or replace with new units as directed by the architect.

3.2 PROTECTION
Touch up scratches or disfigurement caused by shipping and handling of the product. Properly store all the frames, glazing material etc. in a dry location and covered to protect from damage before and after installation.

3.3 CLEANING

Upon completion, clean exposed surfaces of frames and glazing products thoroughly in accordance with manufacturer's instructions. Remove mastic smears and other unsightly marks.

END OF SECTION

BALLISTIC-RESISTANT FIBERGLASS SHEET

PART 1 GENERAL

1.1 SUMMARY : Section Includes Bullet-resistant fiberglass sheet for use in partition assemblies.

1.2 REFERENCES
A. ASTM International (ASTM) (HYPERLINK "http://www.astm.org") E119 - Standard Test Methods for Fire Tests of Building Construction and Materials.
B. Underwriters Laboratories (UL) HYPERLINK "http://www.ul.com") 752 - Bullet Resisting Equipment.

1.3 SYSTEM DESCRIPTION
A. Design Requirements: Provide bullet-resistant sheet of "non-ricochet type" intended to permit capture and retention of attacking projectile, lessening potential of random injury or lateral penetration.

1.4 SUBMITTALS
A. Submittals for Review: Product Data: Include product description for bullet-resistant sheet including bullet- resistant ratings.

1.5 WARRANTIES
A. Provide manufacturer's 2 year warranty providing coverage against defects in materials and workmanship.

PART 2 PRODUCTS

2.1 MANUFACTURERS
A. Products by ARMORTEX, 5926 Corridor Parkway, Schertz, Texas, 800-880-8306, HYPERLINK "http://www.armortex.com" www.armortex.com.

2.2 MATERIALS : Bullet-Resistant Fiberglass Sheet
Source: ARMORTEX Opaque Fiberglass.
Description: Manufactured from multiple layers of woven roving ballistic grade fiberglass cloth impregnated with thermoset polyester resin, compressed into flat rigid sheets.
Provide controlled internal delaminating to permit capture of penetrating projectile.
Ballistic Level: 3 tested to UL 752.
Fire rating: 1 hour, tested to ASTM E119.

2.3 ACCESSORIES
Adhesives and Fasteners: Type recommended by bullet-resistant sheet manufacturer for specific application.

PART 3 EXECUTION

3.1 INSTALLATION
Install in accordance with manufacturer's instructions.

Cut panels to fit at perimeter and around penetrations.

Reinforce joints between sheets with minimum 4 inch wide backup layer of bullet-resistant sheet, centered on joint. Bullet-resistance of reinforced joint at least equal to ballistic level of panel.

Fasten or adhere panels to supports in manner to maintain bullet-resistive rating at perimeter, junctures with other materials, and penetrations.

Shim gypsum wall board covering sheathing as need for flush installation.

END OF SECTION

