

LEGEND

	U.G. CABLE ACCESS
	U.G. CABLE PED.
	ELEC. TRANSFORMER
	ELECTRIC METER
	U.G. ELEC. RECEPTACLE
	GAS METER
	GAS VALVE
	WATER METER
	WATER VALVE
	FIRE PROTECTION - POST INDICATOR VALVE
	FIRE HYDRANT
	WATER SPIGOT
	SPRINKLER HEAD
	SURFACE INLET
	ROOF DRAIN
	STORM SEWER MANHOLE
	SANITARY SEWER MANHOLE
	SANITARY SEWER CLEAN OUT
	UTILITY POLE
	LIGHT POLE
	IRON PIN (FOUND)
	MAG NAIL (FOUND)
	IRON PIN (SET)
	MAG NAIL (SET)
	CONTROL POINT
	SPOT ELEVATION
	U.G. CABLE
	U.G. ELECTRIC
	U.G. NATURAL GAS
	U.G. WATER
	SANITARY SEWER LINE
	STORM SEWER LINE
	OVER HEAD UTILITY
	EASEMENT LINE
	ADJOINING PROPERTY
	PROPERTY LINE
	CHAIN LINK FENCE
	BOARD FENCE
	FL FLOW LINE ELEVATION
	T/R TOP OF RIM ELEVATION
	PVC PLASTIC PIPE
	RCP REINFORCED CONCRETE PIPE
	MTL METAL PIPE
	VCP VITRIFIED CLAY PIPE
	INV INVERT ELEVATION
	18" TREE or larger

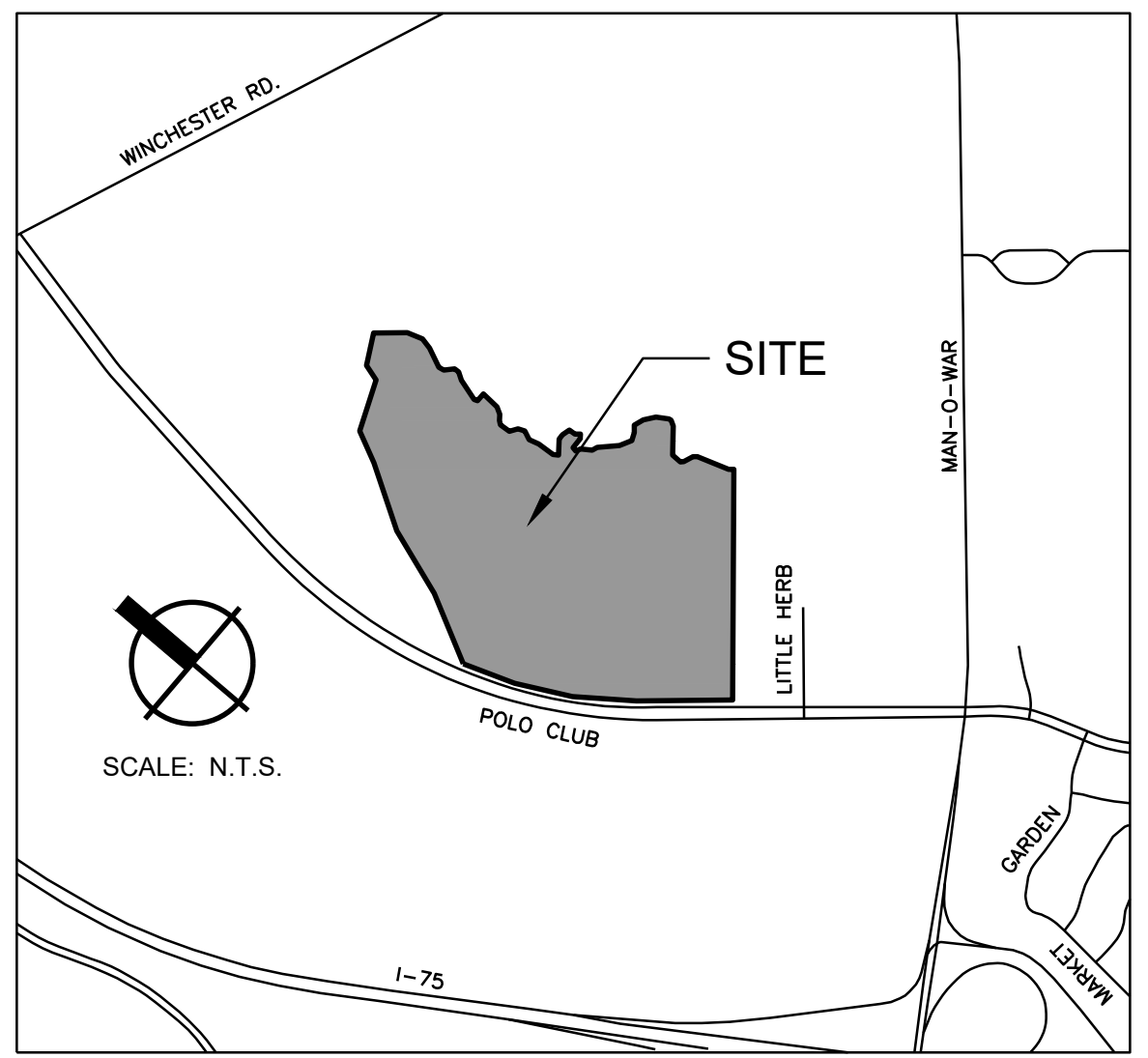

VICINITY MAP

CODED NOTES

KEY	DESCRIPTION	DETAIL
①	REMOVE ALL TREES, LIMBS, AND UNDERBRUSH AS INDICATED BY THE HATCHED AREA. TREE TRUNKS ARE TO BE CUT AT 48" AND REMAIN IN PLACE. GROUND PLANE IS TO REMAIN UNDISTURBED TO THE EXTENT POSSIBLE.	N/A

CARMAN
 LANDSCAPE ARCHITECTURE
 URBAN PLANNING
 CIVIL ENGINEERING
 110 OLD JAMES STREET, SUITE 200, LEXINGTON, KY 40507
 859.254.8803 WWW.CARMANSTELCO.COM

TREE REMOVAL

NEW MIDDLE SCHOOL - POLO CLUB
 2488 POLO CLUB BOULEVARD
 FAYETTE COUNTY PUBLIC SCHOOLS
 LEXINGTON, KENTUCKY



PROJECT	202078
DATE	02-11-22
REVISIONS	
No.	Description

TREE REMOVAL PLAN

SD-1

