

1  
2  
3  
4  
5

A

B

C

D

E

F

PUENTE STREET

ARMELL DRIVE

HOLLENBECK AVENUE

ROWLAND AVENUE

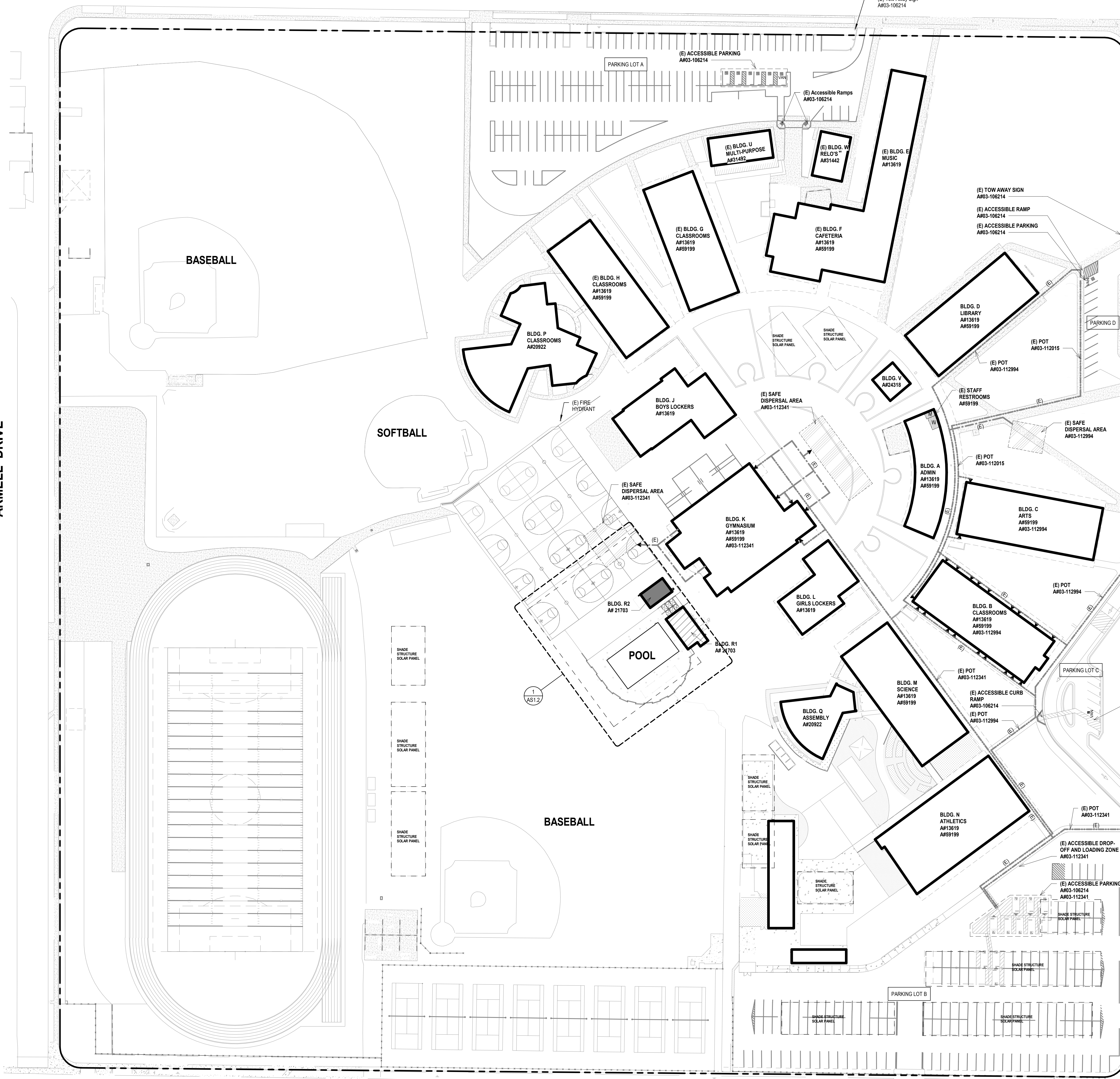

- SITE SYMBOLS**
- EXISTING BUILDING - PART OF SCOPE
  - EXISTING BUILDING - NOT IN CONTRACT
  - EXISTING BUILDING - TO BE REMOVED
  - PROPERTY LINE
  - (E) CHAIN - LINK FENCE
  - (E) FIRE HYDRANT
  - (E) CONCRETE PAVING
  - (E) LAWN / GRASS / LANDSCAPE
  - (E) LAWN / GRASS / LANDSCAPE
  - (E) PATH OF TRAVEL (POT) IS A BARRIER FREE ACCESS WITHOUT ANY ABRUPT VERTICAL CHANGES EXCEEDING 1/2" AT 1:2 MAXIMUM SLOPE EXCEPT THAT LEVEL CHANGES DOES NOT EXCEED 1/4" VERTICAL.
  - (E) EGRESS PATH

**EXISTING SITE PLAN**  
SCALE: 1" = 50'-0"

**DLR GROUP**  
© DLR Group

REGISTERED ARCHITECT  
JESSE MILLER  
No. C-32306  
10/31/2023  
STATE OF CALIFORNIA

**COVINA VALLEY HS POOL REPLACEMENT**  
COVINA VALLEY UNIFIED SCHOOL DISTRICT  
463 SOUTH HOLLENBECK AVENUE COVINA, CA 91723

DSA SUBMITTED SET  
12/19/2022  
REVISIONS

75-22616-00  
DSA # 03-122700  
DSA FILE # 19-48  
EXISTING SITE PLAN

AS1.0

BM\_360/775-22616-00\_C:\USD-CovinaHS\Swimming\pool\75-22616-00\_CovinaHS\_AR\_2020.dwg  
12/16/2022 3:28:21 PM