

CONSTRUCTION PLANS FOR CIVIL SITE PACKAGE CE MURRAY ELEMENTARY/MIDDLE SCHOOL VISITOR ACCESS

WILLIAMSBURG COUNTY SCHOOLS
CE MURRAY BOULEVARD
GREELEYVILLE, SOUTH CAROLINA

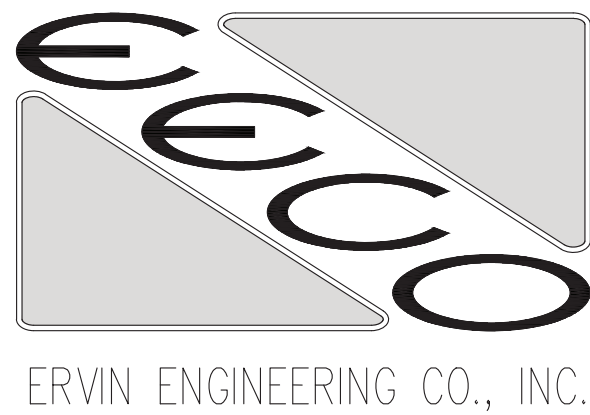
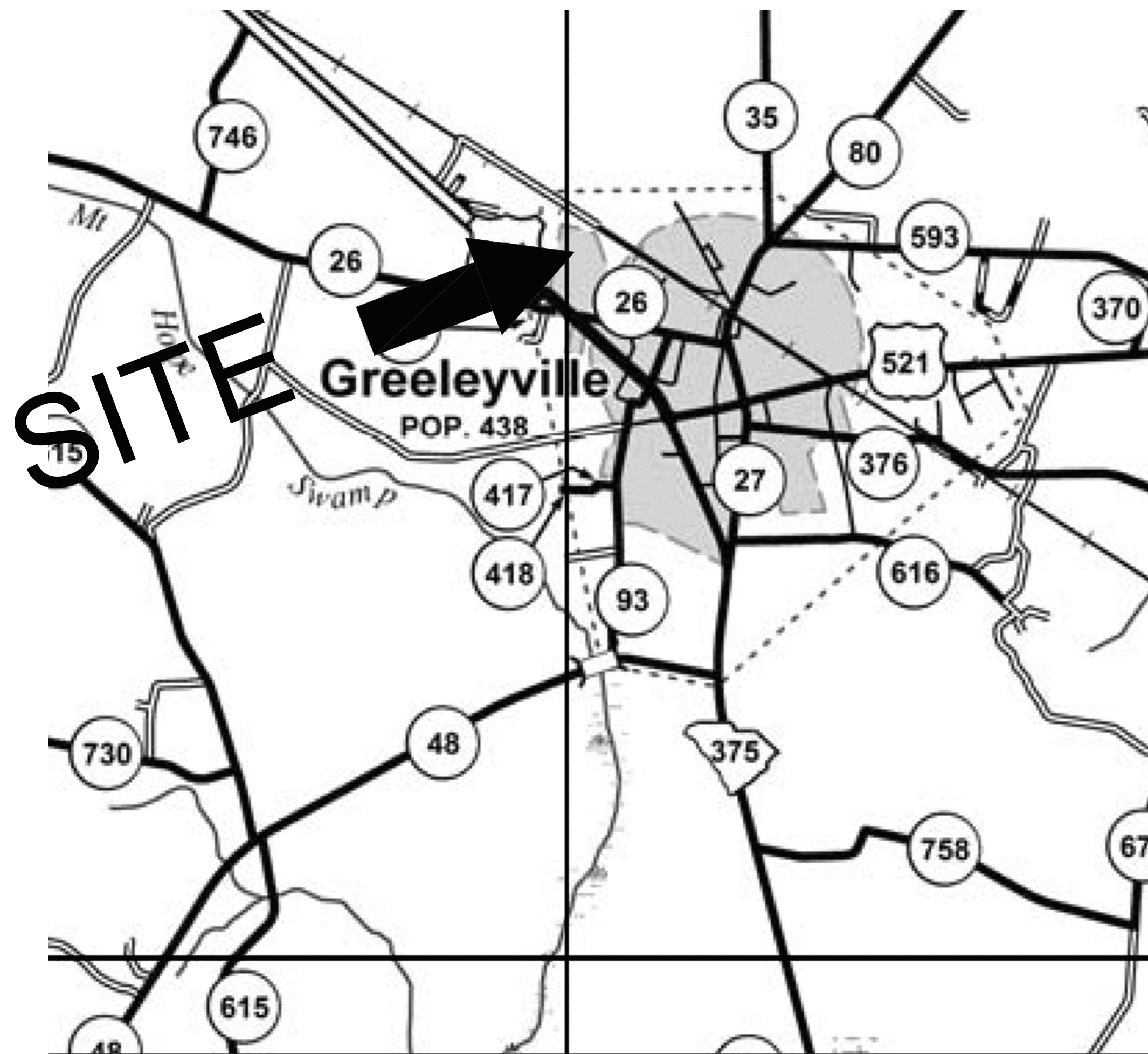

ENGINEER'S CERTIFICATION STATEMENT
I HAVE PLACED MY SIGNATURE AND SEAL ON THE DESIGN DOCUMENTS SUBMITTED SIGNIFYING THAT I ACCEPT RESPONSIBILITY FOR THE DESIGN OF THE SYSTEM.
FURTHER, I CERTIFY TO THE BEST OF MY KNOWLEDGE AND BELIEF THAT THE DESIGN IS CONSISTENT WITH THE REQUIREMENTS OF TITLE 48, CHAPTER 14 CODE OF LAWS OF SC, 1976 AS AMENDED, PURSUANT TO REGULATION 72-300 ET SEQ. (IF APPLICABLE), AND IN ACCORDANCE WITH THE TERMS AND CONDITIONS OF SCR100000.

William C. Ervin, Jr.
WILLIAM C. ERVIN, JR., P.E.
02/14/2023

2021W17001
FOR APPROVAL
02/14/2023

TABLE OF CONTENTS
GENERAL DRAWINGS

| | |
|-------|-------------------------------------|
| C0.00 | TITLE SHEET |
| C0.01 | NOTES |
| C1.00 | EXISTING CONDITIONS |
| C1.01 | PHASE 1 EROSION CONTROL PLAN |
| C1.02 | DEMOLITION PLAN |
| C1.03 | POST DEMOLITION PLAN |
| C2.00 | OVERALL SITE LAYOUT |
| C2.01 | OVERALL SITE LAYOUT WITH DIMENSIONS |
| C3.00 | OVERALL GRADING PLAN |
| C3.01 | SPOT ELEVATION PLAN |
| C4.00 | STORM DRAIN PROFILE |
| C7.07 | PAVING DETAILS |
| C7.08 | PAVEMENT MARKING DETAILS |

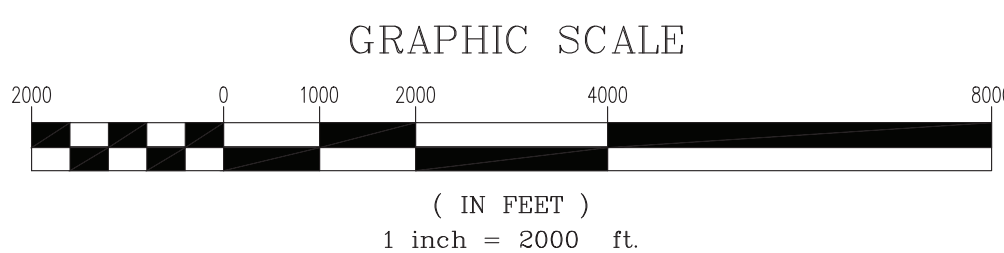

| | |
|------------------|-----------------|
| DRAWN BY: WCE | CHECKED BY: JSE |
| DATE: 5-18-2022 | DATE: 5-18-2022 |
| DESIGNED BY: WCE | CHECKED BY: JSE |
| DATE: 5-18-2022 | DATE: 5-18-2022 |
| SCALE: AS NOTED | |

| | | | | | |
|-------------------------------------|----------|----------|-----------|----------|-----------------|
| WILLIAMSBURG COUNTY SCHOOL DISTRICT | APPROVED | REVISION | REV. DATE | APPROVED | REVISED PER OSF |
| CE MURRAY ELEMENTARY/MIDDLE SCHOOL | | | | WCE | |
| VISITOR ACCESS | | | | | |
| GREELEYVILLE | | | | | |
| SOUTH CAROLINA | | | | | |
| TITLE | | | | | |

C0.00

EECO JOB #: 2021W17001

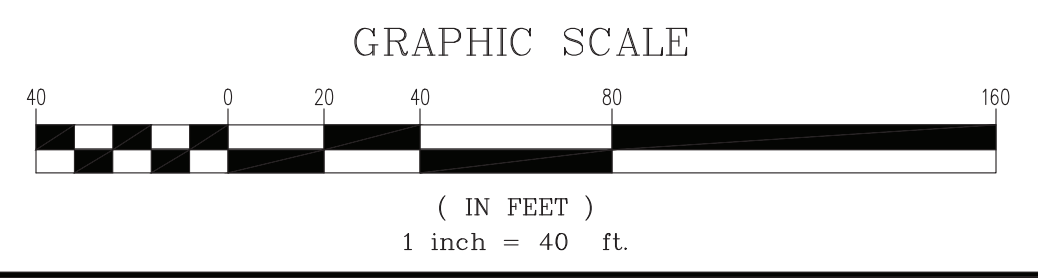
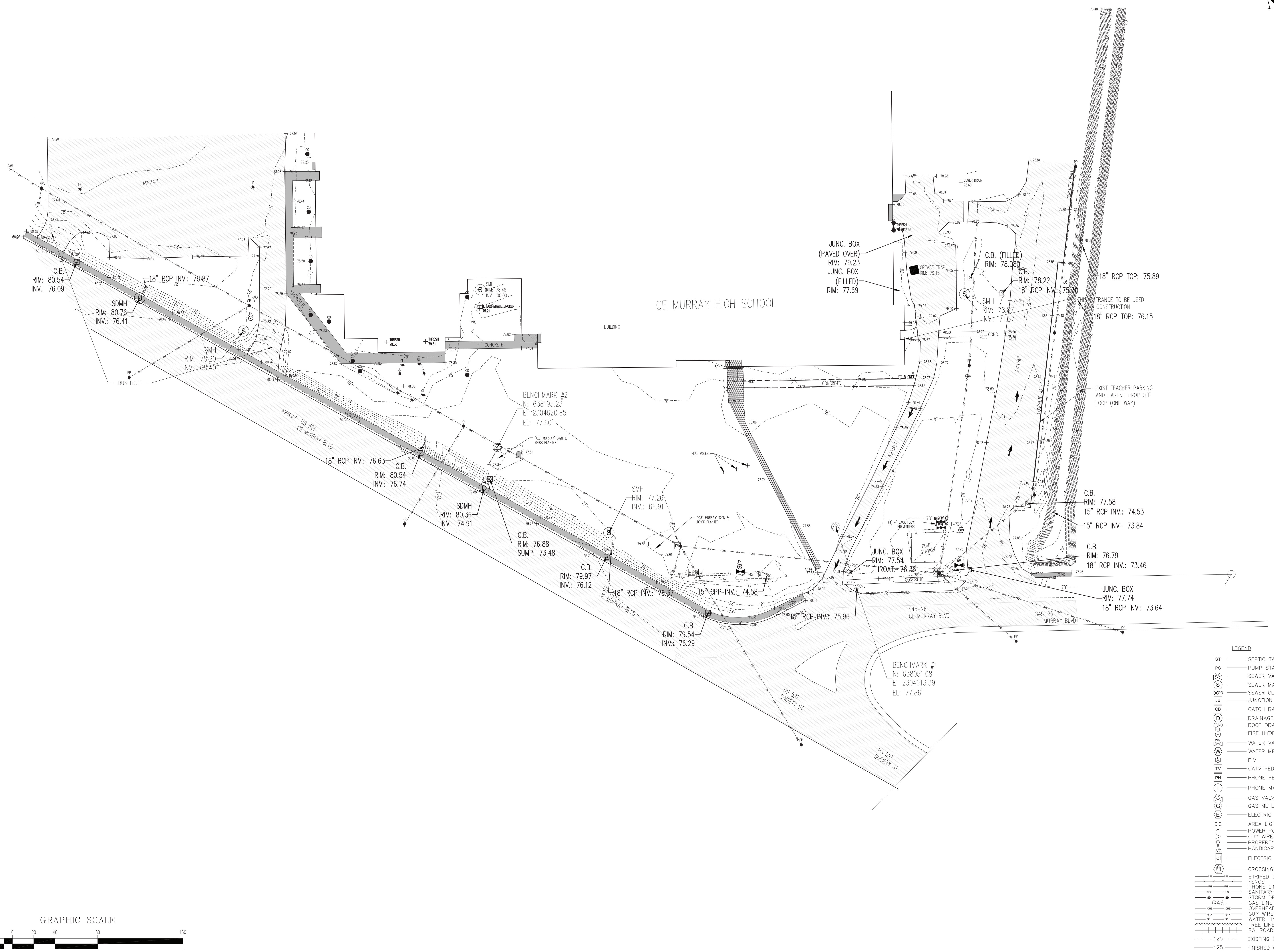
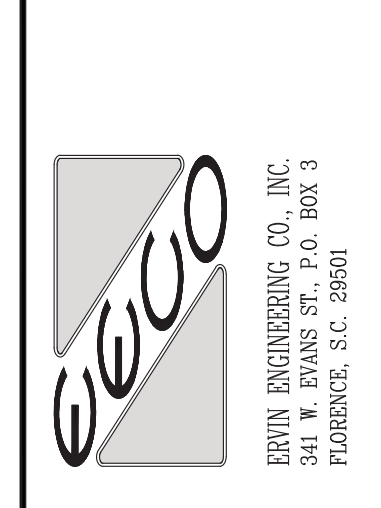
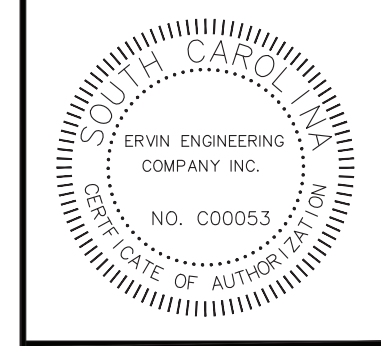
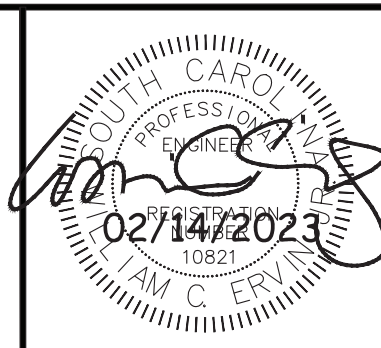
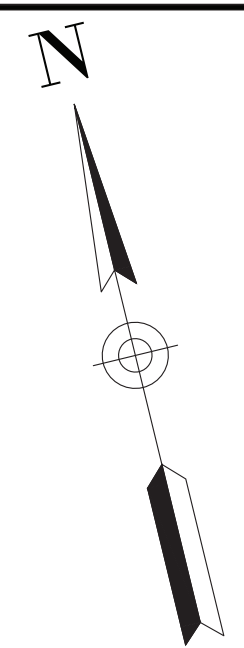

LEGEND

| | |
|-----|------------------------------|
| ST | SEPTIC TANK |
| PS | PUMP STATION |
| SV | SEWER VALVE |
| SC | SEWER CLEANOUT |
| JB | JUNCTION BOX |
| CB | CATCH BASIN |
| DM | DRAINAGE MANHOLE |
| RD | ROOF DRAIN |
| FH | FIRE HYDRANT |
| WV | WATER VALVE |
| WM | WATER METER |
| PV | PIV |
| CP | CATV PEDESTAL |
| PP | PHONE PEDESTAL |
| PM | PHONE MANHOLE |
| GV | GAS VALVE |
| GM | GAS METER |
| EM | ELECTRIC METER |
| AL | AREA LIGHT |
| PO | POWER POLE |
| GWA | GUY WIRE ANCHOR |
| PC | PROPERTY CORNER |
| HP | HANDICAP PARKING |
| EB | ELECTRIC BOX |
| CS | CROSSING SIGNAL |
| ST | STRIPED UG UTILITY TYPE UNK. |
| F | FENCE |
| PL | PHONE LINE |
| SS | SANITARY SEWER LINE |
| SD | STORM DRAIN PIPE |
| G | GAS LINE |
| OE | OVERHEAD ELECTRIC LINE |
| W | WATER LINE |
| T | TREE LINE |
| R | RAILROAD TRACKS |
| 125 | EXISTING CONTOUR |
| 125 | FINISHED GRADE CONTOUR |

| | |
|------------------|-----------------|
| DRAWN BY: WCE | CHECKED BY: USE |
| DATE: 5-18-2022 | DATE: 5-18-2022 |
| DESIGNED BY: WCE | CHECKED BY: USE |
| DATE: 5-18-2022 | DATE: 5-18-2022 |
| SCALE: AS NOTED | |

WILLIAMSBURG COUNTY SCHOOL DISTRICT
 CE MURRAY ELEMENTARY/MIDDLE SCHOOL
 VISITOR ACCESS
 SOUTH CAROLINA
 GREENLYVILLE
 EXISTING CONDITIONS

| REV | DATE | REVISION | APPROVED | REV | DATE | REVISION | APPROVED |
|-----|------------|-----------------------|----------|-----|------|----------|----------|
| A | 05/18/2022 | REVISION PER OSF REV. | WCE | | | | |

C1.00
 EOCO JOB # 2021W17001

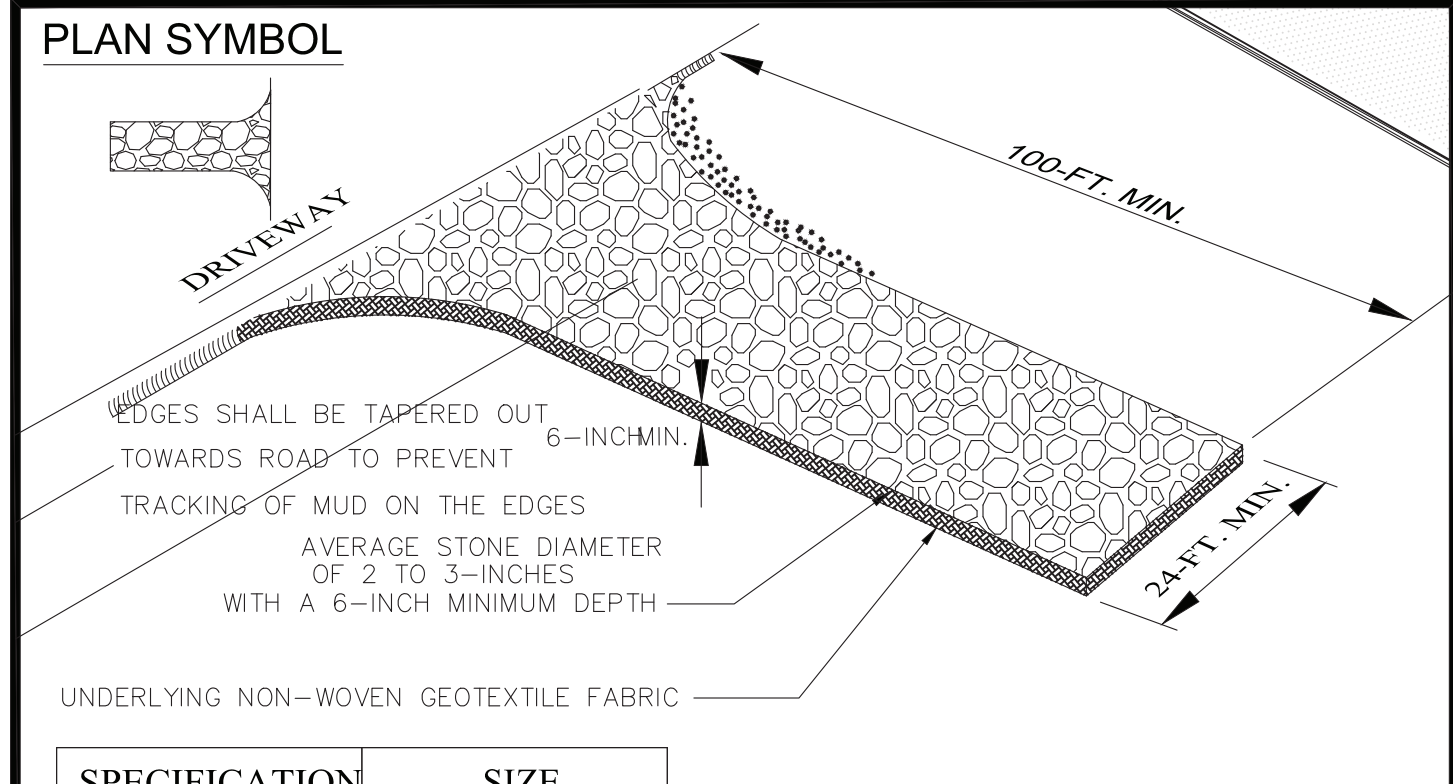
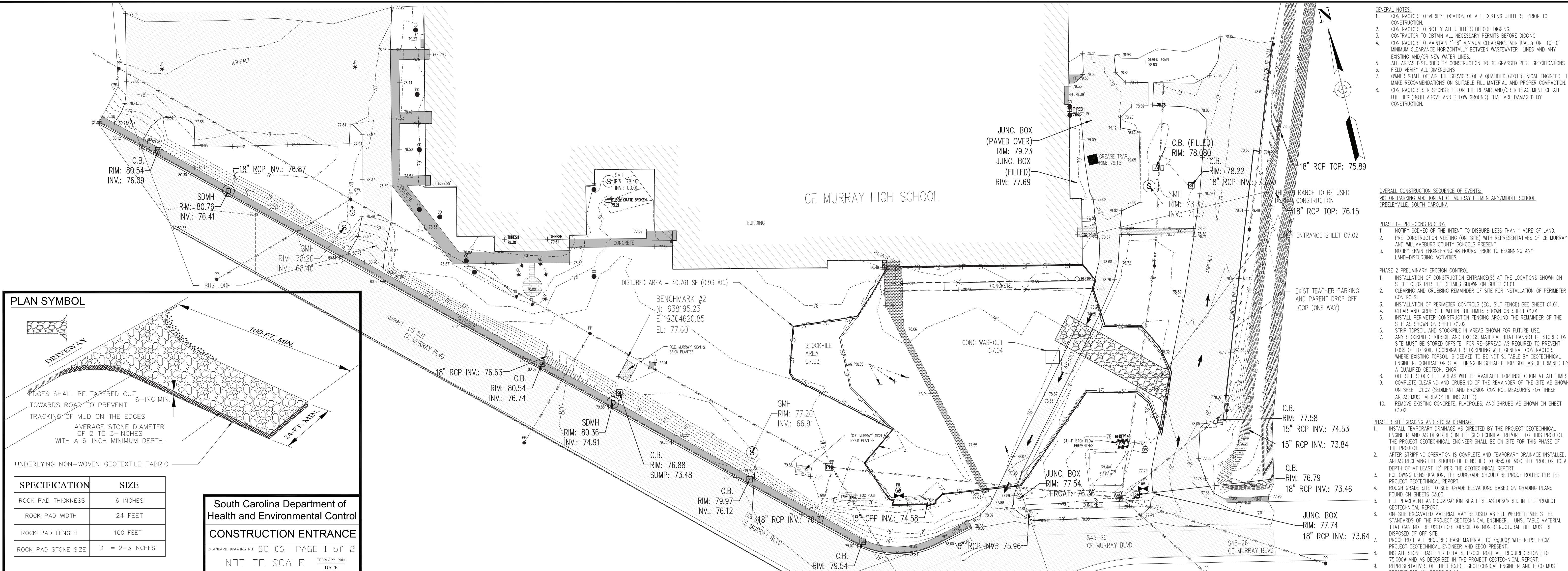

| SPECIFICATION | SIZE |
|---------------------|----------------|
| ROCK PAD THICKNESS | 6 INCHES |
| ROCK PAD WIDTH | 24 FEET |
| ROCK PAD LENGTH | 100 FEET |
| ROCK PAD STONE SIZE | D = 2-3 INCHES |

South Carolina Department of Health and Environmental Control
CONSTRUCTION ENTRANCE
 STANDARD DRAWING NO. SC-06 PAGE 1 of 2
 NOT TO SCALE FEBRUARY 2014 DATE

- CONSTRUCTION ENTRANCE - GENERAL NOTES**
1. Stabilized construction entrances should be used at all points where traffic will egress/ingress a construction site onto a public road or any impervious surfaces, such as parking lots.
 2. Install a non-woven geotextile fabric prior to placing any stone.
 3. Install a culvert pipe across the entrance when needed to provide positive drainage.
 4. The entrance shall consist of 2-inch to 3-inch D50 stone placed at a minimum depth of 6-inches.
 5. Minimum dimensions of the entrance shall be 24-feet wide by 100-feet long, and may be modified as necessary to accommodate site constraints.
 6. The edges of the entrance shall be tapered out towards the road to prevent tracking at the edge of the entrance.
 7. Divert all surface runoff and drainage from the stone pad to a sediment trap or basin or other sediment trapping structure.
 8. Limestone may not be used for the stone pad.

- CONSTR. ENTRANCE - INSPECTION & MAINTENANCE**
1. The key to functional construction entrances is weekly inspections, routine maintenance, and regular sediment removal.
 2. Regular inspections of construction entrances shall be conducted once every calendar week and, as recommended, within 24-hours after each rainfall event that produces 1/2-inch or more of precipitation.
 3. During regular inspections, check for mud and sediment buildup and pad integrity. Inspection frequencies may need to be more frequent during long periods of wet weather.
 4. Reshape the stone pad as necessary for drainage and runoff control.
 5. Wash or replace stones as needed and as directed by site inspector. The stone in the entrance should be washed or replaced whenever the entrance fails to reduce the amount of mud being carried off-site by vehicles. Frequent washing will extend the useful life of stone pad.
 6. Immediately remove mud and sediment tracked or washed onto adjacent impervious surfaces by brushing or sweeping. Flushing should only be used when the water can be discharged to a sediment trap or basin.
 7. During maintenance activities, any broken pavement should be repaired immediately.
 8. Construction entrances should be removed after the site has reached final stabilization. Permanent vegetation should replace areas from which construction entrances have been removed, unless area will be converted to an impervious surface to serve post-construction.

South Carolina Department of Health and Environmental Control
CONSTRUCTION ENTRANCE
 STANDARD DRAWING NO. SC-06 PAGE 2 of 2
 GENERAL NOTES FEBRUARY 2014 DATE

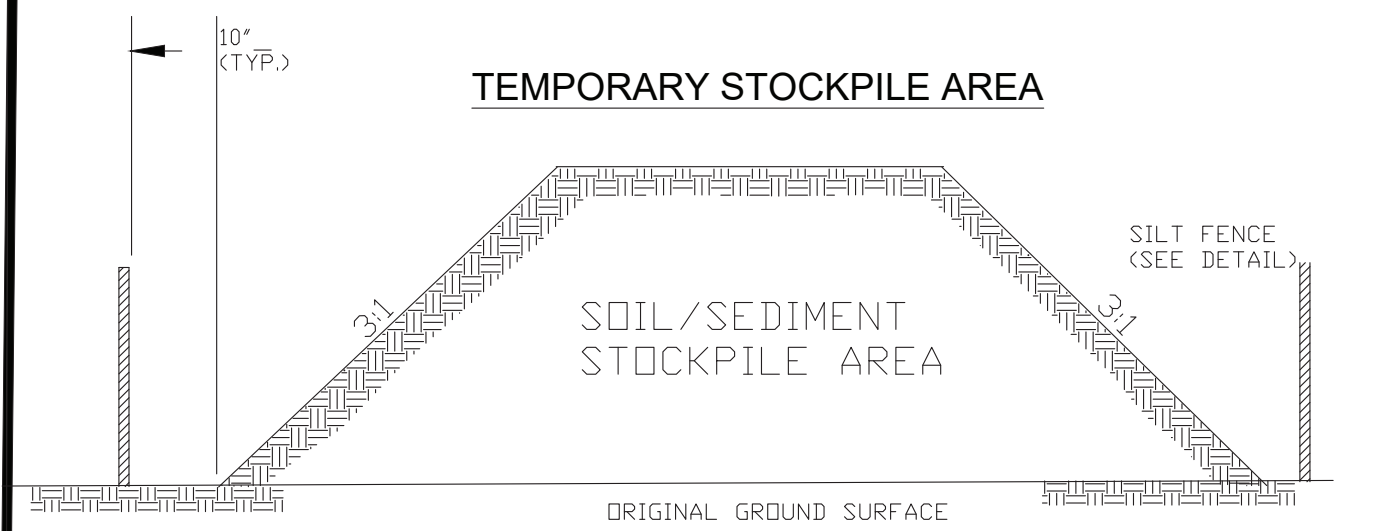

- NOTES:
1. SILT FENCE TO EXTEND AROUND ENTIRE PERIMETER OF STOCKPILE, OR IF STOCKPILE AREA IS LOCATED ON/NEAR A SLOPE THE SILT FENCE IS TO EXTEND ALONG CONTOURS OF THE DOWN-GRADIENT AREA.
 2. IF STOCKPILE IS TO REMAIN FOR MORE THAN 14 DAYS, TEMPORARY STABILIZATION MEASURES MUST BE IMPLEMENTED.
 3. SILT FENCE SHALL BE MAINTAINED UNTIL STOCKPILE AREA HAS EITHER BEEN REMOVED OR PERMANENTLY STABILIZED.
 4. THE KEY TO FUNCTIONAL TEMPORARY STOCKPILE AREAS IS WEEKLY INSPECTIONS, ROUTINE MAINTENANCE, AND REGULAR SEDIMENT REMOVAL.

South Carolina Department of Health and Environmental Control
TEMPORARY STOCKPILE
 STANDARD DRAWING NO. SC-15 PAGE 1 of 1
 NOT TO SCALE FEBRUARY 2014 DATE

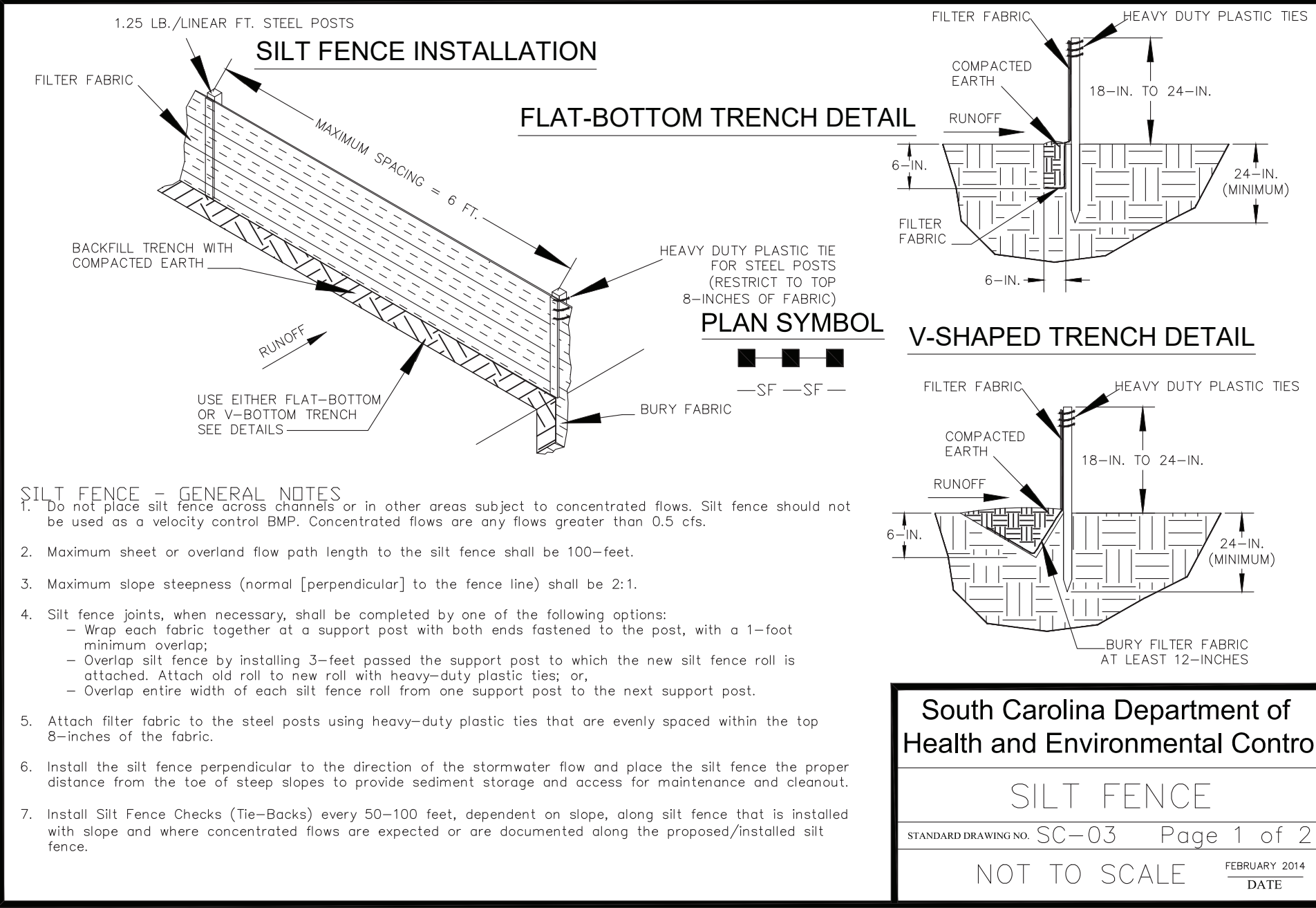
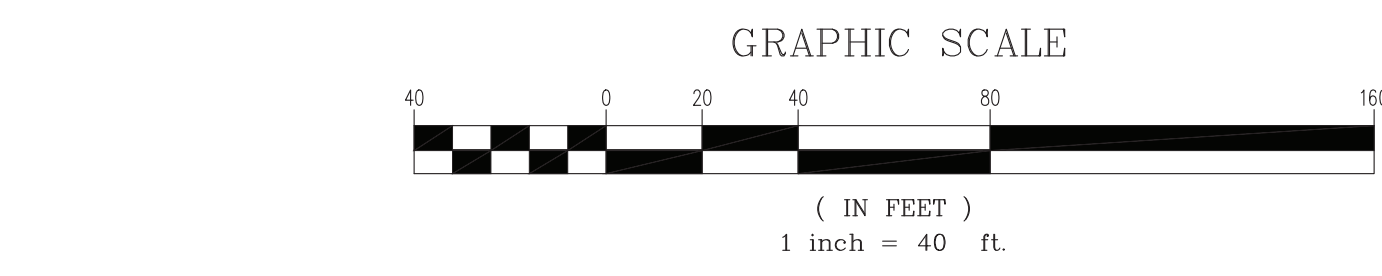

SILT FENCE - FABRIC REQUIREMENTS

1. Silt fence must be composed of woven geotextile filter fabric that consists of the following requirements:
 - Composed of fibers consisting of long chain synthetic polymers of at least 85% by weight of polypropylene, polyester, or polyamide that are formed into a network such that the filaments or yarns retain dimensional stability relative to each other;
 - Free of any treatment or coating which might adversely affect its physical properties after installation;
 - Free of any defects or flaws that significantly affect its physical and/or filtering properties; and,
 - Have a minimum width of 36-inches.
2. Use only fabric appearing on SC DOT's Qualified Products Listing (QPL), Approval Sheet #34, meeting the requirements of the most current edition of the SC DOT Standard Specifications for Highway Construction.
3. 12-inches of the fabric should be placed within excavated trench and toed in when the trench is back-filled.
4. Filter Fabric shall be purchased in continuous rolls and cut to the length of the barrier to avoid joints.
5. Filter Fabric shall be installed at a minimum of 24-inches above the ground.

South Carolina Department of Health and Environmental Control
SILT FENCE
 STANDARD DRAWING NO. SC-03 Page 1 of 2
 NOT TO SCALE FEBRUARY 2014 DATE

- SILT FENCE - POST REQUIREMENTS**
1. Silt Fence posts must be 48-inch long steel posts that meet, at a minimum, the following physical characteristics:
 - Composed of a high strength steel with a minimum yield strength of 50,000 psi;
 - Include a standard "T" section with a nominal face width of 1.38-inches and a nominal "T" length of 1.48-inches;
 - Weight 1.25 pounds per foot (± 8%).
 2. Posts shall be equipped with projections to aid in fastening of filter fabric.
 3. Steel posts may need to have a metal soil stabilization plate welded near the bottom when installed along steep slopes or installed in loose soils. The plate should have a minimum cross section of 17-square inches and be composed of 15 gauge steel, at a minimum. The metal soil stabilization plate should be completely buried.
 4. Install posts to a minimum of 24-inches. A minimum height of 1- to 2-inches above the fabric shall be maintained, and a maximum height of 3 feet shall be maintained above the ground.
 5. Post spacing shall be at a maximum of 6-feet on center.

- SILT FENCE - INSPECTION & MAINTENANCE**
1. The key to functional silt fence is weekly inspections, routine maintenance, and regular sediment removal.
 2. Regular inspections of silt fence shall be conducted once every calendar week and, as recommended, within 24-hours after each rainfall event that produces 1/2-inch or more of precipitation.
 3. Attention to sediment accumulations along the silt fence is extremely important. Accumulated sediment should be continually monitored and removed when necessary.
 4. Remove accumulated sediment when it reaches 1/3 the height of the silt fence.
 5. Removed sediment shall be placed in stockpile storage areas or spread thinly across disturbed area. Stabilize the removed sediment after it is relocated.
 6. Check for areas where stormwater runoff has eroded a channel beneath the silt fence, or where the fence has sagged or collapsed due to runoff overlapping the silt fence. Install checks/tie-backs and/or reinstall silt fence, as necessary.
 7. Check for tears within the silt fence, areas where silt fence has begun to decompose, and for any other circumstance that may render the silt fence ineffective. Removed damaged silt fence and reinstall new silt fence immediately.
 8. Silt fence should be removed within 30 days after final stabilization is achieved and once it is removed, the resulting disturbed area shall be permanently stabilized.

South Carolina Department of Health and Environmental Control
SILT FENCE
 STANDARD DRAWING NO. SC-03 PAGE 2 of 2
 GENERAL NOTES FEBRUARY 2014 DATE

- GENERAL NOTES:**
1. CONTRACTOR TO VERIFY LOCATION OF ALL EXISTING UTILITIES PRIOR TO CONSTRUCTION.
 2. CONTRACTOR TO NOTIFY ALL UTILITIES BEFORE DIGGING.
 3. CONTRACTOR TO OBTAIN ALL NECESSARY PERMITS BEFORE DIGGING.
 4. CONTRACTOR TO MAINTAIN 1'-6" MINIMUM CLEARANCE VERTICALLY OR 10'-0" MINIMUM CLEARANCE HORIZONTALLY BETWEEN WASTEWATER LINES AND ANY EXISTING AND/OR NEW WATER LINES.
 5. ALL AREAS DISTURBED BY CONSTRUCTION TO BE GRASSED PER SPECIFICATIONS.
 6. FIELD VERIFY ALL DIMENSIONS.
 7. OWNER SHALL OBTAIN THE SERVICES OF A QUALIFIED GEOTECHNICAL ENGINEER TO MAKE RECOMMENDATIONS ON SUITABLE FILL MATERIAL AND PROPER COMPACTION. CONTRACTOR IS RESPONSIBLE FOR THE REPAIR AND/OR REPLACEMENT OF ALL UTILITIES (BOTH ABOVE AND BELOW GROUND) THAT ARE DAMAGED BY CONSTRUCTION.

OVERALL CONSTRUCTION SEQUENCE OF EVENTS:
 VISITOR PARKING ADDITION AT CE MURRAY ELEMENTARY/MIDDLE SCHOOL, GREENEVILLE, SOUTH CAROLINA

- PHASE 1- PRE-CONSTRUCTION**
1. NOTIFY SCDEH OF THE INTENT TO DISBURB LESS THAN 1 ACRE OF LAND.
 2. PRE-CONSTRUCTION MEETING (ON-SITE) WITH REPRESENTATIVES OF CE MURRAY AND WILLIAMSBURG COUNTY SCHOOLS PRESENT.
 3. NOTIFY ERVIN ENGINEERING 48 HOURS PRIOR TO BEGINNING ANY LAND-DISTURBING ACTIVITIES.
- PHASE 2 PRELIMINARY EROSION CONTROL**
1. INSTALLATION OF CONSTRUCTION ENTRANCE(S) AT THE LOCATIONS SHOWN ON SHEET C1.02 PER THE DETAILS SHOWN ON SHEET C1.01.
 2. CLEARING AND GRUBBING REMAINDER OF SITE FOR INSTALLATION OF PERMETER CONTROLS.
 3. INSTALLATION OF PERMETER CONTROLS (EG. SILT FENCE) SEE SHEET C1.01.
 4. CLEAR AND GRUB SITE WITHIN THE LIMITS SHOWN ON SHEET C1.01.
 5. INSTALL PERMETER CONSTRUCTION FENCING AROUND THE REMAINDER OF THE SITE AS SHOWN ON SHEET C1.02.
 6. STRIP TOPSOIL AND STOCKPILE IN AREAS SHOWN FOR FUTURE USE.
 7. ANY STOCKPILED TOPSOIL AND EXCESS MATERIAL THAT CANNOT BE STORED ON SITE MUST BE STORED OFF-SITE FOR 18-Spread AS REQUIRED TO PREVENT LOSS OF TOPSOIL. COORDINATE STOCKPILING WITH GENERAL CONTRACTOR.
 8. WHERE EXISTING TOPSOIL IS DEEMED TO BE NOT SUITABLE BY GEOTECHNICAL ENGINEER, CONTRACTOR SHALL BRING IN SUITABLE TOP SOIL AS DETERMINED BY A QUALIFIED GEOTECHNICAL ENGINEER.
 9. OFF SITE STOCK PILE AREAS WILL BE AVAILABLE FOR INSPECTION AT ALL TIMES. COMPLETE CLEARING AND GRUBBING OF THE REMAINDER OF THE SITE AS SHOWN ON SHEET C1.02 (SEDIMENT AND EROSION CONTROL MEASURES FOR THESE AREAS MUST ALREADY BE INSTALLED).
 10. REMOVE EXISTING CONCRETE, FLAGPOLES, AND SHRUBS AS SHOWN ON SHEET C1.02.

- PHASE 3 SITE GRADING AND STORM DRAINAGE**
1. INSTALL TEMPORARY DRAINAGE AS DIRECTED BY THE PROJECT GEOTECHNICAL ENGINEER AND AS DESCRIBED IN THE GEOTECHNICAL REPORT FOR THIS PROJECT. THE PROJECT GEOTECHNICAL ENGINEER SHALL BE ON-SITE FOR THIS PHASE OF THE PROJECT.
 2. AFTER STRIPPING OPERATION IS COMPLETE AND TEMPORARY DRAINAGE INSTALLED, AREAS RECEIVING FILL SHOULD BE DENSIFIED TO 95% OF MODIFIED PROCTOR TO A DEPTH OF AT LEAST 12" PER THE GEOTECHNICAL REPORT.
 3. FOLLOWING DENSIFICATION, THE SUBGRADE SHOULD BE PROOF ROLLED PER THE PROJECT GEOTECHNICAL REPORT.
 4. ROUGH GRADE SITE TO SUB-GRADE ELEVATIONS BASED ON GRADING PLANS FOUND ON SHEETS C3.00-01.
 5. FILL PLACEMENT AND COMPACTION SHALL BE AS DESCRIBED IN THE PROJECT GEOTECHNICAL REPORT.
 6. ON-SITE EXCAVATED MATERIAL MAY BE USED AS FILL WHERE IT MEETS THE STANDARDS OF THE PROJECT GEOTECHNICAL ENGINEER. UNSUITABLE MATERIAL THAT CAN NOT BE USED FOR TOPSOIL OR NON-STRUCTURAL FILL MUST BE DISPOSED OF OFF SITE.
 7. PROOF ROLL ALL REQUIRED BASE MATERIAL TO 75,000# WITH REFS FROM PROJECT GEOTECHNICAL ENGINEER AND ECCO PRESENT.
 8. INSTALL STONE BASE PER DETAILS, PROOF ROLL ALL REQUIRED STONE TO 75,000# AND AS DESCRIBED IN THE PROJECT GEOTECHNICAL REPORT.
 9. REPRESENTATIVES OF THE PROJECT GEOTECHNICAL ENGINEER AND ECCO MUST BE PRESENT FOR ALL PROOF ROLLS.
 10. INSTALL NEW SIDEWALK AS SHOWN ON SHEET C2.00 PER DETAILS SHOWN ON SHEET C7.07.
 11. INSTALL STONE BASE ON ALL ROADS AND PARKING LOTS AS SHOWN ON SHEET C7.07.

- PHASE 4- PAVING AND STRIPING**
1. INSTALL PAVING INTERIOR TO THE SITE.
 2. STRIPE PARKING AREAS AND INSTALL SIGNS AS SHOWN ON SHEET C2.00.
 3. INSTALL PARKING BUMPERS AS SHOWN ON SHEET C2.00.
 4. GRASS SITE PER NOTES ON SHEET C1.01.
 5. CONTRACTOR WILL NOT GET FINAL RELEASE FOR THE PROJECT UNTIL THERE IS AN ESTABLISHED GROUND COVER OVER 70% OF THE SITE.
 6. SUBMIT NOTICE OF TERMINATION (NOT) TO SCDEH AS APPROPRIATE.

SCDOT DRAINAGE STATEMENT: THE POST DEVELOPMENT DISCHARGE INTO THE SCDOT RIGHT OF WAY IS EQUAL TO OR LESS THAN THE PRE DEVELOPMENT DISCHARGE FOR THIS PROJECT FOR THE 2, 10, AND 100 YEAR RAINFALL EVENTS.

WILLIAM C. ERVIN, JR., P.E.
 02/14/2023

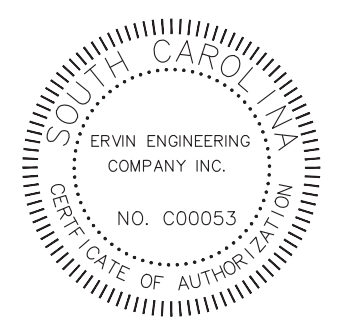
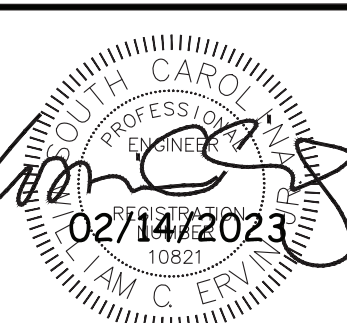

| | |
|------------------|-----------------|
| DRAWN BY: WCE | CHECKED BY: USE |
| DATE: 5-18-2022 | DATE: 5-18-2022 |
| DESIGNED BY: WCE | CHECKED BY: USE |
| DATE: 5-18-2022 | DATE: 5-18-2022 |
| SCALE: AS NOTED | |

WILLIAMSBURG COUNTY SCHOOL DISTRICT
 CE MURRAY ELEMENTARY/MIDDLE SCHOOL
 VISITOR ACCESS
 SOUTH CAROLINA
 GREENEVILLE
 EROSION CONTROL PLAN
 PHASE 1

| REV | DATE | REVISION | APPROVED |
|-----|------|----------|----------|
| A | | | |

C1.01
 ECO JOB #: 2021W17001

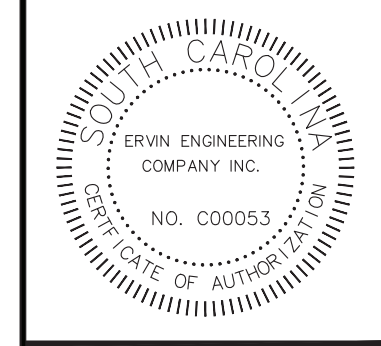
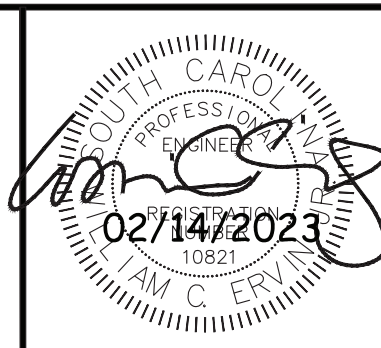
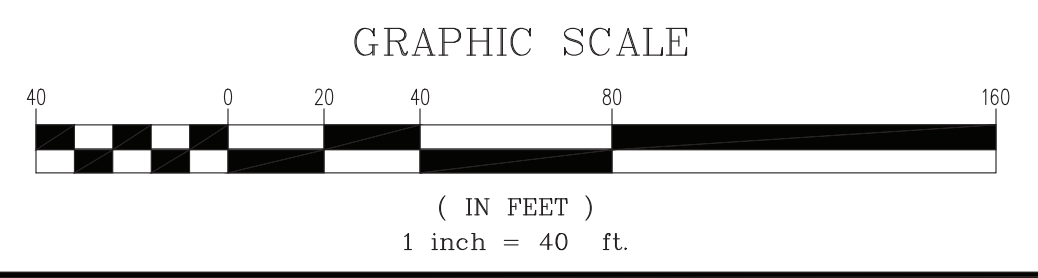
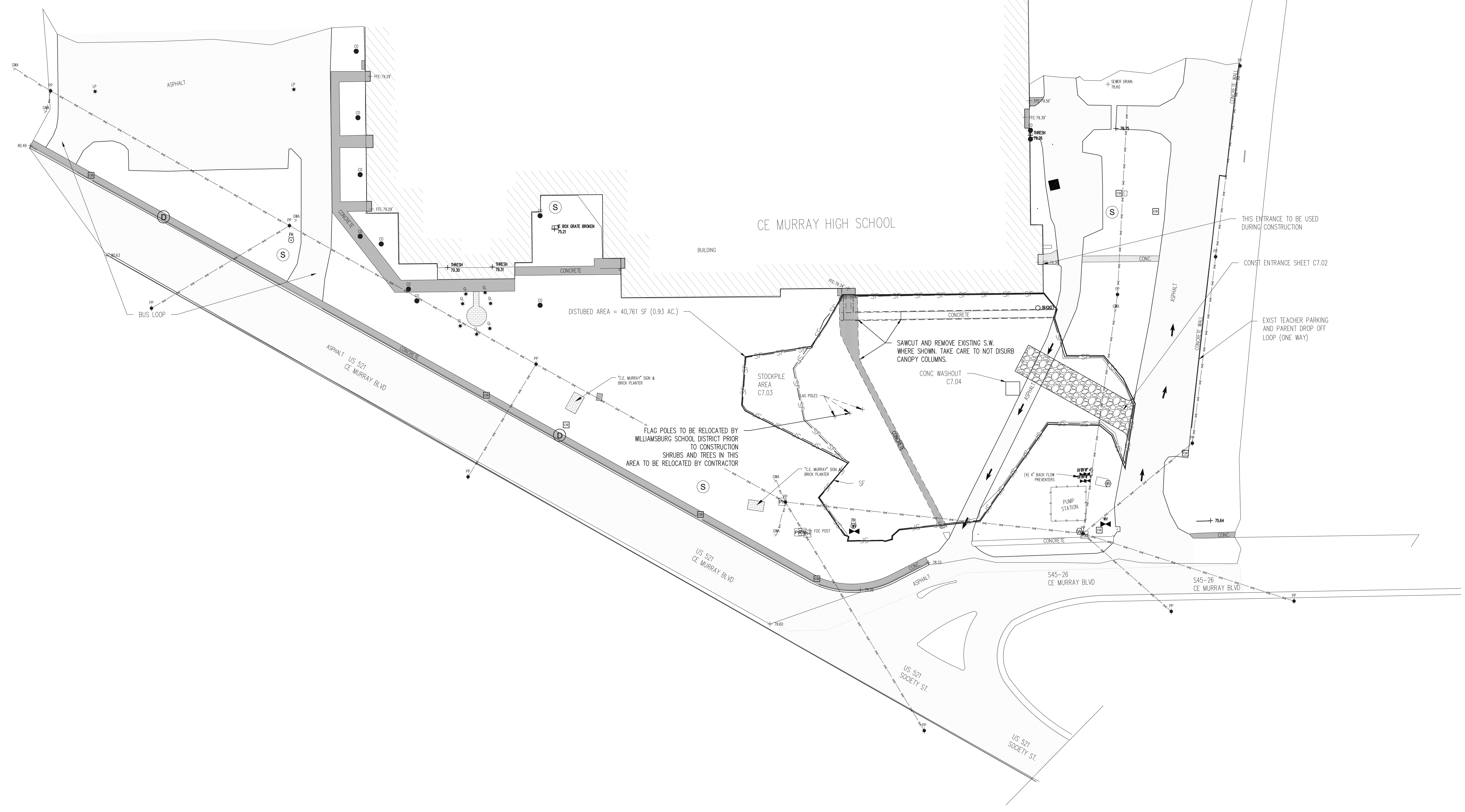
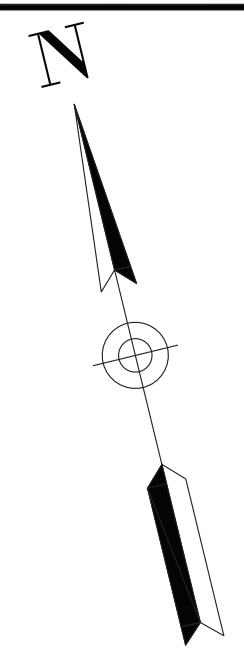

| | |
|------------------|-----------------|
| DRWN BY: WCE | CHECKED BY: JSE |
| DATE: 5-18-2022 | DATE: 5-18-2022 |
| DESIGNED BY: WCE | CHECKED BY: JSE |
| DATE: 5-18-2022 | DATE: 5-18-2022 |
| SCALE: AS NOTED | |

WILLIAMSBURG COUNTY SCHOOL DISTRICT
 CE MURRAY ELEMENTARY/MIDDLE SCHOOL
 VISITOR ACCESS
 GREENLYVILLE SOUTH CAROLINA
 DEMOLITION PLAN

| REV | DATE | REVISION | APPROVED | WCE |
|-----|------------|----------------------|----------|-----|
| A | 05/18/2022 | REVISED PER OSF REV. | | |
| | | | | |
| | | | | |
| | | | | |
| | | | | |
| | | | | |
| | | | | |
| | | | | |
| | | | | |
| | | | | |

C1.02
 EOCO JOB # 2021W17001

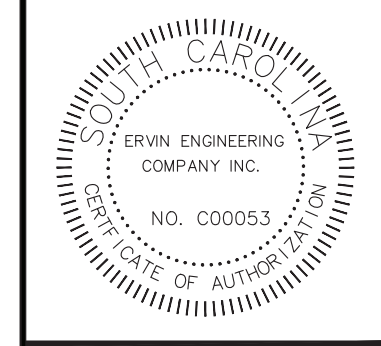
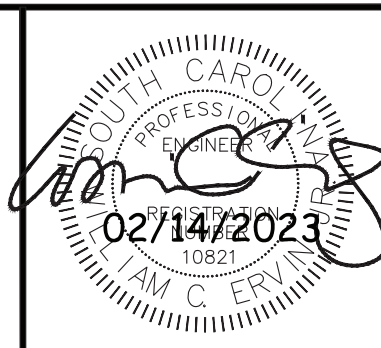
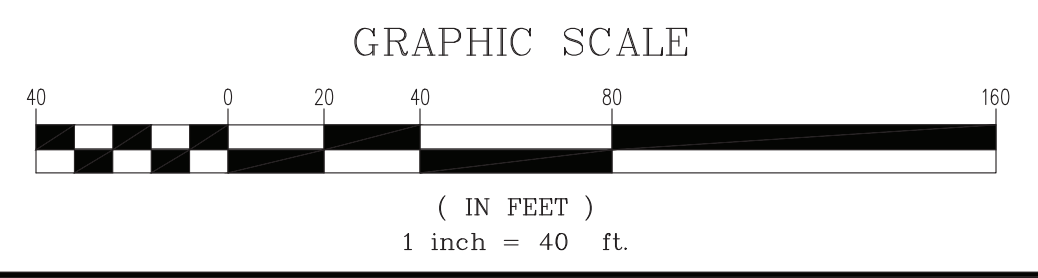
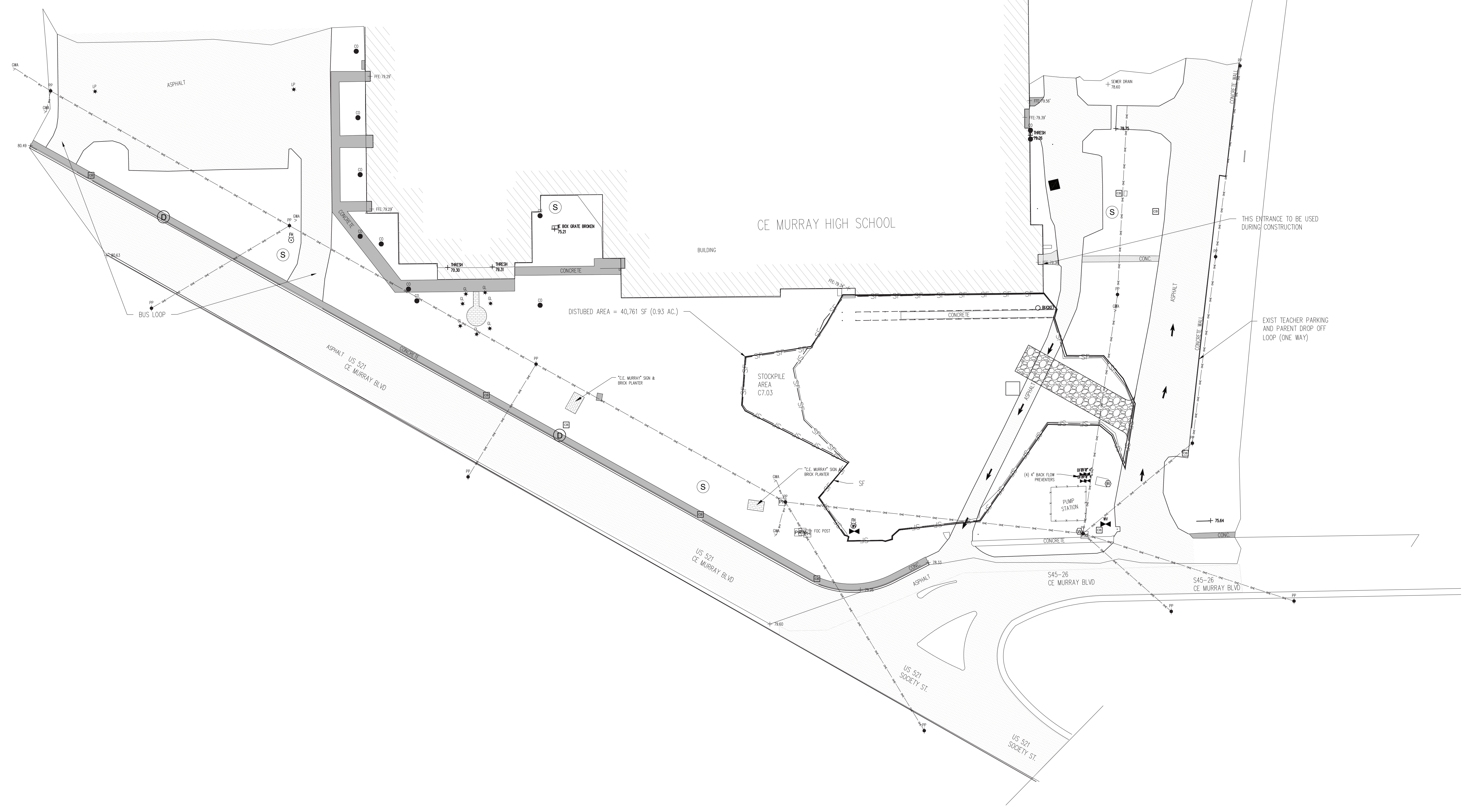
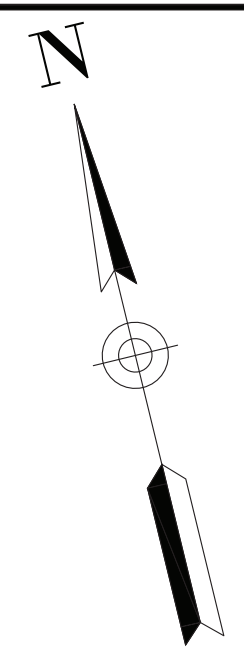

| | |
|------------------|-----------------|
| DRWN BY: WCE | CHECKED BY: JSE |
| DATE: 5-18-2022 | DATE: 5-18-2022 |
| DESIGNED BY: WCE | CHECKED BY: JSE |
| DATE: 5-18-2022 | DATE: 5-18-2022 |
| SCALE: AS NOTED | |

WILLIAMSBURG COUNTY SCHOOL DISTRICT
 CE MURRAY ELEMENTARY/MIDDLE SCHOOL
 VISITOR ACCESS
 GREENLYVILLE SOUTH CAROLINA
 POST DEMOLITION PLAN

| REV | DATE | REVISION | APPROVED |
|-----|------------|----------------------|----------|
| A | 05/18/2022 | REVISED PER OSF REV. | WCE |
| | | | |
| | | | |
| | | | |
| | | | |
| | | | |
| | | | |
| | | | |
| | | | |
| | | | |

C1.03
 RECO JOB # 2021W17001

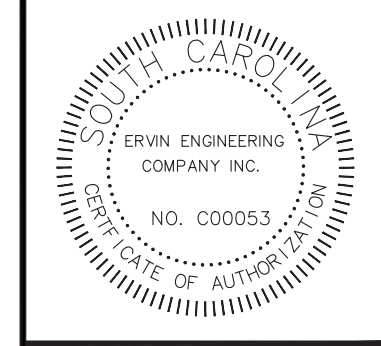
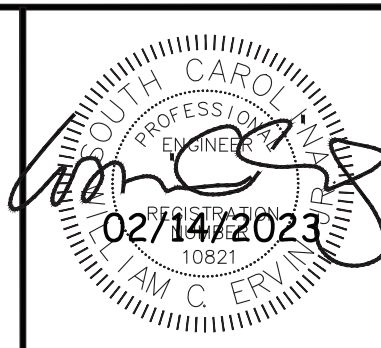

| | | |
|-------------------------------------|------------------|-----------------|
| WILLIAMSBURG COUNTY SCHOOL DISTRICT | CHECKED BY: WCE | CHECKED BY: USE |
| CE MURRAY ELEMENTARY/MIDDLE SCHOOL | DATE: 5-18-2022 | DATE: 5-18-2022 |
| VISITOR ACCESS | DESIGNED BY: WCE | CHECKED BY: USE |
| GREELYVILLE SOUTH CAROLINA | DATE: 5-18-2022 | DATE: 5-18-2022 |
| OVERALL SITE LAYOUT | SCALE: AS NOTED | |

| | |
|----------|--|
| APPROVED | |
| REVISION | |
| DATE | |
| BY | |

| | |
|----------|--|
| APPROVED | |
| REVISION | |
| DATE | |
| BY | |

| | |
|----------|--|
| APPROVED | |
| REVISION | |
| DATE | |
| BY | |

| | |
|----------|--|
| APPROVED | |
| REVISION | |
| DATE | |
| BY | |

C2.00
EFCO JOB #: 2021W17001

CE MURRAY HIGH SCHOOL

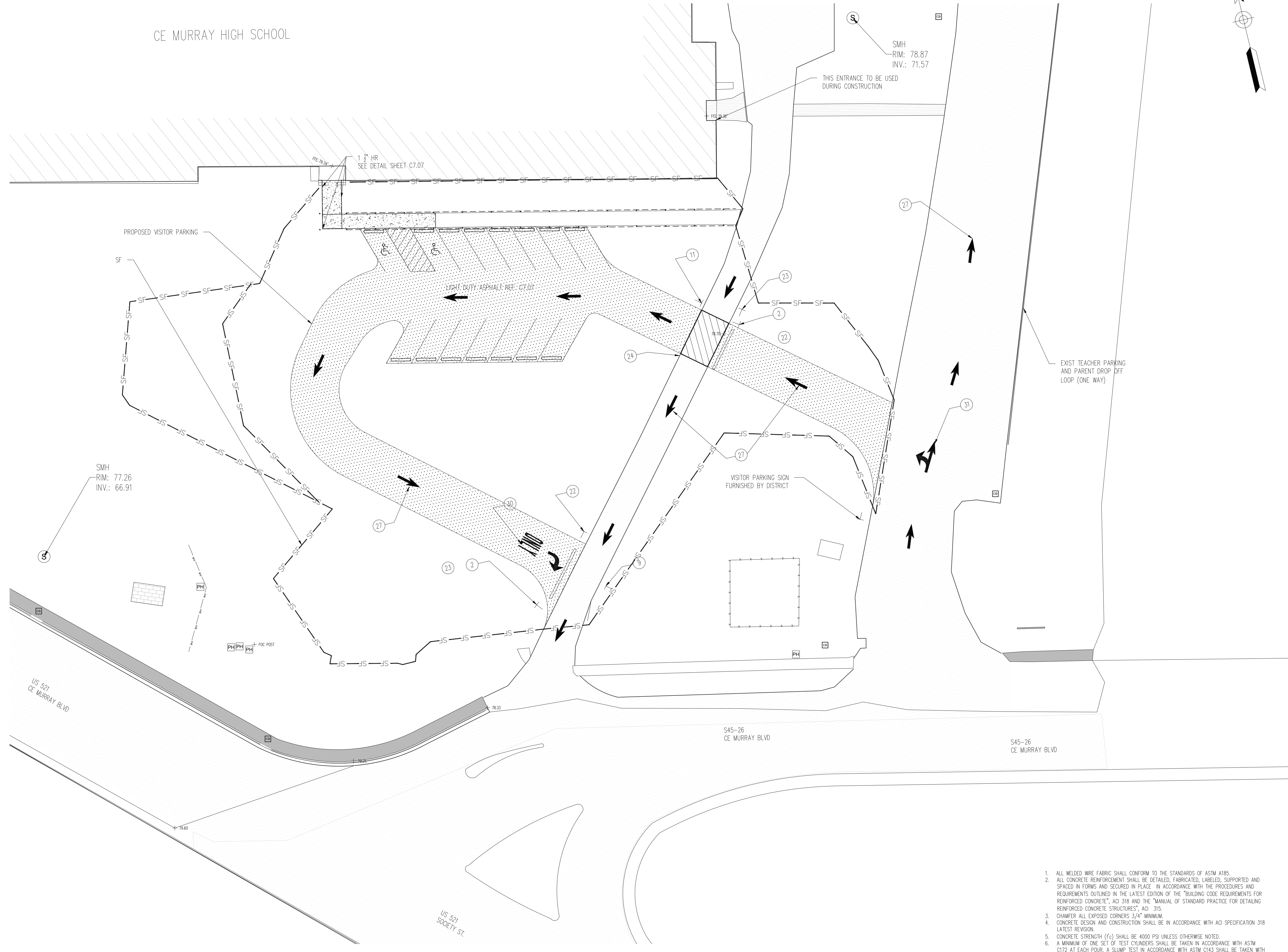

- LEGEND**
- 1 4" WIDE DOUBLE YELLOW LINES
 - 2 24" WIDE WHITE STOP LINE WITH STANDARD OCTAGON STOP SIGN (SCDOT SIGN NUMBER R1-1-36)
 - 3 4" WIDE X 10' LONG WHITE SKIP LINES W/ 30' SPACING
 - 4 4" WIDE X 2' LONG WHITE SKIP LINES W/ 5' SPACING
 - 5 4" WIDE WHITE LINE
 - 6 BLUE ADA SIGN SEE DETAILS SHEET C7.08
 - 7 DO NOT ENTER SIGN (SCDOT NUMBER R5-1-30)
 - 8 8' WHITE LADDER STYLE CROSSWALK MARKINGS
 - 9 ONE WAY SIGN (SCDOT NUMBER R6-1-36)
 - 10 CUSTOM SIGN - 36"x18" KEEP MOVING - CHANGE LANES LATER
 - 11 DO NOT BLOCK DRIVEWAY SIGN (SCDOT NUMBER R10-7.124)
 - 12 4" WIDE YELLOW LINE
 - 13 8" WIDE WHITE LINE
 - 14 STUDENT LOADING ZONE / ALTERNATE MERGE SIGN (SCDOT NUMBER S20-1-30)
 - 15 12" DROP OFF LANE / 20' UNOBSTRUCTED EMERGENCY ACCESS LANE SEPARATED BY 4" WIDE SOLID RED LINE
 - 16 4" WIDE SOLID YELLOW LINES (OUTSIDE)
4" WIDE X 10' LONG YELLOW SKIP LINES W/ 30' SPACING (INSIDE)
 - 17 EMERGENCY ACCESS - 20' WIDE ROAD PER DETAILS ON SHEET C7.04
 - 18 CUSTOM SIGN - 36"x12" BUSES
 - 19 CUSTOM SIGN - 36"x18" STUDENT DROP-OFF / PICK-UP (RIGHT LANE) VISITORS (LEFT LANE)
 - 20 DROP CURB W/ PIPE RAIL GATE W/ KNOX LOCK PER DETAILS ON SHEET C7.04
 - 21 6" WIDE WHITE LINE
 - 22 NO RIGHT TURN 24"x 24" SIGN (SCDOT NUMBER R3-1-24)
 - 23 NO LEFT TURN 24"x 24" SIGN (SCDOT NUMBER R3-2-24)
 - 24 12" WIDE WHITE BORDERLINES WITH 6" WIDE WHITE CROSSHATCH LINES
 - 25 6" HIGH RED LETTERS
 - 26 CUSTOM SIGN - 36"x18" STUDENT DROP-OFF / PICK-UP (RIGHT 2 LANES) VISITORS (LEFT LANE)
 - 27 WHITE STRAIGHT ARROW PER SCDOT DWG. 625-410-00
 - 28 WHITE LEFT TURN ARROW PER SCDOT DWG. 625-410-00
 - 29 WHITE RIGHT TURN ARROW PER SCDOT DWG. 625-410-00
 - 30 WHITE WORD "ONLY" PER SCDOT DWG. 625-410-00
 - 31 WHITE LEFT TURN ARROW & STRAIGHT COMBINATION PER SCDOT DWG. 625-410-00
- NOTES**
1. ALL PROPOSED LANE WIDTHS ARE 12' UNO.
 2. ALL PAVEMENT MARKINGS TO BE THERMOPLASTIC.

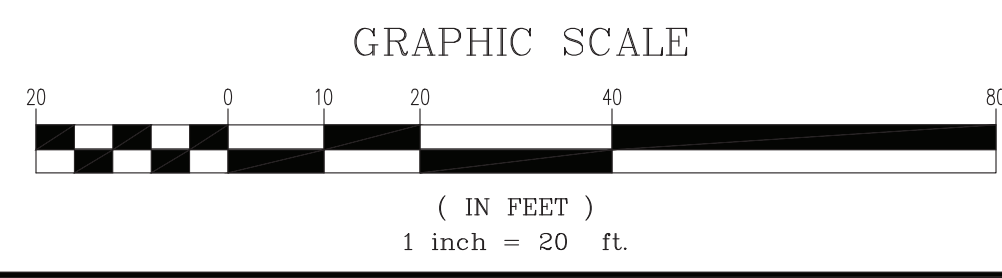

1. ALL WELDED WIRE FABRIC SHALL CONFORM TO THE STANDARDS OF ASTM A185.
2. ALL CONCRETE REINFORCEMENT SHALL BE DETAILED, FABRICATED, LABELED, SUPPORTED AND SPACED IN FORMS AND SECURED IN PLACE IN ACCORDANCE WITH THE PROCEDURES AND REQUIREMENTS OUTLINED IN THE LATEST EDITION OF THE "BUILDING CODE REQUIREMENTS FOR REINFORCED CONCRETE STRUCTURES", ACI 318 AND THE "MANUAL OF STANDARD PRACTICE FOR DETAILING REINFORCED CONCRETE STRUCTURES", ACI 315.
3. CHAMFER ALL EXPOSED CORNERS 3/4" MINIMUM.
4. CONCRETE DESIGN AND CONSTRUCTION SHALL BE IN ACCORDANCE WITH ACI SPECIFICATION 318 LATEST REVISION.
5. CONCRETE STRENGTH (f_c) SHALL BE 4000 PSI UNLESS OTHERWISE NOTED.
6. A MINIMUM OF ONE SET OF TEST CYLINDERS SHALL BE TAKEN IN ACCORDANCE WITH ASTM C172 AT EACH POUR. A SLUMP TEST IN ACCORDANCE WITH ASTM C143 SHALL BE TAKEN WITH EACH SET OF CYLINDERS. THE FIRST SET OF CYLINDERS SHALL BE TAKEN FROM THE FIRST 25 CY Poured. FOR POURS EXCEEDING 25 CY, CYLINDERS SHALL BE TAKEN WITHIN EVERY ADDITIONAL 50 CY OR ANY FRACTION THEREOF. A MINIMUM OF 4 CYLINDERS SHALL BE MADE IN EACH SET UNLESS OTHERWISE SPECIFIED. THE TEST CYLINDERS SHALL BE TESTED IN ACCORDANCE WITH ASTM C39. THE FIRST CYLINDER SHALL BE TESTED AT 7 DAYS, THE SECOND TWO CYLINDERS AT 28 DAYS AND THE LAST CYLINDER SHALL BE DESIGNATED A HOLD CYLINDER.

- LEGEND**
- ① 4" WIDE DOUBLE YELLOW LINES
 - ② 24" WIDE WHITE STOP LINE WITH STANDARD OCTAGON STOP SIGN (SCDOT SIGN NUMBER R1-1-36)
 - ③ 4" WIDE X 10' LONG WHITE SKIP LINES W/ 30' SPACING
 - ④ 4" WIDE X 2' LONG WHITE SKIP LINES W/ 5' SPACING
 - ⑤ 4" WIDE WHITE LINE
 - ⑥ BLUE ADA SIGN SEE DETAILS SHEET C7.08
 - ⑦ DO NOT ENTER SIGN (SCDOT NUMBER R5-1-30)
 - ⑧ 8' WHITE LADDER STYLE CROSSWALK MARKINGS
 - ⑨ ONE WAY SIGN (SCDOT NUMBER R6-1-36)
 - ⑩ CUSTOM SIGN - 36"x18" KEEP MOVING - CHANGE LANES LATER
 - ⑪ DO NOT BLOCK INTERSECTION SIGN (SCDOT NUMBER R10-7-24)
 - ⑫ 4" WIDE YELLOW LINE
 - ⑬ 8" WIDE WHITE LINE
 - ⑭ STUDENT LOADING ZONE / ALTERNATE MERGE SIGN (SCDOT NUMBER S20-1-30)
 - ⑮ 12" DROP OFF LANE / 20' UNOBSTRUCTED EMERGENCY ACCESS LANE SEPARATED BY 4" WIDE SOLID RED LINE
 - ⑯ 4" WIDE SOLID YELLOW LINES (OUTSIDE)
4" WIDE X 10' LONG YELLOW SKIP LINES W/ 30' SPACING (INSIDE)
 - ⑰ EMERGENCY ACCESS - 20' WIDE ROAD PER DETAILS ON SHEET C7.04
 - ⑱ CUSTOM SIGN - 36"x12" BUSES
↑ STUDENT DROP-OFF / PICK-UP (RIGHT LANE) VISITORS (LEFT LANE)
 - ⑲ CUSTOM SIGN - 36"x18" STUDENT DROP-OFF / PICK-UP (RIGHT LANE) VISITORS (LEFT LANE)
 - ⑳ DROP CURB W/ PIPE RAIL GATE W/ KNOX LOCK PER DETAILS ON SHEET C7.04
 - ㉑ 6" WIDE WHITE LINE
 - ㉒ NO RIGHT TURN 24"x 24" SIGN (SCDOT NUMBER R3-1-24)
 - ㉓ NO LEFT TURN 24"x 24" SIGN (SCDOT NUMBER R3-2-24)
 - ㉔ 4" WIDE WHITE EDGELINES W/ 12" WIDE DIAGONAL HASH BARS @ 6' SPACING
 - ㉕ 6' HIGH RED LETTERS
 - ㉖ CUSTOM SIGN - 36"x18" STUDENT DROP-OFF / PICK-UP (RIGHT 2 LANES) VISITORS (LEFT LANE)
 - ㉗ WHITE STRAIGHT ARROW PER SCDOT DWG. 625-410-00
 - ㉘ WHITE LEFT TURN ARROW PER SCDOT DWG. 625-410-00
 - ㉙ WHITE RIGHT TURN ARROW PER SCDOT DWG. 625-410-00
 - ㉚ WHITE WORD "ONLY" PER SCDOT DWG. 625-410-00
 - ㉛ WHITE LEFT TURN ARROW & STRAIGHT COMBINATION PER SCDOT DWG. 625-410-00
- NOTES**
1. ALL PROPOSED LANE WIDTHS ARE 12' UNO.
 2. ALL PAVEMENT MARKINGS TO BE THERMOPLASTIC.

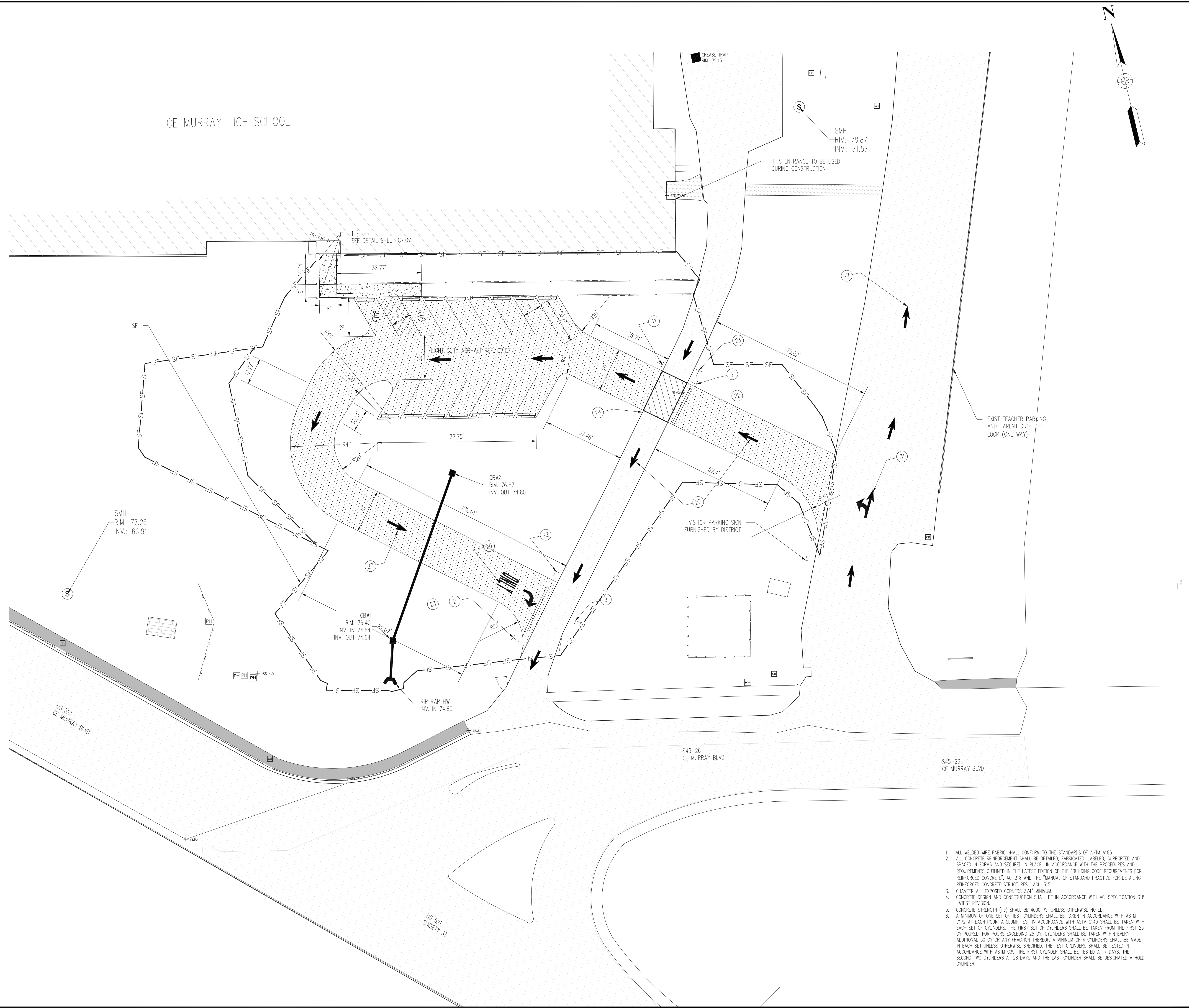
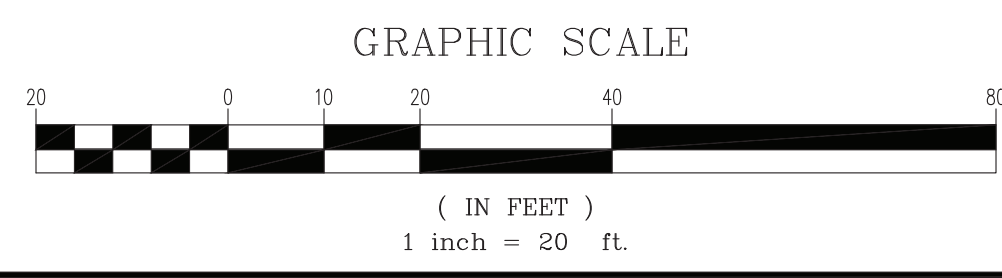

1. ALL WELDED WIRE FABRIC SHALL CONFORM TO THE STANDARDS OF ASTM A185.
2. ALL CONCRETE REINFORCEMENT SHALL BE DETAILED, FABRICATED, LABELED, SUPPORTED AND SPACED IN FORMS AND SECURED IN PLACE IN ACCORDANCE WITH THE PROCEDURES AND REQUIREMENTS OUTLINED IN THE LATEST EDITION OF THE "BUILDING CODE REQUIREMENTS FOR REINFORCED CONCRETE STRUCTURES", ACI 318 AND THE "MANUAL OF STANDARD PRACTICE FOR DETAILING REINFORCED CONCRETE STRUCTURES", ACI 315.
3. CHAMFER ALL EXPOSED CORNERS 3/4" MINIMUM.
4. CONCRETE DESIGN AND CONSTRUCTION SHALL BE IN ACCORDANCE WITH ACI SPECIFICATION 318 LATEST REVISION.
5. CONCRETE STRENGTH (f_c) SHALL BE 4000 PSI UNLESS OTHERWISE NOTED.
6. A MINIMUM OF ONE SET OF TEST CYLINDERS SHALL BE TAKEN IN ACCORDANCE WITH ASTM C172 AT EACH POUR. A SLUMP TEST IN ACCORDANCE WITH ASTM C143 SHALL BE TAKEN WITH EACH SET OF CYLINDERS. THE FIRST SET OF CYLINDERS SHALL BE TAKEN FROM THE FIRST 25 CY Poured. FOR POURS EXCEEDING 25 CY, CYLINDERS SHALL BE TAKEN WITHIN EVERY ADDITIONAL 50 CY OR ANY FRACTION THEREOF. A MINIMUM OF 4 CYLINDERS SHALL BE MADE IN EACH SET UNLESS OTHERWISE SPECIFIED. THE TEST CYLINDERS SHALL BE TESTED IN ACCORDANCE WITH ASTM C39. THE FIRST CYLINDER SHALL BE TESTED AT 7 DAYS, THE SECOND TWO CYLINDERS AT 28 DAYS AND THE LAST CYLINDER SHALL BE DESIGNATED A HOLD CYLINDER.

WECO
 ERVIN ENGINEERING COMPANY INC.
 3415 EBYNS ST., P.O. BOX 3
 FARMING, S.C. 29601

| | | | |
|------------------|-----------------|-----------------|-----------------|
| DRAWN BY: WCE | CHECKED BY: USE | DATE: 5-18-2022 | DATE: 5-18-2022 |
| DESIGNED BY: WCE | CHECKED BY: USE | DATE: 5-18-2022 | DATE: 5-18-2022 |
| SCALE: AS NOTED | | | |

WILLIAMSBURG COUNTY SCHOOL DISTRICT
CE MURRAY ELEMENTARY/MIDDLE SCHOOL
VISITOR ACCESS
 GREENLYVILLE SOUTH CAROLINA

| REV. | DATE | REVISION | APPROVED |
|------|------|----------|----------|
| | | | |
| | | | |
| | | | |
| | | | |

| REV. | DATE | REVISION | PER | OSF | REV. |
|------|------|----------|-----|-----|------|
| | | | | | |
| | | | | | |
| | | | | | |
| | | | | | |

C2.01
 RECO JOB # 2021W17001

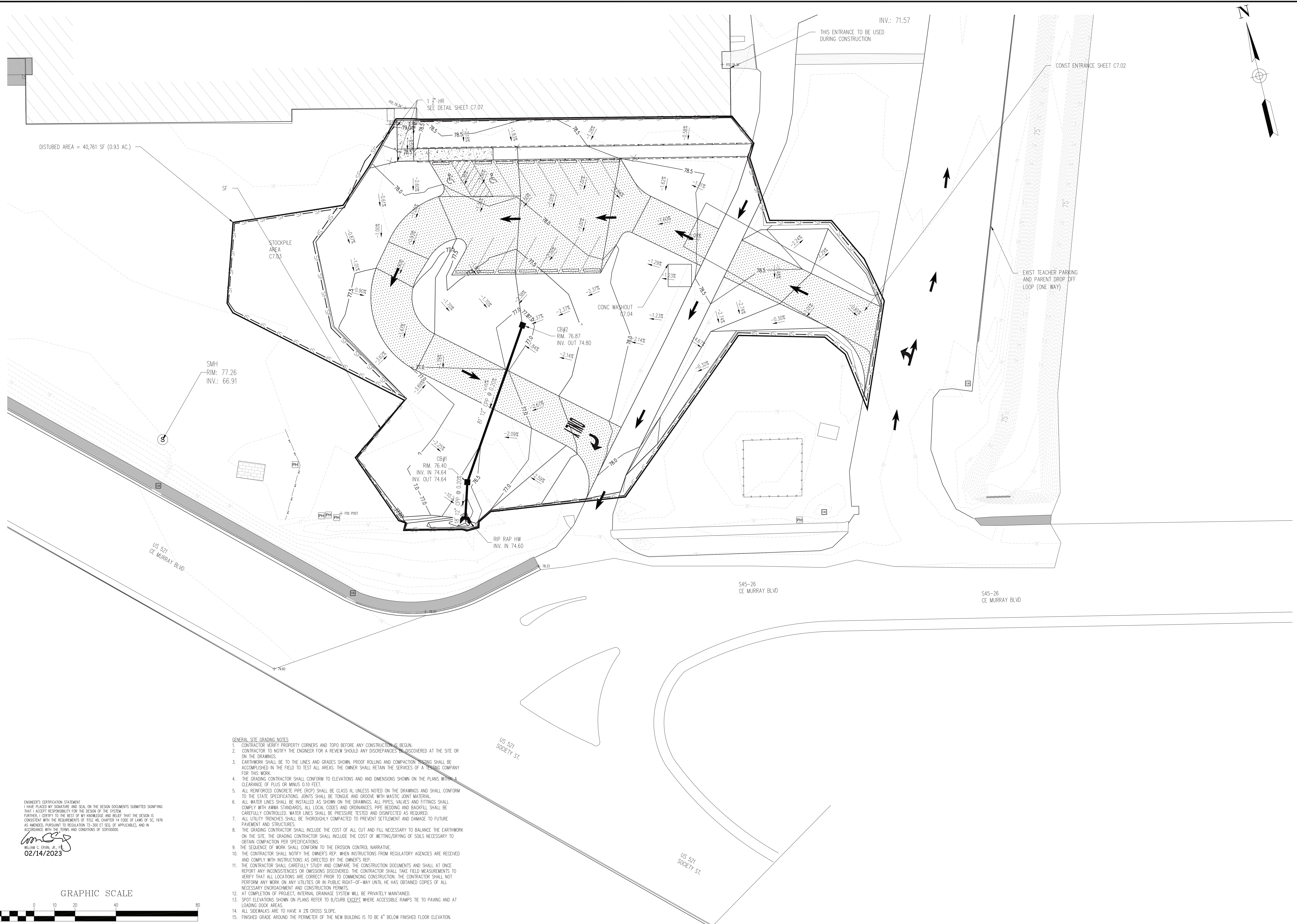

DISTURBED AREA = 40,761 SF (0.93 AC.)

SMH
RIM: 77.26
INV.: 66.91

RIP RAP HW
INV. IN 74.60

US 521
SOCIETY ST.

S45-26
CE MURRAY BLVD

S45-26
CE MURRAY BLVD

- GENERAL SITE GRADING NOTES
- CONTRACTOR VERIFY PROPERTY CORNERS AND TOPO BEFORE ANY CONSTRUCTION BEGINS.
 - CONTRACTOR TO NOTIFY THE ENGINEER FOR A REVIEW SHOULD ANY DISCREPANCIES BE DISCOVERED AT THE SITE OR ON THE DRAWINGS.
 - EARTHWORK SHALL BE TO THE LINES AND GRADES SHOWN. PROOF ROLLING AND COMPACTION TESTING SHALL BE ACCOMPLISHED IN THE FIELD TO TEST ALL AREAS. THE OWNER SHALL RETAIN THE SERVICES OF A TESTING COMPANY FOR THIS WORK.
 - THE GRADING CONTRACTOR SHALL CONFORM TO ELEVATIONS AND DIMENSIONS SHOWN ON THE PLANS WITHIN A CLEARANCE OF PLUS OR MINUS 0.10 FEET.
 - ALL REINFORCED CONCRETE PIPE (RCP) SHALL BE CLASS III, UNLESS NOTED ON THE DRAWINGS AND SHALL CONFORM TO THE STATE SPECIFICATIONS. JOINTS SHALL BE TONGUE AND GROOVE WITH MASTIC JOINT MATERIAL.
 - ALL WATER LINES SHALL BE INSTALLED AS SHOWN ON THE DRAWINGS. ALL PIPES, VALVES AND FITTINGS SHALL COMPLY WITH AWWA STANDARDS, ALL LOCAL CODES AND ORDINANCES. PIPE BEDDING AND BACKFILL SHALL BE CAREFULLY CONTROLLED. WATER LINES SHALL BE PRESSURE TESTED AND DISINFECTED AS REQUIRED.
 - ALL UTILITY TRENCHES SHALL BE THOROUGHLY COMPACTED TO PREVENT SETTLEMENT AND DAMAGE TO FUTURE PAVEMENT AND STRUCTURES.
 - THE GRADING CONTRACTOR SHALL INCLUDE THE COST OF ALL CUT AND FILL NECESSARY TO BALANCE THE EARTHWORK ON THE SITE. THE GRADING CONTRACTOR SHALL INCLUDE THE COST OF WETTING/DRYING OF SOILS NECESSARY TO OBTAIN COMPACTION PER SPECIFICATIONS.
 - THE SEQUENCE OF WORK SHALL CONFORM TO THE EROSION CONTROL NARRATIVE.
 - THE CONTRACTOR SHALL NOTIFY THE OWNER'S REP. WHEN INSTRUCTIONS FROM REGULATORY AGENCIES ARE RECEIVED AND COMPLY WITH INSTRUCTIONS AS DIRECTED BY THE OWNER'S REP.
 - THE CONTRACTOR SHALL CAREFULLY STUDY AND COMPARE THE CONSTRUCTION DOCUMENTS AND SHALL AT ONCE REPORT ANY INCONSISTENCIES OR OMISSIONS DISCOVERED. THE CONTRACTOR SHALL TAKE FIELD MEASUREMENTS TO VERIFY THAT ALL LOCATIONS ARE CORRECT PRIOR TO COMMENCING CONSTRUCTION. THE CONTRACTOR SHALL NOT PERFORM ANY WORK ON ANY UTILITIES OR IN PUBLIC RIGHT-OF-WAY UNTIL HE HAS OBTAINED COPIES OF ALL NECESSARY ENCROACHMENT AND CONSTRUCTION PERMITS.
 - AT COMPLETION OF PROJECT, INTERNAL DRAINAGE SYSTEM WILL BE PRIVATELY MAINTAINED.
 - SPOT ELEVATIONS SHOWN ON PLANS REFER TO B/CURB EXCEPT WHERE ACCESSIBLE RAMPS TIE TO PAVING AND AT LOADING DOCK AREAS.
 - ALL SIDEWALKS ARE TO HAVE A 2% CROSS SLOPE.
 - FINISHED GRADE AROUND THE PERIMETER OF THE NEW BUILDING IS TO BE 6" BELOW FINISHED FLOOR ELEVATION.

ENGINEER'S CERTIFICATION STATEMENT
I HAVE PLACED MY SIGNATURE AND SEAL ON THE DESIGN DOCUMENTS SUBMITTED SIGNIFYING THAT I ACCEPT RESPONSIBILITY FOR THE DESIGN OF THE SYSTEM. FURTHER, I CERTIFY TO THE BEST OF MY KNOWLEDGE AND BELIEF THAT THE DESIGN IS CONSISTENT WITH THE REQUIREMENTS OF TITLE 48, CHAPTER 14 CODE OF LAWS OF SC, 1976 AS AMENDED, PURSUANT TO REGULATION 72-300 ET SEQ. (IF APPLICABLE), AND IN ACCORDANCE WITH THE TERMS AND CONDITIONS OF SCD100000.

William C. Ervin, R. E.
02/14/2023

GRAPHIC SCALE

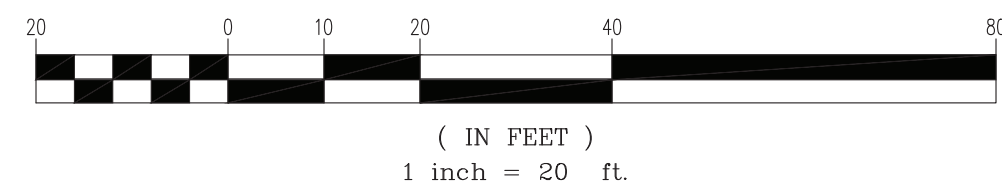

INV.: 71.57

THIS ENTRANCE TO BE USED DURING CONSTRUCTION

CONST ENTRANCE SHEET C7.02

1" HR
SEE DETAIL SHEET C7.07

EXIST TEACHER PARKING AND PARENT DROP OFF LOOP (ONE WAY)

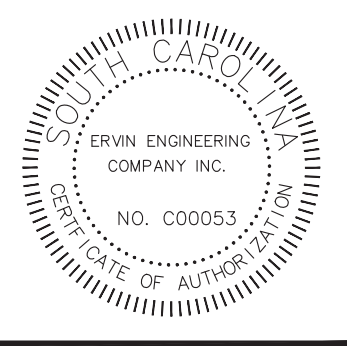
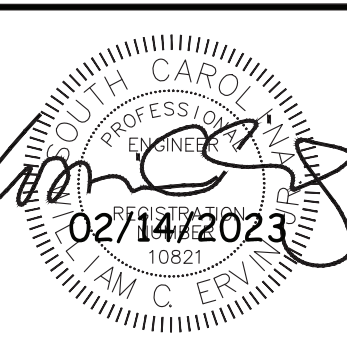

| | |
|------------------|-----------------|
| DRWN BY: WCE | CHECKED BY: JSE |
| DATE: 5-18-2022 | DATE: 5-18-2022 |
| DESIGNED BY: WCE | CHECKED BY: JSE |
| DATE: 5-18-2022 | DATE: 5-18-2022 |
| SCALE: AS NOTED | |

WILLIAMSBURG COUNTY SCHOOL DISTRICT
CE MURRAY ELEMENTARY/MIDDLE SCHOOL
VISITOR ACCESS
GREATVILLE SOUTH CAROLINA
OVERALL GRADING PLAN

| REV. | DATE | REVISION | APPROVED |
|------|------|----------|----------|
| A | | | |

C3.00
RECO JOB #: 2021W17001

CE MURRAY HIGH SCHOOL

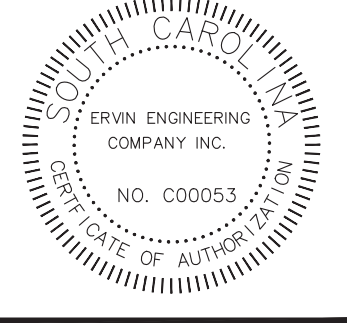
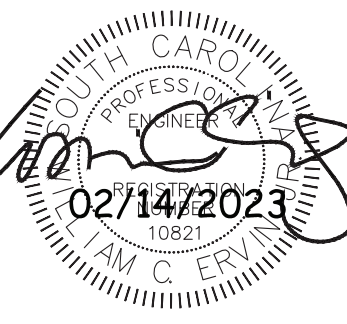
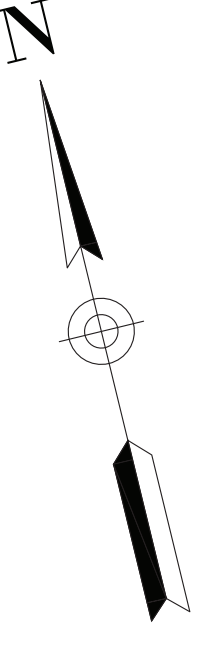
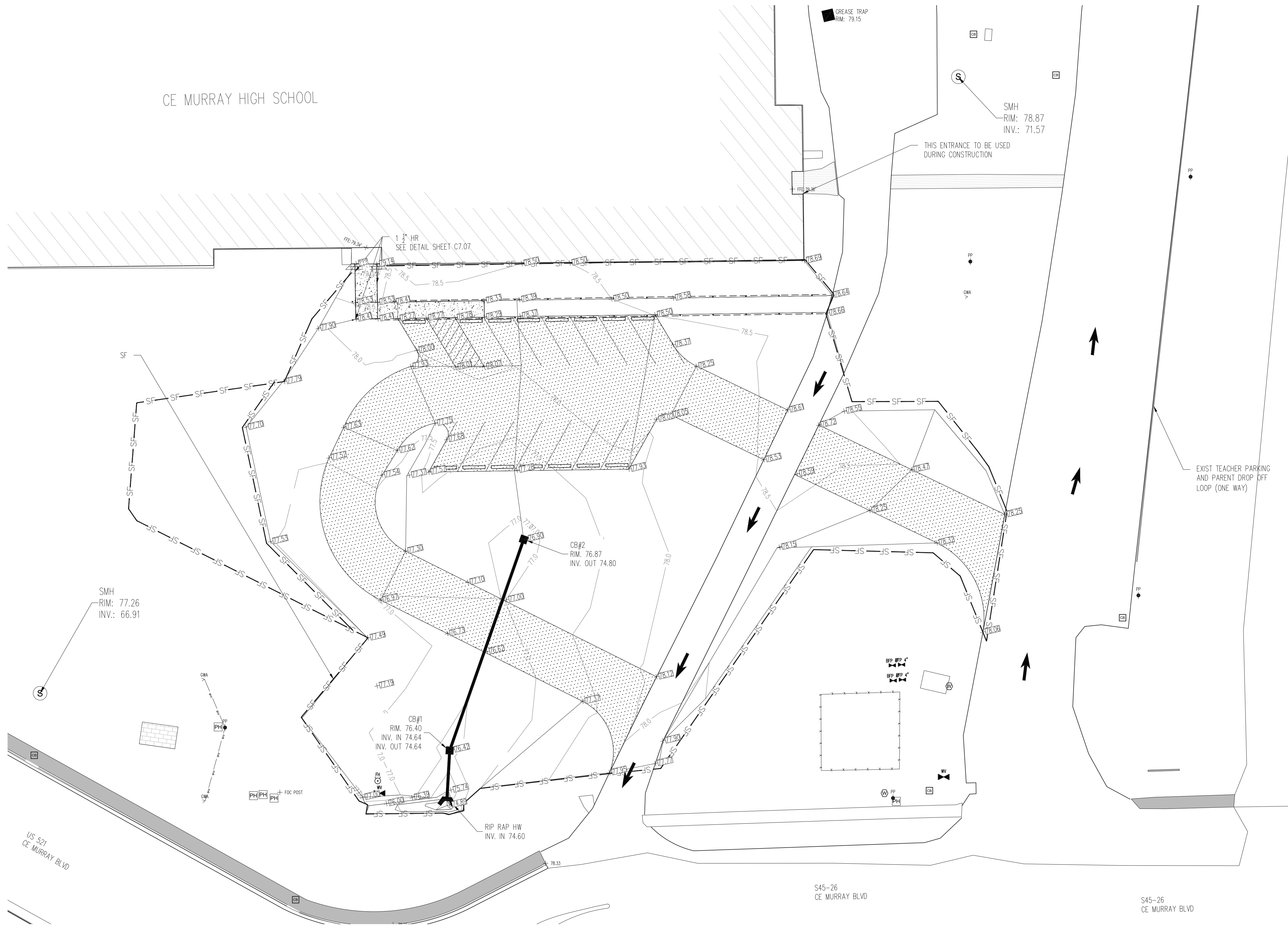

| | |
|------------------|-----------------|
| DRAWN BY: WCE | CHECKED BY: JSE |
| DATE: 5-18-2022 | DATE: 5-18-2022 |
| DESIGNED BY: WCE | CHECKED BY: JSE |
| DATE: 5-18-2022 | DATE: 5-18-2022 |
| SCALE: AS NOTED | |

WILLIAMSBURG COUNTY SCHOOL DISTRICT
 CE MURRAY ELEMENTARY/MIDDLE SCHOOL
 VISITOR ACCESS
 GREENLYVILLE SOUTH CAROLINA
 SPOT ELEVATION PLAN

| REV | DATE | REVISION | APPROVED | REV | DATE | REVISION | APPROVED |
|-----|------------|-----------------------|----------|-----|------|----------|----------|
| A | 05/18/2022 | REVISION PER OSF REV. | | | | | |
| | | | | | | | |
| | | | | | | | |
| | | | | | | | |
| | | | | | | | |
| | | | | | | | |
| | | | | | | | |
| | | | | | | | |
| | | | | | | | |
| | | | | | | | |

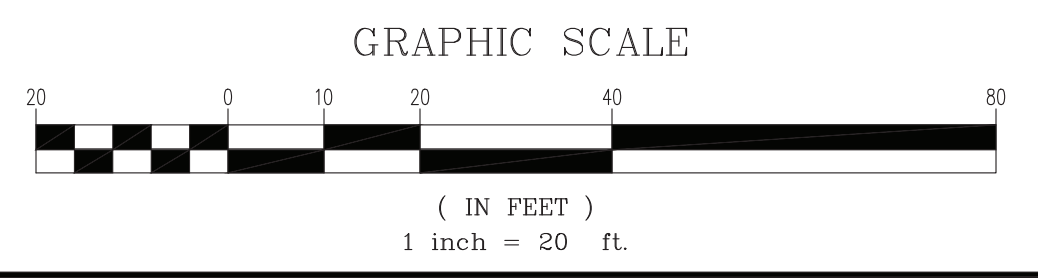

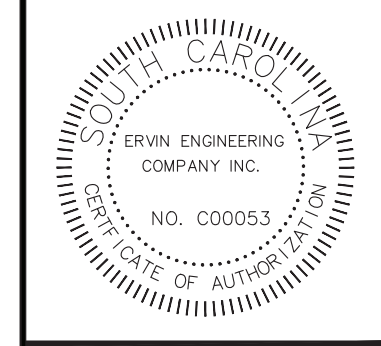
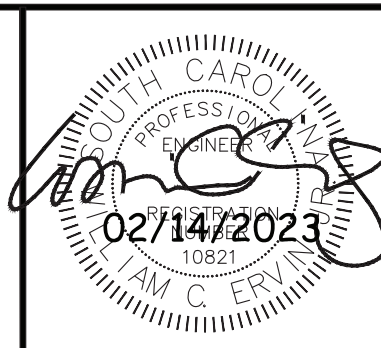
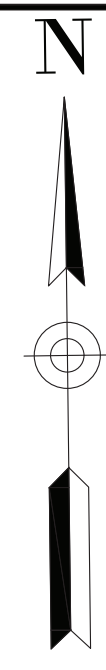
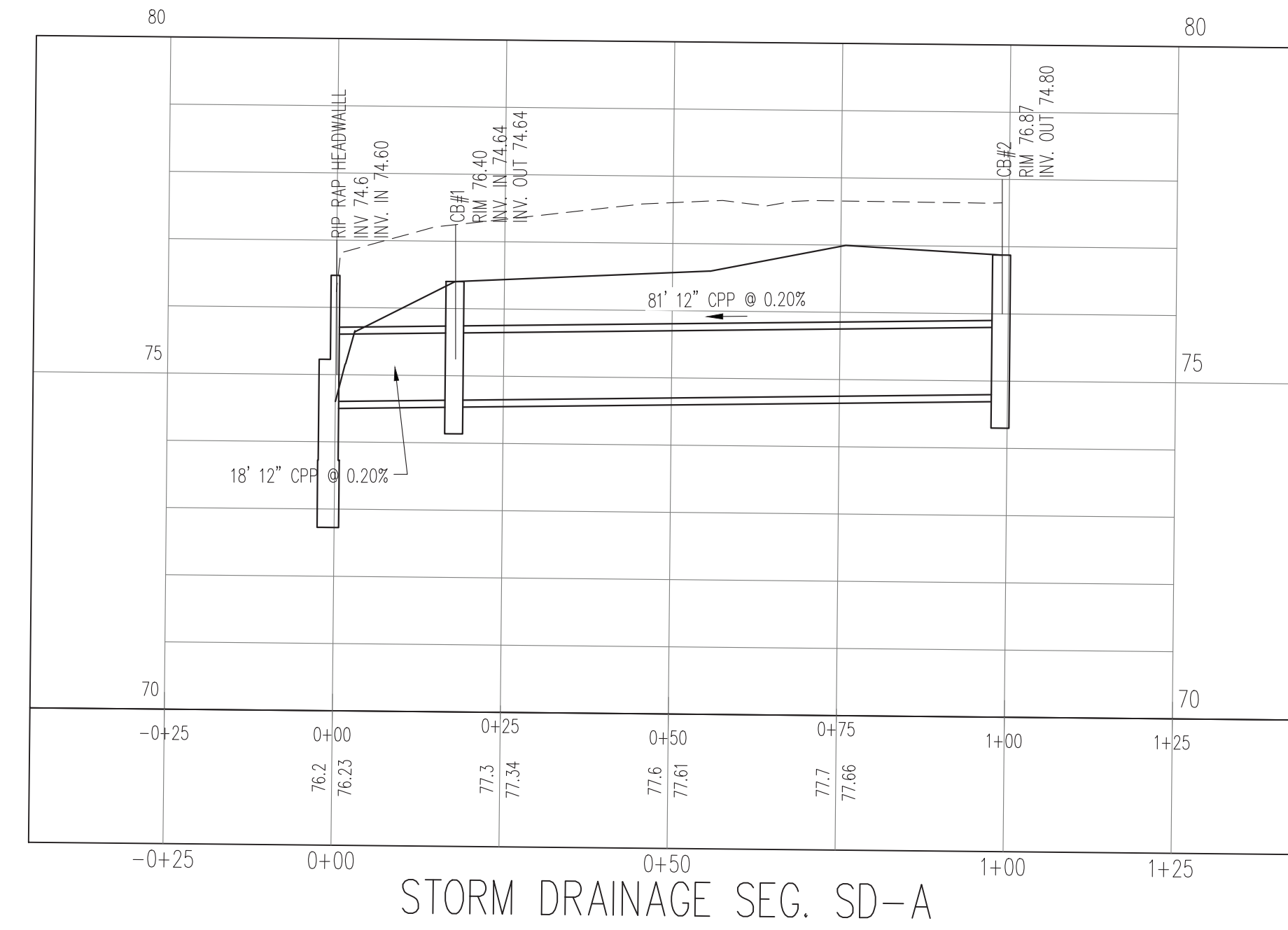
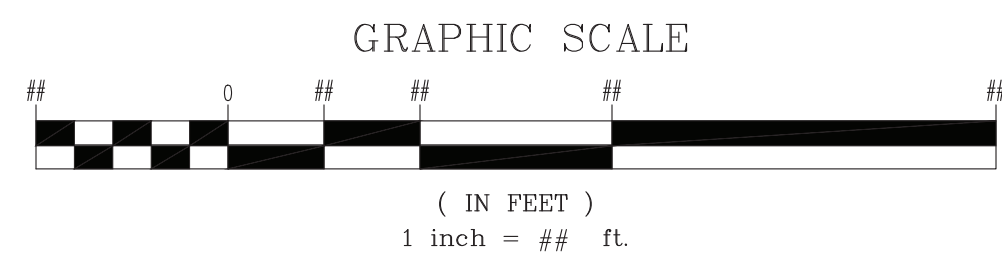

| | |
|------------------|-----------------|
| DRAWN BY: WCE | CHECKED BY: JSE |
| DATE: 5-18-2022 | DATE: 5-18-2022 |
| DESIGNED BY: WCE | CHECKED BY: JSE |
| DATE: 5-18-2022 | DATE: 5-18-2022 |
| SCALE: AS NOTED | |

WILLIAMSBURG COUNTY SCHOOL DISTRICT
 CE MURRAY ELEMENTARY/MIDDLE SCHOOL
 VISITOR ACCESS
 GREENLYVILLE SOUTH CAROLINA

| REV | DATE | REVISION | APPROVED | REV | DATE | REVISION | APPROVED |
|-----|------------|----------------------|----------|-----|------|----------|----------|
| A | 05/18/2022 | REVISED PER OSF REV. | WCE | | | | |
| | | | | | | | |
| | | | | | | | |
| | | | | | | | |
| | | | | | | | |
| | | | | | | | |
| | | | | | | | |
| | | | | | | | |
| | | | | | | | |
| | | | | | | | |

C4.00
 EECO JOB # 2021W17001

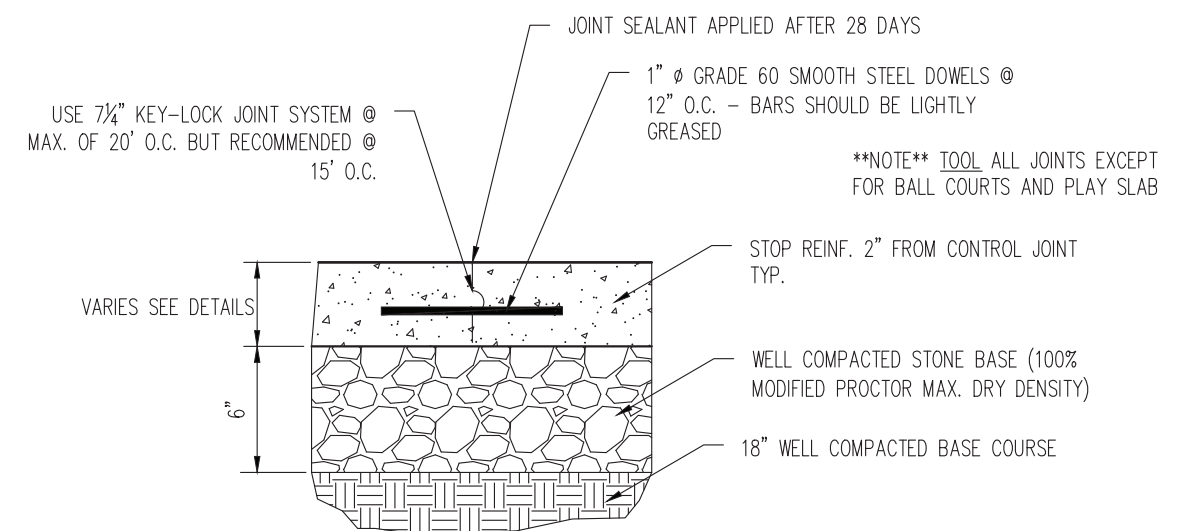

CONCRETE CONSTRUCTION JOINT DETAIL
N.T.S.

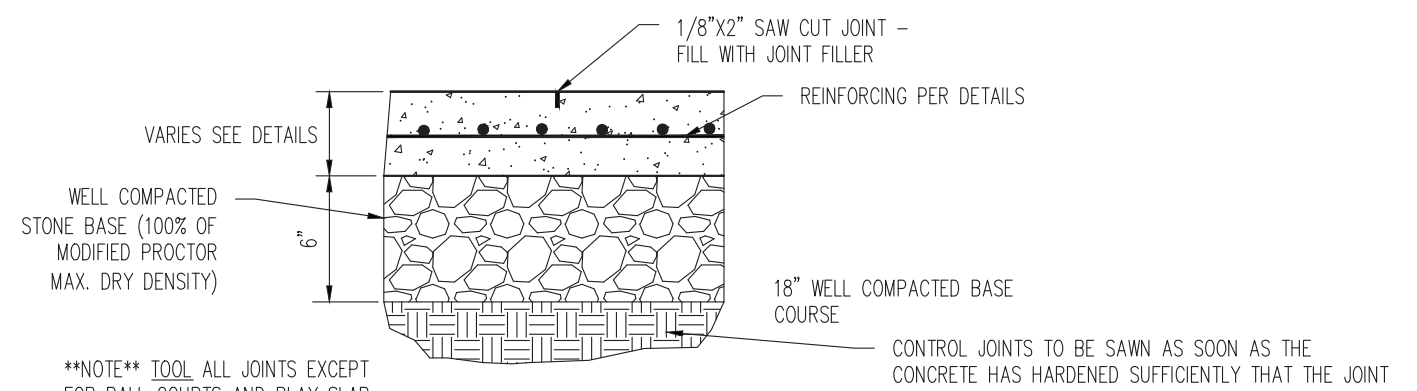

TYPICAL CONTROL JOINT
N.T.S.

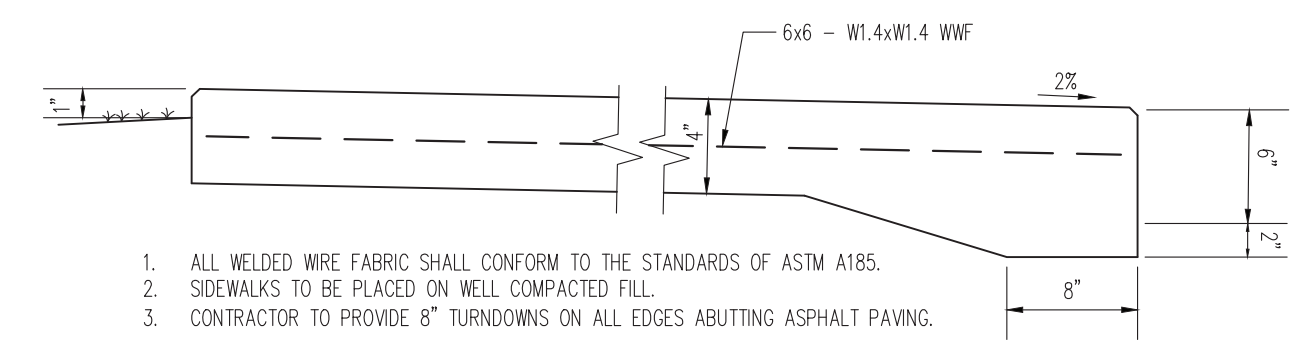

CONCRETE SIDEWALK DETAIL
N.T.S.

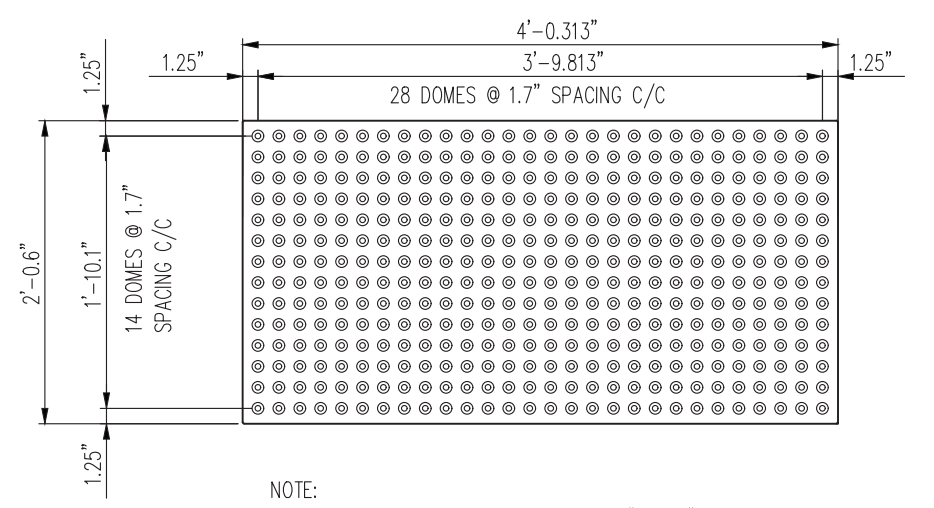

PLAN VIEW
DETECTABLE WARNING SURFACE TILE DETAIL

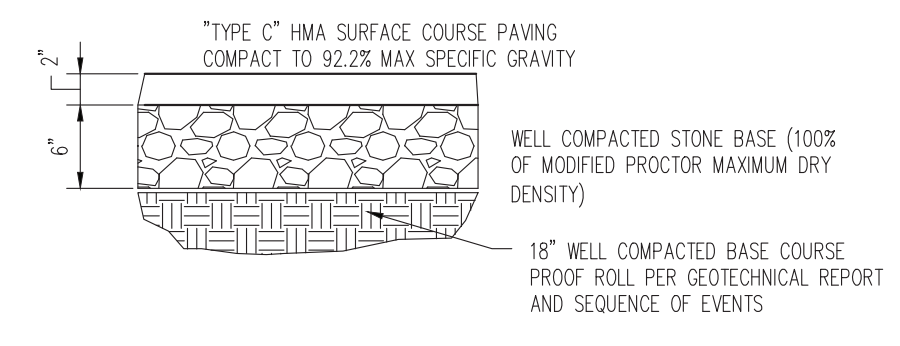

LIGHT DUTY ASPHALT DETAIL
N.T.S.

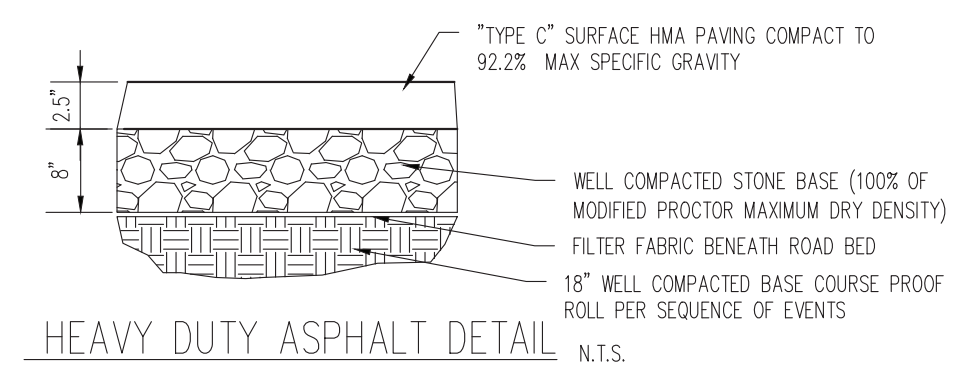

HEAVY DUTY ASPHALT DETAIL
N.T.S.

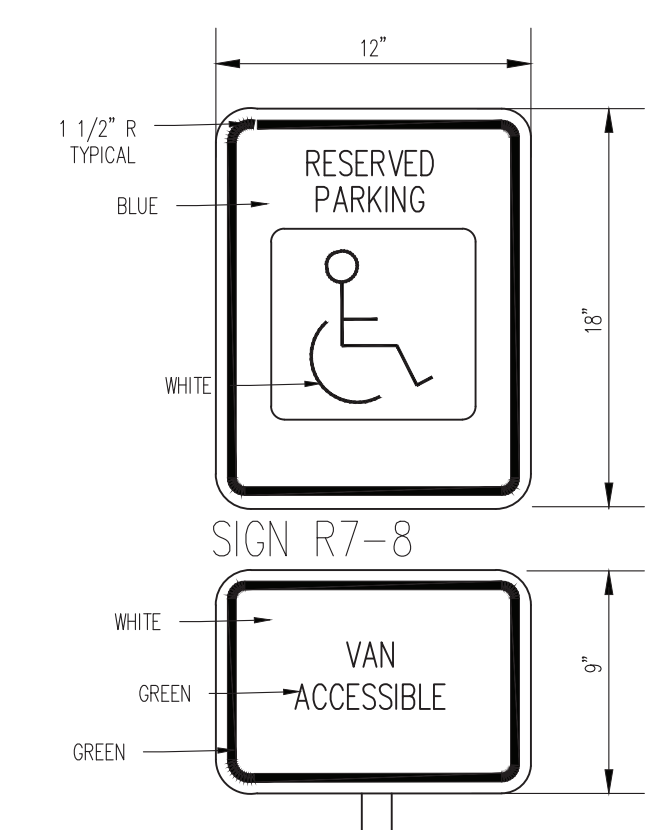
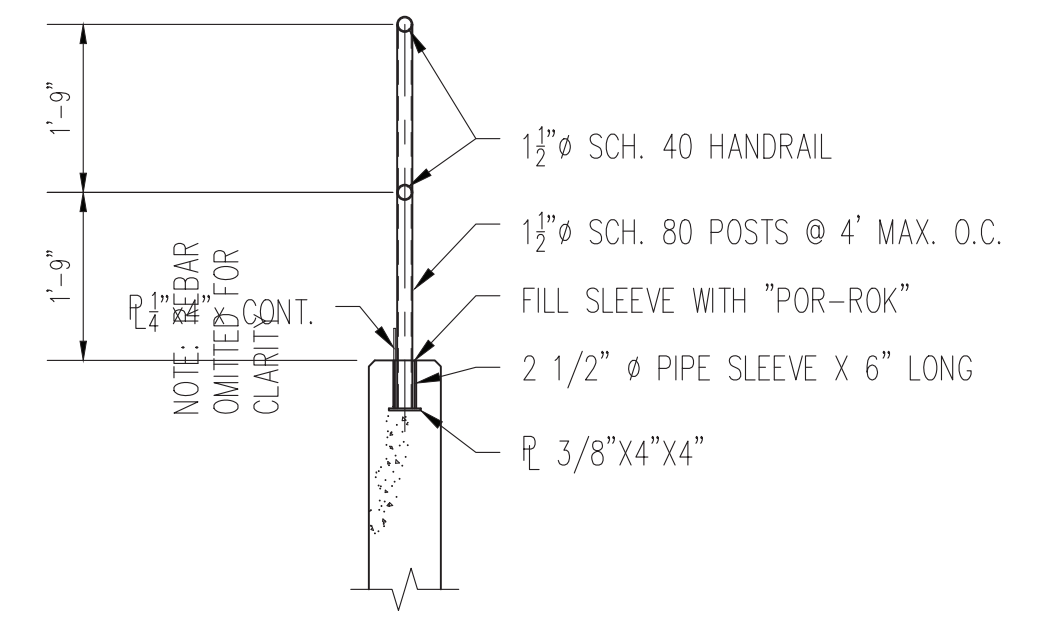

VAN ACCESSIBLE SIGN

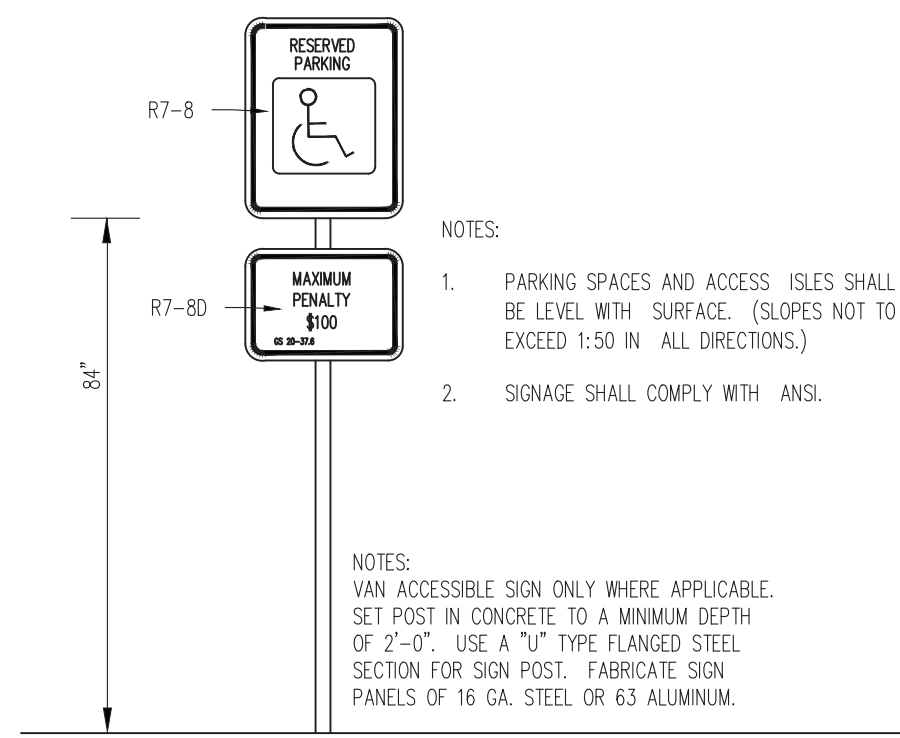

HANDICAPPED SIGN

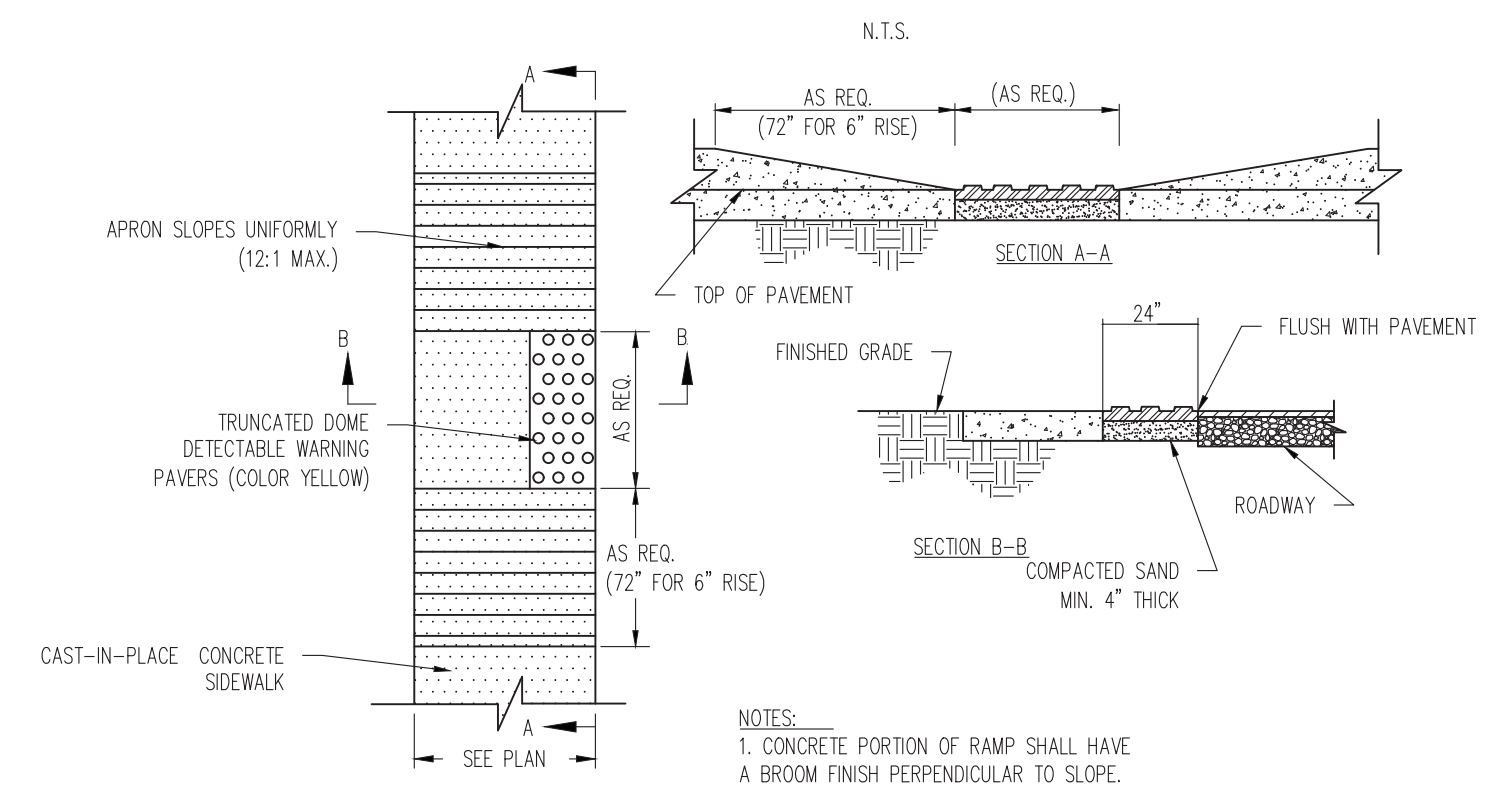

SIDEWALK RAMP WITH DETECTABLE WARNING DEVICE

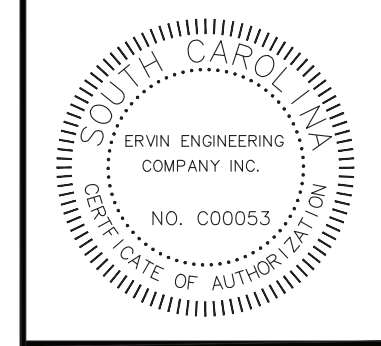
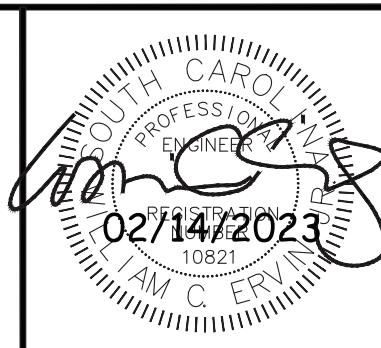

| | |
|------------------|-----------------|
| DRAWN BY: WCE | CHECKED BY: USE |
| DATE: 5-18-2022 | DATE: 5-18-2022 |
| DESIGNED BY: WCE | CHECKED BY: USE |
| DATE: 5-18-2022 | DATE: 5-18-2022 |
| SCALE: NONE | |

WILLIAMSBURG COUNTY SCHOOL DISTRICT
CE MURRAY ELEMENTARY/MIDDLE SCHOOL
VISITOR ACCESS
SOUTH CAROLINA
GREENLYVILLE

| REV | DATE | REVISION | APPROVED |
|-----|------------|----------------------|----------|
| A | 02/14/2023 | REVISED PER OSF REV. | WCE |

STANDARD PAVEMENT MARKINGS

FOR ARROWS & ONLY(S)

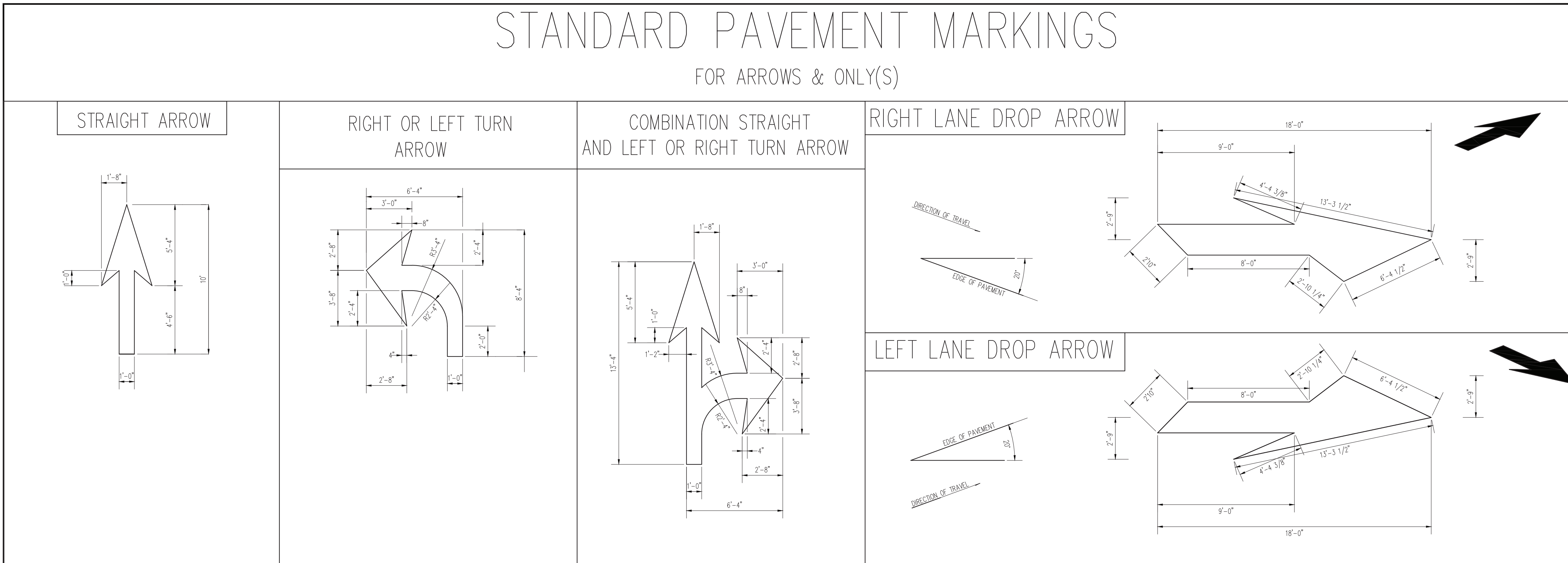

"ONLY"

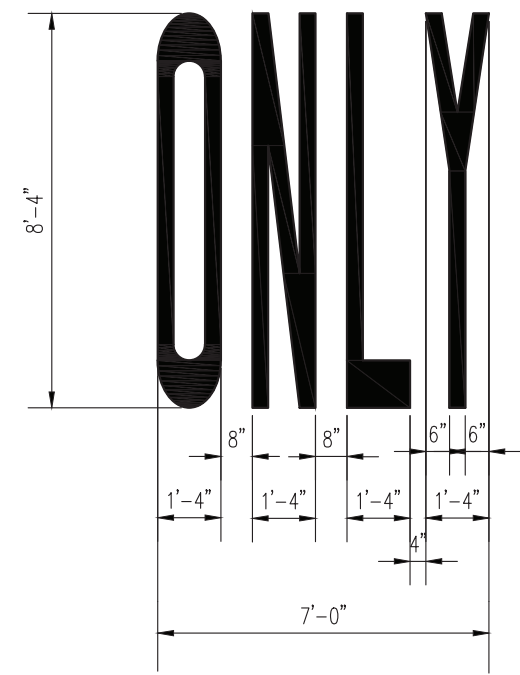

SCODOT STANDARD NOTES:

- 1. ALL PAVEMENT MARKINGS WITHIN SCODOT R/W SHALL BE THERMOPLASTIC AND INSTALLED ACCORDING TO CURRENT SCODOT STANDARDS AND SPECIFICATIONS.
- 2. LANE CLOSURES ARE REQUIRED FOR ALL WORK WITHIN ONE FOOT OF THE TRAVEL WAY. SHOULDER CLOSURES ARE REQUIRED FOR ALL WORK FROM ONE FOOT TO FIFTEEN FEET FROM THE TRAVEL WAY.

SCODOT STANDARD NOTES:

- 1. THERE CAN BE NO WORK PERFORMED IN THE SCODOT R/W BEFORE AN ENCROACHMENT PERMIT HAS BEEN ISSUED AND A PRECONSTRUCTION MEETING HAS BEEN HELD. THE PROPERTY OWNER AND CONTRACTOR MUST SCHEDULE AND ATTEND THE PRECONSTRUCTION MEETING.
 - 2. ANY WORK PERFORMED BEFORE THE PRECONSTRUCTION MEETING WILL HAVE TAKEN PLACE WITHOUT SCODOT KNOWLEDGE, OVERSIGHT, AND CONSENT AND SHALL BE SUBJECT TO REMOVAL BY THE APPLICANT AND/OR AT THE APPLICANT'S EXPENSE.
 - 3. ANY REVISIONS TO THIS APPROVED PLAN SET MUST HAVE PRIOR, WRITTEN APPROVAL FROM SCODOT OR ARE SUBJECT TO REMOVAL AT THE APPLICANT'S EXPENSE.
 - 4. THE CONSTRUCTION ENTRANCE MUST BE ESTABLISHED AT THE LOCATION DESIGNATED IN THIS PLAN SET AND ACCORDING TO SCODOT TYPICAL 815-505-00. NO ADDITIONAL ENTRANCES OR LOCATIONS OTHER THAN SHOWN IN THIS PLAN SET ARE ALLOWED WITHOUT WRITTEN NOTICE FROM SCODOT. APPROVED CONSTRUCTION ENTRANCE SHALL BE INSTALLED PROPERLY AND SHALL BE MAINTAINED AT ALL TIMES. KEEP ROADWAY PROTECTED AND SWIFT OFF AT ALL TIMES. ANY ADDITIONAL, EXISTING DRIVEWAYS OR CONSTRUCTION ENTRANCES, IF ANY, SHALL BE REMOVED FROM SCODOT RIGHT OF WAY AT NO EXPENSE TO SCODOT.
 - 5. NO Dewatering activities shall be performed within SCODOT R/W OR BRING FORTH WATER TO THE SCODOT RIGHT OF WAY BY DIRECT OR INDIRECT METHODS.
 - 6. POST DEVELOPMENT STORMWATER FLOWS TO THE SCODOT R/W CANNOT EXCEED PREDEVELOPMENT FLOW RATES AT ANY TIME FOR ANY REASON.
 - 7. THE APPLICANT IS SOLELY RESPONSIBLE FOR REPAIRS OF ANY AND ALL DAMAGE TO THE TRAVEL WAY DUE TO ANY WORK ALONG THE FRONTAGE OF THIS SITE, AT NO EXPENSE TO SCODOT AND ALL REPAIRS MUST MEET CURRENT SCODOT STANDARDS.
 - 8. ANY DAMAGE TO THE TRAVEL LANE WILL REQUIRE A FULL DEPTH ASPHALT PATCH AND TOTAL ROADWAY (ALL ADJACENT TRAVEL LANES) ASPHALT OVERLAY. PATCHES LARGER THAN A FEW SQUARE FEET OR EXTENDING PAST 1 FOOT INTO THE TRAVEL LANE SHALL REQUIRE AN OVERLAY OF THE ENTIRE WIDTH OF THE EXISTING TRAVEL WAY FOR 50 FEET BEYOND EACH SIDE OF THE FULL DEPTH PATCH. ALL OF THIS WORK WILL BE SOLELY AT THE EXPENSE OF THE APPLICANT AND MUST MEET CURRENT SCODOT STANDARDS.
 - 9. BEFORE INSTALLATION OF ANY NEW DRIVEWAY, THE EXISTING TRAVEL EDGE MUST BE SAW CUT TO PROVIDE A STRAIGHT AND UNIFORM EDGE ALONG THE MOUTH OF THE PROPOSED DRIVEWAY. CARE MUST BE TAKEN TO NOT TO DAMAGE THE EDGE ONCE CUT. ANY DAMAGE TO THE TRAVEL LANE MUST BE REPAIRED AT THE APPLICANT'S EXPENSE.
 - 10. PAVEMENT SECTION IN THE SCODOT R/W SHALL BE, AT A MINIMUM:
 - a. 6 INCHES OF COMPACTED GASC
 - b. 4 INCHES OF COMPACTED TYPE B BINDER COURSE HOT MIX ASPHALT
 - c. 2 INCHES OF COMPACTED TYPE B SURFACE COURSE HOT MIX ASPHALTSEE SCODOT STANDARD SPECIFICATIONS FOR HIGHWAY CONSTRUCTION FOR SURFACE COURSE HOT MIX ASPHALT INSTALLATION TIME AND TEMPERATURE RESTRICTIONS AND THERMO PLASTIC TIME AND TEMPERATURE RESTRICTIONS.
- OR
- d. 8 INCHES OF COMPACTED GASC
 - e. 4 INCHES OF 4,000 PSI CONCRETE
- NO REINFORCEMENT WIRE, REBAR, OR METAL OF ANY KIND IS PERMITTED

NOTE: LANE CLOSURES ARE REQUIRED FOR ALL WORK WITHIN ONE FOOT OF THE TRAVEL WAY. SHOULDER CLOSURES ARE REQUIRED FOR ALL WORK FROM ONE FOOT TO FIFTEEN FEET FROM THE TRAVEL WAY.

NOTE: ALL EXISTING DRIVEWAYS TO BE RESURFACED TO EDGE OF R/W AND TIED IN SMOOTHLY WITH EXISTING DRIVES

- 11. DRIVEWAY LANES SHALL BE A MINIMUM OF 12 FEET IN WIDTH MEASURED FROM EDGE TO EDGE OF ASPHALT.
- 12. DRIVEWAY RADIUS SHALL BE 30 FEET. (UNLESS NOTED OTHERWISE ON THE SCODOT APPROVED PLANS.)
- 13. PAVEMENT MARKINGS SHALL BE THERMOPLASTIC WITH REFLECTIVE BEADS PER SECTION 627 OF THE SCODOT STANDARD SPECIFICATIONS.
 - a. ALL WHITE MARKINGS SHALL BE 125 MIL MINIMUM THICKNESS
 - b. ALL YELLOW MARKINGS SHALL BE 90 MIL MINIMUM THICKNESS
- 14. ALL PERMANENT SIGNAGE SHALL BE INSTALLED ON BREAKAWAY POSTS PER SCODOT STANDARD DRAWING 651-110-00 AND SHALL HAVE A 7 VERTICAL FOOT CLEARANCE FROM THE GROUND TO THE BOTTOM OF THE SIGN.
- 15. DRIVEWAYS SHALL BE CONSTRUCTED TO HAVE A MINIMUM OF A 2 FOOT GRASSSED SHOULDER ON EACH SIDE OF THE DRIVEWAY THREAT.
- 16. DITCH SLOPES SHALL BE NO STEEPER THAN 3H:1V.
- 17. ALL DRIVEWAY CULVERTS SHALL BE INSTALLED AND SEALED ACCORDING TO SCODOT TYPICAL 714-205-01 DETAIL 4 AND 5 WITH AN AASHTO M 315 RUBBER GASKET SEAL, ON PROPER GRADE, TO ALLOW FOR POSITIVE STORM WATER FLOW WITHIN THE PIPE AND TO/FROM ADJACENT PIPES/CROSS LINES.
- 18. ALL CULVERTS INSIDE OF THE SCODOT R/W ARE TO BE INSTALLED WITH BEVELED ENDS PER SCODOT STANDARD DRAWING 719-610-00 AND SEALED PER SCODOT STANDARD DRAWING 714-205-01 AND CANNOT BE COVERED UNTIL AFTER AN INSPECTION BY THE SCODOT INSPECTOR ASSIGNED TO THE PROJECT AT THE REQUIRED SCODOT PRECONSTRUCTION MEETING.
- 19. LANE CLOSURES ARE REQUIRED FOR ALL WORK WITHIN ONE FOOT OF THE TRAVEL WAY. SEE SCODOT LOCAL MAINTENANCE WORK RESTRICTIONS FOR ADDITIONAL INFORMATION.
- 20. SHOULDER CLOSURES ARE REQUIRED FOR ALL WORK IN THE SCODOT R/W BEYOND ONE FOOT FROM THE TRAVEL WAY.
- 21. IT IS THE RESPONSIBILITY OF THE CONTRACTOR TO SCHEDULE ALL REQUIRED INSPECTIONS IN ADVANCE. IF WORK REQUIRING INSPECTION IS PERFORMED WITHOUT PRIOR NOTICE BEING GIVEN TO SCODOT, THAT INSTALLATION SHALL BE SUBJECT TO REMOVAL. AT THE APPLICANT'S EXPENSE. SEVERAL MEANS OF CONTACT WILL BE GIVEN AT THE PRECONSTRUCTION MEETING. FAILURE TO OBTAIN CONTACT IS NOT AN APPROVAL TO PROCEED WITH ANY WORK.
- 22. NO VEGETATION INSTALLED ON PRIVATE PROPERTY SHALL BLOCK THE SCODOT SIGHT TRIANGLES OR SIGHT DISTANCES FOR MOTORISTS INGRESS OR EGRESS FROM APPROVED DRIVEWAYS AND OR ROADWAY INTERSECTIONS. THE PROPERTY OWNER SHALL BE RESPONSIBLE FOR KEEPING OFFSITE LANDSCAPINGS PROPERTY MAINTAINED TO IMPROVE ALL SIGHT DISTANCES. THE PROPERTY OWNER SHALL ALSO BE RESPONSIBLE FOR THE REPAIR OF ANY DAMAGES TO SIDEWALK, DRIVEWAY OR ROADWAY, UTILITY, DRAINAGE OR OTHER STRUCTURES DAMAGED DUE TO THE INSTALLATION OR EXISTENCE OF OFFSITE LANDSCAPING.
- 23. THE DEPARTMENT SHALL NOT BE RESPONSIBLE FOR DAMAGE TO ANY UTILITY STRUCTURES LOCATED WITHIN THE RIGHT-OF-WAY AS A RESULT OF ROUTINE HIGHWAY MAINTENANCE OPERATIONS. THESE STRUCTURES INCLUDE BUT ARE NOT LIMITED TO ARV, METERS, VALVES, MANHOLES, ALL TYPE OF PEDESTALS AND UTILITY LINES (OVERHEAD AND/OR UNDERGROUND). THE APPLICANT SHOULD USE MECHANICAL WORKERS TO CUT AROUND THESE TYPE STRUCTURES TO INCREASE VISIBILITY FOR HIGHWAY MAINTENANCE WORKERS.

NOTE

ALL CULVERTS SHALL BE INSTALLED AND SEALED ACCORDING TO SCODOT TYPICAL 714-201-01 DETAILS 4 AND 5 WITH AN AASHTO M 315 RUBBER GASKET SEAL, ON PROPER GRADE TO ALLOW FOR POSITIVE STORM WATER FLOW WITHIN THE PIPE AND TO/FROM ADJACENT PIPES/CROSS LINES. CULVERTS INSIDE OF THE SCODOT R/W CANNOT BE COVERED UNTIL AFTER AN INSPECTION BY THE SCODOT INSPECTOR ASSIGNED TO THE PROJECT AT THE REQUIRED SCODOT PRECONSTRUCTION MEETING.

ALL HEADWALLS TO USE BEVELED END PIPE WITH RIP RAP PER SCODOT TYPICAL 719-610-00

- 24. APPLICANT IS RESPONSIBLE FOR THE INSTALLATION AND SECURING OF ANY VALVE OR MANHOLE RISERS AS NEEDED.
- 25. THE DEPARTMENT SHALL BE HELD HARMLESS FROM AND AGAINST ANY AND ALL CLAIMS, DAMAGES AND LOSSES ASSOCIATED WITH WORK AS APPROVED UNDER THIS PERMIT APPLICATION. ANY SUCH DAMAGE CLAIMS RECEIVED BY THE DEPARTMENT SHALL BE THE RESPONSIBILITY OF THE APPLICANT TO PROCESS ACCORDINGLY. THE HOLD HARMLESS AGREEMENT SHALL BE FOR THE LIFE OF THE FACILITY, STRUCTURE(S) OR ENCROACHMENT AS IT REMAINS WITHIN PUBLIC RIGHT-OF-WAY.
- 26. APPLICANT IS RESPONSIBLE FOR THE REPAIR OF ANY TRAFFIC SIGNAL LOOPS/WIRES/HEAD/CABINETS IF DAMAGED DUE TO THIS INSTALLATION. ALL WORK SHALL BE APPROVED UNDER THE DIRECTION OF THE SCODOT DISTRICT SIGNAL SHOP AND PERFORMED BY A SCODOT APPROVED SIGNAL CONTRACTOR, AT NO EXPENSE TO THE DEPARTMENT.
- 27. IF REQUIRED UNDER THE APPROVED SCODOT ENCROACHMENT PERMIT, A THIRD PARTY TESTER SHALL BE REQUIRED AT THE APPLICANT'S EXPENSE TO PERFORM COMPACTION ANALYSIS AND WITNESS A PASSING PROOF ROLL ON ALL SUB-GRADE, BASE, AND ASPHALT. ONE THIRD PARTY INSPECTOR SHALL TAKE DENSITY READINGS AT RANDOM STATION NUMBERS. A SECOND (2ND) THIRD PARTY INSPECTOR/TESTER SHALL BE AT THE ASPHALT PLANT TESTING THE ASPHALT AT THE TIME THAT SURFACE ASPHALT IS BEING PRODUED AND PUT DOWN ON THE JOB. ONE CORE SAMPLE (LOCATIONS TO BE DETERMINED) SHALL BE TAKEN AND WEIGHED BY THE THIRD PARTY INSPECTOR. ALL RESULTS TO BE SUBMITTED IN WRITING TO SCODOT FOR REVIEW THE FOLLOWING DAY. WINTER WORK RESTRICTIONS AND HOLIDAY WORK RESTRICTIONS MUST BE ADHERED TO. SEE PERMIT FOR MORE DETAILS.
- 28. AN INSPECTION DATE SHALL BE SET UP IN ADVANCE FOR WHICH THE INSPECTOR WILL COME OUT AND INSPECT THE SIDEWALK FORMS BEFORE POURING CONCRETE. DO NOT LEAVE MORE THAN A 2" DROP OFF UNATTENDED. NO MORE THAN A 2" DROP OFF OR A 3:1 DITCH SLOPE IS PERMITTED ANYWHERE WITHIN THE RIGHT OF WAY DUE TO THE CONSTRUCTION ASSOCIATED WITH THIS SIDEWALK. THE INSTALLATION OF SIDEWALK SHALL BE FLUSH WITH SHOULDER OR HAVE A DRAINAGE INLET BUILT UNDERNEATH TO ALLOW FOR PROPER STORM WATER FLOW. NO WATER SHALL POND IN SHOULDER, ROADWAY, DRIVEWAYS, OR RIGHT OF WAY DUE TO THIS INSTALLATION.
- 29. ADA MATS (RAISED DETECTABLE WARNING PADS) SHALL BE INSTALLED AS NET INSETS AND AT ROADWAY INTERSECTIONS ONLY.
- 30. NO VALVES OR OTHER APPURTENANCES IN ROADWAY ASPHALT, WITHIN 5 FEET OF EDGE OF PAVEMENT, OR WITHIN DITCH LINE OR SWALE LINE. APPLICANT SHALL INSTALL 8-16 FEET OF NEW, UNDEGRADED RCP ON PROPER GRADE, FACING THE PROPER DIRECTION, MATCHING THE DIAMETER OF DRIVEWAY AND/OR CROSS LINE UPSIDE, BUT NOT EXCEEDING THE PIPE DIAMETER DOWNGRADE. THE ABOVE CANNOT BE AVOIDED. INSTALL RIP RAP AROUND ANY EXPOSED PIPES, COVER AND SOO TO MEET SCODOT MINIMUM STANDARDS. CALL SCODOT ENCROACHMENT OFFICE FOR INSPECTION OF PIPE BEFORE COVERING.
- 31. PROPOSED UTILITY INSTALLATION LOCATED IN SHOULDER AREA SHALL HAVE A MINIMUM COVER OF 42" ACCORDING TO FIGURE 6 OF APPENDIX B. ANY EXPOSED ROOTS TO BE REMOVED OR TRIMMED FLUSH WITH SHOULDER/DITCH.

THIRD PARTY TESTING REQUIRED AT THE APPLICANT'S EXPENSE ON SUB-GRADE, BASE, AND ASPHALT. ONE THIRD PARTY INSPECTOR SHALL TAKE DENSITY READINGS AT RANDOM STATION NUMBERS. A THIRD PARTY INSPECTOR/TESTER SHALL BE AT THE ASPHALT PLANT TESTING THE ASPHALT AT THE TIME THAT SURFACE ASPHALT IS BEING PRODUED AND PUT DOWN ON THE JOB. RANDOM CORE SAMPLES SHALL BE TAKEN AND WEIGHED BY THE THIRD PARTY INSPECTOR PER SCODOT DETERMINATION. ALL RESULTS TO BE SUBMITTED IN WRITING TO SCODOT FOR REVIEW THE FOLLOWING DAY.

THIRD PARTY TESTING REQUIRED AT THE APPLICANT'S EXPENSE ON ALL STORM DRAIN PIPING. INSPECTIONS SHALL BE AS DESCRIBED IN SC-M-714 (SUPPLEMENTAL TECHNICAL SPECIFICATION FOR PERMANENT PIPE CULVERTS). SPECIFICALLY PAGES 9-12. ALL RESULTS TO BE SUBMITTED IN WRITING TO SCODOT FOR REVIEW THE FOLLOWING DAY.

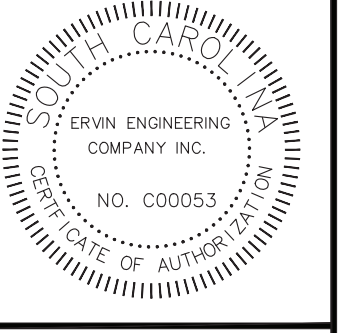
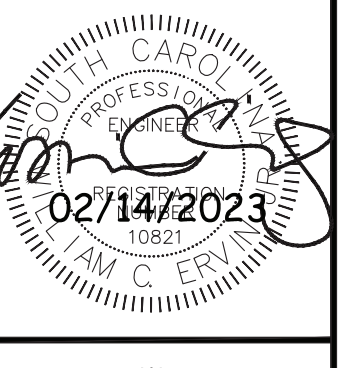

| | |
|------------------|-----------------|
| DRAWN BY: WCE | CHECKED BY: USE |
| DATE: 5-18-2022 | DATE: 5-18-2022 |
| DESIGNED BY: WCE | CHECKED BY: USE |
| DATE: 5-18-2022 | DATE: 5-18-2022 |
| SCALE: NONE | |

WILLIAMSBURG COUNTY SCHOOL DISTRICT
CE MURRAY ELEMENTARY/MIDDLE SCHOOL
VISITOR ACCESS
SOUTH CAROLINA
GREENVILLE

| REV | DATE | REVISION | REVISED PER | OSF | REV | APPROVED | DATE | REVISION | REVISION | DATE | REVISION | REVISION | DATE | REVISION | REVISION |
|-----|------|----------|-------------|-----|-----|----------|------|----------|----------|------|----------|----------|------|----------|----------|
| A | | | | | | | | | | | | | | | |

C7.08