

| STATE | COUNTY | FILE NO. | PROJECT NO. | ROUTE NO. | SHEET NO. |
|-------|----------|----------|-------------|-----------|-----------|
| SC | BEAUFORT | | | SC-170 | 1 |

SHEET INDEX

| SHEET NO. | DESCRIPTION | SHEET TOTALS |
|-----------|----------------------------------|--------------|
| 1 | TITLE SHEET | 1 |
| 2 | SUMMARY OF ESTIMATED QUANTITIES | 1 |
| 3 | TYPICAL SECTION | 1 |
| 3A | DETAIL SHEET | 1 |
| 4 | RIGHT OF WAY DATA SHEET | 1 |
| 5 | GENERAL NOTES | 1 |
| 5A | REFERENCE DATA SHEET | 1 |
| 6 | PLAN SHEET | 1 |
| EC1 | EROSION CONTROL DATA SHEET | 1 |
| D1 | DRAINAGE & EROSION CONTROL SHEET | 1 |
| LL1-LL6 | LIGHTING PLANS | 6 |
| LA1 | LANDSCAPING PLANS | 1 |
| X1-X2 | CROSS SECTIONS | 2 |
| TOTAL | | 19 |

CITY OF BEAUFORT



PLAN AND PROFILE OF SC-170 SIDEWALK EXTENSION

FROM: ROBERT SMALLS PKWY (SC-170)
TO: SPANISH MOSS TRAIL

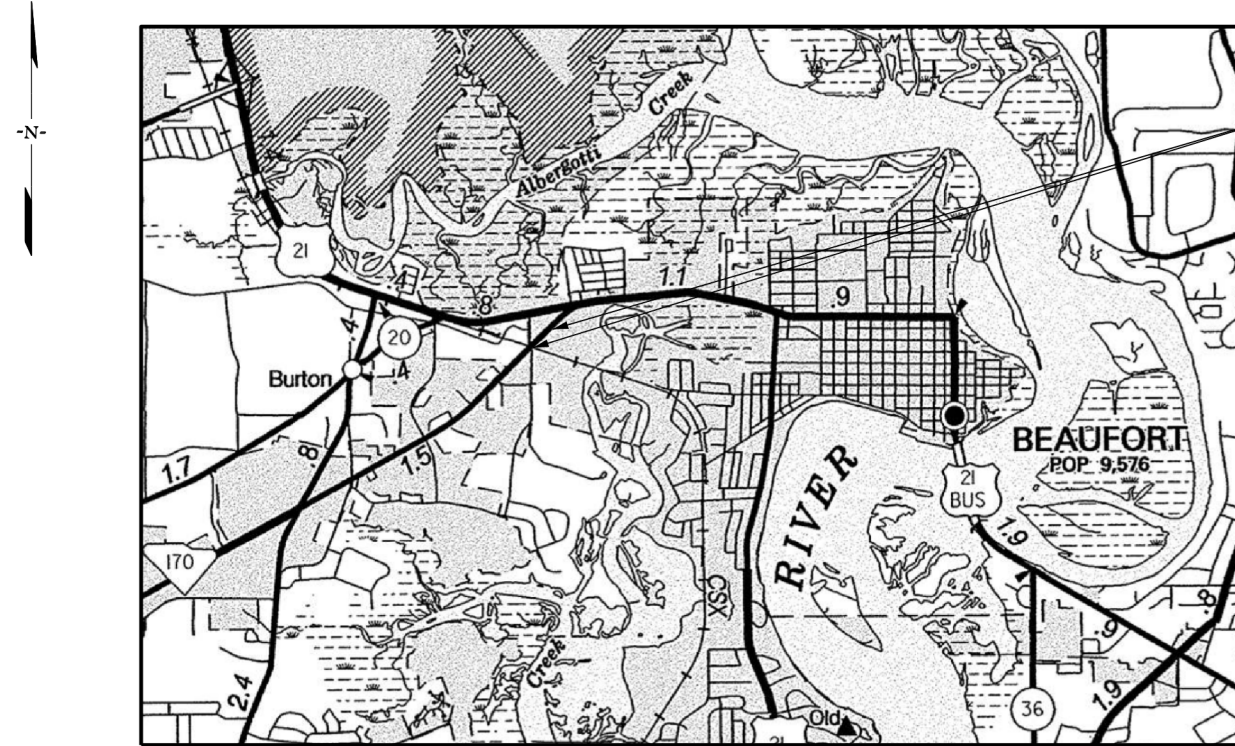

LAYOUT
N.T.S.

ROBERT SMALLS PKWY (SC-170)
BEGIN CONSTRUCTION
STA. 10+33.13
END CONSTRUCTION
STA. 16+26.39

| NPDES PERMIT INFORMATION | |
|---|--------------------|
| Disturbed Area = <u>0.125</u> Acre(s) | |
| Approximate Location of Roadway is | |
| Begin | |
| Latitude | <u>32°26'15" N</u> |
| Longitude | <u>80°42'27" W</u> |
| End | |
| Latitude | <u>32°26'19" N</u> |
| Longitude | <u>80°42'23" W</u> |
| Hydraulic and NPDES Design provided by: | |
| <u>I.C.E.</u> | |
| Designs may be obtained from the SCDOT Regional Production Group | |

THE INITIALS ABOVE DO NOT RELIEVE THE ENGINEER OF RECORD OF THE RESPONSIBILITY TO DESIGN THIS PROJECT IN ACCORDANCE WITH ALL APPLICABLE CRITERIA.

| | SCDOT REVIEW | | RIGHT-OF-WAY | | CONSTRUCTION | |
|--------------------------------------|--------------|------|--------------|------|--------------|------|
| | INITIAL | DATE | INITIAL | DATE | INITIAL | DATE |
| PRECONSTRUCTION SUPPORT - ROAD | | | | | | |
| PRECONSTRUCTION SUPPORT - STRUCTURES | | | | | | |
| RPG - DESIGN MANAGER | | | | | | |
| RPG - PROGRAM MANAGER | | | | | | |

THE INITIALS ABOVE DO NOT RELIEVE THE ENGINEER OF RECORD OF THE RESPONSIBILITY TO DESIGN THIS PROJECT IN ACCORDANCE WITH ALL APPLICABLE CRITERIA.

For Right Of Way Acquisition:

Date

Consultant Engineer of Record

Hydraulic Design Reference for these plans is the:
2009
Edition of SCDOT's "Requirements for Hydraulic Design Studies"

Design Reference for these plans is the:
2011
AASHTO "A Policy on Geometric Design of Highways and Streets"

3 DAYS BEFORE DIGGING IN
SOUTH CAROLINA
CALL 811
SOUTH CAROLINA 811 (SC811)
WWW.SC811.COM
ALL UTILITIES MAY NOT BE A MEMBER OF SC811

RAILROAD INVOLVEMENT?
YES NO

| | SC - 170 | TOTAL (MILES) |
|-------------------------|----------|---------------|
| NET LENGTH OF ROADWAY | 0.11 | 0.11 |
| NET LENGTH OF BRIDGES | - | - |
| NET LENGTH OF PROJECT | 0.11 | 0.11 |
| LENGTH OF EXCEPTIONS | - | - |
| GROSS LENGTH OF PROJECT | 0.11 | 0.11 |

EQUALITIES IN STATIONING:
NONE

NOTE: EXCEPT AS MAY OTHERWISE BE SPECIFIED ON THE PLANS OR IN THE SPECIAL PROVISIONS, ALL MATERIALS AND WORKMANSHIP ON THIS PROJECT SHALL TO CONFORM WITH SOUTH CAROLINA DEPARTMENT OF TRANSPORTATION STANDARD SPECIFICATIONS FOR HIGHWAY CONSTRUCTION (2007 EDITION) AND STANDARD DRAWINGS FOR ROAD CONSTRUCTION IN EFFECT AT THE TIME OF LETTING.

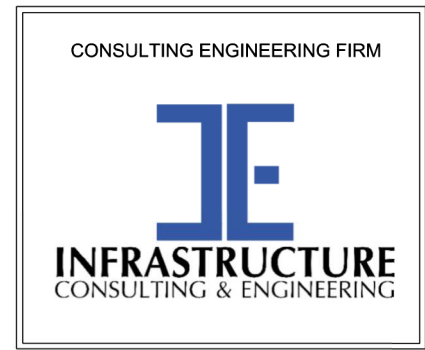

ENGINEER OF RECORD

Digitally signed by
James Hinson
Date: 2023.10.12
14:43:02-0400'
DATE

FOR CONSTRUCTION : _____

SUMMARY OF ESTIMATED QUANTITIES

| PAYITEM | DESCRIPTION | QUANTITY | UNIT |
|---------|---|----------|------|
| 1031000 | MOBILIZATION | 1.00 | LS |
| 1032010 | BONDS AND INSURANCE | 1.00 | LS |
| 1050800 | CONSTRUCTION STAKES, LINES & GRADES | 1.00 | EA |
| 1071000 | TRAFFIC CONTROL | 1.00 | LS |
| 2012000 | CLEARING & GRUBBING WITHIN ROADWAY | 1.00 | LS |
| 2021010 | REMOVAL & DISPOSAL OF EXISTING DROP INLET | 1.00 | EA |
| 2024100 | REMOVAL & DISPOSAL OF EXISTING CURB | 265.00 | LF |
| 2027000 | REMOVAL & DISPOSAL OF EXISTING CONCRETE | 360.00 | SY |
| 2031000 | UNCLASSIFIED EXCAVATION | 20.00 | CY |
| 2033000 | BORROW EXCAVATION | 90.00 | CY |
| 6271015 | 8' WHITE SOLID LINES THERMOPLASTIC - 125 MIL. | 236.00 | LF |
| 6020005 | PERMANENT CONSTRUCTION SIGNS (GROUND MOUNTED) SCHEME D | 100.00 | SF |
| 6651091 | SINGLE DECORATIVE LIGHT POLE WITH SINGLE LIGHT | 4.00 | EA |
| 675027Y | FURNISH & INSTALL 4.0" SCHD 80 PVC CONDUIT(DIRECTION BORED) | 120.00 | LF |
| 6760020 | 2' SCHEDULE 80 PVC CONDUIT | 560.00 | LF |
| 6770319 | #8Cu,1,600V,RHH,RHW,USE | 1760.00 | LF |
| 6800530 | 17X30X28D.ELEC.UNGRD.ENCLOS/HD | 2.00 | EA |
| 6888110 | INSTALL STREET LIGHT LUMINAIRE | 5.00 | EA |
| 7198320 | JUNCTION BOX - CONVERT DROP INLET 24" X 36" | 2.00 | EA |
| 7204100 | CONCRETE SIDEWALK(4" UNIFORM) | 374.00 | SY |
| 7204900 | DETECTABLE WARNING MATERIAL | 50.00 | SF |
| 7209000 | PEDESTRIAN RAMP CONSTRUCTION | 100.00 | SY |
| 8100100 | PERMANENT COVER | 0.08 | ACRE |
| 8100200 | TEMPORARY COVER | 0.08 | ACRE |
| 8104005 | FERTILIZER (NITROGEN) | 8.00 | LB |
| 8104010 | FERTILIZER (PHOSPHORIC ACID) | 8.00 | LB |
| 8104015 | FERTILIZER (POTASH) | 8.00 | LB |
| 8105005 | AGRICULTURAL GRANULAR LIME | 160.00 | LB |
| 8110001 | LANDSCAPING | 1.00 | LS |
| 8151203 | HYDRAULIC EROSION CONTROL PRODUCT (HECP) - TYPE 3 | 0.05 | ACRE |
| 8153000 | SILT FENCE | 510.00 | LF |
| 8153090 | REPLACE/REPAIR SILT FENCE | 51.00 | LF |
| 8154050 | REMOVAL OF SILT RETAINED BY SILT FENCE | 127.50 | LF |

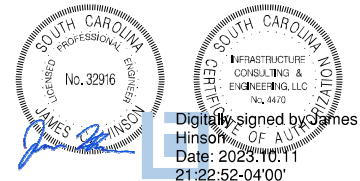

Digitally signed by James Hinson
 Date: 2023.10.11 21:22:52-04'00'

| 4 | | | |
|--------------|-----|-----------------|-------------------------|
| 3 | | | |
| 2 | | | |
| 1 | | | |
| REV. NO. | BY | DATE | DESCRIPTION OF REVISION |
| DESIGNED BY: | TKC | DATE 10/10/2023 | |
| DRAWN BY: | TKC | DATE 10/10/2023 | |
| CHECKED BY: | JCH | DATE 10/10/2023 | |

TYPICAL SECTIONS

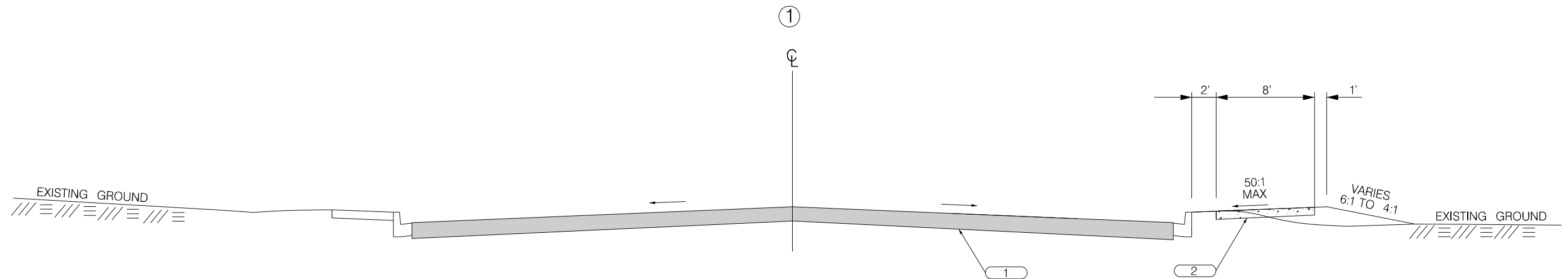

USE THIS SECTION ON
 ROBERT SMALLS PARKWAY (SC-170)
 STA. 10+33.15 TO STA. 16+19.91

| | | |
|---|--|--------------------------------|
| 1 | | EXISTING PAVEMENT - RETAIN |
| 2 | | CONCRETE SIDEWALK (4" UNIFORM) |

| |
|--|
| |
| |
| |
| |
| |
| |
| |
| |

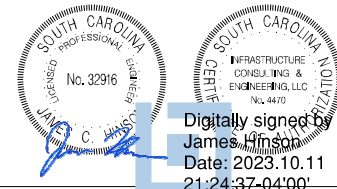

| 4 | | | |
|--------------|-----|------|-------------------------|
| 3 | | | |
| 2 | | | |
| 1 | | | |
| REV. NO. | BY | DATE | DESCRIPTION OF REVISION |
| DESIGNED BY: | TKC | DATE | 10/10/2023 |
| DRAWN BY: | TKC | DATE | 10/10/2023 |
| CHECKED BY: | JCH | DATE | 10/10/2023 |

| | |
|--|--------|
| BEAUFORT COUNTY CITY OF BEAUFORT | |
| ROBERT SMALLS PARKWAY (SC-170) TYPICAL SECTIONS | |
| SHEET 3 | SCALE: |

REFERENCES

NATIONAL DOCUMENTS
 REVISED DRAFT GUIDELINES FOR ACCESSIBLE PUBLIC RIGHTS-OF-WAY NOVEMBER, 2005
 MUTCD 2009

SCDOT DOCUMENTS
 SCDOT TRANSITION PLAN
 QPL 61

RELATED DRAWINGS & KEYWORDS

THIS DRAWING IS ONLY VALID FOR CONSTRUCTION WHEN SEALED AND SIGNED BY A PROFESSIONAL ENGINEER REGISTERED IN THE STATE OF SOUTH CAROLINA. CHECK WWW.SCDOT.ORG FOR LATEST UPDATE.



James W. Kendall
 SIGNATURE
 10/30/2015
 DATE

| # | DATE | CHK | DESCRIPTION |
|---|-------|-----|--------------------|
| 6 | | | |
| 5 | | | |
| 4 | | | |
| 3 | 1/16 | HJC | REM DET 2, GENERAL |
| 2 | 1/15 | JMG | BLEND NOTES |
| 1 | 10/14 | JMG | REMOVED PAY ITEMS |
| 0 | 1/13 | DSO | NEW DRAWING |



STANDARD DRAWING
 PEDESTRIAN RAMP
 CONDENSED
 TERMINAL
 (PARALLEL RAMP)

720-952-11
 EFFECTIVE LETTING DATE: JANUARY 2016

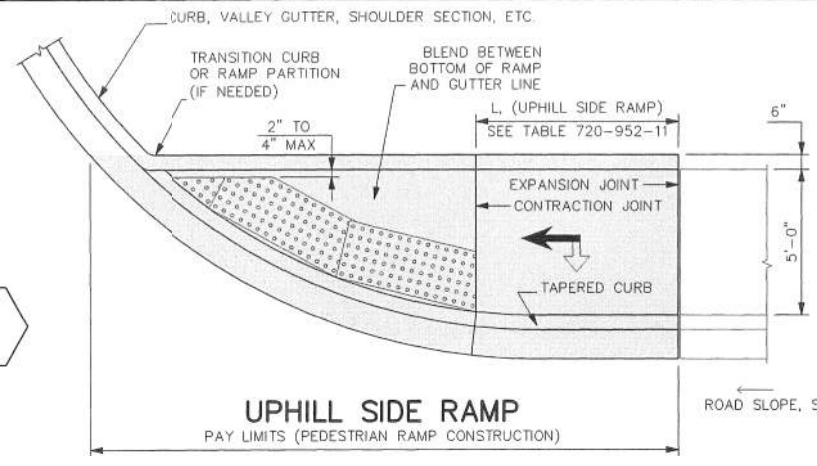
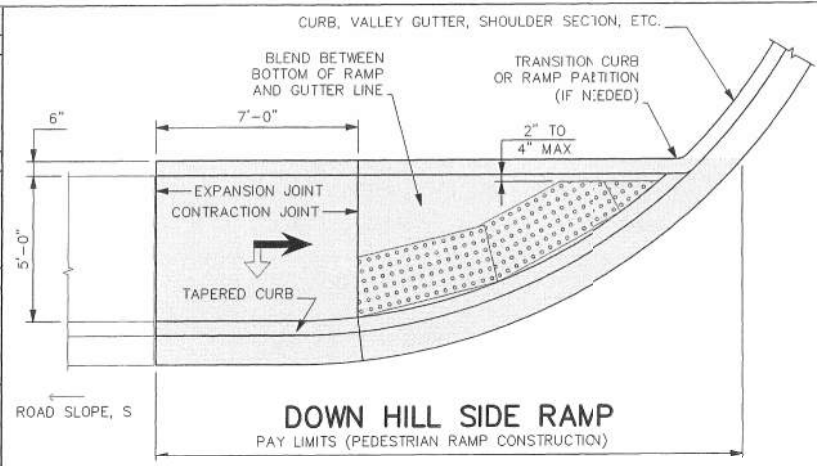

DETAIL 1
 SCALE: 3/16" = 1'-0"
 PLAN
 NO GRASS STRIP
 SEE 720-901-03 FOR SYMBOLS
 SINGLE CROSSWALK

- NOTES:**
- SEE STANDARD DRAWINGS 720-901-XX FOR GENERAL NOTES AND 720-901-03 FOR SYMBOLS.
 - SEE STANDARD DRAWINGS 720-91X-XX FOR INSTALLATION PROCEDURES FOR DETECTABLE WARNING SURFACE MATERIALS.
 - SEE STANDARD DRAWINGS 720-929-XX FOR VARIANTS TO THIS STANDARD.
 - QUANTITIES IN TABLE 720-952-11 ASSUME THAT DOWN HILL SIDE RAMP IS ALWAYS AT LEAST 7'-0" LONG.
 - CONSTRUCT RAMP PARTITION AT ALL LOCATIONS WHERE ROADWAY DRAINAGE COULD DISCHARGE ONTO ADJACENT PROPERTY. CONSTRUCT RAMP PARTITION IF NEEDED TO RETAIN EXISTING GROUND ELEVATION ON ADJACENT PROPERTY.

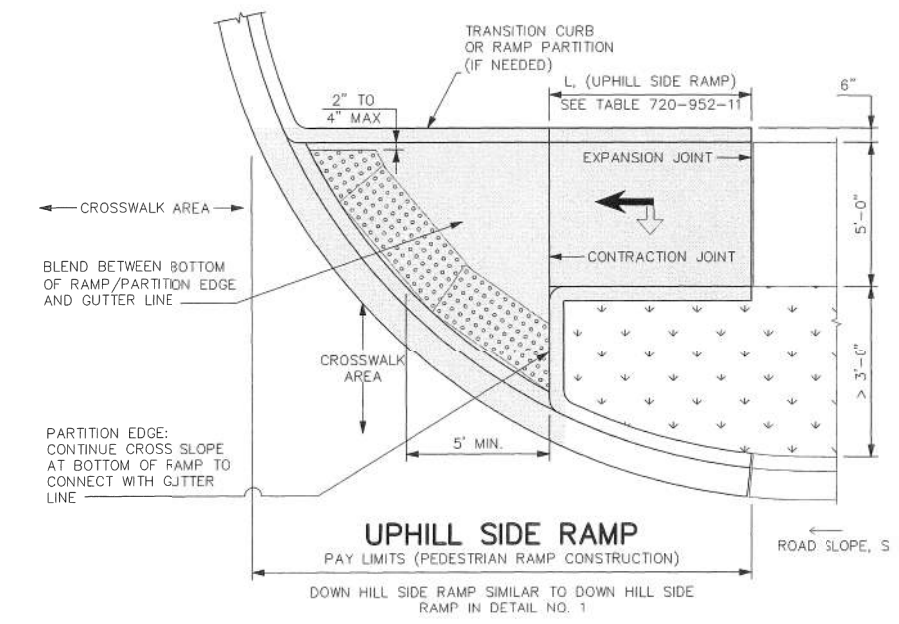

DETAIL 2
 SCALE: 3/16" = 1'-0"
 PLAN
 > 3'-0" GRASS STRIP
 SEE 720-901-03 FOR SYMBOLS
 CONSIDER USING PERPENDICULAR RAMP TO CROSS MAIN LINE
 DUAL CROSSWALK

TABLE: 720-952-11 (SEE 720-929-01, X=10')

| ROAD SLOPE, S (%) | L, (UPHILL SIDE RAMP), [FT] |
|-------------------|-----------------------------|
| S ≤ 1% | 7'-0" |
| 1% > S ≤ 3% | 10'-0" |
| S > 3% | 15'-0" |

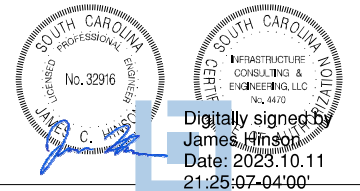

| 4 | | | | |
|--------------|-----|------|-------------------------|--|
| 3 | | | | |
| 2 | | | | |
| 1 | | | | |
| REV. NO. | BY | DATE | DESCRIPTION OF REVISION | |
| DESIGNED BY: | TKC | DATE | 10/10/2023 | |
| DRAWN BY: | TKC | DATE | 10/10/2023 | |
| CHECKED BY: | JCH | DATE | 10/10/2023 | |

BEAUFORT COUNTY
 CITY OF BEAUFORT

ROBERT SMALLS PKWY (SC-170)
 DETAIL SHEET

SHEET 3A SCALE: NTS

| STATE | COUNTY | FILE NO. | PROJECT NO. | ROUTE NO. | SHEET NO. |
|-------|----------|----------|-------------|-----------|-----------|
| SC | BEAUFORT | | | SC-170 | 5 |

GENERAL NOTES

GENERAL CONSTRUCTION NOTES:

THE CITY ENGINEER MUST SPECIFICALLY AUTHORIZE CHANGES INVOLVING INCREASED COST OF THE PROJECT OR CHANGES IN ALIGNMENT.

WATER VALVES, GAS VALVES, AND SEWER MANHOLES SHALL BE ADJUSTED BY THE CONTRACTOR (RAISED OR LOWERED) TO MATCH THE SIDEWALK PROFILE AND SHALL NOT BE PARTIALLY LOCATED WITHIN THE SIDEWALK. NO ADDITIONAL PAYMENT WILL BE MADE FOR ADJUSTING THESE VALVES OR MANHOLES. THIS WORK SHALL BE CONSIDERED INCIDENTAL IN THE UNIT COST OF CLEARING AND GRUBBING AND SHALL INCLUDE ALL WORKMANSHIP AND MATERIALS NECESSARY TO COMPLETE THIS ITEM.

THE LOCATIONS OF EXISTING UTILITIES SHOWN ON THE PLANS HAVE BEEN DETERMINED FROM AVAILABLE INFORMATION AND ARE PROVIDED FOR THE CONVENIENCE OF THE CONTRACTOR. THE ENGINEER ASSUMES NO RESPONSIBILITY FOR THE ACCURACY OR COMPLETENESS OF THE UTILITIES INFORMATION SHOWN ON THE DRAWINGS. IT IS THEREFORE THE CONTRACTOR'S RESPONSIBILITY TO CONFIRM THAT THE PROPER COORDINATION WITH THE VARIOUS UTILITY OWNERS HAS BEEN PERFORMED.

THE CONTRACTOR SHALL COOPERATE WITH THE UTILITY OWNERS DURING RELOCATION OPERATIONS. THE CONTRACTOR SHALL EXERCISE CAUTION WHEN CROSSING AN UNDERGROUND UTILITY WHETHER SHOWN ON THE DRAWINGS OR LOCATED BY THE UTILITY COMPANY. COST OF DAMAGES TO ANY UTILITIES AS A RESULT OF CONSTRUCTION SHALL BE THE RESPONSIBILITY OF THE CONTRACTOR.

ALL WORKMANSHIP AND MATERIALS USED ON THIS PROJECT SHALL CONFORM TO THE SCDOT STANDARD SPECIFICATIONS FOR HIGHWAY CONSTRUCTION (2007 EDITION), SCDOT 2007 SUPPLEMENTAL SPECIFICATIONS, SCDOT SUPPLEMENTAL TECHNICAL SPECIFICATIONS IN EFFECT AT THE TIME OF LETTING, AND SCDOT 2009 STANDARD DRAWINGS EXCEPT WHERE OTHERWISE NOTED IN THE PLANS.

ALL EXISTING ROAD SIGNS AFFECTED BY CONSTRUCTION ACTIVITIES SHALL BE RETAINED, RELOCATED, OR REMOVED AS DIRECTED BY ENGINEER. PAYMENT FOR THIS WORK SHALL BE INCLUDED IN THE LUMP SUM COST FOR CLEARING AND GRUBBING.

ALL NEW SIGNS SHALL BE PLACED IN ACCORDANCE WITH THE MANUAL ON UNIFORM TRAFFIC CONTROL DEVICES AND SCDOT STANDARD DRAWINGS, NEW 2P & 3P SIGN SUPPORTS REQUIRED FOR RELOCATED SIGNS WILL BE PAID PER LINEAR FOOT INSTALLED AND ACCEPTED.

THE CONTRACTOR SHALL FURNISH, INSTALL, AND MAINTAIN ALL NECESSARY PROVISIONS FOR TRAFFIC CONTROL FOR THE DURATION OF THE PROJECT. THESE PROVISIONS, AS IN EACH CASE IS APPLICABLE, WILL CONFORM TO THE REQUIREMENTS CONTAINED IN THE SCDOT STANDARD SPECIFICATIONS, STANDARD DRAWINGS, SUPPLEMENTAL SPECIFICATIONS, SPECIAL PROVISIONS, THE FEDERAL HIGHWAY ADMINISTRATION MANUAL ON UNIFORM TRAFFIC CONTROL DEVICES, AND AS DIRECTED BY THE ENGINEER. THE CONTRACTOR SHALL SUBMIT THE TRAFFIC CONTROL PLAN TO THE COUNTY FOR APPROVAL BEFORE BEGINNING CONSTRUCTION.

THE LUMP SUM COST FOR TRAFFIC CONTROL SHALL INCLUDE ALL WORK AS DIRECTED ABOVE. THIS LUMP SUM COST SHALL INCLUDE TEMPORARY CONSTRUCTION SIGNS, BARRICADES, DRUMS, CONES, LIGHTS, AND OTHER ITEMS AS REQUIRED TO COMPLETE THIS WORK.

CONTRACTOR SHALL REFER TO SCDOT STD. DWG. 605-010-02 FOR PLACEMENT OF PERMANENT CONSTRUCTION SIGNS. THIS PROJECT REQUIRES ONE (1) SCHEME C AND ONE (1) SCHEME E. SIGNS SHALL BE PAID FOR PER SQUARE FOOT INSTALLED AND ACCEPTED UNDER THE BID ITEM FOR PERMANENT CONSTRUCTION SIGNS.

NARRATIVE DESCRIPTION:

THE STORMWATER MANAGEMENT FOR THESE SIDEWALK IMPROVEMENTS INCLUDE MAINTAINING THE EXISTING STORM DRAINAGE COLLECTION AND CONVEYANCE SYSTEM DESIGNED TO ACCEPT STORM WATER RUNOFF FROM THE ROADWAY AND ADJACENT PROPERTIES ON A NETWORK OF INLETS AND CATCH BASINS AND CONVEY IT IN A CLOSED PIPE SYSTEM AND DISCHARGE IT INTO A MAINTAINED OUTFALL DITCH PERPENDICULAR TO SC-170.

THE TOPOGRAPHY OF THE SITE IS VERY FLAT AND PRIMARILY COMMERCIAL DEVELOPMENT WITH GRASSY LANDSCAPED AREAS. THIS PROJECT WILL NOT AFFECT THE EXISTING BUILDINGS BUT WILL ENCROACH ON THE LANDSCAPING. WEB SOIL SURVEY WAS USED TO DETERMINE THE SOIL CONDITIONS AT THIS SITE. THE SOILS ARE PREDOMINANTLY SANDY SOILS.

THE SEDIMENT CONTROL PLAN INCLUDES FOLLOWING THE EROSION CONTROL NOTES AND SEQUENCE OF CONSTRUCTION BY PLACING SILT FENCE AROUND THE PERIMETER, AND BY PLACING A COMBINATION OF TYPE A AND TYPE F INLET TUBES AT ADJACENT INLETS.

ALL ITEMS IN SECTION 10D OF THE CURRENT ARMS MANUAL FOR BOTH CONSTRUCTION AND POST CONSTRUCTION DESIGN HAVE BEEN STUDIED AND ADDRESSED. ALL NECESSARY BMPS HAVE BEEN IMPLEMENTED FOR BOTH PHASES (CONSTRUCTION AND POST CONSTRUCTION) TO AVOID NEGATIVELY IMPACTING IMPAIRED WATERS OF THE SCDOT SYSTEM AND/OR ITS DISCHARGES.

SEQUENCE OF CONSTRUCTION

1. OBTAIN NPDES COVERAGE FROM DHEC AND FINAL MS4 APPROVAL FROM THE CITY OF BEAUFORT DEPARTMENT OF PUBLIC WORKS.
2. NOTIFY SC DHEC REGIONAL OFFICE AND THE CITY OF BEAUFORT DEPARTMENT OF PUBLIC WORKS 48 HOURS PRIOR TO ANY LAND DISTURBING ACTIVITIES.
3. INSTALL TREE PROTECTION AND DELINEATE CLEARING LIMITS.
4. CLEARING & GRUBBING ONLY AS NECESSARY FOR INSTALLATION OF PERIMETER CONTROLS (E.G. SILT FENCE).
5. INSTALL PERIMETER CONTROLS (E.G. SILT FENCE).
6. PROVIDE SITE DRAINAGE WITH DIVERSION DITCHES, SWALES AND DRAINS.
7. CLEARING AND GRUBBING OF SITE (SEDIMENT & EROSION CONTROL MEASURES FOR THESE AREAS MUST ALREADY BE INSTALLED).
8. STRIP TOP SOIL AND STOCKPILE FOR LATER USE ON SHOULDERS AND SLOPES PER SECTION 209 OF THE STANDARD SPECIFICATIONS. "ALL DISTURBED AREA [ANY AREA OF LAND THAT WILL BE DISTURBED DURING CONSTRUCTION, THAT INCLUDES CLEARING, GRUBBING, STOCK PILING AND INSTALLATION OF ANY BMPS (SILT FENCE, SWALES, CHECK DAMS, ETC)] MUST BE INCLUDED WITHIN THE LIMITS OF DISTURBANCE."
9. ROUGH GRADING.
10. INSTALL STORM DRAINAGE.
11. FINE GRADING.
12. CONSTRUCT CURB & GUTTER.
13. ASPHALT PAVING.
14. CONSTRUCT SIDEWALK.
15. FINISH GRADING AND FINAL GRASSING AND LANDSCAPING.
16. MAINTAIN ALL SEDIMENT AND EROSION CONTROL DEVICES FOR THE EXTENT OF THE PROJECT.
17. REMOVAL OF SEDIMENT CONTROLS AFTER SITE HAS BEEN STABILIZED.
18. CONTACT THE BEAUFORT COUNTY CAPITAL PROJECTS DIRECTOR FOR FINAL PROJECT INSPECTION.
19. FILE NOTICE OF TERMINATION.

IE INFRASTRUCTURE
CONSULTING & ENGINEERING

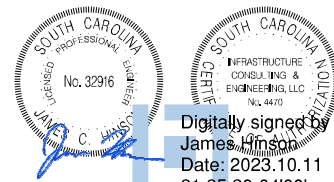

Digitally signed by
James Hinson
Date: 2023.10.11
21:25:20-04'00'

| 4 | | | |
|--------------|-----|-----------------|-------------------------|
| 3 | | | |
| 2 | | | |
| 1 | | | |
| REV. NO. | BY | DATE | DESCRIPTION OF REVISION |
| DESIGNED BY: | TKC | DATE 10/10/2023 | |
| DRAWN BY: | TKC | DATE 10/10/2023 | |
| CHECKED BY: | JCH | DATE 10/10/2023 | |

BEAUFORT COUNTY
CITY OF BEAUFORT

ROBERT SMALLS PKWY (SC-170)
GENERAL CONSTRUCTION NOTES

SHEET 5

SCALE:

| STATE | COUNTY | FILE NO. | PROJECT NO. | ROUTE NO. | SHEET NO. |
|-------|----------|----------|-------------|-----------|-----------|
| SC | BEAUFORT | | | SC-170 | 5A |

| GENERAL INFORMATION | |
|------------------------|--|
| CONTROL SURVEY SUMMARY | |
| VERTICAL | - NORTH AMERICAN VERTICAL DATUM 1988 (NAVD 88) |
| HORIZONTAL | - NORTH AMERICAN DATUM 1983 (NAD 83) |
| COORDINATES | - SOUTH CAROLINA STATE PLANE COORDINATE SYSTEM |

| ALIGNMENT CONTROL POINTS | | |
|--------------------------|--------------|---------------|
| CONTROL | NORTHING (Y) | EASTING (X) |
| PI = 10+00.00 | 220,006.826 | 2,090,194.824 |
| PI = 16+00.00 | 220,428.124 | 2,090,622.033 |

| SURVEY CONTROL POINTS | | | | |
|-----------------------|--------------|---------------|-----------|------------------------------|
| CONTROL | NORTHING (Y) | EASTING (X) | ELEVATION | DESCRIPTION |
| BM 1 | 220,288.1904 | 2,090,426.214 | 15.117 | X ON CROSS WALK CONC PAD VRS |
| BM 2 | 220,502.5017 | 2,090,588.869 | 15.977 | RR SPIKE IN 1" OAK |
| BM 3 | 220,011.5551 | 2,090,152.624 | 14.337 | X IN TOP OF CONC CURB |

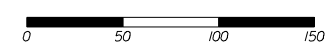
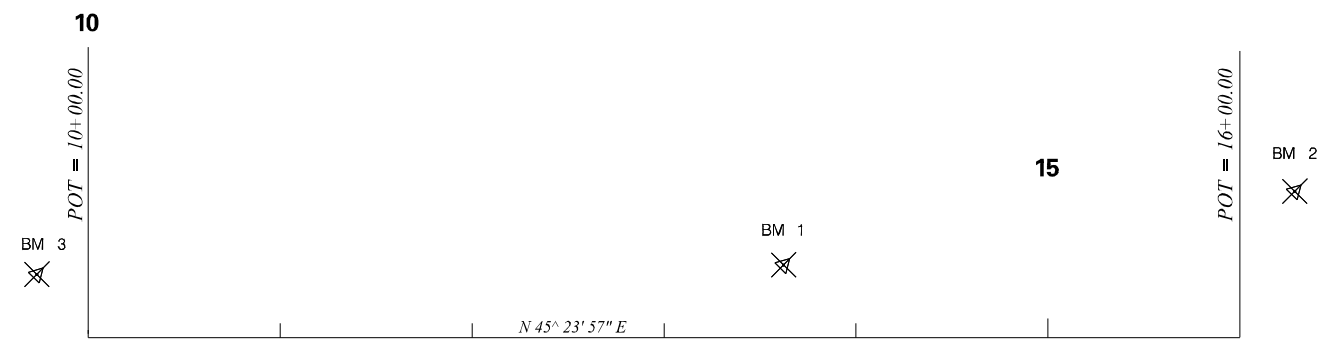
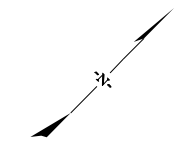

IE INFRASTRUCTURE
CONSULTING & ENGINEERING

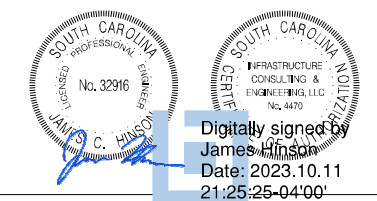

Digitally signed by
James Hinson
Date: 2023.10.11
21:25:25-04:00'

| 4 | | | |
|--------------|-----|-----------------|-------------------------|
| 3 | | | |
| 2 | | | |
| 1 | | | |
| REV. NO. | BY | DATE | DESCRIPTION OF REVISION |
| DESIGNED BY: | TKC | DATE 10/10/2023 | |
| DRAWN BY: | TKC | DATE 10/10/2023 | |
| CHECKED BY: | JCH | DATE 10/10/2023 | |

BEAUFORT COUNTY
CITY OF BEAUFORT

ROBERT SMALLS PKWY (SC-170)
REFERENCE DATA SHEET

SHEET 5A SCALE: 1" = 50'

| STATE | COUNTY | FILE NO. | PROJECT NO. | ROUTE NO. | SHEET NO. |
|-------|----------|----------|-------------|-----------|-----------|
| SC | BEAUFORT | | | SC-170 | 6 |

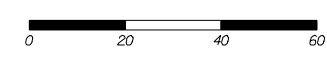
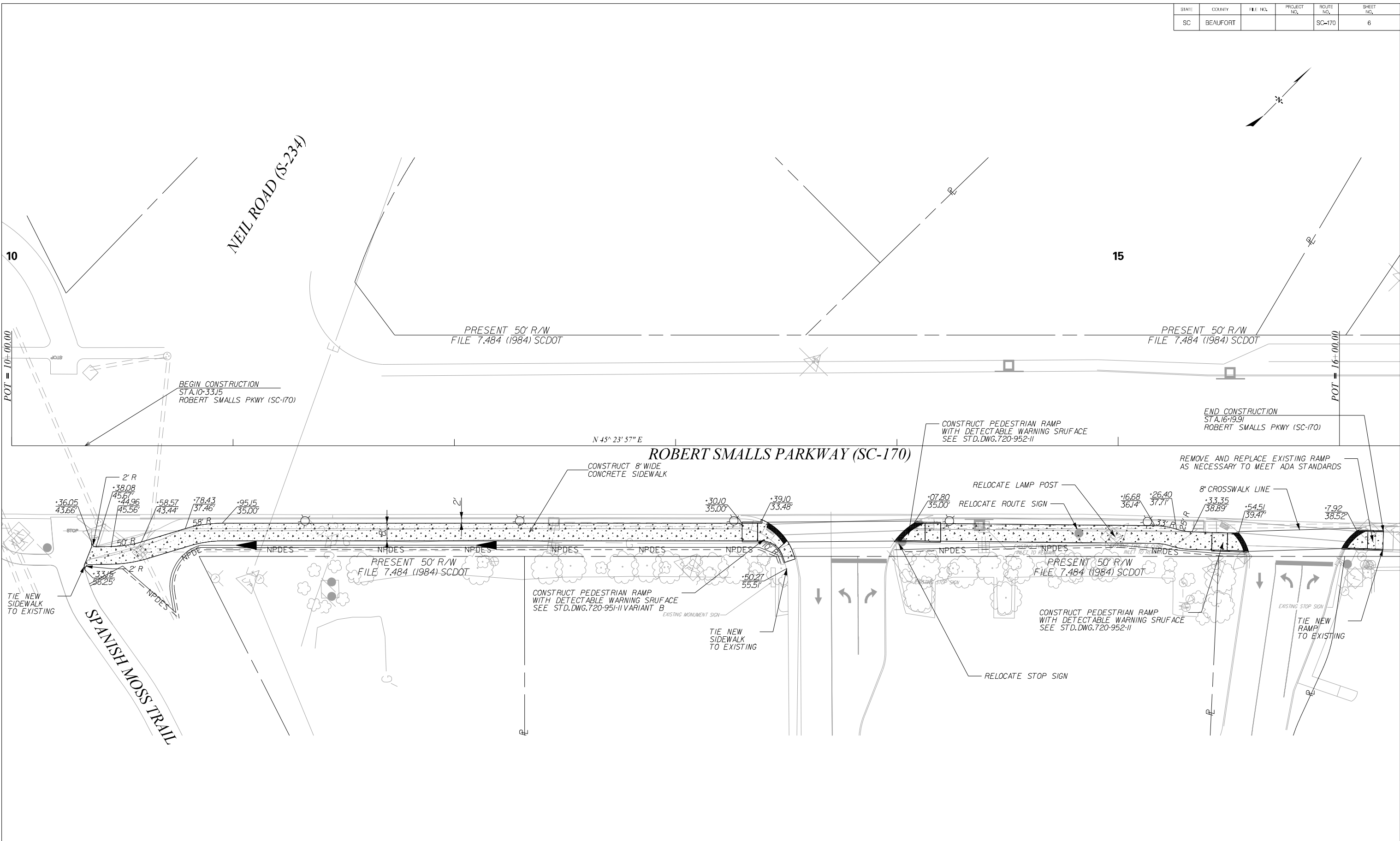

IE INFRASTRUCTURE
CONSULTING & ENGINEERING

Digitally signed by James C. Hinson
Date: 2023.10.11 21:25:29-04'00'

(Professional Engineer Seal: SOUTH CAROLINA PROFESSIONAL ENGINEER No. 32916)

(Professional Engineer Seal: SOUTH CAROLINA PROFESSIONAL ENGINEER No. 4470)

| 4 | | | |
|--------------|-----|-----------------|-------------------------|
| 3 | | | |
| 2 | | | |
| 1 | | | |
| REV. NO. | BY | DATE | DESCRIPTION OF REVISION |
| DESIGNED BY: | TKC | DATE 10/10/2023 | |
| DRAWN BY: | TKC | DATE 10/10/2023 | |
| CHECKED BY: | JCH | DATE 10/10/2023 | |

BEAUFORT COUNTY
CITY OF BEAUFORT

ROBERT SMALLS PKWY (SC-170)
PLAN SHEET

SHEET 6 SCALE: 1" = 20'

| STATE | COUNTY | FILE NO. | PROJECT NO. | ROUTE NO. | SHEET NO. |
|-------|----------|----------|-------------|-----------|-----------|
| SC | BEAUFORT | | | SC-170 | D1 |

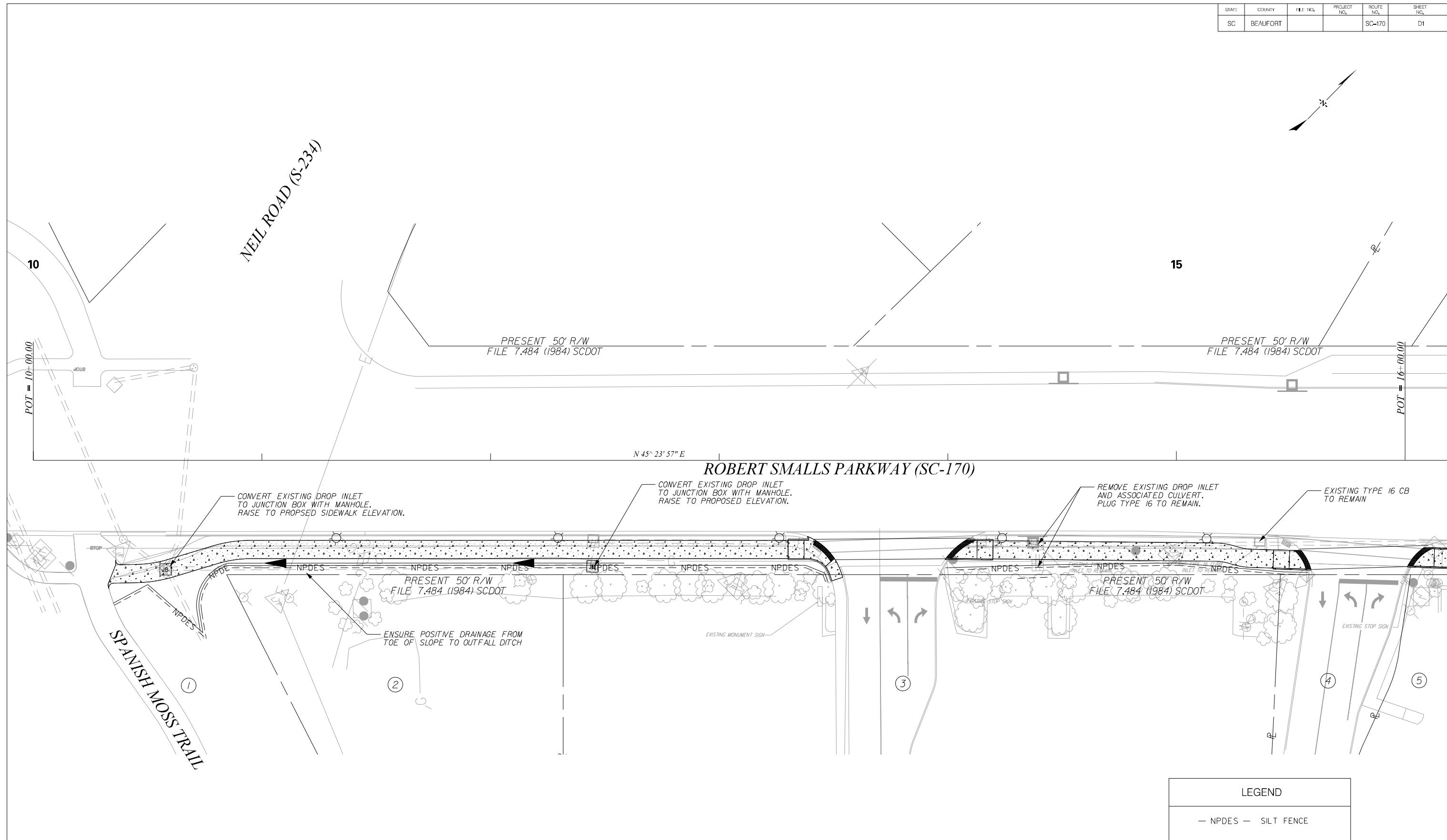
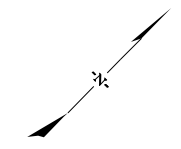

| LEGEND | |
|-----------|------------|
| — NPDES — | SILT FENCE |

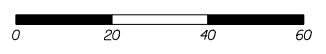

IE INFRASTRUCTURE
CONSULTING & ENGINEERING

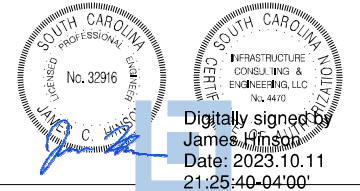

| 4 | | | |
|--------------|-----|-----------------|-------------------------|
| 3 | | | |
| 2 | | | |
| 1 | | | |
| REV. NO. | BY | DATE | DESCRIPTION OF REVISION |
| DESIGNED BY: | TKC | DATE 10/10/2023 | |
| DRAWN BY: | TKC | DATE 10/10/2023 | |
| CHECKED BY: | JCH | DATE 10/10/2023 | |

| | |
|---|-----------------|
| BEAUFORT COUNTY CITY OF BEAUFORT | |
| ROBERT SMALLS PKWY (SC-170) DRAINAGE & EROSION CONTROL | |
| SHEET D1 | SCALE: 1" = 20' |

| STATE | COUNTY | FILE NO. | PROJECT NO. | ROUTE NO. | SHEET NO. |
|-------|----------|----------|-------------|-----------|-----------|
| SC | BEAUFORT | | | SC-170 | LL1 |







NOTES:

1. ALL WORK AND MATERIALS SHALL BE DONE IN ACCORDANCE WITH THE 2007 SOUTH CAROLINA DOT STANDARD SPECIFICATIONS FOR HIGHWAY CONSTRUCTION, SCDOT SUPPLEMENTAL SPECIFICATIONS – ROADWAY LIGHTING, NATIONAL ELECTRICAL CODE AND NATIONAL ELECTRIC SAFETY CODE.
2. CONTACT TERRANCE HARRIS WITH DOMINION ENERGY FOR SERVICE POINT COORDINATION: TERRANCE.HARRIS@DOMINIONENERGY.COM: (843) 592-6728.
3. CONTRACTOR SHALL BE AWARE OF OVERHEAD POWER LINES DURING CONSTRUCTION.
4. CONDUIT ACCESSORIES SUCH AS EXPANSION JOINTS, ELBOWS, LB'S, FLEXIBLE CONDUIT, ETC SHALL BE INCLUDED IN THE PRICE BID FOR CONDUIT.
5. LUMINAIRE MANUFACTURER SHALL PROVIDE A TEN YEAR WRITTEN WARRANTY FOR PARTS AND DEFECTIVE WORKMANSHIP ON LUMINAIRES.
6. ALL PITS USED FOR INSTALLED PUSHED (JACKED) CASINGS UNDER EXISTING ROADWAYS SHALL HAVE A MINIMUM OF FIVE FEET BETWEEN EDGE OF SHOULDER. LOCATIONS AS SHOWN ARE APPROXIMATE AND MAY BE SHIFTED AS NECESSARY TO MEET CLEARANCE REQUIREMENTS. CONTRACTOR SHALL FOLLOW MUTCD, SCDOT STANDARD DRAWINGS, AND SCDOT REQUIREMENTS FOR ALL TRAFFIC CONTROL RELATED WORK.
7. ALL ELECTRICAL CONNECTIONS SHALL BE MADE ABOVE GRADE INSIDE POLE BASES OR JUNCTION BOXES. NO UNDERGROUND SPLICING ALLOWED.
8. CONTRACTOR SHALL VERIFY THE LOCATION OF ALL UTILITIES PRIOR TO INSTALLATION. ANY DAMAGE TO EXISTING UTILITIES SHALL BE REPAIRED BY THE CONTRACTOR AT NO ADDITIONAL COST.
9. THE CONTRACTOR SHALL PROVIDE THE SERVICE POLE UNLESS OTHERWISE NOTED. THE SERVICE RISER AND LATERAL, WEATHERHEAD, WATERPROOF ENCLOSURES, CIRCUIT BREAKERS, LIGHTNING ARRESTER, AND THE NECESSARY WIRING FOR CONNECTING TO THE POWER SOURCE, SHALL BE INCLUDED UNDER THE "ELECTRICAL SERVICE CONNECTIONS" PAY ITEM.



POLE DATA TABLE

| Pole | Sta. No. | Offset | Center / Base Line | Sheet No. | Fixture Mounting Height | No. of Lum's | Arm Length | Circuit | Installation Notes |
|------|----------|-----------|--------------------|-----------|-------------------------|--------------|------------|----------|----------------------|
| P1 | 11+32.32 | 33.97' RT | ROBERT SMALLS PKWY | LL2 | 16' | 1 | N/A | EXISTING | |
| P2 | 12+29.53 | 33.96' RT | ROBERT SMALLS PKWY | LL2 | 16' | 1 | N/A | EXISTING | |
| P3 | 13+26.31 | 33.93' RT | ROBERT SMALLS PKWY | LL2 | 16' | 1 | N/A | EXISTING | |
| P4 | 14+23.75 | 33.97' RT | ROBERT SMALLS PKWY | LL2 | 16' | 1 | N/A | EXISTING | |
| P5 | 15+13.21 | 34.32' RT | ROBERT SMALLS PKWY | LL2 | EXISTING | 1 | N/A | EXISTING | RELOCATED LIGHT POLE |

LEGEND:

-  PROPOSED DECORATIVE POLE, 14' POLE, 16' MOUNTING HEIGHT. WITH LED LUMINAIRE. LUMINAIRES SHALL BE (OR APPROVED EQUAL) - HOLOPHANE MDLE2 P40 40K AS 3 BK RBK CH FBK PR12 (7280 LUMENS, 77 W, 4000K) POLE SHALL BE (OR APPROVED EQUAL) - HOLOPHANE CHA14F4J16P07ABGBK CH16 BRKWAY KIT FGIUS BK
-  RELOCATED LIGHT POLE
-  EXIST LIGHT POLE TO REMAIN
-  EXIST LIGHT POLE TO BE RELOCATED
-  PROPOSED PULL BOX. SEE CONSTRUCTION DETAILS ON SHEET LL6.
-  DIRECTIONAL BORE, SIZE AND TYPE AS SHOWN.

CONDUIT AND CABLE SCHEDULE

-  2" SCH 80 PVC CONDUIT WITH 2 #8 AND 1 #8 GND, INSTALLED IN TRENCH.
-  2" SCH 80 PVC CONDUIT WITH 2 #8 AND 1 #8 GND, PULLED IN 4" CASING (STEEL OR HDPE), DIRECTIONALLY BORED.

| ELECTRICAL ITEMS | | | |
|------------------|---------------------------------|------|----|
| 6651091 | SINGLE DECORATIVE LIGHT POLE | 4 | EA |
| 6888110 | INSTALL STREET LIGHT LUMINAIRE | 5 | EA |
| 675027Y | 4.0"SC-HED80 PVC COND-DIR.BORED | 120 | LF |
| 6760020 | 2.0" SCHEDULE 80 PVC CONDUIT | 560 | LF |
| 6770319 | #8Cu, 1,600V, RHH, RHW, USE | 1760 | LF |
| 6800530 | 17X30X28D.ELEC.UNGRD.ENCLOS/HD | 2 | EA |

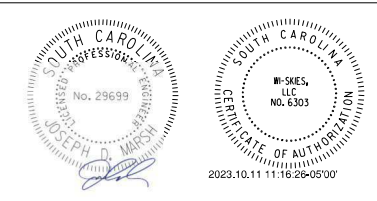

| 4 | | | |
|--------------|----|------|-------------------------|
| 3 | | | |
| 2 | | | |
| 1 | | | |
| REV. NO. | BY | DATE | DESCRIPTION OF REVISION |
| DESIGNED BY: | | DATE | |
| DRAWN BY: | | DATE | |
| CHECKED BY: | | DATE | |

BEAUFORT COUNTY
CITY OF BEAUFORT

ROBERT SMALLS PKWY (SC-170)
LIGHTING PLAN SHEET

SHEET LL1 NO SCALE

| STATE | COUNTY | FILE NO. | PROJECT NO. | ROUTE NO. | SHEET NO. |
|-------|----------|----------|-------------|-----------|-----------|
| SC | BEAUFORT | | | SC-170 | LL2 |

15

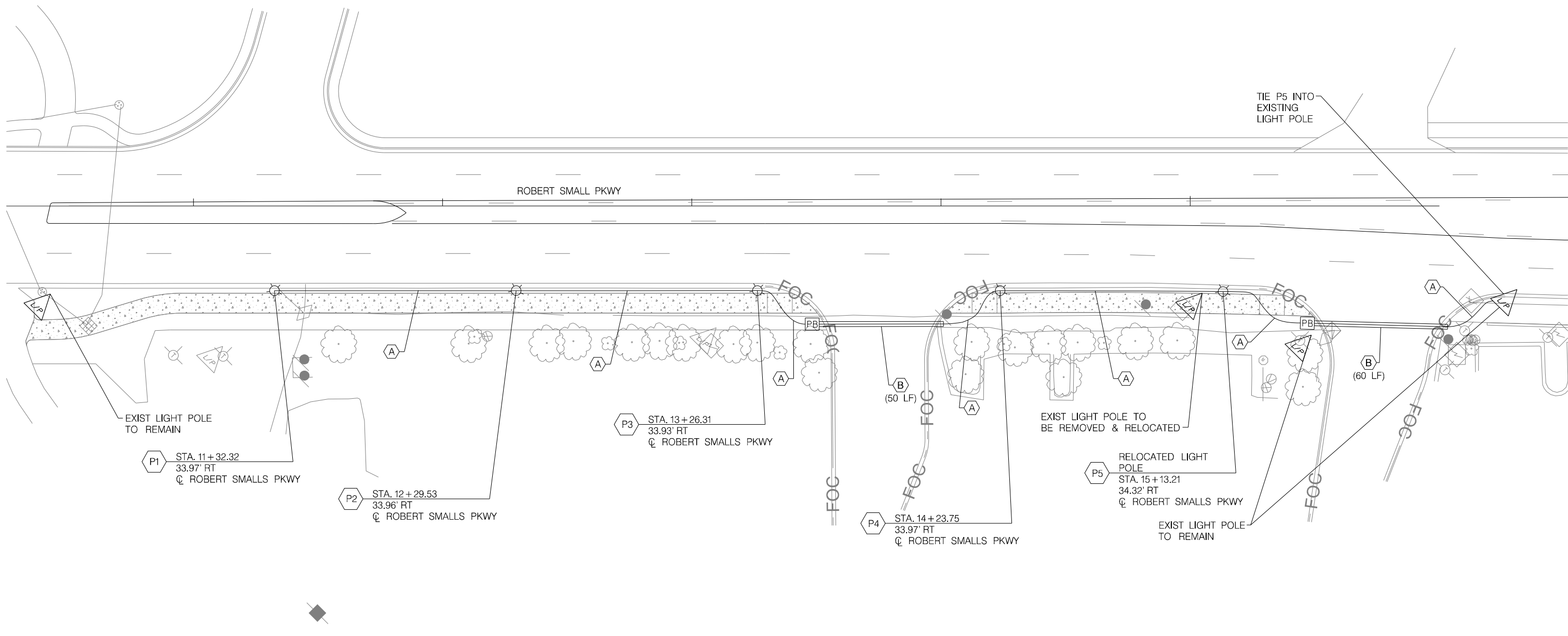

JE INFRASTRUCTURE
CONSULTING & ENGINEERING

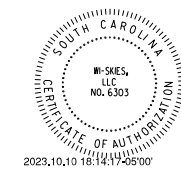

| 4 | | | |
|--------------|----|------|-------------------------|
| 3 | | | |
| 2 | | | |
| 1 | | | |
| REV. NO. | BY | DATE | DESCRIPTION OF REVISION |
| DESIGNED BY: | | DATE | |
| DRAWN BY: | | DATE | |
| CHECKED BY: | | DATE | |

BEAUFORT COUNTY
CITY OF BEAUFORT

ROBERT SMALLS PKWY (SC-170)
LIGHTING PLAN SHEET

SHEET LL2

SCALE: 1" = 20'

| STATE | COUNTY | FILE NO. | PROJECT NO. | ROUTE NO. | SHEET NO. |
|-------|----------|----------|-------------|-----------|-----------|
| SC | BEAUFORT | | | SC-170 | LL3 |

NOTES

1. CONTRACTOR SHALL UTILIZE EXISTING CIRCUIT BREAKER TO POWER RELOCATED AND NEW FIXTURES.
2. CONTRACTOR TO VERIFY AND NOTE ON DRAWINGS ALL CIRCUIT INFORMATION PRIOR TO BEGINNING WORK. THIS INCLUDES BUT NOT LIMITED TO, PANEL NAME, CIRCUIT NUMBER, CABLE SIZE AND NUMBER OF POLES.

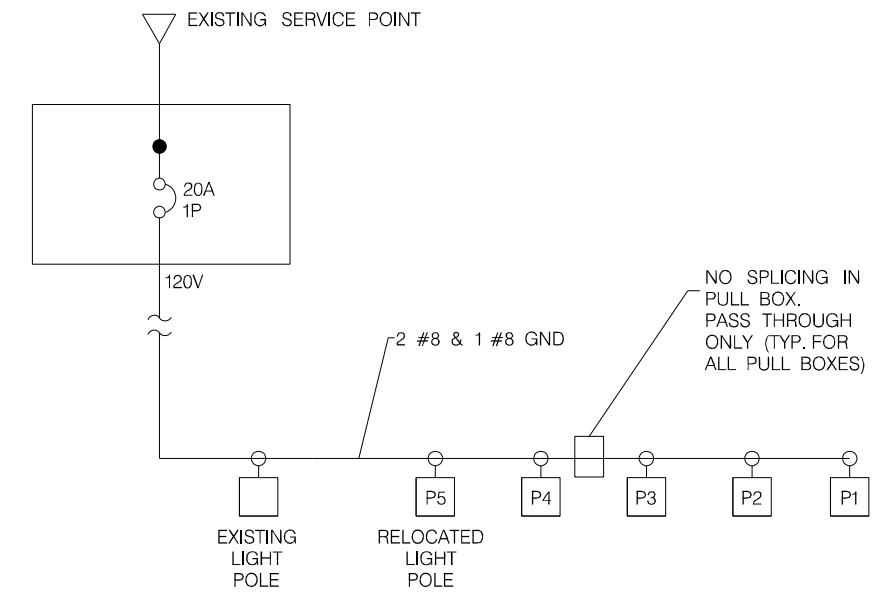

SYSTEM SINGLE LINE DIAGRAM



JE INFRASTRUCTURE
CONSULTING & ENGINEERING

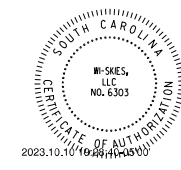

| 4 | | | |
|--------------|-------|------------|-------------------------|
| 3 | | | |
| 2 | | | |
| 1 | | | |
| REV. NO. | BY | DATE | DESCRIPTION OF REVISION |
| DESIGNED BY: | _____ | DATE _____ | |
| DRAWN BY: | _____ | DATE _____ | |
| CHECKED BY: | _____ | DATE _____ | |

| | |
|---|----------|
| BEAUFORT COUNTY CITY OF BEAUFORT | |
| ROBERT SMALLS PKWY (SC-170) LIGHTING PLAN SHEET SINGLE LINE DIAGRAM | |
| SHEET LL3 | NO SCALE |

| STATE | COUNTY | FILE NO. | PROJECT NO. | ROUTE NO. | SHEET NO. |
|-------|----------|----------|-------------|-----------|-----------|
| SC | BEAUFORT | | | SC-170 | LL4 |

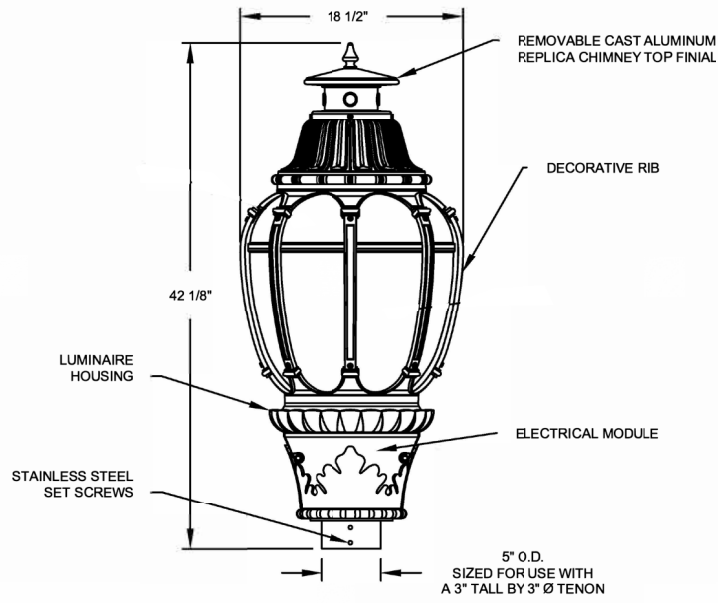

LUMINAIRE DETAIL

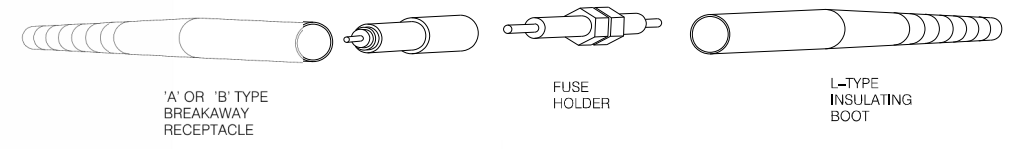

IN-LINE FUSE HOLDER WITH BREAKAWAY FEATURE DETAIL

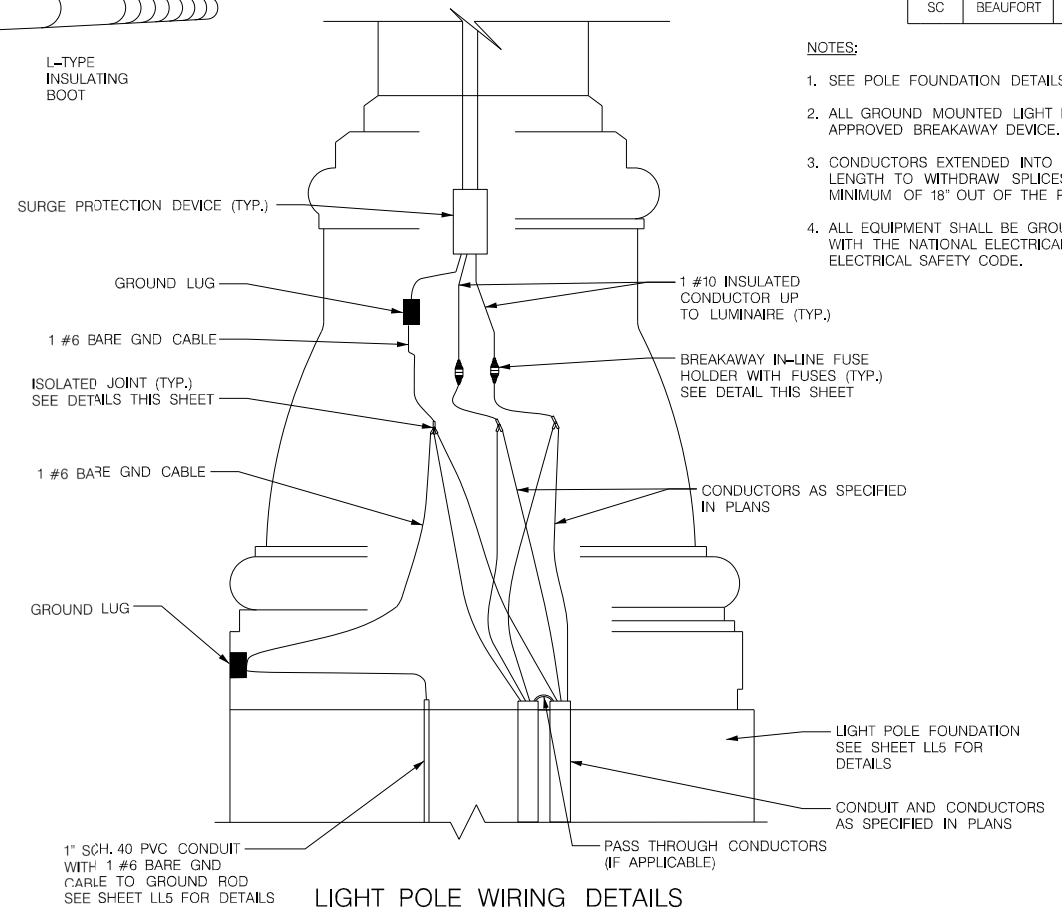

LIGHT POLE WIRING DETAILS

- NOTES:
- SEE POLE FOUNDATION DETAILS ON SHEET LL5.
 - ALL GROUND MOUNTED LIGHT POLES ARE TO BE MOUNTED ON FHWA APPROVED BREAKAWAY DEVICE.
 - CONDUCTORS EXTENDED INTO POLE BASE SHALL BE OF SUFFICIENT LENGTH TO WITHDRAW SPLICES AND/OR ISOLATED JOINTS A MINIMUM OF 18" OUT OF THE POLE HANDHOLE.
 - ALL EQUIPMENT SHALL BE GROUNDED AND BONDED IN ACCORDANCE WITH THE NATIONAL ELECTRICAL CODE AND THE NATIONAL ELECTRICAL SAFETY CODE.

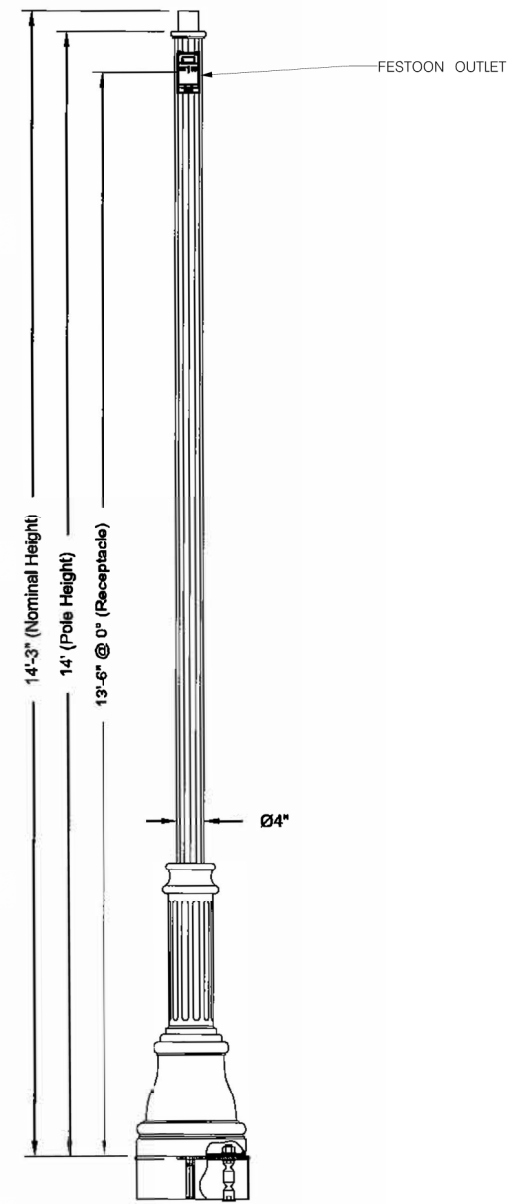

POLE DETAIL

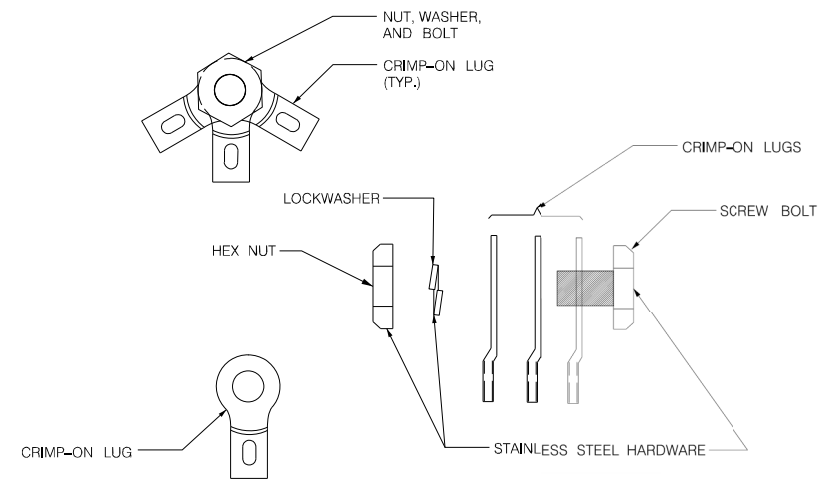

ISOLATED JOINT DETAIL

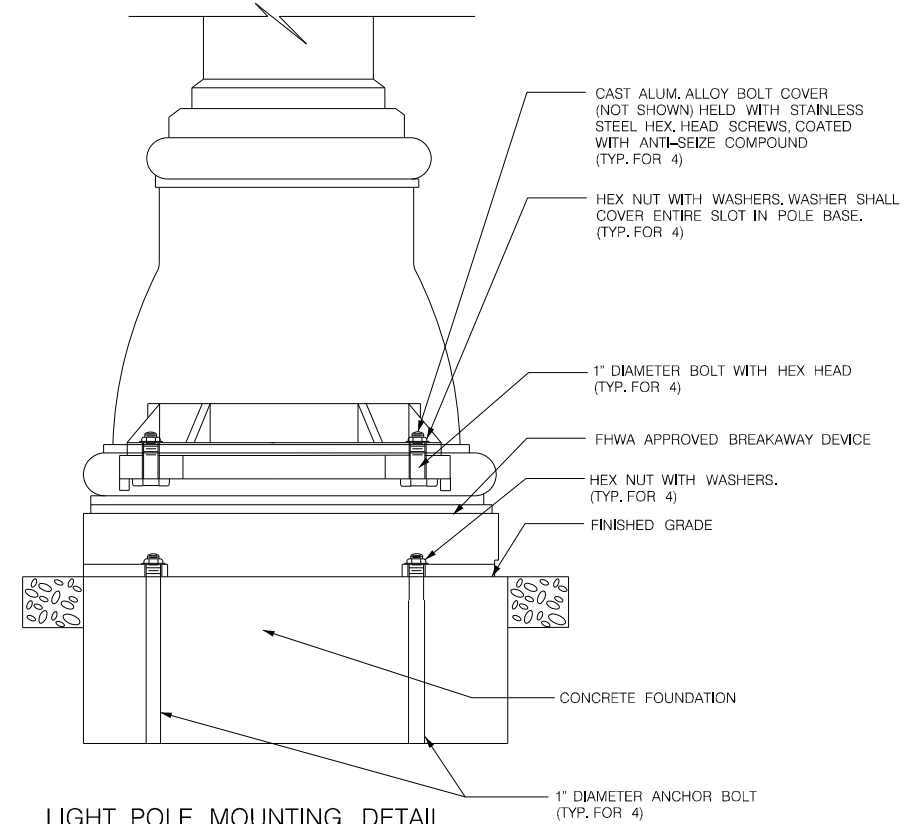

LIGHT POLE MOUNTING DETAIL



INFRASTRUCTURE
CONSULTING & ENGINEERING

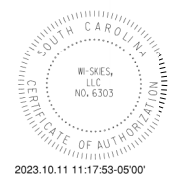

| 4 | | | | |
|--------------|----|------|-------------------------|--|
| 3 | | | | |
| 2 | | | | |
| 1 | | | | |
| REV. NO. | BY | DATE | DESCRIPTION OF REVISION | |
| DESIGNED BY: | | DATE | | |
| DRAWN BY: | | DATE | | |
| CHECKED BY: | | DATE | | |

BEAUFORT COUNTY
CITY OF BEAUFORT

ROBERT SMALLS PKWY (SC-170)
LIGHTING PLAN SHEET
LIGHTING POLE DETAILS

SHEET LL4 NO SCALE

| | | | | | |
|-------|----------|----------|-------------|-----------|-----------|
| STATE | COUNTY | FILE NO. | PROJECT NO. | ROUTE NO. | SHEET NO. |
| SC | BEAUFORT | | | SC-170 | LL5 |

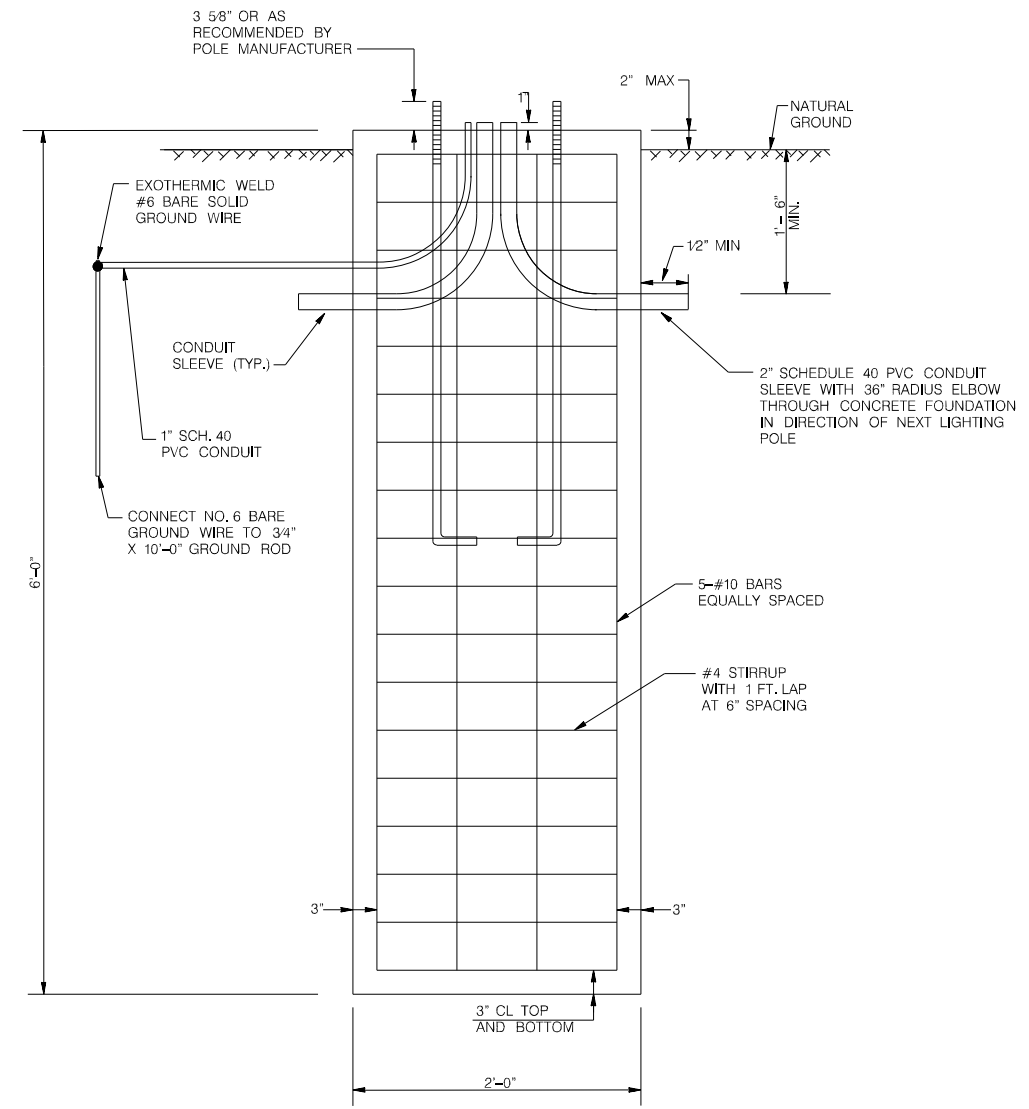

ELEVATION

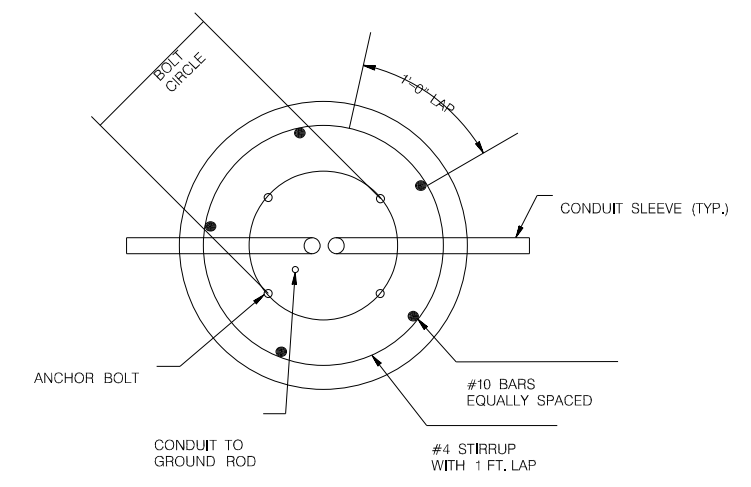

PLAN

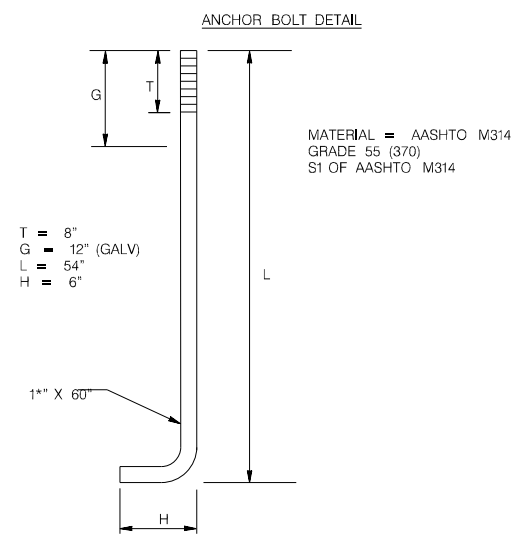

NOTE:
EACH 2' X 6' FOUNDATION REQUIRES:
0.70 CU. YDS. CLASS A CONCRETE AND
114 LBS OF BAR REINFORCING STEEL.
THESE ARE CONSIDERED INCIDENTAL TO
COST OF FOUNDATION.



INFRASTRUCTURE
CONSULTING & ENGINEERING

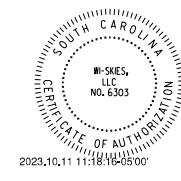

| 4 | | | | |
|--------------|----|------|-------------------------|--|
| 3 | | | | |
| 2 | | | | |
| 1 | | | | |
| REV. NO. | BY | DATE | DESCRIPTION OF REVISION | |
| DESIGNED BY: | | DATE | | |
| DRAWN BY: | | DATE | | |
| CHECKED BY: | | DATE | | |

| | |
|---|----------|
| BEAUFORT COUNTY CITY OF BEAUFORT | |
| ROBERT SMALLS PKWY (SC-170) LIGHTING PLAN SHEET POLE FOUNDATION DETAILS | |
| SHEET LL5 | NO SCALE |

| | | | | | |
|-------|----------|----------|-------------|-----------|-----------|
| STATE | COUNTY | FILE NO. | PROJECT NO. | ROUTE NO. | SHEET NO. |
| SC | BEAUFORT | | | SC-170 | LL6 |

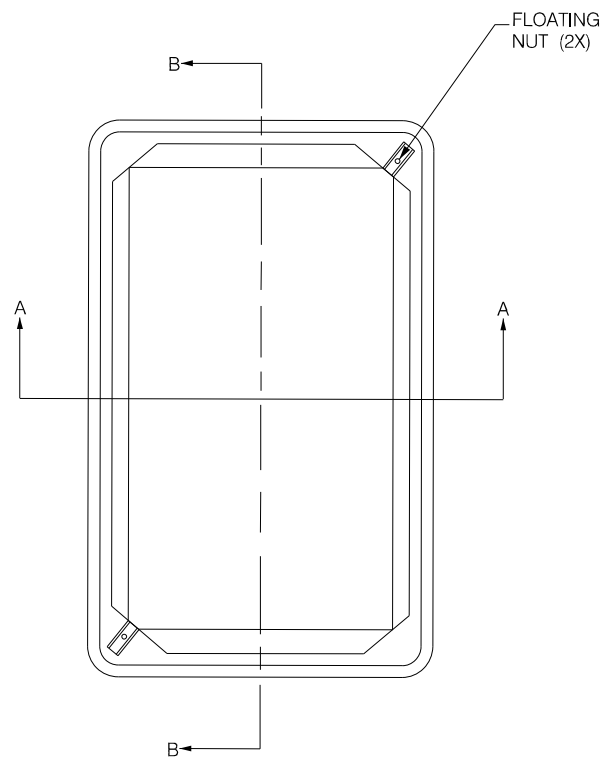

PLAN VIEW

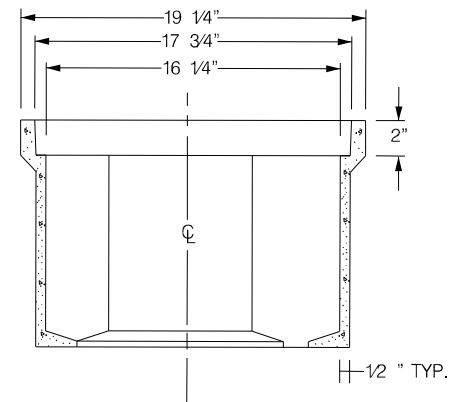

SECTION A-A

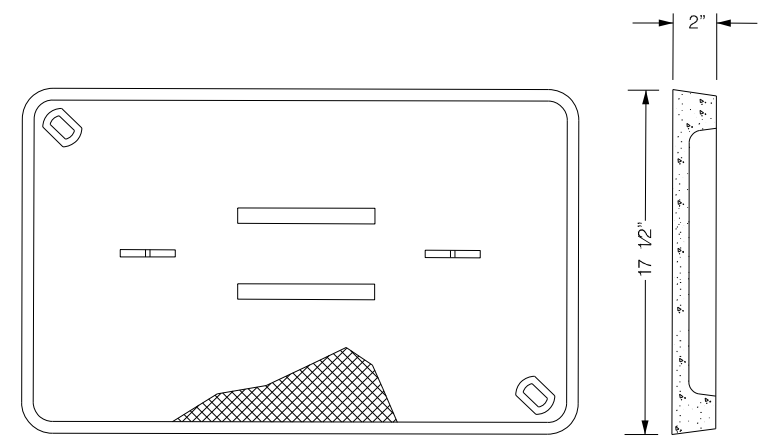

POLYMER CONCRETE COVER

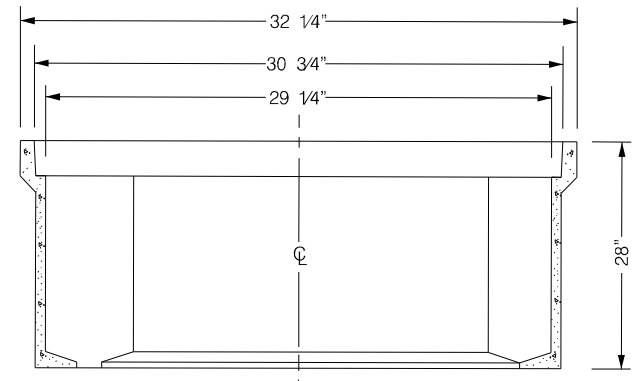
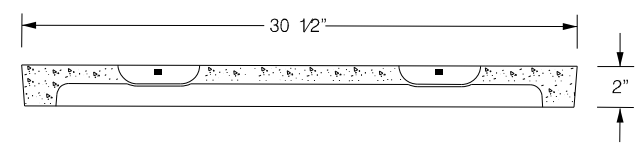

SECTION B-B

NOTES:

- 1) POLYMER BOX TOP AND FRAME MAY HAVE A DIFFERENT CROSS SECTION THAN WHAT IS SHOWN.
- 2) THERE SHALL BE NO CABLE SPLICING WITHIN PULL BOX. PULL BOX SHALL BE USED ONLY AS A CABLE PASS THROUGH.
- 3) ALL PULL BOXES SHALL HAVE SCDOT ELECTRIC LOGO CAST ON THE LID.



INFRASTRUCTURE
CONSULTING & ENGINEERING

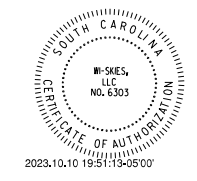

| 4 | | | | |
|--------------|----|------|-------------------------|--|
| 3 | | | | |
| 2 | | | | |
| 1 | | | | |
| REV. NO. | BY | DATE | DESCRIPTION OF REVISION | |
| DESIGNED BY: | | DATE | | |
| DRAWN BY: | | DATE | | |
| CHECKED BY: | | DATE | | |

| | |
|---|----------|
| BEAUFORT COUNTY CITY OF BEAUFORT | |
| ROBERT SMALLS PKWY (SC-170) LIGHTING PLAN SHEET JUNCTION BOX/PULL BOX DETAILS | |
| SHEET LL6 | NO SCALE |

| | | | | | |
|-------|----------|----------|-------------|-----------|-----------|
| STATE | COUNTY | FILE NO. | PROJECT NO. | ROUTE NO. | SHEET NO. |
| SC | BEAUFORT | | | SC-170 | LA1 |

PLANT LIST - THIS SHEET

| KEY | SYMBOL | BOTANICAL NAME | COMMON NAME | SIZE | BALL/CONT. | QUANTITY EACH |
|------|--------|----------------|-------------|------|------------|---------------|
| SEED | | | BERMUDA | | | 1500 SF |

BERMUDA SEEDING AND MULCHING TO BE IN ACCORDANCE WITH SCDOT STANDARD SPECIFICATIONS

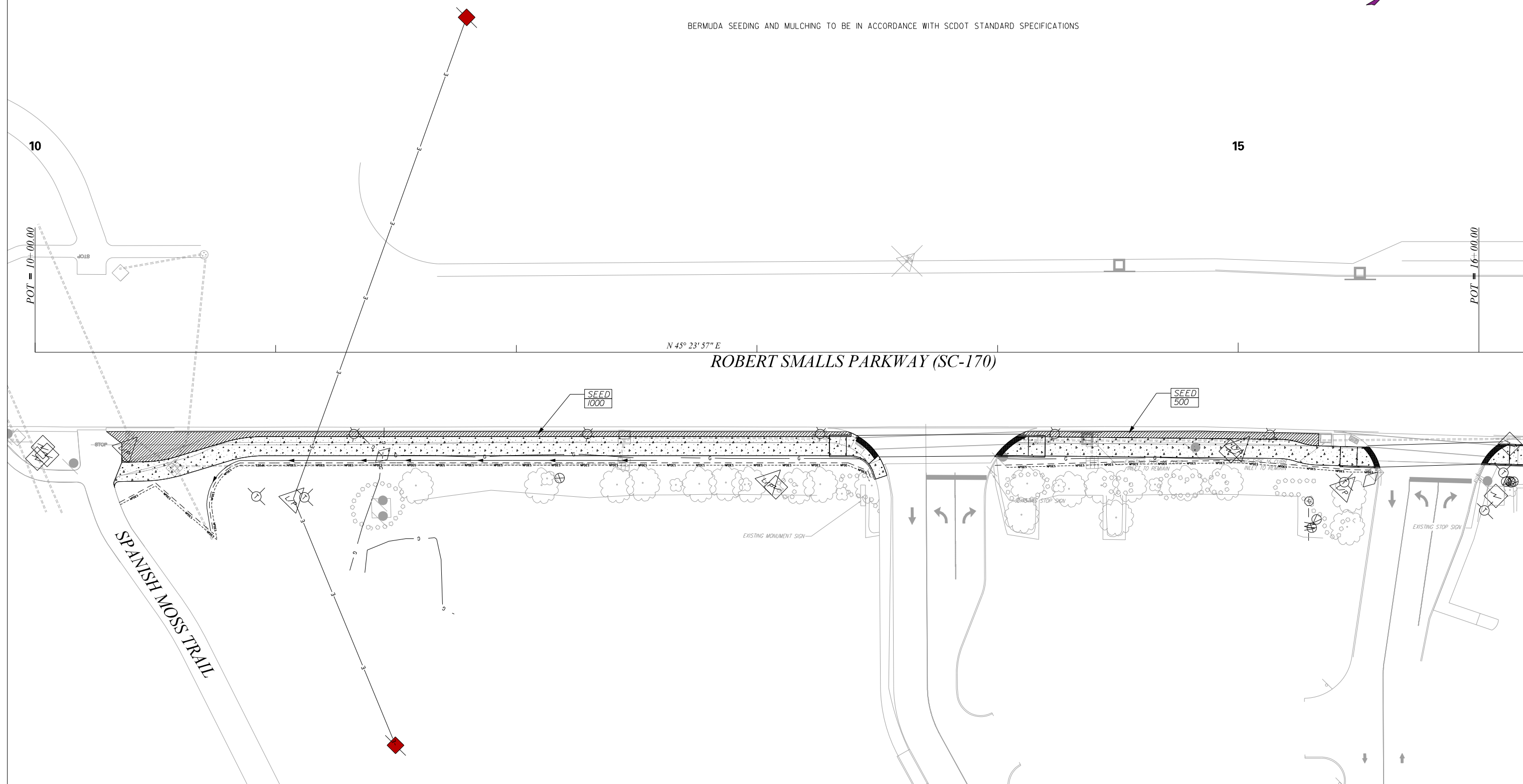
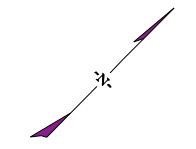

JE INFRASTRUCTURE
CONSULTING & ENGINEERING

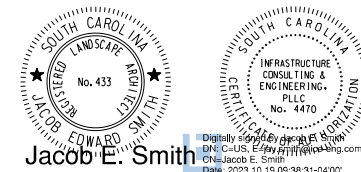

| 4 | | | | |
|--------------|-----|------|-------------------------|--|
| 3 | | | | |
| 2 | | | | |
| 1 | | | | |
| REV. NO. | BY | DATE | DESCRIPTION OF REVISION | |
| DESIGNED BY: | TKC | DATE | 10/10/2023 | |
| DRAWN BY: | TKC | DATE | 10/10/2023 | |
| CHECKED BY: | JCH | DATE | 10/10/2023 | |

BEAUFORT COUNTY
CITY OF BEAUFORT

ROBERT SMALLS PKWY (SC-170)
LANDSCAPE PLAN SHEET

SHEET LA1 SCALE: 1" = 20'

80

70

60

50

40

30

20

10

0

10

20

30

40

50

| | | | | | |
|-------|----------|----------|-------------|-----------|-----------|
| STATE | COUNTY | FILE NO. | PROJECT NO. | ROUTE NO. | SHEET NO. |
| SC | BEAUFORT | | | SC-170 | X1 |

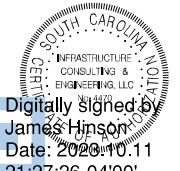

Digitally Signed by
James Hinson
Date: 2020.10.11
21:27:26-04'00'

15

10

15

10

15

10

15

10

15

10

15

10

12 + 50.00

12 + 00.00

11 + 50.00

11 + 00.00

10 + 50.00

**BEGIN CONSTRUCTION
ROBERT SMALLS PWKY (SC-170)
STA. 10+33.15**

10 + 00.00

80

70

60

50

40

30

20

10

0

10

20

30

40

50

60

70

80

80

70

60

50

40

30

20

10

☉

10

20

30

40

50

| STATE | COUNTY | FILE NO. | PROJECT NO. | ROUTE NO. | SHEET NO. |
|-------|----------|----------|-------------|-----------|-----------|
| SC | BEAUFORT | | | SC-170 | X2 |

END CONSTRUCTION
ROBERT SMALLS PWKY (SC-170)
STA. 16+19.91



Digitally signed by
 James Hinson
 Date: 2023.10.11
 21:27:42-04'00'

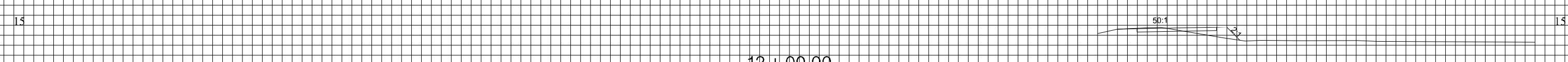
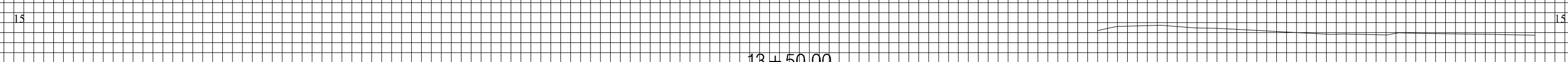
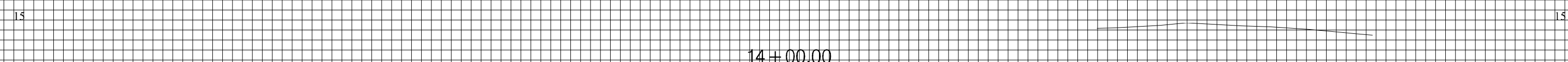
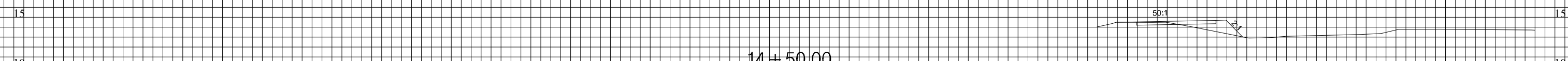
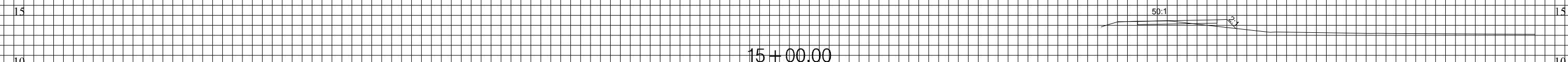
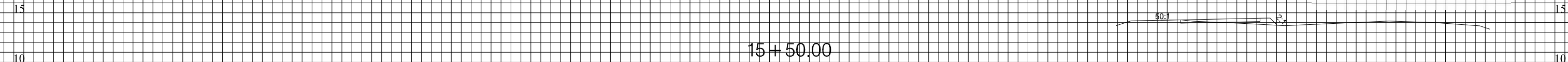

80

70

60

50

40

30

20

10

☉

10

20

30

40

50

60 70 80