



MAIN: 100 AMP / 2 POLE MAIN CIRCUIT BREAKER										VOLTAGE: 120/240V, 1Ø, 3 WIRE			
SPEC: PROVIDED WITH MODULAR BUILDING													
MOUNTING: PROVIDED WITH MODULAR BUILDING										AIC SYM: 22,000			
DESCRIPTION	WIRE	GND.	COND.	TRIP	OKT.	A PHASE KVA	C PHASE KVA	KVA	TRIP	COND.	GND.	WIRE	DESCRIPTION
MODULAR BUILDING EXT LGTS	—	—	—	20	1	0.1 0.2	2	20	—	—	—	—	MODULAR BUILDING CHASE RECP
MODULAR BUILDING CHASE LGTS	—	—	—	20	3	—	0.1 0.2	4	20	—	—	—	MODULAR BUILDING LGTS & FAN
MODULAR BUILDING LGTS & FAN	—	—	—	20	5	0.2 1.1	—	60	—	—	—	—	MODULAR BUILDING HAND DRYER
MODULAR BUILDING HAND DRYER	—	—	—	20	7	—	1.1 1.2	8	20	1/2"	1#12	2#12	PICKLEBALL COURT LIGHTING
IRRIGATION PUMP	2#10	1#10	3/4"	30	9	1.5 1.2	—	10	2	—	—	—	PICKLEBALL COURT LIGHTING
				2	11	—	1.5 1.2	12	20	1/2"	1#12	2#12	PICKLEBALL COURT LIGHTING
LIFT STATION	2#10	1#10	3/4"	30	15	1.5 1.2	—	14	2	—	—	—	PICKLEBALL COURT LIGHTING
				2	15	—	1.5 1.2	16	20	1/2"	1#12	2#12	PICKLEBALL COURT LIGHTING
				2	17	—	—	18	2	—	—	—	PICKLEBALL COURT LIGHTING
PICKLEBALL COURT LIGHTING	2#12	1#12	1/2"	20	12	1.2 1.2	—	18	2	—	—	—	PICKLEBALL COURT LIGHTING
				2	19	—	1.2 0.4	20	20	1/2"	1#12	1#12	SITE LIGHTING
						9.4	—	9.5					
						78.3	—	80.0					
						19.0	—	TOTAL KVA					



ENGINEER CERTIFICATION

☐ JOSEPH W. SCHULKE
FL. REG. NO. 47048

☐ JODAH B. BITTLE
FL. REG. NO. 57396

☐ WILLIAM P. STOODARD
FL. REG. NO. 57605

DATE: _____

SHEET
E0.1

PROJECT NO.
18-182

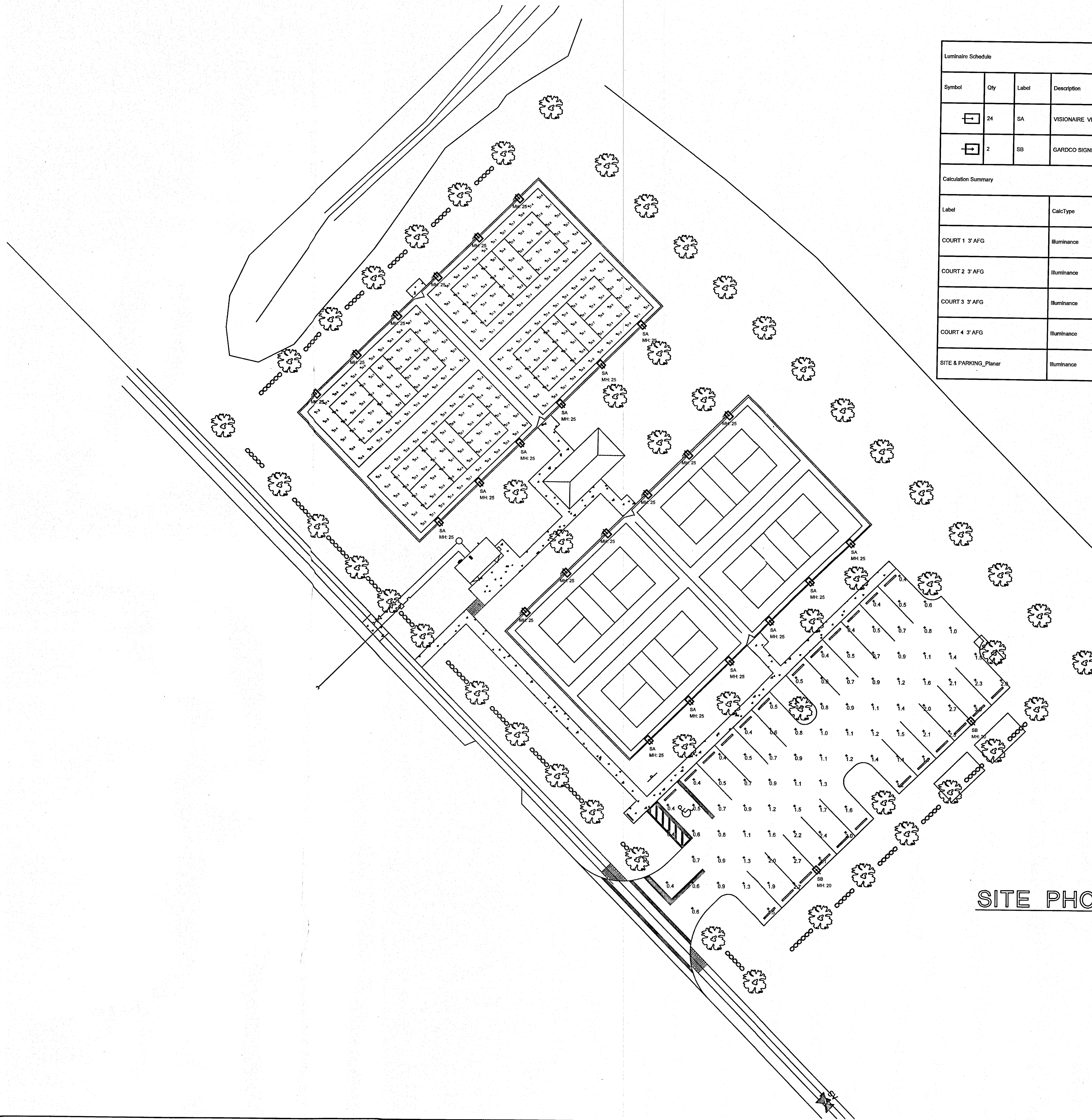

Luminaire Schedule										
Symbol	Qty	Label	Description	Lumens/Lamp	LLD	LDD	BF	LLF	Lum. Watts	Total Watts
	24	SA	VISIONAIRE VLX-1-T4-192L-C-7-4K-UV POLE MOUNT 25' AFG	N.A.	0.900	0.900	1.000	0.810	421	10104
	2	SB	GARDCO SIGNIFY ECF-S-32L-1A-NW-G2-4-HS POLE MOUNT 20' AFG	N.A.	0.900	0.900	1.000	0.810	110.7	221.4

Calculation Summary							
Label	CalcType	Units	Avg	Max	Min	Avg/Min	Max/Min
COURT 1 3' AFG	Illuminance	Fc	30.33	38.2	18.5	1.64	2.06
COURT 2 3' AFG	Illuminance	Fc	30.32	38.2	18.4	1.65	2.05
COURT 3 3' AFG	Illuminance	Fc	30.29	38.0	18.4	1.65	2.07
COURT 4 3' AFG	Illuminance	Fc	30.29	38.0	18.4	1.65	2.07
SITE & PARKING_Planar	Illuminance	Fc	1.17	3.1	0.4	2.93	7.75

SITE PHOTOMETRIC PLAN
1"=20'-0"

SITE LIGHTING PLAN
ISSUED FOR PERMIT

KAMM CONSULTING PROJECT # 2019-0001
PROJECT MANAGER: DUANE MILLAR

KAMM Consulting
1408 Orange Blossom Lane
Fort Pierce, FL 34946
Phone 772-335-1744
bbrown@kammconsulting.com
Certification of Authorization #8189
05-21-19222

PRINCIPAL
Brady L. Brown
Florida License #58332

ENGINEER CERTIFICATION
I, **JOSEPH W. SCHULKE**,
FL REG. NO. 47048
DOAN B. BITTLE,
FL REG. NO. 57396
WILLIAM P. STODDARD,
FL REG. NO. 57625

DATE: **11/20/2018**

SHEET E1.1
PROJECT NO. 18-182

SCHULKE, BITTLE & STODDARD, L.L.C.
CIVIL & STRUCTURAL ENGINEERING • LAND PLANNING • ENVIRONMENTAL PERMITTING
CERTIFICATION OF AUTHORIZATION NO.: 00008668
1717 INDIAN RIVER BLVD., SUITE 201 VERO BEACH, FLORIDA 32960
TEL 772/770-9622 FAX 772/770-9496 EMAIL info@sbsengineers.com

COS AIRPORT PICKLEBALL
AIRPORT DRIVE EAST
SEBASTIAN, FL
INDIAN RIVER COUNTY

