

Storm Sewer As-Built

- EX 87 Ex. Grate Inlet  
Ex. Top=18.43  
Ex. Inv. In=  
Ex. Inv. Out=  
\*Grate inlet has a liner in it prohibiting any access to structure. We were instructed by Brian with HDR, not to disturb the liner.
- EX 86 Ex. Grate Inlet  
Ex. Top=19.44  
Ex. Inv. In=  
Ex. Inv. Out=  
\*Grate inlet has a liner in it prohibiting any access to structure. We were instructed by Brian with HDR, not to disturb the liner.
- EX 87 Ex. Grate Inlet  
Ex. Top=19.39  
Ex. Inv. In=  
Ex. Inv. Out=  
\*Grate inlet has a liner in it prohibiting any access to structure. We were instructed by Brian with HDR, not to disturb the liner.
- EX 88 Ex. Grate Inlet  
Ex. Top=18.98  
Ex. Inv. In=  
Ex. Inv. Out=  
\*Grate inlet has a liner in it prohibiting any access to structure. We were instructed by Brian with HDR, not to disturb the liner.
- EX 89 Ex. Grate Inlet  
Ex. Top=18.74  
Ex. Inv. In=  
Ex. Inv. Out=  
\*Grate inlet has a liner in it prohibiting any access to structure. We were instructed by Brian with HDR, not to disturb the liner.
- EX 104 Ex. Storm Manhole  
Ex. Top=22.70  
Ex. Inv. @ C/L of Structure=13.70  
\*Unable to obtain inverts of pipe from above ground. Confined space required.
- EX 104A Ex. Storm Manhole  
Ex. Top=21.95  
Ex. Inv. In=13.93 (18" RCP from 105)  
Ex. Inv. In=13.93 (18" RCP from South)  
Ex. Inv. Out=13.86 (18" RCP to 104)
- EX 105 Ex. Storm Manhole  
Ex. Top=21.64  
Ex. Inv. In=14.30 (18" RCP from 106)  
Ex. Inv. Out=14.24 (18" RCP to 104A)
- EX 106 Ex. Grate Inlet  
Ex. Top=21.36  
Ex. Inv. In=  
Ex. Inv. Out=  
\*Grate inlet has a liner in it prohibiting any access to structure. We were instructed by Brian with HDR, not to disturb the liner.
- EX 107 Ex. Storm Manhole  
Ex. Top=22.46  
Ex. Inv. In=17.36 (18" RCP from 107)  
Ex. Inv. Out=17.28 (18" RCP to 106)
- EX 108 Ex. Grate Inlet  
Ex. Top=23.10  
Ex. Inv. In=  
Ex. Inv. Out=  
\*Grate inlet has a liner in it prohibiting any access to structure. We were instructed by Brian with HDR, not to disturb the liner.
- EX 109 Ex. Storm Manhole  
Ex. Top=27.56  
Ex. Inv. In=20.24 (18" RCP from 117)  
Ex. Inv. Out=20.22 (18" RCP to 109)
- EX 110 Ex. Storm Manhole  
Ex. Top=22.60  
Ex. Inv. @ C/L of Structure=12.91  
\*Unable to obtain inverts of pipe from above ground. Confined space required.

From	To	Pipe Information
104A	104	19.9' - 18" RCP @ 0.80%
105	104A	28.6' - 18" RCP @ 1.08%
117	109	45.4' - 18" RCP @ 2.18%
104	110	30.8' - 18" RCP @ 5.91%
111	110	103.2' - 18" RCP @ 1.76%
112	111	133.6' - 18" RCP @ 1.53%
113	112	109.4' 18" RCP @ 1.84%
119	118	27.4' - 15" RCP @ 25.9%
122	118	80.6' - 15" RCP @ 1.17%
124	122	43.7' - 15" RCP @ 0.81%

- EX 111 Ex. Storm Manhole  
Ex. Top=23.21  
Ex. Inv. @ C/L of Structure=14.73  
\*Unable to obtain inverts of pipe from above ground. Confined space required.
- EX 112 Ex. Storm Manhole  
Ex. Top=23.93  
Ex. Inv. In=16.93 (18" RCP from 113)  
Ex. Inv. Out=16.84 (18" RCP to 111)
- EX 113 Ex. Storm Manhole  
Ex. Top=24.62  
Ex. Inv. In=20.38 (15" RCP from 114)  
Ex. Inv. Out=18.94 (18" RCP to 112)
- EX 114 Ex. Grate Inlet  
Ex. Top=23.44  
Ex. Inv. In=  
Ex. Inv. Out=  
\*Grate inlet has a liner in it prohibiting any access to structure. We were instructed by Brian with HDR, not to disturb the liner.
- EX 115 Ex. Grate Inlet  
Ex. Top=23.89  
Ex. Inv. In=  
Ex. Inv. Out=  
\*Grate inlet has a liner in it prohibiting any access to structure. We were instructed by Brian with HDR, not to disturb the liner.
- EX 116 Ex. Storm Manhole  
Ex. Top=25.57  
Ex. Inv. In=19.90 (6" PVC from West)  
Ex. Inv. Out=19.88 (6" PVC to MM)  
\*Appears to be a combined Storm and Sanitary line.
- EX 117 Ex. Storm Manhole  
Ex. Top=29.23  
Ex. Inv. In=23.02 (18" RCP from Northwest)  
Ex. Inv. Out=21.23 (18" RCP to 109)  
\*Appears to be a combined Storm and Sanitary line.
- EX 118 Ex. Storm Manhole  
Ex. Top=40.22  
Ex. Inv. In=31.12 (15" RCP from 119)  
Ex. Inv. In=30.72 (15" RCP from 122)  
Ex. Inv. Out=27.30 (18" RCP to South)
- EX 119 Ex. Storm Manhole  
Ex. Top=42.78  
Ex. Inv. In=38.23 (15" RCP from 120)  
Ex. Inv. Out=38.11 (15" RCP to 118)
- EX 120 Ex. Grate Inlet  
Ex. Top=45.31  
Ex. Inv. In=  
Ex. Inv. Out=  
\*Grate inlet has a liner in it prohibiting any access to structure. We were instructed by Brian with HDR, not to disturb the liner.
- EX 121 Ex. Grate Inlet  
Ex. Top=46.34  
Ex. Inv. In=  
Ex. Inv. Out=  
\*Unable to get lid open.
- EX 122 Ex. Grate Inlet  
Ex. Top=39.11  
Ex. Inv. In=36.21 (15" RCP from 123)  
Ex. Inv. In=31.86 (15" RCP from 124)  
Ex. Inv. In=34.76 (6" PVC from Northeast)  
Ex. Inv. Out=31.66 (15" RCP to 118)
- EX 123 Ex. Curb Inlet  
Ex. Top=46.37  
Ex. Inv. In=40.69 (15" RCP from West)  
Ex. Inv. Out=40.34 (15" RCP to 122)
- EX 124 Ex. Curb Inlet  
Ex. Top=42.49  
Ex. Inv. In=32.59 (15" RCP from 125)  
Ex. Inv. Out=32.21 (15" RCP to 122)
- EX 125 Ex. Grate Inlet  
Ex. Top=42.03  
Ex. Inv. In=  
Ex. Inv. Out=  
\*Grate inlet has a liner in it prohibiting any access to structure. We were instructed by Brian with HDR, not to disturb the liner.

Sanitary Sewer As-Built

- EX 111 Ex. Sanitary Manhole  
Ex. Top=Buried  
Ex. Inv. In=  
Ex. Inv. Out=  
\*Could not find. No evidence on the ground of a structure. Approximate location shown on plan.
- EX 112 Ex. Sanitary Manhole  
Ex. Top=24.80  
Ex. Inv. In=20.95 (6" PVC from North)  
Ex. Inv. In=21.05 (4" PVC from Southwest)  
Ex. Inv. Out=20.02 (8" PVC to JJ)
- EX 113 Ex. Sanitary Manhole  
Ex. Top=24.53  
Ex. Inv. In=  
Ex. Inv. Out=  
\*Structure full of sludge.
- EX 114 Ex. Sanitary Manhole  
Ex. Top=24.53  
Ex. Inv. @ C/L structure=19.31 (6" PVC from 116)

\*Not all sanitary manholes located and shown hereon are part of the gravity sewer network. Only the ones labeled as such were opened and as-built.

LEGEND

- S — Ex. Sanitary Sewer
- E — Ex. Overhead Electric
- W — Ex. Water Line
- G — Ex. Underground Gas Line
- UGE — Ex. Underground Electric
- UGT — Ex. Underground Telephone
- GR — Ex. Guard Rail
- CG — Ex. Curb and Gutter
- EP — Ex. Edge Of Pavement
- GB — Ex. Geotechnical Boring
- WM — Ex. Water Meter
- WV — Ex. Water Valve
- FH — Ex. Fire Hydrant
- SS — Ex. Storm Sewer
- SS — Ex. Sanitary Sewer
- TM — Ex. Telephone Manhole
- EM — Ex. Electric Manhole
- HH — Ex. Hand Hole
- SCO — Ex. Sanitary Clean Out
- GVP — Ex. Gas Vent Pipe
- U — Ex. Unknown Utility
- PP — Ex. Power Pole
- GW — Ex. Guy Wire
- LP — Ex. Light Post
- S — Ex. Sign
- B — Ex. Bollard

Notes:

1. No boundary information was compiled for this survey. Not all easements may be shown.
2. This site survey was completed under the direct and responsible charge of Rinker Design Associates, P.C. from an actual ground survey made under my supervision; that the imagery and other data was obtained on December 28, 2022, and that this digital geospatial data, including metadata, meets minimum accuracy standards unless otherwise noted.
3. Subsurface utility data depicted in this survey was designated by an unknown source at an unknown time. At the request of the client, RDA located the utility point designation on December 28, 2022. RDA is not responsible for the accuracy or completeness of the utility designation point depicted in this survey.
4. Horizontal datum: VCS 1983 - North Zone  
Vertical Datum: NVD29  
Contour Interval: 1 foot
5. Storm and Sanitary manholes were located and shown to the center of the structure, not to the center of the manhole.

Survey Control

Point	Northing	Easting	Elevation	Description
1	6993808.289	1189464.460	19.42	GPSM-Mag Nail
2	6993894.459	1189425.987	20.28	GPSM-Rod & Cap
3	6993920.491	11894284.161	21.28	TRV-Rod & Cap
4	6994047.536	11894253.162	51.29	TRV-Rod & Cap
5	6994141.374	11894489.092	42.21	GPSM-Mag Nail
6	6994276.337	11894595.993	42.50	TRV-Rod & Cap
7	6994280.168	11894759.838	23.79	TRV-Mag Nail
8	6994056.904	11894703.281	22.46	TRV-Mag Nail

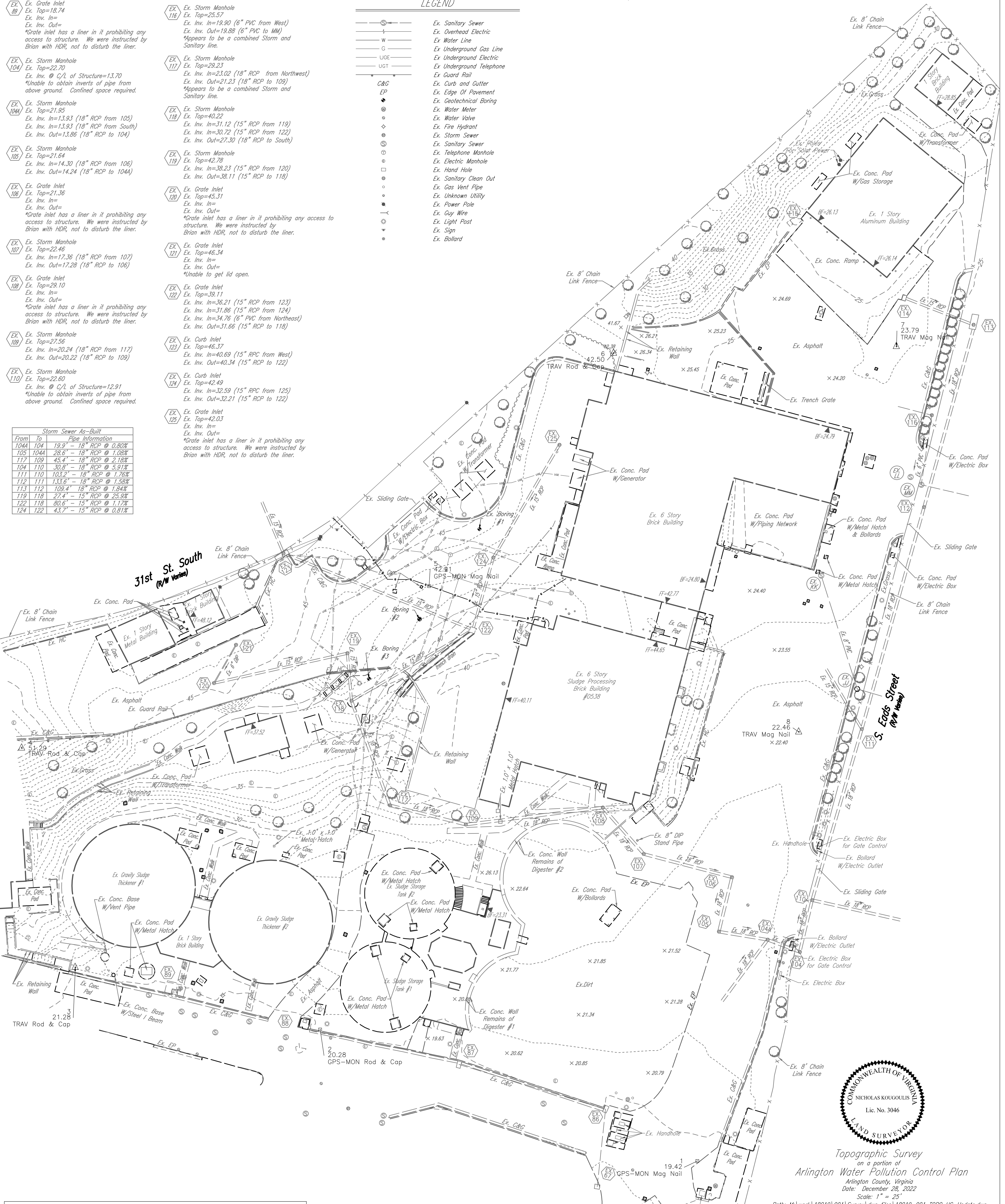

Boring #	Northing	Easting	Elevation	Description
1	6994174.446	11894518.205	44.37	TEST-HOLE/ASPHALT PATCH
2	6994122.271	11894483.527	40.77	TEST-HOLE/ASPHALT PATCH
3	6994087.729	11894454.304	41.50	TEST-HOLE/CL OF 5'X8' DISTAREA

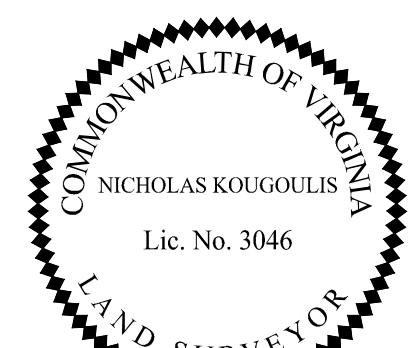

Topographic Survey  
on a portion of  
Arlington Water Pollution Control Plan  
Arlington County, Virginia  
Date: December 28, 2022  
Scale: 1" = 25'  
Path: M:\work\18019\001\Survey\dwg files\18019-001 TOPO HC-Update.dwg

