

CITY OF TREASURE ISLAND, FLORIDA

CONSTRUCTION PLANS
FOR
BEAUTIFICATION OF 125TH AVE.

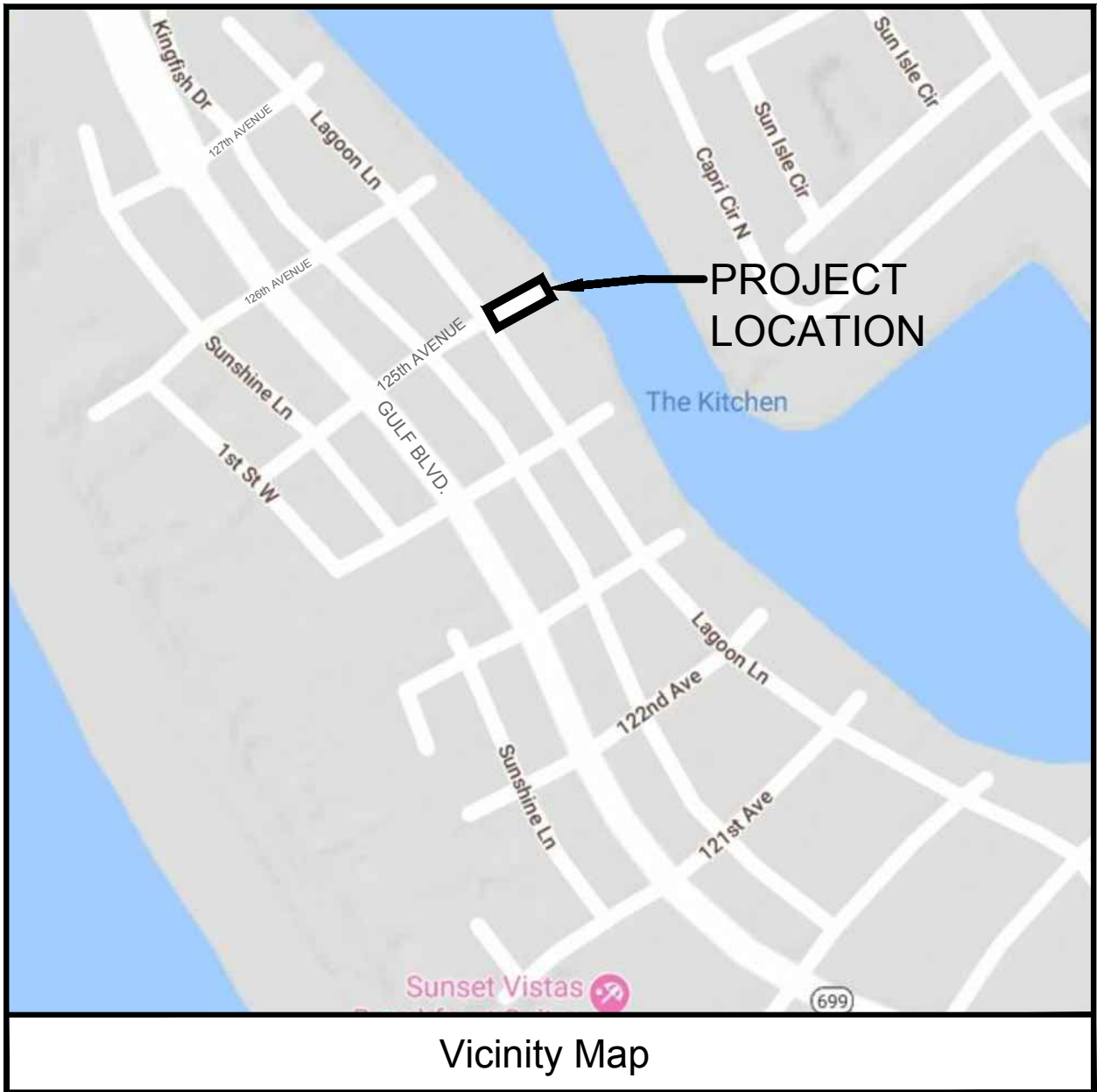

TREASURE ISLAND, Florida



BID DOCUMENTS

NOVEMBER 2018

PREPARED BY:

Michael Baker

INTERNATIONAL
4211 WEST BOY SCOUT BLVD
SUITE 500, TAMPA, FLORIDA, 33607
(813) 889-3892, (813) 889-3893 FAX
FLORIDA CORPORATE LICENSE NO. 28861

TITLE

COVER SHEET
GENERAL NOTES
PROJECT LAYOUT PLAN, KEY SHEET, AND SURVEY CONTROL PLAN
MAINTENANCE OF TRAFFIC PLAN
EXISTING CONDITIONS AND DEMOLITION PLAN
SITE PLAN
JOINT LAYOUT PLAN
TYPICAL SECTIONS
DRAINAGE AND EROSION CONTROL DETAILS
LANDSCAPING AND SITE DETAILS
LANDSCAPING PLANTING SCHEDULE AND NOTES

DRAWING No.

G-001
G-002
G-100
G-201
C-201
C-301
C-302
C-351
C-352
L-101
L-102

REVISIONS			
No.	Description	Date	By

ENGINEER OF RECORD:

NATHAN PARISH

FLORIDA P.E. NO. 68317

\\\\TAMPI1FS1\\Tampol\\Projects\\Treasure Island, FL\\125thAve-at-LagoonLnEndTerminus\\CADD-dwg\\003_(G-100)_Project Layout Plan and Key Sheet.dwg November 27 2018 - 10:15



CITY OF
TREASURE ISLAND
FLORIDA

Michael Baker
INTERNATIONAL
Michael Baker International, Inc.
4211 WEST BOY SCOUT BLVD., SUITE 500
TAMPA, FLORIDA 33607 (813) 889-3892
CERTIFICATE OF AUTHORIZATION NUMBER 28861

Designer:
SMR
Technician:
AF
Checked by:
NEP
BAKER Project Number:
168828

NATHAN PARISH
FLORIDA P.E. NO. 68317

Notes:

Revision No.	Description	Date	By

Project Name:
**BEAUTIFICATION OF
125TH AVE.**

Drawing Name:
**PROJECT LAYOUT PLAN,
KEY SHEET AND SURVEY
CONTROL PLAN**

CITY OF TREASURE ISLAND PROJECT NUMBER:
Date:
NOVEMBER 2018
Issue:

Scale:
AS SHOWN
Sheet Number:
G-100

\\TAMPI1FS1\Tampol\Projects\Treasure Island, FL\125thAve-at-LagoonLnEndTerminus\CADD-dwg\004_(G-201)_Maintenance of Traffic.dwg November 27 2018 - 10:19



CITY OF
TREASURE ISLAND
FLORIDA

Michael Baker
INTERNATIONAL
Michael Baker International, Inc.
4211 WEST BOY SCOUT BLVD., SUITE 500
TAMPA, FLORIDA 33607 (813) 889-3892
CERTIFICATE OF AUTHORIZATION NUMBER 28861

Designer:
SMR
Technician:
AF
Checked by:
NEP
BAKER Project Number:
168828

NATHAN PARISH
FLORIDA P.E. NO. 68317

Notes:

Revision No.	Description	Date	By

Project Name:
**BEAUTIFICATION OF
125TH AVE.**

Drawing Name:
**MAINTENANCE OF
TRAFFIC PLAN**









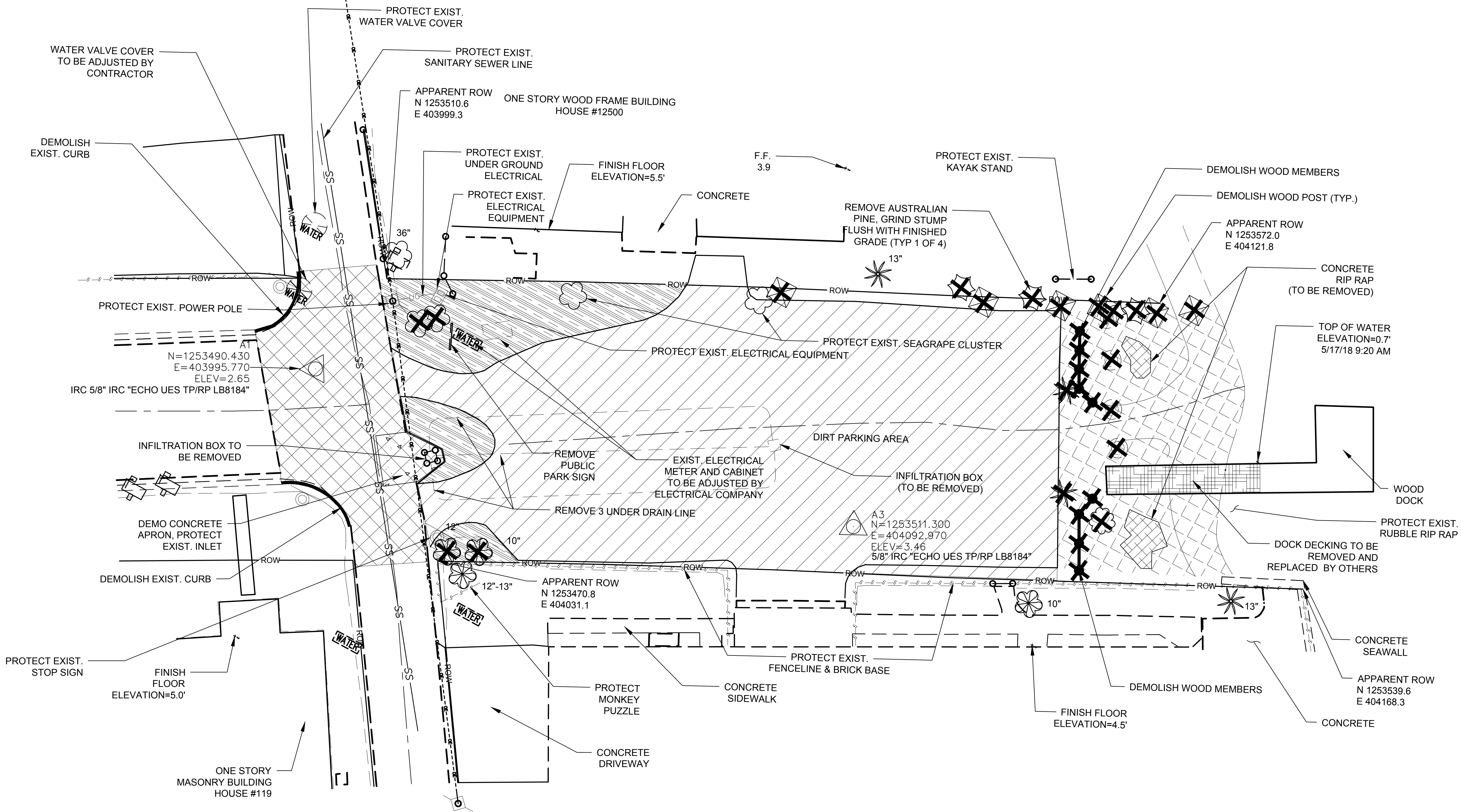

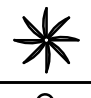

CITY OF TREASURE ISLAND PROJECT NUMBER:
Date:
NOVEMBER 2018
Issue:

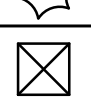
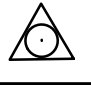
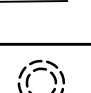
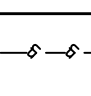
Scale:
AS SHOWN
Sheet Number:
G-201

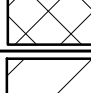
\\TAMPL1FS1\Tampa\Projects\Treasure Island, FL\125thAve-at-Lagoon\atEnd\Terminus\CADD-dwg\006 (C-201)_Existing Conditions and Demolition Plan.dwg November 27 2018 - 10:23

125th AVE



	SEAGRAPE CLUSTER
	MONKEY PUZZLE
	PALM
	OAK
	PINK AUSTRALIAN
	
	SURVEY POINTS
	ROW
	APPARENT R/W
	BOLLARD
	EXIST. PICKET FENCE OVER BRICK BASE
	OBJECT TO BE REMOVED
	EXIST. CONC. PAVT. TO BE REMOVED AND REPLACED
	EXIST. SHELL MATERIAL TO BE REMOVED AND REPLACED
	TOPSOIL STRIPPING
	SURFACE PREPARATION

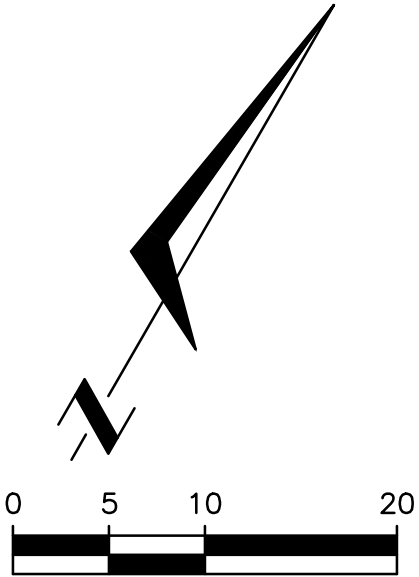

CITY OF
TREASURE ISLAND
FLORIDA

Michael Baker
INTERNATIONAL
Michael Baker International, Inc.
4211 WEST BOY SCOUT BLVD., SUITE 500
TAMPA, FLORIDA 33607 (813) 889-3892
CERTIFICATE OF AUTHORIZATION NUMBER 28861

Designer:
SMR
Technician:
AF
Checked by:
NEP
BAKER Project Number:
168828

NATHAN PARISH
FLORIDA P.E. NO. 68317

Notes:

Revision No.	Description	Date	By

Project Name:

BEAUTIFICATION OF
125TH AVE.

Drawing Name:

EXISTING CONDITIONS AND
DEMOLITION PLAN

CITY OF TREASURE ISLAND PROJECT NUMBER:

Date:
NOVEMBER 2018

Issue:

Scale:
AS SHOWN

Sheet Number:
C-201

\\TAMUPL1FS1\Tampa\Projects\Treasure Island, FL\125thAve-at-Lagoon\EndTerminus\CADD-dwg\007 (C-301)_Site Plan.dwg November 27 2018 12:12

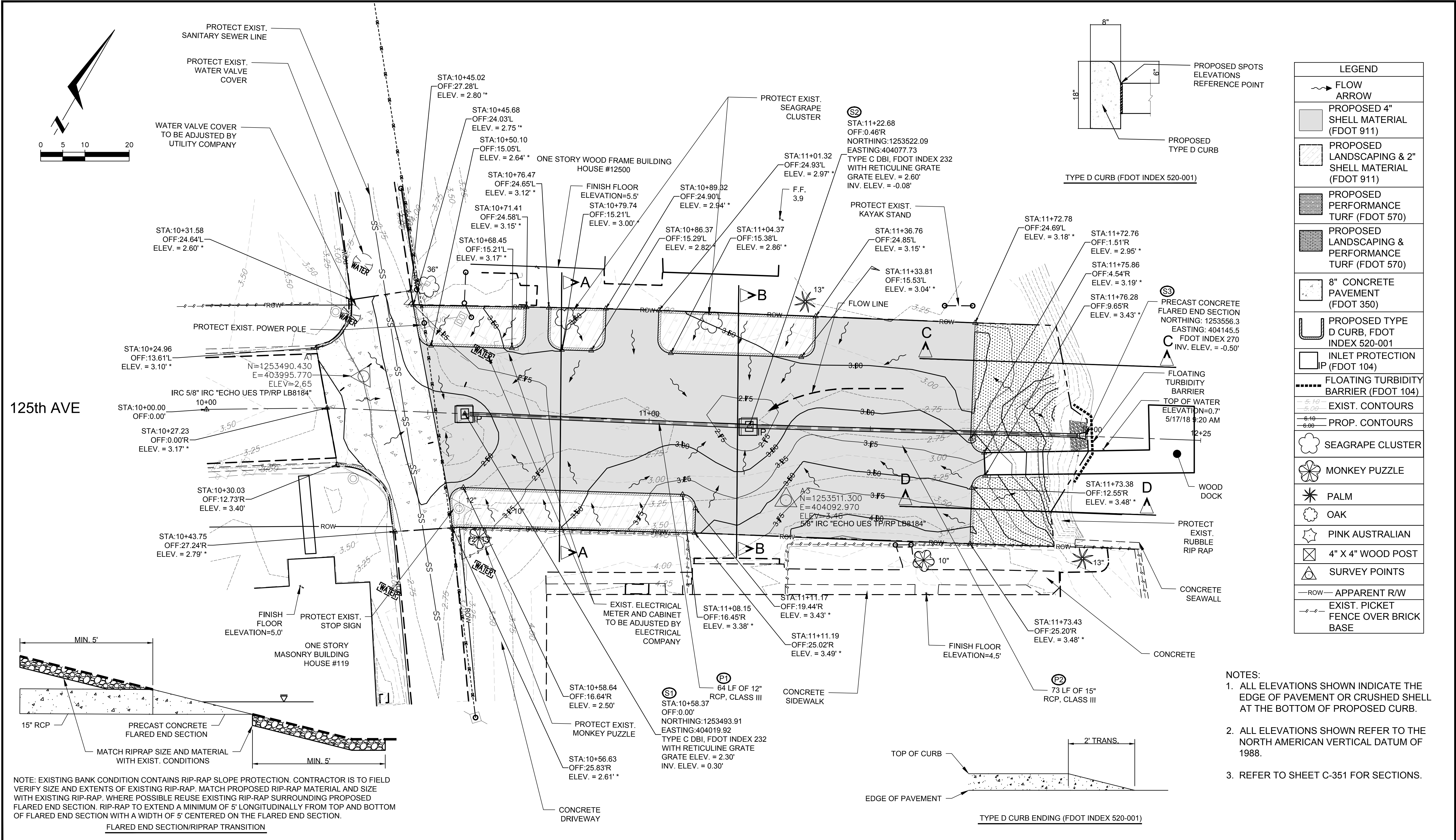

- NOTES:
1. ALL ELEVATIONS SHOWN INDICATE THE EDGE OF PAVEMENT OR CRUSHED SHELL AT THE BOTTOM OF PROPOSED CURB.
 2. ALL ELEVATIONS SHOWN REFER TO THE NORTH AMERICAN VERTICAL DATUM OF 1988.
 3. REFER TO SHEET C-351 FOR SECTIONS.

	CITY OF TREASURE ISLAND FLORIDA	<div>Michael Baker</div> <div>INTERNATIONAL</div> <div>Michael Baker International, Inc.</div> <div>4211 WEST BOY SCOUT BLVD., SUITE 500 TAMPA, FLORIDA 33607 (813) 889-3892 CERTIFICATE OF AUTHORIZATION NUMBER 28861</div>	Designer: SMR	Notes:	Revision No. Description Date By				Project Name: BEAUTIFICATION OF 125TH AVE.	Drawing Name: SITE PLAN	CITY OF TREASURE ISLAND PROJECT NUMBER:		
			Technician: AF									Date: NOVEMBER 2018	Issue: ---
			Checked by: NEP										
			BAKER Project Number: 168828										
			NATHAN PARISH FLORIDA P.E. NO. 68317								Scale: AS SHOWN	Sheet Number: C-301	

\\TAMPEL1FS1\Tampa\Projects\Treasure Island, FL\125thAve-at-Lagoon\InterTerminus\CADD-dwg\007 (C-302)_JOINT Plan.dwg November 27 2018 - 11:23

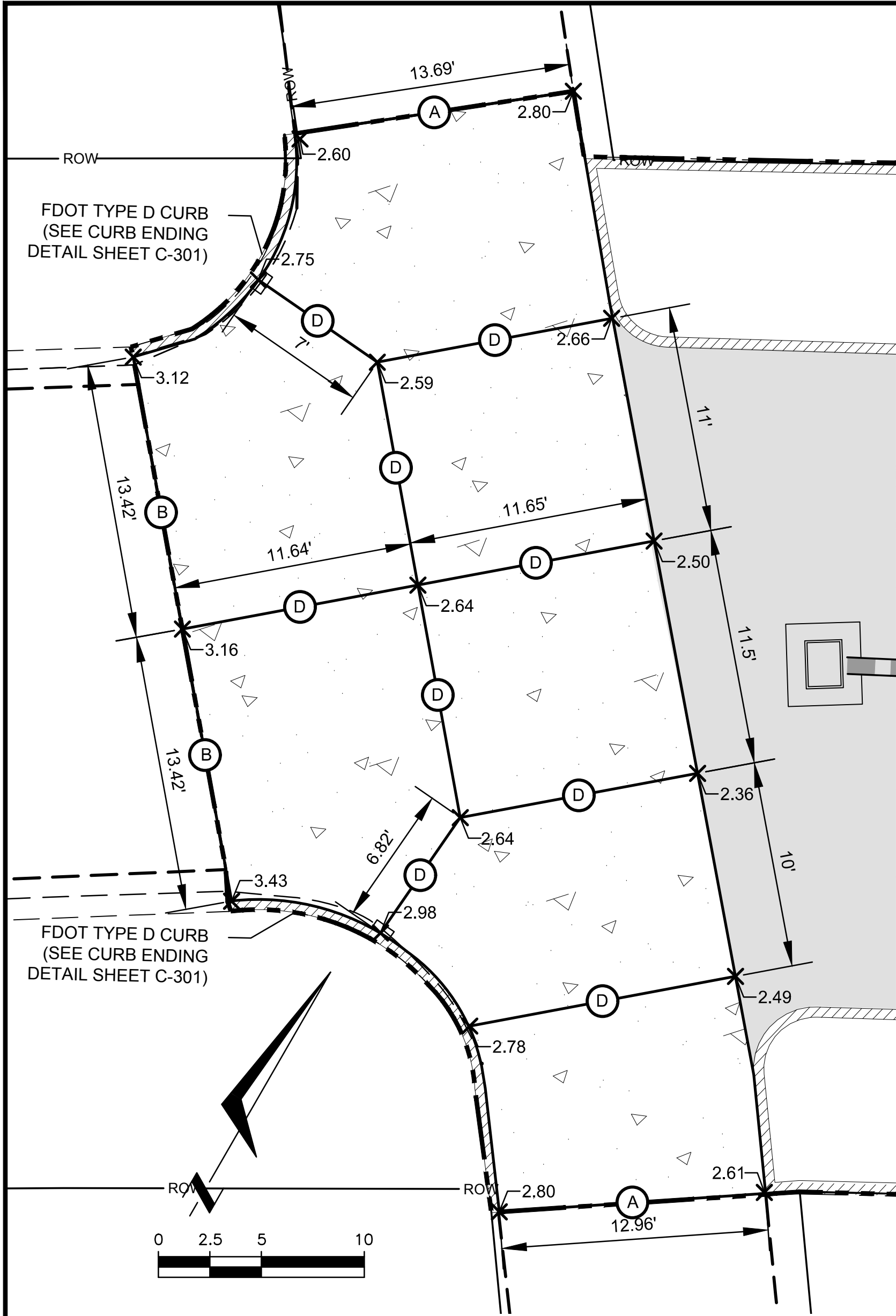

JOINT LAYOUT PLAN

N.T.S.

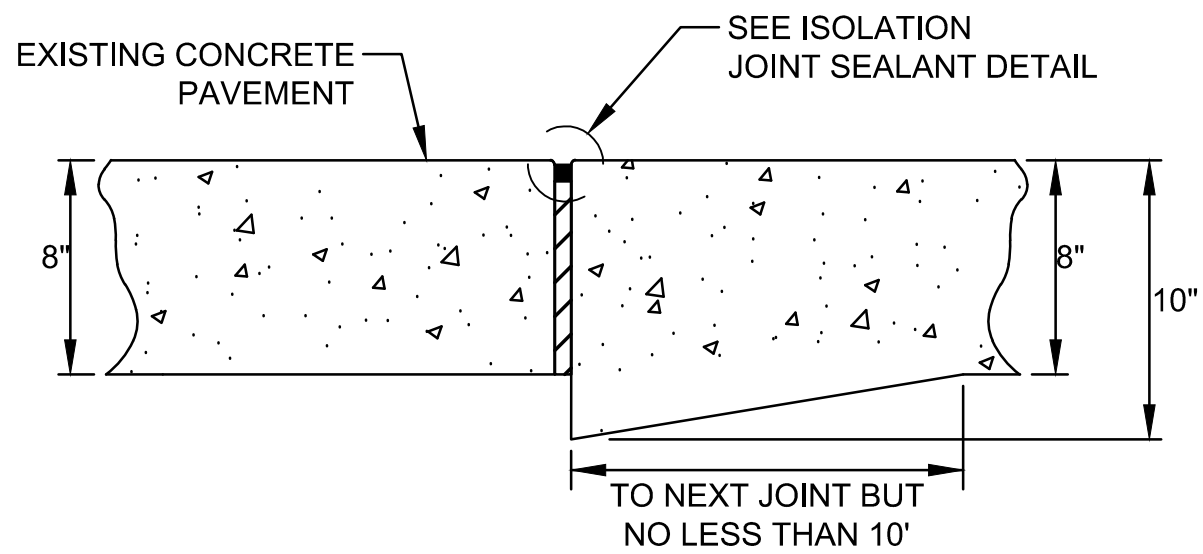

THICKENED EDGE ISOLATION JOINT DETAIL (TYPE A)

N.T.S.

LEGEND	
(A) THICKENED EDGE ISOLATION JOINT (TYPE A)	(D) DOWELED CONTRACTION /CONSTRUCTION JOINT (TYPE D)
(B) CONSTRUCTION JOINT PCC/ASPHALT JUNCTURE (TYPE B)	8" CONCRETE PAVEMENT (FDOT 350)

- NOTES:
1. ALL ELEVATIONS SHOWN INDICATE THE EDGE OF PAVEMENT.
 2. TYPE B JOINTS MAY BE DOWELED CONTRACTION OR CONSTRUCTION JOINTS, TO BE DECIDED BY THE CONTRACTOR.

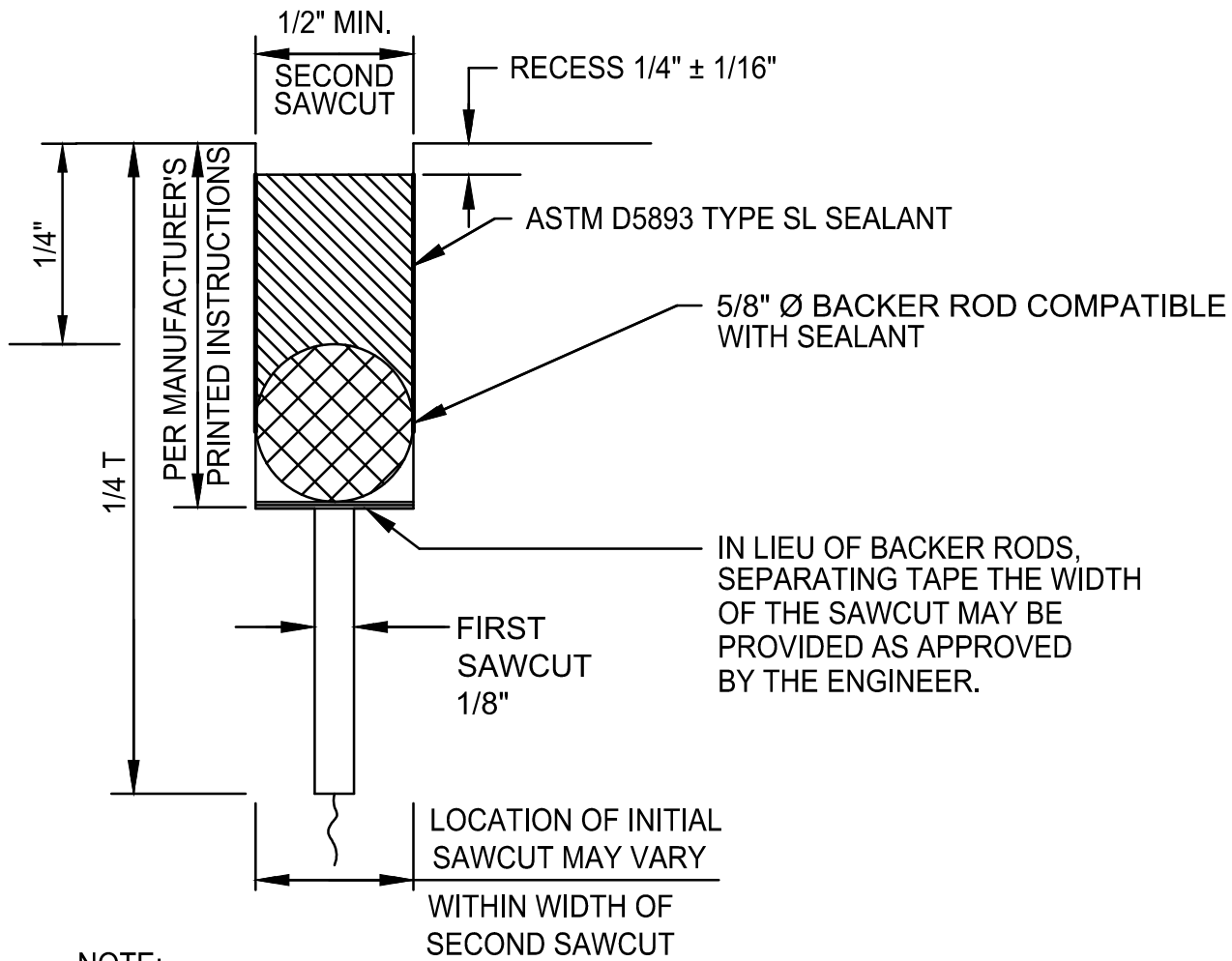

NOTE:
ALL SEALANT MATERIALS MUST BE INSTALLED IN ACCORDANCE WITH MANUFACTURER'S PRINTED INSTRUCTIONS AS APPROVED BY ENGINEER.

STEP SAWED CONTRACTION JOINT

N.T.S.

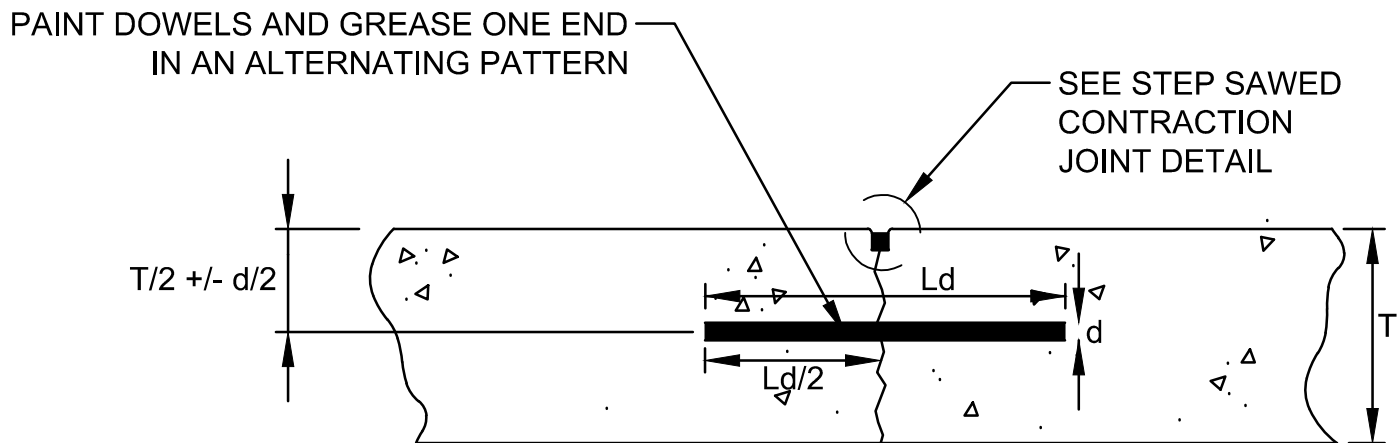

DOWELED CONTRACTION JOINT (TYPE D)

N.T.S.

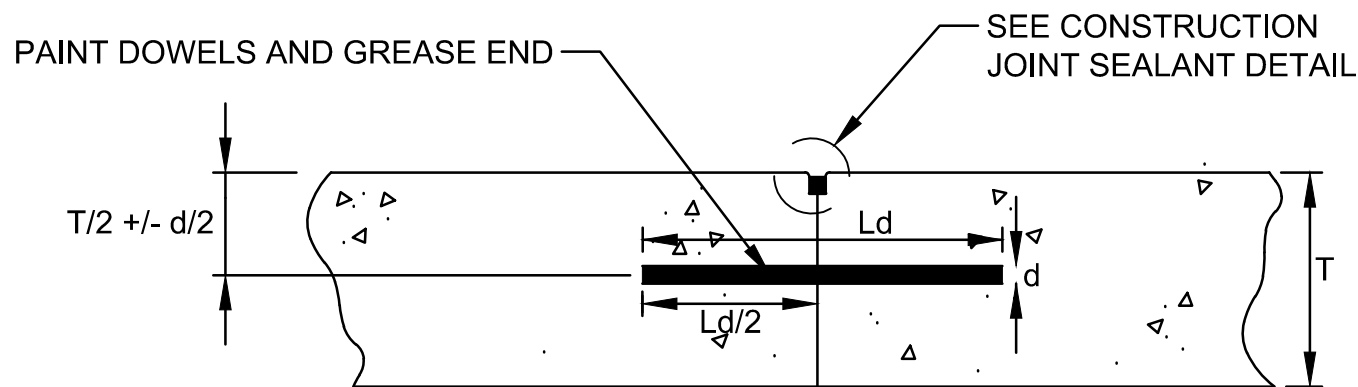

DOWELED CONSTRUCTION JOINT (TYPE D)

N.T.S.

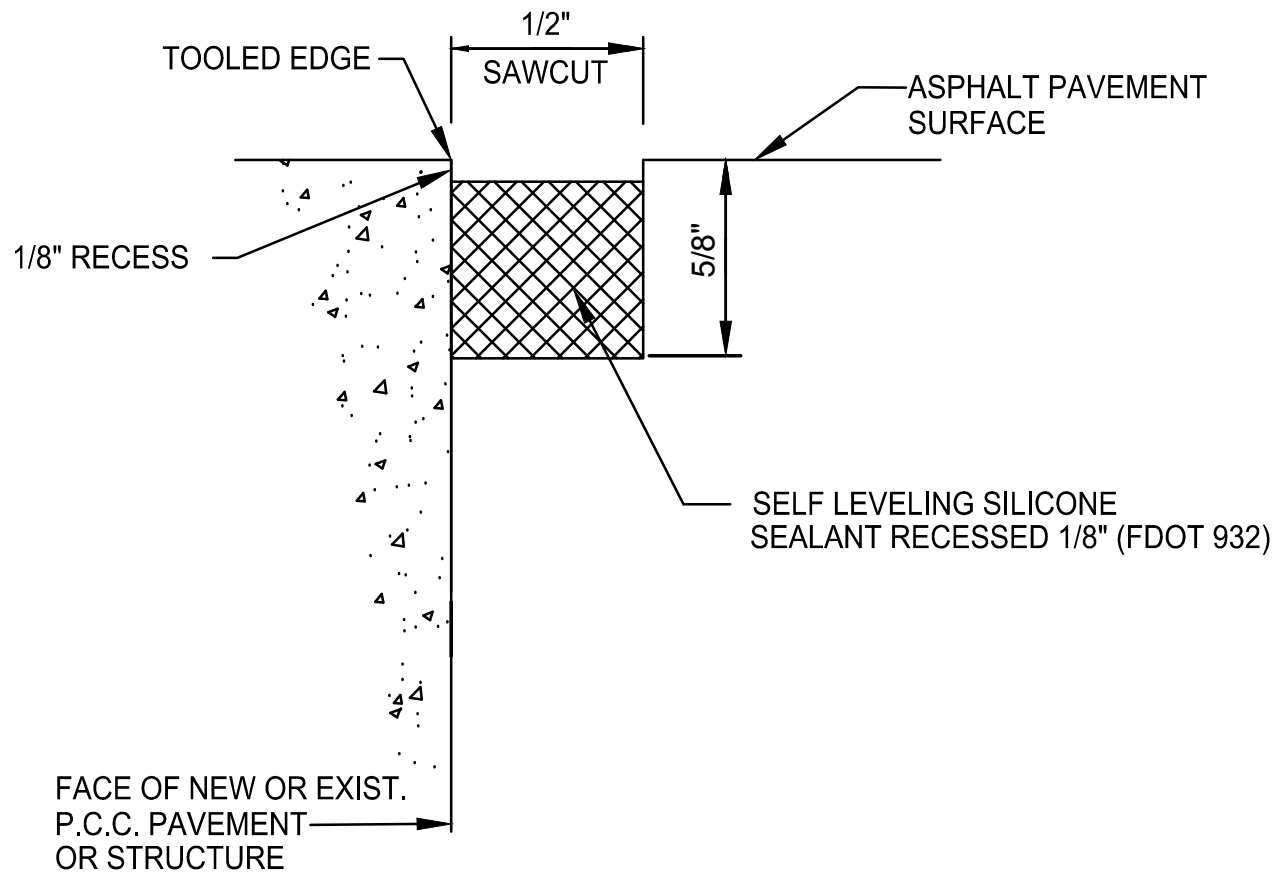

CONSTRUCTION JOINT P.C.C/ASPHALT JUNCTURE (TYPE B)

N.T.S.

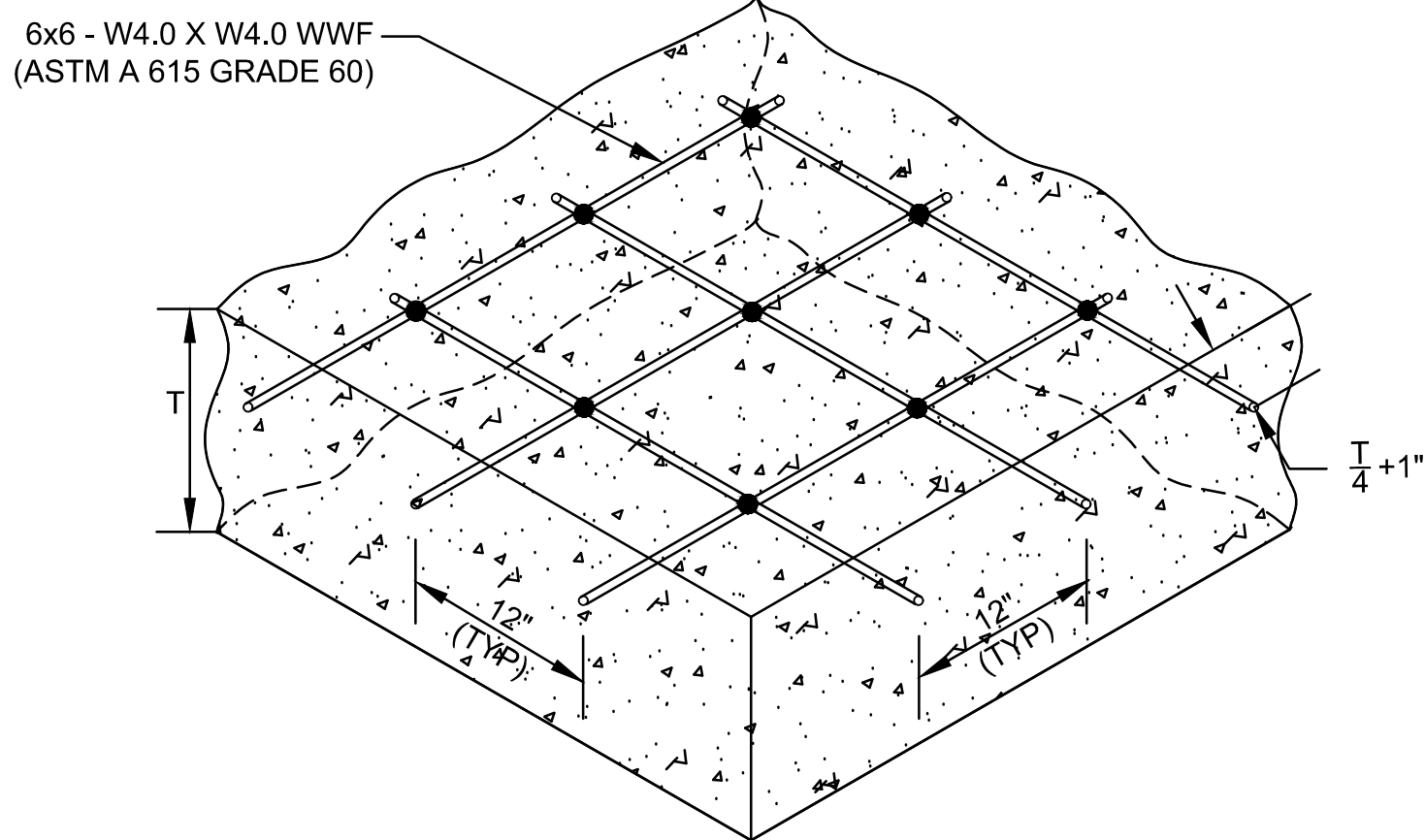

SLAB REINFORCEMENT DETAIL

N.T.S.

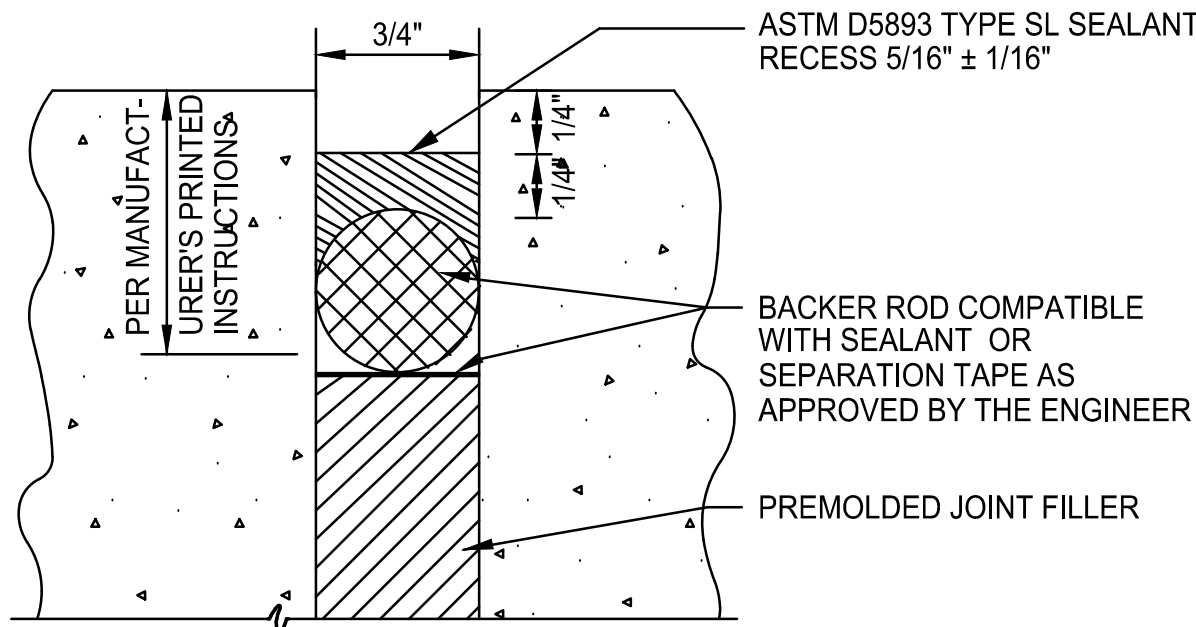

NOTE:
ALL SEALANT MATERIALS MUST BE INSTALLED IN ACCORDANCE WITH MANUFACTURER'S PRINTED INSTRUCTIONS AS APPROVED BY ENGINEER.

ISOLATION JOINT SEALANT

N.T.S.

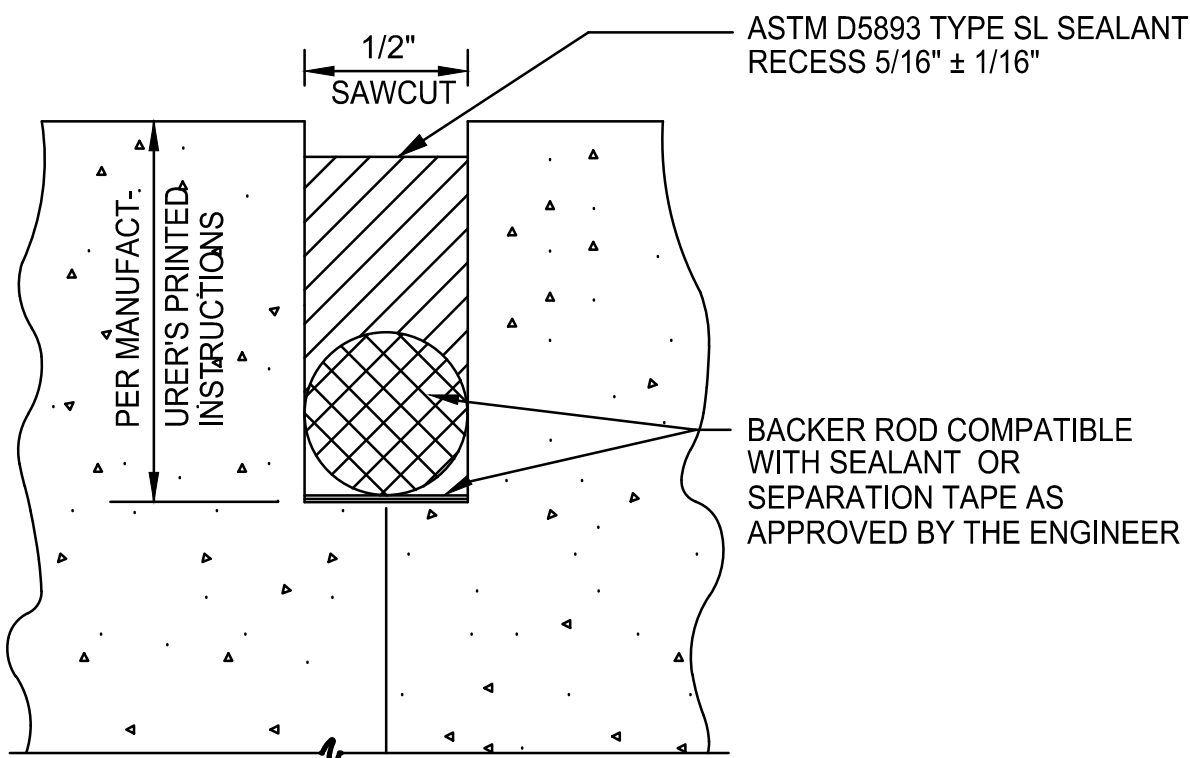

NOTE:
ALL SEALANT MATERIALS MUST BE INSTALLED IN ACCORDANCE WITH MANUFACTURER'S PRINTED INSTRUCTIONS AS APPROVED BY ENGINEER.

CONSTRUCTION JOINT SEALANT

N.T.S.

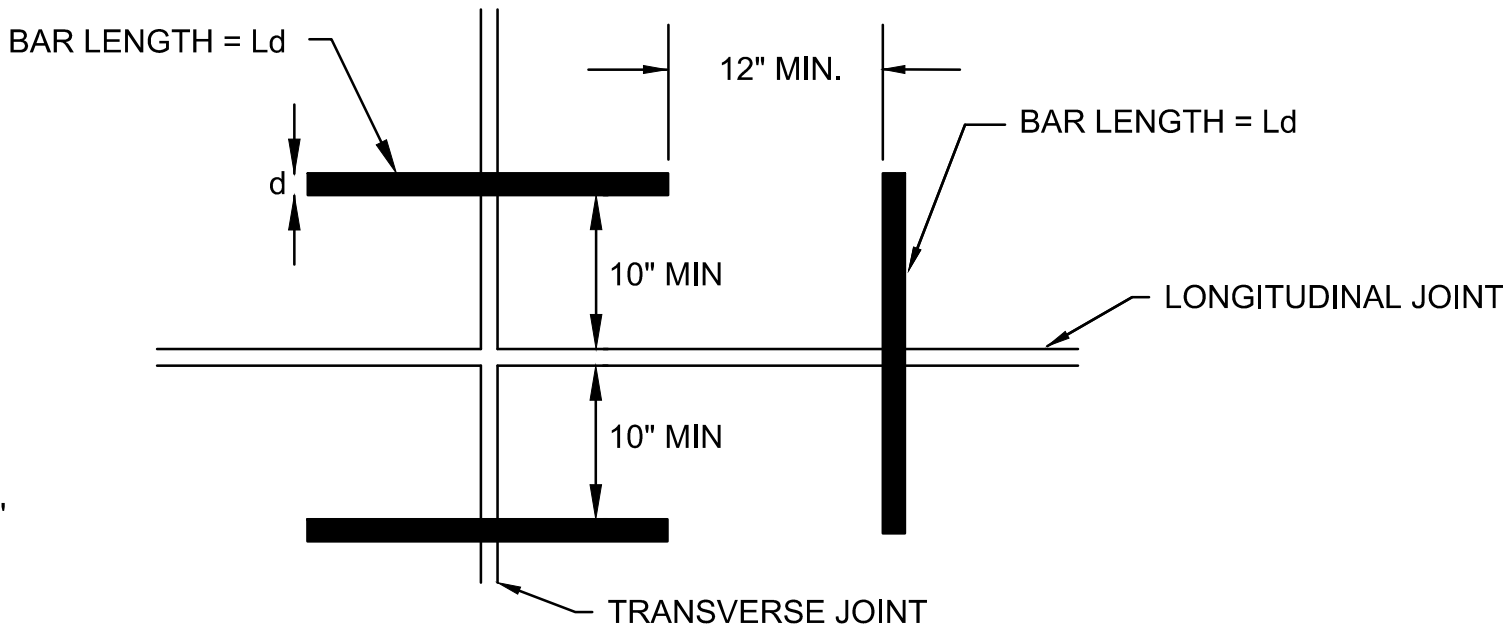

JOINT NOTES:
T= 8 INCHES
D = 1 INCH
Ld = 18 INCHES
DOWEL SPACING FOR ALL DOWELED JOINTS IS 12 INCHES O.C.
ALL DOWELS AND TIE BARS SHALL BE GRADE 60 STEEL

NOTE:
THE CONTRACTOR SHALL PROVIDE THE MAXIMUM NUMBER OF DOWEL BARS IN BOTH LONGITUDINAL AND TRANSVERSE JOINTS WHILE STILL MEETING THE MINIMUM CLEARANCES SHOWN IN THIS DETAIL.

DOWEL BARS AT SLAB CORNERS

N.T.S.



CITY OF
TREASURE ISLAND
FLORIDA

Michael Baker
INTERNATIONAL
Michael Baker International, Inc.

4211 WEST BOY SCOUT BLVD., SUITE 500
TAMPA, FLORIDA 33607 (813) 889-3892
CERTIFICATE OF AUTHORIZATION NUMBER 28861

Designer:
SMR
Technician:
AF
Checked by:
NEP
BAKER Project Number:
168828

NATHAN PARISH
FLORIDA P.E. NO. 68317

Notes:
1. REFER TO SHEET
C-351 FOR SECTIONS.

Revision No.	Description	Date	By

Project Name:
**BEAUTIFICATION OF
125TH AVE.**

Drawing Name:
JOINT LAYOUT PLAN

CITY OF TREASURE ISLAND PROJECT NUMBER:

Date:
NOVEMBER 2018

Issue:

Scale:
AS SHOWN

Sheet Number:
C-302

\\TAMPL1FS1\Tampa\Projects\Treasure Island, FL\125thAve-at-Lagoon\InEnd\Terminus\CADD-dwg\008 (C-351)_Typical Sections and Site Details.dwg November 27 2018 11:26

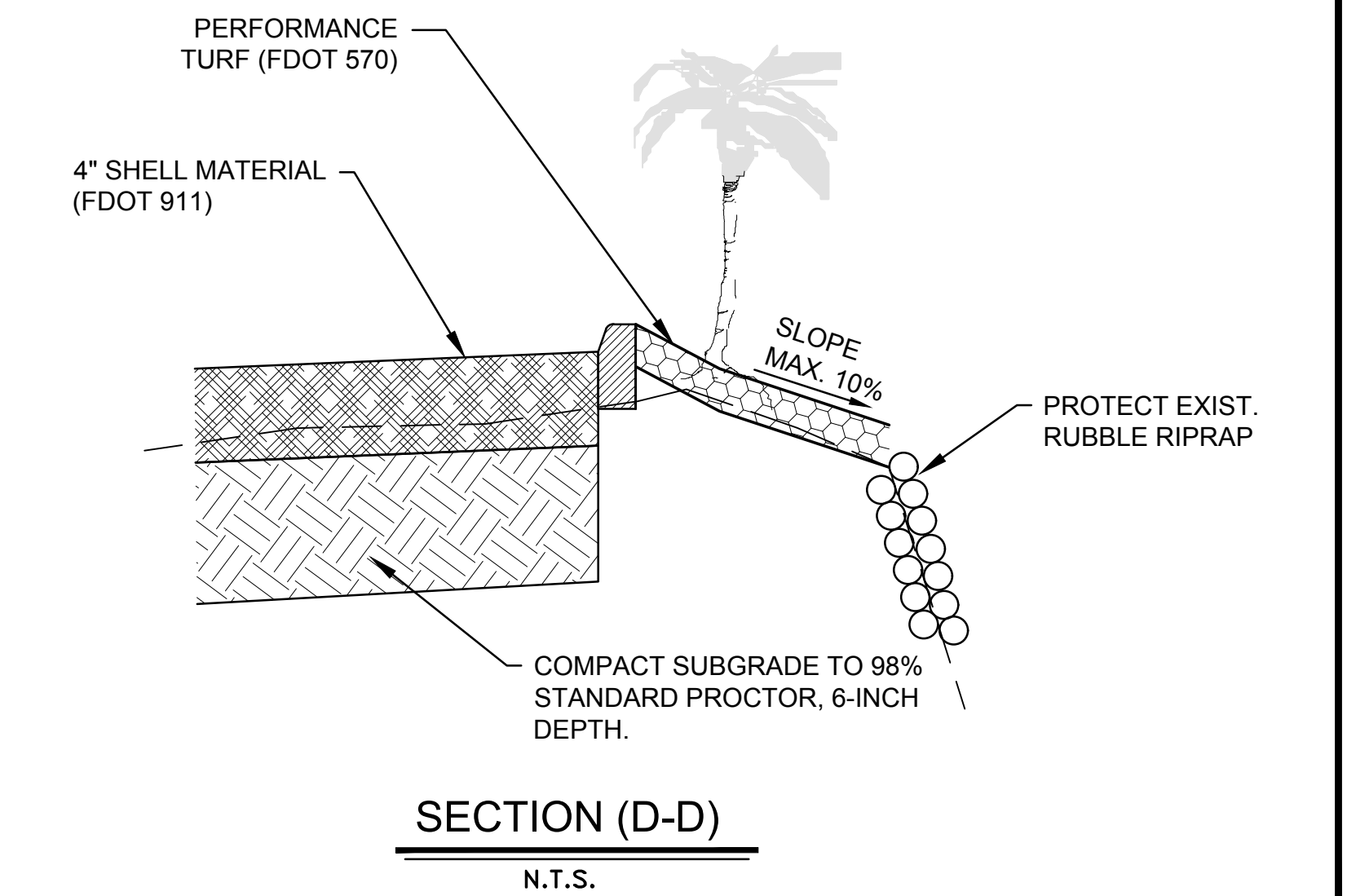
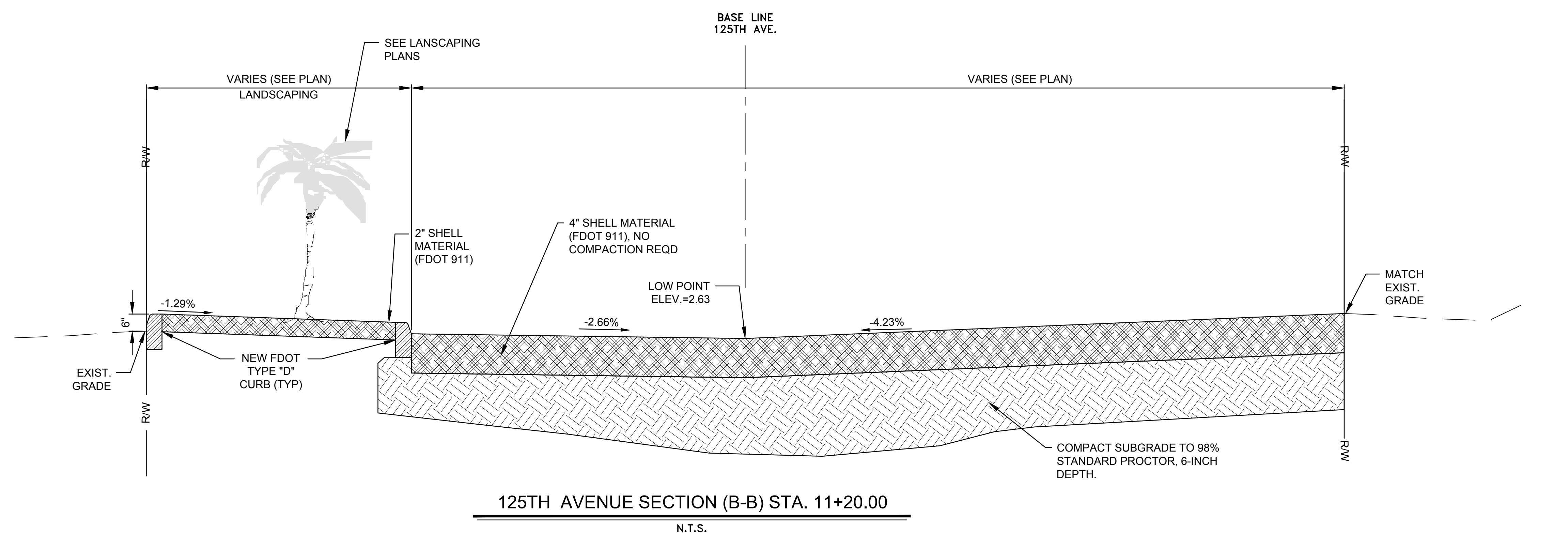
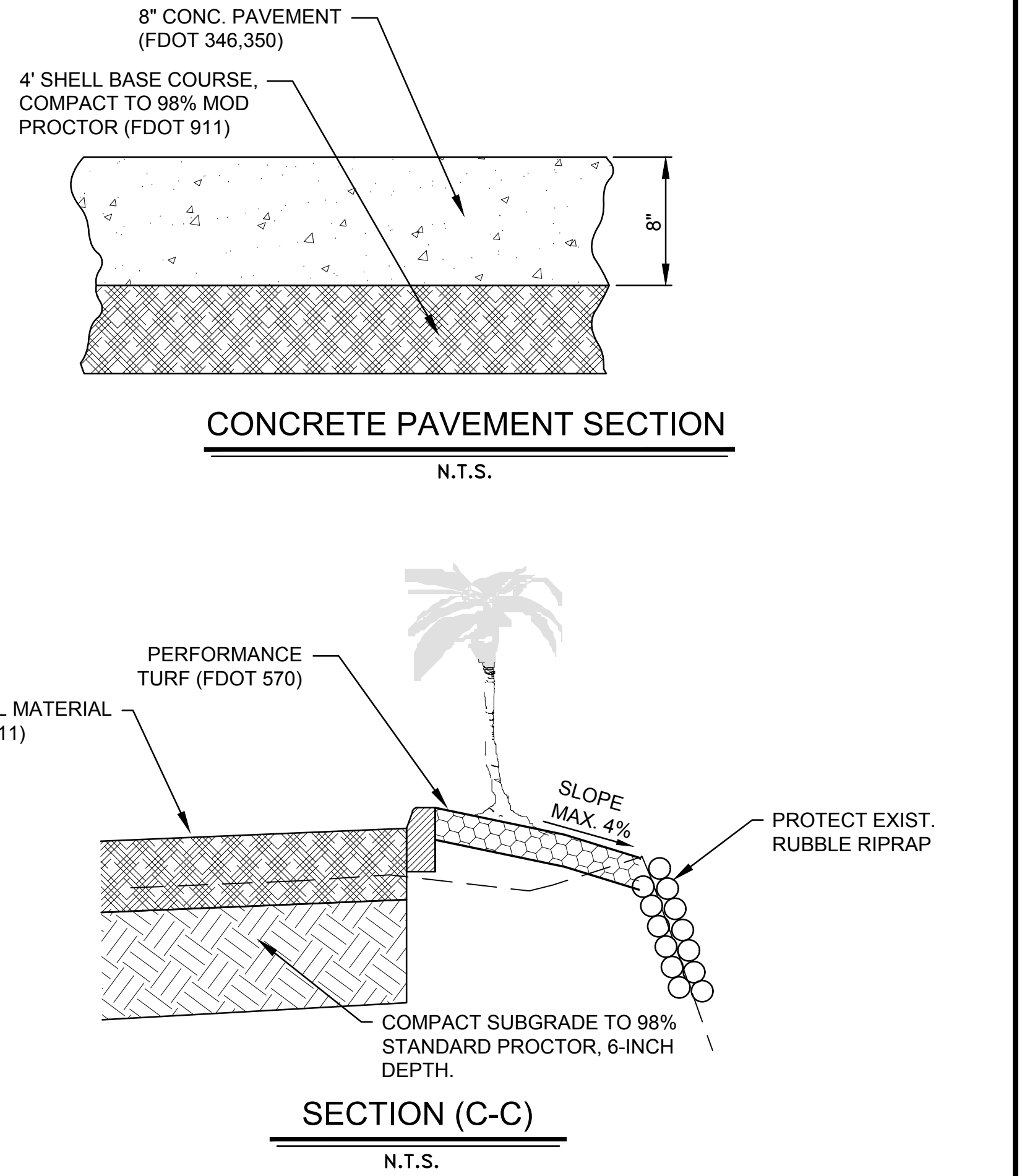
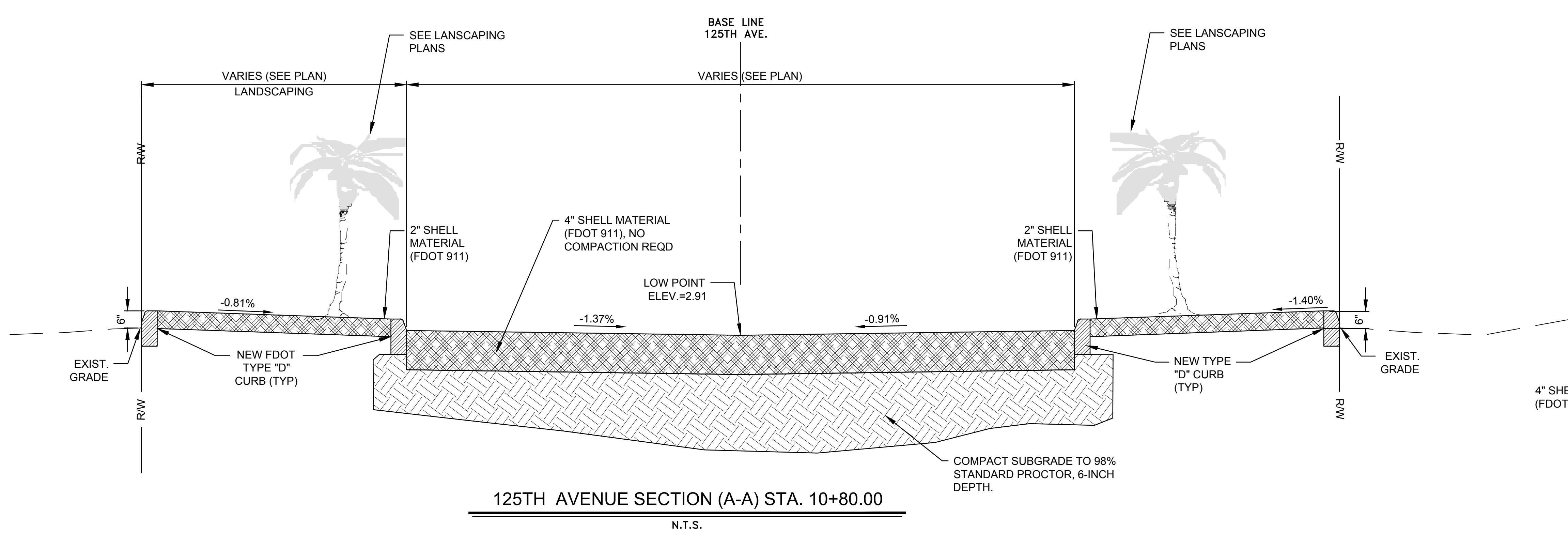

CITY OF
TREASURE ISLAND
FLORIDA

Michael Baker
INTERNATIONAL
Michael Baker International, Inc.
4211 WEST BOY SCOUT BLVD., SUITE 500
TAMPA, FLORIDA 33607 (813) 889-3892
CERTIFICATE OF AUTHORIZATION NUMBER 28861

Designer:
SMR
Technician:
AF
Checked by:
NEP
BAKER Project Number:
168828

NATHAN PARISH
FLORIDA P.E. NO. 68317

Notes:

Revision No.	Description	Date	By

Project Name:

BEAUTIFICATION OF
125TH AVE.

Drawing Name:

TYPICAL SECTIONS

CITY OF TREASURE ISLAND PROJECT NUMBER:

Date:
NOVEMBER 2018

Issue:

Scale:
AS SHOWN

Sheet Number:
C-351

\\TAMPL1FS1\Tampa\Projects\Treasure Island, FL\125thAve-at-Lagoon\atEnd\Terminus\CADD-dwg\009 (C-5352)_Drainage and Erosion Control Details.dwg November 27 2018 11:28

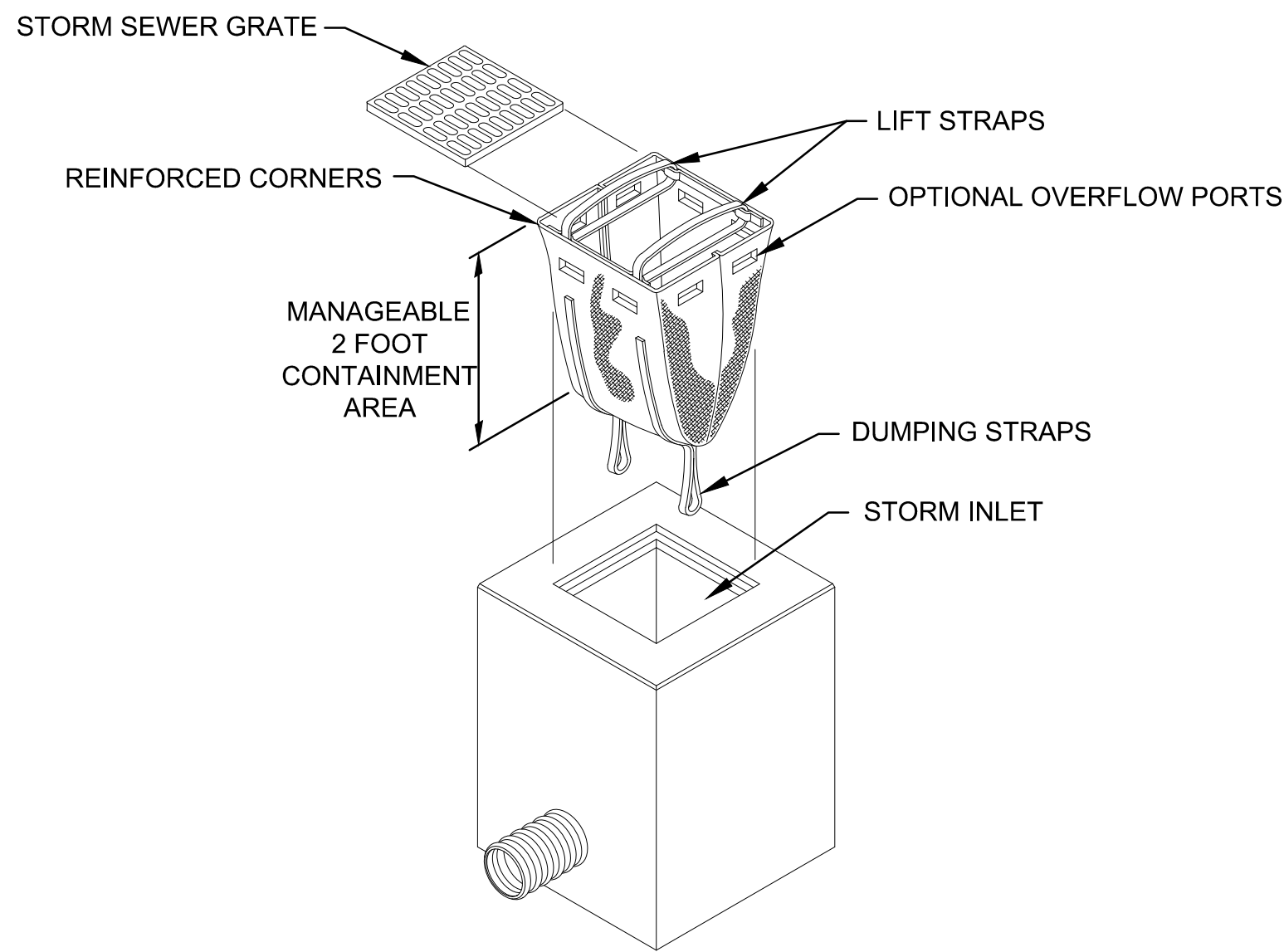

1. TEMPORARY INLET PROTECTION SHALL BE DANDY SACK BY DANDY PRODUCTS OR APPROVED EQUIVALENT.
2. FILTER SACK SHALL BE CLEANED AFTER ALL RAINFALL EVENTS & INSPECTED REGULARLY.

TEMPORARY INLET PROTECTION

N.T.S.

NOTE:
ALL PIPE JOINTS SHALL BE WRAPPED WITH A MINIMUM OF 3 LF OF NON-WOVEN FILTER FABRIC, 12" MIN. OVERLAP. COST IS INCIDENTAL TO PIPE INSTALLATION.

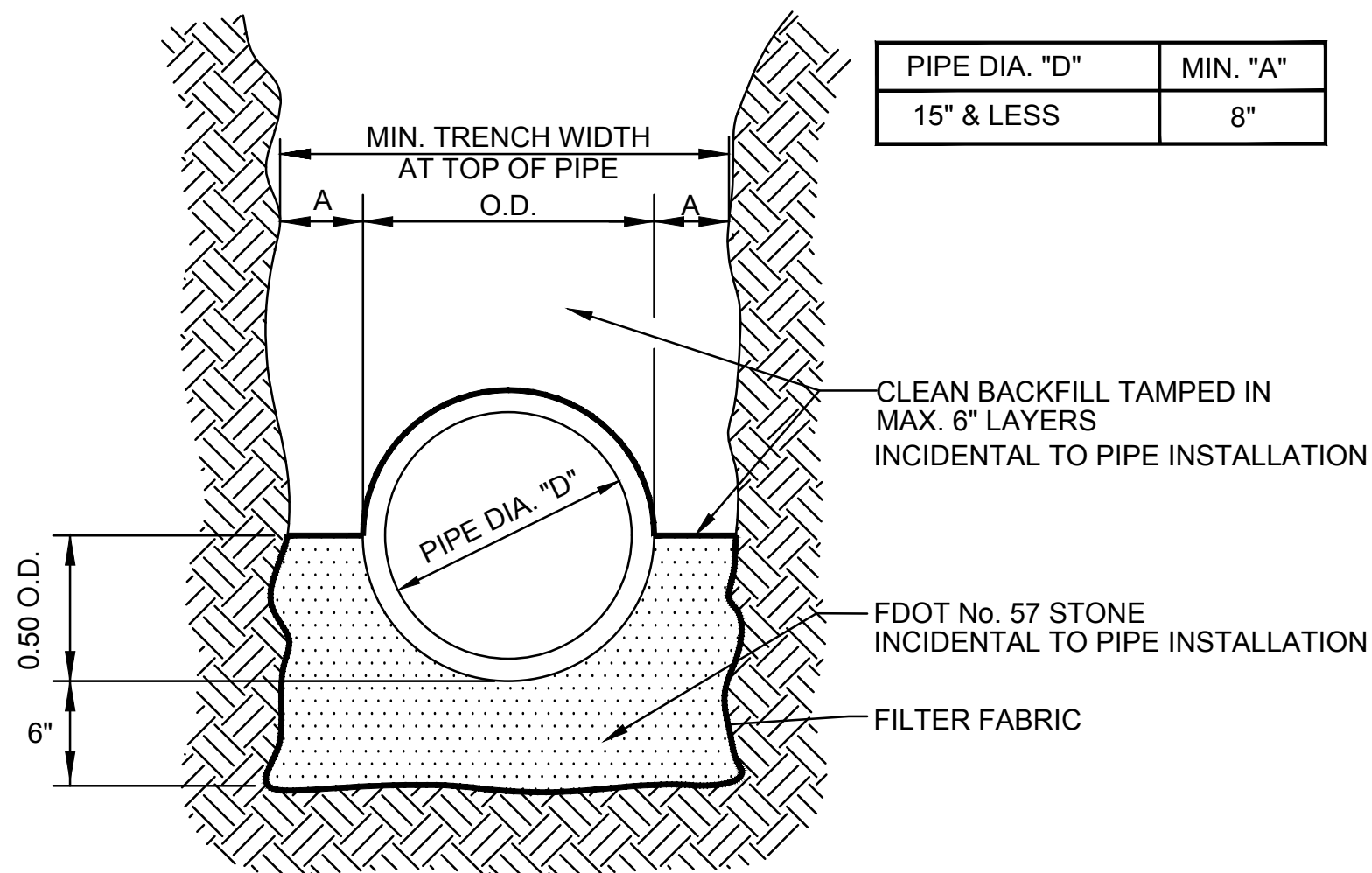

DRAINAGE PIPE BEDDING

N.T.S.

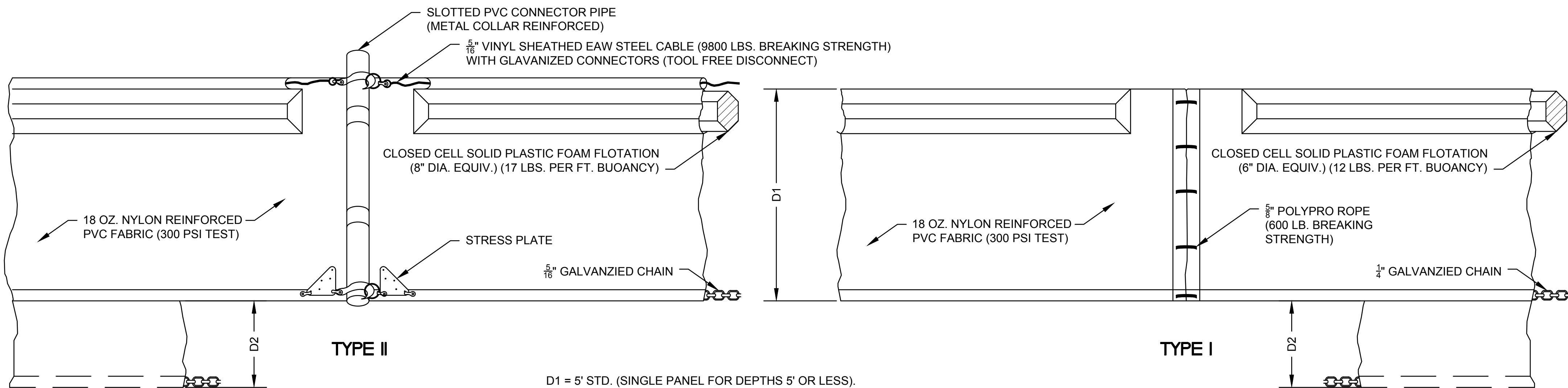

D1 = 5' STD. (SINGLE PANEL FOR DEPTHS 5' OR LESS).
D2 = 5' STD. (ADDITIONAL PANEL FOR DEPTHS > 5').
CURTAIN TO REACH BOTTOM UP TO DEPTHS OF 10 FEET. TWO (2) PANELS TO BE USED FOR DEPTHS GREATER THAN 10 FEET UNLESS SPECIAL DEPTH CURTAINS SPECIFICALLY CALL FOR IN THE PLANS OR AS DETERMINED BY THE ENGINEER..

NOTICE: COMPONENTS OF TYPES I AND II MAY BE SIMILAR OR IDENTICAL TO PROPRIETARY DESIGNS. ANY INFRINGEMENT ON THE PROPRIETARY RIGHTS OF THE DESIGNER SHALL BE THE SOLE RESPONSIBILITY OF THE USER.
SUBSTITUTES FOR TYPES I AND II SHALL BE AS APPROVED BY THE ENGINEER.

FLOATING TURBIDITY BARRIER

N.T.S.



CITY OF
TREASURE ISLAND
FLORIDA

Michael Baker

INTERNATIONAL
Michael Baker International, Inc.

4211 WEST BOY SCOUT BLVD., SUITE 500
TAMPA, FLORIDA 33607 (813) 889-3892
CERTIFICATE OF AUTHORIZATION NUMBER 28861

Designer:
SMR
Technician:
AF
Checked by:
NEP
BAKER Project Number:
168828

NATHAN PARISH
FLORIDA P.E. NO. 68317

Notes:

Revision No.	Description	Date	By

Project Name:

BEAUTIFICATION OF
125TH AVE.

Drawing Name:

DRAINAGE AND EROSION
CONTROL DETAILS

CITY OF TREASURE ISLAND PROJECT NUMBER:





Date:
NOVEMBER 2018

Issue:

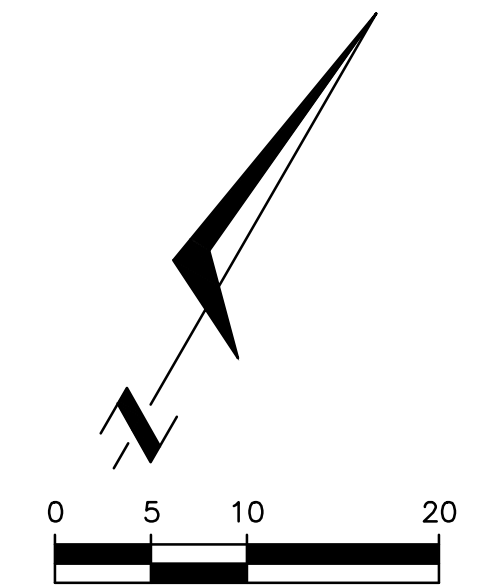
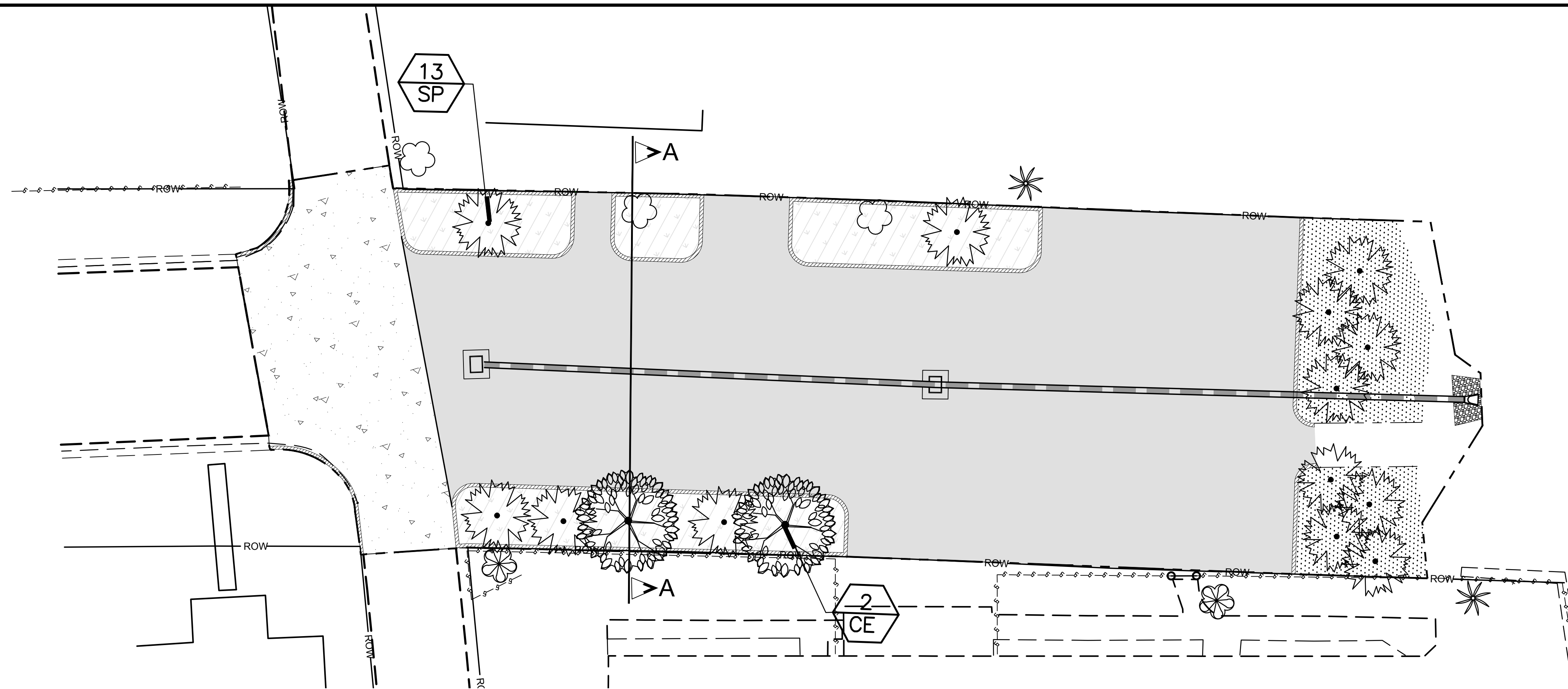
Scale:
AS SHOWN

Sheet Number:
C-352

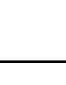

LEGEND	
	PROPOSED 4" SHELL MATERIAL (FDOT 911)
	PROPOSED LANDSCAPING & 2" SHELL MATERIAL (FDOT 911)
	PROPOSED PERFORMANCE TURF (FDOT 570)
	8" CONCRETE PAVEMENT (FDOT 350)
	PROPOSED TYPE D CURB, FDOT INDEX 520-001

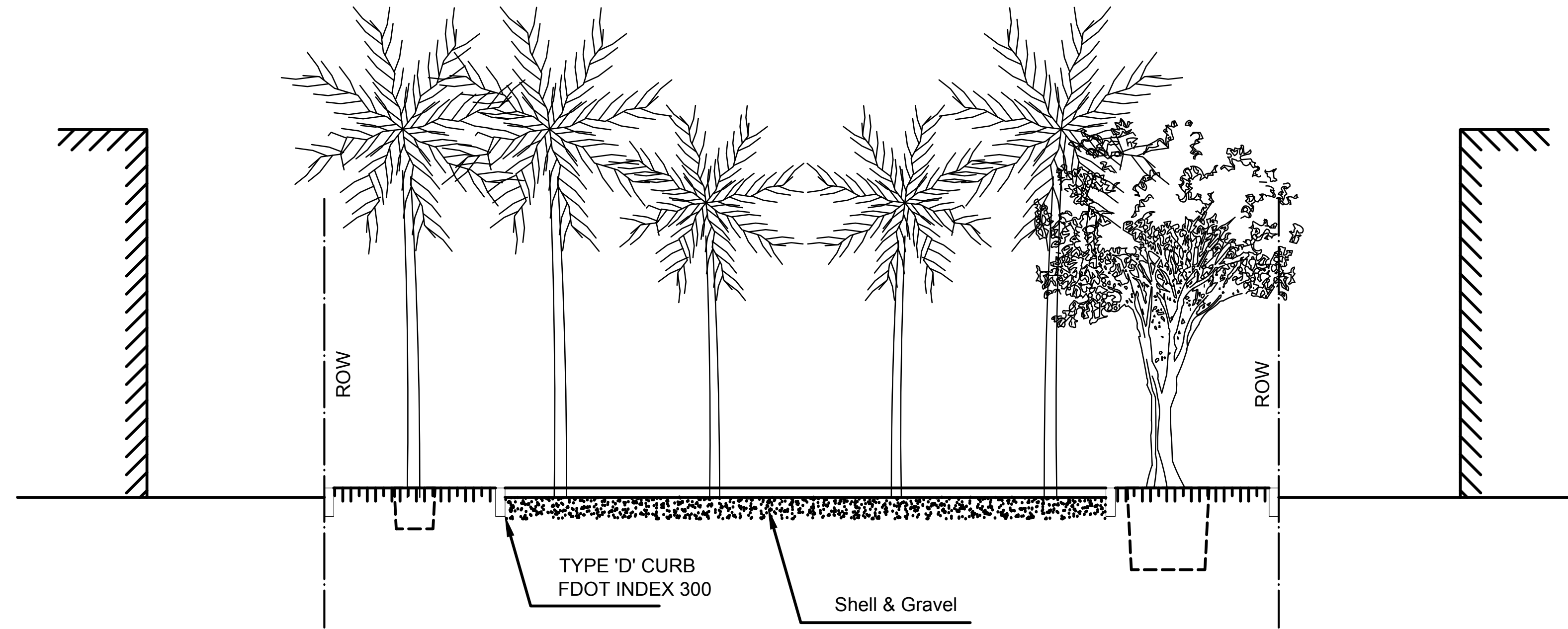

SECTION - A-A' 125TH AVE.
NTS



CITY OF
TREASURE ISLAND
FLORIDA

Michael Baker
I N T E R N A T I O N A L
Michael Baker International, Inc.
4211 WEST BOY SCOUT BLVD., SUITE 500
TAMPA, FLORIDA 33607 (813) 889-3892
CERTIFICATE OF AUTHORIZATION NUMBER 2886

Designer:	SMR
Technician:	AF
Checked by:	NEP
BAKER Project Number:	168828

NATHAN PARISH
FLORIDA P.E. NO. 68317

Notes:

[illegible]

Project Name:

**BEAUTIFICATION OF
125TH AVE.**

Drawing Name:

LANDSCAPING AND SITE DETAILS

CITY OF TREASURE ISLAND PROJECT NUMBER:

Date: NOVEMBER 2018

Scale: AS SHOWN

Issue: _____

Sheet Number:
L-101

\\TAMPELIFS1\Tampc\Projects\Treasure Island, FL\25thAve-at-LagoonLnEnd\Terminus\CADD-dwg\011 (L-102)_Landscaping.dwg November 27 2018 -- 11:45

PLANT SCHEDULE

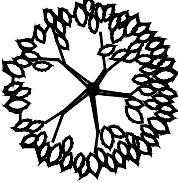
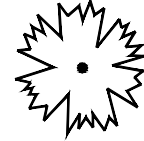
TREES	CODE	BOTANICAL/COMMON	CONT. SIZE	DIMENSIONS	QTY	REMARKS
	CE	CONOCORPUS ERECTUS / GREEN BUTTONWOOD	36" BOX	14' OH	2	WELL FOLIATED WITH UPRIGHT BRANCH STRUCTURE
	SP	SABAL PALMETTO / CABBAGE PALMETTO	36" BOX	12-16' CT	13	SLICK TRUNK - VARY HEIGHTS ALONG THE END OF THE LIMEROCK

LANDSCAPE GENERAL NOTES:

1. LOCATE ALL UNDERGROUND UTILITIES AND FIELD CHECK ALL DIMENSIONS PRIOR TO ANY LANDSCAPE OR IRRIGATION INSTALLATION. REPORT ANY CONFLICTS AND DISCREPANCIES TO LANDSCAPE ARCHITECT & CITY. TAKE RESPONSIBILITY TO PROVIDE APPLICABLE SEPARATION BETWEEN PROPOSED / EXISTING UTILITIES AND LANDSCAPE WORKS.
- 2.CONSTRUCTION MUST COMPLY WITH LANDSCAPE PLAN SPECIFICATIONS AND CONFORM WITH FLORIDA DEPARTMENT OF TRANSPORTATION STANDARD SPECIFICATIONS FOR ROAD AND BRIDGE CONSTRUCTION, DATED 2017 AND SUPPLEMENTS THERETO, PRIMARILY SECTION 580. ANY CONSTRUCTION NOT IN COMPLIANCE WILL BE REJECTED BY THE LANDSCAPE ARCHITECT AND REPLACED WITH PROPER INSTALLATION COMPLETED BY THE CONTRACTOR AT NO ADDITIONAL COST.
- 3.INSTALL ONLY PLANTS GRADED FLORIDA #1 OR BETTER AS SET FORTH IN THE FLORIDA DEPARTMENT OF AGRICULTURE "GRADES AND STANDARDS FOR NURSERY PLANTS" SECOND ADDITION: FEBRUARY 1998 AND WHICH MEET OR EXCEED THE SIZES INDICATED ON THE TABULATION OF QUANTITIES SHEET AND IN THE DETAILS. ALL PLANTS SHALL CONFORM TO NURSERY STOCK STANDARDS BY THE AMERICAN ASSOCIATION OF NURSERYMEN.
- 4.FOLLOW MANUFACTURERE'S SPECIFICATIONS FOR APPLICATION. FERTILIZE PALMS WITH SPECIAL PALM FERTILIZER CONTAINING MANGANESE AND MAGNESIUM PER MANUFACTURER'S DIRECTION. ALL FERTILIZER SHALL COMPLY WITH SECTION 982. FURNISH RECEIPTS FOR MATERIAL USED.
- 5.PREPARE ALL PLANTING BEDS IN ACCORDANCE WITH SECTION 580-4.4 FDOT STANDARD SPECIFICATIONS (FDOT SS). MIX IN 6" LAYER OF FINISH SOIL IN ALL PLANTING BEDS TO 18" DEPTH. FINISH SOIL MUST COMPLY WITH SECTION 987 FDOT SS.
- 6.BACKFILL ALL TREE PLANTING PITS WITH THE FOLLOWING MIXTURE: ½ ON-SITE SOIL, ½ CLEAN FRIABLE SANDY-LOAM TOPSOIL IN COMPLIANCE WITH SECTION 987-2.2 FDOT SS. SUBMIT SAMPLES FOR APPROVAL BY LANDSCAPE ARCHITECT (SEE PLANTING DETAILS).
- 7.FERTILIZE ALL PLANTING BEDS WITH APPROX. RATIO OF 4-1-2. APPLY AT RATE SPECIFIED BY MANUFACTURER. FURNISH RECEIPTS FOR MATERIALS USED.
- 8.TREAT ALL PLANTING BEDS WITH PRE-EMERGENT AND POST-EMERGENT HERBICIDES ACCORDING TO THE MANUFACTURER'S SPECIFICATIONS. SUBMIT RECEIPTS FOR MATERIALS USED.
- 9.MULCH PLANTING BEDS TO A MINIMUM 3" THICKNESS WITH CLEAN, INSECT-FREE FLORIMULCH OR APPROVED EQUAL. DO NOT COVER BRANCHES, LEAVES OR STEMS; KEEP AIRSPACE AROUND TRUNKS (MIN. 6"). WATER-IN WELL TO SECURE IN PLACE.
- 10.VERIFY ALL QUANTITIES IN THE PLANTING SCHEDULE AND INSTALL ALL PLANTS AND MATERIAL AS INDICATED IN THE PLAN. PROVIDE UNIT PRICES FOR EACH ITEM. UNIT COST FOR EACH PLANT IS TO INCLUDE ALL LABOR FOR SITE PREPARATION TREATMENTS, EXCAVATION STAKING & GUYING, ETC.
- 11.NOTIFY THE ENGINEER AND LANDSCAPE ARCHITECT OF ANY UNFORESEEN CONDITIONS I.E. COMPACTED SOIL/SUBGRADE, POOR DRAINAGE, UTILITY CONFLICTS, ETC., PRIOR TO PROCEEDING WITH LANDSCAPE OR IRRIGATION INSTALLATION.
- 12.GUARANTEE ALL PLANTS FOR ONE YEAR IN ACCORDANCE WITH SECTION 580-11 PLANT ESTABLISHMENT PERIOD AND CONTRACTOR'S WARRANTY, FDOT SS.
- 13.ALL PLANTS. MATERIALS AND WORKMANSHIP ARE SUBJECT TO THE APPROVAL OF THE CITY AND LANDSCAPE ARCHITECT.
- 14.THE LOCATIONS OF PLANTINGS SPECIFIED ON THIS PLAN ARE FINAL, BUT MAY BE ADJUSTED TO ACCOMMODATE UNFORESEEN FIELD CONDITIONS, TO COMPLY WITH HORIZONTAL CLEARANCE AND CLEAR-SIGHT REQUIREMENTS, OR AS DIRECTED/APPROVED BY THE CITY ENGINEER. PLANT MATERIAL AND INSTALLATION AND MAINTENANCE SHALL BE IN COMPLIANCE WITH FDOT STANDARDS INDICES 544 AND 546 AND CLEAR ZONE REQUIREMENTS OF FDOT PLANS PREPARATION MANUAL AND FLORIDA HIGHWAY LANDSCAPE GUIDE.
- 15.DO NOT MAKE SUBSTITUTIONS OR REVISIONS. ANY REVISIONS OR MODIFICATIONS TO THE LANDSCAPE PLAN MUST HAVE PRIOR APPROVAL BY THE LANDSCAPE ARCHITECT, CITY ENGINEER AND PERMITTING AUTHORITY. REVISIONS MUST BE DOCUMENTED AS REQUIRED BY APPLICABLE STATE, CITY OR COUNTY REGULATIONS.
- 16.FINISH GRADE FOR ALL PLANTING AREA ADJACENT TO PAVEMENT SHALL PROVIDE THE 1" DROP-OFF, AS REQUIRED IN FDOT STANDARD INDEX 105.



CITY OF
TREASURE ISLAND
FLORIDA

Michael Baker

INTERNATIONAL

Michael Baker International, Inc.

4211 WEST BOY SCOUT BLVD., SUITE 500

TAMPA, FLORIDA 33607 (813) 889-3892

CERTIFICATE OF AUTHORIZATION NUMBER 28861

Designer: SMR
Technician: AF
Checked by: NEP
BAKER Project Number: 168828

NATHAN PARISH
FLORIDA P.E. NO. 68317

Notes:

Revision No.	Description	Date	By

Project Name:

BEAUTIFICATION OF
125TH AVE.

Drawing Name:

LANDSCAPING PLANTING
SCHEDULE AND NOTES

CITY OF TREASURE ISLAND PROJECT NUMBER:	
Date: NOVEMBER 2018	Issue: ---
Scale: AS SHOWN	Sheet Number: L-102