

**OFFICE OF THE SULLIVAN COUNTY PURCHASING AGENT  
3411 HIGHWAY 126 – SUITE 201  
BLOUNTVILLE, TN 37617-0569**

**KRISTINIA DAVIS  
PURCHASING AGENT**

PHONE 423/323-6400

FAX 423/323-7249

[Kris.davis@sullivancountytn.gov](mailto:Kris.davis@sullivancountytn.gov)

**DISPOSITION OF REAL PROPERTY  
Holston Ballfield Property  
Located 238 Maple Street (across from Old Holston School)  
Blountville, TN 37617**

**by  
SEALED BIDS  
#HBP2020(KD)**

**Holston Ballfield Property Located at 238 Maple Street  
(across from Old Holston School), Blountville, Tennessee to be Sold by Sealed Bid**

Sealed bids shall be received by the Sullivan County Purchasing Agent for real property thereon generally known as “Holston Ballfield Property” until **2:00 p.m. on Wednesday, May 27, 2020** at which time all bids received will be publicly opened and read aloud. In the event the winning bid is tied among bidders a bid off will be conducted amongst the tie bids. All bids must be received at the Office of the Sullivan County Purchasing Agent, Attn: Kristinia Davis, Purchasing Agent, 3411 Highway 126, Suite 201, Blountville, Tennessee 37617. Each bidder shall be responsible for the delivery of their bid by the above listed date and time. Sealed bids must be delivered by U.S. Postal Service, Courier, or Private Carrier Service, (i.e. FedEx, UPS) on or before the opening day/time. Sullivan County is not responsible for delays by mail or courier. **Late bids will not be accepted!!!**

**ONLINE SUBMISSIONS ALLOWED:** In addition to acceptance of sealed bids received by U.S. Postal Service, Courier, or Private Carrier Service, the County will allow online submissions of the bid. The following instructions provide the process for submitting your bid online. Submitting online does not excuse the requirements for submissions of bids by 2:00 p.m. and no late bids will be accepted.

**Electronic Submission Procedures:**

Electronic submissions shall be submitted online through Vendor Registry. If submitting online, **DO NOT EMAIL YOUR SUBMISSION**. All bidders must register as a vendor in order to submit an electronic file.

**Electronic bids must be delivered via:**

**<https://vrapp.vendorregistry.com/Bids/View/BidsList?BuyerId=37b55d57-2b40-462fbd8e-5b80ab095ddd>**

**DO NOT WAIT UNTIL SUBMISSION DEADLINE TO REGISTER AS A VENDOR.** Register as a vendor (vendors are encouraged to complete this step **now** to ensure a seamless submission process prior to deadline).

The electronic submission link will be disabled at 2:00:00 p.m. Eastern time. Vendors will not have the ability to submit any electronic files once the deadline has passed.

**To register as a vendor, use the link below:**

<https://vrapp.vendorregistry.com/Vendor/Register/Index/sullivan-county-tn-vendor-registration>

The real property to be sold is known as the Holston Ballfield Property, and is located at 238 Maple Street, Blountville, Tennessee 37617, as shown on Map 094, Parcel 73, and more particularly described as Parcel A on Exhibit 1 attached hereto This is the parcel without the Old School on it. Reference is made to the following deeds:

Deed from Mary Johnson to the Sullivan County Board of Education, dated September 8, 1967 and recorded in Deed Book 296A at page 139 in the Register of Deeds Office for Sullivan County, Tennessee.

Deed from Millard Johnson and wife, Lois Johnson to the Sullivan County Board of Education dated September 8, 1967 and recorded in Deed Book 296A at page 141 in the Register of Deeds Office for Sullivan County, Tennessee.

Deed from Eva Yoakley Fisher and husband, Frank Fisher to the Sullivan County Board of Education, dated November 4, 1967 and recorded in Deed Book 299A at page 303 in the Register of Deeds Office for Sullivan County, Tennessee.

The sale of the property shall be subject to survey, title examination, and negotiation of final terms and conditions.

After receipt of bids, the Sullivan County Board of Education shall review all bids and shall choose the successful bidder(s). The Sullivan County Board of Education reserves the right to reject any or all bids.

The real property shall be sold subject to any and all restrictions, easements, limitations, reversions and stipulations of record in the aforesaid Register of Deeds' Office against the property. The real property and any improvements thereon shall be sold "AS IS, WHERE IS," and no warranties or guarantees are made, express or implied, as to the condition of the property.

A QUITCLAIM DEED to the property will be executed to the successful bidder or bidders by the Sullivan County Board of Education.

**TERMS OF SALE:** Cash, Certified Check or Cashier's Check; No Money Orders or Personal Checks will be accepted. Purchaser shall be required to pay the bid amount in full to

Ingrid Deloach, Business Manager located at Department of Education, 154 Blountville Bypass, Blountville, TN 37617 upon delivery of deed.

To schedule a day/time to view property, please contact the Maintenance Director, Charles Hubbard at 423/354-1151.

**SEALED BIDS must be presented in a sealed envelope to the Office of the Sullivan County Purchasing Agent on or before the day/time designated and must indicate the following information on the outside:**

**SEALED BID #HBP2020(KD)  
DISPOSITION OF REAL PROPERTY**

# **COST EVALUATION FORM**

**"HOLSTON BALLFIELD PROPERTY"**  
**SULLIVAN COUNTY PURCHASING**  
**SEALED BID #HBP2020(KD)**

1. Parcel A – Bid Price                      \$ \_\_\_\_\_

*I/WE AGREE TO PURCHASE THE AFOREMENTIONED PROPERTY AT THE PRICE OFFERED ABOVE AND PER THE TERMS AND CONDITIONS OF THIS SEALED BID.*

**PERSON SUBMITTING SEALED BID** \_\_\_\_\_  
(PLEASE PRINT)

**IF BID IS BEING SUBMITTED ON BEHALF OF CORPORATION OR ORGANIZATION, PLEASE PROVIDE NAME OF CORPORATION OR ORGANIZATION:** \_\_\_\_\_

\_\_\_\_\_

**SIGNATURE:** \_\_\_\_\_ **DATE** \_\_\_\_\_

**PHONE:** \_\_\_\_\_ **FAX:** \_\_\_\_\_

**E-MAIL:** \_\_\_\_\_

# Sullivan County - Parcel: 094 073.00

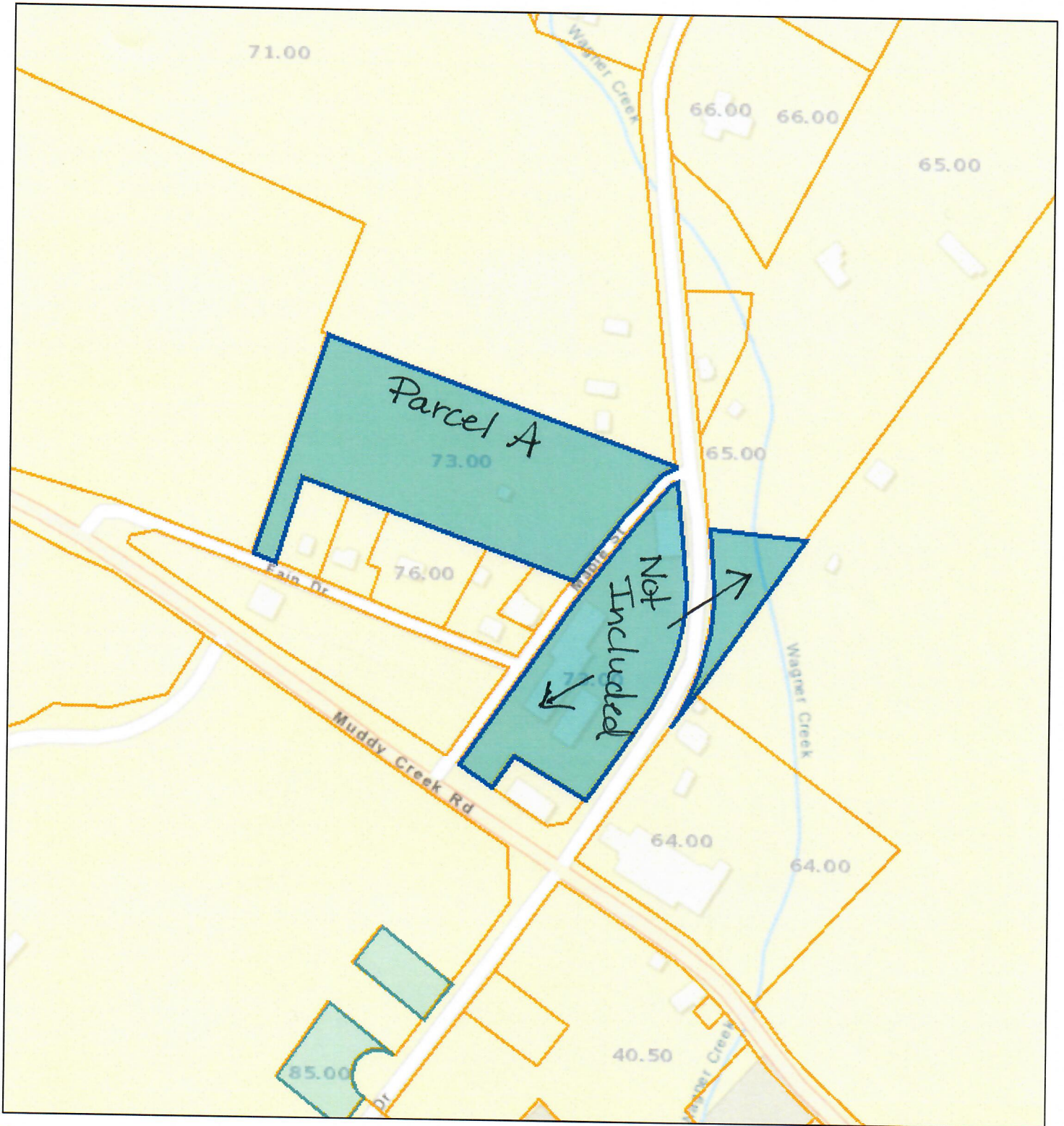

Date: April 23, 2020  
County: Sullivan  
Owner: SULLIVAN COUNTY BD OF ED  
Address: HOLSTON DR 544  
Parcel Number: 094 073.00  
Deeded Acreage: 0  
Calculated Acreage: 9.5  
Date of Imagery: 2015

Sources: Esri, HERE, Garmin, USGS, Intermap, INCREMENT P, NRCan, Esri Japan, METI, Esri China (Hong Kong), Esri Korea, Esri (Thailand), NGCC, (c) OpenStreetMap contributors, and the GIS User Community  
TN Comptroller - OLG  
State of Tennessee, Comptroller of the Treasury, Office of Local Government

The property lines are compiled from information maintained by your local county Assessor's office but are not conclusive evidence of property ownership in any court of law.