

STRUCTURE TABLE					
QTY	STR. #	STATION	SIDE	DESCRIPTION	CONNECTED PIPE
1	S-(1)	17+45.01	Lt.	Index No. 232 - Ditch Bottom Inlet - Type C	12" Pipe Culvert S/CD
1	S-(2)	17+45.77	Lt.	Existing Ditch Bottom Inlet to be Removed - Connect new Pipe	12" Pipe Culvert S/CD
1	S-(3)	20+29.29	Rt.	Index No. 258 - Rip Rap - Single 18-84 in. Dia Pipe, see detail sheet 10	48" Pipe Culvert S/CD
1	S-(4)	21+39.52	Rt.	Index No. 232 - Ditch Bottom Inlet - Type H with 3 grates	48" Pipe Culvert S/CD 24" Pipe Culvert S/CD 48" Pipe Culvert S/CD 24" Pipe Culvert S/CD
1	S-(5)	21+71.26	Rt.	Index No. 258 - Rip Rap - Single 18-84 in. Dia Pipe, see detail sheet 10	48" Pipe Culvert S/CD
1	S-(6)	487+88.10	Lt.	Index No. 232 - Ditch Bottom Inlet - Type C	24" Pipe Culvert S/CD
1	S-(7)	487+87.94	Rt.	Index No. 232 - Ditch Bottom Inlet - Type C	24" Pipe Culvert S/CD 24" Pipe Culvert S/CD
1	S-(8)	489+48.03	Rt.	Index No. 272 - Cross Drain MES with 1:4 Slope - Single Round Conc. Pipe	24" Pipe Culvert S/CD
1	S-(9)	577+55.51	Lt.	-	24" Pipe Culvert S/CD
1	S-(10)	577+62.87	Lt.	Index No. 201 - Type 8 Manhole (Eccentric Cone with 1 or 2-Piece Cover, Round Structure Bottom)	24" Pipe Culvert S/CD 24" Pipe Culvert S/CD
1	S-(11)	578+08.73	Lt.	Index No. 272 - Cross Drain MES with 1:4 Slope - Single Round Conc. Pipe	24" Pipe Culvert S/CD
1	S-(12)	460+97.10	Lt.	Index No. 272 - Cross Drain MES with 1:4 Slope - Single Round Conc. Pipe	12" Pipe Culvert S/CD
1	S-(13)	461+40.99	Lt.	Index No. 201 - Type 7 Manhole (1 or 2-Piece Cover (Center), Round Bottom)	12" Pipe Culvert S/CD
1	S-(14)	461+84.90	Rt.	Existing End of Pipe	24" Pipe Culvert S/CD
1	S-(15)	461+98.83	Rt.	Index No. 232 - Ditch Bottom Inlet - Type C	24" Pipe Culvert S/CD 24" Pipe Culvert S/CD
1	S-(16)	462+42.35	Rt.	Existing End of Pipe	24" Pipe Culvert S/CD
1	S-(17)	510+61.21	Lt.	Index No. 272 - Cross Drain MES with 1:4 Slope - Single Round Conc. Pipe	12" Vertical Elliptical Concrete Pipe
1	S-(18)	510+98.19	Lt.	Index No. 272 - Cross Drain MES with 1:4 Slope - Single Round Conc. Pipe	12" Vertical Elliptical Concrete Pipe
1	S-(19)	543+52.40	Lt.	Index No. 272 - Cross Drain MES with 1:4 Slope - Single Round Conc. Pipe	12" Vertical Elliptical Concrete Pipe
1	S-(20)	543+89.38	Lt.	Index No. 272 - Cross Drain MES with 1:4 Slope - Single Round Conc. Pipe	12" Vertical Elliptical Concrete Pipe

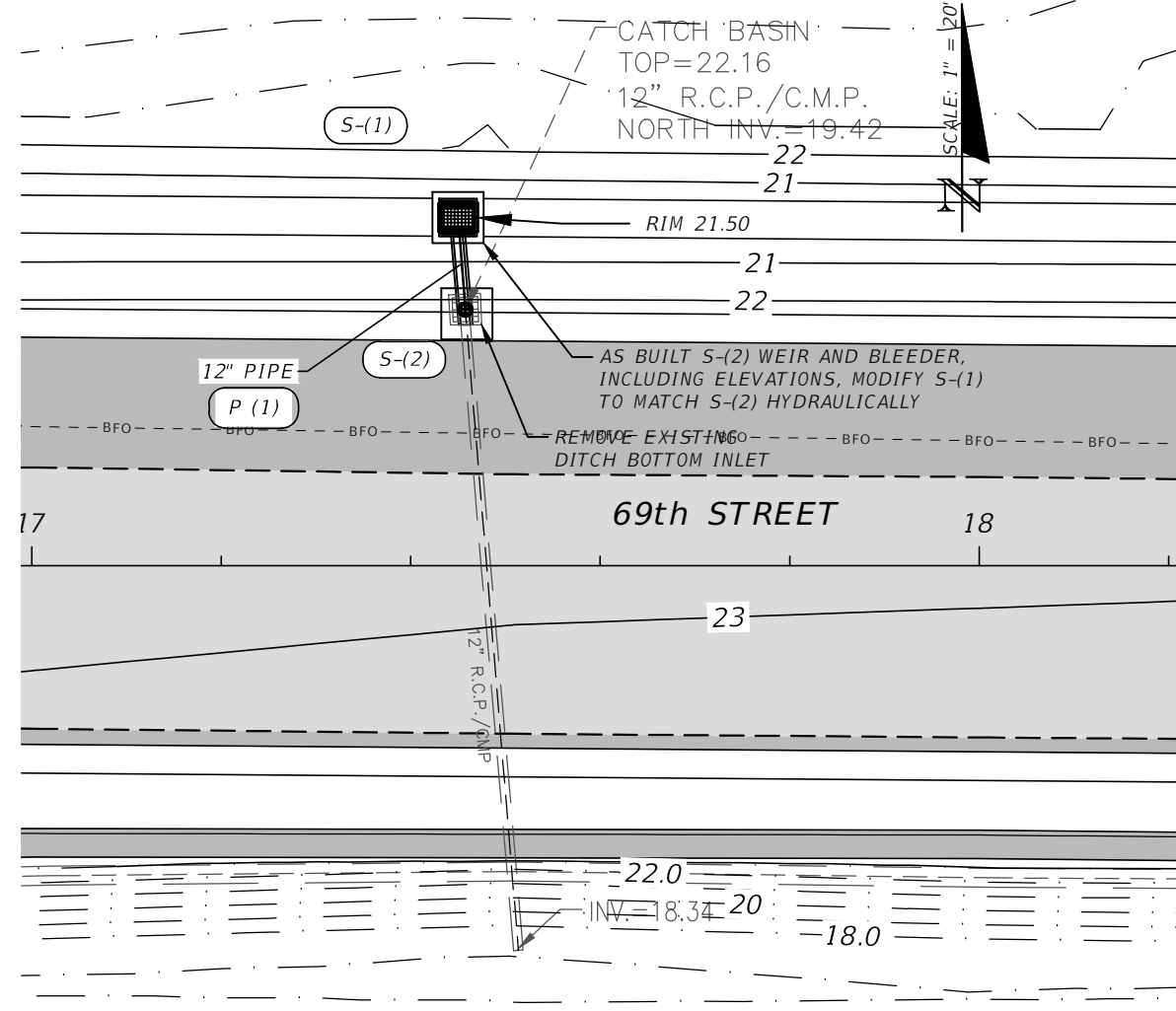

PIPE TABLE					
#	STRT #	SIDE	DESCRIPTION	SIZE INCHES	LENGTH
P(1)	S-(2)	-27.05 Lt.	12" RCP, ROUND	12.0"	9.75'
P(2)	S-(3)	45.09 Rt.	48" RCP, ROUND	48.0"	110.24'
P(3)	S-(4)	46.67 Rt.	48" RCP, ROUND	48.0"	31.74'
P(4)	S-(6)	86.53 Rt.	24" RCP, ROUND	24.0"	75.00'
P(5)	S-(7)	35.66 Rt.	24" RCP, ROUND	24.0"	37.91'
P(6)	S-(4)	39.60 Rt.	24" RCP, ROUND	24.0"	120.00'
P(7)	S-(9)	-48.43 Lt.	24" RCP / CMP, ROUND	24.0"	16.99'
P(8)	S-(10)	-33.19 Lt.	24" RCP, ROUND	24.0"	45.86'
P(9)	S-(13)	-32.44 Lt.	12" RCP, ROUND	12.0"	43.89'
P(10)	S-(16)	36.09 Rt.	24" RCP, ROUND	24.0"	14.25'
P(11)	S-(15)	44.40 Rt.	24" RCP, ROUND	24.0"	44.41'
P(12)	S-(18)	-33.05 Lt.	23" x 14" Vertical Elliptical Concrete Pipe	12.0"	48.00'
P(13)	S-(20)	-31.33 Lt.	23" x 14" Vertical Elliptical Concrete Pipe	12.0"	36.99'

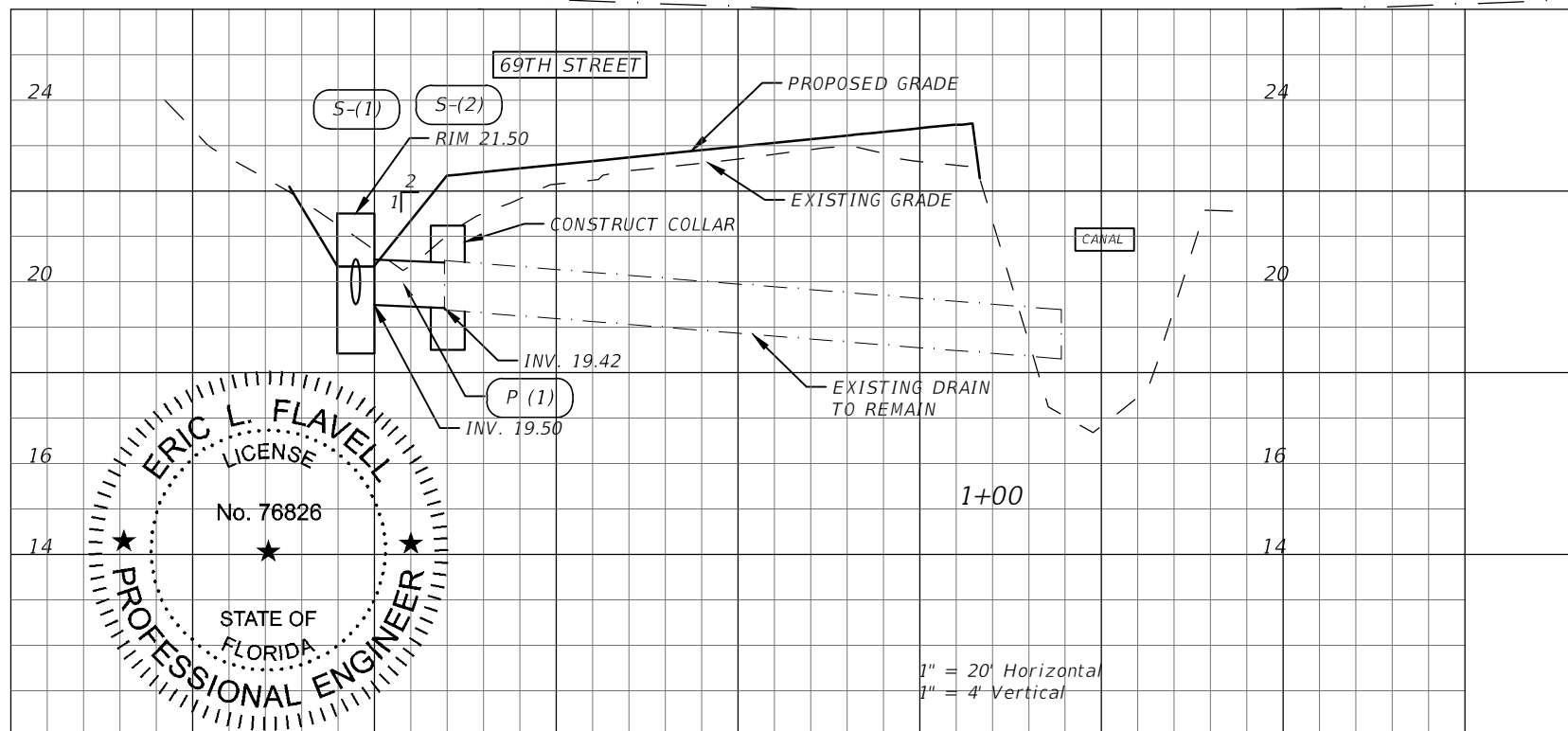

REVISIONS				ERIC L. FLAVELL, P.E. P.E. LICENSE NUMBER 76826 BOWMAN CONSULTING GROUP 4450 W. EAU GALLIE BLVD. MELBOURNE, FL 32934 CERTIFICATE OF AUTHORIZATION 30462	INDIAN RIVER COUNTY DEPARTMENT OF PUBLIC WORKS/ENGINEERING DIVISION ROAD NO. COUNTY FINANCIAL PROJECT ID CR-613 INDIAN RIVER IRC: 1325 58th AVE FD01.436416-1-54-01	DRAINAGE PLAN AND PROFILE	SHEET NO. 180
DATE	DESCRIPTION	DATE	DESCRIPTION				
2/19/20	RESPONSE TO COUNTY COMMENTS						

FOR BIDDING PURPOSES ONLY

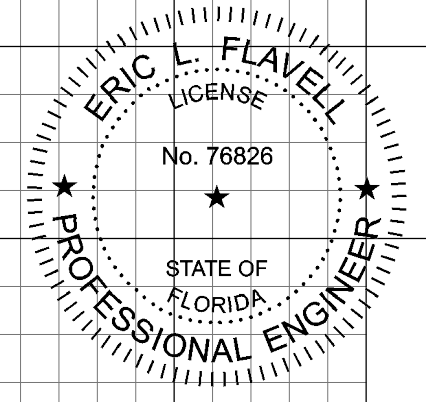
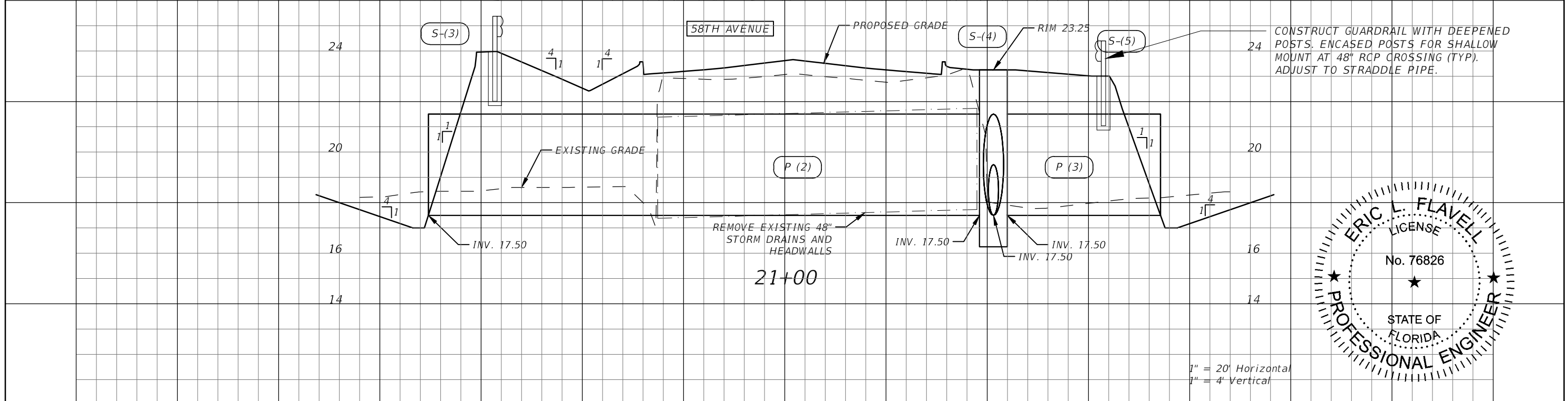
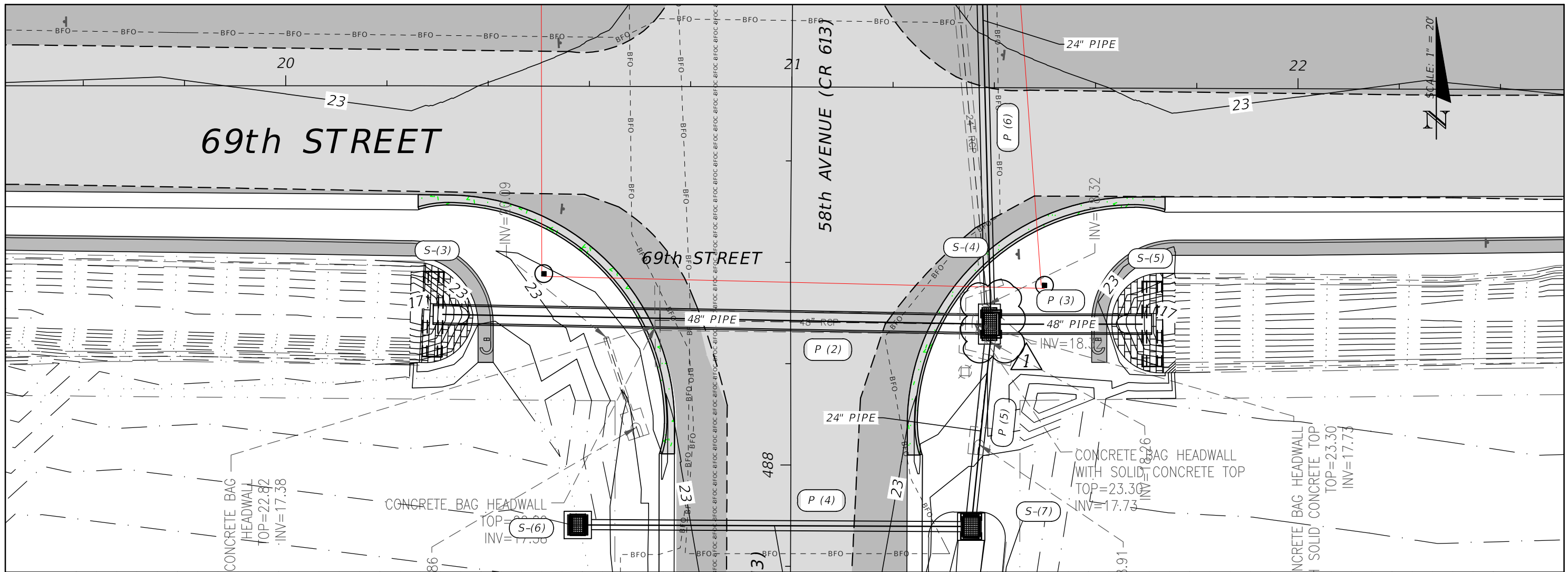

1" = 20' Horizontal
1" = 4' Vertical

REVISIONS		DESCRIPTION		DATE	DATE
DATE	DESCRIPTION	DATE	DESCRIPTION		
2/19/20	RESPONSE TO COUNTY COMMENTS Δ				

ERIC L. FLAVELL, P.E. P.E. LICENSE NUMBER 76826 BOWMAN CONSULTING GROUP 4450 W. EAU GALLIE BLVD. MELBOURNE, FL 32934 CERTIFICATE OF AUTHORIZATION 30462		INDIAN RIVER COUNTY DEPARTMENT OF PUBLIC WORKS/ENGINEERING DIVISION ROAD NO. COUNTY FINANCIAL PROJECT ID CR-613 INDIAN RIVER IRC: 1325 58th AVE FD01:436416-1-54-01		SHEET NO. 181
--	--	--	--	-----------------------------

FOR BIDDING PURPOSES ONLY

DRAINAGE PLAN AND PROFILE

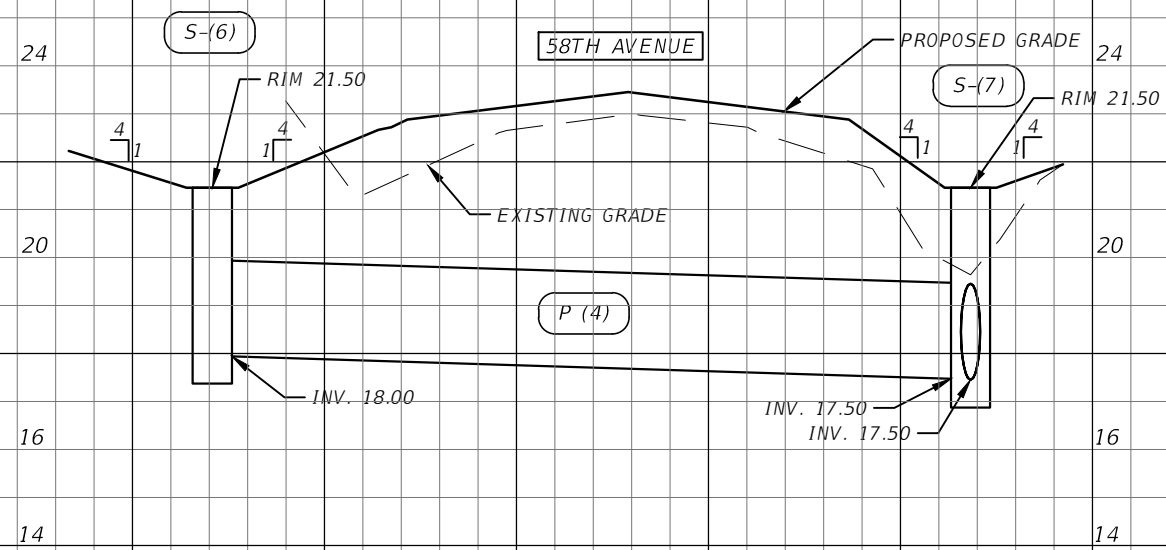
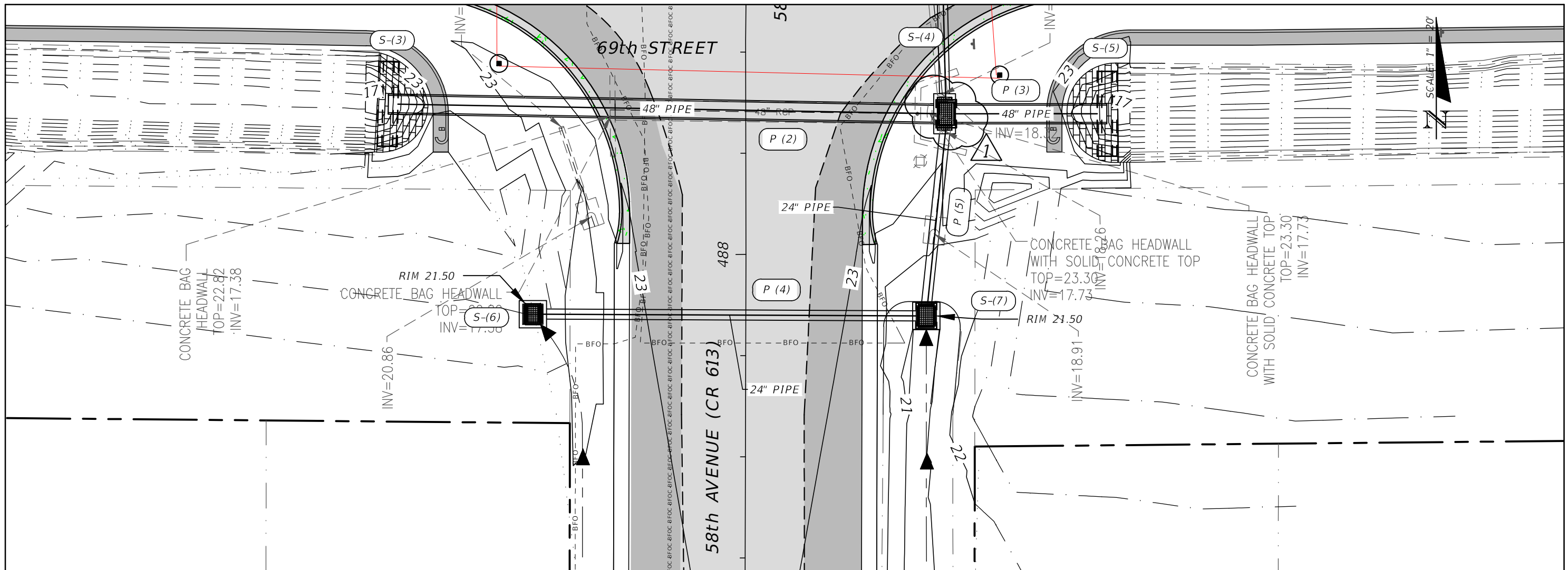

1" = 20' Horizontal
1" = 4' Vertical

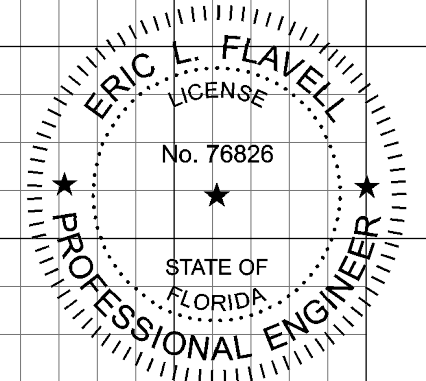

REVISIONS	
DATE	DESCRIPTION
2/19/20	RESPONSE TO COUNTY COMMENTS ▲

ERIC L. FLAVELL, P.E.
P.E. LICENSE NUMBER 76826
BOWMAN CONSULTING GROUP
4450 W. EAU GALLIE BLVD.
MELBOURNE, FL 32934
CERTIFICATE OF AUTHORIZATION 30462

INDIAN RIVER COUNTY
DEPARTMENT OF PUBLIC WORKS/ENGINEERING DIVISION

ROAD NO.	COUNTY	FINANCIAL PROJECT ID
CR-613	INDIAN RIVER	IRC: 1325
58th AVE		FD01:436416-1-54-01

DRAINAGE PLAN AND PROFILE

SHEET NO.
182

FOR BIDDING PURPOSES ONLY

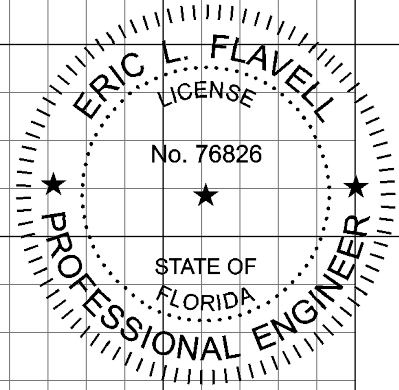
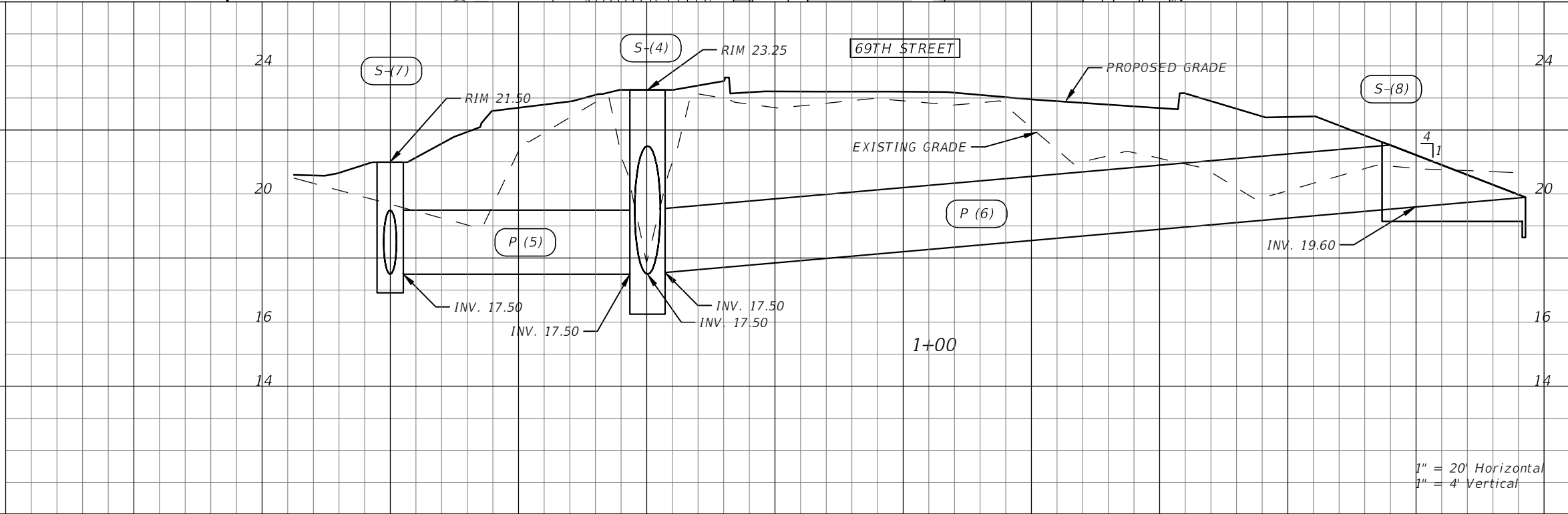
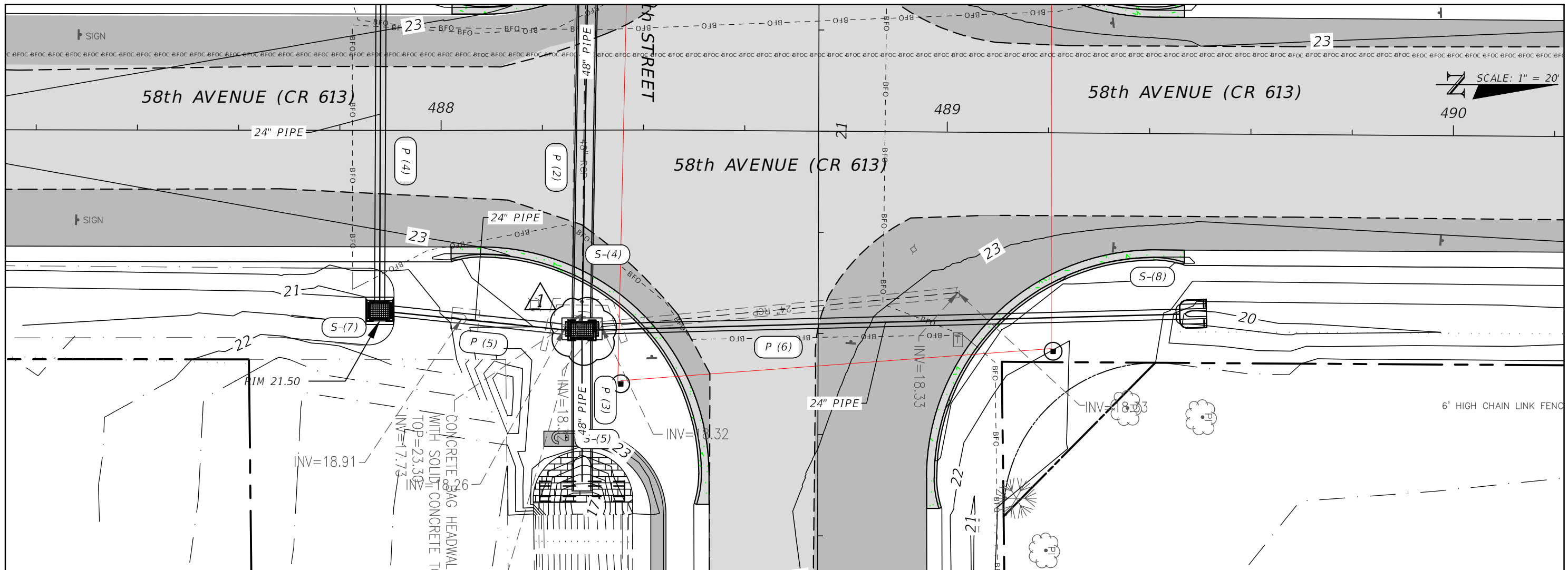

REVISIONS	
DATE	DESCRIPTION
2/19/20	RESPONSE TO COUNTY COMMENTS Δ

ERIC L. FLAVELL, P.E.
P.E. LICENSE NUMBER 76826
BOWMAN CONSULTING GROUP
4450 W. EAU GALLIE BLVD.
MELBOURNE, FL 32934
CERTIFICATE OF AUTHORIZATION 30462

INDIAN RIVER COUNTY
DEPARTMENT OF PUBLIC WORKS/ENGINEERING DIVISION
ROAD NO. COUNTY FINANCIAL PROJECT ID
CR-613 INDIAN RIVER IRC: 1325
58th AVE FD01:436416-1-54-01

DRAINAGE PLAN AND PROFILE

SHEET NO.
183

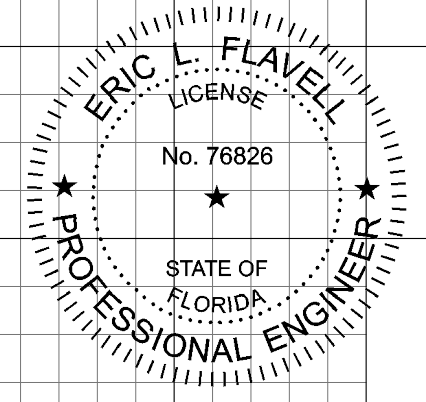
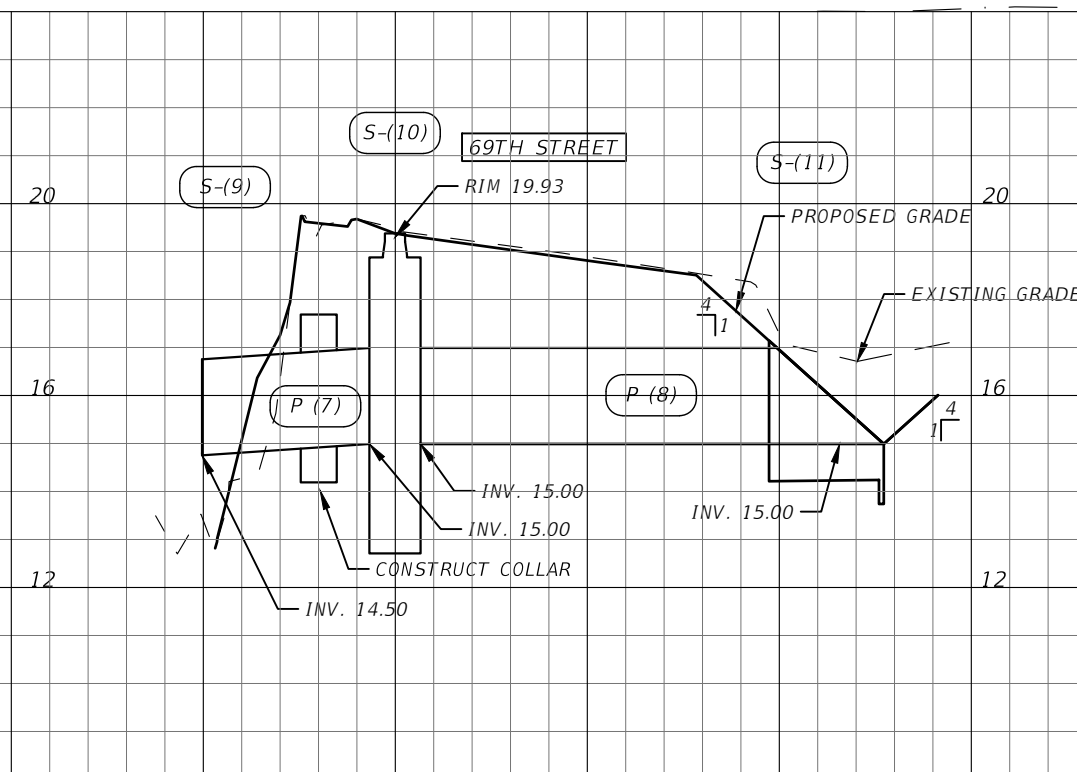
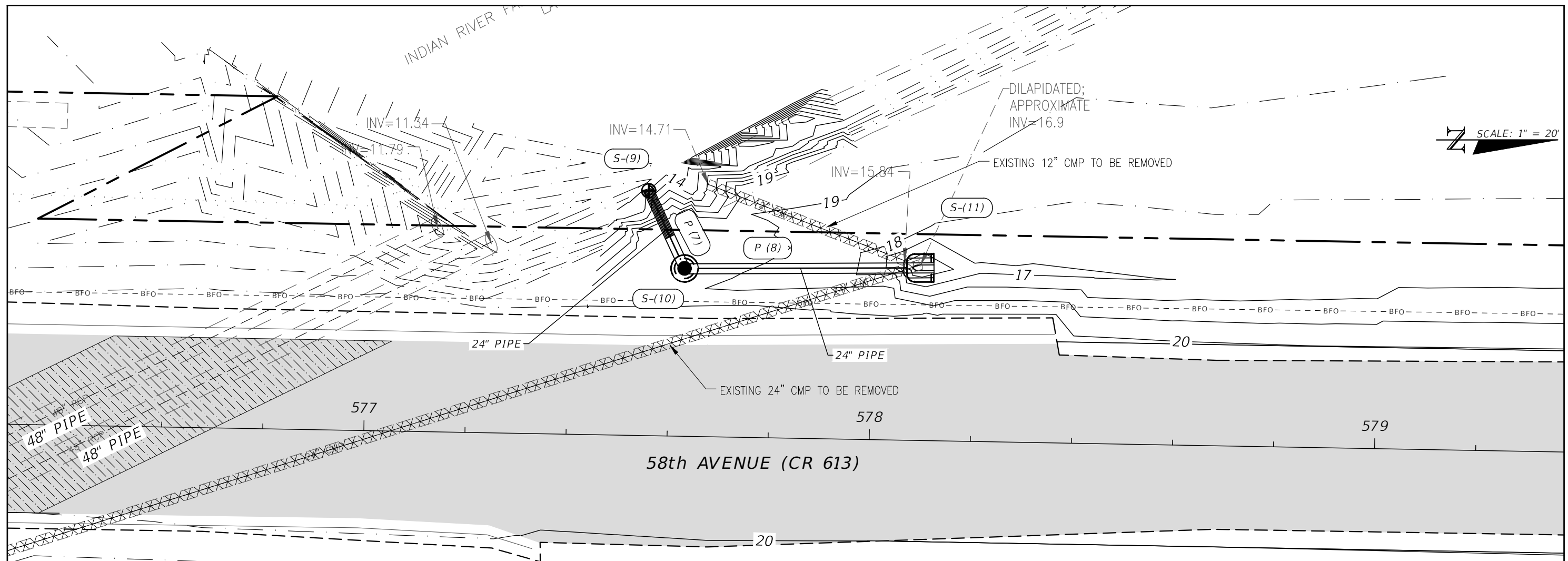

REVISIONS	
DATE	DESCRIPTION

ERIC L. FLAVELL, P.E.
P.E. LICENSE NUMBER 76826
BOWMAN CONSULTING GROUP
4450 W. EAU GALLIE BLVD.
MELBOURNE, FL 32934
CERTIFICATE OF AUTHORIZATION 30462

INDIAN RIVER COUNTY
DEPARTMENT OF PUBLIC WORKS/ENGINEERING DIVISION

ROAD NO.	COUNTY	FINANCIAL PROJECT ID
CR-613	INDIAN RIVER	IRC: 1325
58th AVE		FD01:436416-1-54-01

DRAINAGE PLAN AND PROFILE

SHEET NO.
184

FOR BID PURPOSES ONLY

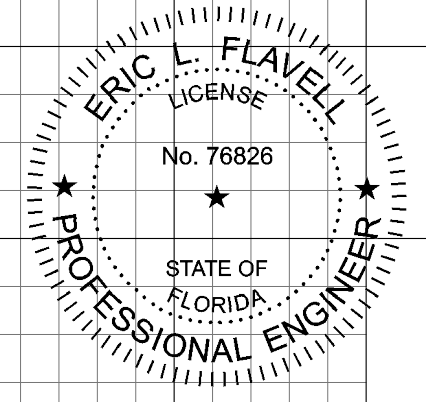
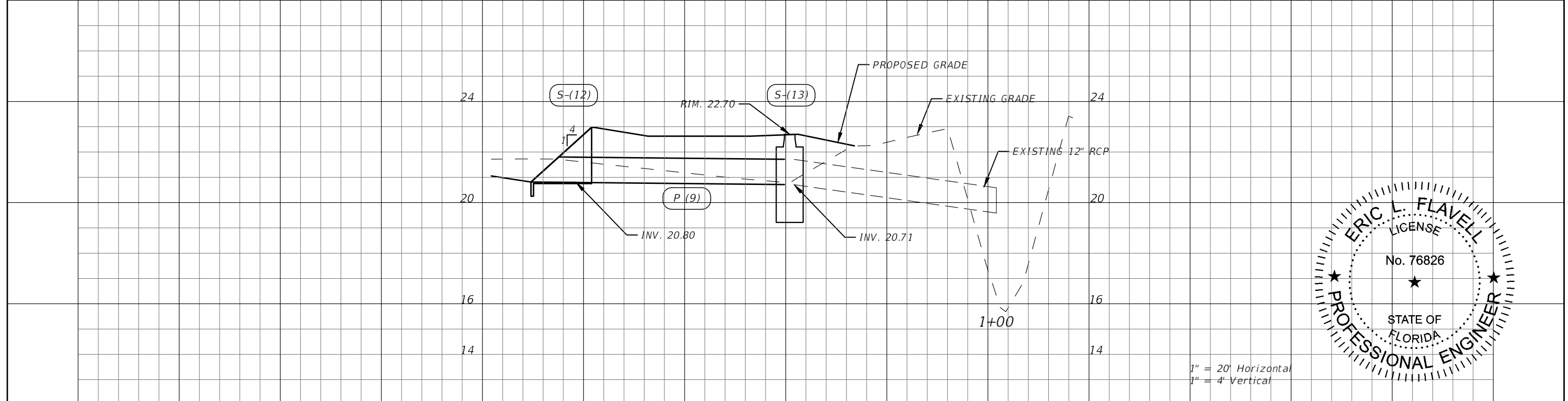
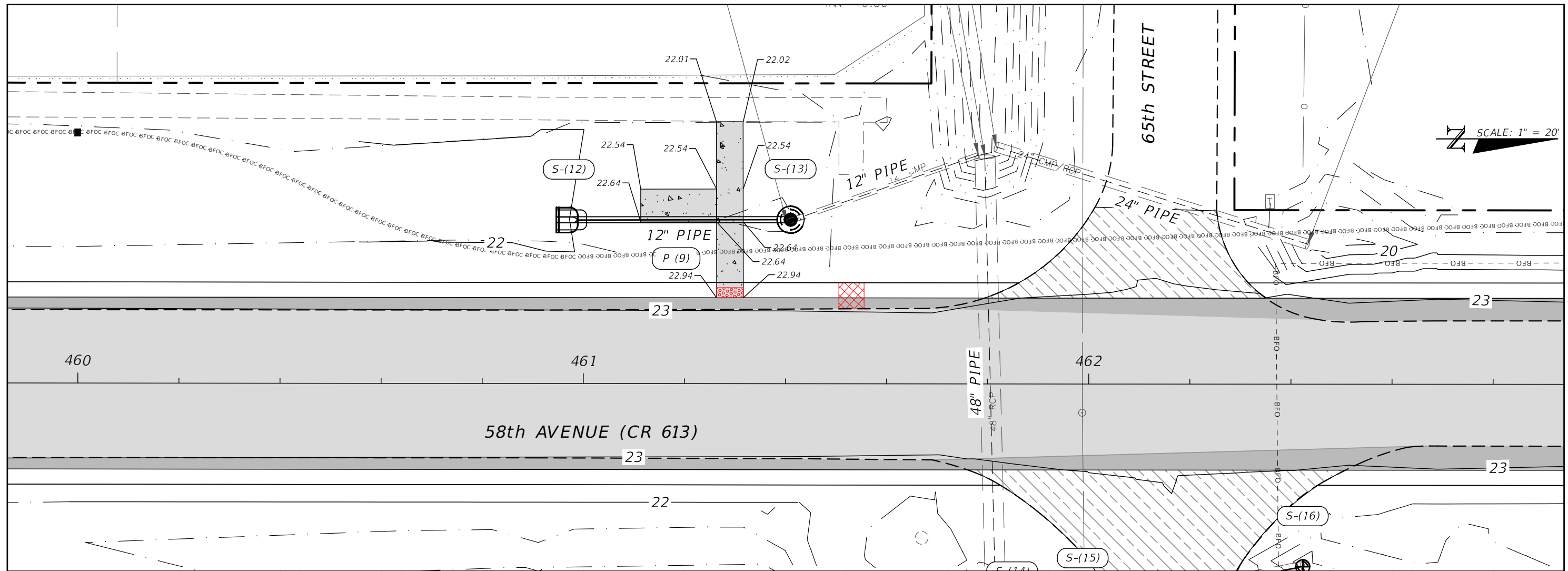

REVISIONS		DESCRIPTION		DATE	DESCRIPTION	SHEET NO.
DATE	DESCRIPTION	DATE	DESCRIPTION			
---	---	---	---			185

FOR BIDDING PURPOSES ONLY

INDIAN RIVER COUNTY
 DEPARTMENT OF PUBLIC WORKS/ENGINEERING DIVISION
 ROAD NO. COUNTY FINANCIAL PROJECT ID
 CR-613 INDIAN RIVER IRC: 1325
 58th AVE FD01:436416-1-54-01

DRAINAGE PLAN AND PROFILE

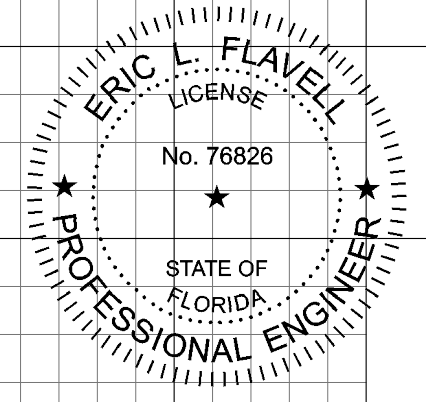
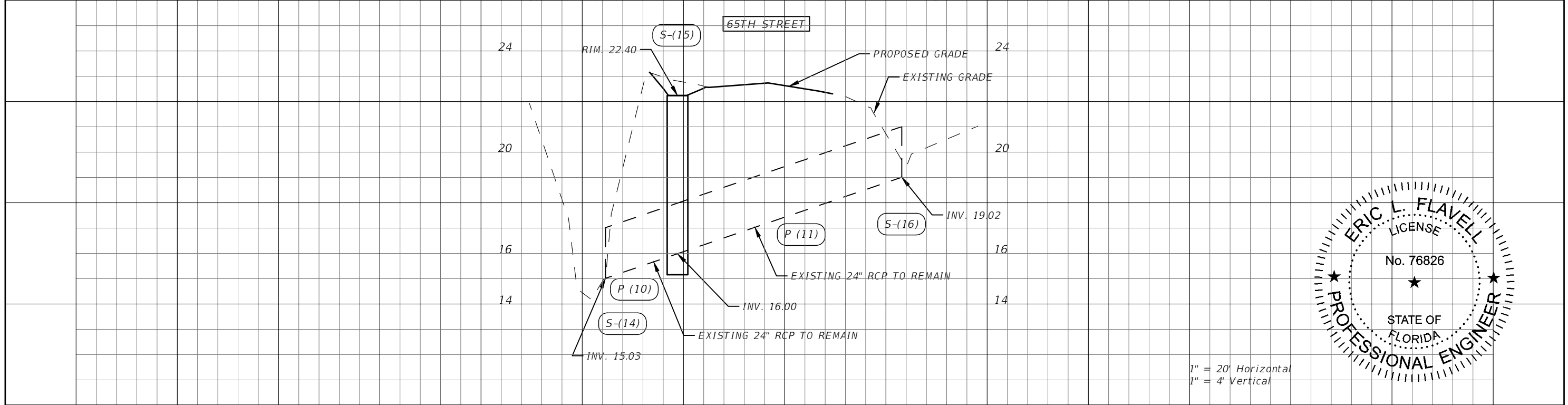
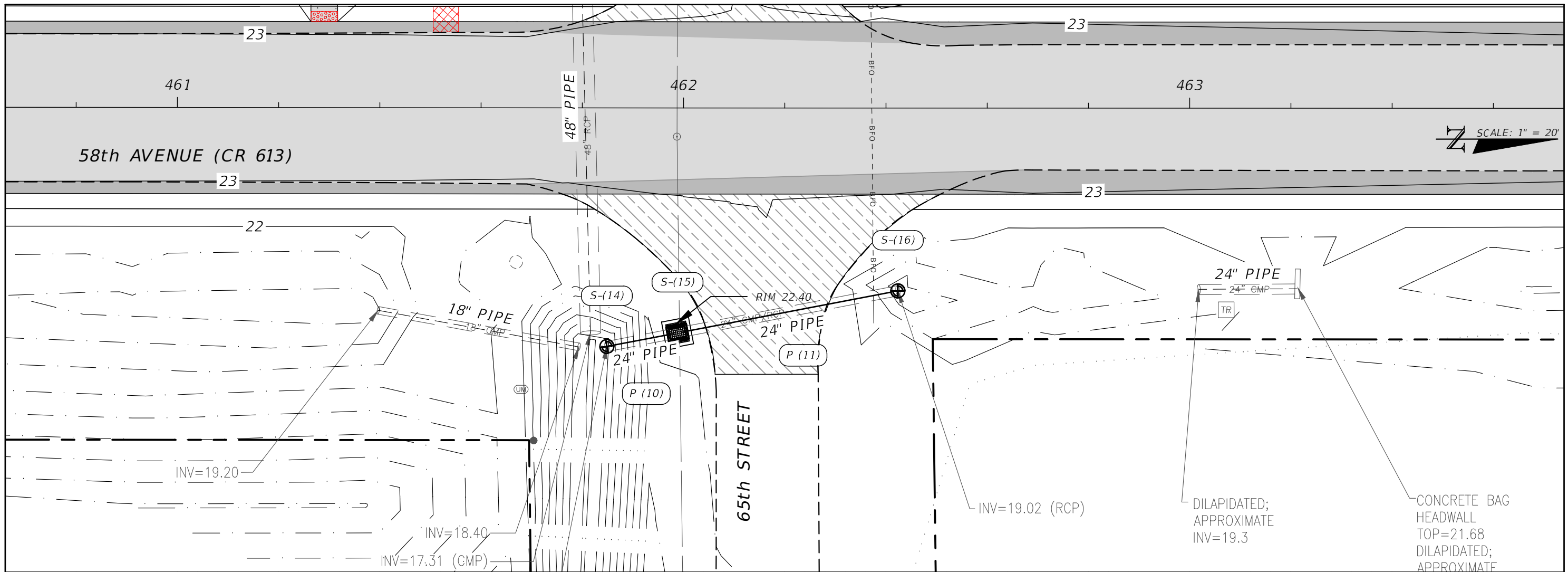

REVISIONS		DESCRIPTION		ERIC L. FLAVELL, P.E. P.E. LICENSE NUMBER 76826 BOWMAN CONSULTING GROUP 4450 W. EAU GALLIE BLVD. MELBOURNE, FL 32934 CERTIFICATE OF AUTHORIZATION 30462	INDIAN RIVER COUNTY DEPARTMENT OF PUBLIC WORKS/ENGINEERING DIVISION			DRAINAGE PLAN AND PROFILE	SHEET NO. 186
DATE	DESCRIPTION	DATE	DESCRIPTION		ROAD NO. CR-613 58th AVE	COUNTY INDIAN RIVER	FINANCIAL PROJECT ID IRC: 1325 FD01:436416-1-54-01		

FOR BIDDING PURPOSES ONLY

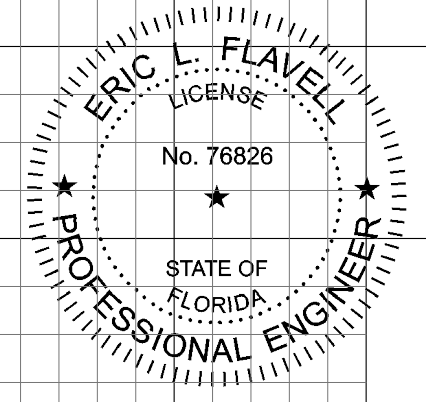
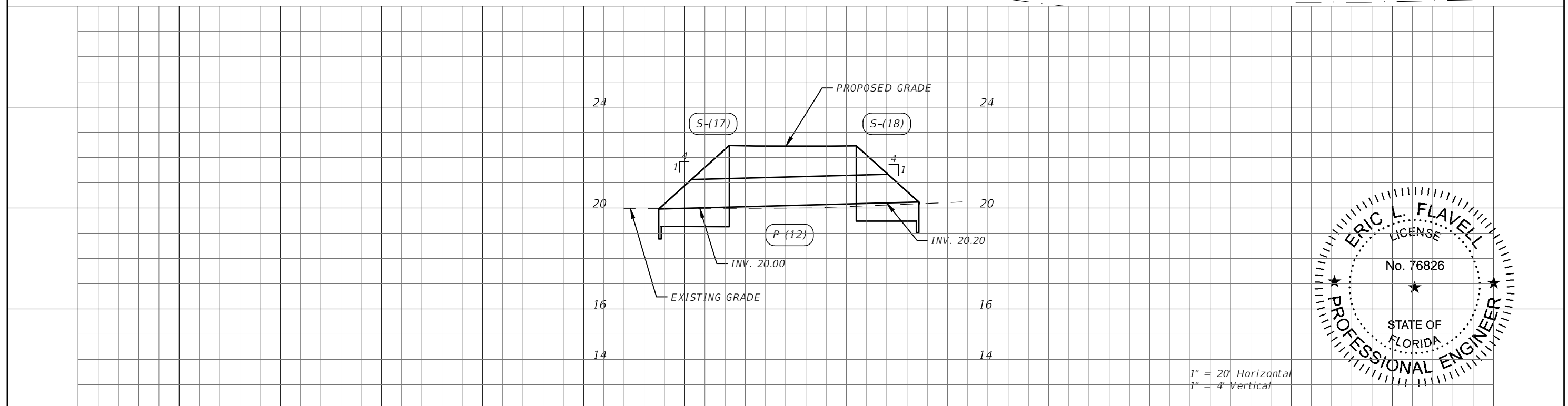
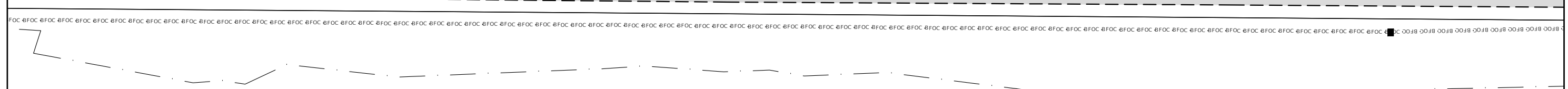
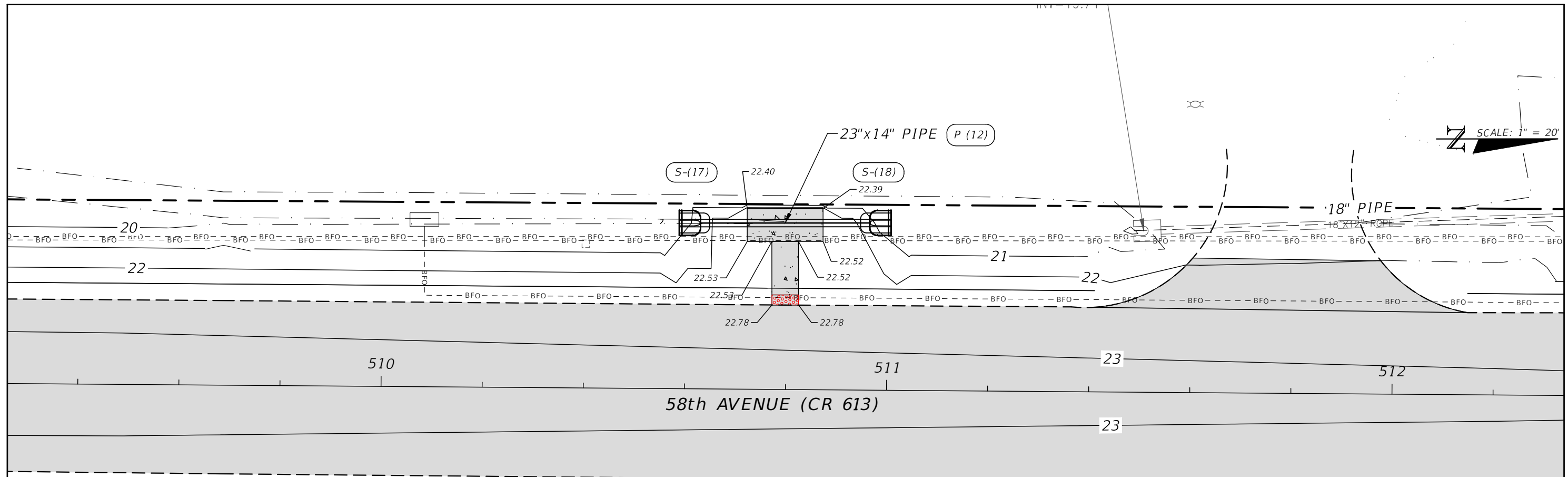

REVISIONS		DESCRIPTION		INDIAN RIVER COUNTY		SHEET NO.
DATE	DESCRIPTION	DATE	DESCRIPTION	ROAD NO.	COUNTY	
---	---	---	---	CR-613	INDIAN RIVER	187
FOR BIDDING PURPOSES ONLY				58th AVE	INDIAN RIVER	

ERIC L. FLAVELL, P.E.
P.E. LICENSE NUMBER 76826
BOWMAN CONSULTING GROUP
4450 W. EAU GALLIE BLVD.
MELBOURNE, FL 32934
CERTIFICATE OF AUTHORIZATION 30462

INDIAN RIVER COUNTY
DEPARTMENT OF PUBLIC WORKS/ENGINEERING DIVISION
ROAD NO. COUNTY FINANCIAL PROJECT ID
CR-613 INDIAN RIVER IRC: 1325
58th AVE FD01:436416-1-54-01

DRAINAGE PLAN AND PROFILE

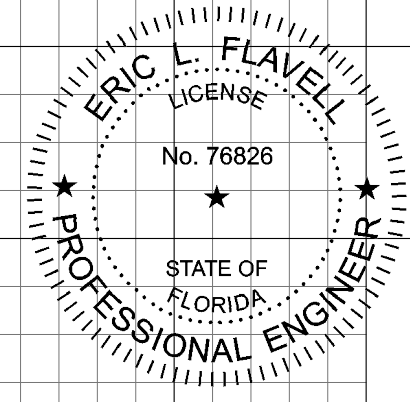
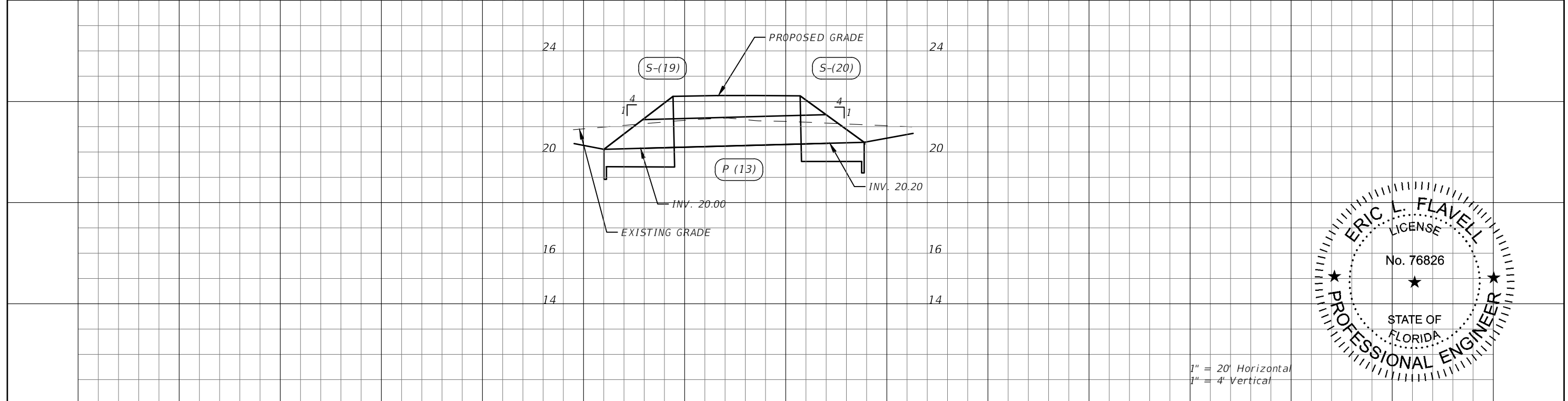
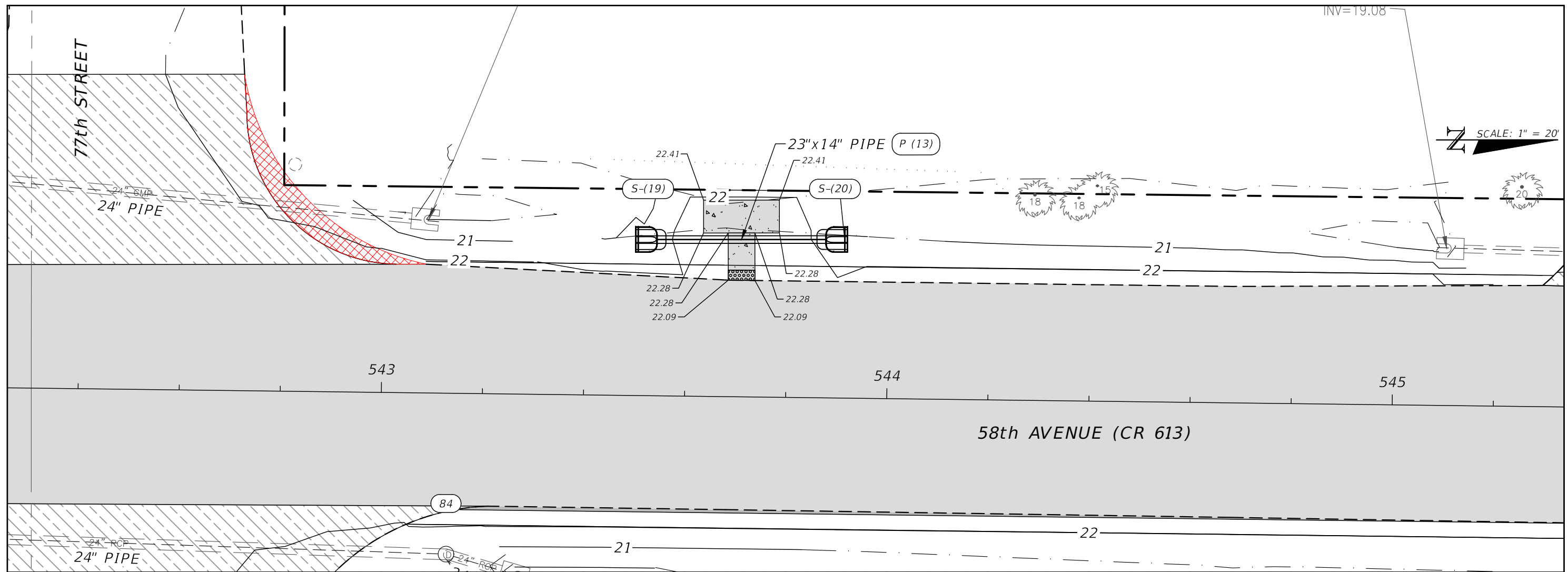

1" = 20' Horizontal
1" = 4' Vertical

REVISIONS		DESCRIPTION		DATE	DATE	DESCRIPTION	DATE	DESCRIPTION	SHEET NO.
DATE	DESCRIPTION	DATE	DESCRIPTION						
---	---	---	---	---	---	---	---	---	188

FOR BIDDING PURPOSES ONLY

ERIC L. FLAVELL, P.E.
P.E. LICENSE NUMBER 76826
BOWMAN CONSULTING GROUP
4450 W. EAU GALLIE BLVD.
MELBOURNE, FL 32934
CERTIFICATE OF AUTHORIZATION 30462

INDIAN RIVER COUNTY
DEPARTMENT OF PUBLIC WORKS/ENGINEERING DIVISION
ROAD NO. COUNTY FINANCIAL PROJECT ID
CR-613 INDIAN RIVER IRC: 1325
58th AVE FD01:436416-1-54-01

DRAINAGE PLAN AND PROFILE