

Electrical Panels
208 Volts

Three 5 Ton T60H
Bard Units

Honeywell
EMS Panel
Location

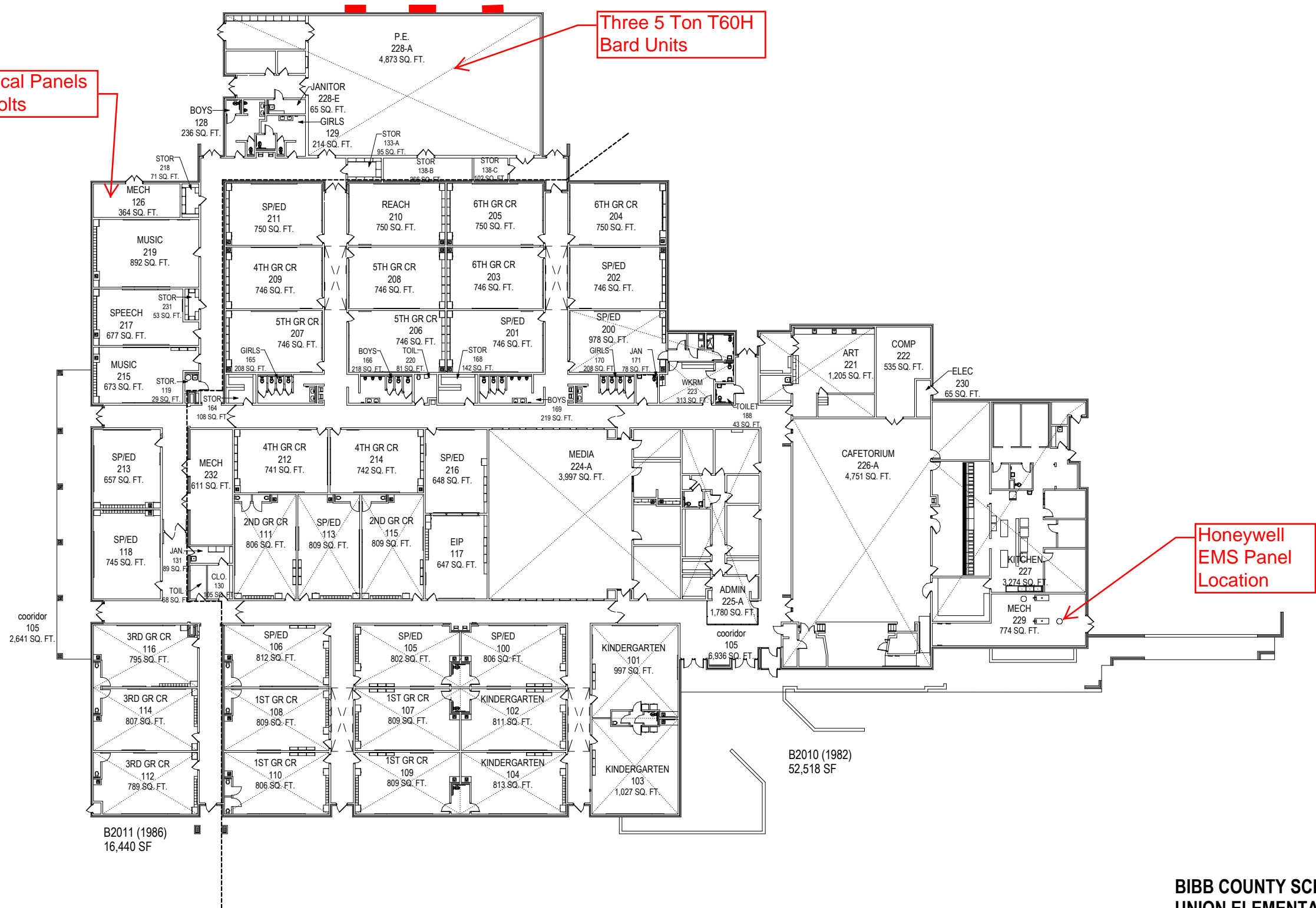

SCALE: 1" = 40'

**BIBB COUNTY SCHOOL DISTRICT
UNION ELEMENTARY SCHOOL**

FACILITY NUMBER:	0705
INSTRUCTIONAL UNITS:	42
FTE:	625
SITE ACREAGE:	19 AC.
TOTAL BUILDING AREA:	68,958 SF

