



PUBLIC NOTICE
SALE OF REAL PROPERTY
FY 21-12
December 14, 2020

The City of Waycross is offering for sale by sealed bids real property owned by the City of Waycross briefly described below. Attached is a full legal description.

0.204 Acre. Alpha/Ethel Street, Waycross, GA Parcel # WA0403086; Conway Park Sub Division West ½ Lot, 1, B8

Payment must be made within 5 (five) business days following award; via certified funds.

Deed, document preparation and fees will be the purchasers' responsibility.
City Attorney will prepare these documents for a fee, which is not part of the bid.
City Attorney will review all documents before deeds are transferred.

The City reserves the right to accept or reject any or all bids; to waive formalities and technicalities, and to make an award in the best interest of the City.

Bids will be accepted until **2:00 p.m., Tuesday, January 5, 2021**. Bids will not be accepted or considered after the deadline. Envelopes must be sealed and marked "FY21-12 Property" and deliver or mail to Linda Jones, Purchasing Director, Waycross City Hall, PO Drawer 99, 417 Pendleton Street, Waycross, GA 31502.

BID PRICE \$ _____

NAME _____

ADDRESS _____

PHONE _____

EXHIBIT A

**SURVEY FOR
CITY OF WAYCROSS
0.204 ACRES
LOCATED IN CONWAY
PARK S/D,
WEST 1/2 LOT 1, B B
WAYCROSS-WARE
COUNTY, GA
SCALE 1"=50'
DATE: 10/06/2020**

GRAPHIC SCALE
30' 0' 20' 10'
1 inch = 50' ft.

LEGEND
THESE STANDARD SYMBOLS ARE
AS SHOWN IN THE DRAWING.

- CONCRETE MONUMENT FOUND
- ▲ 1/2" REBAR FOUND
- 1/2" NUBB SET
- ▲ NO CORNER SET/FOUND

FIELD WORK: CT-JT
Survey Date: 10-06-2020
PLAT BY: CHH
Plot Date: 10-06-2020
Checked By: CHH
BY THE ALPHA-FIRM

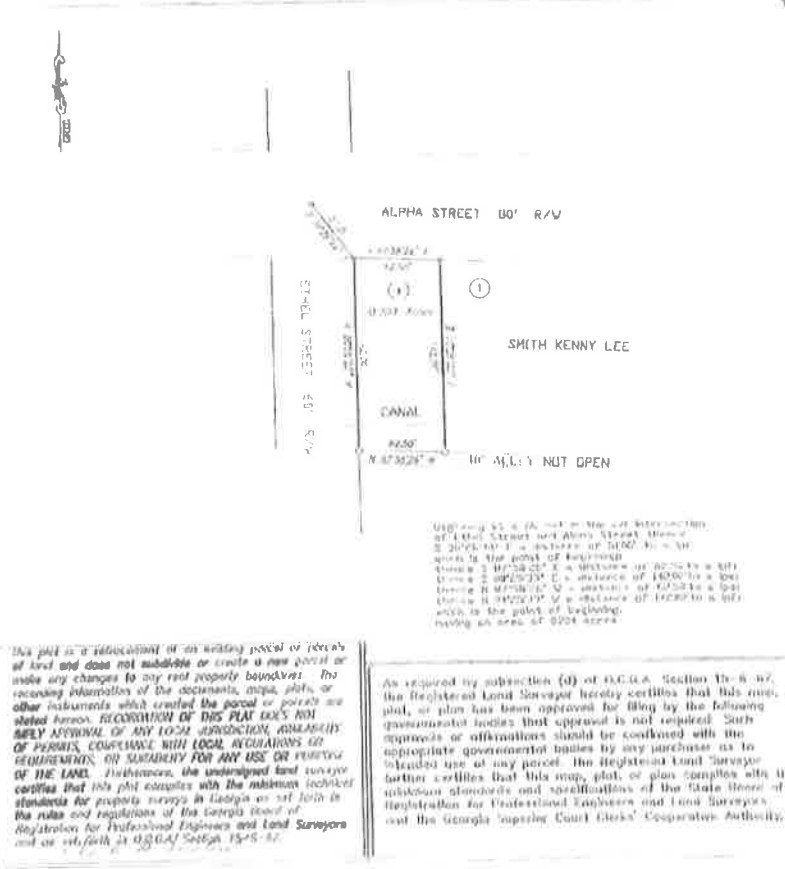

CHARLES H. TOMBERLIN & ASSOCIATES
3721 RICHMOND HENKLEW ROAD
WAYCROSS, GEORGIA 31591
OFFICE 912-283-2973
CELL 912-614-7843

Such approvals or affirmations should be conferred with the appropriate governmental bodies by any purchaser as to intended use of any parcel. The Registered Land Surveyor further certifies that this map, plot, or plan complies with the minimum standards and specifications of the State Board of Registration for Professional Engineers and Land Surveyors and the Georgia Superior Court Clerks' Cooperative Authority.

References:
Survey plat recorded in Book Y page 192 Public records of WAYCROSS county.

Owner Statement:
The data upon which this plat is based has a closure of one foot in 13,800 feet and an angular error of 02 seconds per angle and was adjusted using the compass rule. This plat has been calculated for closure and found to be accurate to 1 foot in 999,999 feet.

Notes:
1) The field data was collected using a Sokkiso total station, Conava 3100.
2) The bearings are true bearings obtained from known true ground distances measured in U.S. feet and decimal parts thereof.
3) This survey has been performed without the benefit of a formal title exam.
4) Charles H. Tomberlin, the Land Surveyor, whose seal is affixed hereto does not guarantee that all easements which may affect this property are shown.

LOCAL STATUTE NOTE: In Georgia, property is conveyed by deed, the statute is in O.C.G.A. § 44-5-101.