

PERMIT SET
ORIGINAL SHEET SIZE: 24"x36"
DRAWING SCALE
N.T.S.
SHEET
1 OF 10

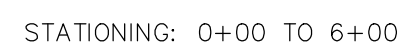

1 1/2" SUPERPAVE ASPHALTIC CONCRETE, TYPE SP-9.5

8" SHELL ROCK LBR 100 (OR BASE GROUP 6 EQUIV.)

12" OF STABILIZATION COMPACTED TO 98% AS
PER AASHTO T-180 SUB-BASE & SHOULDERS

ALL NEW CURBING TO HAVE BASE STABILIZED PER SPECIFICATIONS LISTED ABOVE.

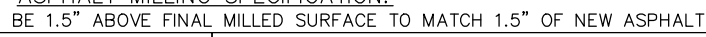

-ALL CURB RAMPS WITHIN THE PROJECT AREA ARE TO HAVE
DETECTABLE WARNING STRIPS INSTALLED.

-PROJECT AREA CONSISTS OF ALL ROADWAYS, SIDEWALKS, AND CURBING THAT WILL BE REPLACED AND ADJACENT WALKS TO THESE ITEMS.

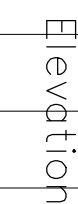
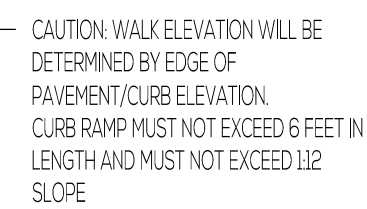
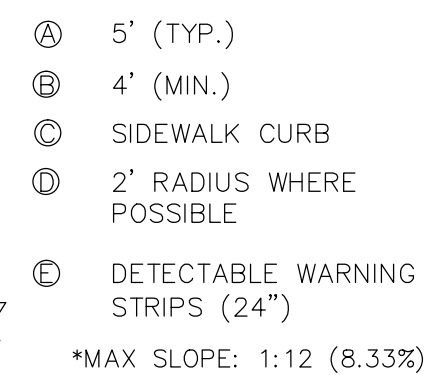

CERTIFICATE OF AUTHORIZATION # 5684
ROGER DALE POLSTON P. E. # 33222
MARVIN LUTHER WOLFE P.E. # 46030

PRINTED COPIES ARE NOT VALID WITHOUT
ORIGINAL SIGNATURE AND RAISED SEAL



ENGINEER JOB #
15055

CITY OF SEBRING
STREET IMPROVEMENTS
ORANGE ST. - ROSE TO NASTURTIUM

PERMIT SET
ORIGINAL SHEET SIZE: 24"x36"

DRAWING SCALE

1" = 20'

SHEET
2 OF 10

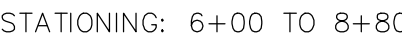

- CAUTION: IN CERTAIN AREAS WALK ELEVATION WILL BE DETERMINED BY EDGE OF PAVEMENT/CURB ELEVATION. CURB RAMP MUST NOT EXCEED 6 FEET IN LENGTH AND MUST NOT EXCEED 1:12 SLOPE
- INTERSECTIONS AND WALKS ADJACENT TO CURB RAMPS MAY NEED ELEVATIONS ADJUSTED TO MAINTAIN THIS CRITERIA.

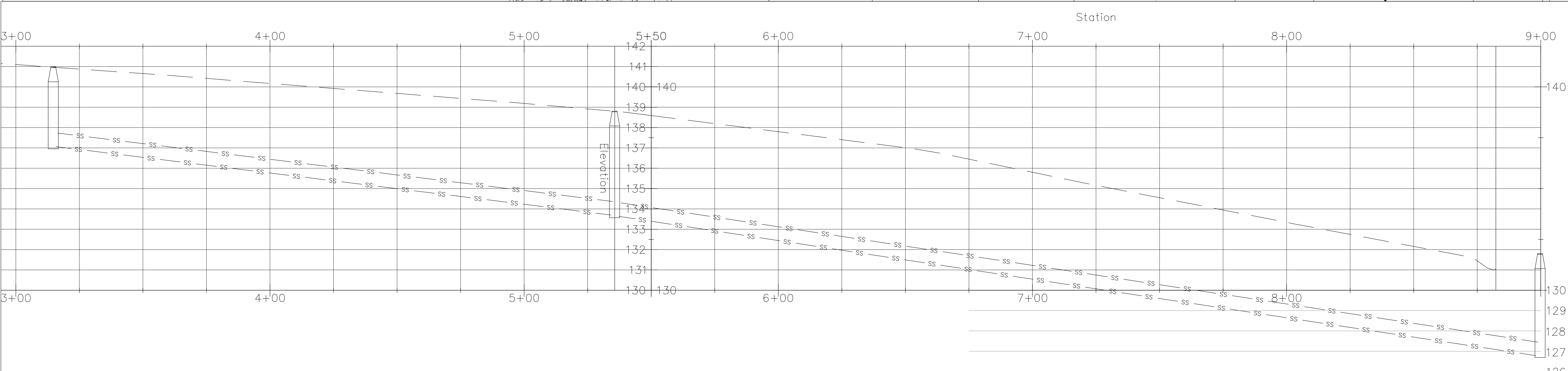
[illegible]

BID SET

CERTIFICATE OF AUTHORIZATION # 5684
ROGER DALE POLSTON P. E. # 33222
MARVIN LUTHER WOLFE P.E. # 46030

PRINTED COPIES ARE NOT VALID WITHOUT ORIGINAL SIGNATURE AND RAISED SEAL



2925 KENILWORTH BLVD., SEBRING, FLORIDA 33870
863-385-5564 PHONE -- 863-385-2462 FAX

CITY OF SEBRING
STREET IMPROVEMENTS
ORANGE ST. - NASTURTIUM TO EAST CENTER

ENGINEER JOB #
15055

PERMIT SET ORIGINAL SHEET SIZE: 24"x36"
DRAWING SCALE 1" = 20'
SHEET 3 OF 10

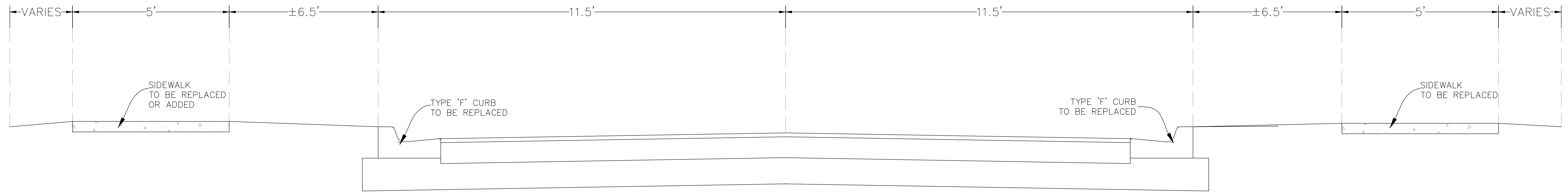

SECTION NASTURTIUM AVE.
AREA BETWEEN PINE ST. & SEBRING PKWY.
TYPICAL
N.T.S.

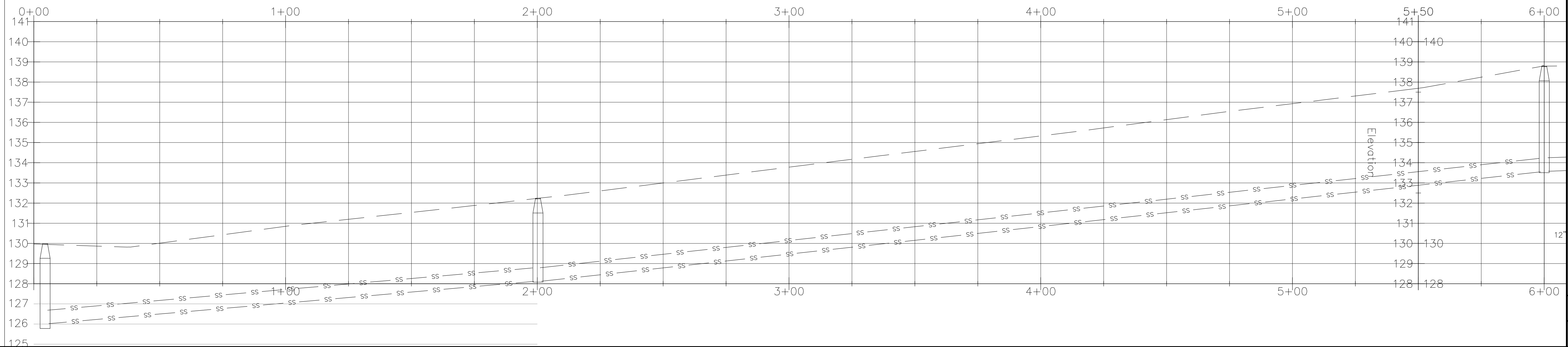
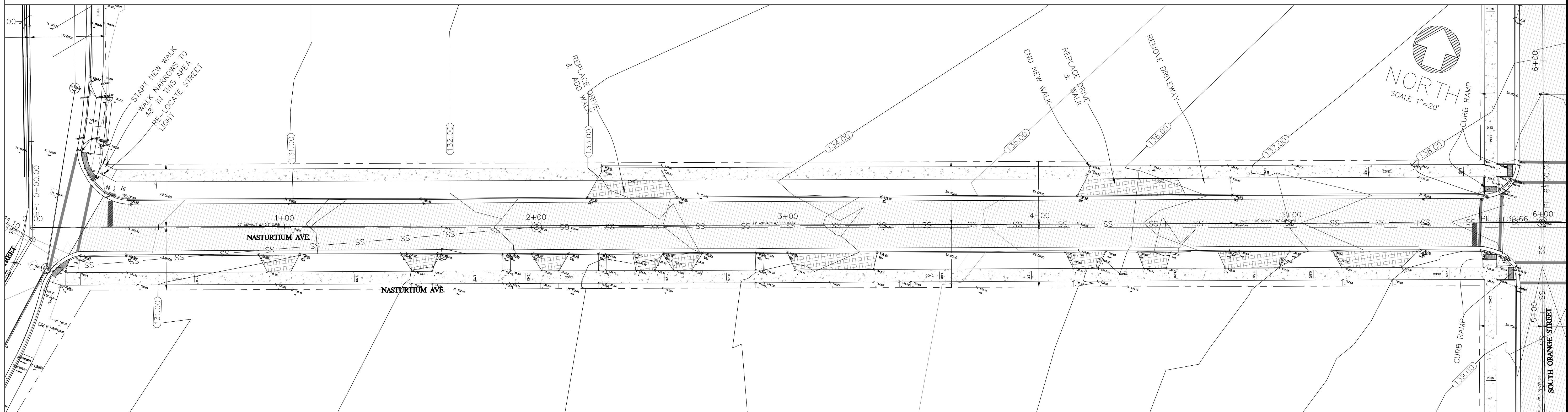

DATE	REMARK	CH
07-18-18	ORIGINAL SUBMITTAL	DRJ
		RDP

BID SET

CERTIFICATE OF AUTHORIZATION # 5684
ROGER DALE POLSTON P.E. # 53222
MARVIN LUTHER WOLFE P.E. # 46030

Polston
PE Engineering
CIVIL ENGINEERING CONSULTANTS
2925 KENILWORTH BLVD., SEBRING, FLORIDA 33870
863-385-5564 PHONE -- 863-385-2482 FAX

ENGINEER JOB #
15055

CITY OF SEBRING
STREET IMPROVEMENTS
NASTURTIUM AVE. - PINE TO ORANGE

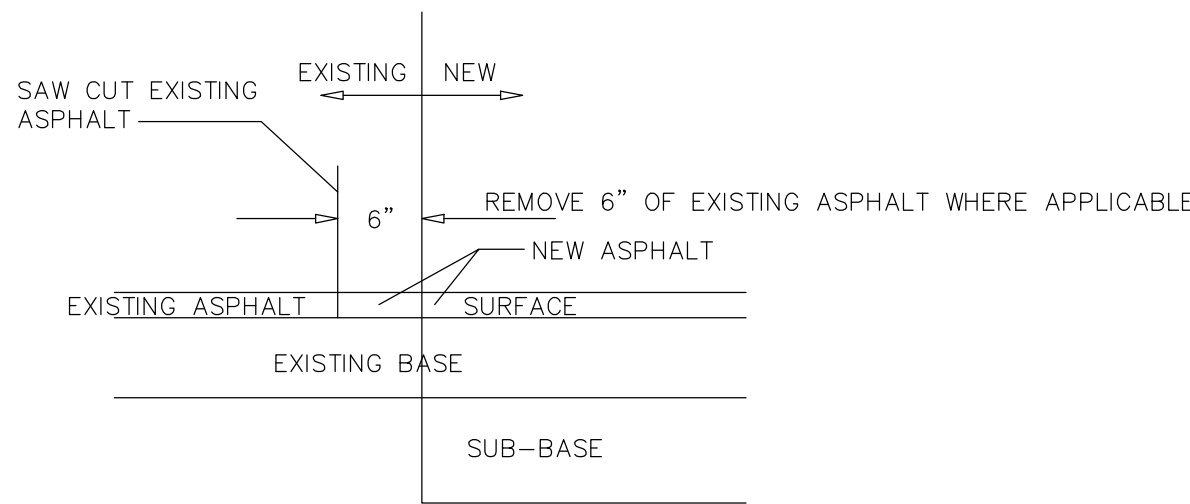

CONNECTION TO EXISTING PAVEMENT

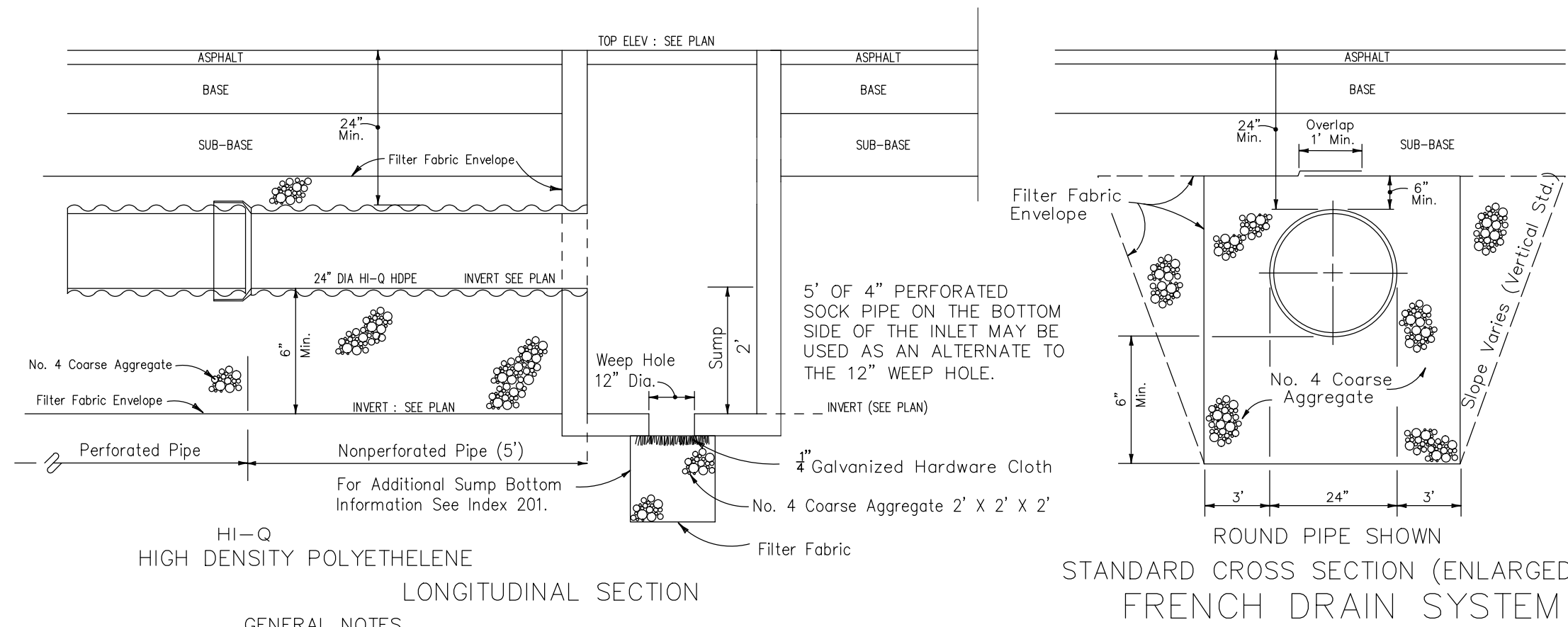

- GENERAL NOTES**
- Pipe shall be any of the optional types permitted in Section 443 of the Specifications unless otherwise restricted in the plans. Dissimilar types of pipe will not be permitted in a continuous run of pipe.
 - Filter fabric shall be Subsurface Drainage type meeting the requirements of Section 985. All filter fabric joints shall lap a minimum of one (1) foot.
 - The standard cross section shall be constructed unless other section(s) described or detailed in the plans.
 - For supplemental details see Index No. 280.
 - The contractor shall take the necessary precautions to prevent contamination of the trench with sand, silt and foreign materials.
 - The 12" diameter weep hole shall be eliminated, when the bottom of the inlet is below the normal water table, unless otherwise shown in the plans.

NOTE:
SEE PLANS FOR INLET TOPS, INVERTS, AND BOTTOMS.

NOTE:
—ALL INLETS TO HAVE A STEEL REINFORCED GRATE LIP CAST INTO THE INLET TOP. NO EXCEPTIONS.

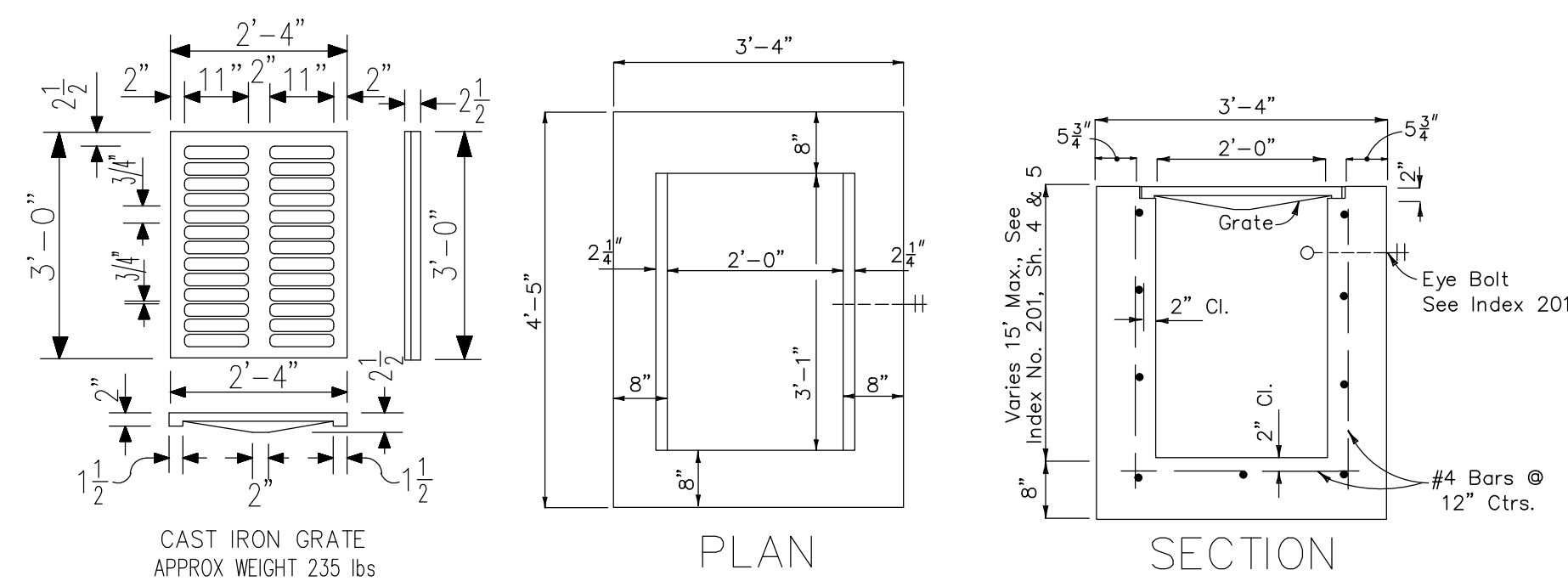

TYPE 'C' INLET

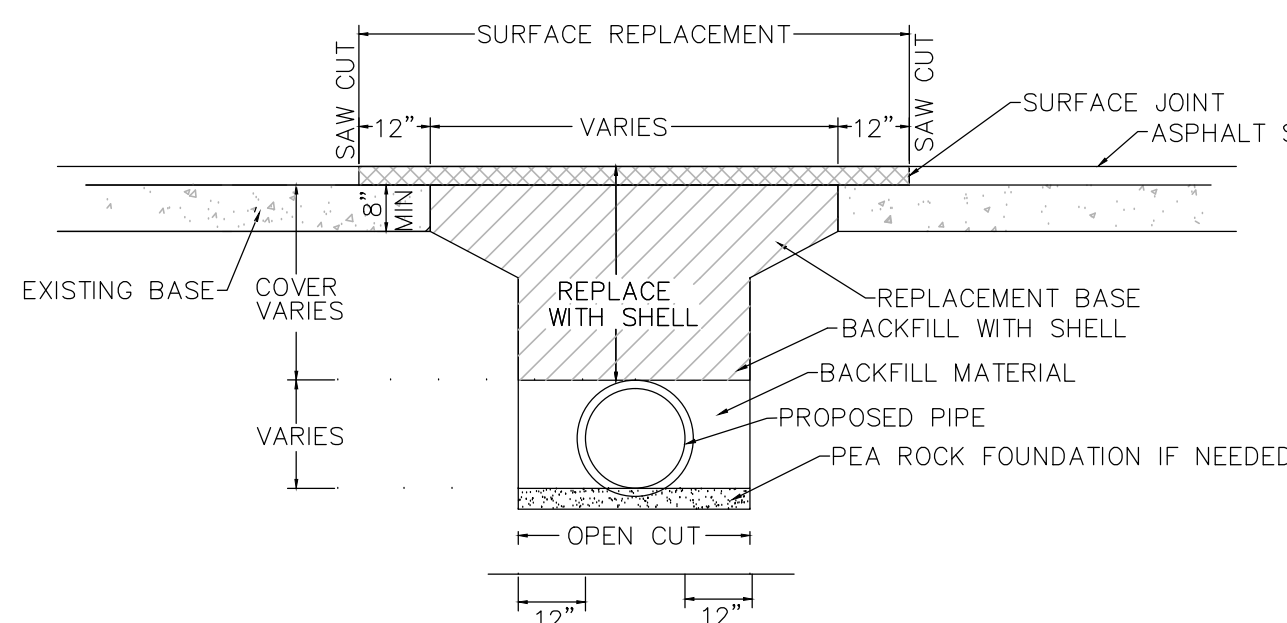

ROAD REPAIR SECTION

GENERAL NOTES

- REPLACED BASE MATERIAL OVER DITCH SHALL BE TO THE TOP OF THE PIPE AS SHOWN.
- ALL BACKFILL, INCLUDING BASE MATERIAL SHALL BE REPLACED IN 6" MINIMUM LIFTS AND EACH LIFT COMPACTED TO 98% DENSITY AS PER AASHTO T-180.
- ASPHALT CONCRETE PAVEMENT JOINTS SHALL BE MECHANICALLY SAWED.
- SURFACE TREATED PAVEMENTS SHALL BE LAPPED AND FEATHERED.
- SURFACE MATERIAL FOR THE PATCH SHALL BE 2" MINIMUM, SUPERPAVE ASPHALTIC CONCRETE, TYPE SP-9.5.
- BACKFILL MATERIAL SHALL MEET FDOT STANDARD SPECIFICATIONS.
- OVERLAY SURFACE MATERIAL SHALL BE 1.5" MINIMUM SUPERPAVE ASPHALTIC CONCRETE, TYPE SP-9.5.

INLET CURB PLACEMENT

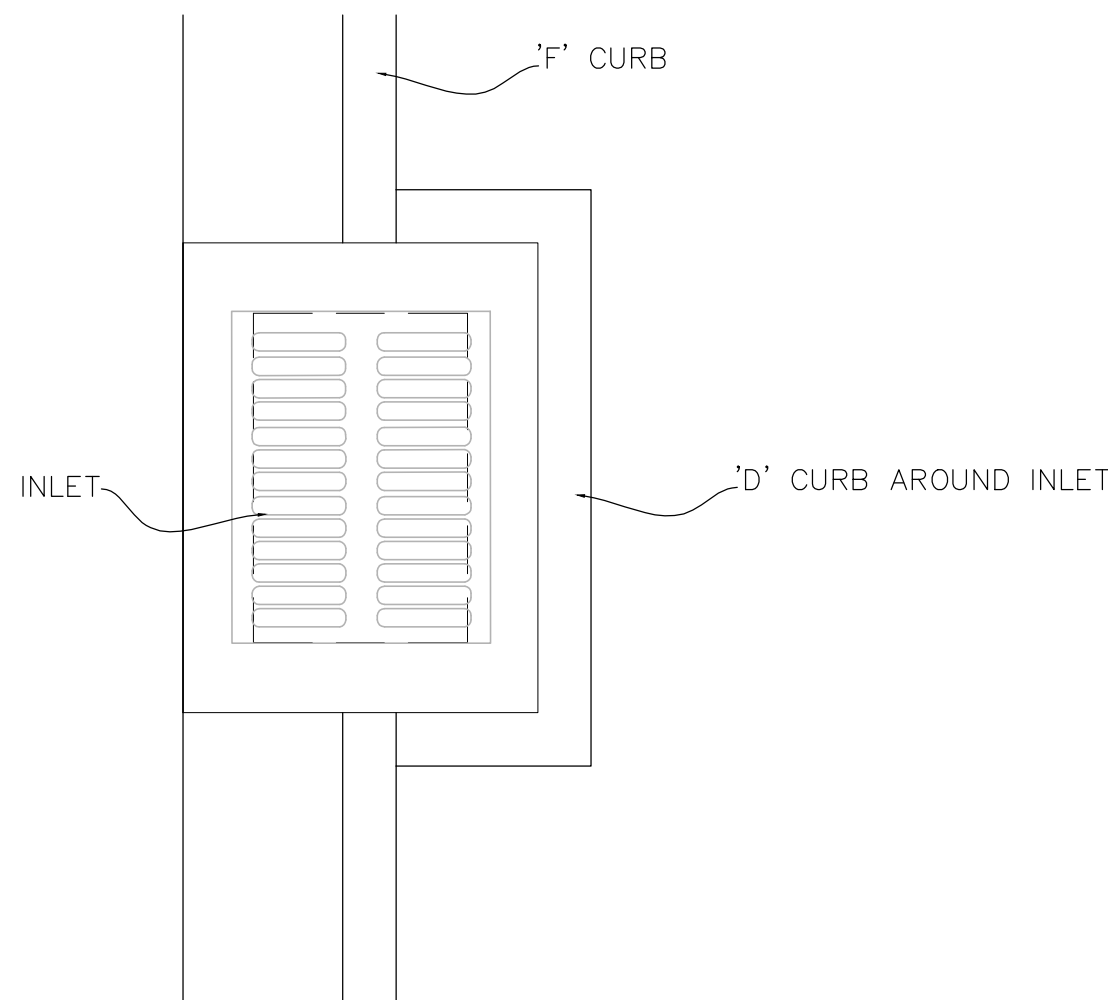

WATERLINE CROSSING TABLE

	HORIZONTAL SEPARATION	CROSSING (1)	JOINT SPACING • CROSSINGS (FULL JOINT CENTERED)
STORM SEWER, STORMWATER FORCE MAIN, RECLAIMED WATER (2)			
VACUUM SANITARY SEWER			
GRAVITY OR PRESSURE SANITARY SEWER, SANITARY SEWER FORCE MAIN, RECLAIMED WATER (4)			

- (1) WATER MAIN SHOULD CROSS ABOVE OTHER PIPE. WHEN WATER MAIN MUST BE BELOW OTHER PIPE THE MINIMUM SEPARATION IS 12 INCHES.
(2) RECLAIMED WATER REGULATED UNDER PART III OF CHAPTER 62-610, F.A.C.
(3) 3 FEET FOR GRAVITY SANITARY SEWER WHERE THE BOTTOM OF THE WATER MAIN IS LAID AT LEAST 6 INCHES ABOVE THE TOP OF THE GRAVITY SANITARY SEWER.
(4) RECLAIMED WATER NOT REGULATED UNDER PART III OF CHAPTER 62-610, F.A.C.

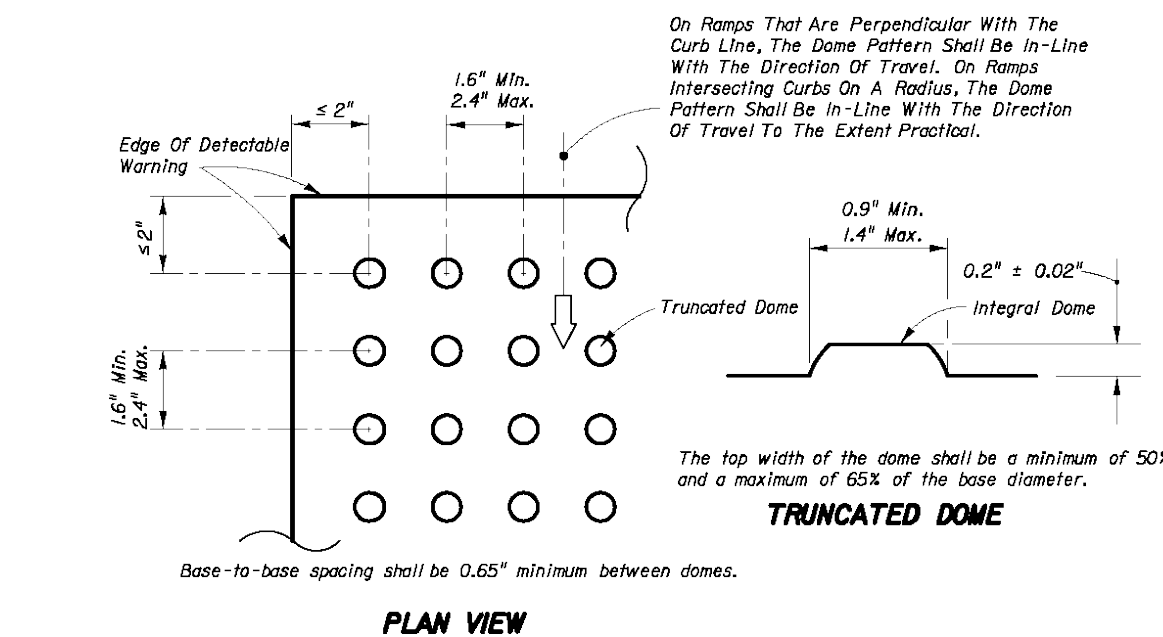

PLAN VIEW

All Sidewalk Curb Ramps Shall Have Detectable Warning Surfaces That Extend The Full Width Of The Ramp And In The Direction Of Travel 24 Inches (610 mm) From The Back Of Curb.

CURB RAMP DETECTABLE WARNING DETAIL

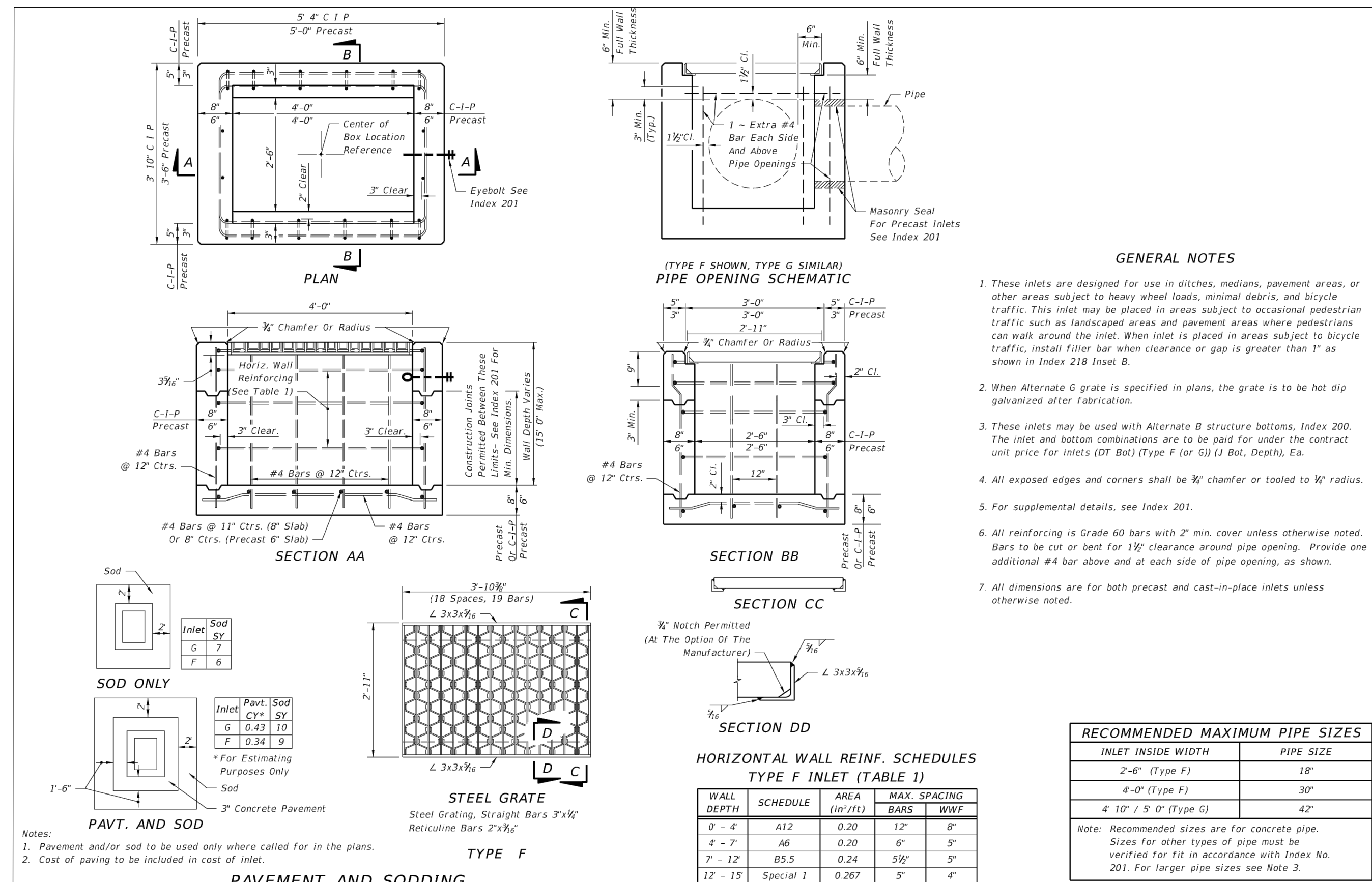

GENERAL NOTES

- These inlets are designed for use in ditches, medians, pavement areas, or other areas subject to heavy wheel loads, minimal debris, and bicycle traffic. This inlet may be placed in areas subject to occasional pedestrian traffic such as landscaped areas and pavement areas where pedestrians can walk around the inlet. When inlet is placed in areas subject to bicycle traffic, install filler bar when clearance or gap is greater than 1" as shown in Index 218 Inset B.
- When Alternate G grate is specified in plans, the grate is to be hot dip galvanized after fabrication.
- These inlets may be used with Alternate B structure bottoms, Index 200. The inlet and bottom combinations are to be paid for under the contract unit price for inlets (DT Bot) (Type F (or G)) (J Bot, Depth), Ea.
- All exposed edges and corners shall be 1/4" chamfer or tool to 1/4" radius.
- For supplemental details, see Index 201.
- All reinforcing is Grade 60 bars with 2" min. cover unless otherwise noted. Bars to be cut or bent for 18" clearance around pipe opening. Provide one additional #4 bar above and at each side of pipe opening, as shown.
- All dimensions are for both precast and cast-in-place inlets unless otherwise noted.

RECOMMENDED MAXIMUM PIPE SIZES

INLET INSIDE WIDTH	PIPE SIZE
2'-6" (Type F)	18"
4'-0" (Type F)	30"
4'-10" / 5'-0" (Type G)	42"

Note: Recommended sizes are for concrete pipe. Sizes for other types of pipe must be verified for fit in accordance with Index No. 201. For larger pipe sizes see Note 3.

HORIZONTAL WALL REIN. SCHEDULES TYPE F INLET (TABLE 1)

WALL DEPTH	SCHEDULE	AREA (in ² /ft)	MAX. SPACING
0' - 4'	A12	0.20	12"
4' - 7'	A6	0.20	6"
7' - 12'	B5.5	0.24	5 1/2"
12' - 15'	Special 1	0.267	5"

CERTIFICATE OF AUTHORIZATION # 5684
ROGER DALE POLSTON P. E. # 33222
MARVIN LUTHER WOLFE P. E. # 46030

Polston Engineering Inc.
CIVIL ENGINEERING CONSULTANTS
2925 KENILWORTH BLVD., SEBRING, FLORIDA 33870
888-365-5864 PHONE - 888-365-4492 FAX

CITY OF SEBRING
STREET IMPROVEMENTS
DETAILS

PERMIT SET
ORIGINAL SHEET SIZE: 24"x36"
DRAWING SCALE
N.T.S.
SHEET
7 OF 10

GENERAL NOTES

1. Cross Slopes and Grades:

- A. Sidewalk, ramp, and landing slopes (i.e. 0.02, 0.05, and 1:12) shown in this Index are maximums. With approval of the Engineer, provide the minimum feasible slope where the requirements cannot be met.
- B. Landings must have cross-slopes less than or equal to 0.02 in any direction.
- C. Install ramp slopes along a single linear plane (i.e. no warps or varying slope). Ramp slopes are not required to exceed 15 feet in length.
- D. Joints permitted at the location of Slope Breaks. Otherwise locate joints in accordance with Index 522-001. No joints are permitted within the ramp portion of the Curb Ramp.

2. Grade Breaks:

- Grade breaks at the top and bottom of ramps must be parallel to each other and perpendicular to the direction of the ramp slope.

3. Curb, Curb and Gutter and/or Sidewalk:

- A. Refer to Index 522-001 for concrete thickness and sidewalk details.
- B. Remove any existing curb or curb and gutter to the nearest joint beyond the curb transition or to the extent that no remaining section of curb or curb and gutter is less than 5 feet long. Remove any existing sidewalk to the nearest joint beyond the transition slope or to the extent that no remaining section of sidewalk is less than 5 feet long.

4. Curb Ramp Alpha-Identification:

- A. Sidewalk curb ramp alpha-identifications (e.g. CR-A) are provided for reference purposes in the Plans.
- B. Alpha-identifications CR-I and CR-J are intentionally omitted.

5. Detectable Warnings:

- A. Install detectable warnings in accordance with Specification 527.
- B. Place detectable warnings across the full width of the ramp or landing, to a minimum depth of 2 feet measured perpendicular to the curb line and no greater than 5 feet from the back of the curb or edge of pavement.
- C. If detectable warnings are shown in the Plans on slopes greater than 5%, align the truncated domes with the centerline of the ramp; otherwise, the truncated domes are not required to be aligned.

6. Detectable Warnings - Acceptance Criteria:

- A. Color and texture shall be complete and uniform.
- B. 90% of individual truncated domes shall be in accordance with the Americans with Disabilities Act Standards for Transportation Facilities, Section 705.
- C. There shall be no more than 4 non-compliant domes in any one square foot.
- D. Non-compliant domes shall not be adjacent to other non-compliant domes.
- E. Surfaces shall not deviate more than 0.10" from a true plane.

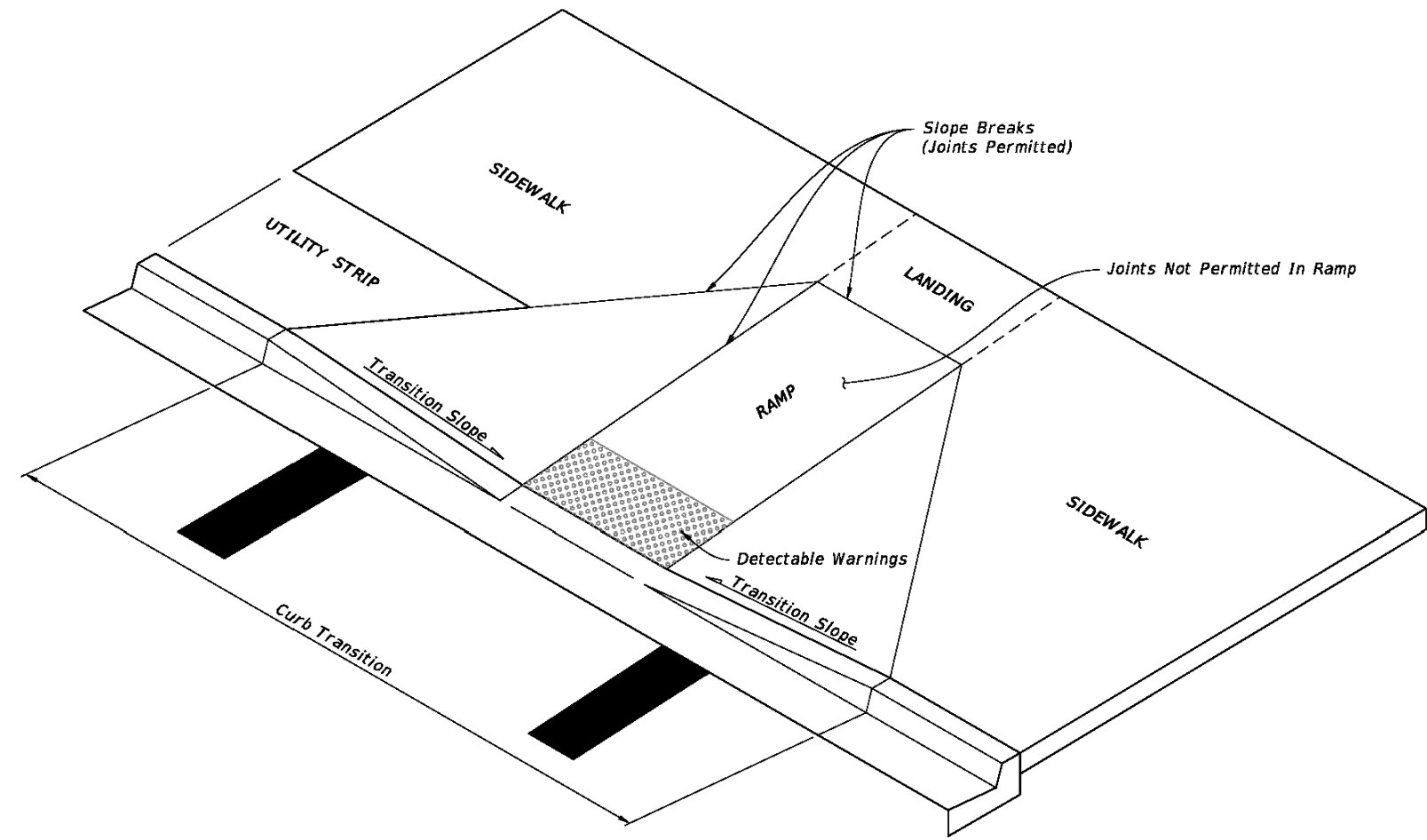

CURB RAMP NOMENCLATURE

LAST REVISION	DESCRIPTION:	FY 2018-19	INDEX	SHEET
11/01/17	STANDARD PLANS	DETECTABLE WARNINGS AND SIDEWALK CURB RAMPS	522-002	1 of 8

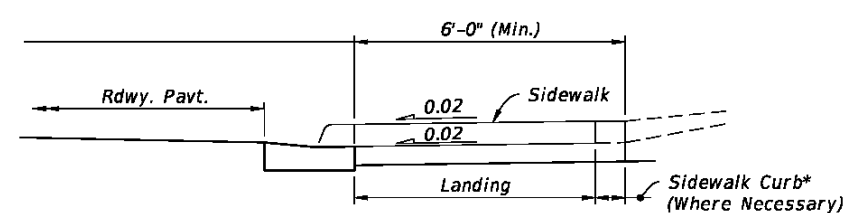
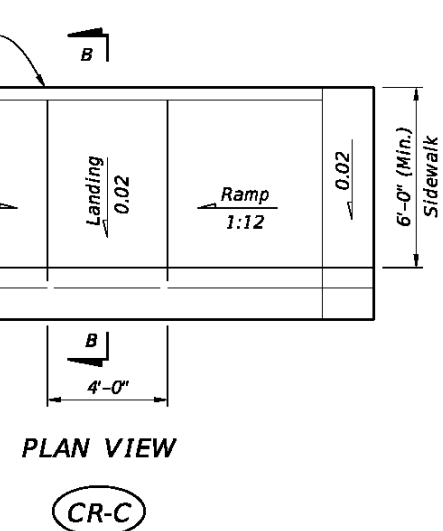
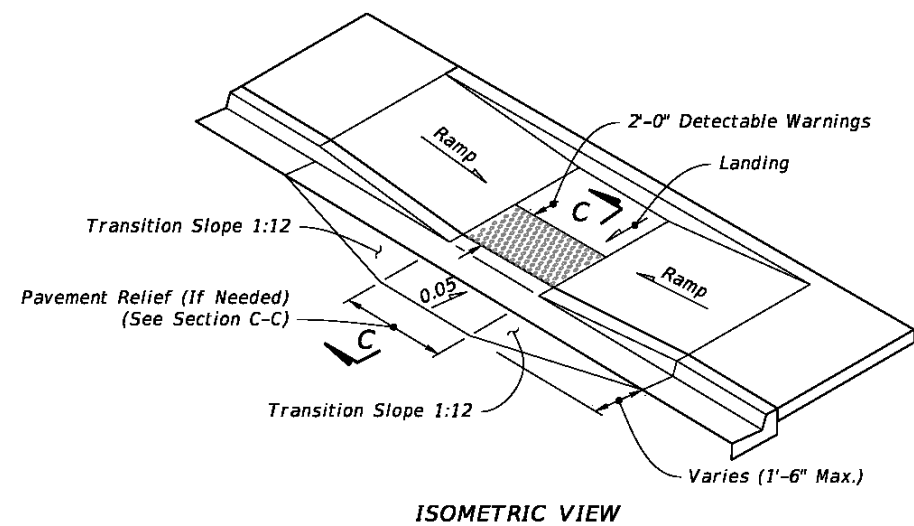

* Note: For Additional Information On Sidewalk Curb Construction, See SIDEWALK CURB OPTIONS details.

SECTION B-B

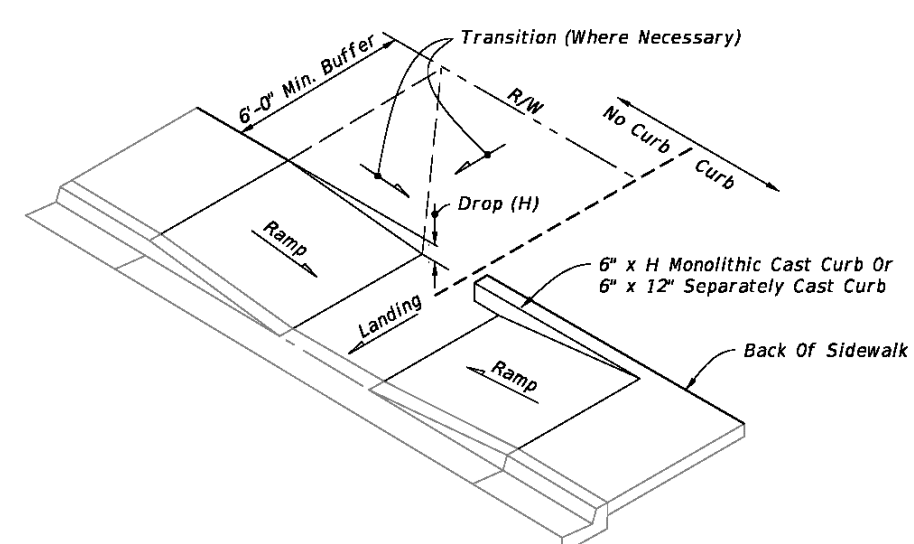

CONSTRUCTION OF SIDEWALK CURB IN CUT SECTIONS

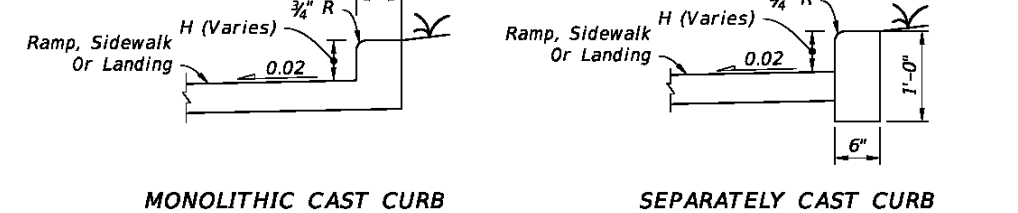

MONOLITHIC CAST CURB

SEPARATELY CAST CURB

SIDEWALK CURB OPTIONS

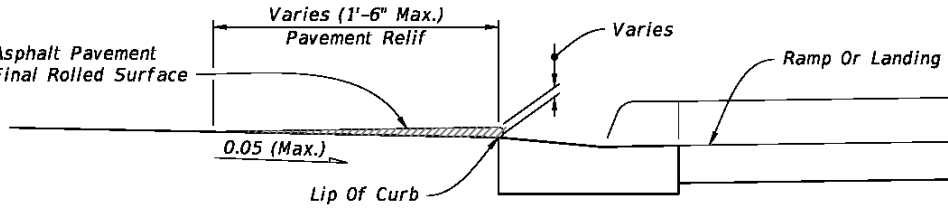

Note: Remove Elevated Pavement By Spading And Rolling, Smooth Milling or Grinding.

SECTION C-C

SIDEWALK CURB RAMPS CR-C AND SIDEWALK CURB

LAST REVISION	DESCRIPTION:	FY 2018-19	INDEX	SHEET
11/01/17	STANDARD PLANS	DETECTABLE WARNINGS AND SIDEWALK CURB RAMPS	522-002	3 of 8

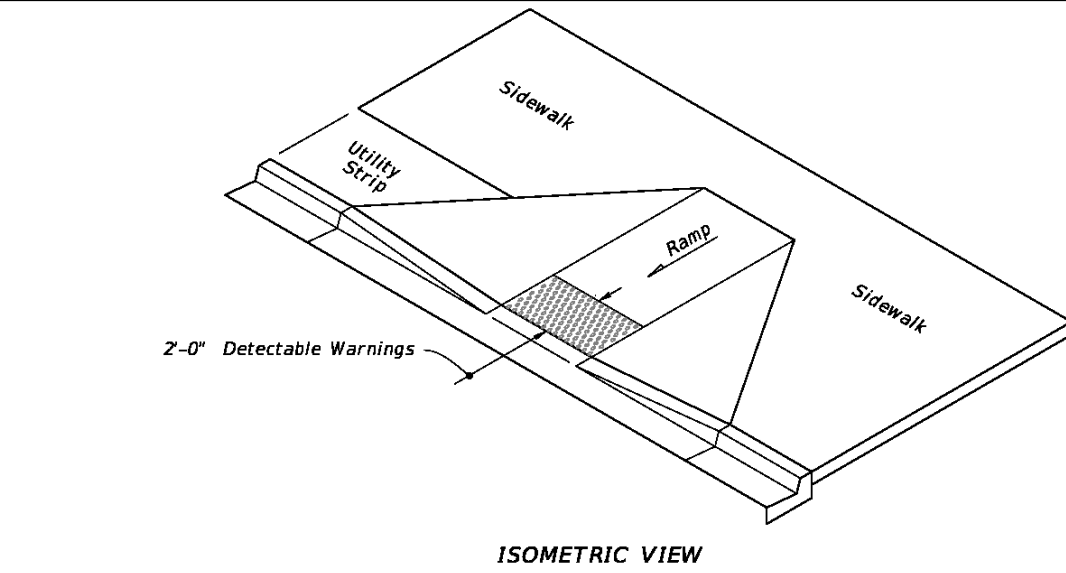

ISOMETRIC VIEW

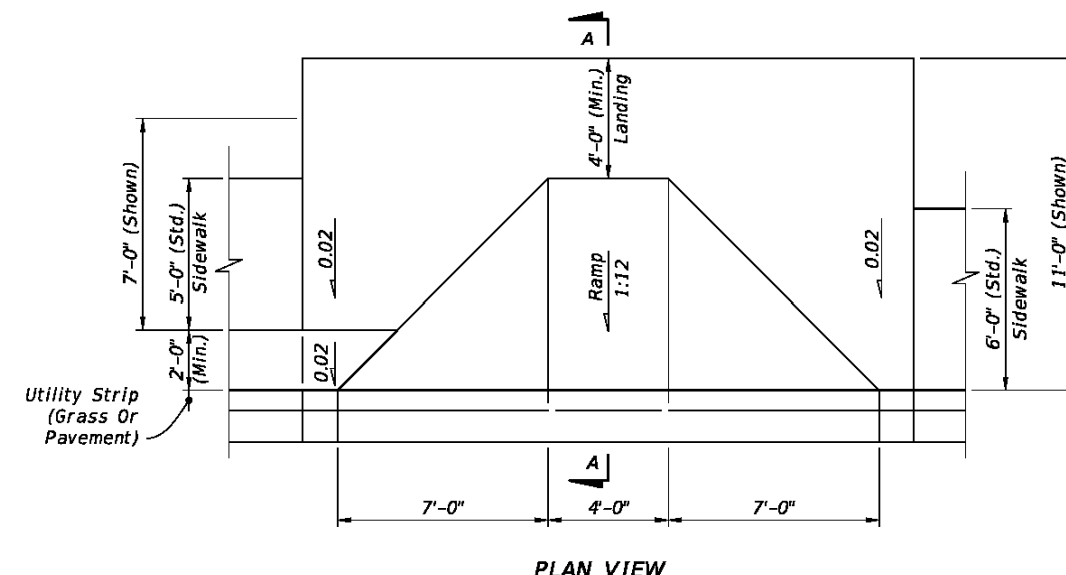

PLAN VIEW

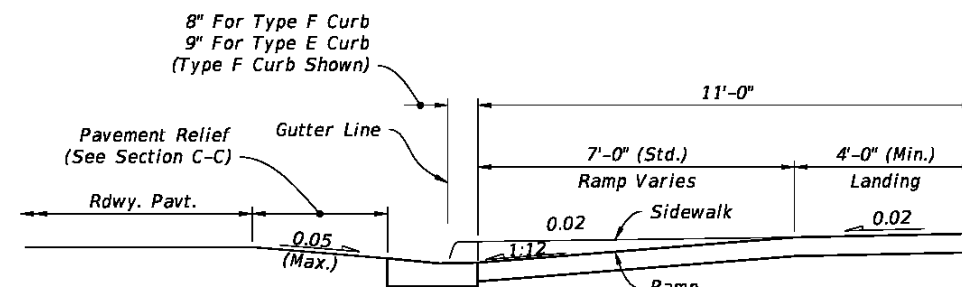

SECTION A-A

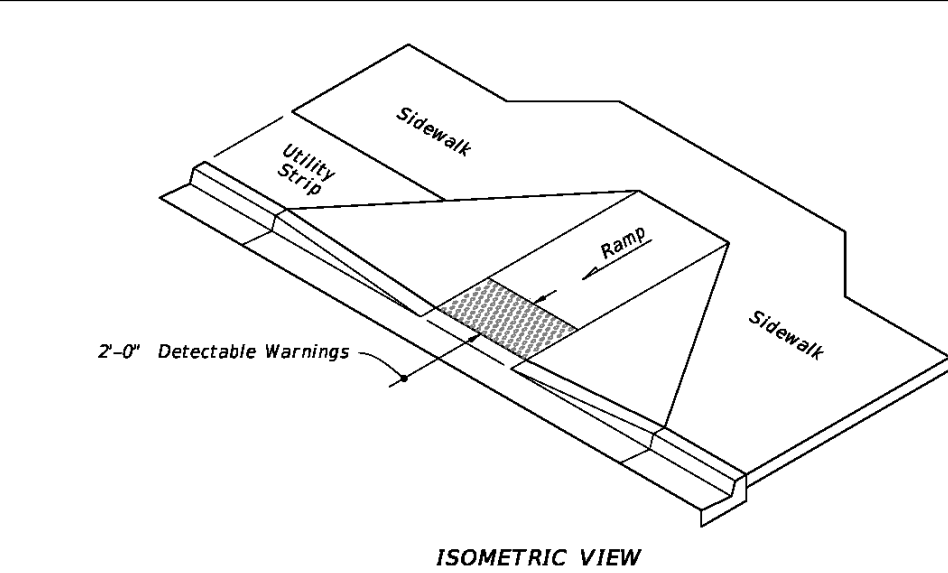

ISOMETRIC VIEW

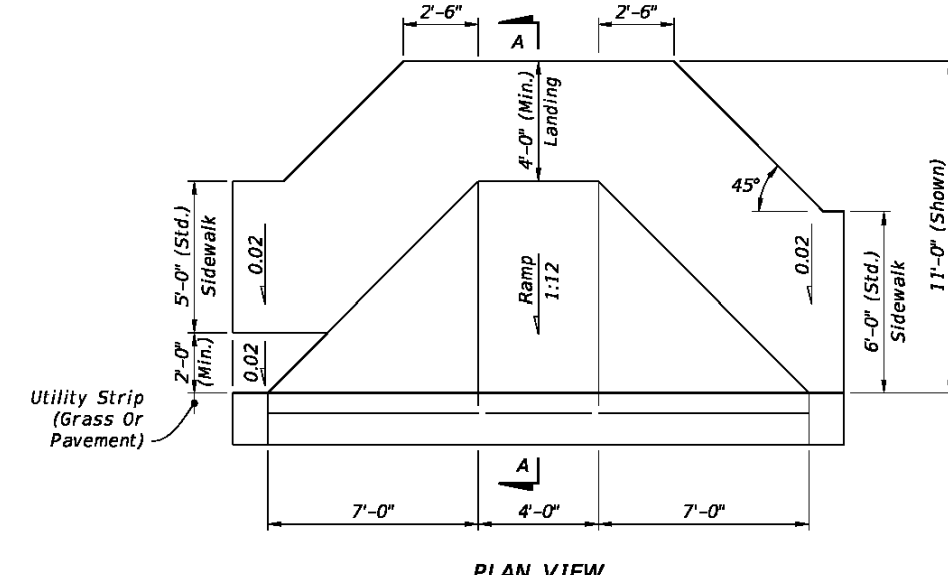

PLAN VIEW

SIDEWALK CURB RAMPS CR-A AND CR-B

LAST REVISION	DESCRIPTION:	FY 2018-19	INDEX	SHEET
11/01/17	STANDARD PLANS	DETECTABLE WARNINGS AND SIDEWALK CURB RAMPS	522-002	2 of 8

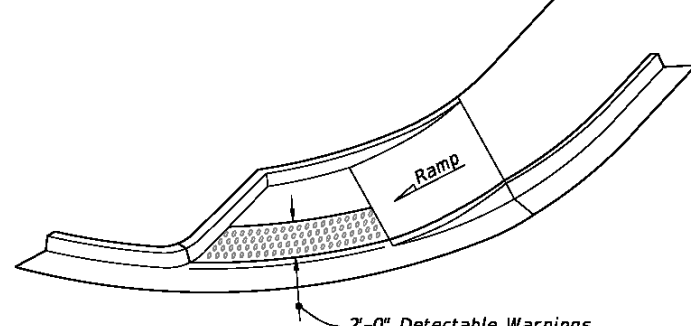

ISOMETRIC VIEW

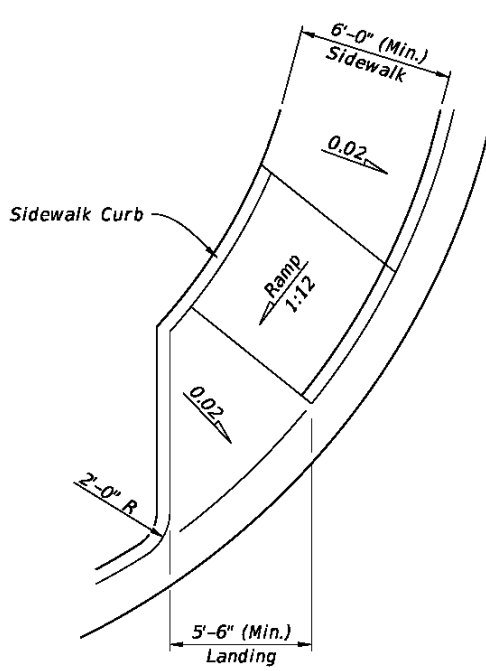

PLAN VIEW

CR-D

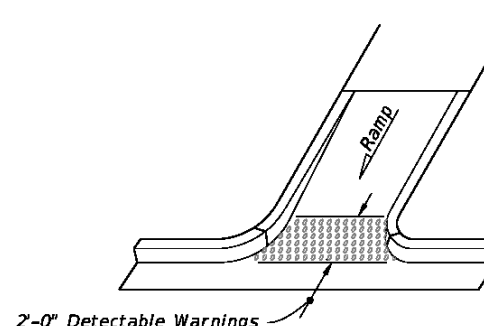

ISOMETRIC VIEW

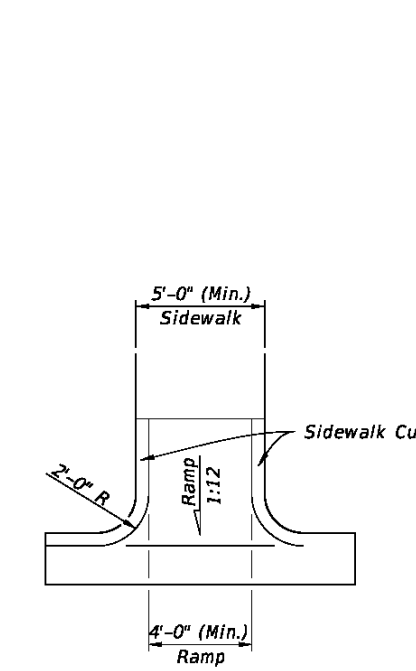

PLAN VIEW

CR-E

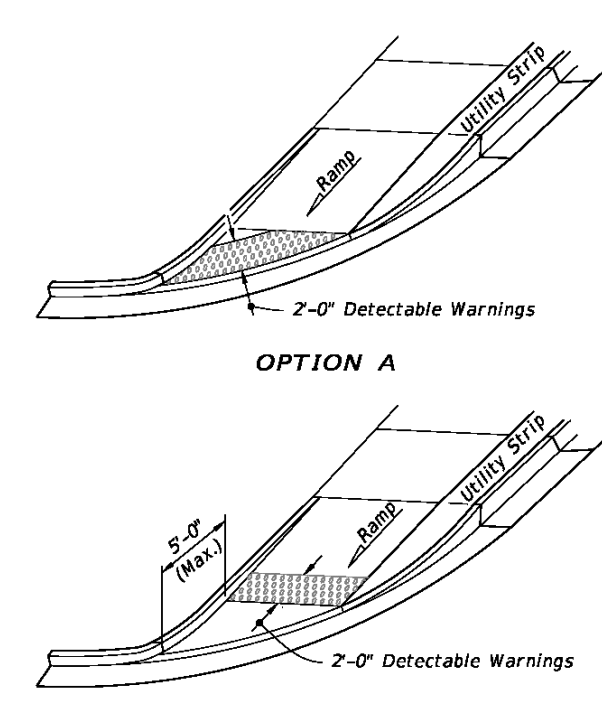

ISOMETRIC VIEW

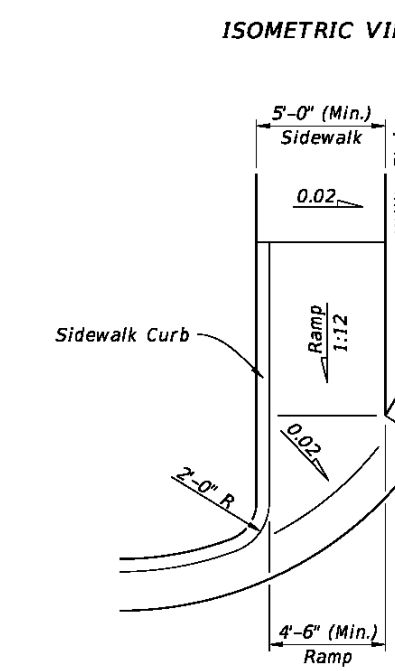

PLAN VIEW

CR-F

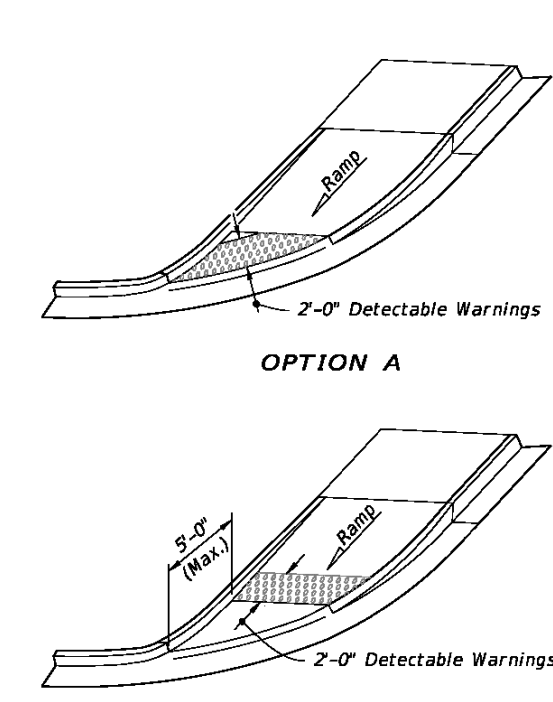

ISOMETRIC VIEW

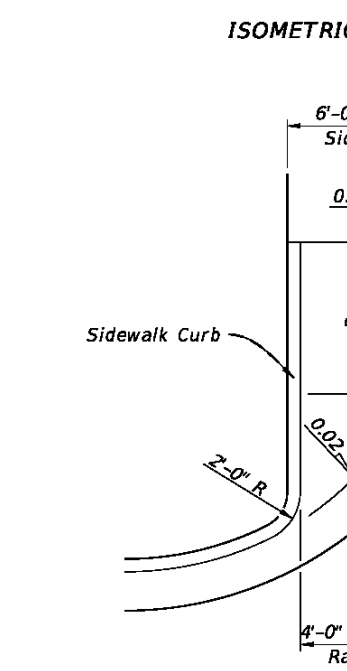

PLAN VIEW

CR-G

SIDEWALK CURB RAMPS CR-D, CR-E, CR-F & CR-G

LAST REVISION	DESCRIPTION:	FY 2018-19	INDEX	SHEET
11/01/17	STANDARD PLANS	DETECTABLE WARNINGS AND SIDEWALK CURB RAMPS	522-002	4 of 8

DATE	REMARK	CH
07-18-18	ORIGINAL SUBMITTAL	RDP

BID SET

CERTIFICATE OF AUTHORIZATION # 5684
ROGER DALE POLSTON P.E. # 33222
MARVIN LUTHER WOLFE P.E. # 46030



CITY OF SEBRING
STREET IMPROVEMENTS
DETAILS

PERMIT SET
ORIGINAL SHEET SIZE: 24"x36"
DRAWING SCALE
N.T.S.
SHEET
8 OF 10

