

3/10/2022 4:20 PM
Z:\21201 - HCS - HES PLAYGROUND DESIGN\DRAWINGS\SHEET DRAWINGS\21201 COVER NOTES.DWG

HOMEWOOD ELEMENTARY SCHOOL PLAYGROUND

FOR

HORRY COUNTY SCHOOLS



DEVELOPMENT RESOURCE GROUP, LLC
4703 OLEANDER DRIVE
MYRTLE BEACH, SC 29577
843-839-3350 | DRGPLLC.COM



PROJECT SUMMARY

SITE LOCATION
HOMEWOOD ELEMENTARY SCHOOL
108 N CLEMSON CIR
CONWAY, SC 29526

SHEET INDEX

HORIZONTAL DATUM : NAD 83
VERTICAL DATUM : NAVD 88
BENCHMARK : 1/2" IRON PIPE (SEE SHEET C3.0)
NPDES PERMIT : N/A
SCDHEC WATER PERMIT : N/A
SCDHEC SEWER PERMIT : N/A



LOCATION MAP / VICINITY MAP
SCALE N.T.S.

DESCRIPTION	SHEET
COVER SHEET	C1.0
GENERAL NOTES	C2.0
EXISTING CONDITIONS & DEMO PLAN	C3.0
SITE PLAN	C4.0
GRADING & DRAINAGE PLAN	C5.0
DRAINAGE PROFILE	C5.1
EROSION & SEDIMENT CONTROL	C6.0 - C6.1
DETAILS	C7.0

PARCEL PIN #'(S) :	32500000036
CURRENT ZONING :	R1 (CITY OF CONWAY)
PROPOSED LAND USE :	ELEMENTARY SCHOOL
TOTAL PROJECT AREA =	24.23 ACRES
LAND DISTURBANCE AREA =	2.33 ACRES
<u>IMPERVIOUS AREAS =</u>	<u>0.17 ACRES (7%)</u>
PLAYGROUND AREAS =	0.17 ACRES
<u>PERVIOUS AREAS =</u>	<u>2.16 ACRES (93%)</u>
GRASS/LANDSCAPING =	2.16 ACRES
WETLAND AREA =	NONE
POND AREA =	NONE

THIS PROPERTY IS LOCATED IN FLOOD ZONE "X" AS SCALED FROM F.I.R.M. No. 45051C0531 K, DATED DECEMBER 16, 2021, THIS PLAT IS NOT THE BASIS FOR FLOOD ZONE DETERMINATION OR FLOOD ZONE RELATED ISSUES.

CONTRACTOR SHALL BE KNOWLEDGEABLE WITH LOCAL, CITY, COUNTY, STATE, AND FEDERAL REGULATIONS AS THEY MAY PERTAIN TO THIS PROJECT AND SHALL ADHERE TO THESE REGULATIONS.

INFORMATION REGARDING THE PRESENCE, SIZE, CHARACTER, AND LOCATION OF ANY UNDERGROUND UTILITY AND/OR STRUCTURE SHOWN ON THIS PLAN IS APPROXIMATE. IT IS THE CONTRACTOR'S RESPONSIBILITY TO HAVE ALL UNDERGROUND UTILITIES LOCATED.

COVER SHEET
HOMEWOOD ELEMENTARY SCHOOL PLAYGROUND

PREPARED FOR:
HORRY COUNTY SCHOOLS
335 FOUR MILE ROAD (29526)
PO BOX 260005, CONWAY, SC 29528
TREVOR TURNER

PLANS FOR PERMITTING

JOB NO: 21.201
SCALE: NTS
DRAWN BY: PJC
CHECKED BY: WAG
APPROVED BY: WAG
DATE: 03/10/2022

SHEET NUMBER:

C1.0



**Know what's below.
Call before you dig.**

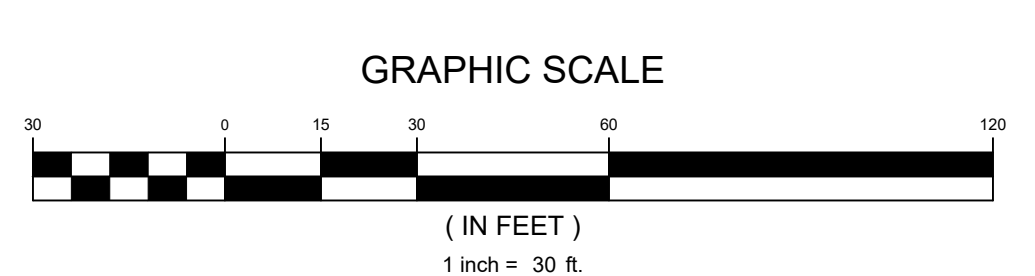
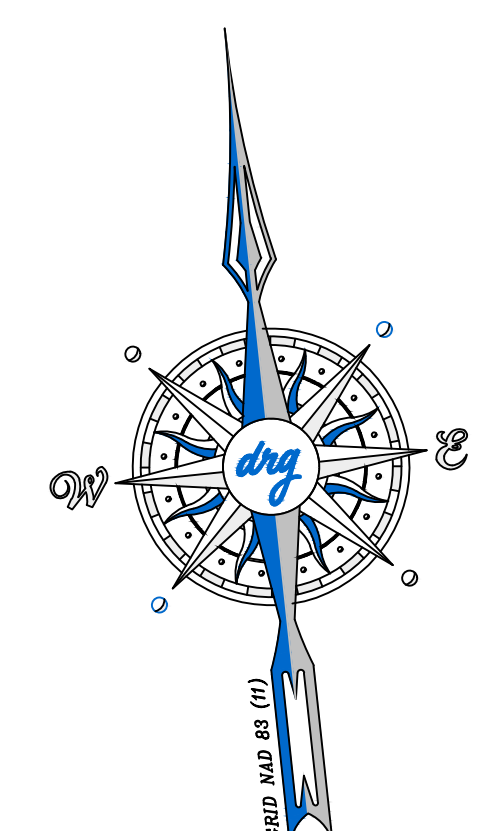
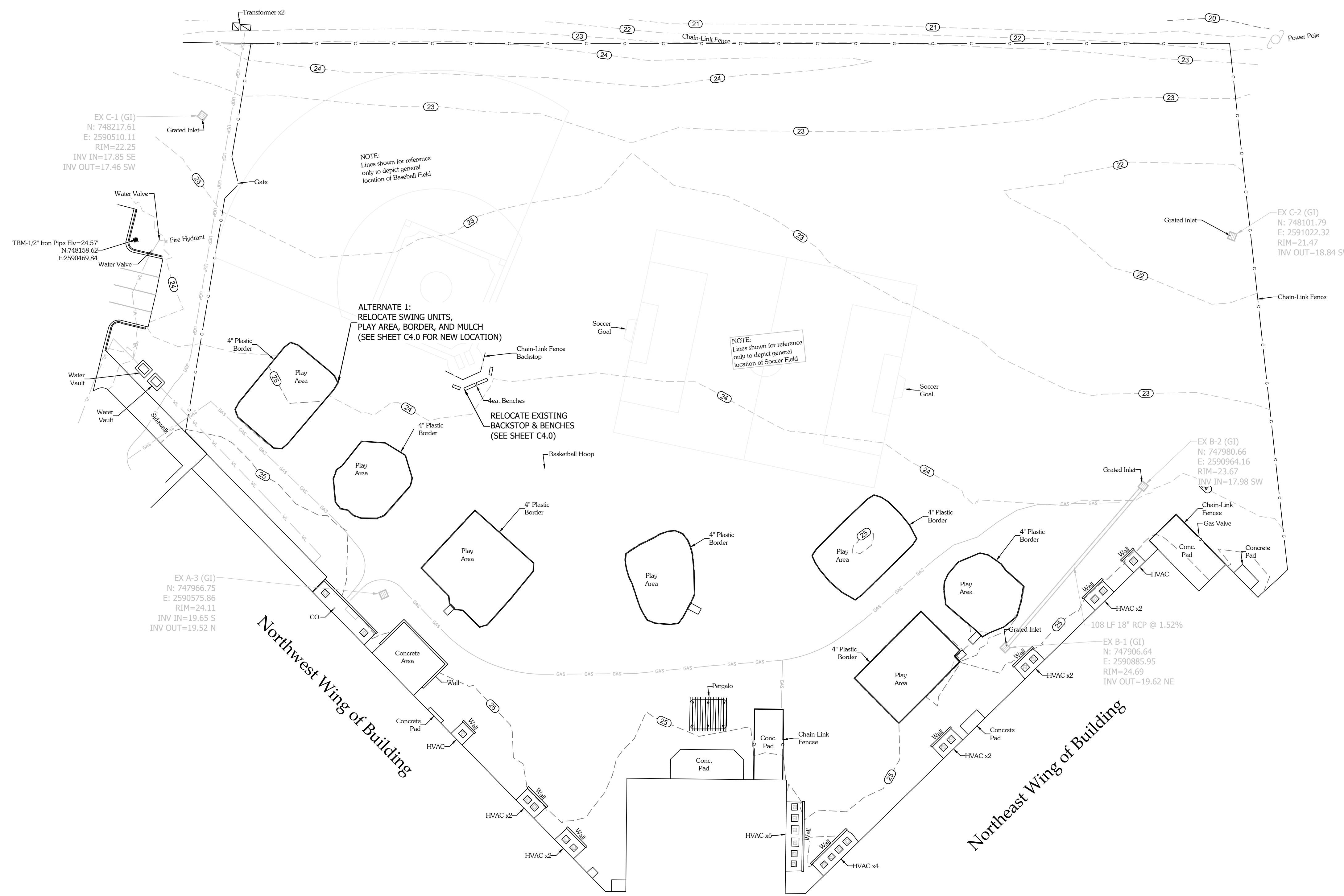

DEVELOPMENT RESOURCE GROUP, LLC
 4703 OLEANDER DRIVE
 MYRTLE BEACH, SC 29577
 843-839-3350 | DRGPLLC.COM



EXISTING CONDITIONS & DEMO PLAN
HOMWOOD ELEMENTARY SCHOOL PLAYGROUND

PREPARED FOR:
 Horry County Schools
 335 FOUR MILE ROAD (29526)
 PO BOX 260005, CONWAY, SC 29528
 TREVOR TURNER

PLANS FOR PERMITTING

JOB NO: 21.201
 SCALE: 1" = 30'
 DRAWN BY: PJC
 CHECKED BY: WAG
 APPROVED BY: WAG
 DATE: 03/10/2022

SHEET NUMBER:
C3.0

3/11/2022 12:08 PM
Z:\21201 - HCS - HES PLAYGROUND DESIGN\DRAWINGS\SHEET DRAWINGS\21201 SITE PLAN.DWG

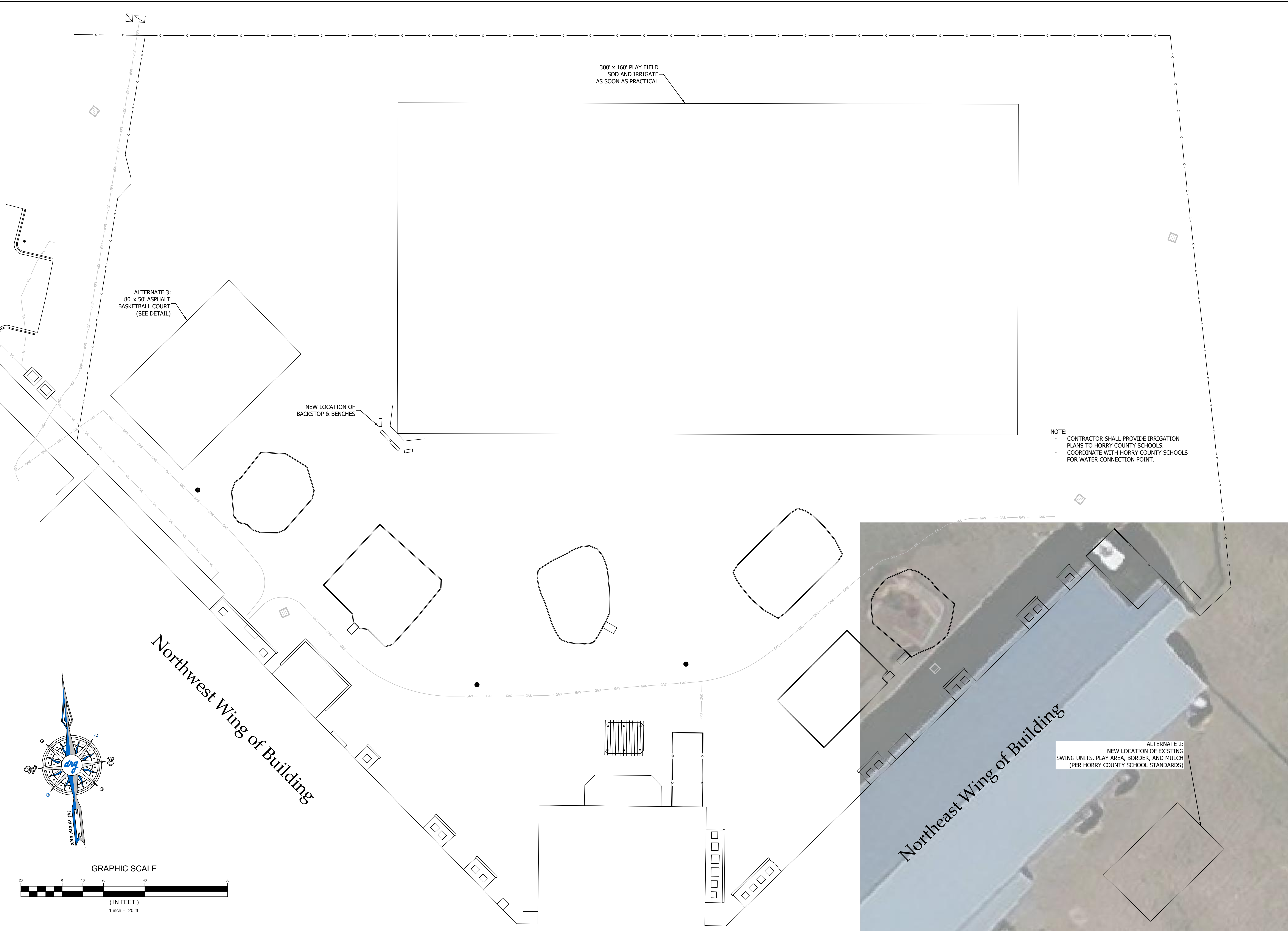

NOTE:
 - CONTRACTOR SHALL PROVIDE IRRIGATION PLANS TO Horry COUNTY SCHOOLS.
 - COORDINATE WITH Horry COUNTY SCHOOLS FOR WATER CONNECTION POINT.



DEVELOPMENT RESOURCE GROUP, LLC
 4703 OLEANDER DRIVE
 MYRTLE BEACH, SC 29577
 843-839-3350 | DRGPLLC.COM

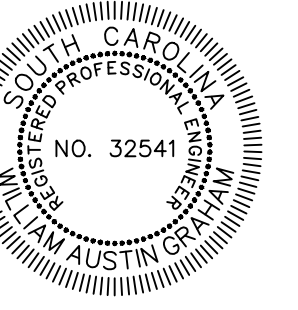

SITE PLAN
 HOMEWOOD ELEMENTARY SCHOOL PLAYGROUND

PREPARED FOR:
 Horry COUNTY SCHOOLS
 335 FOUR MILE ROAD (29526)
 PO BOX 260005, CONWAY, SC 29528
 TREVOR TURNER

PLANS FOR PERMITTING

JOB NO:	21.201
SCALE:	1" = 20'
DRAWN BY:	PJC
CHECKED BY:	WAG
APPROVED BY:	WAG
DATE:	03/10/2022

SHEET NUMBER:

C4.0

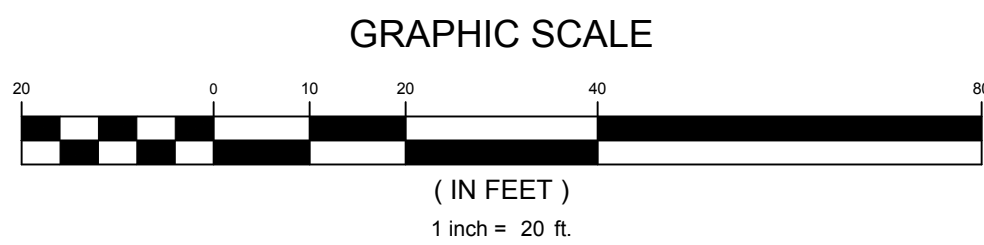
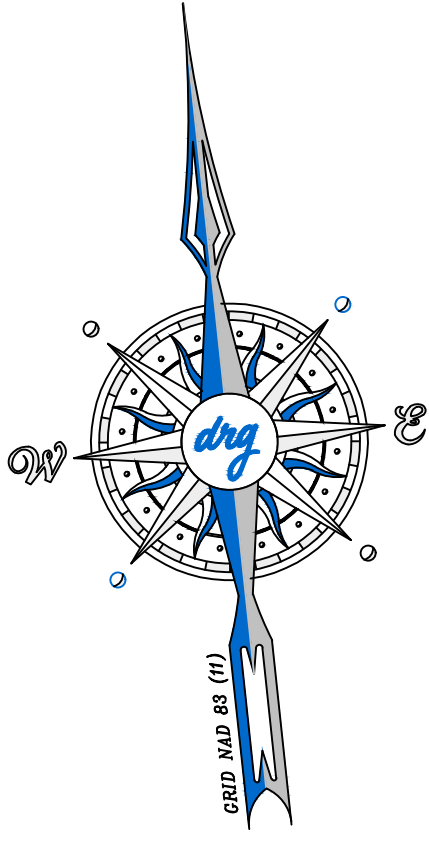

Z:\21201 - HCS - HES PLAYGROUND\DESIGN\DRAWINGS\SHEET DRAWINGS\21201 DRAINAGE\GRADING PLAN.DWG
 3/10/2022 4:20 PM

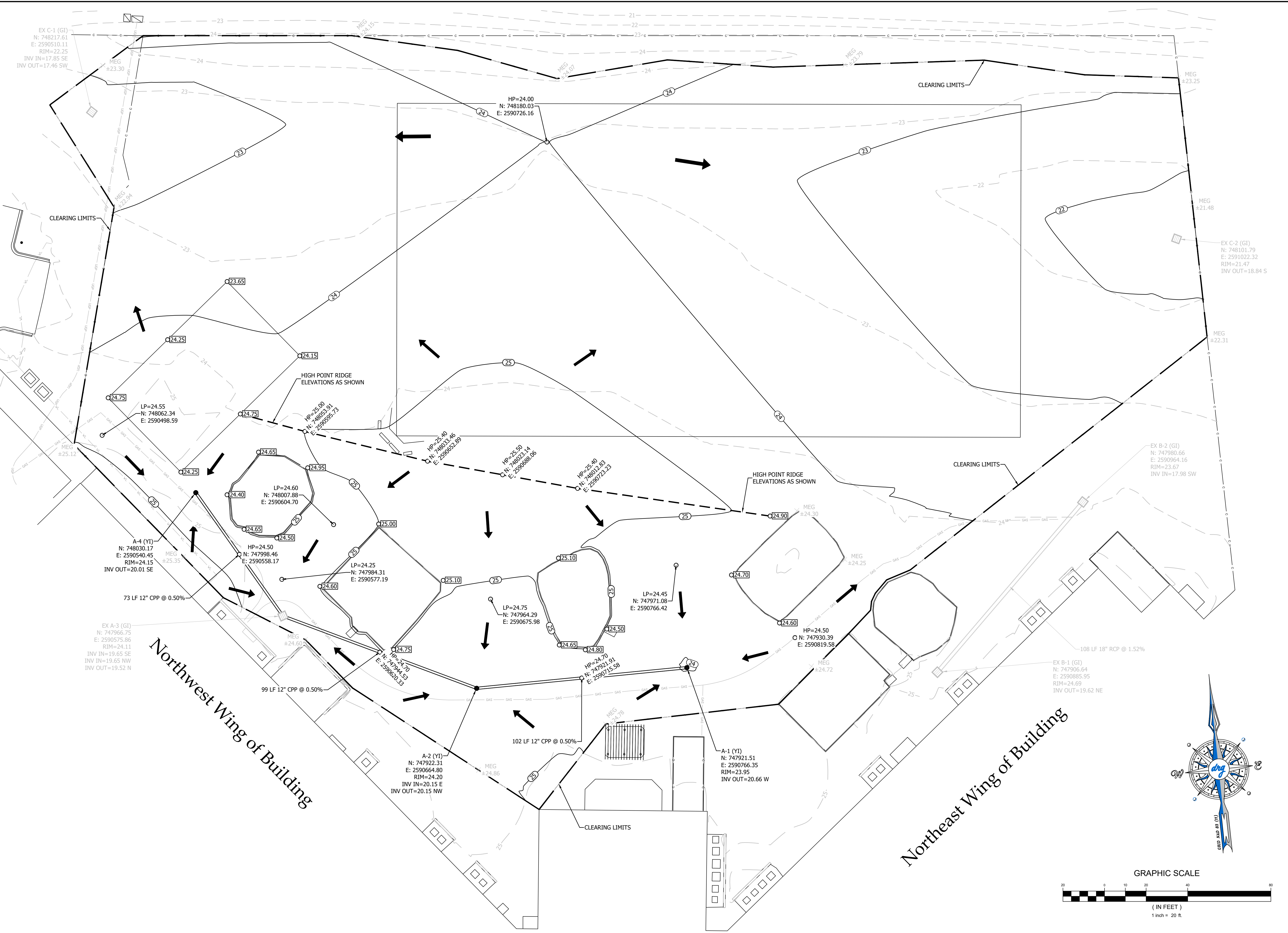

JOB NO:	21.201
SCALE:	1" = 20'
DRAWN BY:	PJC
CHECKED BY:	WAG
APPROVED BY:	WAG
DATE:	03/10/2022
SHEET NUMBER:	C5.0

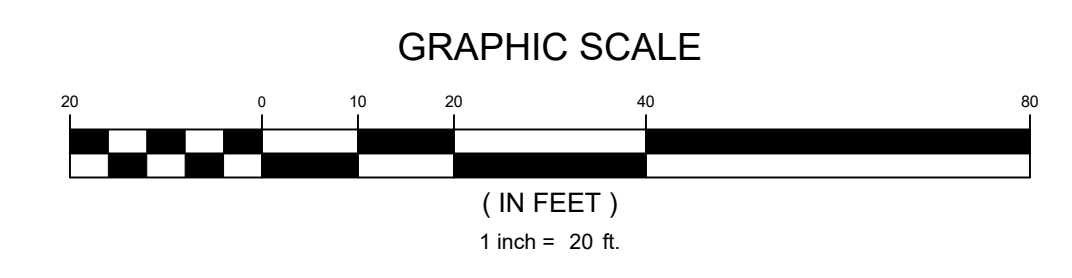
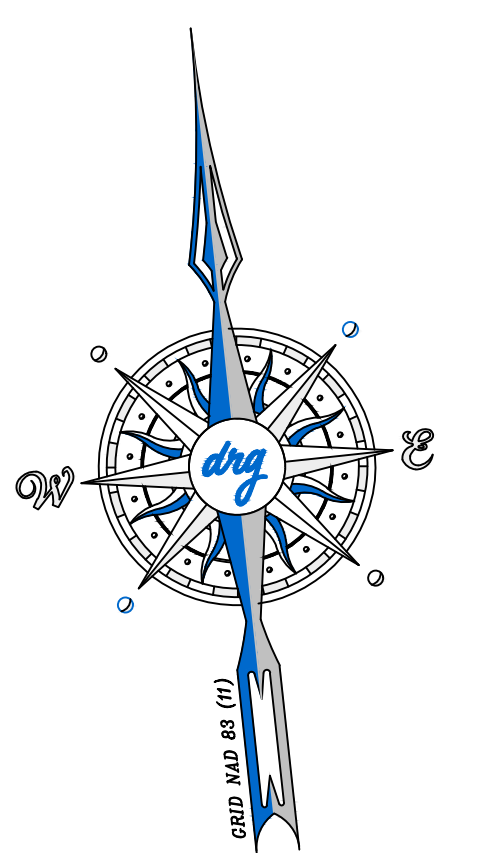

Northeast Wing of Building

Northwest Wing of Building

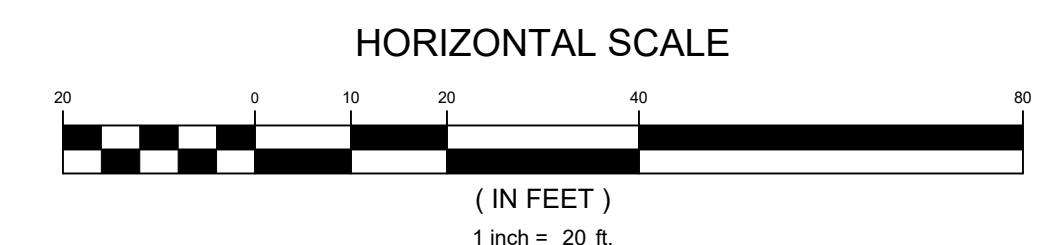
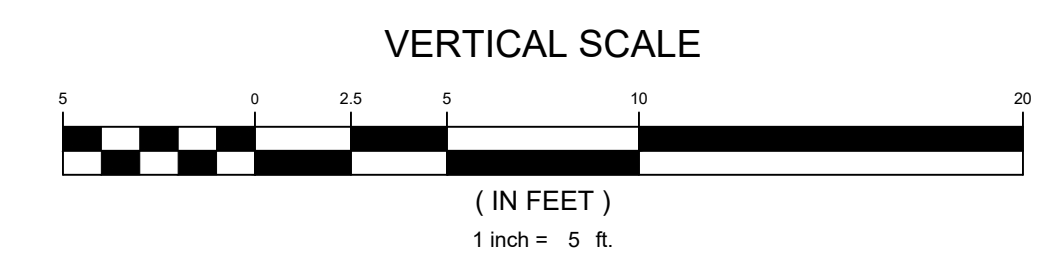
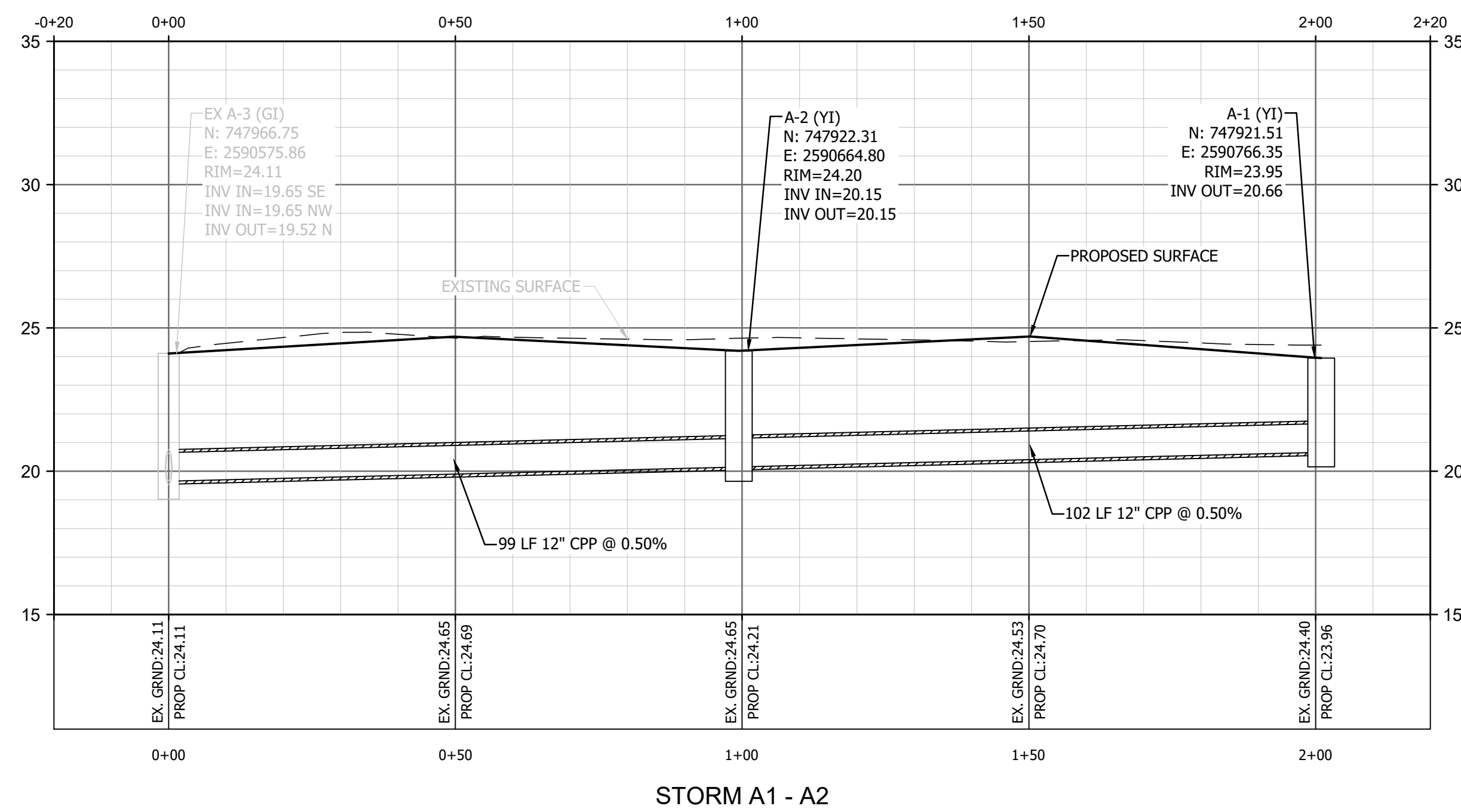
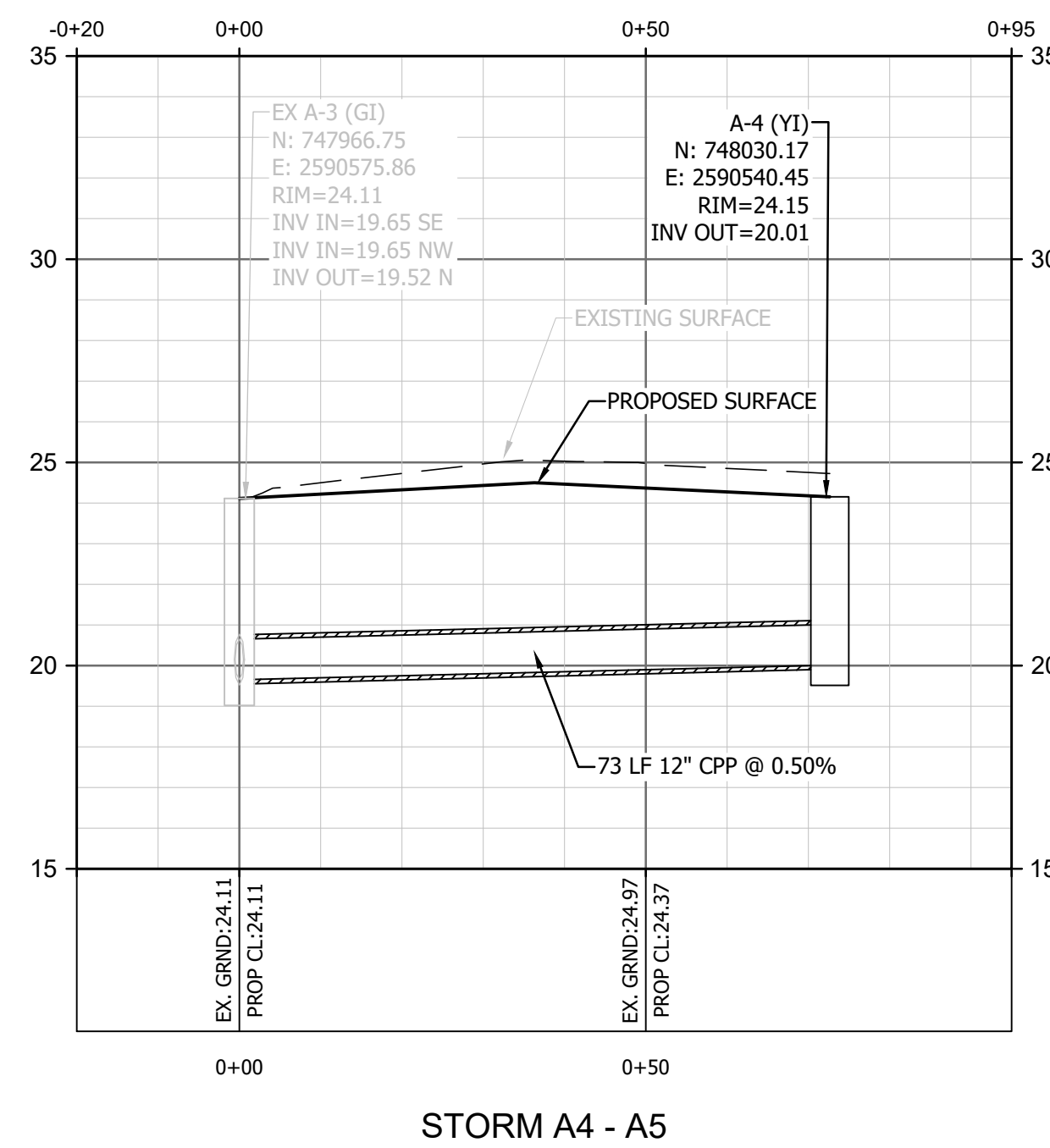

DEVELOPMENT RESOURCE GROUP, LLC
4703 OLEANDER DRIVE
MYRTLE BEACH, SC 29577
843-839-3350 | DRGPLLC.COM



DRAINAGE PROFILE
HOMEWOOD ELEMENTARY SCHOOL PLAYGROUND

PREPARED FOR:
HORRY COUNTY SCHOOLS
335 FOUR MILE ROAD (29526)
PO BOX 260005, CONWAY, SC 29528
TREVOR TURNER

PLANS FOR PERMITTING

JOB NO: 21.201
SCALE: AS SHOWN
DRAWN BY: PJC
CHECKED BY: WAG
APPROVED BY: WAG
DATE: 03/10/2022

SHEET NUMBER:

C5.1

3/10/2022 4:21 PM

Z:\21201 - HCS - HES PLAYGROUND\DESIGN\DRAWINGS\SHEET DRAWINGS\21201 ESC PLAN.DWG

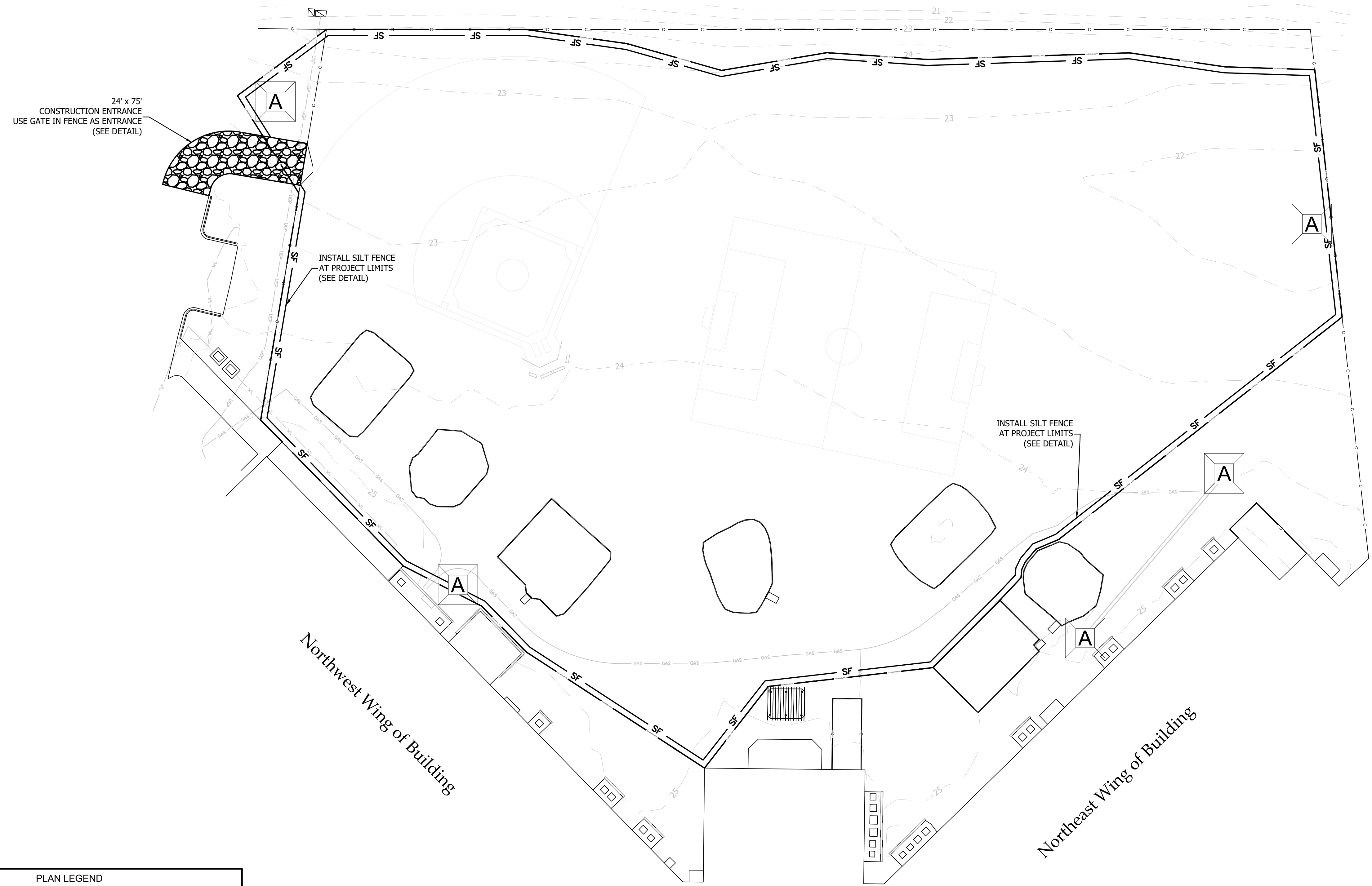

24' x 75'
CONSTRUCTION ENTRANCE
USE GATE IN FENCE AS ENTRANCE
(SEE DETAIL)

INSTALL SILT FENCE
AT PROJECT LIMITS
(SEE DETAIL)

INSTALL SILT FENCE
AT PROJECT LIMITS
(SEE DETAIL)

Northwest Wing of Building

Northeast Wing of Building

PLAN LEGEND

- SILT FENCE (SEE DETAIL)
- STREET SWEEPING
- TYPE A INLET PROTECTION (FABRIC & STAKES - SEE DETAIL)
- PERMANENT SEEDING

CONSTRUCTION PHASE 1 **DATE**

CLEAR PATH FOR PERIMETER SILT FENCE	
INSTALL PERIMETER SILT FENCE (SEE DETAIL)	
CLEAR & GRUB TO PERIMETER SILT FENCE	

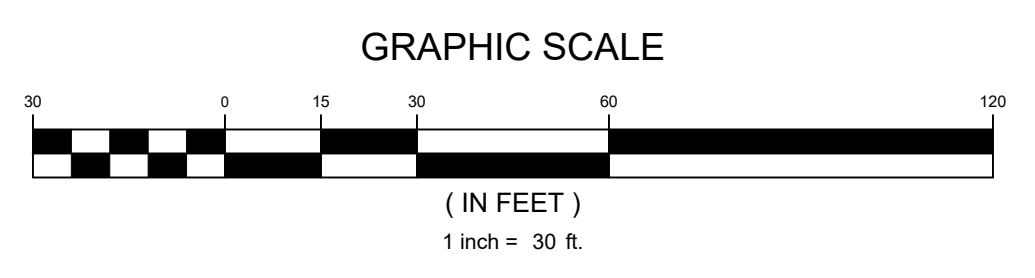
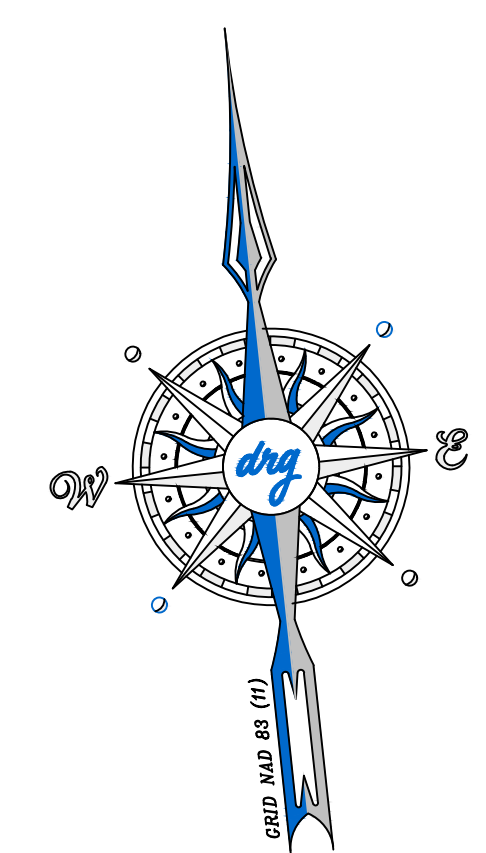

DEVELOPMENT RESOURCE GROUP, LLC
4703 OLEANDER DRIVE
MYRTLE BEACH, SC 29577
843-839-3350 | DRGPLLC.COM

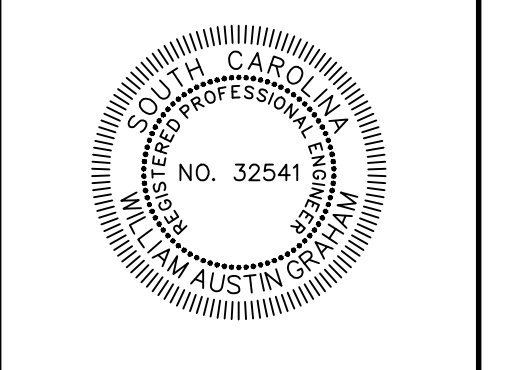

EROSION & SEDIMENT CONTROL - PH 1
HOMWOOD ELEMENTARY SCHOOL PLAYGROUND

PREPARED FOR:
Horry County Schools
335 FOUR MILE ROAD (29526)
PO BOX 260005, CONWAY, SC 29528
TREVOR TURNER

PLANS FOR PERMITTING

JOB NO: 21.201
SCALE: 1" = 30'
DRAWN BY: PJC
CHECKED BY: WAG
APPROVED BY: WAG
DATE: 03/10/2022

SHEET NUMBER:

C6.0

3/11/2022 12:09 PM

Z:\21201 - HCS - HES PLAYGROUND DESIGN\DRAWINGS\SHEET DRAWINGS\21201 ESC PLAN.DWG

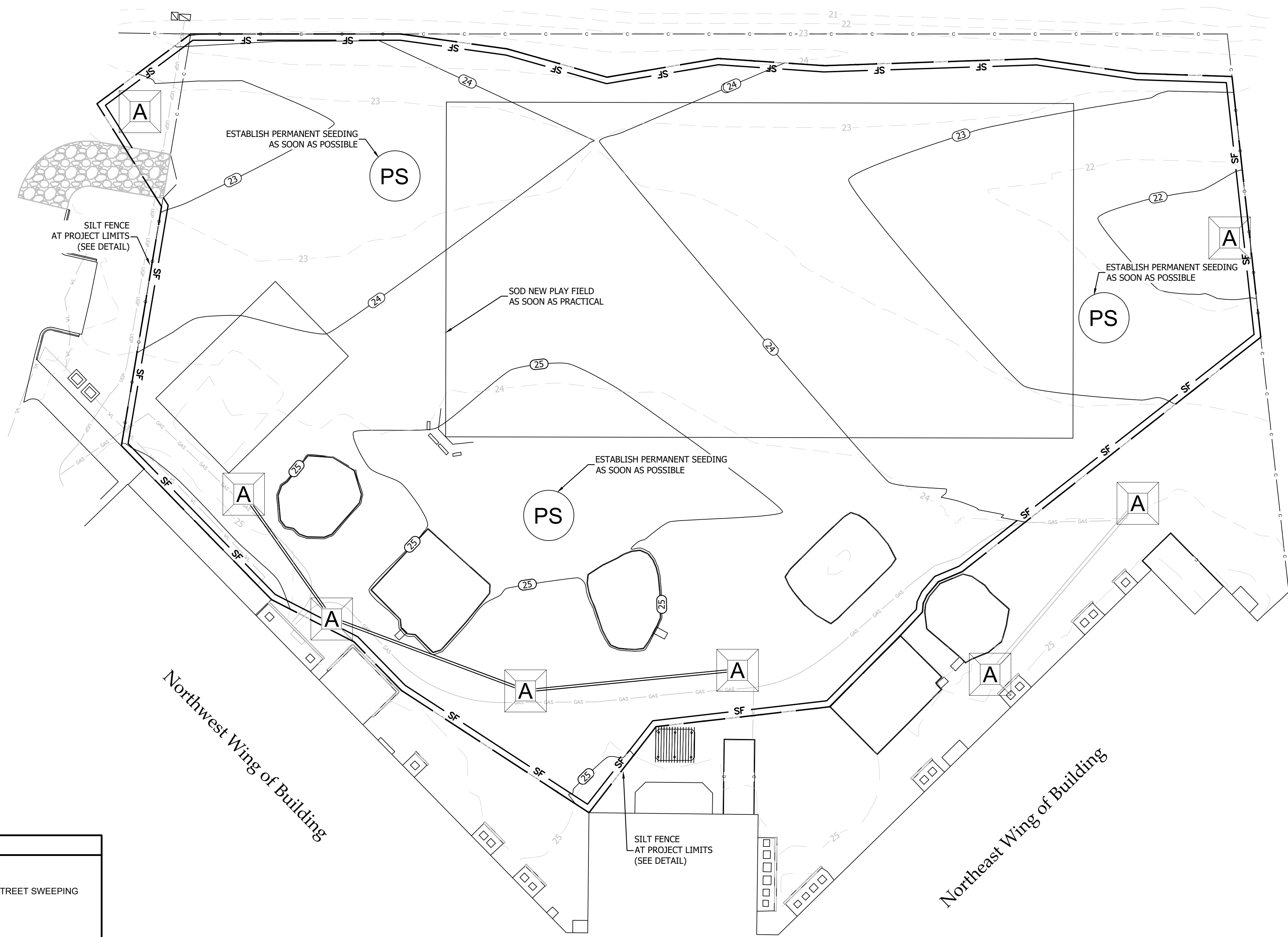

PLAN LEGEND	
SF	SILT FENCE (SEE DETAIL)
SW	STREET SWEEPING
A	TYPE A INLET PROTECTION (FABRIC & STAKES - SEE DETAIL)
PS	PERMANENT SEEDING

CONSTRUCTION PHASE 2	DATE
DEWATER NECESSARY AREAS VIA DEWATERING BAG OR APPROVED EQUIVALENT METHOD	
ESTABLISH MATERIAL STORAGE AREA PER SWPPP & CGP	
COVER BUILDING MATERIALS PER SWPPP & CGP	
STABILIZE REMAINING DISTURBED AREAS	
SILT FENCE REMOVAL - TO COMMENCE ONCE 75% VEGETATIVE COVER HAS BEEN ACHIEVED	



DEVELOPMENT RESOURCE GROUP, LLC
 4703 OLEANDER DRIVE
 MYRTLE BEACH, SC 29577
 843-839-3350 | DRGPLLC.COM



EROSION & SEDIMENT CONTROL - PH 2
 HOMEWOOD ELEMENTARY SCHOOL PLAYGROUND

PREPARED FOR:
 Horry County Schools
 335 FOUR MILE ROAD (29526)
 PO BOX 260005, CONWAY, SC 29528
 TREVOR TURNER

PLANS FOR PERMITTING

JOB NO: 21.201
 SCALE: 1" = 30'
 DRAWN BY: PJC
 CHECKED BY: WAG
 APPROVED BY: WAG
 DATE: 03/10/2022

SHEET NUMBER:

C6.1

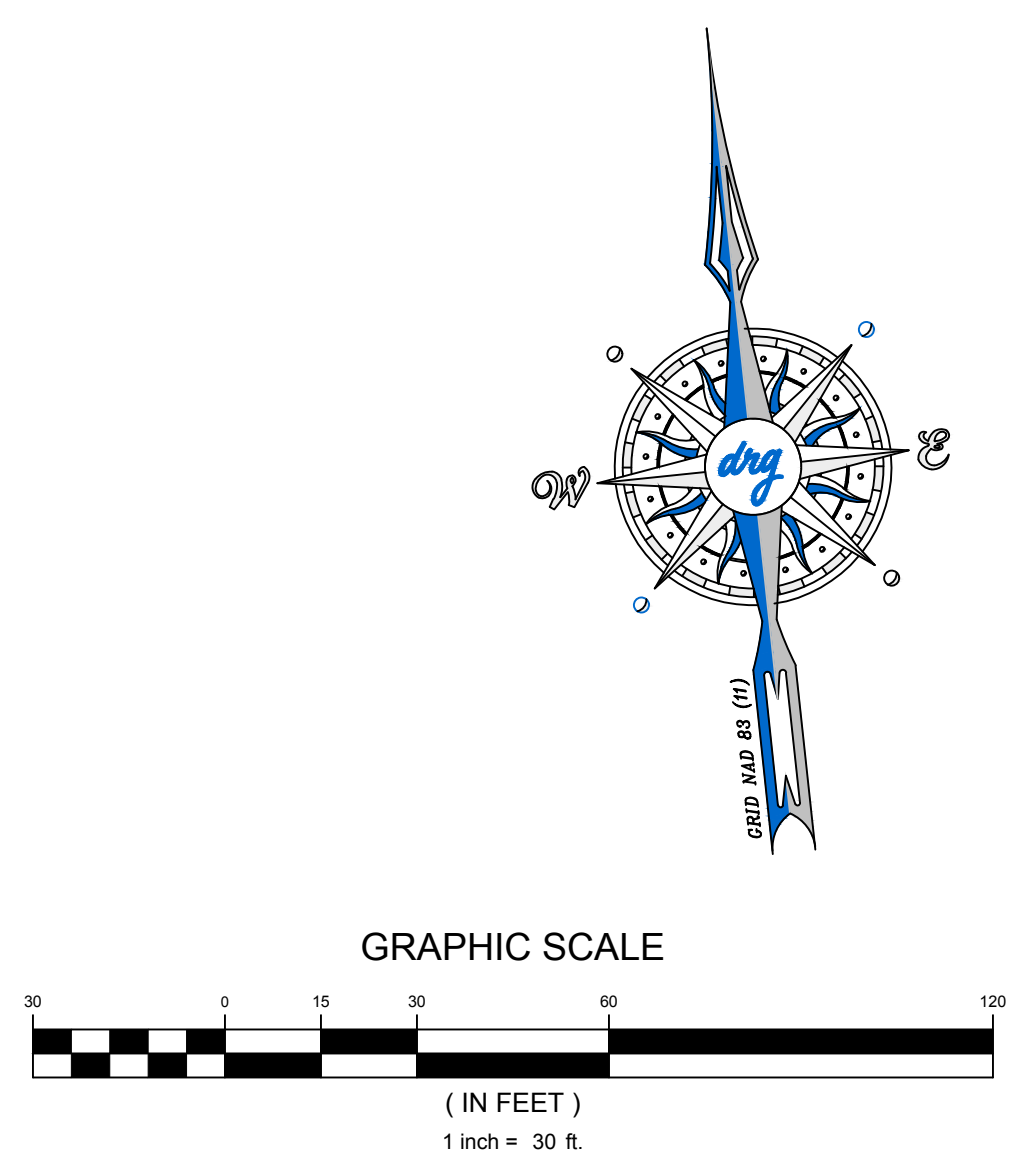

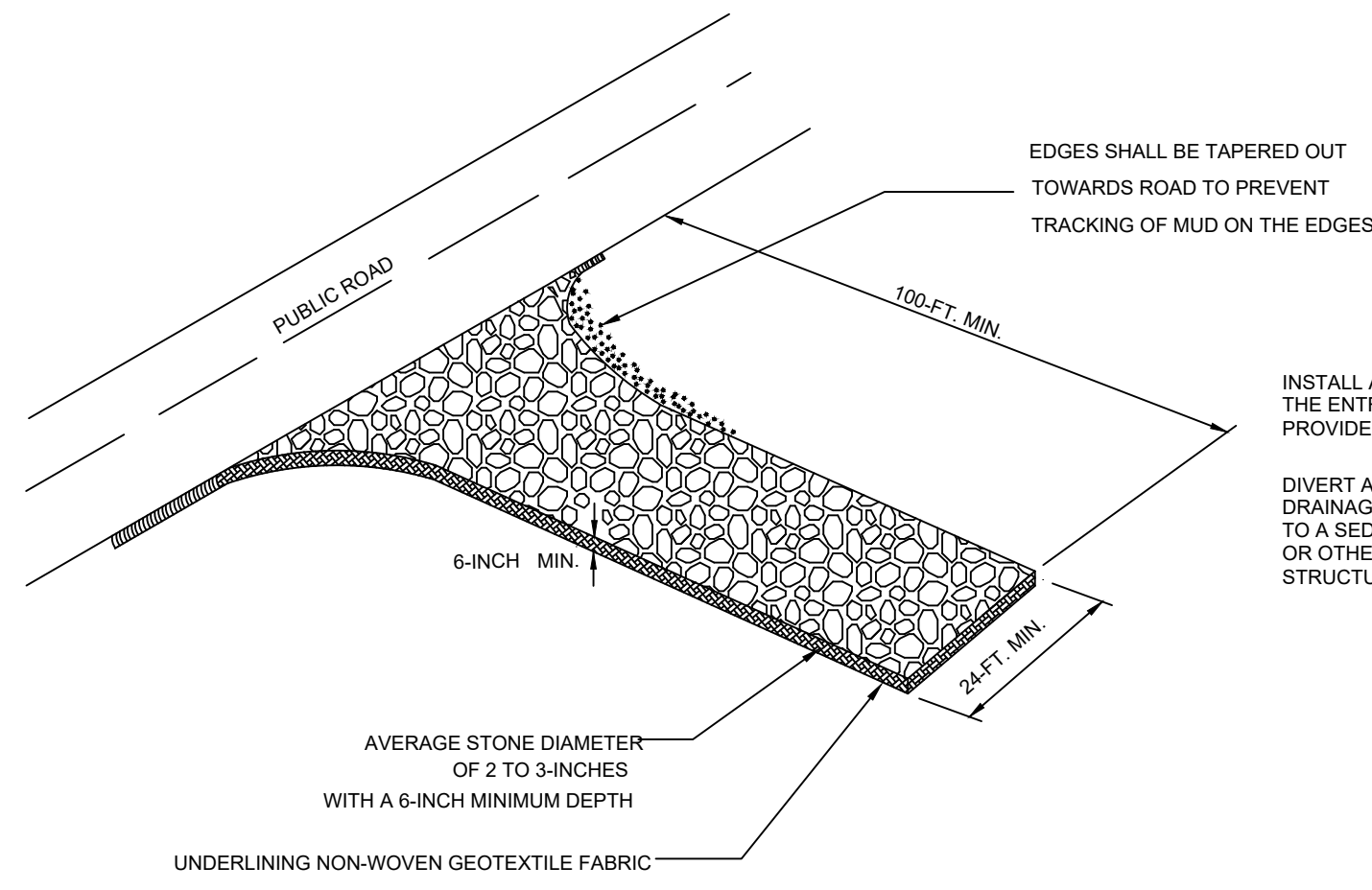

South Carolina Department of Health and Environmental Control

STABILIZED CONSTRUCTION ENTRANCE

STANDARD DRAWING NO. SC-06 Page 1 of 3

APPROVED BY: SCHEIC DATE: AUGUST, 2005

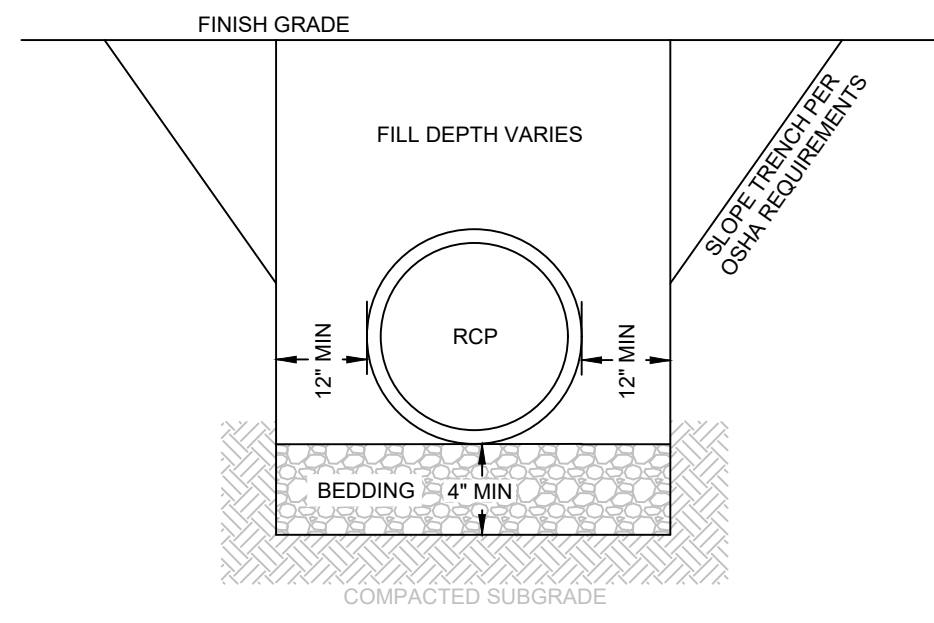

NOTES

1. BEDDING SHALL BE COMPACTED CRUSHED STONE (CLASS 1 MATERIAL) SHAPED TO THE BOTTOM OF PIPE.
2. MATERIAL UTILIZED AS FILL SHALL BE FREE OF LARGE ROCKS, DEBRIS, ORGANICS AND PLACED IN 6" LOOSE LIFTS AND COMPACTED TO 96% STANDARD PROCTOR.
3. BACKFILL MUST MEET SCDOT SUPPLEMENTAL SPECIFICATIONS SC-M-714

REINFORCED CONCRETE PIPE BEDDING CLAY SOILS & WET CONDITIONS

D# N.T.S. 07/XX/19

DEVELOPMENT RESOURCE GROUP, LLC

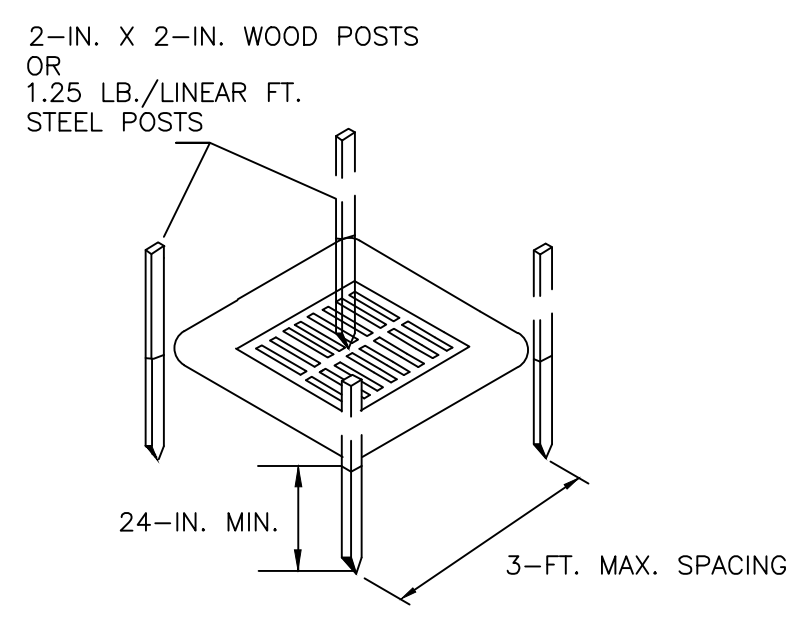

POST INSTALLATION DETAIL

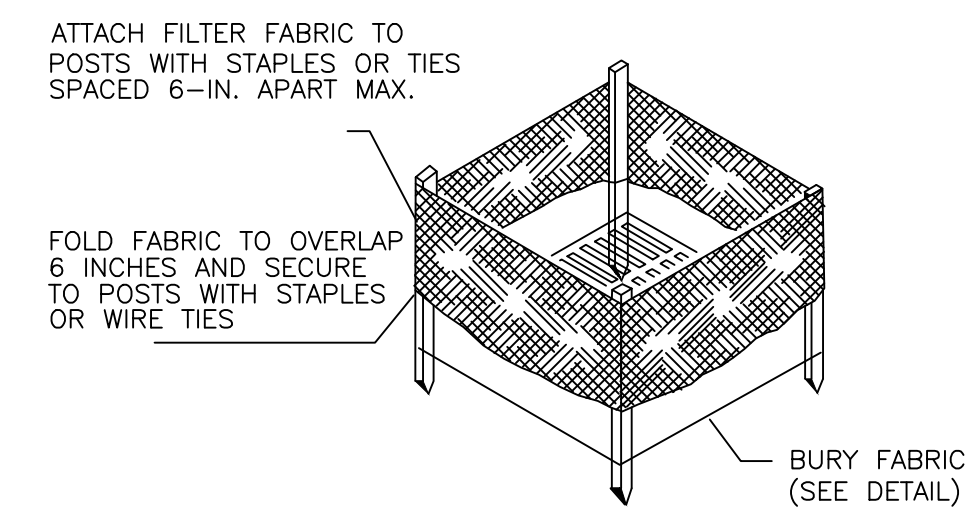

FILTER FABRIC INSTALLATION DETAIL

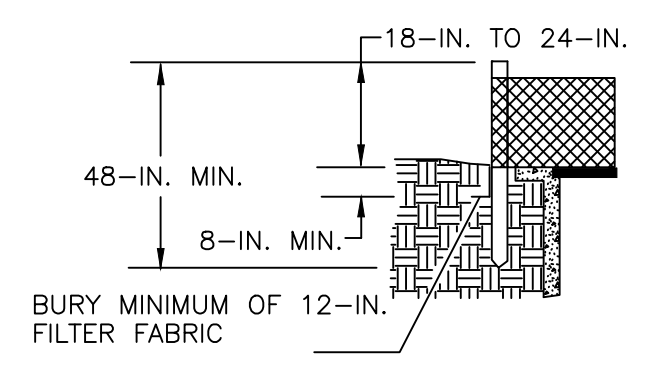

FILTER FABRIC BURIAL DETAIL

South Carolina Department of Health and Environmental Control

TYPE A - FILTER FABRIC INLET PROTECTION

STANDARD DRAWING NO. SC-07 Page 1 of 2

APPROVED BY: SCHEIC DATE: AUGUST, 2005



DEVELOPMENT RESOURCE GROUP, LLC
4703 OLEANDER DRIVE
MYRTLE BEACH, SC 29577
843-839-3350 | DRGPLLC.COM



NYLOPLAST DRAIN BASIN WITH STANDARD GRATE

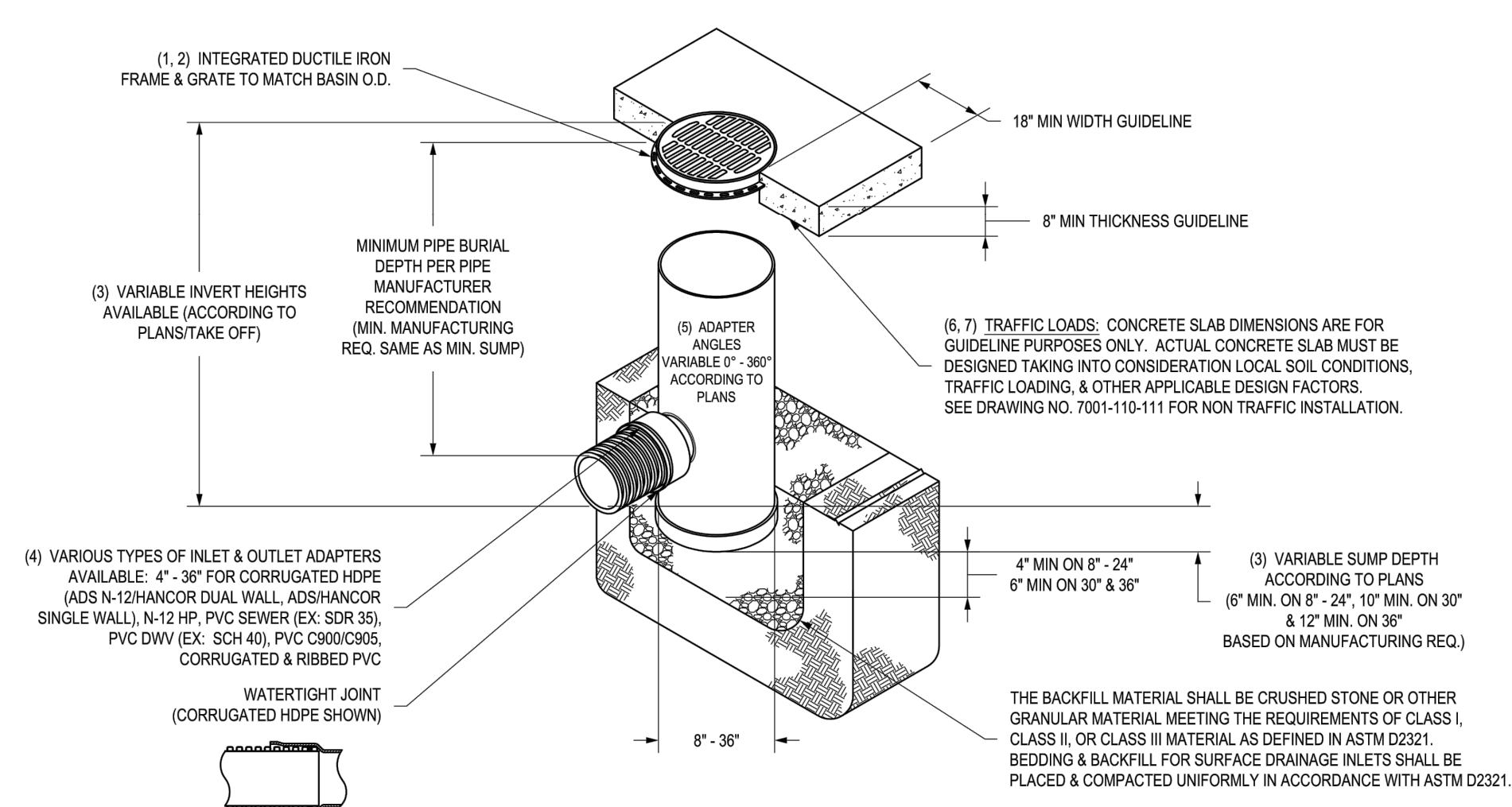

- 1 - 6" - 30" STANDARD GRATES SHALL BE DUCTILE IRON PER ASTM A536 GRADE 70-50-8.
- 2 - 12" - 30" FRAMES SHALL BE DUCTILE IRON PER ASTM A536 GRADE 70-50-8.
- 3 - 6" & 10" STANDARD GRATES FIT DIRECTLY ONTO DRAIN BASINS WITH THE USE OF A PVC BODY TOP. SEE DRAWING NO. 7001-110-046.
- 4 - DRAIN BASIN TO BE CUSTOM MANUFACTURED ACCORDING TO PLAN DETAILS. RISERS ARE NEEDED FOR BASINS OVER 4" DUE TO SHIPPING RESTRICTIONS. SEE DRAWING NO. 7001-110-065.
- 5 - DRAINAGE CONNECTION STUD JOINT TIGHTNESS SHALL CONFORM TO ASTM D2022 FOR CORRUGATED HDPE AND N-12 HANCOR DUAL WALL, N-12 HP & PVC SEWER (EX. SDR 35), PVC DWV (EX. SCH 40), PVC C900/C905, CORRUGATED & RIBBED PVC.
- 6 - ADAPTERS CAN BE MOUNTED ON ANY ANGLE 0° TO 360° TO DETERMINE MINIMUM ANGLE BETWEEN ADAPTERS SEE DRAWING NO. 7001-110-012.
- 7 - 12" - 30" STANDARD GRATES SHALL MEET H20 LOAD RATINGS.
- 8 - 6" & 10" STANDARD GRATES ARE RATED FOR LIGHT DUTY APPLICATIONS ONLY; NO CONCRETE COLLAR NEEDED FOR LIGHT DUTY RATING.

THIS PRINT DISCLOSES SUBJECT MATTER IN WHICH NYLOPLAST HAS PROPRIETARY RIGHTS. THE RECEIPT OR POSSESSION OF THIS PRINT DOES NOT CONFER, TRANSFER, OR LICENSE THE USE OF THE DESIGN OR TECHNICAL INFORMATION SHOWN HEREIN. REPRODUCTION OF THIS PRINT OR ANY INFORMATION CONTAINED HEREIN, OR MANUFACTURE OF ANY ARTICLE HEREFROM FOR THE DISCLOSURE TO OTHERS IS FORBIDDEN, EXCEPT BY SPECIFIC WRITTEN PERMISSION FROM NYLOPLAST.

3130 VERONA AVE
BUFORD, GA 30918
PH (770) 932-2463
FAX (770) 932-2490
www.nyloplast-us.com

Nyloplast

TITLE: DRAIN BASIN WITH STANDARD GRATE QUICK SPEC INSTALLATION DETAIL

DWG NO. 7001-110-144 REV. J

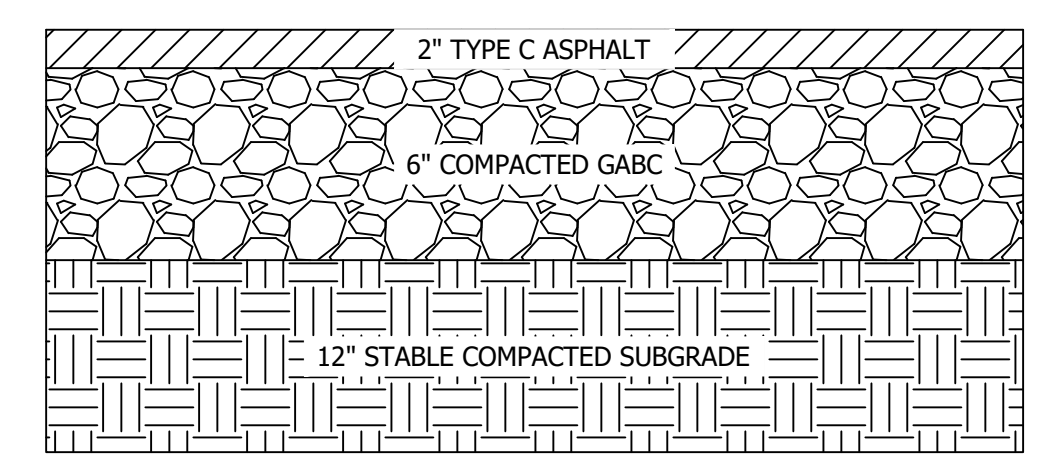

ASPHALT COURT PAVEMENT SECTION

R# N.T.S. 07/XX/19

DEVELOPMENT RESOURCE GROUP, LLC

DETAILS - 1

HOMWOOD ELEMENTARY SCHOOL PLAYGROUND

PREPARED FOR:
Horry County Schools
335 FOUR MILE ROAD (29526)
PO BOX 260005, CONWAY, SC 29528
TREVOR TURNER

PLANS FOR PERMITTING

JOB NO: 21.201

SCALE: NTS

DRAWN BY: PJC

CHECKED BY: WAG

APPROVED BY: WAG

DATE: 03/10/2022

SHEET NUMBER:

C7.0