

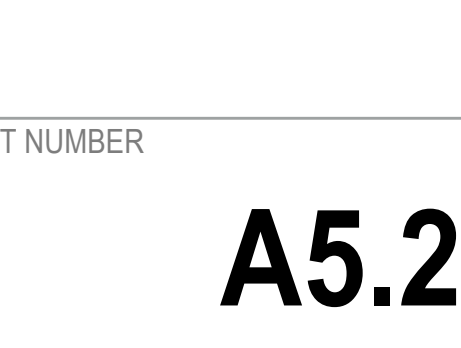

SEAL

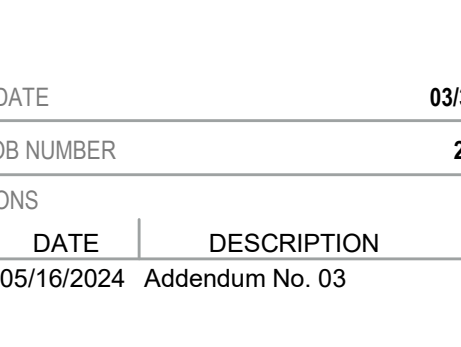
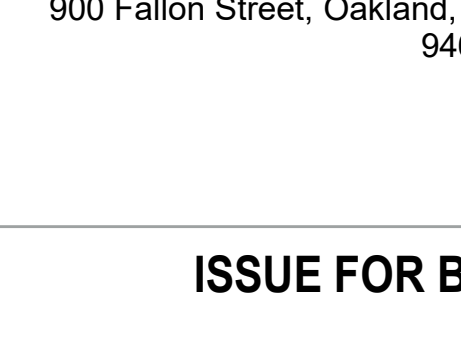
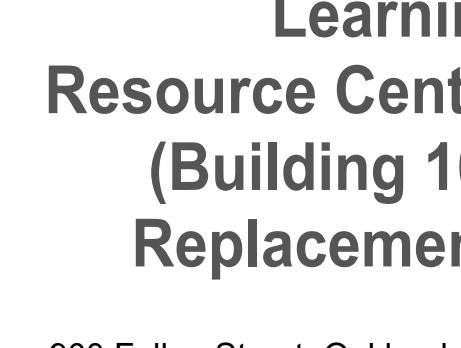
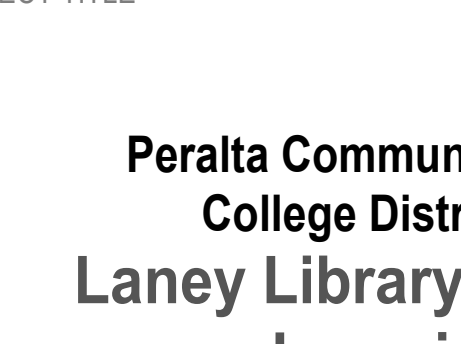
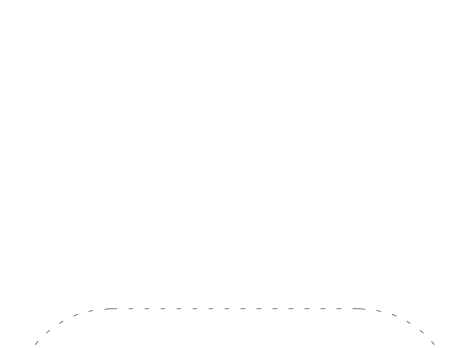
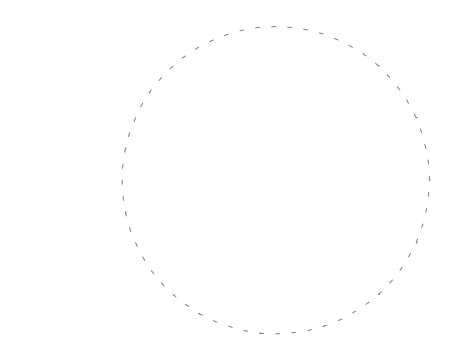

PROJECT TITLE

**Peralta Community College District
Laney Library & Learning Resource Center
(Building 100 Replacement)**
900 Fallon Street, Oakland, CA 94607

ISSUE FOR BID

ISSUE DATE 03/19/23
SAT. JOB NUMBER 21942
REVISIONS
DATE DESCRIPTION
3 05/16/2024 Addendum No. 03

SHEET TITLE
INTERIOR ELEVATIONS - L3 361-396

SHEET NUMBER

A5.24

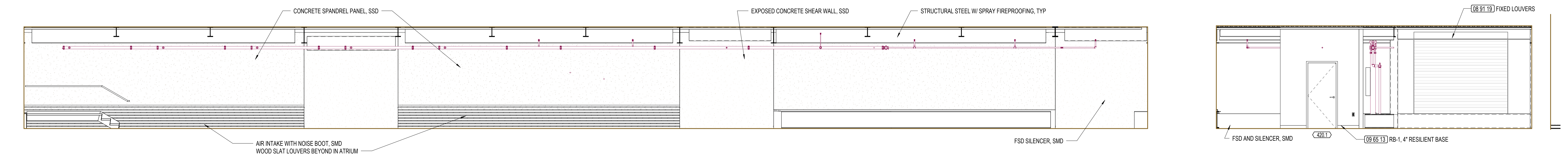
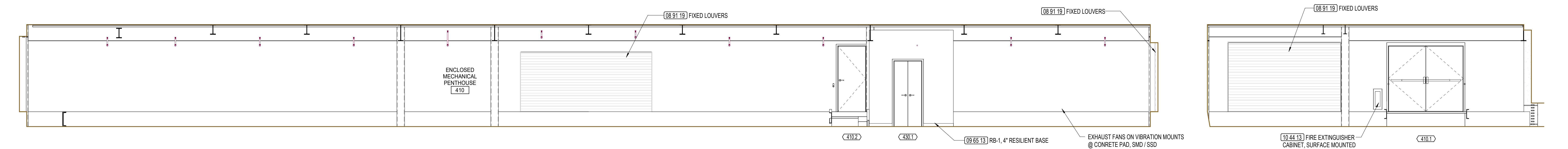
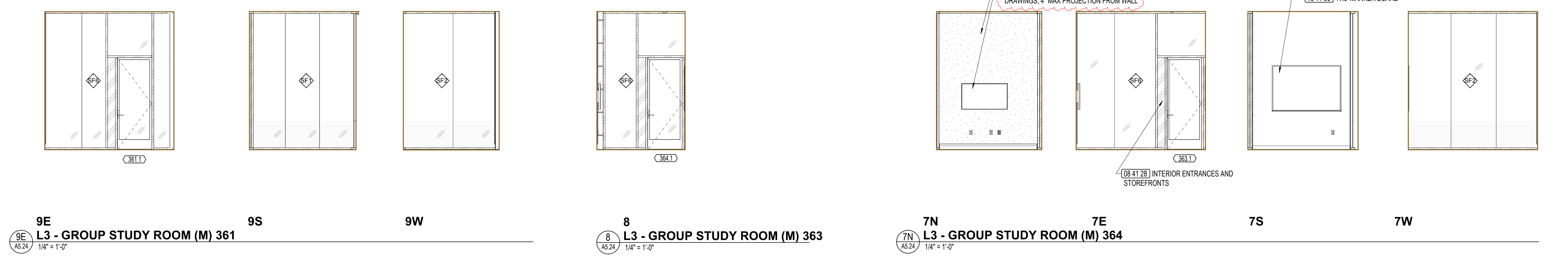
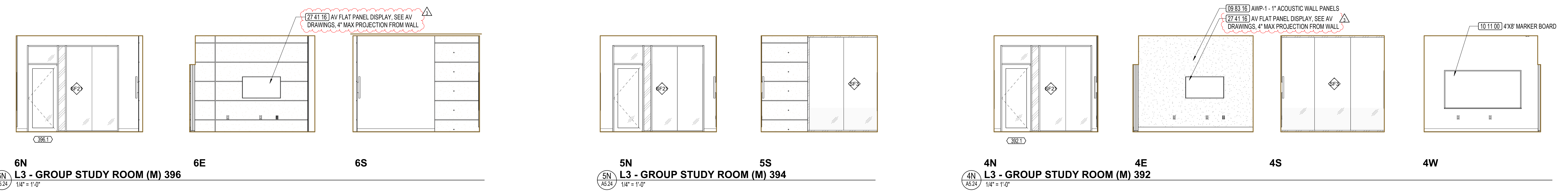
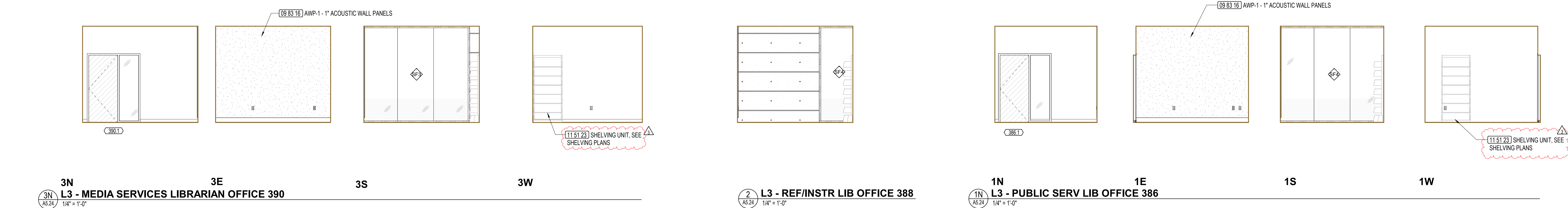

GENERAL NOTES

- SEE FLOOR PLANS FOR DOOR IDENTIFICATION
- SEE LAYOUT PLANS FOR PARTITION IDENTIFICATION
- SEE SHEET A2.51 FOR DOOR SCHEDULE
- SEE M4 SERIES FOR STAIR AND ELEVATOR SHEETS
- SEE SHEET A8.10 FOR INTERIOR WALL PARTITION TYPES
- SEE SHEET A8.16 FOR WALL FINISH ASSEMBLIES
- SEE SHEETS A8.31 & A8.52 FOR INTERIOR STOREFRONT AND WINDOW TYPES
- SEE SHEET A8.70 FOR CASEWORK TYPES
- SEE A9.10 FOR ROOM FINISH SCHEDULE
- APPLY 09666 INTUMESCENT FIREPROOFING TO ALL EXPOSED STEEL STRUCTURE, INCLUDING COLUMNS, BEAMS, AND ATTACHMENTS TYP. SPRAY PRIMARY STRUCTURAL STEEL MEMBERS HIDDEN FROM VIEW WITH 078100 APPLIED CEMENTITIOUS FIREPROOFING
- SEE STRUCTURAL DRAWINGS FOR BACKING DETAILS

KEYNOTE LEGEND

Key Value	Keynote Text
08 41 28	08 41 28 INTERIOR ENTRANCES AND STOREFRONTS
08 91 19	08 91 19 FIXED LOUVERS
09 65 13.A2	09 65 13 RB-1, 4" RESILIENT BASE
09 63 16.A1	09 63 16 AWP-1 - 1" ACOUSTIC WALL PANELS
10 11 00.A3	10 11 00 4X6 MARKER BOARD
10 11 00.A4	10 11 00 4X6 MARKER BOARD
10 44 13.A4	10 44 13 FIRE EXTINGUISHER CABINET, SURFACE MOUNTED
11 51 23.A2	11 51 23 SHELVING UNIT, SEE SHELVING PLANS
28 41 16.A9	27 41 16 AV FLAT PANEL DISPLAY, SEE AV DRAWINGS, 4" MAX PROJECTION FROM WALL

LEGEND

WOOD FINISHES
SEE A8.16 FOR WOOD WALL FINISH DETAILS.

MISC FINISHES

MISCELLANEOUS

WOOD GRILLE
WOOD MICROPERF PANEL
WOOD FINISH

FABRIC WRAPPED PANEL
FIRE EXTINGUISHER CABINET