

File Location: X:\2017\170118CLCH\_CADD\CLC\dwn01 - 50x25 Pier UTILITY  
 Date Created: July 17, 2018  
 Date Last Saved: July 17, 2018  
 Date Plotted: July 17, 2018

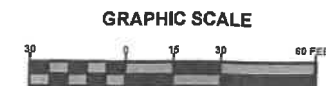
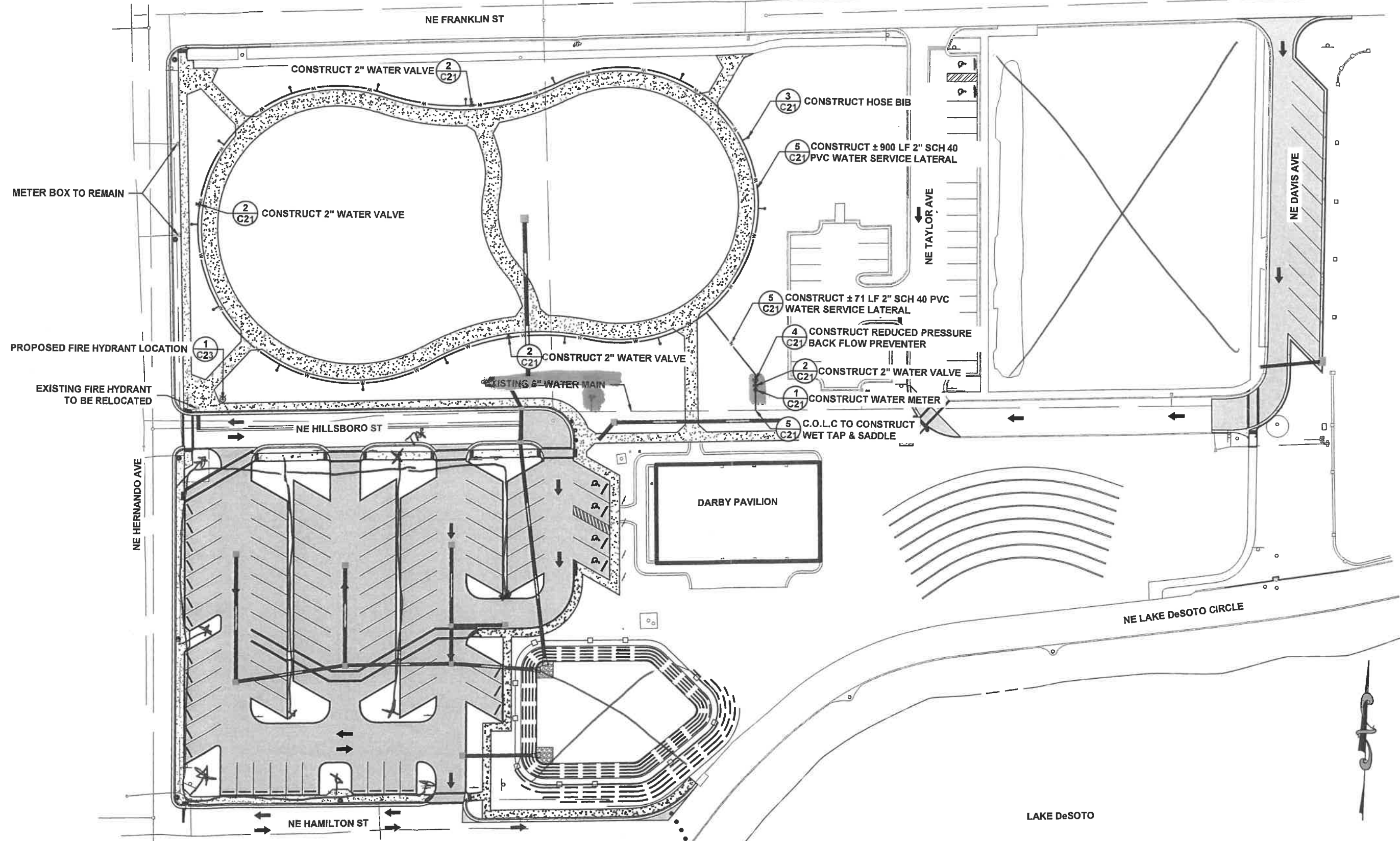

JOB NUMBER: L17010118CLC  
 DESIGNED BY: BJS  
 DRAFTED BY: BS  
 CHECKED BY: GB  
 ENGINEER OF RECORD: GREGORY C. BAILEY  
 P.E. NO.: 43868  
 DATE: 01/2017  
 SHEET NO.: C17

REVISIONS:

NORTH FLORIDA PROFESSIONAL ENGINEERS ASSOCIATION  
 N.F.P.E.

North Florida Professional Services, Inc.  
 P.O. BOX 3823  
 Lake City, FL 32025  
 Tallahassee, FL 32318  
 Ph. 386-752-4675  
 Fax. 386-752-4674  
 Emp. 1

**WILSON PARK**  
**COLUMBIA COUNTY, FLORIDA**