

Construction Detail

Not to Scale

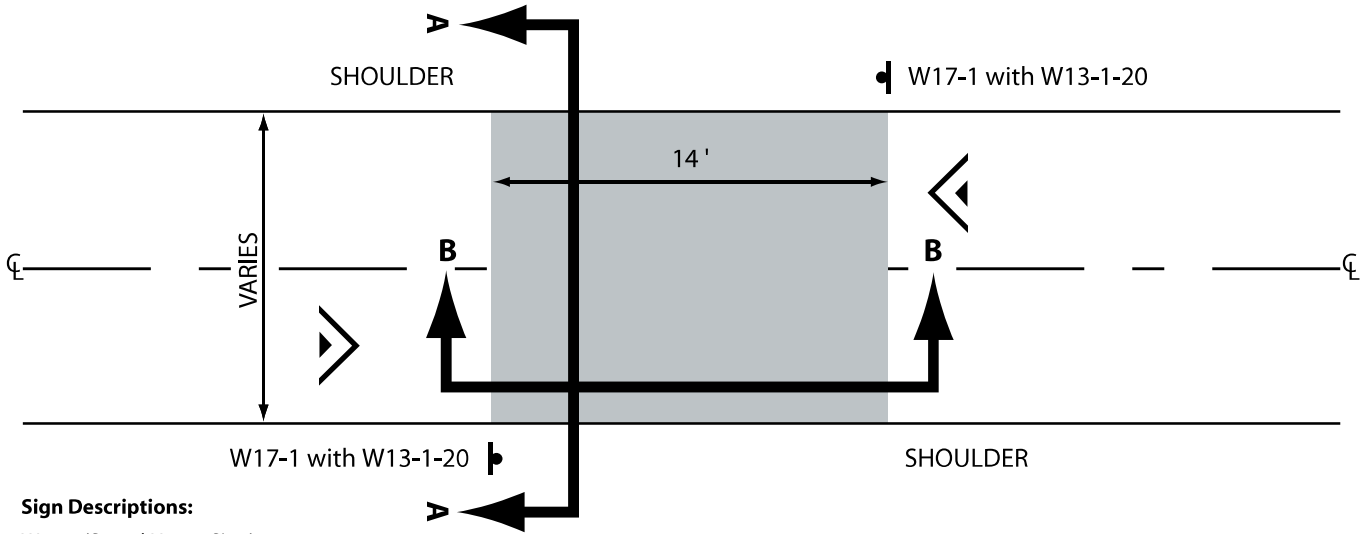

Sign Descriptions:
 W17-1 (Speed Hump Sign)
 W13-1 (Advisory Speed Plaque)

* Use 12" taper with curb & gutter, not encroaching into gutter area.

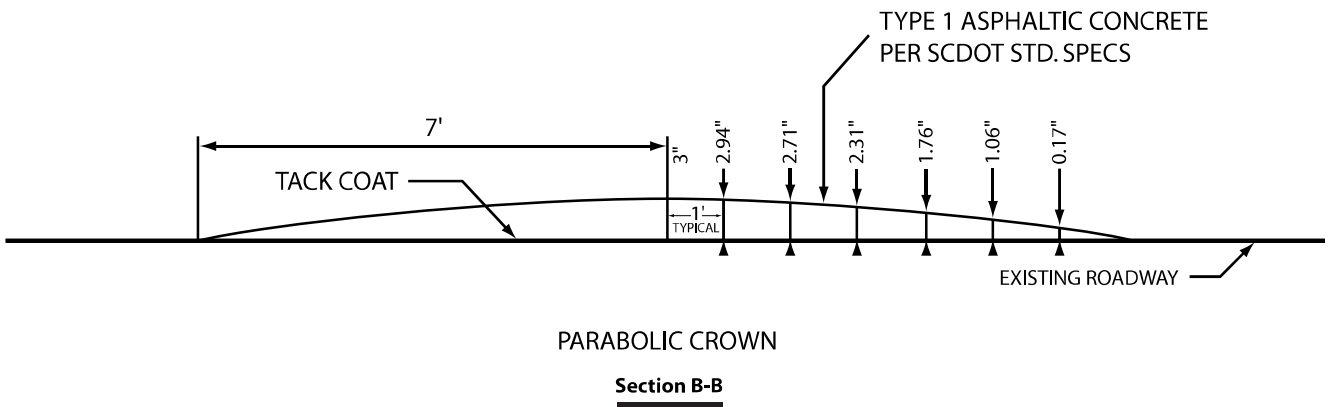
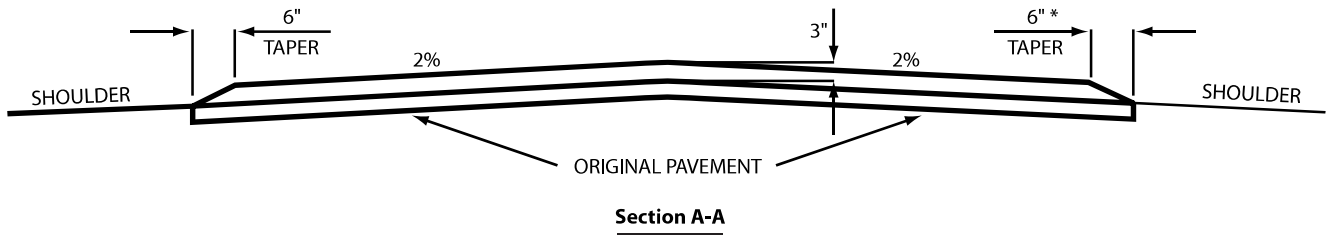

Note:

1. Materials must be approved by Resident Maintenance Engineer.
2. Decorative asphalt paving may be used if in accordance with SCDOT standards.

PARABOLIC SPEED HUMP

For use on roadways with ADTs ≤ 2,000