



**CITY OF CALLAWAY
JAN DR. & GENEVIEVE AVE. DRAINAGE IMPROVEMENTS
BID NO: PW2022-03**

ADDENDUM #3

Date Issued: March 24, 2022

This addendum is being released to extend the bid closing deadline and address the following questions regarding TASK 1 – JAN DR. IMPROVEMENTS:

1. Regarding bid line item # 10, 48” pipe culvert, I have +/- 300’, but the bid quantity states 692’. Can we get a verification for the quantity?

Plans attached to previous bid package had been previously superseded; please refer to the correct plan set provided in this Addendum #3. Quantities reflected in the original basis of bid were established using the latest and attached plan set.

2. On the Letohatchee Street it states on sheet C101 to repair the Headwalls as required, but on sheet C106 it states to reconstruct the headwalls. Can we get a clarification regarding this matter?

Contractor to demo all existing headwalls/endwalls (except Minneola) and reconstruct post-culvert installation per 2022-23 FDOT Standard Plans Index 430-030; see the correct plan set provided in this Addendum #3.

3. Can there be a separate line item for any walls that will be repaired versus the walls that will be demo/reconstructed?

Contractor to demo all existing headwalls/endwalls (except Minneola) and reconstruct post-culvert installation per 2022-23 FDOT Standard Plans Index 430-030; see the correct plan set provided in this Addendum #3.

4. For the Minneola Street crossing it states on sheet C103 to demo existing concrete headwalls, reconstruct to intercept existing pipes and concrete flumes, then on sheet C110 it states to utilize the existing 48” RCP and existing headwalls, repair any current damages to headwall structures. Do we repair or demo/reconstruct the headwalls?

No demo or repairs are to occur at Minneola. The existing concrete headwall/endwall and 60” RCP are to remain intact and unaltered. Refer to correct plan set included with this Addendum #3.

5. Also, on sheet C110 it states to utilize the existing 48” RCP but the profile states the pipe as 60” RCP. If we are to reconstruct the wall, will it be for 48” or 60”?

No demo or repairs are to occur at Minneola. The existing concrete headwall/endwall and 60” RCP are to remain intact and unaltered. Refer to correct plan set included with this Addendum #3.

6. On the bid list, it's showing three ditch bottom Type C > 10' inlets. I count one Type H, One Type E w/J bottom, and one 48" Concrete MES. Can we get a clarification on that line item?

Refer to the correct plan set, and updated Bid Certification Form provided in this Addendum #3.

7. For most of the headwalls that are shown to be reconstructed it states reconstruct Concrete headwall per FDOT INDEX # 430-030 and # 430-040, are we to match the existing layout of the headwalls or follow the FDOT standards?

Contractor to follow FDOT standards and reconstruct headwall/endwalls per 2022-23 FDOT Standard Plans Index 430-030 and align parallel to existing roadway; see the correct plan set provided in this Addendum #3.

8. The Bid Closing Date is hereby extended as follows:

FRIDAY, APRIL 1, 2022 - 2:00 P.M.
BID OPENING: 2:15 P.M.
CALLAWAY ARTS & CONFERENCE CENTER
500 CALLAWAY PARK WAY

ATTACHMENTS:

- UPDATED BID CERTIFICATION FORM
- UPDATED PLANS (*also uploaded to Vendor Registry separately*)

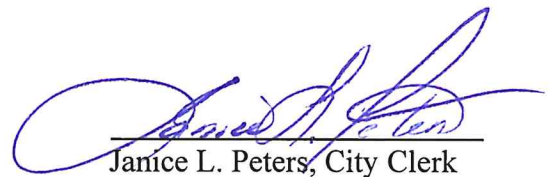
Janice L. Peters, City Clerk

This Addendum must be acknowledged and included with the bid packet submission.

Signature

Company Name

Date

AMENDED
3.24.22

BID/RFP CERTIFICATION FORM

CITY OF CALLAWAY

JAN DR. & GENEVIEVE AVE. DRAINAGE IMPROVEMENTS

BID NO: PW2022-03

PROPOSERS CERTIFICATION TO THE CITY OF CALLAWAY:

1. The undersigned warrants that: (A) This Proposal is submitted in response to, and is in compliance with, all terms and conditions applicable thereto as set forth in the Advertisement, Instructions to Proposers, General Instructions and Conditions, Special Instructions and Conditions, Bid/RFP Certification Forms, the Minimum Technical Specifications, Addendum, Exhibits, Agreement, Bonds, and Insurance Requirements, each of which has been carefully examined, (B) Proposer or Proposer's representative has made such investigation as is necessary to determine the character and extent of the work and their capability to perform the work, and (C) agrees that if the Proposal is accepted by the City, Proposer will provide the necessary labor, materials, machinery, equipment, tools or apparatus, and perform all the work or services required to complete the assignment and/or contract within the time specified according to the requirements of the City as herein and hereinafter set forth, and (D) he/she is authorized to legally execute binding contracts for and on behalf of the Proposer.
2. Please check one:
 - Proposer declares that the only person, persons, company, or parties interested in this Proposal are named in the Proposal.
 - Proposer, or one or more of Proposer's officers, principals, or any owner of more than 5% in or of proposer, or members of their immediate families: (A) have a financial interest in another company, project, or property that could benefit financially from this proposed project; and/or (B) another individual or business will be compensated by (or on behalf of proposer) if Proposer is selected by the City for the requested services. (Attach a detailed explanation for either.)
3. Bid Bond - If the Proposal is accepted by the City, it will become a binding contract on both parties. If a Bid Bond or Cashier's Check/Certified Check is required, it shall be submitted with the Proposal. If the undersigned shall fail to deliver or perform, or if applicable, execute a Contract as stated herein, then the City may, at its option, determine that the undersigned has abandoned the Award/Contract, and thereupon such Bid and/or Award shall be null and void, and any Cashier's Check/Certified Check or Bond accompanying this Bid shall be forfeited to and become the property of the City, and the full amount of said check, or if a Bid Bond, the full amount of such bond, shall be paid to the City as partial liquidated damages; otherwise, any Bond or Cashier's Check/Certified Check accompanying this Bid shall be returned to the undersigned within 30 calendar days from the date of Award, or if provisions for a Notice to Proceed are included, from the date of the Notice to Proceed.
4. Vendor proposes and agrees to provide all materials, services or equipment required for the City of Callaway JAN DR. & GENEVIEVE AVE. DRAINAGE IMPROVEMENTS BID NO: PW2022-03, for the Total Sum(s) as follows: *(Totals must match breakdown of costs for each part on next page.)* Dollar Amount (\$ _____)
Written Amount: _____
5. Number of days from date of the Notice to Proceed that will be required for the final completion of all work as described herein.

(Maximum 360 Calendar Days)
6. The City reserves the right to accept any or all prices itemized in any combination that best serves the interests of the City. The City further reserves the right to accept or reject any of the components of this Proposal, including alternates.

TASK 1
OUTFALL DITCH JAN DRIVE
FROM CHERRY STREET TO ROGERS POND

ARTICLE 1 – BASIS OF BID

1.01 Bidder will complete the Work in accordance with the Contract Documents for the following price(s):

1.02 LUMP SUM

A. Where payment for items is shown to be paid for on a lump sum basis, no separate payment will be made for any item of work required to complete the lump sum item. The lump sum price bid for various items shall be compensation in full for furnishing all materials, labor, equipment, and incidentals with these plans and specification. All disposal costs shall be included in the bid items. Unless otherwise stated, measurement shall be based upon the Engineer's estimate of percent complete per partial payment period.

1. **Bid Item 1 – General Provisions:** The LUMP SUM BID AMOUNT for all work included under this bid item will be made for mobilization and demobilization of all labor, equipment, materials, and appurtenances necessary for construction of the project. Mobilization shall include all those operations necessary for the movement of personnel, equipment, supplies, and incidentals to the initial project site, safety equipment and first aid supplies, and sanitary and other facilities. Also included as part of this bid item is the cost for project performance and payment bonds, insurance, indemnifications, photographs, shop drawings, working drawings, schedules, documents, coordination, and phasing and other miscellaneous items associated with the work. Measurement for this bid item will be lump sum. The lump sum price for general provisions will be limited to five percent (5%) of the contract amount. Seventy percent (70%) of the lump sum price will be payable with the first month's partial payment. The remaining thirty (30%) will be payable with the final partial payment.
2. **Bid Item 2 – Maintenance of Traffic (MOT):** The LUMP SUM BID AMOUNT for all work included under this bid item will be made for any labor and materials required to successfully address Maintenance of Traffic during project construction. Contractor will refer to the MOT plans provided in the approved design plans. MOT shall include all those operations necessary to maintain traffic flow during hours of active construction and provide safe traffic operation conditions during off-hour scenarios. MOT items may include, but will not be limited to, FDOT-approved traffic cone placement concrete barricades, flag personnel, electronic signage, standard signage, temporary pavement markings and detour route planning. The LUMP SUM BID AMOUNT shall be based on the percentages of work completed as approved by the ENGINEER.
3. **Bid Item 3 – Utility Verification/Location:** The LUMP SUM BID AMOUNT will be a payment for coordination with any on-site utility owners to address utility relocations (as needed) to successfully complete construction. The LUMP SUM BID AMOUNT shall be on the percentages of work completed as approved by the ENGINEER.
4. **Bid Item 6 – Dewatering:** The LUMP SUM BID AMOUNT will be a payment for furnishing and installing all necessary equipment, piping, fittings, valves, shoring, and electrical work required to effectively dewater submerged areas which conflict with construction efforts. This includes, but is not limited to, all pumps, fuel, hoses/piping, fittings, valves, restraints, supports, clearing, grading, debris removal and electrical (i.e., generators). The LUMP SUM BID AMOUNT shall be based on the percentages of work completed as approved by the ENGINEER.

5. **Bid Item 11 – Roadway Repair:** The **LUMP SUM BID AMOUNT** will be a payment for furnishing all necessary equipment and labor required to fully repair any areas of roadway damage during pipe culvert replacement and other related construction activities. This includes, but is not limited to, all equipment for excavation, concrete saws, tamping equipment, base materials, surface course materials and paving equipment. The LUMP SUM BID AMOUNT shall be based on the percentages of work completed as approved by the ENGINEER.

Basis of Bid:

PROJECT NAME: CHERRY STREET DRAINAGE					
TASK 1 – OUTFALL DITCH JAN DRIVE – FROM CHERRY ST. TO ROGERS POND					
ITEM	DESCRIPTION	QTY	UNIT	UNIT PRICE	AMOUNT
1	General Provisions	1	LS		
2	Maintenance of Traffic	1	LS		
3	Utility Verification/Location	1	LS		
4	Floating Turbidity Barrier	100	LF		
5	Clearing and Grubbing	1.4	AC		
6	Dewatering	1	LS		
7	Lateral Ditch Excavation	3,200	CY		
8	Excavation for Structures	1,200	CY		
9	FDOT Type H BDI (2 Grate, Alt. JB Bottom	1	EA		
10	FDOT Type E BDI, Alt. JB Bottom	1	EA		
11	48" Concrete Mitered End Section	2	EA		
12	48" Reinforced Concrete Pipe	692	LF		
13	Class II Concrete Headwalls/Endwalls	9	EA		
14	Asphaltic Roadway Repair of Saw Cut	1	LS		
15	Performance Turf, Sod	4,900	SY		
14	Replace 6' Wood Fence	50	LF		
TOTAL BASE BID FOR TASK 1 PROJECT					\$

TASK 2
GENEVIEVE DRAINAGE PIPING
BIG OAK LN CUL-DE-SAC TO CALLAWAY BAYOU

ARTICLE 2 – BASIS OF BID

2.01 Bidder will complete the Work in accordance with the Contract Documents for the following price(s):

2.02 LUMP SUM

A. Where payment for items is shown to be paid for on a lump sum basis, no separate payment will be made for any item of work required to complete the lump sum item. The lump sum price bid for various items shall be compensation in full for furnishing all materials, labor, equipment, and incidentals with these plans and specification. All disposal costs shall be included in the bid items. Unless otherwise stated, measurement shall be based upon the Engineer's estimate of percent complete per partial payment period.

1. **Bid Item 1 – General Provisions:** The LUMP SUM BID AMOUNT for all work included under this bid item will be made for mobilization and demobilization of all labor, equipment, materials and appurtenances necessary for construction of the project. Mobilization shall include all those operations necessary for the movement of personnel, equipment, supplies, and incidentals to the initial project site, safety equipment and first aid supplies, and sanitary and other facilities. Also included as part of this bid item is the cost for project performance and payment bonds, insurance, indemnifications, photographs, shop drawings, working drawings, schedules, documents, coordination, and phasing and other miscellaneous items associated with the work. Measurement for this bid item will be lump sum. The lump sum price for general provisions will be limited to five percent (5%) of the contract amount. Seventy percent (70%) of the lump sum price will be payable with the first month's partial payment. The remaining thirty (30%) will be payable with the final partial payment.
2. **Bid Item 2 – Maintenance of Traffic (MOT):** The LUMP SUM BID AMOUNT for all work included under this bid item will be made for any labor and materials required to successfully address Maintenance of Traffic during project construction. Contractor will refer to the MOT plans provided in the approved design plans. MOT shall include all those operations necessary to maintain traffic flow during hours of active construction and provide safe traffic operation conditions during off-hour scenarios. MOT items may include, but will not be limited to, FDOT-approved traffic cone placement concrete barricades, flag personnel, electronic signage, standard signage, temporary pavement markings and detour route planning. The LUMP SUM BID AMOUNT shall be based on the percentages of work completed as approved by the ENGINEER.
3. **Bid Item 3 - Utility Verification/Location:** The LUMP SUM BID AMOUNT will be a payment for coordination with any on-site utility owners to address utility relocations (as needed) to successfully complete construction. The LUMP SUM BID AMOUNT shall be based on the percentages of work completed as approved by the ENGINEER.
4. **Bid Item 4 – Clearing and Grubbing:** The LUMP SUM BID AMOUNT will be a payment for successfully clearing and grubbing any areas within the project limits which prevent construction due to vegetative growth or landscaping. This includes, but is not limited to, all tree and shrub removal, equipment operated stump removal, chainsaw operation, excavation associated with vegetation removal, manual soil removal, manual removal of vegetation overgrowth and associated costs with equipment operation/maintenance. Seventy percent (70%) of the lump sum price will be payable with the first month's partial payment. The remaining thirty (30%) will be payable with the final partial payment.

5. **Bid Item 5 – Erosion Control:** The **LUMP SUM BID AMOUNT** for furnishing and installing silt fencing and incidentals necessary for installing erosion control Best Management Practices (BMP's) in accordance with these specifications. The required material for the silt fencing is detailed in the drawings. The LUMP SUM BID AMOUNT shall be based on the percentages of work completed as approved by the ENGINEER.

6. **Bid Item 6 – Dewatering:** The **LUMP SUM BID AMOUNT** will be a payment for furnishing and installing all necessary equipment, piping, fittings, valves, shoring, and electrical work required to effectively dewater submerged areas which conflict with construction efforts. This includes, but is not limited to, all pumps, fuel, hoses/piping, fittings, valves, restraints, supports, clearing, grading, debris removal and electrical (i.e. generators). The LUMP SUM BID AMOUNT shall be based on the percentages of work completed as approved by the ENGINEER.

7. **Bid Item 7 – Earthwork (Excavation, Rough Grading, Fine grading and Sod Prep):** The **LUMP SUM BID AMOUNT** will be full compensation for all labor, materials, and equipment necessary to excavate and rough grade and/all soils required for construction and fine grade all back fill and prepare the backfill areas for sodding as described herein and within the contract documents, complete as shown on the Plans, specified, and directed by the Engineer. The earthwork quantities to be paid for under this section shall be based on the area square yards of required earth removal and subsequent rough grading completed and acceptable to the Engineer. The LUMP SUM BID AMOUNT shall be paid based on the measured area of necessary earthwork during the requested period as approved by the ENGINEER.

Basis of Bid:

PROJECT NAME: CHERRY STREET DRAINAGE GENEVIEVE PIPING					
(TASK 2) BIG OAK LN. CUL-DE-SAC TO CALLAWAY BAYOU					
ITEM	DESCRIPTION	QTY	UNIT	UNIT PRICE	AMOUNT
1	General Provisions	1	LS		
2	Maintenance of Traffic	1	LS		
3	Utility Verification/Location	1	LS		
4	Clearing and Grubbing	1	LS		
5	Erosion Control	1	LS		
6	Dewatering	1	LS		
7	Earthwork	1	LS		
8	42" ADS HP	1,161	LF		
9	36" ADS HP	17	LF		
10	FDOT Concrete Connection Collar	1	EA		
11	C.I.P. Inlet	1	EA		
12	FDOT Type H DBI	3	EA		
13	FDOT Manhole J Bottom	1	EA		
14	42" Concrete M.E.S.	1	EA		
15	Sod	2,500	SY		
16	Demo/Reconstruct Existing Asphalt	1,089	SF		
<i>TOTAL BASE BID FOR TASK 2 PROJECT</i>					

7. BIDDER HEREBY ACKNOWLEDGES RECEIPT OF THE FOLLOWING ADDENDUMS: _____

Name of Bidder: _____

Business structure: () Corporation, () Partnership, () Individual, () Other: _____

If a Partnership: _____

Name(s) of Partner(s): _____

If a Corporation: _____

Incorporated in State of: _____ Date of Incorporation: _____

Business Address: _____

City: _____ State _____ Zip _____

Telephone Number: () _____ Fax () _____

E-mail Address: _____

Submitted By: _____
(Print)

Affix Corporate Seal
(If Corporation)

Title: _____

Signature: _____

ATTEST: _____

Secretary

By: _____
Print Name

State of Florida
County of _____

The foregoing instrument was acknowledged before
me by means of Physical Presence or
 Online Notarization

The foregoing instrument was acknowledged before me this ___ day of _____, 20___, by _____,
who is personally known to me or who presented _____ as identification, and who (did) (did not) take
an oath.

[Signature of Notary Public]

[Printed, typed or stamped name of Notary Public]

NOTE: BIDS MAY BE REJECTED IF ALL DOCUMENTS ARE NOT COMPLETE AND EXECUTED, AND THE NUMBER OF COPIES SPECIFIED/REQUESTED OF EACH ARE NOT SUBMITTED WITH THE BID.

CONSTRUCTION PLANS FOR CHERRY STREET DRAINAGE IMPROVEMENTS

TASK 1 - OUTFALL DITCH JAN DRIVE TO ROGERS POND

PREPARED FOR



CITY OF CALLAWAY

CITY OFFICIALS

PAMM HENDERSON MAYOR
SCOTT DAVIS WARD I COMMISSIONER
DAVID GRIGGS WARD II COMMISSIONER
BOB PELLETIER WARD III COMMISSIONER
FRANK MANCINELLI WARD IV COMMISSIONER

BDI PROJECT No. 27655.01
MARCH 2022

PREPARED BY

B BASKERVILLE-DONOVAN, INC.
ENGINEERING THE SOUTH SINCE 1927

418 W. MAIN ST., PENSACOLA, FL 32502 (850)438-6661
ENGINEERING BUSINESS: EB-0000340
Pensacola - Panama City Beach - Tallahassee - Mobile

THIS SEAL HAS BEEN DIGITALLY SIGNED AND
SEALED BY JEFFREY C. BETERMANN ON THE
DATE ADJACENT TO THE SEAL. PRINTED COPIES
OF THIS DOCUMENT ARE NOT CONSIDERED
SIGNED AND SEALED AND THE SIGNATURE
MUST BE VERIFIED ON ANY ELECTRONIC COPIES.

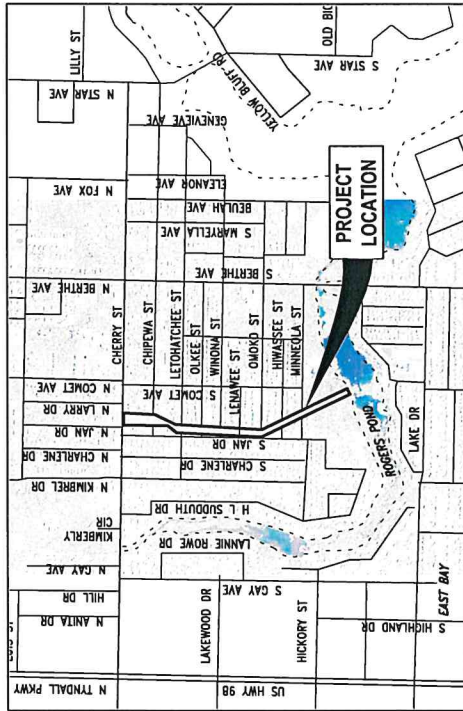

VICINITY MAP
NOT TO SCALE

SHEET INDEX

SHEET NO.	SHEET DESCRIPTION
G-000	KEY SHEET
G-001	GENERAL NOTES
C-100	CONTROL PLAN
C-101-104	EXISTING CONDITIONS & DEMOLITION PLAN
C-105-111	PLAN & PROFILE
C-112-119	CROSS SECTIONS
C-900	DETAILS
C-901-907	FOOT DETAILS

100% PLAN SET
RELEASED FOR CONSTRUCTION

CONTROL PLAN

PROJECT NO.	27651.01		
DATE	MAR 2022		
PROJ. NO.	202		
CHD. BY	JCP		
DRWN. BY	MCC		
DESIGNED BY	DM		
REVISION/ACTION TAKEN			
NO.	DATE	APPR.	REVISION/ACTION TAKEN

CHERRY STREET
DRAINAGE IMPROVEMENTS
(JAN DR TO ROGERS POND)

BASKERVILLE-DONOVAN, INC.
ENGINEERING THE SOUTH SINCE 1927
449 W. MAIN ST., PENNSACOLA FL 32502 (904)383-8661
CONVENING BUSINESS EST. 03/03/20

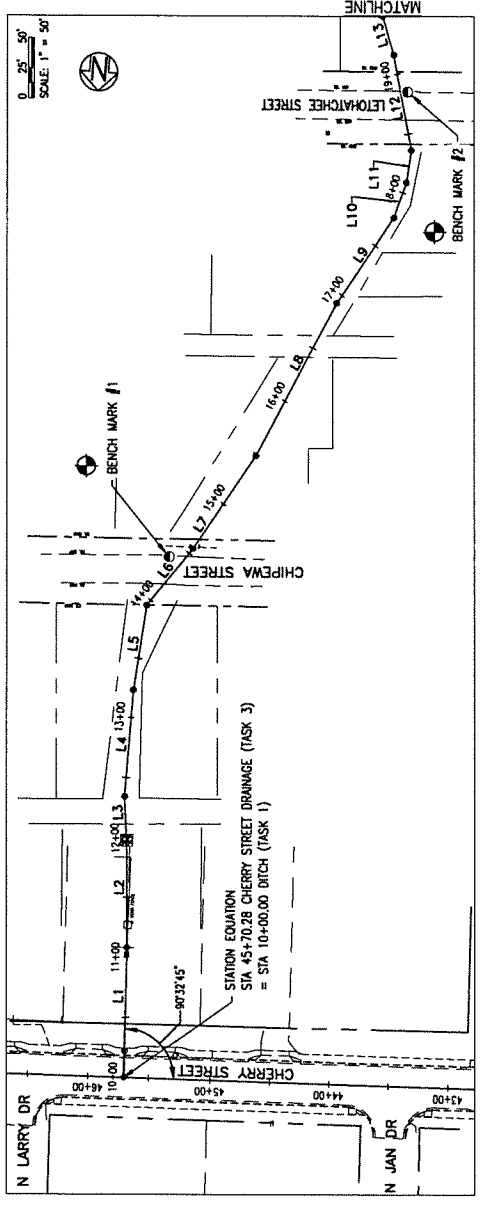
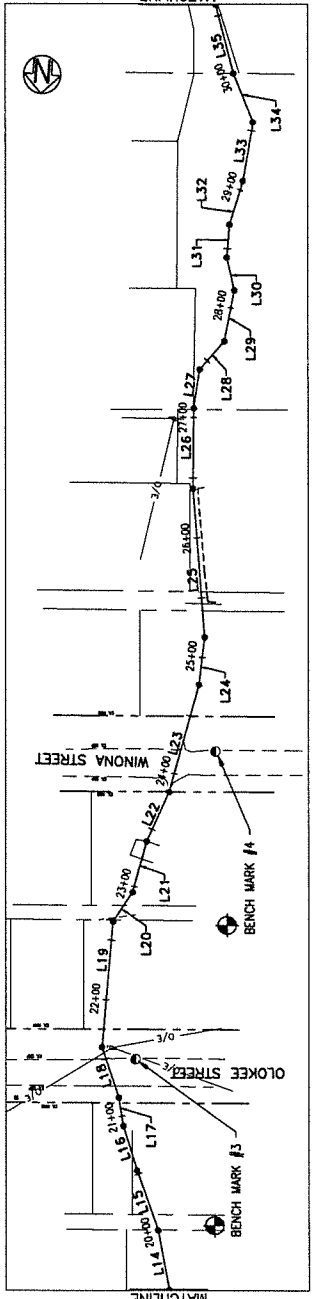
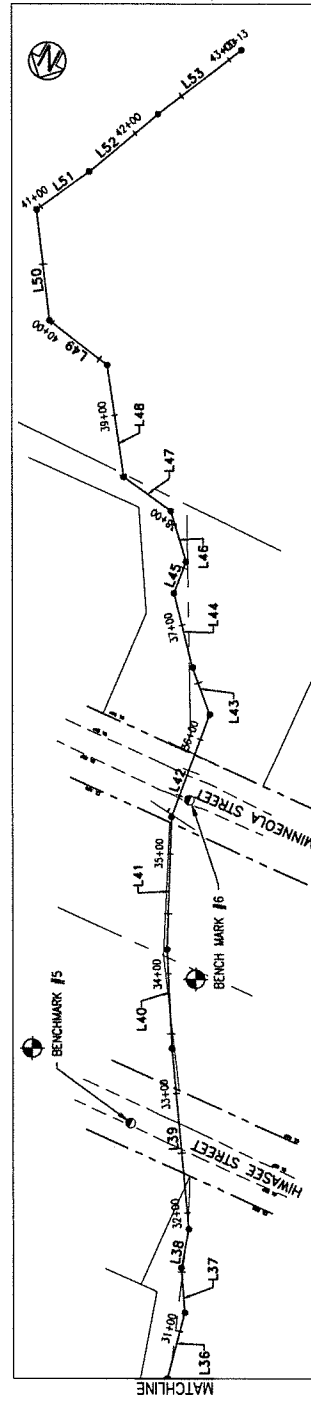

LINE TABLE

LINE #	DISTANCE	BEARING
L49	61.18'	S76°36'22.28"E
L50	92.96'	S30°33'52.51"E
L51	54.66'	S30°54'21.77"W
L52	74.66'	S26°26'21.05"W
L53	87.95'	S26°54'35.29"W

LINE TABLE

LINE #	DISTANCE	BEARING
L1	102.37'	S1°16'19.62"W
L2	90.82'	S0°03'36.74"W
L3	41.03'	S2°20'37.25"E
L4	60.19'	S4°36'29.00"W
L5	71.24'	S9°00'11.53"W
L6	60.37'	S36°16'08.44"W
L7	93.23'	S34°17'33.90"W
L8	144.17'	S26°12'43.27"W
L9	85.74'	S34°24'56.84"W
L10	30.98'	S19°36'06.10"W
L11	26.65'	S6°37'34.97"W
L12	60.18'	S10°21'01.44"E
L13	33.28'	S16°44'38.71"E
L14	60.53'	S10°46'03.80"E
L15	52.86'	S19°09'38.13"E
L16	38.82'	S17°00'34.46"E
L17	24.04'	S9°54'31.99"E
L18	44.39'	S18°50'13.10"E
L19	105.24'	S5°14'36.57"W
L20	26.49'	S33°45'23.84"W
L21	43.82'	S15°12'25.50"W
L22	45.22'	S24°37'30.33"W
L23	93.05'	S15°44'42.55"W
L24	39.76'	S9°46'54.53"W
L25	123.88'	S4°27'12.67"E
L26	66.96'	S0°38'43.80"W
L27	32.53'	S6°43'17.6"W
L28	31.20'	S41°26'20.02"W
L29	43.17'	S11°08'38.85"W
L30	27.26'	S13°05'54.42"E
L31	27.43'	S4°46'46.24"W
L32	38.03'	S17°08'04.51"W
L33	49.12'	S9°54'17.88"W
L34	43.65'	S21°37'04.37"E
L35	58.56'	S14°26'46.81"E
L36	56.77'	S8°17'52.97"E
L37	37.26'	S26°13'28.89"E
L38	33.03'	S13°10'44.84"E
L39	151.35'	S29°14'38.11"E
L40	42.80'	S26°39'32.21"E
L41	110.41'	S22°00'52.10"E
L42	91.15'	S3°37'56.17"E
L43	41.51'	S43°44'44.80"E
L44	64.02'	S37°35'17.28"E
L45	27.80'	S2°46'17.58"E
L46	44.16'	S40°29'23.67"E
L47	44.88'	S76°35'32.87"E
L48	93.86'	S32°25'15.28"E

BENCH MARK DATA

- BENCH MARK #1
STA 114+37.83 OFFSET 10.56' LT
SET MAGNETIC SURVEY
NAIL AND DISK NO. 0304
ELEVATION= 24.76'
- BENCH MARK #2
STA 18+HELIX OFFSET 5.72' RT
SET MAGNETIC SURVEY
NAIL AND DISK NO. 0304
ELEVATION= 24.48'
- BENCH MARK #3
STA 21+14.06 OFFSET 23.59' RT
SET MAGNETIC SURVEY
NAIL AND DISK NO. 0304
ELEVATION= 21.39'
- BENCH MARK #4
SET MAGNETIC SURVEY
NAIL AND DISK NO. 0304
ELEVATION= 21.39'
- BENCH MARK #5
SET MAGNETIC SURVEY
NAIL AND DISK NO. 0304
ELEVATION= 15.98'
- BENCH MARK #6
SET MAGNETIC SURVEY
NAIL AND DISK NO. 0304
ELEVATION= 13.21'

EXISTING CONDITIONS & DEMOLITION PLAN

PROJECT NO.	27651.01		
DESIGNED BY:	BCC		
CHECKED BY:	JCP		
DATE:	MAR 2022		
NOT RELEASED FOR CONSTRUCTION BY:	DATE		
NO.	DATE	APPR.	REVISION/ACTION TAKEN

CHERRY STREET
DRAINAGE IMPROVEMENTS
(JAN DR TO ROGERS POND)

ATKINS & KIRKMAN, P.C.
11100 W. MAINT ST., POKESCAVA, VA 22902 (800)636-6661
FEDERAL ENGINEERING CONSULTANTS & ARCHITECTS, INC.
449 W. MAIN ST., POKESCAVA, VA 22902 (800)636-6661
ENGINEERING THE SOUTH SINCE 1927

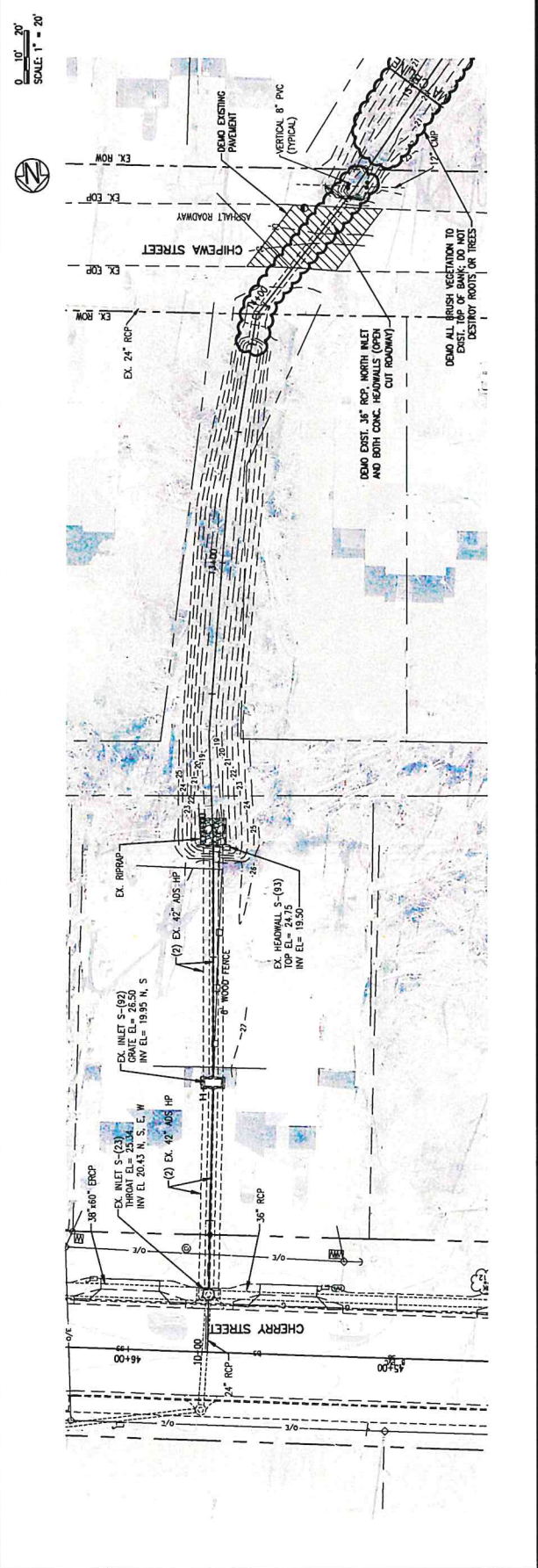
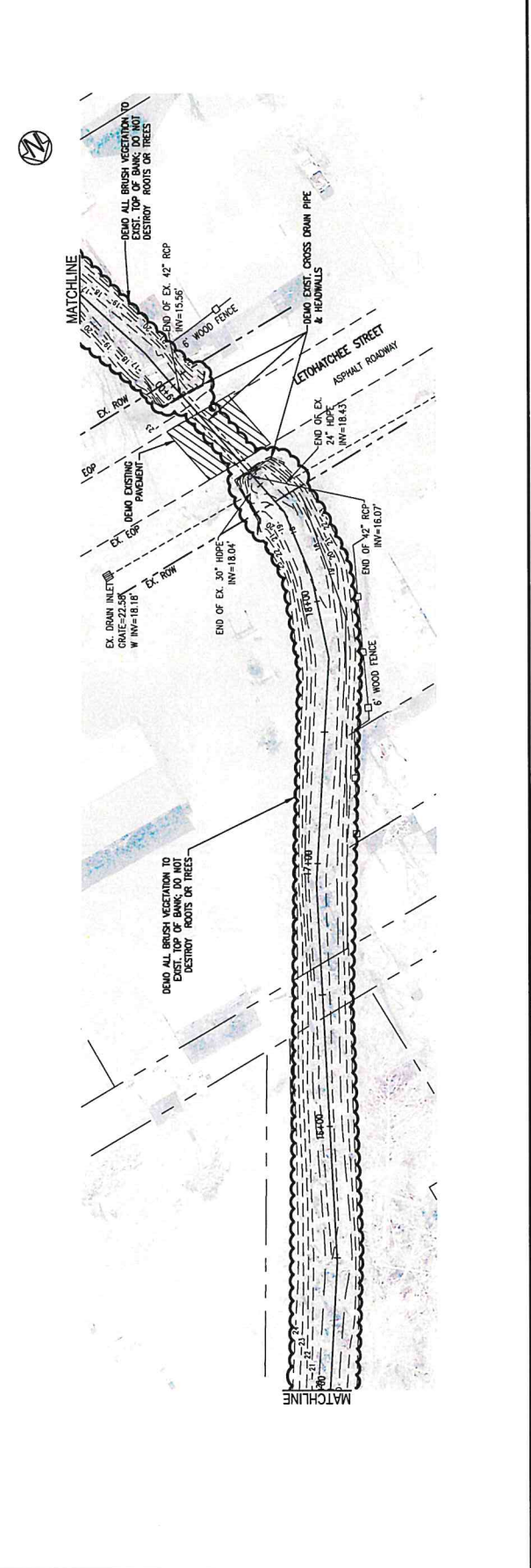

EXISTING CONDITIONS & DEMOLITION PLAN

PROJECT NO.	27651.01		
DESIGNED BY	GR		
DRAWN BY	KCP		
CHECKED BY	KCP		
DATE	MAR 2022		
NOT RELEASED FOR CONSTRUCTION BY	DATE / /		
NO.	DATE	APPR.	REVISION/ACTION TAKEN

CHERRY STREET
DRAINAGE IMPROVEMENTS
(JAN DR TO ROGERS POND)

PROJECT: FRENCH CITY BRUSH - ADDRESS - 10000
449 W MAIN ST, FRENCH CITY, MO 64503
ENGINEERING BUSINESS - 2000000
BASKERVILLE-DONOVAN, INC.
ENGINEERING THE SOUTH SINCE 1927

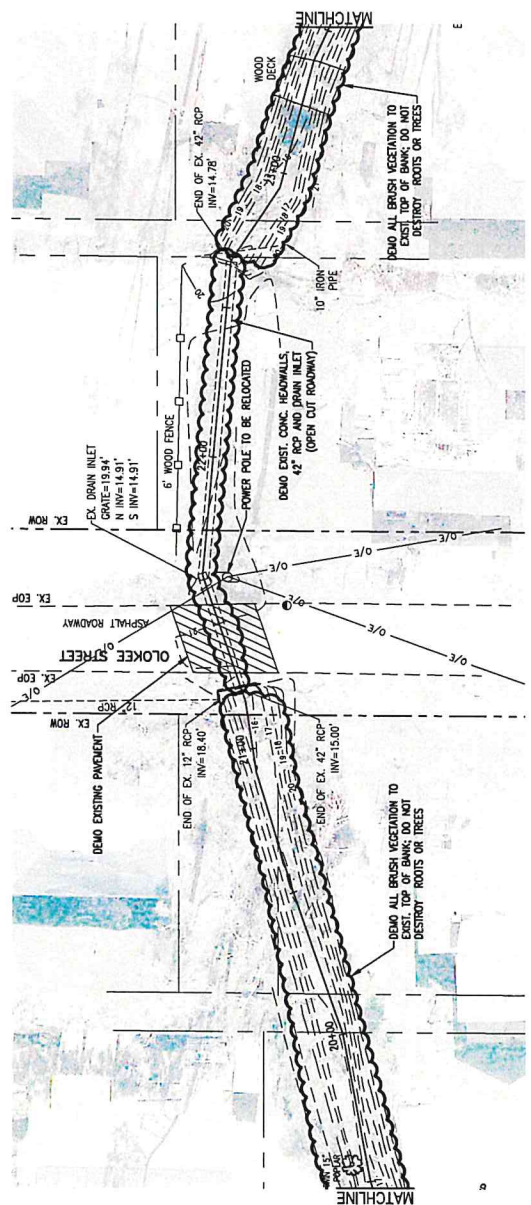
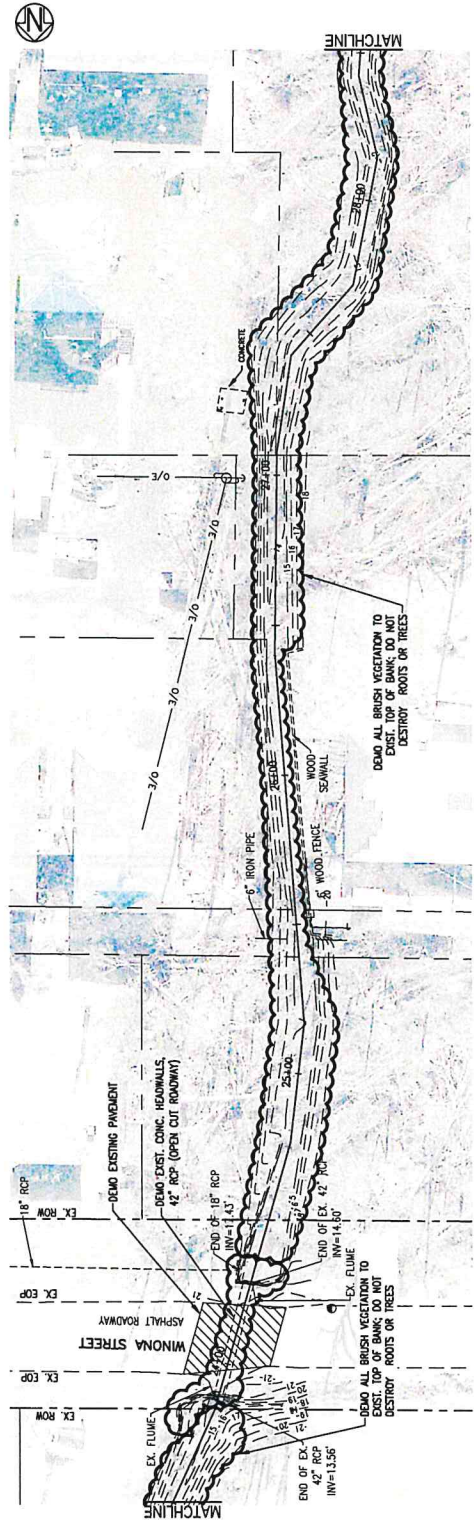

SCALE: 1" = 20'
DATE: 03/20/22

EXISTING CONDITIONS
& DEMOLITION PLAN

PROJECT NO.	27651.01		
DESIGNED BY	GA		
PROGRAM	RSC		
CLIENT	JCF		
DATE	APR 2022		
NOT RELEASED FOR CONSTRUCTION BY	DATE		
NO.	DATE	APPR.	REVISION/ACTION TAKEN

CHERRY STREET
DRAINAGE IMPROVEMENTS
(JAN DR TO ROGERS POND)

ATTY C. KEDDUM, P.E.
11 Hwy, Englewood #77340
BASKERVILLE-DONOVAN, INC.
ENGINEERING THE SOUTH SINCE 1927
409 W MAIN ST, PENSACOLA, FL 32502 (904)363-9844
PROFESSIONAL ENGINEERING BUSINESS, EA-000000
1909 W MAIN ST, PENSACOLA, FL 32502 (904)363-9844

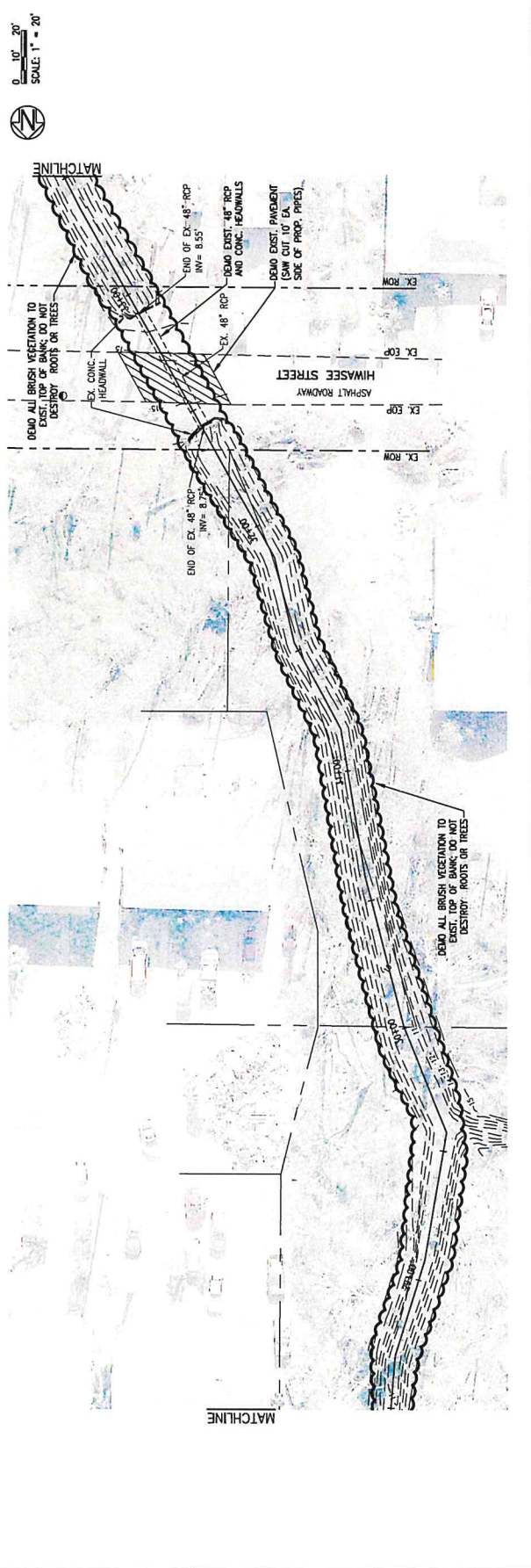
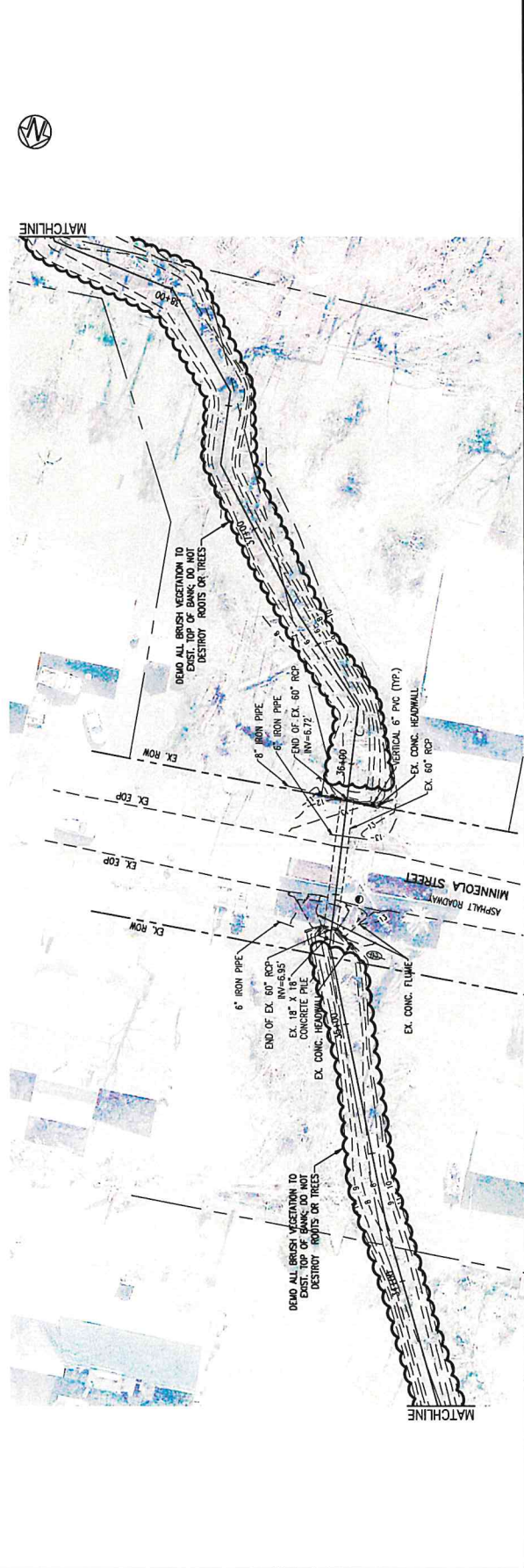

SCALE: 1" = 20'
N

EXISTING CONDITIONS
& DEMOLITION PLAN

PROJECT NO.	27651.01		
DESIGNED BY:	GA		
DRAWN BY:	BJC		
CHECKED BY:	JCP		
DATE:	MAR 2022		
NOT RELEASED FOR CONSTRUCTION BY	DATE		
NO.	DATE	APPR.	REVISION/ACTION TAKEN

CHERRY STREET
DRAINAGE IMPROVEMENTS
(JAN DR TO ROGERS
POND)

ARTHY C. RITTMAN, P.E.
P.L. Reg. Engineer #77540

BASKERVILLE-DONOVAN, INC.
ENGINEERING THE SOUTH SINCE 1927
449 W. MAIN ST., PENSACOLA, FL 32502
904.433.1111
www.baskerville-donovan.com

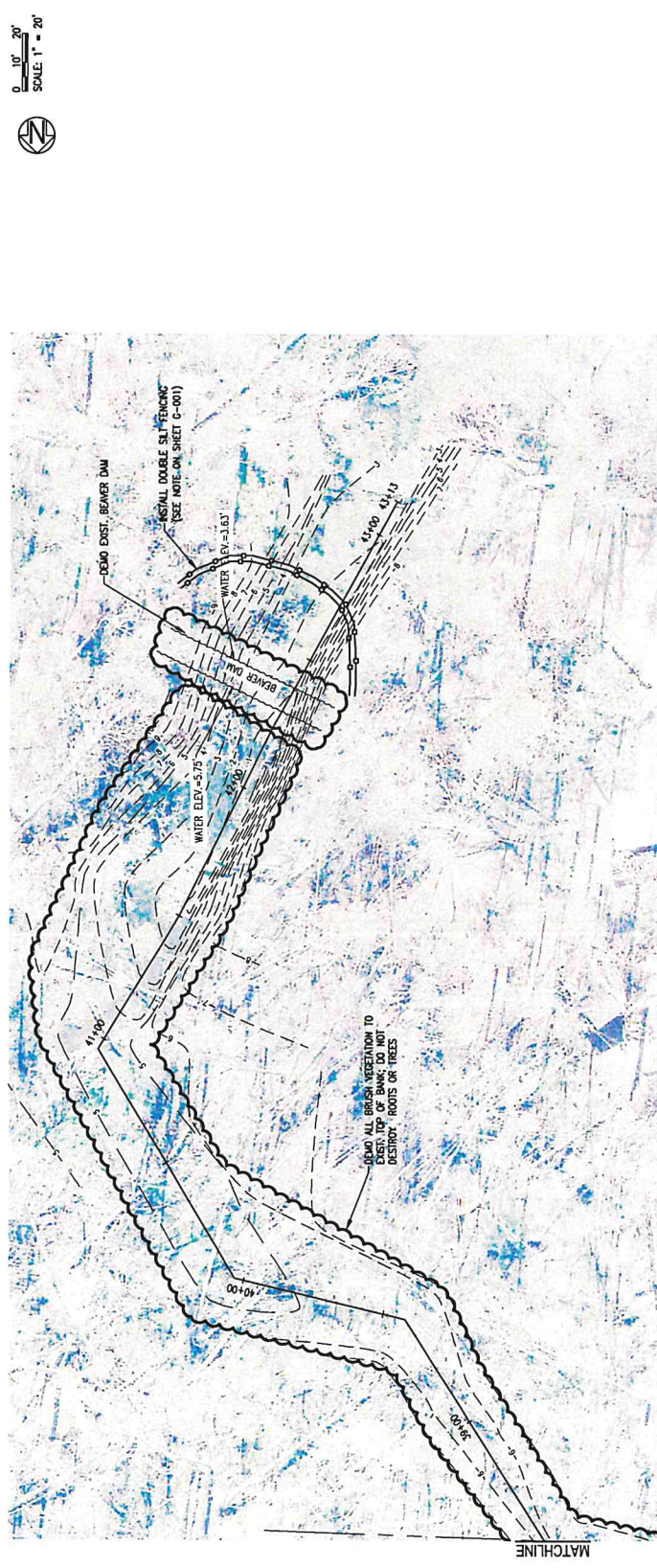

SCALE: 1" = 20'
N

PLAN AND PROFILE

PROJECT NO.	27655.01
DATE	MAR 2022
ISSUED FOR	CONSTRUCTION BY DATE
DESIGNED BY	
CHECKED BY	
DATE	
REVISION/ACTION TAKEN	

CHERRY STREET
DRAINAGE IMPROVEMENTS
(JAN DR TO ROGERS POND)

BASKERVILLE-DONOVAN, INC.
ENGINEERING THE SOUTH SINCE 1927
4400 W. MAIN ST., FENNSBORO, VA 22939
TEL: 800.828.8888

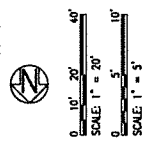
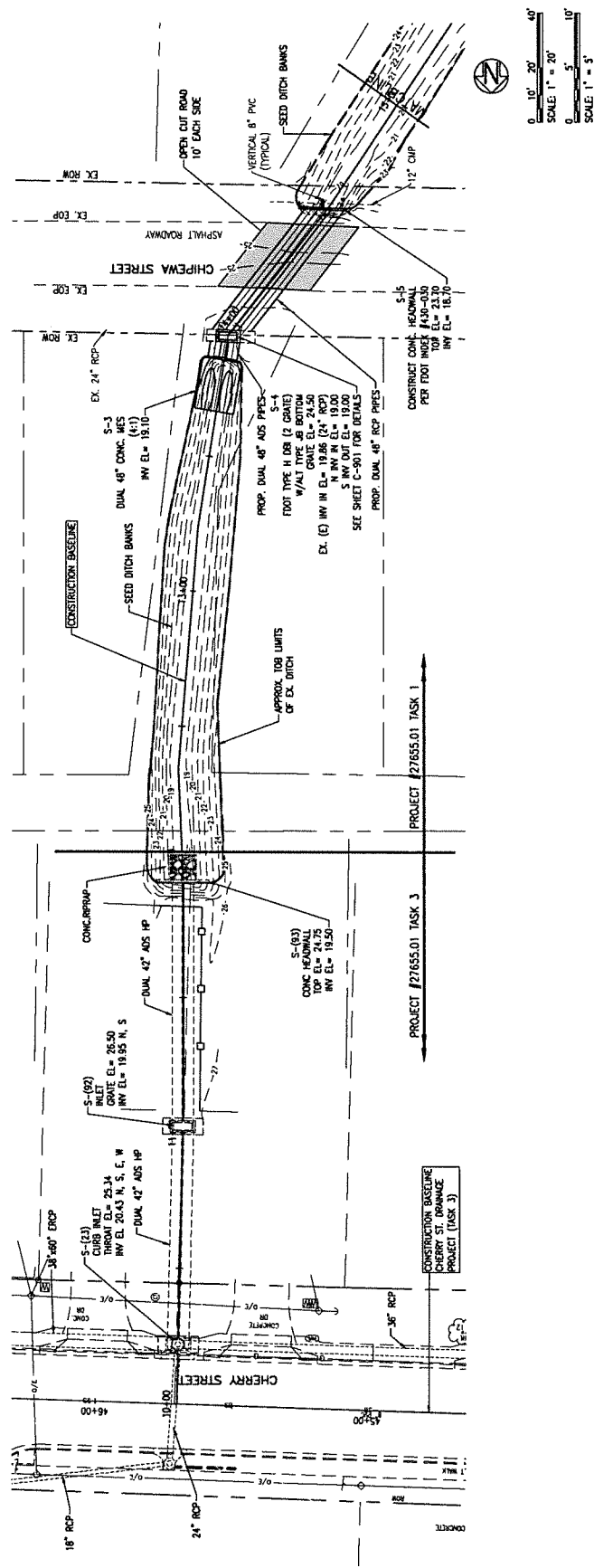
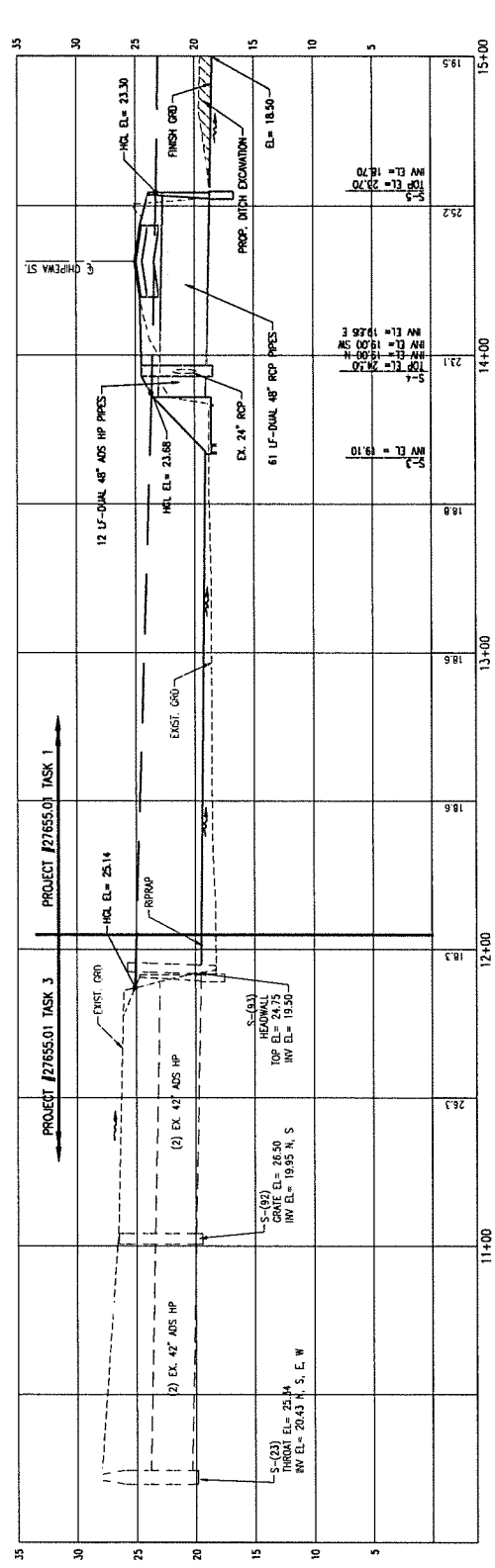

PLAN AND PROFILE

PROJECT NO.	27851.01
DESIGNED BY:	DM
DATE	
APPROVED	
REVISION/ACTION TAKEN	
DATE	
BY	
NOT RELEASED FOR CONSTRUCTION BY	

CHERRY STREET
DRAINAGE IMPROVEMENTS
(JAN DR TO ROGERS
POND)

LETTS & KITCHEN P.C.
11. Hwy. Engineer #77500

BASKERVILLE-DONOVAN, INC.
ENGINEERING THE SOUTH SINCE 1927
CONCRETE BUSINESS: 813-200-0951
429 W. MARKET, FORT WORTH, TX 76102

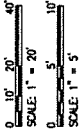
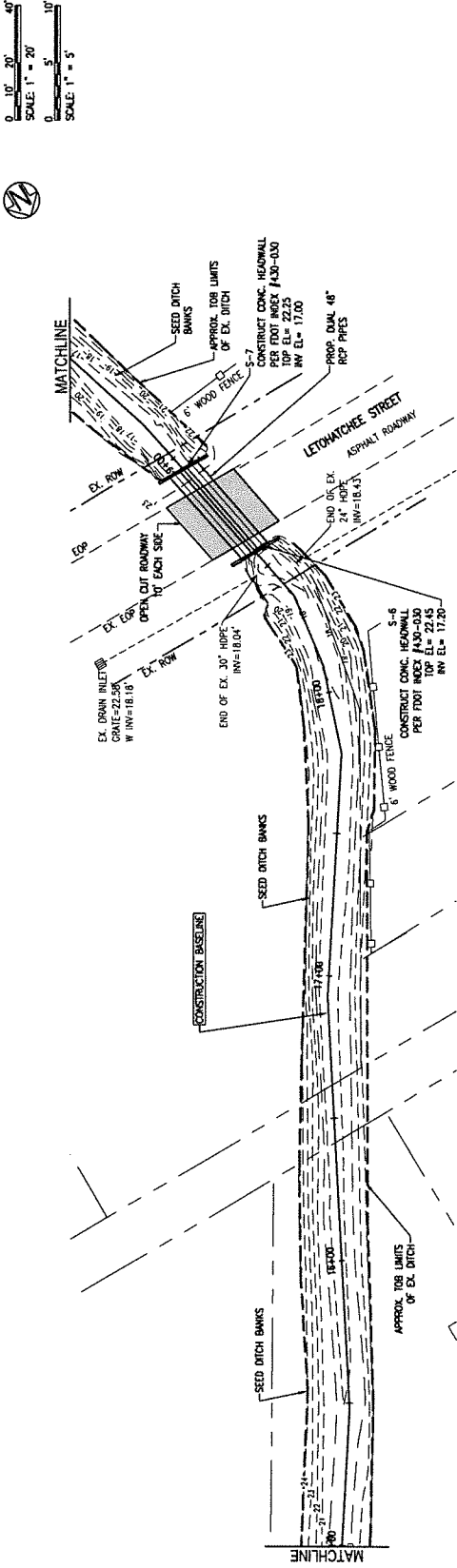
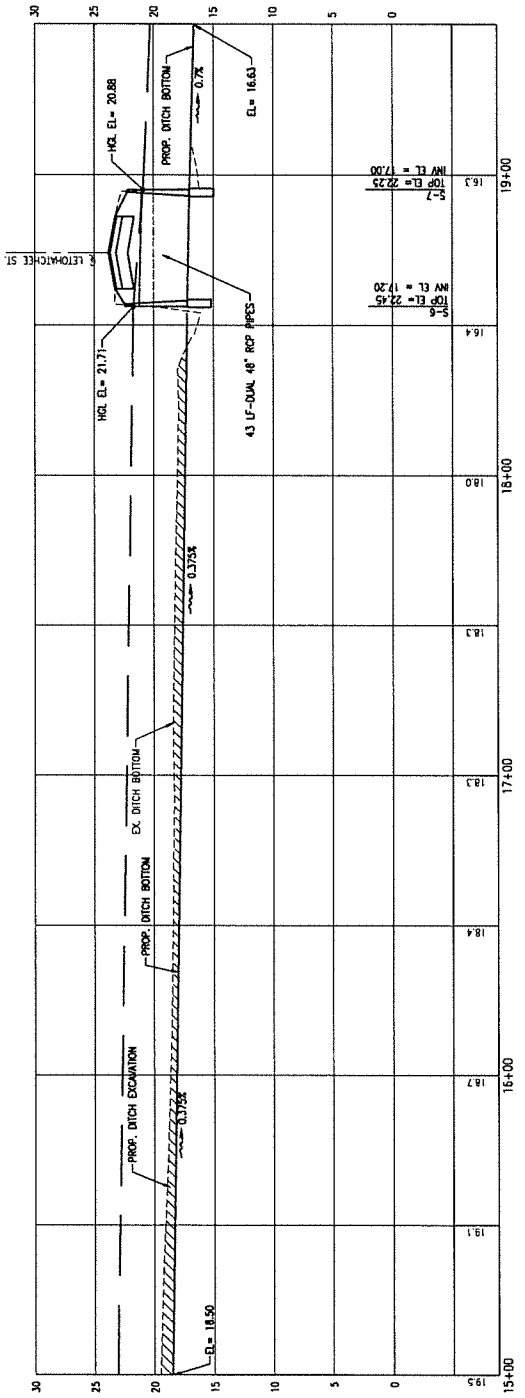

PROJECT NO.	27651.01
DATE	MAR 2022
PROJ. MGR.	JCF
CHD. ENGR.	JCF
DRAWING BY	REC
CHECKED BY	GM
NOT RELEASED FOR CONSTRUCTION BY	DATE
REVISION/ACTION	TAKEN

CHERRY STREET
DRAINAGE IMPROVEMENTS
(JAN DR TO ROGERS
POND)

ARTHUR C. KEDMOR, P.E.
FL Reg. Engineer #7720

BASKERVILLE-DONOVAN, INC.
ENGINEERING THE SOUTH SINCE 1927
409 W. MAIN ST. PENSACOLA, FL 32502 (904)394-1844
ENGINEERING BUSINESS, EST. 1927

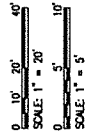
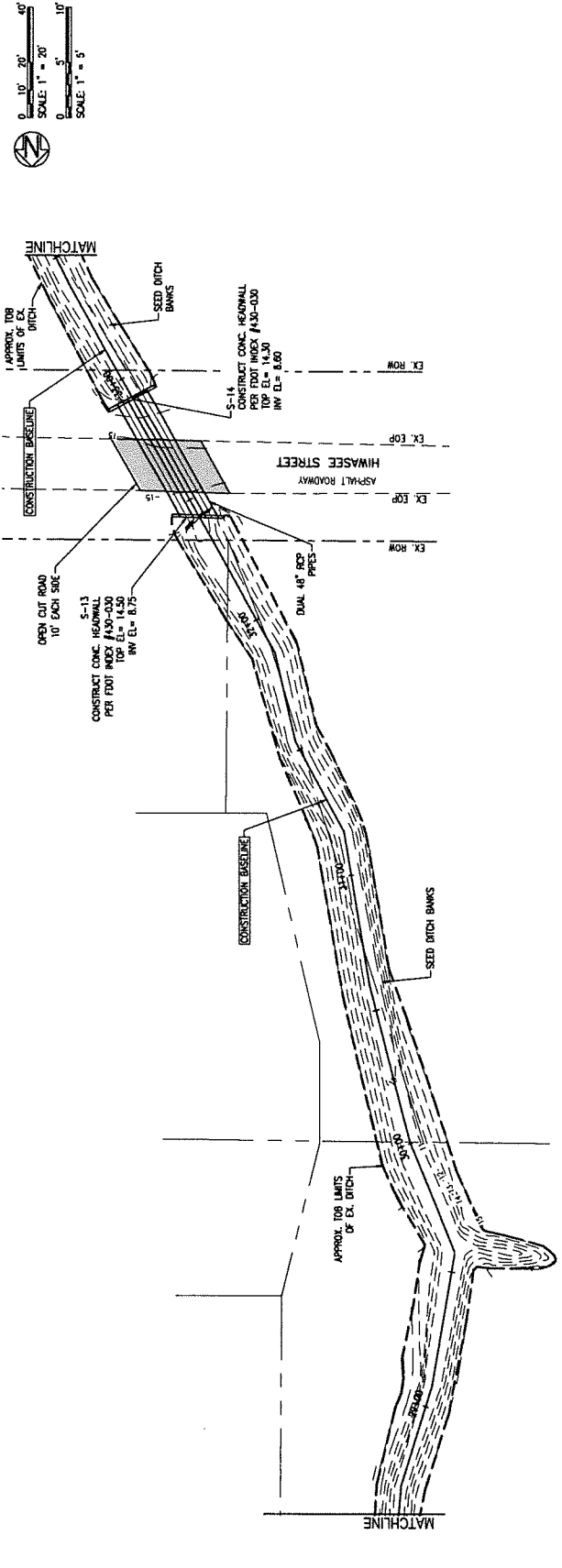
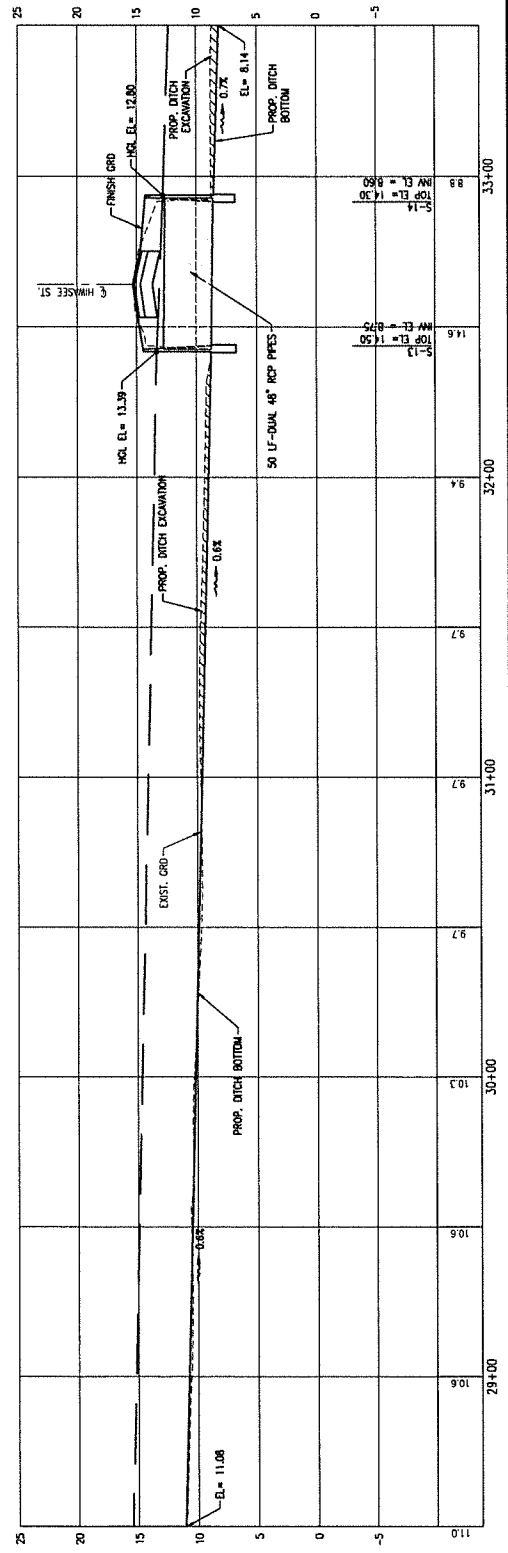

CROSS-SECTIONS

PROJECT NO.	27655.01
DISCIPLINE	DR
DATE	APRIL
REVISION/ACTION TAKEN	
NOT RELEASED FOR CONSTRUCTION BY	DATE

CHERRY STREET
DRAINAGE IMPROVEMENTS
(JAN DR TO ROGERS
POND)

ALVIN C. KEMMER, P.E.
11 King, Columbia, SC 29204
Professional - Planning City Engineer - Transportation - Utilities
BASKERVILLE-DONOVAN, INC.
ENGINEERING THE SOUTH SINCE 1927
437 MARKET ST., NEWSCOLA BLDG. 2202B (29203) 803-733-1111
ENGINERING BUSINESS EXP. 200000

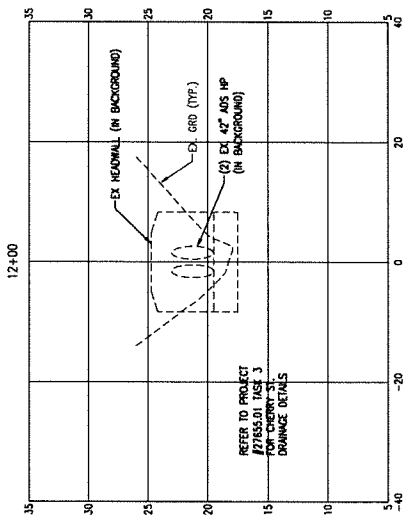
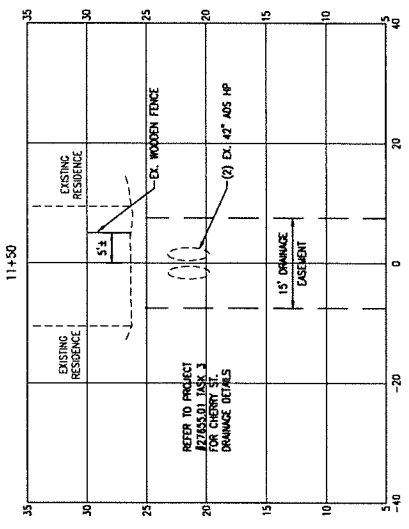
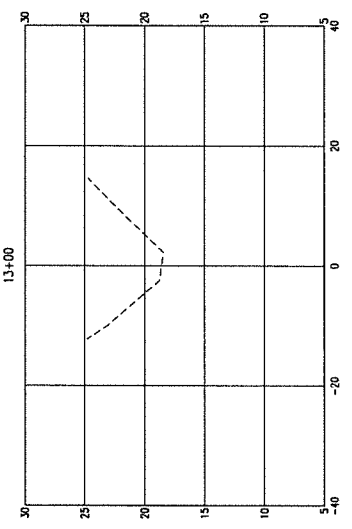
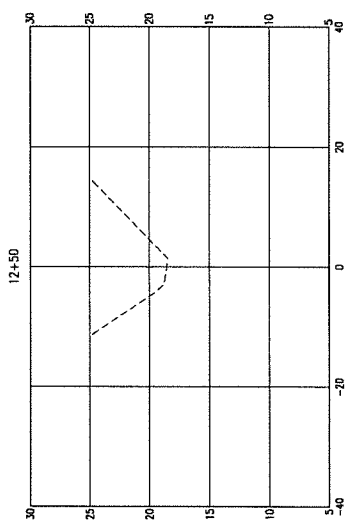
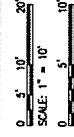
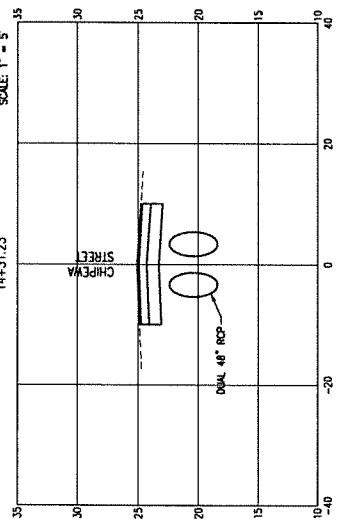
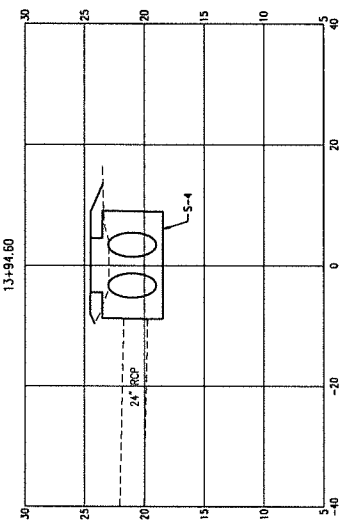
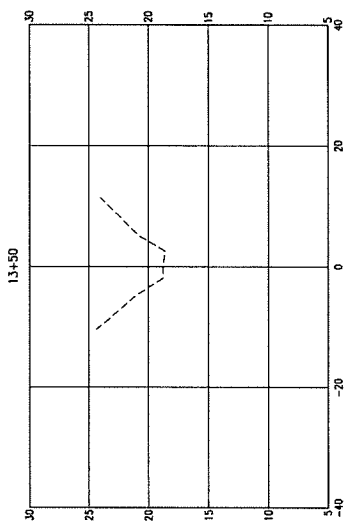

CROSS-SECTIONS

PROJECT NO:	27631.01
DESIGNED BY:	GM
DRAWN BY:	MSZ
CHECKED BY:	JCF
PROJECT:	JCF
DATE:	MAR 2022
NOT RELEASED FOR CONSTRUCTION BY:	DATE: / /
REVISION/ACTION TAKEN:	

CHERRY STREET
DRAINAGE IMPROVEMENTS
(JAN DR TO ROGERS
POND)

B BASKERVILLE-DONOVAN, INC.
ENGINEERING THE SOUTH SINCE 1927
4439 W. MAJAN ST. PENSACOLA, FL 32502 (904) 386-8661
ENGINEERING BUSINESS: EA-000200
Professional - Florida City/County - Technical - State
ALBERT C. DONOVAN, P.E.
FL Reg. Engineer #17300

This drawing is the property of BASKERVILLE-DONOVAN, INC. and it is to be returned to them or its agent if it is not to be used on any other project and it is returned when required.

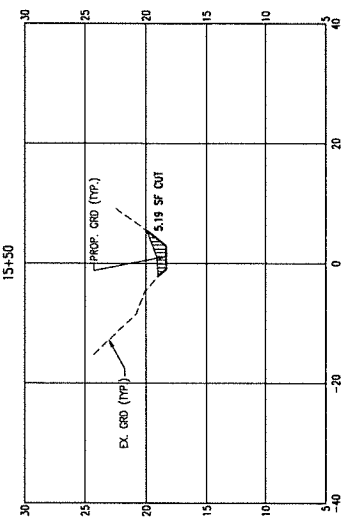
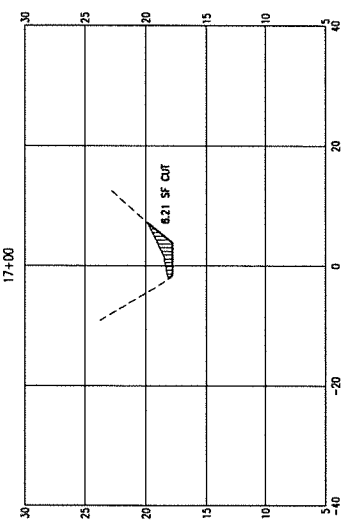
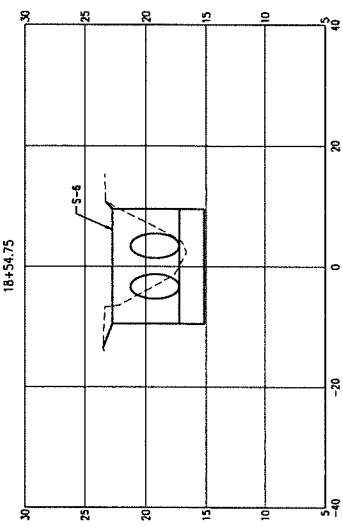
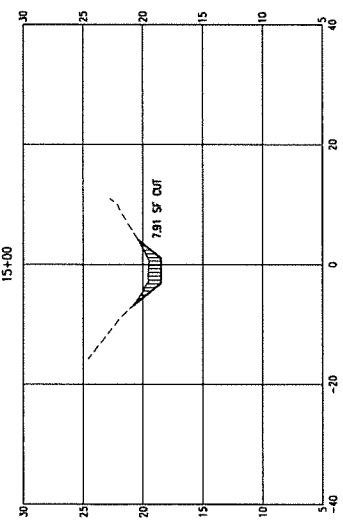
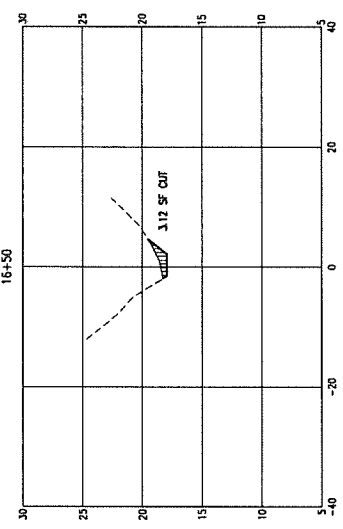
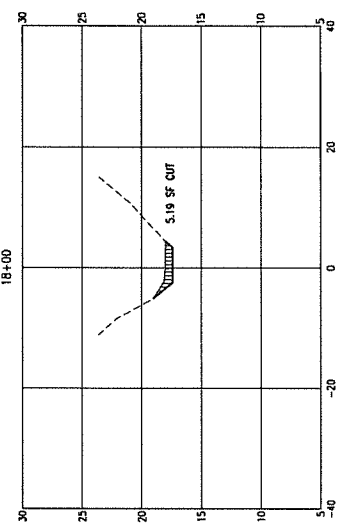
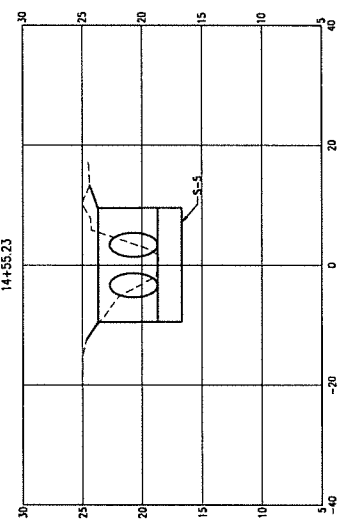
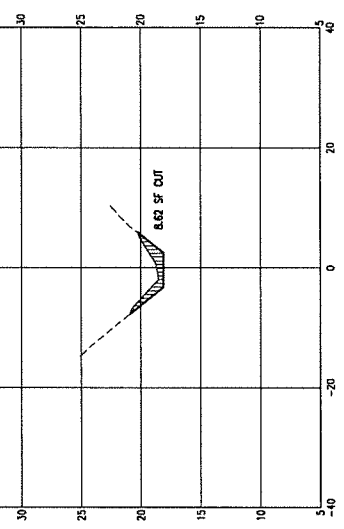
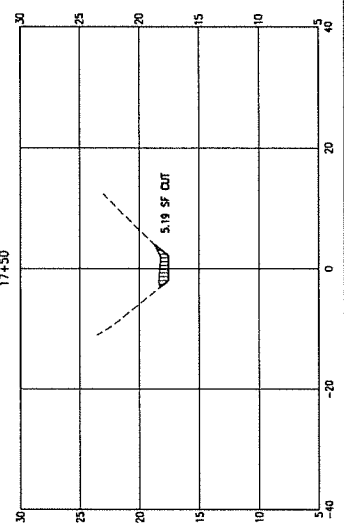

CROSS-SECTIONS

PROJECT NO.	27651.01
DATE	04/20/22
NO.	
DATE	
APPR.	
REVISION/ACTION TAKEN	
NOT RELEASED FOR CONSTRUCTION BY	DATE
DATE	
PROJECT NO.	
DATE	
NO.	
DATE	
APPR.	
REVISION/ACTION TAKEN	

CHERRY STREET
DRAINAGE IMPROVEMENTS
(JAN DR TO ROGERS
POND)

FRANK C. VITANO, P.E.
REGISTERED PROFESSIONAL ENGINEER
No. 11750

FB
ENGINEERING THE SOUTH SINCE 1927
BASKERVILLE-DONOVAN, INC.
1400 N. MAIN ST., PENSACOLA, FL 32503 (850) 438-8861
PROFESSIONAL ENGINEERS & SURVEYORS
FL REG. ENGINEER #11750

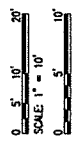
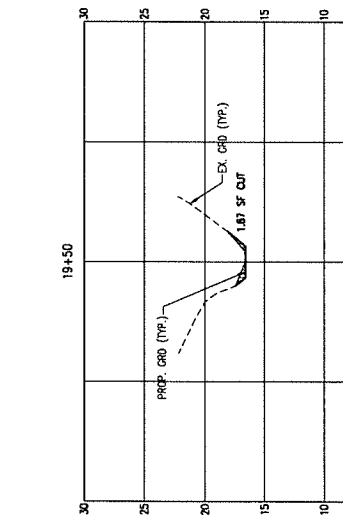
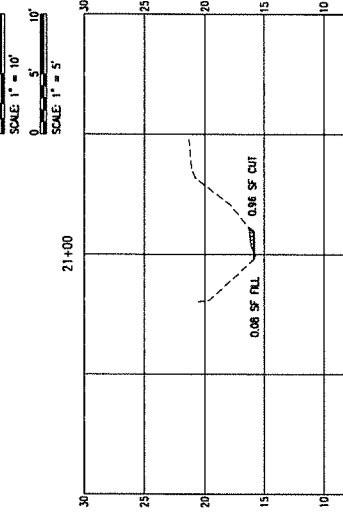
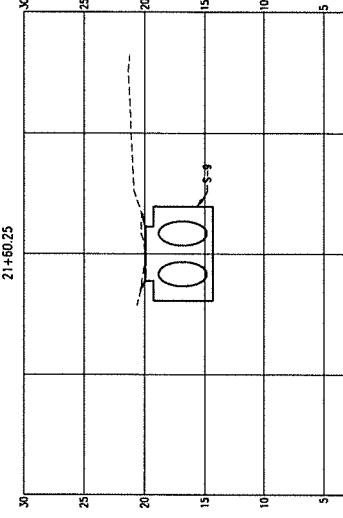
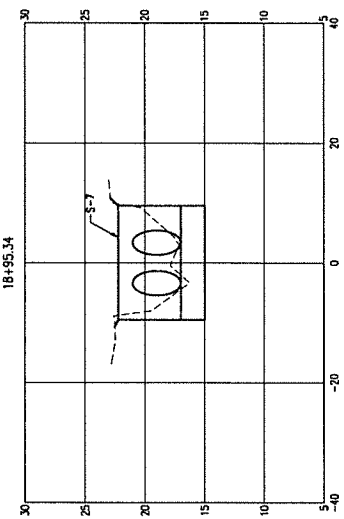
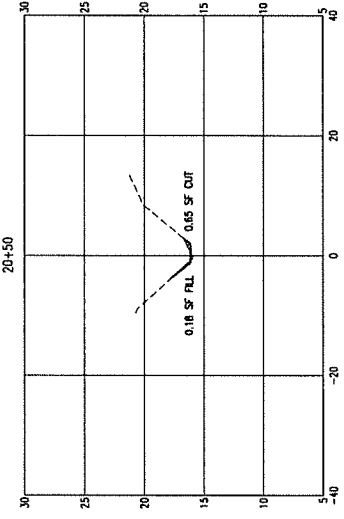
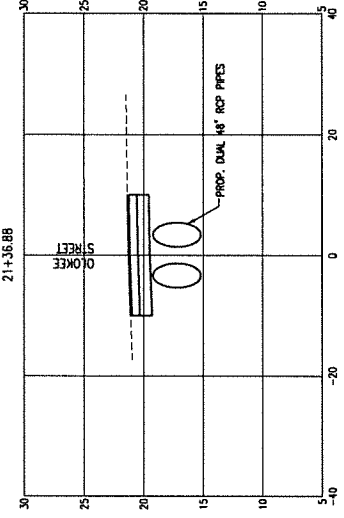
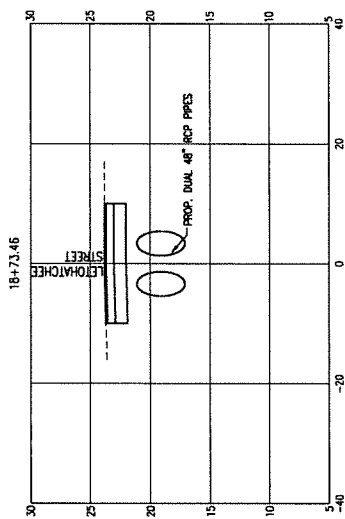
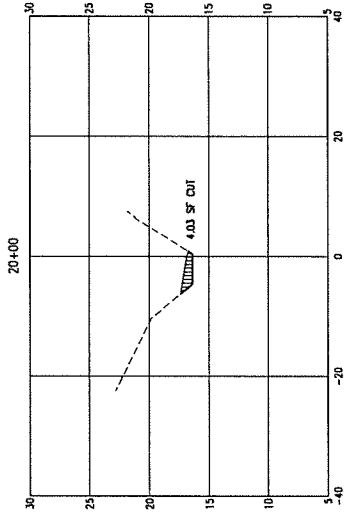
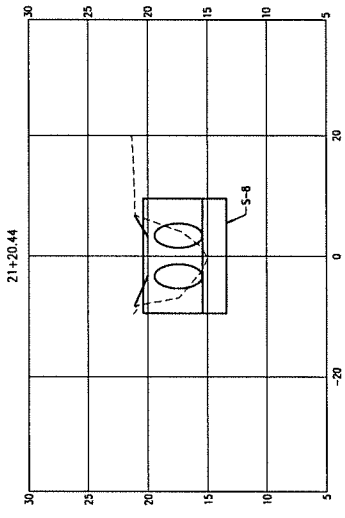

CROSS-SECTIONS

PROJECT NO.	27651.01		
DESIGNED BY	JCP		
DRAWN BY	JCP		
CHECKED BY	JCP		
DATE	04/20/2022		
NOT RELEASED FOR CONSTRUCTION BY	DATE		
NO.	DATE	APPROV.	REVISION/ACTION TAKEN

CHERRY STREET
DRAINAGE IMPROVEMENTS
(JAN DR TO ROGERS
POND)

ATYEE C. RITTMANN, P.E.
P.E. License No. 17150

BASKERVILLE-DONOVAN, INC.
ENGINEERING THE SOUTH SINCE 1927
449 W. MAIN ST., PENNSACOLA, FL 32502 (904)369-6661
PENNSACOLA - PANAMA CITY BEACH - TAMPA - JACKSONVILLE

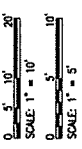
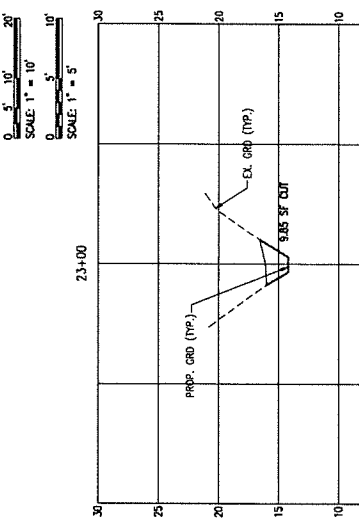
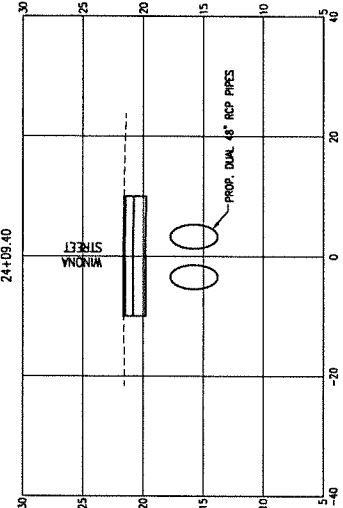
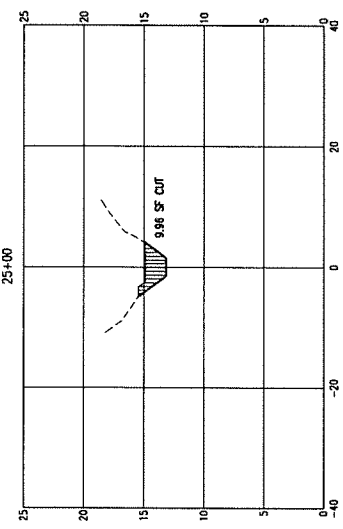
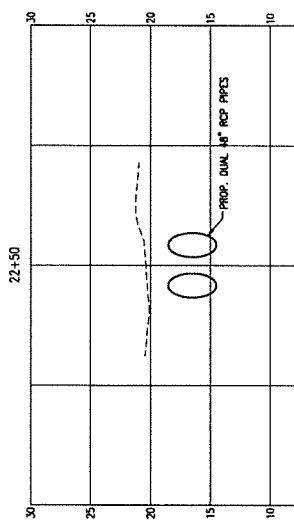
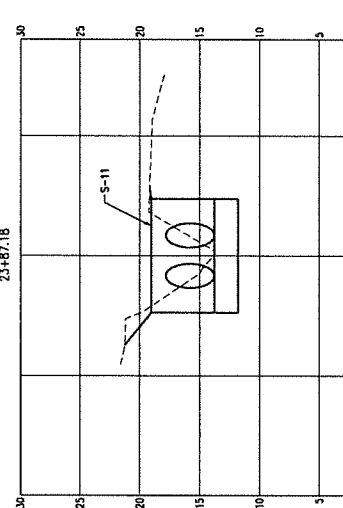
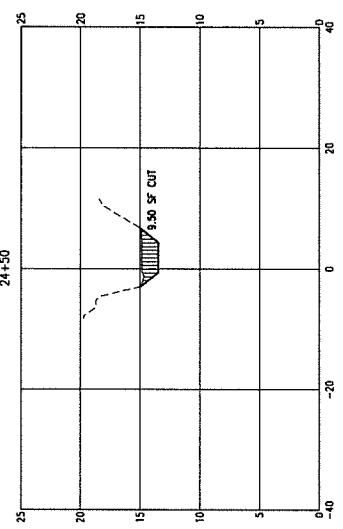
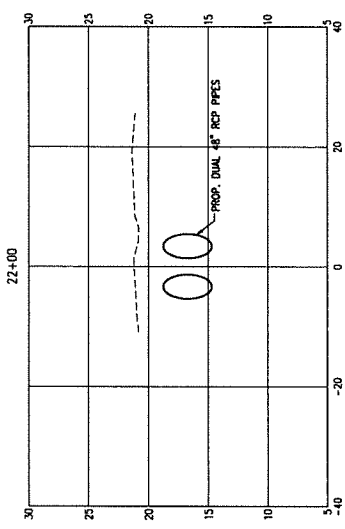
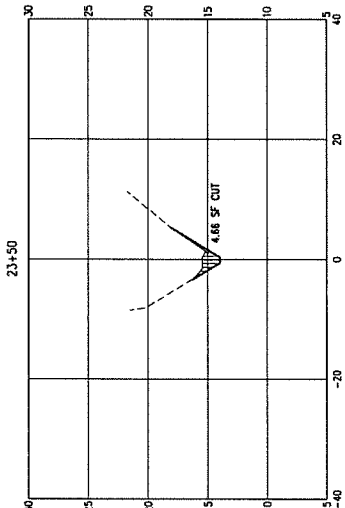
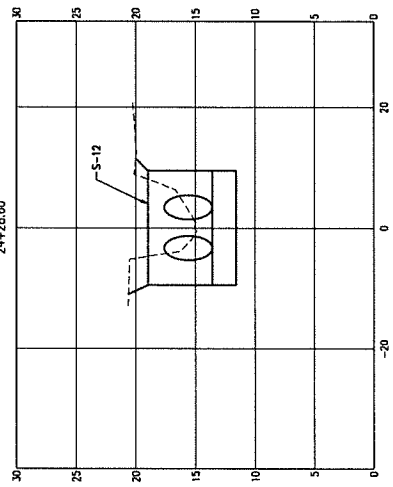

CROSS-SECTIONS

PROJECT NO.	27651.01
NO.	
DATE	APRIL
REVISION/ACTION TAKEN	
NOT RELEASED FOR CONSTRUCTION BY	DATE / /
PROJ. MGR.	JCP
CHIEF ENGR.	JCP
DRAWN BY	MSC
DESIGNED BY	DM

CHERRY STREET
DRAINAGE IMPROVEMENTS
(JAN DR TO ROGERS
POND)

FL. Eng. Engineer #77540
ALBERT L. KIRBY, P.E.

BASKERVILLE-DONOVAN, INC.
ENGINEERING THE SOUTH SINCE 1927
449 W. MAIN ST. PEASACOCKA, VA 22601 (800)455-8181
Professional - Potomac City Branch - Tidewater - Roanoke

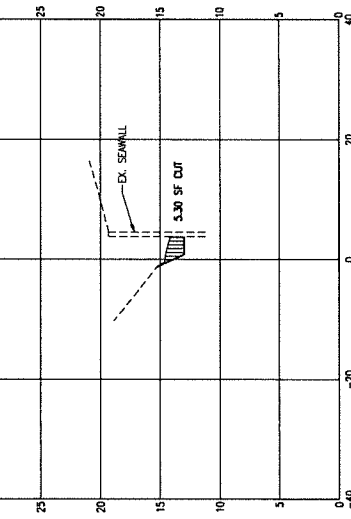
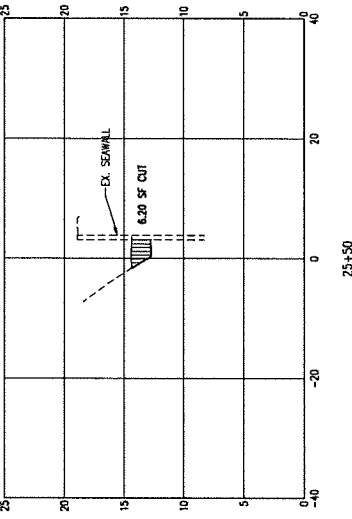
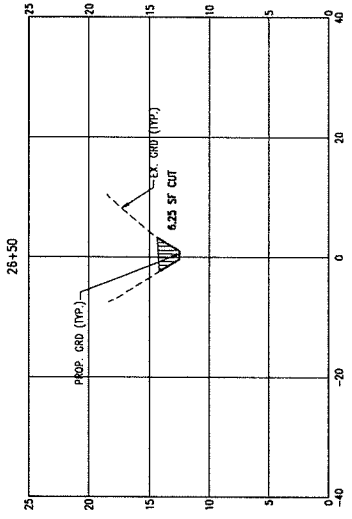
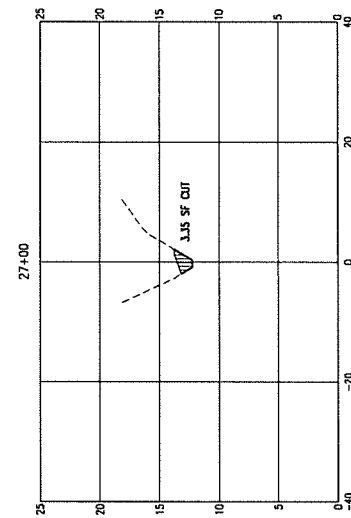
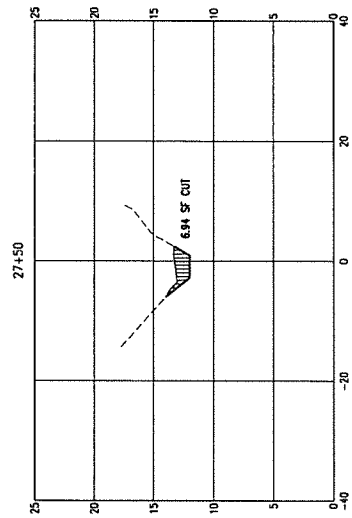
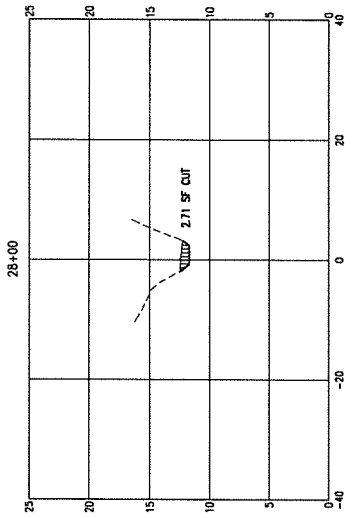
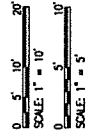

CROSS-SECTIONS

PROJECT NO.	27651.01		
DESIGNED BY	ML		
DRAWN BY	ML		
CHECKED BY	JCF		
DATE	MAR 2022		
NOT RELEASED FOR CONSTRUCTION BY	DATE / /		
NO.	DATE	APPR.	REVISION/ACTION TAKEN

CHERRY STREET
DRAINAGE IMPROVEMENTS
(JAN DR TO ROGERS
POND)

ALBERT C. KIRWAN, P.E.
P.E. License # 177240

BASKERVILLE-DONOVAN, INC.
ENGINEERING THE SOUTH SINCE 1927
449 W. MAIN ST., PENSACOLA FL 32502 (904)666-1111
PROVIDING A COMPLETE RANGE OF ENGINEERING SERVICES TO CLIENTS

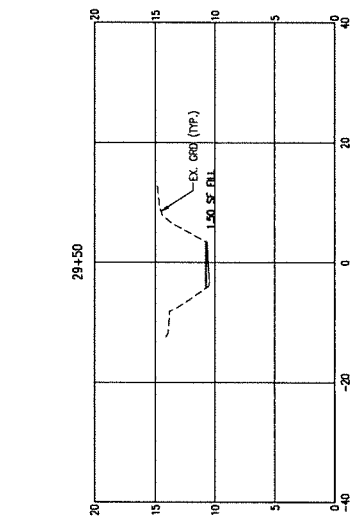
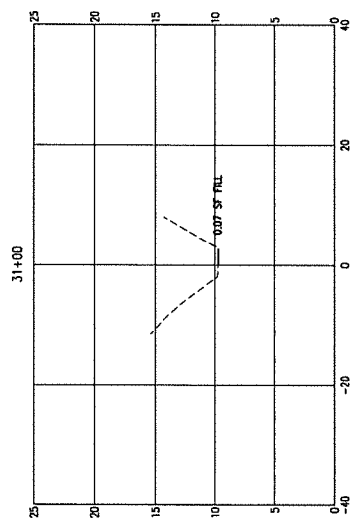
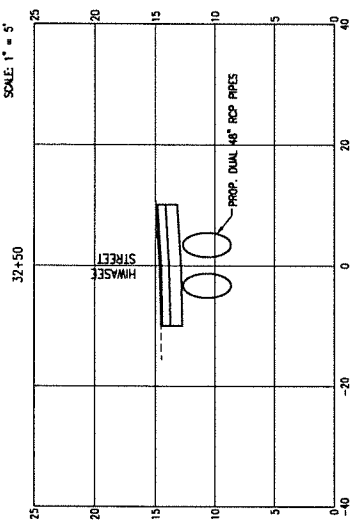
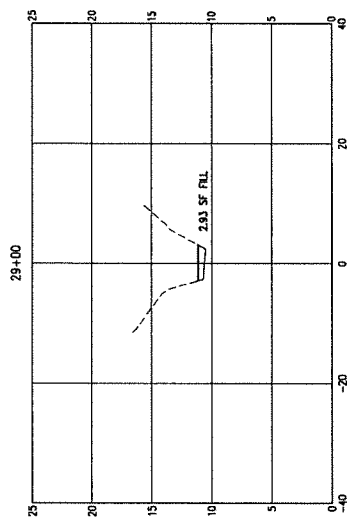
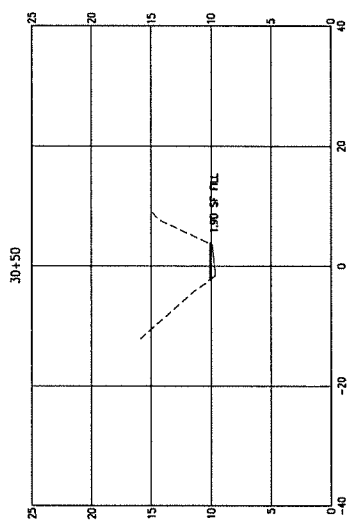
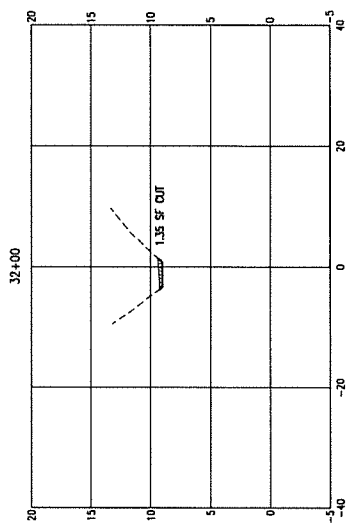
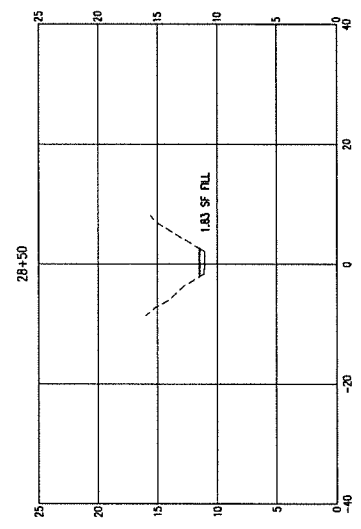
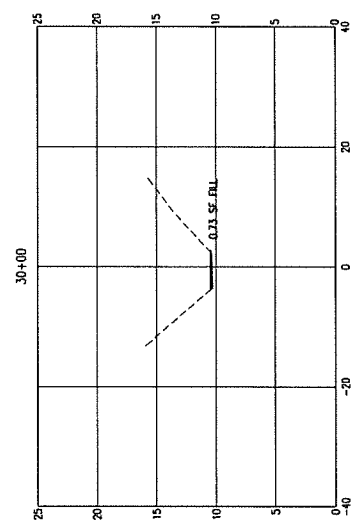
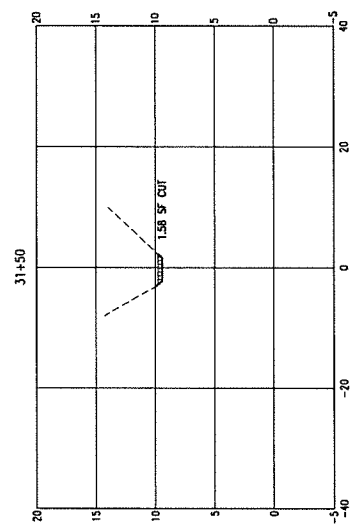

SCALE: 1" = 5'
SCALE: 1" = 10'
0 5 10 20

CROSS-SECTIONS

PROJECT NO.	27651.01		
DESIGNED BY: EA			
DRAWN BY: JCF			
CHECKED BY: JCF			
PROJ. WORK: JCF			
DATE: MAR 2022			
NOT RELEASED FOR CONSTRUCTION BY	DATE		
NO.	DATE	APPR.	REVISION/ACTION TAKEN

CHERRY STREET
DRAINAGE IMPROVEMENTS
(JAN DR TO ROGERS
POND)

ITR, Inc., Engineer #77540
11, King, Engineer #77540

BASKERVILLE-DONOVAN, INC.
ENGINEERING THE SOUTH SINCE 1927
449 NW 14th ST, FRENCH CREEK, MO 64501
ENGINEERING BUSINESS: EB-000030
Professional Engineers - Missouri
The drawing is the property of BASKERVILLE-DONOVAN, INC. and it is to be returned to them if it is not paid for and the original project used in its intended application.

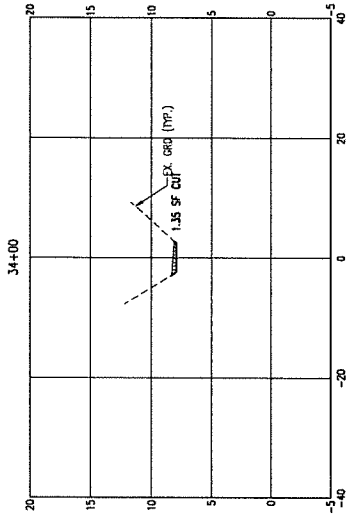
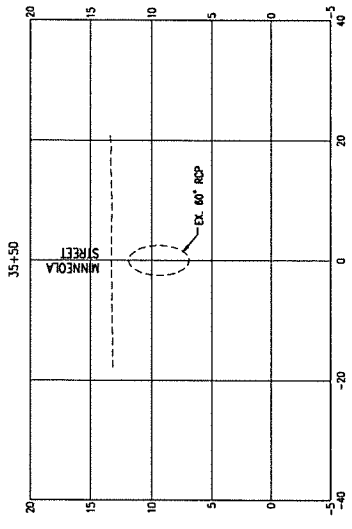
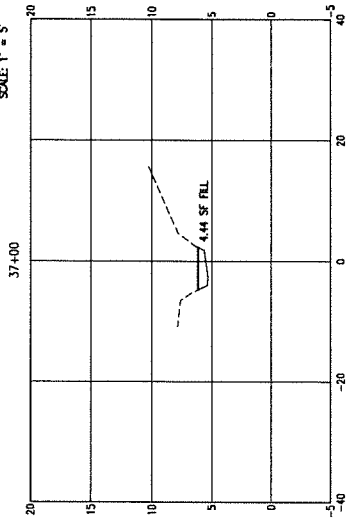
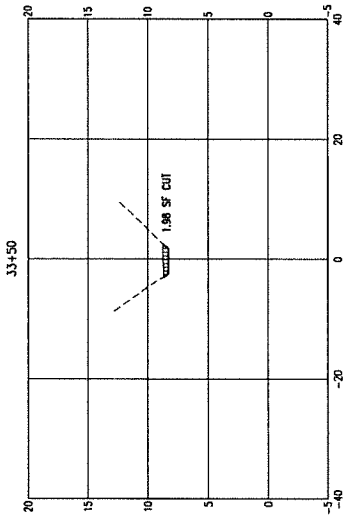
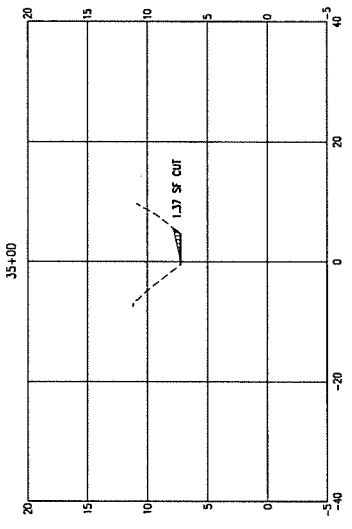
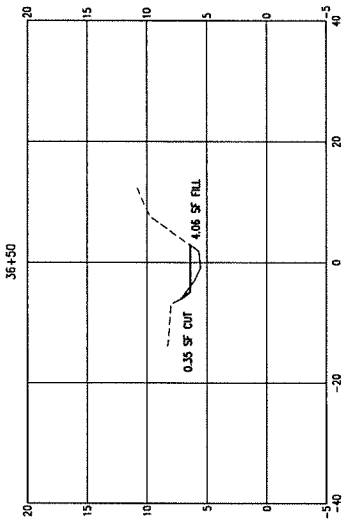
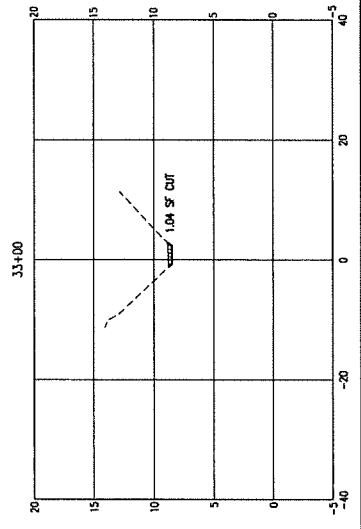
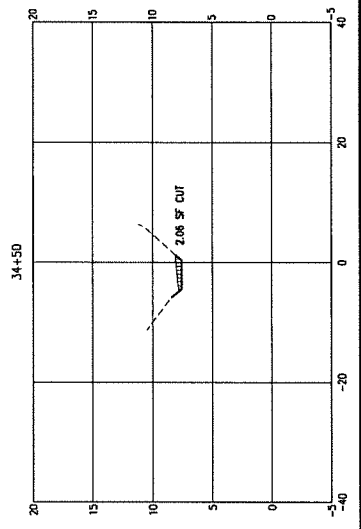
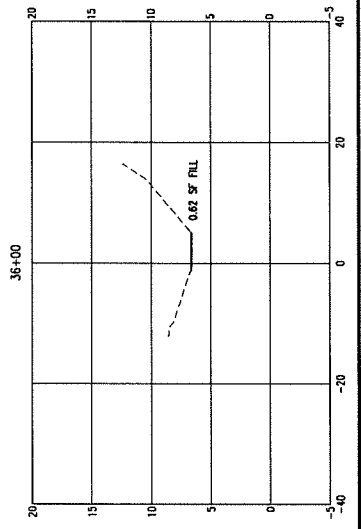

SCALE: 1" = 5'
SCALE: 1" = 10'

CROSS-SECTIONS

PROJECT NO.	27651.01
DESIGNED BY	RM
DRAWN BY	BCD
CHECK BY	JCP
PROJ. NO.	JCP
DATE	MAR 2022
NOT BUILT FOR CONSTRUCTION BY	DATE
REVISION/ACTION TAKEN	

CHERRY STREET
DRAINAGE IMPROVEMENTS
(JAN DR TO ROGERS POND)

ATTY C. KIRWAN P.E.
T.L. King, Engineer #177540

BASKERVILLE-DONOVAN, INC.
ENGINEERING THE SOUTH SINCE 1927
445 W. MAIN ST., PENNSACOLA, FL 32501 (904)363-9961
PROFESSIONAL ENGINEERS - FLORIDA - LICENSE # 1994

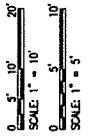
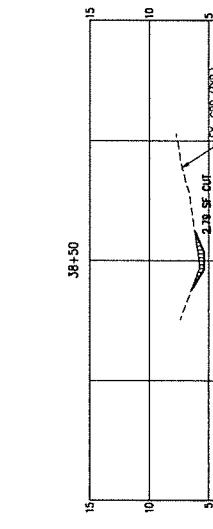
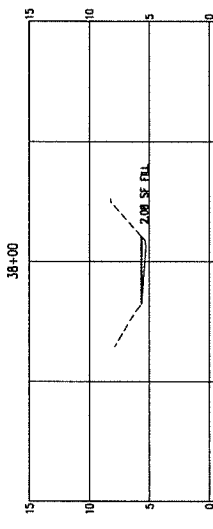
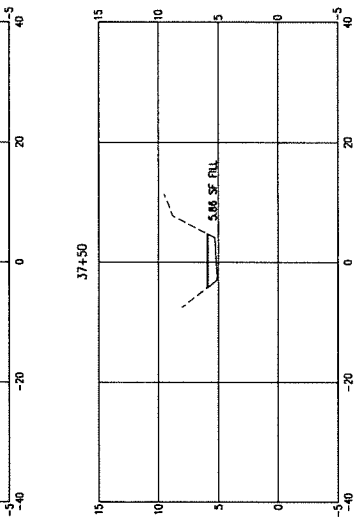
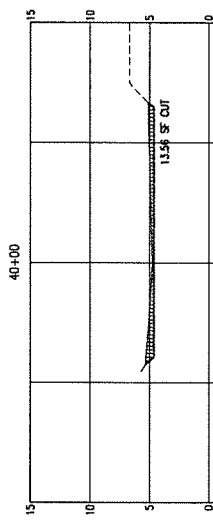
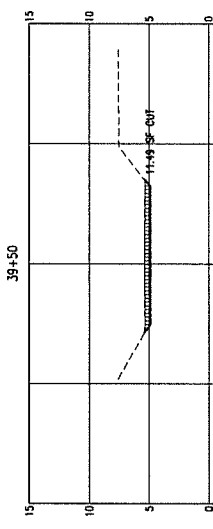
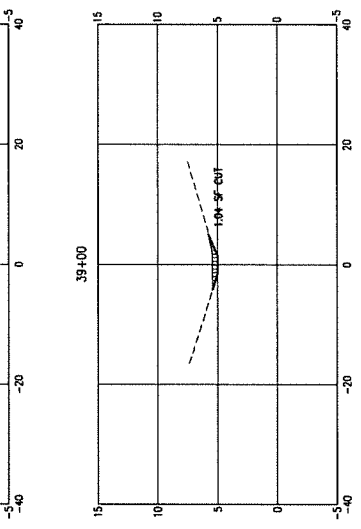
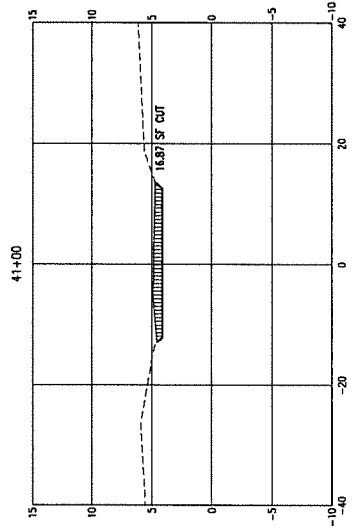
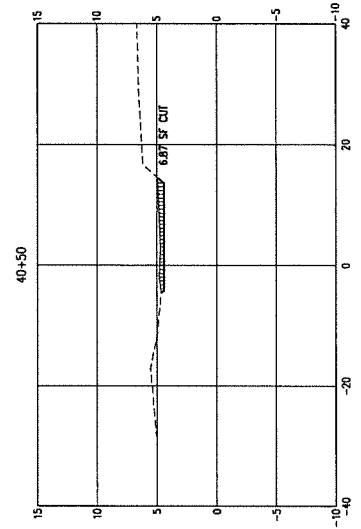

FOOT DETAILS

STRUCTURE BOTTOMS TYPE J AND P

TABLE 1: WALL REINFORCEMENT SCHEDULE (TABLE 1)

SECTION	WALL THICKNESS (IN)	VERTICAL REINFORCEMENT	HORIZONTAL REINFORCEMENT	MINIMUM SCHEDULE
WALL 1	18	#4 @ 12" O.C.	#4 @ 12" O.C.	#4 @ 12" O.C.
WALL 2	24	#5 @ 12" O.C.	#5 @ 12" O.C.	#5 @ 12" O.C.
WALL 3	30	#6 @ 12" O.C.	#6 @ 12" O.C.	#6 @ 12" O.C.
WALL 4	36	#7 @ 12" O.C.	#7 @ 12" O.C.	#7 @ 12" O.C.
WALL 5	42	#8 @ 12" O.C.	#8 @ 12" O.C.	#8 @ 12" O.C.
WALL 6	48	#9 @ 12" O.C.	#9 @ 12" O.C.	#9 @ 12" O.C.
WALL 7	54	#10 @ 12" O.C.	#10 @ 12" O.C.	#10 @ 12" O.C.
WALL 8	60	#11 @ 12" O.C.	#11 @ 12" O.C.	#11 @ 12" O.C.
WALL 9	66	#12 @ 12" O.C.	#12 @ 12" O.C.	#12 @ 12" O.C.
WALL 10	72	#13 @ 12" O.C.	#13 @ 12" O.C.	#13 @ 12" O.C.
WALL 11	78	#14 @ 12" O.C.	#14 @ 12" O.C.	#14 @ 12" O.C.
WALL 12	84	#15 @ 12" O.C.	#15 @ 12" O.C.	#15 @ 12" O.C.
WALL 13	90	#16 @ 12" O.C.	#16 @ 12" O.C.	#16 @ 12" O.C.
WALL 14	96	#17 @ 12" O.C.	#17 @ 12" O.C.	#17 @ 12" O.C.
WALL 15	102	#18 @ 12" O.C.	#18 @ 12" O.C.	#18 @ 12" O.C.
WALL 16	108	#19 @ 12" O.C.	#19 @ 12" O.C.	#19 @ 12" O.C.
WALL 17	114	#20 @ 12" O.C.	#20 @ 12" O.C.	#20 @ 12" O.C.
WALL 18	120	#21 @ 12" O.C.	#21 @ 12" O.C.	#21 @ 12" O.C.
WALL 19	126	#22 @ 12" O.C.	#22 @ 12" O.C.	#22 @ 12" O.C.
WALL 20	132	#23 @ 12" O.C.	#23 @ 12" O.C.	#23 @ 12" O.C.
WALL 21	138	#24 @ 12" O.C.	#24 @ 12" O.C.	#24 @ 12" O.C.
WALL 22	144	#25 @ 12" O.C.	#25 @ 12" O.C.	#25 @ 12" O.C.
WALL 23	150	#26 @ 12" O.C.	#26 @ 12" O.C.	#26 @ 12" O.C.
WALL 24	156	#27 @ 12" O.C.	#27 @ 12" O.C.	#27 @ 12" O.C.
WALL 25	162	#28 @ 12" O.C.	#28 @ 12" O.C.	#28 @ 12" O.C.
WALL 26	168	#29 @ 12" O.C.	#29 @ 12" O.C.	#29 @ 12" O.C.
WALL 27	174	#30 @ 12" O.C.	#30 @ 12" O.C.	#30 @ 12" O.C.
WALL 28	180	#31 @ 12" O.C.	#31 @ 12" O.C.	#31 @ 12" O.C.
WALL 29	186	#32 @ 12" O.C.	#32 @ 12" O.C.	#32 @ 12" O.C.
WALL 30	192	#33 @ 12" O.C.	#33 @ 12" O.C.	#33 @ 12" O.C.
WALL 31	198	#34 @ 12" O.C.	#34 @ 12" O.C.	#34 @ 12" O.C.
WALL 32	204	#35 @ 12" O.C.	#35 @ 12" O.C.	#35 @ 12" O.C.
WALL 33	210	#36 @ 12" O.C.	#36 @ 12" O.C.	#36 @ 12" O.C.
WALL 34	216	#37 @ 12" O.C.	#37 @ 12" O.C.	#37 @ 12" O.C.
WALL 35	222	#38 @ 12" O.C.	#38 @ 12" O.C.	#38 @ 12" O.C.
WALL 36	228	#39 @ 12" O.C.	#39 @ 12" O.C.	#39 @ 12" O.C.
WALL 37	234	#40 @ 12" O.C.	#40 @ 12" O.C.	#40 @ 12" O.C.
WALL 38	240	#41 @ 12" O.C.	#41 @ 12" O.C.	#41 @ 12" O.C.
WALL 39	246	#42 @ 12" O.C.	#42 @ 12" O.C.	#42 @ 12" O.C.
WALL 40	252	#43 @ 12" O.C.	#43 @ 12" O.C.	#43 @ 12" O.C.
WALL 41	258	#44 @ 12" O.C.	#44 @ 12" O.C.	#44 @ 12" O.C.
WALL 42	264	#45 @ 12" O.C.	#45 @ 12" O.C.	#45 @ 12" O.C.
WALL 43	270	#46 @ 12" O.C.	#46 @ 12" O.C.	#46 @ 12" O.C.
WALL 44	276	#47 @ 12" O.C.	#47 @ 12" O.C.	#47 @ 12" O.C.
WALL 45	282	#48 @ 12" O.C.	#48 @ 12" O.C.	#48 @ 12" O.C.
WALL 46	288	#49 @ 12" O.C.	#49 @ 12" O.C.	#49 @ 12" O.C.
WALL 47	294	#50 @ 12" O.C.	#50 @ 12" O.C.	#50 @ 12" O.C.
WALL 48	300	#51 @ 12" O.C.	#51 @ 12" O.C.	#51 @ 12" O.C.
WALL 49	306	#52 @ 12" O.C.	#52 @ 12" O.C.	#52 @ 12" O.C.
WALL 50	312	#53 @ 12" O.C.	#53 @ 12" O.C.	#53 @ 12" O.C.
WALL 51	318	#54 @ 12" O.C.	#54 @ 12" O.C.	#54 @ 12" O.C.
WALL 52	324	#55 @ 12" O.C.	#55 @ 12" O.C.	#55 @ 12" O.C.
WALL 53	330	#56 @ 12" O.C.	#56 @ 12" O.C.	#56 @ 12" O.C.
WALL 54	336	#57 @ 12" O.C.	#57 @ 12" O.C.	#57 @ 12" O.C.
WALL 55	342	#58 @ 12" O.C.	#58 @ 12" O.C.	#58 @ 12" O.C.
WALL 56	348	#59 @ 12" O.C.	#59 @ 12" O.C.	#59 @ 12" O.C.
WALL 57	354	#60 @ 12" O.C.	#60 @ 12" O.C.	#60 @ 12" O.C.
WALL 58	360	#61 @ 12" O.C.	#61 @ 12" O.C.	#61 @ 12" O.C.
WALL 59	366	#62 @ 12" O.C.	#62 @ 12" O.C.	#62 @ 12" O.C.
WALL 60	372	#63 @ 12" O.C.	#63 @ 12" O.C.	#63 @ 12" O.C.
WALL 61	378	#64 @ 12" O.C.	#64 @ 12" O.C.	#64 @ 12" O.C.
WALL 62	384	#65 @ 12" O.C.	#65 @ 12" O.C.	#65 @ 12" O.C.
WALL 63	390	#66 @ 12" O.C.	#66 @ 12" O.C.	#66 @ 12" O.C.
WALL 64	396	#67 @ 12" O.C.	#67 @ 12" O.C.	#67 @ 12" O.C.
WALL 65	402	#68 @ 12" O.C.	#68 @ 12" O.C.	#68 @ 12" O.C.
WALL 66	408	#69 @ 12" O.C.	#69 @ 12" O.C.	#69 @ 12" O.C.
WALL 67	414	#70 @ 12" O.C.	#70 @ 12" O.C.	#70 @ 12" O.C.
WALL 68	420	#71 @ 12" O.C.	#71 @ 12" O.C.	#71 @ 12" O.C.
WALL 69	426	#72 @ 12" O.C.	#72 @ 12" O.C.	#72 @ 12" O.C.
WALL 70	432	#73 @ 12" O.C.	#73 @ 12" O.C.	#73 @ 12" O.C.
WALL 71	438	#74 @ 12" O.C.	#74 @ 12" O.C.	#74 @ 12" O.C.
WALL 72	444	#75 @ 12" O.C.	#75 @ 12" O.C.	#75 @ 12" O.C.
WALL 73	450	#76 @ 12" O.C.	#76 @ 12" O.C.	#76 @ 12" O.C.
WALL 74	456	#77 @ 12" O.C.	#77 @ 12" O.C.	#77 @ 12" O.C.
WALL 75	462	#78 @ 12" O.C.	#78 @ 12" O.C.	#78 @ 12" O.C.
WALL 76	468	#79 @ 12" O.C.	#79 @ 12" O.C.	#79 @ 12" O.C.
WALL 77	474	#80 @ 12" O.C.	#80 @ 12" O.C.	#80 @ 12" O.C.
WALL 78	480	#81 @ 12" O.C.	#81 @ 12" O.C.	#81 @ 12" O.C.
WALL 79	486	#82 @ 12" O.C.	#82 @ 12" O.C.	#82 @ 12" O.C.
WALL 80	492	#83 @ 12" O.C.	#83 @ 12" O.C.	#83 @ 12" O.C.
WALL 81	498	#84 @ 12" O.C.	#84 @ 12" O.C.	#84 @ 12" O.C.
WALL 82	504	#85 @ 12" O.C.	#85 @ 12" O.C.	#85 @ 12" O.C.
WALL 83	510	#86 @ 12" O.C.	#86 @ 12" O.C.	#86 @ 12" O.C.
WALL 84	516	#87 @ 12" O.C.	#87 @ 12" O.C.	#87 @ 12" O.C.
WALL 85	522	#88 @ 12" O.C.	#88 @ 12" O.C.	#88 @ 12" O.C.
WALL 86	528	#89 @ 12" O.C.	#89 @ 12" O.C.	#89 @ 12" O.C.
WALL 87	534	#90 @ 12" O.C.	#90 @ 12" O.C.	#90 @ 12" O.C.
WALL 88	540	#91 @ 12" O.C.	#91 @ 12" O.C.	#91 @ 12" O.C.
WALL 89	546	#92 @ 12" O.C.	#92 @ 12" O.C.	#92 @ 12" O.C.
WALL 90	552	#93 @ 12" O.C.	#93 @ 12" O.C.	#93 @ 12" O.C.
WALL 91	558	#94 @ 12" O.C.	#94 @ 12" O.C.	#94 @ 12" O.C.
WALL 92	564	#95 @ 12" O.C.	#95 @ 12" O.C.	#95 @ 12" O.C.
WALL 93	570	#96 @ 12" O.C.	#96 @ 12" O.C.	#96 @ 12" O.C.
WALL 94	576	#97 @ 12" O.C.	#97 @ 12" O.C.	#97 @ 12" O.C.
WALL 95	582	#98 @ 12" O.C.	#98 @ 12" O.C.	#98 @ 12" O.C.
WALL 96	588	#99 @ 12" O.C.	#99 @ 12" O.C.	#99 @ 12" O.C.
WALL 97	594	#100 @ 12" O.C.	#100 @ 12" O.C.	#100 @ 12" O.C.
WALL 98	600	#101 @ 12" O.C.	#101 @ 12" O.C.	#101 @ 12" O.C.
WALL 99	606	#102 @ 12" O.C.	#102 @ 12" O.C.	#102 @ 12" O.C.
WALL 100	612	#103 @ 12" O.C.	#103 @ 12" O.C.	#103 @ 12" O.C.
WALL 101	618	#104 @ 12" O.C.	#104 @ 12" O.C.	#104 @ 12" O.C.
WALL 102	624	#105 @ 12" O.C.	#105 @ 12" O.C.	#105 @ 12" O.C.
WALL 103	630	#106 @ 12" O.C.	#106 @ 12" O.C.	#106 @ 12" O.C.
WALL 104	636	#107 @ 12" O.C.	#107 @ 12" O.C.	#107 @ 12" O.C.
WALL 105	642	#108 @ 12" O.C.	#108 @ 12" O.C.	#108 @ 12" O.C.
WALL 106	648	#109 @ 12" O.C.	#109 @ 12" O.C.	#109 @ 12" O.C.
WALL 107	654	#110 @ 12" O.C.	#110 @ 12" O.C.	#110 @ 12" O.C.
WALL 108	660	#111 @ 12" O.C.	#111 @ 12" O.C.	#111 @ 12" O.C.
WALL 109	666	#112 @ 12" O.C.	#112 @ 12" O.C.	#112 @ 12" O.C.
WALL 110	672	#113 @ 12" O.C.	#113 @ 12" O.C.	#113 @ 12" O.C.
WALL 111	678	#114 @ 12" O.C.	#114 @ 12" O.C.	#114 @ 12" O.C.
WALL 112	684	#115 @ 12" O.C.	#115 @ 12" O.C.	#115 @ 12" O.C.
WALL 113	690	#116 @ 12" O.C.	#116 @ 12" O.C.	#116 @ 12" O.C.
WALL 114	696	#117 @ 12" O.C.	#117 @ 12" O.C.	#117 @ 12" O.C.
WALL 115	702	#118 @ 12" O.C.	#118 @ 12" O.C.	#118 @ 12" O.C.
WALL 116	708	#119 @ 12" O.C.	#119 @ 12" O.C.	#119 @ 12" O.C.
WALL 117	714	#120 @ 12" O.C.	#120 @ 12" O.C.	#120 @ 12" O.C.
WALL 118	720	#121 @ 12" O.C.	#121 @ 12" O.C.	#121 @ 12" O.C.
WALL 119	726	#122 @ 12" O.C.	#122 @ 12" O.C.	#122 @ 12" O.C.
WALL 120	732	#123 @ 12" O.C.	#123 @ 12" O.C.	#123 @ 12" O.C.
WALL 121	738	#124 @ 12" O.C.	#124 @ 12" O.C.	#124 @ 12" O.C.
WALL 122	744	#125 @ 12" O.C.	#125 @ 12" O.C.	#125 @ 12" O.C.
WALL 123	750	#126 @ 12" O.C.	#126 @ 12" O.C.	#126 @ 12" O.C.
WALL 124	756	#127 @ 12" O.C.	#127 @ 12" O.C.	#127 @ 12" O.C.
WALL 125	762	#128 @ 12" O.C.	#128 @ 12" O.C.	#128 @ 12" O.C.
WALL 126	768	#129 @ 12" O.C.	#129 @ 12" O.C.	#129 @ 12" O.C.
WALL 127	774	#130 @ 12" O.C.	#130 @ 12" O.C.	#130 @ 12" O.C.
WALL 128	780	#131 @ 12" O.C.	#131 @ 12" O.C.	#131 @ 12" O.C.
WALL 129	786	#132 @ 12" O.C.	#132 @ 12" O.C.	#132 @ 12" O.C.
WALL 130	792	#133 @ 12" O.C.	#133 @ 12" O.C.	#133 @ 12" O.C.
WALL 131	798	#134 @ 12" O.C.	#134 @ 12" O.C.	#134 @ 12" O.C.
WALL 132	804	#135 @ 12" O.C.	#135 @ 12" O.C.	#135 @ 12" O.C.
WALL 133	810	#136 @ 12" O.C.	#136 @ 12" O.C.	#136 @ 12" O.C.
WALL 134	816	#137 @ 12" O.C.	#137 @ 12" O.C.	#137 @ 12" O.C.
WALL 135	822	#138 @ 12" O.C.	#138 @ 12" O.C.	#138 @ 12" O.C.
WALL 136	828	#139 @ 12" O.C.	#139 @ 12" O.C.	#139 @ 12" O.C.
WALL 137	834	#140 @ 12" O.C.	#140 @ 12" O.C.	#140 @ 12" O.C.
WALL 138	840	#141 @ 12" O.C.	#141 @ 12" O.C.	#141 @ 12" O.C.
WALL 139	846	#142 @ 12" O.C.	#142 @ 12" O.C.	#142 @ 12" O.C.
WALL 140	852	#143 @ 12" O.C.	#143 @ 12" O.C.	#143 @ 12" O.C.
WALL 141	858	#144 @ 12" O.C.	#144 @ 12" O.C.	#144 @ 12" O.C.
WALL 142	864	#145 @ 12" O.C.	#145 @ 12" O.C.	#145 @ 12" O.C.
WALL 143	870	#146 @ 12" O.C.	#146 @ 12" O.C.	#146 @ 12" O.C.
WALL 144	876	#147 @ 12" O.C.	#147 @ 12" O.C.	#147 @ 12" O.C.
WALL 145	882	#148 @ 12" O.C.	#148 @ 12" O.C.	#148 @ 12" O.C.
WALL 146	888	#149 @ 12" O.C.	#149 @ 12" O.C.	#149 @ 12" O.C.
WALL 147	894	#150 @ 12" O.C.	#150 @ 12" O.C.	#150 @ 12" O.C.
WALL 148	900	#151 @ 12" O.C.	#151 @ 12" O.C.	#151 @ 12" O.C.
WALL 149	906	#152 @ 12" O.C.	#152 @ 12" O.C.	#152 @ 12" O.C.
WALL 150	912	#153 @ 12" O.C.	#153 @ 12" O.C.	#153 @ 12" O.C.
WALL 151	918	#154 @ 12" O.C.	#154 @ 12" O.C.	#154 @ 12" O.C.
WALL 152	924	#155 @ 12" O.C.	#155 @ 12" O.C.	#155 @ 12" O.C.
WALL 153	930	#156 @ 12" O.C.	#156 @ 12" O.C.	#156 @ 12" O.C.
WALL 154	936	#157 @ 12" O.C.	#157 @ 12" O.C.	#157 @ 12" O.C.
WALL 155	942	#158 @ 12" O.C.	#158 @ 12" O.C.	#158 @ 12" O.C.
WALL 156	948	#159 @ 12" O.C.	#159 @ 12" O.C.	#159 @ 12" O.C.
WALL 157	954	#160 @ 12" O.C.	#160 @ 12" O.C.	#160 @ 12" O.C.
WALL 158	960	#161 @ 12" O.C.	#161 @ 12" O.C.	#161 @ 12" O.C.
WALL 159	966	#162 @ 12" O.C.	#162 @ 12" O.C.	#162 @ 12" O.C.
WALL 160	972	#163 @ 12" O.C.	#163 @ 12" O.C.	#163 @ 12" O.C.
WALL 161	978	#164 @ 12" O.C.	#164 @ 12" O.C.	#164 @ 12" O.C.
WALL 162	984	#165 @ 12" O.C.	#165 @ 12" O.C.	#165 @ 12" O.C.
WALL 163	990	#166 @ 12" O.C.	#166 @ 12" O.C.	#166 @ 12" O.C.
WALL 164	996	#167 @ 12" O.C.	#167 @ 12" O.C.	#

CHERRY STREET DRAINAGE IMPROVEMENTS (JAN DR TO ROGERS POND)
 BASKERVILLE-DONOVAN, INC. ENGINEERING THE SOUTH SINCE 1927
 4849 IVY MAINT. PENNSYLVANIA, PA 15022
 PROJECT: CHERRY STREET DRAINAGE IMPROVEMENTS, TOWNSHIP: BASKERVILLE

SECTION 1
 FT 2020-21 STANDARD PLANS
 CROSS DRAIN INTERIOR END SECTION

GENERAL NOTES:

1. All concrete shall be cast in place and cured properly. The concrete shall be finished to a smooth surface.
2. All concrete shall be cast in place and cured properly. The concrete shall be finished to a smooth surface.
3. All concrete shall be cast in place and cured properly. The concrete shall be finished to a smooth surface.
4. All concrete shall be cast in place and cured properly. The concrete shall be finished to a smooth surface.
5. All concrete shall be cast in place and cured properly. The concrete shall be finished to a smooth surface.
6. All concrete shall be cast in place and cured properly. The concrete shall be finished to a smooth surface.
7. All concrete shall be cast in place and cured properly. The concrete shall be finished to a smooth surface.
8. All concrete shall be cast in place and cured properly. The concrete shall be finished to a smooth surface.
9. All concrete shall be cast in place and cured properly. The concrete shall be finished to a smooth surface.
10. All concrete shall be cast in place and cured properly. The concrete shall be finished to a smooth surface.

TABLE OF CONCRETE

ITEM	DESCRIPTION	QUANTITY	UNIT
1	CONCRETE	1.00	CU YD
2	REINFORCING BARS	1.00	TON
3	FORMWORK	1.00	SQ YD
4	PIPE	1.00	LINEAL FT
5	GRASS	1.00	SQ YD
6	PAVING	1.00	SQ YD
7	GRASS	1.00	SQ YD
8	PAVING	1.00	SQ YD
9	GRASS	1.00	SQ YD
10	PAVING	1.00	SQ YD

SECTION 2
 FT 2020-21 STANDARD PLANS
 CROSS DRAIN INTERIOR END SECTION

TABLE F
 SINGLE AND MULTIPLE CONCRETE PIPE DIMENSIONS AND QUANTITIES

NO.	DESCRIPTION	QUANTITY	UNIT
1	CONCRETE PIPE	1.00	LINEAL FT
2	CONCRETE PIPE	1.00	LINEAL FT
3	CONCRETE PIPE	1.00	LINEAL FT
4	CONCRETE PIPE	1.00	LINEAL FT
5	CONCRETE PIPE	1.00	LINEAL FT
6	CONCRETE PIPE	1.00	LINEAL FT
7	CONCRETE PIPE	1.00	LINEAL FT
8	CONCRETE PIPE	1.00	LINEAL FT
9	CONCRETE PIPE	1.00	LINEAL FT
10	CONCRETE PIPE	1.00	LINEAL FT

SECTION 3
 FT 2020-21 STANDARD PLANS
 DITCH BOTTOM INLET TYPES C, D, E AND H

GENERAL NOTES:

1. All concrete shall be cast in place and cured properly. The concrete shall be finished to a smooth surface.
2. All concrete shall be cast in place and cured properly. The concrete shall be finished to a smooth surface.
3. All concrete shall be cast in place and cured properly. The concrete shall be finished to a smooth surface.
4. All concrete shall be cast in place and cured properly. The concrete shall be finished to a smooth surface.
5. All concrete shall be cast in place and cured properly. The concrete shall be finished to a smooth surface.
6. All concrete shall be cast in place and cured properly. The concrete shall be finished to a smooth surface.
7. All concrete shall be cast in place and cured properly. The concrete shall be finished to a smooth surface.
8. All concrete shall be cast in place and cured properly. The concrete shall be finished to a smooth surface.
9. All concrete shall be cast in place and cured properly. The concrete shall be finished to a smooth surface.
10. All concrete shall be cast in place and cured properly. The concrete shall be finished to a smooth surface.

TABLE OF CONCRETE

ITEM	DESCRIPTION	QUANTITY	UNIT
1	CONCRETE	1.00	CU YD
2	REINFORCING BARS	1.00	TON
3	FORMWORK	1.00	SQ YD
4	PIPE	1.00	LINEAL FT
5	GRASS	1.00	SQ YD
6	PAVING	1.00	SQ YD
7	GRASS	1.00	SQ YD
8	PAVING	1.00	SQ YD
9	GRASS	1.00	SQ YD
10	PAVING	1.00	SQ YD

SECTION 4
 FT 2020-21 STANDARD PLANS
 SINGLE AND MULTIPLE CONCRETE PIPE

GENERAL NOTES:

1. All concrete shall be cast in place and cured properly. The concrete shall be finished to a smooth surface.
2. All concrete shall be cast in place and cured properly. The concrete shall be finished to a smooth surface.
3. All concrete shall be cast in place and cured properly. The concrete shall be finished to a smooth surface.
4. All concrete shall be cast in place and cured properly. The concrete shall be finished to a smooth surface.
5. All concrete shall be cast in place and cured properly. The concrete shall be finished to a smooth surface.
6. All concrete shall be cast in place and cured properly. The concrete shall be finished to a smooth surface.
7. All concrete shall be cast in place and cured properly. The concrete shall be finished to a smooth surface.
8. All concrete shall be cast in place and cured properly. The concrete shall be finished to a smooth surface.
9. All concrete shall be cast in place and cured properly. The concrete shall be finished to a smooth surface.
10. All concrete shall be cast in place and cured properly. The concrete shall be finished to a smooth surface.

TABLE OF CONCRETE

ITEM	DESCRIPTION	QUANTITY	UNIT
1	CONCRETE	1.00	CU YD
2	REINFORCING BARS	1.00	TON
3	FORMWORK	1.00	SQ YD
4	PIPE	1.00	LINEAL FT
5	GRASS	1.00	SQ YD
6	PAVING	1.00	SQ YD
7	GRASS	1.00	SQ YD
8	PAVING	1.00	SQ YD
9	GRASS	1.00	SQ YD
10	PAVING	1.00	SQ YD

