

City of
SHELBYVILLE
Tennessee

DATE: October 11, 2021

NOTICE TO BIDDERS

Notice is hereby given that the CITY OF SHELBYVILLE, TENNESSEE is advertising for sealed bids on:

DOG PARK FENCE INSTALLATION AT H. V. GRIFFIN PARK

Bids will be accepted by the City of Shelbyville Purchasing Office, 201 N. Spring Street, Shelbyville, TN 37160 or may be mailed to P.O. Box 185, Shelbyville, TN 37162 **until 2:00 P.M. on Thursday, October 28, 2021** Any bids received after the scheduled closing time for receipt of bids will be returned to the bidder unopened.

The bids shall be opened and read aloud during a public meeting of the City Council appointed BID COMMITTEE on Thursday, October 28, 2021 at 2:00 P.M. at Shelbyville City Hall, Conference Room, 201 N. Spring Street, Shelbyville, TN. Award of the bid is scheduled to be on the agenda at the next City Council business meeting at the Shelbyville Recreation Center. (November 9, 2021)

GENERAL INFORMATION

It will be the sole responsibility of the Bidder to deliver personally or by mail the bid or bids to the City of Shelbyville Purchasing Office, 201 N. Spring Street, Shelbyville, TN 37160 on or before the closing hour and date announced for the receipt of the bids. **The envelope must be sealed and marked on the outside “Sealed Bid for Dog Park Fence Installation at H. V. Griffin Park”.**

The City is exempt from taxes imposed by State and/or Federal Government. Exemption certificate, if required, will be furnished by the successful bidder and will be completed by the City.

Each variance to these specifications must be specifically stated by the bidder in the bidding proposal. The City Council reserves the right to reject any or all proposals, to waive informalities and to accept all or any part of any proposal as described therein, as they deem necessary to be in the best interest of the City.

City of Shelbyville

Bidders guarantee that the prices quoted in the bid will remain firm from the date of the bid opening until the completion of delivery.

All proposals shall be made on forms furnished by the CITY. Supporting information shall be on the bidder's stationery.

All proposals must indicate the firm's name and address and be signed in ink by an officer or employee having authority to bind the company or firm.

The intent of these specifications is to insure delivery of a new complete unit for operation. Omission of any essential detail from these specifications does not relieve the supplier from furnishing such unit. All bids must be on new models. This provision excludes surplus, used or demonstrators.

The bidder, by executing a contract or bid proposal on the terms of the invitation to bid, warrants the product that is supplied to be buyer shall remain fully in accord with the specifications and to be of the highest quality. In the event the product, as supplied to the buyer, is found to be defective or does not conform to the specifications, the buyer reserves the right to cancel the order upon written notice to the supplier and return such product to the supplier at the supplier's expense.

Payment will commence or be made in full after delivery and acceptance of product. All documents, invoice, title and exemption certificate shall be presented to the City of Shelbyville Purchasing Office.

All Bidders must comply with A.D.A. guidelines if required.

All Bidders must be in compliance with Title VI, Civil Rights Act of 1964, which specifies that: No person in the United States shall, on the grounds of race, color or national origin, be excluded from participation in, be denied the benefits of, or be subjected to discrimination under a program or activity receiving federal financial assistance from the Department of Transportation or the U.S. Department of Justice.

The City of Shelbyville is subject to the Open Records Act, TCA 10-7-501, et. Seq. Bidders are advised that all documents submitted on behalf of this invitation to bid shall be open to the public for viewing and inspection.

The City of Shelbyville will fulfill Public Record Requests in compliance with Tennessee Open Records Act.

Failure on the part of the bidder to comply with all instructions herein may result in bid rejection.

BID FORM

TO: City of Shelbyville
201 N. Spring Street
Shelbyville, TN 37160

Date: _____

IN ACCORDANCE WITH YOUR INVITATION TO BID ON:

DOG PARK FENCE INSTALLATION AT H. V. GRIFFIN PARK

WE HEREBY SUBMIT THE FOLLOWING BID:

MINIMUM SPECIFICATIONS

MEETS

EXCEEDS

DOESN'T MEET

Dog Park fence installation
at H. V. Griffin Park,
220 Tulip Tree Road,
Shelbyville, TN as
specifications and diagram
both attached.

**Turnkey project to include all
necessary parts and labor.**

**SITE VISIT HIGHLY
RECOMMENDED
H. V. Griffin Park
220 Tulip Tree Road
Shelbyville, TN 37160**

**Please schedule site visit with
Mike Alsup, Parks and
Recreation Director
931/684-9780**

MINIMUM SPECIFICATIONS

MEETS

EXCEEDS

DOESN'T MEET

To be included with submission:

- warranty information
- estimated delivery/installation date
- any variations to the attached specifications

Any reference to name brands in this Invitation for Bids or the attached specifications is for example only. An approved equal will be accepted. The purchaser reserves the right to determine whether a substitute offer is equivalent to and meets the standard of quality indicated by the brand name referenced, and the purchaser may require a bidder offering a substitute to supply additional descriptive material.

- Vendors are welcome to submit more than one bid if options are available.
- A current business license must be furnished upon request.
- Any questions may be directed to Parks & Recreation Director, Mike Alsup, at 931-684-9780 or Lori Saddler, Purchasing / IT Director, at 931-684-2691.

We hereby submit the following price(s) for your consideration:

\$ _____ total for Dog Park fence installation
turnkey project as described in specifications

Installation date _____

Signed: _____

Printed name: _____

Title: _____

Date: _____

Email: _____

Phone #: _____

Company Name and Address:

Bid quote good for _____ days.

SHELBYVILLE PARKS AND RECREATION DEPARTMENT
H.V. GRIFFIN PARK – DOG PARK
FENCE SPECIFICATIONS
September 7, 2021

PART 1 GENERAL

1.01 SECTION INCLUDES

- A. Fence framework, fabric, and accessories.
- B. Excavation for post bases; concrete foundation for posts.
- C. Manual gates and related hardware.

1.02 RELATED REQUIREMENTS

- A. Section 03 3000 - Cast-in-Place Concrete: Concrete anchorage for posts.

1.03 REFERENCE STANDARDS

- A. ASTM A123/A123M - Standard Specification for Zinc (Hot-Dip Galvanized) Coatings on Iron and Steel Products; 2017.
- B. ASTM A153/A153M - Standard Specification for Zinc Coating (Hot-Dip) on Iron and Steel Hardware; 2016a.
- C. ASTM A392 - Standard Specification for Zinc-Coated Steel Chain-Link Fence Fabric; 2011a (Reapproved 2017).
- D. ASTM A653/A653M - Standard Specification for Steel Sheet, Zinc-Coated (Galvanized) or Zinc-Iron Alloy-Coated (Galvannealed) by the Hot-Dip Process; 2018.
- E. ASTM A1011/A1011M - Standard Specification for Steel, Sheet and Strip, Hot-Rolled, Carbon, Structural, High-Strength Low-Alloy, High-Strength Low-Alloy with Improved Formability, and Ultra-High Strength; 2018a.
- F. ASTM F567 - Standard Practice for Installation of Chain-Link Fence; 2014a.
- G. ASTM F1083 - Standard Specification for Pipe, Steel, Hot-Dipped Zinc-Coated (Galvanized) Welded, for Fence Structures; 2016.

1.04 SUBMITTALS

- A. Product Data: Provide data on fabric, posts, accessories, fittings and hardware.
- B. Manufacturer's Installation Instructions: Indicate installation requirements, post foundation anchor bolt templates.
- C. Automatic Gate Closers

1.05 QUALITY ASSURANCE

- A. Manufacturer Qualifications: Company specializing in manufacturing products specified in this section, with not less than three years of documented experience.

PART 2 PRODUCTS

201 MATERIALS

- A. Posts, Rails, and Frames: ASTM F1083 Schedule 40 hot-dipped galvanized steel pipe, welded construction, minimum yield strength of 30 ksi.
- B. Wire Fabric: ASTM A392 zinc coated steel chain link fabric.
- C. Concrete: Type specified in Section 03 3000.

202 COMPONENTS

- A. Line Posts: 2.38 inch diameter.
- B. Corner and Terminal Posts: 4.0 inch.
- C. Gate Posts: 4.5 inch diameter.
- D. Top and Brace Rail: 1.66 inch diameter, plain end, sleeve coupled.
- E. Gate Frame: 1.66 inch diameter for welded fabrication.
- F. Fabric: 2 inch diamond mesh interwoven wire, 9 gage, 0.1144 inch thick, top selvage knuckle end closed, bottom selvage twisted tight.
- G. Tension Wire: 6 gage, 0.1620 inch thick steel, single strand.
- H. Tie Wire: Aluminum alloy steel wire.
- I. Automatic Gate Closers on the two (2) Entry Gates, Leash Unleash area

203 ACCESSORIES

- A. Caps: Cast steel galvanized; sized to post diameter, set screw retainer.
- B. Fittings: Sleeves, bands, clips, rail ends, tension bars, fasteners and fittings; steel.
- C. Hardware for Single Swinging Gates: 180 degree hinges, 2 for gates up to 60 inches high, 3 for taller gates; fork latch with gravity drop and padlock hasp; keeper to hold gate in fully open position.
- D. Hardware for Double Swinging Gates: 180 degree hinges, 2 for gates up to 60 inches high, 3 for taller gates; drop bolt on inactive leaf engaging socket stop set in concrete, active leaf latched to inactive leaf preventing raising of drop bolt, padlock hasp.
- E. Automatic gate closer

204 FINISHES

- A. Components (Other than Fabric): Galvanized in accordance with ASTM A123/A123M, at 1.7 oz/sq ft.
- B. Hardware: Hot-dip galvanized to weight required by ASTM A153/A153M.
- C. Accessories: Same finish as framing.

PART 3 EXECUTION

301 INSTALLATION

- A. Install framework, fabric, accessories and gates in accordance with ASTM F567.
- B. Place fabric on outside of posts and rails.
- C. Set intermediate posts plumb, in concrete footings with top of footing 2 inches above finish grade. Slope top of concrete for water runoff.
- D. Line Post Footing Depth Below Finish Grade: ASTM F567.
- E. Corner, Gate and Terminal Post Footing Depth Below Finish Grade: ASTM F567.
- F. Brace each gate and corner post to adjacent line post with horizontal center brace rail and diagonal truss rods. Install brace rail one bay from end and gate posts.
- G. Provide top rail through line post tops and splice with 6 inch long railsleeves.
- H. Install center brace rail on corner gate leaves.
- I. Do not stretch fabric until concrete foundation has cured 28 days.
- J. Stretch fabric between terminal posts or at intervals of 100 feet maximum, whichever is less.
- K. Position bottom of fabric 2 inches above finished grade.
- L. Fasten fabric to top rail, line posts, braces, and bottom tension wire with tie wire at maximum 15 inches on centers.
- M. Attach fabric to end, corner, and gate posts with tension bars and tension bar clips.

- N. Install bottom tension wire stretched taut between terminal posts.
- O. Install gate with fabric to match fence. Install hardware.
- P. Provide concrete center drop to footing depth and drop rod retainers at center of double gate openings.

3.02 TOLERANCES

- A. Maximum Variation From Plumb: 1/4 inch.
- B. Maximum Offset From True Position: 1 inch.

Shelbyville Parks
 H. V. Griffin Park Dog Park Fence

1" = 50'

N →

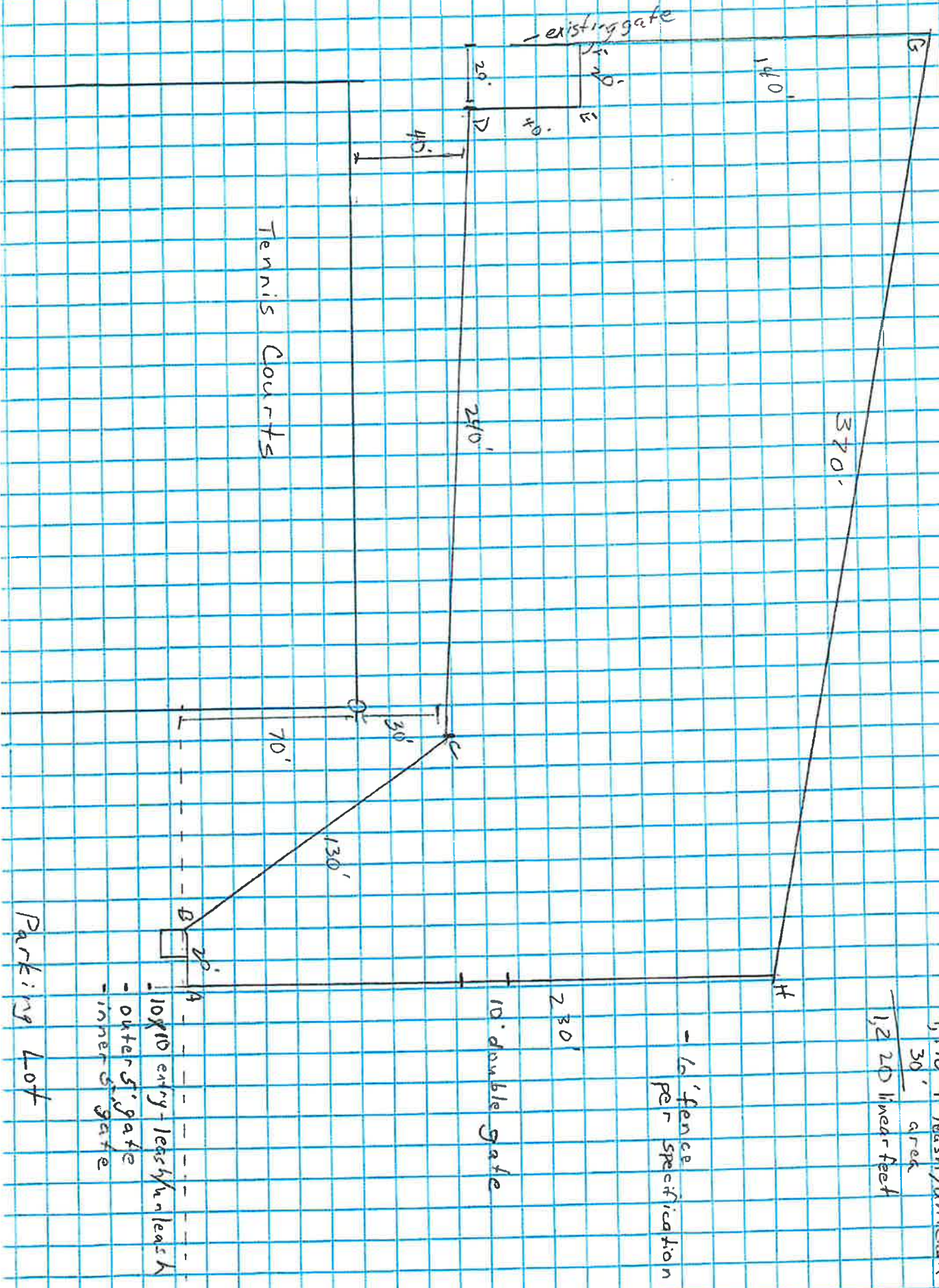

1,190' + leash/lin/leash
 30' area
 1,220 linear feet

- 1/2' fence per specification

10' double gate

10' x 10' entry-leash/lin/leash
 - outer 5' gate
 - inner 5' gate

Parking Lot

Tennis Courts