

Drawing Date:
October 6, 2020

Revisions
Comments
--/--/----

City of Lebanon
Approval
--/--/2020

Comments
--/--/----

THE CONTRACTOR/DEVELOPER SHALL CHECK ALL EXISTING CONDITIONS AND PROPOSED INFORMATION AS SHOWN ON THE APPROVED CONSTRUCTION DRAWINGS (I.E. INVERTS, UTILITY ROUTINGS, UTILITY CROSSINGS, DIMENSIONS, GRADING, AND DRAINAGE) PRIOR TO COMMENCEMENT OF ANY WORK

THE CITY OF LEBANON IS NOT RESPONSIBLE FOR ERRORS OR OMISSIONS CONTAINED WITHIN THE APPROVED CONSTRUCTION PLANS

CONTRACTOR TO COORDINATE WITH MTEMC AND THE CITY OF LEBANON FOR ELECTRICAL LAYOUT PLAN

ANY MODIFICATIONS TO THE APPROVED PLAN SHALL BE APPROVED BY THE CITY OF LEBANON AIRPORT COMMISSION AND THE CITY OF LEBANON ENGINEERING DEPARTMENT.

Development Summary

Property Information
Map 81 Parcel 004.01 000 2020
780 Franklin Rd
Lebanon, TN 37087
Zoning: CS, RD, CG, R2, RR
Airport Zoning Overlay
Total Site Area - 12.39 ac
Area of Disturbance - 11.42 ac

Owner
City of Lebanon
200 N Castle Heights Ave
Lebanon, TN 37087
Phone: (615) 443-2839

Developer
Steven DiLeo
442 Main St
Gallatin, TN 37066
Phone: (615) 804-4570
Email: sdielo@bellsouth.net

Engineer
Brilliant Design Build, Inc.
Jacob T. Blystone, PE
6201 Charlotte Pike
Nashville, TN 37209
Phone: (615) 393-8585
Email: jacob@brilliantdesignbuild.com

Floodnote
This Property does Not Lie Within a Flood Hazard Area as Depicted on the Current Flood Insurance Rate Maps (FIRM) Number 47037C0382H Dated 4/5/2017.

Benchmark
BENCHMARK 1

Legend

- Construction Entrance
- New Permanent Fence
- SE Silt Fence
- TP Tree Protection Fence
- HV High Visibility Fence
- Existing Topography Contour

STABILIZATION OF DISTURBED SOILS

a. Soil Stabilization will be accomplished by the use of seeding in the appropriate areas, as specified. Temporary seeding will be required in those areas that consist of disturbed soils that have remained dormant for periods of more than 15 days.

b. As a general rule, permanent seeding will be performed within 14 days after the final grade on an area has been established. If disturbed areas on-site are to remain dormant for periods greater than 15 days in duration, the contractor will apply permanent soil stabilization. An allowance in the time schedule will be made for snow cover during periods of construction downtime. Seeding will be performed by hydro-seeding, by hand, or by a mechanical broadcasting method.

c. The areas to be seeded will be uniform and will conform to the finished grade and cross section shown in the plans for this project or as otherwise designated. Owner's representative will perform minor shaping of uneven and rough areas outside the graded section as directed in order to provide for more effective erosion control and for ease of subsequent earth moving operations.

d. The seed bed (including cut slopes) will be loosened to a minimum depth of 3 inches before agricultural lime, fertilizer or seed is applied. The areas to be seeded will be cleared of stones larger than 2.5 inches in dimension, roots, and other debris.

Stabilization Note:
All slopes 3:1 or greater to be stabilized with type II erosion control matting or equivalent within 7 days of disturbance.

Tennessee Construction General Permit Notice of Coverage (NOC) Certification: The project associated with these submitted plans is covered under Tennessee Construction General Permit TNR244458.

This site discharges into waters identified by TDEC as:
YES NO
X Impaired for siltation
X Impaired for habitat alteration
X Exception

Signature: _____ Date: 10/20/20
Circle one: Developer/Project Engineer/Other:

Please attach a copy of the Notice of Coverage under the Construction General Permit.
Note: A project will not be scheduled for a Pre-Construction Meeting until the State Construction General Permit NOC letter is submitted.

SERVICE ROAD TO CONNECT TO EXISTING CASTLE HEIGHTS ENTRANCE ROAD. SERVICE ROAD TO BE CONSTRUCTED TO EACH PHASE LINE

Civil Site Design for
LEBANON AIRPORT/
Map 081 Parcel 004.01 000 2020
Lebanon, Wilson County, Tennessee

Final
EPSC

Brilliant Design Build, Inc.
600 Charlotte Pike
Nashville, TN 37206
(615) 393-8585

BDB Project #20914
LEBANON AIRPORT
C1.3

APPROVED AS NOTED
richard.baldwin
CITY OF LEBANON ENG. DEPT.
DATE: 02/25/2021



PERMITS:
Tracking #
SWGR #
YY-SL-####
YY-WL-####

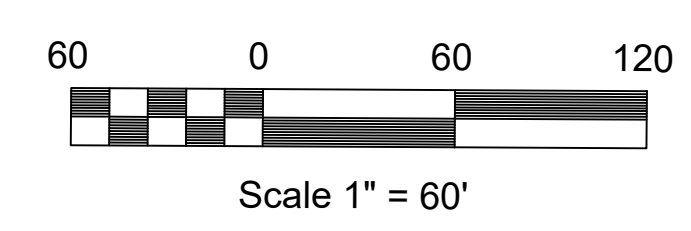

**ROW F T-HANGARS
OPTION 1**

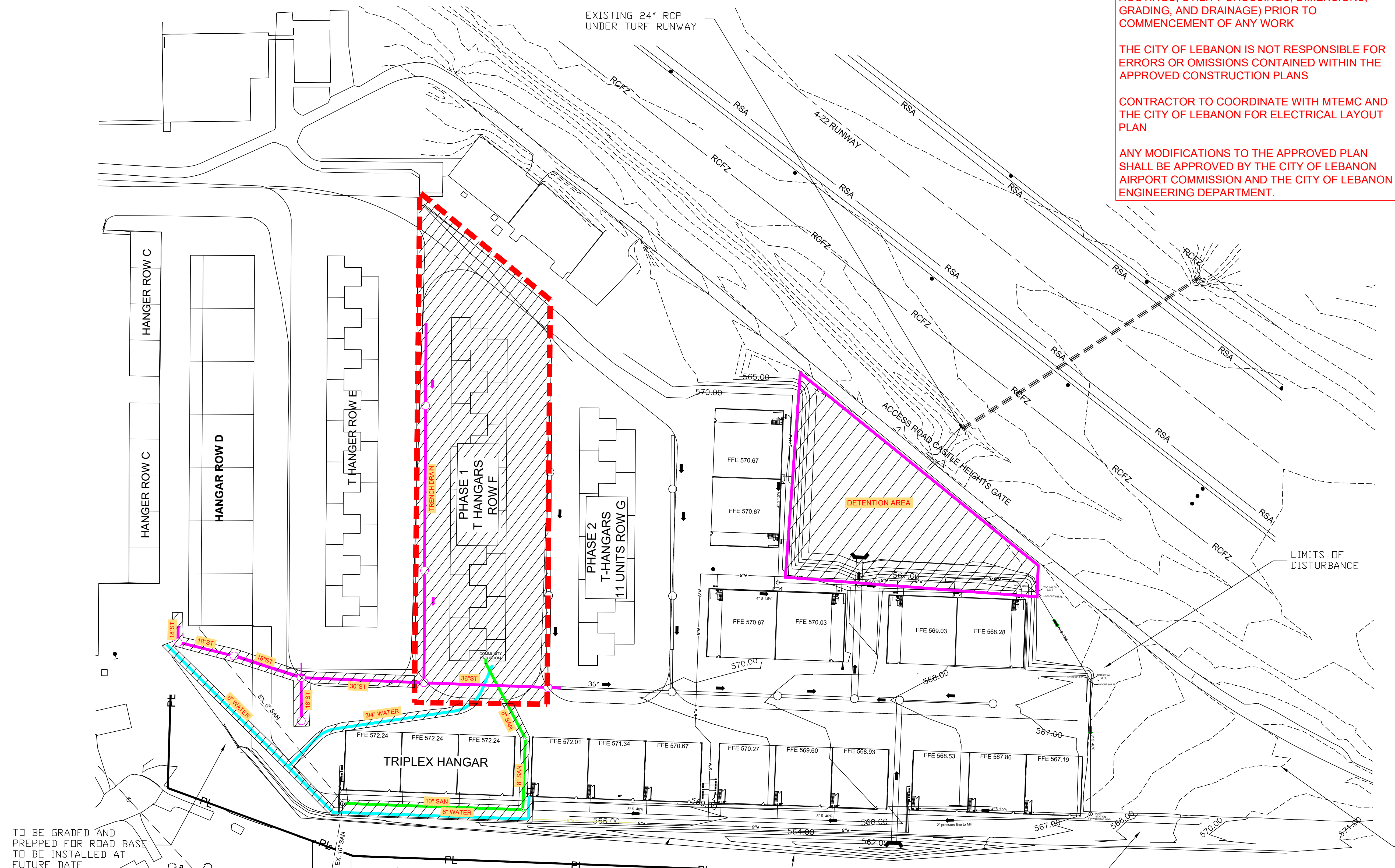

TO BE GRADED AND PREPPED FOR ROAD BASE TO BE INSTALLED AT FUTURE DATE

Existing sewer easements on plat recorded March 2 1973

EXISTING LIFT STATION

NEW FENCE TO BE 6' HIGH WITH 18"H BARBWIRE

NEW ROAD (TYP.)