

CITY/COUNTY	PROJECT NUMBER	SHEET NO.	TOTAL SHEETS
CHEROKEE COUNTY	152-14-102	1	4

MATCH LINE 104- SEE SHEET: #

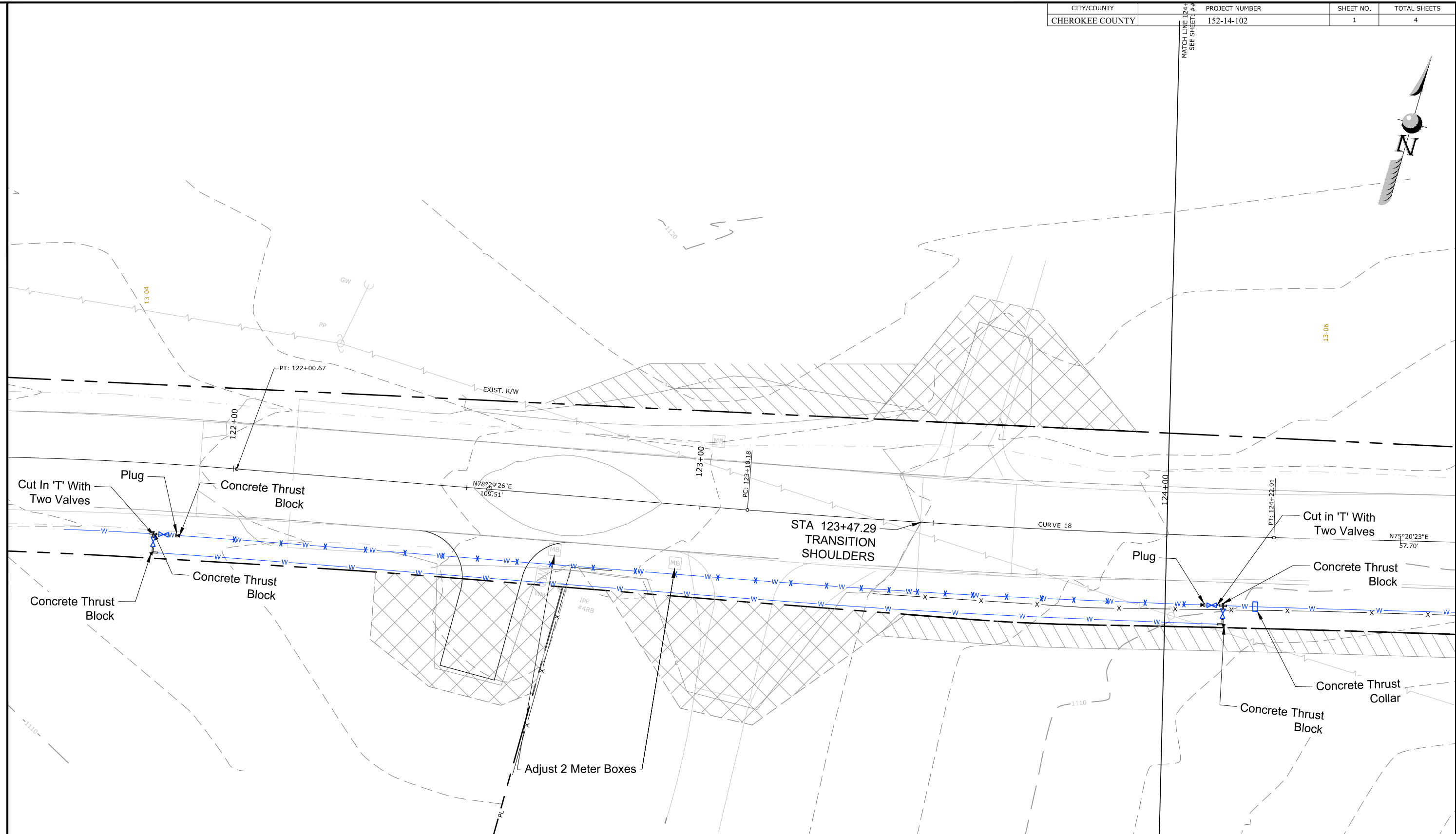
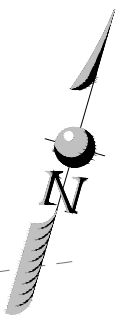

DRAWING NAME: I:\CUSTOMERS_PROJECTS\152 Cherokee County\152-14-102 Brick Mill Road\Eng\Construction\Exhibits\152-14-102-C-PROJ\WaterLine07-18-17.dwg
 DATE: 06/26/2017 11:41 AM
 PRINTED BY: HEVA GURK

PROPERTY AND EX. R/W LINE		STORM LINE	
REQUIRED R/W LINE		TELEPHONE LINE	
CONSTRUCTION LIMITS		OH POWER LINE	
PERMANENT EASEMENT FOR MAINTENANCE		UG POWER LINE	
TEMPORARY EASEMENT FOR CONSTRUCTION		WATER LINE	
EASEMENT FOR CONSTRUCTION OF DRIVEWAYS		FIBER OPTIC LINE	
PERMANENT DRAINAGE EASEMENT		GAS LINE	
		SANITARY SEWER LINE	
		LIGHTING CONDUIT	
		RETAINING WALL	
		LIMIT OF DISTURBANCE	



SEI
 SOUTHEASTERN ENGINEERING, INC.
 2470 Sandy Plains Road Marietta, Georgia 30066
 tel: 770-321-3936 fax: 770-321-3935
 www.seengineering.com

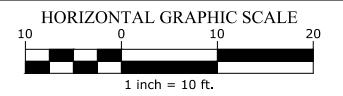

REVISION DATES	
12-18-15	

CHEROKEE COUNTY GOVERNMENT

OFFICE: _____ DATE: 06/26/17

WATERLINE RELOCATION PLAN

ROADWAY IMPROVEMENTS
 BRICK MILL ROAD

SHEET NO.
 44-01

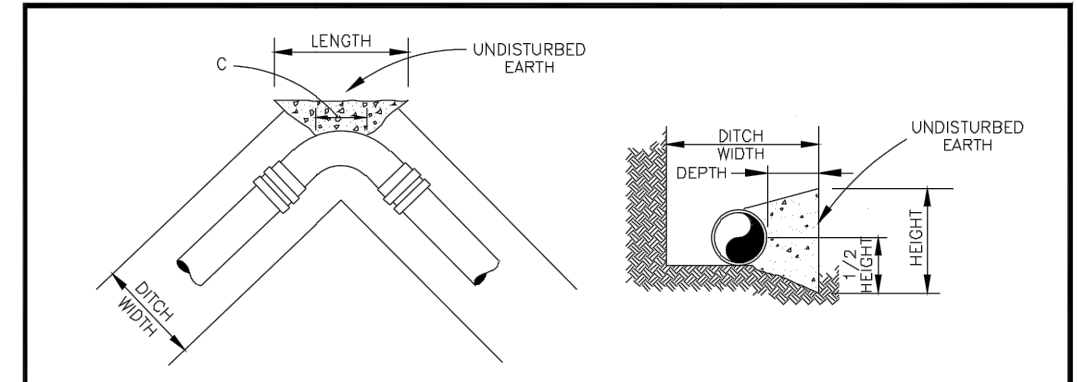

TABLE FOR CONCRETE BLOCKING
(250 PSI TEST PRESSURE)

FITTING	SIZE	MINIMUM DIMENSIONS OF BLOCKING					VOLUME (C.Y.)	THRUST (LB.)
		DEPTH (FT.)	LENGTH (FT.)	"C" (IN.)	HEIGHT (FT.)			
11 1/4" BEND	6"	1.0	2.0	6	1.0	0.04	1,385	
11 1/4" BEND	8"	1.0	2.0	7	1.0	0.05	2,465	
11 1/4" BEND	10"	1.0	2.0	9	1.0	0.07	3,850	
11 1/4" BEND	12"	1.0	2.5	11	1.5	0.12	5,550	
11 1/4" BEND	16"	2.0	2.5	12	2.1	0.26	9,860	
11 1/4" BEND	20"	2.0	3.5	15	2.5	0.48	15,406	
11 1/4" BEND	24"	2.0	4.0	18	3.0	0.70	22,185	
22 1/2" BEND	6"	1.0	2.0	6	1.0	0.04	2,760	
22 1/2" BEND	8"	1.0	2.0	7	1.5	0.06	4,905	
22 1/2" BEND	10"	1.0	2.0	9	2.0	0.10	7,665	
22 1/2" BEND	12"	1.0	3.0	11	2.0	0.16	11,040	
22 1/2" BEND	16"	2.0	3.5	12	3.0	0.45	19,625	
22 1/2" BEND	20"	2.0	4.0	15	4.0	0.74	30,665	
22 1/2" BEND	24"	3.0	5.0	18	4.5	1.47	44,160	
45° BEND	6"	1.0	2.0	6	1.5	0.06	5,415	
45° BEND	8"	1.0	2.5	7	2.0	0.10	9,625	
45° BEND	10"	2.0	3.5	9	2.5	0.31	15,040	
45° BEND	12"	2.0	3.5	11	3.0	0.41	21,655	
45° BEND	16"	3.0	5.0	12	4.0	1.45	38,495	
45° BEND	20"	4.0	6.0	15	5.0	2.05	60,145	
45° BEND	24"	4.0	7.5	18	6.5	3.35	91,610	
90° BEND	6"	1.0	2.5	12	2.0	0.13	10,005	
90° BEND	8"	2.0	3.0	14	3.0	0.38	17,785	
90° BEND	10"	2.5	4.5	18	3.0	0.74	27,785	
90° BEND	12"	3.0	5.0	20	4.0	1.24	40,000	
90° BEND	16"	4.0	6.5	26	5.5	2.91	71,125	
90° BEND	20"	4.0	8.0	32	7.0	4.68	111,135	
90° BEND	24"	5.0	10.0	40	8.0	8.50	160,035	

NOTES:

- SOIL BEARING STRENGTH OF 2000 PSI IS ASSUMED IN THE CALCULATIONS ABOVE. ENGINEER SHALL VERIFY.
- COVER GLANDS AND BOLTS WITH POLYETHYLENE BEFORE PLACING CONCRETE.
- ALLOW CONCRETE TO SET UP A MINIMUM OF 6 HOURS BEFORE PLACING BACKFILL.
- CONCRETE SHALL BE 3000 PSI, CLASS A.
- ALL IRON FITTINGS SHALL BE BLOCKED AND SUPPORTED AS SHOWN ABOVE.
- VERTICAL BENDS WITH AN UPWARD THRUST SHALL BE RESTRAINED AS SHOWN IN STANDARD W715.
- VERTICAL BENDS WITH A DOWNWARD THRUST SHALL BE RESTRAINED AS SHOWN IN STANDARD W716.

CONCRETE BLOCKING FOR BENDS

CITY OF CANTON, GEORGIA	CONCRETE BLOCKING DETAIL	DATE: SEPT. '13	STANDARD NO. W713
		APPROVED:	
CONSTRUCTION STANDARD			

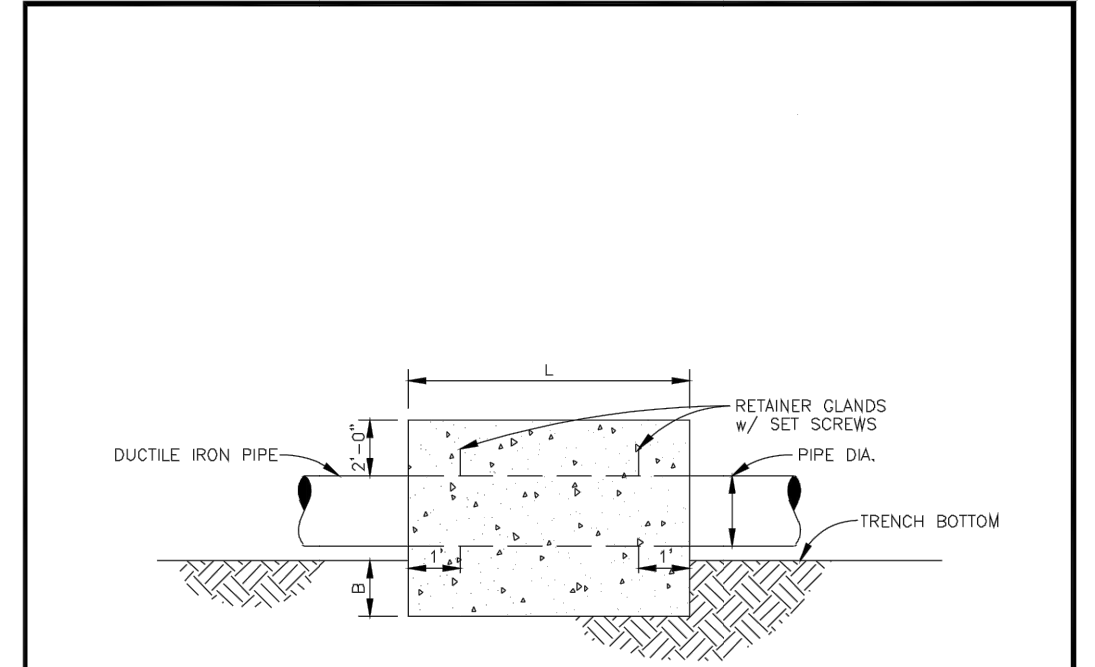

PROFILE VIEW

PIPE DIA.	L	B
6"	4'	1'
8"	4'	1'
10"	4'	1'
12"	4'	1'
16"	4'	2'

NOTE:
CONCRETE COLLAR WIDTH EQUALS THE WIDTH OF THE TRENCH PLUS FOUR FEET (TWO FEET ON EACH SIDE OF THE TRENCH).

CONCRETE THRUST COLLAR

CITY OF CANTON, GEORGIA	CONCRETE THRUST COLLAR	DATE: SEPT. '13	STANDARD NO. W717
		APPROVED:	
CONSTRUCTION STANDARD			

DRAWING NAME: I:\CUSTOMERS_PROJECTS\152-14-102-Brick Mill Road\Eng\Construction\Exhibits\152-14-102-C-PROF\WaterLine07-18-17.dwg
DATE: 09/26/2017 11:40 AM
PRINTED BY: HEVA GARR

PROPERTY AND EX. R/W LINE	---R---	STORM LINE	====
REQUIRED R/W LINE	---R---	TELEPHONE LINE	---T---
CONSTRUCTION LIMITS	---C---	OH POWER LINE	---V---
PERMANENT EASEMENT FOR MAINTENANCE	////	UG POWER LINE	---P---
TEMPORARY EASEMENT FOR CONSTRUCTION	////	WATER LINE	---W---
EASEMENT FOR CONSTRUCTION OF DRIVEWAYS	XXXX	FIBER OPTIC LINE	---FO---
PERMANENT DRAINAGE EASEMENT	*****	GAS LINE	---G---
		SANITARY SEWER LINE	---SS---
		LIGHTING CONDUIT	---
		RETAINING WALL	---
		LIMIT OF DISTURBANCE	---



SEI
SOUTHEASTERN ENGINEERING, INC.
2470 Sandy Plains Road Marietta, Georgia 30066
tel: 770-321-3936 fax: 770-321-3935
www.seengineering.com

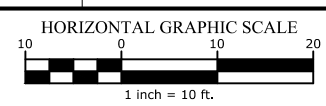

REVISION DATES

CHEROKEE COUNTY GOVERNMENT	
OFFICE:	DATE: 06/26/17
WATERLINE RELOCATION PLAN	
ROADWAY IMPROVEMENTS BRICK MILL ROAD	
SHEET NO.	44-02

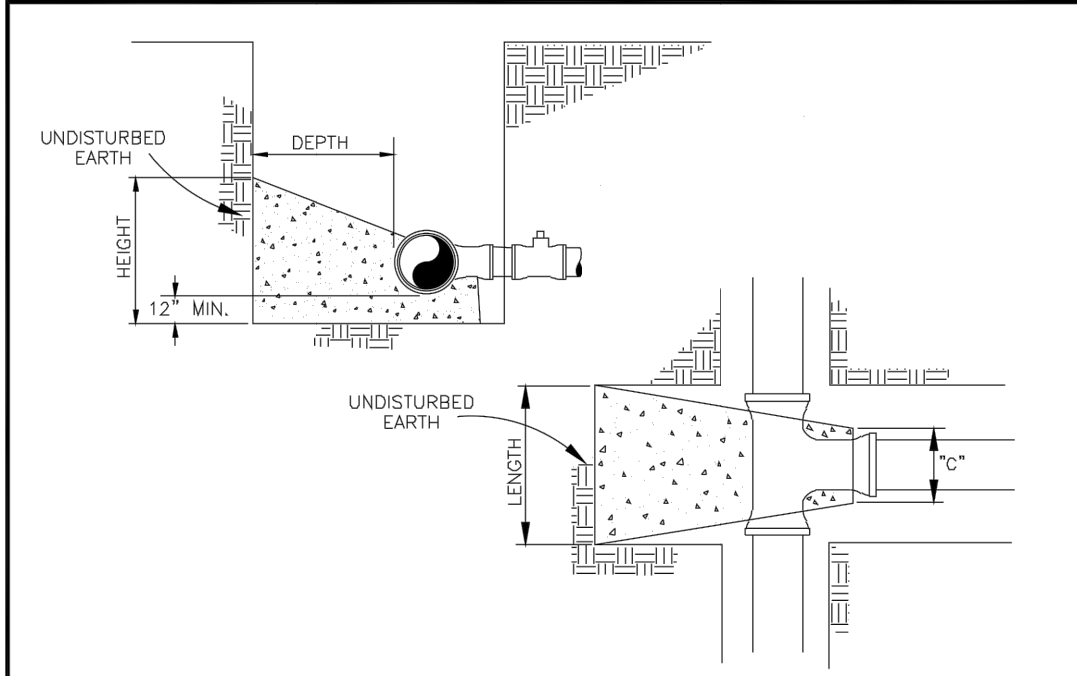

TABLE FOR CONCRETE BLOCKING
(250 PSI TEST PRESSURE)

SIZE	DEPTH (FT.)	LENGTH (FT.)	"C" (IN.)	HEIGHT (FT.)	VOLUME (C.Y.)	THRUST (LB.)
6"	1.0	2.5	12	1.5	0.10	7,070
8"	1.7	3.25	14	2.0	0.27	12,565
10"	2.0	4.0	18	2.5	0.50	19,635
12"	2.5	4.5	20	3.25	0.91	28,275
16"	3.0	5.0	26	5.0	1.77	50,265
20"	4.0	7.0	32	5.75	3.69	78,540
24"	6.0	9.0	40	6.5	7.94	113,100

- NOTES:
1. SOIL BEARING STRENGTH OF 2000 PSI IS ASSUMED IN THE CALCULATIONS ABOVE. ENGINEER SHALL VERIFY.
 2. COVER GLANDS AND BOLTS WITH POLYETHYLENE BEFORE PLACING CONCRETE.
 3. ALLOW CONCRETE TO SET UP A MINIMUM OF 6 HOURS BEFORE PLACING BACKFILL.
 4. CONCRETE SHALL BE 3000 PSI, CLASS A.
 5. ALL IRON FITTINGS SHALL BE BLOCKED AND SUPPORTED AS SHOWN ABOVE.

CONCRETE BLOCKING-FOR TEES AND PLUGS

CITY OF CANTON, GEORGIA	CONCRETE BLOCKING DETAIL	DATE: SEPT. '13	STANDARD NO. W714
		APPROVED:	
CONSTRUCTION STANDARD			

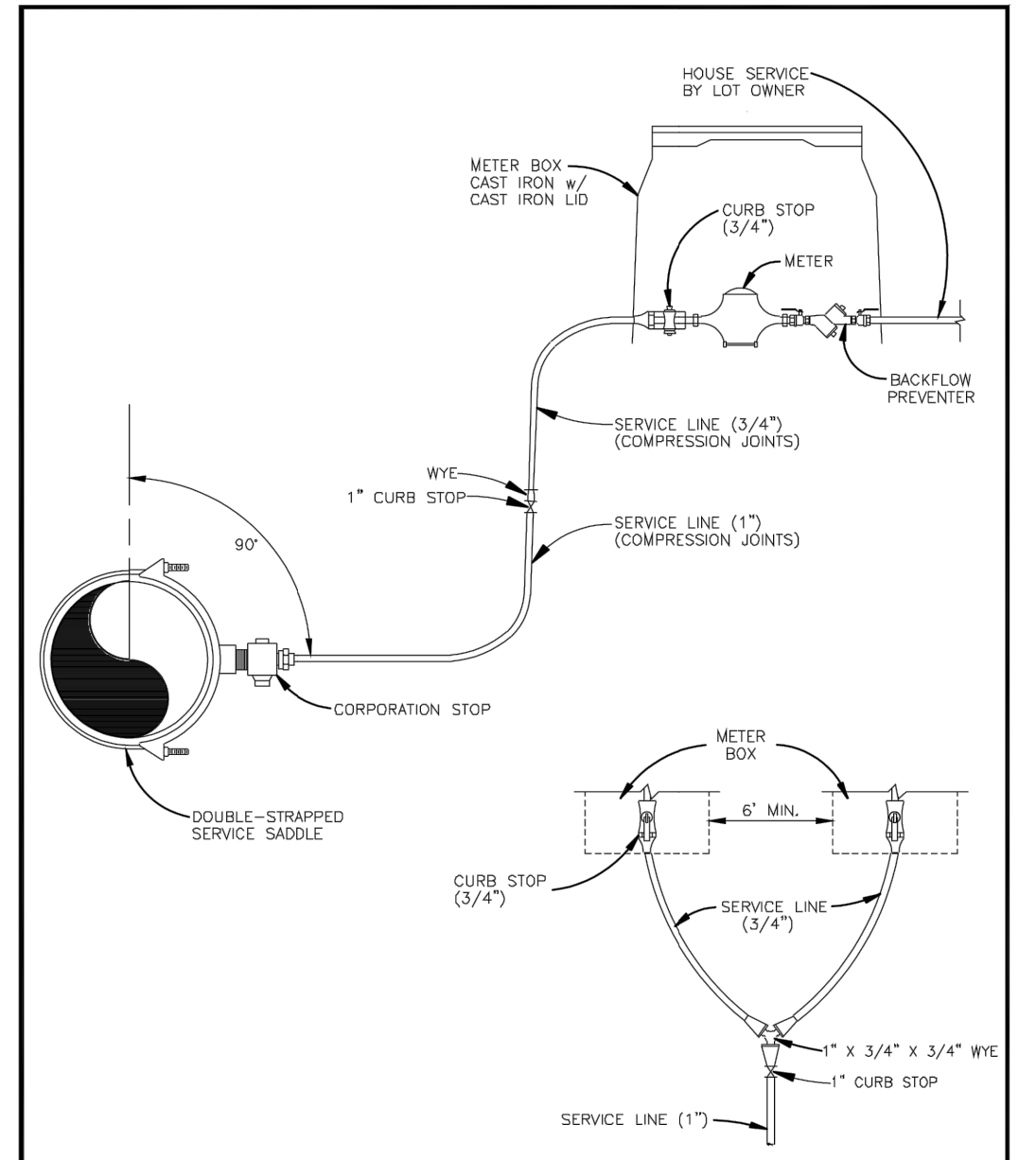

PLAN FOR WYE

CITY OF CANTON, GEORGIA	RESIDENTIAL WATER METER INSTALLATION CONSTRUCTION STANDARD	DATE: SEPT. '13	STANDARD NO. W704
		APPROVED:	

DRAWING NAME: I:\CUSTOMERS_PROJECTS\152-14-102-Brick Mill Road\Eng\Construction\Exhibits\152-14-102-C-PROF\WaterLine07-18-17.dwg
DATE: 09/20/2017 11:41 AM
PRINTED BY: HEVA CURK

PROPERTY AND EX. R/W LINE	STORM LINE
REQUIRED R/W LINE	TELEPHONE LINE
CONSTRUCTION LIMITS	OH POWER LINE
PERMANENT EASEMENT FOR MAINTENANCE	UG POWER LINE
TEMPORARY EASEMENT FOR CONSTRUCTION	WATER LINE
EASEMENT FOR CONSTRUCTION OF DRIVEWAYS	FIBER OPTIC LINE
PERMANENT DRAINAGE EASEMENT	GAS LINE
	SANITARY SEWER LINE
	LIGHTING CONDUIT
	RETAINING WALL
	LIMIT OF DISTURBANCE



SEI
SOUTHEASTERN ENGINEERING, INC.
2470 Sandy Plains Road Marietta, Georgia 30066
tel: 770-321-3936 fax: 770-321-3935
www.seengineering.com

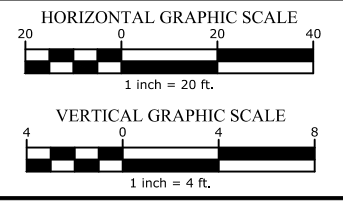

REVISION DATES	
1/12/16	

CHEROKEE COUNTY GOVERNMENT	
OFFICE:	DATE: 06/26/17
WATERLINE RELOCATION PLAN	
ROADWAY IMPROVEMENTS BRICK MILL ROAD	
SHEET NO.	44-03

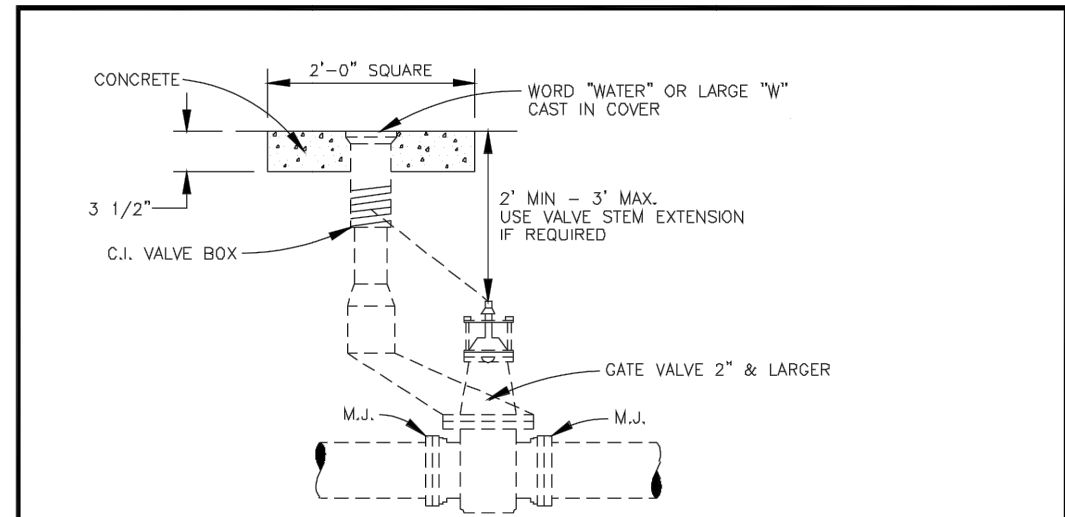

TYPICAL VALVE INSTALLATION

NOTES:

1. TOP OF EXTENSION SHALL BE NO MORE THAN THREE FEET BELOW FINAL GRADE.
2. CONTRACTOR IS RESPONSIBLE FOR IN FIELD MEASUREMENT OF DEPTH OF PIPE COVER TO DETERMINE NEED FOR VALVE STEM EXTENSION.

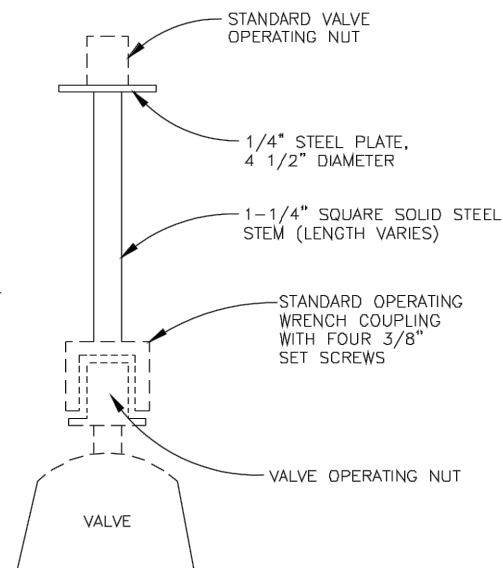

VALVE STEM EXTENSION DETAIL

**CITY OF
CANTON, GEORGIA**

**TYPICAL
VALVE
INSTALLATION**
CONSTRUCTION STANDARD

DATE:	SEPT. '13	STANDARD NO. W718
APPROVED:		

DRAWING NAME: I:\CUSTOMERS_PROJECTS\152 Cherokee County\152-14-102 Brick Mill Road\Eng\Construction\Exhibits\152-14-102-C-PROF\WaterLine07-18-17.dwg
DATE: 09/26/2017 11:41 AM
PRINTED BY: HEYR CARB

PROPERTY AND EX. R/W LINE	
REQUIRED R/W LINE	
CONSTRUCTION LIMITS	
PERMANENT EASEMENT FOR MAINTENANCE	
TEMPORARY EASEMENT FOR CONSTRUCTION	
EASEMENT FOR CONSTRUCTION OF DRIVEWAYS	
PERMANENT DRAINAGE EASEMENT	

STORM LINE	
TELEPHONE LINE	
OH POWER LINE	
UG POWER LINE	
WATER LINE	
FIBER OPTIC LINE	
GAS LINE	
SANITARY SEWER LINE	
LIGHTING CONDUIT	
RETAINING WALL	
LIMIT OF DISTURBANCE	

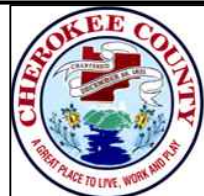

SOUTHEASTERN ENGINEERING, INC.
2470 Sandy Plains Road Marietta, Georgia 30066
tel: 770-321-3936 fax: 770-321-3935
www.seengineering.com

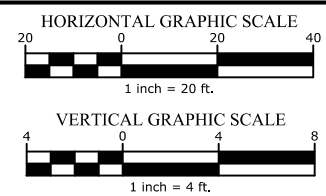

REVISION DATES	
1/12/16	

CHEROKEE COUNTY GOVERNMENT	
OFFICE:	DATE: 06/26/17
WATERLINE RELOCATION PLAN	
ROADWAY IMPROVEMENTS BRICK MILL ROAD	SHEET NO. 44-04