

TRAFFIC SIGNAL MODIFICATION PLAN - PHASE 2 - COLUMBIA PIKE AND S. ORME STREET  
SEE NOTE 11 ON SHEET A19.1 FOR WORKING HOURS  
POSTED SPEED LIMIT: 30 MPH

PROJECT MANAGER: *Christiana Brabant-Dunn, PE* - (703) 259-2960 - VDOT NOVA District  
SURVEYED BY: \_\_\_\_\_  
DESIGN SUPERVISED BY: \_\_\_\_\_  
DESIGNED BY: *Dewberry & Davis, LLC* - (703) 289-4796

Clearance Chart

| R/W | CLEAR | NEXT | Ø  |
|-----|-------|------|----|
| G   | G     | G    | G  |
| G   | Y     | R    | R  |
| ←   | ←     | ←    | ←  |
| ←   | ←     | ←    | ←  |
| G   | Y     | R    | R  |
| G   | Y     | R    | R  |
| G   | Y     | R    | R  |
| R   | R     | R    | R  |
| R   | R     | R    | R  |
| R   | R     | R    | R  |
| R   | R     | R    | R  |
| W   | W     | W    | W  |
| W   | FDW   | DW   | DW |

Street Name Signs

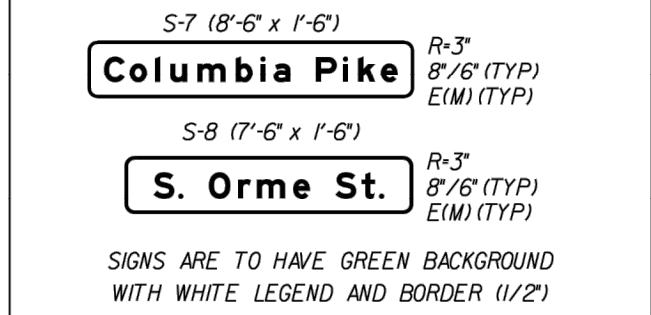

Signs

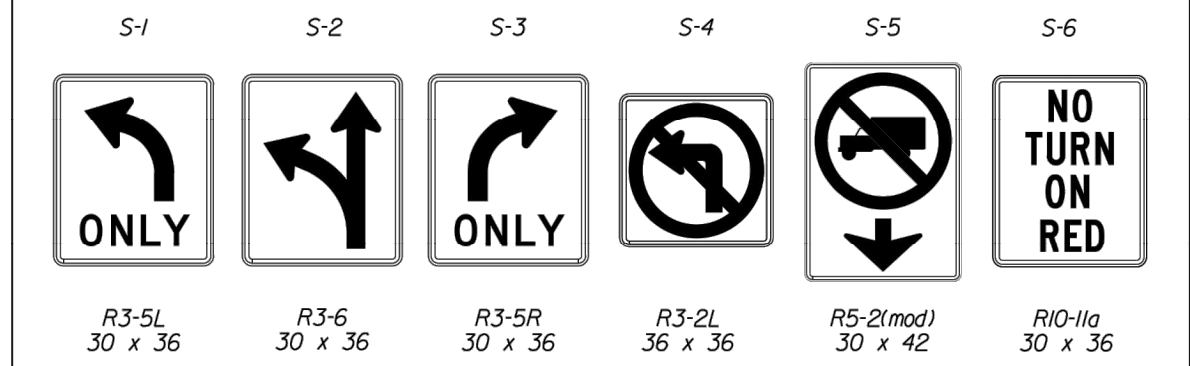

Cable & Conduit Runs

- A) 1-3" CONDUIT  
1 CABLE FOR APS PB6  
17C FOR HEAD P2  
1-8 AWG EGC
- B) 1-4" BORED CONDUIT  
1 CABLE FOR APS PB6  
17C FOR HEAD P2  
1-8 AWG EGC
- C) 1-3" CONDUIT  
1 CABLE FOR APS PB5  
17C FOR HEADS P2  
27C FOR HEADS 25  
27C FOR HEADS 44A  
2 CABLES FOR OPTICOM  
2 VIDEO DETECTION CABLES  
1-8 AWG EGC
- D) 1-3" CONDUIT  
1 CABLE FOR APS PB4  
17C FOR HEADS P3  
1-8 AWG EGC
- E) 1-4" BORED CONDUIT  
3 CABLES FOR APS PB4/PB5/PB6  
37C FOR HEADS P2/P3  
27C FOR HEADS 25  
27C FOR HEADS 44A  
2 CABLES FOR OPTICOM  
2 VIDEO DETECTION CABLES  
1-8 AWG EGC
- F) 1-3" CONDUIT  
1 CABLE FOR APS PB3  
17C FOR HEAD P3  
17C FOR HEADS 33A/3B  
1 CABLE FOR OPTICOM  
1 VIDEO DETECTION CABLE  
1-8 AWG EGC
- G) 1-3" CONDUIT  
1 CABLE FOR APS PB2  
17C FOR HEAD P6  
1-8 AWG EGC
- H) 1-4" BORED CONDUIT  
5 CABLES FOR APS PB2/PB3/PB4/PB5/PB6  
57C FOR HEAD P2/P3/P6  
17C FOR HEADS 33A/3B  
27C FOR HEADS 25  
27C FOR HEADS 44A  
3 CABLES FOR OPTICOM  
3 CABLES FOR VIDEO DETECTION  
1-8 AWG EGC
- I) 1-3" CONDUIT  
1 CABLE FOR APS PB1  
17C FOR HEAD P6  
17C FOR HEADS 6  
1 CABLE FOR OPTICOM  
1 CABLE FOR VIDEO DETECTION  
1-8 AWG EGC
- J) 1-4" CONDUIT  
6 CABLES FOR APS PB1/PB2/PB3/PB4/PB5/PB6  
67C FOR HEADS P2/P3/P6  
17C FOR HEADS 6  
27C FOR HEADS 25  
27C FOR HEADS 44A  
17C FOR HEADS 33A/3B  
1-8 AWG EGC
- K) 1-1/2" METAL CONDUIT  
3-6 AWG EGC  
FOR ELECTRICAL SERVICE
- L) 1-2" PVC CONDUIT  
1-8 AWG/L  
FOR ELECTRICAL SERVICE
- M) 1-4" CONDUIT  
1-6 AWG EGC  
FOR SYSTEM GROUNDING
- EGC - EQUIPMENT GROUNDING CONDUCTOR  
(S) - SHIELDED CABLE

Phasing Diagram

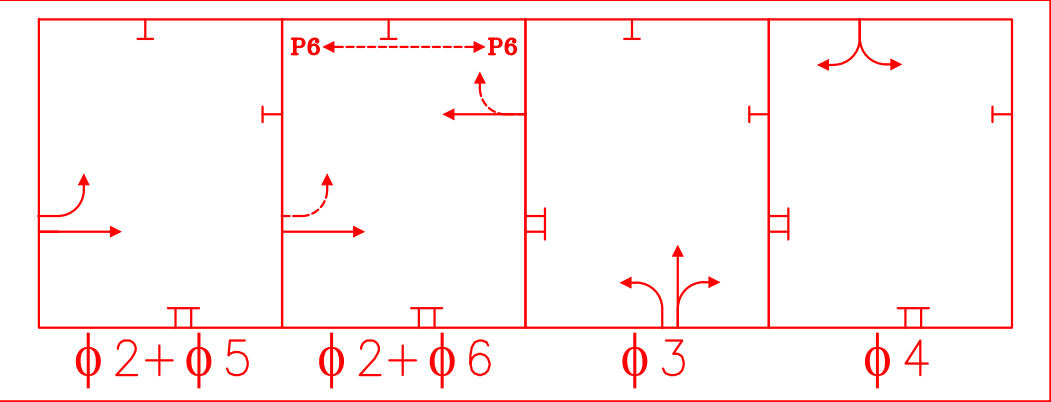

Initial Timing Chart

| PHASE                      | 1                   | 2             | 3                 | 4                   | 5                   | 6 | 7 | 8 |
|----------------------------|---------------------|---------------|-------------------|---------------------|---------------------|---|---|---|
| MOVEMENT                   | EB TH COLUMBIA PIKE | NB LTR RAMP D | SB LR ORME STREET | EB LT COLUMBIA PIKE | WB TH COLUMBIA PIKE |   |   |   |
| PHASE ON                   | x                   | x             | x                 | x                   | x                   |   |   |   |
| PHASE OFF                  |                     |               |                   |                     |                     | x | x | x |
| INTERVAL                   |                     |               |                   |                     |                     |   |   |   |
| MIN GR                     | 7.0                 | 7.0           | 7.0               | 7.0                 | 7.0                 |   |   |   |
| PASSAGE                    | 3.0                 | 3.0           | 3.0               | 3.0                 | 3.0                 |   |   |   |
| YELLOW                     | 3.5                 | 3.0           | 3.0               | 3.5                 | 3.5                 |   |   |   |
| ALL RED                    | 3.0                 | 3.0           | 3.0               | 3.0                 | 2.5                 |   |   |   |
| MAX I                      | 75.5                | 26.0          | 17.0              | 37.5                | 32                  |   |   |   |
| MIN GAP                    | 3.0                 | 3.0           | 3.0               | 3.0                 | 3.0                 |   |   |   |
| MODE                       | MIN R               | NL            | NL                | NL                  | MIN R               |   |   |   |
| INITIAL CYCLE LENGTH (MIN) | 50 SECONDS          |               |                   |                     |                     |   |   |   |
| INITIAL CYCLE LENGTH (MAX) | 130 SECONDS         |               |                   |                     |                     |   |   |   |
| PEDESTRIAN TIMINGS         |                     |               |                   |                     |                     |   |   |   |
| INTERVAL                   | 7.0                 | 7.0           |                   | 7.0                 |                     |   |   |   |
| CLEARANCE                  | 9.0                 | 10.0          |                   | 8.0                 |                     |   |   |   |

Pole Locations

|  | OFFSET: |
|--|---------|
| 1 STA 1357-75 COLUMBIA PIKE  | 71' LT  |
| 2 STA 1358-37 COLUMBIA PIKE  | 46' LT  |
| 3 STA 1358-44 COLUMBIA PIKE  | 38' LT  |
| 4 STA 1358-28 COLUMBIA PIKE  | 42' RT  |
| 5 STA 1358-38 COLUMBIA PIKE  | 40' RT  |
| 6 STA 1357-46 COLUMBIA PIKE  | 50' RT  |
| * TRAFFIC SIGNAL POLES SHALL BE SUPPLIED WITH AN ORNAMENTAL LUMINAIRE ARM. |         |

Color Sequence Chart

| SIGNAL | 2 | 3 | 4 | 5 | 6 | 25 | 26 | 3 | 4 | FLASH |
|--------|---|---|---|---|---|----|----|---|---|-------|
| 2      | G |   |   |   |   | G  | G  |   |   | Y     |
| 3      |   | G |   |   |   |    |    | G |   | R     |
| 3A     |   |   |   |   |   |    |    |   | ← | R     |
| 3B     |   |   |   |   |   |    |    |   | → | R     |
| 4      |   |   | G |   |   |    |    | G |   | R     |
| 4A     |   |   |   | G |   |    |    |   | ← | R     |
| 5      |   |   |   |   | G |    |    |   | → | R     |
| 6      |   |   |   |   |   | G  | G  |   |   | Y     |
| P2     | W |   |   |   |   | W  | W  |   |   | BLNK  |
| P3     | W |   |   |   |   | W  | W  |   |   | BLNK  |
| P6     |   |   |   | W | W |    |    | W | W | BLNK  |

Note: Blank spaces denote red indications. Walk Indication displayed after pedestrian call serviced. Otherwise "Don't Walk" will be displayed.

Signals

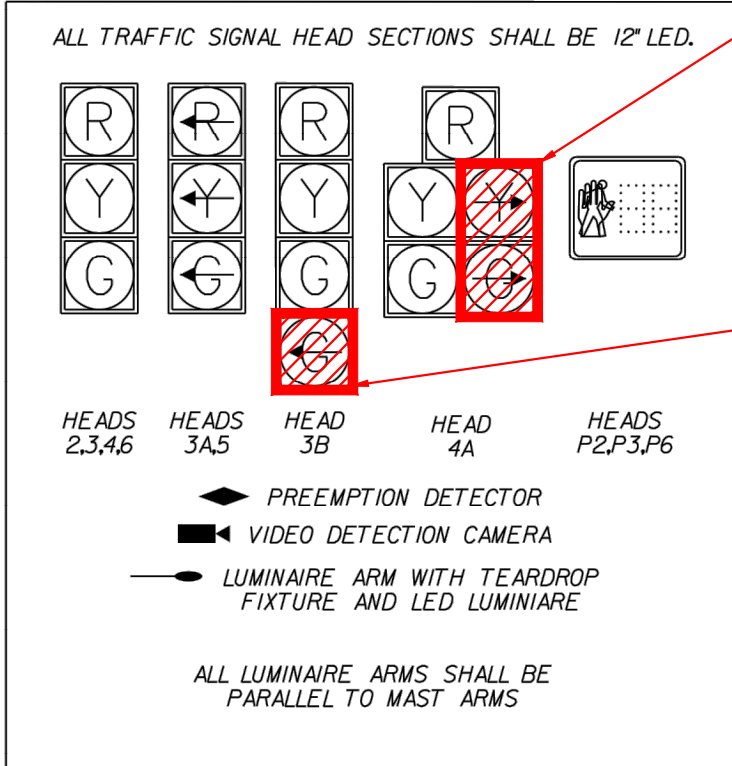

CONTRACTOR TO SECURELY COVER GREEN AND YELLOW RIGHT-TURN ARROW LENSES SO THAT ARROW INDICATIONS ARE NOT VISIBLE

Accessible Pedestrian System (APS) Pushbuttons

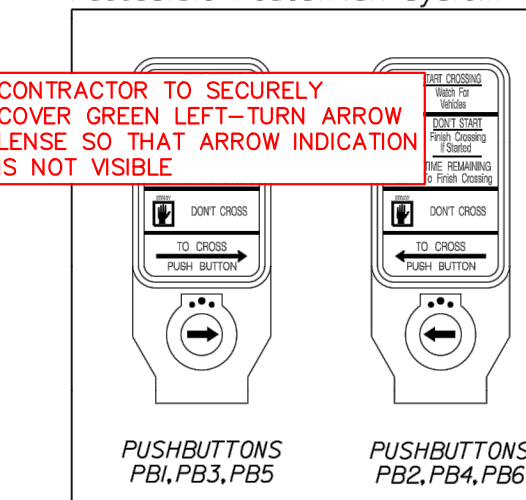

ACCESSIBLE PEDESTRIAN SYSTEM SHALL BE POLARA SYSTEM CONFORMING TO ARLINGTON COUNTY SPECIFICATIONS, AND SHALL INCLUDE A POLARA CENTRAL CONTROL UNIT.

ALL PUSHBUTTONS SHALL HAVE A PERCUSSIVE TONE WALK INDICATION.

SEE BORDER FOR SCALE

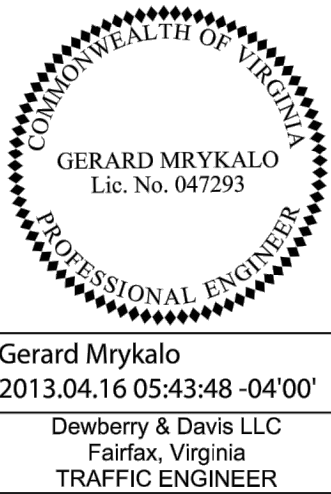

| REVISED           | STATE | ROUTE | PROJECT                      | SHEET NO. |
|-------------------|-------|-------|------------------------------|-----------|
| 1/9/13<br>4/16/13 | VA    | 27    | 0027-000-VOI<br>RW-201,C-501 | 14(3)     |

DESIGN FEATURES RELATING TO CONSTRUCTION OR TO REGULATION AND CONTROL OF TRAFFIC MAY BE SUBJECT TO CHANGE AS DEEMED NECESSARY BY THE DEPARTMENT

Gerard Mrykalo  
2013.04.16 05:43:48 -04'00'  
Dewberry & Davis LLC  
Fairfax, Virginia  
TRAFFIC ENGINEER



DEPARTMENT OF ENVIRONMENTAL SERVICES

Facilities & Engineering Division  
Engineering Bureau  
2100 Clarendon Boulevard, Suite 813  
Arlington, VA 22201  
Phone: 703.228.3629  
Fax: 703.228.3606

**Kimley»Horn**  
Kimley-Horn  
and Associates, Inc.  
© 2021 KIMLEY-HORN AND ASSOCIATES, INC.  
11400 Commerce Park Drive, Suite 400  
Reston, Virginia 20191  
Phone: 703-874-1500  
Fax: 703-874-1590

Seal

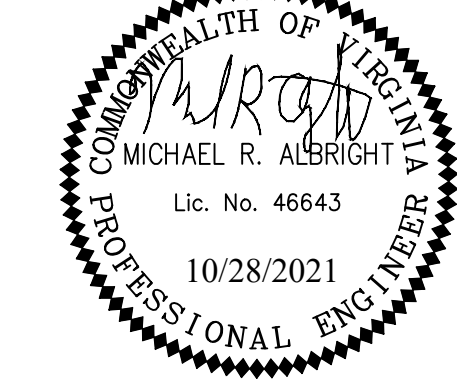

Approvals Date

Design Team Engineer Supervisor

Construction Management Supervisor

Water, Sewer, Streets Bureau Chief

Transportation Director

Project Manager

Revisions Date

Designed: ATS  
Drawn: ATS  
Checked: MRA  
Miss Utility Transmittal #:

Filename: 010073-A-MOT-TS.dwg  
Path: C:\Users\mra\AppData\Local\Microsoft\Windows\Temporary Internet Files\Content.IE5\mra\010073-A-MOT-TS.dwg  
Plotted: October 28, 2021  
Plotted by: Patrick.Husted

ARLINGTON COUNTY, VIRGINIA  
DEPARTMENT OF ENVIRONMENTAL SERVICES

MAINTENANCE OF TRAFFIC SIGNAL MODIFICATION PLAN  
COLUMBIA PIKE - ROUTE 244  
COLUMBIA PIKE - MULTIMODAL STREET IMPROVEMENTS  
SEGMENT A

SCALE: HOR. 1" = 30' SHEET: A19.7 of A19.8

MODIFICATIONS TO TRAFFIC SIGNAL FOR MAINTENANCE OF TRAFFIC PURPOSES ARE SHOWN IN RED ON THIS PLAN. SIGNAL MODIFICATIONS ARE SHOWN ON TOP OF EXISTING SIGNAL PLAN, WHICH WAS PREPARED BY OTHERS. P.E. SEAL IN BORDER APPLIES ONLY TO SIGNAL MODIFICATIONS SHOWN IN RED. SIGNAL SHALL BE RETURNED TO EXISTING CONDITIONS FOLLOWING COMPLETION OF CORRESPONDING PHASE OF CONSTRUCTION.



DEPARTMENT OF ENVIRONMENTAL SERVICES

11/23/2021  
APPROVAL DATE



TRAFFIC SIGNAL MODIFICATION PLAN - PHASE 3A - COLUMBIA PIKE AND S. ORME STREET  
SEE NOTE 11 ON SHEET A19.1 FOR WORKING HOURS  
POSTED SPEED LIMIT: 30 MPH

PROJECT MANAGER: *Christiano Brabant-Dunn, PE* - (703) 259-2960 - VDOT NOVA District  
SURVEYED BY: \_\_\_\_\_  
DESIGN SUPERVISED BY: \_\_\_\_\_  
DESIGNED BY: *Dewberry & Davis, LLC* - (703) 289-4796

Clearance Chart

| R/W | Clear | Next | Ø  |
|-----|-------|------|----|
| G   | G     | G    | G  |
| G   | Y     | R    | R  |
| ←   | ←     | ←    | ←  |
| ←   | ←     | ←    | ←  |
| G   | Y     | R    | R  |
| G   | Y     | R    | R  |
| G   | Y     | R    | R  |
| R   | R     | R    | R  |
| R   | R     | R    | R  |
| R   | R     | R    | R  |
| R   | R     | R    | R  |
| W   | W     | W    | W  |
| W   | FDW   | DW   | DW |

Street Name Signs

S-7 (8'-6" x 1'-6")  
**Columbia Pike** R-3" 8"/8" (TYP) EMI (TYP)

S-8 (7'-6" x 1'-6")  
**S. Orme St.** R-3" 8"/8" (TYP) EMI (TYP)

SIGNS ARE TO HAVE GREEN BACKGROUND WITH WHITE LEGEND AND BORDER 1/2"

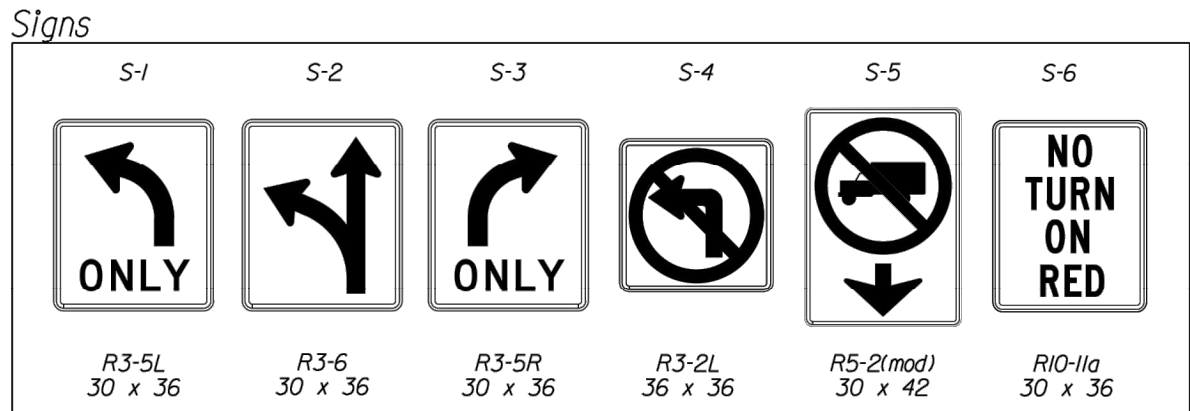

Cable & Conduit Runs

- A) 1-3" CONDUIT  
1 CABLE FOR APS PB6  
17C FOR HEAD P2  
1-8 AWG EGC
- B) 1-4" BORED CONDUIT  
1 CABLE FOR APS PB6  
17C FOR HEAD P2  
1-8 AWG EGC
- C) 1-3" CONDUIT  
1 CABLE FOR APS PB5  
17C FOR HEADS P2  
27C FOR HEADS 4A  
2 CABLES FOR OPTICOM  
2 VIDEO DETECTION CABLES  
1-8 AWG EGC
- D) 1-3" CONDUIT  
1 CABLE FOR APS PB4  
17C FOR HEADS P3  
1-8 AWG EGC
- E) 1-4" BORED CONDUIT  
3 CABLES FOR APS PB4/PB5/PB6  
37C FOR HEADS P2/P3  
27C FOR HEADS 4A  
2 CABLES FOR OPTICOM  
2 VIDEO DETECTION CABLES  
1-8 AWG EGC
- F) 1-3" CONDUIT  
1 CABLE FOR APS PB3  
17C FOR HEAD P1  
17C FOR HEADS 3,3A,3B  
1 CABLE FOR OPTICOM  
1 VIDEO DETECTION CABLE  
1-8 AWG EGC
- G) 1-3" CONDUIT  
1 CABLE FOR APS PB2  
17C FOR HEAD P6  
1-8 AWG EGC
- H) 1-4" BORED CONDUIT  
5 CABLES FOR APS PB2/PB3/PB4/PB5/PB6  
57C FOR HEAD P2/P3/P6  
17C FOR HEADS 3,3A,3B  
27C FOR HEADS 2,5  
27C FOR HEADS 4A  
3 CABLES FOR OPTICOM  
3 CABLES FOR VIDEO DETECTION  
1-8 AWG EGC
- I) 1-3" CONDUIT  
1 CABLE FOR APS PB1  
17C FOR HEAD P6  
1 CABLE FOR OPTICOM  
1 CABLE FOR VIDEO DETECTION  
1-8 AWG EGC
- J) 1-4" CONDUIT  
6 CABLES FOR APS PB1/PB2/PB3/PB4/PB5/PB6  
67C FOR HEADS P2/P3/P6  
17C FOR HEADS 6  
27C FOR HEADS 2,5  
27C FOR HEADS 4A  
17C FOR HEADS 3,3A,3B  
1-8 AWG EGC
- K) 1-1/2" METAL CONDUIT  
3-6 AWG EGC  
FOR ELECTRICAL SERVICE
- L) 1-2" PVC CONDUIT  
1-8 AWG/L  
FOR ELECTRICAL SERVICE
- M) 1-4" CONDUIT  
1-6 AWG EGC  
FOR SYSTEM GROUNDING
- EGC = EQUIPMENT GROUNDING CONDUCTOR (S) = SHIELDED CABLE

PROPOSED TEMPORARY SIGNALS

HEAD 6A

Phasing Diagram

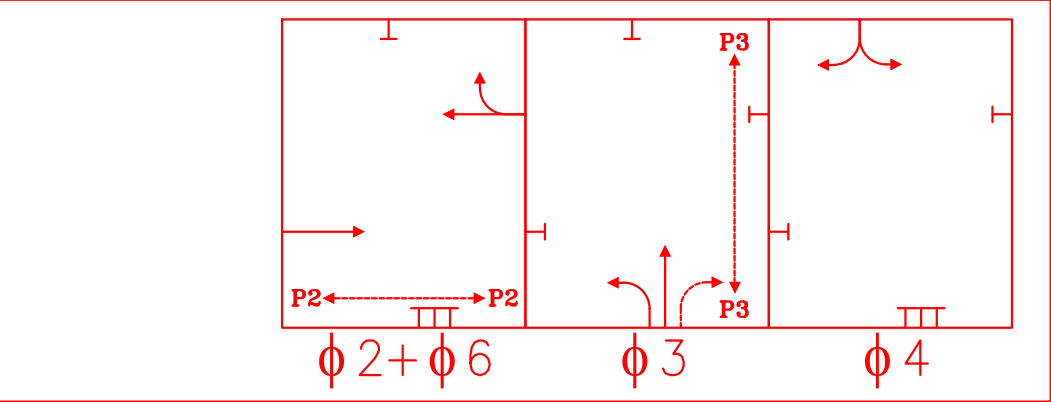

Initial Timing Chart

| PHASE                                  | 1                   | 2             | 3                 | 4                   | 5                   | 6 | 7 | 8 |
|--|---------------------|---------------|-------------------|---------------------|---------------------|---|---|---|
| MOVEMENT                               | EB TH COLUMBIA PIKE | NB LTR RAMP D | SB LR ORME STREET | EB LT COLUMBIA PIKE | WB TH COLUMBIA PIKE |   |   |   |
| PHASE ON                               | x                   | x             | x                 | x                   | x                   |   |   |   |
| PHASE OFF                              |                     |               |                   |                     |                     | x | x | x |
| INTERVAL                               | PHASE TIMINGS       |               |                   |                     |                     |   |   |   |
| MIN GR                                 | 7.0                 | 7.0           | 7.0               | 7.0                 | 7.0                 |   |   |   |
| PASSAGE                                | 3.0                 | 3.0           | 3.0               | 3.0                 | 3.0                 |   |   |   |
| YELLOW                                 | 3.5                 | 3.0           | 3.0               | 3.5                 | 3.5                 |   |   |   |
| ALL RED                                | 3.0                 | 3.0           | 3.0               | 3.0                 | 2.5                 |   |   |   |
| MAX I                                  | 75.5                | 26.0          | 17.0              | 37.5                | 32                  |   |   |   |
| MIN GAP                                | 3.0                 | 3.0           | 3.0               | 3.0                 | 3.0                 |   |   |   |
| MODE                                   | MIN R               | NL            | NL                | NL                  | MIN R               |   |   |   |
| INITIAL CYCLE LENGTH (MIN) 50 SECONDS  |                     |               |                   |                     |                     |   |   |   |
| INITIAL CYCLE LENGTH (MAX) 130 SECONDS |                     |               |                   |                     |                     |   |   |   |
| PEDESTRIAN TIMINGS                     |                     |               |                   |                     |                     |   |   |   |
| INTERVAL                               | 7.0                 | 7.0           |                   | 7.0                 |                     |   |   |   |
| CLEARANCE                              | 9.0                 | 10.0          |                   | 8.0                 |                     |   |   |   |

Pole Locations

|                             | OFFSET: |
|-----------------------------|---------|
| 1 STA 1357-75 COLUMBIA PIKE | 71' LT  |
| 2 STA 1358-37 COLUMBIA PIKE | 46' LT  |
| 3 STA 1358-44 COLUMBIA PIKE | 38' LT  |
| 4 STA 1358-28 COLUMBIA PIKE | 42' RT  |
| 5 STA 1358-38 COLUMBIA PIKE | 40' RT  |
| 6 STA 1357-46 COLUMBIA PIKE | 50' RT  |

X TRAFFIC SIGNAL POLES SHALL BE SUPPLIED WITH AN ORNAMENTAL LUMINAIRE ARM.

Color Sequence Chart

| SIGNAL | 2 | 3 | 4 | 5 | 6 | 2,5 | 2,6 | 3,4 | 4 | FLASH |
|--------|---|---|---|---|---|-----|-----|-----|---|-------|
| 2      | G |   |   |   |   | G   | G   |     |   | Y     |
| 3      |   | G |   |   |   |     |     | G   |   | R     |
| 3A     |   |   | ← |   |   |     |     | ←   |   | R     |
| 4      |   |   |   | G |   |     |     |     | G | R     |
| 4A     |   |   |   |   | G |     |     |     |   | R     |
| 5      |   |   |   |   |   | G   |     |     |   | Y     |
| 6      |   |   |   |   |   |     |     |     | G | R     |
| P2     | W |   |   |   |   | W   | W   |     |   | BLNK  |
| P3     | W |   |   |   |   | W   | W   |     |   | BLNK  |
| P6     |   |   |   | W | W |     |     | W   | W | BLNK  |

Note: Blank spaces denote red indications. Walk indication displayed after pedestrian call serviced. Otherwise "Don't Walk" will be displayed.

Signals

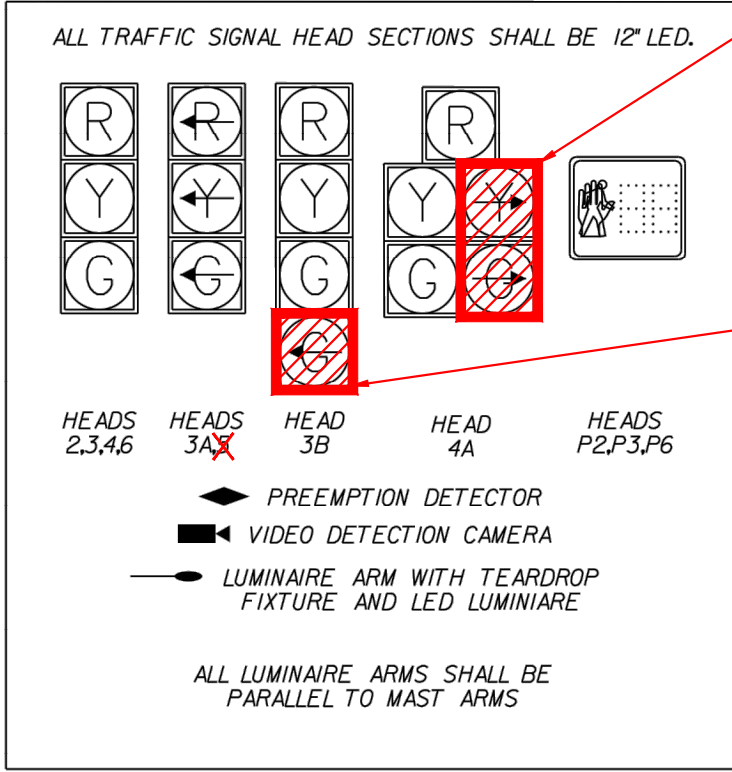

Accessible Pedestrian System (APS) Pushbuttons

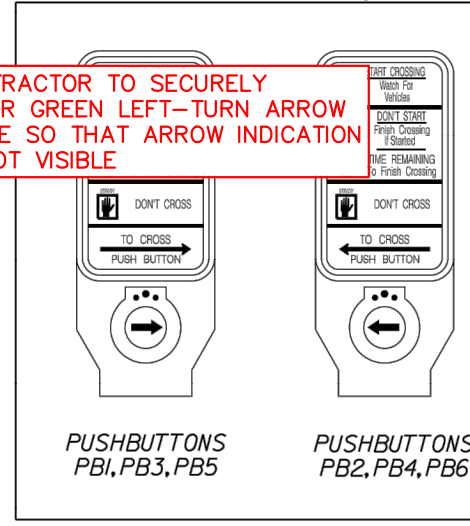

ACCESSIBLE PEDESTRIAN SYSTEM SHALL BE POLARA SYSTEM CONFORMING TO ARLINGTON COUNTY SPECIFICATIONS, AND SHALL INCLUDE A POLARA CENTRAL CONTROL UNIT.

ALL PUSHBUTTONS SHALL HAVE A PERCUSSIVE TONE WALK INDICATION.

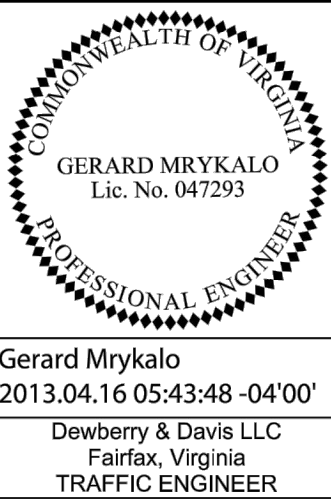

| REVISED           | STATE | ROUTE | PROJECT                      | SHEET NO. |
|-------------------|-------|-------|------------------------------|-----------|
| 1/9/13<br>4/16/13 | VA    | 27    | 0027-000-VOI<br>RW-201,C-501 | 14(3)     |

DESIGN FEATURES RELATING TO CONSTRUCTION OR TO REGULATION AND CONTROL OF TRAFFIC MAY BE SUBJECT TO CHANGE AS DEEMED NECESSARY BY THE DEPARTMENT

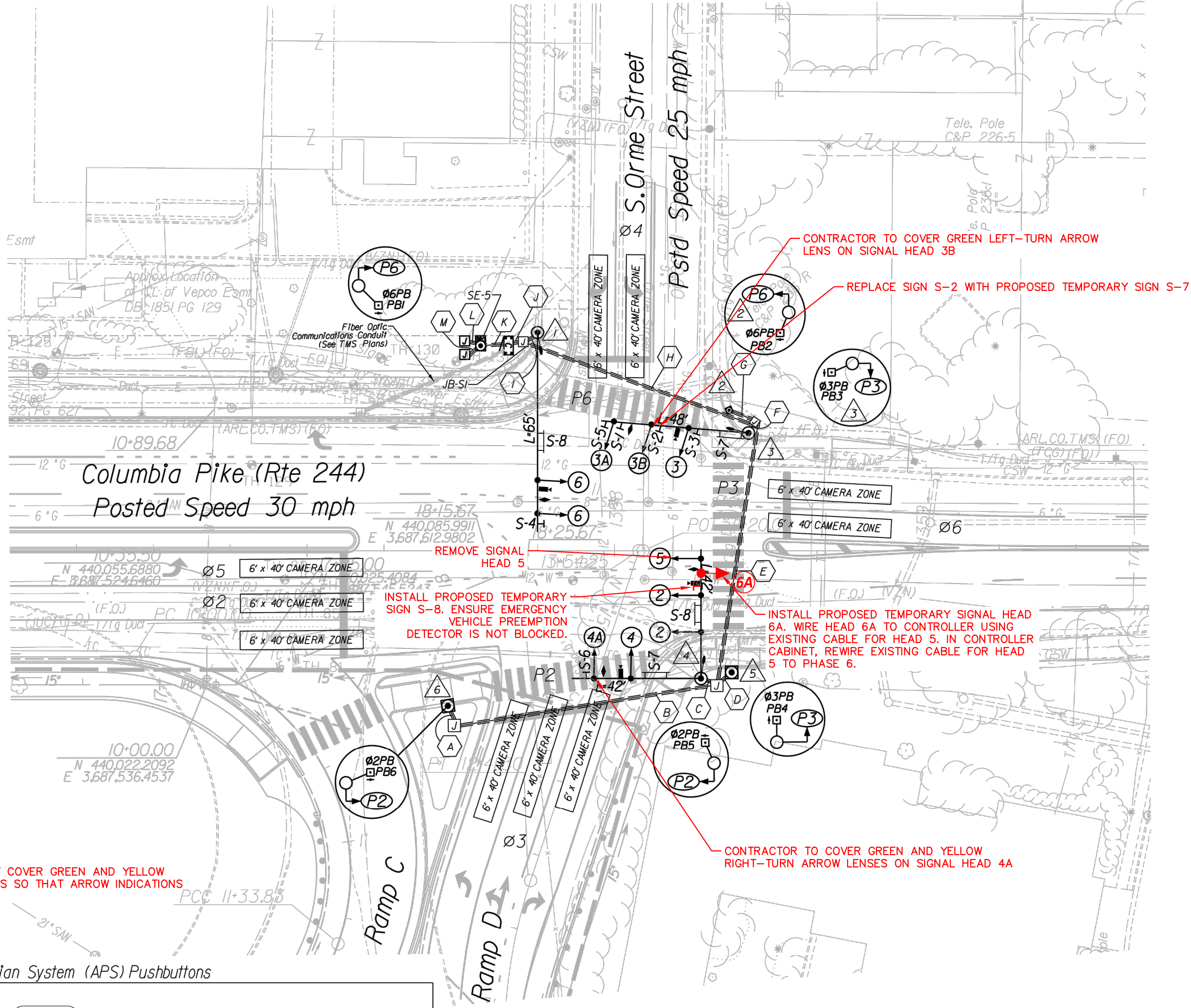

SEE BORDER FOR SCALE



DEPARTMENT OF ENVIRONMENTAL SERVICES

Facilities & Engineering Division  
Engineering Bureau  
2100 Clarendon Boulevard, Suite 813  
Arlington, VA 22201  
Phone: 703.228.3629  
Fax: 703.228.3606

**Kimley»Horn**  
Kimley-Horn  
and Associates, Inc.

© 2021 KIMLEY-HORN AND ASSOCIATES, INC.  
11400 Commerce Park Drive, Suite 400  
Reston, Virginia 20191  
Phone: 703-874-1500  
Fax: 703-874-1590

Seal

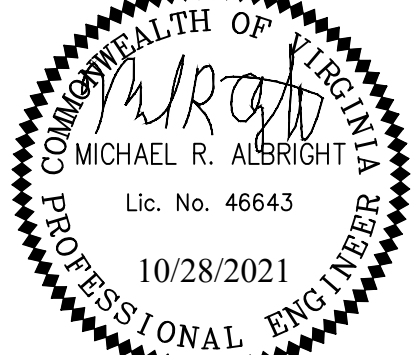

Approvals Date

Design Team Engineer Supervisor

Construction Management Supervisor

Water, Sewer, Streets Bureau Chief

Transportation Director

Project Manager

Revisions Date

Designed: ATS  
Drawn: ATS  
Checked: MRA  
Miss Utility Transmittal #:

Filename: 010073-A-MOT-TS.dwg  
Path: Z:\NVA\_R00V\11000073-arlington-pike-maintenance\production\11000073-arlington-pike-maintenance.dwg  
Plotted: October 28, 2021  
Plotted by: Patrick.Husted

ARLINGTON COUNTY, VIRGINIA  
DEPARTMENT OF ENVIRONMENTAL SERVICES

MAINTENANCE OF TRAFFIC SIGNAL MODIFICATION PLAN  
COLUMBIA PIKE - ROUTE 244  
COLUMBIA PIKE - MULTIMODAL STREET IMPROVEMENTS  
SEGMENT A

SCALE: HOR. 1" = 30' SHEET: A19.7.1 of A19.8

MODIFICATIONS TO TRAFFIC SIGNAL FOR MAINTENANCE OF TRAFFIC PURPOSES ARE SHOWN IN RED ON THIS PLAN. SIGNAL MODIFICATIONS ARE SHOWN ON TOP OF EXISTING SIGNAL PLAN, WHICH WAS PREPARED BY OTHERS. P.E. SEAL IN BORDER APPLIES ONLY TO SIGNAL MODIFICATIONS SHOWN IN RED. SIGNAL SHALL BE RETURNED TO EXISTING CONDITIONS FOLLOWING COMPLETION OF CORRESPONDING PHASE OF CONSTRUCTION.



DEPARTMENT OF ENVIRONMENTAL SERVICES

11/23/2021  
APPROVAL DATE



TRAFFIC SIGNAL MODIFICATION PLAN - PHASE 3B - COLUMBIA PIKE AND S. ORME STREET  
SEE NOTE 11 ON SHEET A19.1 FOR WORKING HOURS  
POSTED SPEED LIMIT: 30 MPH

PROJECT MANAGER: *Christiano Brant-Dunn, PE* - (703) 259-2960 - VDOT NOVA District  
SURVEYED BY: \_\_\_\_\_  
DESIGN SUPERVISED BY: \_\_\_\_\_  
DESIGNED BY: *Dewberry & Davis, LLC* - (703) 289-4796

Clearance Chart

| R/W | CLEAR | NEXT | Ø  |
|-----|-------|------|----|
| G   | G     | G    | G  |
| G   | Y     | R    | R  |
| ←   | ←     | ←    | ←  |
| ←   | ←     | ←    | ←  |
| G   | Y     | R    | R  |
| G   | Y     | R    | R  |
| G   | Y     | R    | R  |
| R   | R     | R    | R  |
| R   | R     | R    | R  |
| R   | R     | R    | R  |
| R   | R     | R    | R  |
| W   | W     | W    | W  |
| W   | FDW   | DW   | DW |

Street Name Signs

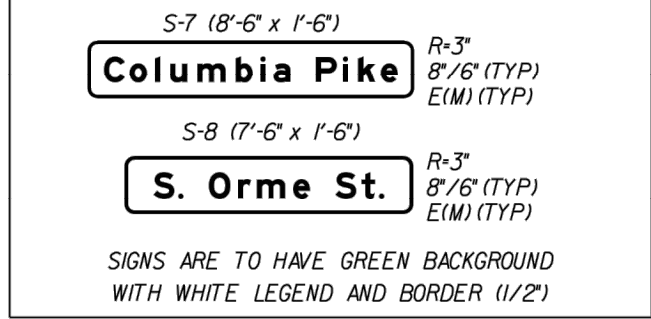

Signs

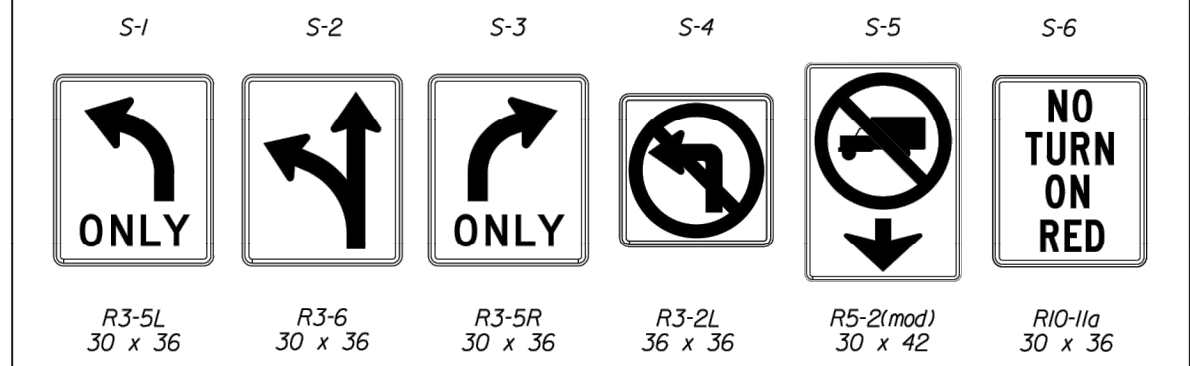

Cable & Conduit Runs

- A) 1-3" CONDUIT  
1 CABLE FOR APS PB6  
1 TC FOR HEAD P2  
1-# AWG EGC
- B) 1-4" BORED CONDUIT  
1 CABLE FOR APS PB6  
1 TC FOR HEAD P2  
1-# AWG EGC
- C) 1-3" CONDUIT  
1 CABLE FOR APS PB5  
1 TC FOR HEADS P2  
2 TC FOR HEADS 4A  
2 CABLES FOR OPTICOM  
2 VIDEO DETECTION CABLES  
1-# AWG EGC
- D) 1-3" CONDUIT  
1 CABLE FOR APS PB4  
1 TC FOR HEADS P3  
1-# AWG EGC
- E) 1-4" BORED CONDUIT  
3 CABLES FOR APS PB4, PB5, PB6  
3 TC FOR HEADS P2, P3  
2 TC FOR HEADS 4A  
2 TC FOR HEADS 4A  
2 CABLES FOR OPTICOM  
2 VIDEO DETECTION CABLES  
1-# AWG EGC
- F) 1-3" CONDUIT  
1 CABLE FOR APS PB3  
1 TC FOR HEAD P3  
1 TC FOR HEADS 3, 3A, 3B  
1 CABLE FOR OPTICOM  
1 VIDEO DETECTION CABLE  
1-# AWG EGC
- G) 1-3" CONDUIT  
1 CABLE FOR APS PB2  
1 TC FOR HEAD P6  
1-# AWG EGC
- H) 1-4" BORED CONDUIT  
5 CABLES FOR APS PB2, PB3, PB4, PB5, PB6  
5 TC FOR HEAD P2, P3, P6  
1 TC FOR HEADS 3, 3A, 3B  
2 TC FOR HEADS 2, 5  
2 TC FOR HEADS 4A  
3 CABLES FOR OPTICOM  
3 CABLES FOR VIDEO DETECTION  
1-# AWG EGC
- I) 1-3" CONDUIT  
1 CABLE FOR APS PB1  
1 TC FOR HEAD P6  
1 CABLE FOR OPTICOM  
1 CABLE FOR VIDEO DETECTION  
1-# AWG EGC
- J) 1-4" CONDUIT  
6 CABLES FOR APS PB1, PB2, PB3, PB4, PB5, PB6  
6 TC FOR HEADS P2, P3, P6  
1 TC FOR HEADS 6  
2 TC FOR HEADS 2, 5  
2 TC FOR HEADS 4A  
1 TC FOR HEADS 3, 3A, 3B  
1-# AWG EGC
- K) 1-1/2" METAL CONDUIT  
3-# AWG EGC  
FOR ELECTRICAL SERVICE
- L) 1-2" PVC CONDUIT  
1-# AWG/L  
FOR ELECTRICAL SERVICE
- M) 1-4" CONDUIT  
1-# AWG EGC  
FOR SYSTEM GROUNDING
- EGC - EQUIPMENT GROUNDING CONDUCTOR  
(S) - SHIELDED CABLE

Pole Locations

|                             | OFFSET: |
|-----------------------------|---------|
| 1 STA 1357-75 COLUMBIA PIKE | 71' LT  |
| 2 STA 1358-37 COLUMBIA PIKE | 46' LT  |
| 3 STA 1358-44 COLUMBIA PIKE | 38' LT  |
| 4 STA 1358-28 COLUMBIA PIKE | 42' RT  |
| 5 STA 1358-38 COLUMBIA PIKE | 40' RT  |
| 6 STA 1357-46 COLUMBIA PIKE | 50' RT  |

X TRAFFIC SIGNAL POLES SHALL BE SUPPLIED WITH AN ORNAMENTAL LUMINAIRE ARM.

Color Sequence Chart

| SIGNAL | PHASE | COMBINATION | FLASH |
|--------|-------|-------------|-------|
| 2      | G     |             | Y     |
| 3      | G     |             |       |
| 4      | G     |             |       |
| 5      | G     |             |       |
| 6      | G     |             |       |
| 25     | G     | G           | Y     |
| 26     | G     | G           |       |
| 3      | ←     |             | R     |
| 3A     | ←     |             | R     |
| 3B     | ←     |             | R     |
| 4      | ←     |             | R     |
| 4A     | ←     |             | R     |
| 6      | ←     |             | R     |
| P2     | W     |             | BLNK  |
| P3     | W     |             | BLNK  |
| P6     | W     |             | BLNK  |

Note: Blank spaces denote red indications. Walk Indication displayed after pedestrian call serviced. Otherwise "Don't Walk" will be displayed.

Signals

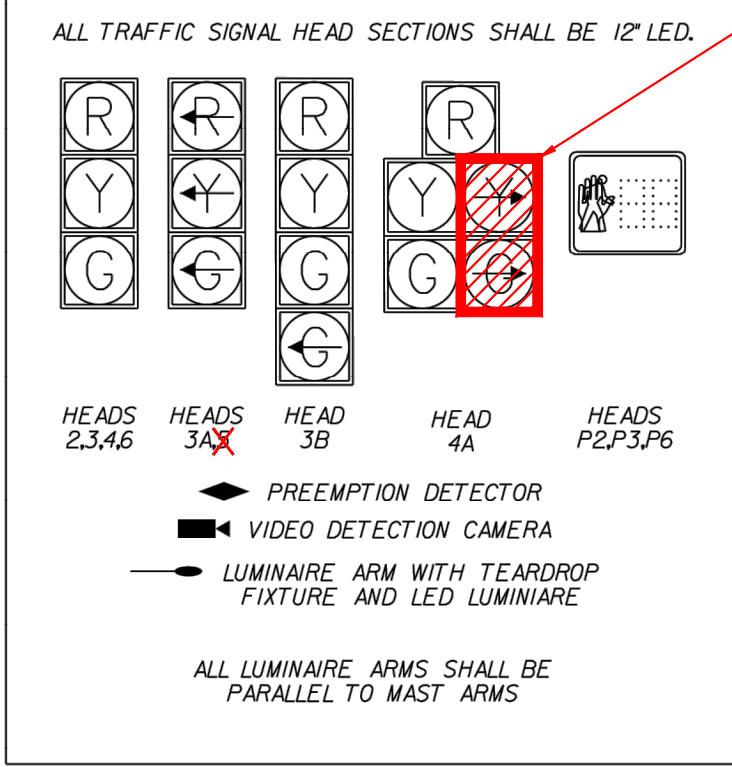

Accessible Pedestrian System (APS) Pushbuttons

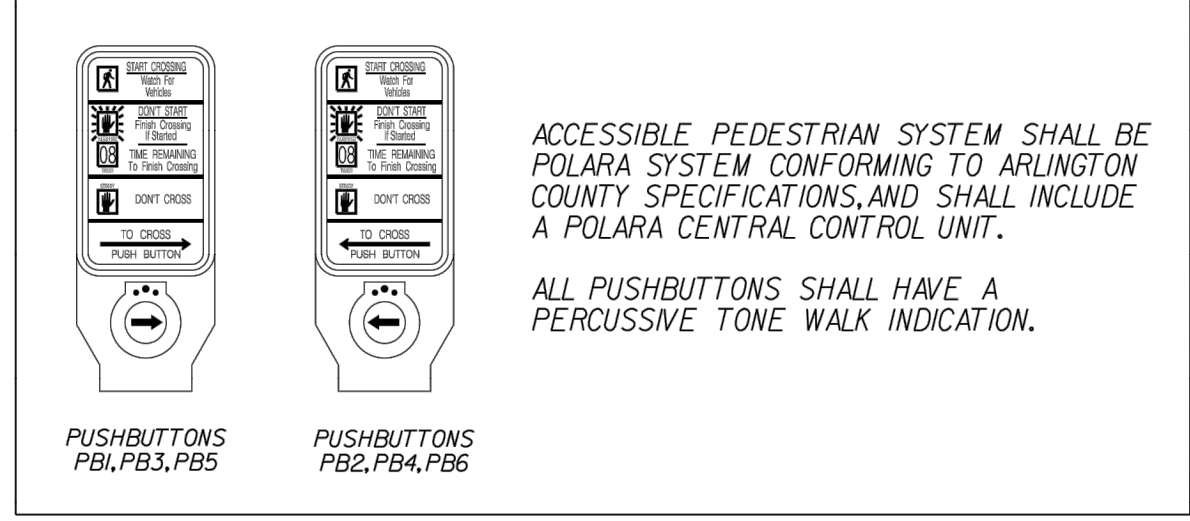

SEE BORDER FOR SCALE

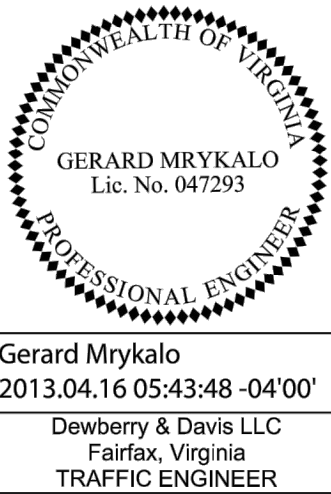

| REVISED           | STATE | ROUTE | PROJECT                       | SHEET NO. |
|-------------------|-------|-------|-------------------------------|-----------|
| 1/9/13<br>4/16/13 | VA    | 27    | 0027-000-VOI<br>RW-201, C-501 | 14(3)     |

DESIGN FEATURES RELATING TO CONSTRUCTION OR TO REGULATION AND CONTROL OF TRAFFIC MAY BE SUBJECT TO CHANGE AS DEEMED NECESSARY BY THE DEPARTMENT

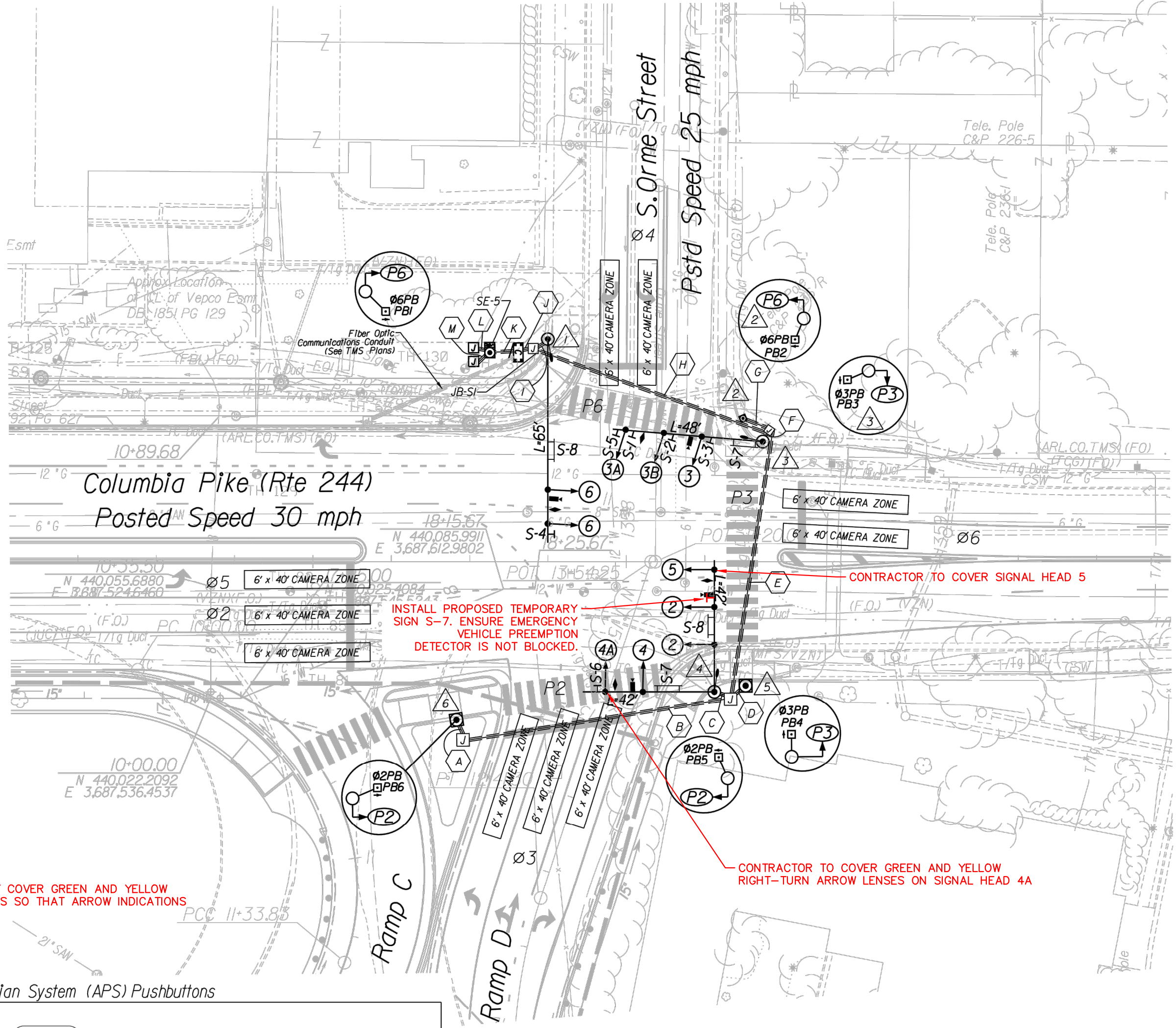

Phasing Diagram

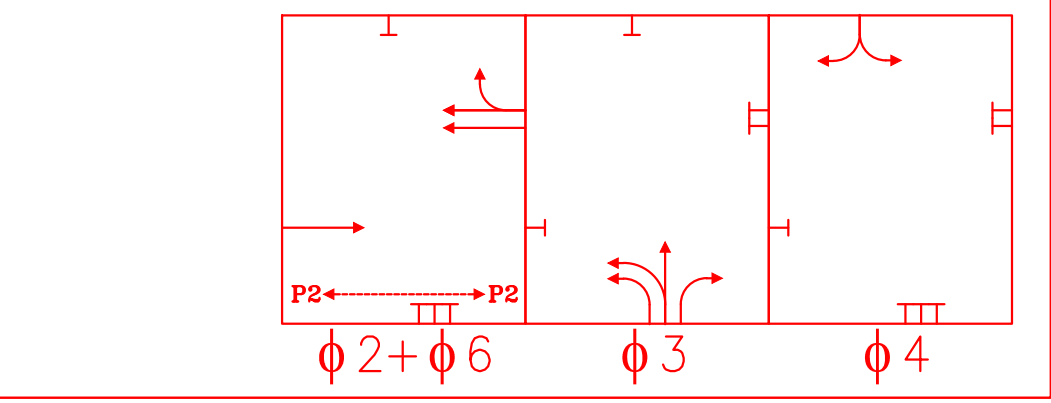

MODIFICATIONS TO TRAFFIC SIGNAL FOR MAINTENANCE OF TRAFFIC PURPOSES ARE SHOWN IN RED ON THIS PLAN. SIGNAL MODIFICATIONS ARE SHOWN ON TOP OF EXISTING SIGNAL PLAN, WHICH WAS PREPARED BY OTHERS. P.E. SEAL IN BORDER APPLIES ONLY TO SIGNAL MODIFICATIONS SHOWN IN RED. SIGNAL SHALL BE RETURNED TO EXISTING CONDITIONS FOLLOWING COMPLETION OF CORRESPONDING PHASE OF CONSTRUCTION.



ARLINGTON  
VIRGINIA

DEPARTMENT OF  
ENVIRONMENTAL SERVICES

Facilities & Engineering Division  
Engineering Bureau  
2100 Clarendon Boulevard, Suite 813  
Arlington, VA 22201  
Phone: 703.228.3629  
Fax: 703.228.3606

Kimley»Horn

Kimley-Horn  
and Associates, Inc.

© 2021 KIMLEY-HORN AND ASSOCIATES, INC.  
11400 Commerce Park Drive, Suite 400  
Reston, Virginia 20191  
Phone: 703-874-1500  
Fax: 703-874-1590

Seal



Approvals Date

Design Team Engineer Supervisor

Construction Management Supervisor

Water, Sewer, Streets Bureau Chief

Transportation Director

Project Manager

Revisions Date

Designed: ATS  
Drawn: ATS  
Checked: MRA  
Miss Utility Transmittal #:

Filename: 010073-A-MOT-TS.dwg  
Path: Z:\NVA\_R00V\11000073-arlington-pike-maintenance-production\11000073-arlington-pike-maintenance-production\11000073-arlington-pike-maintenance-production.dwg  
Plotted: October 28, 2021  
Plotted by: Patrick.Husted

ARLINGTON COUNTY, VIRGINIA  
DEPARTMENT OF ENVIRONMENTAL SERVICES

MAINTENANCE OF TRAFFIC SIGNAL MODIFICATION PLAN  
COLUMBIA PIKE - ROUTE 244  
COLUMBIA PIKE - MULTIMODAL STREET IMPROVEMENTS  
SEGMENT A

SCALE: HOR. 1" = 30' SHEET: A19.7.2 of A19.8



DEPARTMENT OF  
ENVIRONMENTAL SERVICES

11/23/2021  
APPROVAL DATE



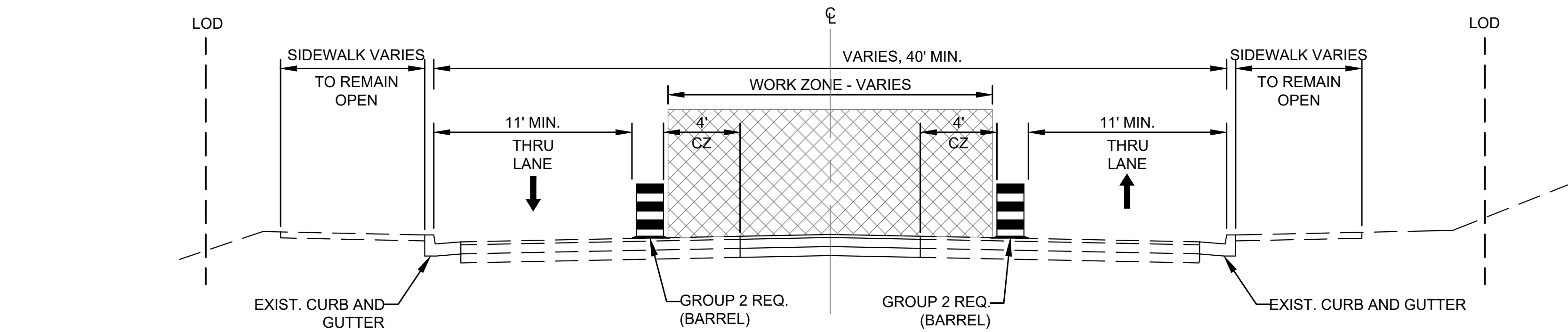

**TYPICAL SECTION - COLUMBIA PIKE - PHASE 1**  
MEDIAN/CENTER LANES

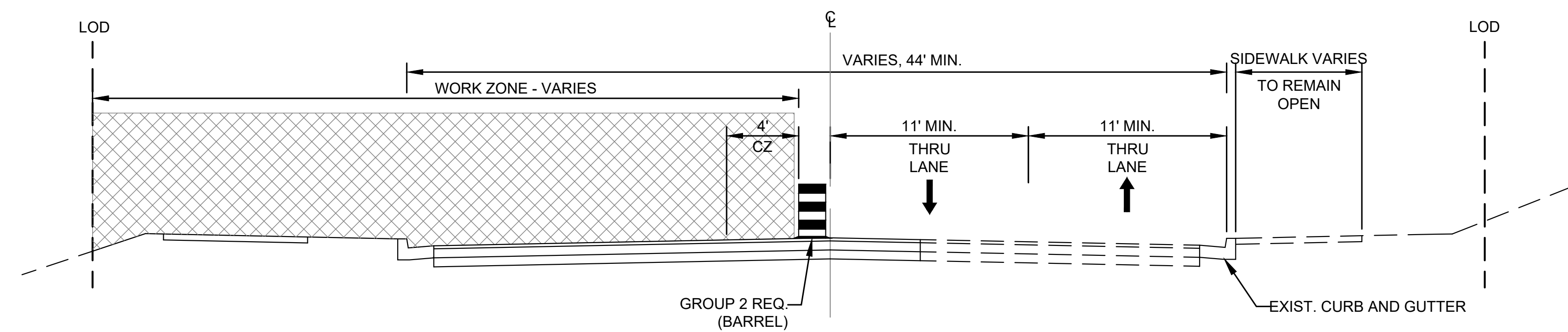

**TYPICAL SECTION - COLUMBIA PIKE - PHASE 2**  
SOUTH/EASTBOUND LANES

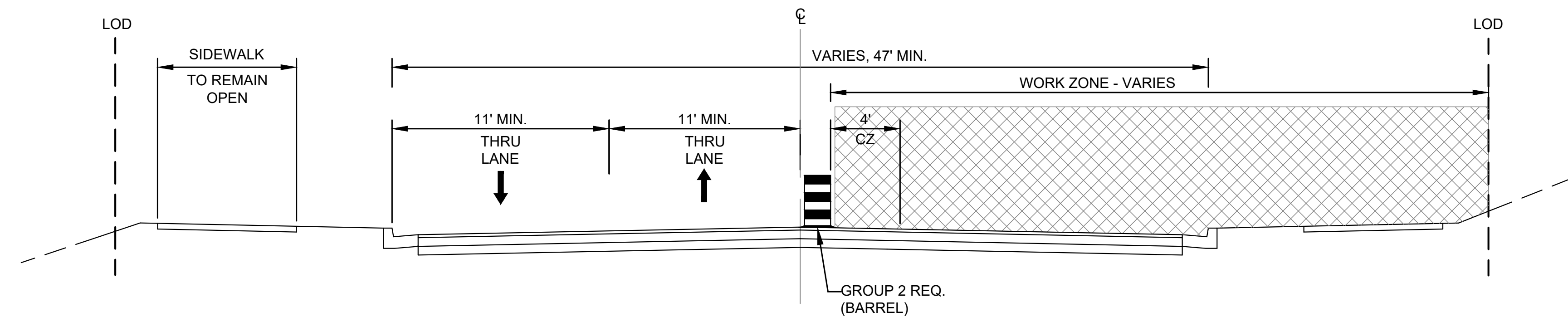

**TYPICAL SECTION - COLUMBIA PIKE - PHASE 3A, 3B**  
NORTH/WESTBOUND LANES

**NOTES**

1. NO CONSTRUCTION PHASE MAY BE COMBINED WITH ANY OTHER PHASE TO CREATE LARGER WORK AREAS THAN SHOWN IN THE PLANS. NO CONSTRUCTION PHASE MAY BE IMPLEMENTED/ACTIVE AT THE SAME TIME AS ANOTHER PHASE TO AVOID MULTIPLE LANE SHIFTS WITHIN THE PROJECT AREA AT ONE TIME.
2. CONSTRUCTION PHASES MUST BE LIMITED TO THE AREAS DESCRIBED HEREIN AND SHOWN IN THE PLANS. WORK AREAS MAY NOT BE EXPANDED BEYOND THE LIMITS SHOWN IN THE PLANS.
3. SHOULD THE CONTRACTOR WISH TO MODIFY, COMBINE, AND/OR OTHERWISE ALTER THE MAINTENANCE OF TRAFFIC OR CONSTRUCTION PHASING SHOWN HEREIN, THE CONTRACTOR SHALL SUBMIT A REQUEST FOR THIS CHANGE ALONG WITH A PROPOSED PLAN SIGNED BY A QUALIFIED AND LICENSED ENGINEER TO ARLINGTON COUNTY FOR REVIEW AND APPROVAL. THE CONTRACTOR SHALL PROCEED ONLY FOLLOWING APPROVAL OF THE REQUESTED CHANGE AND WRITTEN AUTHORIZATION FROM ARLINGTON COUNTY.
4. REFER TO CONSTRUCTION NOTES ON SHEET A19.1 FOR ALLOWABLE WORK HOURS

**SUGGESTED SEQUENCE OF CONSTRUCTION**

UNLESS OTHERWISE APPROVED BY THE ENGINEER AND/OR COUNTY, THE CONTRACTOR IS TO PLAN AND EXECUTE THE WORK ACCORDING TO THE FOLLOWING:

- PHASE 1**
- INSTALL EROSION AND SEDIMENT CONTROL (ESC) MEASURES AS REQUIRED FOR THIS PHASE. APPROVAL OF ESC INSTALLATIONS BY ARLINGTON COUNTY IS REQUIRED.
  - IDENTIFY CONSTRUCTION ACCESS POINTS.
  - INSTALL MOT PHASE 1.
  - CONSTRUCT SANITARY SEWER, PARTICULARLY WHERE IN CLOSE PROXIMITY TO PROPOSED GAS LINES.
  - COORDINATE WITH AND SCHEDULE WASHINGTON GAS CONTRACTOR TO INSTALL PROPOSED GAS MAIN.
  - CONSTRUCT UTILITY DUCT BANKS AND OTHER UTILITIES WITHIN THE WORK ZONE. UTILITY DUCT BANK TO BE EXTENDED IN FUTURE PHASES SHALL BE CAPPED PRIOR TO BACKFILL IN PREPARATION FOR COMPLETION IN SUBSEQUENT PHASES.
  - CONSTRUCT ROADWAY SECTION, LESS TOP COURSE OF PAVEMENT, WITHIN THE WORK ZONE. TEMPORARY RECOVERY AREAS AND OTHER SAFETY MEASURES AS REQUIRED BY THE VA WAPM SHALL BE INSTALLED AS NECESSARY.
- PHASE 2**
- INSTALL ESC MEASURES AS REQUIRED FOR THIS PHASE. APPROVAL OF ESC INSTALLATIONS BY ARLINGTON COUNTY IS REQUIRED.
  - IDENTIFY CONSTRUCTION ACCESS POINTS.
  - INSTALL MOT PHASE 2
  - INSTALL TEMPORARY EASTBOUND BUS STOP IN LOCATION SHOWN ON THE PLANS. TEMPORARY BUS STOP SHALL REMAIN CLEAR AND ACCESSIBLE FOR THE DURATION OF THIS PHASE. TEMPORARY BUS STOP MAY BE REMOVED UPON OPENING OF PROPOSED EASTBOUND TRANSIT STOP.
  - CONSTRUCT UTILITY DUCT BANK AND OTHER UTILITIES WITHIN THE WORK ZONE, INCLUDING OUTSIDE THE ROADWAY.
  - CONSTRUCT ROADWAY SECTION, LESS TOP COURSE OF PAVEMENT, WITHIN THE WORK ZONE. CONSTRUCT CURB AND GUTTER, SIDEWALK, AND OTHER PROPOSED IMPROVEMENTS ON THE SOUTH SIDE OF COLUMBIA PIKE.
- PHASE 3A**
- INSTALL ESC MEASURES AS REQUIRED FOR THIS PHASE. APPROVAL OF ESC INSTALLATIONS BY ARLINGTON COUNTY IS REQUIRED.
  - IDENTIFY CONSTRUCTION ACCESS POINTS.
  - INSTALL MOT PHASE 3A.
  - INSTALL TEMPORARY BUS STOP IN LOCATION SHOWN ON THE PLANS. TEMPORARY BUS STOP SHALL REMAIN CLEAR AND ACCESSIBLE FOR THE DURATION OF THIS PHASE.
  - CONSTRUCT UTILITY DUCT BANK AND OTHER UTILITIES WITHIN THE WORK ZONE, INCLUDING OUTSIDE THE ROADWAY.
  - CONSTRUCT ROADWAY SECTION, LESS TOP COURSE OF PAVEMENT, WITHIN THE WORK ZONE. CONSTRUCT CURB AND GUTTER, SIDEWALK, AND OTHER PROPOSED IMPROVEMENTS ON THE NORTH SIDE OF COLUMBIA PIKE WITHIN THE WORK AREAS IDENTIFIED.
- PHASE 3B**
- INSTALL ESC MEASURES AS REQUIRED FOR THIS PHASE. APPROVAL OF ESC INSTALLATIONS BY ARLINGTON COUNTY IS REQUIRED.
  - IDENTIFY CONSTRUCTION ACCESS POINTS.
  - INSTALL MOT PHASE 3B.
  - TEMPORARY BUS STOP INSTALLED FOR PHASE 3A MAY BE REMOVED UPON OPENING OF PROPOSED WESTBOUND TRANSIT STOP. TRANSIT STOP SHALL REMAIN CLEAR AND ACCESSIBLE FOR THE DURATION OF THIS PHASE.
  - COMPLETE UTILITY DUCT BANK AND OTHER UTILITY INSTALLATIONS WITHIN THE WORK ZONE INCLUDING OUTSIDE THE ROADWAY.
  - CONSTRUCT ROADWAY SECTION, LESS TOP COURSE OF PAVEMENT, WITHIN THE WORK ZONE. COMPLETE CURB AND GUTTER, SIDEWALK, AND OTHER PROPOSED IMPROVEMENTS ON THE NORTH SIDE OF COLUMBIA PIKE WITHIN THE WORK AREAS IDENTIFIED.
  - INSTALL TOP COURSE OF PAVEMENT, PLACE ALL REMAINING SIGNING AND MARKING, AND COMPLETE PROJECT.



DEPARTMENT OF  
ENVIRONMENTAL SERVICES

Facilities & Engineering Division  
Engineering Bureau  
2100 Clarendon Boulevard, Suite 813  
Arlington, VA 22201  
Phone: 703.228.3629  
Fax: 703.228.3606

**Kimley»Horn**  
Kimley-Horn  
and Associates, Inc.  
©2021 KIMLEY-HORN AND ASSOCIATES, INC.  
11400 Commerce Park Drive, Suite 400  
Reston, Virginia 20191  
Phone: 703-674-1300  
Fax: 703-674-1300

Seal



Approvals \_\_\_\_\_ Date \_\_\_\_\_

Design Team Engineer Supervisor \_\_\_\_\_

Construction Management Supervisor \_\_\_\_\_

Water, Sewer, Streets Bureau Chief \_\_\_\_\_

Transportation Director \_\_\_\_\_

Project Manager \_\_\_\_\_

| Revisions | Date |
|-----------|------|
|           |      |
|           |      |
|           |      |
|           |      |
|           |      |
|           |      |
|           |      |
|           |      |
|           |      |
|           |      |

Designed: EJD  
Drawn: OCD  
Checked: MRA  
Miss Utility Transmittal #:

Filename: 010073-A-MOT-TYP.dwg  
Path: C:\NVA\_RDP\Y110010073\_columbia\_pike\_multimodal\production\work  
design\010073-A-MOT-TYP.dwg  
Plotted: October 28, 2021  
Plotted by: Patrick.Husted

ARLINGTON COUNTY, VIRGINIA  
DEPARTMENT OF ENVIRONMENTAL SERVICES

MOT TYPICAL SECTIONS  
COLUMBIA PIKE - ROUTE 244  
COLUMBIA PIKE - MULTIMODAL STREET IMPROVEMENTS  
SEGMENT A

SCALE: NOT TO SCALE SHEET: A19.8 of A19.8



DEPARTMENT OF  
ENVIRONMENTAL SERVICES

11/23/2021  
APPROVAL DATE



**customrock**  
FORMLINER

Elastomeric formliners are high end liners that capture pattern details with precision. They couple strength with excellent pattern reproduction. The embedded plywood allows ease of handling and installation for cast in place and precast form systems. They have a multiple reuse factor, subject to pattern configuration and proper handling.

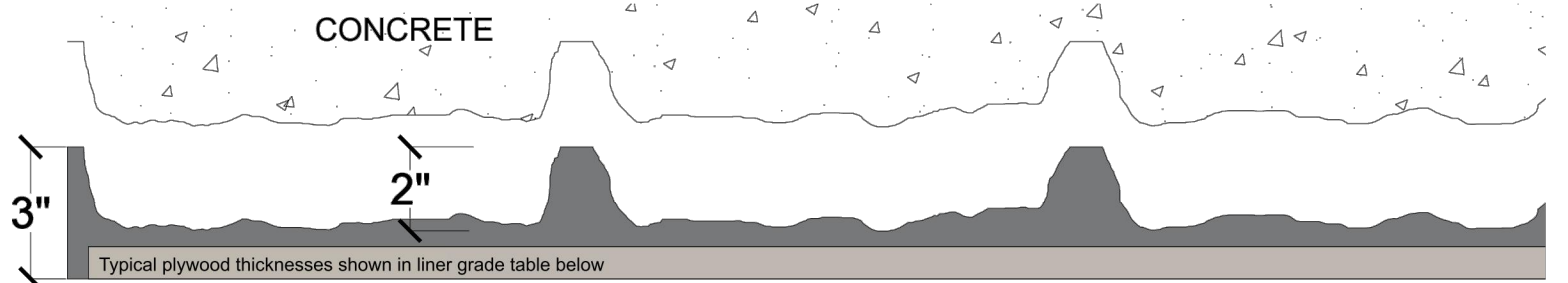

**\*Typical liner thickness shown. Final thickness will be determined on a per job basis.**

**\*\*Representational pattern layout shown. Layout made up of multiple liner modules.**

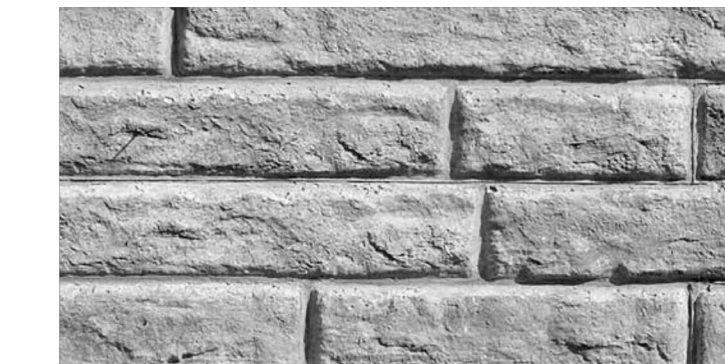
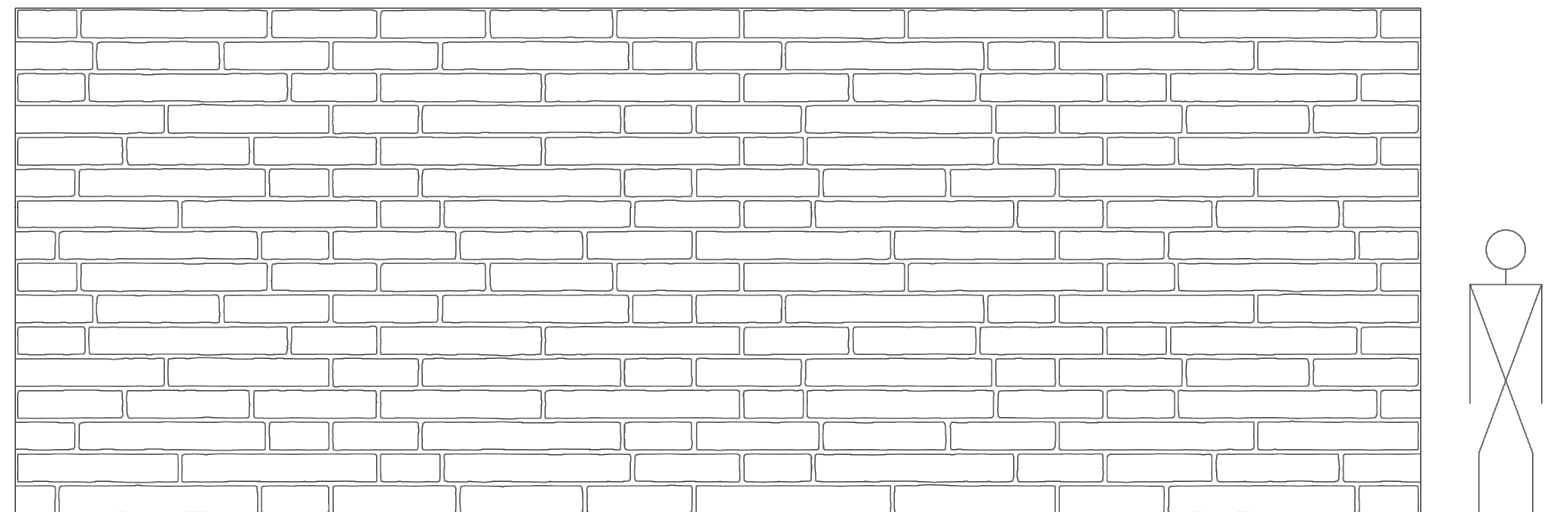

**Stone Size:**  
7" (height)  
7" - 50" (width)

**Care and Handling:**

- Keep out of the sunlight and covered when not in use
- Keep away from steam, acids, and certain fuels
- Do not expose to temperatures >150°F (65.5°C)
- For further instructions refer to the application guide

| Available Grades: | Duraform   | Hi-Lite   | Multi-Lite  | Cut-Lite   |
|-------------------|--|---|---|--|
| Description:      | High reuse /<br>Heavy Weight /<br>3/4" Plywood Typical | High reuse /<br>Lightweight /<br>1/2" Plywood Typical | Medium reuse /<br>Lightweight /<br>1/2" Plywood Typical | Low reuse /<br>Lightweight /<br>1/2" Plywood Typical |

**Custom Rock Formliner • 2020 West 7th Street • St. Paul, MN 55116 • (800) 637-2447**  
**[www.customrock.com](http://www.customrock.com)**

**NOTE:** HORIZONTAL GROUT LINES IN FORMLINER SHALL BE LAID LEVEL REGARDLESS OF GRADE AT FACE OF WALL. HORIZONTAL GROUT LINES SHALL BE CONTINUOUS ACROSS ALL EXPANSION AND CONTROL JOINTS.

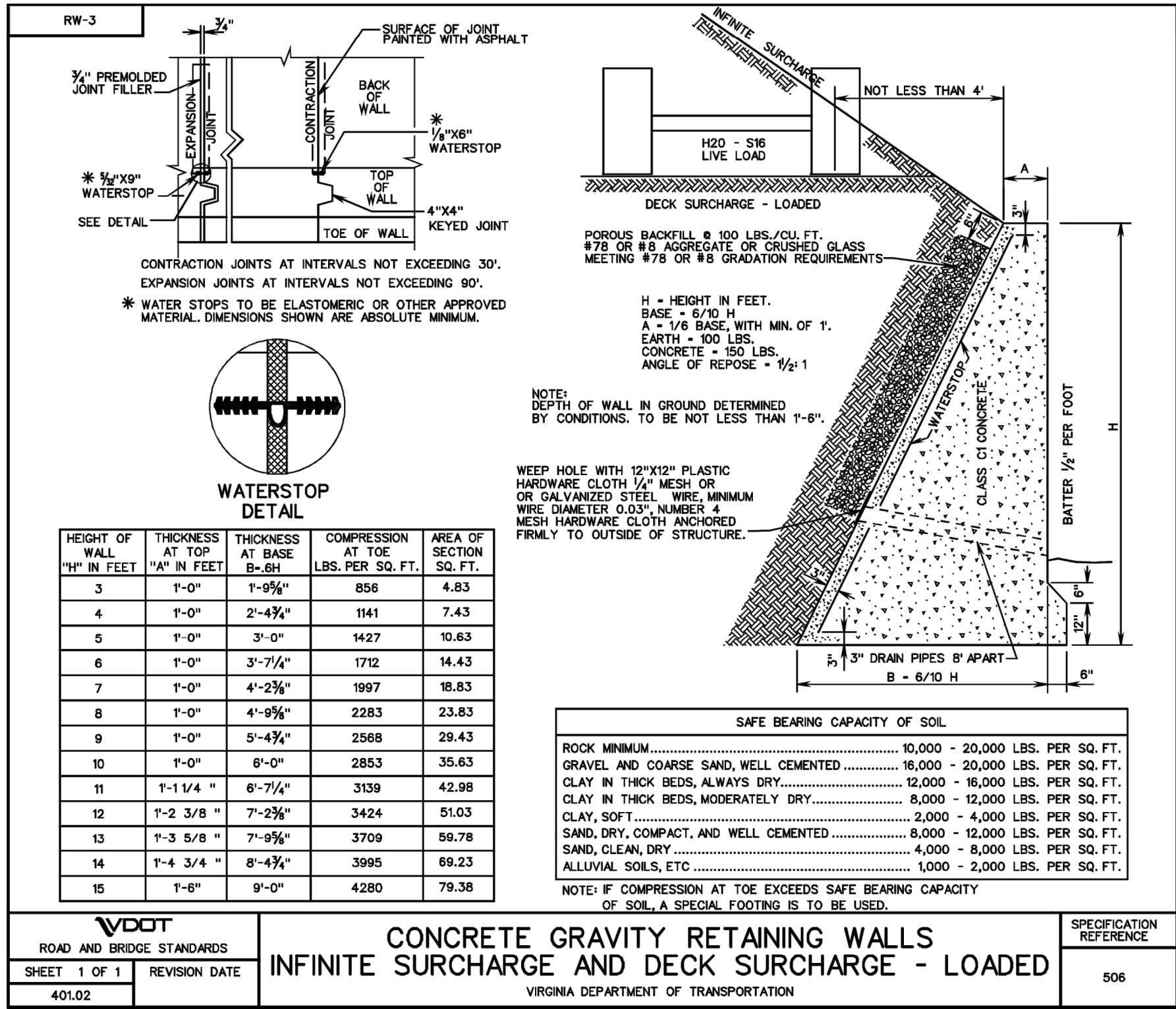
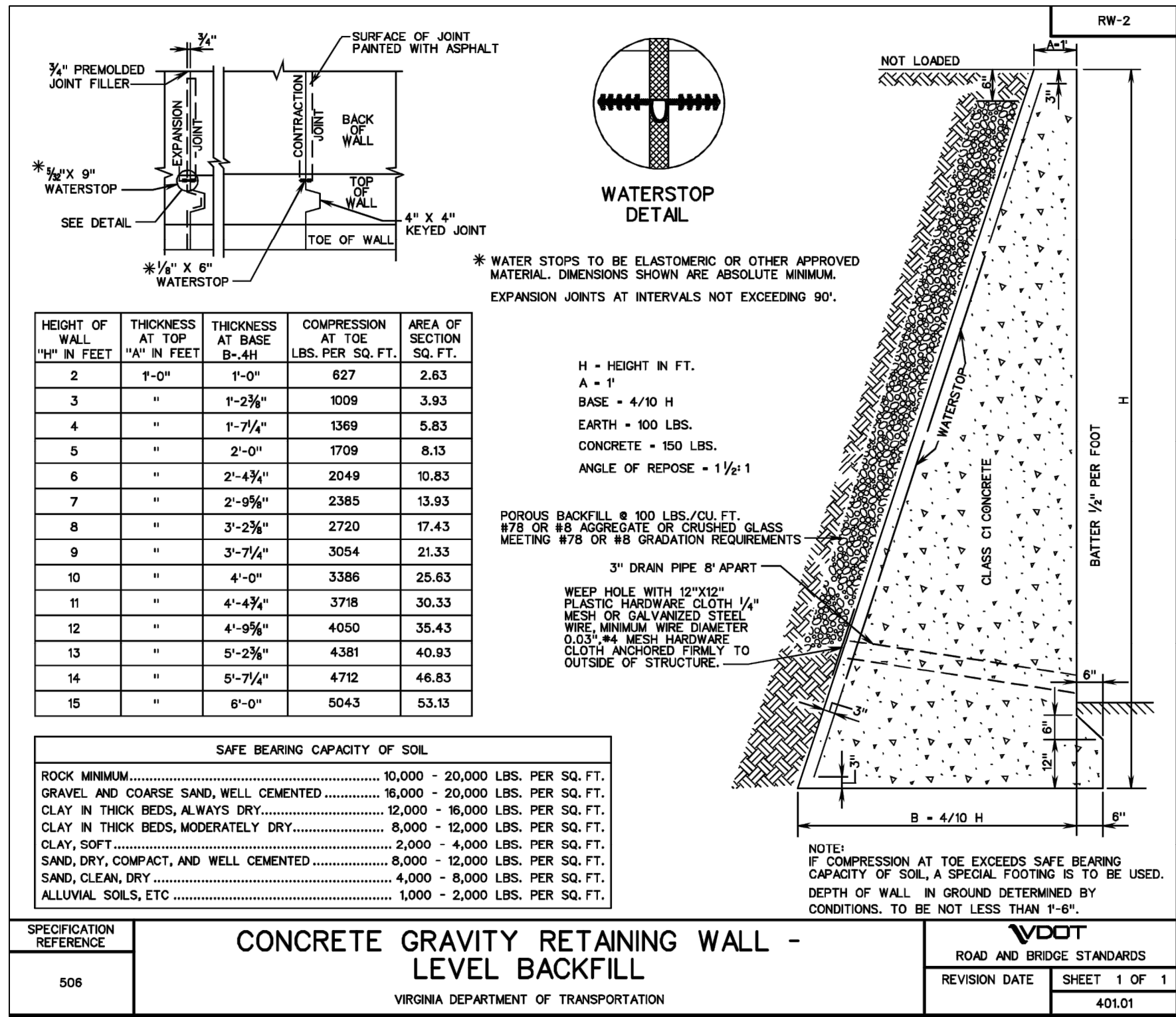

## NOTES

- RETAINING WALLS TO BE VDOT STANDARD RW-2 OR RW-3 CONCRETE GRAVITY RETAINING WALLS WHERE EXISTING CONDITIONS AND AVAILABLE RIGHT OF WAY OR EASEMENTS ALLOW (SEE VDOT STANDARD DRAWINGS 401.01 AND 401.02 THIS SHEET). IN CONSTRAINED AREAS AND WHERE APPROPRIATE, H-PILE GRATED WALLS WITH LAGGING SHALL BE INSTALLED USING TOP-DOWN CONSTRUCTION.
2. IN CONSTRAINED AREAS AND WHERE APPROPRIATE, CONTRACTOR MAY ELECT TO UTILIZE H-PILE GRATED WALLS WITH LAGGING USING TOP-DOWN CONSTRUCTION. H-PILE WALLS, IF UTILIZED, SHALL BE DESIGNED AND PLANS SIGNED AND SEALED BY A PROFESSIONAL ENGINEER REGISTERED IN THE COMMONWEALTH OF VIRGINIA. SEALED PLANS AND CALCULATIONS SHALL BE SUBMITTED TO ARLINGTON COUNTY FOR REVIEW AND APPROVAL PRIOR TO BEGINNING CONSTRUCTION.
3. ALL PROPOSED RETAINING WALLS, INCLUDING CONCRETE GRAVITY WALLS AND H-PILE GRATED WALLS, SHALL INCLUDE CUSTOM ROCK® FORMLINER, "RUNNING BOND STONE PATTERN #1106-R2 (SEE SPECIFICATION - THIS SHEET), OR APPROVED EQUAL. SHOULD THE CONTRACTOR ELECT TO USE AN ALTERNATIVE RETAINING WALL FORMLINER, SHOP DRAWINGS AND SPECIFICATIONS FOR THE ALTERNATE FORMLINER SHALL BE SUBMITTED TO ARLINGTON COUNTY FOR REVIEW AND APPROVAL.
4. FORMLINER TO BE APPLIED TO ALL PROPOSED RETAINING WALLS (SEE NOTE 3) SHALL HAVE 2" RELIEF AND 12" COURSING.
5. CONTRACTOR SHALL FIELD VERIFY ALL EXISTING ITEMS TO BE IMPACTED BY CONSTRUCTION OF ALL RETAINING WALLS, AND SHALL NOTIFY ARLINGTON COUNTY BEFORE RETAINING WALL INSTALLATION OF ANY ITEMS TO BE IMPACTED BY INSTALLATION THAT ARE NOT EXPLICITLY CALLED OUT FOR REMOVAL OR RELOCATION IN THE PLANS.
6. LIMITS OF DISTURBANCE ARE GENERALLY TIGHT, AND RETAINING WALL INSTALLATION MAY REQUIRE SLOPE STABILIZATION DEPENDING ON TECHNIQUES USED FOR WALL CONSTRUCTION. NO ADDITIONAL EASEMENTS OR DISTURBANCE AREA BEYOND THOSE SHOWN ON THE PLANS SHALL BE PERMITTED WITHOUT ARLINGTON COUNTY APPROVAL AND PROPERTY OWNER APPROVAL.
7. BASE OF RETAINING WALLS SHALL BE EMBEDDED FOR FROST PROTECTION. EMBEDMENT DEPTH SHALL NOT BE LESS THAN 1'-6" PER VDOT STANDARD RW-2 AND RW-3 (SEE DETAILS THIS SHEET). CONTRACTOR SHALL VERIFY EMBEDMENT DEPTH BASED ON FIELD SOIL CONDITIONS PRIOR TO WALL CONSTRUCTION.
8. CONTRACTOR SHALL VERIFY REQUIRED BEARING CAPACITY AND BACKFILL REQUIREMENTS. CALCULATIONS SEALED BY A PROFESSIONAL ENGINEER SHALL BE SUBMITTED TO THE OWNER FOR APPROVAL PRIOR TO WALL CONSTRUCTION.
9. RETAINING WALLS TO USE CLASS A-3 CONCRETE.

ARLINGTON COUNTY, VIRGINIA  
DEPARTMENT OF ENVIRONMENTAL SERVICES

RETAINING WALL DETAILS  
COLUMBIA PIKE - ROUTE 244  
COLUMBIA PIKE - MULTIMODAL STREET IMPROVEMENTS  
SEGMENT A

|        |     |        |                |
|--------|-----|--------|----------------|
| SCALE: | N/A | SHEET: | A20.1 of A20.3 |
|--------|-----|--------|----------------|



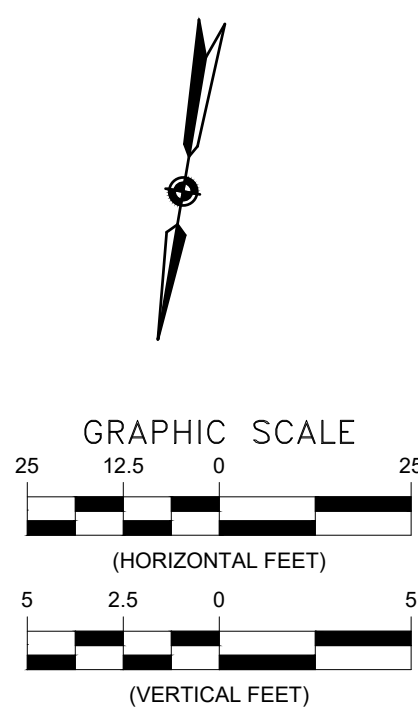
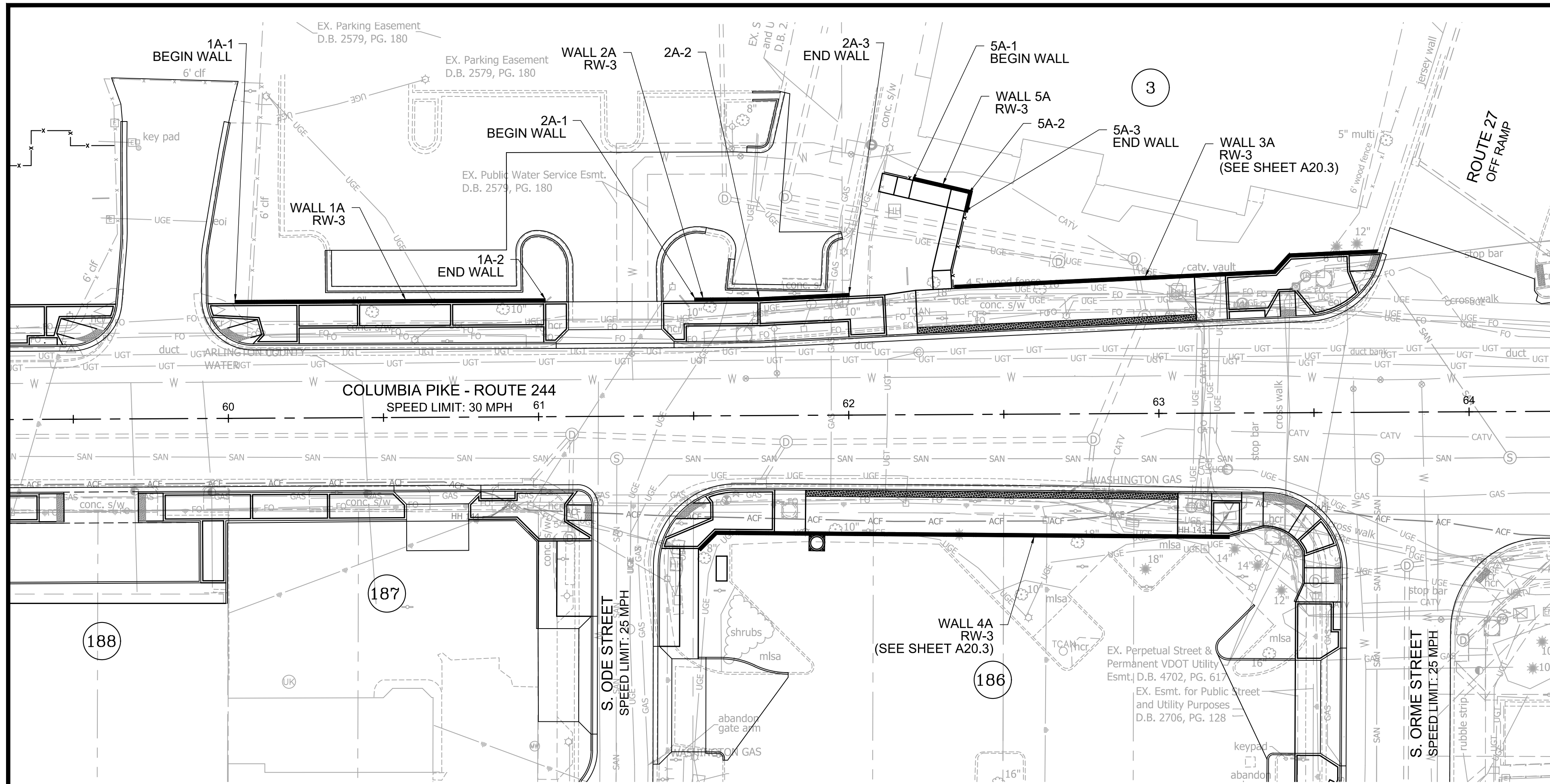

NOTES:

- SEE SHEET A20.1 FOR RETAINING WALL STANDARD DETAILS AND SPECIFICATIONS.
- OFFSETS SHOWN FOR WALL GEOMETRY POINTS ARE MEASURED TO THE FACE OF WALL FROM THE RESPECTIVE ALIGNMENT USED. (SEE POINT OF OFFSET DETAIL - THIS SHEET).
- RET. WALL 1A SHALL HAVE A VDOT STD. HR-1 TYPE II HANDRAIL INSTALLED FOR THE ENTIRE LENGTH OF THE WALL (SEE DETAIL SHEET A20.1).

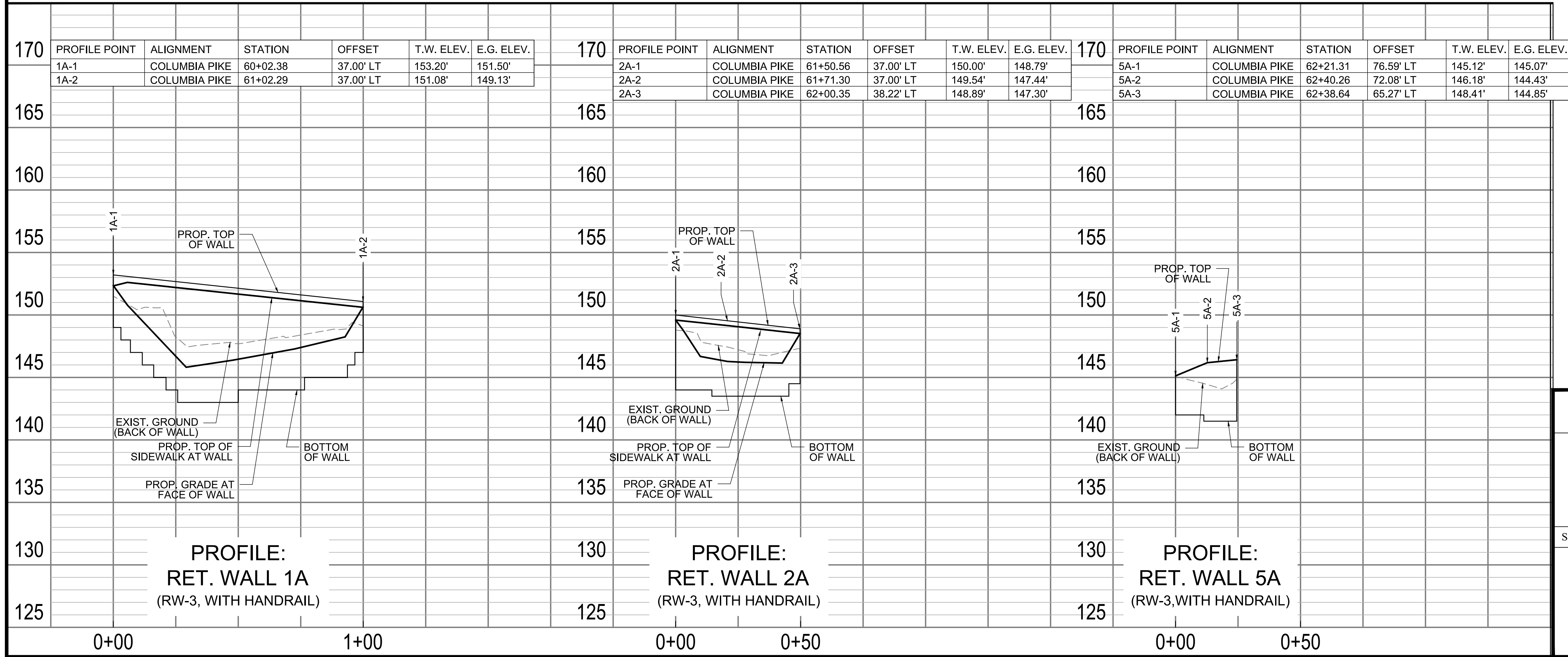
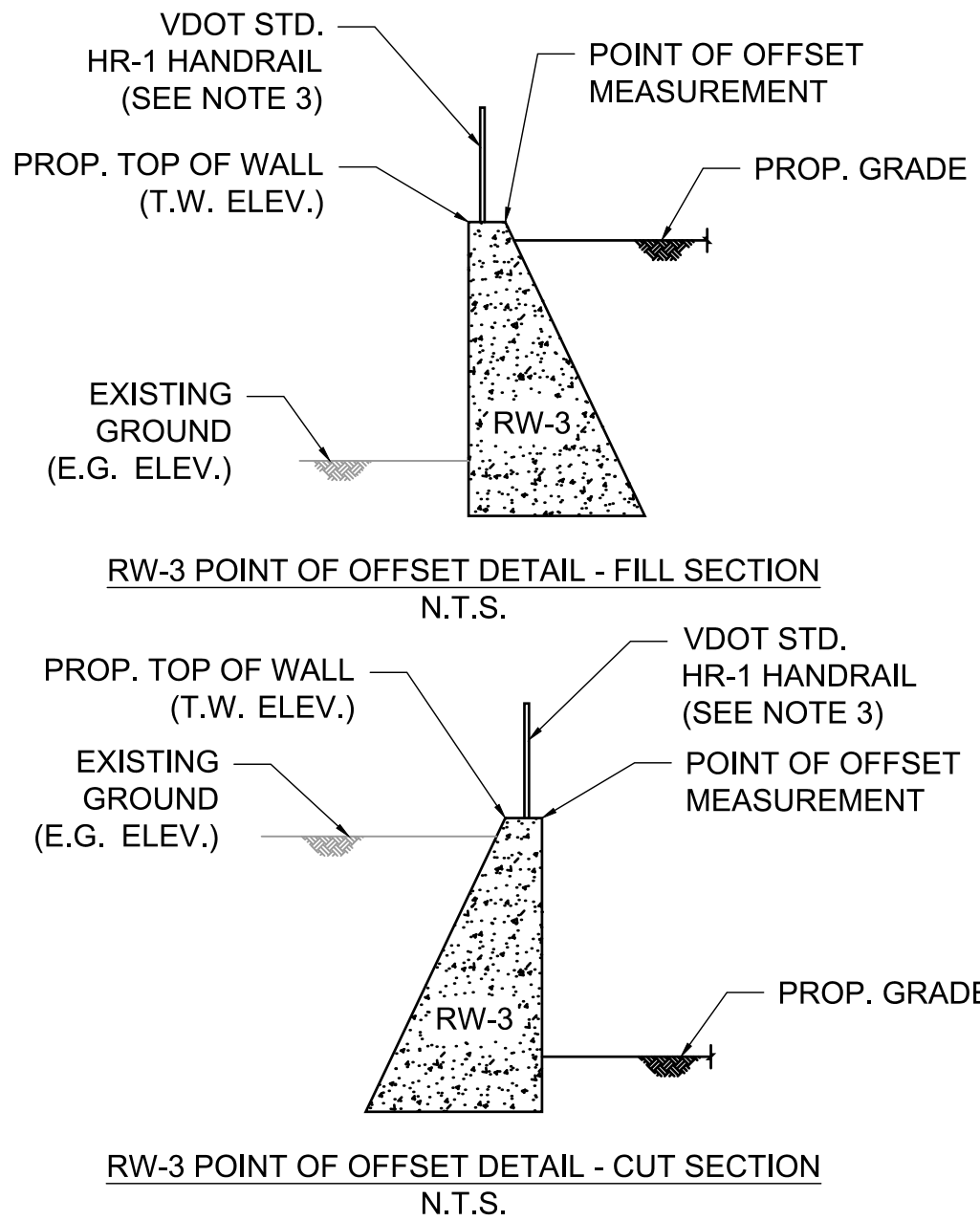

DEPARTMENT OF ENVIRONMENTAL SERVICES

Facilities & Engineering Division  
Engineering Bureau  
2100 Clarendon Boulevard, Suite 813  
Arlington, VA 22201  
Phone: 703.228.3629  
Fax: 703.228.3606

**Kimley»Horn**  
Kimley-Horn  
and Associates, Inc.  
© 2021 KIMLEY-HORN AND ASSOCIATES, INC.  
11400 Commerce Park Drive, Suite 400  
Reston, Virginia 20191  
Phone: 703-674-1500  
Fax: 703-674-1500

Seal



Approvals Date

Design Team Engineer Supervisor

Construction Management Supervisor

Water, Sewer, Streets Bureau Chief

Transportation Director

Project Manager

Revisions Date

Designed: EJD  
Drawn: EJD  
Checked: MRA  
Miss Utility Transmittal #:

Filename: 010073-A-WALL.dwg  
Path: C:\Users\jason\OneDrive\Documents\010073-A-WALL.dwg  
Plotted: October 28, 2021  
Plotted by: Patrick.Husted

ARLINGTON COUNTY, VIRGINIA  
DEPARTMENT OF ENVIRONMENTAL SERVICES

RET. WALL ELEVATION PROFILES  
COLUMBIA PIKE - ROUTE 244  
COLUMBIA PIKE - MULTIMODAL STREET IMPROVEMENTS  
SEGMENT A

SCALE: HOR. 1" = 25' VERT. 1" = 5' SHEET: A20.2 of A20.3



DEPARTMENT OF ENVIRONMENTAL SERVICES

11/23/2021  
APPROVAL DATE















LEGEND

Prop. Storm Catch Basin

Ex. Storm Catch Basin

Prop. Storm Gate

Ex. Storm Gate

Prop. Storm MH

Ex. Storm MH

Prop. Sanitary MH

Ex. Sanitary MH

Prop. Cobra Head Light

Prop. Carlyle Light

Prop. Light Pole (BY Others)

Ex. Light Pole

Prop. Utility Pole

Ex. Utility Pole

Ex. Utility MH (Type Indicated Elec. Tele. etc)

Ex. Traffic Control Box

Prop. Water MH

Ex. Water MH

Prop. Water Valve

Ex. Water Valve

Prop. Water FH

Ex. Water FH

Prop. Water Meter

Ex. Water Meter

P.K. Nail Found

P.K. Nail Set

Rebar Rod Found

Rebar Rod Set

Iron Pipe

Monument (GPS)

Monument

To Be Removed (TBR)

Traffic Sign

Guy Wires

Prop. Gas Valve

Ex. Gas Valve

Prop. Handicap Ramp

Ex. Handicap Ramp

Metro Station

Benchmark

Deciduous Tree

Coniferous Tree

Shrub

Wooded Area

Bridge

North Arrow

Telephone Ped.

Electric Box

Cable Ped.

Gas Marker

Construction Notes  
(Leader to area affected)

C1 Curve Number (See Curve Table)

L1 Line Number (See Line Table)

Ex. Sanitary Sewer Structure Number  
(Number obtained from WSE)

Ex. Storm Sewer Structure Number  
(Number obtained from WSE)

Prop. Sanitary Sewer Structure Number  
(Number obtained from WSE)

Prop. Storm Sewer Structure Number  
(Number obtained from WSE)

Parking Meter

Mailbox

Ground Light

Traverse

Bus Sign

Abbreviations

DEV

DOMINION VIRGINIA POWER

VZN

VERIZON

COM

COMCAST

TBR

TO BE REMOVED

CE

CONCRETE ENCASED

DB

DUCTBANK

TH

TEST HOLE/PIT

ESMT

EASEMENT

LP

LIGHT POLE

COND

CONDUIT

MANHOLE DIAGRAMS

NOT TO SCALE

PROPOSED CONDUIT

EXISTING CONDUIT

EXISTING CONDUIT (SPARE)

EMPTY WINDOW

8'x16'x8' DEV MANHOLE (0'-5' COVER) (MH #1)

17.00'

9.33'

8.00'

16.00'

9.00'

BOTTOM OF LARGE MH

LARGE MANHOLE TOP

16.00'

8.00'

17.00'

8'x16'x8' DEV MANHOLE (5'-10' COVER) (MH #2)

17.33'

9.33'

8.00'

16.00'

9.33'

BOTTOM OF LARGE MH

LARGE MANHOLE TOP

16.00'

8.00'

17.33'

6'x12'x7' DEV MANHOLE (0'-5' COVER) (MH #3)

12.00'

7.00'

6.00'

13.00'

7.00'

BOTTOM OF MH

MANHOLE TOP

12.00'

6.00'

13.00'

8'x16'x10' DEV MANHOLE (0'-5' COVER) (MH #4)

17.00'

11.33'

9.00'

16.00'

10.00'

BOTTOM OF MH

LARGE MANHOLE TOP

16.00'

8.00'

17.00'

PROP. DEV MANHOLE #1 (0'-5' COVER)

SOUTH WALL

PROPOSED 2-8" CE PVC DUCTBANK, STUB OUT (2W X 2H)

EAST WALL

PROPOSED 4-8" CE PVC DUCTBANK 'DEV-1' (2W X 2H)

WEST WALL

PROPOSED 4-8" CE PVC DUCTBANK 'DEV-1' (2W X 2H)

NORTH WALL

BOTTOM OF MH

EX. DEV MANHOLE #C1017 GJ53

SOUTH WALL

APPROX. LOCATION EXISTING 8-6" CE PVC DUCTBANK (2W X 4H)

EAST WALL

APPROX. LOCATION EXISTING 8-6" CE PVC DUCTBANK (2W X 4H)

WEST WALL

PROPOSED 2-8" CE PVC DUCTBANK 'DEV-1.4' (2W X 1H)

NORTH WALL

BOTTOM OF MH

PROP. DEV MANHOLE #2 (5'-10' COVER)

SOUTH WALL

PROPOSED 2-8" & 3-4" CE PVC DUCTBANK (2W X 2H)

EAST WALL

PROPOSED 1-4" & 4-8" CE PVC DUCTBANK 'DEV-1' (2W X 3H)

WEST WALL

PROPOSED 2-8" CE PVC DUCTBANK (2W X 1H)

NORTH WALL

PROPOSED 2-4" & 4-8" CE PVC DUCTBANK 'DEV-1' (2W X 3H)

BOTTOM OF MH

EX. DEV MANHOLE #186

SOUTH WALL

APPROX. LOCATION EXISTING 2-6", 2-8" & 2-6" ELECTRIC CONDUIT (2W X 3H)

EAST WALL

PROPOSED 4-8" CE PVC DUCTBANK 'DEV-5.2' (2W X 2H)

WEST WALL

APPROX. LOCATION EXISTING 2-6" ELECTRIC CONDUIT (2W X 1H)

NORTH WALL

APPROX. LOCATION EXISTING 1-8" ELECTRIC CONDUIT (1W X 1H)

BOTTOM OF MH

DOMINION ENERGY DUCTBANKS

2-8"

1-4"

1-4" & 4-8"

4-8"

2-4" & 4-8"

6-8"

8-8"

3-4" & 4-8"

1-4" & 6-8"

1-4" & 8-8"

ARLINGTON COUNTY, VIRGINIA  
DEPARTMENT OF ENVIRONMENTAL SERVICES

DRY UTILITY DETAILS  
COLUMBIA PIKE - ROUTE 244  
MULTIMODAL STREET IMPROVEMENTS  
SEGMENT A

SCALE:HOR. 1" = 25' VERT. 1" = 5'

SHEET: A21.3 of A21.14

DEPARTMENT OF  
ENVIRONMENTAL SERVICES

Facilities & Engineering Division  
Engineering Bureau  
2100 Clarendon Boulevard, Suite 813  
Arlington, VA 22201  
Phone: 703.228.3629  
Fax: 703.228.3606

**Rinker Design  
Associates, P.C.**  
11100 Endeavor Court, Suite 200, Manassas VA, 20109  
www.rdcivil.com  
Telephone: (703) 368-7373

Approvals Date

Design Team Engineer Supervisor

Construction Management Supervisor

Water, Sewer, Streets Bureau Chief

Transportation Director

Project Manager

Revisions Date

Designed: BMY  
Drawn: BMY, KCC  
Checked: SDD  
Miss Utility Transmittal #:

Filename: 010073-A21-DETAILS.dwg  
Path:  
Plotted: September 01, 2021  
Plotted by: ccorcoran

DEPARTMENT OF  
ENVIRONMENTAL SERVICES

11/23/2021  
APPROVAL DATE