

EXISTING



DEPARTMENT OF
ENVIRONMENTAL SERVICES

Facilities & Engineering Division
Engineering Bureau
2100 Clarendon Boulevard, Suite 813
Arlington, VA 22201
Phone: 703.228.3629
Fax: 703.228.3606

Kimley»Horn
Kimley-Horn
and Associates, Inc.

©2021 KIMLEY-HORN AND ASSOCIATES, INC.
11400 Commerce Park Drive, Suite 400
Reston Virginia 20191
Phone: 703-674-1300
Fax: 703-674-1350

Seal



Approvals	Date
-----------	------

Design Team Engineer Supervisor

Construction Management Supervisor

Water, Sewer, Streets Bureau Chief

Transportation Director

Project Manager

[illegible]

Designed: EJD
 Drawn: JGJ
 Checked: MRA
 Miss Utility Transmittal #:

Filename: 010073-F-XS401.dwg
 Path: K:\NA_RDWY\110010073 Columbia Pike Multimodal Production\Task
 Design\Final Design of Columbia Pike Segments\Segment F17 S2 - 100%
 Design\SheetSheets
 Plotted: September 02, 2021
 Plotted by: patrick.husted

ARLINGTON COUNTY, VIRGINIA
DEPARTMENT OF ENVIRONMENTAL SERVICES

ROADWAY CROSS SECTIONS
COLUMBIA PIKE - ROUTE 244
COLUMBIA PIKE - MULTIMODAL STREET IMPROVEMENTS
SEGMENT F
STA. 148+75.00 TO STA. 150+00

SCALE:	HOR. 1" = 10' VERT. 1" = 10'	SHEET:	F16.12 of F16.33
--------	------------------------------	--------	------------------

DEPARTMENT OF
ENVIRONMENTAL SERVICES

10/19/2021
APPROVAL DATE

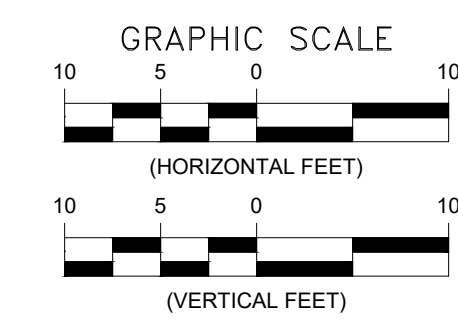

EXISTING

TCE

MNTC

RIGHT OF WAY

TEMPORARY CONSTRUCTION EASEMENT

PERMANENT EASEMENT

MAINTENANCE EASEMENT

PROPOSED

TCE

MNTC

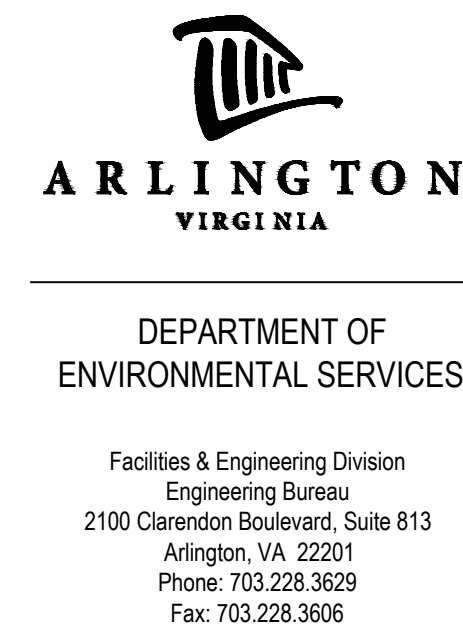

Kimley»Horn
Kimley-Horn
and Associates, Inc.
© 2021 KIMLEY-HORN AND ASSOCIATES, INC.
11400 Commerce Park Drive, Suite 400
Reston Virginia 20191
Phone: 703-674-1300
Fax: 703-674-1350

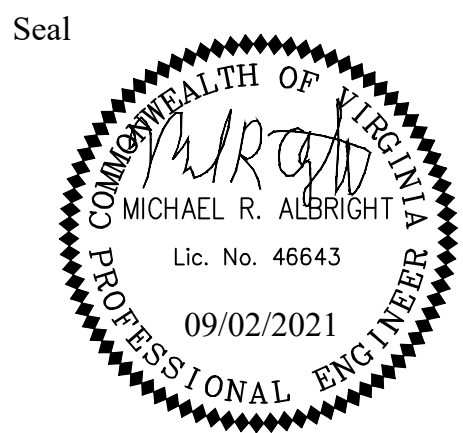

Approvals	1
-----------	---

Design Team Engineer SupervisorConstruction Management SupervisorWater, Sewer, Streets Bureau ChiefTransportation DirectorProject Manager[illegible]

Designed: EJD
 Drawn: JGJ
 Checked: MRA
 Miss Utility Transmittal #:

Filename: 010073-F-XS401.dwg
 Path: K:\NVA_RDWY\11001073_Columbia Pike Multimodal Proje
 7.5 Final Design of Columbia Pike Segments\Segment F17.5.2 - I
 Design\PlanSheets
 Plotted: September 02, 2021
 Plotted by: patrick.husted

ARLINGTON COUNTY, VIRGINIA DEPARTMENT OF ENVIRONMENTAL SERVICES			
ROADWAY CROSS SECTIONS COLUMBIA PIKE - ROUTE 244 COLUMBIA PIKE - MULTIMODAL STREET IMPROVEMENTS SEGMENT F STA. 150+25.00 TO STA. 151+50.00			
SCALE:	HOR. 1" = 10' VERT. 1" = 10'	SHEET:	F16.13 of F16.33

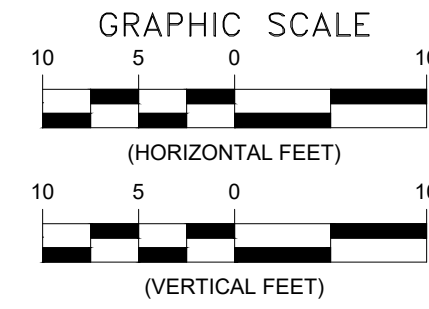
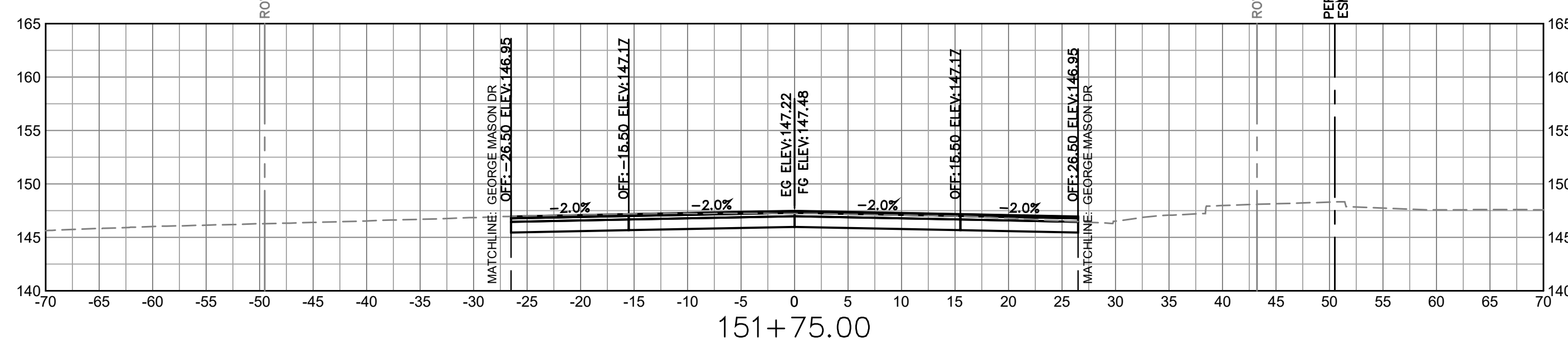
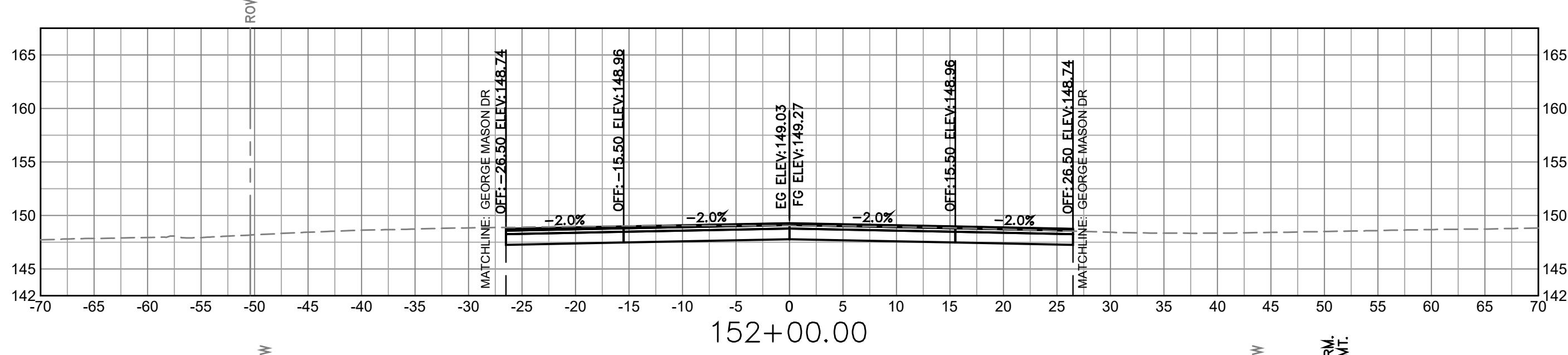
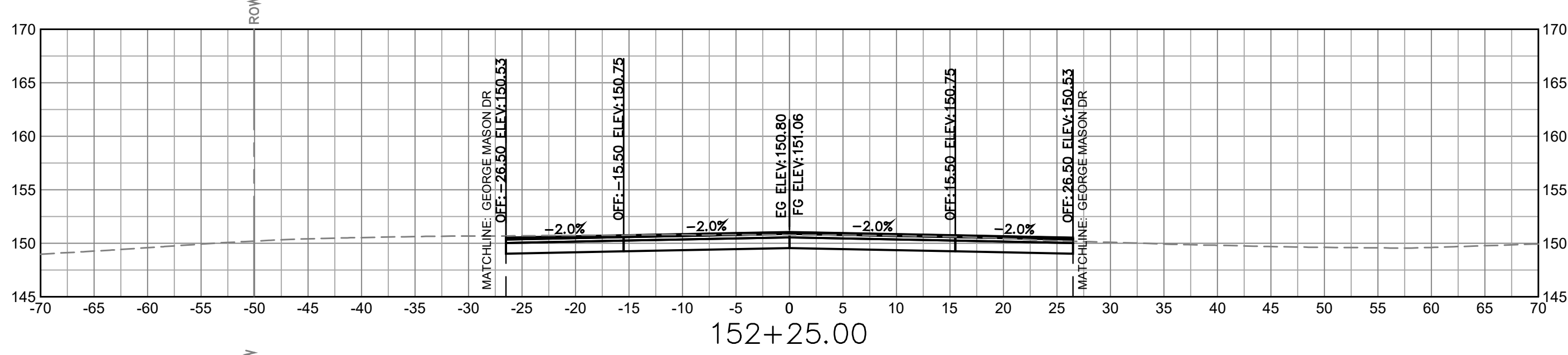
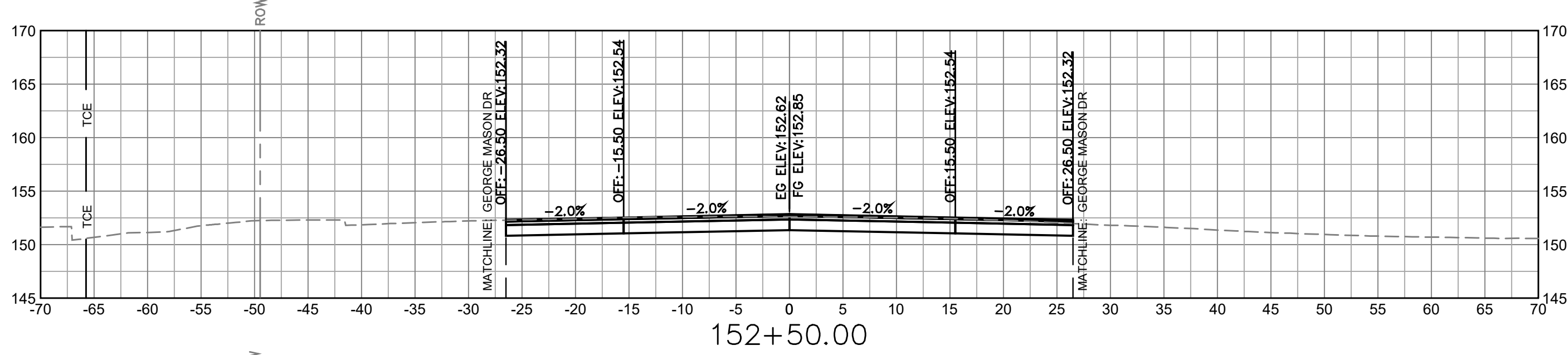
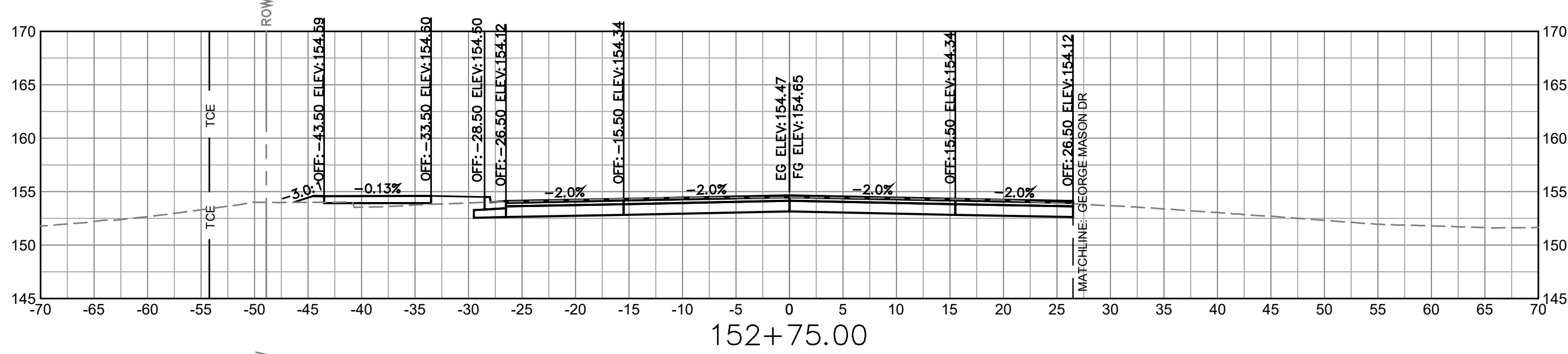
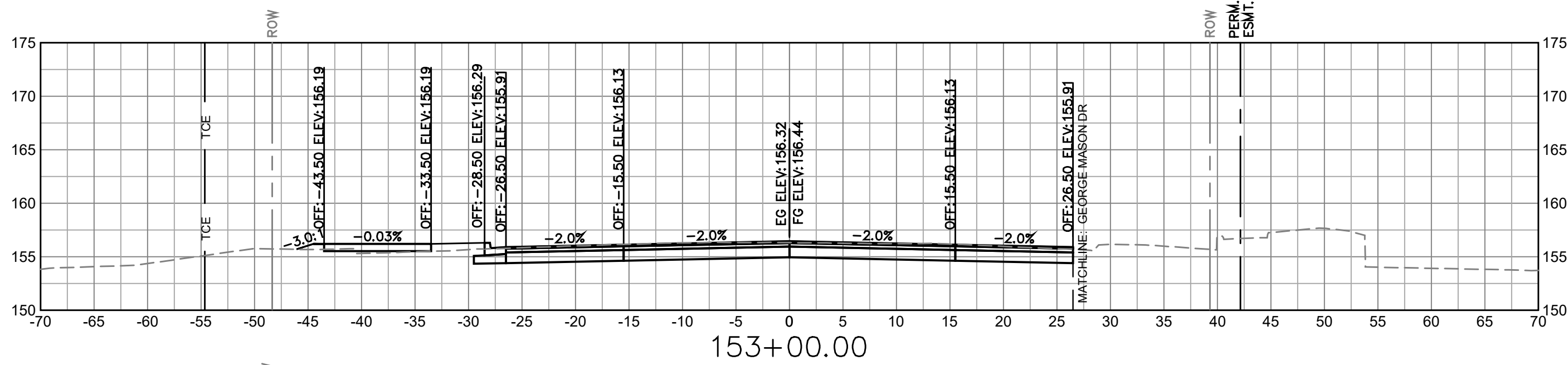

LEGEND		
EXISTING	RIGHT OF WAY	PROPOSED
— TCE —	— TEMPORARY CONSTRUCTION EASEMENT —	— TCE —
— — —	— PERMANENT EASEMENT —	— — —
— MNTC —	— MAINTENANCE EASEMENT —	— MNTC —
EG	EXISTING PROFILE GRADE	
FG	PROPOSED PROFILE GRADE	



DEPARTMENT OF
ENVIRONMENTAL SERVICES

Facilities & Engineering Division
Engineering Bureau
2100 Clarendon Boulevard, Suite 813
Arlington, VA 22201
Phone: 703.228.3629
Fax: 703.228.3606

Kimley»Horn
Kimley-Horn
and Associates, Inc.
© 2021 KIMLEY-HORN AND ASSOCIATES, INC.
11400 Commerce Park Drive, Suite 400
Reston, Virginia 20191
Phone: 703-674-1500
Fax: 703-674-1500

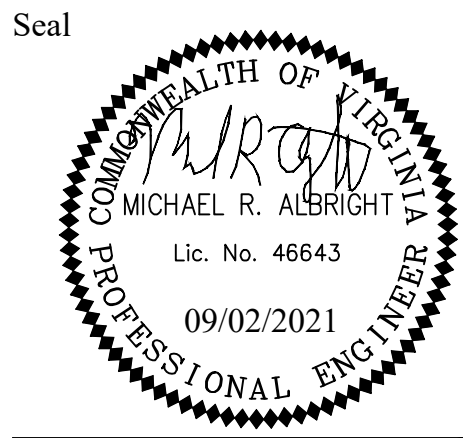

Approvals _____ Date _____

Design Team Engineer Supervisor _____

Construction Management Supervisor _____

Water, Sewer, Streets Bureau Chief _____

Transportation Director _____

Project Manager _____

Revisions	Date

Designed: EJD
Drawn: JGJ
Checked: MRA
Miss Utility Transmittal #:

Filename: 010073-F-XS401.dwg
Path: C:\Users\JGJ\OneDrive\Documents\Projects\010073-F-XS401.dwg
Plotted: September 02, 2021
Plotted by: patrick.husted

ARLINGTON COUNTY, VIRGINIA
DEPARTMENT OF ENVIRONMENTAL SERVICES

ROADWAY CROSS SECTIONS
COLUMBIA PIKE - ROUTE 244
COLUMBIA PIKE - MULTIMODAL STREET IMPROVEMENTS
SEGMENT F
STA. 151+75.00 TO STA. 153+00.00

SCALE: HOR. 1" = 10' VERT. 1" = 10' SHEET: F16.14 of F16.33

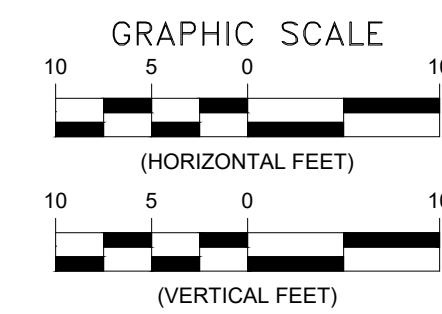

LEGEND

EXISTING	RIGHT OF WAY	PROPOSED
EG		
FG		
TCE	TEMPORARY CONSTRUCTION EASEMENT	TCE
	PERMANENT EASEMENT	
MNTC	MAINTENANCE EASEMENT	MNTC

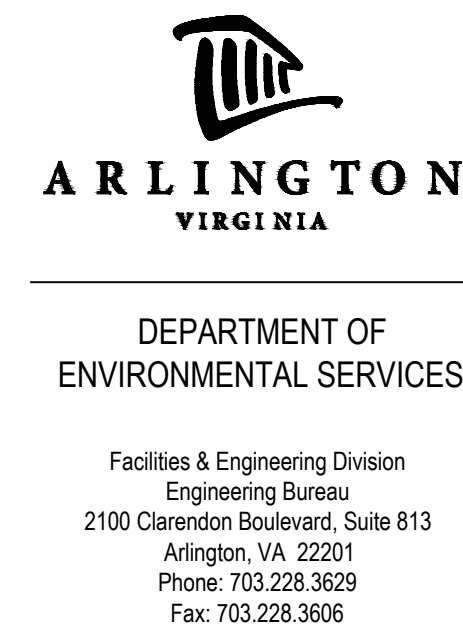

Kimley»Horn
Kimley-Horn
and Associates, Inc.
© 2021 KIMLEY-HORN AND ASSOCIATES, INC.
11400 Commerce Park Drive, Suite 400
Reston Virginia 20191
Phone: 703-674-1300
Fax: 703-674-1350

A circular professional engineer seal for the Commonwealth of Virginia. The outer ring contains the text "COMMONWEALTH OF VIRGINIA" at the top and "PROFESSIONAL ENGINEER" at the bottom. Inside the ring, the name "Michael R. Albright" is written in a cursive script. Below the name, the text "MICHAEL R. ALBRIGHT" is printed in a sans-serif font. Underneath that, the license number "Lic. No. 46643" is printed. At the bottom of the seal, the expiration date "09/02/2021" is printed. The seal has a decorative, serrated border.

Approvals	1
-----------	---

Design Team Engineer Supervisor

Construction Management Supervisor

Water, Sewer, Streets Bureau Chief

Transportation Director

Project Manager

[illegible]

Designed: EJD
 Drawn: JGJ
 Checked: MRA
 Miss Utility Transmittal #:

Filename: 010073-F-XS401.dwg
 Path: K:\NVA_RDWY\110010073 Columbia Pike Multimodal Proje
 7.5 Final Design of Columbia Pike Segments\Segment F17.5.2 - I
 Design\PlanSheets
 Plotted: September 02, 2021
 Plotted by: patrick.husted

ARLINGTON COUNTY, VIRGINIA DEPARTMENT OF ENVIRONMENTAL SERVICES			
ROADWAY CROSS SECTIONS COLUMBIA PIKE - ROUTE 244 COLUMBIA PIKE - MULTIMODAL STREET IMPROVEMENTS SEGMENT F STA. 153+25.00 TO STA. 154+50.00			
SCALE:	HOR. 1" = 10' VERT. 1" = 10'	SHEET:	F16.15 of F16.33

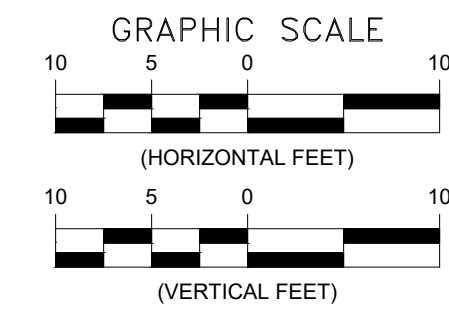
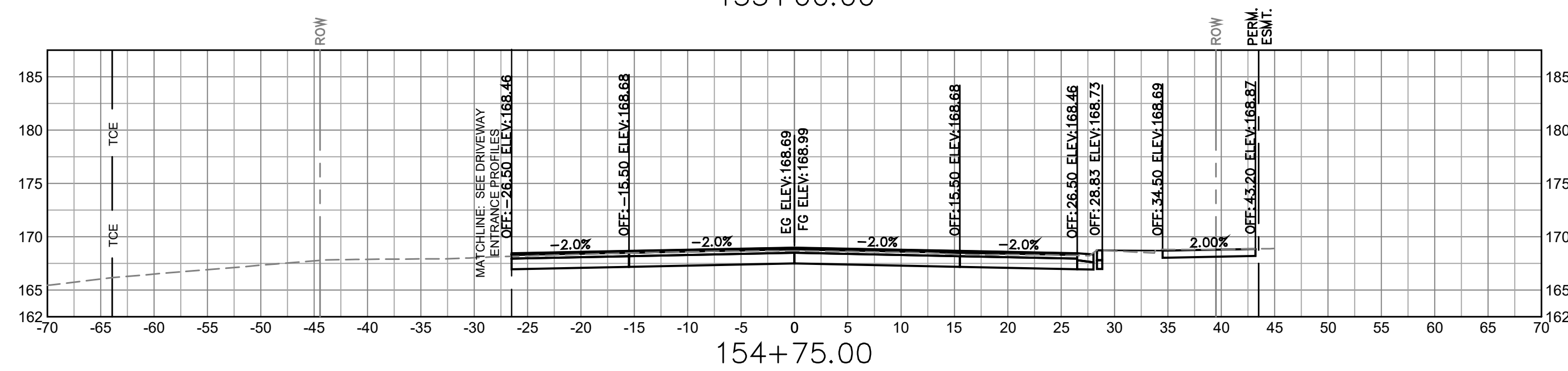
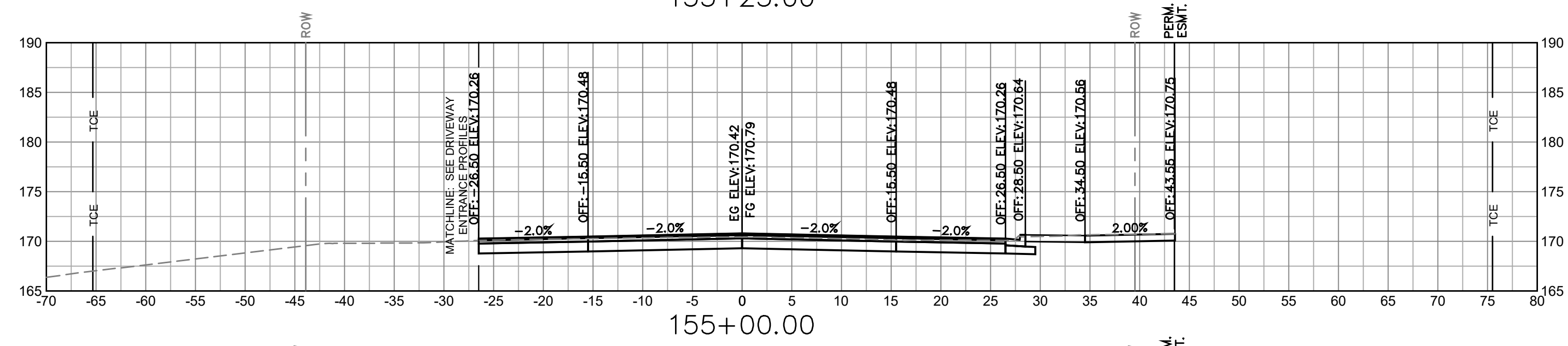
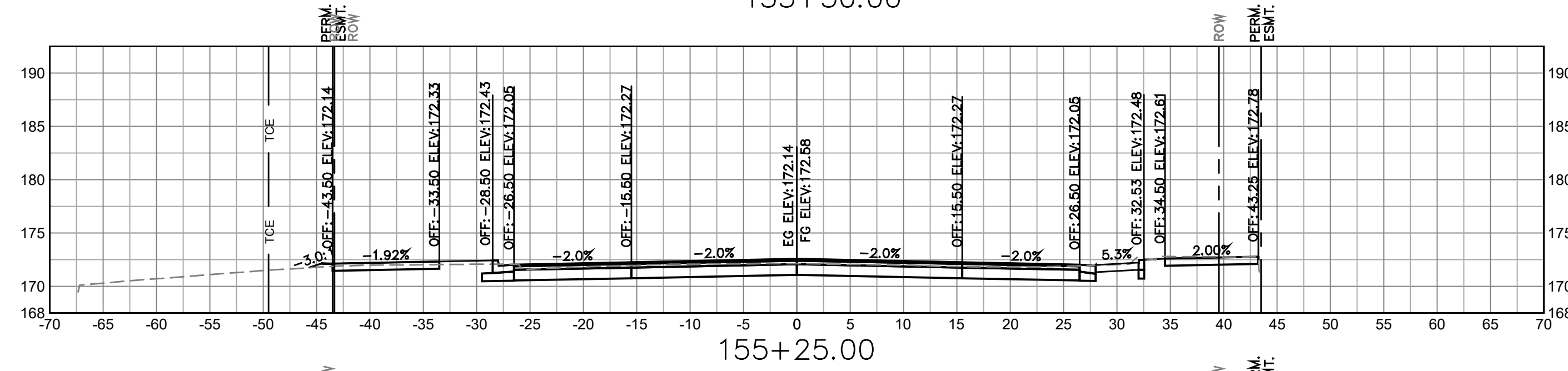
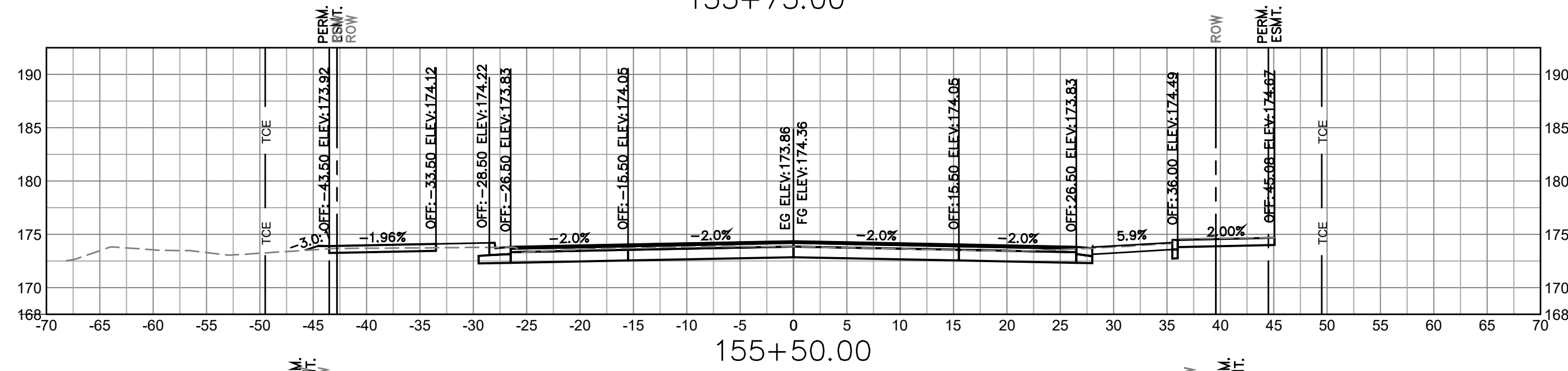
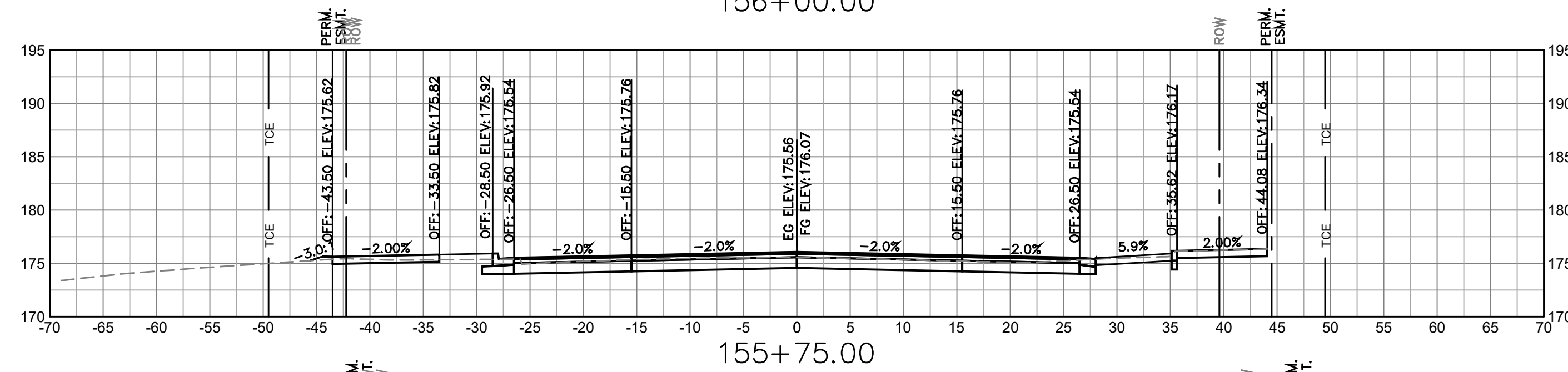
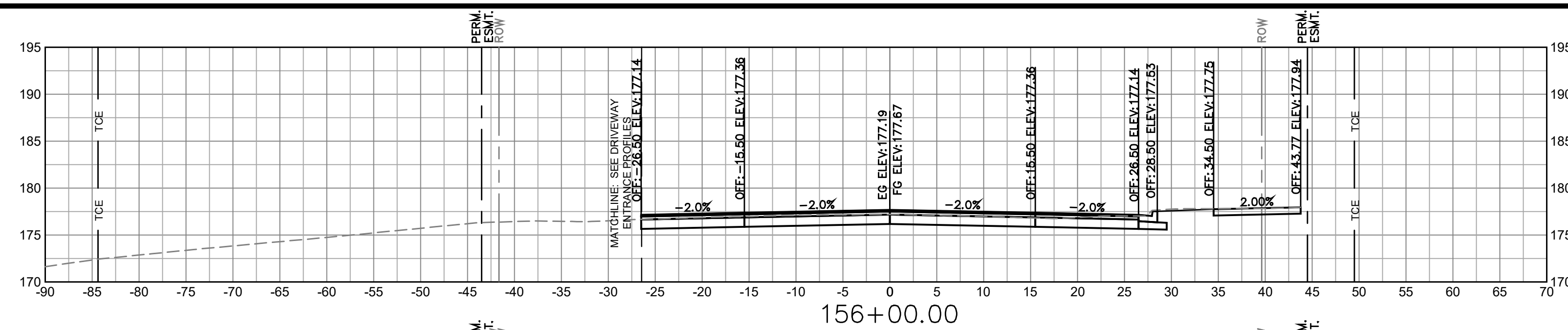

		<u>LEGEND</u>	
EXISTING		PROPOSED	
_____	RIGHT OF WAY	_____	
_____ TCE _____	TEMPORARY CONSTRUCTION EASEMENT	_____ TCE _____	
_____	PERMANENT EASEMENT	_____	
_____ MNTC _____	MAINTENANCE EASEMENT	_____ MNTC _____	
EG	EXISTING PROFILE GRADE		
FG	PROPOSED PROFILE GRADE		



DEPARTMENT OF
ENVIRONMENTAL SERVICES

Facilities & Engineering Division
Engineering Bureau
2100 Clarendon Boulevard, Suite 813
Arlington, VA 22201
Phone: 703.228.3629
Fax: 703.228.3606

Kimley»Horn
Kimley-Horn
and Associates, Inc.
© 2021 KIMLEY-HORN AND ASSOCIATES, INC.
11400 Commerce Park Drive, Suite 400
Reston Virginia 20191
Phone: 703-674-1500
Fax: 703-674-1350

Seal

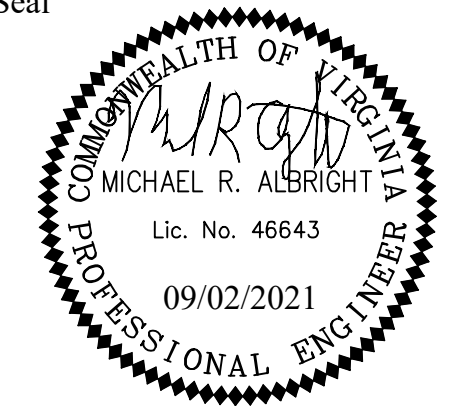

Approvals	Date
-----------	------

Design Team Engineer Supervisor

Construction Management Supervisor

Water, Sewer, Streets Bureau Chief

Transportation Director

Project Manager

[illegible]

Designed: EJD
 Drawn: JGJ
 Checked: MRA
 Miss Utility Transmittal #:

Filename: 010073-F-XS401.dwg
 Path: K:\NVA_RDW\1\10010073_Columbia Pike Multimodal Production\Task
 7.5 Final Design of Columbia Pike Segments\Segment F17.5.2 - 100%
 Design\PlanSheets
 Plotted: September 02, 2021
 Plotted by: patrick.husted

ARLINGTON COUNTY, VIRGINIA
DEPARTMENT OF ENVIRONMENTAL SERVICES

ROADWAY CROSS SECTIONS
COLUMBIA PIKE - ROUTE 244
COLUMBIA PIKE - MULTIMODAL STREET IMPROVEMENTS
SEGMENT F
STA. 154+75.00 TO STA. 156+00.00

SCALE:	HOR. 1" = 10' VERT. 1" = 10'	SHEET:	F16.16 of F16.33
--------	------------------------------	--------	------------------

DEPARTMENT OF
ENVIRONMENTAL SERVICES

10/19/2021
APPROVAL DATE

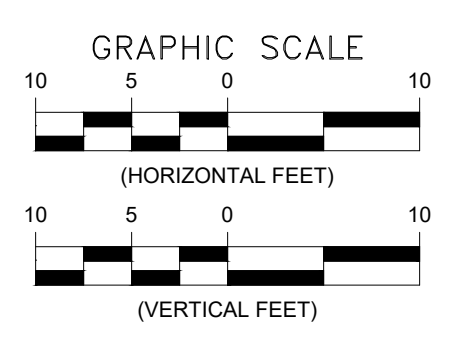
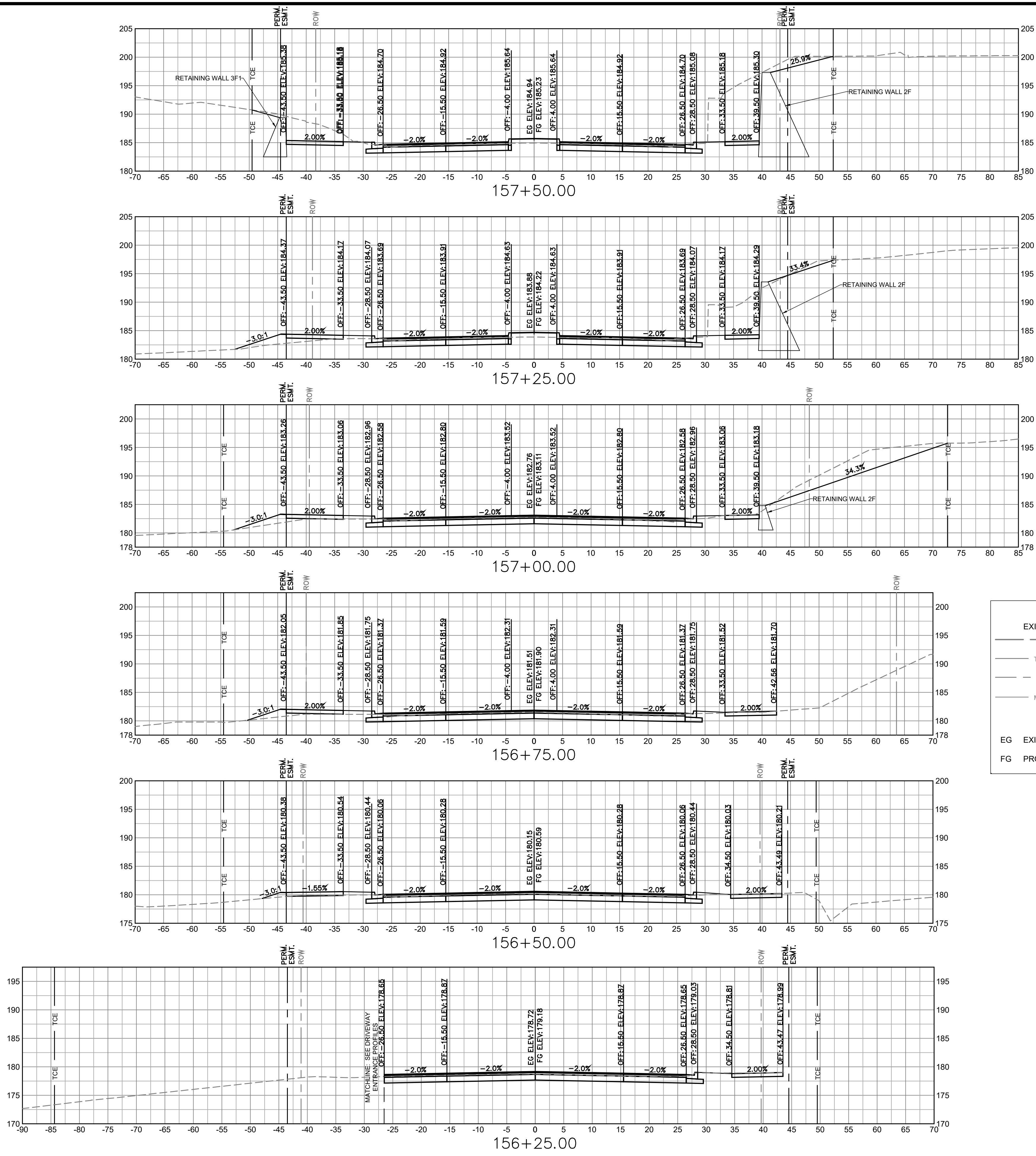

LEGEND		
EXISTING		PROPOSED
---	RIGHT OF WAY	---
---	TCE	---
---	TEMPORARY CONSTRUCTION EASEMENT	---
---	PERMANENT EASEMENT	---
---	MNTC	---
---	MAINTENANCE EASEMENT	---
---	EG	EXISTING PROFILE GRADE
---	FG	PROPOSED PROFILE GRADE

ARLINGTON COUNTY, VIRGINIA
DEPARTMENT OF ENVIRONMENTAL SERVICES

ROADWAY CROSS SECTIONS
COLUMBIA PIKE - ROUTE 244
COLUMBIA PIKE - MULTIMODAL STREET IMPROVEMENTS
SEGMENT F
STA. 156+25.00 TO STA. 157+50.00

SCALE: HOR. 1" = 10' VERT. 1" = 10' SHEET: F16.17 of F16.33

ARLINGTON
VIRGINIA

DEPARTMENT OF
ENVIRONMENTAL SERVICES

Facilities & Engineering Division
Engineering Bureau
2100 Clarendon Boulevard, Suite 813
Arlington, VA 22201
Phone: 703.228.3629
Fax: 703.228.3606

Kimley»Horn
Kimley-Horn
and Associates, Inc.

© 2021 KIMLEY-HORN AND ASSOCIATES, INC.
11400 Commerce Park Drive, Suite 400
Reston, Virginia 20191
Phone: 703-674-1500
Fax: 703-674-1500



Approvals _____ Date _____

Design Team Engineer Supervisor _____

Construction Management Supervisor _____

Water, Sewer, Streets Bureau Chief _____

Transportation Director _____

Project Manager _____

Revisions	Date

Designed: EJD
Drawn: JGJ
Checked: MRA
Miss Utility Transmittal #:

Filename: 010073-F-XS401.dwg
Path: C:\Users\JGJ\OneDrive\Documents\010073-F-XS401.dwg
Plotted: September 02, 2021
Plotted by: patrick.husted

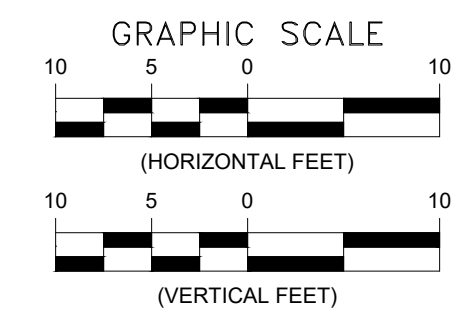
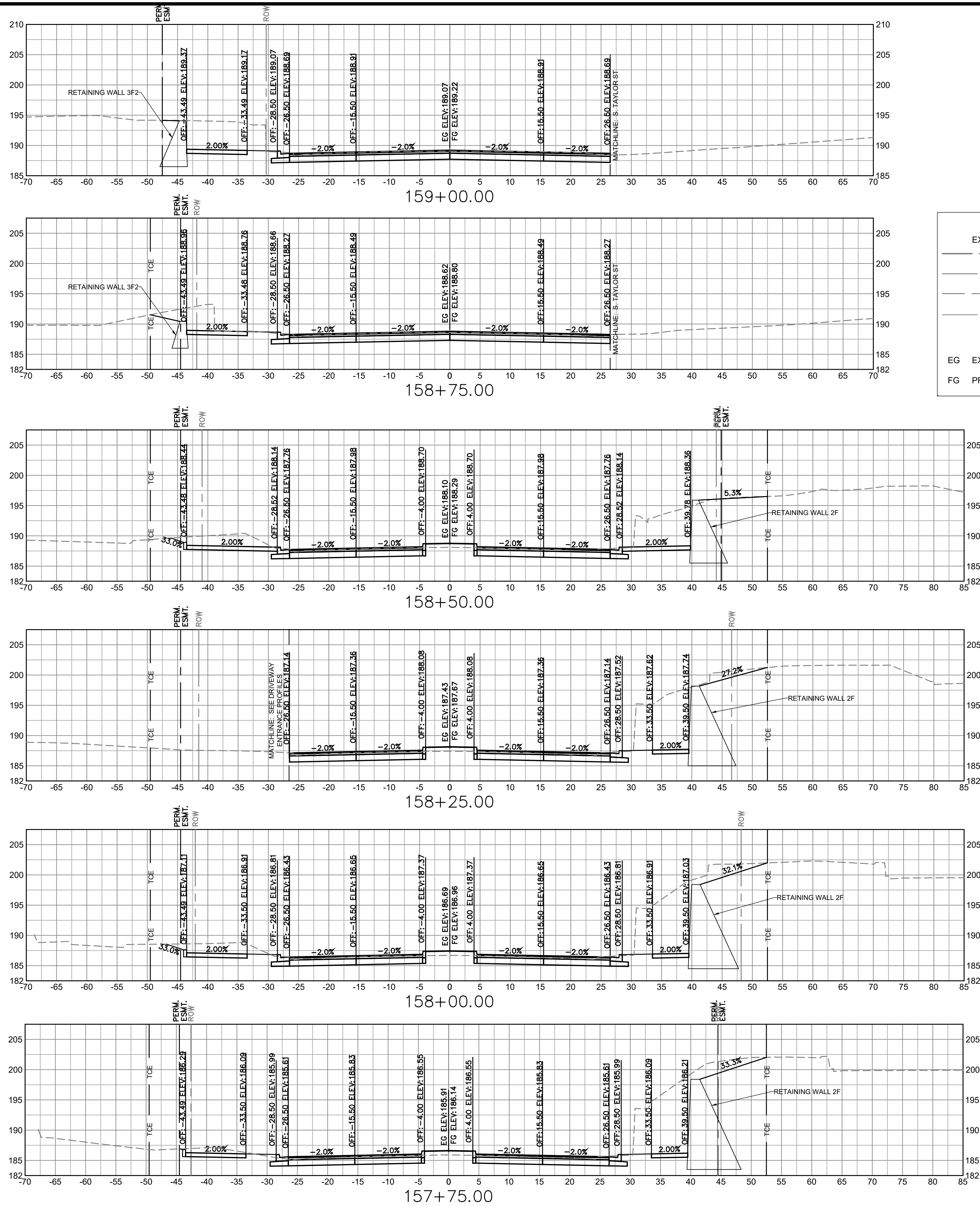

LEGEND		
EXISTING		PROPOSED
—	RIGHT OF WAY	---
---	TEMPORARY CONSTRUCTION EASEMENT	---
---	PERMANENT EASEMENT	---
---	MAINTENANCE EASEMENT	---
EG	EXISTING PROFILE GRADE	
FG	PROPOSED PROFILE GRADE	



DEPARTMENT OF ENVIRONMENTAL SERVICES

Facilities & Engineering Division
Engineering Bureau
2100 Clarendon Boulevard, Suite 813
Arlington, VA 22201
Phone: 703.228.3629
Fax: 703.228.3606

Kimley»Horn
Kimley-Horn
and Associates, Inc.

© 2021 KIMLEY-HORN AND ASSOCIATES, INC.
11400 Commerce Park Drive, Suite 400
Reston, Virginia 20191
Phone: 703-674-1500
Fax: 703-674-1500

Seal

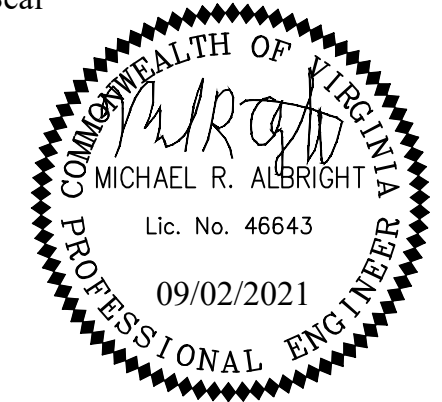

Approvals Date

Design Team Engineer Supervisor

Construction Management Supervisor

Water, Sewer, Streets Bureau Chief

Transportation Director

Project Manager

Revisions	Date

Designed: EJD
Drawn: JGJ
Checked: MRA
Miss Utility Transmittal #:

Filename: 010073-F-XS401.dwg
Path: C:\Users\jgja\OneDrive\Documents\Projects\010073-F-XS401.dwg
Plotted: September 02, 2021
Plotted by: patrick.husted

ARLINGTON COUNTY, VIRGINIA
DEPARTMENT OF ENVIRONMENTAL SERVICES

ROADWAY CROSS SECTIONS
COLUMBIA PIKE - ROUTE 244
COLUMBIA PIKE - MULTIMODAL STREET IMPROVEMENTS
SEGMENT F
STA. 157+75.00 TO STA. 159+00.00

SCALE: HOR. 1" = 10' VERT. 1" = 10' SHEET: F16.18 of F16.33



DEPARTMENT OF ENVIRONMENTAL SERVICES

10/19/2021
APPROVAL DATE

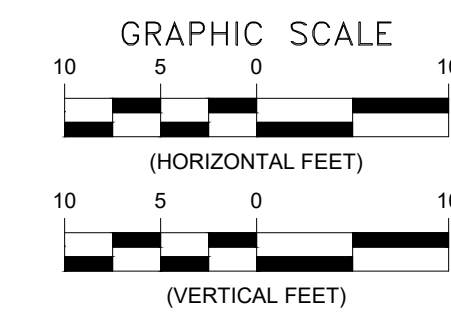

LEGEND

EXISTING		PROPOSED
_____	RIGHT OF WAY	_____
_____ TCE _____	TEMPORARY CONSTRUCTION EASEMENT	_____ TCE _____
_____	PERMANENT EASEMENT	_____
_____ MNTC _____	MAINTENANCE EASEMENT	_____ MNTC _____

EG EXISTING PROFILE GRADE

FG PROPOSED PROFILE GRADE

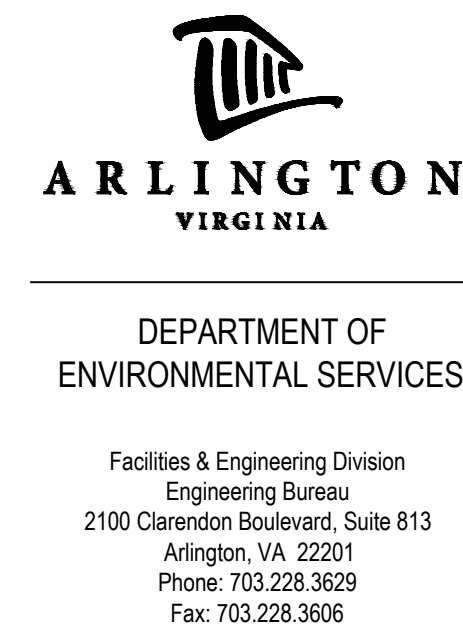

Kimley»Horn
Kimley-Horn
and Associates, Inc.
© 2021 KIMLEY-HORN AND ASSOCIATES, INC.
11400 Commerce Park Drive, Suite 400
Reston Virginia 20191
Phone: 703-674-1300
Fax: 703-674-1350

A circular professional engineer seal for the Commonwealth of Virginia. The outer ring contains the text "COMMONWEALTH OF VIRGINIA" at the top and "PROFESSIONAL ENGINEER" at the bottom. In the center, the name "Michael R. Albright" is written in a cursive script. Below the name, the text "MICHAEL R. ALBRIGHT" is printed in a sans-serif font. Underneath that, the license number "Lic. No. 46643" is printed. At the bottom of the seal, the expiration date "09/02/2021" is printed. The seal has a decorative, serrated border.

Approvals	1
-----------	---

Design Team Engineer Supervisor

Construction Management Supervisor

Water, Sewer, Streets Bureau Chief

Transportation Director

Project Manager

[illegible]

Designed: EJD
 Drawn: JGJ
 Checked: MRA
 Miss Utility Transmittal #:

Filename: 010073-F-XS401.dwg
 Path: K:\NVA_RDW\110010073 Columbia Pike Multimodal Project
 7.5 Final Design of Columbia Pike Segments\Segment F17.5.1 - I
 Design\PlanSheets
 Plotted: September 02, 2021
 Plotted by: patrick.husted

ARLINGTON COUNTY, VIRGINIA
DEPARTMENT OF ENVIRONMENTAL SERVICES

ROADWAY CROSS SECTIONS
COLUMBIA PIKE - ROUTE 244
COLUMBIA PIKE - MULTIMODAL STREET IMPROVEMENTS
SEGMENT F
STA. 159+25.00 TO STA. 160+50.00

SCALE:	HOR. 1" = 10' VERT. 1" = 10'	SHEET:	F16.19 of F16.33
--------	------------------------------	--------	------------------

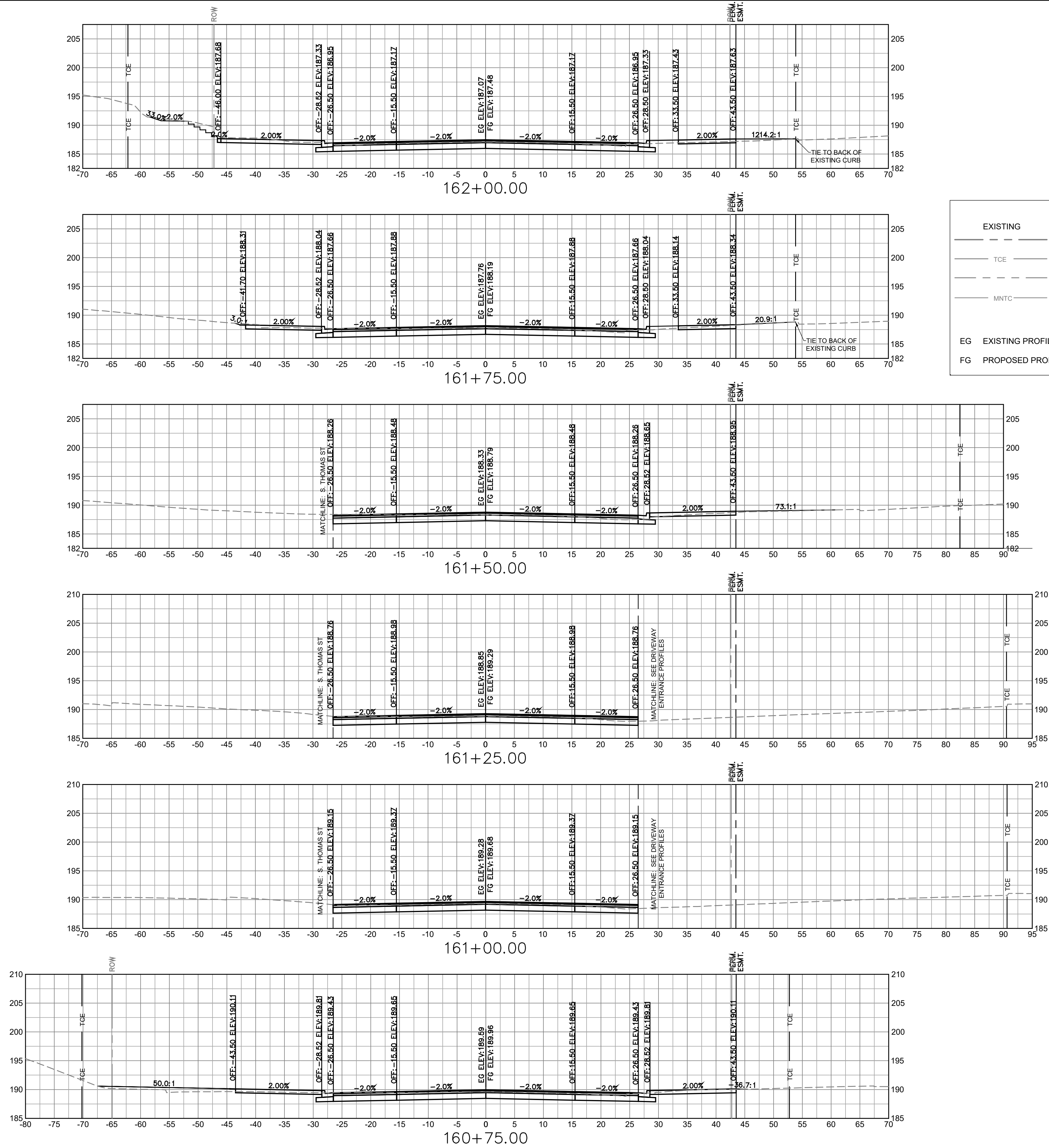



ARLINGTON
VIRGINIA

DEPARTMENT OF ENVIRONMENTAL SERVICES

Facilities & Engineering Division
Engineering Bureau
2100 Clarendon Boulevard, Suite 813
Arlington, VA 22201
Phone: 703.228.3629
Fax: 703.228.3606

Kimley»Horn
Kimley-Horn
and Associates, Inc.

© 2021 KIMLEY-HORN AND ASSOCIATES, INC.
11400 Commerce Park Drive, Suite 400
Reston, Virginia 20191
Phone: 703-674-1500
Fax: 703-674-1500

Seal



Approvals _____ Date _____

Design Team Engineer Supervisor _____

Construction Management Supervisor _____

Water, Sewer, Streets Bureau Chief _____

Transportation Director _____

Project Manager _____

Revisions	Date

Designed: EJD
Drawn: JGJ
Checked: MRA
Miss Utility Transmittal #:

Filename: 010073-F-XS401.dwg
Path: C:\NVA_KORV\10010073 Columbia Pike Multimodal Production\Task 11 - Final Design of Columbia Pike Segment Segment F\2.1 - 100% Design\Drawings
Plotted: September 02, 2021
Plotted by: patrick.husted

ARLINGTON COUNTY, VIRGINIA
DEPARTMENT OF ENVIRONMENTAL SERVICES

ROADWAY CROSS SECTIONS
COLUMBIA PIKE - ROUTE 244
COLUMBIA PIKE - MULTIMODAL STREET IMPROVEMENTS
SEGMENT F
STA. 160+75.00 TO STA. 162+00.00

SCALE:	HOR. 1" = 10' VERT. 1" = 10'	SHEET:	F16.20 of F16.33
--------	------------------------------	--------	------------------

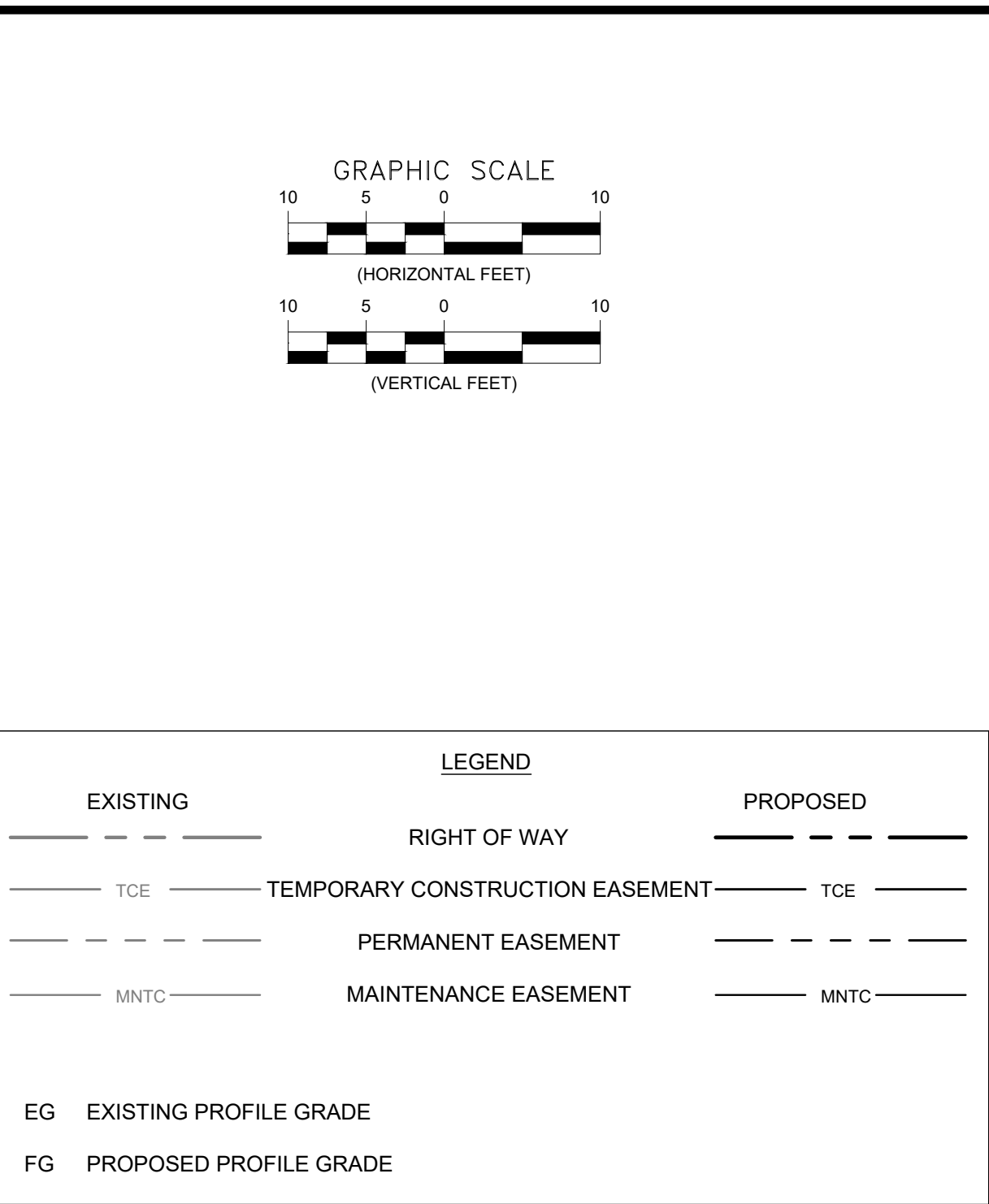

DEPARTMENT OF
ENVIRONMENTAL SERVICES

Facilities & Engineering Division
Engineering Bureau
2100 Clarendon Boulevard, Suite 813
Arlington, VA 22201
Phone: 703.228.3629
Fax: 703.228.3606

Kimley»Horn
Kimley-Horn
and Associates, Inc.
© 2021 KIMLEY-HORN AND ASSOCIATES, INC.
11400 Commerce Park Drive, Suite 400
Reston Virginia 20191
Phone: 703-674-1300
Fax: 703-674-1350

Seal

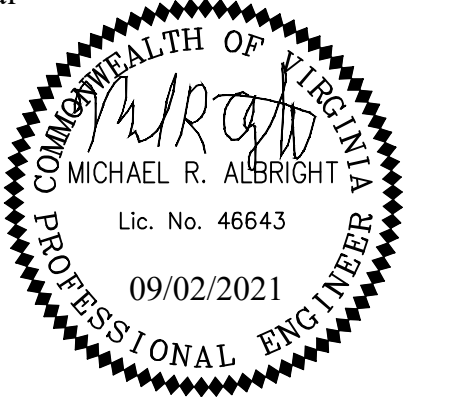

Approvals	Date
-----------	------

Design Team Engineer Supervisor

Construction Management Supervisor

Water, Sewer, Streets Bureau Chief

Transportation Director

Project Manager

[illegible]

Designed: EJD
 Drawn: JGJ
 Checked: MRA
 Miss Utility Transmittal #:

Filename: 010073-F-XS401.dwg
 Path: K:\NVA_RDWY\10010073 Columbia Pike Multimodal Productive\Task
 7.5 Final Design of Columbia Pike Segment\Segment 7.5.2 - 100%
 Design\PlanSheets
 Plotted: September 02, 2021
 Plotted by: patrick.husted

ARLINGTON COUNTY, VIRGINIA
DEPARTMENT OF ENVIRONMENTAL SERVICES

ROADWAY CROSS SECTIONS
COLUMBIA PIKE - ROUTE 244
COLUMBIA PIKE - MULTIMODAL STREET IMPROVEMENTS
SEGMENT F
STA. 162+25.00 TO STA. 163+50.00

SCALE: HOR. 1" = 10' VERT. 1" = 10' SHEET: F16.21 of F16.33

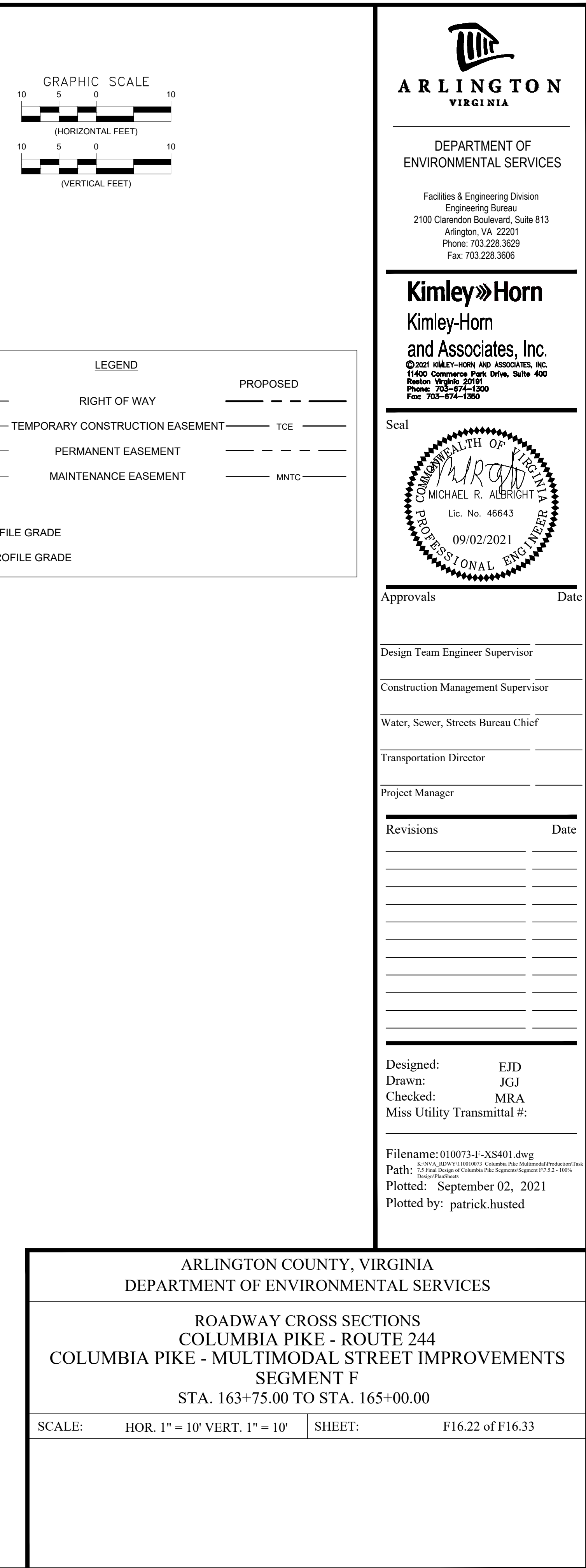

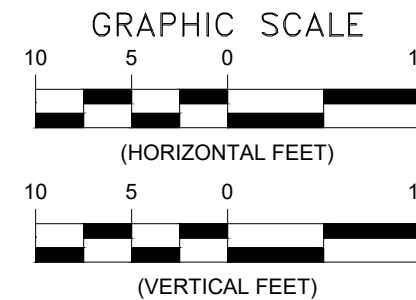
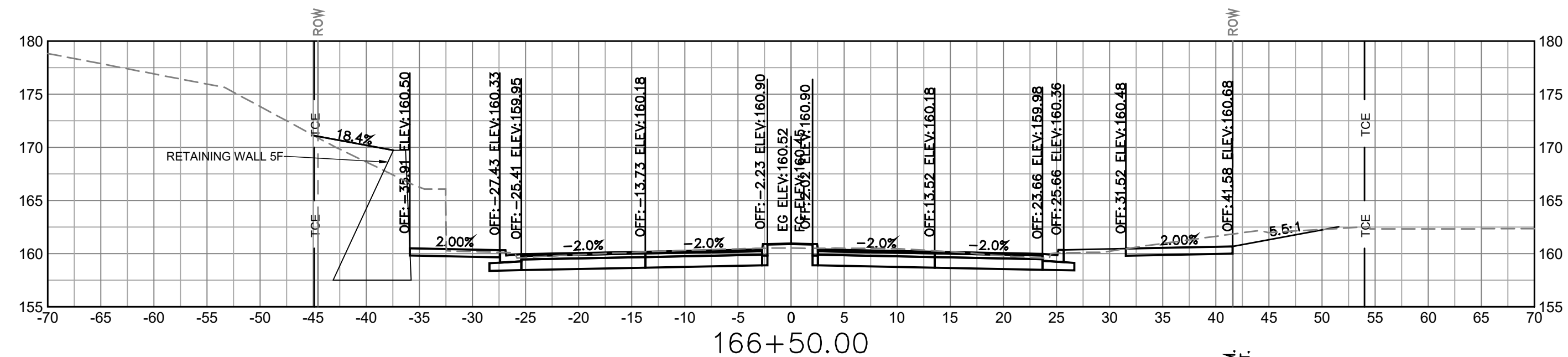

LEGEND		
EXISTING	RIGHT OF WAY	PROPOSED
---	---	---
---	TEMPORARY CONSTRUCTION EASEMENT	---
---	PERMANENT EASEMENT	---
---	MAINTENANCE EASEMENT	---
EG	EXISTING PROFILE GRADE	
FG	PROPOSED PROFILE GRADE	

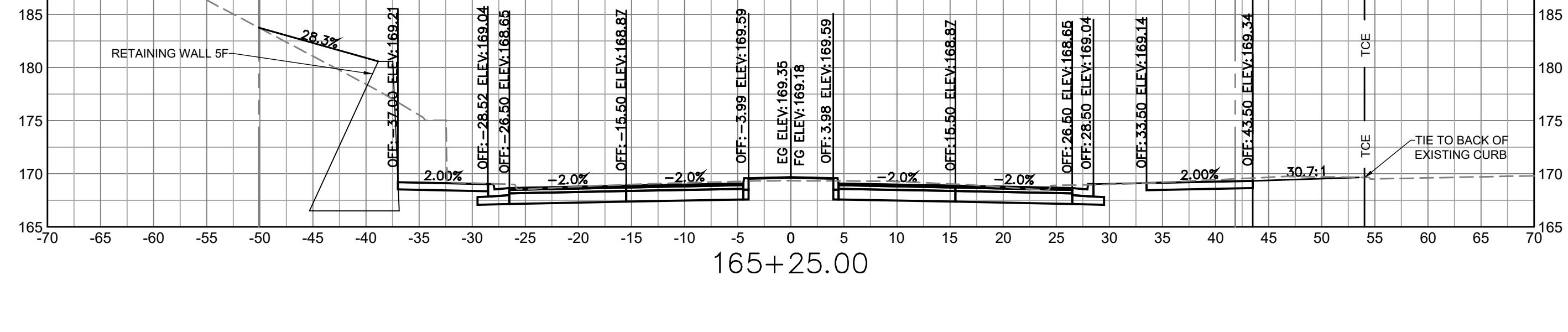
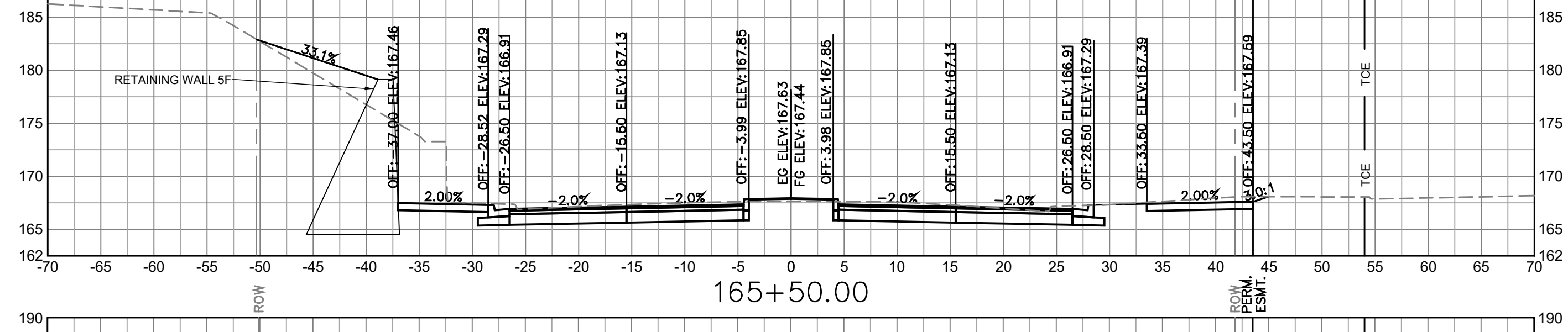
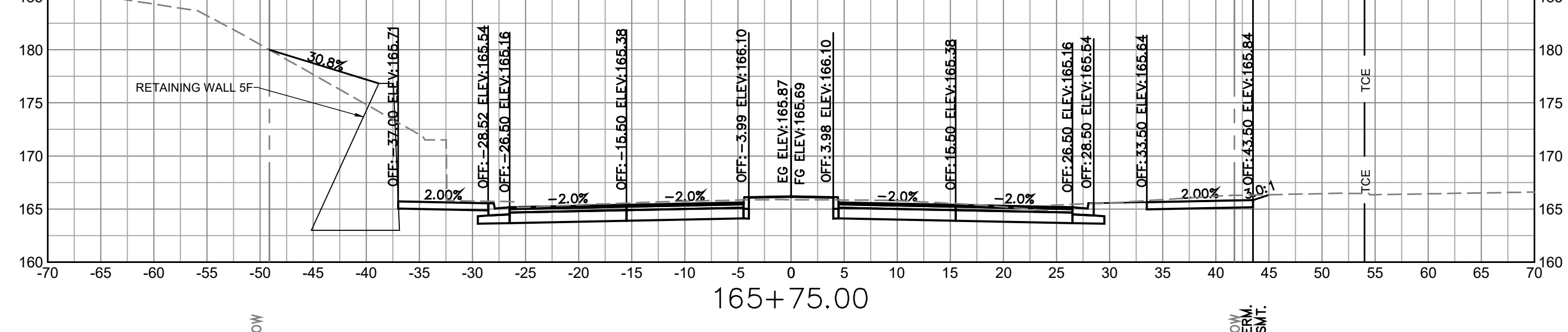
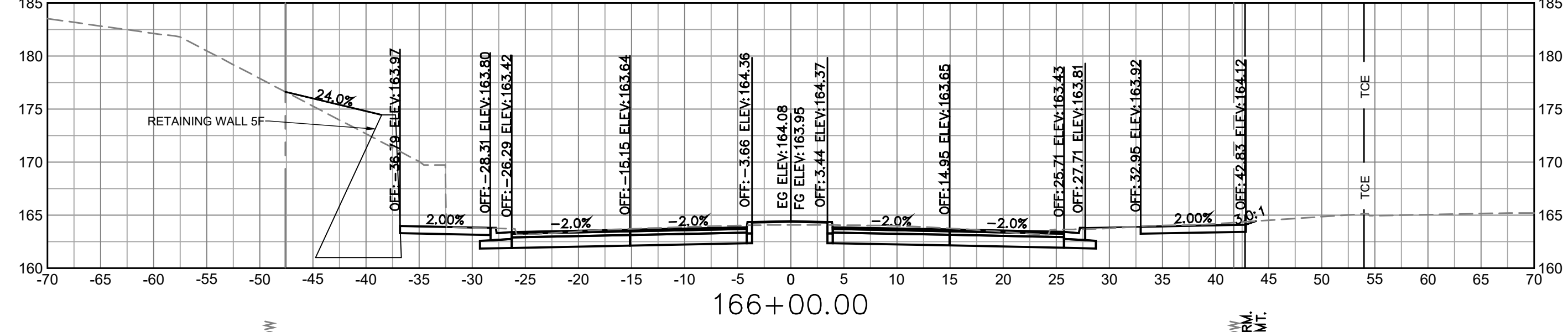
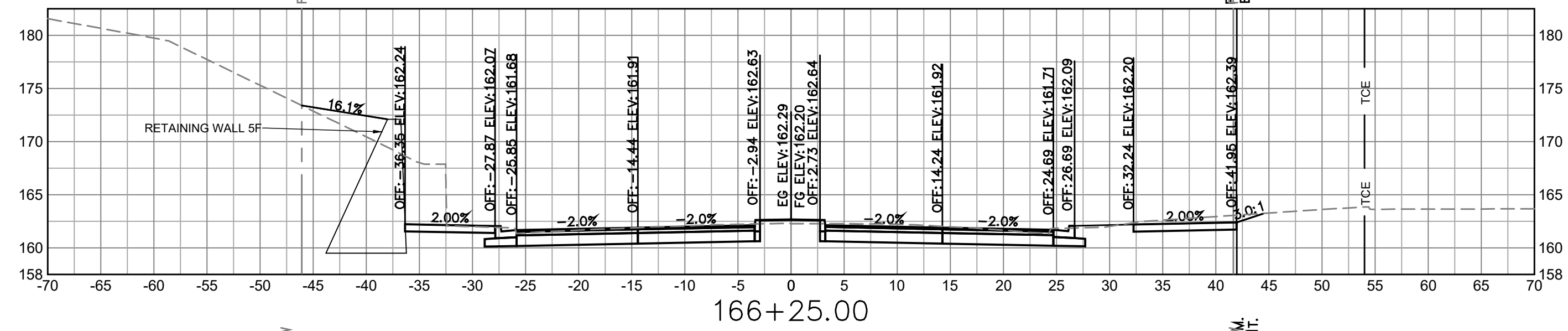

Approvals _____ Date _____

Design Team Engineer Supervisor _____

Construction Management Supervisor _____

Water, Sewer, Streets Bureau Chief _____

Transportation Director _____

Project Manager _____

Revisions	Date

Designed: EJD
Drawn: JGJ
Checked: MRA
Miss Utility Transmittal #:

Filename: 010073-F-XS401.dwg
Path: C:\Users\JGJ\OneDrive\Documents\Projects\010073-F-XS401.dwg
Plotted: September 02, 2021
Plotted by: patrick.husted

ARLINGTON COUNTY, VIRGINIA
DEPARTMENT OF ENVIRONMENTAL SERVICES
ROADWAY CROSS SECTIONS
COLUMBIA PIKE - ROUTE 244
COLUMBIA PIKE - MULTIMODAL STREET IMPROVEMENTS
SEGMENT F
STA. 165+25.00 TO STA. 166+50.00
SCALE: HOR. 1" = 10' VERT. 1" = 10' SHEET: F16.23 of F16.33

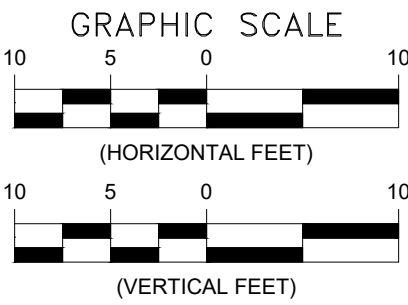

DEPARTMENT OF
ENVIRONMENTAL SERVICES

Facilities & Engineering Division
Engineering Bureau
2100 Clarendon Boulevard, Suite 813
Arlington, VA 22201
Phone: 703.228.3629
Fax: 703.228.3606

Kimley»Horn

Kimley-Horn
and Associates, Inc.

© 2021 KIMLEY-HORN AND ASSOCIATES, INC.
11400 Commerce Park Drive, Suite 400
Reston, Virginia 20191
Phone: 703-874-1500
Fax: 703-874-1500

Seal



Approvals Date

Design Team Engineer Supervisor

Construction Management Supervisor

Water, Sewer, Streets Bureau Chief

Transportation Director

Project Manager

Revisions Date

Designed: EJD
Drawn: JGJ
Checked: MRA
Miss Utility Transmittal #:

Filename: 010073-F-XS401.dwg
Path: C:\NVA_KORV\11010073 Columbia Pike Multimodal Production\Task
Design\TaskSheet
Plotted: September 02, 2021
Plotted by: patrick.husted

ARLINGTON COUNTY, VIRGINIA
DEPARTMENT OF ENVIRONMENTAL SERVICES

ROADWAY CROSS SECTIONS
COLUMBIA PIKE - ROUTE 244
COLUMBIA PIKE - MULTIMODAL STREET IMPROVEMENTS
SEGMENT F
STA. 166+75.00 TO STA. 167+25.00

SCALE: HOR. 1" = 10' VERT. 1" = 10' SHEET: F16.24 of F16.33

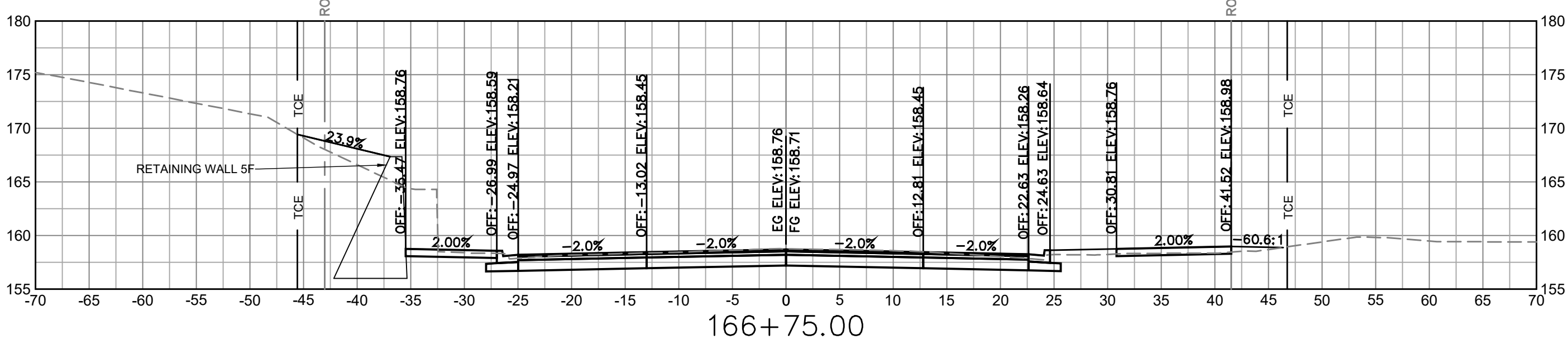
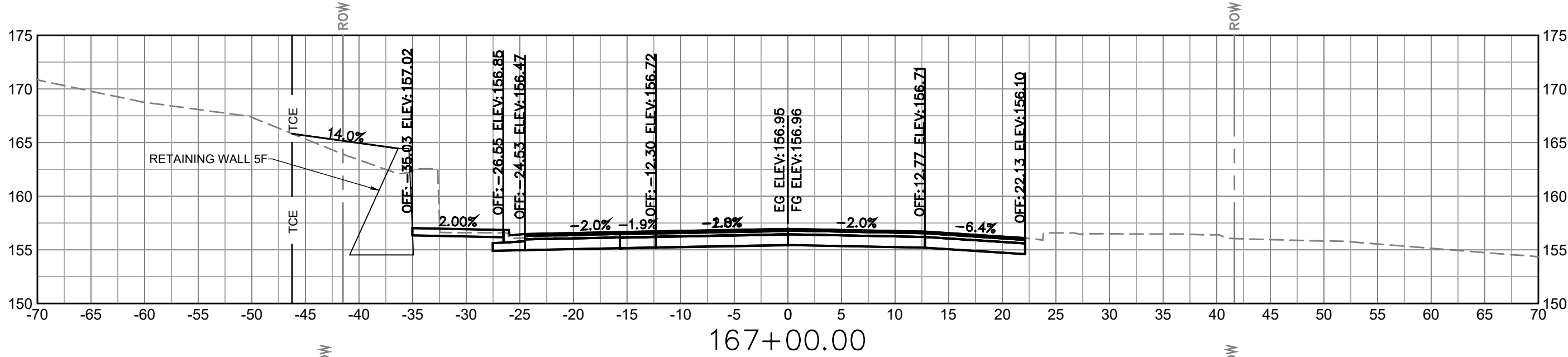
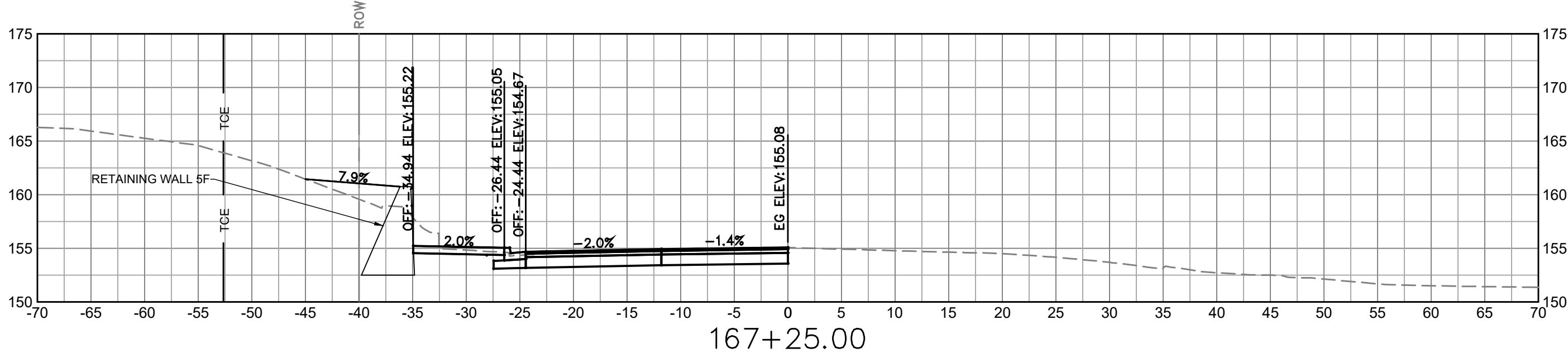
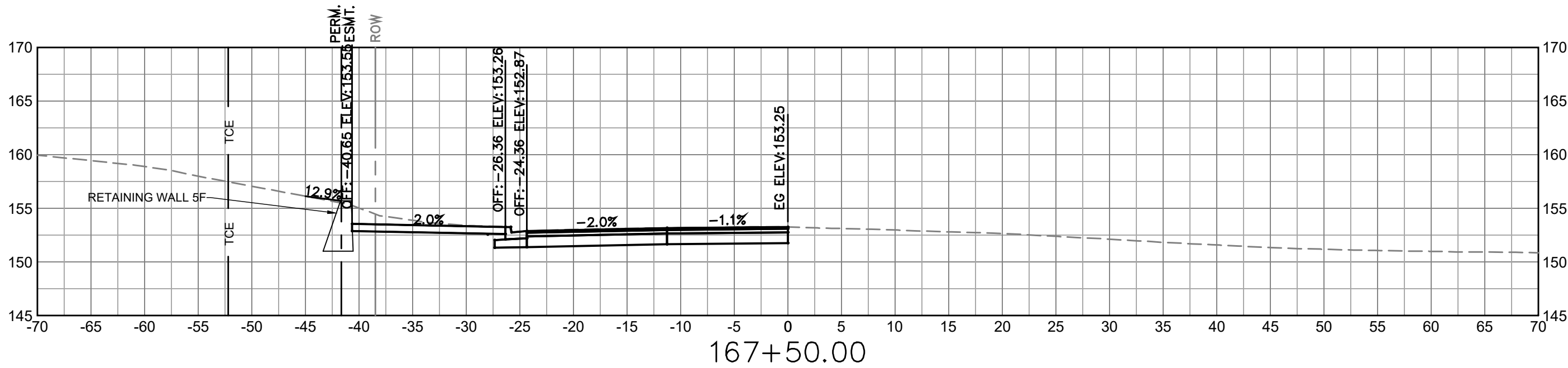

DEPARTMENT OF
ENVIRONMENTAL SERVICES

10/19/2021
APPROVAL DATE

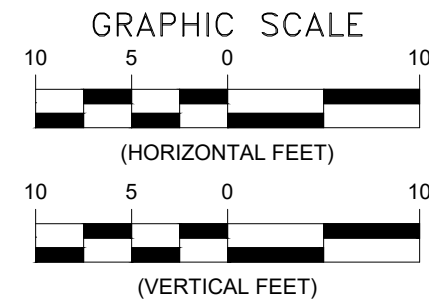

DEPARTMENT OF
ENVIRONMENTAL SERVICES

Facilities & Engineering Division
Engineering Bureau
2100 Clarendon Boulevard, Suite 813
Arlington, VA 22201
Phone: 703.228.3629
Fax: 703.228.3606

Kimley»Horn
Kimley-Horn
and Associates, Inc.
© 2021 KIMLEY-HORN AND ASSOCIATES, INC.
11400 Commerce Park Drive, Suite 400
Reston, Virginia 20191
Phone: 703-674-1500
Fax: 703-674-1500

Seal



Approvals Date

Design Team Engineer Supervisor

Construction Management Supervisor

Water, Sewer, Streets Bureau Chief

Transportation Director

Project Manager

Revisions	Date

Designed: EJD
Drawn: JGJ
Checked: MRA
Miss Utility Transmittal #:

Filename: 010073-F-XS408.dwg
Path: I:\2021\010073\010073 Columbia Pike Multimodal\Production\Task
1 - 11 Final Design of Columbia Pike Segment\Segment F\1 - 100%
Design\Plots\Drawn
Plotted: September 02, 2021
Plotted by: patrick.husted

ARLINGTON COUNTY, VIRGINIA
DEPARTMENT OF ENVIRONMENTAL SERVICES

ROADWAY CROSS SECTIONS
COLUMBIA PIKE - ROUTE 244
COLUMBIA PIKE - MULTIMODAL STREET IMPROVEMENTS
SEGMENT F
S. THOMAS ST.

SCALE: HOR. 1" = 10' VERT. 1" = 10' SHEET: F16.25 of F16.33

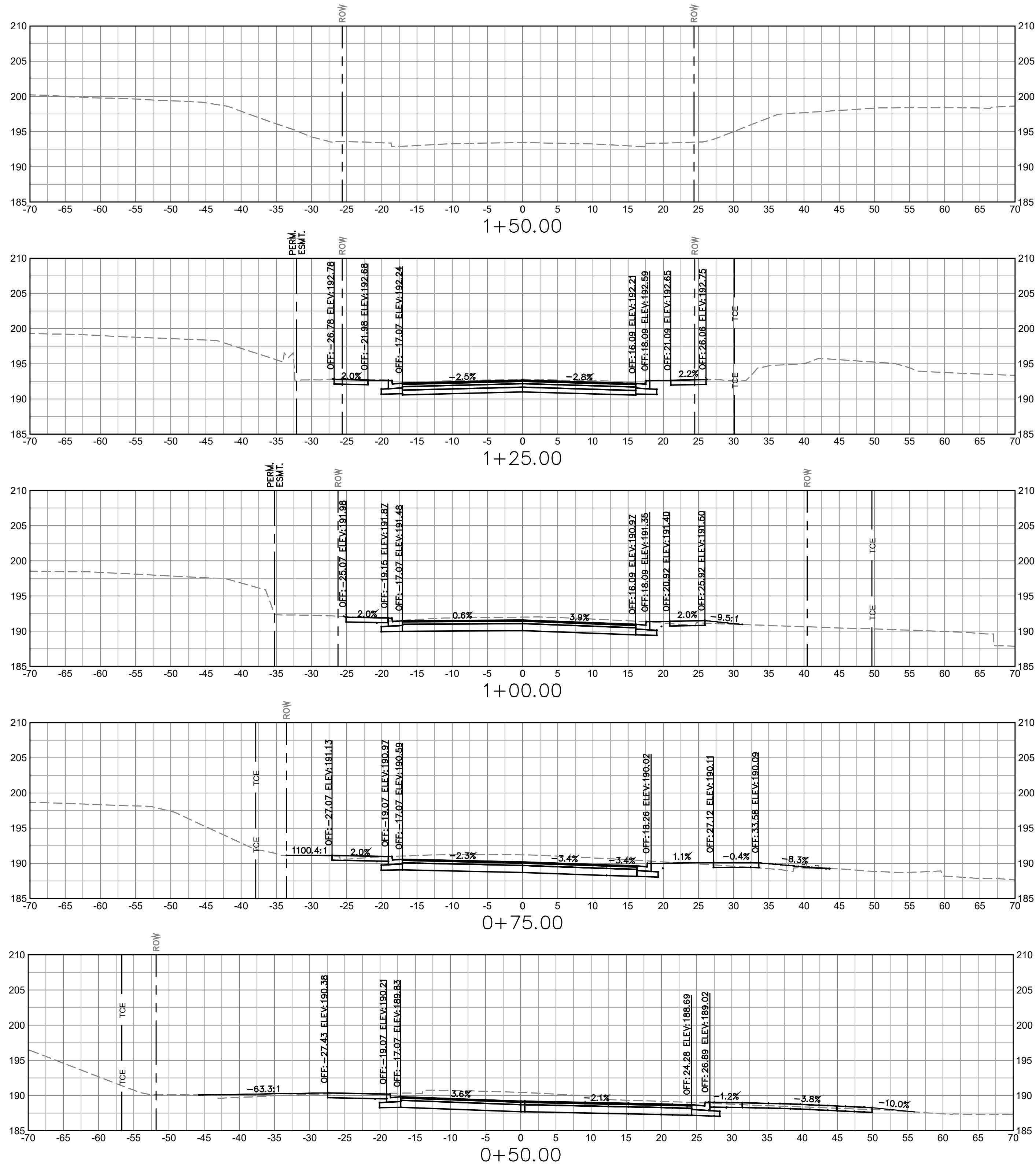

LEGEND		
EXISTING	RIGHT OF WAY	PROPOSED
— TCE —	— TEMPORARY CONSTRUCTION EASEMENT —	— TCE —
— — —	— PERMANENT EASEMENT —	— — —
— MNTC —	— MAINTENANCE EASEMENT —	— MNTC —
EG	EXISTING PROFILE GRADE	
FG	PROPOSED PROFILE GRADE	



DEPARTMENT OF
ENVIRONMENTAL SERVICES

LUIS ARAYA
BUREAU CHIEF, DES - DEVELOPMENT SERVICES

10/19/2021
APPROVAL DATE