

DETOUR PLAN 1B: S THOMAS ST

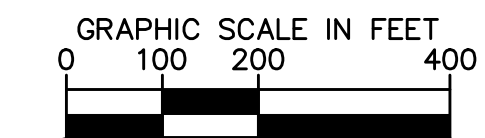

MAINTENANCE OF TRAFFIC LEGEND

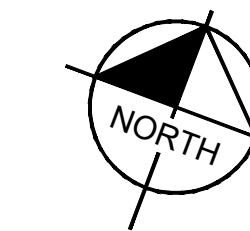
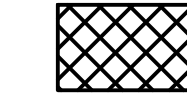

WORK ZONE



DETOUR SIGN

NOTES:

1. **CONTRACTOR TO LAY OUT
DETOUR SIGNAGE IN
CONFORMANCE WITH THE
VIRGINIA WORK AREA
PROTECTION MANUAL,
SPECIFICALLY TEMPORARY
TRAFFIC CONTROL FIGURE 34.2.**



ARLINGTON
VIRGINIA

DEPARTMENT OF
ENVIRONMENTAL SERVICES

Facilities & Engineering Division
Engineering Bureau
2100 Clarendon Boulevard, Suite 813
Arlington, VA 22201
Phone: 703.228.3629
Fax: 703.228.3606

Kimley»Horn

Kimley-Horn
and Associates, Inc.

© 2021 KIMLEY-HORN AND ASSOCIATES, INC.
11400 Commerce Park Drive, Suite 400
Reston Virginia 20191
Phone: 703-674-1300
Fax: 703-674-1350

Seal



Approvals	Date
-----------	------

Design Team Engineer Supervisor

Construction Management Supervisor

Water, Sewer, Streets Bureau Chief

Transportation Director

Project Manager

[illegible]

Designed: EJD
 Drawn: OCD
 Checked: MRA
 Miss Utility Transmittal #:

Filename: PHASE 4A DETOUR.dwg
 Path: K:\NVA_RD\WY\1109100073_Columbian Pike Multimodal Project\Task
 7.5 Final Design of Columbian Pike Segments\Segment 7\F.5.2 - 100%
 Design\PlanSheets
 Plotted: October 12, 2021
 Plotted by: Patrick.Husted

ARLINGTON COUNTY, VIRGINIA
DEPARTMENT OF ENVIRONMENTAL SERVICES

MAINTENANCE OF TRAFFIC PHASE 1B DETOUR
COLUMBIA PIKE - ROUTE 244
COLUMBIA PIKE - MULTIMODAL STREET IMPROVEMENTS
SEGMENT F

SCALE:	HOR. 1"=200'	SHEET:	F19.17 of F19.31
--------	--------------	--------	------------------



ARLINGTON
VIRGINIA

VIRGINIA
Luis Araya
LUIS ARAYA
BUREAU CHIEF, DES - DEVELOPMENT SERVICES

DEPARTMENT OF ENVIRONMENTAL SERVICES

10/19/2021
APPROVAL DATE

DETOUR PLAN 1C: S QUINCY ST

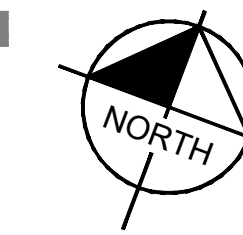
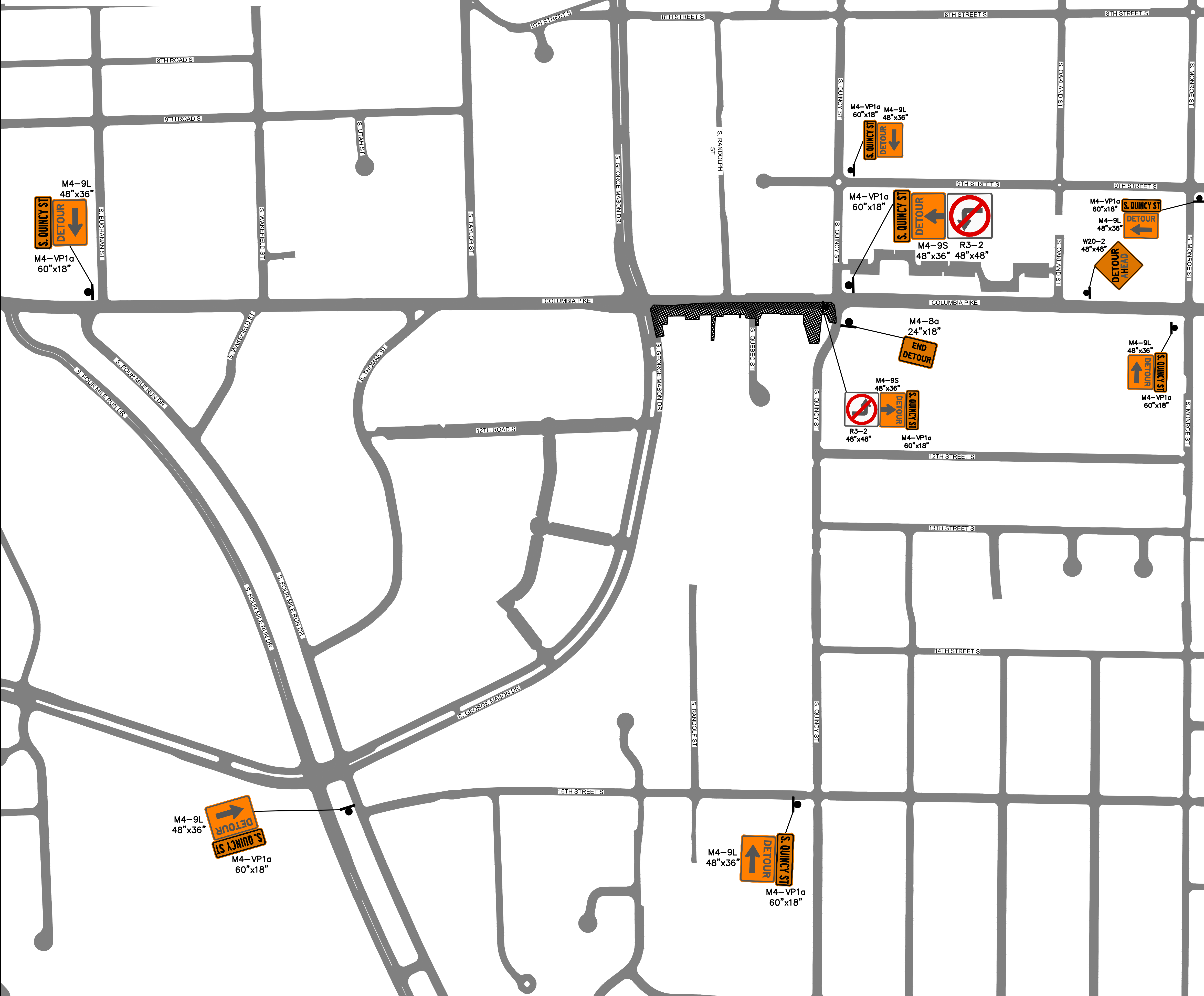

GRAPHIC SCALE IN FEET

0 100 200 400

MAINTENANCE OF TRAFFIC LEGEND

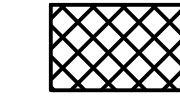

WORK ZONE



DETOUR SIGN

NOTES:

1. **CONTRACTOR TO LAY OUT
DETOUR SIGNAGE IN
CONFORMANCE WITH THE
VIRGINIA WORK AREA
PROTECTION MANUAL,
SPECIFICALLY TEMPORARY
TRAFFIC CONTROL FIGURE 34.2.**



ARLINGTON
VIRGINIA

DEPARTMENT OF
ENVIRONMENTAL SERVICES

Facilities & Engineering Division
Engineering Bureau
2100 Clarendon Boulevard, Suite 813
Arlington, VA 22201
Phone: 703.228.3629
Fax: 703.228.3606

Kimley»Horn
Kimley-Horn
and Associates, Inc.

© 2021 KIMLEY-HORN AND ASSOCIATES, INC.
11400 Commerce Park Drive, Suite 400
Reston Virginia 20191
Phone: 703-674-1300
Fax: 703-674-1350

Seal



Approvals

Date _____

Design Team Engineer Supervisor

Construction Management Supervisor

Water, Sewer, Streets Bureau Chief

Transportation Director

Project Manager

[illegible]

Designed: EJD
 Drawn: OCD
 Checked: MRA
 Miss Utility Transmittal #:

Filename: PHASE 4A DETOUR.dwg
 Path: K:\NVA_RDWY\110010073_Columbus Pike Multimodal Production\Task
 7.5 Final Design of Columbus Pike Segments\Segment P7.5.2 - 100%
 Design Plans\Sheets
 Plotted: October 12, 2021
 Plotted by: Patrick.Husted

ARLINGTON COUNTY, VIRGINIA DEPARTMENT OF ENVIRONMENTAL SERVICES	
MAINTENANCE OF TRAFFIC PHASE 1C DETOUR COLUMBIA PIKE - ROUTE 244 COLUMBIA PIKE - MULTIMODAL STREET IMPROVEMENTS SEGMENT F	
SCALE:	HOR. 1"=200'
SHEET:	F19.18 of F19.31



ARLINGTON
VIRGINIA

VIRGINIA
Luis Araya
LUIS ARAYA
BUREAU CHIEF, DES - DEVELOPMENT SERVICES

DEPARTMENT OF ENVIRONMENTAL SERVICES

10/19/2021
APPROVAL DATE

DETOUR PLAN 1D: S QUINCY ST

The map illustrates the detour route for S. Quincy St. The construction zone is located between 9th Street S and 12th Street S. The detour route is indicated by a shaded area and various traffic signs.

Signs and Locations:

- 8th Street S:**
 - At S. Taylor St: S. Quincy St Detour (Right Turn) (M4-9R, 48"x36")
 - At S. George Mason Dr: S. Quincy St Detour (Right Turn) (M4-VP1a, 60"x18")
- 9th Street S:**
 - At S. Randolph St: S. Quincy St Detour (Down Arrow) (M4-9R, 48"x36")
 - At S. Quincy St: S. Quincy St Detour (Down Arrow) (M4-VP1a, 60"x18")
 - At S. Oakland St: S. Quincy St Detour (Down Arrow) (M4-VP1a, 60"x18")
 - At S. Monroe St: S. Quincy St Detour (Left Turn) (M4-VP1a, 60"x18")
- 10th Street S:**
 - At S. Quincy St: S. Quincy St Detour (Left Turn) (M4-VP1a, 60"x18")
 - At S. Oakland St: S. Quincy St Detour (Left Turn) (M4-9S, 48"x36")
 - At S. Monroe St: S. Quincy St Detour (Left Turn) (M4-VP1a, 60"x18")
- 11th Street S:**
 - At S. Quincy St: S. Quincy St Detour (Left Turn) (M4-VP1a, 60"x18")
 - At S. Oakland St: S. Quincy St Detour (Left Turn) (M4-9S, 48"x36")
 - At S. Monroe St: S. Quincy St Detour (Left Turn) (M4-VP1a, 60"x18")
- 12th Street S:**
 - At S. Quincy St: S. Quincy St Detour (Left Turn) (M4-VP1a, 60"x18")
 - At S. Oakland St: S. Quincy St Detour (Left Turn) (M4-9S, 48"x36")
 - At S. Monroe St: S. Quincy St Detour (Left Turn) (M4-VP1a, 60"x18")
- 13th Street S:**
 - At S. Quincy St: S. Quincy St Detour (Left Turn) (M4-VP1a, 60"x18")
 - At S. Oakland St: S. Quincy St Detour (Left Turn) (M4-9S, 48"x36")
 - At S. Monroe St: S. Quincy St Detour (Left Turn) (M4-VP1a, 60"x18")

Additional Signs:

- W20-2:** 48"x48" (Detour Ahead)
- R3-2:** 48"x48" (No Left Turn)
- M4-8a:** 24"x18" (End Detour)

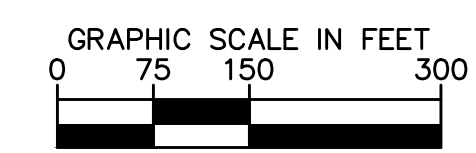

1. CONTRACTOR TO LAY OUT
DETOUR SIGNAGE IN
CONFORMANCE WITH THE
VIRGINIA WORK AREA
PROTECTION MANUAL,
SPECIFICALLY TEMPORARY
TRAFFIC CONTROL FIGURE 34.2.

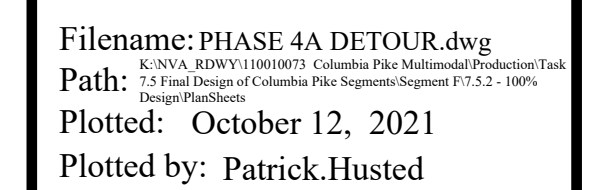

SCALE:	HOR. 1"=150'	SHEET:	F19.19 of F19.31
--------	--------------	--------	------------------

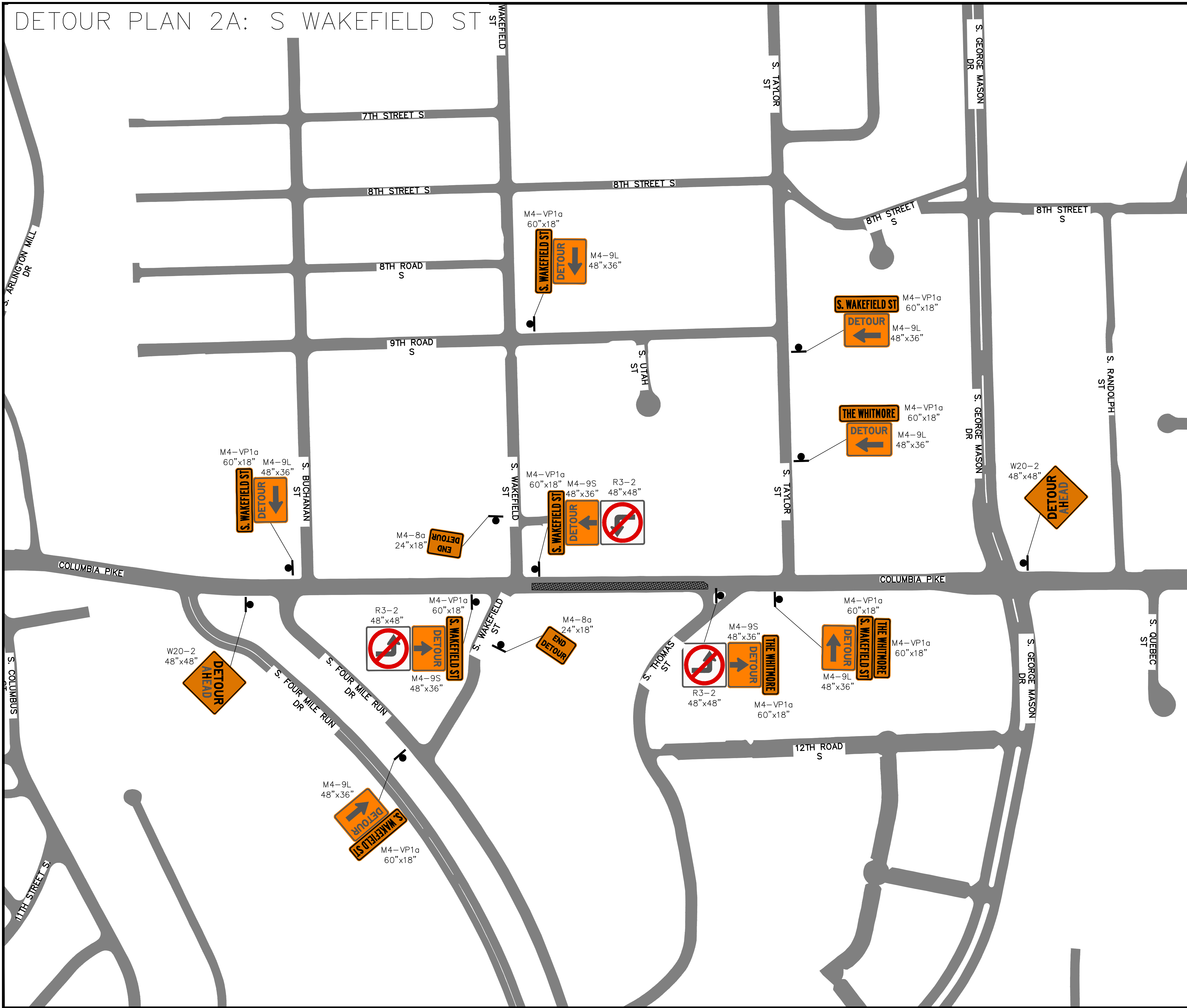

MAINTENANCE OF TRAFFIC LEGEND

WORK ZONE

DETOUR SIGN

NOTES:

1. CONTRACTOR TO LAY OUT DETOUR SIGNAGE IN CONFORMANCE WITH THE VIRGINIA WORK AREA PROTECTION MANUAL, SPECIFICALLY TEMPORARY TRAFFIC CONTROL FIGURE 34.2.

ARLINGTON VIRGINIA

DEPARTMENT OF ENVIRONMENTAL SERVICES

Facilities & Engineering Division
Engineering Bureau
2100 Clarendon Boulevard, Suite 813
Arlington, VA 22201
Phone: 703.228.5629
Fax: 703.228.3606

Kimley»Horn
Kimley-Horn
and Associates, Inc.

© 2021 KIMLEY-HORN AND ASSOCIATES, INC.
11400 Commerce Park Drive, Suite 400
Reston, Virginia 20191
Phone: 703-674-1300
Fax: 703-674-1350

Seal

Approvals	Date
Design Team Engineer Supervisor	
Construction Management Supervisor	
Water, Sewer, Streets Bureau Chief	
Transportation Director	
Project Manager	

Revisions	Date

Designed: EJD

Drawn: OCD

Checked: MRA

Miss Utility Transmittal #:

Filename: PHASE 4A DETOUR.dwg

Path: L:\VNA_2020\Y11010073 Columbia Pike Multimodal Production\Task 12 - Final Design of Columbia Pike Segment\Report\T12.2 - 100% Design\Platblm

Plotted: September 02, 2021

Plotted by: patrick.husted

ARLINGTON COUNTY, VIRGINIA
DEPARTMENT OF ENVIRONMENTAL SERVICES

MAINTENANCE OF TRAFFIC PHASE 2A DETOUR
COLUMBIA PIKE - ROUTE 244
COLUMBIA PIKE - MULTIMODAL STREET IMPROVEMENTS
SEGMENT F

SCALE:	HOR. 1"=150'	SHEET:	F19.20 of F19.31
--------	--------------	--------	------------------

DETOUR PLAN 2B: S THOMAS ST/S TAYLOR ST/S GEORGE MASON DR

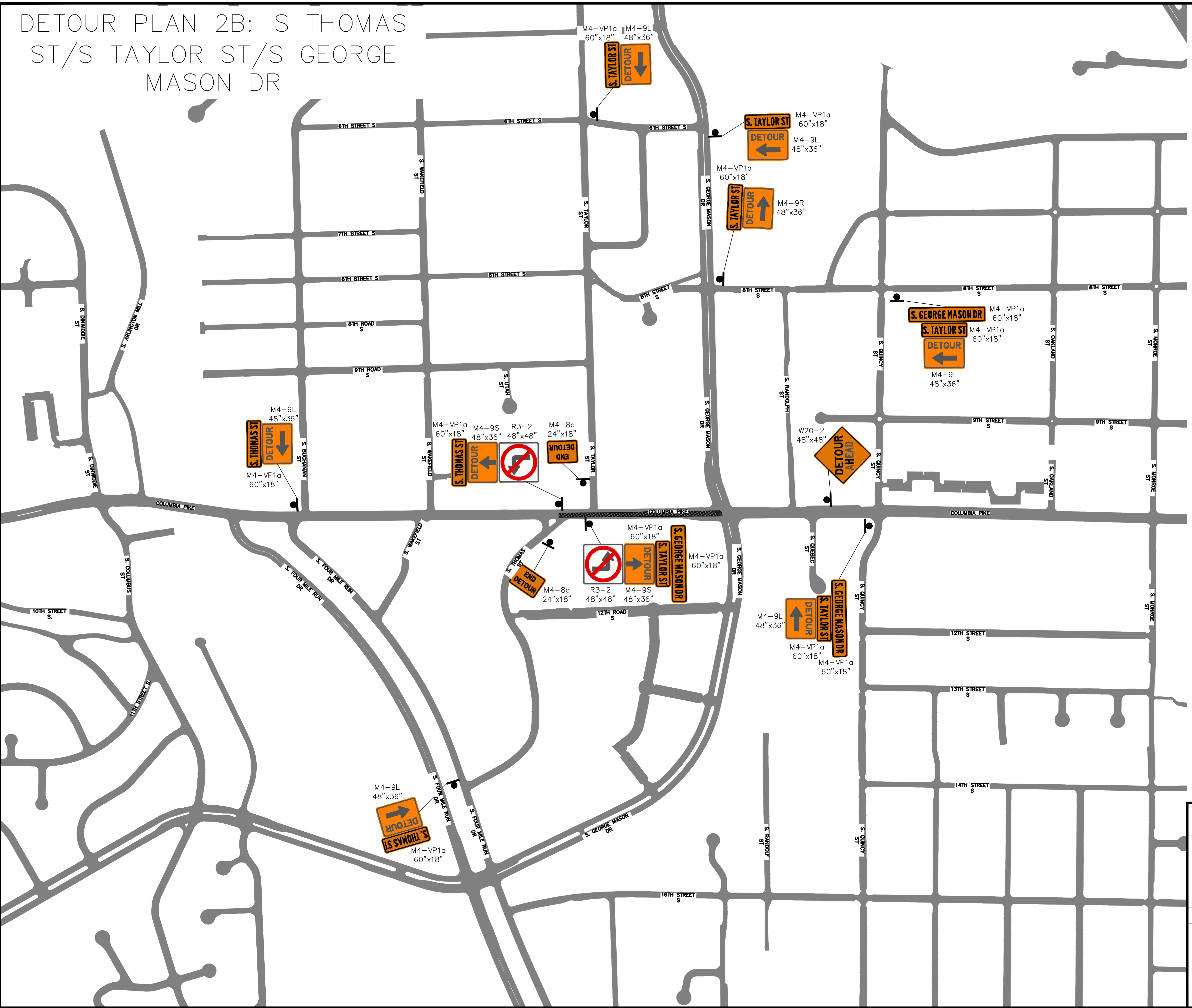

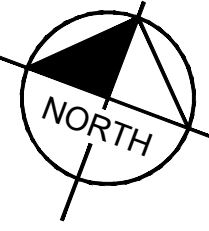

GRAPHIC SCALE IN FEET
0 125 250 500

MAINTENANCE OF TRAFFIC LEGEND

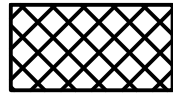
 WORK ZONE

 DETOUR SIGN

NOTES:

1. CONTRACTOR TO LAY OUT DETOUR SIGNAGE IN CONFORMANCE WITH THE VIRGINIA WORK AREA PROTECTION MANUAL, SPECIFICALLY TEMPORARY TRAFFIC CONTROL FIGURE 34.2.



ARLINGTON
VIRGINIA

DEPARTMENT OF ENVIRONMENTAL SERVICES

Facilities & Engineering Division
Engineering Bureau
2100 Clarendon Boulevard, Suite 813
Arlington, VA 22201
Phone: 703.228.5629
Fax: 703.228.3606

Kimley»Horn
Kimley-Horn
and Associates, Inc.

© 2021 KIMLEY-HORN AND ASSOCIATES, INC.
11400 Commerce Park Drive, Suite 400
Reston, Virginia 20191
Phone: 703-674-1300
Fax: 703-674-1300

Seal



Approvals

Date

Design Team Engineer Supervisor

Construction Management Supervisor

Water, Sewer, Streets Bureau Chief

Transportation Director

Project Manager

Revisions

Date

Designed: EJD

Drawn: OCD

Checked: MRA

Miss Utility Transmittal #:

Filename: PHASE 4A DETOUR.dwg

Path: \\C:\NA_A\000\11010071 Columbia Pike Multimodal Production\Task 1 - Final Design of Columbia Pike Segment\Segment F\1-2 - 100% Design\Plottings

Plotted: September 02, 2021

Plotted by: patrick.husted

ARLINGTON COUNTY, VIRGINIA
DEPARTMENT OF ENVIRONMENTAL SERVICES

MAINTENANCE OF TRAFFIC PHASE 2B DETOUR
COLUMBIA PIKE - ROUTE 244
COLUMBIA PIKE - MULTIMODAL STREET IMPROVEMENTS
SEGMENT F

SCALE: HOR. 1"=225'

SHEET: F19.21 of F19.31

DETOUR PLAN 2C: S RANDOLF ST/S QUINCY ST/S
QUEBEC ST/S GEORGE MASON DR

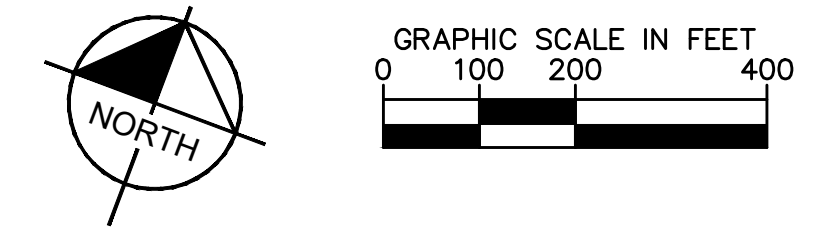
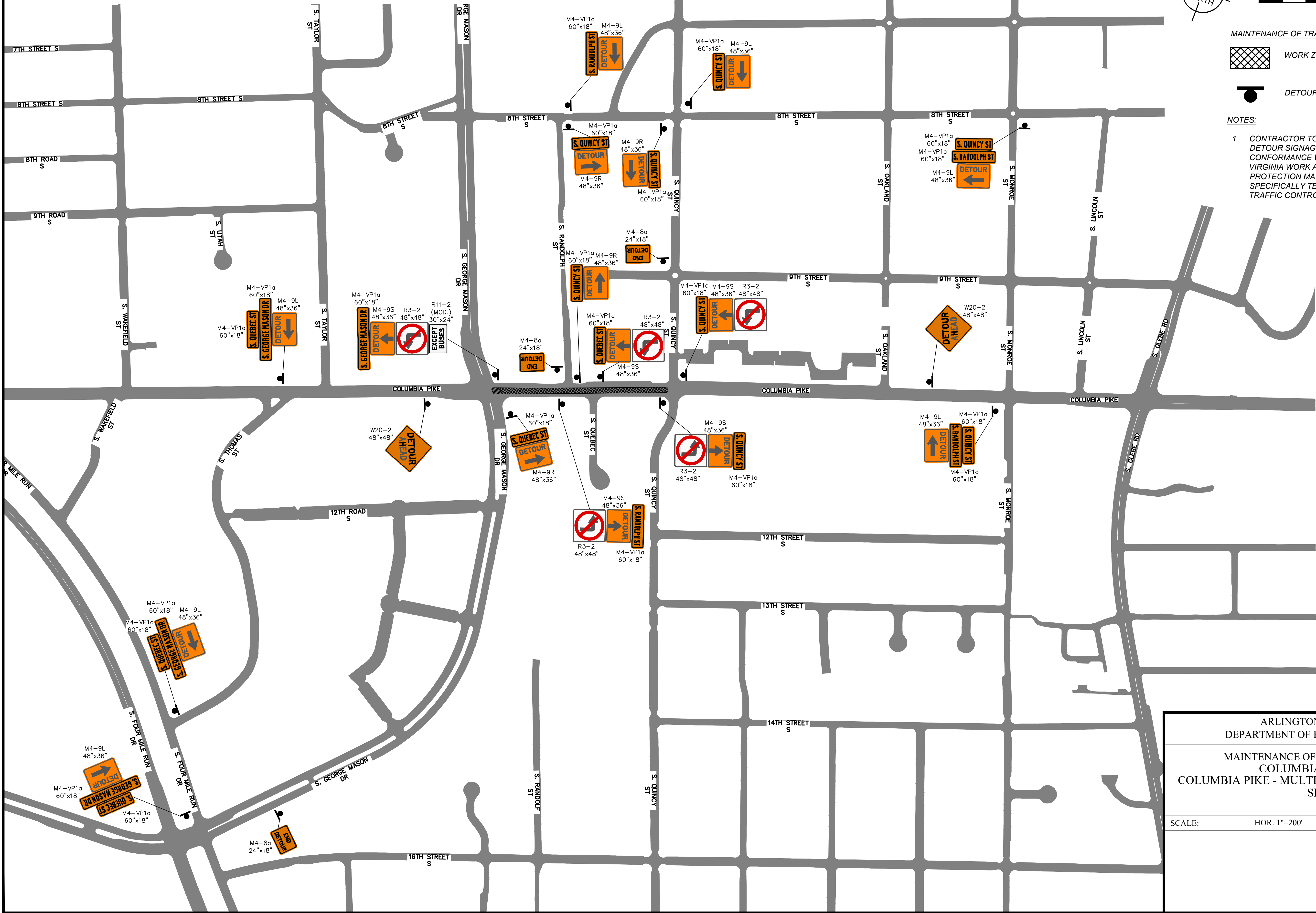

MAINTENANCE OF TRAFFIC LEGEND

WORK ZONE

DETOUR SIGN

NOTES:

1. CONTRACTOR TO LAY OUT DETOUR SIGNAGE IN CONFORMANCE WITH THE VIRGINIA WORK AREA PROTECTION MANUAL, SPECIFICALLY TEMPORARY TRAFFIC CONTROL FIGURE 34.2.

ARLINGTON VIRGINIA

DEPARTMENT OF ENVIRONMENTAL SERVICES

Facilities & Engineering Division
Engineering Bureau
2100 Clarendon Boulevard, Suite 813
Arlington, VA 22201
Phone: 703.228.5629
Fax: 703.228.3606

Kimley»Horn
Kimley-Horn
and Associates, Inc.

© 2021 KIMLEY-HORN AND ASSOCIATES, INC.
11400 Commerce Park Drive, Suite 400
Reston, Virginia 20191
Phone: 703-674-1300
Fax: 703-674-1350

Seal

Approvals _____ Date _____

Design Team Engineer Supervisor _____

Construction Management Supervisor _____

Water, Sewer, Streets Bureau Chief _____

Transportation Director _____

Project Manager _____

Revisions	Date

Designed: EJD
Drawn: OCD
Checked: MRA
Miss Utility Transmittal #:

Filename: PHASE 4A DETOUR.dwg
Path: \\S:\NA_2021\Y11010073 Columbia Pike Multimodal Production\Task
12 Final Design of Columbia Pike Segment\Segment F\12-100%
Design\Plottings
Plotted: September 02, 2021
Plotted by: patrick.husted

ARLINGTON COUNTY, VIRGINIA
DEPARTMENT OF ENVIRONMENTAL SERVICES

MAINTENANCE OF TRAFFIC PHASE 2C DETOUR
COLUMBIA PIKE - ROUTE 244
COLUMBIA PIKE - MULTIMODAL STREET IMPROVEMENTS
SEGMENT F

SCALE: HOR. 1"=200' SHEET: F19.22 of F19.31

ARLINGTON VIRGINIA

Luiz Araya
LUIS ARAYA
BUREAU CHIEF, DES - DEVELOPMENT SERVICES

DEPARTMENT OF ENVIRONMENTAL SERVICES

10/19/2021
APPROVAL DATE

DETOUR PLAN 2D: S QUINCY ST/S
OAKLAND ST



ARLINGTON
VIRGINIA

DEPARTMENT OF
ENVIRONMENTAL SERVICES

Facilities & Engineering Division
Engineering Bureau
2100 Clarendon Boulevard, Suite 813
Arlington, VA 22201
Phone: 703.228.5629
Fax: 703.228.3606

Kimley»Horn
Kimley-Horn
and Associates, Inc.
© 2021 KIMLEY-HORN AND ASSOCIATES, INC.
11400 Commerce Park Drive, Suite 400
Reston, Virginia 20191
Phone: 703-674-1300
Fax: 703-674-1350

Seal

Approvals _____ Date _____

Design Team Engineer Supervisor _____

Construction Management Supervisor _____

Water, Sewer, Streets Bureau Chief _____

Transportation Director _____

Project Manager _____

Revisions	Date

Designed: EJD
Drawn: OCD
Checked: MRA
Miss Utility Transmittal #:

Filename: PHASE 4A DETOUR.dwg
Path: I:\Projects\2021\10\10\073 Columbia Pike Multimodal Production Task
Plotted: September 02, 2021
Plotted by: patrick.husted

ARLINGTON COUNTY, VIRGINIA
DEPARTMENT OF ENVIRONMENTAL SERVICES

MAINTENANCE OF TRAFFIC PHASE 2D DETOUR
COLUMBIA PIKE - ROUTE 244
COLUMBIA PIKE - MULTIMODAL STREET IMPROVEMENTS
SEGMENT F

SCALE:	HOR. 1"=150'	SHEET:	F19.23 of F19.31
--------	--------------	--------	------------------

DETOUR PLAN 3B: S TAYLOR ST/S GEORGE MASON DR



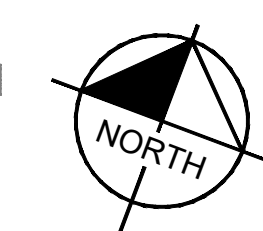

GRAPHIC SCALE IN FEET
0 112.5 225 450

MAINTENANCE OF TRAFFIC LEGEND

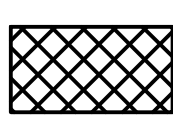
 WORK ZONE

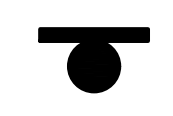
 DETOUR SIGN

NOTES:

1. CONTRACTOR TO LAY OUT
DETOUR SIGNAGE IN
CONFORMANCE WITH THE
VIRGINIA WORK AREA
PROTECTION MANUAL,
SPECIFICALLY TEMPORARY
TRAFFIC CONTROL FIGURE 34.2.



ARLINGTON
VIRGINIA

DEPARTMENT OF
ENVIRONMENTAL SERVICES

Facilities & Engineering Division
Engineering Bureau
2100 Clarendon Boulevard, Suite 813
Arlington, VA 22201
Phone: 703.228.5629
Fax: 703.228.3606

Kimley»Horn

Kimley-Horn
and Associates, Inc.

© 2021 KIMLEY-HORN AND ASSOCIATES, INC.
11400 Commerce Park Drive, Suite 400
Reston, Virginia 20191
Phone: 703-674-1300
Fax: 703-674-1350

Seal



Approvals

Date

Design Team Engineer Supervisor

Construction Management Supervisor

Water, Sewer, Streets Bureau Chief

Transportation Director

Project Manager

Revisions

Date

Designed: EJD

Drawn: OCD

Checked: MRA

Miss Utility Transmittal #:

Filename: PHASE 4A DETOUR.dwg

Path: C:\NVA_2020\Y11010071 Columbia Pike Multimodal Production\Task 12 - Final Design of Columbia Pike Segment Segment F17.5.2 - 100% Design\Drawings

Plotted: October 12, 2021

Plotted by: Patrick.Husted

ARLINGTON COUNTY, VIRGINIA
DEPARTMENT OF ENVIRONMENTAL SERVICES

MAINTENANCE OF TRAFFIC PHASE 3B DETOUR
COLUMBIA PIKE - ROUTE 244
COLUMBIA PIKE - MULTIMODAL STREET IMPROVEMENTS
SEGMENT F

SCALE: HOR. 1"=225'

SHEET: F19.25 of F19.31



ARLINGTON
VIRGINIA

DEPARTMENT OF
ENVIRONMENTAL SERVICES

LORI ARAYA
BUREAU CHIEF, DES - DEVELOPMENT SERVICES

10/19/2021

APPROVAL DATE

DETOUR PLAN 3C: S QUINCY ST/S RANDOLPH ST/S GEORGE MASON DR



NORTH

GRAPHIC SCALE IN FEET

0 100 200 400

MAINTENANCE OF TRAFFIC LEGEND

WORK ZONE

DETOUR SIGN

NOTES:

1. CONTRACTOR TO LAY OUT DETOUR SIGNAGE IN CONFORMANCE WITH THE VIRGINIA WORK AREA PROTECTION MANUAL, SPECIFICALLY TEMPORARY TRAFFIC CONTROL FIGURE 34.2.

Seal

Approvals

Date

Design Team Engineer Supervisor

Construction Management Supervisor

Water, Sewer, Streets Bureau Chief

Transportation Director

Project Manager

Revisions	Date

Designed: EJD
Drawn: OCD
Checked: MRA
Miss Utility Transmittal #:

Filename: PHASE 4A DETOUR.dwg
Path: C:\NVA_2020\Y11010071 Columbia Pike Multimodal Production\Task 12 - Final Design of Columbia Pike Segment Segment F\12.1 - 100% Design\Drawings
Plotted: October 12, 2021
Plotted by: Patrick.Husted

ARLINGTON COUNTY, VIRGINIA
DEPARTMENT OF ENVIRONMENTAL SERVICES

MAINTENANCE OF TRAFFIC PHASE 3C DETOUR
COLUMBIA PIKE - ROUTE 244
COLUMBIA PIKE - MULTIMODAL STREET IMPROVEMENTS
SEGMENT F

SCALE: HOR. 1"=200'

SHEET: F19.26 of F19.31

DETOUR PLAN 3D: S QUINCY ST TO S OAKLAND ST

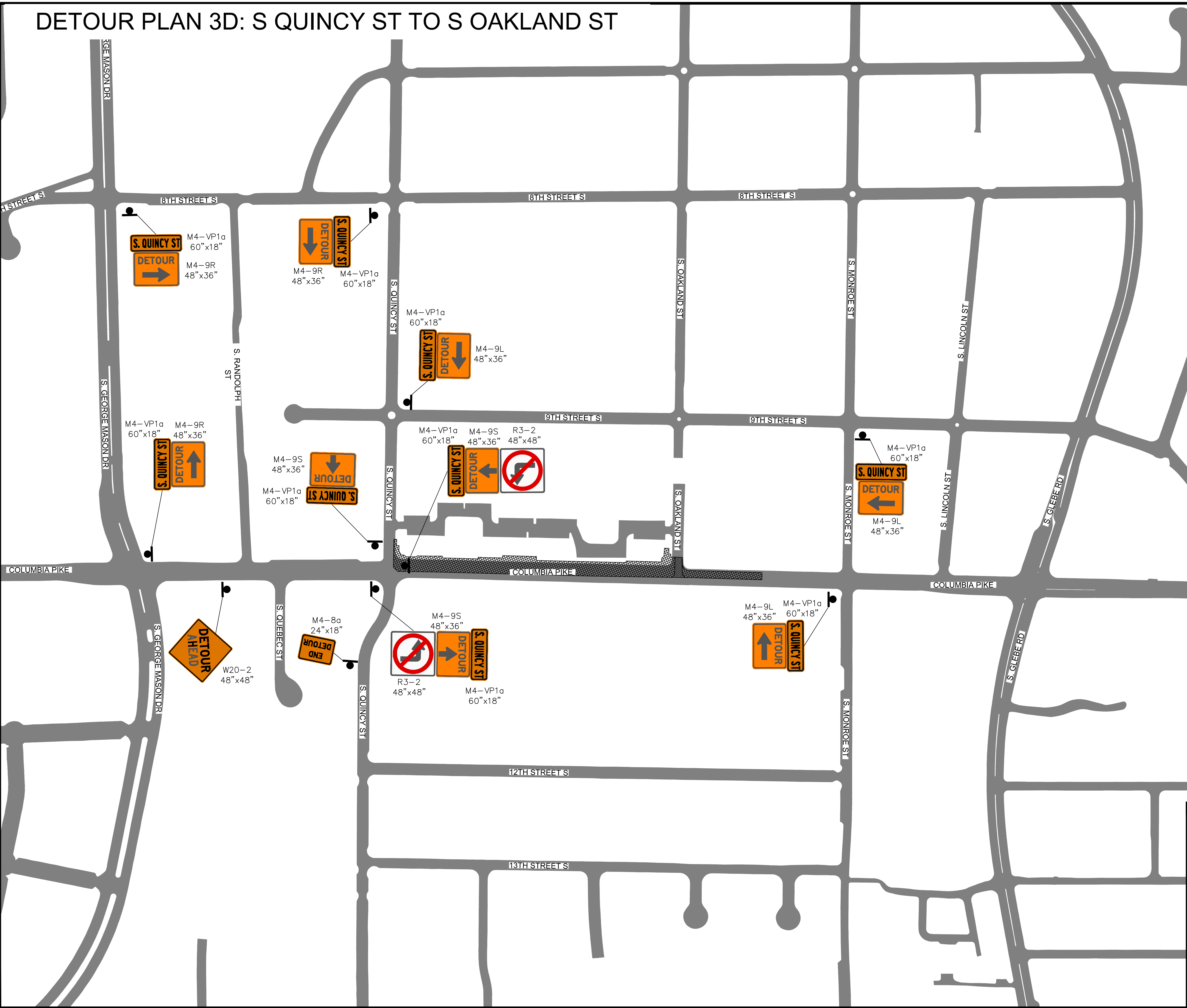

NORTH

GRAPHIC SCALE IN FEET

0 75 150 300

MAINTENANCE OF TRAFFIC LEGEND

WORK ZONE

DETOUR SIGN

NOTES:

1. CONTRACTOR TO LAY OUT DETOUR SIGNAGE IN CONFORMANCE WITH THE VIRGINIA WORK AREA PROTECTION MANUAL, SPECIFICALLY TEMPORARY TRAFFIC CONTROL FIGURE 34.2.

ARLINGTON VIRGINIA

DEPARTMENT OF ENVIRONMENTAL SERVICES

Facilities & Engineering Division
Engineering Bureau
2100 Clarendon Boulevard, Suite 813
Arlington, VA 22201
Phone: 703.228.5629
Fax: 703.228.3606

Kimley»Horn
Kimley-Horn and Associates, Inc.
© 2021 KIMLEY-HORN AND ASSOCIATES, INC.
11400 Commerce Park Drive, Suite 400
Reston, Virginia 20191
Phone: 703-674-1500
Fax: 703-674-1500

Seal

Approvals	Date
Design Team Engineer Supervisor	
Construction Management Supervisor	
Water, Sewer, Streets Bureau Chief	
Transportation Director	
Project Manager	

Revisions	Date

Designed: EJD
Drawn: OCD
Checked: MRA
Miss Utility Transmittal #:

Filename: PHASE 4A DETOUR.dwg
Path: Z:\VA_2020\Y11010071 Columbia Pike Multimodal Production\Task 1 - Final Design of Columbia Pike Segment Segment F17.5.2 - 100% Design\Drawings
Plotted: October 12, 2021
Plotted by: Patrick.Husted

ARLINGTON COUNTY, VIRGINIA
DEPARTMENT OF ENVIRONMENTAL SERVICES

MAINTENANCE OF TRAFFIC PHASE 3D DETOUR
COLUMBIA PIKE - ROUTE 244
COLUMBIA PIKE - MULTIMODAL STREET IMPROVEMENTS
SEGMENT F

SCALE:	HOR. 1"=150'	SHEET:	F19.27 of F19.31
--------	--------------	--------	------------------

DETOUR PLAN 4A & 4B: COLUMBIA PIKE

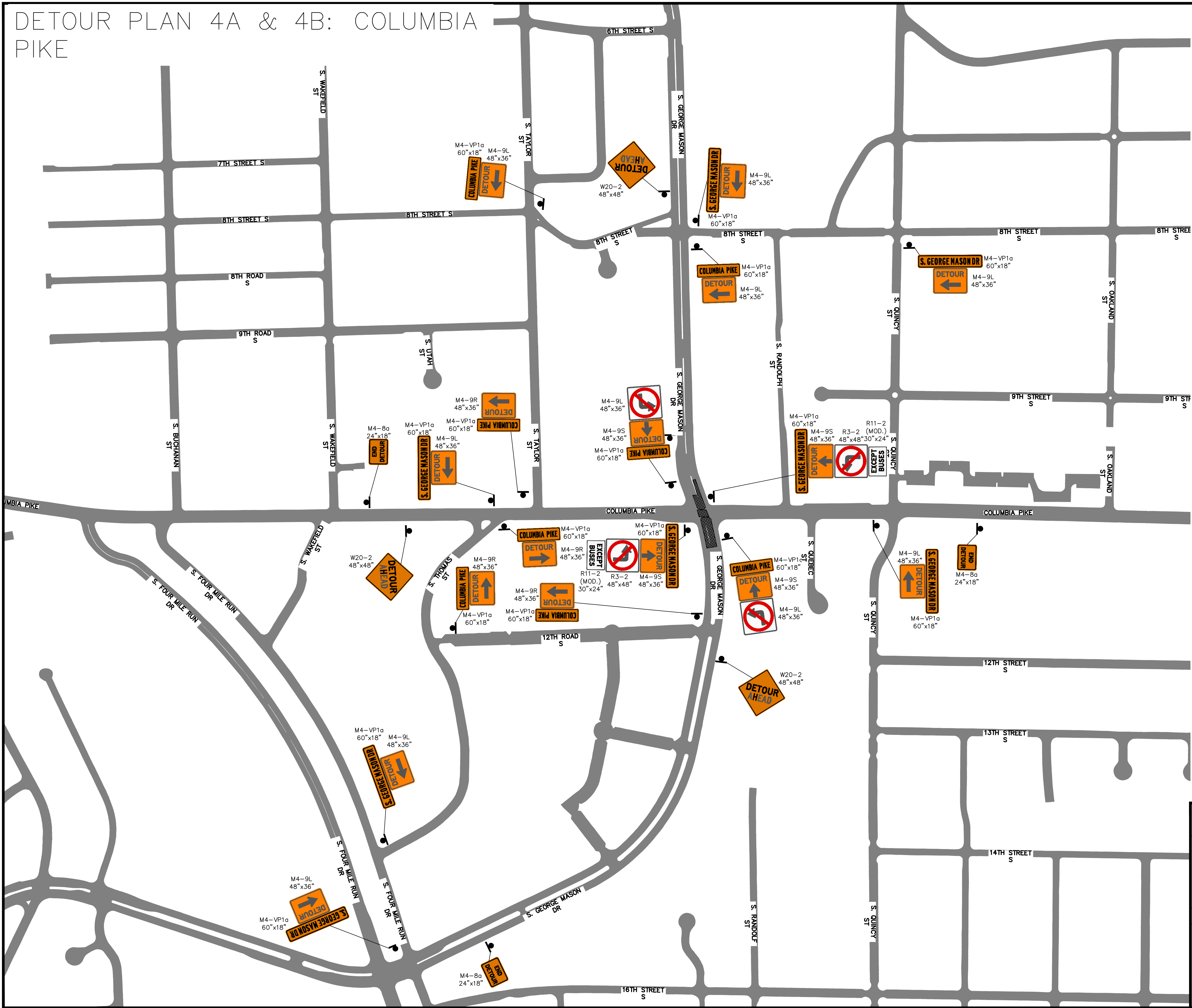

ARLINGTON
VIRGINIA

DEPARTMENT OF
ENVIRONMENTAL SERVICES

Facilities & Engineering Division
Engineering Bureau
2100 Clarendon Boulevard, Suite 813
Arlington, VA 22201
Phone: 703.228.5629
Fax: 703.228.3606

Kimley»Horn
Kimley-Horn
and Associates, Inc.

© 2021 KIMLEY-HORN AND ASSOCIATES, INC.
11400 Commerce Park Drive, Suite 400
Reston, Virginia 20191
Phone: 703-674-1300
Fax: 703-674-1350

Seal

Approvals _____ Date _____

Design Team Engineer Supervisor _____

Construction Management Supervisor _____

Water, Sewer, Streets Bureau Chief _____

Transportation Director _____

Project Manager _____

Revisions	Date

Designed: EJD
Drawn: OCD
Checked: MRA
Miss Utility Transmittal #:

Filename: PHASE 4A DETOUR.dwg
Path: C:\NVA_2020\Y11010071 Columbia Pike Multimodal Production\Task
1 - Final Design of Columbia Pike Segment\Segment F1.5.2 - 100%
Design\Plottings
Plotted: September 02, 2021
Plotted by: patrick.husted

ARLINGTON COUNTY, VIRGINIA
DEPARTMENT OF ENVIRONMENTAL SERVICES

MAINTENANCE OF TRAFFIC PHASE 4A & 4B DETOUR
COLUMBIA PIKE - ROUTE 244
COLUMBIA PIKE - MULTIMODAL STREET IMPROVEMENTS
SEGMENT F

SCALE:	HOR. 1"=150'	SHEET:	F19.28 of F19.31
--------	--------------	--------	------------------

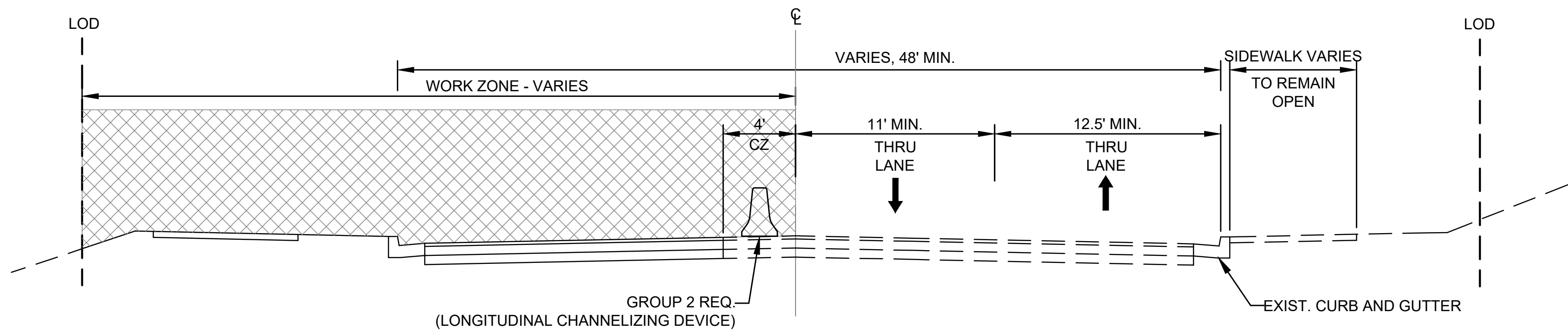

TYPICAL SECTION - COLUMBIA PIKE - PHASE 1A, 1B, 1C, 1D
SOUTH/EASTBOUND LANES

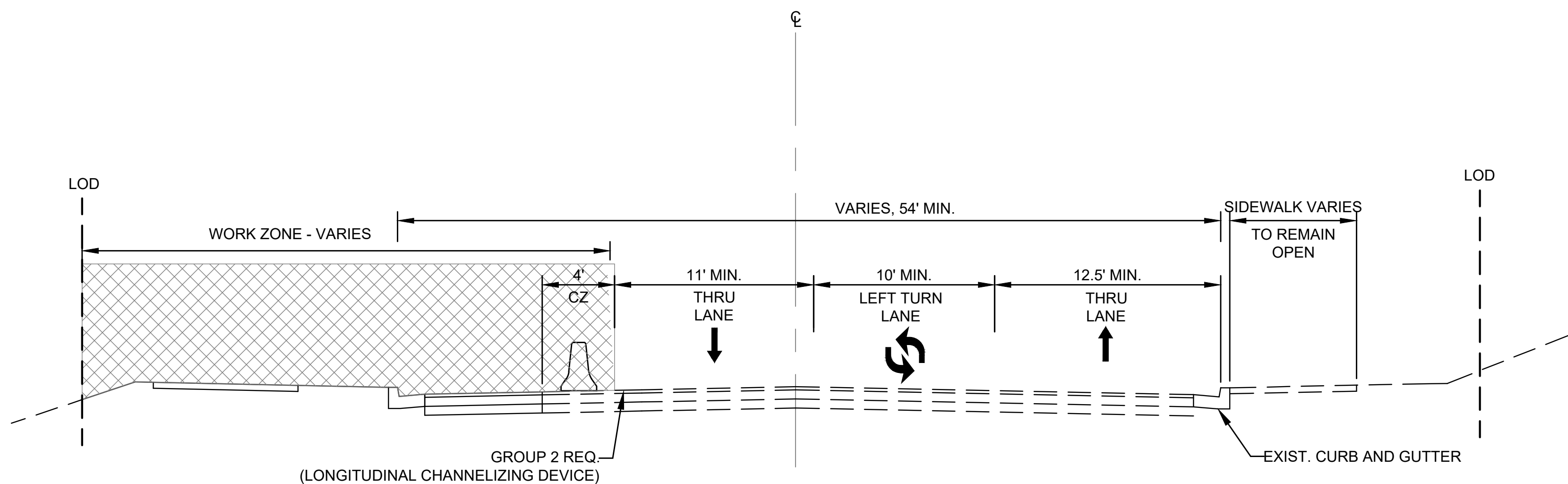

TYPICAL SECTION - COLUMBIA PIKE - PHASE 1B, 1C
SOUTH/EASTBOUND LANES
AT S. GEORGE MASON DR

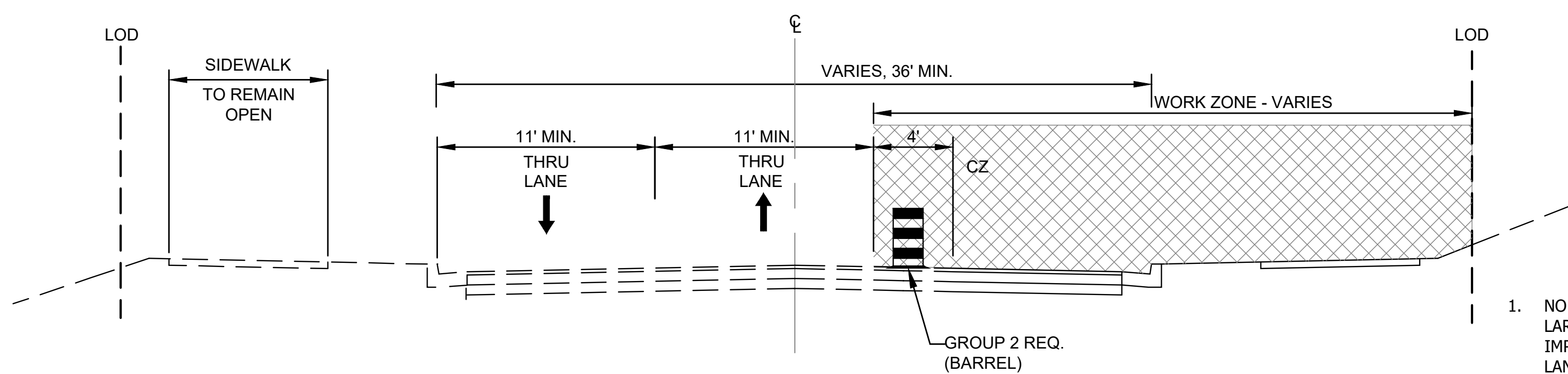

TYPICAL SECTION - S. THOMAS ST - PHASE 1A
SOUTHBOUND LANES

SEQUENCE OF CONSTRUCTION

UNLESS OTHERWISE APPROVED BY THE ENGINEER AND/OR COUNTY, THE CONTRACTOR IS TO PLAN AND EXECUTE THE WORK ACCORDING TO THE FOLLOWING:

PHASE 1

- INSTALL EROSION AND SEDIMENT CONTROL (ESC) MEASURES AS REQUIRED FOR THIS PHASE. APPROVAL OF ESC INSTALLATIONS BY ARLINGTON COUNTY IS REQUIRED.
- IDENTIFY CONSTRUCTION ACCESS POINTS.
- INSTALL MOT PHASE 1, DETOURS, AND TEMPORARY SIGNAL MODIFICATIONS.
- INSTALL TEMPORARY EASTBOUND AND WESTBOUND BUS STOPS IN LOCATIONS SHOWN ON PLANS. TEMPORARY BUS STOPS SHALL REMAIN CLEAR AND ACCESSIBLE FOR THE DURATION OF THIS PHASE. TEMPORARY BUS STOPS MAY BE REMOVED UPON OPENING OF PROPOSED BUS STOPS OR OPENING OF TEMPORARY BUS STOPS ASSOCIATED WITH SUBSEQUENT PHASES.
- CONSTRUCT WET AND DRY UTILITIES AND SERVICE CONNECTIONS AND EXTEND TO LIMITS FOR FUTURE PHASES. CONTRACTOR TO DETERMINE SEQUENCE OF INSTALLATION.
- CONSTRUCT ROADWAY SECTION, LESS TOP COURSE OF PAVEMENT, WITHIN THE WORK ZONE. TEMPORARY RECOVERY AREAS AND OTHER SAFETY MEASURES AS REQUIRED BY THE VA WAPM SHALL BE INSTALLED AS NECESSARY. CONSTRUCT CURB AND GUTTER, SIDEWALK, AND OTHER PROPOSED IMPROVEMENTS ON THE SOUTH SIDE OF COLUMBIA PIKE.

PHASE 2

- INSTALL ESC MEASURES AS REQUIRED FOR THIS PHASE. APPROVAL OF ESC INSTALLATIONS BY ARLINGTON COUNTY IS REQUIRED.
- IDENTIFY CONSTRUCTION ACCESS POINTS.
- INSTALL MOT PHASE 2 AND ASSOCIATED DETOURS
- INSTALL TEMPORARY EASTBOUND AND WESTBOUND BUS STOPS IN LOCATIONS SHOWN ON PLANS. TEMPORARY BUS STOPS SHALL REMAIN CLEAR AND ACCESSIBLE FOR THE DURATION OF THIS PHASE. TEMPORARY BUS STOPS MAY BE REMOVED UPON OPENING OF PROPOSED BUS STOPS OR OPENING OF TEMPORARY BUS STOPS ASSOCIATED WITH SUBSEQUENT PHASES.
- CONSTRUCT WET AND DRY UTILITIES AND SERVICE CONNECTIONS AND EXTEND TO LIMITS FOR FUTURE PHASES.
- CONSTRUCT ROADWAY SECTION AND MEDIANS, LESS TOP COURSE OF PAVEMENT, WITHIN THE WORK ZONE.

PHASE 3

- INSTALL ESC MEASURES AS REQUIRED FOR THIS PHASE. APPROVAL OF ESC INSTALLATIONS BY ARLINGTON COUNTY IS REQUIRED.
- IDENTIFY CONSTRUCTION ACCESS POINTS.
- INSTALL MOT PHASE 3, DETOURS, AND TEMPORARY TRAFFIC SIGNAL MODIFICATIONS.
- INSTALL TEMPORARY BUS STOP IN LOCATION SHOWN ON THE PLANS. TEMPORARY BUS STOP SHALL REMAIN CLEAR AND ACCESSIBLE FOR THE DURATION OF THIS PHASE.
- CONSTRUCT WET AND DRY UTILITIES AND SERVICE CONNECTIONS. CONSTRUCT ROADWAY SECTION, LESS TOP COURSE OF PAVEMENT, WITHIN THE WORK ZONE. CONSTRUCT CURB AND GUTTER, SIDEWALK, AND OTHER PROPOSED IMPROVEMENTS ON THE NORTH SIDE OF COLUMBIA PIKE WITHIN THE WORK AREAS IDENTIFIED.

PHASE 4

- INSTALL ESC MEASURES AS REQUIRED FOR THIS PHASE. APPROVAL OF ESC INSTALLATIONS BY ARLINGTON COUNTY IS REQUIRED.
- IDENTIFY CONSTRUCTION ACCESS POINTS.
- INSTALL MOT PHASE 4.
- CONSTRUCT WET AND DRY UTILITIES AND SERVICE CONNECTIONS.
- CONSTRUCT ROADWAY SECTION, LESS TOP COURSE OF PAVEMENT, WITHIN THE WORK ZONE. COMPLETE CURB AND GUTTER, SIDEWALK, AND OTHER PROPOSED IMPROVEMENTS ON S. GEORGE MASON DRIVE WITHIN THE WORK AREAS IDENTIFIED.
- INSTALL TOP COURSE OF PAVEMENT, PLACE ALL REMAINING SIGNING AND MARKING, AND COMPLETE PROJECT.

NOTES

1. NO CONSTRUCTION PHASE MAY BE COMBINED WITH ANY OTHER PHASE TO CREATE LARGER WORK AREAS THAN SHOWN IN THE PLANS. NO CONSTRUCTION PHASE MAY BE IMPLEMENTED/ACTIVE AT THE SAME TIME AS ANOTHER PHASE TO AVOID MULTIPLE LANE SHIFTS WITHIN THE PROJECT AREA AT ONE TIME.
2. CONSTRUCTION PHASES MUST BE LIMITED TO THE AREAS DESCRIBED HEREIN AND SHOWN IN THE PLANS. WORK AREAS MAY NOT BE EXPANDED BEYOND THE LIMITS SHOWN IN THE PLANS.
3. SHOULD THE CONTRACTOR WISH TO MODIFY, COMBINE, AND/OR OTHERWISE ALTER THE MAINTENANCE OF TRAFFIC OR CONSTRUCTION PHASING SHOWN HEREIN, THE CONTRACTOR SHALL SUBMIT A REQUEST FOR THIS CHANGE ALONG WITH A PROPOSED PLAN SIGNED BY A QUALIFIED AND LICENSED ENGINEER TO ARLINGTON COUNTY FOR REVIEW AND APPROVAL. THE CONTRACTOR SHALL PROCEED ONLY FOLLOWING APPROVAL OF THE REQUESTED CHANGE AND WRITTEN AUTHORIZATION FROM ARLINGTON COUNTY.
4. REFER TO CONSTRUCTION NOTES ON SHEET F19.1 FOR ALLOWABLE WORK HOURS.
5. CONTRACTOR REQUIRED TO MAINTAIN SAFE AND ADA COMPLIANT PEDESTRIAN ACCESS THROUGHOUT THE WORK AREA AT ALL TIMES. SIDEWALK AND CROSSWALK CLOSURES AS NEEDED SHALL COMPLY WITH THE CONTROL MEASURES SHOWN HEREIN AND WITH THE VA WAPM (CURRENT VERSION).



DEPARTMENT OF
ENVIRONMENTAL SERVICES

Facilities & Engineering Division
Engineering Bureau
2100 Clarendon Boulevard, Suite 813
Arlington, VA 22201
Phone: 703.228.3629
Fax: 703.228.3606

Kimley»Horn
Kimley-Horn
and Associates, Inc.
©2021 KIMLEY-HORN AND ASSOCIATES, INC.
14400 Commerce Park Drive, Suite 400
Reston, Virginia 20191
Phone: 703-674-1300
Fax: 703-674-1300

Seal



Approvals _____ Date _____

Design Team Engineer Supervisor _____

Construction Management Supervisor _____

Water, Sewer, Streets Bureau Chief _____

Transportation Director _____

Project Manager _____

Revisions _____ Date _____

Designed: EJD
Drawn: DHB
Checked: MRA
Miss Utility Transmittal #: _____

Filename: MOT TYPICAL SECTIONS.dwg
Path: C:\NVA_RDP\Y11010071 Columbia Pike Multimodal Production\Task
Design\PlanBooks
Plotted: September 02, 2021
Plotted by: patrick.husted

ARLINGTON COUNTY, VIRGINIA
DEPARTMENT OF ENVIRONMENTAL SERVICES

MOT TYPICAL SECTIONS
COLUMBIA PIKE - ROUTE 244
COLUMBIA PIKE - MULTIMODAL STREET IMPROVEMENTS
SEGMENT F

SCALE: NOT TO SCALE SHEET: F19.29 of F19.31



DEPARTMENT OF
ENVIRONMENTAL SERVICES

10/19/2021
APPROVAL DATE

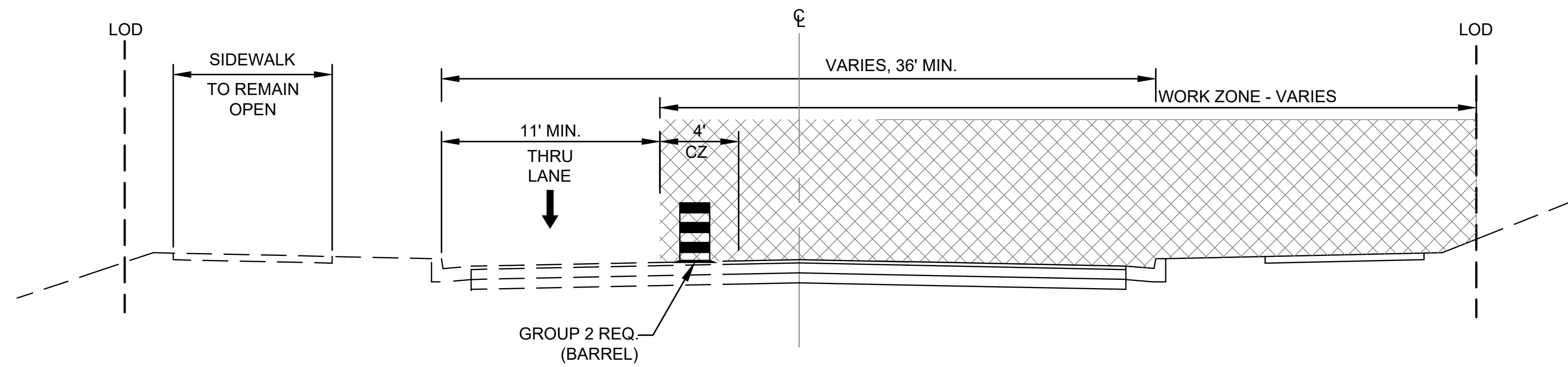

TYPICAL SECTION - S. THOMAS ST - PHASE 1A - TEMPORARY CLOSURE
SOUTHBOUND LANES

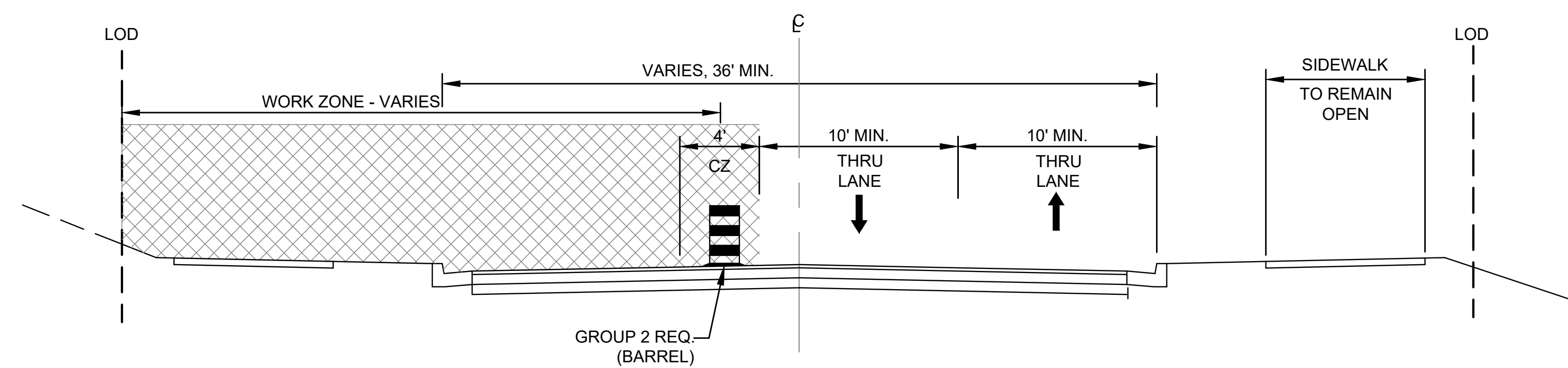

TYPICAL SECTION - S. THOMAS ST - PHASE 1B
NORTHBOUND LANES

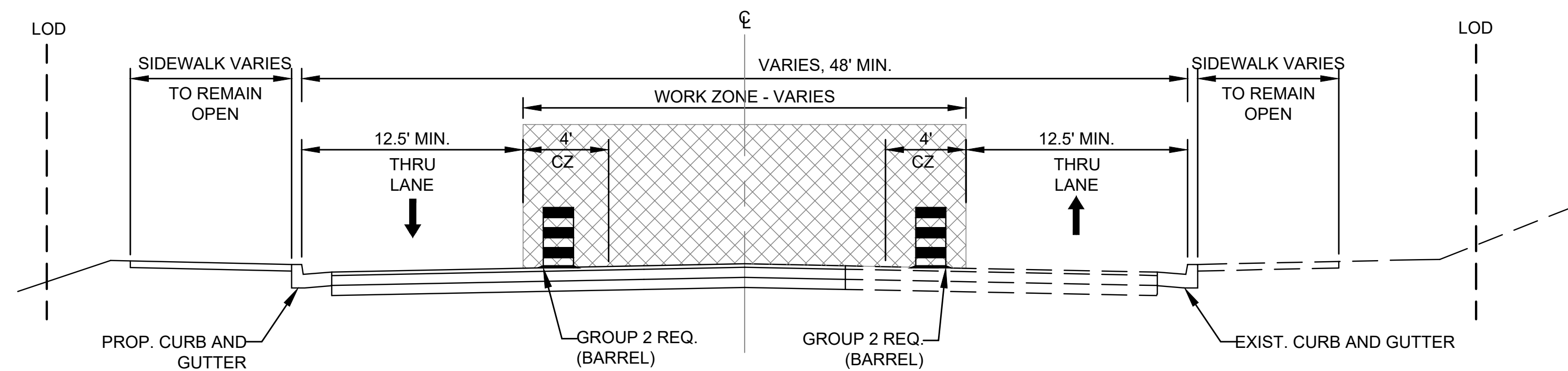

TYPICAL SECTION - COLUMBIA PIKE - PHASE 2A, 2B, 2C, 2D
MEDIAN/CENTER LANES

NOTES

1. NO CONSTRUCTION PHASE MAY BE COMBINED WITH ANY OTHER PHASE TO CREATE LARGER WORK AREAS THAN SHOWN IN THE PLANS. NO CONSTRUCTION PHASE MAY BE IMPLEMENTED/ACTIVE AT THE SAME TIME AS ANOTHER PHASE TO AVOID MULTIPLE LANE SHIFTS WITHIN THE PROJECT AREA AT ONE TIME.
2. CONSTRUCTION PHASES MUST BE LIMITED TO THE AREAS DESCRIBED HEREIN AND SHOWN IN THE PLANS. WORK AREAS MAY NOT BE EXPANDED BEYOND THE LIMITS SHOWN IN THE PLANS.
3. SHOULD THE CONTRACTOR WISH TO MODIFY, COMBINE, AND/OR OTHERWISE ALTER THE MAINTENANCE OF TRAFFIC OR CONSTRUCTION PHASING SHOWN HEREIN, THE CONTRACTOR SHALL SUBMIT A REQUEST FOR THIS CHANGE ALONG WITH A PROPOSED PLAN SIGNED BY A QUALIFIED AND LICENSED ENGINEER TO ARLINGTON COUNTY FOR REVIEW AND APPROVAL. THE CONTRACTOR SHALL PROCEED ONLY FOLLOWING APPROVAL OF THE REQUESTED CHANGE AND WRITTEN AUTHORIZATION FROM ARLINGTON COUNTY.
4. REFER TO CONSTRUCTION NOTES ON SHEET F19.1 FOR ALLOWABLE WORK HOURS.
5. CONTRACTOR REQUIRED TO MAINTAIN SAFE AND ADA COMPLIANT PEDESTRIAN ACCESS THROUGHOUT THE WORK AREA AT ALL TIMES. SIDEWALK AND CROSSWALK CLOSURES AS NEEDED SHALL COMPLY WITH THE CONTROL MEASURES SHOWN HEREIN AND WITH THE VA WAPM (CURRENT VERSION).



DEPARTMENT OF
ENVIRONMENTAL SERVICES

Facilities & Engineering Division
Engineering Bureau
2100 Clarendon Boulevard, Suite 813
Arlington, VA 22201
Phone: 703.228.3629
Fax: 703.228.3606

Kimley»Horn
Kimley-Horn
and Associates, Inc.
© 2021 KIMLEY-HORN AND ASSOCIATES, INC.
11400 Commerce Park Drive, Suite 400
Reston, Virginia 20191
Phone: 703-674-1300
Fax: 703-674-1300

Seal

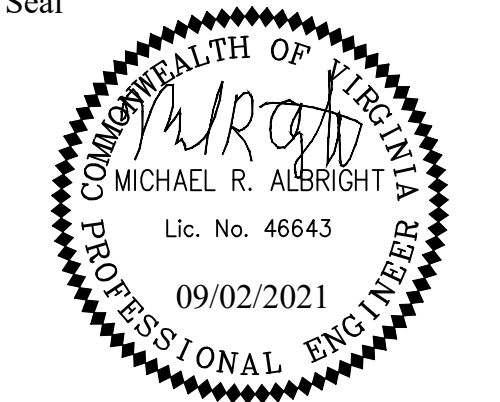

Approvals _____ Date _____

Design Team Engineer Supervisor _____

Construction Management Supervisor _____

Water, Sewer, Streets Bureau Chief _____

Transportation Director _____

Project Manager _____

Revisions _____ Date _____

Designed: EJD
Drawn: DHB
Checked: MRA
Miss Utility Transmittal #: _____

Filename: MOT TYPICAL SECTIONS.dwg
Path: C:\NVA_RDP\11010071 Columbia Pike Multimodal Production\Task
Design\PlanSheets
Plotted: September 02, 2021
Plotted by: patrick.husted

ARLINGTON COUNTY, VIRGINIA
DEPARTMENT OF ENVIRONMENTAL SERVICES

MOT TYPICAL SECTIONS
COLUMBIA PIKE - ROUTE 244
COLUMBIA PIKE - MULTIMODAL STREET IMPROVEMENTS
SEGMENT F

SCALE: NOT TO SCALE SHEET: F19.30 of F19.31



DEPARTMENT OF
ENVIRONMENTAL SERVICES

10/19/2021
APPROVAL DATE

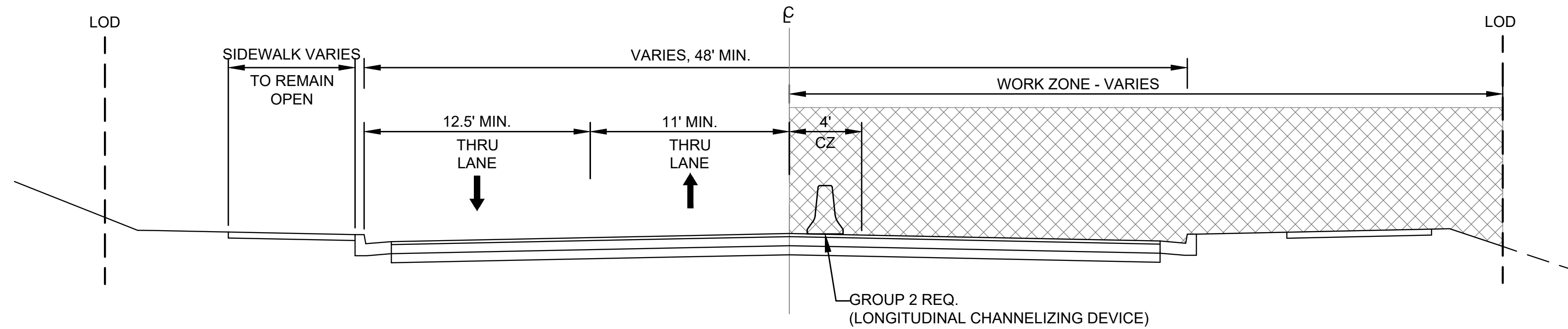

TYPICAL SECTION - COLUMBIA PIKE - PHASE 3A, 3B, 3C, 3D
NORTH/WESTBOUND LANES

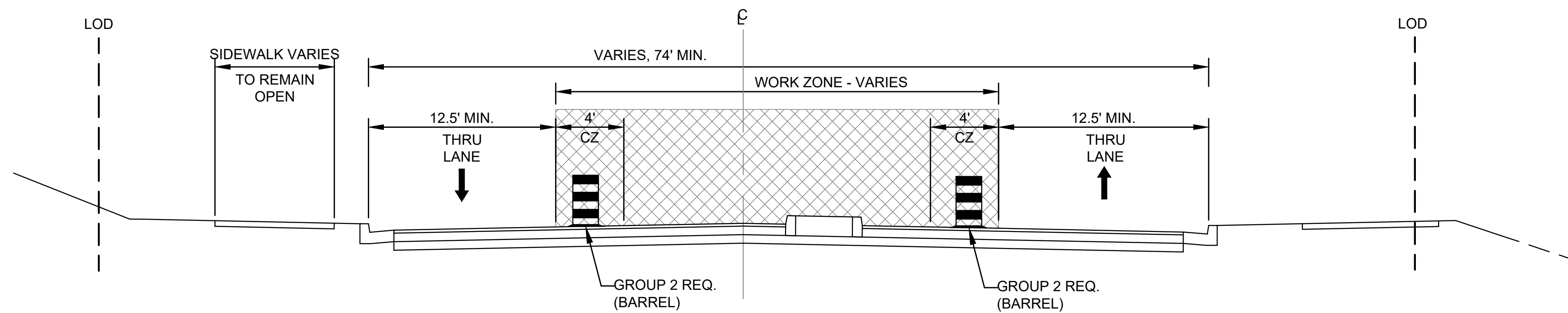

TYPICAL SECTION - S GEORGE MASON DR- PHASE 4A, 4B
SOUTH OF COLUMBIA PIKE

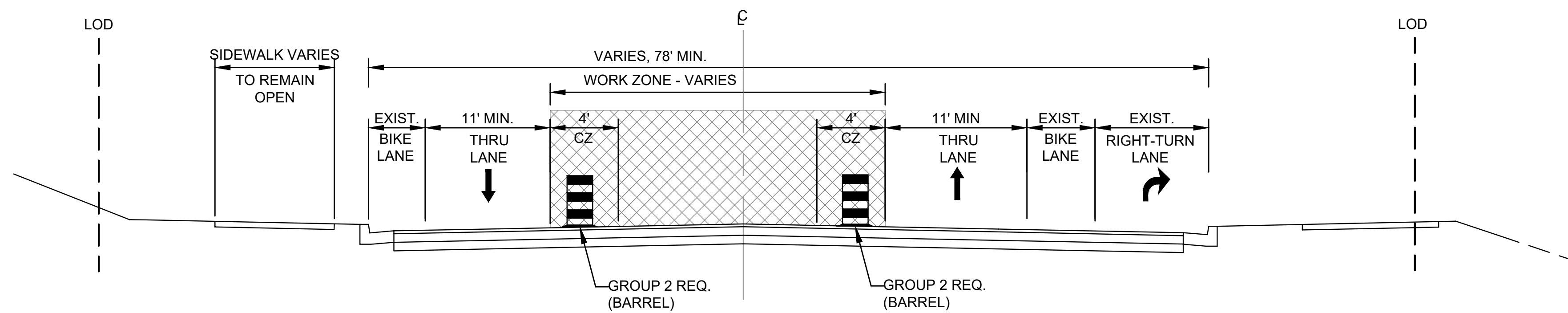

TYPICAL SECTION - S GEORGE MASON DR- PHASE 4A, 4B
NORTH OF COLUMBIA PIKE

NOTES

1. NO CONSTRUCTION PHASE MAY BE COMBINED WITH ANY OTHER PHASE TO CREATE LARGER WORK AREAS THAN SHOWN IN THE PLANS. NO CONSTRUCTION PHASE MAY BE IMPLEMENTED/ACTIVE AT THE SAME TIME AS ANOTHER PHASE TO AVOID MULTIPLE LANE SHIFTS WITHIN THE PROJECT AREA AT ONE TIME.
2. CONSTRUCTION PHASES MUST BE LIMITED TO THE AREAS DESCRIBED HEREIN AND SHOWN IN THE PLANS. WORK AREAS MAY NOT BE EXPANDED BEYOND THE LIMITS SHOWN IN THE PLANS.
3. SHOULD THE CONTRACTOR WISH TO MODIFY, COMBINE, AND/OR OTHERWISE ALTER THE MAINTENANCE OF TRAFFIC OR CONSTRUCTION PHASING SHOWN HEREIN, THE CONTRACTOR SHALL SUBMIT A REQUEST FOR THIS CHANGE ALONG WITH A PROPOSED PLAN SIGNED BY A QUALIFIED AND LICENSED ENGINEER TO ARLINGTON COUNTY FOR REVIEW AND APPROVAL. THE CONTRACTOR SHALL PROCEED ONLY FOLLOWING APPROVAL OF THE REQUESTED CHANGE AND WRITTEN AUTHORIZATION FROM ARLINGTON COUNTY.
4. REFER TO CONSTRUCTION NOTES ON SHEET F19.1 FOR ALLOWABLE WORK HOURS.
5. CONTRACTOR REQUIRED TO MAINTAIN SAFE AND ADA COMPLIANT PEDESTRIAN ACCESS THROUGHOUT THE WORK AREA AT ALL TIMES. SIDEWALK AND CROSSWALK CLOSURES AS NEEDED SHALL COMPLY WITH THE CONTROL MEASURES SHOWN HEREIN AND WITH THE VA WAPM (CURRENT VERSION).



DEPARTMENT OF
ENVIRONMENTAL SERVICES

Facilities & Engineering Division
Engineering Bureau
2100 Clarendon Boulevard, Suite 813
Arlington, VA 22201
Phone: 703.228.3629
Fax: 703.228.3606

Kimley»Horn
Kimley-Horn
and Associates, Inc.

© 2021 KIMLEY-HORN AND ASSOCIATES, INC.
11400 Commerce Park Drive, Suite 400
Reston, Virginia 20191
Phone: 703-674-1300
Fax: 703-674-1300

Seal



Approvals _____ Date _____

Design Team Engineer Supervisor _____

Construction Management Supervisor _____

Water, Sewer, Streets Bureau Chief _____

Transportation Director _____

Project Manager _____

Revisions _____ Date _____

Designed: EJD
Drawn: DHB
Checked: MRA
Miss Utility Transmittal #: _____

Filename: MOT TYPICAL SECTIONS.dwg
Path: C:\NVA_RDP\11010071 Columbia Pike Multimodal Production\Task
Design\PlanSheets
Plotted: September 02, 2021
Plotted by: patrick.husted

ARLINGTON COUNTY, VIRGINIA
DEPARTMENT OF ENVIRONMENTAL SERVICES

MOT TYPICAL SECTIONS
COLUMBIA PIKE - ROUTE 244
COLUMBIA PIKE - MULTIMODAL STREET IMPROVEMENTS
SEGMENT F

SCALE: NOT TO SCALE SHEET: F19.31 of F19.31



DEPARTMENT OF
ENVIRONMENTAL SERVICES

10/19/2021
APPROVAL DATE