

ALL DESIGN DRAWINGS OR SPECIFICATIONS DEPICTED ON THIS SHEET ARE PROPERTY OF KARPUS DESIGN, LLC. COPYRIGHT 2020. ANY USE OR REPRODUCTION OF THESE DOCUMENTS WITHOUT EXPRESS PERMISSION OF KARPUS DESIGN, LLC IS STRICTLY PROHIBITED AND SUBJECT TO LEGAL ACTION. POSSESSION IN ANY FORM CONSTITUTES ACCEPTANCE OF THESE CONDITIONS.

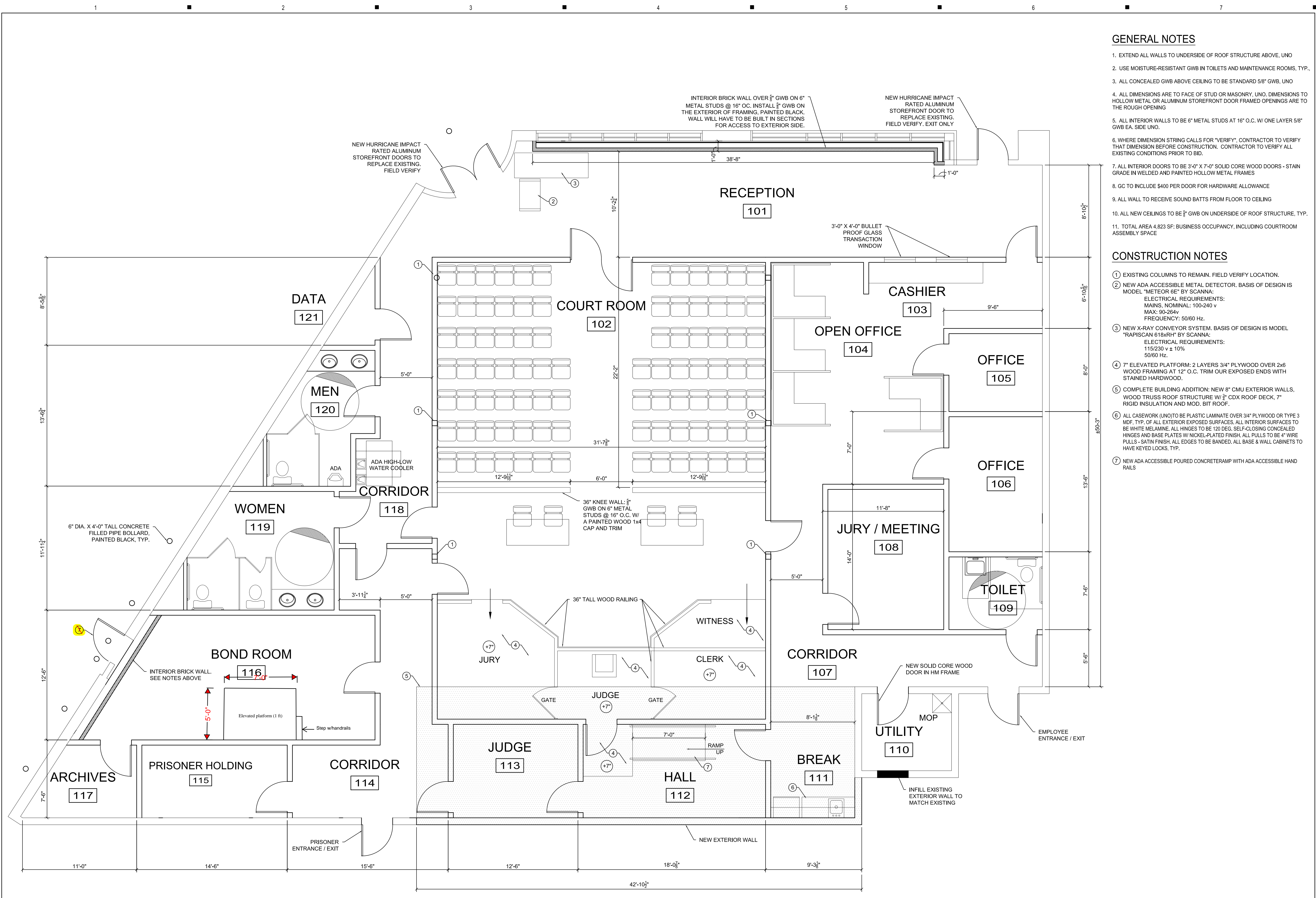

**GENERAL NOTES**

1. EXTEND ALL WALLS TO UNDERSIDE OF ROOF STRUCTURE ABOVE, UNO
2. USE MOISTURE-RESISTANT GWB IN TOILETS AND MAINTENANCE ROOMS, TYP.
3. ALL CONCEALED GWB ABOVE CEILING TO BE STANDARD 5/8" GWB, UNO
4. ALL DIMENSIONS ARE TO FACE OF STUD OR MASONRY, UNO. DIMENSIONS TO HOLLOW METAL OR ALUMINUM STOREFRONT DOOR FRAMED OPENINGS ARE TO THE ROUGH OPENING
5. ALL INTERIOR WALLS TO BE 6" METAL STUDS AT 16" O.C. W/ ONE LAYER 5/8" GWB EA. SIDE UNO.
6. WHERE DIMENSION STRING CALLS FOR "VERIFY", CONTRACTOR TO VERIFY THAT DIMENSION BEFORE CONSTRUCTION. CONTRACTOR TO VERIFY ALL EXISTING CONDITIONS PRIOR TO BID.
7. ALL INTERIOR DOORS TO BE 3'-0" X 7'-0" SOLID CORE WOOD DOORS - STAIN GRADE IN WELDED AND PAINTED HOLLOW METAL FRAMES
8. GC TO INCLUDE \$400 PER DOOR FOR HARDWARE ALLOWANCE
9. ALL WALL TO RECEIVE SOUND BATTS FROM FLOOR TO CEILING
10. ALL NEW CEILINGS TO BE 5/8" GWB ON UNDERSIDE OF ROOF STRUCTURE, TYP.
11. TOTAL AREA 4,823 SF: BUSINESS OCCUPANCY, INCLUDING COURTROOM ASSEMBLY SPACE

**CONSTRUCTION NOTES**

- 1 EXISTING COLUMNS TO REMAIN. FIELD VERIFY LOCATION.
- 2 NEW ADA ACCESSIBLE METAL DETECTOR. BASIS OF DESIGN IS MODEL "METEOR 6E" BY SCANNA:  
ELECTRICAL REQUIREMENTS:  
MAINS, NOMINAL: 100-240 v  
MAX: 90-284v  
FREQUENCY: 50/60 Hz.
- 3 NEW X-RAY CONVEYOR SYSTEM. BASIS OF DESIGN IS MODEL "RAPISCAN 618xRH" BY SCANNA:  
ELECTRICAL REQUIREMENTS:  
115/230 v ± 10%  
50/60 Hz.
- 4 7" ELEVATED PLATFORM: 2 LAYERS 3/4" PLYWOOD OVER 2x6 WOOD FRAMING AT 12" O.C. TRIM OUR EXPOSED ENDS WITH STAINED HARDWOOD.
- 5 COMPLETE BUILDING ADDITION: NEW 8" CMU EXTERIOR WALLS, WOOD TRUSS ROOF STRUCTURE W/ 3/4" CDX ROOF DECK, 7" RIGID INSULATION AND MOD. BIT ROOF.
- 6 ALL CASEWORK (UNO) TO BE PLASTIC LAMINATE OVER 3/4" PLYWOOD OR TYPE 3 MDF, TYP. OF ALL EXTERIOR EXPOSED SURFACES, ALL INTERIOR SURFACES TO BE WHITE MELAMINE. ALL HINGES TO BE 120 DEG. SELF-CLOSING CONCEALED HINGES AND BASE PLATES W/ NICKEL-PLATED FINISH. ALL PULLS TO BE 4" WIRE PULLS - SATIN FINISH. ALL EDGES TO BE Banded. ALL BASE & WALL CABINETS TO HAVE KEYPED LOCKS, TYP.
- 7 NEW ADA ACCESSIBLE POURED CONCRETE RAMP WITH ADA ACCESSIBLE HAND RAILS

**A1 FLOOR PLAN**  
SCALE: 1/4"=1'-0"

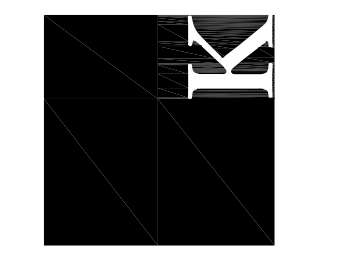

**KARPUS DESIGN, LLC**  
P.O. Box 986  
Summerville, South Carolina, 29484  
ph: 843.425.4124 | fax: 843.832.7331  
karpusdesign.com

Renovations to Office for  
**TOWN OF SUMMERVILLE**  
West Richardson  
Summerville, South Carolina

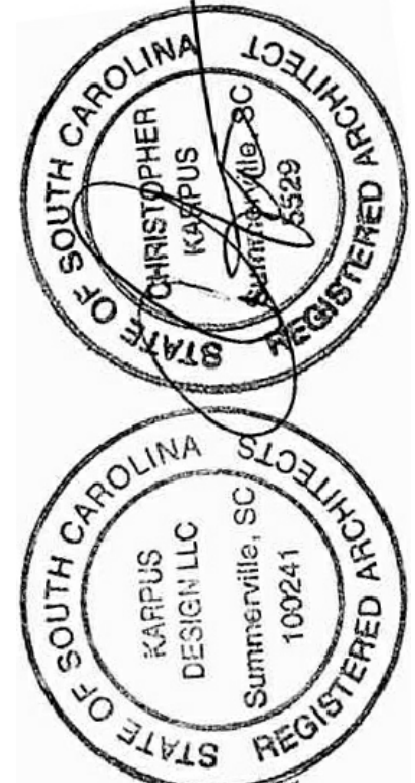

**REVIEW DRAWINGS**  
Rev. Date Description

DRAWN BY: CMK  
CHECKED BY: CMK  
PROJECT NUMBER: 20007  
DATE: 02.04.21

SHEET TITLE:  
**FLOOR PLAN**

SHEET NUMBER:  
**A1.1**