

ALL DESIGN DRAWINGS OR SPECIFICATIONS DEPICTED ON THIS SHEET ARE PROPERTY OF KARPUS DESIGN, LLC. COPYRIGHT 2020. ANY USE OR REPRODUCTION OF THESE DOCUMENTS WITHOUT EXPRESS PERMISSION OF KARPUS DESIGN, LLC IS STRICTLY PROHIBITED AND SUBJECT TO LEGAL ACTION. POSSESSION IN ANY FORM CONSTITUTES ACCEPTANCE OF THESE CONDITIONS.

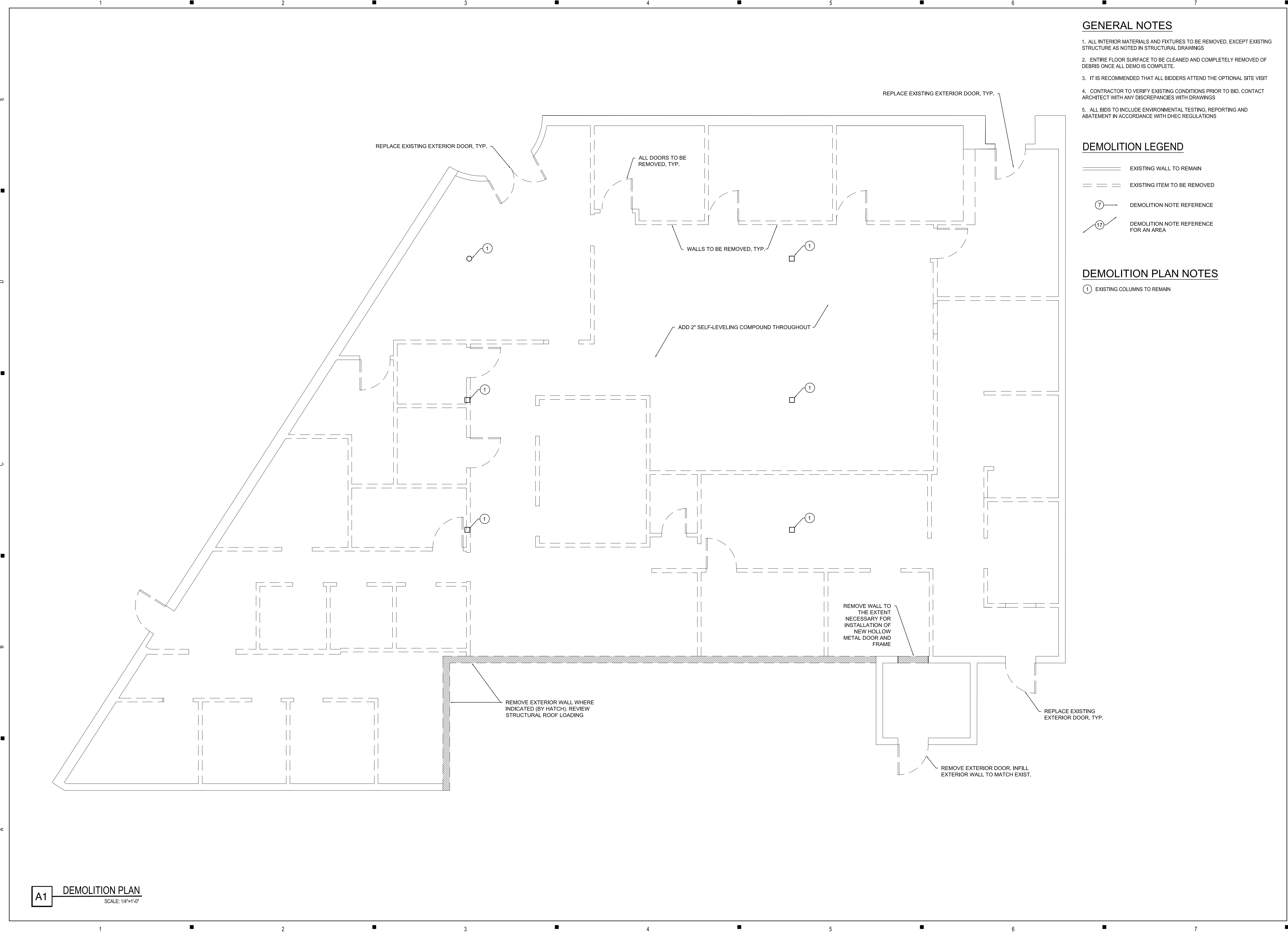

GENERAL NOTES

1. ALL INTERIOR MATERIALS AND FIXTURES TO BE REMOVED, EXCEPT EXISTING STRUCTURE AS NOTED IN STRUCTURAL DRAWINGS
2. ENTIRE FLOOR SURFACE TO BE CLEANED AND COMPLETELY REMOVED OF DEBRIS ONCE ALL DEMO IS COMPLETE.
3. IT IS RECOMMENDED THAT ALL BIDDERS ATTEND THE OPTIONAL SITE VISIT
4. CONTRACTOR TO VERIFY EXISTING CONDITIONS PRIOR TO BID. CONTACT ARCHITECT WITH ANY DISCREPANCIES WITH DRAWINGS
5. ALL BIDS TO INCLUDE ENVIRONMENTAL TESTING, REPORTING AND ABATEMENT IN ACCORDANCE WITH DHEC REGULATIONS

DEMOLITION LEGEND

- EXISTING WALL TO REMAIN
- - - EXISTING ITEM TO BE REMOVED
- ⑦ DEMOLITION NOTE REFERENCE
- ⑰ DEMOLITION NOTE REFERENCE FOR AN AREA

DEMOLITION PLAN NOTES

- ① EXISTING COLUMNS TO REMAIN

A1 DEMOLITION PLAN
SCALE: 1/4"=1'-0"

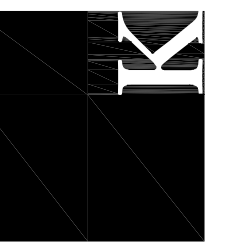

KARPUS DESIGN, LLC
P.O. Box 986
Summerville, South Carolina, 29484
ph: 843.425.4124 fax: 843.832.7331
karpusdesign.com

Renovations to Office for
TOWN OF SUMMERVILLE
West Richardson
Summerville, South Carolina



REVIEW DRAWINGS

Rev.	Date	Description

DRAWN BY: CMK
CHECKED BY: CMK
PROJECT NUMBER: 20007
DATE: 02.19.20

SHEET TITLE:

DEMOLITION PLAN

SHEET NUMBER:

D1.1