

# DR. MELLICHAMP DRIVE

## STREETSCAPE IMPROVEMENTS

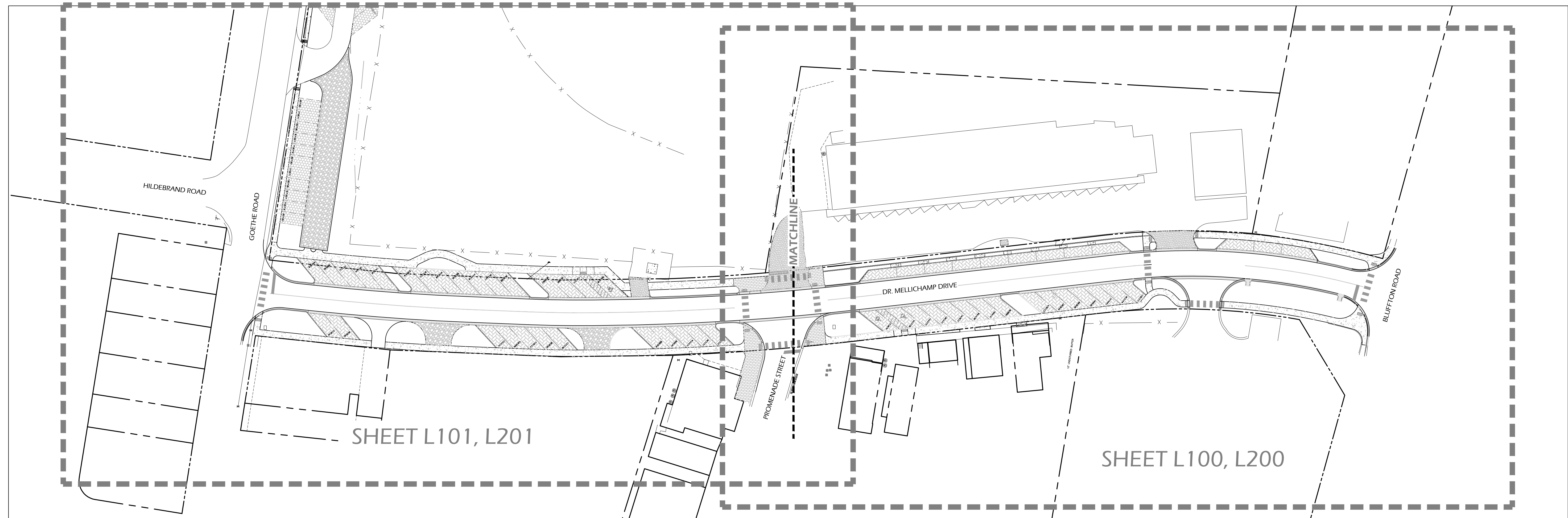

### CONSULTANT INFO

TOPO AND BOUNDARY SURVEYS, EXISTING TREES AND SURVEY DATA WERE TAKEN FROM DIGITAL DATA PROVIDED BY:

SEA ISLAND LAND SURVEY, LLC  
HILTON HEAD ISLAND, SOUTH CAROLINA  
(843) 681.3248

ALL CIVIL ENGINEERING INFORMATION WAS TAKEN FROM DIGITAL DATA PROVIDED BY:

THOMAS AND HUTTON  
SANAHHAH, GEORGIA  
(912) 234.5300

16 JUNE 2017

### CONTACT

WITMER JONES KEEFER  
23 PROMENADE ST., SUITE 201  
BLUFFTON, SC. 29910  
(843) 757.7411  
WWW.WJKLTD.COM

### SHEET INDEX

- CS - COVER SHEET, SHEET INDEX
- L20 - NOTES
- L100 - SIGNAGE, FURNISHINGS, AND LIGHTING PLAN 1
- L101 - SIGNAGE, FURNISHINGS, AND LIGHTING PLAN 2
- L200 - PLANTING PLAN 1
- L201 - PLANTING PLAN 2
- L210 - PLANTING SCHEDULE AND DETAILS
- L300 - DETAILS 1
- L301 - DETAILS 2
- I1 - IRRIGATION 1
- I2 - IRRIGATION 2
- I3 - IRRIGATION 3
- I4 - IRRIGATION 4

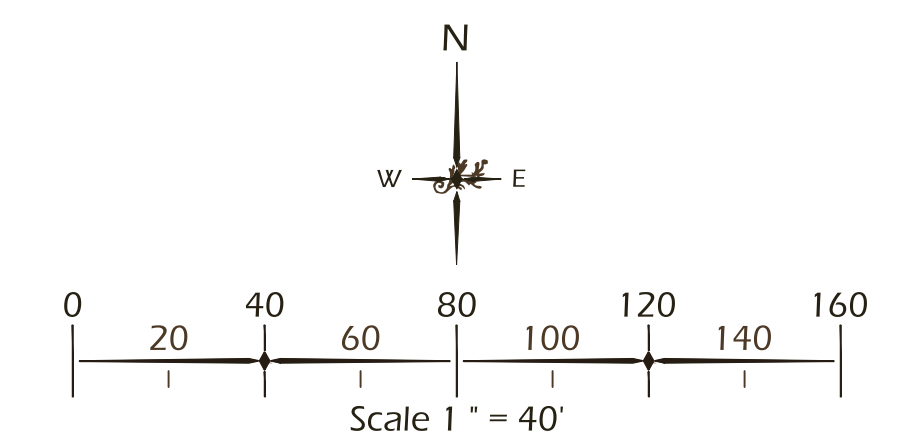

© 2017 WJK LTD.  
DESIGN CONCEPTS, DRAWING SHEETS, LOGOS, SPECIFICATIONS, DETAILS, WRITTEN MATERIAL SHALL NOT BE USED OR REPRODUCED IN WHOLE OR IN PART IN ANY FORM WITHOUT PRIOR WRITTEN CONSENT OF WJK LTD.  
THIS SHEET TO SCALE AT: 24"x36"

SITE DEVELOPMENT PLANS

FOR

**DR. MELLICHAMP DRIVE**

BLUFFTON, SOUTH CAROLINA

DATE: 16 JUNE 2017  
PROJECT NO.: 1624.03  
DRAWN BY: KJ  
CHECKED BY: DK

**BID SET,  
NOT FOR  
CONSTRUCTION**

REVISIONS:  
\_\_\_\_\_  
\_\_\_\_\_  
\_\_\_\_\_

DRAWING TITLE  
COVER SHEET

DRAWING NUMBER

**CS**



**GENERAL NOTES:**

- ALL NOTES APPLY TO ALL DRAWINGS AND ALL TRADES.
- REFER TO ENGINEERING PLANS FOR LAYOUT AND LOCATION OF UTILITIES, ROADS, AND WALKWAYS.
- ALL SURVEY AND SITE INFORMATION WERE COMPILED FROM A VARIETY OF SOURCES AT VARIOUS TIMES. SITE INFORMATION MUST BE FIELD VERIFIED BEFORE CONSTRUCTION BEGINS. REPORT ANY DISCREPANCIES TO THE OWNER OR OWNER'S REPRESENTATIVE.
- IT IS THE RESPONSIBILITY OF ALL CONTRACTORS AND TRADES TO COORDINATE THE INSTALLATION OF THEIR WORK WITH THE INSTALLATION OF WORK BY ALL OTHER CONTRACTORS AND TRADES.
- THE REQUIREMENTS OF THE SPECIFICATIONS, DRAWINGS, GENERAL REQUIREMENTS, AND ALL ITEMS OF THE CONTRACT DOCUMENTS ARE EQUALLY BINDING FOR ALL CONTRACTORS AND TRADES.
- EACH CONTRACTOR IS REQUIRED TO MAINTAIN FULL (COLOR) SETS OF THE CONTRACT DOCUMENTS FOR HIS EMPLOYEES USE ON THE PROJECT TO ASSURE THAT ALL WORK IS PROPERLY COORDINATED AND FOR REVIEWS BY COUNTY AND / OR MUNICIPALITY OFFICIALS FOR INSPECTIONS.
- ALL CONTRACTORS AND ALL TRADES ARE RESPONSIBLE FOR OBTAINING THE CORRECT PERMITS AND INSPECTIONS PRIOR TO CONSTRUCTION AS REQUIRED BY LOCAL PLANNING, ZONING, BUILDING CODE AND OTHER TOWN AUTHORITIES.
- W.J.K. LTD., THE OWNER AND / OR THE OWNER'S REPRESENTATIVE SHALL BE NOTIFIED OF ANY SITE CONDITIONS WHICH MAY NECESSITATE MODIFICATION TO THE PLAN. THE OWNER OR OWNER'S REPRESENTATIVE SHALL MAKE 'IN-FIELD MODIFICATIONS,' IF NECESSARY.
- CONTRACTOR SHALL PROVIDE AND FURNISH ALL MATERIALS, EQUIPMENT AND LABOR NECESSARY FOR ALL CONSTRUCTION, PROTECTION, MAINTENANCE AND RELATED ITEMS TO COMPLETE WORK INDICATED ON THE DRAWINGS.
- BEFORE COMMENCING ANY WORK CONTRACTOR SHALL ASCERTAIN THE LOCATION OF ALL UTILITIES, SUB-SURFACE DRAINAGE, AND UNDERGROUND CONSTRUCTION SO THAT PROPER PRECAUTIONS MAY BE TAKEN NOT TO DISTURB ANY SUB-SURFACE IMPROVEMENTS. CONTRACTOR SHALL TAKE ALL NECESSARY PRECAUTIONS IN BRINGING EQUIPMENT ON TO AND OFF OF THE SITE, PROTECTING WALKS, PAVING, STEPS AND OTHER EXISTING CONSTRUCTION ON THE SITE. CONTACTS SHALL BE MADE BY CONTRACTOR WITH PROPER AUTHORITIES BEFORE AND DURING THIS WORK SO AS TO COMPLY WITH ALL REGULATIONS AND ORDINANCES.
- CONTRACTOR SHALL FIELD LOCATE ALL UTILITIES AND CONFIRM / DETERMINE UTILITY ELEVATIONS PRIOR TO CONSTRUCTION. CONTRACTOR IS RESPONSIBLE FOR ANY DAMAGE AND MAKE REPAIRS, AT THEIR OWN EXPENSE, THAT MAY OCCUR TO EXISTING UTILITIES IN ACCORDANCE WITH NATIONAL, STATE AND LOCAL CODES.
- CONTRACTOR SHALL VERIFY ALL EXISTING TREE CONDITIONS AND ELEVATIONS PRIOR TO CONSTRUCTION. CONTRACTOR SHALL NOTIFY THE OWNER OR OWNER'S REPRESENTATIVE OF ANY DISCREPANCIES PRIOR TO THEIR REMOVAL.
- CONTRACTOR SHALL PROTECT AND INSTALL TREE PROTECTION FENCE AROUND THE DRIP LINE OF ALL TREES, NATURAL AREAS AND EXISTING VEGETATION TO REMAIN. TREE PROTECTION LOCATION SHALL BE APPROVED BY LANDSCAPE ARCHITECT PRIOR TO CONSTRUCTION.
- ALL CONSTRUCTION FOR ALL TRADES SHALL CONFORM TO OR EXCEED THE PRODUCT MANUFACTURER'S RECOMMENDATIONS, REGULATIONS OF BEAUFORT COUNTY AND THE AMERICANS WITH DISABILITIES ACT, AND / OR OTHER APPLICABLE NATIONAL, STATE, AND LOCAL CODES AND ANY OTHER GOVERNING AUTHORITIES.
- CONTRACTOR ACCESS FOR CONSTRUCTION AS DIRECTED BY THE OWNER OR OWNER'S REPRESENTATIVE.
- CONTRACTOR SHALL PROTECT THE GENERAL PUBLIC FROM CONSTRUCTION AREAS DURING CONSTRUCTION.
- THE OWNER MAY REQUIRE FLAG MEN TO BE AVAILABLE DURING THE CONSTRUCTION PROCESS.
- ANY DEVIATIONS FROM THESE PLANS MUST BE SPECIFICALLY APPROVED BY W.J.K. LTD., AND THE OWNER OR OWNER'S REPRESENTATIVE.

**LAYOUT NOTES:**

- ALL CONSTRUCTION STAKING SHALL BE THE RESPONSIBILITY OF THE CONTRACTOR.
- CONTRACTOR TO USE DIGITAL FILES PROVIDED BY WITMER-JONES-KEEFEER, LTD. TO LAYOUT AND STAKE ALL SITE IMPROVEMENTS AND ELEMENTS. FINAL LAYOUT AND STAKING TO BE FIELD VERIFIED AND APPROVED BY LANDSCAPE ARCHITECT AND OWNER OR OWNER'S REPRESENTATIVE PRIOR TO CONSTRUCTION.
- CONTRACTOR SHALL FIELD LOCATE, STAKE AND USE COLOR CODED SPRAY PAINT FOR ALL ABOVE AND BELOW GROUND UTILITIES. CONTRACTOR TO CONFIRM / DETERMINE UTILITY ELEVATIONS PRIOR TO CONSTRUCTION. ANY EXISTING UTILITY CONFLICTS WITH SITE IMPROVEMENTS TO BE REPORTED TO OWNER, OWNER'S REPRESENTATIVE AND LANDSCAPE ARCHITECT PRIOR TO CONSTRUCTION. CONTRACTOR IS RESPONSIBLE FOR ANY DAMAGE TO EXISTING UTILITIES AS STATED IN THE GENERAL NOTES.
- ALL SITE IMPROVEMENTS REPRESENTED IN THIS SET OF PLANS SHALL BE STAKED AND REVIEWED WITH THE OWNER OR OWNER'S REPRESENTATIVE PRIOR TO CONSTRUCTION. ANY DISCREPANCIES TO BE REPORTED TO THE OWNER, OWNER'S REPRESENTATIVE OR LANDSCAPE ARCHITECT.
- ALL DIMENSIONS ARE TO EDGE OF PAVING AND CENTERLINE OF WALLS AND COLUMNS UNLESS OTHERWISE INDICATED.
- ALL ANGLES ARE 90 UNLESS OTHERWISE INDICATED.
- CONTRACTOR SHALL PROVIDE LIGHTING, IRRIGATION AND ANY OTHER CONDUIT NEEDED TO ALL LANDSCAPE AREAS. (COORDINATE WITH SITE CONTRACTOR).
- ANY AND ALL FIELD ADJUSTMENTS SHALL RECEIVE APPROVAL FROM THE OWNER, OWNER'S REPRESENTATIVE OR LANDSCAPE ARCHITECT PRIOR TO CONSTRUCTION.

**CONSTRUCTION NOTES:**

- ALL CONTRACTORS AND ALL TRADES ARE RESPONSIBLE FOR OBTAINING THE CORRECT PERMITS AND INSPECTIONS PRIOR TO CONSTRUCTION AS REQUIRED BY LOCAL PLANNING, ZONING, BUILDING CODE AND OTHER TOWN AUTHORITIES.
- CONTRACTOR SHALL PROVIDE SAMPLES OF ALL MATERIALS AND OBTAIN APPROVAL FROM OWNER, OWNER'S REPRESENTATIVE OR LANDSCAPE ARCHITECT PRIOR TO CONSTRUCTION.
- ON SITE TOPOGRAPHY MAY REQUIRE ADJUSTMENTS OF FINAL SPOT ELEVATIONS ON SITE FOR PROPOSED VERTICAL CONSTRUCTION ELEMENTS. THE CONTRACTOR SHALL NOTIFY THE OWNER OR OWNER'S REPRESENTATIVE PROMPTLY UPON THE DISCOVERY OF ANY SUCH REQUIRED ADJUSTMENTS.
- THE CONTRACTOR SHALL PROVIDE FILL AS IS REQUIRED TO OBTAIN PROPER RELATIONSHIP OF FOOTING TO FINISH GRADE REQUIREMENTS - FEATHER FILL TO ADJACENT EXISTING GRADE TO ASSURE A COORDINATED AND DESIRED EFFECT.
- THE CONTRACTOR IS RESPONSIBLE FOR ALL DAMAGE TO EXISTING CONDITIONS SCHEDULED TO REMAIN DURING CONSTRUCTION.
- THE CONTRACTOR IS RESPONSIBLE FOR LOCATING ALL EXISTING UTILITIES AND FOR ANY DAMAGE THAT MAY OCCUR TO EXISTING UTILITIES DURING CONSTRUCTION.
- 'IN-FIELD MODIFICATIONS' MAY BE NECESSARY TO PRODUCE DESIRED EFFECT. MODIFICATIONS TO BE APPROVED BY LANDSCAPE ARCHITECT AND OWNER OR OWNER'S REPRESENTATIVE.
- ALL CONCRETE TO BE 3000 P.S.I. AT 28 DAYS UNLESS OTHERWISE SPECIFIED.
- ALL WELDS TO BE CONTINUOUS.
- ALL WOOD MEMBERS, UNLESS OTHERWISE SPECIFIED, ARE TO BE PRESSURE TREATED #1 SOUTHERN YELLOW PINE FOR ABOVE GROUND USE. ALL CUTS SHALL BE EVEN AND JOINTS FLUSH. SAND FOUR SIDES AND FILL IMPERFECTIONS, COUNTERSINKS AND NAIL HOLES TO ASSURE EVEN FINISH.
- CONTRACTOR SHALL VERIFY ALL WOOD MEMBERS FOR APPROPRIATE SIZE, SPACING, ATTACHMENTS AND STRUCTURAL STABILITY PRIOR TO CONSTRUCTION. CONTRACTOR TO REPORT ANY DISCREPANCIES TO OWNER, OWNER'S REPRESENTATIVE OR LANDSCAPE ARCHITECT.
- ALL NOTCHES SHALL BE SHOP CUT TO ASSURE TIGHT JOINTS. EACH MEMBER SHALL BE DRIVEN HOME TO ASSURE TIGHT FIT. PILOT HOLES SHALL BE DRILLED FOR EACH CARRIAGE BOLT. PLUG, SEAL AND PRIME.
- FINISH ALL SIDES AND CAULK ALL JOINTS WITH APPROPRIATE EXTERIOR CAULK PRIOR TO FINISHING.
- ALL CONNECTORS, UNLESS OTHERWISE SPECIFIED, SHALL BE STAINLESS STEEL. BOLTS, THREADED RODS, WASHERS, NUTS AND ALL BUILDING HARDWARE SHALL BE STAINLESS STEEL AND SUITABLE FOR PRESSURE TREATED WOOD. ALL THROUGH BOLTS TO BE SMOOTH SHAFT WITH STAINLESS STEEL NUTS, BOLTS AND WASHERS. ALL NAILS AND FINISH NAILS SHALL BE ANNULAR STAINLESS STEEL.

**LIGHTING NOTES:**

- THE INTENT OF THE LIGHTING DESIGN IS TO PROVIDE LOW LEVEL UNOBTRUSIVE SITE LIGHTING OR ARCHITECTURAL ELEMENTS. THE CONTRACTOR SHALL MAKE EVERY EFFORT TO CREATE THIS EFFECT BY CLOSE COORDINATION WITH THE LANDSCAPE ARCHITECT AND CAREFUL PLACEMENT OF ALL FIXTURES.
- THE CONTRACTOR SHALL ENGINEER THE ELECTRICAL SYSTEM BASED ON THE LOCATION AND TYPE OF FIXTURES AS SHOWN ON THE PLAN. PROPERLY SIZED WIRING, TRANSFORMERS, BREAKERS, ACCESSORIES, ETC., SHALL BE PROVIDED BY THE CONTRACTOR AS NECESSARY TO GUARANTEE A COMPLETELY FUNCTIONAL LIGHTING, DISTRIBUTION AND CONTROL SYSTEM.
- CONTRACTOR TO PROVIDE ELECTRICAL PLANS AND SHOP DRAWINGS FOR REVIEW AND APPROVAL BY THE LANDSCAPE ARCHITECT AND OWNER OR OWNER'S REPRESENTATIVE PRIOR TO INSTALLATION.
- ALL LIGHTING EQUIPMENT SHALL BE INSTALLED PER MANUFACTURERS INSTRUCTIONS AND RECOMMENDATIONS, AND MUST COMPLY WITH ALL APPLICABLE STATE AND COUNTY CODES.
- THE CONTRACTOR IS RESPONSIBLE FOR ACQUIRING ALL NECESSARY PERMITS AND INSPECTION / APPROVALS REQUIRED.
- THE CONTRACTOR SHALL STAKE OUT ALL LIGHT FIXTURE AND TRANSFORMER LOCATIONS FOR APPROVAL BY THE LANDSCAPE ARCHITECT, OWNER, OR OWNER'S REPRESENTATIVE PRIOR TO INSTALLATION. EXACT LOCATIONS OF CONTROLLERS, ELECTRICAL PANELS, ETC. TO BE COORDINATED WITH AND APPROVED BY OWNER, OWNER'S REPRESENTATIVE OR LANDSCAPE ARCHITECT.
- FINAL AIMING AND ADJUSTMENT SHALL BE MADE AT NIGHT WITH LANDSCAPE ARCHITECT PRESENT TO GIVE FINAL APPROVAL.
- THE CONTRACTOR SHALL COORDINATE, STAKE AND FLAG ALL LOCATIONS WHERE ELECTRICAL CONDUIT OR PVC SLEEVING MAY BE REQUIRED BENEATH WALKS OR OTHER PAVED AREAS PRIOR TO HARDSCAPE INSTALLATION.
- ALL ELECTRICAL WIRING RUNNING UNDER PAVED AREAS SHALL BE PLACED IN ELECTRICAL CONDUIT OR PVC SLEEVES PROVIDED BY CONTRACTOR.
- CONTRACTOR SHALL RUN ALL NECESSARY ELECTRICAL WIRING TO UTILITY PANEL AND TRANSFORMER.
- CONTRACTOR SHALL PROVIDE A MINIMUM OF 36" OF BURIES EXCESS CABLE AT EACH FIXTURE TO ALLOW FOR FIXTURE ADJUSTMENT.
- ALL LIGHTING TO BE PLACED ON AN APPROPRIATE TIMER. THE CONTRACTOR SHALL SELECT AN APPROPRIATE TIMER FOR ALL LIGHTS AND SET THE TIME APPROPRIATELY FOR PROPER NIGHT TIME ILLUMINATION, FOR APPROVAL BY OWNER OR OWNER'S REPRESENTATIVE.
- CONTRACTOR SHALL PROVIDE GROUND FAULT CIRCUIT BREAKERS FOR ALL CIRCUITS AS REQUIRED BY NATIONAL, STATE AND LOCAL CODES.
- THE CONTRACTOR SHALL PROVIDE ALL EQUIPMENT, LABOR, EXCAVATION AND BACKFILL NECESSARY TO COMPLETE THE WORK.
- ALL FIXTURES PER MODELS SPECIFIED UNLESS CONTRACTOR GETS APPROVAL FROM LANDSCAPE ARCHITECT FOR A SUBSTITUTION.
- SYSTEM INSTALLATION, INCLUDING PARTS AND LABOR, SHALL BE GUARANTEED AND REPAIRED AS NECESSARY BY THE CONTRACTOR FOR ONE YEAR.
- CONTRACTOR TO PROVIDE 'AS-BUILT' DRAWINGS IMMEDIATELY AFTER FINAL ACCEPTANCE, ALONG WITH ALL INSTRUCTION MANUALS FOR ALL EQUIPMENT INSTALLED.
- IF POSSIBLE, FIELD MODIFICATIONS WILL BE DIRECTED BY THE LANDSCAPE ARCHITECT, OWNER OR OWNER'S REPRESENTATIVE.

**IRRIGATION NOTES:**

- CONTRACTOR TO SUPPLY AUTOMATIC IRRIGATION SYSTEM, COMPLETE AND INSTALLED. SYSTEM TO INCLUDE ALL VALVES, PIPES, HEADS, FITTINGS, BACK FLOW CONTROLLER, AND IRRIGATION METER AND TO PROVIDE 100% COVERAGE FOR ALL NEW PLANTINGS. DRIP IRRIGATION TO BE USED FOR ALL PLANTINGS, EXCEPT LAWNS.
- NO IRRIGATION COMPONENTS SHALL BE CLOSER THAN 12" TO ANY EDGE OF PAVEMENT OR CURB AND GUTTER. IRRIGATION SHALL NOT SPRAY BEYOND LANDSCAPED AREAS, OR INTO ANY UNDISTURBED BUFFERS. NO OVER SPRAY SHALL BE PERMITTED ONTO ADJACENT PROPERTIES OR PEDESTRIAN SIDEWALK AREAS.
- LANDSCAPE CONTRACTOR TO FIELD VERIFY ALL COMPONENT LOCATIONS TO ENSURE APPROPRIATE COVERAGE.
- LANDSCAPE CONTRACTOR SHALL LOCATE WATER SOURCE AND PROVIDE POWER TO CONTROLLER.
- CONTROLLER LOCATION TO BE APPROVED BY OWNERS REPRESENTATIVE IN FIELD PRIOR TO CONSTRUCTION.
- ALL DRIP TUBING SHALL BE COVERED WITH MIN. 3" OF MULCH.
- ALL DRIP AND SPRAY ZONES SHALL BE SEPARATE.
- CONTRACTOR SHALL SUBMIT FINAL, AS BUILT IRRIGATION PLANS TO OWNER'S REPRESENTATIVE AND ALL REVIEWING BODIES / AGENCIES FOR FINAL APPROVAL PRIOR TO INSTALLATION.

**SOIL AMENDMENT NOTES:**

- TOPSOIL SHALL CONSIST OF THE NATURAL LOAM, SANDY LOAM, SILT LOAM, OR CLAY LOAM HUMUS BEARING SOILS, ADAPTED TO THE SUSTENANCE OF PLANT LIFE, WITH THE FOLLOWING TEXTURE:
  - ORGANIC MATERIAL - TWO (2) TO TWENTY (20) PERCENT BY MASS
  - SAND CONTENT - TWENTY (20) TO SIXTY (60) PERCENT BY MASS
  - CLAY/SILT CONTENT - THIRTY FIVE (35) TO SEVENTY (70) PERCENT BY MASS.
  - TOPSOIL PH SHALL BE BETWEEN FIVE (5) AND SEVEN (7).
- TOPSOIL SHALL BE OF UNIFORM QUALITY AND FREE FROM FOREIGN MATERIAL SUCH HARD CLODS, SOD, STIFF CLAY, HARD PAN, STONES LARGER THAN ONE (1) INCH DIAMETER, LIME CEMENT, ASHES, SLAG, CONCRETE, TAR RESIDUES, TARRED PAPER, BOARDS, CHIPS, STICKS, OR OTHER UNDESIRABLE MATERIALS. IT SHALL ALSO BE REASONABLY FREE FROM WEEDS AND OBJECTIONABLE PLANT MATERIAL.
- AFTER ALL DEMOLITION, CLEARING AND DISPOSAL IS COMPLETED, THE CONTRACTOR SHALL STRIP FROM THE TOP OF THE EXISTING GROUND ALL TOPSOIL IN ALL AREAS TO BE GRADED.
- PRIOR TO STOCKPIILING OF TOPSOIL, TOPSOIL SHALL BE SCREENED WITH A ONE HALF (1/2) INCH SIZE SIEVE. STOCKPILE TOPSOIL IN DESIGNATED OR APPROVED LOCATIONS WITH PROPER DRAINAGE AND WHERE IT WILL NOT INTERFERE WITH THE WORK. AFTER TOPSOIL HAS BEEN STOCKPILED, CONTRACTOR SHALL QUANTIFY THE AMOUNTS AT NO ADDITIONAL COST TO THE OWNER. QUANTITIES SHALL BE GIVEN TO THE ARCHITECT, OWNER AND SITE DESIGN PROFESSIONAL.
- IF AMOUNT OF SCREENED TOPSOIL STOCKPILED FROM STRIPING OPERATIONS IS INSUFFICIENT TO PROVIDE THE NECESSARY AMOUNTS (4" MINIMUM DEPTH), IT SHALL BE THE CONTRACTOR'S RESPONSIBILITY TO OBTAIN (FROM OFF-SITE SOURCE) THE NECESSARY AMOUNT OF SCREENED TOPSOIL TO COMPLETE THE PROJECT.
- SCREENED TOPSOIL SHALL BE DISTRIBUTED WITH A MINIMUM DEPTH OF FOUR (4) INCHES TO ALL GRADED AREAS (NOT INCLUDING BUILDING, PAVED, SYNTHETIC TURF, PERVIOUS PAVEMENT, ETC.) AND / OR AS DIRECTED BY THE OWNER OR OWNER'S REPRESENTATIVE. GROUND SHALL BE SCARIFIED BEFORE PLACING TOPSOIL AREAS WHERE SCREENED TOPSOIL IS DISTRIBUTED SHALL BE STABILIZED WITH TEMPORARY AND/OR PERMANENT VEGETATION (SEASON DEPENDENT) OR TEMPORARY MULCH WITHIN FOURTEEN (14) CALENDAR DAYS OF DISTRIBUTION.

**PLANTING NOTES:**

- CONTRACTOR IS RESPONSIBLE FOR INSPECTION OF EXISTING CONDITIONS, INCLUDING UTILITIES, AND PROMPTLY REPORTING ANY DISCREPANCIES OR CONFLICTS WITH PLANTING AREAS. REPORT INFORMATION TO OWNER, OWNER'S REPRESENTATIVE AND LANDSCAPE ARCHITECT.
- CONTRACTOR SHALL FIELD LOCATE ALL UTILITIES. CONTRACTOR IS RESPONSIBLE FOR ANY DAMAGE AND MAKE REPAIRS THAT MAY OCCUR TO EXISTING UTILITIES IN ACCORDANCE WITH NATIONAL, STATE AND LOCAL CODES.
- LANDSCAPE PLANTING AND / OR MULCHED AREAS TO BE FINE GRADED, HAND RAKED SMOOTH AND FREE OF DEBRIS.
- CONTRACTOR TO PERFORM SOIL TESTS AS NECESSARY TO ASSURE PLANT HEALTH AND GROWTH.
- MULCH ALL PLANTING BEDS TO A MIN. 3" DEPTH WITH MULCH SPECIFIED IN PLANT SCHEDULE.
- CONTRACTOR VERIFIES THAT ALL PLANT MATERIAL IS DETERMINED AVAILABLE AS SPECIFIED WHEN BID / PROPOSAL IS SUBMITTED.
- PLANT SCHEDULE WAS PREPARED FOR ESTIMATING PURPOSES ONLY. CONTRACTOR SHALL MAKE OWN QUANTITY TAKEOFFS USING DRAWINGS TO DETERMINE QUANTITIES TO HIS SATISFACTION, REPORTING PROMPTLY ANY DISCREPANCIES WHICH MAY AFFECT BIDDING.
- GALLON SIZES ARE FOR PRICING PURPOSES ONLY. PLANT MUST MEET HEIGHTS AND WIDTHS SPECIFIED IN PLANT SCHEDULE.
- ROOT TYPE MAY BE FREELY SUBSTITUTED IN CASE OF BALLED AND BURLAPPED OR CONTAINER GROWN, OTHER SPECIFICATIONS REMAINING UNCHANGED, EXCEPT IN THE CASE OF CONTAINER GROWN SPECIMEN TREES AS INDICATED IN THE TREE PLANTING SCHEDULE.
- ANY SIGNIFICANT ROOTS ENCOUNTERED 2" DIA. AND LARGER SHALL BE DUG OUT BY HAND AND CLEANLY CUT BACK IN THE FOOTING / FOUNDATION AREA TO PROMOTE ROOT RE-GROWTH AND HELP PREVENT ROOT DIEBACK.
- ALL PLANT MATERIAL (EXCEPT SEASONAL COLOR) SHALL BE GUARANTEED AND REPLACED AS NECESSARY BY THE CONTRACTOR FOR ONE YEAR.
- ALL SEASONAL COLOR SHALL BE GUARANTEED AND REPLACED AS NECESSARY BY THE CONTRACTOR FOR THREE MONTH TIME FRAMES.

**TURF AND GRASSING NOTES:**

- GRASS SEED: PROVIDE FRESH, CLEAN, NEW-CROP SEED COMPLYING WITH TOLERANCE FOR PURITY AND GERMINATION ESTABLISHED BY OFFICIAL SEED ANALYSIS OF NORTH AMERICA. PROVIDE SEED MIXTURE COMPOSED OF GRASS SPECIES, PROPORTIONS AND MINIMUM PERCENTAGES OF PURITY, GERMINATION, AND MAXIMUM PERCENTAGE OF WEED SEED, AS SPECIFIED SEED MANUFACTURER.
- SOD SHALL BE STRONGLY ROOTED AND FREE OF PERNICIOUS WEEDS. ALL NETTING SHALL BE REMOVED FROM SOD BEFORE IT IS LAID.
- ALL AREAS IN WHICH EARTHWORK SHALL BE SUSPENDED FOR MORE THAN TWO (2) WEEKS SHALL BE GRASSED WITH TEMPORARY GRASS.
- AFTER TOPSOIL HAS BEEN INSTALLED, AND BEFORE ANY SOD IS LAID, CORRECT ALL SOFT SPOTS AND IRREGULARITIES IN GRADE. THE SOD SHALL BE LAID BY BUTTING THE ENDS AND SIDES UP EVENLY AND STAGGERING THE ROLLS OF SOD. CONTRACTOR SHALL NOT OVERLAP SOD, AS SOON AS THE SOD IS LAID OR AS IT IS BEING LAID ROLL OVER WITH A LIGHT ROLLER, MAKING CERTAIN THAT ALL OF THE SOD IS IN CONTACT WITH THE SOIL. THE COMPLETED SODDED AREAS SHALL BE TRUE TO FINISH GRADE, EVEN AND FIRM AT ALL POINTS.
- SEED SHALL BE AT A RATE OF 10 POUNDS PER ACRE.
- THIRTY DAYS AFTER LAST SEEDING/SODDING OPERATION, APPLY 1 POUND OF TYPE A NITROGEN FERTILIZER PER ACRE OF LAWN AREAS AND IMMEDIATELY WATER.
- UPON COMPLETION OF PLANTINGS ALL EXCESS SOIL STONES AND DEBRIS WHICH HAS NOT PREVIOUSLY BEEN CLEANED UP SHALL BE REMOVED FROM THE SITE AND DISPOSED OF AS DIRECTED BY THE OWNER'S REPRESENTATIVE.
- ALL LAWN AREAS THAT DO NOT SHOW SATISFACTORY GROWTH WITHIN (18) DAYS AFTER PLANTING SHALL BE RE-PLANTED AND RE-FERTILIZED AS SPECIFIED UNTIL A SATISFACTORY LAWN IS ESTABLISHED. THE LAWN SHALL BE CONSIDERED ESTABLISHED WHEN ITS REASONABLY FREE FROM WEED, GREEN IN APPEARANCE AND THE SPECIFIED GRASS IS VIGOROUS AND GROWING WELL ON EACH SQ. FT. OF LAWN AREA.
- LAWN SHALL BE PROTECTED AND MAINTAINED BY WATERING, MOWING, AND REPLANTING, OVERSEEING, AS NECESSARY FOR AS LONG AS IS NECESSARY TO ESTABLISH A UNIFORM STAND. SCATTERED BARE SPOTS, NONE OF WHICH IS LARGER THAN ONE SQ. FT., WILL BE ALLOWED UP TO MAXIMUM OF THREE PERCENT OF ANY LAWN AREA. IT SHALL BE THE RESPONSIBILITY OF THE CONTRACTOR TO REPAIR ANY EROSIONAL DAMAGE TO THE LAWN AREA. FULL COVERAGE IS REQUIRED IN SIXTY DAYS.
- MAINTENANCE OF GRASSED AREAS SHALL CONSIST OF MOWING, WATERING AND FERTILIZING. ALL GRASSED AREAS SHALL BE MAINTAINED AT A HEIGHT NOT TO EXCEED 6" ABOVE FINISHED GRADE.
- IT SHALL BE THE CONTRACTOR'S RESPONSIBILITY TO MAINTAIN ALL GRASSED AREAS UNTIL ACCEPTANCE BY OWNER AT END OF PROJECT. LAWN MAINTENANCE SHALL OCCUR AT A MINIMUM OF ONCE PER SEVEN CALENDAR DAYS.
- FINAL SEEDING AND SOD AREAS / SQUARE FOOTAGES TO BE PAINTED IN FIELD AND APPROVED AND ADJUSTED IN FIELD BY OWNER'S REPRESENTATIVE PRIOR TO INSTALLATION.
- SEEDING SHALL TAKE PLACE IMMEDIATELY AFTER FINE GRADING. MAINTAIN SEEDED LAWN UNTIL COMPLETION AND ACCEPTANCE OF ENTIRE PROJECT.
- SEEDING BED SHALL HAVE TOPSOIL LOOSEN TO A DEPTH OF 4". REMOVE STONE OVER 1" IN ANY DIMENSION, ROOTS, RUBBISH, AND EXTRANEIOUS MATTER.



© 2017 WJK LTD.  
 DESIGN CONCEPTS, DRAWING, SHEETS, LOGOS, SPECIFICATIONS, DETAILS, WRITTEN MATERIAL SHALL NOT BE USED OR REPRODUCED IN WHOLE OR IN PART IN ANY FORM WITHOUT PRIOR WRITTEN CONSENT OF WJK LTD.  
 THIS SHEET TO SCALE AT: 24"X36"

SITE DEVELOPMENT PLANS  
 FOR  
**DR. MELLICHAMP DRIVE**  
 BLUFFTON, SOUTH CAROLINA

DATE:	16 JUNE 2017
PROJECT NO.:	1624.03
DRAWN BY:	KJ
CHECKED BY:	DK

**BID SET,  
NOT FOR  
CONSTRUCTION**

REVISIONS:

DRAWING TITLE  
**NOTES**

DRAWING NUMBER

**L20**





SITE DEVELOPMENT PLANS  
 FOR  
**DR. MELLICHAMP DRIVE**  
 BLUFFTON, SOUTH CAROLINA

DATE: 16 JUNE 2017  
 PROJECT NO.: 1624.03  
 DRAWN BY: KJ  
 CHECKED BY: DK

**BID SET,  
 NOT FOR  
 CONSTRUCTION**

REVISIONS:

DRAWING TITLE  
**SIGNAGE, FURNISHINGS, &  
 LIGHTING PLAN 1**

DRAWING NUMBER  
**L100**

SITE FURNISHINGS SCHEDULE L100			
SYMB.	QTY.	DETAIL	DESCRIPTION
	8	1/L300	STREET LIGHT
	1	2/L300	STREET LIGHT WITH ATTACHED SIGNAGE
	2	3/L300	STREET SIGN WITH ATTACHED STOP SIGN
	1	4/L300	WAYFINDING SIGNAGE - VEHICULAR
	-	5/L300	WAYFINDING SIGNAGE - PEDESTRIAN
	2	1/L301	BENCH
	2	2/L301	TRASH CAN
	4	3/L301	PLANTER
	-	4/L301	BIKE RACK

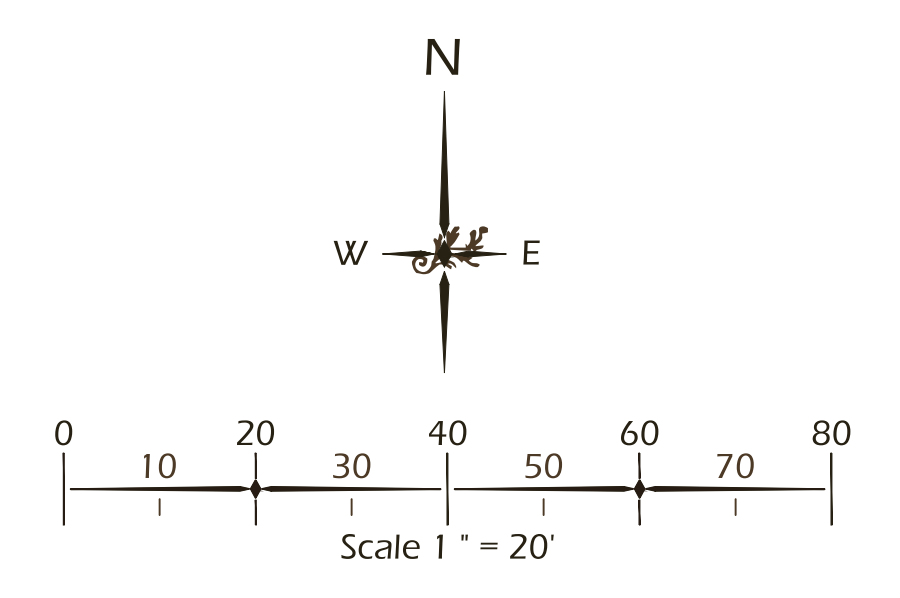
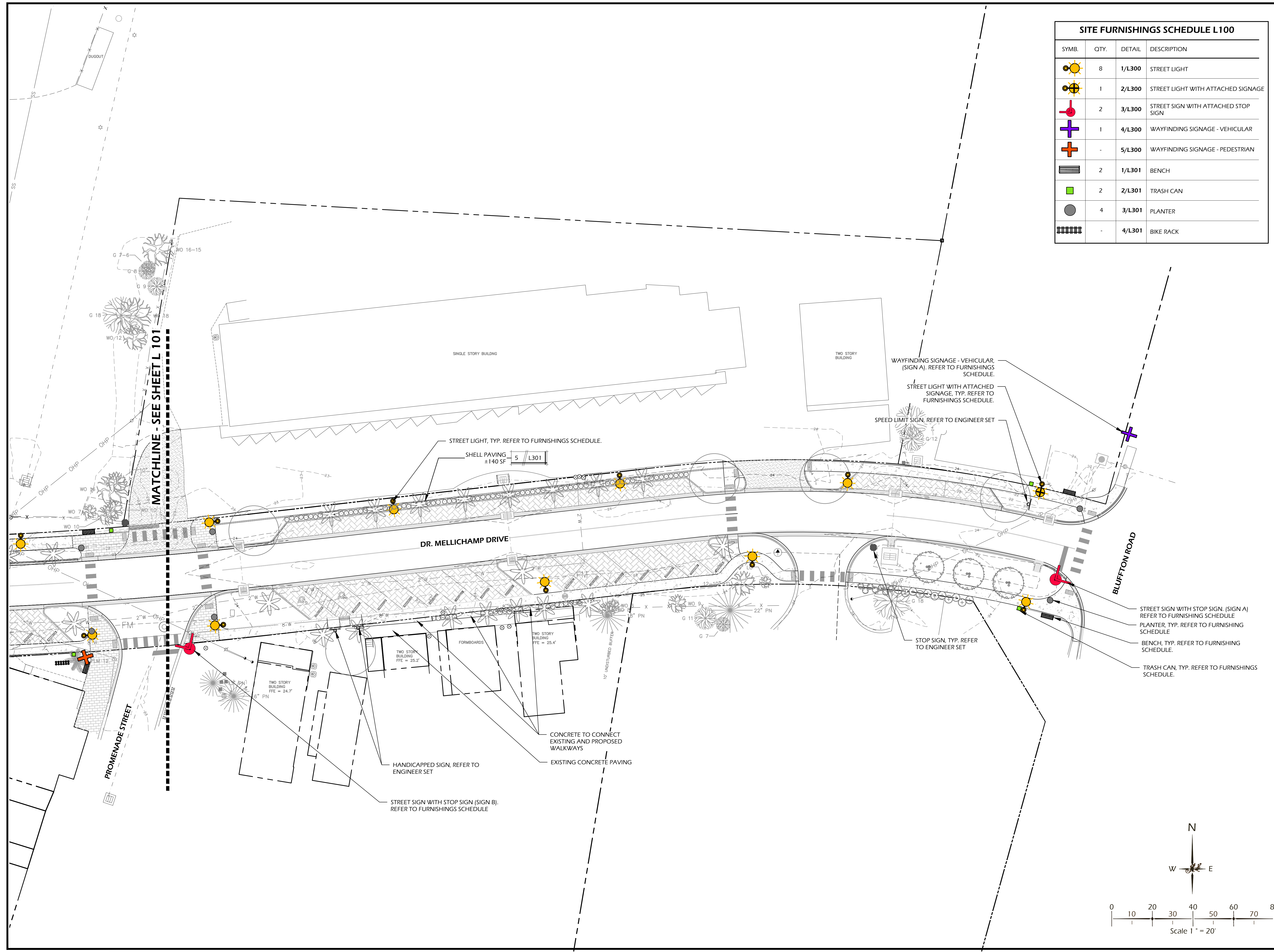



© 2017 WJK LTD.  
 DESIGN, CONCEPTS, DRAWING, SHEETS,  
 LOGOS, SPECIFICATIONS, DETAILS, WRITTEN  
 MATERIAL SHALL NOT BE USED OR  
 REPRODUCED IN WHOLE OR IN PART IN  
 ANY FORM WITHOUT PRIOR WRITTEN  
 CONSENT OF WJK LTD.  
 THIS SHEET TO SCALE AT: 24"X36"

SITE DEVELOPMENT PLANS  
 FOR  
**DR. MELLICHAMP DRIVE**  
 BLUFFTON, SOUTH CAROLINA

DATE: 16 JUNE 2017  
 PROJECT NO.: 1624.03  
 DRAWN BY: KJ  
 CHECKED BY: DK

**BID SET,  
 NOT FOR  
 CONSTRUCTION**

REVISIONS:

DRAWING TITLE  
**SIGNAGE, FURNISHINGS, &  
 LIGHTING PLAN 2**

DRAWING NUMBER  
**L101**

SITE FURNISHINGS SCHEDULE L101			
SYMB.	QTY.	DETAIL	DESCRIPTION
	8	1/L300	STREET LIGHT
	1	2/L300	STREET LIGHT WITH ATTACHED SIGNAGE
	1	3/L300	STREET SIGN WITH STOP SIGN
	1	4/L300	WAYFINDING SIGNAGE - VEHICULAR
	2	5/L300	WAYFINDING SIGNAGE - PEDESTRIAN
	4	6/L300	BENCH
	4	7/L300	TRASH CAN
	3	3/L301	PLANTER
	1	8/L300	BIKE RACK

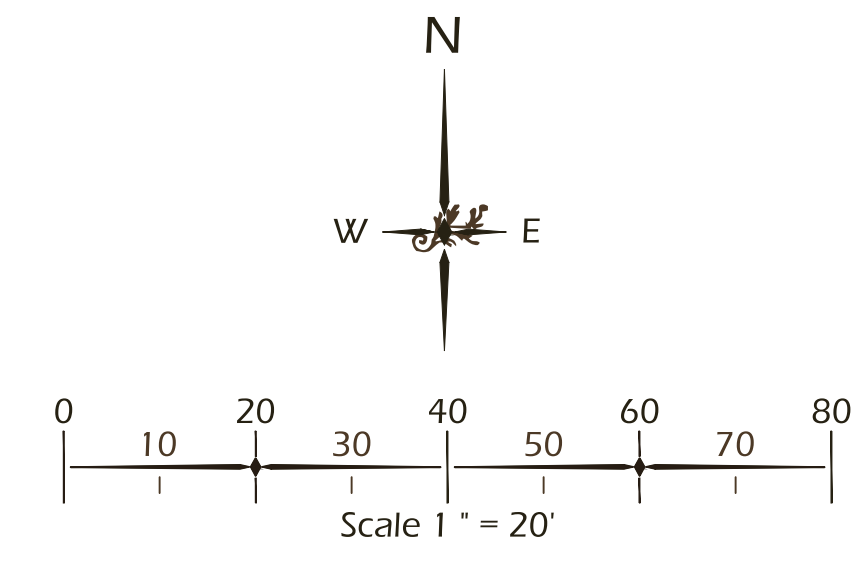
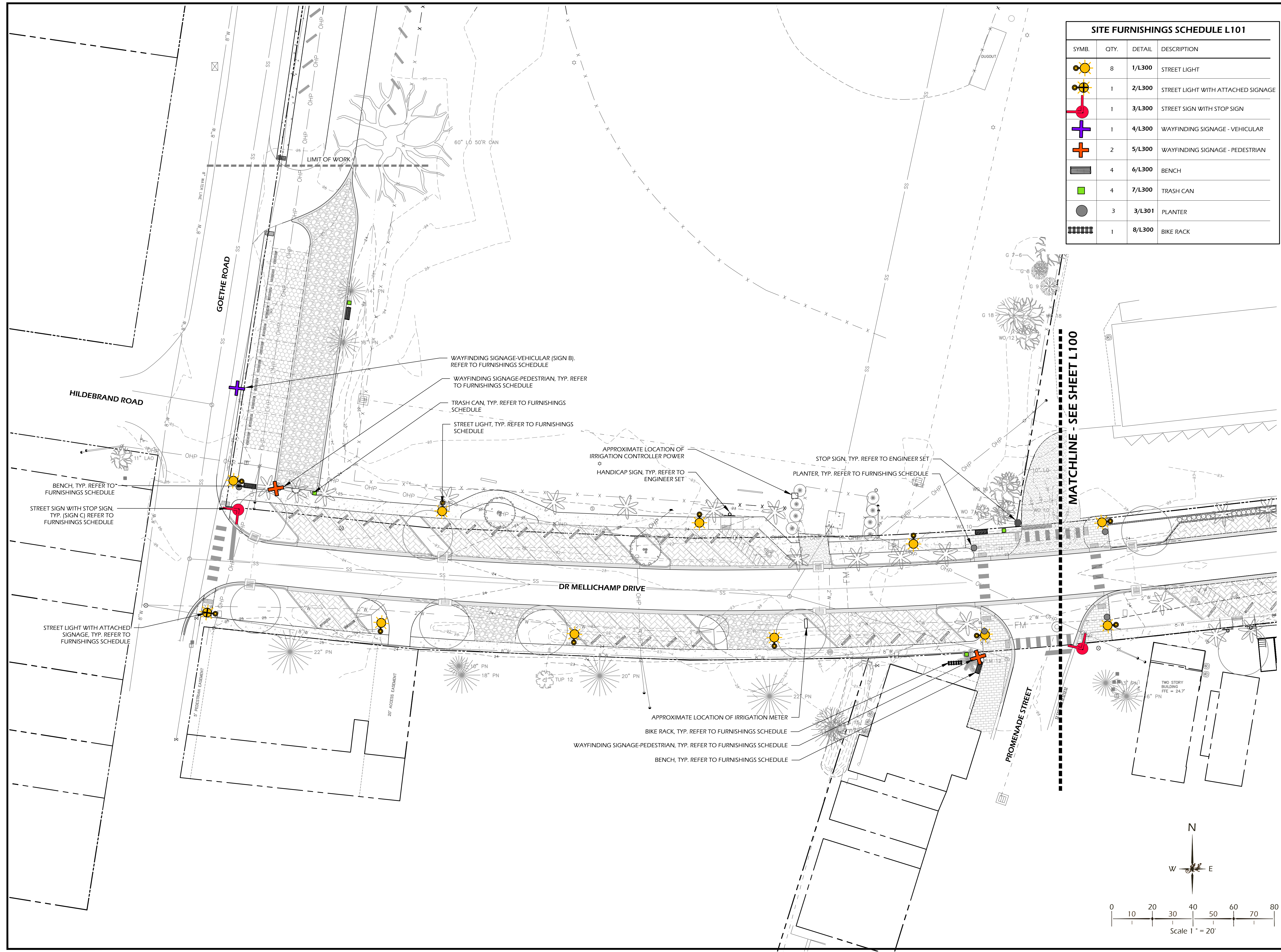



© 2017 WJK LTD.  
 DESIGN CONCEPTS, DRAWING, SHEETS,  
 LOGOS, SPECIFICATIONS, DETAILS, WRITTEN  
 MATERIAL SHALL NOT BE USED OR  
 REPRODUCED IN WHOLE OR IN PART IN  
 ANY FORM WITHOUT PRIOR WRITTEN  
 CONSENT OF WJK LTD.  
 THIS SHEET TO SCALE AT: 24"X36"

SITE DEVELOPMENT PLANS  
 FOR  
**DR. MELLICHAMP DRIVE**  
 BLUFFTON, SOUTH CAROLINA

DATE: 16 JUNE 2017  
 PROJECT NO.: 1624.03  
 DRAWN BY: KJ  
 CHECKED BY: DK

**BID SET,  
 NOT FOR  
 CONSTRUCTION**

REVISIONS:  
 \_\_\_\_\_  
 \_\_\_\_\_  
 \_\_\_\_\_  
 \_\_\_\_\_

DRAWING TITLE  
**PLANTING PLAN 1**

DRAWING NUMBER  
**L200**

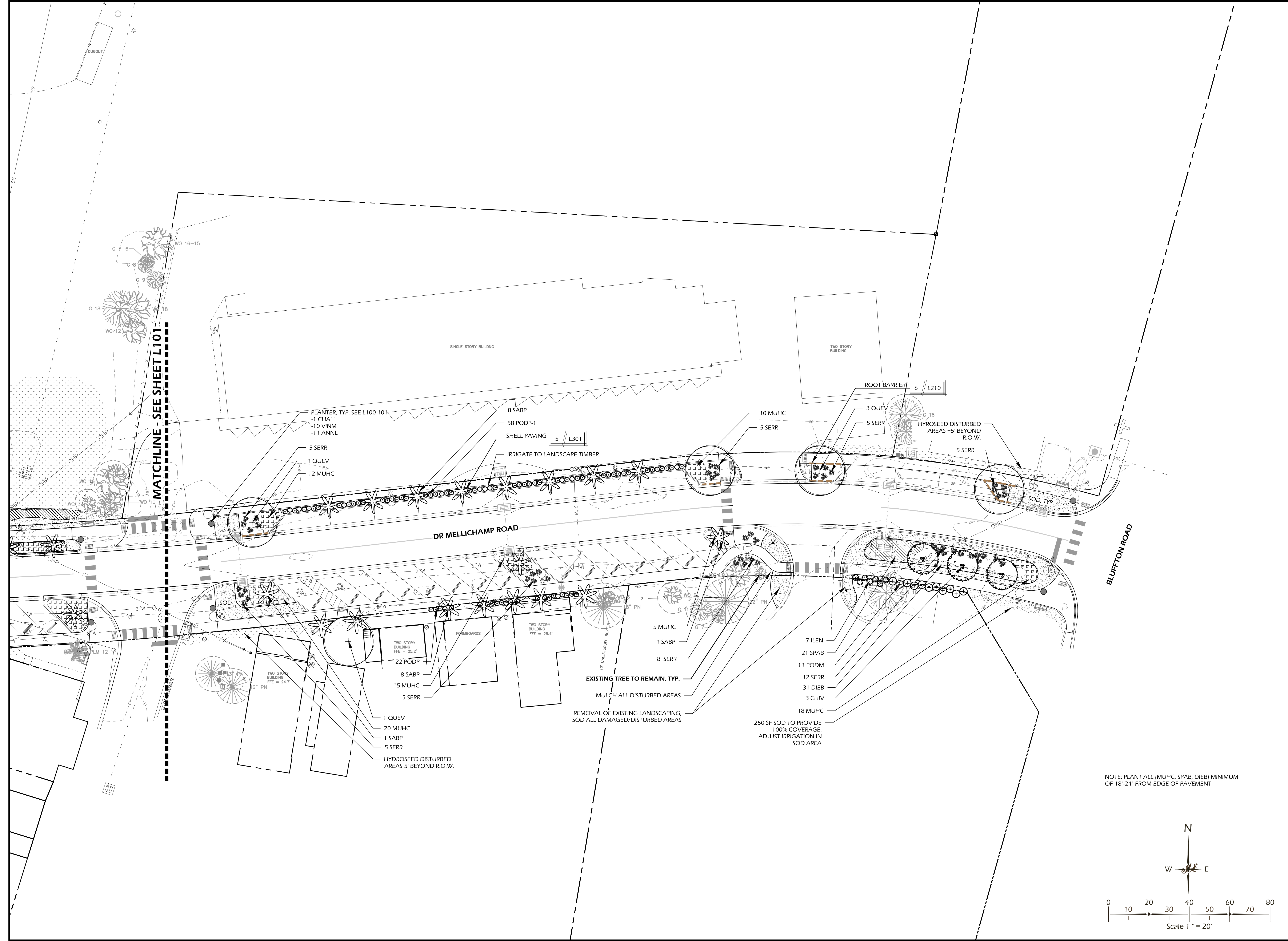

NOTE: PLANT ALL (MUHC, SPAB, DIEB) MINIMUM  
 OF 18"-24" FROM EDGE OF PAVEMENT

MATCHLINE - SEE SHEET L101













NOTE:  
 - STREET LIGHT POST TO BE 18" FROM SIDEWALK  
 - STREET LIGHT TO MATCH BLUFFTON 'SHEPARD'S HOOK' EXISTING LIGHT POSTS

**STREET LIGHT - N.I.C.**  
 (PRODUCED BY SCEG)

1 // L300 STREET LIGHT  
 NOTE TO SCALE



NOTE:  
 - TO MATCH BLUFFTON EXISTING BLUFFTON STREET LIGHT AND PARKING SIGNS  
 - STREET SIGNS AND TEXT TO BE APPROVED BY OWNER OR OWNERS REPRESENTATIVE PRIOR TO ORDERING AND INSTALLATION.

**\*\*ONLY ATTACHED PARKING SIGN FOR BID**

**STREET LIGHT = N.I.C.**  
 (PRODUCED BY SCEG)

2 // L300 STREET LIGHT WITH ATTACHED SIGNAGE  
 SCALE: NOT TO SCALE

STREET SIGNAGE SCHEDULE			
LETTER	SYMBOL	DESCRIPTION	LOCATION
A		1 BLUFFTON ROAD	BLUFFTON ROAD & DR MELLICHAMP ROAD
		2 DR MELLICHAMP ROAD	
B		1 PROMENADE STREET	PROMENADE STREET & DR MELLICHAMP ROAD
		2 DR MELLICHAMP ROAD	
C		1 GOETHE ROAD	GOETHE ROAD & DR MELLICHAMP ROAD
		2 DR MELLICHAMP ROAD	

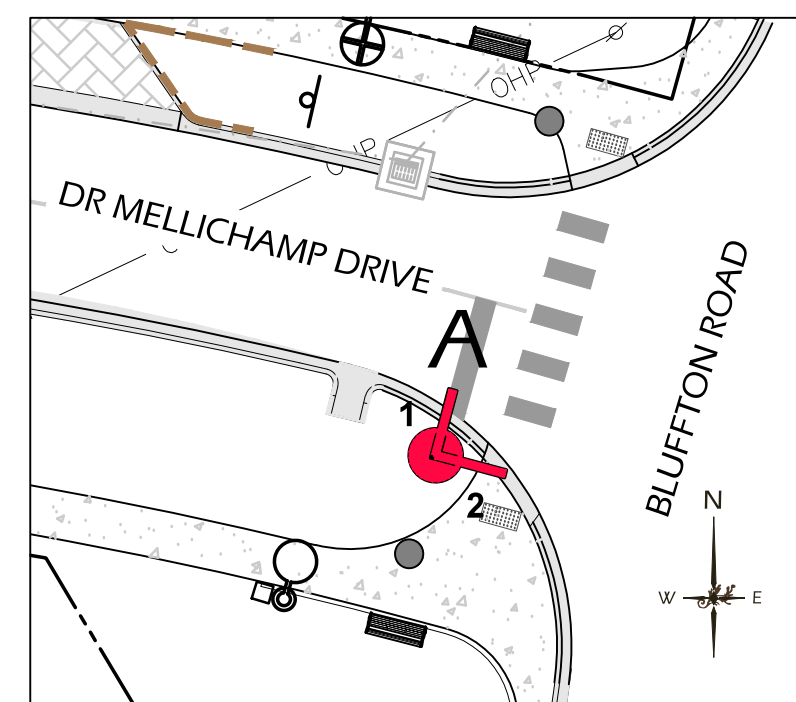

**A** DR MELLICHAMP DRIVE & PROMENADE STREET  
 SCALE: 1"=20'-0"

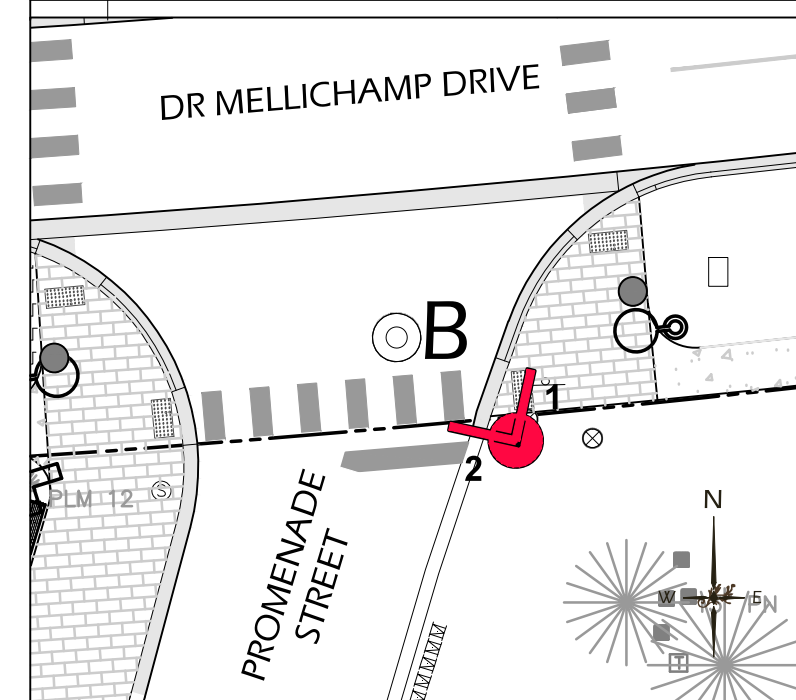

**B** DR MELLICHAMP DRIVE & PROMENADE STREET  
 SCALE: 1"=20'-0"

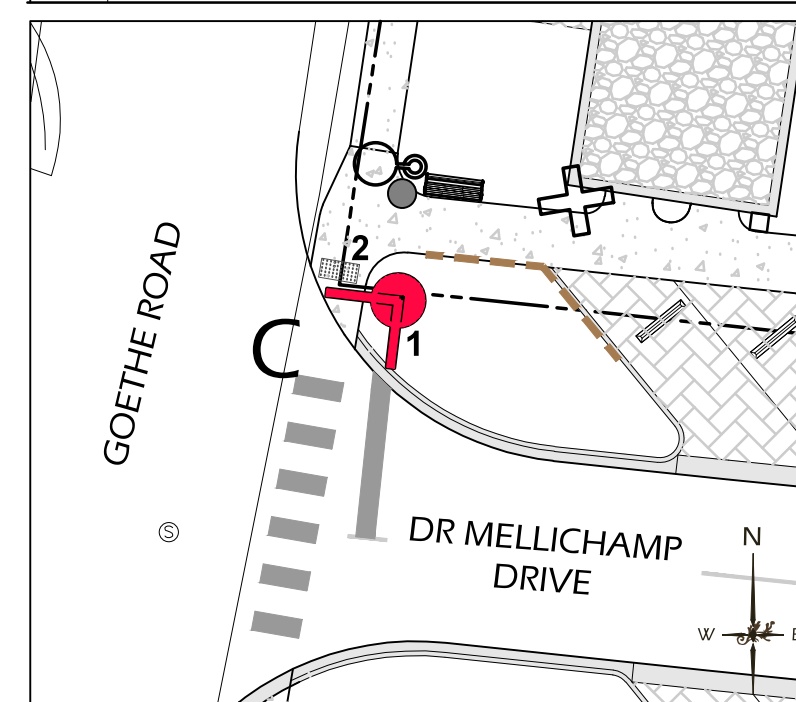

**C** DR MELLICHAMP DRIVE & PROMENADE STREET  
 SCALE: 1"=20'-0"



NOTE:  
 - TO MATCH BLUFFTON EXISTING STREET SIGN WITH ATTACHED STOP SIGN  
 - STREET SIGNS AND TEXT TO BE APPROVED BY OWNER OR OWNERS REPRESENTATIVE PRIOR TO ORDERING AND INSTALLATION.

WITH ATTACHED STOP SIGN TO POST

3 // L300 STREET SIGN  
 SCALE: NOT TO SCALE



NOTE:  
 - TO MATCH BLUFFTON EXISTING WAYFINDING SIGNAGE  
 - STREET SIGNS AND TEXT TO BE APPROVED BY OWNER OR OWNERS REPRESENTATIVE PRIOR TO ORDERING AND INSTALLATION.

**SIGN A:** NORTH FACING  
 → M.C. RILEY PARK  
 → PARKING DR MELLICHAMP DRIVE

**SIGN B:** NORTH FACING SOUTH FACING  
 ← PARKING DR MELLICHAMP DRIVE → M.C. RILEY PARK

4 // L300 WAYFINDING SIGNAGE - VEHICULAR  
 SCALE: NOT TO SCALE



NOTE:  
 - TO MATCH BLUFFTON EXISTING 'OLD TOWN BLUFFTON' MAP SIGNAGE

5 // L300 WAYFINDING SIGNAGE - PEDESTRIAN  
 SCALE: NOT TO SCALE

© 2017 WJK LTD.  
 DESIGN CONCEPTS, DRAWING, SHEETS, LOGOS, SPECIFICATIONS, DETAILS, WRITTEN MATERIAL SHALL NOT BE USED OR REPRODUCED IN WHOLE OR IN PART IN ANY FORM WITHOUT PRIOR WRITTEN CONSENT OF WJK LTD.  
 THIS SHEET TO SCALE AT: 24"x36"

SITE DEVELOPMENT PLANS  
 FOR  
**DR. MELLICHAMP DRIVE**  
 BLUFFTON, SOUTH CAROLINA

DATE: 16 JUNE 2017  
 PROJECT NO.: 1624.03  
 DRAWN BY: KJ  
 CHECKED BY: DK

**BID SET,  
 NOT FOR  
 CONSTRUCTION**

REVISIONS:  
 \_\_\_\_\_  
 \_\_\_\_\_  
 \_\_\_\_\_

DRAWING TITLE  
**DETAILS 1**

DRAWING NUMBER

**L300**





MANUFACTURER: VICTOR STANLEY  
 PRODUCT: RBW-28 (6)  
 MATERIAL: IPE WOOD WITH BLACK POWDERCOAT METAL FINISH

NOTE: TO BE APPROVED BY OWNER OR OWNER'S REPRESENTATIVE PRIOR TO ORDERING AND INSTALLATION.



MANUFACTURER: VICTOR STANLEY  
 PRODUCT: SDC-24  
 CAPACITY: 24 GAL  
 MATERIAL: BLACK POWDERCOAT METAL FINISH

NOTE: TO BE APPROVED BY OWNER OR OWNER'S REPRESENTATIVE PRIOR TO ORDERING AND INSTALLATION.



TABBY PLANTER TO MATCH EXISTING MAY RIVER ROAD STREETSCAPE

NOTE:  
 - TIE IRRIGATION TO PLANTERS  
 - TO BE APPROVED BY OWNER OR OWNER'S REPRESENTATIVE PRIOR TO ORDERING AND INSTALLATION.

1 // L301 BENCH  
 NOTE TO SCALE

2 // L301 TRASH CAN  
 SCALE: NOT TO SCALE

3 // L301 PLANTER  
 SCALE: NOT TO SCALE

CONCRETE SPECIFICATION:

- PROVIDE CONSTRUCTION JOINTS EVENLY SPACED ;5' O.C.
- INSTALL FIBER EXPANSION JOINT ONE FOOT FROM EDGE. TOOL EDGES OF EXPANSION MATERIALS. INSTALL JOINT PRIOR TO WASHING AGGREGATE.
- REMOVE TWO SIDE FORMS AFTER WASHING & WASH SIDES TO SOFTEN SHARP EDGES.

MANUFACTURER / ORDER INFORMATION:

THE PARK AND FACILITIES CATALOG  
 PHONE: (800) 695-3503  
 WEB: WWW.THEPARKCATALOG.COM

BIKE RACK: LOW PROFILE BIKE STAND  
 MATERIAL: METAL  
 MODEL: #342-1075, 12 BIKE GROUP LOOP BIKE RACK 85 LONG  
 FINISH: POWDER COATED BLACK - SMOOTH FINISH

NOTE: TO BE APPROVED BY OWNER OR OWNER'S REPRESENTATIVE PRIOR TO ORDERING AND INSTALLATION.



EXAMPLE PICTURE

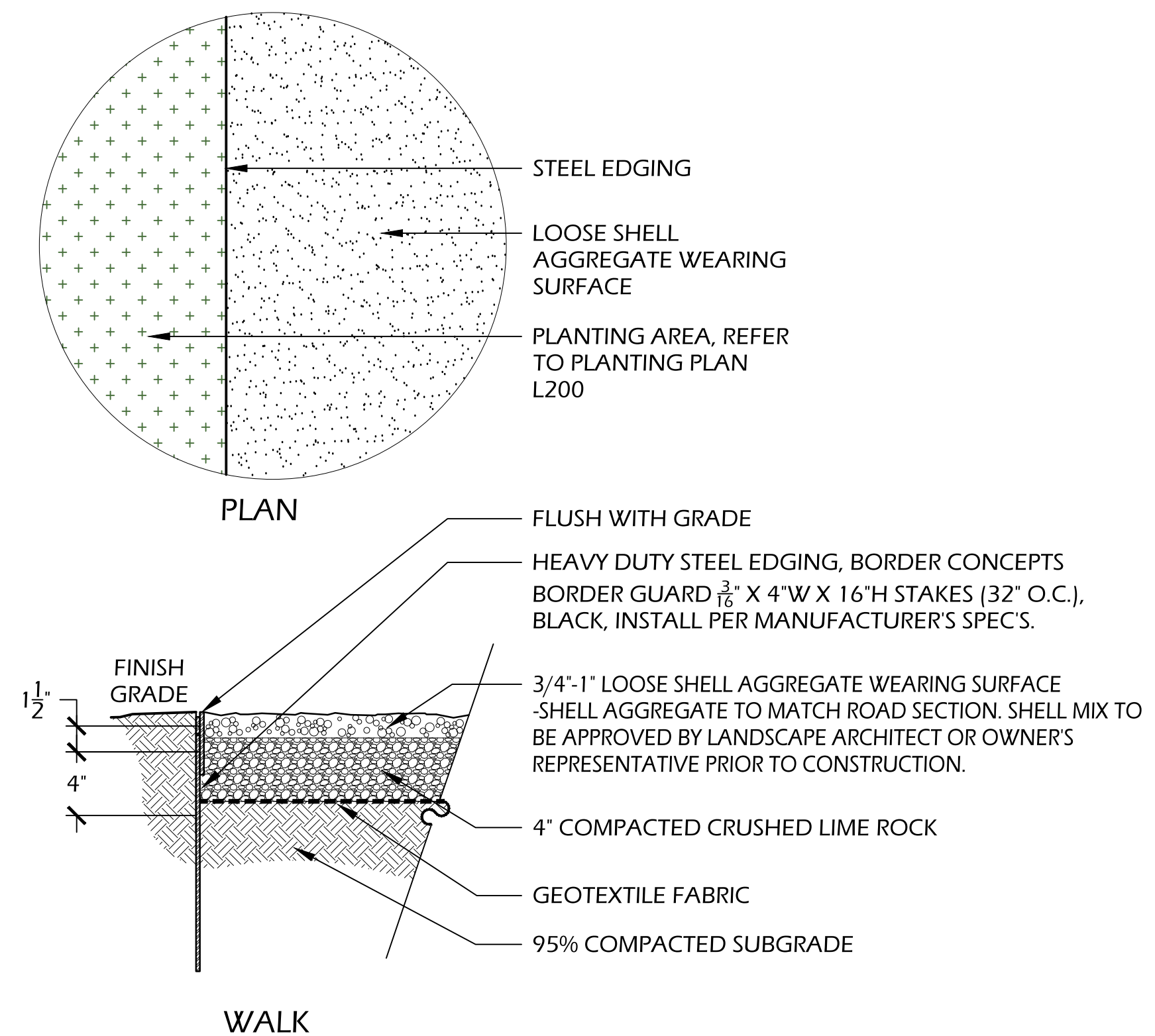
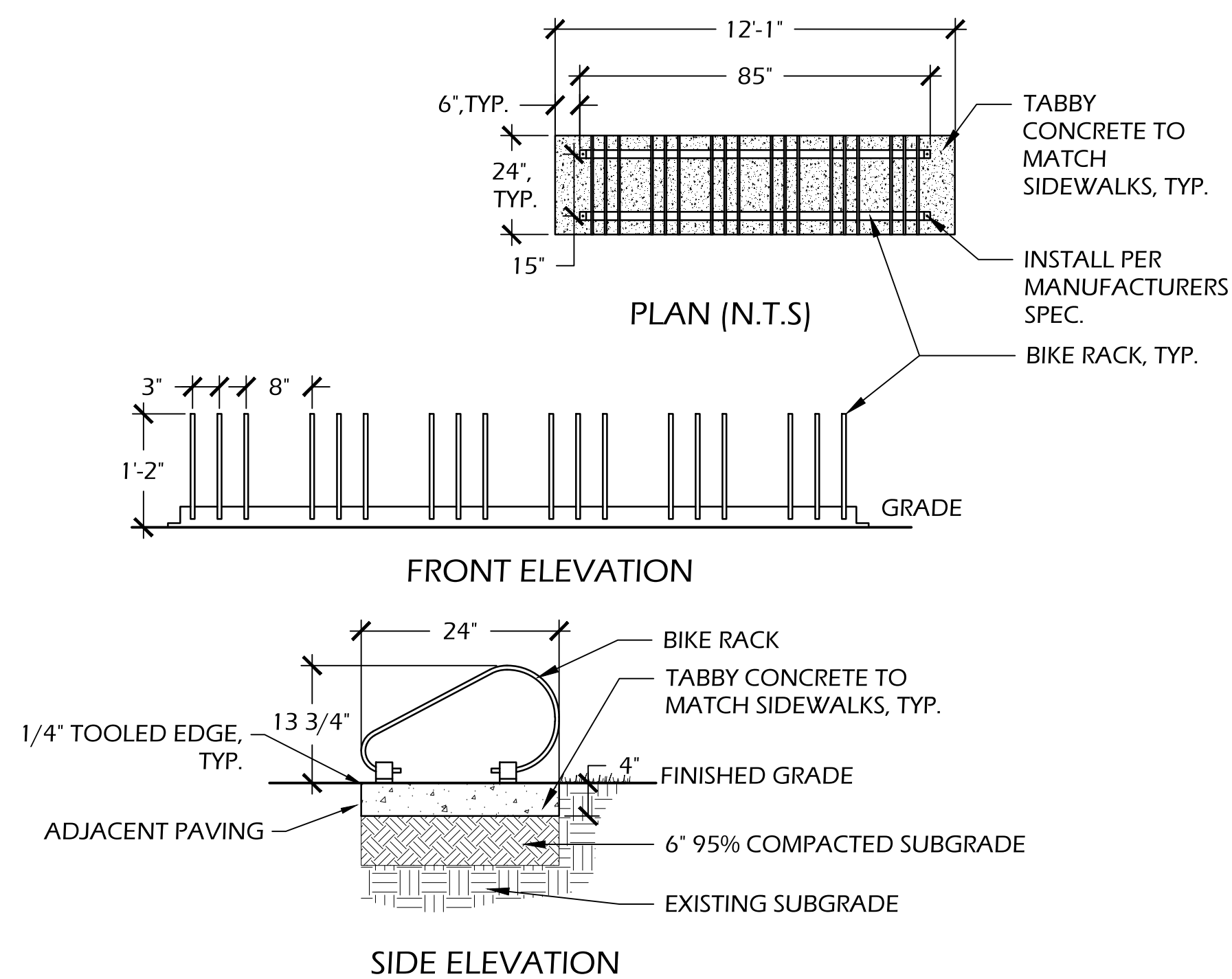

SITE DEVELOPMENT PLANS  
 FOR  
**DR. MELLICHAMP DRIVE**  
 BLUFFTON, SOUTH CAROLINA

DATE: 16 JUNE 2017  
 PROJECT NO.: 1624.03  
 DRAWN BY: KJ  
 CHECKED BY: DK

**BID SET,  
 NOT FOR  
 CONSTRUCTION**

REVISIONS:  
 \_\_\_\_\_  
 \_\_\_\_\_  
 \_\_\_\_\_

DRAWING TITLE  
**DETAILS 2**

DRAWING NUMBER

**L301**

© 2017 WJK LTD.  
 DESIGN CONCEPTS, DRAWING, SHEETS, LOGOS, SPECIFICATIONS, DETAILS, WRITTEN MATERIAL SHALL NOT BE USED OR REPRODUCED IN WHOLE OR IN PART IN ANY FORM WITHOUT PRIOR WRITTEN CONSENT OF WJK LTD.  
 THIS SHEET TO SCALE AT: 24"X36"

**Wimmer Jones-Keefe**  
 Ltd.  
 landscape architecture  
 and planning  
 www.wjkLtd.com  
 38 Promenade Street, Suite 801 | Bluffton, South Carolina 29910 | ph. 843.797.7411

4 // L301 BIKE RACK  
 SCALE: NOT TO SCALE

5 // L301 SHELL PAVING  
 SCALE: 1 1/2"=1'-0"



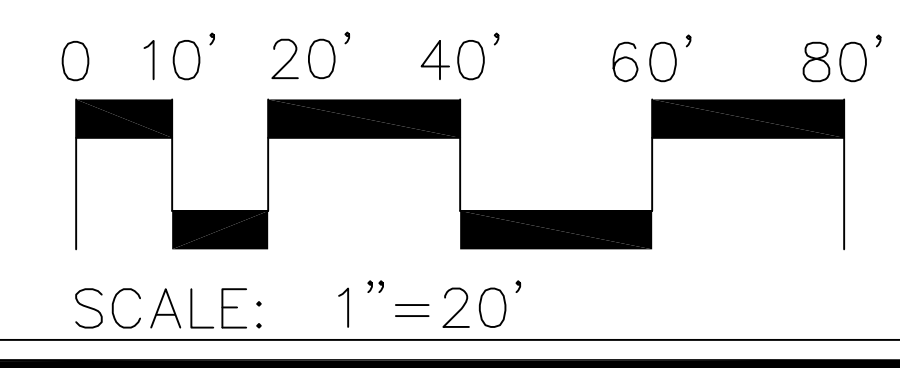
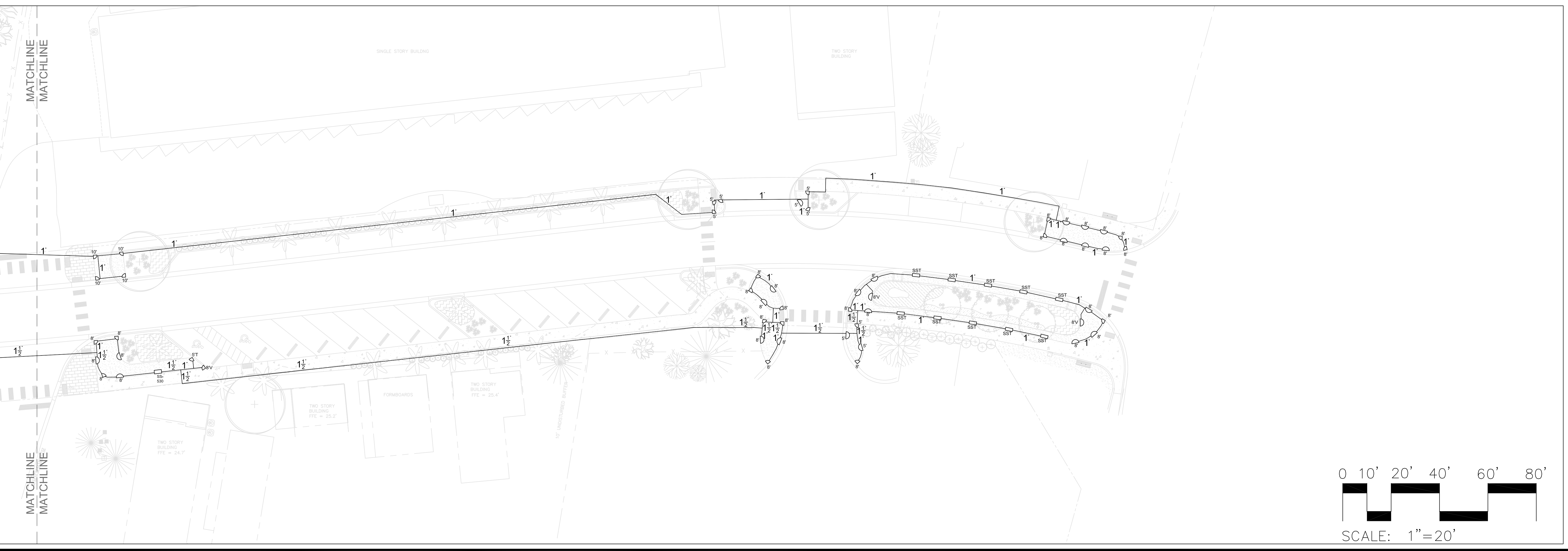
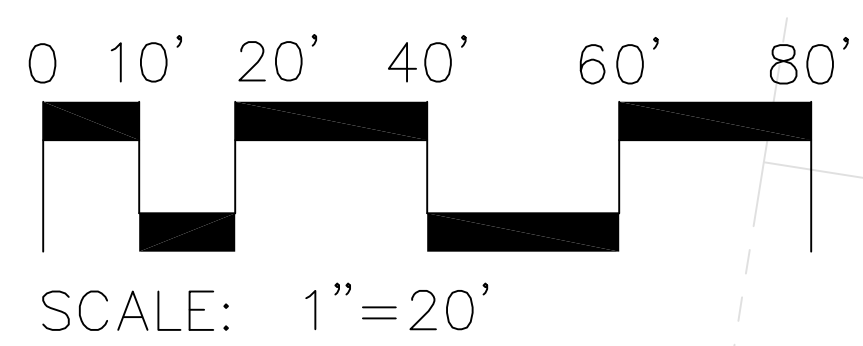
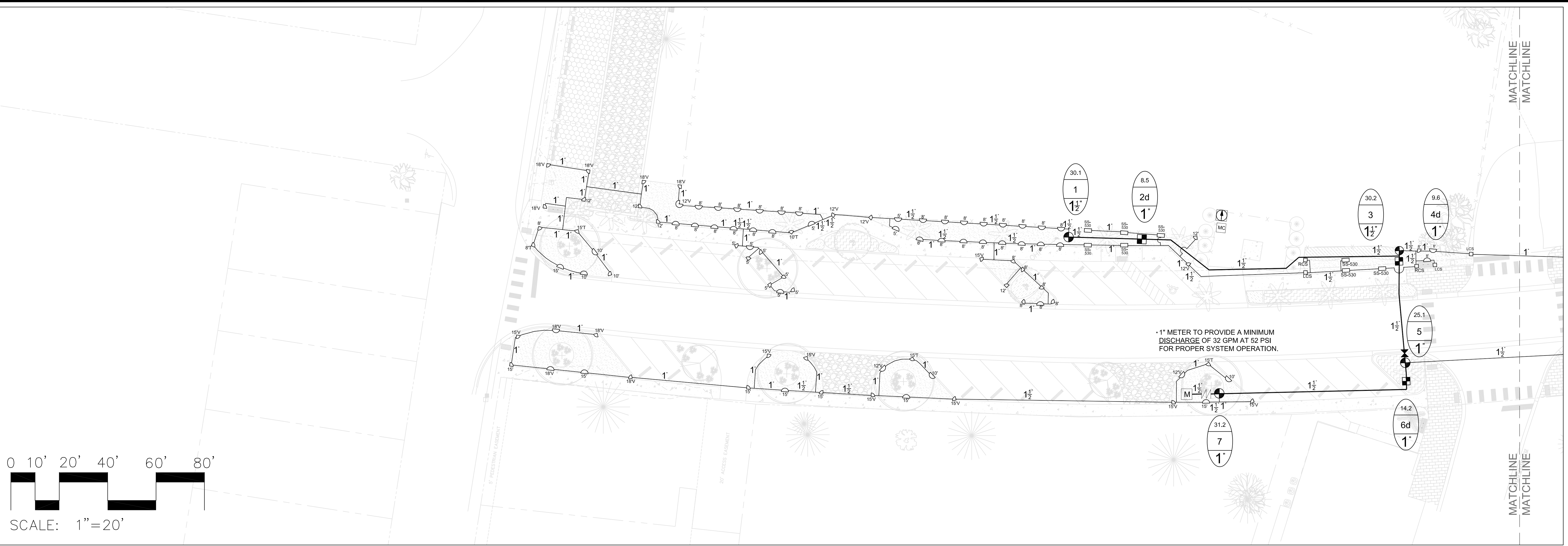

**Simmons Irrigation Supply**  
 P.O. BOX 10  
 526 SIDNEYS ROAD  
 WALTERBORO, SC 29488  
 PH: (843)538-5566  
 FAX: (843)538-2068  
[ssstznc@loucountry.com](mailto:ssstznc@loucountry.com)

THE DESIGN AND SPECIFICATIONS FOR THIS PROJECT PREPARED BY SIMMONS IRRIGATION SUPPLY PERSON OR PERSONS OTHER THAN SAID CLIENT OR HIS AGENTS. THIS DESIGN AND SPECIFICATIONS SHALL BE USED ONLY FOR THE PROJECT AND SHALL NOT BE USED IN CONNECTION WITH ANY OTHER PROJECT WITHOUT THE EXPRESS WRITTEN CONSENT OF SIMMONS IRRIGATION SUPPLY.

**DR. MELLICHAMP DRIVE  
 BLUFFTON, S.C.**  
 SPRAY IRRIGATION LAYOUT



REVISED 06-16-17
Acad #: 3849-1
Date: 05-12-2017
Scale: 1" = 20'
Drawn: TMM/CMN/ANR
Sheet: 1 OF 4







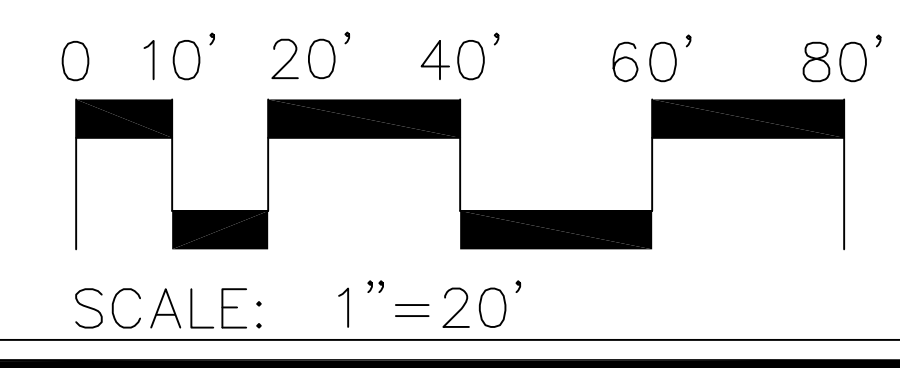
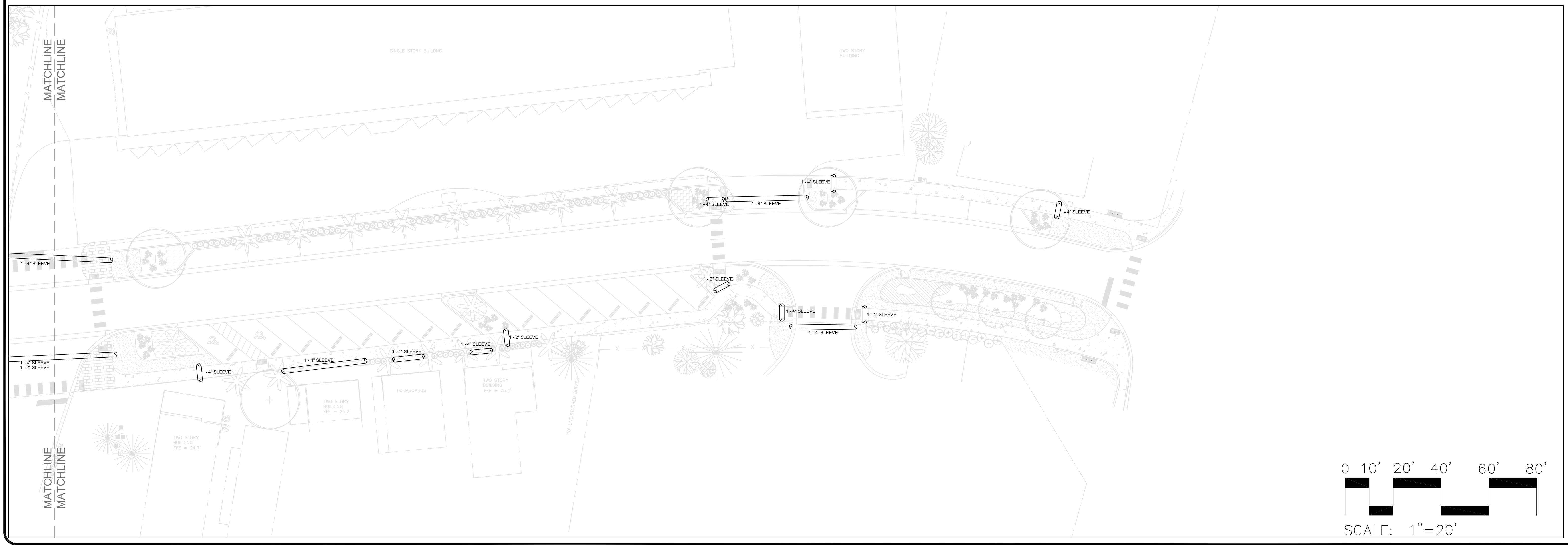
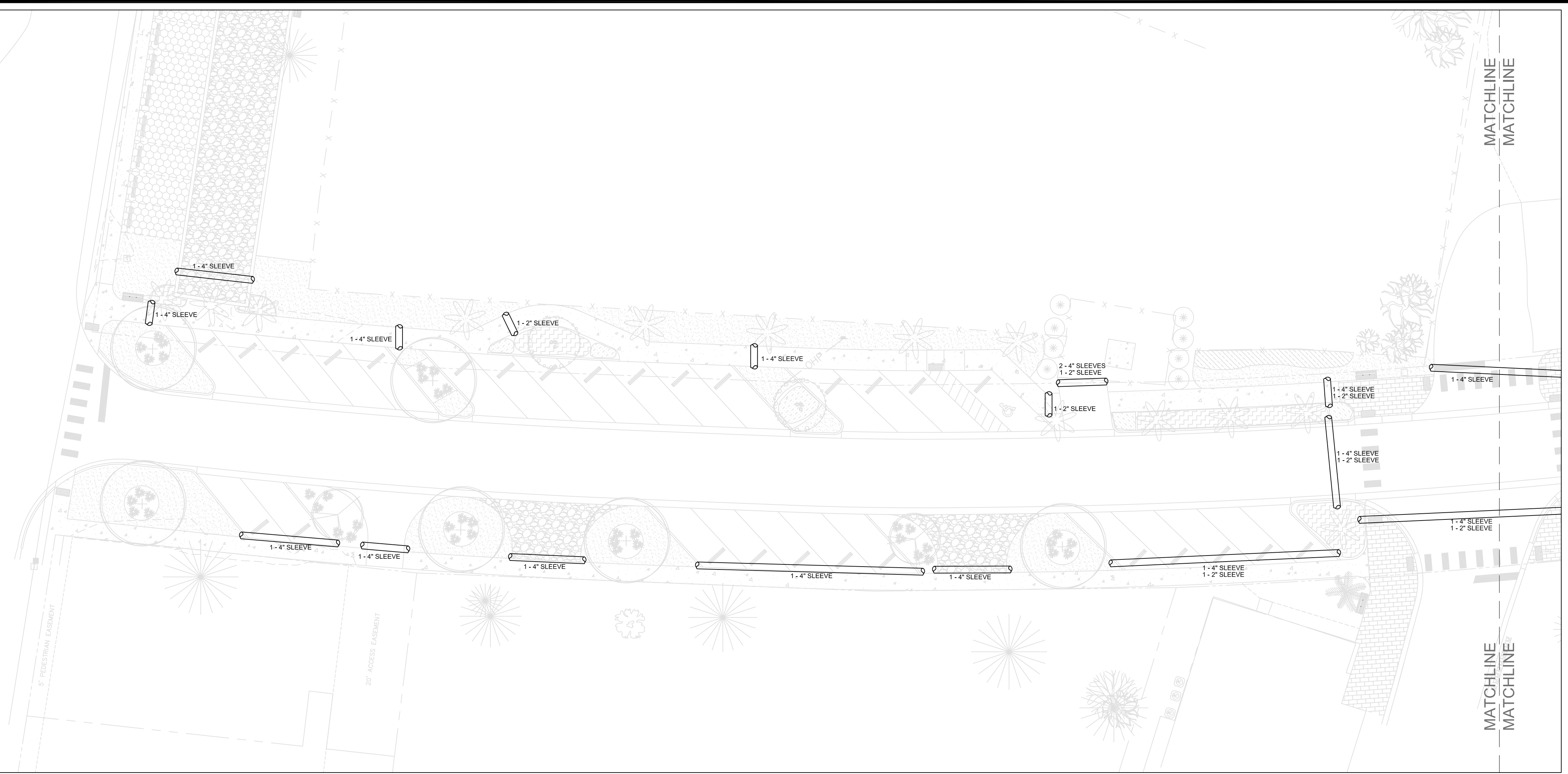
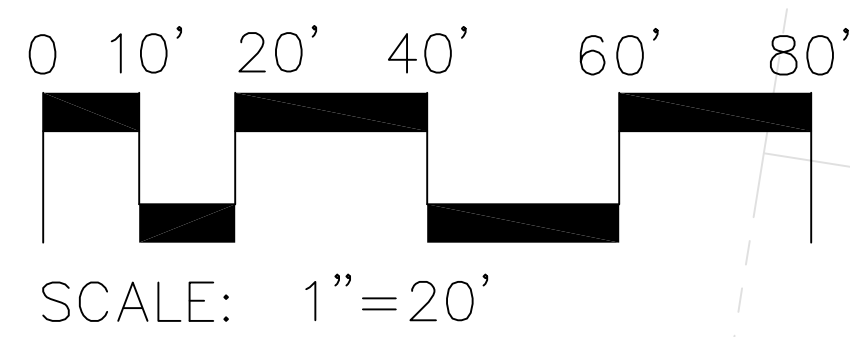

**Simmons Irrigation Supply**  
 P.O. BOX 10  
 526 SIDNEYS ROAD  
 WALTERBORO, SC 29488  
 PH: (843)538-5566  
 FAX: (843)538-2068  
[ssstz@loucountry.com](mailto:ssstz@loucountry.com)

THE DESIGN AND SPECIFICATIONS FOR THIS PROJECT PREPARED BY SIMMONS IRRIGATION SUPPLY PERSON OR PERSONS OTHER THAN SAID CLIENT OR HIS AGENTS. THIS DESIGN AND SPECIFICATIONS SHALL BE USED ONLY FOR THE PROJECT AND SHALL NOT BE USED IN CONNECTION WITH ANY OTHER PROJECT WITHOUT THE EXPRESS WRITTEN CONSENT OF SIMMONS IRRIGATION SUPPLY.

**DR. MELLICHAMP DRIVE  
 BLUFFTON, S.C.**

IRRIGATION SLEEVE LAYOUT



REVISED 06-16-17
Acad #: 3849-1
Date: 05-12-2017
Scale: 1" = 20'
Drawn: TMM/CMN/ANR
Sheet: 3 OF 4



**HUNTER PRO-C SERIES CONTROLLER**

- 4-16 STATIONS.
- VERSATILE MODULAR DESIGN SIMPLIFIES INVENTORY MANAGEMENT; EASILY CUSTOMIZE UNIT TO DESIRED NUMBER OF STATIONS.
- THREE PROGRAMS (A, B, C) WITH MULTIPLE START TIMES, INDEPENDENT PROGRAMMING HANDLES MANY DIFFERENT WATERING REQUIREMENTS.
- CHOICE OF INDEPENDENT DAY SCHEDULING OPTIONS - DAYS OF THE WEEK, ODD/EVEN OR 31-DAY INTERVAL FOR MAXIMUM FLEXIBILITY.
- GLOBAL WATER BUDGET/SEASONAL ADJUSTMENT EASILY SPACE TO WORK.
- NON-VOLATILE MEMORY HOLDS PROGRAMS INDEFINITELY; EXCELLENT INSURANCE AGAINST UNRELIABLE POWER.
- SUPERIOR SURGE PROTECTION AND SELF-DIAGNOSTIC SHORT CIRCUIT PROTECTION. MICROCIRCUITS ARE PROTECTED FROM ELECTRICAL SPIKES, NO FUSES TO WORRY ABOUT.
- REMOTE CONTROL READY - SUPPLIED WITH CONNECTION FOR SRR ANC ICR REMOTE CONTROL AND SRP PC PROGRAMMER.
- PROGRAMMABLE PUMP/MASTER VALVE CIRCUIT BY STATION.
- PROGRAMMABLE DELAY BETWEEN STATIONS OF ZERO SECONDS TO 4 HOURS FOR WELL RECOVERY OR SLOW-CLOSING VALVES.
- RUN TIME: UP TO SIX HOURS ON EACH STATION.
- START TIMES: 4 PER PROGRAM, FOR REPEAT WATERING NEEDS.
- CAPABLE OF OPERATING EQUIVALENT OF 3 SOLENOIDS SIMULTANEOUSLY.
- TRANSFORMER OUTPUT: 24VAC, 1.0 AMPS.
- STATION OUTPUT: 24VAC, 0.56A PER STATION.

**HUNTER MINI-CLIK SERIES RAIN SENSOR**

- EASILY INSTALLS ON ANY AUTOMATIC IRRIGATION SYSTEM; VERSATILE ENOUGH TO WORK WITH ALL POPULAR CONTROLLERS.
- PATENTED MECHANISM CANNOT BE FOULED BY DIRT OR DEBRIS; RELIABLE OPERATION; NO FALSE SHUTDOWNS.
- ADJUST TO ACTUATE AT VARIOUS RAINFALL QUANTITIES; SET FROM 1/8" TO 1" BASED UPON YOUR LOCAL CONDITIONS.
- INCLUDES 25 FEET OF 20 GAUGE WIRE TWO CONDUCTOR WIRE FOR FAST AND EASY MOUNTING OUT OF SIGHT.
- HEIGHT: 5 INCHES.
- SWITCH RATINGS: 10.1 AMPS, AT 125/250VAC.

**HUNTER PGV SERIES ELECTRIC VALVE**

- 1", 1 1/2" & 2".
- HEAVY-DUTY SOLENOID PROVIDES DEPENDABLE OPERATION AND LONG LIFE.
- HIGH GRADE CONSTRUCTION, 150 PSI RATING, MADE OF DURABLE MATERIALS TO RESIST WATER.
- INTERNAL MANUAL BLEED - EASY TO USE AND KEEPS VALVE BOX DRY.
- FLOW CONTROL WITH NON-RISING HANDLE - ADJUST THE FLOW OF EACH ZONE ON A SYSTEM.
- RIGID DIAPHRAM SUPPORT THAT WORKS TO PREVENT STRESS FAILURE IN TOUGH CONDITIONS.
- GLOBE AND ANGLE CONFIGURATIONS THAT ARE EASY TO USE IN ANY APPLICATION.
- CAPTIVE BONNET BOLTS AND SOLENOID PLUNGER - NO LOST PARTS DURING SERVICING.
- ACCU-SET PRESSURE REGULATOR COMPATIBLE - DIAL SETTING PRESSURE REGULATION FOR PRECISE SYSTEM CONTROL.
- PRESSURE: 20 TO 150 PSI.
- FLOW: .2 TO 120 GPM.
- POWER: 24VAC.

**HUNTER PRS30 SERIES POPUP SPRAYHEAD**

- MODELS: 4", 6", & 12"
- IN-STEM PRESSURE REGULATION BUILT-IN FOR MAXIMUM NOZZLE EFFICIENCY REGARDLESS OF INLET PRESSURE.
- HEAVY-DUTY BODY AND CAP CONSTRUCTION - MULTI-THREAD BUTTRESS DESIGN WITHSTANDS THE HARSHTEST ENVIRONMENTS.
- PRESSURE ACTIVATED, MULTI-FUNCTION, NO FLOW-BY WIPER SEAL THAT IS EASY TO REMOVE AND CLEAN; TREATED WITH UV INHIBITORS TO ENSURE LONG LIFE.
- COMPATIBLE WITH ALL FEMALE THREADED NOZZLES; ACCEPTS ADJUSTABLE, FIXED AND SPECIALTY NOZZLES FROM HUNTER AND ALL MAJOR BRANDS.
- OPTIONAL FACTORY-INSTALLED DRAIN CHECK VALVE FOR UP TO 14 FEET ELEVATION CHANGE TO ELIMINATE LANDSCAPE DAMAGE FROM FLOODING AND EROSION.
- RATCHETING RISER FOR QUICK ARC ALIGNMENT; MAKE ADJUSTMENTS WHILE SPRINKLER IS OPERATING.
- HEAVY-DUTY SPRING FOR POSITIVE RETRACTION UNDER ANY CONDITIONS.
- INNOVATIVE "PULL-RING" FLUSH PLUG DESIGN TO ALLOW LIMITED FLOW PERMITTING CONTROLLED DIRECTIONAL FLUSHING.
- RECOMMENDED PRESSURE RANGE: 15 TO 100 PSI.
- 1/2" FEMALE INLET NPT.

**HUNTER PCZ-101 SERIES CONTROL ZONE KIT**

- FACTORY-ASSEMBLED AND WATER TESTED.
- HIGHEST QUALITY COMPONENTS (SS FILTER SCREEN, STANDARD FLUSH CAP, TOP OF THE LINE REGULATOR).
- FILTER SCREEN\*\* DIAPHRAM SCREEN CLEANING SYSTEM ON ICZ KITS.
- WIDE FLOW RANGE TO COVER MOST MICRO IRRIGATION APPLICATIONS.
- PRESSURE REGULATION: 25 OR 40 PSI.
- FLOW: 0.5 TO 15 GPM.
- OPERATING PRESSURE: 20 TO 120 PSI.
- OPERATING TEMPERATURE: UP TO 150° F.

**RAIN BIRD PRESSURE COMPENSATING MODULE**

- POINT-SOURCE MEDIUM FLOW EMITTERS FOR WATERING LARGER SHRUBS AND TREES.
- THE ONLY EMITTERS WITH SELF-PERCING BARBS, MAKING THEM THE EASIEST TO INSTALL USING THE XERIMAN TOOL.
- WIDEST SELECTION OF PRESSURE-COMPENSATING EMITTERS, WITH 6 FLOW RATES AND 3 INLET OPTIONS.
- MOST COMPACT AND UNOBTRUSIVE EMITTERS.
- FLOW RATES FROM 5 TO 24 GPH (18.93 TO 90.84 l/h)
- PRESSURE-COMPENSATING DESIGN DELIVERS UNIFORM FLOW THROUGHOUT A WIDE PRESSURE RANGE (10 TO 50 PSI; 0.7 TO 3.5 BAR)
- AVAILABLE IN 3 DIFFERENT INLETS
  - SELF-PERCING BARBS FOR QUICK ONE-STEP EMITTER INSERTION INTO 1/2" OR 3/4" DRIP TUBING.
  - 10-32 THREADED INLET THAT EASILY THREADS INTO A POLYFLEX RISER 1032 THREAD ADAPTER OR 1800 XERI-BUBBLER ADAPTER.
  - 1/2" FPT INLET THAT EASILY THREADS ONTO A 1/2" PVC RISER.
- ROBUST DESIGN - DURABLE PLASTIC CONSTRUCTION IS UV-RESISTANT AND COLOR-CODED TO IDENTIFY FLOW RATE.
- REQUIRES A 100 MESH FILTRATION.
- MODELS:
  - PC-05: LIGHT BROWN, 5 GPH
  - PC-07: VIOLET, 7 GPH
  - PC-10: GREEN, 10 GPH
  - PC-12: DARK BROWN, 12 GPH
  - PC-18: WHITE, 18 GPH
  - PC-24: ORANGE, 24 GPH

**RAIN BIRD XERI-BUG SERIES EMITTER**

- PRESSURE-COMPENSATING DESIGN DELIVERS UNIFORM FLOW THROUGHOUT A WIDE PRESSURE RANGE (15 TO 50 PSI).
- COLOR-CODED INLET BARB (XB SERIES) IDENTIFIES FLOW RATE.
- AVAILABLE WITH SELF-PERCING INLET BARB (XB SERIES) TO PERMIT ONE-STEP EMITTER INSERTION INTO 1/2" OR 3/4" DRIP TUBING WHEN INSTALLED WITH XB-TOOL. 10-32 THREADED INLET EASILY THREADS INTO ADAPTERS OR 1/4" TUBING.
- 1/2" FPT INLET (XBT SERIES) THREAD EASILY ONTO 1/2" RISER.
- SELF-FLUSHING ACTION MINIMIZES CLOGGING.
- BARBED OUTLET SECURELY RETAINS 1/4" DISTRIBUTION TUBING (DT-025) OR (PT-025).
- HIGHLY INERT DIAPHRAM IS RESISTANT TO CHEMICALS.
- DURABLE PLASTIC CONSTRUCTION IS UV-RESISTANT.
- FLOW: 0.5, 1.0 OR 2.0 GPH.
- PRESSURE: 15 TO 50 PSI.
- FILTRATION: 150 TO 200 MESH.
- MODELS: XB-05
  - XB-10
  - XB-20
  - XBT-10
  - XBT-20

**PROJECT CONDITIONS**

- PERFORM SITE SURVEY, RESEARCH PUBLIC UTILITY RECORDS, AND VERIFY EXISTING UTILITY LOCATIONS. VERIFY THAT IRRIGATION SYSTEM PIPING MAY BE INSTALLED IN COMPLIANCE WITH ORIGINAL DESIGN AND REFERENCED STANDARDS.

**WATER SOURCE**

- INSTALLER SHOULD CONFIRM THE MINIMUM DISCHARGE REQUIREMENTS OF THE WATER SOURCE AS INDICATED ON THE DRAWING LEGEND PRIOR TO INSTALLATION.
- IF SOURCE IS LESS THAN MINIMUM REQUIREMENT, CONSULT WITH A DESIGNER FOR POSSIBLE HYDRAULIC CHANGES.

**BACKFLOW PREVENTER**

- DESIGN UTILIZES AN INLINE DOUBLE CHECK ASSEMBLY BACKFLOW PREVENTER DEVICE. INSTALLER MUST CONFIRM WITH THE LOCAL WATER AUTHORITY, THEIR APPROVED TYPE DEVICE AND INSTALLATION METHODS IN ORDER TO CONFORM WITH LOCAL CODES. IF A DIFFERENT TYPE DEVICE IS USED, CONSULT WITH A DESIGNER FOR POSSIBLE HYDRAULIC CHANGES.

**SLEEVING**

- A MINIMUM OF PR-200 PVC SLEEVES SHOULD BE USED UNDER ANY HARDSCAPING. (EXAMPLE: SIDEWALKS AND DRIVES).
- SLEEVES TO BE A MINIMUM OF (2) PIPE SIZES LARGER THAN THE PIPE RUNNING THROUGH IT.
- A SEPARATE SLEEVE IS RECOMMENDED FOR WIRE.

**PIPE AND FITTINGS**

- ALL PIPE 1" OR SMALLER TO BE PR-200 SDR-21 SOLVENT WELD PVC PIPE.
- ALL PIPE 1 1/2" OR LARGER TO BE PR-160 SDR-26 SOLVENT WELD PVC PIPE.
- ALL PVC PIPE FITTINGS TO BE SCHEDULE 40, SOCKET-TYPE.
- PVC PIPING AND FITTINGS SOLVENT-CEMENTED JOINTS TO BE CONSTRUCTED UTILIZING CLEANER, PURPLE PRIMER, AND SOLVENT CEMENTS.
- GENERAL LOCATIONS AND ARRANGEMENTS: DRAWINGS INDICATED GENERAL LOCATION AND ARRANGEMENT OF PIPING SYSTEMS. INDICATED LOCATIONS AND ARRANGEMENTS WERE USED FOR DESIGN LEGIBILITY, TO SIZE PIPE AND CALCULATE FRICTION LOSS, AND OTHER DESIGN CONSIDERATIONS.
- MINIMUM COVER: PROVIDE THE FOLLOWING MINIMUM COVER OVER TOP OF BURIED PIPING OR 12" BELOW THE AVERAGE LOCAL FROST DEPTH, WHICHEVER IS THE GREATER DEPTH.
  - PRESSURE PIPING: 18" OF COVER FOR PIPE 2 1/2" AND SMALLER; 24" FOR PIPE 3" AND 4"; AND 30" FOR PIPE 6" AND LARGER.
  - CIRCUIT PIPING: 18" OF COVER FOR CIRCUIT PIPE.
  - DRAIN PIPING: 18" OF COVER FOR PIPE 4" AND SMALLER; 24" FOR PIPE 6" AND LARGER.
  - SLEEVES: 24" OF COVER FOR PIPE 6" AND SMALLER; 30" FOR PIPE 8" AND LARGER.
- PRIOR APPROVAL BY LANDSCAPE ARCHITECT MUST BE OBTAINED FOR ALL TRENCHING AROUND EXISTING SPECIMEN/LARGE TREES.
- ONLY HAND TRENCHING WILL BE ALLOWED WITHIN THE "TREE SAVE" AREAS.

**WIRING**

- SOLID COPPER CONDUCTOR, INSULATED CABLE, SUITABLE FOR DIRECT BURIAL.
- LOW-VOLTAGE, BRANCH CIRCUIT CABLES: TYPE PE, NO. 14 AWG MINIMUM, BETWEEN CONTROLLERS AND AUTOMATIC CONTROL VALVES. JACKET COLOR IS OTHER THAN FEEDER-CIRCUIT-CABLE JACKET COLOR.
- SPLICING MATERIALS: 3M DBR/Y OR APPROVED EQUAL.

**VALVE/ZONE IDENTIFICATION**

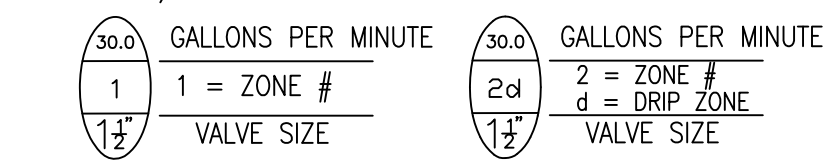

**SPRINKLER INSTALLATION**

- LOCATION OF SPRINKLERS AND DEVICES: DESIGN LOCATION IS APPROXIMATE. MINOR FIELD ADJUSTMENTS MAY BE NECESSARY TO AVOID PLANTINGS AND OBSTRUCTIONS SUCH AS SIGNS AND LIGHT STANDARDS.
- SPRINKLERS TO BE SPACED NO GREATER THAN 50% - 55% OF DIAMETER OF THROW AT OPTIMUM PERFORMANCE PRESSURE. THIS WILL ACHIEVE "HEAD TO HEAD" COVERAGE PERFORMANCE.
- FLUSH CIRCUIT PIPING WITH FULL HEAD OF WATER AND INSTALL SPRINKLERS AFTER HYDROSTATIC TEST IS COMPLETE.
- INSTALL LAWN SPRINKLERS AT MANUFACTURER'S RECOMMENDED HEIGHTS.
- INSTALL SHRUBBERY SPRINKLERS AT HEIGHTS INDICATED.
- LOCATE PART-CIRCLE SPRINKLERS TO MAINTAIN A MINIMUM DISTANCE OF 6" FROM WALLS AND 3" FROM OTHER BOUNDARIES (SIDEWALKS, CURBS) UNLESS OTHERWISE INDICATED.
- CAREFULLY ADJUST LAWN SPRINKLERS SO THEY WILL BE FLUSH WITH, OR NOT MORE THAN 1/2" ABOVE, FINISH GRADE AFTER COMPLETION OF LANDSCAPE WORK.
- CAREFULLY ADJUST ALL SPRINKLERS IN MULCH AREAS SO THEY WILL BE PLUMB AND FLUSH WITH TOP OF MULCH GRADE.
- ALL SPRAYHEAD NOZZLES INDICATED ON PLAN.
- USE VANS (VARIABLE ARC NOZZLE) WHERE INDICATED ON PLAN.

**VALVE INSTALLATION**

- ALL VALVES (MANUAL AND ELECTRIC) TO BE INSTALLED IN A NDS #212BC 10" ROUND PRO SERIES VALVE BOX WITH LID (UNLESS OTHERWISE NOTED).
- CONTRACTOR TO ADJUST THE FLOW CONTROL HANDLE IN ORDER TO ACHIEVE PROPER VALVE OPERATION AND OPTIMUM SPRINKLER PERFORMANCE.
- VALVES SHALL NOT BE PLACED WITHIN 5 FEET OF ANY DRIVEWAY, OR WHERE THEY CAN BE DAMAGED BY VEHICLES.

**DRIP INSTALLATION**

- IRRIGATION CONTRACTOR OR LANDSCAPE MANAGER MAY NEED TO ADJUST THE NUMBER OF EMITTERS AND/OR THE CONTROLLER RUN TIME SCHEDULE IN ORDER TO ACHIEVE OPTIMUM GROWING CONDITIONS FOR EACH PLANT IN REGARD TO: PLANT SIZE, TYPE, MATURITY, SOIL CONDITIONS, SITE LOCATION, DRAINAGE, AND PLANTING SEASON.
- NO BLANK TUBING RUN TO EXCEED 175' FROM CONNECTION TO PVC LATERAL HEADER PIPE.
- ZONES BASED ON A MINIMUM OF 25 PSI.

**ELEVATION**

- THE PRESSURE REQUIREMENT OF THE WATER SOURCE IS BASED ON NO MORE THAN 3 FEET OF RISE IN ELEVATION FROM WATER SOURCE THROUGHOUT THE IRRIGATION COVERAGE AREA. IF SITE HAS GREATER ELEVATION CHANGE, CONSULT WITH DESIGNER FOR POSSIBLE HYDRAULIC CHANGE.

**SCHEDULING**

- ADJUST SETTINGS OF CONTROLLERS AND AUTOMATIC CONTROL VALVES, AND PROVIDE WRITTEN SCHEDULE TO OWNER.

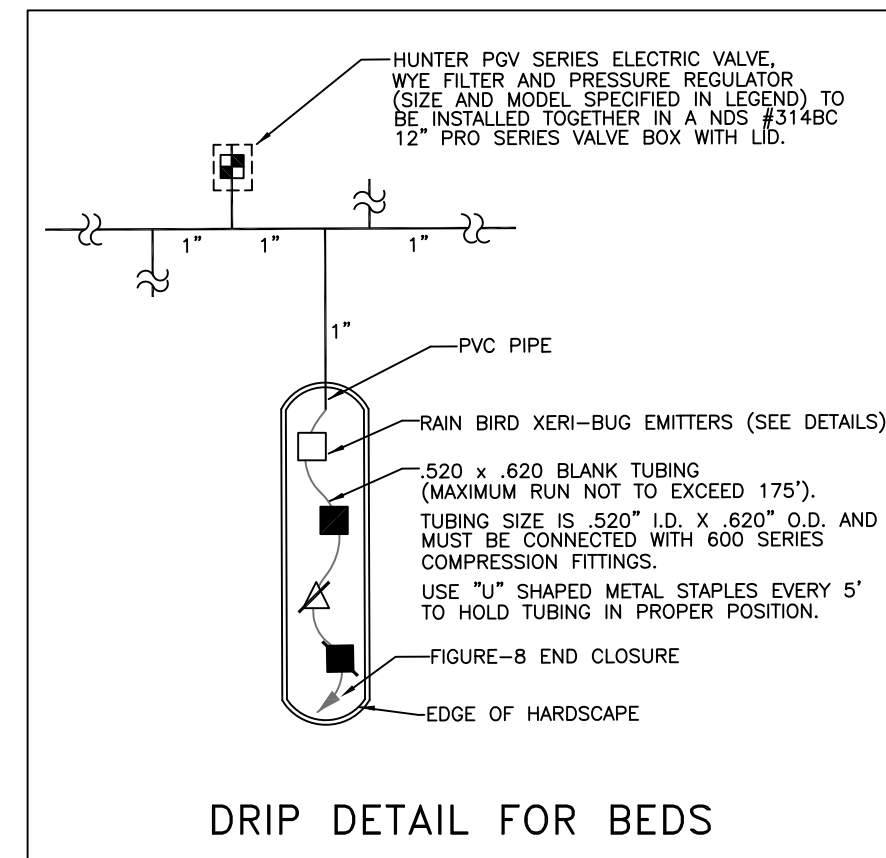
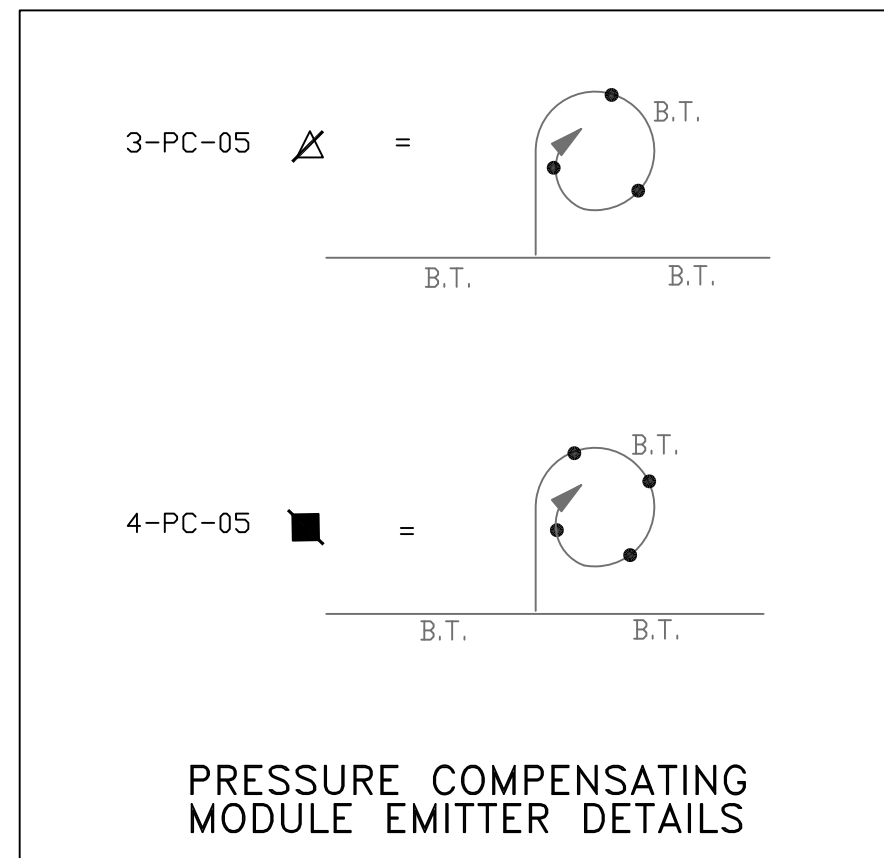
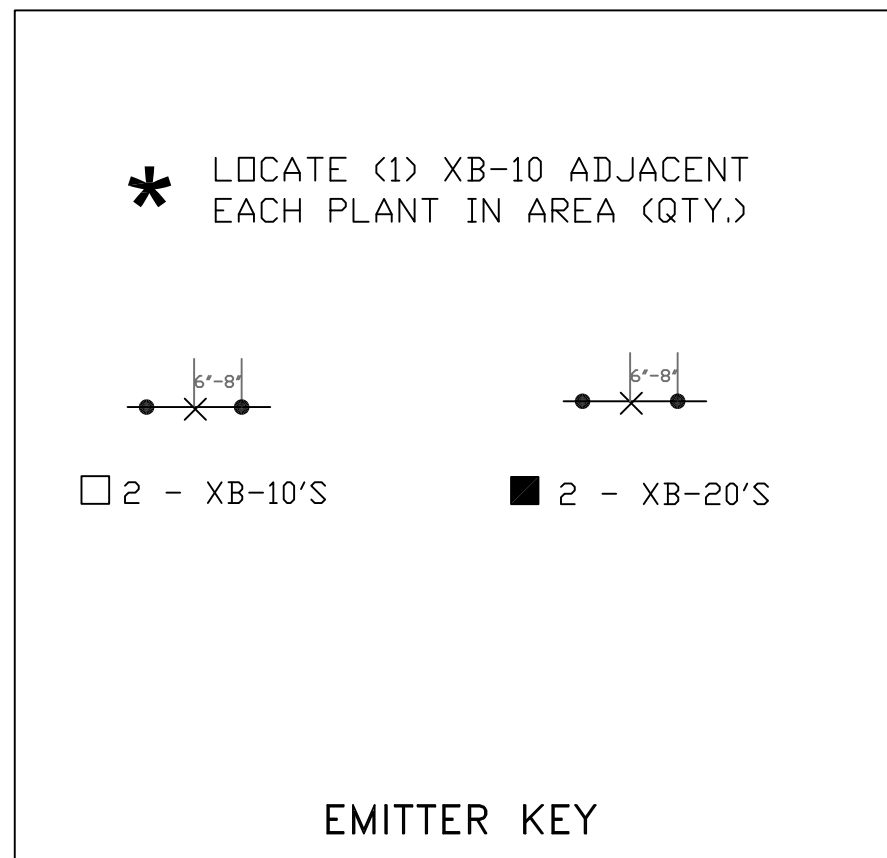
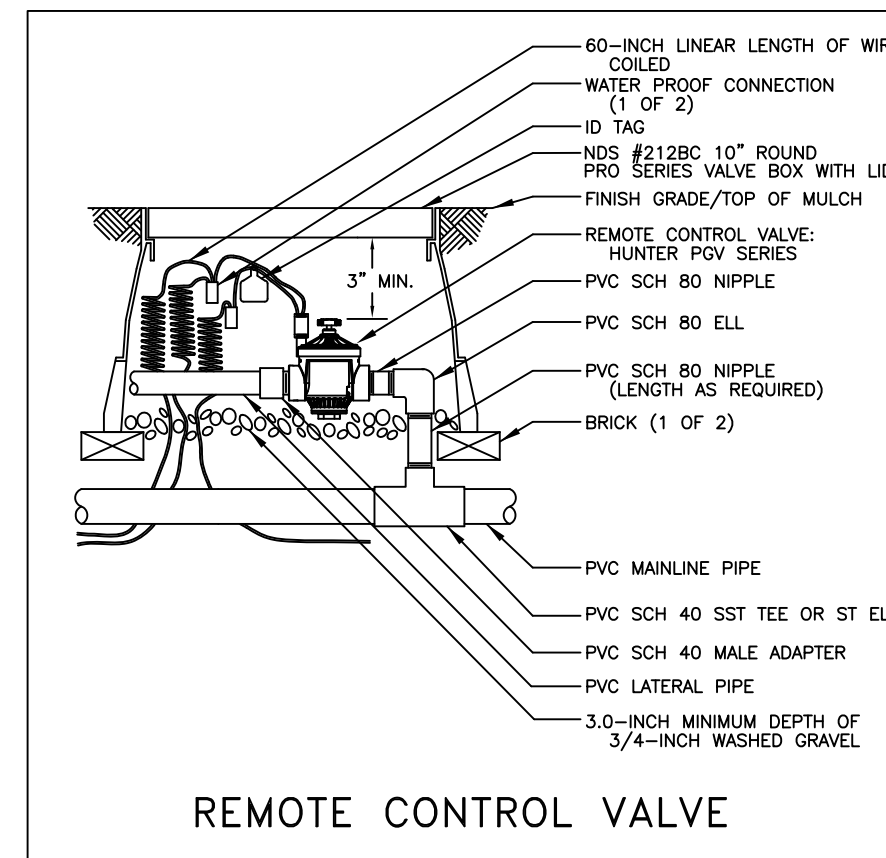
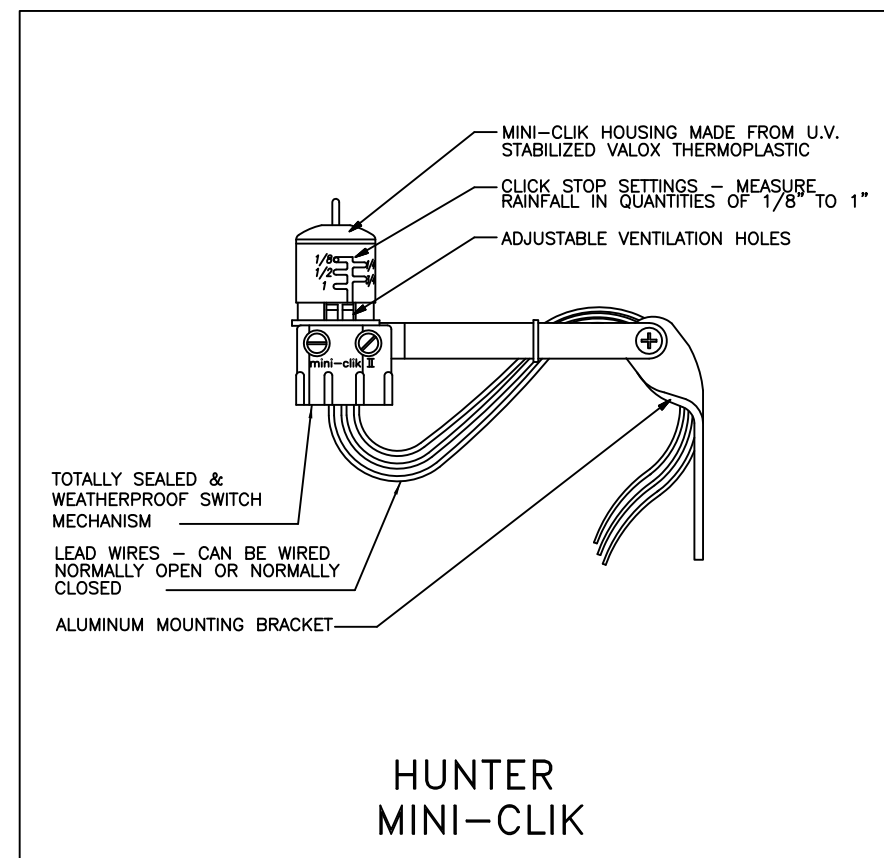
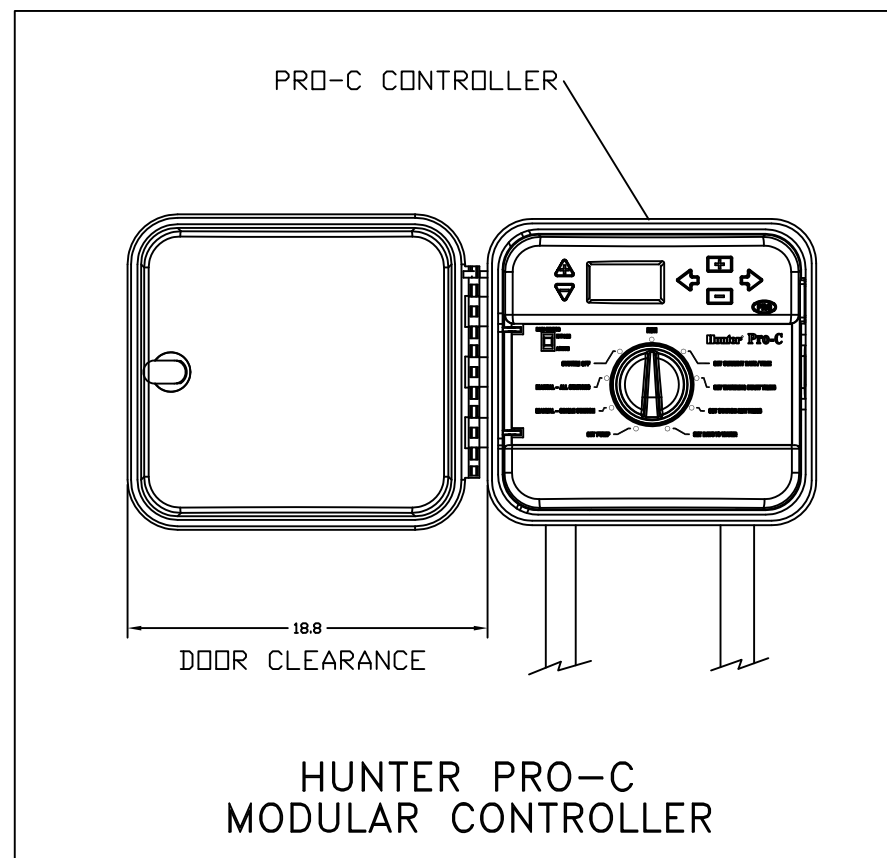
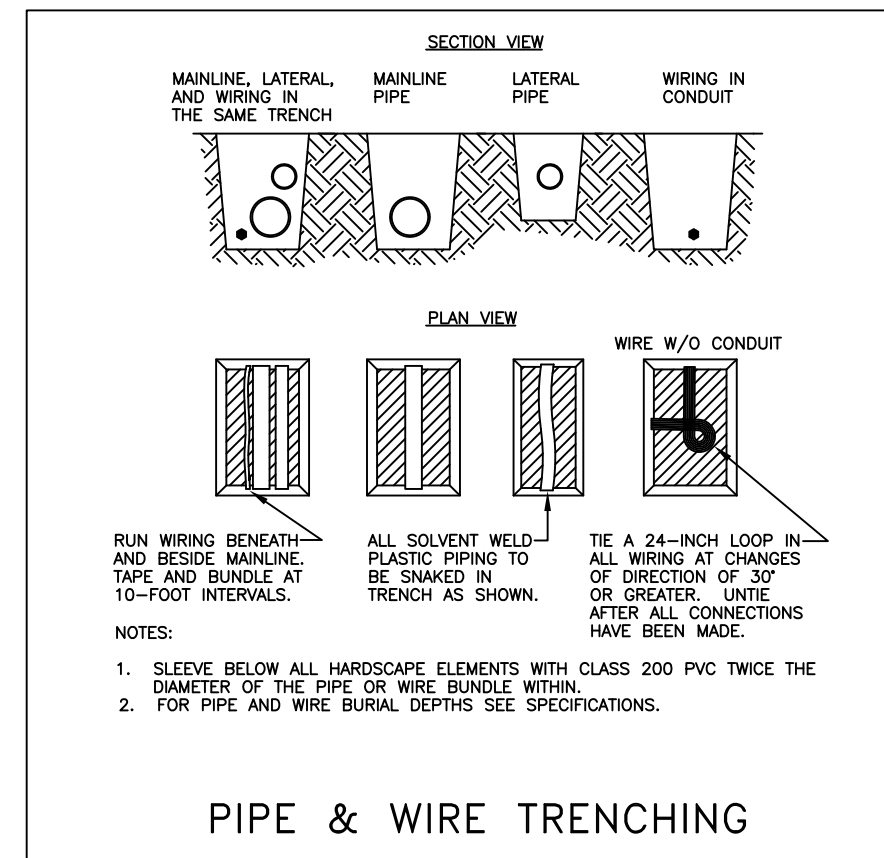
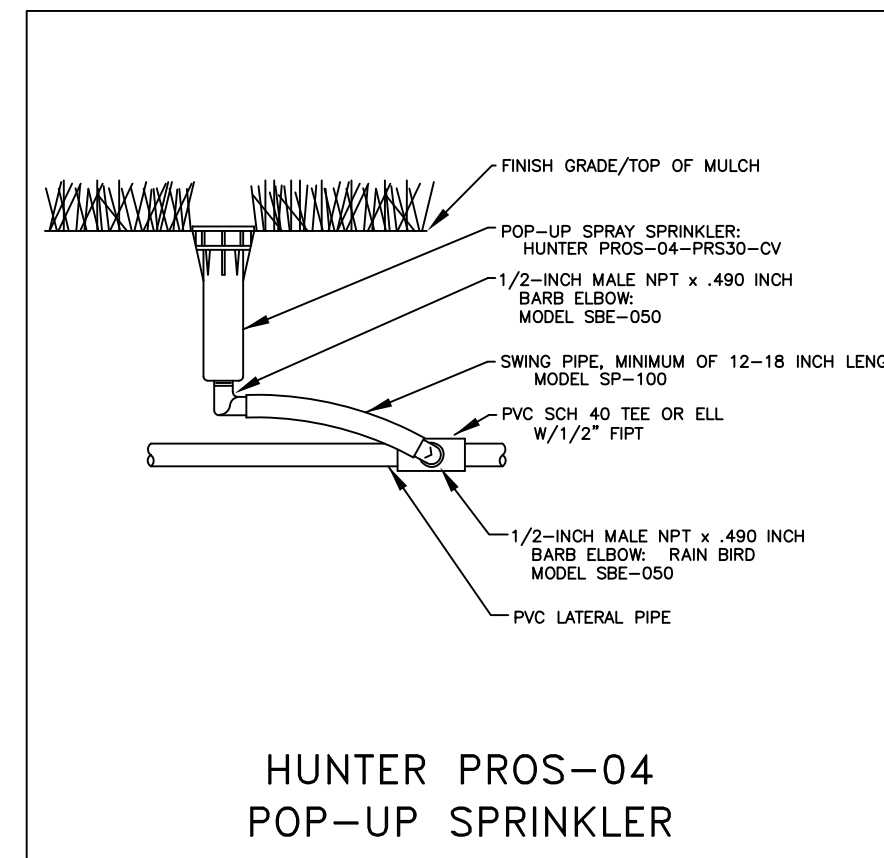
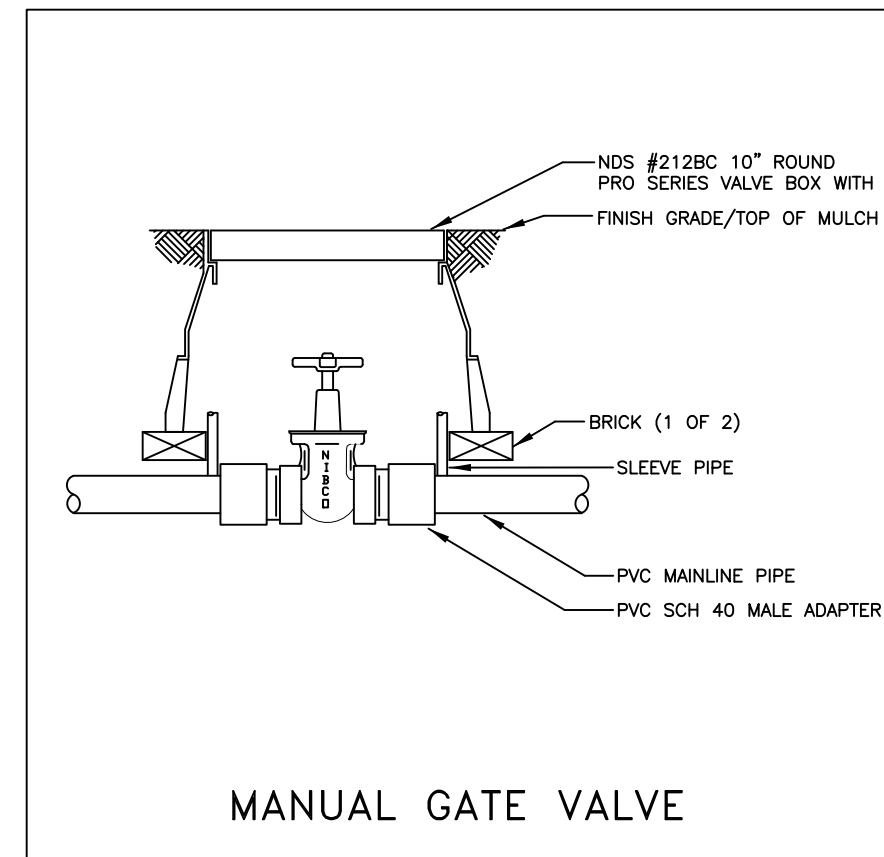

ITEM	SYMBOL	DESCRIPTION
1		HUNTER PC-700 SERIES PRO-C MODULAR CONTROLLER
2		HUNTER MINI-CLIK SERIES WIRED RAIN SENSOR
3		HUNTER PGV SERIES ELECTRIC VALVE
4		HUNTER PRS-04-PRS30-CV SERIES 4" POPUP SPRAYHEAD
5		RAIN BIRD PC-05 SERIES PRESSURE COMPENSATING MODULE EMITTERS
6		RAIN BIRD XB-10 AND XB-20 SERIES XERI-BUG EMITTERS
7		HUNTER PCZ-101-25 SERIES DRIP CONTROL ZONE KIT: HUNTER PGV SERIES ELECTRIC VALVE WITH HUNTER HFR-100-075-25 SERIES 1" X 3/4" OUTLET FILTER REGULATOR.
9		FIGURE 8 END CLOSURE
10		WILKINS MODEL 350-XL 1" BACKFLOW PREVENTER
11		1" METER
12		.520 X .620 BLANK TUBING
13		LATERAL PIPE
14		MAINLINE PIPE
15		NIBCO Ti-8 BRASS 200 W.O.G. GATE VALVE

WATER SOURCE: 1" METER TO PROVIDE A MINIMUM DISCHARGE OF 32 GPM AT 52 PSI FOR SYSTEM TO OPERATE PROPERLY.