





**SITE PLAN LEGEND**

-  (E) PROPERTY LINE
-  (E) CHAIN LINK FENCE
-  BUILDING NOT A PART OF THIS SCOPE.
-  REMOVE (E) ROOFING DOWN TO EXISTING ROOF DECK AND PREPARE FOR INSTALLATION OF NEW SINGLE PLY ROOFING MEMBRANE. THIS INCLUDES BUT IS NOT LIMITED TO THE EXISTING SINGLE PLY ROOF.

ARCHITECT STAMP

CONSULTANT STAMP

REVISIONS

NO.	DATE	DESCRIPTION

PROJECT OWNER & TITLE

**COVINA-VALLEY UNIFIED  
SCHOOL DISTRICT**  
519 E Badillo Street  
Covina, CA 91723

**BEN LOMOND  
ELEMENTARY SCHOOL**

621 E Covina Blvd  
Covina, CA 91722

SHEET TITLE

**SITE PLAN**

DRAWN BY:

JOB NUMBER:

SHEET NO.

**G-101**

DATE:





**KEYNOTES**

- 07.01.A (E) ROOF TO REMAIN
- 07.01.B REMOVE (E) SINGLE PLY ROOFING SYSTEM AND ALL ASSOCIATED FLASHING. REMOVE ROOFING MATERIAL DOWN TO EXISTING DECK AND PREPARE FOR INSTALLATION OF NEW SINGLE PLY ROOFING RETROFIT. INSTALL NEW EDGE METAL.
- 07.02.A PREP (E) PIPE AND VENT PENETRATIONS FOR (N) SEALS. REMOVE ALL NECESSARY ROOFING OR (E) SEALANT MATERIAL & PROTECT IN PLACE ALL AREAS NOT AFFECTED BY NEW PIPE/VENT PENETRATION SEALS.
- 07.60.A REMOVE (E) GUTTER AND DOWN SPOUT AT ROOF EDGE.

**GENERAL NOTES**

1. THE DEMOLITION KEYNOTES ARE THE RESPONSIBILITY OF THE GENERAL CONTRACTOR.
2. GENERAL CONTRACTOR SHALL SALVAGE MECHANICAL EQUIPMENT, DISCONNECTS AND CONTROLS FOR REINSTALLATION. PROTECT WITHIN LAY DOWN AREA.
3. CONTRACTOR SHALL PROVIDE FULL SCAFFOLD AND STAIR TOWER ACCESS TO ROOF IF REQUIRED. PROVIDE ALL OSHA REQUIREMENTS INCLUDING FALL PROTECTION.
4. (E) DURABLOCKS SHALL REMAIN; REPLACE ALL WOOD BLOCKS AND METAL SUPPORTS WITH (N) DURABLOCKS; TYPICAL AT ALL ROOFS.
5. PROTECT IN PLACE ALL (E) ELECTRICAL CONDUITS, TYPICAL OF ALL ROOF CONDITIONS.
6. CONTRACTOR TO REPLACE ANY DAMAGED FASCIA OR WOOD DECKING.

**DEMOLITION LEGEND**

-  (E) ROOFING MATERIAL TO REMAIN.
-  (E) ROOF SYSTEM, REMOVE IN ITS ENTIRETY.

**DEMOLITION NOTES**

1. IN ACCORDANCE WITH PERTINENT ITEMS OF THESE NOTES AND THOSE ITEMS SO INDICATED ON THE DRAWINGS, CAREFULLY DEMOLISH AND REMOVE FROM THE JOB SITE THOSE ITEMS SCHEDULED TO BE SO DEMOLISHED AND REMOVED.
2. PREPARE AND FOLLOW AN ORGANIZED PLAN FOR DEMOLITION AND REMOVAL OF ITEMS. SHARE PLAN WITH DISTRICT.
3. DEMOLITION: BY CAREFUL STUDY OF THE DRAWINGS, DETERMINE THE LOCATION AND EXTENT OF SELECTIVE DEMOLITION REQUIRED.
4. VISIT THE SITE AND VERIFY THE EXTENT AND LOCATION OF SELECTIVE DEMOLITION REQUIRED. CAREFULLY IDENTIFY LIMITS OF SELECTIVE DEMOLITION.
5. KEYNOTED ELEMENTS SCHEDULED FOR DEMOLITION ARE NOTED FOR CLARIFICATION ONLY. SEE GENERAL NOTES, LEGENDS, PLANS, ELEVATIONS AND DETAILS FOR ADDITIONAL DEMOLITION REQUIREMENTS.
6. USE ADEQUATE NUMBERS OF SKILLED WORKMAN WHO ARE THOROUGHLY TRAINED AND EXPERIENCED IN THE NECESSARY CRAFTS AND WHO ARE COMPLETELY FAMILIAR WITH THE SPECIFIED REQUIREMENTS AND THE METHODS NEEDED FOR PROPER PERFORMANCE OF THE WORK.
7. SURFACE CONDITIONS: EXAMINE THE AREAS AND CONDITIONS UNDER WHICH WORK WILL BE PERFORMED. INCORRECT CONDITIONS ARE DETRIMENTAL TO TIMELY AND PROPER COMPLETION OF THE WORK. DO NOT PROCEED UNTIL UNSATISFACTORY CONDITIONS ARE CORRECTED.
8. MARK INTERFACE SURFACES AS REQUIRED TO ENABLE WORKMAN ALSO TO IDENTIFY ITEMS TO BE REMOVED AND ITEMS TO BE LEFT IN PLACE INTACT.
9. COMPLETELY REMOVE ITEMS SCHEDULED TO BE DEMOLISHED AND REMOVED, LEAVING SURFACES CLEAN, SOLID AND READY TO RECEIVE NEW MATERIALS SPECIFIED ELSEWHERE.
10. REPLACEMENTS: IN THE EVENT OF DEMOLITION OF ITEMS NOT SO SCHEDULED TO BE DEMOLISHED, PROMPTLY REPLACE SUCH ITEMS TO THE APPROVAL OF THE DISTRICT AND AT NO ADDITIONAL COST TO THE DISTRICT.
11. THE PLANS AND SPECIFICATIONS INDICATE THE GENERAL EXTENT OF WORK BASED ON OWNER PROVIDED "EXISTING" DRAWINGS AND LIMITED FIELD VERIFICATION. THE CONTRACTOR SHALL VERIFY THE EXISTING CONDITIONS AND WILL BE RESPONSIBLE FOR DISCONNECTING AND RECONNECTING PLUMBING, MECHANICAL AND ELECTRICAL SYSTEMS NECESSARY TO ACCOMPLISH WORK WHETHER SPECIFICALLY INDICATED OR NOT.
12. ALL EXISTING MATERIAL NOT TO BE REUSED OR NOT INDICATED TO BE RETAINED BY THE OWNER SHALL BE REMOVED FROM THE SITE AND BECOME THE PROPERTY OF THE CONTRACTOR FOR SALVAGE.
13. THE CONTRACTOR IS RESPONSIBLE FOR DAILY REMOVAL OF DEBRIS AND CLEANING THE AREA WHERE THEY ARE WORKING. THE CONTRACTOR MUST PROVIDE THEIR OWN MEANS OF DEBRIS AND WASTE REMOVAL AND MAY NOT USE THE OWNER'S WASTE RECEPTACLES.
14. ANY ADJACENT ITEMS OR SURFACES TO THE DEMOLITION WORK THAT IS DAMAGED DURING THE CONSTRUCTION SHALL BE RESTORED TO ITS ORIGINAL CONDITION OR FINISHED TO MATCH ADJACENT SURFACES AT NO ADDITIONAL COST TO THE OWNER.

**KEY PLAN**

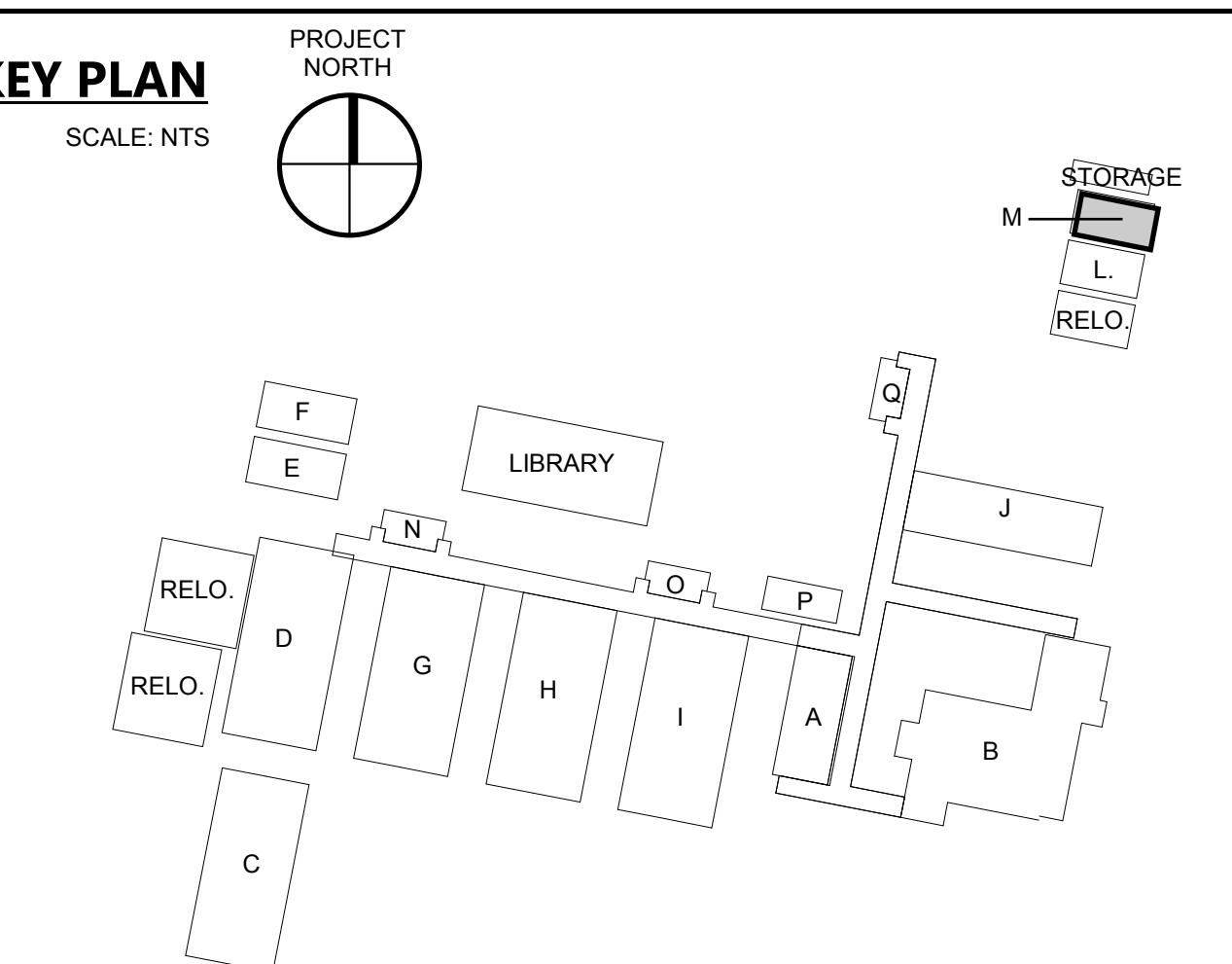

ARCHITECT STAMP      CONSULTANT STAMP

REVISIONS

NO.	DATE	DESCRIPTION

PROJECT OWNER & TITLE  
**COVINA-VALLEY UNIFIED  
SCHOOL DISTRICT**  
519 E Badillo Street  
Covina, CA 91723

**BEN LOMOND  
ELEMENTARY SCHOOL**  
621 E Covina Blvd  
Covina, CA 91722

SHEET TITLE  
**(E) BUILDING M  
DEMOLITION PLAN**

DRAWN BY:      JOB NUMBER:

SHEET NO.  
**A01-021**

DATE:

07.60.A

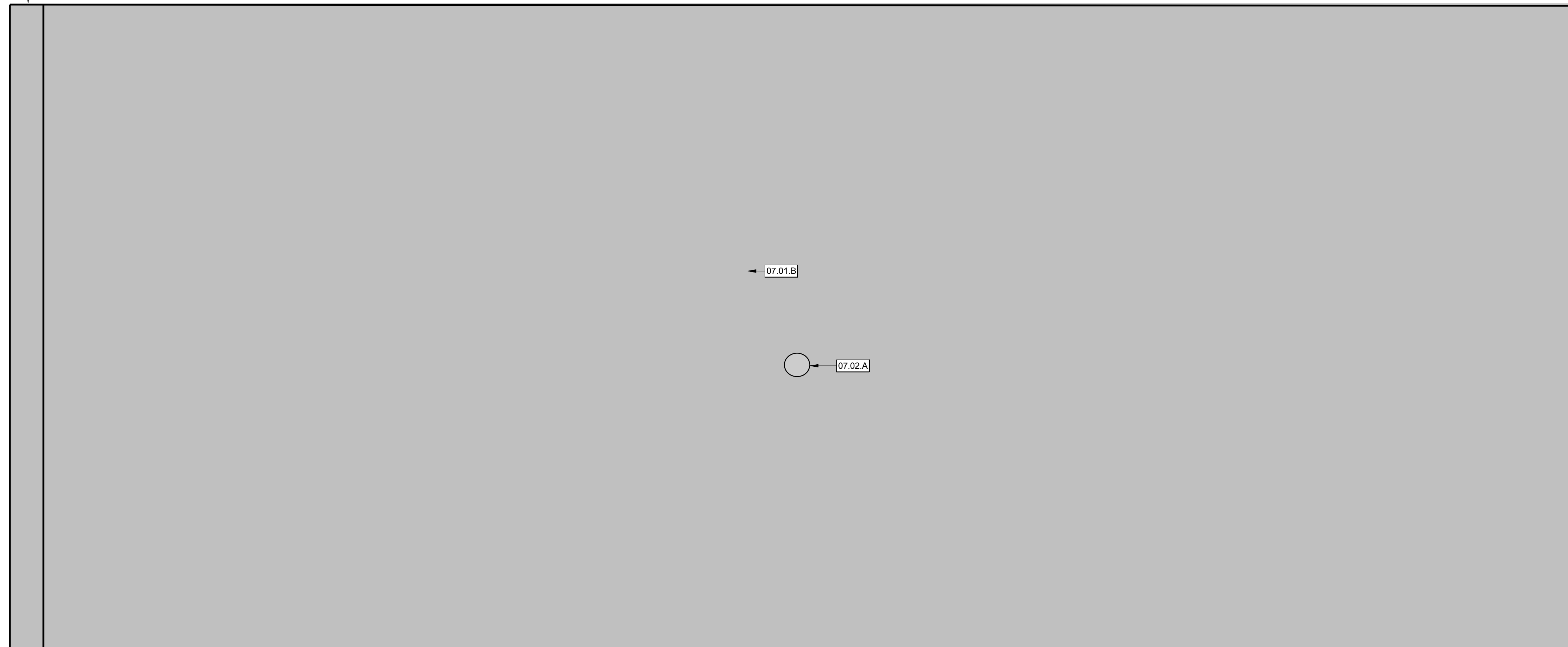

07.01.B

07.02.A

07.01.A

(E) BUILDING L



AGENCY APPROVAL

**BID**  
**22-23-108**



**KEYNOTES**

- 07.01.A (E) ROOF TO REMAIN
- 07.01.C INSTALL FULLY ADHERED SINGLE PLY ROOFING SYSTEM RETROFIT PER MANUFACTURER'S DETAILS, SPECIFICATIONS, AND INSTALLATION GUIDES.
- 07.02.B SEAL (E) PIPE & VENT PENETRATIONS
- 07.60.B (N) GUTTER SYSTEM ATTACHED TO (N) DOWNSPOUTS

**ROOF PLAN GENERAL NOTES**

1. (E) DURABLEBLOCKS SHALL REMAIN; REPLACE ALL WOOD BLOCKS AND METAL SUPPORTS WITH (N) DURABLEBLOCKS; TYPICAL AT ALL ROOFS.
2. CONTRACTOR TO REPLACE ANY DAMAGED FASCIA OR WOOD DECKING.
3. GUTTER STYLES SHALL BE SELECTED BY DISTRICT PRIOR TO PLACING ORDER AND INSTALLATION.

**PLAN LEGEND**

-  (E) ROOFING MATERIAL TO REMAIN.
-  (N) ROOF SYSTEM & STRUCTURE EXTENTS.

**KEY PLAN**

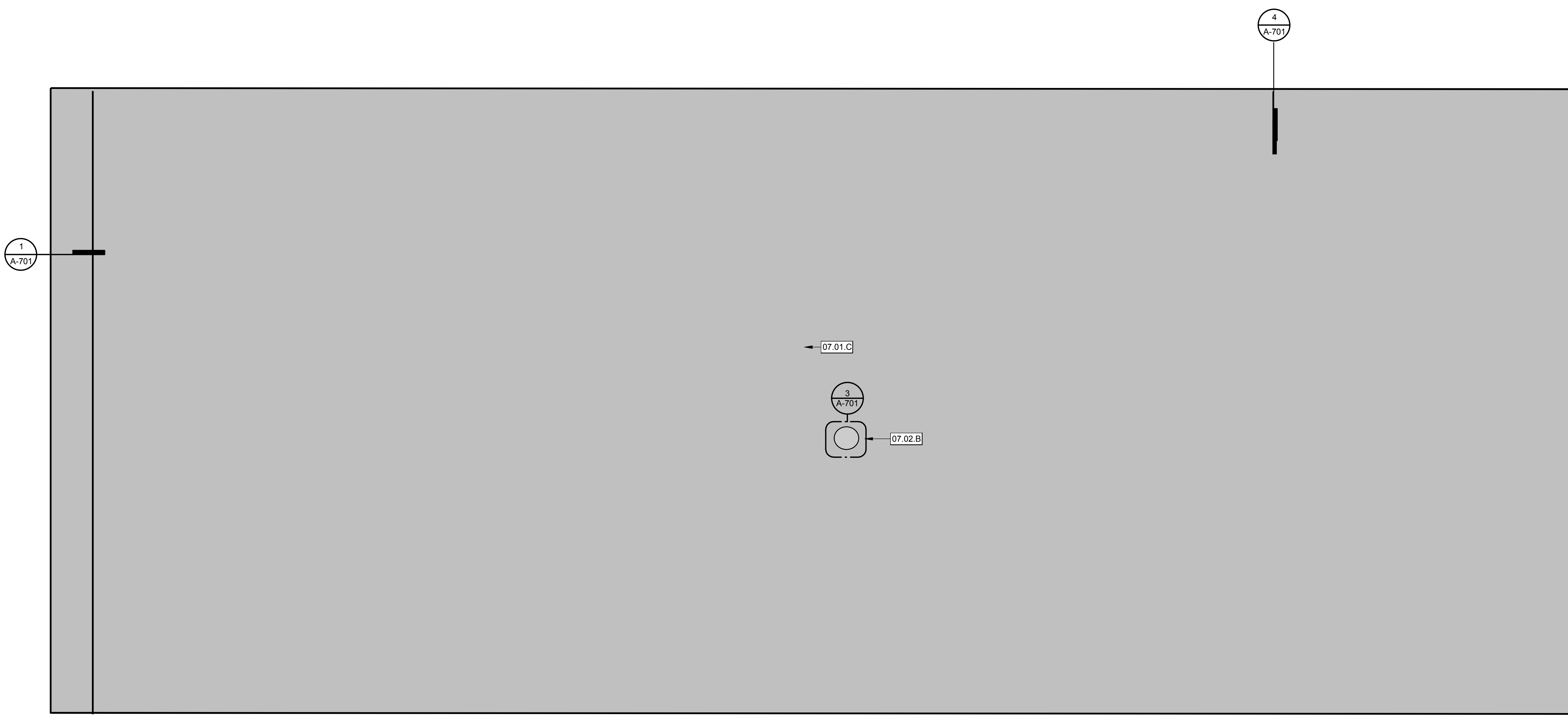
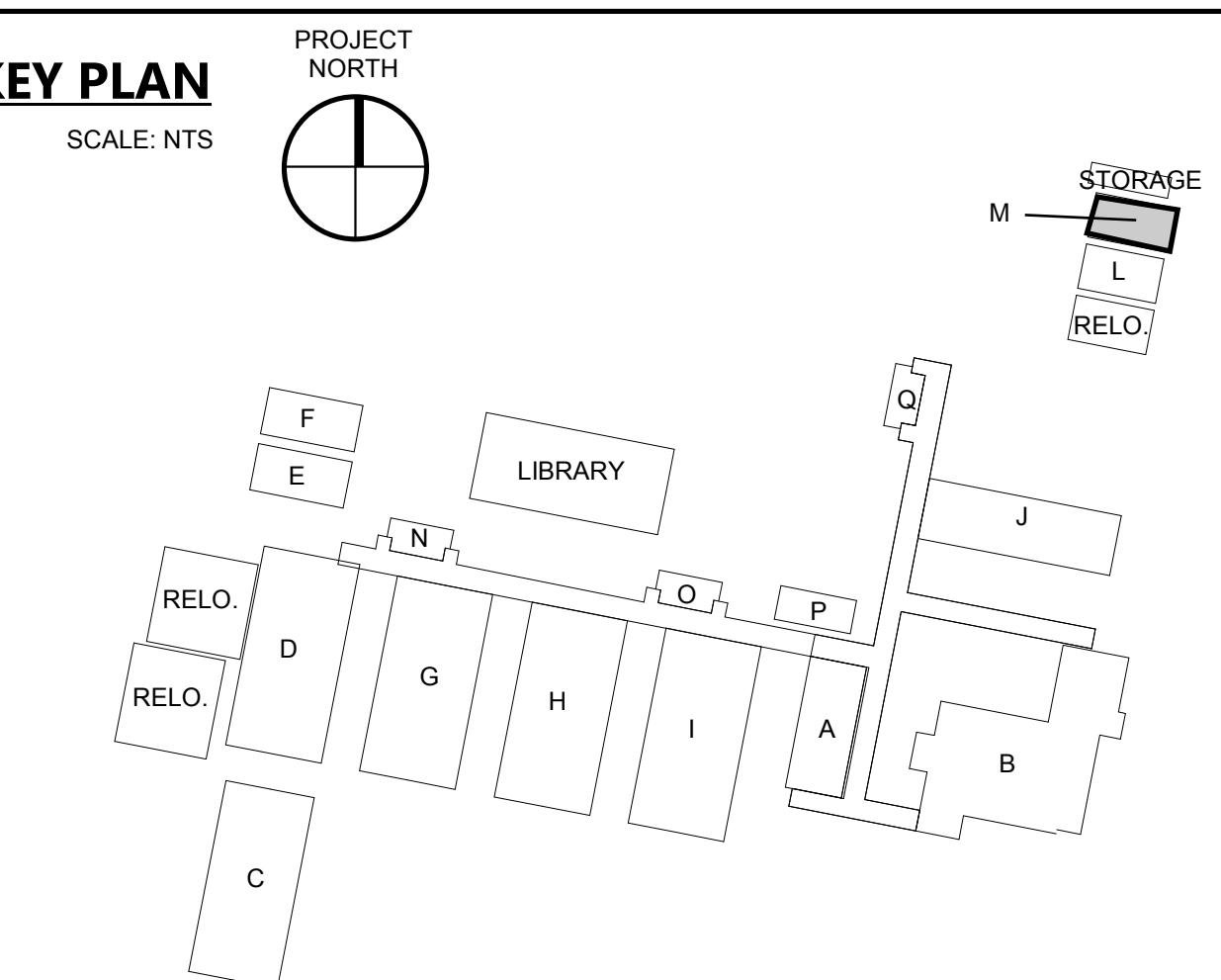

ARCHITECT STAMP      CONSULTANT STAMP

REVISIONS

NO.	DATE	DESCRIPTION

PROJECT OWNER & TITLE

**COVINA-VALLEY UNIFIED SCHOOL DISTRICT**  
519 E Badillo Street  
Covina, CA 91723

**BEN LOMOND ELEMENTARY SCHOOL**  
621 E Covina Blvd  
Covina, CA 91722

SHEET TITLE

**(E) BUILDING M ROOF PLAN**

DRAWN BY:      JOB NUMBER:

SHEET NO.

**A01-221**

DATE:

07.01.A  
(E) BUILDING L



**BUILDING G ROOF PLAN**

N.T.S.

**1**

PROJECT STATUS

# BID 22-23-108

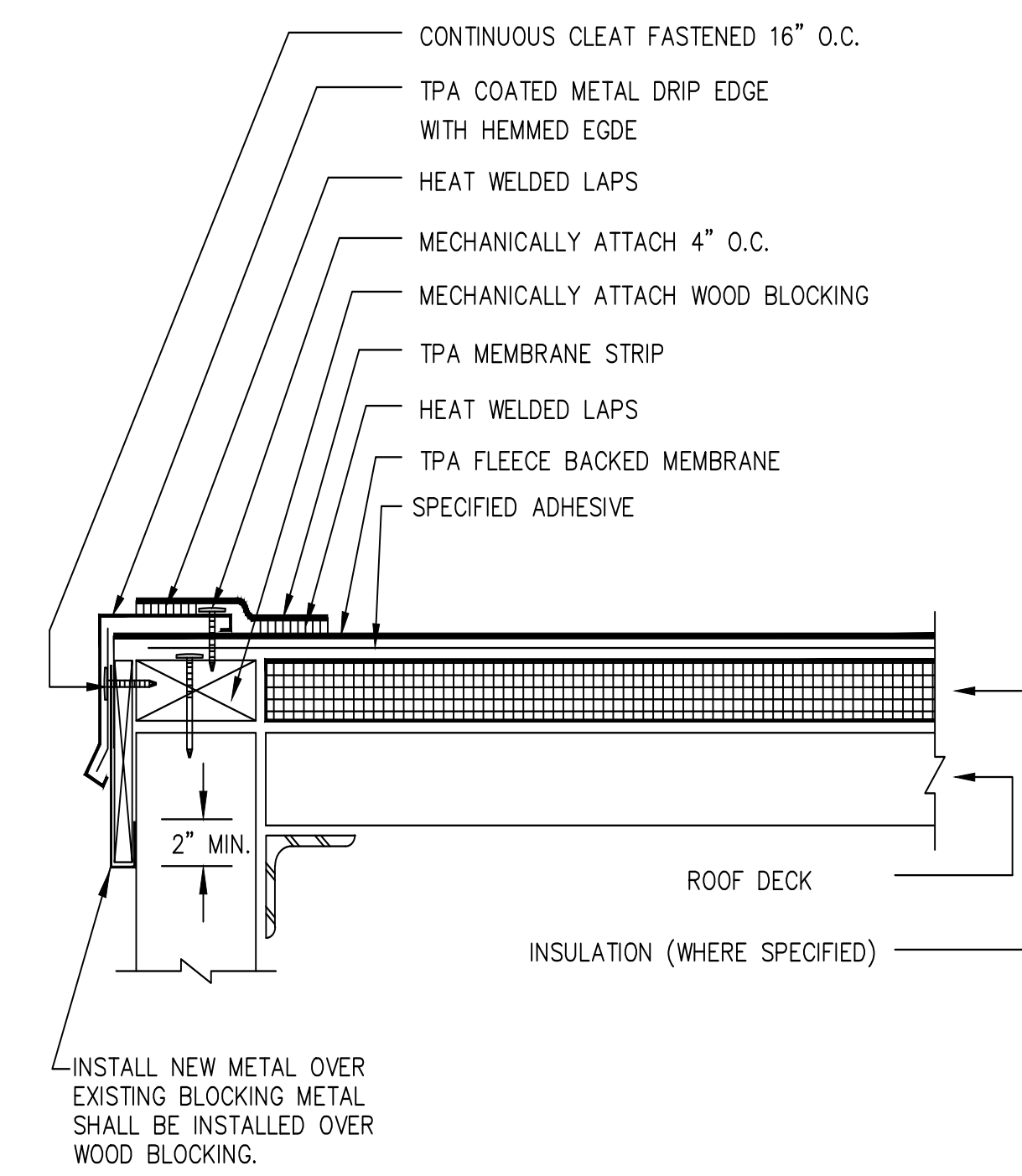

**EDGE DETAILING** N.T.S. **4**

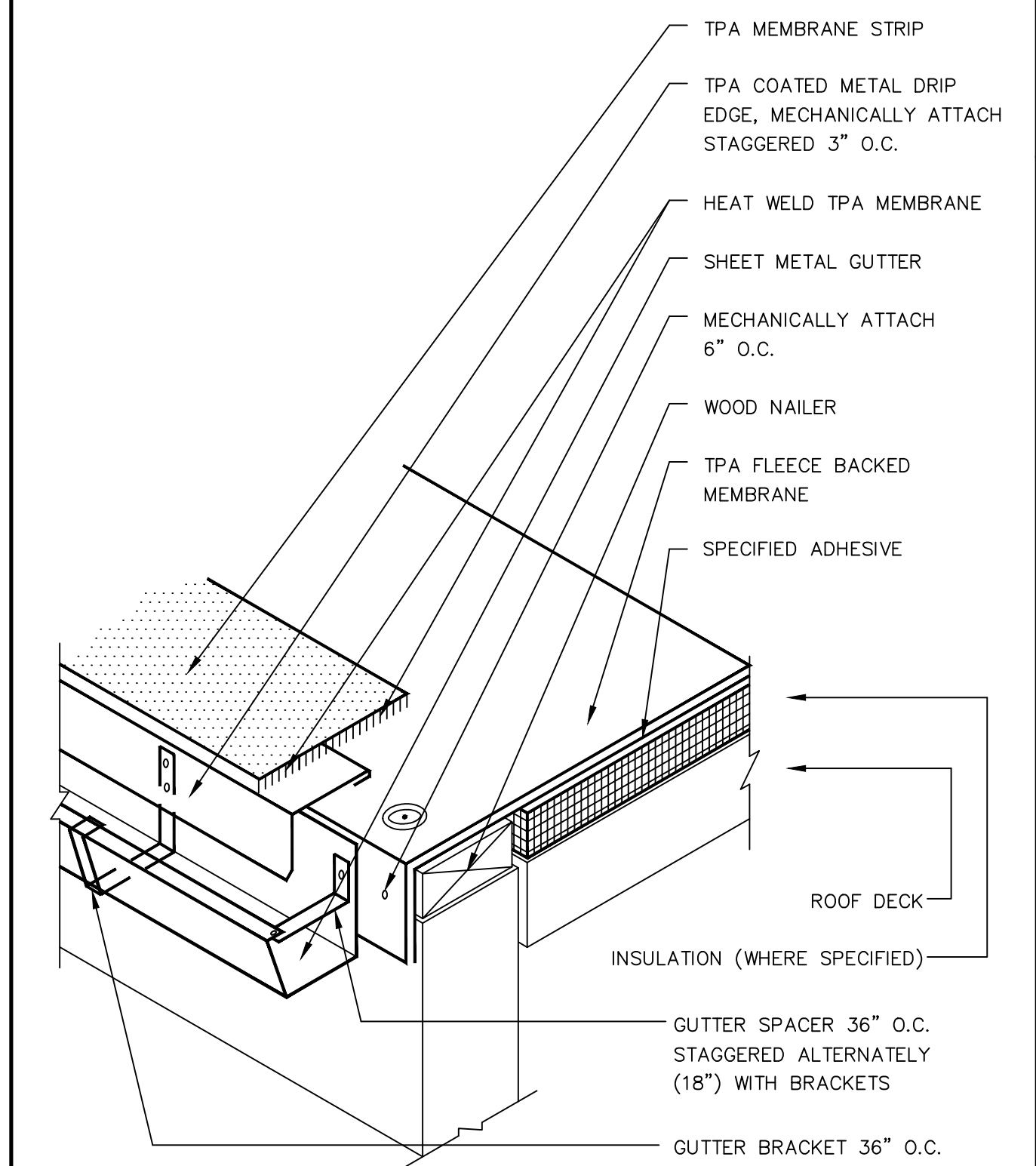

**GUTTER DETAIL** N.T.S. **1**

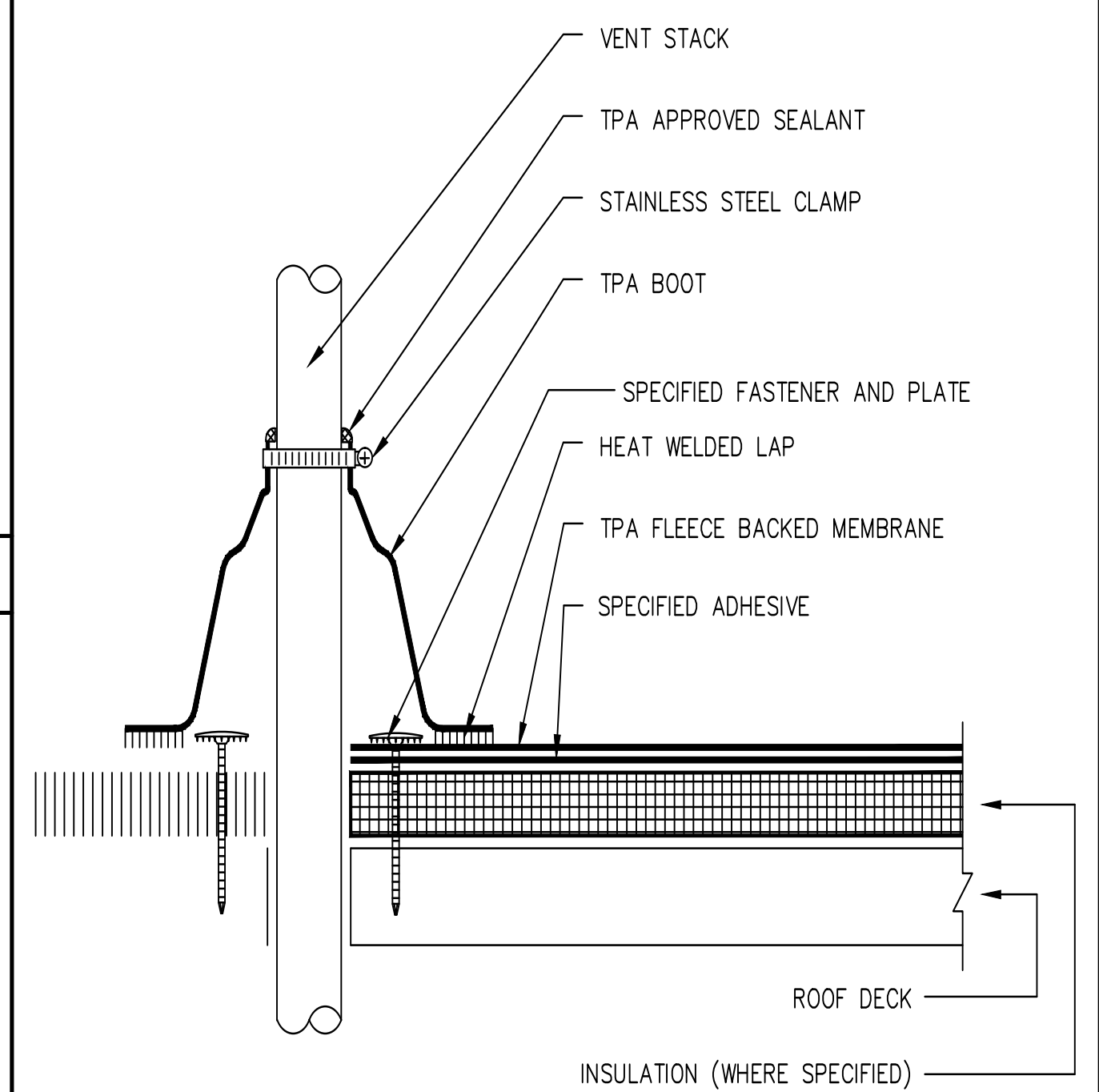

**PIPE FLASHING** N.T.S. **3**

ARCHITECT STAMP      CONSULTANT STAMP

REVISIONS

NO.	DATE	DESCRIPTION

PROJECT OWNER & TITLE  
**COVINA-VALLEY UNIFIED SCHOOL DISTRICT**  
 519 E Badillo Street  
 Covina, CA 91723

**BEN LOMOND ELEMENTARY SCHOOL**  
 621 E Covina Blvd  
 Covina, CA 91722

SHEET TITLE

**DETAILS**

DRAWN BY:      JOB NUMBER:

SHEET NO.

**A-701**

DATE:

PROJECT STATUS